

PROJECT NO.	APPROVAL	DATE	STATUS	APPROVED BY
2737	AP	12/15/2011	APPROVED	NA
7982	PO	12/15/2011	APPROVED	NA
7982	CA	12/15/2011	APPROVED	NA
12211	PO	12/15/2011	APPROVED	NA
12213	PO	12/15/2011	APPROVED	NA

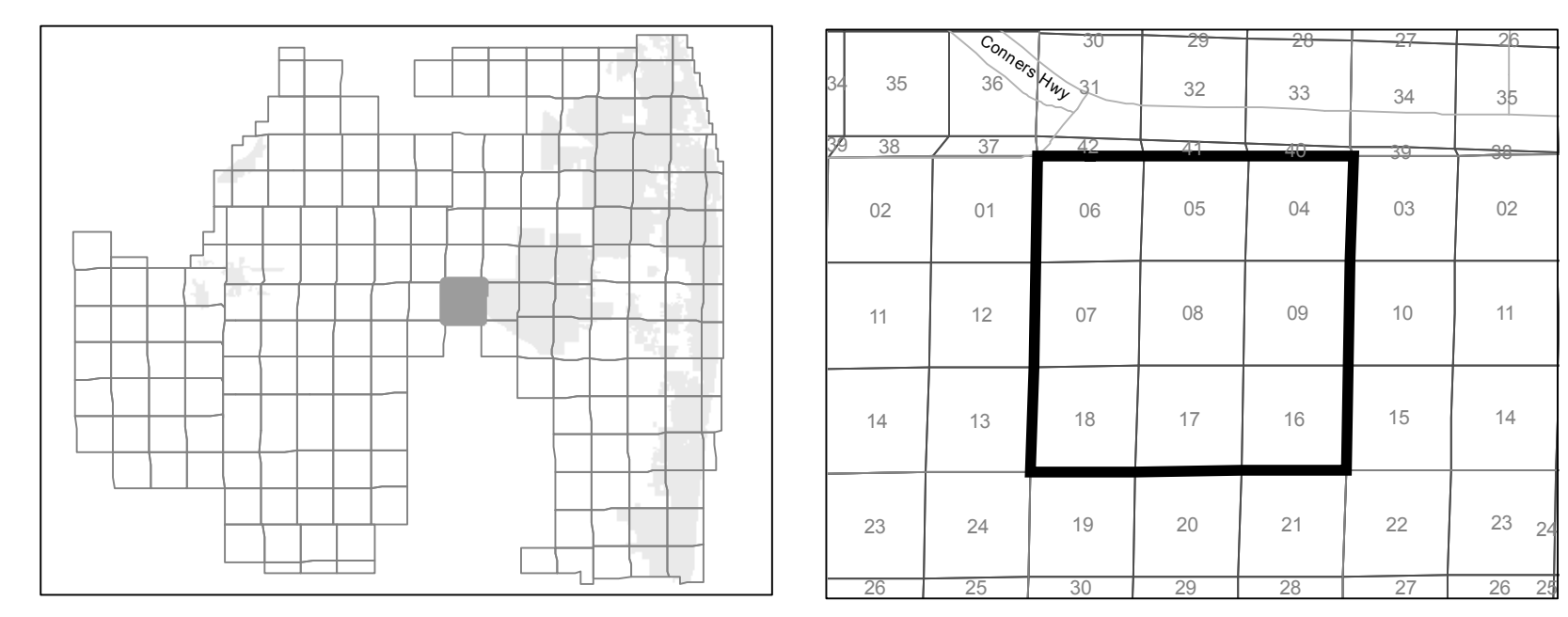
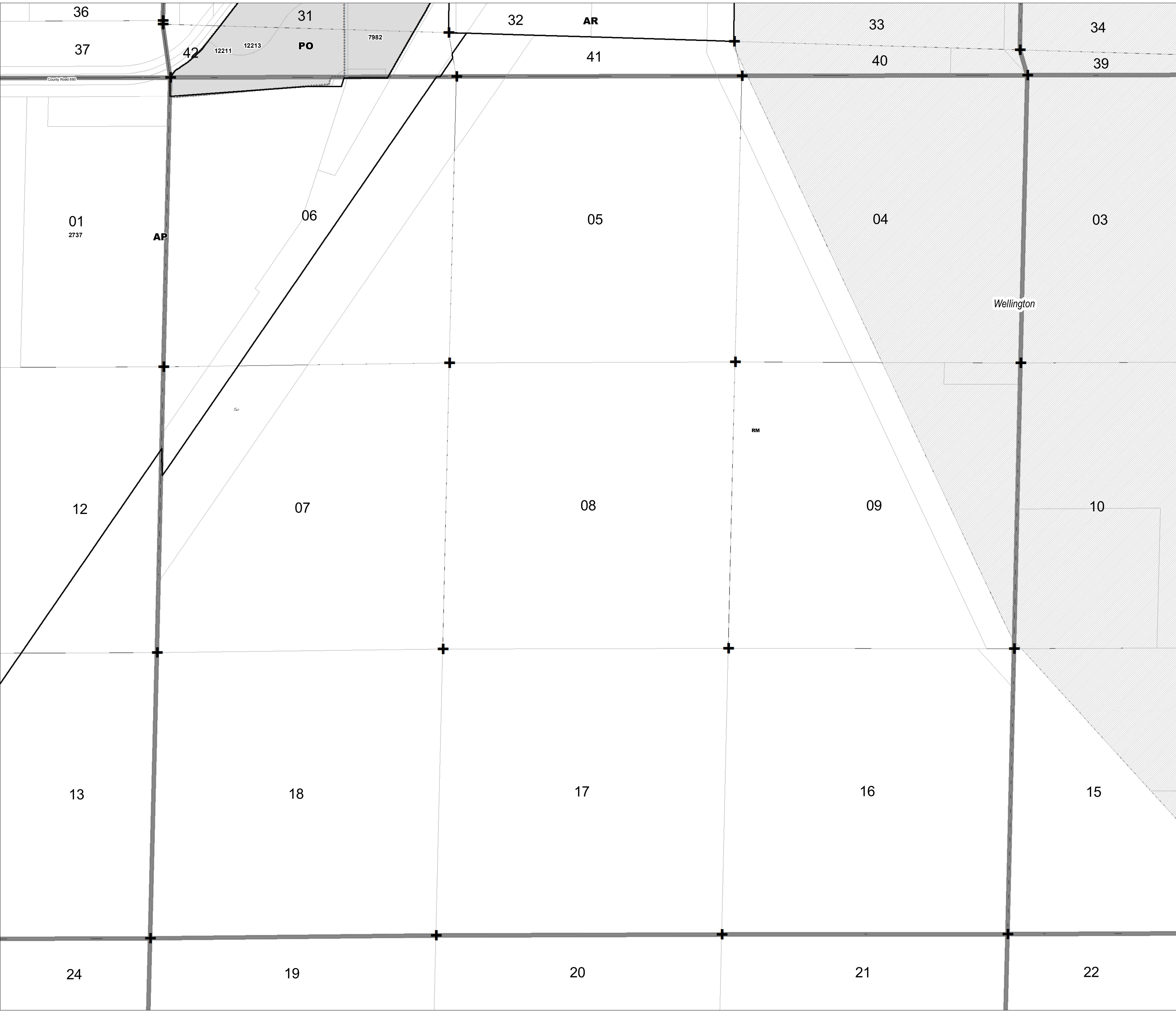

**ZONING QUAD 108**  
 Zoning District Map of Palm Beach County  
 February 19, 2014

12345	Additional Approvals		Overlays		Water
	Zoning Quad Boundary		Parcels		Section Lines
	Zoning District Boundary		Municipality		
	Corresponding PDD (CPDD) - Pursuant to Article 3.A.2.D of the ULDC (amended under Ordinance 2012-003) The Zoning Director has the authority to update the Official Zoning Map administratively to delineate a Planned Development District that corresponds to those prior approvals that are specified in Art.3.A.3.E.2, Planned Development Districts.				1 inch = 600 feet 0 600 1,200 Feet

**PALM BEACH COUNTY**  
 Planning, Zoning and Building Department