

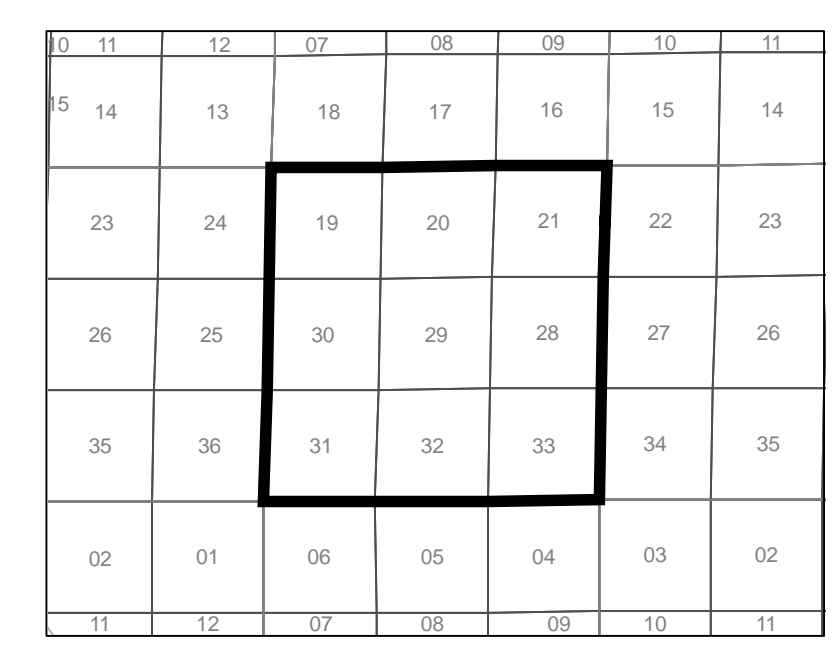

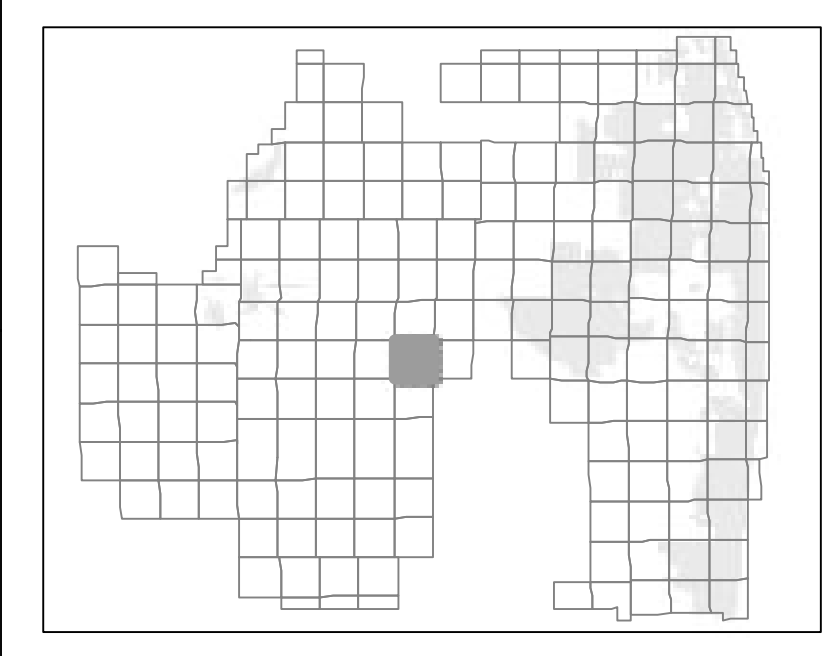

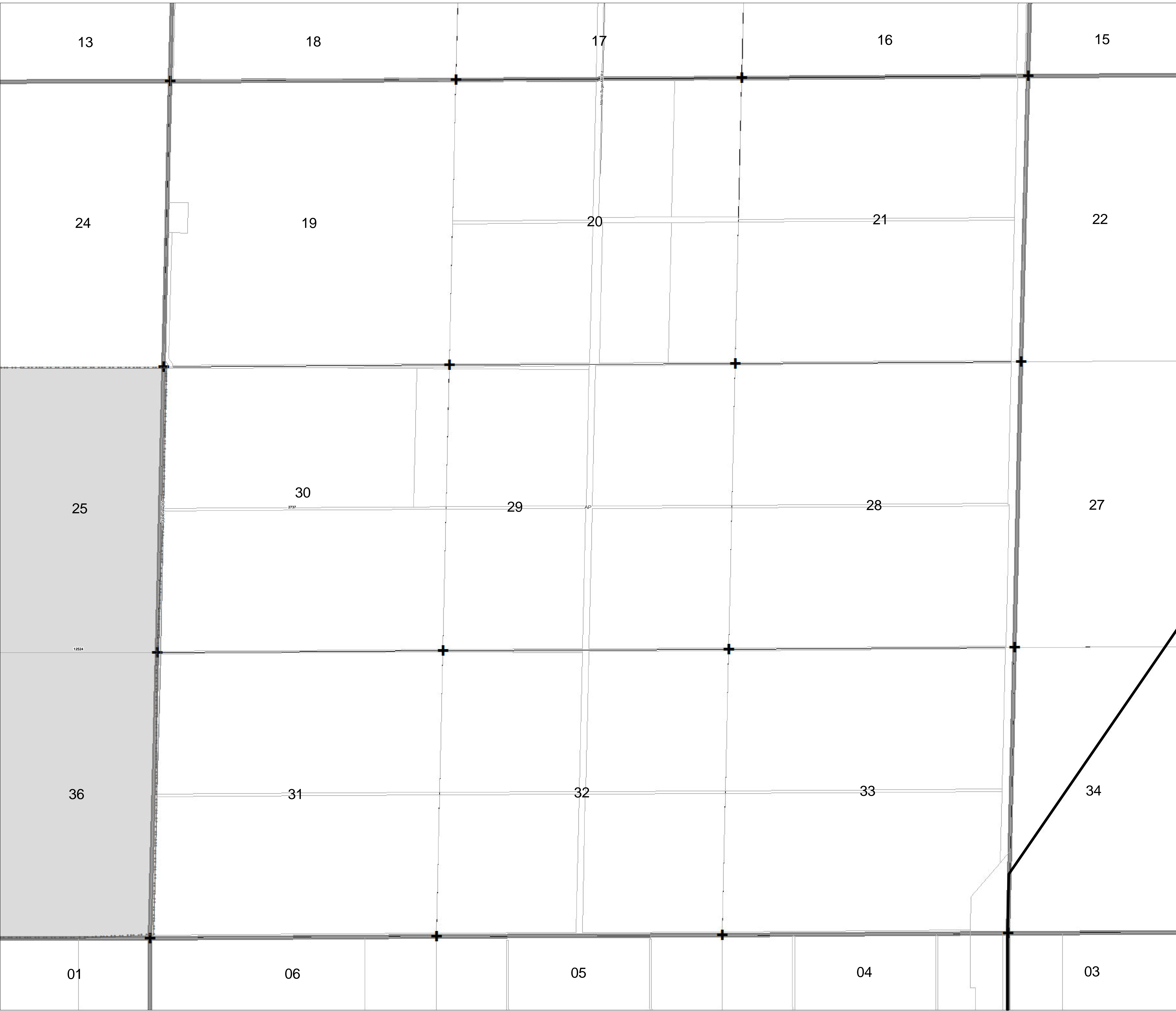



IDENT. NO.	ZONING	APPROVAL	PETITION	SUPPLEMENT	RESOLUTION	DATE	DECISION
1737	AM	NA	95-05	NA	6-19-95	199505	APPROVED
1738	AM	CA	2011-0004	NA	12-07-2011	20110004	APPROVED
1739	AM	CA	2011-0004	NA	12-07-2011	20110004	APPROVED

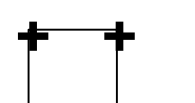

ZONING QUAD 139
Zoning District Map of Palm Beach County
 June 18, 2012

-  12345 Additional Approvals
-  Overlays
-  Water
-  Zoning Quad Boundary
-  Parcels
-  Section Lines
-  Zoning District Boundary
-  Municipality

