

AGENT	MC	COMM	APPROVAL	PETITION	RESOLUTION	DATE	DECISION	STATUS
1001	NA	NA	NA	1000-0001	NA	12/10/10	APPROVED	NA
1002	NA	NA	NA	1000-0002	NA	12/10/10	APPROVED	NA
1003	NA	NA	NA	1000-0003	NA	12/10/10	APPROVED	NA
1004	NA	NA	NA	1000-0004	NA	12/10/10	APPROVED	NA
1005	NA	NA	NA	1000-0005	NA	12/10/10	APPROVED	NA

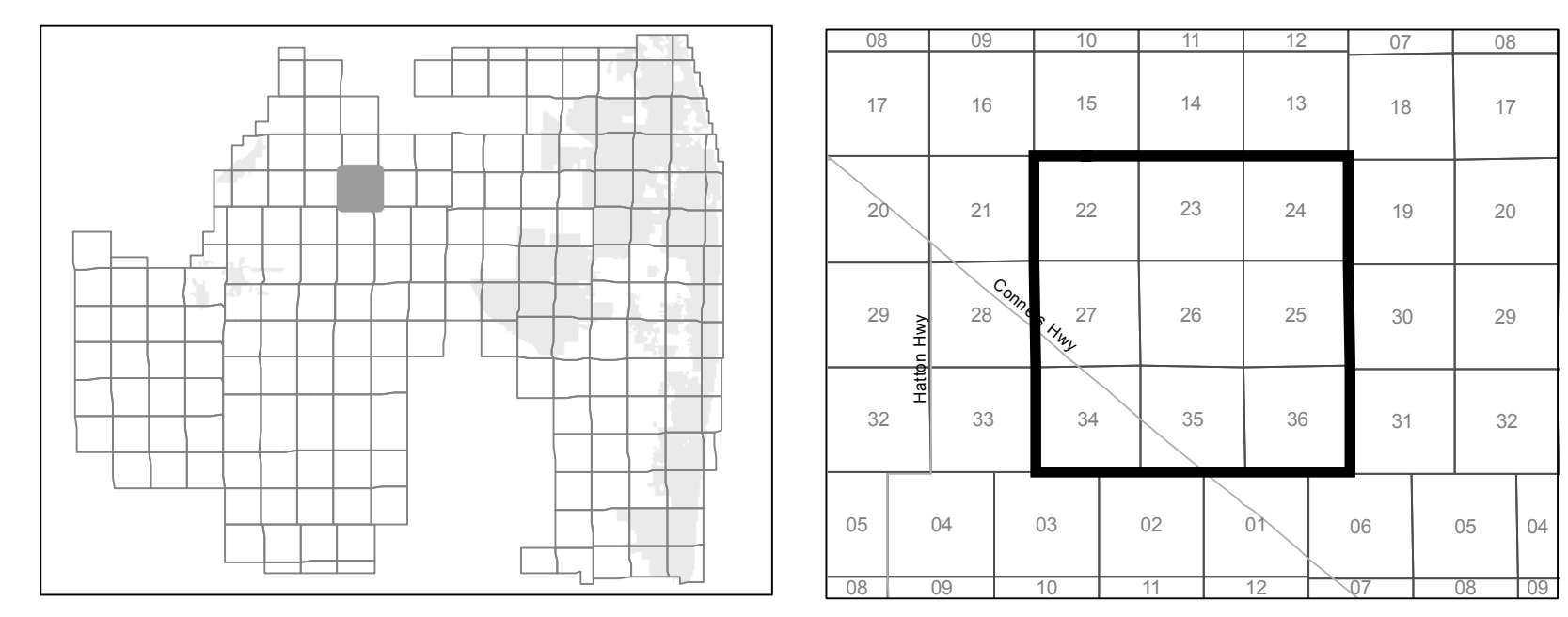
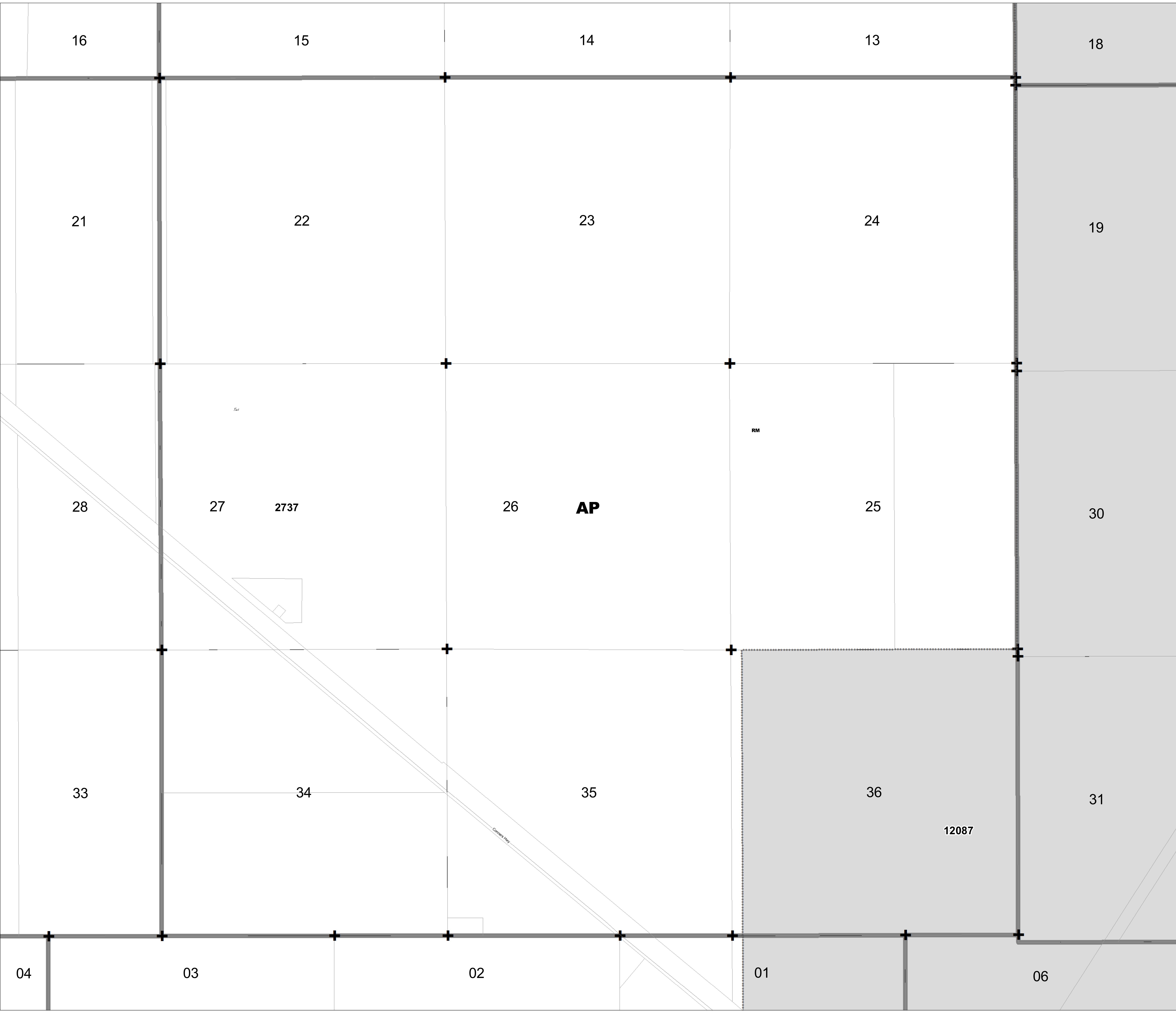

**ZONING QUAD 150**  
 Zoning District Map of Palm Beach County  
 December 09, 2013

12345	Additional Approvals		Overlays		Water
	Zoning Quad Boundary		Parcels		Section Lines
	Zoning District Boundary		Municipality		1 inch = 600 feet 0 600 1200 Feet
	Corresponding PDD (CPDD) - Pursuant to Article 3.A.2.D of the ULDC (amended under Ordinance 2012-003) The Zoning Director has the authority to update the Official Zoning Map administratively to delineate a Planned Development District that corresponds to those prior approvals that are specified in Art.3.A.3.E.2, Planned Development Districts.	 <b>PALM BEACH COUNTY</b> Planning, Zoning and Building Department			