

13 18
24

18 17
20

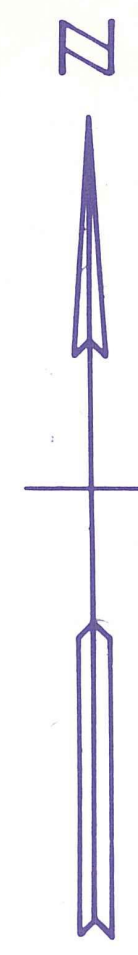

Palm Beach County (County) makes no representation or warranties whatsoever on the attached / enclosed information reflected herein pertaining to easements, rights-of-way, setback lines, reservations, agreements, and other similar matters. The information provided herein should not be relied upon by the requesting party to confirm the existence / non-existence of facts contained herein.

00-000-900.0

610.11 AC.

CANAL
C-18
20.80 ACRES
00-090-100.0

PT. OF SECTION IN COUNTY-00
PT OF SEC IN PALM BEACH GARDENS-52

NOTE:
NOT TO BE REPRODUCED IN
ANY FORM EXCEPT BY EXPRESS
WRITTEN CONSENT FROM THE
PALM BEACH COUNTY
ASSESSOR.
Information shown hereon is
compiled from the best available
sources and CANNOT be used
for surveys or land transfers of
any type.

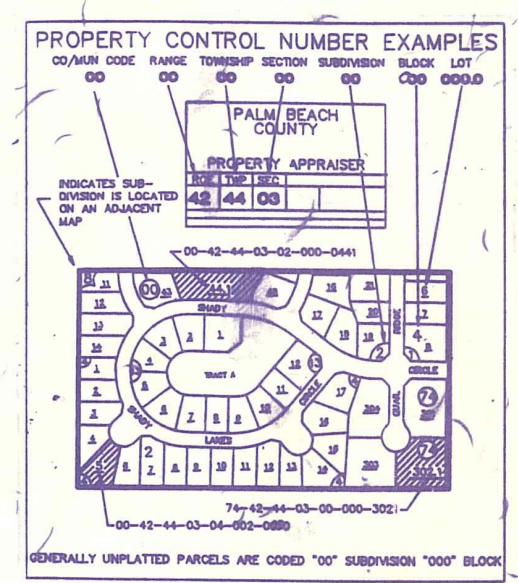

24 16
25 30

20 75
30 29

DONALD DB 1031-628 (filed N-7) ROSS

ROAD

PALM BEACH COUNTY
N-60

PROPERTY APPRAISER

38	31	32	33	34	35	36	37	RGE	TWP	SEC	AERIAL	
1	6	9	4	3	2	1	8	42	41	19	NO	
12	7	8	3	10	11	12	7	SCALE	1"=200'			
13	16	17	14	15	14	13	10	DRAWN BY	KESHIAN 6-17-74			
24	18	20	21	22	23	24	19	UPDATED				
25	30	29	28	27	26	25	30					
34	31	32	33	34	35	36	31					
1	2	3	4	3	2	1	6					

K-6

PLANNING 04-141 1-008