

**Palm Beach County (County) makes no representation or warranties whatsoever on the attached / enclosed information reflected herein pertaining to easements, rights-of-way, setback lines, reservations, agreements, and other similar matters. The information provided herein should not be relied upon by the requesting party to confirm the existence / non-existence of facts contained herein.**

*NORTHLAKE BLVD.  
FROM 2800' W. OF ZIBIS BLVD (13-42-41)  
TO 900' W. OF BEE LINE HWY ACCEPTING (16-17-18)  
MAINTENANCE BY RES. 93-908. (17-18-19)*

*TO P.B. Co. DB 1022-540  
TO DOT DB 1023-545  
(file Red N-14) → SEE NOTES.*

*SEE NOTES.*

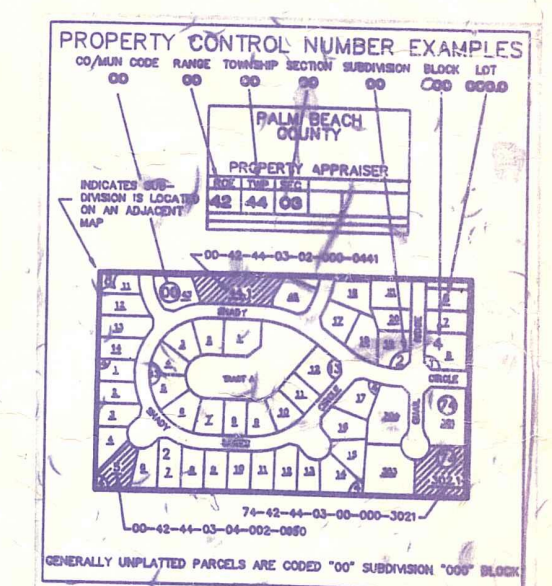

NOTE:  
NOT TO BE REPRODUCED IN ANY FORM EXCEPT BY EXPRESS WRITTEN CONSENT FROM THE PALM BEACH COUNTY ASSESSOR.  
Information shown hereon is compiled from the best available sources and CANNOT be used for surveys or land transfers of any type.  
K-11 J-11  
K-12 J-12

**PALM BEACH COUNTY**  
**N-14**  
**PROPERTY APPRAISER**

36	31	32	33	34	35	36	31
1	8	5	4	3	2	1	8
12	7	8	9	10	11	12	7
13	6	7	8	9	10	11	6
24	15	16	17	18	19	20	15
25	14	15	16	17	18	19	14
26	13	14	15	16	17	18	13
27	12	13	14	15	16	17	12
28	11	12	13	14	15	16	11
29	10	11	12	13	14	15	10
30	9	10	11	12	13	14	9
31	8	9	10	11	12	13	8

RGE	TWP	SEC	AERIAL
42	42	1817	NO 201
SCALE		1" = 400'	
DRAWN BY		GRICE 8-1-73	
UPDATED		6/18/11 LP	

WEST PALM BEACH PUBLIC  
WATER SUPPLY AREA  
PLAT BOOK 23 P149

(74) 900  
603.12 AC  
(16.55 AC RD R/W)

(74) 701  
236.47 AC  
(7.55 AC RD R/W)

(74) 900  
661 AC

(74) 900  
661 AC

7  
18  
12  
13

7  
8  
2611.22'

8  
9  
2636.36'

18  
14  
15  
14

18  
17  
1175.56'

16  
21  
24.54'

24  
29  
19  
30

19  
20  
30  
29

20  
29  
21  
28

BOUNDING 44-141 1-008