

Denotes 66' R/W - BUTT RD - PB 668-115 (Before Area Was Plotted)

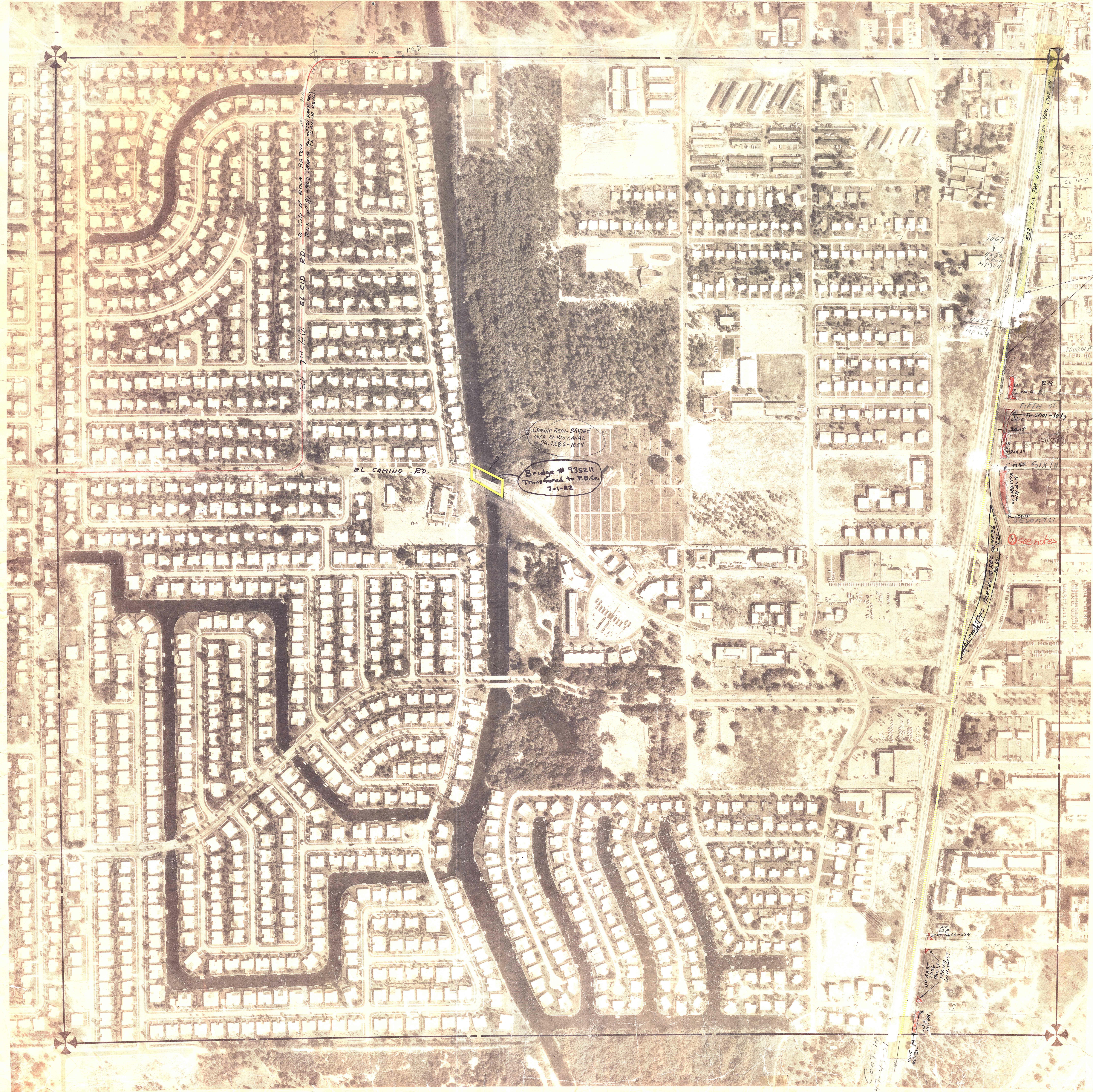
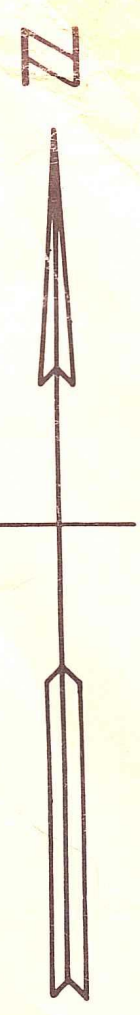

LEASE #48

E-W E OF NE1/4

PARCELS 16-24 PART OF
BEACH RESUB.
PB 20-24 1/10
BY CASE 84-745 CL H
3-3181-1320/29

Old Dixie Hwy - City of Boca Raton would like to have this parcel if it ever becomes available

Palm Beach County (County) makes no representation or warrants whatsoever on the attached / enclosed information reflected herein pertaining to easements, rights-of-way, setback lines, reservations, agreements, and other similar matters. The information provided herein should not be relied upon by the requesting party to confirm the existence / non-existence of facts contained herein.

See notes

NOTE:

NOT TO BE REPRODUCED IN ANY FORM EXCEPT BY EXPRESS WRITTEN CONSENT FROM THE PALM BEACH COUNTY ASSESSOR.

Information shown hereon is compiled from the best available sources and CANNOT be used for surveys or land transfers of any type.

PALM BEACH COUNTY
554
DAVID L. REID
County Assessor

R/E	TWP	SEC	AF/IAL
-----	-----	-----	--------