

#1

SIGN SPECIFICATIONS:
 SIGN FACE - HIGH INTENSITY SHEETING
 SIZE - AS SHOWN
 COLOR - AS SHOWN
 HEIGHT - 7' MEASURED FROM BOTTOM OF THE SIGN TO HEIGHT OF THE NEAR EDGE OF PAVEMENT, OR TO TOP OF THE TRAFFIC SEPARATOR.
 THICKNESS (ALUMINUM) : .080 MILS
 THICKNESS (FIBER GLASS OR PLASTIC) : .120 MILS
 BOLTS: 3/8" x 3/4" W/ HEX NUTS, 2 (MIN.) PER SIGN
 POSTS: SIGNS 9 SQUARE FEET AND LARGER SHALL BE DOUBLE POSTED.

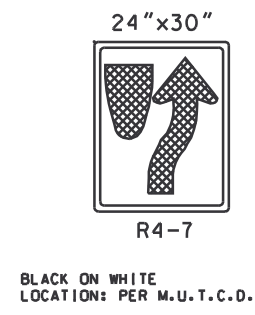

#2

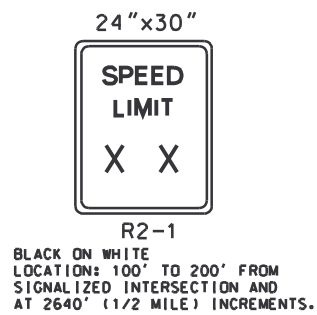
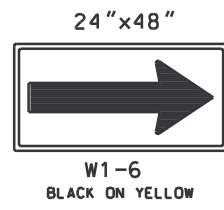
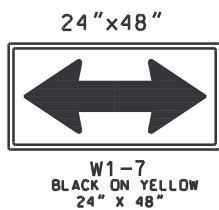
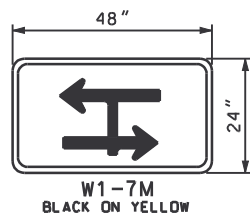

- THE MODIFIED W1-7 SIGN SHALL BE USED AT THE LOCATIONS MEETING THE FOLLOWING CRITERIA:
- 1.) ALL 'T' SIGNALIZED INTERSECTIONS.
 - 2.) INTERSECTIONS WHERE THE LEG APPROACHING 'T' IS POSTED AT 40 M.P.H. OR GREATER.
 - 3.) OTHER LOCATIONS WHERE NEED HAS BEEN DETERMINED BY AN ENGINEERING STUDY.

CASE 1: Yellow baked enamel with nine 3" yellow reflectors, or yellow high intensity sheeting without reflectors.

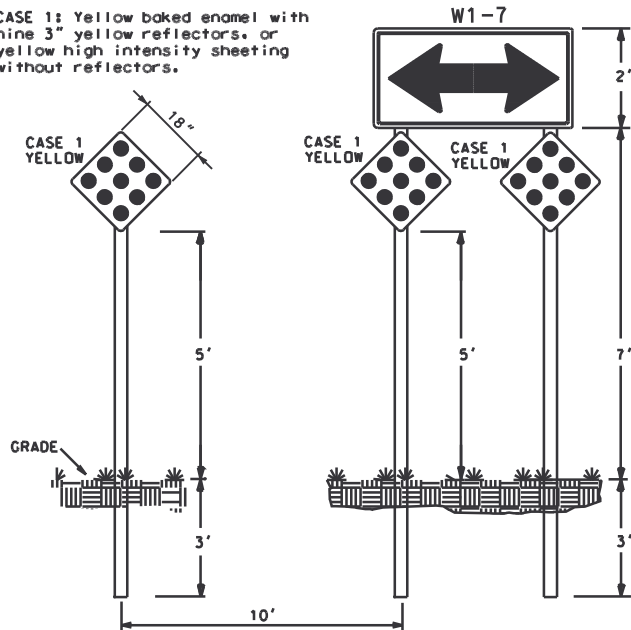

SIGN LOCATION AT "T" INTERSECTION

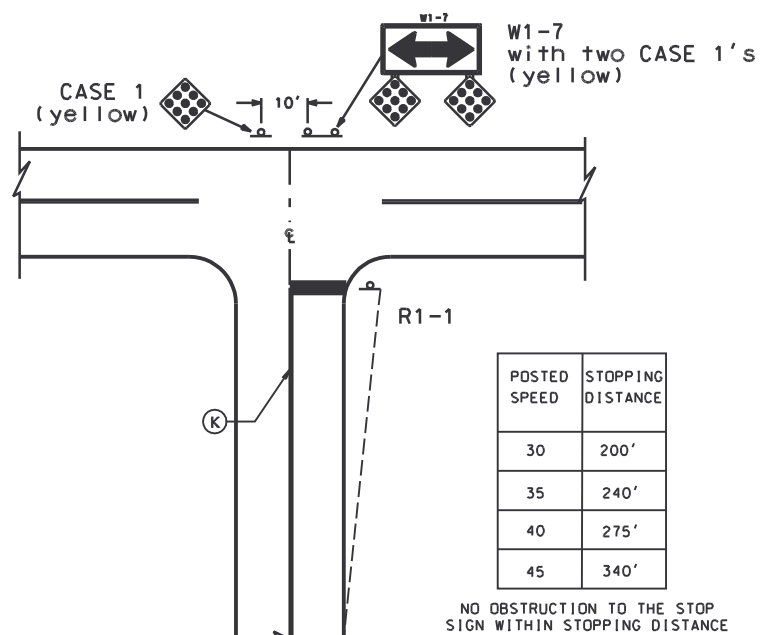

#3

SIGN LOCATION AT CURVE

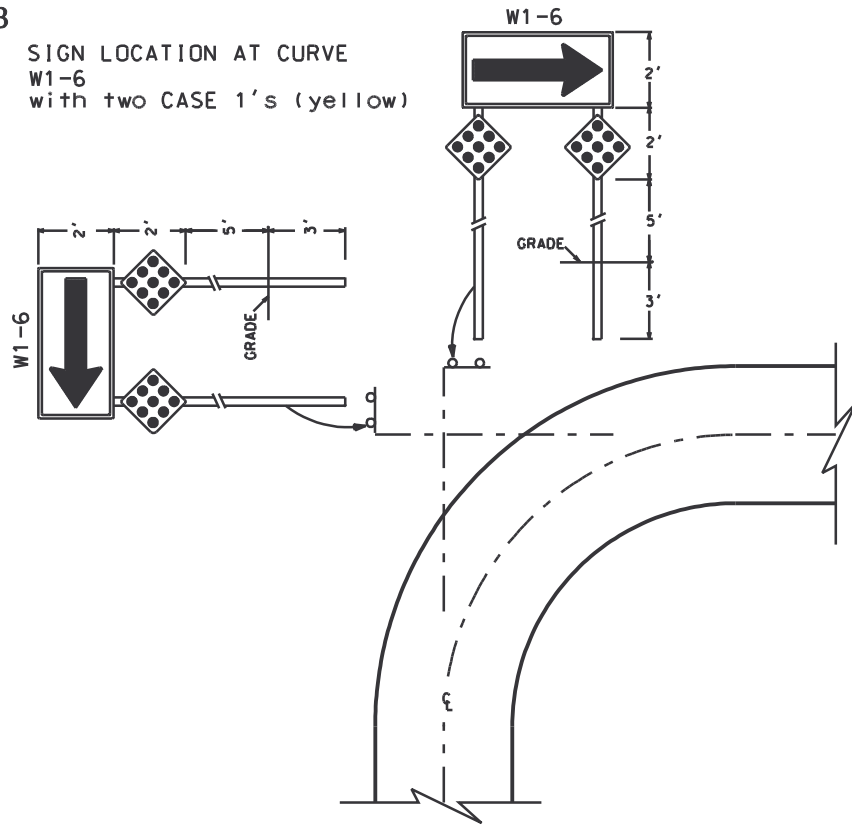

#4

CASE 2 RED

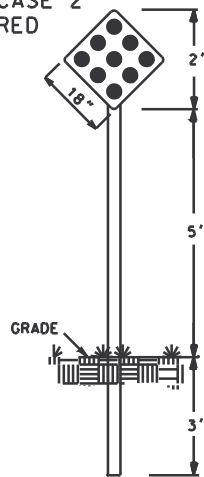

CASE 2: Red baked enamel with nine 3" red reflectors, or red high intensity sheeting without reflectors.

SIGN LOCATION AT DEAD END STREET

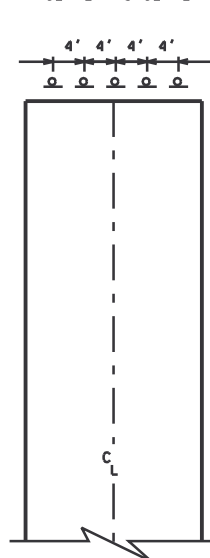

#5

CHANNEL POST

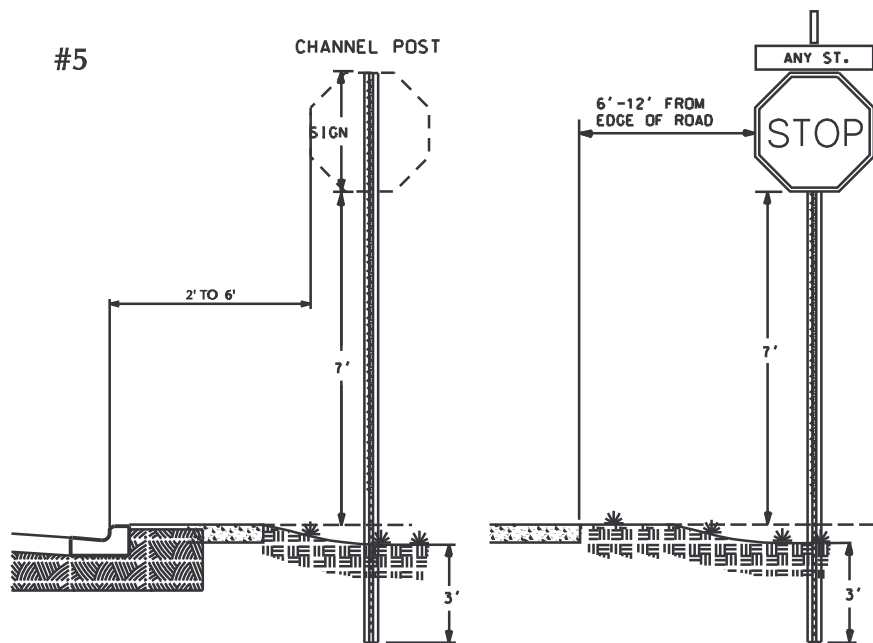

POST: Steel flanged channel post w/ baked green alkyd or galvanized finish per A.S.T.M.-A-123 1 Min. weight: 3 lbs. per foot. 1/16" dia. holes, 1" apart top to bottom.

PALM BEACH COUNTY, FLORIDA
TRAFFIC DIVISION
 TYPICAL
SIGN PLACEMENT

BOGDAN T. PIORKOWSKI REGISTERED ENGINEER		DAN I. WEISBERG TRAFFIC DIRECTOR	
NAME	DATE	SCALE	CONTRACT NO.
DRAWN BY CGT	1-27-2004	N.T.S.	
TRACED BY		DRAWING	T-P-06-001
CHECKED BY		SHEET	8 OF 19 SHEETS