

\* MIN. DIMENSION MAY BE EXTENDED BY TRAFFIC ENGINEER  
 SEE CHART 3 SHEET 2 FOR SINGLE TURN LANE & CHART  
 4 SHEET 2 FOR DUAL LEFT TURNS.

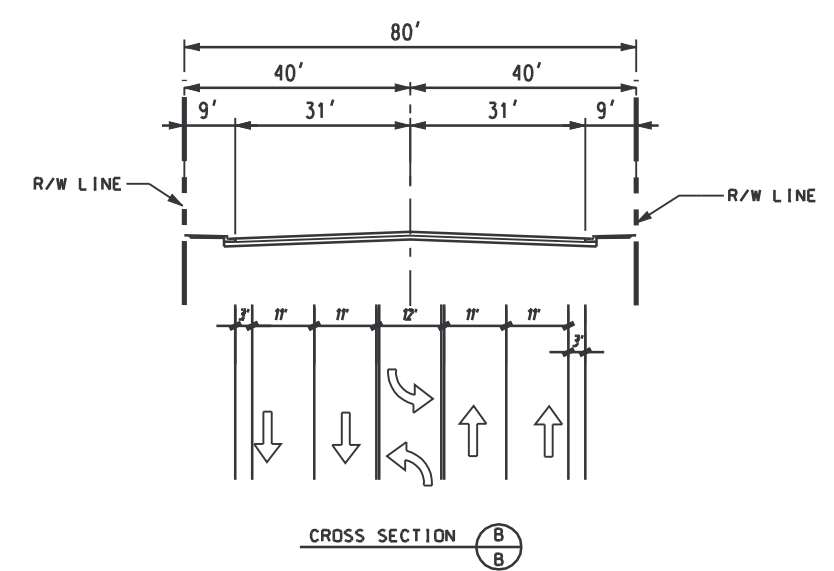

NOTE:  
 ASSUMES 90 DEGREE INTERSECTION, ALL OTHERS TO BE  
 MODIFIED ACCORDINGLY (HOLD REQUIRED STORAGE LENGTH).

- NOTES:
1. IF TRANSITION IS DONE ONLY ON ONE SIDE OF THE ROAD, A DOUBLING OF THE RIGHT OF WAY TRANSITION WILL BE REQUIRED.
  2. R/W REQUIREMENTS SHOWN REFLECT A 90 DEGREE INTERSECTION. FOR OTHER INTERSECTING ANGLES, MODIFY DIMENSIONS ACCORDINGLY.
  3. FOR EXACT CROSS WALK PLACEMENT PLEASE SEE DETAIL 2 ON SHEET 3 OF THIS TYPICAL.

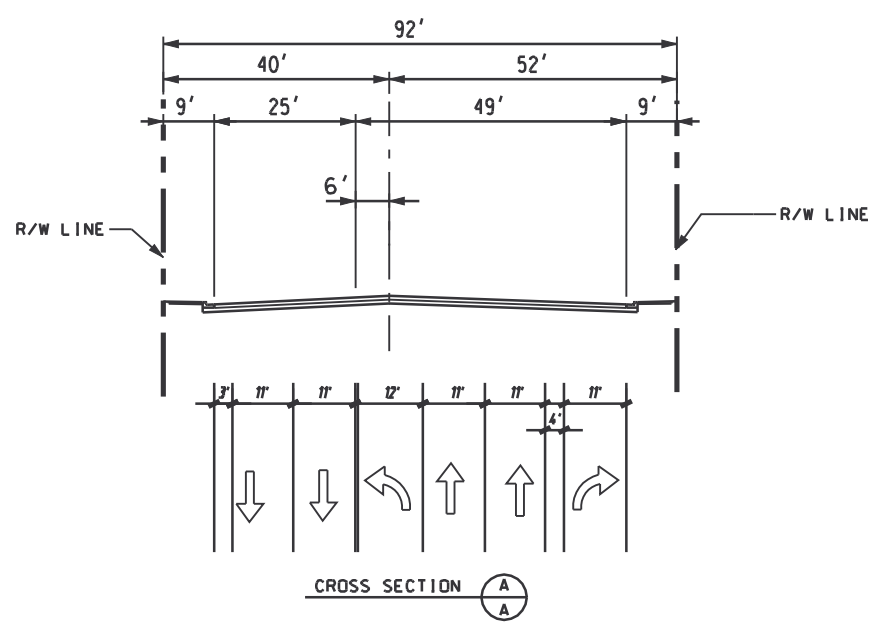
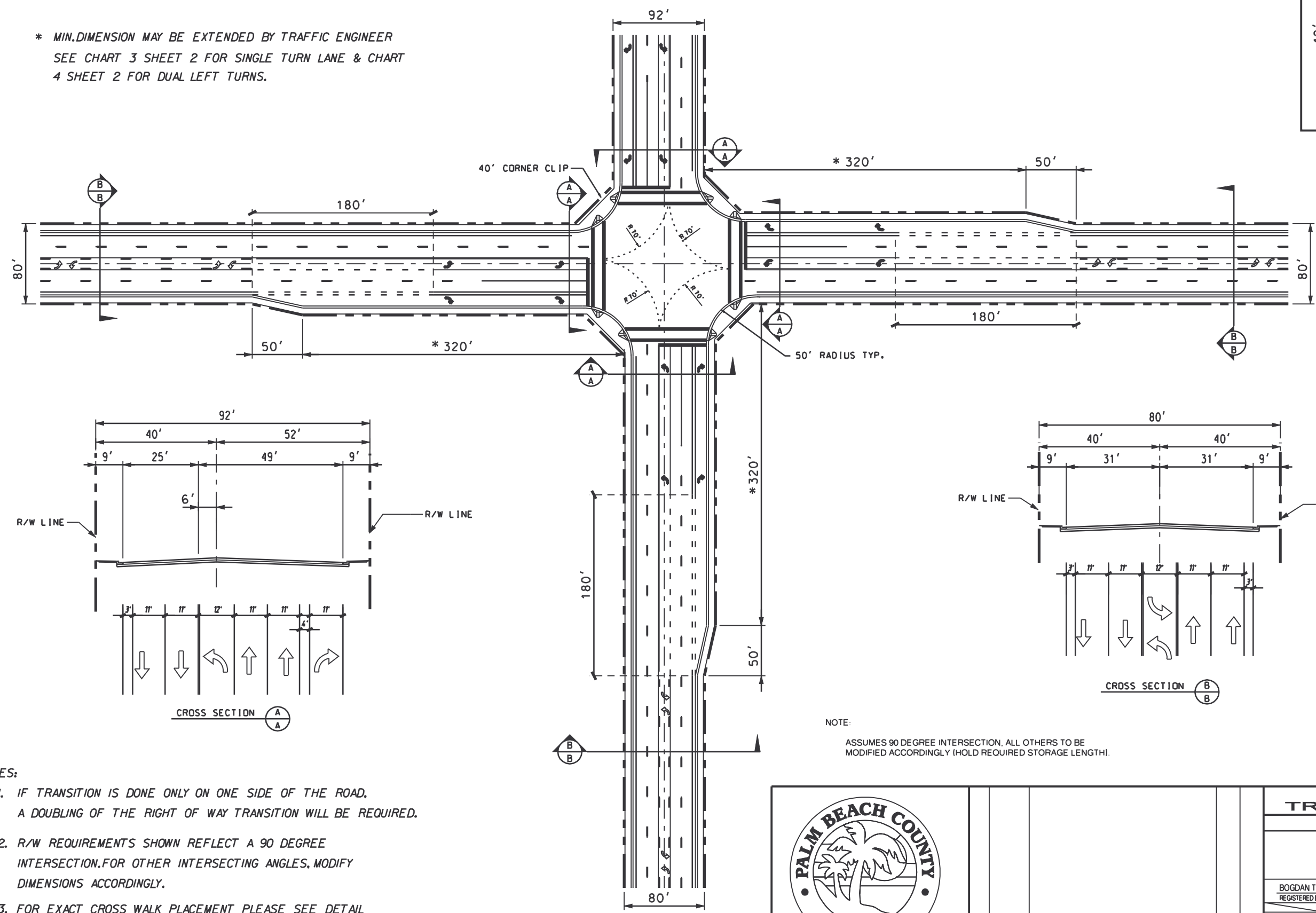
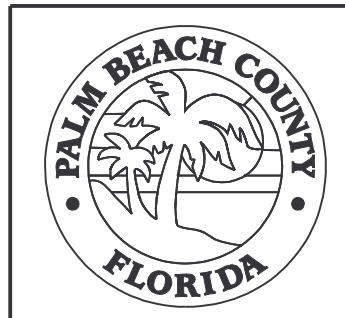

NO.	DATE	REVISIONS	BY	APP.

PALM BEACH COUNTY, FLORIDA			
TRAFFIC DIVISION			
TYPICAL			
80' X 80'			
SINGLE LEFT TURN LANE EXPANDED INTERSECTION			
BOGDAN T. PIORKOWSKI REGISTERED ENGINEER		DAN I. WEISBERG TRAFFIC DIRECTOR	
DRAWN BY	NAME	DATE	SCALE
TRACED BY	CGT	1-27-2004	N.T.S.
CHECKED BY			DRAWING
			CONTRACT NO.
			T-P-06-001
SHEET 11 OF 19 SHEETS			