

II. FISCAL IMPACT ANALYSIS

A. Five Year Summary of Fiscal Impact:

Fiscal Years	2007	2008	2009	2010	2011
Capital Expenditures	\$495,000	-0-	-0-	-0-	-0-
Operating Costs	-0-	-0-	-0-	-0-	-0-
External Revenues	<\$120,000>	-0-	-0-	-0-	-0-
Program Income (County)	-0-	-0-	-0-	-0-	-0-
In-Kind Match (County)	-0-	-0-	-0-	-0-	-0-
NET FISCAL IMPACT	\$375,000	-0-	-0-	-0-	-0-

ADDITIONAL FTE
POSITIONS (Cumulative) _____

Is Item Included in Current Budget? Yes _____ No X
Budget Acct No.: Fund ___ Dept. ___ Unit ___ Object ___
Program

B. Recommended Sources of Funds/Summary of Fiscal Impact:

Transportation Improvement Fund
Forest Hill Blvd OTIS/W of Sherwood Forest to Fla Mango

Project Cost	\$495,000.00
JPA Funding FDOT	<\$120,000.00>
Fiscal Impact	\$375,000.00

C. Departmental Fiscal Review: R. J. Ward 8/29/06

III. REVIEW COMMENTS

A. OFMB Fiscal and/or Contract Dev. and Control Comments:

[Signature] 9-19-06
OFMB
9/19/06

[Signature] 9/22/06
Contract Dev. and Control
6. Jones 9/22/06

B. Approved as to Form and Legal Sufficiency:

[Signature] 9/25/06
Assistant County Attorney

This Contract complies with our contract review requirements.

C. Other Department Review:

Department Director

This summary is not to be used as a basis for payment.

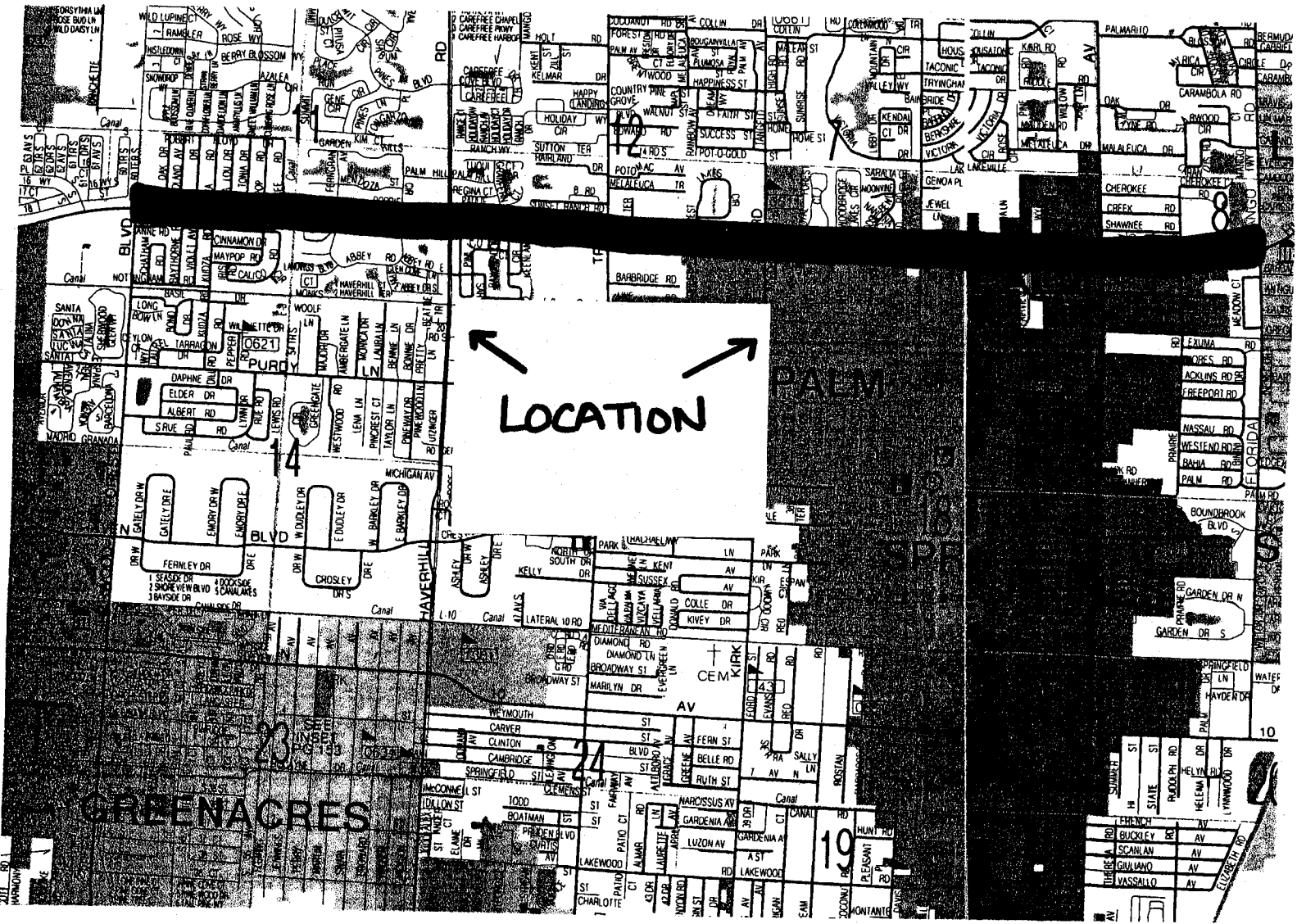

LOCATION SKETCH

RESOLUTION NO.

RESOLUTION OF THE BOARD OF COUNTY COMMISSIONERS OF PALM BEACH COUNTY, FLORIDA TO APPROVE A JOINT PARTICIPATION AGREEMENT WITH THE FLORIDA DEPARTMENT OF TRANSPORTATION.

WHEREAS, Forest Hill Boulevard (State Road 882) at the location contemplated herein is under the Jurisdiction of the Florida Department of Transportation (FDOT); and

WHEREAS, Palm Beach County (COUNTY) is planning to install an Only Trees, Irrigation and Sod (OTIS) project in the medians of Forest Hill Boulevard from .2 mile west of Sherwood Forest Boulevard to Florida Mango Road during the COUNTY's Fiscal Year 2007; and

WHEREAS, FDOT has a road resurfacing project scheduled for this roadway; and

WHEREAS, FDOT is willing to reimburse the COUNTY up to \$120,000 for the County's OTIS improvements, once FDOT's road project comes on line July 1, 2008.

WHEREAS, FDOT requires that the COUNTY enter into a Joint Participation Agreement to accomplish that intent.

NOW, THEREFORE, BE IT RESOLVED BY THE BOARD OF COUNTY COMMISSIONERS OF PALM BEACH COUNTY, FLORIDA, THAT:

1. The foregoing recitals are hereby affirmed and ratified.
2. The Chairman (or Vice-Chairperson) is hereby authorized to execute the Joint Participation Agreement on behalf of Palm Beach County.

The foregoing Resolution was offered by Commissioner _____, who moved its adoption. The motion was seconded by Commissioner _____, and upon being put to a vote, the vote was as follows:

Commissioner Tony Masilotti, Chairman	-
Commissioner Addie Greene, Vice Chairperson	-
Commissioner Karen T. Marcus	-
Commissioner Jeff Koons	-
Commissioner Warren H. Newell	-
Commissioner Mary McCarty	-
Commissioner Burt Aaronson	-

The Chairman thereupon declared the Resolution duly passed and adopted this _____ day of _____ 2006.

APPROVED AS TO FORM ~~AND~~
LEGAL SUFFICIENCY

PALM BEACH COUNTY BY ITS
BOARD OF COUNTY COMMISSIONERS

Sharon R. Bock, Clerk and
Comptroller

By: _____
Assistant County Attorney

By: _____

Contract No.: _____
FM Nos.: 229817-1-A8-01
229817-2-A8-01
FEID No.: VF-596-000-785

**STATE OF FLORIDA DEPARTMENT OF TRANSPORTATION
JOINT PARTICIPATION AGREEMENT**

THIS AGREEMENT, entered into this ___ day of _____, 200___, by and between the State of Florida Department of Transportation hereinafter called the **DEPARTMENT**, and the **PALM BEACH COUNTY**, at **2300 NORTH JOG ROAD, WEST PALM BEACH, FLORIDA 33411-2745**, hereinafter referred to as the **COUNTY**.

WITNESSETH

WHEREAS, the **DEPARTMENT** and the **COUNTY** are desirous of having the **COUNTY** make certain improvements in connection with Financial Management (FM) (**Funded in Fiscal Year 2009**) **229817-1-A8-01** and **229817-2-A8-01** for **THE DESIGN AND CONSTRUCTION OF REPLACEMENT OF LANDSCAPING & IRRIGATION IMPROVEMENTS WITHIN SR-882/FOREST HILL BOULEVARD FROM .2 MILE WEST OF SHERWOOD FOREST BOULEVARD TO FLORIDA MANGO ROAD** in **PALM BEACH COUNTY**; Refer to Exhibit "A" of this Agreement for a detailed Scope of Services and Exhibit "C" for Production Plans; and,

WHEREAS, for purposes of this Agreement, improvements to be made as stated above are hereinafter referred to as the **PROJECT**; and,

WHEREAS, in order to expedite the **PROJECT** in advance of the **DEPARTMENT'S** schedule, the **COUNTY** is prepared to advance the **PROJECT** in **Fiscal Year 2006/2007** for the landscaping component, pursuant to **Section 339.12 Florida Statutes**; and,

WHEREAS, said **PROJECT** is on the State Highway System, is not revenue producing and is contained in the **DEPARTMENT'S** Adopted Work Program; and,

WHEREAS, the improvements are in the interest of both the **COUNTY** and the **DEPARTMENT** and it would be more practical, expeditious, and economical for the **COUNTY** to perform such activities; and,

WHEREAS, the **COUNTY** by Palm Beach County Board of County Commissioners Resolution No. _____ adopted on _____, 200___, a copy of which is attached hereto and made a part hereof, authorizes the proper officials to enter into this Agreement.

NOW, THEREFORE, in consideration of the mutual benefits to be derived from joint participation on the **PROJECT**, the parties agree to the following:

1. The recitals set forth above are true and correct and are deemed incorporated herein.
2. The **COUNTY** shall have the responsibility to complete the **PROJECT** in accordance with the Scope of Services set forth in Exhibit "A".

3. The COUNTY shall be responsible for assuring that the PROJECT complies with all applicable Federal, State and Local laws, rules, regulations, guidelines and standards.

The COUNTY shall be responsible for preparation of the construction plans and contract documents, advertising for bids, evaluating bids, and awarding a contract for construction of the PROJECT. The COUNTY shall also be responsible for providing construction engineering inspection (CEI) services including, administration and technical coordination required for the PROJECT. The COUNTY shall utilize the DEPARTMENT'S Procedure No. 375-020-010 "Errors and Omissions" ^{for} to all work being done for the DEPARTMENT.

The COUNTY shall design and construct the Project in accordance with the Scope of Services.

4. In the event that the future work of the DEPARTMENT, which is unrelated to the Project but in the vicinity of the Project, damages all or a portion of the Project, then the DEPARTMENT agrees to require its construction contractor to restore the COUNTY'S beautification improvements (including irrigation) to the reasonably same condition they were in prior to the start of roadway construction.

During the time that the DEPARTMENT'S work is being performed in the vicinity of the Project, then the DEPARTMENT agrees to require its construction contractor to maintain and perform a mowing cycle of once a week from May 1st to Oct 31st and twice a month from November 1st to April 30th.

5. The DEPARTMENT agrees to make all previous studies, maps, drawings, surveys and other data and information pertaining to the PROJECT available to the COUNTY at no cost.
6. The COUNTY shall have the sole responsibility for resolving claims and requests for additional work for the PROJECT. The COUNTY will make best efforts to obtain the DEPARTMENT input in its decisions.
7. For satisfactory completion and upon written approval and acceptance of all services detailed in Exhibit "A" (Scope of Services) of this Agreement, the DEPARTMENT will pay the COUNTY a lump sum amount not to exceed **ONE HUNDRED TWENTY THOUSAND DOLLARS (\$120,000.00)**, for actual cost incurred.

The funding breakdown is as follows:

FUNDING ALLOTMENT	
Financial Mgmt. No. (FM#)	Amount
229817-1-A8-01	\$40,000.00
229817-2-A8-01	\$80,000.00
TOTAL	\$120,000.00

The COUNTY will not invoice the DEPARTMENT prior to **July 1, 2008**, the fiscal year the PROJECT is scheduled in the DEPARTMENT'S work program.

The **PARTICIPANT** will comply with the Federal and State Audit provisions set forth in **Exhibit "B"** are attached hereto and made part of this Agreement.

8. In the event the **PROJECT** costs, **PROJECT** modifications, or changes to bid items occur that increase or exceed the amount authorized in paragraph 6, the **DEPARTMENT** and the **COUNTY** shall meet and attempt to mutually agree to the amount and distribution of the additional funding needed to complete the **PROJECT**. Any funding increase or modifications to the **PROJECT** shall be added by means of a Supplemental Amendment to the original Agreement to be signed by both parties before work is undertaken. However, in the event the **COUNTY** and the **DEPARTMENT** fail to negotiate a Supplemental Amendment for any reason whatsoever, then the increase in the **PROJECT** costs will be the responsibility of the **COUNTY**.
9. The **COUNTY** acknowledges and agrees that the **DEPARTMENT'S** obligation to pay the sum set forth herein is contingent upon an annual appropriation by the Florida Legislature.
10. In the event it becomes necessary for the **DEPARTMENT** to institute suit for the enforcement of the provisions of this Agreement, each party shall be responsible to pay their own attorney fees and court costs. Venue with respect to any such litigation shall be in State of Florida court in Broward County.
11. Should the **DEPARTMENT** and the **COUNTY** decide to proceed with subsequent phases of the **PROJECT**, the Agreement may be amended to identify the respective responsibilities and the financial arrangement between the parties.
12. This Agreement and any interest herein shall not be assigned, transferred or otherwise encumbered by the **COUNTY** under any circumstances without the prior written consent of the **DEPARTMENT**. However, this Agreement shall run to the **DEPARTMENT** and its successors.
13. Except as otherwise set forth herein, this Agreement shall continue in effect and be binding to both the **COUNTY** and the **DEPARTMENT** until the **PROJECT** is **completed** as evidenced by the written acceptance of the **DEPARTMENT**, and the **COUNTY** has been reimbursed pursuant to paragraph 7 above, or **December 31, 2008**, whichever occurs first.
14. Payment shall be made only after receipt and approval of goods and services unless advance payments are authorized by the Department of Financial Services under Section 215.422(14), Florida Statutes, or by the Department's Comptroller under Section 334.044(29), Florida Statutes.
15. If this Agreement involves units of deliverables, then such units must be received and accepted in writing by the **DEPARTMENT'S** Project Manager prior to payments. The **DEPARTMENT** will render a decision on the acceptability of services within 10 working days of receipt of a Progress Report. The **DEPARTMENT** reserves the right to withhold payments for work not completed, or work completed unsatisfactorily, or

work that is deemed inadequate or untimely by the **DEPARTMENT**. Any payment withheld will be released and paid to the **COUNTY** promptly when work is subsequently performed.

16. Bills for fees or other compensation for services for expenses shall be submitted in detail sufficient for proper preaudit and postaudit thereof.
17. Bills for travel expenses specifically authorized in this Agreement shall be submitted on the Department's Travel Form No. 300-000-01 and will be paid in accordance with Section 112.061, Florida Statutes.
18. **COUNTY** providing goods and services to the **DEPARTMENT** should be aware of the following time frames. Upon receipt of an invoice from the **COUNTY**, the **DEPARTMENT** has (10) ten working days to inspect and approve the goods and services where working day is defined as any day of the week excluding Saturday, Sunday and any legal holiday as designated in Section 110.117, Florida Statutes. Please note that each invoice must be broken down by financial project number as described on Page 1 of this Agreement. The **DEPARTMENT** has 20 calendar days to deliver a request for payment (voucher) to the Department of Financial Services. The 20 calendar days are measured from the latter of the date the invoice is received or the goods or services are received, inspected and approved.
19. If payment is not available within 40 calendar days, a separate interest penalty at a rate as established pursuant to Section 55.03(1), Florida Statutes, will be due and payable, in addition to the invoice amount, to the **COUNTY**. Interest penalties of less than one (1) dollar will not be enforced. The invoice payment requirements do not start until a properly completed invoice is provided to the **DEPARTMENT**.
20. A Vendor Ombudsman has been established within the Department of Financial Services. The duties of this individual include acting as an advocate for contractors/vendors who may be experiencing problems in obtaining timely payment(s) from a state agency. The Vendor Ombudsman may be contacted at (850)410-9724 or by calling the State Comptroller's Hotline, 1-800-848-3792.
21. Records of costs incurred under the terms of this AGREEMENT shall be maintained and made available upon request to the **DEPARTMENT** at all times during the period of this Agreement and for five years after final payment is made. Copies of these documents and records shall be furnished to the **DEPARTMENT** upon request. Records of costs incurred includes the **COUNTY 'S** general accounting records and the project records, together with supporting documents and records, of the contractor and all subcontractors performing work on the project, and all other records of the Contractor and subcontractors considered necessary by the **DEPARTMENT** for a proper audit of costs.
22. In the event this contract is for services in excess of TWENTY FIVE THOUSAND DOLLARS \$25,000.00) and a term for a period of more than one year, the provisions of Section 339.135(6)(a), Florida Statutes, are hereby incorporated:

"The **DEPARTMENT**, during any fiscal year, shall not expend money, incur any liability, or enter into any contract which, by its terms, involves the expenditure of money in excess of the amounts budgeted as available for expenditure during such fiscal year. Any contract, verbal or written, made in violation of this subsection is null and void, and no money may be paid on such contract. The **DEPARTMENT** shall require a statement from the Comptroller of the **DEPARTMENT** that such funds are available prior to entering into any such contract or other binding commitment of funds. Nothing herein contained shall prevent the making of contracts for periods exceeding one year, but any contract so made shall be executory only for the value of the services to be rendered or agreed to be paid for in succeeding fiscal years; and this paragraph shall be incorporated verbatim in all contracts of the **DEPARTMENT** which are for an amount in excess of TWENTY FIVE THOUSAND DOLLARS (\$25,000.00) and which have a term for a period of more than one year."

23. The **COUNTY** will comply with all Federal, State, and Local laws and ordinances applicable to the work or payment for work thereof, and will not discriminate on the grounds of race, color, religion, sex, national origin, age, or disability in the performance of work under the Agreement.
24. The **COUNTY** warrants that it has not employed or obtained any company or person, other than bona fide employees of the **COUNTY**, to solicit or secure this Agreement, and it has not paid or agreed to pay any company, corporation, individual or firm, other than a bona fide employee employed by the **COUNTY**. For breach or violation of this provision, the **DEPARTMENT** shall have the right to terminate the Agreement without liability.
25. To the extent allowed by the Laws of Florida, the **COUNTY** hereby agrees to indemnify, defend, save, and hold harmless the **DEPARTMENT** from all claims, demands, liabilities, and suits of any nature arising out of, because of or due to any intentional and/or negligent act or occurrence, omission, or commission of the **COUNTY**, and its employees, arising out of this contract or the work which is the subject hereof. In addition, with respect to any of the **COUNTY'S** agents, consultants, contractors, and/or sub-contractors, such party in any contract for this project shall agree to indemnify, defend, save and hold harmless the **DEPARTMENT** from all claims, demands, liabilities, and suits of any nature arising out of, because of or due to any intentional and/or negligent act or occurrence, omission or commission of such agents, consultants, contractors, and/or sub-contractors. The **COUNTY** shall provide to the **DEPARTMENT** written evidence of the foregoing upon the request of the **DEPARTMENT**. It is specifically understood and agreed that this indemnification clause does not cover or indemnify the **DEPARTMENT** for its own negligence.
26. This Agreement is governed by and construed in accordance with the laws of the United States, State of Florida.
27. This document incorporates and includes all prior negotiations, correspondence, conversations, agreements, or understandings applicable to the matters contained herein, and the parties agree that there are no commitments, agreements or understandings concerning the subject matter of this agreement that are not contained in this document. Accordingly, it is agreed that no deviation from the terms hereof shall

be predicated upon any prior representation or agreements whether oral or written. It is further agreed that no modification, amendment, or alteration in the terms and conditions contained herein shall be effective unless contained in a written document executed with the same formality and of equal dignity herewith.

28. Any or all notices (except invoices) given or required under this Agreement shall be in writing and either personally delivered with receipt acknowledged or sent by certified mail, return receipt requested. All notices delivered shall be sent to the following addresses:

If to the DEPARTMENT:

Florida Department of Transportation - District Four
3400 West Commercial Blvd.
Fort Lauderdale, Florida 33309-3421
Attn: **Leos A. Kennedy, Jr.**
With a copy to: **Scott Peterson**
A second copy to: District General Counsel

If to the COUNTY:

Palm Beach County
Dept. of Engineering and Public Works
2300 North Jog Road
West Palm Beach, Florida 33411-2745
Attn: **Andrew S. Hertel, AICP**
Manager
With A Copy to: **Ms. Marlene Everitt,**
Assistant County Attorney
301 N. Olive Avenue, 6th Floor
West Palm Beach, FL 33401

IN WITNESS WHEREOF, this Agreement is to be executed by the parties below for the purposes specified herein. Authorization has been given to enter into and execute this Agreement by Resolution No. _____, hereto attached.

PALM BEACH COUNTY, FLORIDA
A POLITICAL SUBDIVISION OF THE
STATE OF FLORIDA
BOARD OF COUNTY COMMISSIONERS

STATE OF FLORIDA
DEPARTMENT OF TRANSPORTATION

BY: _____
NAME: _____
TITLE: _____

BY: _____
ROSIELYN QUIROZ
DIRECTOR OF TRANSPORTATION SUPPORT

ATTEST:
SHARON R. BROCK, CLERK & COMPTROLLER

APPROVED: (AS TO FORM)

CLERK OR DEPUTY CLERK (SEAL)

BY: _____
DISTRICT GENERAL COUNSEL

**APPROVED AS TO FORM AND:
LEGAL SUFFICIENCY:**

APPROVED:

BY: _____
COUNTY ATTORNEY

BY: _____
PROFESSIONAL SERVICES ADMINISTRATOR

APPROVED AS TO TERMS AND CONDITIONS:

BY: *M. MacConnell*

Exhibit A

Scope of Services

The **COUNTY** shall design, construct, and maintain, landscaping and/or irrigation, in accordance with **DEPARTMENT** standards, along Forest Hill Boulevard (SR 882) from approximately .2 Mile West of Sherwood Forest Boulevard to Florida Mango Road (MP 7.641).

The **COUNTY** shall complete all construction activities related to this Agreement prior to June 2008.

Exhibit "B"

FEDERAL AND/OR STATE FUNDED CONTRACTS

The administration of resources awarded by the Department to PALM BEACH COUNTY may be subject to audits and/or monitoring by the Department, as described in this section.

MONITORING

In addition to reviews of audits conducted in accordance with OMB Circular A-133 and Section 215.97, F.S., as revised (see "AUDITS" below), monitoring procedures may include, but not be limited to, on-site visits by Department staff, limited scope audits as defined by OMB Circular A-133, as revised, and/or other procedures. By entering into this agreement, the recipient agrees to comply and cooperate fully with any monitoring procedures/processes deemed appropriate by the Department. In the event the Department determines that a limited scope audit of the recipient is appropriate, the PALM BEACH COUNTY regarding such audit. PALM BEACH COUNTY further agrees to comply and cooperate with any inspections, reviews, investigations, or audits deemed necessary by the FDOT's Office of Inspector General (OIG) and Florida's Chief Financial Officer (CFO) or Auditor General.

AUDITS

PART I: FEDERALLY FUNDED

Recipients of federal funds (i.e. state, local government, or non-profit organizations as defined in OMB Circular A-133, as revised) are to have audits done annually using the following criteria:

1. In the event that the recipient expends \$500,000 or more in Federal awards in its fiscal year, the recipient must have a single or program-specific audit conducted in accordance with the provisions of OMB Circular A-133, as revised. EXHIBIT 1 to this agreement indicates Federal resources awarded through the Department by this agreement. In determining the Federal awards expended in its fiscal year, the recipient shall consider all sources of Federal awards, including Federal resources received from the Department. The determination of amounts of Federal awards expended should be in accordance with the guidelines established by OMB Circular A-133, as revised. An audit of the recipient conducted by the Auditor General in accordance with the provisions OMB Circular A-133, as revised, will meet the requirements of this part.
2. In connection with the audit requirements addressed in Part I, paragraph 1., the recipient shall fulfill the requirements relative to auditee responsibilities as provided in Subpart C of OMB Circular A-133, as revised.
3. If the recipient expends less than \$500,000 in Federal awards in its fiscal year, an audit conducted in accordance with the provisions of OMB Circular A-133, as revised, is not required. However, if the recipient elects to have an audit conducted in accordance with the provisions of OMB Circular A-133, as revised, the cost of the audit must be paid from non-Federal resources (i.e., the cost of such an audit must be paid from recipient resources obtained from other than Federal entities).
4. Federal awards are to be identified using the Catalog of Federal Domestic Assistance (CFDA) title and number, award number and year, and name of the awarding federal agency.

PART II: STATE FUNDED

Recipients of state funds (i.e. a nonstate entity as defined by Section 215.97(2)(l), Florida Statutes) are to have audits done annually using the following criteria:

1. In the event that the recipient expends a total amount of state financial assistance equal to or in excess of \$500,000 in any fiscal year, the recipient must have a State single or project-specific audit for such fiscal year in accordance with Section 215.97, Florida Statutes; applicable rules of the Department of Financial Services and the CFO; and Chapters 10.550 (local governmental entities) or 10.650 (nonprofit and for-profit organizations), Rules of the Auditor General. EXHIBIT 1 to this

agreement indicates state financial assistance awarded through the Department by this agreement. In determining the state financial assistance expended in its fiscal year, the recipient shall consider all sources of state financial assistance, including state financial assistance received from the Department, other state agencies, and other nonstate entities. State financial assistance does not include Federal direct or pass-through awards and resources received by a nonstate entity for Federal program matching requirements.

2. In connection with the audit requirements addressed in Part II, paragraph 1, the recipient shall ensure that the audit complies with the requirements of Section 215.97(7), Florida Statutes. This includes submission of a financial reporting package as defined by Section 215.97(2)(d), Florida Statutes, and Chapters 10.550 (local governmental entities) or 10.650 (nonprofit and for-profit organizations), Rules of the Auditor General.
3. If the recipient expends less than \$500,000 in state financial assistance in its fiscal year, an audit conducted in accordance with the provisions of Section 215.97, Florida Statutes, is not required. However, if the recipient elects to have an audit conducted in accordance with the provisions of Section 215.97, Florida Statutes, the cost of the audit must be paid from the nonstate entity's resources (i.e., the cost of such an audit must be paid from the recipient's resources obtained from other than State entities).
4. State awards are to be identified using the Catalog of State Financial Assistance (CSFA) title and number, award number and year, and name of the state agency awarding it.

PART III: OTHER AUDIT REQUIREMENTS

The recipient shall follow up and take corrective action on audit findings. Preparation of a summary schedule of prior year audit findings, including corrective action and current status of the audit findings is required. Current year audit findings require corrective action and status of findings.

Records related to unresolved audit findings, appeals, or litigation shall be retained until the action is completed or the dispute is resolved. Access to project records and audit work papers shall be given to the FDOT, the Department of Financial Services, and the Auditor General. This section does not limit the authority of the Department to conduct or arrange for the conduct of additional audits or evaluations of state financial assistance or limit the authority of any other state official.

PART IV: REPORT SUBMISSION

1. Copies of reporting packages for audits conducted in accordance with OMB Circular A-133, as revised, and required by PART I of this agreement shall be submitted, when required by Section .320 (d), OMB Circular A-133, as revised, by or on behalf of the recipient directly to each of the following:
 - A. The Department at each of the following addresses:

**Florida Department of Transportation,
3400 W. Commercial Blvd.
Ft. Lauderdale, FL 33309
Antonette P. Adams, Professional Services Administrator
Scott Peterson, Project Manager**
 - B. The Federal Audit Clearinghouse designated in OMB Circular A-133, as revised (the number of copies required by Sections .320 (d)(1) and (2), OMB Circular A-133, as revised, should be submitted to the Federal Audit Clearinghouse), at the following address:

**Federal Audit Clearinghouse
Bureau of the Census
1201 East 10th Street
Jeffersonville, IN 47132**
 - C. Other Federal agencies and pass-through entities in accordance with Sections .320 (e) and (f), OMB Circular A-133, as revised.

2. In the event that a copy of the reporting package for an audit required by PART I of this agreement and conducted in accordance with OMB Circular A-133, as revised, is not required to be submitted to the Department for reasons pursuant to section .320 (e)(2), OMB Circular A-133, as revised, the recipient shall submit the required written notification pursuant to Section .320 (e)(2) and a copy of the recipient's audited schedule of expenditures of Federal awards directly to each of the following:

Florida Department of Transportation,
3400 W. Commercial Blvd.
Ft. Lauderdale, FL 33309
Antonette P. Adams, Professional Services Administrator
Scott Peterson, Project Manager

In addition, pursuant to Section .320 (f), OMB Circular A-133, as revised, the recipient shall submit a copy of the reporting package described in Section .320 (c), OMB Circular A-133, as revised, and any management letters issued by the auditor, to the Department at each of the following addresses:

Florida Department of Transportation,
3400 W. Commercial Blvd.
Ft. Lauderdale, FL 33309
Antonette P. Adams, Professional Services Administrator
Scott Peterson, Project Manager

3. Copies of financial reporting packages required by PART II of this agreement shall be submitted by or on behalf of the recipient directly to each of the following:

A. The Department at each of the following addresses:

Florida Department of Transportation,
3400 W. Commercial Blvd.
Ft. Lauderdale, FL 33309
Antonette P. Adams, Professional Services Administrator
Scott Peterson, Project Manager

B. The Auditor General's Office at the following address:

Auditor General's Office
Room 401, Pepper Building
111 West Madison Street
Tallahassee, Florida 32399-1450

4. Copies of reports or the management letter required by PART III of this agreement shall be submitted by or on behalf of the recipient directly to:

A. The Department at each of the following addresses:

Florida Department of Transportation,
3400 W. Commercial Blvd.
Ft. Lauderdale, FL 33309
Antonette P. Adams, Professional Services Administrator
Scott Peterson, Project Manager

5. Any reports, management letter, or other information required to be submitted to the Department pursuant to this agreement shall be submitted timely in accordance with OMB Circular A-133, Florida Statutes, and Chapters 10.550 (local governmental entities) or 10.650 (nonprofit and for-profit organizations), Rules of the Auditor General, as applicable.
6. Recipients, when submitting financial reporting packages to the Department for audits done in accordance with OMB Circular A-133 or Chapters 10.550 (local governmental entities) or 10.650 (nonprofit and for-profit organizations), Rules of the Auditor General, should indicate the date that the reporting package was delivered to the recipient in correspondence accompanying the reporting package.

PART V: RECORD RETENTION

1. The recipient shall retain sufficient records demonstrating its compliance with the terms of this agreement for a period of at least five years from the date the audit report is issued, and shall allow the Department, or its designee, CFO, or Auditor General access to such records upon request. The recipient shall ensure that audit working papers are made available to the Department, or its designee, CFO, or Auditor General upon request for a period of at least five years from the date the audit report is issued, unless extended in writing by the Department.

FEDERAL and/or STATE resources awarded to the recipient pursuant to this agreement should be listed below. If the resources awarded to the recipient represent more than one Federal or State program, provide the same information for each program and the total resources awarded. **Compliance Requirements** applicable to each State program should also be listed below. If the resources awarded to the recipient represent more than one program, list applicable compliance requirements for each program in the same manner as shown here:

STATE RESOURCES

<u>State Agency</u>	<u>Catalog of State Financial Assistance (Number & Title)</u>	<u>Amount</u>
DOT (Department of Transportation)	55.023 State Highway Project Reimbursement	\$120,000.00

Compliance Requirements

1. *Exhibit "A" Scope of Services*
2. a) *Most projects are administered by or through State Transportation Departments or Federal agencies*
b) *The Participant must follow specific laws, guidelines or regulations regarding allowable program expenditures.*
- 3.

EXHIBIT "C"

PRODUCTION PLANS

Plans of:
Irrigation Improvements for:

FOREST HILL BOULEVARD

From Sherwood Forest Blvd. to Florida Mango Road

Location Map

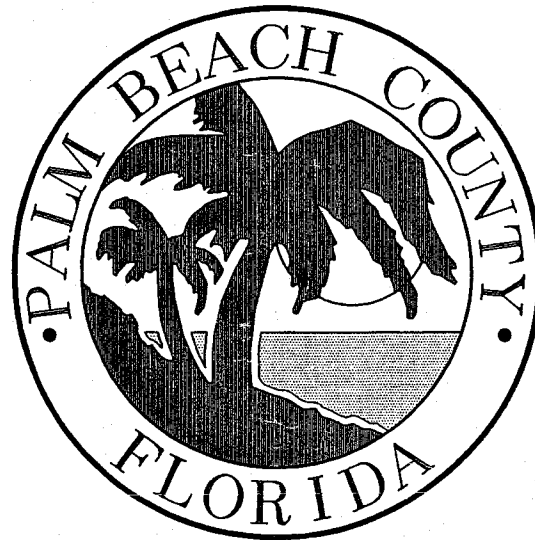
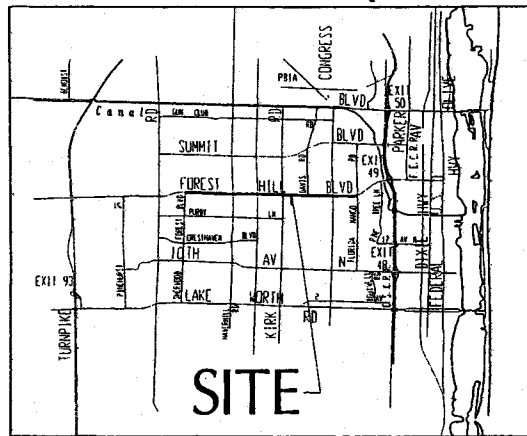

Index of Drawings

Sheet No.	Description
Index	Index of Drawings
R-1 - R-31	Irrigation Development Plans
R-32	Irrigation Details
R-33	Irrigation Details

ATTENTION IS DIRECTED TO THE FACT THAT THESE PLANS MAY HAVE BEEN SLIGHTLY REDUCED IN SIZE DURING REPRODUCTION. THIS MUST BE CONSIDERED WHEN OBTAINING SCALED DATA.

THESE PLANS HAVE BEEN PREPARED IN ACCORDANCE WITH AND ARE GOVERNED BY THE OFFICE OF THE PALM BEACH COUNTY ENGINEER AND THE PALM BEACH COUNTY STREETSCAPE STANDARDS MANUAL DATED AUGUST 1999.

FIELD ADJUSTMENTS MAY BE REQUIRED BY THE CONTRACTOR TO INSURE THAT ALL PALM BEACH COUNTY REQUIREMENTS ARE ADHERED TO.

THE CONTRACTOR SHALL BRING ANY AND ALL CONFLICTS WITH TREE LOCATIONS TO THE ATTENTION OF THE LANDSCAPE ARCHITECT AND/OR OWNER, WHO SHALL COORDINATE THE NECESSARY FIELD ADJUSTMENTS REQUIRED.

LANDSCAPE ARCHITECT
OF RECORD:

PHASE III SUBMITTAL

GEORGE G. GENTILE, FASLA L A20000530
CERTIFICATION OF AUTHORIZATION NO. LC00000111

Irrigation Plans Prepared by:

CONTROL
PRECIPITATION
DESIGN INC.
IRRIGATION CONSULTANTS
P.O. BOX 2236
BOCA RATON, FL 33421
1 (407) 361-3926

- ALL LANDSCAPING AND ABOVE GROUND STRUCTURES SHOWN HEREON ARE DESIGNED AND ARE TO BE MAINTAINED AND INSTALLED IN ACCORDANCE WITH THE P.B.C. STREETSCAPE STANDARDS, AUGUST 1999 INCLUDING REVISIONS DATED APRIL 12, 2001 AND JULY 17, 2001 AND OCTOBER 23, 2003
JUNE 17, 2004

PRELIMINARY

DATE	BY	DESCRIPTION	DATE	BY	DESCRIPTION



Control
Precipitation
Design Inc.
Irrigation Consultants
P.O. Box 2236
Boca Raton, FL 33421
1 (407) 361-3926



PALM BEACH COUNTY
ENGINEERING AND PUBLIC WORKS
STREETSCAPE SECTION
WEST PALM BEACH, FLORIDA
(561) 862-3100

FOREST HILL BOULEVARD

INDEX

1. ALL landscaping and above ground structures shown herein are designed and are to be maintained in accordance with the palm beach county streetscape standard manual with regards to safe sight distance and roadside clear zones.

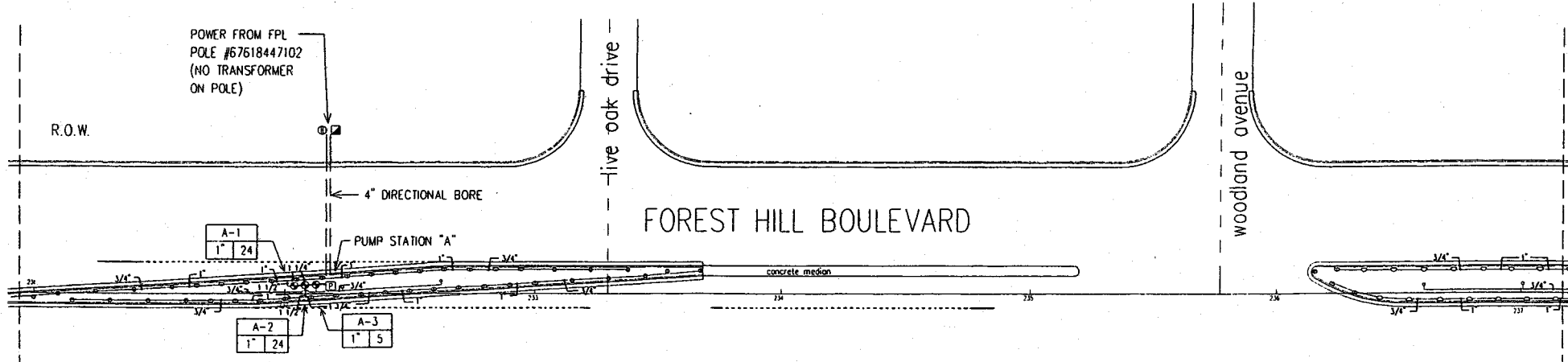

MATCHLINE
SEE SHEET IR-1

MATCHLINE
SEE SHEET IR-3

SPRINKLER KEY LEGEND

SYM	TYPE	MODEL #	DESIGN PSI	DESIGN FLOW (GPM)
●	6" POP UP SPRAY	25702-6P-PRX-E - NOZZLE BELOW		
●		-15N	30	1.65
●		-15T		1.18
●		-17N		1.08
●		-17O		.50
●		-18N		.71
●		-875N		1.48
●		-875O		.74
●		-455T		.45
●		-455I		.90
●		-455S		.90
○	RRRTRL FLOOD EMITTER	2513	30	1.50

NOTE: USE SCREENS IN ALL HEADS
CONTRACTOR TO VERIFY AND IS RESPONSIBLE FOR COMPLETE COVERAGE.

NOTES

- THE IRRIGATION SYSTEM HEAD LAYOUT IS DESIGNED AND SHALL BE INSTALLED AND MAINTAINED TO MINIMIZE OVERSPRAY ONTO ROADWAYS. AFTER THE SYSTEM IS FLUSHED AND HOZZLED, THE ANCS SHALL BE SET TO MINIMIZE OVERSPRAY AND THE FLOW CONTROL/PRESSURE REGULATOR ON THE ZONE CONTROL VALVE SHALL BE ADJUSTED DOWN TO PREVENT ANY MISTING OR FOGGING, TO PRODUCE DROPLETS OF WATER TO MINIMIZE THE EFFECT OF THE WIND THEREBY LIMITING OVERSPRAY AND WATER WASTE. CONTROLLER PROGRAMMING SHALL BE SET SO AS NOT TO ALLOW THE BOREHOLE TO OPERATE ANY RUN OFF WHICH COULD OPERATE WATER ON THE ROAD.
- THE DESIGNER CANNOT BE HELD RESPONSIBLE FOR ANY WATER, ICE, OR EFFECT ARISING FROM OVERSPRAY, BOREHOLE PIPES HEADS OR NOZZLES IN THE EVENT OF A BREAK OR BROKEN OFF HEAD OR NOZZLE, THE COMPONENT SHALL BE REPAIRED/REPLACED/CAPPED OR ZONE TURNED OFF FROM AUTOMATIC OPERATION AS SOON AS POSSIBLE.
- THE DESIGNER DOES NOT WARRANT THAT ALL EXISTING UNDERGROUND UTILITIES ARE SHOWN OR, IF SHOWN, ARE PROPERLY LOCATED ON THE PLANS, AND ARE EITHER IN SERVICE OR ABANDONED. THE CONTRACTOR SHALL CALL "FLORIDA STATE ONE CALL" AT (800) 432-4778 TO NOTIFY UTILITY LOCATIONS AT LEAST 48 HOURS PRIOR TO DIGGING. THE CONTRACTOR SHALL BE RESPONSIBLE TO CONTACT/LOCATE OTHER UTILITIES NOT SUBSCRIBING TO "FLORIDA STATE ONE CALL". ALSO CALL (561) 644-3429, PALM BEACH COUNTY UTILITIES OR APPLICABLE LOCAL UTILITY AGENCY TO VERIFY LOCATIONS AND DEPTHS OF UNDERGROUND UTILITIES.
- THE CONTRACTOR SHALL BE RESPONSIBLE FOR COORDINATING WITH ALL UTILITY COMPANIES AND RELEVANT GOVERNMENT DEPARTMENTS AND ENSURING ALL UTILITIES LOCATED ABOVE, ON, OR BELOW THE SURFACE OF THE SITE ARE PROPERLY DISCOVERED, IDENTIFIED, MARKED, AND FIELD LABELED, AND ENSURING THOSE SAME UTILITIES ARE AT ALL TIMES SAFELY CONTROLLED AND PROTECTED BY REASONABLE MEANS FROM DAMAGE.
- THESE PLANS HAVE BEEN PREPARED IN ACCORDANCE WITH AND ARE CONTROLLED BY THE PALM BEACH COUNTY STREETScape STANDARDS MANUAL DATED AUGUST, 1999, AND SUPPLEMENTS. ALL ABOVE GROUND STRUCTURES SHOWN HEREIN ARE TO BE DESIGNED, INSTALLED AND MAINTAINED IN ACCORDANCE WITH THESE STANDARDS. THE CONTRACTOR SHALL REFER TO THESE STANDARDS FOR COMPLETE REQUIREMENTS.
- CONTRACTOR SHALL ADHERE TO MINIMUM 6' CLEAR ZONE, MEASURED FROM CLOSEST (OUTSIDE EDGE OF CURB), SUCH THAT ALL ABOVE GRADE EQUIPMENT INSTALLATIONS WILL BE OUTSIDE OF CLEAR ZONE.
- LOCATE SPRINKLER HEADS 12" FROM BACK OF CURB. LOCATE IRRIGATION VALVE BORES A MINIMUM 18" FROM BACK OF CURB.

R.O.W.

Irrigation Plans Prepared By

CONTROL
PRECIPITATION
DESIGN INC.
IRRIGATION CONSULTANTS
PO BOX 2208
PICKA WATSON, FL 33422
(561) 396-3936



40'
Scale: 1" = 40'

JUNE 17, 2004

DATE	BY	DESCRIPTION	DATE	BY	DESCRIPTION

FOREST HILL BOULEVARD IRRIGATION DEVELOPMENT PLAN

Designed and set to be maintained in accordance with the Palm Beach County Standard Manual with respect to all signs, markers and roadway view cones.

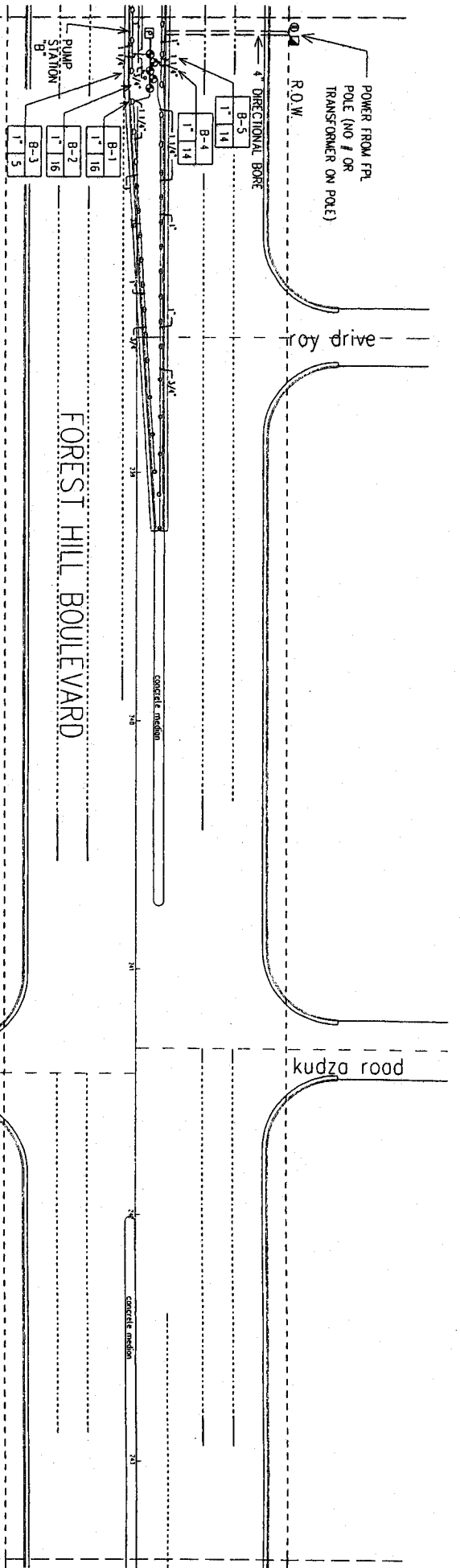

MATCHLINE
SEE SHEET IR-2

MATCHLINE
SEE SHEET IR-4

- NOTES:
- THE IRRIGATION SYSTEM IS TO BE MAINTAINED AND OPERATED IN ACCORDANCE WITH THE DESIGN AND CONSTRUCTION SPECIFICATIONS AND STANDARDS SET FORTH IN THE PALM BEACH COUNTY STANDARD MANUAL WITH RESPECT TO ALL SIGNS, MARKERS AND ROADWAY VIEW CONES.
 - THE DESIGNER SHALL BE RESPONSIBLE FOR THE PROTECTION OF ALL EXISTING UTILITIES AND STRUCTURES AND SHALL BE RESPONSIBLE FOR THE PROTECTION OF ALL EXISTING UTILITIES AND STRUCTURES AND SHALL BE RESPONSIBLE FOR THE PROTECTION OF ALL EXISTING UTILITIES AND STRUCTURES.
 - THE DESIGNER SHALL BE RESPONSIBLE FOR THE PROTECTION OF ALL EXISTING UTILITIES AND STRUCTURES AND SHALL BE RESPONSIBLE FOR THE PROTECTION OF ALL EXISTING UTILITIES AND STRUCTURES.
 - THE DESIGNER SHALL BE RESPONSIBLE FOR THE PROTECTION OF ALL EXISTING UTILITIES AND STRUCTURES AND SHALL BE RESPONSIBLE FOR THE PROTECTION OF ALL EXISTING UTILITIES AND STRUCTURES.
 - THE DESIGNER SHALL BE RESPONSIBLE FOR THE PROTECTION OF ALL EXISTING UTILITIES AND STRUCTURES AND SHALL BE RESPONSIBLE FOR THE PROTECTION OF ALL EXISTING UTILITIES AND STRUCTURES.
 - THE DESIGNER SHALL BE RESPONSIBLE FOR THE PROTECTION OF ALL EXISTING UTILITIES AND STRUCTURES AND SHALL BE RESPONSIBLE FOR THE PROTECTION OF ALL EXISTING UTILITIES AND STRUCTURES.
 - THE DESIGNER SHALL BE RESPONSIBLE FOR THE PROTECTION OF ALL EXISTING UTILITIES AND STRUCTURES AND SHALL BE RESPONSIBLE FOR THE PROTECTION OF ALL EXISTING UTILITIES AND STRUCTURES.
 - THE DESIGNER SHALL BE RESPONSIBLE FOR THE PROTECTION OF ALL EXISTING UTILITIES AND STRUCTURES AND SHALL BE RESPONSIBLE FOR THE PROTECTION OF ALL EXISTING UTILITIES AND STRUCTURES.
 - THE DESIGNER SHALL BE RESPONSIBLE FOR THE PROTECTION OF ALL EXISTING UTILITIES AND STRUCTURES AND SHALL BE RESPONSIBLE FOR THE PROTECTION OF ALL EXISTING UTILITIES AND STRUCTURES.
 - THE DESIGNER SHALL BE RESPONSIBLE FOR THE PROTECTION OF ALL EXISTING UTILITIES AND STRUCTURES AND SHALL BE RESPONSIBLE FOR THE PROTECTION OF ALL EXISTING UTILITIES AND STRUCTURES.

SPRINKLER KEY LEGEND

SYM.	TYPE	MODEL	FLOW RATE (GPM)	SPACING (FT)	RESP. (FT)
●	1000' R.P. SPARK	4000-SP-100-C	150	30	150
○	1000' R.P. SPARK	4000-SP-100-C	150	30	150
○	1000' R.P. SPARK	4000-SP-100-C	150	30	150
○	1000' R.P. SPARK	4000-SP-100-C	150	30	150
○	1000' R.P. SPARK	4000-SP-100-C	150	30	150
○	1000' R.P. SPARK	4000-SP-100-C	150	30	150
○	1000' R.P. SPARK	4000-SP-100-C	150	30	150
○	1000' R.P. SPARK	4000-SP-100-C	150	30	150
○	1000' R.P. SPARK	4000-SP-100-C	150	30	150
○	1000' R.P. SPARK	4000-SP-100-C	150	30	150

NOTE: USE SYMBOLS IN ALL KEYS.
CONSTRUCTION TO BE SHOWN AND S.

PALM BEACH COUNTY
 ENGINEERING & SURVEYING
 1000 S. PALM BEACH BLVD., SUITE 200
 WEST PALM BEACH, FL 33411
 (561) 833-3333

FOREST HILL BOULEVARD IRRIGATION DEVELOPMENT PLAN

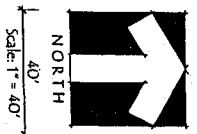

Prepared by:

CONTRACTOR
 PREPARED BY
 PERSON INC.
 1000 S. PALM BEACH BLVD.
 SUITE 200
 WEST PALM BEACH, FL 33411

JUNE 11, 2004

all landscaping and above ground structures shown herein are designed and are to be maintained in accordance with the palm beach county streetscape standard manual with regards to safe sight distance and roadside clear zones.

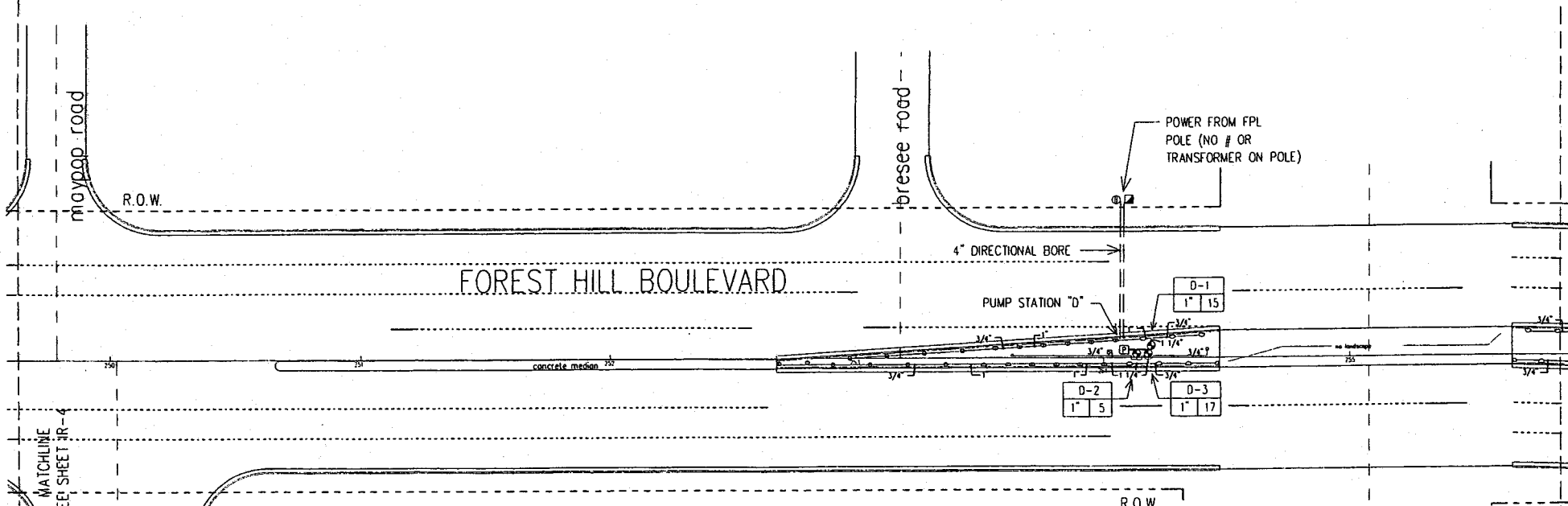

SPRINKLER KEY LEGEND

SYM.	TYPE	MODEL #	DESIGN PSI	DESIGN FLOW (GPM)
●	1000 6" POP UP SPRAY	#5702-6P-PRE-C - NOZZLE BELOW		
●		-15H	30	1.65
●		-15T		1.10
●		-12H		1.08
●		-12T		.50
●		-10H		.71
●		-875H		1.48
●		-8750		.74
●		-4'S1		.45
●		-4'S2		.90
●		-4'S3		.90
○	CONTROL FLOOD BARRIER	#533	30	1.50

NOTE: USE SCREENS IN ALL HEADS. CONTRACTOR TO VERIFY AND IS RESPONSIBLE FOR COMPLETE COVERAGE. QUANTITY FOR REFERENCE ONLY.

NOTES:

1. THE IRRIGATION SYSTEM HEAD LAYOUT IS DESIGNED AND SHALL BE INSTALLED AND MAINTAINED TO MINIMIZE OVERSPRAY ONTO ROADWAYS. AFTER THE SYSTEM IS FLUSHED AND MOZZLES, THE HEADS SHALL BE SET TO MINIMIZE OVERSPRAY AND THE FLOW CONTROL PRESSURE REGULATOR ON THE ZONE CONTROL VALVE SHALL BE ADJUSTED DOWN TO PREVENT ANY WASTING OR FLOODING. TO PREVENT OVERSPRAYS OF WATER TO MINIMIZE THE EFFECT OF THE WIND THEREBY LIMITING OVERSPRAY AND WATER WASTE, CONTROLLER PROGRAMMING SHALL BE SET SO AS NOT TO ALLOW THE IRRIGATION TO CREATE ANY RUN OFF WHICH COULD CREATE WATER ON THE ROAD.
2. THE DESIGNER CANNOT BE HELD RESPONSIBLE FOR ANY WATER, ACT, OR EFFECT ARISING FROM OVERSPRAY, BROKEN PIPES, HEADS OR NOZZLES IN THE EVENT OF A BREAK OR BROKEN OFF HEAD OR NOZZLE. THE COMPONENT SHALL BE REPAIRED, REPLACED, CAPPED, OR ZONE TURNED OFF FROM AUTOMATIC OPERATION AS SOON AS POSSIBLE.
3. THE DESIGNER DOES NOT WARRANT THAT ALL EXISTING UNDERGROUND UTILITIES ARE SHOWN OR, IF SHOWN, ARE PROPERLY LOCATED ON THE PLANS, AND ARE EITHER IN SERVICE OR ABANDONED. THE CONTRACTOR SHALL CALL "FLORIDA STATE ONE CALL" AT (800) 432-4770 TO VERIFY UTILITY LOCATIONS AT LEAST 48 HOURS PRIOR TO BEGINNING. THE CONTRACTOR SHALL BE RESPONSIBLE TO CONTACT/LOCATE OTHER UTILITIES NOT SUBSCRIBING TO "FLORIDA STATE ONE CALL", ALSO CALL (561) 641-3429, PALM BEACH COUNTY UTILITIES OR APPLICABLE LOCAL UTILITY AGENCY TO VERIFY LOCATIONS AND DEPT'S OF UNDERGROUND UTILITIES.
4. THE CONTRACTOR SHALL BE RESPONSIBLE FOR COORDINATING WITH ALL UTILITY COMPANIES AND RELEVANT GOVERNMENT DEPARTMENTS AND ENSURING ALL UTILITIES LOCATED ABOVE, ON, OR BELOW THE SURFACE OF THE SITE ARE PROPERLY DISCONNECTED, MARKED, IDENTIFIED, AND FIELD LABELED, AND ENSURING THOSE SAME UTILITIES ARE AT ALL TIMES SAFELY CONTROLLED AND PROTECTED BY REASONABLE MEANS FROM DAMAGE.
5. THESE PLANS HAVE BEEN PREPARED IN ACCORDANCE WITH AND ARE GOVERNED BY THE PALM BEACH COUNTY STREETScape STANDARD MANUAL DATED AUGUST, 1996, AND SUPPLEMENTS. ALL ABOVE GROUND STRUCTURES SHOWN HEREON ARE TO BE DESIGNED, INSTALLED AND MAINTAINED IN ACCORDANCE WITH THESE STANDARDS. THE CONTRACTOR SHALL REFER TO THESE STANDARDS FOR COMPLETE REQUIREMENTS.
6. CONTRACTOR SHALL ADHERE TO MINIMUM 6' CLEAR ZONE MEASURED FROM CLOSEST (OUTSIDE EDGE OF CURB), SUCH THAT ALL ABOVE GRADE EQUIPMENT INSTALLATIONS WILL BE OUTSIDE OF CLEAR ZONE.
7. LOCATE SPRINKLER HEADS 12" FROM BACK OF CURB. LOCATE IRRIGATION VALVE BOXES A MINIMUM 18" FROM BACK OF CURB.

Irrigation Plans Prepared By
CONTROL
PRECIPITATION
DESIGN INC.
1826 GARDEN CORNER TOWNS
P.O. BOX 238
HOCA RATON, FL 33422
(561) 99-3599

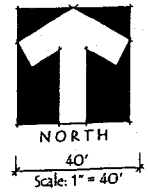

JUNE 17, 2004

DATE	BY	DESCRIPTION	DATE	BY	DESCRIPTION	DATE	BY	DESCRIPTION



FOREST HILL BOULEVARD IRRIGATION DEVELOPMENT PLAN

note:
of landscaping and above ground structures shown herein are
designed and are to be maintained in accordance
with the palm beach county streetscape standard manual with
regards to safe sight distance and roadside clear zones

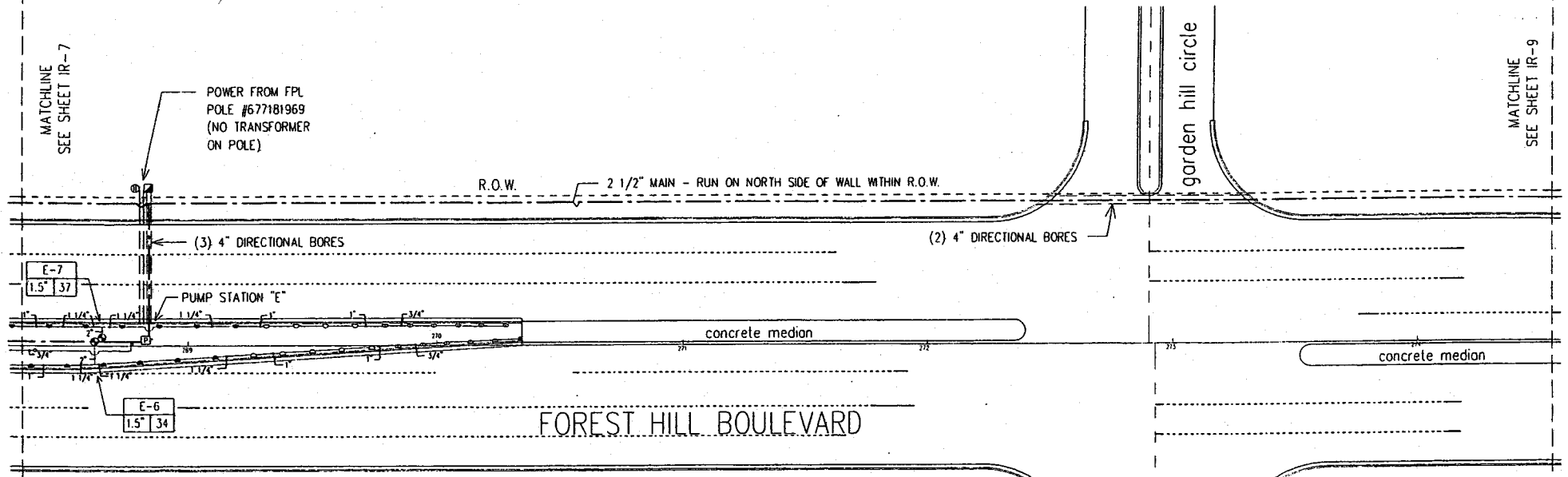

R.O.W.

SPRINKLER KEY LEGEND

SYM	TYPE	MODEL #	DESIGN PSI	DESIGN FLOW (GPM)
TOPD	4" POP UP SPRAY	FS702-6P-PRO-C - NOZZLE BELOW		
A	"	-15N	30	1.65
B	"	-15T		1.10
C	"	-15M		1.09
D	"	-17D		.50
E	"	-10N		.71
F	"	-87SN		1.48
G	"	-87SO		.74
H	"	-47ST		.45
I	"	-47ST		.90
J	"	-47ST		.90
K	WETTED FLOOD BUBBLER	FS33	30	1.50

NOTE: USE SCREENS IN ALL HEADS
CONTRACTOR TO VERIFY AND IS
RESPONSIBLE FOR COMPLETE COVERAGE.

NOTES:

1. THE IRRIGATION SYSTEM HEAD LAYOUT IS DESIGNED AND SHALL BE INSTALLED AND MAINTAINED TO MINIMIZE OVERSPRAY DURING ROADWAYS AFTER THE SYSTEM IS FLOWED AND HOZZLES, THE UNCS SHALL BE SET TO MINIMIZE OVERSPRAY AND THE FLOW CONTROL PRESSURE REGULATOR ON THE ZONE CONTROL VALVE SHALL BE ADJUSTED DOWN TO PREVENT ANY WASTING OR FLOODING, TO PRODUCE DROPLETS OF WATER TO MINIMIZE THE EFFECT OF THE WIND THEREBY LIMITING OVERSPRAY AND WATER WASTE. CONTROLLER PROGRAMMING SHALL BE SET SO AS NOT TO ALLOW THE IRRIGATION TO CREATE ANY RUN OFF WHICH COULD CREATE WATER ON THE ROAD.
2. THE DESIGNER CANNOT BE HELD RESPONSIBLE FOR ANY WATER, ICE, OR EFFECT ARISING FROM OVERSPRAY, BROKEN PIPES, HEADS OR HOZZLES IN THE EVENT OF A BREAK OR BUSH OFF HEAD OR HOZZLE, THE COMPONENT SHALL BE REPAIRED/REPLACED/CAPPED, OR ZONE TURNED OFF FROM AUTOMATIC OPERATION AS SOON AS POSSIBLE.
3. THE DESIGNER DOES NOT WARRANT THAT ALL EXISTING UNDERGROUND UTILITIES ARE SHOWN OR, IF SHOWN, ARE PROPERLY LOCATED ON THE PLANS, AND ARE EITHER IN SERVICE OR ABANDONED. THE CONTRACTOR SHALL CALL "SHIMMIE STATE ONE CALL" AT (800) 432-4770 TO VERIFY UTILITY LOCATIONS AT LEAST 48 HOURS PRIOR TO DIGGING. THE CONTRACTOR SHALL BE RESPONSIBLE TO CONTACT/CARE OTHER UTILITIES NOT SUBSCRIBING TO "SHIMMIE STATE ONE CALL". ALSO CALL (561) 641-3476, PALM BEACH COUNTY UTILITIES OF APPLICABLE LOCAL UTILITY AGENCY TO VERIFY LOCATIONS AND DEPTHS OF UNDERGROUND UTILITIES.
4. THE CONTRACTOR SHALL BE RESPONSIBLE FOR COORDINATING WITH ALL UTILITY COMPANIES AND RELEVANT GOVERNMENT DEPARTMENTS AND ENSURING ALL UTILITIES LOCATED ABOVE, ON, OR BELOW THE SURFACE OF THE SITE ARE PROPERLY DISCOVERED, IDENTIFIED, MARKED, AND FIELD LABELED, AND ENSURING THESE UTILITIES ARE AT ALL TIMES SAFELY CONTROLLED AND PROTECTED BY REASONABLE MEANS FROM DAMAGE.
5. THESE PLANS HAVE BEEN PREPARED IN ACCORDANCE WITH AND ARE GOVERNED BY THE PALM BEACH COUNTY STREETScape STANDARDS MANUAL BASED AUGUST 1999, AND SUPPLEMENTS. ALL ABOVE GROUND STRUCTURES SHOWN HEREIN ARE TO BE DESIGNED, INSTALLED AND MAINTAINED IN ACCORDANCE WITH THESE STANDARDS. THE CONTRACTOR SHALL REFER TO THESE STANDARDS FOR COMPLETE REQUIREMENTS.
6. CONTRACTOR SHALL ADHERE TO MINIMUM 4' CLEAR ZONE, MEASURED FROM CLOSEST (OUTSIDE EDGE OF CURB), SUCH THAT ALL ABOVE GRADE EQUIPMENT INSTALLATIONS WILL BE OUTSIDE OF CLEAR ZONE.
7. LOCATE SPRINKLER HEADS 12" FROM BACK OF CURB. LOCATE IRRIGATION VALVE BOXES A MINIMUM 18" FROM BACK OF CURB.

Irrigation Plans Prepared by

CONTROL
PRECIPITATION
DESIGN INC.
IRRIGATION CONSULTANTS
P.O. BOX 2248
ROCK HAVEN, FL 32650
(904) 394-3954

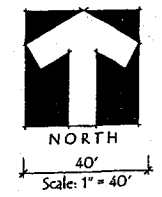

JUNE 17, 2004

DATE	BY	DESCRIPTION	DATE	BY	DESCRIPTION

FOREST HILL BOULEVARD

IRRIGATION DEVELOPMENT PLAN

an irrigation system shall be installed in accordance with the design and specifications of the local health department and shall be installed in accordance with the local health department standards and specifications for the local health department and shall be installed in accordance with the local health department standards and specifications for the local health department.

MATCHLINE
SEE SHEET IR-9

haverhill road

R.O.W.

FOREST HILL BOULEVARD

concrete median

POWER FROM FPL
POLE (NO # OR
TRANSFORMER ON POLE)

2 1/2" MAIN - RUN IN SWALE
BETWEEN SIDEWALK & CURB

MATCHLINE
SEE SHEET IR-11

R.O.W.

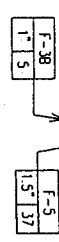

SPRINKLER KEY LEGEND

SYMBOL	DEPTH	PIPING	MODEL	REGION	FLOW
●	1000	4" per 4' spool	101	16	1.0
○	1000	4" per 4' spool	102	16	1.0
○	1000	4" per 4' spool	103	16	1.0
○	1000	4" per 4' spool	104	16	1.0
○	1000	4" per 4' spool	105	16	1.0
○	1000	4" per 4' spool	106	16	1.0
○	1000	4" per 4' spool	107	16	1.0
○	1000	4" per 4' spool	108	16	1.0
○	1000	4" per 4' spool	109	16	1.0
○	1000	4" per 4' spool	110	16	1.0
○	1000	4" per 4' spool	111	16	1.0
○	1000	4" per 4' spool	112	16	1.0
○	1000	4" per 4' spool	113	16	1.0
○	1000	4" per 4' spool	114	16	1.0
○	1000	4" per 4' spool	115	16	1.0
○	1000	4" per 4' spool	116	16	1.0
○	1000	4" per 4' spool	117	16	1.0
○	1000	4" per 4' spool	118	16	1.0
○	1000	4" per 4' spool	119	16	1.0
○	1000	4" per 4' spool	120	16	1.0
○	1000	4" per 4' spool	121	16	1.0
○	1000	4" per 4' spool	122	16	1.0
○	1000	4" per 4' spool	123	16	1.0
○	1000	4" per 4' spool	124	16	1.0
○	1000	4" per 4' spool	125	16	1.0
○	1000	4" per 4' spool	126	16	1.0
○	1000	4" per 4' spool	127	16	1.0
○	1000	4" per 4' spool	128	16	1.0
○	1000	4" per 4' spool	129	16	1.0
○	1000	4" per 4' spool	130	16	1.0

NOTE: SEE SPECIFIC R. & S. CONNECTION TO VERT. AND S. QUANTITY FOR DISTANCE OUT RESPONSIBLE FOR COMPLETE OVERLAP.

- NOTES:
1. THE IRRIGATION SYSTEM SHALL BE DESIGNED AND INSTALLED IN ACCORDANCE WITH THE DESIGN AND SPECIFICATIONS OF THE LOCAL HEALTH DEPARTMENT AND SHALL BE INSTALLED IN ACCORDANCE WITH THE LOCAL HEALTH DEPARTMENT STANDARDS AND SPECIFICATIONS FOR THE LOCAL HEALTH DEPARTMENT AND SHALL BE INSTALLED IN ACCORDANCE WITH THE LOCAL HEALTH DEPARTMENT STANDARDS AND SPECIFICATIONS FOR THE LOCAL HEALTH DEPARTMENT.
 2. THE IRRIGATION SYSTEM SHALL BE DESIGNED AND INSTALLED IN ACCORDANCE WITH THE DESIGN AND SPECIFICATIONS OF THE LOCAL HEALTH DEPARTMENT AND SHALL BE INSTALLED IN ACCORDANCE WITH THE LOCAL HEALTH DEPARTMENT STANDARDS AND SPECIFICATIONS FOR THE LOCAL HEALTH DEPARTMENT AND SHALL BE INSTALLED IN ACCORDANCE WITH THE LOCAL HEALTH DEPARTMENT STANDARDS AND SPECIFICATIONS FOR THE LOCAL HEALTH DEPARTMENT.
 3. THE IRRIGATION SYSTEM SHALL BE DESIGNED AND INSTALLED IN ACCORDANCE WITH THE DESIGN AND SPECIFICATIONS OF THE LOCAL HEALTH DEPARTMENT AND SHALL BE INSTALLED IN ACCORDANCE WITH THE LOCAL HEALTH DEPARTMENT STANDARDS AND SPECIFICATIONS FOR THE LOCAL HEALTH DEPARTMENT AND SHALL BE INSTALLED IN ACCORDANCE WITH THE LOCAL HEALTH DEPARTMENT STANDARDS AND SPECIFICATIONS FOR THE LOCAL HEALTH DEPARTMENT.
 4. THE IRRIGATION SYSTEM SHALL BE DESIGNED AND INSTALLED IN ACCORDANCE WITH THE DESIGN AND SPECIFICATIONS OF THE LOCAL HEALTH DEPARTMENT AND SHALL BE INSTALLED IN ACCORDANCE WITH THE LOCAL HEALTH DEPARTMENT STANDARDS AND SPECIFICATIONS FOR THE LOCAL HEALTH DEPARTMENT AND SHALL BE INSTALLED IN ACCORDANCE WITH THE LOCAL HEALTH DEPARTMENT STANDARDS AND SPECIFICATIONS FOR THE LOCAL HEALTH DEPARTMENT.
 5. THE IRRIGATION SYSTEM SHALL BE DESIGNED AND INSTALLED IN ACCORDANCE WITH THE DESIGN AND SPECIFICATIONS OF THE LOCAL HEALTH DEPARTMENT AND SHALL BE INSTALLED IN ACCORDANCE WITH THE LOCAL HEALTH DEPARTMENT STANDARDS AND SPECIFICATIONS FOR THE LOCAL HEALTH DEPARTMENT AND SHALL BE INSTALLED IN ACCORDANCE WITH THE LOCAL HEALTH DEPARTMENT STANDARDS AND SPECIFICATIONS FOR THE LOCAL HEALTH DEPARTMENT.
 6. THE IRRIGATION SYSTEM SHALL BE DESIGNED AND INSTALLED IN ACCORDANCE WITH THE DESIGN AND SPECIFICATIONS OF THE LOCAL HEALTH DEPARTMENT AND SHALL BE INSTALLED IN ACCORDANCE WITH THE LOCAL HEALTH DEPARTMENT STANDARDS AND SPECIFICATIONS FOR THE LOCAL HEALTH DEPARTMENT AND SHALL BE INSTALLED IN ACCORDANCE WITH THE LOCAL HEALTH DEPARTMENT STANDARDS AND SPECIFICATIONS FOR THE LOCAL HEALTH DEPARTMENT.
 7. LOCAL STANDARDS SHALL BE FOLLOWED FOR THE DESIGN AND INSTALLATION OF THE IRRIGATION SYSTEM.

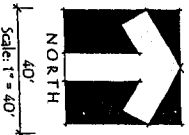

JUNE 11, 2024

DATE	BY	DESCRIPTION	SCALE	STATUS

FOREST HILL BOULEVARD IRRIGATION DEVELOPMENT PLAN

all landscaping and above ground structures shown herein are designed and are to be maintained in accordance with the palm beach county streetscape standard manual with regards to safe sight distance and roadside clear zones

SYM.	TYPE	MODEL /	DESIGN PSZ	FLOW (GPM)
LD	4" POP UP STRAY	PS102-4P-PSH-C - NOZZLE BELOW		
•		-15H	30	1.55
•		-15T		1.10
•		-17H		1.08
•		-17D		50
•		-10H		71
•		-875H		1.48
•		-875D		74
•		-475T		43
•		-475H		90
•		-475I		90
○	CONTROL FLOODED BUBBLER	PS33	30	1.50

NOTE: USE SCREENS IN ALL HEADS. CONTRACTOR TO VERIFY AND IS RESPONSIBLE FOR COMPLETE COVERAGE.

QUANTITY FOR REFERENCE ONLY. CONTRACTOR TO VERIFY AND IS RESPONSIBLE FOR COMPLETE COVERAGE.

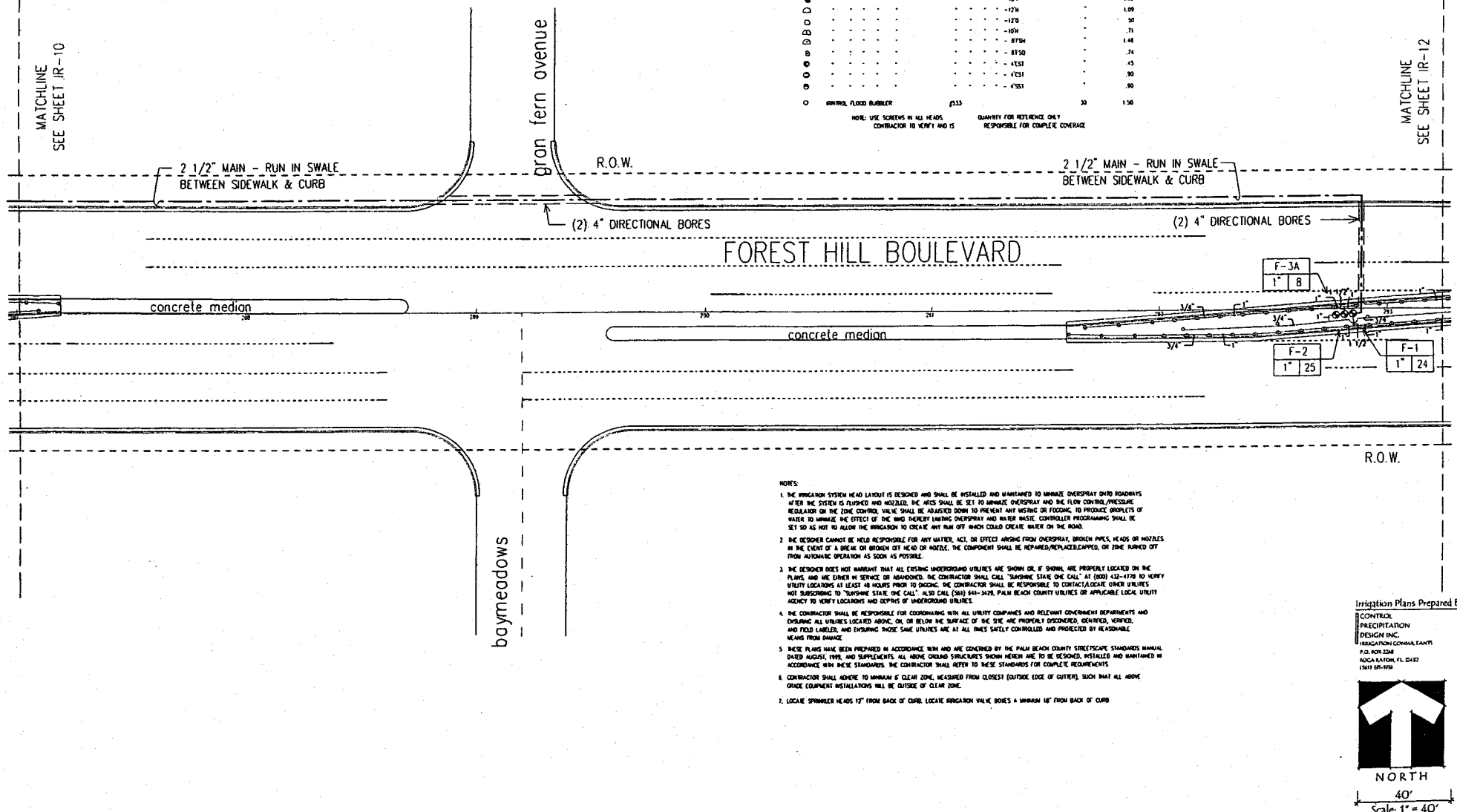

- NOTES:
1. THE IRRIGATION SYSTEM HEAD LAYOUT IS DESIGNED AND SHALL BE INSTALLED AND MAINTAINED TO MINIMIZE OVERSPRAY ONTO ROADWAYS AFTER THE SYSTEM IS FLUSHED AND NOZZLED. THE ARCS SHALL BE SET TO MINIMIZE OVERSPRAY AND THE FLOW CONTROL/PRESSURE REGULATOR ON THE ZONE CONTROL VALVE SHALL BE ADJUSTED DOWN TO PREVENT ANY WASTING OR TOGGING. TO PRODUCE DRIPLETS OF SIZE TO MINIMIZE THE EFFECT OF THE WIND THEREBY LIMITING OVERSPRAY AND WATER WASTE. CONTROLLER PROGRAMMING SHALL BE SET SO AS NOT TO ALLOW THE IRRIGATION TO CREATE ANY RUN OFF WHICH COULD CREATE WATER ON THE ROAD.
 2. THE DESIGNER CANNOT BE HELD RESPONSIBLE FOR ANY WATER, ACID, OR EFFECT ARISING FROM OVERSPRAY, BROKEN PIPES, HEADS OR NOZZLES IN THE EVENT OF A BREAK OR BROKEN OFF HEAD OR NOZZLE. THE COMPONENT SHALL BE REPAIRED/REPLACED/REPPED, OR ZONE TURNED OFF FROM AUTOMATIC OPERATION AS SOON AS POSSIBLE.
 3. THE DESIGNER DOES NOT WARRANT THAT ALL EXISTING UNDERGROUND UTILITIES ARE SHOWN OR, IF SHOWN, ARE PROPERLY LOCATED ON THE PLANS AND ARE EITHER IN SERVICE OR ABANDONED. THE CONTRACTOR SHALL CALL "SHOWING STATE ONE CALL" AT (800) 432-4178 TO VERIFY UTILITY LOCATIONS AT LEAST 48 HOURS PRIOR TO DIGGING. THE CONTRACTOR SHALL BE RESPONSIBLE TO CONTACT/LOCATE OTHER UTILITIES NOT SUBORDINATE TO "SHOWING STATE ONE CALL". ALSO CALL (561) 644-5476, PALM BEACH COUNTY UTILITIES OR APPLICABLE LOCAL UTILITY AGENCY TO VERIFY LOCATIONS AND DEPTHS OF UNDERGROUND UTILITIES.
 4. THE CONTRACTOR SHALL BE RESPONSIBLE FOR COORDINATING WITH ALL UTILITY COMPANIES AND RELEVANT GOVERNMENT DEPARTMENTS AND CHECKING ALL UTILITIES LOCATED ABOVE, ON, OR BELOW THE SURFACE OF THE SITE ARE PROPERLY DISCONNECTED, IDENTIFIED, VERIFIED, AND FIELD LABELED, AND ENSURING THOSE SAME UTILITIES ARE AT ALL TIMES SAFELY CONTROLLED AND PROTECTED BY REASONABLE MEANS FROM DAMAGE.
 5. THESE PLANS HAVE BEEN PREPARED IN ACCORDANCE WITH AND ARE COVERED BY THE PALM BEACH COUNTY STREETScape STANDARDS MANUAL DATED AUGUST 1999, AND SUPPLEMENTS. ALL ABOVE GROUND STRUCTURES SHOWN HEREIN ARE TO BE DESIGNED, INSTALLED AND MAINTAINED IN ACCORDANCE WITH THESE STANDARDS. THE CONTRACTOR SHALL REFER TO THESE STANDARDS FOR COMPLETE REQUIREMENTS.
 6. CONTRACTOR SHALL AVOID TO MINIMIZE CLEAR ZONE, MEASURED FROM CLOSEST (OUTSIDE EDGE OF GUTTER), SUCH THAT ALL ABOVE GRADE COMPONENT INSTALLATIONS WILL BE OUTSIDE OF CLEAR ZONE.
 7. LOCATE SPINNIER HEADS 12" FROM BACK OF CURB. LOCATE IRRIGATION VALVE BOXES A MINIMUM 18" FROM BACK OF CURB.

Irrigation Plans Prepared By:
 CONTROL
 PRECIPITATION
 DESIGN INC.
 IRRIGATION CONSULTANTS
 P.O. BOX 2306
 BOCA RATON, FL 33421
 (561) 997-1978



JUNE 17, 2024

DATE	BY	DESCRIPTION	DATE	BY	DESCRIPTION

Control
Precipitation
Design Inc.
Irrigation Consultants
P.O. Box 2306
Boca Raton, FL 33421
(561) 997-1978

PALM BEACH COUNTY
ENGINEERING AND PUBLIC WORKS
STRATEGIC SECTION
WEST PALM BEACH, FLORIDA
15618 WALKER

FOREST HILL BOULEVARD IRRIGATION DEVELOPMENT PLAN

with the plan shown, verify that the proposed standard manual with appropriate to and right, structure and roadway show shown.

MATCHLINE
SEE SHEET IR-12

R.O.W.

drive

MATCHLINE
SEE SHEET IR-14

concrete median

concrete median

FOREST HILL BOULEVARD

R.O.W.

SPRINKLER KEY LEGEND

SYMBOL	TYPE	DEPTH, L	DESIGN FLOW
●	1800	150	1.15
○	1200	150	1.10
○	900	150	1.05
○	600	150	1.00
○	300	150	0.95
○	150	150	0.90
○	75	150	0.85
○	37.5	150	0.80
○	18.75	150	0.75
○	9.375	150	0.70
○	4.6875	150	0.65
○	2.34375	150	0.60
○	1.171875	150	0.55
○	0.5859375	150	0.50
○	0.29296875	150	0.45
○	0.146484375	150	0.40
○	0.0732421875	150	0.35
○	0.03662109375	150	0.30
○	0.018310546875	150	0.25
○	0.0091552734375	150	0.20
○	0.00457763671875	150	0.15

NO IRRIGATION THIS SHEET

- NOTES:**
1. THE PROPOSED SYSTEM AND LAYOUT OF SYSTEMS AND SHALL BE PROVIDED AND MAINTAINED TO MAINTAIN ADEQUATE FLOW CAPACITY AND TO MAINTAIN THE SYSTEM IN GOOD WORKING ORDER. THE CONTRACTOR SHALL BE RESPONSIBLE FOR THE PROTECTION AND MAINTENANCE OF ALL EXISTING UTILITIES AND SHALL BE RESPONSIBLE FOR THE PROTECTION AND MAINTENANCE OF ALL EXISTING UTILITIES AND SHALL BE RESPONSIBLE FOR THE PROTECTION AND MAINTENANCE OF ALL EXISTING UTILITIES.
 2. THE CONTRACTOR SHALL BE RESPONSIBLE FOR THE PROTECTION AND MAINTENANCE OF ALL EXISTING UTILITIES AND SHALL BE RESPONSIBLE FOR THE PROTECTION AND MAINTENANCE OF ALL EXISTING UTILITIES.
 3. THE CONTRACTOR SHALL BE RESPONSIBLE FOR THE PROTECTION AND MAINTENANCE OF ALL EXISTING UTILITIES AND SHALL BE RESPONSIBLE FOR THE PROTECTION AND MAINTENANCE OF ALL EXISTING UTILITIES.
 4. THE CONTRACTOR SHALL BE RESPONSIBLE FOR THE PROTECTION AND MAINTENANCE OF ALL EXISTING UTILITIES AND SHALL BE RESPONSIBLE FOR THE PROTECTION AND MAINTENANCE OF ALL EXISTING UTILITIES.
 5. THE CONTRACTOR SHALL BE RESPONSIBLE FOR THE PROTECTION AND MAINTENANCE OF ALL EXISTING UTILITIES AND SHALL BE RESPONSIBLE FOR THE PROTECTION AND MAINTENANCE OF ALL EXISTING UTILITIES.
 6. THE CONTRACTOR SHALL BE RESPONSIBLE FOR THE PROTECTION AND MAINTENANCE OF ALL EXISTING UTILITIES AND SHALL BE RESPONSIBLE FOR THE PROTECTION AND MAINTENANCE OF ALL EXISTING UTILITIES.
 7. THE CONTRACTOR SHALL BE RESPONSIBLE FOR THE PROTECTION AND MAINTENANCE OF ALL EXISTING UTILITIES AND SHALL BE RESPONSIBLE FOR THE PROTECTION AND MAINTENANCE OF ALL EXISTING UTILITIES.
 8. THE CONTRACTOR SHALL BE RESPONSIBLE FOR THE PROTECTION AND MAINTENANCE OF ALL EXISTING UTILITIES AND SHALL BE RESPONSIBLE FOR THE PROTECTION AND MAINTENANCE OF ALL EXISTING UTILITIES.
 9. THE CONTRACTOR SHALL BE RESPONSIBLE FOR THE PROTECTION AND MAINTENANCE OF ALL EXISTING UTILITIES AND SHALL BE RESPONSIBLE FOR THE PROTECTION AND MAINTENANCE OF ALL EXISTING UTILITIES.
 10. THE CONTRACTOR SHALL BE RESPONSIBLE FOR THE PROTECTION AND MAINTENANCE OF ALL EXISTING UTILITIES AND SHALL BE RESPONSIBLE FOR THE PROTECTION AND MAINTENANCE OF ALL EXISTING UTILITIES.

JUNE 11, 2004

NO.	DATE	BY	DESCRIPTION
1	06/11/04

Central
Engineering and Surveying
11111 111th Street, Suite 111
Tomball, TX 77375
Tel: 281-358-1111
Fax: 281-358-1112
www.central-engineering.com

PALM BEACH COUNTY
ENGINEERING AND SURVEYING
11111 111th Street, Suite 111
Tomball, TX 77375
Tel: 281-358-1111
Fax: 281-358-1112
www.palm-beach-county.com

FOREST HILL BOULEVARD IRRIGATION DEVELOPMENT PLAN

Scale: 1" = 40'

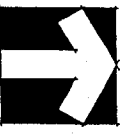

Prepared by
CENTRAL ENGINEERING AND SURVEYING
11111 111th Street, Suite 111
Tomball, TX 77375
Tel: 281-358-1111
Fax: 281-358-1112
www.central-engineering.com

at boundaries and show ground structures above horizon or
 designed and are to be maintained in accordance
 with the palm beach county street/cross street manual with
 (regard to their sign structure and include their sizes.

MATCHLINE
 SEE SHEET IR-13

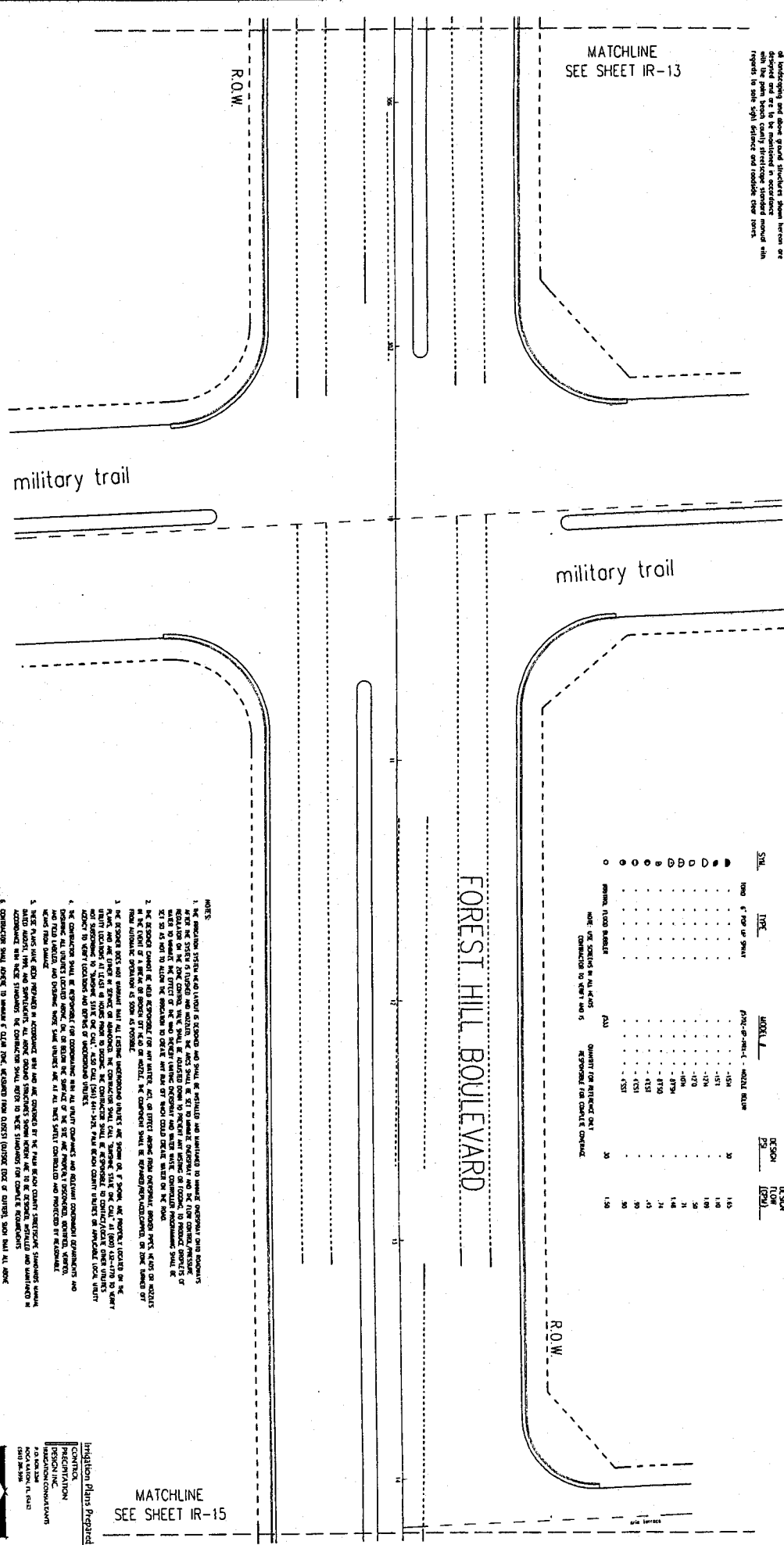

SYMBOL	TYPE	SPACING	QUANTITY FOR EACH 100' SECTION	DESIGN FLOW (GPM)
●	SPRINKLER	10'	10	1.0
○	SPRINKLER	15'	7	1.0
○	SPRINKLER	20'	5	1.0
○	SPRINKLER	25'	4	1.0
○	SPRINKLER	30'	3	1.0
○	SPRINKLER	35'	3	1.0
○	SPRINKLER	40'	2	1.0
○	SPRINKLER	45'	2	1.0
○	SPRINKLER	50'	2	1.0
○	SPRINKLER	55'	2	1.0
○	SPRINKLER	60'	2	1.0
○	SPRINKLER	65'	2	1.0
○	SPRINKLER	70'	2	1.0
○	SPRINKLER	75'	2	1.0
○	SPRINKLER	80'	2	1.0
○	SPRINKLER	85'	2	1.0
○	SPRINKLER	90'	2	1.0
○	SPRINKLER	95'	2	1.0
○	SPRINKLER	100'	2	1.0

NO IRRIGATION THIS SHEET

FOREST HILL BOULEVARD

MATCHLINE
 SEE SHEET IR-15

- NOTES**
1. THE IRRIGATION SYSTEM SHALL BE DESIGNED AND SHALL BE INSTALLED AND MAINTAINED TO MAINTAIN PROPERLY DRAIN BOUNDARIES AND TO PREVENT FLOODING AND SOIL EROSION. THE DESIGN SHALL BE SUBJECT TO THE REVIEW AND APPROVAL OF THE PALM BEACH COUNTY ENGINEERING DEPARTMENT. THE DESIGN SHALL BE SUBJECT TO THE REVIEW AND APPROVAL OF THE PALM BEACH COUNTY ENGINEERING DEPARTMENT. THE DESIGN SHALL BE SUBJECT TO THE REVIEW AND APPROVAL OF THE PALM BEACH COUNTY ENGINEERING DEPARTMENT.
 2. THE DESIGN SHALL BE SUBJECT TO THE REVIEW AND APPROVAL OF THE PALM BEACH COUNTY ENGINEERING DEPARTMENT. THE DESIGN SHALL BE SUBJECT TO THE REVIEW AND APPROVAL OF THE PALM BEACH COUNTY ENGINEERING DEPARTMENT. THE DESIGN SHALL BE SUBJECT TO THE REVIEW AND APPROVAL OF THE PALM BEACH COUNTY ENGINEERING DEPARTMENT.
 3. THE DESIGN SHALL BE SUBJECT TO THE REVIEW AND APPROVAL OF THE PALM BEACH COUNTY ENGINEERING DEPARTMENT. THE DESIGN SHALL BE SUBJECT TO THE REVIEW AND APPROVAL OF THE PALM BEACH COUNTY ENGINEERING DEPARTMENT. THE DESIGN SHALL BE SUBJECT TO THE REVIEW AND APPROVAL OF THE PALM BEACH COUNTY ENGINEERING DEPARTMENT.
 4. THE DESIGN SHALL BE SUBJECT TO THE REVIEW AND APPROVAL OF THE PALM BEACH COUNTY ENGINEERING DEPARTMENT. THE DESIGN SHALL BE SUBJECT TO THE REVIEW AND APPROVAL OF THE PALM BEACH COUNTY ENGINEERING DEPARTMENT. THE DESIGN SHALL BE SUBJECT TO THE REVIEW AND APPROVAL OF THE PALM BEACH COUNTY ENGINEERING DEPARTMENT.
 5. THE DESIGN SHALL BE SUBJECT TO THE REVIEW AND APPROVAL OF THE PALM BEACH COUNTY ENGINEERING DEPARTMENT. THE DESIGN SHALL BE SUBJECT TO THE REVIEW AND APPROVAL OF THE PALM BEACH COUNTY ENGINEERING DEPARTMENT. THE DESIGN SHALL BE SUBJECT TO THE REVIEW AND APPROVAL OF THE PALM BEACH COUNTY ENGINEERING DEPARTMENT.
 6. THE DESIGN SHALL BE SUBJECT TO THE REVIEW AND APPROVAL OF THE PALM BEACH COUNTY ENGINEERING DEPARTMENT. THE DESIGN SHALL BE SUBJECT TO THE REVIEW AND APPROVAL OF THE PALM BEACH COUNTY ENGINEERING DEPARTMENT. THE DESIGN SHALL BE SUBJECT TO THE REVIEW AND APPROVAL OF THE PALM BEACH COUNTY ENGINEERING DEPARTMENT.
 7. THE DESIGN SHALL BE SUBJECT TO THE REVIEW AND APPROVAL OF THE PALM BEACH COUNTY ENGINEERING DEPARTMENT. THE DESIGN SHALL BE SUBJECT TO THE REVIEW AND APPROVAL OF THE PALM BEACH COUNTY ENGINEERING DEPARTMENT. THE DESIGN SHALL BE SUBJECT TO THE REVIEW AND APPROVAL OF THE PALM BEACH COUNTY ENGINEERING DEPARTMENT.

JUNE 11, 2004

all underground and above ground structures shown herein are designed and are to be installed in accordance with the report of the engineer of record and shall be installed in accordance with the report of the engineer of record and shall be installed in accordance with the report of the engineer of record.

STA	TYPE	MODEL #	PS	CON
1000	6" pop up grate			
1005				
1010				
1015				
1020				
1025				
1030				
1035				
1040				
1045				
1050				
1055				
1060				
1065				
1070				
1075				
1080				
1085				
1090				
1095				
1100				
1105				
1110				
1115				
1120				
1125				
1130				
1135				
1140				
1145				
1150				
1155				
1160				
1165				
1170				
1175				
1180				
1185				
1190				
1195				
1200				

1. THE CONTRACTOR SHALL BE RESPONSIBLE FOR THE DESIGN AND CONSTRUCTION OF ALL STRUCTURES AND UTILITIES SHOWN ON THIS PLAN. THE CONTRACTOR SHALL BE RESPONSIBLE FOR OBTAINING ALL NECESSARY PERMITS AND APPROVALS FROM THE APPROPRIATE AGENCIES.
2. THE CONTRACTOR SHALL BE RESPONSIBLE FOR THE PROTECTION OF ALL EXISTING UTILITIES AND STRUCTURES. THE CONTRACTOR SHALL BE RESPONSIBLE FOR OBTAINING ALL NECESSARY PERMITS AND APPROVALS FROM THE APPROPRIATE AGENCIES.
3. THE CONTRACTOR SHALL BE RESPONSIBLE FOR THE PROTECTION OF ALL EXISTING UTILITIES AND STRUCTURES. THE CONTRACTOR SHALL BE RESPONSIBLE FOR OBTAINING ALL NECESSARY PERMITS AND APPROVALS FROM THE APPROPRIATE AGENCIES.
4. THE CONTRACTOR SHALL BE RESPONSIBLE FOR THE PROTECTION OF ALL EXISTING UTILITIES AND STRUCTURES. THE CONTRACTOR SHALL BE RESPONSIBLE FOR OBTAINING ALL NECESSARY PERMITS AND APPROVALS FROM THE APPROPRIATE AGENCIES.
5. THE CONTRACTOR SHALL BE RESPONSIBLE FOR THE PROTECTION OF ALL EXISTING UTILITIES AND STRUCTURES. THE CONTRACTOR SHALL BE RESPONSIBLE FOR OBTAINING ALL NECESSARY PERMITS AND APPROVALS FROM THE APPROPRIATE AGENCIES.
6. THE CONTRACTOR SHALL BE RESPONSIBLE FOR THE PROTECTION OF ALL EXISTING UTILITIES AND STRUCTURES. THE CONTRACTOR SHALL BE RESPONSIBLE FOR OBTAINING ALL NECESSARY PERMITS AND APPROVALS FROM THE APPROPRIATE AGENCIES.
7. THE CONTRACTOR SHALL BE RESPONSIBLE FOR THE PROTECTION OF ALL EXISTING UTILITIES AND STRUCTURES. THE CONTRACTOR SHALL BE RESPONSIBLE FOR OBTAINING ALL NECESSARY PERMITS AND APPROVALS FROM THE APPROPRIATE AGENCIES.

MATCHLINE
SEE SHEET IR-14

drive

MATCHLINE
SEE SHEET IR-16

FOREST HILL BOULEVARD

concrete median

concrete median

ROW

ROW

JANE 11, 2004

DATE	DESCRIPTION	BY	CHKD





FOREST HILL BOULEVARD

IRRIGATION DEVELOPMENT PLAN

Irrigation Plans Prepared by:
 J. L. BISHOP
 PROFESSIONAL ENGINEER
 NO. 11,202
 STATE OF FLORIDA
 J. L. BISHOP & ASSOCIATES
 1100 N. W. 11th St.
 Ft. Lauderdale, FL 33304
 (954) 561-1111

NORTH
 40'
 Scale 1" = 40'

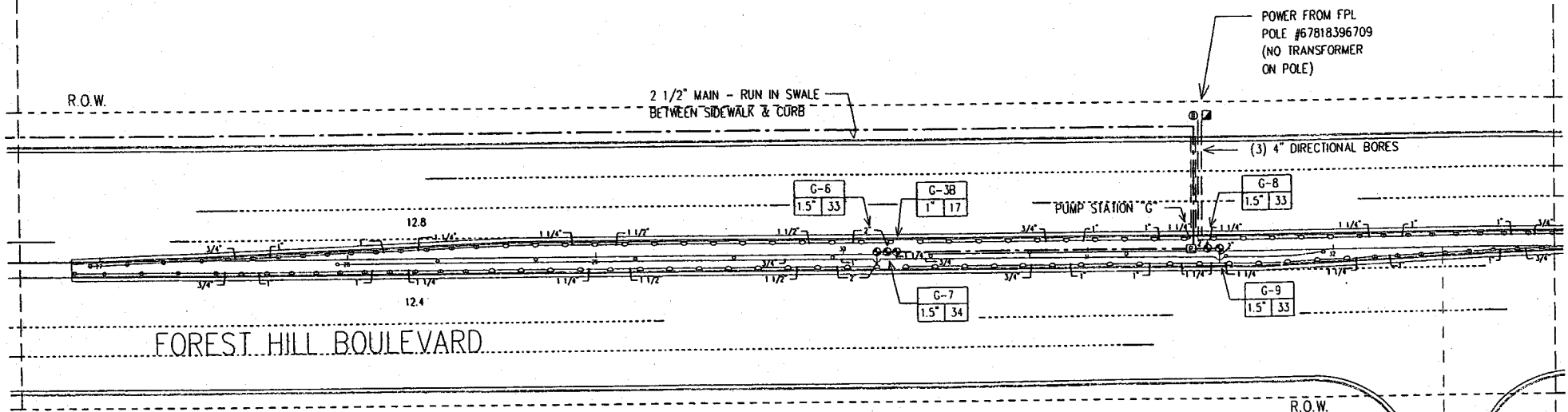
designed and are to be maintained in accordance with the palm beach county streetscape standard manual with regards to safe sight distance and roadside clear zones.



POWER FROM FPL
POLE #67818396709
(NO TRANSFORMER
ON POLE)

FOREST HILL BOULEVARD

MATCHLINE
SEE SHEET IR-16

SPRINKLER KEY LEGEND

SYM.	TYPE	MODEL #	DESIGN PSI	DESIGN FLOW (GPM)
1290	4" POP UP SPRAY	1290Z-0P-PRV-E - NOZZLE BELOW	30	1.65
●	●	-15N	-	1.10
●	●	-15T	-	1.09
●	●	-17N	-	50
●	●	-17T	-	71
●	●	-10N	-	148
●	●	-873N	-	74
●	●	-8750	-	45
●	●	-4151	-	90
●	●	-4152	-	90
●	●	-4153	-	90
○	IRRIG. FLOOD BUBBLER	333	30	1.50

NOTE: USE SCREENS IN ALL HEADS. CONTRACTOR TO VERIFY AND IS RESPONSIBLE FOR COMPLETE COVERAGE.

NOTES

1. THE IRRIGATION SYSTEM HEAD LAYOUT IS DESIGNED AND SHALL BE INSTALLED AND MAINTAINED TO MINIMIZE OVERSPRAY OVER ROADWAYS. AFTER THE SYSTEM IS FLOODED AND NOZZLES, THE NOZZS SHALL BE SET TO MINIMIZE OVERSPRAY AND THE FLOW CONTROL/PRESSURE REGULATOR ON THE ZONE CONTROL VALVE SHALL BE ADJUSTED DOWN TO PREVENT ANY WASTING OR FOULING. TO PRODUCE DROPLETS OF WATER TO MINIMIZE THE EFFECT OF THE WIND THEREBY LIMITING OVERSPRAY AND WASTE. CONTROLLER PROGRAMMING SHALL BE SET SO AS NOT TO ALLOW THE IRRIGATION TO CREATE ANY RUN OFF. BACK CLOSURE CLEAR ZONE ON THE ROAD.
2. THE DESIGNER CANNOT BE HELD RESPONSIBLE FOR ANY WATER, AIR, OR ELECTRICITY ARISING FROM OVERSPRAY, BROKEN PIPES, HEADS OR NOZZLES IN THE EVENT OF A BREAK OR BROKEN OFF HEAD OR NOZZLE, THE COMPONENT SHALL BE REPAIRED/REPLACED/CAPPED, OR ZONE TURNED OFF FROM AUTOMATIC OPERATION AS SOON AS POSSIBLE.
3. THE DESIGNER DOES NOT WARRANT THAT ALL EXISTING UNDERGROUND UTILITIES ARE SHOWN OR IF SHOWN, ARE PROPERLY LOCATED ON THE PLANS, AND ARE EITHER IN SERVICE OR ABANDONED. THE CONTRACTOR SHALL CALL "SOUNDING STATE ONE CALL" AT (800) 438-4370 TO VERIFY UTILITY LOCATIONS AT LEAST 48 HOURS PRIOR TO DIGGING. THE CONTRACTOR SHALL BE RESPONSIBLE TO CONTACT/AGREE OTHER UTILITIES NOT SUBSCRIBING TO "SOUNDING STATE ONE CALL". ALSO CALL (561) 841-3428, PALM BEACH COUNTY UTILITIES OR APPLICABLE LOCAL UTILITY AGENCY TO VERIFY LOCATIONS AND DEPTHS OF UNDERGROUND UTILITIES.
4. THE CONTRACTOR SHALL BE RESPONSIBLE FOR COORDINATING WITH ALL UTILITY COMPANIES AND RELEVANT GOVERNMENT DEPARTMENTS AND ENSURING ALL UTILITIES LOCATED ABOVE, ON OR BELOW THE SURFACE OF THE SITE ARE PROPERLY DISCOVERED, IDENTIFIED, MARKED, AND FIELD LABELED, AND ENSURING THOSE SAME UTILITIES ARE AT ALL TIMES SAFELY CONTROLLED AND PROTECTED BY REASONABLE MEANS FROM DAMAGE.
5. THESE PLANS HAVE BEEN PREPARED IN ACCORDANCE WITH AND ARE GOVERNED BY THE PALM BEACH COUNTY STREETScape STANDARD MANUAL, DATED AUGUST 1998, AND SUPPLEMENTS. ALL ABOVE GROUND STRUCTURES SHOWN HEREIN ARE TO BE DESIGNED, INSTALLED AND MAINTAINED IN ACCORDANCE WITH THESE STANDARDS. THE CONTRACTOR SHALL REFER TO THESE STANDARDS FOR COMPLETE REQUIREMENTS.
6. CONTRACTOR SHALL ADHERE TO MINIMUM 4' CLEAR ZONE, MEASURED FROM CLOSEST (OUTSIDE EDGE OF CUTTER), SUCH THAT ALL ABOVE GROUND EQUIPMENT INSTALLATIONS WILL BE OUTSIDE OF CLEAR ZONE.
7. LOCATE SPRINKLER HEADS 12" FROM BACK OF CURB. LOCATE IRRIGATION VALVE BORES A MINIMUM 18" FROM BACK OF CURB.

sandstone

MATCHLINE
SEE SHEET IR-18

Irrigation Plans Prepared By
CONTROL
PRECIPITATION
DESIGN INC.
IRRIGATION CONSULTANTS
P.O. BOX 2208
NOCA BEACH, FL 33432
(561) 948-3434



40'
Scale: 1" = 40'

JUNE 17, 2004

DATE	BY	DESCRIPTION	DATE	BY	DESCRIPTION	DATE	BY	DESCRIPTION

Copple Highway Observatory
ENGINEERING AND PUBLIC WORKS
STREETScape SYSTEMS
WEST PALM BEACH, FLORIDA
(561) 848-3434

FOREST HILL BOULEVARD

IRRIGATION DEVELOPMENT PLAN

note:
all landscaping and above ground structures shown herein are designed and are to be maintained in accordance with the palm beach county streetscape standard manual with regards to safe sight distance and roadside clear zones.

- NOTES:
1. THE IRRIGATION SYSTEM HEAD LAYOUT IS DESIGNED AND SHALL BE INSTALLED AND MAINTAINED TO MINIMIZE OVERSPRAY ONTO ROADWAYS AFTER THE SYSTEM IS FLUSHED AND HOZZLES. THE ARCS SHALL BE SET TO MINIMIZE OVERSPRAY AND THE FLOW CONTROL/PRESSURE REGULATOR ON THE ZONE CONTROL VALVE SHALL BE ADJUSTED DOWN TO PREVENT ANY MISSING OR FLOODING TO PRODUCE DROPLETS OF WATER TO MINIMIZE THE EFFECT OF THE WIND INCREASING OVERSPRAY AND WATER WASTE. CONTROLLER PROGRAMMING SHALL BE SET SO AS NOT TO ALLOW THE IRRIGATION TO OPERATE ANY RUN BY WHICH COULD CREATE WATER ON THE ROAD.
 2. THE DESIGNER CANNOT BE HELD RESPONSIBLE FOR ANY WATER, ACT, OR EFFECT ARISING FROM OVERSPRAY, BROKEN PIPES, HEADS OR HOZZLES. IN THE EVENT OF A BROKEN OR BROKEN OFF HEAD OR HOZZLE, THE COMPONENT SHALL BE REPAIRED/REPLACED/CAPPED, OR ZONE TURNED OFF FROM AUTOMATIC OPERATION AS SOON AS POSSIBLE.
 3. THE DESIGNER DOES NOT WARRANT THAT ALL EXISTING UNDERGROUND UTILITIES ARE SHOWN OR, IF SHOWN, ARE PROPERLY LOCATED ON THE PLANS, AND ARE EITHER IN SERVICE OR ABANDONED. THE CONTRACTOR SHALL CALL "SHOUSHINE START ONE CALL" AT (800) 432-4770 TO VERIFY UTILITY LOCATIONS AT LEAST 48 HOURS PRIOR TO DIGGING. THE CONTRACTOR SHALL BE RESPONSIBLE TO CONTRACT/LOCATE OTHER UTILITIES NOT SUBSIDIARY TO "SHOUSHINE START ONE CALL". ALSO CALL (561) 644-3479, PALM BEACH COUNTY UTILITIES OR APPLICABLE LOCAL UTILITY AGENCY TO VERIFY LOCATIONS AND DEPTHS OF UNDERGROUND UTILITIES.
 4. THE CONTRACTOR SHALL BE RESPONSIBLE FOR COORDINATING WITH ALL UTILITY COMPANIES AND RELEVANT GOVERNMENT DEPARTMENTS AND ENSURING ALL UTILITIES LOCATED ABOVE, ON, OR BELOW THE SURFACE OF THE SITE ARE PROPERLY DISCONNECTED, EXPOSED, VERIFIED, AND FIELD LABELED, AND ENSURING THOSE SAME UTILITIES ARE AT ALL TIMES SAFELY CONTROLLED AND PROTECTED BY REASONABLE MEANS FROM DAMAGE.
 5. THESE PLANS HAVE BEEN PREPARED IN ACCORDANCE WITH AND ARE GOVERNED BY THE PALM BEACH COUNTY STREETScape STANDARDS MANUAL, DATED AUGUST, 1998, AND SUPPLEMENTS. ALL ABOVE GROUND STRUCTURES SHOWN HEREIN ARE TO BE DESIGNED, INSTALLED AND MAINTAINED IN ACCORDANCE WITH THESE STANDARDS. THE CONTRACTOR SHALL REFER TO THESE STANDARDS FOR COMPLETE REQUIREMENTS.
 6. CONTRACTOR SHALL ADHERE TO MINIMUM 6' CLEAR ZONE, MEASURED FROM CLOSEST (OUTSIDE EDGE OF CURB), SUCH THAT ALL ABOVE GROUND EQUIPMENT INSTALLATIONS WILL BE OUTSIDE OF CLEAR ZONE.
 7. LOCATE SPRINKLER HEADS 12" FROM BACK OF CURB. LOCATE IRRIGATION VALVE BORES A MINIMUM 18" FROM BACK OF CURB.

SPRINKLER KEY LEGEND

SYM	TYPE	MODEL #	DESIGN PS	DESIGN FLOW (GPM)
TORO	6" POP UP SPRAY	PNZ-IP-PRO-E - HOZZLE BELOW		
●			15M	30
●			15T	118
●			12M	109
●			12T	50
●			18M	31
●			18T	148
●			15SD	71
●			15SI	45
●			15ST	90
●			15ST	90
○	CONTROL FLOOD BUBBLER	P33	30	150

NOTE: USE SCREENS IN ALL HEADS. CONTRACTOR TO VERIFY AND IS RESPONSIBLE FOR COMPLETE COVERAGE.

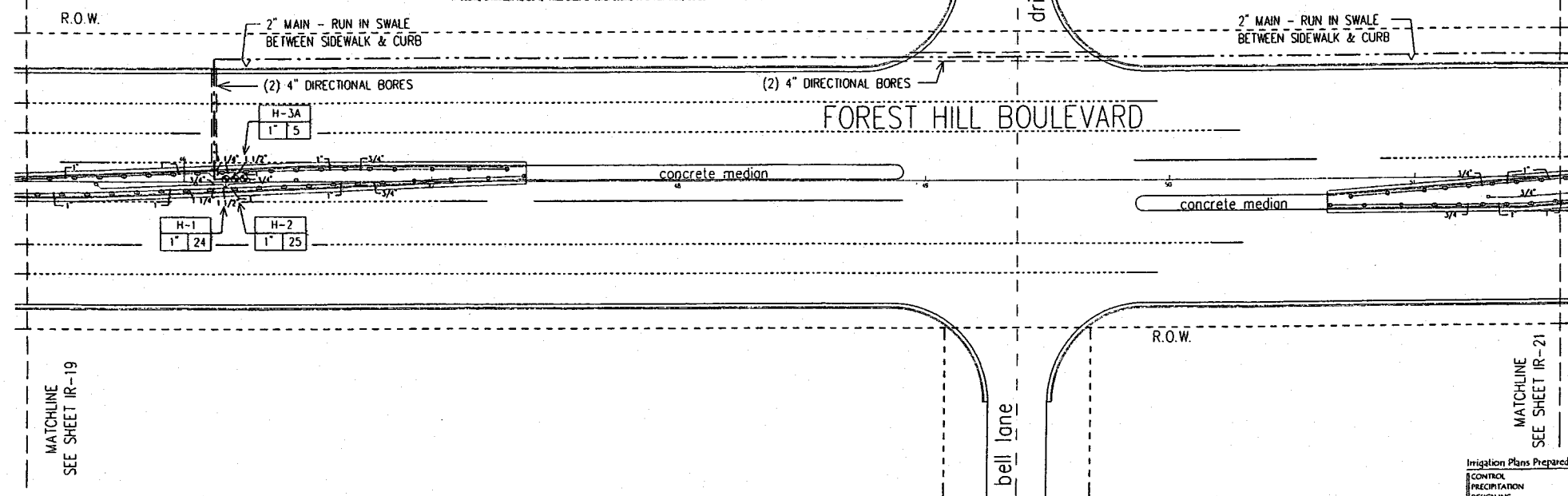

JUNE 17, 2004

DATE	BY	DESCRIPTION	DATE	BY	DESCRIPTION

Coville-Holloway
 ENGINEERS AND ARCHITECTS
 1000 S. PALM BEACH BLVD.
 SUITE 200
 PALM BEACH, FL 33480
 (561) 844-1188



PALM BEACH COUNTY
 ENGINEERING AND PUBLIC WORKS
 STREETScape SECTION
 1000 S. PALM BEACH, FLORIDA
 (561) 844-1188

FOREST HILL BOULEVARD IRRIGATION DEVELOPMENT PLAN

Irrigation Plans Prepared By
CONTROL PRECIPITATION DESIGN INC.
 IRRIGATION CONSULTANTS
 P.O. BOX 2388
 MOCA RATION, FL 32841
 (386) 391-9990

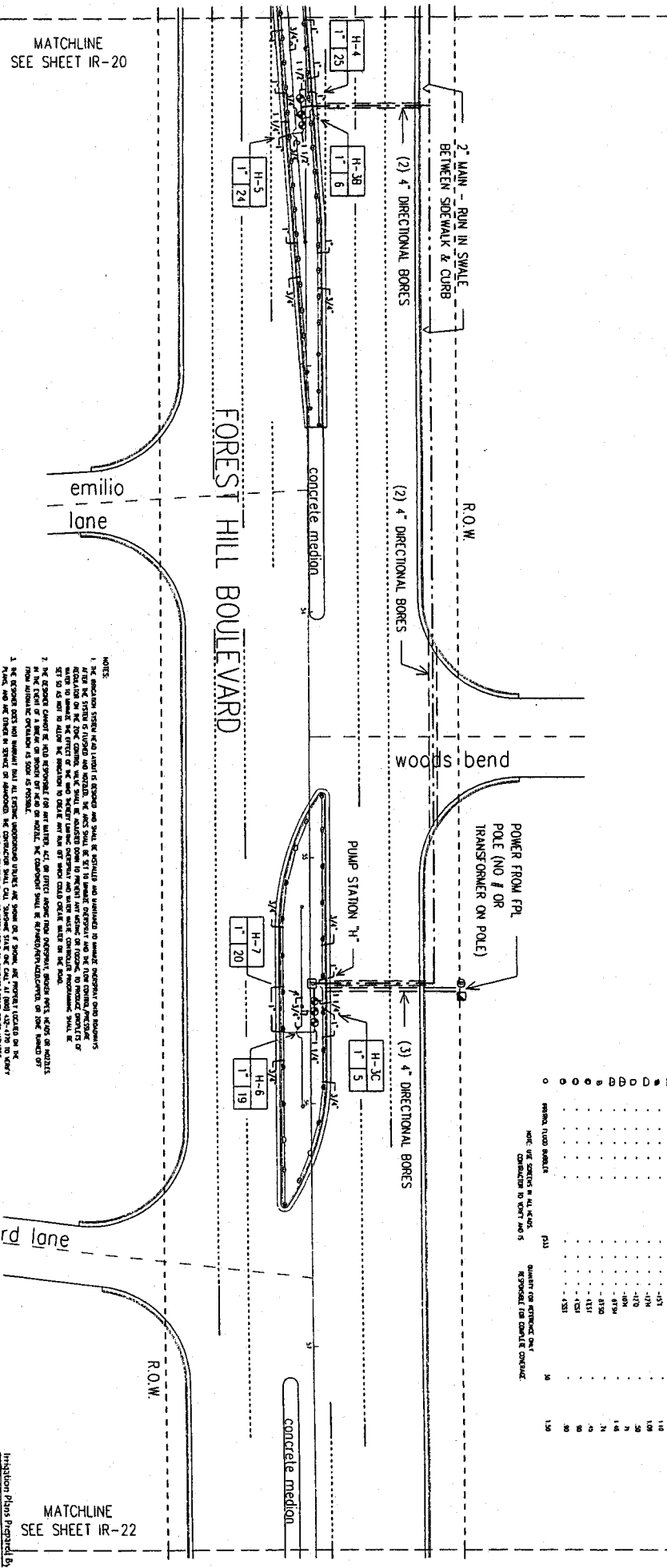

NOTE:
 all landscaping and above ground structures shown herein are
 proposed and are to be installed at the contractor's expense
 and shall be subject to the approval of the local authority
 having jurisdiction. The contractor shall be responsible for
 report to site right of way and provide clear zones



SIR	TYPE	DEPTH	CONTRIBUTION TO VOLT AND IS	QUALITY FOR REFERENCE ONLY - RESPONSIBLE FOR CORRECT OVERLAP
100	5" PVC SPLIT	-1.51		3.0
110	"	-1.51		1.0
120	"	-1.74		1.0
130	"	-1.70		1.0
140	"	-1.81		1.0
150	"	-1.79		1.0
160	"	-1.52		1.0
170	"	-1.51		1.0
180	"	-1.51		1.0
190	"	-1.51		1.0
200	"	-1.51		1.0
210	"	-1.51		1.0
220	"	-1.51		1.0
230	"	-1.51		1.0
240	"	-1.51		1.0
250	"	-1.51		1.0
260	"	-1.51		1.0
270	"	-1.51		1.0
280	"	-1.51		1.0
290	"	-1.51		1.0
300	"	-1.51		1.0
310	"	-1.51		1.0
320	"	-1.51		1.0
330	"	-1.51		1.0
340	"	-1.51		1.0
350	"	-1.51		1.0
360	"	-1.51		1.0
370	"	-1.51		1.0
380	"	-1.51		1.0
390	"	-1.51		1.0
400	"	-1.51		1.0

- NOTES:
1. THE OPERATOR SHALL BE RESPONSIBLE FOR THE PROTECTION AND MAINTENANCE OF ALL UTILITIES AND STRUCTURES SHOWN HEREON. THE CONTRACTOR SHALL BE RESPONSIBLE FOR THE PROTECTION AND MAINTENANCE OF ALL UTILITIES AND STRUCTURES SHOWN HEREON. THE CONTRACTOR SHALL BE RESPONSIBLE FOR THE PROTECTION AND MAINTENANCE OF ALL UTILITIES AND STRUCTURES SHOWN HEREON.
 2. THE CONTRACTOR SHALL BE RESPONSIBLE FOR THE PROTECTION AND MAINTENANCE OF ALL UTILITIES AND STRUCTURES SHOWN HEREON. THE CONTRACTOR SHALL BE RESPONSIBLE FOR THE PROTECTION AND MAINTENANCE OF ALL UTILITIES AND STRUCTURES SHOWN HEREON.
 3. THE CONTRACTOR SHALL BE RESPONSIBLE FOR THE PROTECTION AND MAINTENANCE OF ALL UTILITIES AND STRUCTURES SHOWN HEREON. THE CONTRACTOR SHALL BE RESPONSIBLE FOR THE PROTECTION AND MAINTENANCE OF ALL UTILITIES AND STRUCTURES SHOWN HEREON.
 4. THE CONTRACTOR SHALL BE RESPONSIBLE FOR THE PROTECTION AND MAINTENANCE OF ALL UTILITIES AND STRUCTURES SHOWN HEREON. THE CONTRACTOR SHALL BE RESPONSIBLE FOR THE PROTECTION AND MAINTENANCE OF ALL UTILITIES AND STRUCTURES SHOWN HEREON.
 5. THE CONTRACTOR SHALL BE RESPONSIBLE FOR THE PROTECTION AND MAINTENANCE OF ALL UTILITIES AND STRUCTURES SHOWN HEREON. THE CONTRACTOR SHALL BE RESPONSIBLE FOR THE PROTECTION AND MAINTENANCE OF ALL UTILITIES AND STRUCTURES SHOWN HEREON.
 6. THE CONTRACTOR SHALL BE RESPONSIBLE FOR THE PROTECTION AND MAINTENANCE OF ALL UTILITIES AND STRUCTURES SHOWN HEREON. THE CONTRACTOR SHALL BE RESPONSIBLE FOR THE PROTECTION AND MAINTENANCE OF ALL UTILITIES AND STRUCTURES SHOWN HEREON.
 7. UTILITY STRUCTURES SHALL BE 12" FROM FACE OF CURB UNLESS OTHERWISE SHOWN.

JUNE 11, 2004

Scale: 1" = 40'

IRIGATION PLANS PREPARED BY: [Logo] CONSULTING ENGINEERS

DESIGN INC. CONSULTANTS

1000 W. PALM BEACH BLVD. SUITE 1000 PALM BEACH, FL 33480

FOREST HILL BOULEVARD

IRRIGATION DEVELOPMENT PLAN

designed and are to be installed in accordance with the palm beach county landscape standard manual with regard to soil type, drainage and mulch color tones

SPRINKLER KEY LEGEND

SYM	TYPE	MODEL #	RESPON (GPM)	DESIGN (GPM)
○	TYPE 1	1-10	30	100
○	TYPE 2	1-11	100	100
○	TYPE 3	1-12	100	100
○	TYPE 4	1-13	50	50
○	TYPE 5	1-14	75	75
○	TYPE 6	1-15	100	100
○	TYPE 7	1-16	100	100
○	TYPE 8	1-17	100	100
○	TYPE 9	1-18	100	100
○	TYPE 10	1-19	100	100
○	TYPE 11	1-20	100	100
○	TYPE 12	1-21	100	100
○	TYPE 13	1-22	100	100
○	TYPE 14	1-23	100	100
○	TYPE 15	1-24	100	100
○	TYPE 16	1-25	100	100
○	TYPE 17	1-26	100	100
○	TYPE 18	1-27	100	100
○	TYPE 19	1-28	100	100
○	TYPE 20	1-29	100	100
○	TYPE 21	1-30	100	100
○	TYPE 22	1-31	100	100
○	TYPE 23	1-32	100	100
○	TYPE 24	1-33	100	100
○	TYPE 25	1-34	100	100
○	TYPE 26	1-35	100	100
○	TYPE 27	1-36	100	100
○	TYPE 28	1-37	100	100
○	TYPE 29	1-38	100	100
○	TYPE 30	1-39	100	100
○	TYPE 31	1-40	100	100
○	TYPE 32	1-41	100	100
○	TYPE 33	1-42	100	100
○	TYPE 34	1-43	100	100
○	TYPE 35	1-44	100	100
○	TYPE 36	1-45	100	100
○	TYPE 37	1-46	100	100
○	TYPE 38	1-47	100	100
○	TYPE 39	1-48	100	100
○	TYPE 40	1-49	100	100
○	TYPE 41	1-50	100	100
○	TYPE 42	1-51	100	100
○	TYPE 43	1-52	100	100
○	TYPE 44	1-53	100	100
○	TYPE 45	1-54	100	100
○	TYPE 46	1-55	100	100
○	TYPE 47	1-56	100	100
○	TYPE 48	1-57	100	100
○	TYPE 49	1-58	100	100
○	TYPE 50	1-59	100	100
○	TYPE 51	1-60	100	100
○	TYPE 52	1-61	100	100
○	TYPE 53	1-62	100	100
○	TYPE 54	1-63	100	100
○	TYPE 55	1-64	100	100
○	TYPE 56	1-65	100	100
○	TYPE 57	1-66	100	100
○	TYPE 58	1-67	100	100
○	TYPE 59	1-68	100	100
○	TYPE 60	1-69	100	100
○	TYPE 61	1-70	100	100
○	TYPE 62	1-71	100	100
○	TYPE 63	1-72	100	100
○	TYPE 64	1-73	100	100
○	TYPE 65	1-74	100	100
○	TYPE 66	1-75	100	100
○	TYPE 67	1-76	100	100
○	TYPE 68	1-77	100	100
○	TYPE 69	1-78	100	100
○	TYPE 70	1-79	100	100
○	TYPE 71	1-80	100	100
○	TYPE 72	1-81	100	100
○	TYPE 73	1-82	100	100
○	TYPE 74	1-83	100	100
○	TYPE 75	1-84	100	100
○	TYPE 76	1-85	100	100
○	TYPE 77	1-86	100	100
○	TYPE 78	1-87	100	100
○	TYPE 79	1-88	100	100
○	TYPE 80	1-89	100	100
○	TYPE 81	1-90	100	100
○	TYPE 82	1-91	100	100
○	TYPE 83	1-92	100	100
○	TYPE 84	1-93	100	100
○	TYPE 85	1-94	100	100
○	TYPE 86	1-95	100	100
○	TYPE 87	1-96	100	100
○	TYPE 88	1-97	100	100
○	TYPE 89	1-98	100	100
○	TYPE 90	1-99	100	100
○	TYPE 91	1-100	100	100

1. THE CONTRACTOR SHALL BE RESPONSIBLE FOR OBTAINING ALL NECESSARY PERMITS AND APPROVALS FROM THE PALM BEACH COUNTY ENGINEERING AND SURVEYING DEPARTMENT AND THE PALM BEACH COUNTY PLANNING AND ZONING DEPARTMENT. THE CONTRACTOR SHALL BE RESPONSIBLE FOR OBTAINING ALL NECESSARY PERMITS AND APPROVALS FROM THE PALM BEACH COUNTY ENGINEERING AND SURVEYING DEPARTMENT AND THE PALM BEACH COUNTY PLANNING AND ZONING DEPARTMENT. THE CONTRACTOR SHALL BE RESPONSIBLE FOR OBTAINING ALL NECESSARY PERMITS AND APPROVALS FROM THE PALM BEACH COUNTY ENGINEERING AND SURVEYING DEPARTMENT AND THE PALM BEACH COUNTY PLANNING AND ZONING DEPARTMENT.
2. THE CONTRACTOR SHALL BE RESPONSIBLE FOR OBTAINING ALL NECESSARY PERMITS AND APPROVALS FROM THE PALM BEACH COUNTY ENGINEERING AND SURVEYING DEPARTMENT AND THE PALM BEACH COUNTY PLANNING AND ZONING DEPARTMENT. THE CONTRACTOR SHALL BE RESPONSIBLE FOR OBTAINING ALL NECESSARY PERMITS AND APPROVALS FROM THE PALM BEACH COUNTY ENGINEERING AND SURVEYING DEPARTMENT AND THE PALM BEACH COUNTY PLANNING AND ZONING DEPARTMENT.
3. THE CONTRACTOR SHALL BE RESPONSIBLE FOR OBTAINING ALL NECESSARY PERMITS AND APPROVALS FROM THE PALM BEACH COUNTY ENGINEERING AND SURVEYING DEPARTMENT AND THE PALM BEACH COUNTY PLANNING AND ZONING DEPARTMENT. THE CONTRACTOR SHALL BE RESPONSIBLE FOR OBTAINING ALL NECESSARY PERMITS AND APPROVALS FROM THE PALM BEACH COUNTY ENGINEERING AND SURVEYING DEPARTMENT AND THE PALM BEACH COUNTY PLANNING AND ZONING DEPARTMENT.
4. THE CONTRACTOR SHALL BE RESPONSIBLE FOR OBTAINING ALL NECESSARY PERMITS AND APPROVALS FROM THE PALM BEACH COUNTY ENGINEERING AND SURVEYING DEPARTMENT AND THE PALM BEACH COUNTY PLANNING AND ZONING DEPARTMENT. THE CONTRACTOR SHALL BE RESPONSIBLE FOR OBTAINING ALL NECESSARY PERMITS AND APPROVALS FROM THE PALM BEACH COUNTY ENGINEERING AND SURVEYING DEPARTMENT AND THE PALM BEACH COUNTY PLANNING AND ZONING DEPARTMENT.
5. THE CONTRACTOR SHALL BE RESPONSIBLE FOR OBTAINING ALL NECESSARY PERMITS AND APPROVALS FROM THE PALM BEACH COUNTY ENGINEERING AND SURVEYING DEPARTMENT AND THE PALM BEACH COUNTY PLANNING AND ZONING DEPARTMENT. THE CONTRACTOR SHALL BE RESPONSIBLE FOR OBTAINING ALL NECESSARY PERMITS AND APPROVALS FROM THE PALM BEACH COUNTY ENGINEERING AND SURVEYING DEPARTMENT AND THE PALM BEACH COUNTY PLANNING AND ZONING DEPARTMENT.
6. THE CONTRACTOR SHALL BE RESPONSIBLE FOR OBTAINING ALL NECESSARY PERMITS AND APPROVALS FROM THE PALM BEACH COUNTY ENGINEERING AND SURVEYING DEPARTMENT AND THE PALM BEACH COUNTY PLANNING AND ZONING DEPARTMENT. THE CONTRACTOR SHALL BE RESPONSIBLE FOR OBTAINING ALL NECESSARY PERMITS AND APPROVALS FROM THE PALM BEACH COUNTY ENGINEERING AND SURVEYING DEPARTMENT AND THE PALM BEACH COUNTY PLANNING AND ZONING DEPARTMENT.
7. LOCATE SPRINKLER HEADS 1' FROM FACE OF CURB (SEE SECTION) AND 1' FROM FACE OF CURB

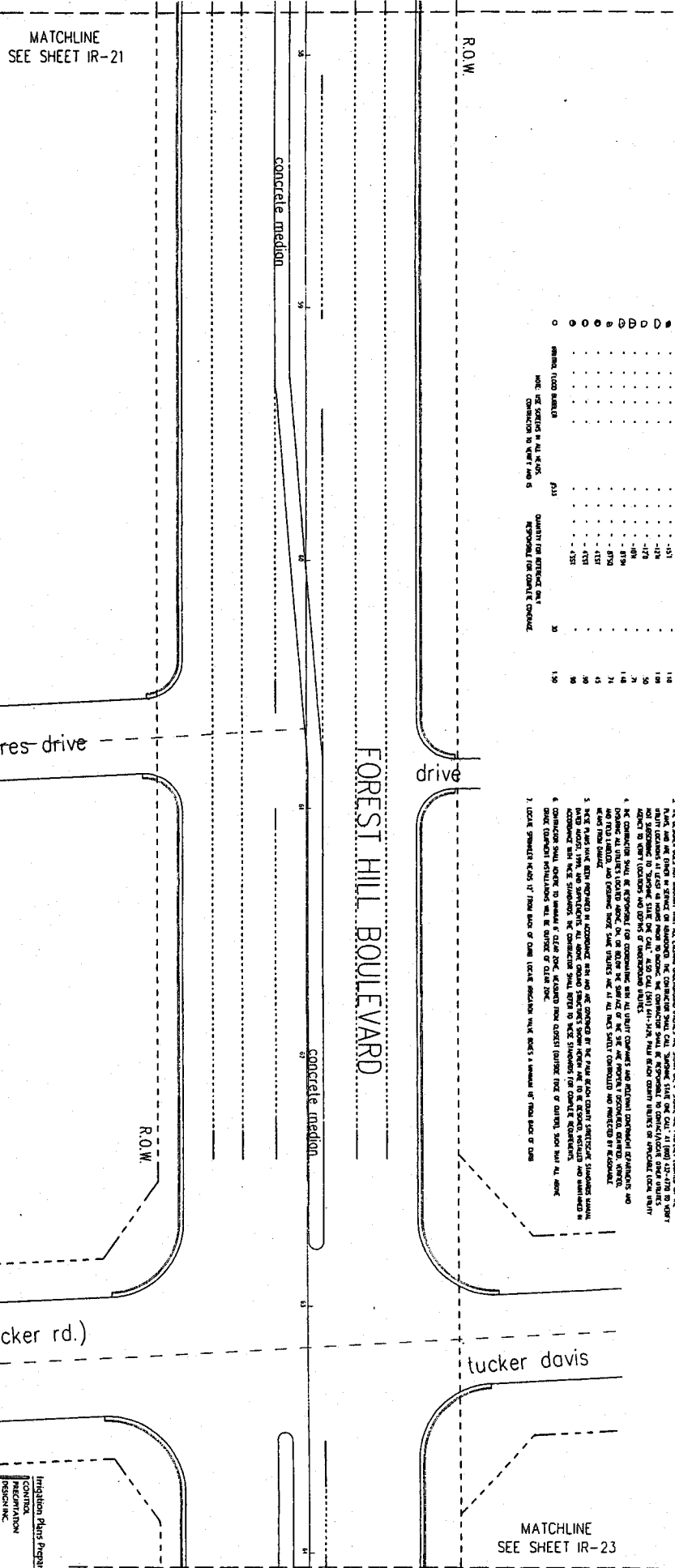

NO IRRIGATION THIS SHEET

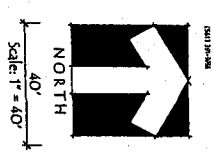

Irrigation Plans Prepared by
 CONSULTING ENGINEER
 PERSON INC.
 400 S.W. 11th St.
 Palm Beach, FL 33480
 (561) 835-1111

JUNE 11, 2004

NO.	DATE	DESCRIPTION
1	06/11/04	ISSUED FOR PERMIT
2	06/11/04	ISSUED FOR PERMIT
3	06/11/04	ISSUED FOR PERMIT
4	06/11/04	ISSUED FOR PERMIT
5	06/11/04	ISSUED FOR PERMIT
6	06/11/04	ISSUED FOR PERMIT
7	06/11/04	ISSUED FOR PERMIT
8	06/11/04	ISSUED FOR PERMIT
9	06/11/04	ISSUED FOR PERMIT
10	06/11/04	ISSUED FOR PERMIT

PALM BEACH COUNTY
 ENGINEERING AND SURVEYING DEPARTMENT
 400 S.W. 11th St.
 Palm Beach, FL 33480
 (561) 835-1111

FOREST HILL BOULEVARD

IRRIGATION DEVELOPMENT PLAN

displayed and are to be maintained in accordance with applicable laws and regulations. The contractor shall be responsible for obtaining all necessary permits and approvals for this project.

ROW

FOREST HILL BOULEVARD

concrete median

drive

drive

concrete median

drive

ROW

MATCHLINE
SEE SHEET IR-22

MATCHLINE
SEE SHEET IR-24

NO IRRIGATION THIS SHEET

- NOTES
1. THE EXISTING DRIVE AND SIDEWALK ARE TO BE MAINTAINED AND REPAIRED TO MEET THE REQUIREMENTS OF THE CITY OF PALM BEACH COUNTY. THE CONTRACTOR SHALL BE RESPONSIBLE FOR OBTAINING ALL NECESSARY PERMITS AND APPROVALS FROM THE CITY OF PALM BEACH COUNTY AND THE STATE OF FLORIDA.
 2. THE CONTRACTOR SHALL MAINTAIN ALL EXISTING UTILITIES AND SHALL BE RESPONSIBLE FOR PROTECTING THEM THROUGHOUT THE PROJECT. ANY DAMAGE TO UTILITIES SHALL BE REPAIRED AT THE CONTRACTOR'S EXPENSE.
 3. THE CONTRACTOR SHALL MAINTAIN THE DRIVE AND SIDEWALK AT ALL TIMES DURING CONSTRUCTION. ANY DAMAGE TO THE DRIVE AND SIDEWALK SHALL BE REPAIRED AT THE CONTRACTOR'S EXPENSE.
 4. THE CONTRACTOR SHALL MAINTAIN THE DRIVE AND SIDEWALK AT ALL TIMES DURING CONSTRUCTION. ANY DAMAGE TO THE DRIVE AND SIDEWALK SHALL BE REPAIRED AT THE CONTRACTOR'S EXPENSE.
 5. THE CONTRACTOR SHALL MAINTAIN THE DRIVE AND SIDEWALK AT ALL TIMES DURING CONSTRUCTION. ANY DAMAGE TO THE DRIVE AND SIDEWALK SHALL BE REPAIRED AT THE CONTRACTOR'S EXPENSE.
 6. THE CONTRACTOR SHALL MAINTAIN THE DRIVE AND SIDEWALK AT ALL TIMES DURING CONSTRUCTION. ANY DAMAGE TO THE DRIVE AND SIDEWALK SHALL BE REPAIRED AT THE CONTRACTOR'S EXPENSE.
 7. THE CONTRACTOR SHALL MAINTAIN THE DRIVE AND SIDEWALK AT ALL TIMES DURING CONSTRUCTION. ANY DAMAGE TO THE DRIVE AND SIDEWALK SHALL BE REPAIRED AT THE CONTRACTOR'S EXPENSE.

LINE	SPRINKLER KEY LEGEND	QUANTITY FOR ESTIMATE ONLY	RESPONSIBLE FOR CONTRACT
1000	5" PVC UP SPUR	100	CONTRACTOR
1010	4" PVC UP SPUR	100	CONTRACTOR
1020	3" PVC UP SPUR	100	CONTRACTOR
1030	2" PVC UP SPUR	100	CONTRACTOR
1040	1" PVC UP SPUR	100	CONTRACTOR
1050	1/2" PVC UP SPUR	100	CONTRACTOR
1060	1/4" PVC UP SPUR	100	CONTRACTOR
1070	1/8" PVC UP SPUR	100	CONTRACTOR
1080	1/4" PVC UP SPUR	100	CONTRACTOR
1090	1/8" PVC UP SPUR	100	CONTRACTOR
1100	1/4" PVC UP SPUR	100	CONTRACTOR
1110	1/8" PVC UP SPUR	100	CONTRACTOR
1120	1/4" PVC UP SPUR	100	CONTRACTOR
1130	1/8" PVC UP SPUR	100	CONTRACTOR
1140	1/4" PVC UP SPUR	100	CONTRACTOR
1150	1/8" PVC UP SPUR	100	CONTRACTOR
1160	1/4" PVC UP SPUR	100	CONTRACTOR
1170	1/8" PVC UP SPUR	100	CONTRACTOR
1180	1/4" PVC UP SPUR	100	CONTRACTOR
1190	1/8" PVC UP SPUR	100	CONTRACTOR
1200	1/4" PVC UP SPUR	100	CONTRACTOR

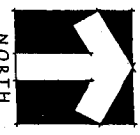

Scale: 1" = 40'

JUNE 11, 2004

NO.	DATE	DESCRIPTION	BY
1	06/11/04	ISSUED FOR PERMIT	...

PALM BEACH COUNTY
 ENGINEERING AND PLANNING DEPARTMENT
 1000 WEST PALM BEACH BOULEVARD
 WEST PALM BEACH, FLORIDA 33411

FOREST HILL BOULEVARD **IRRIGATION DEVELOPMENT PLAN**

NOTE:
 All structures and other ground structures shown herein are designed and set to be installed in accordance with the Palm Beach County Standard Manual with respect to site sign systems and roadside tree preservation.

SYMBOL	DESCRIPTION	AMOUNT	REMARKS
●	1" DIA. 10' HIGH	10	
○	2" DIA. 10' HIGH	10	
○	3" DIA. 10' HIGH	10	
○	4" DIA. 10' HIGH	10	
○	5" DIA. 10' HIGH	10	
○	6" DIA. 10' HIGH	10	
○	7" DIA. 10' HIGH	10	
○	8" DIA. 10' HIGH	10	
○	9" DIA. 10' HIGH	10	
○	10" DIA. 10' HIGH	10	
○	11" DIA. 10' HIGH	10	
○	12" DIA. 10' HIGH	10	
○	13" DIA. 10' HIGH	10	
○	14" DIA. 10' HIGH	10	
○	15" DIA. 10' HIGH	10	
○	16" DIA. 10' HIGH	10	
○	17" DIA. 10' HIGH	10	
○	18" DIA. 10' HIGH	10	
○	19" DIA. 10' HIGH	10	
○	20" DIA. 10' HIGH	10	
○	21" DIA. 10' HIGH	10	
○	22" DIA. 10' HIGH	10	
○	23" DIA. 10' HIGH	10	
○	24" DIA. 10' HIGH	10	
○	25" DIA. 10' HIGH	10	
○	26" DIA. 10' HIGH	10	
○	27" DIA. 10' HIGH	10	
○	28" DIA. 10' HIGH	10	
○	29" DIA. 10' HIGH	10	
○	30" DIA. 10' HIGH	10	

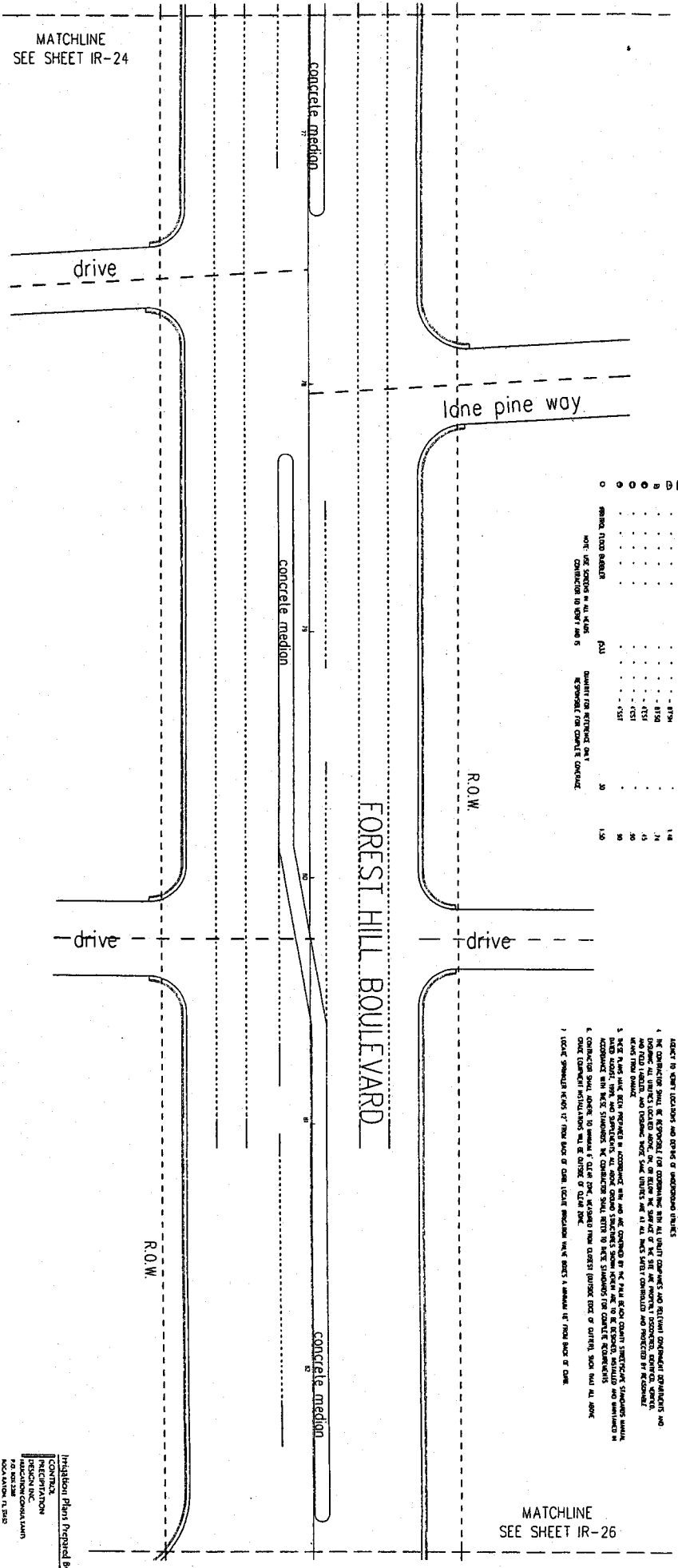

NO IRRIGATION THIS SHEET

1. THE DESIGNER HAS CONDUCTED A VISUAL SURVEY OF THE SITE AND HAS FOUND THAT THE PROPOSED DEVELOPMENT IS COMPATIBLE WITH THE SURROUNDING AREA AND DOES NOT CONFLICT WITH ANY EXISTING OR PROPOSED UTILITIES OR STRUCTURES.

2. THE DESIGNER HAS CONDUCTED A VISUAL SURVEY OF THE SITE AND HAS FOUND THAT THE PROPOSED DEVELOPMENT IS COMPATIBLE WITH THE SURROUNDING AREA AND DOES NOT CONFLICT WITH ANY EXISTING OR PROPOSED UTILITIES OR STRUCTURES.

3. THE DESIGNER HAS CONDUCTED A VISUAL SURVEY OF THE SITE AND HAS FOUND THAT THE PROPOSED DEVELOPMENT IS COMPATIBLE WITH THE SURROUNDING AREA AND DOES NOT CONFLICT WITH ANY EXISTING OR PROPOSED UTILITIES OR STRUCTURES.

4. THE DESIGNER HAS CONDUCTED A VISUAL SURVEY OF THE SITE AND HAS FOUND THAT THE PROPOSED DEVELOPMENT IS COMPATIBLE WITH THE SURROUNDING AREA AND DOES NOT CONFLICT WITH ANY EXISTING OR PROPOSED UTILITIES OR STRUCTURES.

5. THE DESIGNER HAS CONDUCTED A VISUAL SURVEY OF THE SITE AND HAS FOUND THAT THE PROPOSED DEVELOPMENT IS COMPATIBLE WITH THE SURROUNDING AREA AND DOES NOT CONFLICT WITH ANY EXISTING OR PROPOSED UTILITIES OR STRUCTURES.

6. THE DESIGNER HAS CONDUCTED A VISUAL SURVEY OF THE SITE AND HAS FOUND THAT THE PROPOSED DEVELOPMENT IS COMPATIBLE WITH THE SURROUNDING AREA AND DOES NOT CONFLICT WITH ANY EXISTING OR PROPOSED UTILITIES OR STRUCTURES.

7. THE DESIGNER HAS CONDUCTED A VISUAL SURVEY OF THE SITE AND HAS FOUND THAT THE PROPOSED DEVELOPMENT IS COMPATIBLE WITH THE SURROUNDING AREA AND DOES NOT CONFLICT WITH ANY EXISTING OR PROPOSED UTILITIES OR STRUCTURES.

JUNE 11, 2004

NO.	DATE	DESCRIPTION
1	06/11/04	PRELIMINARY
2	06/11/04	FINAL

FOREST HILL BOULEVARD **IRRIGATION DEVELOPMENT PLAN**

Irrigation Plans Prepared by:
CONTROL
 PRECIPITATION
 DESIGN INC.
 1000 W. PALM BEACH BLVD.
 BOCA RATON, FL 33432
 (561) 992-2222

NORTH
 40'
 Scale: 1" = 40'

MATCHLINE
 SEE SHEET IR-26

all landscaping and above ground structures shown herein are designed and are to be maintained in accordance with the palm beach county streetscape standard manual with regards to safe sight distance and roadside clear zones

MATCHLINE
SEE SHEET IR-25

MATCHLINE
SEE SHEET IR-27

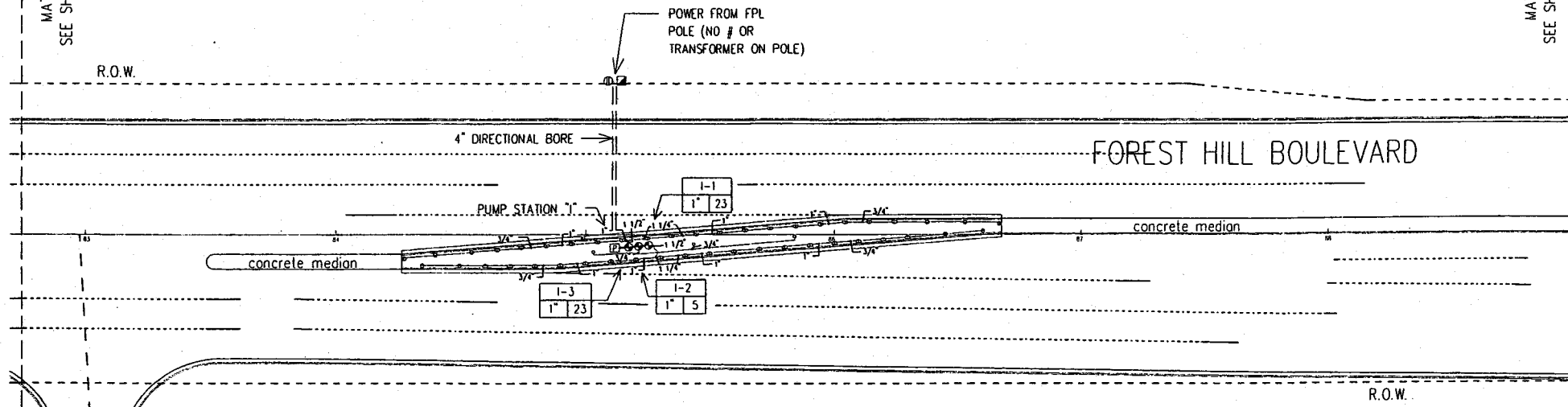

NOTES:

1. THE IRRIGATION SYSTEM HEAD LAYOUT IS DESIGNED AND SHALL BE INSTALLED AND MAINTAINED TO MINIMIZE OVERSPRAY ONTO ROADWAYS AFTER THE SYSTEM IS FLUSHED AND MOZZLED. THE JNCS SHALL BE SET TO MINIMIZE OVERSPRAY AND THE FLOW CONTROL/PRESSURE REGULATOR ON THE ZONE CONTROL VALVE SHALL BE ADJUSTED DOWN TO PREVENT ANY HISING OR FOOSING. TO PRODUCE BURSTETS OF WATER TO MINIMIZE THE EFFECT OF THE WIND THEREBY LIMITING OVERSPRAY AND WATER WASTE. CONTROLLER PROGRAMMING SHALL BE SET SO AS NOT TO ALLOW THE IRRIGATION TO CREATE ANY RUN OFF WHICH COULD CREATE WADE ON THE ROAD.
2. THE DESIGNER CANNOT BE HELD RESPONSIBLE FOR ANY WAFFER, ACT, OR EFFECT ARISING FROM OVERSPRAY, BROKEN PIPES, HEADS OR NOZZLES IN THE EVENT OF A BREAK OR BROKEN OFF HEAD OR NOZZLE. THE COMPONENT SHALL BE REPAIRED/REPLACED/ACCEPTED, OR ZONE NUMBER OFF FROM AUTOMATIC OPERATION AS SOON AS POSSIBLE.
3. THE DESIGNER DOES NOT WARRANT THAT ALL EXISTING UNDERGROUND UTILITIES ARE SHOWN OR, IF SHOWN, ARE PROPERLY LOCATED ON THE PLANS, AND ARE EITHER IN SERVICE OR ABANDONED. THE CONTRACTOR SHALL CALL "TAMPAH STATE ONE CALL" AT (800) 432-4770 TO VERIFY UTILITY LOCATIONS AT LEAST 48 HOURS PRIOR TO DIGGING. THE CONTRACTOR SHALL BE RESPONSIBLE TO CONTACT/LOCATE OTHER UTILITIES NOT SUBSCRIBING TO "TAMPAH STATE ONE CALL". ALSO CALL (561) 644-3428, PALM BEACH COUNTY UTILITIES OR APPLICABLE LOCAL UTILITY AGENCY TO VERIFY LOCATIONS AND DEPTHS OF UNDERGROUND UTILITIES.
4. THE CONTRACTOR SHALL BE RESPONSIBLE FOR COORDINATING WITH ALL UTILITY COMPANIES AND RELEVANT GOVERNMENT DEPARTMENTS AND ENSURING ALL UTILITIES LOCATED ABOVE, ON, OR BELOW THE SURFACE OF THE SITE ARE PROPERLY DISCOVERED, IDENTIFIED, MARKED, AND FIELD LABELED, AND ENSURING THOSE SAME UTILITIES ARE AT ALL TIMES SAFELY CONTROLLED AND PROTECTED BY REASONABLE MEANS FROM DAMAGE.
5. THESE PLANS HAVE BEEN PREPARED IN ACCORDANCE WITH AND ARE GOVERNED BY THE PALM BEACH COUNTY STREETSCAPE STANDARDS MANUAL DATED AUGUST 1998, AND SUPPLEMENTS. ALL ABOVE GROUND STRUCTURES SHOWN HEREIN ARE TO BE DESIGNED, INSTALLED AND MAINTAINED IN ACCORDANCE WITH THESE STANDARDS. THE CONTRACTOR SHALL REFER TO THESE STANDARDS FOR COMPLETE REQUIREMENTS.
6. CONTRACTOR SHALL ADHERE TO MINIMUM 4' CLEAR ZONE, MEASURED FROM CLOSEST (OUTSIDE EDGE OF CURB), SUCH THAT ALL ABOVE GRADE EQUIPMENT INSTALLATIONS WILL BE OUTSIDE OF CLEAR ZONE.
7. LOCATE SPRINKLER HEADS 12" FROM BACK OF CURB. LOCATE IRRIGATION VALVE BOXES 4' MINIMUM 16" FROM BACK OF CURB.

SPRINKLER KEY LEGEND

SYM.	TYPE	MODEL #	DESIGN PS.	DESIGN FLOW (GPM)
	TORO 4" POP UP SPRAY	(5702-6P-PRO-4 - NOZZLE BELOW		
●	"	" -15H	30	1.65
●	"	" -15T	"	1.10
●	"	" -12M	"	1.09
●	"	" -170	"	50
●	"	" -10H	"	71
●	"	" -87SH	"	1.48
●	"	" -87SO	"	74
●	"	" -42ST	"	45
●	"	" -42SI	"	90
●	"	" -42SI	"	90
○	SPRINKLER FLOOD BUBBLER	(533)	30	1.50

NOTE: USE SCREENS IN ALL HEADS. CONTRACTOR TO VERIFY AND IS RESPONSIBLE FOR COMPLETE COVERAGE.

Irrigation Plans Prepared By:
CONTROL PRECIPITATION DESIGN INC. IRRIGATION CONSULTANTS
P.O. BOX 2248
ROCK HAVEN, FL 32472
(904) 991-2294



JUNE 11, 2004

DATE	BY	DESCRIPTION	DATE	BY	DESCRIPTION

FOREST HILL BOULEVARD IRRIGATION DEVELOPMENT PLAN

at intersections and along grade structures shown herein are designed and set to be maintained in accordance with the joint bench control standards manual with regards to side sight distance and roadside clear zones.

MATCHLINE
SEE SHEET IR-27

R.O.W.

concrete median

muskogee road

concrete median

FOREST HILL BOULEVARD

MATCHLINE
SEE SHEET IR-29

R.O.W.

SPRINKLER KEY LEGEND

SYM.	TYPE	MODEL #	QTY	QTY FOR SERVICE CHG
●	100' 6" pop up spray	PRO-SPRINK-6 - MODEL 8000	36	36
○	100' 6" pop up spray	PRO-SPRINK-6 - MODEL 8000	153	153
○	100' 6" pop up spray	PRO-SPRINK-6 - MODEL 8000	108	108
○	100' 6" pop up spray	PRO-SPRINK-6 - MODEL 8000	37	37
○	100' 6" pop up spray	PRO-SPRINK-6 - MODEL 8000	148	148
○	100' 6" pop up spray	PRO-SPRINK-6 - MODEL 8000	24	24
○	100' 6" pop up spray	PRO-SPRINK-6 - MODEL 8000	43	43
○	100' 6" pop up spray	PRO-SPRINK-6 - MODEL 8000	30	30
○	100' 6" pop up spray	PRO-SPRINK-6 - MODEL 8000	86	86
○	100' 6" pop up spray	PRO-SPRINK-6 - MODEL 8000	130	130

NOTE: VEE SPRINKERS IN ALL KEYS RESPONSIBLE FOR SERVICE CHG RESPONSIBLE FOR COMPLETE CONFORMANCE

NO IRRIGATION THIS SHEET

FOREST HILL BOULEVARD

IRRIGATION DEVELOPMENT PLAN

JUNE 11, 2004

NO.	DATE	BY	DESCRIPTION
1			
2			
3			
4			
5			
6			
7			
8			
9			
10			

- NOTES:
1. THE IRRIGATION SYSTEM SHALL BE DESIGNED AND SHALL BE INSTALLED AND MAINTAINED TO MEET CURRENT CODE REQUIREMENTS. AFTER THE SYSTEM IS TURNED ON AND TESTED, THE USER SHALL BE SET TO MAINTAIN OPERATIONAL AND THE USER SHALL BE RESPONSIBLE FOR THE SYSTEM. THE USER SHALL BE RESPONSIBLE FOR THE SYSTEM. THE USER SHALL BE RESPONSIBLE FOR THE SYSTEM. THE USER SHALL BE RESPONSIBLE FOR THE SYSTEM.
 2. THE USER SHALL BE RESPONSIBLE FOR THE SYSTEM. THE USER SHALL BE RESPONSIBLE FOR THE SYSTEM. THE USER SHALL BE RESPONSIBLE FOR THE SYSTEM. THE USER SHALL BE RESPONSIBLE FOR THE SYSTEM.
 3. THE USER SHALL BE RESPONSIBLE FOR THE SYSTEM. THE USER SHALL BE RESPONSIBLE FOR THE SYSTEM. THE USER SHALL BE RESPONSIBLE FOR THE SYSTEM. THE USER SHALL BE RESPONSIBLE FOR THE SYSTEM.
 4. THE USER SHALL BE RESPONSIBLE FOR THE SYSTEM. THE USER SHALL BE RESPONSIBLE FOR THE SYSTEM. THE USER SHALL BE RESPONSIBLE FOR THE SYSTEM. THE USER SHALL BE RESPONSIBLE FOR THE SYSTEM.
 5. THE USER SHALL BE RESPONSIBLE FOR THE SYSTEM. THE USER SHALL BE RESPONSIBLE FOR THE SYSTEM. THE USER SHALL BE RESPONSIBLE FOR THE SYSTEM. THE USER SHALL BE RESPONSIBLE FOR THE SYSTEM.
 6. THE USER SHALL BE RESPONSIBLE FOR THE SYSTEM. THE USER SHALL BE RESPONSIBLE FOR THE SYSTEM. THE USER SHALL BE RESPONSIBLE FOR THE SYSTEM. THE USER SHALL BE RESPONSIBLE FOR THE SYSTEM.
 7. THE USER SHALL BE RESPONSIBLE FOR THE SYSTEM. THE USER SHALL BE RESPONSIBLE FOR THE SYSTEM. THE USER SHALL BE RESPONSIBLE FOR THE SYSTEM. THE USER SHALL BE RESPONSIBLE FOR THE SYSTEM.

Irrigation Plan Prepared by:
 DESIGNER:
 PROJECT NO.:
 DATE:

NORTH
 40'
 Scale: 1" = 40'

NOTE:
 all hand-drawn and above ground structures shown herein are
 intended only to be used as a guide in accordance with the
 provisions of the applicable laws and regulations. The contractor
 shall be responsible for obtaining all necessary permits and
 approvals in state, local and federal laws and regulations.

MATCHLINE
 SEE SHEET IR-28

R.O.W.

prairie road

FOREST HILL BOULEVARD

concrete median

concrete median

concrete median

R.O.W.

MATCHLINE
 SEE SHEET IR-30

SPRINKLER KEY LEGEND

SYMBOL	TYPE	MODEL /	DESIGN	DESIGN
			PSD	(GPM)
●	1000	1" pipe w/ 1" spool	30	185
○	1000	1" pipe w/ 1" spool	150	110
○	1000	1" pipe w/ 1" spool	140	100
○	1000	1" pipe w/ 1" spool	120	90
○	1000	1" pipe w/ 1" spool	100	80
○	1000	1" pipe w/ 1" spool	80	70
○	1000	1" pipe w/ 1" spool	60	60
○	1000	1" pipe w/ 1" spool	40	50
○	1000	1" pipe w/ 1" spool	30	40
○	1000	1" pipe w/ 1" spool	20	30

NOTE: SEE SPECIFICATIONS IN ALL SECTIONS FOR QUANTITIES FOR CONCRETE MEDIAN.
 QUANTITIES FOR RETAINMENT WALLS AND OTHER STRUCTURES TO BE DETERMINED BY THE CONTRACTOR.

- NOTES:**
1. THE PROPOSED SYSTEM HAS BEEN DESIGNED AND SHALL BE INSTALLED AND MAINTAINED TO MAINTAIN PROPER FLOW AND PROTECT THE EXISTING AND PROPOSED STRUCTURES AND UTILITIES. THE CONTRACTOR SHALL OBTAIN ALL NECESSARY PERMITS AND APPROVALS FROM THE APPROPRIATE AGENCIES.
 2. THE CONTRACTOR SHALL BE RESPONSIBLE FOR OBTAINING ALL NECESSARY PERMITS AND APPROVALS FROM THE APPROPRIATE AGENCIES.
 3. THE CONTRACTOR SHALL BE RESPONSIBLE FOR OBTAINING ALL NECESSARY PERMITS AND APPROVALS FROM THE APPROPRIATE AGENCIES.
 4. THE CONTRACTOR SHALL BE RESPONSIBLE FOR OBTAINING ALL NECESSARY PERMITS AND APPROVALS FROM THE APPROPRIATE AGENCIES.
 5. THE CONTRACTOR SHALL BE RESPONSIBLE FOR OBTAINING ALL NECESSARY PERMITS AND APPROVALS FROM THE APPROPRIATE AGENCIES.
 6. THE CONTRACTOR SHALL BE RESPONSIBLE FOR OBTAINING ALL NECESSARY PERMITS AND APPROVALS FROM THE APPROPRIATE AGENCIES.
 7. THE CONTRACTOR SHALL BE RESPONSIBLE FOR OBTAINING ALL NECESSARY PERMITS AND APPROVALS FROM THE APPROPRIATE AGENCIES.



FOREST HILL BOULEVARD IRRIGATION DEVELOPMENT PLAN

PAUL BEACH COUNTY
 ENGINEERING & SURVEYING
 1000 S. PALM BEACH BLVD., SUITE 100
 WEST PALM BEACH, FL 33411
 (561) 833-1111

JUNE 11, 2004

NO.	DATE	DESCRIPTION
1	JUN 11, 2004	ISSUED FOR PERMIT

note:
 all landscaping and above ground structures shown herein are designed and are to be maintained in accordance with the palm beach county streetscape standard manual with regards to safe sight distance and roadside clear zones.

MATCHLINE
 SEE SHEET IR-29

MATCHLINE
 SEE SHEET IR-31

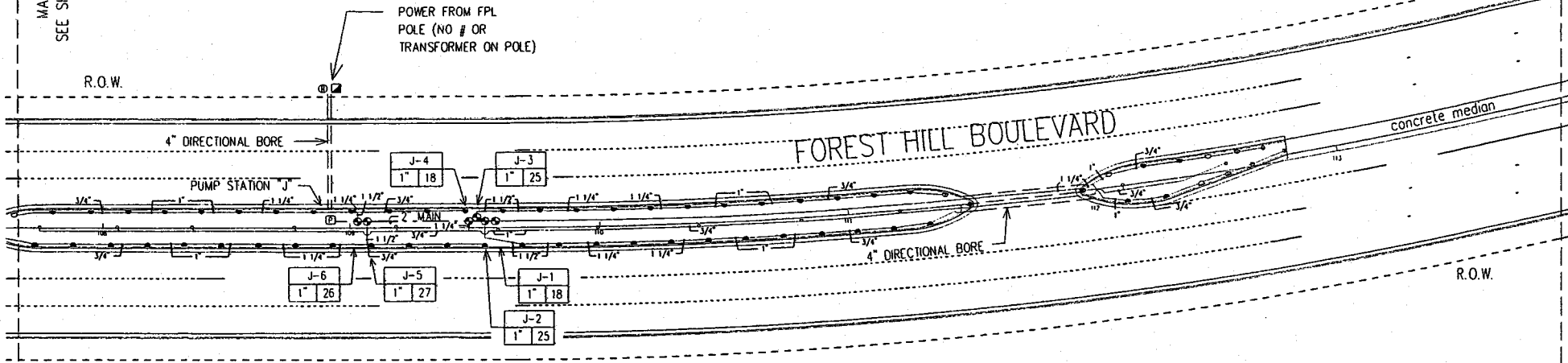

SPRINKLER KEY LEGEND

SYM.	TYPE	MODEL #	DESIGN PSI	DESIGN FLOW (GPM)
●	TURD 8" POP UP SPRAY	5702-0P-101-E - NOZZLE BELOW	30	1.65
○		-15N	-	1.50
○		-17N	-	1.20
○		-17B	-	5.0
○		-10N	-	7.1
○		-875N	-	1.48
○		-875N	-	7.4
○		-4751	-	4.5
○		-4751	-	9.0
○		-4751	-	9.0
○	CONTROL FLOOD BUBBLER	#533	30	1.50

NOTE: USE SCREENS IN ALL HEADS
 CONTRACTOR TO VERIFY AND IS RESPONSIBLE FOR COMPLETE COVERAGE

QUANTITY FOR REFERENCE ONLY
 RESPONSIBLE FOR COMPLETE COVERAGE

- NOTES:**
1. THE IRRIGATION SYSTEM HEAD LAYOUT IS DESIGNED AND SHALL BE INSTALLED AND MAINTAINED TO MINIMIZE OVERSPRAY ONTO ROADWAYS. AFTER THE SYSTEM IS FLUSHED AND MOTTLED, THE MICS SHALL BE SET TO MINIMIZE OVERSPRAY AND THE FLOW CONTROL/PRESSURE REGULATOR ON THE ZONE CONTROL VALVE SHALL BE ADJUSTED DOWN TO PREVENT ANY HISING OR FEEDING TO PRODUCE DRIPPLES BY WATER TO MINIMIZE THE EFFECT OF THE WHO THEREBY LIMITING OVERSPRAY AND WATER WASTE. CONTROLLER PROGRAMMING SHALL BE SET SO AS NOT TO ALLOW THE IRRIGATION TO CREATE ANY FLOW OFF WHICH COULD CREATE WATER ON THE ROAD.
 2. THE DESIGNER CANNOT BE HELD RESPONSIBLE FOR ANY MATTER, ACT, OR EFFECT ARISING FROM OVERSPRAY, BROKEN PIPES, HEADS OR NOZZLES IN THE EVENT OF A BREAK OR BROKEN OFF HEAD OR NOZZLE, THE COMPONENT SHALL BE REPAIRED/REPLACED/CAPPED, OR ZONE TURNED OFF FROM AUTOMATIC OPERATION AS SOON AS POSSIBLE.
 3. THE DESIGNER DOES NOT WARRANT THAT ALL EXISTING UNDERGROUND UTILITIES ARE SHOWN OR, IF SHOWN, ARE PROPERLY LOCATED ON THE PLANS, AND ARE EITHER IN SERVICE OR ABANDONED. THE CONTRACTOR SHALL CALL "BROWNE STATE ONE CALL" AT (800) 432-4770 TO VERIFY UTILITY LOCATIONS AT LEAST 48 HOURS PRIOR TO DIGGING. THE CONTRACTOR SHALL BE RESPONSIBLE TO CONTACT/LOCATE OTHER UTILITIES NOT SUBSCRIBING TO "BROWNE STATE ONE CALL". ALSO CALL (407) 841-3429, PALM BEACH COUNTY UTILITIES OR APPLICABLE LOCAL UTILITY AGENCY TO VERIFY LOCATIONS AND DEPT'S OF UNDERGROUND UTILITIES.
 4. THE CONTRACTOR SHALL BE RESPONSIBLE FOR COORDINATING WITH ALL UTILITY COMPANIES AND RELEVANT GOVERNMENT DEPARTMENTS AND ENSURING ALL UTILITIES LOCATED ABOVE, ON, OR BELOW THE SURFACE OF THE SITE ARE PROPERLY DISCOVERED, IDENTIFIED, MARKED, AND FIELD LABELED, AND ENSURING THOSE SAME UTILITIES ARE AT ALL TIMES SAFELY CONTROLLED AND PROTECTED BY REASONABLE MEANS FROM DAMAGE.
 5. THESE PLANS HAVE BEEN PREPARED IN ACCORDANCE WITH AND ARE COVERED BY THE PALM BEACH COUNTY STREETScape STANDARDS MANUAL DATED AUGUST, 1999, AND SUPPLEMENTS. ALL ABOVE GROUND STRUCTURES SHOWN HEREIN ARE TO BE DESIGNED, INSTALLED AND MAINTAINED IN ACCORDANCE WITH THESE STANDARDS. THE CONTRACTOR SHALL REFER TO THESE STANDARDS FOR COMPLETE REQUIREMENTS.
 6. CONTRACTOR SHALL ADHERE TO MINIMUM 6' CLEAR ZONE, MEASURED FROM CLOSEST (OUTSIDE EDGE OF CURB), SUCH THAT ALL ABOVE CURB EQUIPMENT INSTALLATIONS WILL BE OFFSIDE OF CLEAR ZONE.
 7. LOCATE SPRINKLER HEADS 12" FROM BACK OF CURB. LOCATE IRRIGATION WALK BONES A MINIMUM 18" FROM BACK OF CURB.

Irrigation Plans Prepared By

CONTROL
 PRECIPITATION
 DESIGN INC.
 IRRIGATION CONSULTANTS
 910 W. US HWY
 BOCA RATON, FL 33421
 (561) 991-1278

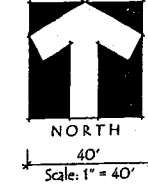

JUNE 17, 2004

DATE	BY	DESCRIPTION	DATE	BY	DESCRIPTION	DATE	BY	DESCRIPTION

Control
 Precipitation
 Design Inc.
 IRRIGATION CONSULTANTS
 910 W. US HWY
 BOCA RATON, FL 33421
 (561) 991-1278

PALM BEACH COUNTY
 ENGINEERING AND PUBLIC WORKS
 STREETScape SECTION
 WEST PALM BEACH, FLORIDA
 (561) 864-4400

FOREST HILL BOULEVARD IRRIGATION DEVELOPMENT PLAN

NOTES:

1. PUMP: CLASS 200 PWC OR RMC W/ METALLIC WABLER LINE 6" ABOVE MAIN LINE
2. MAIN LINE: PWC 1/2" IS NOT USED, 3/4" & GREATER USE SCH 40 PWC
3. STEELS: DIRECTIONAL BORE WITH SCH 80 PWC
4. FITTINGS: MAIN LINE: HANNO DIRECTION BORE, ZONE LINE: SCH 40 PWC
5. FABRICATION: SQUARE OR, OLEUM ALL JOINTS USE OLEUM OR ALL LATERALS USE GREY PWC CEMENT FULTY BRIDGE ALL JOINTS
6. ALL FABRICATION SHALL BE TO MANUFACTURER'S SPECIFICATIONS
7. ALL PIPING SHALL BE TO CODES TO OBTAIN TO LISTED ASIN SPECS.
8. DEPTH OF LINES: MAIN LINE AND WABER = 24" DEEP, MAIN LINE: 18" DEEP, ZONE LINE: 12" DEEP
9. MAIN LINE AND WABER: 24" DEEP, MAIN LINE: 18" DEEP, ZONE LINE: 12" DEEP
10. MAIN LINE AND WABER: 24" DEEP, MAIN LINE: 18" DEEP, ZONE LINE: 12" DEEP
11. MAIN LINE AND WABER: 24" DEEP, MAIN LINE: 18" DEEP, ZONE LINE: 12" DEEP
12. MAIN LINE AND WABER: 24" DEEP, MAIN LINE: 18" DEEP, ZONE LINE: 12" DEEP
13. MAIN LINE AND WABER: 24" DEEP, MAIN LINE: 18" DEEP, ZONE LINE: 12" DEEP
14. MAIN LINE AND WABER: 24" DEEP, MAIN LINE: 18" DEEP, ZONE LINE: 12" DEEP
15. MAIN LINE AND WABER: 24" DEEP, MAIN LINE: 18" DEEP, ZONE LINE: 12" DEEP
16. MAIN LINE AND WABER: 24" DEEP, MAIN LINE: 18" DEEP, ZONE LINE: 12" DEEP
17. MAIN LINE AND WABER: 24" DEEP, MAIN LINE: 18" DEEP, ZONE LINE: 12" DEEP
18. MAIN LINE AND WABER: 24" DEEP, MAIN LINE: 18" DEEP, ZONE LINE: 12" DEEP
19. MAIN LINE AND WABER: 24" DEEP, MAIN LINE: 18" DEEP, ZONE LINE: 12" DEEP
20. MAIN LINE AND WABER: 24" DEEP, MAIN LINE: 18" DEEP, ZONE LINE: 12" DEEP

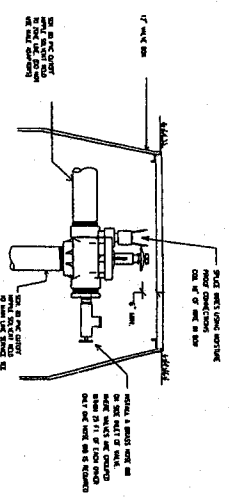
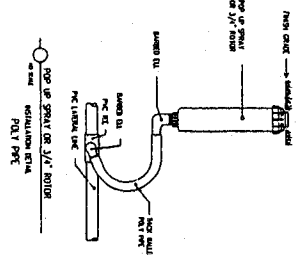
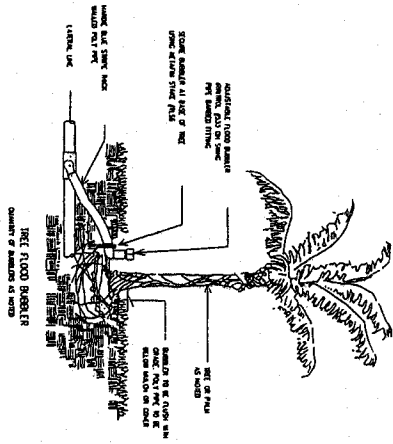

MATERIAL QUANTITY		
ITEM	QUANTITY	UNIT
7" MAIN LINE	1,320	L.F.
2 1/2" MAIN LINE	4,300	L.F.
#14 AWC BRIDGION WRE	15,000	L.F.
#12 AWC BRIDGION WRE	6,500	L.F.
4" DIRECTIONAL BORE	2,800	L.F.
1" ZONE VALVES	45	EA.
1 1/2" ZONE VALVES	16	EA.

SYMBOL	DESCRIPTION	QUANTITY
●	1000' 6" HOSE	10
○	1000' 6" HOSE	15
○	1000' 6" HOSE	18
○	1000' 6" HOSE	19
○	1000' 6" HOSE	20
○	1000' 6" HOSE	21
○	1000' 6" HOSE	22
○	1000' 6" HOSE	23
○	1000' 6" HOSE	24
○	1000' 6" HOSE	25
○	1000' 6" HOSE	26
○	1000' 6" HOSE	27
○	1000' 6" HOSE	28
○	1000' 6" HOSE	29
○	1000' 6" HOSE	30
○	1000' 6" HOSE	31
○	1000' 6" HOSE	32
○	1000' 6" HOSE	33
○	1000' 6" HOSE	34
○	1000' 6" HOSE	35
○	1000' 6" HOSE	36
○	1000' 6" HOSE	37
○	1000' 6" HOSE	38
○	1000' 6" HOSE	39
○	1000' 6" HOSE	40
○	1000' 6" HOSE	41
○	1000' 6" HOSE	42
○	1000' 6" HOSE	43
○	1000' 6" HOSE	44
○	1000' 6" HOSE	45
○	1000' 6" HOSE	46
○	1000' 6" HOSE	47
○	1000' 6" HOSE	48
○	1000' 6" HOSE	49
○	1000' 6" HOSE	50

MATERIAL LEGEND

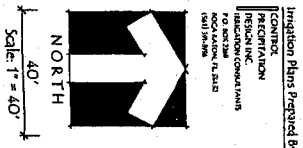
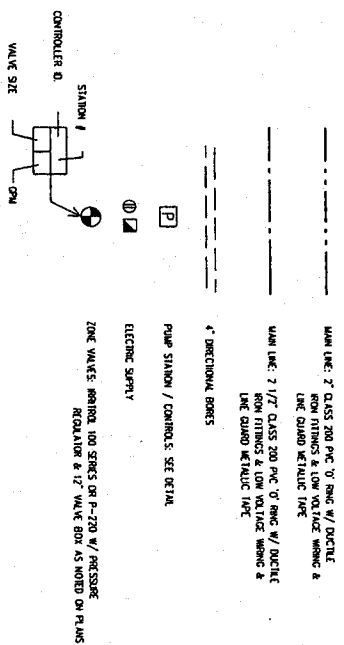

CONTROLLER: TORO SEMI-RAIL SATELLITE WALL MOUNT STAINLESS STEEL ENCLOSURE WITH DOME ANTENNA. NUMBER OF STATIONS PER TABULATION. PHONE CONNECTION TO BE PROVIDED ONLY IN CONTROLLER SPECIFIED ON PLANS.

DISCONNECT AND CONTROLLER ON HOT DIPPED GALV. STEEL UNISTRUT

ELECTRIC METER AT F.P.L. POLE. HAND HOLE. LOCATION AS NOTED ON PLANS. MOUNT ON CONCRETE POLE OR HOT DIPPED GALV UNISTRUT TO CODE.

MUNTER RAINCHECK RAINSWITCH ON PVC POLE X MIN. 8' HIGH

PUMP STATION: MANUFACTURED SKID MOUNTED WITH HINGED DULL ALUMINUM COVER. MOTOR CONTROL PANEL, LOSS OF PRIME, SURGE PROTECTION, CENTRIFUGAL PUMP AND ALL STEEL MANIFOLDING SECURED TO SKID. SYSTEM TO BE CLOCK START. REFER TO PUMP TABULATION FOR PUMP SIZE. ENCLOSURE TO BE 36"W X 24"L X 18"H MAX.

A 1 1/2" PRESSURE CONTROL VALVE AS MANUFACTURED BY CLA-VALVE OR EQUAL SHALL BE INSTALLED ON SHP OR LARGER PUMPS.

STATION SHALL BE AS MANUFACTURED BY SULLIVAN ELECTRIC, LAKE WORTH, FL.

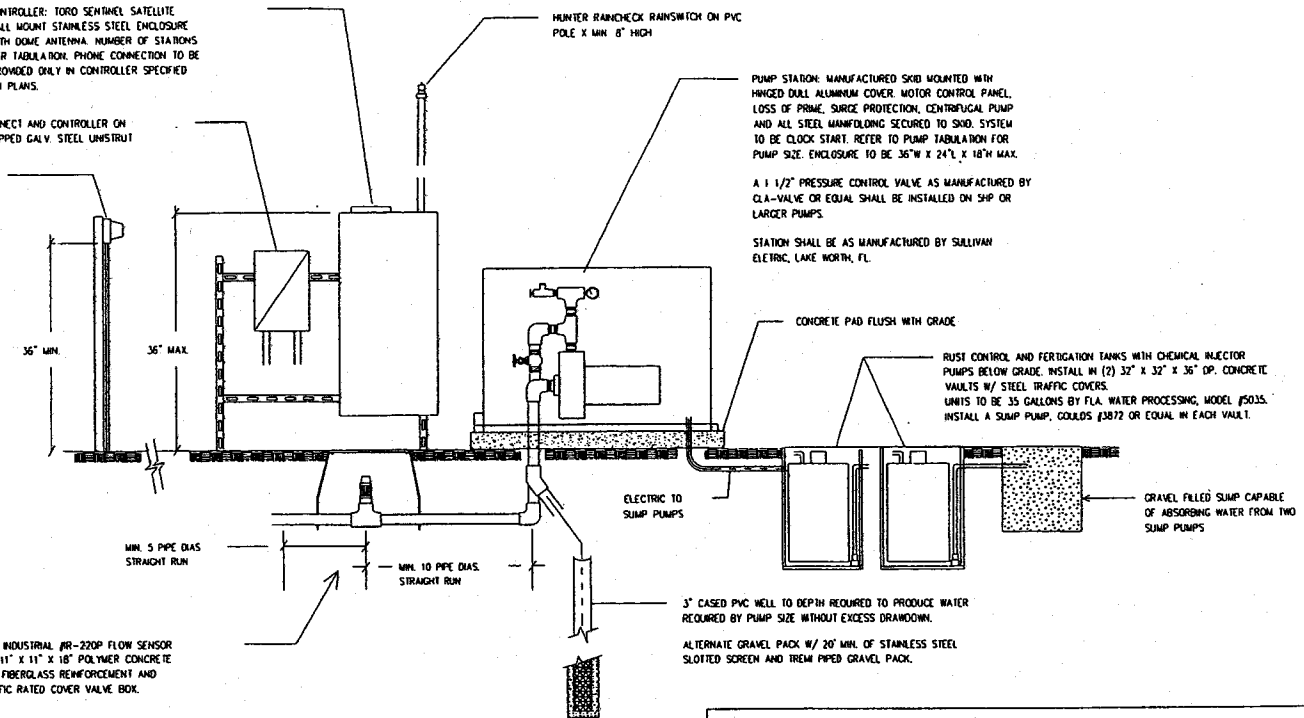

DATA INDUSTRIAL IR-220P FLOW SENSOR IN A 11" X 11" X 18" POLYMER CONCRETE WITH FIBERGLASS REINFORCEMENT AND TRAFFIC RATED COVER VALVE BOX.

NOTES:
 VERIFY ELECTRIC SUPPLY, VOLTAGE AND PHASE
 LAYOUT ALL EQUIPMENT IN CENTER OF MEDIAN AND ORIENTATE PUMP STATION AND RACK SO LONG SIDES RUN PARALLEL WITH MEDIAN SO AS NOT TO INTERFERE WITH TRAFFIC SIGHT LINES.
 LOCATE ALL UNDERGROUND AS FEASIBLE FOR EASE OF SERVICE.
 STAKE OUT ALL LOCATIONS BEFORE INSTALLATION FOR P.B.C. ENGINEERING APPROVAL TO CODE.

CONCRETE PAD FLUSH WITH GRADE

RUST CONTROL AND FERTIGATION TANKS WITH CHEMICAL INJECTOR PUMPS BELOW GRADE. INSTALL IN (2) 32" X 32" X 36" DP. CONCRETE VAULTS W/ STEEL TRAFFIC COVERS. UNITS TO BE 35 GALLONS BY FLA. WATER PROCESSING, MODEL #5035. INSTALL A SUMP PUMP, COULDS #3872 OR EQUAL IN EACH VAULT.

GRAVEL FILLED SUMP CAPABLE OF ABSORBING WATER FROM TWO SUMP PUMPS

3" Cased PVC WELL TO DEPTH REQUIRED TO PRODUCE WATER REQUIRED BY PUMP SIZE WITHOUT EXCESS DRAWDOWN.

ALTERNATE GRAVEL PACK W/ 20' MIN. OF STAINLESS STEEL SLOTTED SCREEN AND TREM PIPED GRAVEL PACK.

SYSTEM	PUMP		BASE WELL DEPTH **	WELL TYPE	CONTROLLER	PHONE CONNECTION
	SIZE	PERFORMANCE				
A	2 H.P.	110 TDH @ 40 GPM	100'	OPEN END	12 STATION	*
B	2 H.P.	110 TDH @ 40 GPM	100'	OPEN END	12 STATION	*
C	2 H.P.	110 TDH @ 40 GPM	100'	OPEN END	12 STATION	*
D	2 H.P.	110 TDH @ 40 GPM	100'	OPEN END	12 STATION	*
E	3 H.P.	115 TDH @ 50 GPM	100'	OPEN END	12 STATION	*
F	3 H.P.	115 TDH @ 50 GPM	100'	OPEN END	12 STATION	*
G	2 H.P.	110 TDH @ 40 GPM	100'	OPEN END	12 STATION	*
H	2 H.P.	110 TDH @ 40 GPM	100'	OPEN END	12 STATION	*
I	2 H.P.	110 TDH @ 40 GPM	100'	OPEN END	12 STATION	*
J	2 H.P.	110 TDH @ 40 GPM	100'	OPEN END	12 STATION	*

* PHONE CONNECTION LOCATION TO BE DETERMINED BY PALM BEACH COUNTY
 ** DEPTH TO BE DETERMINED BY CONTRACTOR TO PRODUCE REQUIRED WATER

Irrigation Plans Prepared By
 CONTROL PRECIPITATION DESIGN INC.
 IRRIGATION CONSULTANTS
 P.O. BOX 2308
 BOCA RATON, FL 33427
 (561) 994-3376

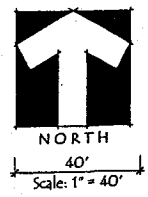

JUNE 11, 2024

DATE	BY	DESCRIPTION	DATE	BY	DESCRIPTION



FOREST HILL BOULEVARD

IRRIGATION DETAILS

**BOARD OF COUNTY COMMISSIONERS
PALM BEACH COUNTY
BUDGET Amendment**

FUND Transportation Improvement

BGRV
BGEX

ACCOUNT NUMBER	ACCOUNT NAME	ORIGINAL BUDGET	CURRENT BUDGET	INCREASE	DECREASE	ADJUSTED BUDGET	EXPENDED/ ENCUMBERED AS OF 10/01/06	REMAINING BALANCE
<u>REVENUES</u>								
<u>FOREST HILL OTIS/SHERWOOD FOREST-FL MANGO</u>								
3500-361-1170-3449	State Grant Other Transportation	<u>0</u>	<u>0</u>	<u>120,000</u>	<u>0</u>	<u>120,000</u>		
TOTAL RECEIPTS & BALANCES		260,611,354	260,611,354	120,000	0	260,731,354		
<u>EXPENDITURES</u>								
<u>FOREST HILL OTIS/SHERWOOD FOREST-FL MANGO</u>								
3500-361-1170-6510	Landscaping/Irrigation-Infra	<u>0</u>	<u>0</u>	<u>120,000</u>	<u>0</u>	<u>120,000</u>	0	120,000
TOTAL APPROPRIATIONS & EXPENDITURES		260,611,354	260,611,354	120,000	0	260,731,354		

Engineering & Public Works

Administration / Budget Approval

OFMB Department – Posted

SIGNATURE

DATE

By Board of County Commissioners
At Meeting of 10/03/06

R.D. Ward

8/21/06

Deputy Clerk to the
Board of County Commissioners

**BOARD OF COUNTY COMMISSIONERS
PALM BEACH COUNTY
BUDGET Transfer**

BGEX

FUND Transportation Improvement

ACCOUNT NUMBER	ACCOUNT NAME	ORIGINAL BUDGET	CURRENT BUDGET	INCREASE	DECREASE	ADJUSTED BUDGET	EXPENDED/ ENCUMBERED AS OF 10/01/06	REMAINING BALANCE
<u>FOREST HILL OTIS/SHERWOOD FOREST-FL MANGO</u>								
3500-361-1170-6510	Landscaping/Irrigation-Infra	0	120,000	375,000	0	495,000	0	495,000
<u>UNINCORPORATED AREA OTIS</u>								
3500-361-1000-6510	Landscaping/Irrigation-Infra	6,151,134	6,151,134	<u>0</u>	<u>375,000</u>	5,776,134		
				375,000	375,000			

SIGNATURE

DATE

By Board of County Commissioners
At Meeting of 10/03/06

Engineering & Public Works

R.D. Ward

8/21/06

Administration / Budget Approval

OFMB Department – Posted

Deputy Clerk to the
Board of County Commissioners