

**Submitted By: Engineering & Public Works**  
**Submitted For: Engineering Services Division**

10/24/06  
Date

## II. FISCAL IMPACT ANALYSIS

### A. Five Year Summary of Fiscal Impact:

Fiscal Years	2007	2008	2009	2010	2011
Capital Expenditures	\$ -0-	-0-	-0-	-0-	-0-
Operating Costs	-0-	-0-	-0-	-0-	-0-
External Revenues	-0-	-0-	-0-	-0-	-0-
Program Income (County)	-0-	-0-	-0-	-0-	-0-
In-Kind Match (County)	-0-	-0-	-0-	-0-	-0-
NET FISCAL IMPACT	\$ -0-	-0-	-0-	-0-	-0-

#ADDITIONAL FTE

POSITIONS (Cumulative) \_\_\_\_\_

Is Item Included in Current Budget? Yes \_\_\_\_\_

No \_\_\_\_\_

Budget Acct No.: Fund \_\_\_\_\_ Dept. \_\_\_\_\_ Unit \_\_\_\_\_ Object \_\_\_\_\_  
Program \_\_\_\_\_

### B. Recommended Sources of Funds/Summary of Fiscal Impact:

This item has no additional fiscal impact.

C. Departmental Fiscal Review: R. E. Ward 10/12/06

## III. REVIEW COMMENTS

### A. OFMB Fiscal and/or Contract Dev. and Control Comments:

[Signature] 10-24-06  
OFMB  
[Signature] 10-24-06  
[Signature] 10-24-06

[Signature] 10/25/06  
Contract Dev. and Control  
[Signature] 10/25/06

### B. Approved as to Form and Legal Sufficiency:

[Signature]  
Assistant County Attorney

### C. Other Department Review:

\_\_\_\_\_  
Department Director

This summary is not to be used as a basis for payment.

**PROJECT LOCATION**  
**SEABREEZE DRIVE – 3<sup>RD</sup> ROAD & 1<sup>ST</sup> ROAD**  
**PROJECT NO. 2006163**

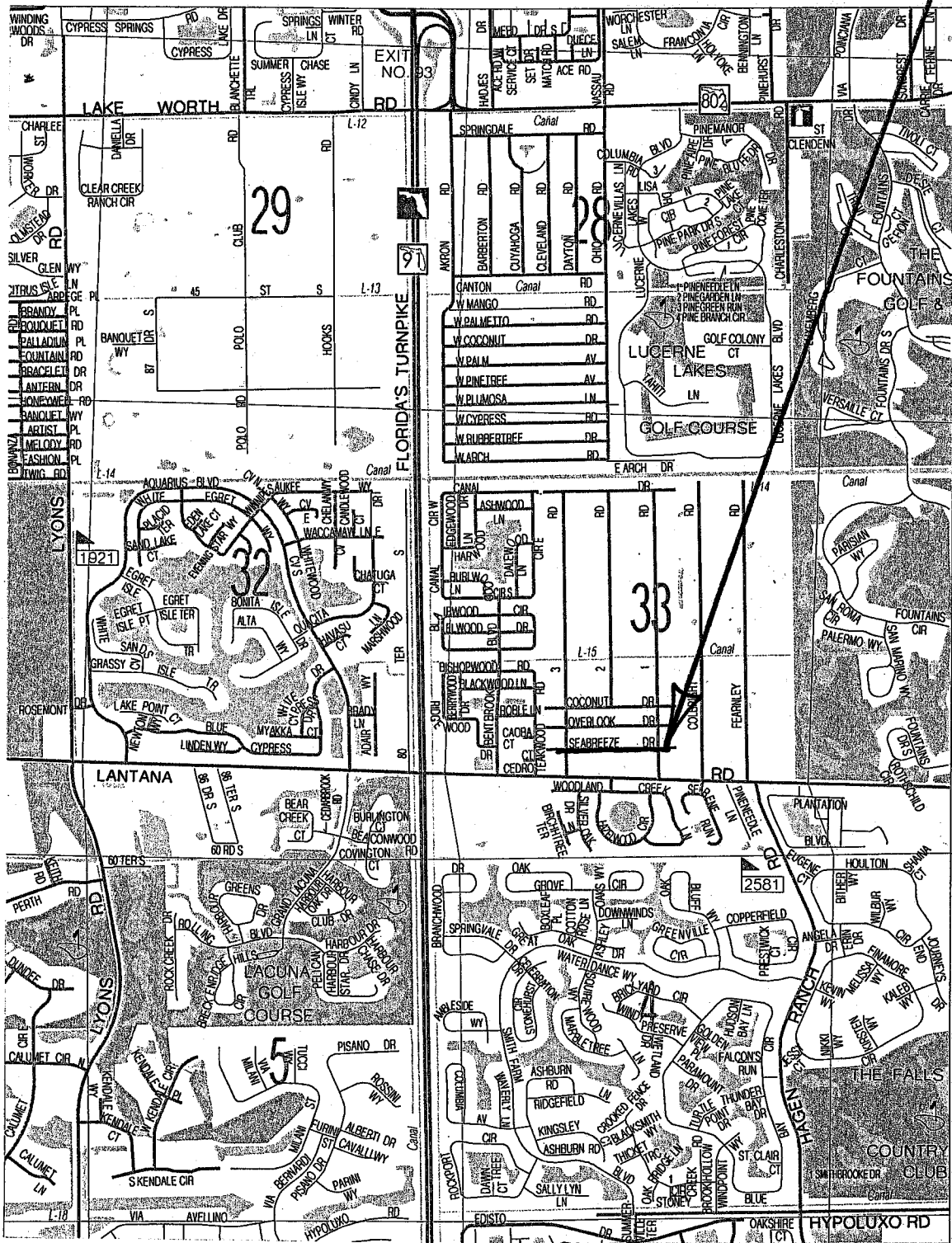

**LOCATION SKETCH**

RESOLUTION NO. \_\_\_\_\_

RESOLUTION OF THE BOARD OF COUNTY COMMISSIONERS OF PALM BEACH COUNTY, FLORIDA, TO APPROVE THE RECORDATION AND FILING OF A SPECIFIC PURPOSE SURVEY FOR SEABREEZE DRIVE IN SECTION 33, TOWNSHIP 44 SOUTH, RANGE 42 EAST, WITH THE CLERK OF THE CIRCUIT COURT OF AND FOR PALM BEACH COUNTY, FLORIDA

WHEREAS, the entire length of Seabreeze Drive from west of 3<sup>rd</sup> Road to east of 1<sup>st</sup> Road, Maintenance Map – Specific Purpose Survey has been submitted to the Board for approval for filing for records; and

WHEREAS, the Road and Bridge Division Director has certified that the County has maintained this area of Seabreeze Drive for four years, as required by Florida Statute 95.361.

NOW, THEREFORE, BE IT RESOLVED BY THE BOARD OF COUNTY COMMISSIONERS OF PALM BEACH COUNTY, FLORIDA, that:

1. The foregoing recitals are hereby reaffirmed and ratified.
2. The Chairman of the Board and the County Engineer are hereby authorized to sign the Specific Purpose Survey (Maintenance Map) and the Clerk is authorized to sign same.

The foregoing Resolution was offered by Commissioner \_\_\_\_\_ who moved its adoption. The motion was seconded by Commissioner \_\_\_\_\_ and upon being put to a vote, the vote was as follows:

Karen T. Marcus	-
Jeff Koons	-
Warren H. Newell	-
Mary McCarthy	-
Burt Aaronson	-
	-
Addie L. Greene	-

RESOLUTION NO. \_\_\_\_\_

The Chairman thereupon declared the Resolution duly passed and adopted  
this \_\_\_\_\_ day of \_\_\_\_\_, 200\_\_\_\_.

APPROVED AS TO FORM AND  
LEGAL SUFFICIENCY:

PALM BEACH COUNTY, FLORIDA  
BY ITS' BOARD OF COUNTY  
COMMISSIONERS:

SHARON R. BOCK, CLERK AND  
COMPTROLLER

\_\_\_\_\_  
County Attorney

By: \_\_\_\_\_  
Deputy Clerk