

PALM BEACH COUNTY  
BOARD OF COUNTY COMMISSIONERS  
AGENDA ITEM SUMMARY

Meeting Date: December 19, 2006

Consent  
 Workshop

Regular  
 Public Hearing

Department: Facilities Development and Operations

I. EXECUTIVE BRIEF

**Motion and Title:** Staff recommends motion to approve: Change Order No. 19 to the Contract with Catalfumo Construction, Ltd. (R2004-1626), to provide Builder's Risk insurance for Operations & Support Center at Vista Center in the amount of \$143,757.60.

**Summary:** This Change Order will provide the required Builder's Risk insurance for the project. At the time of the Guaranteed Maximum Price (GMP) award, PBC Risk Management was in the process of obtaining the Builder's Risk policy for the project, but the effort proved to be too costly. The Construction Manager (CM) was directed to purchase a policy and that policy has been in effect since construction began. This Change Order is for work which has been partially completed prior to Board approval of this Change Order. M/WBE participation for this change order is 0%. When added to the CM's participation to date, the resulting M/WBE is 26.92%. The CM's M/WBE contract goal is 15%. **(Capital Improvements Division) District 2 (JM)**

**Background and Justification:** Catalfumo is the Construction Manager for this project and the Board approved a GMP (R2005-2019) for the vertical improvements for the project on October 18, 2005. It was determined, subsequent to issuance of the GMP, that it would be cost effective to have Builder's Risk insurance provided by the Construction Manager, rather than by the County, which was originally intended.

**Attachments:**

1. Location Map
2. Budget Authorization Statement
3. Change Order No. 19

Recommended by:

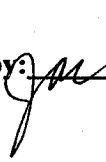

  
Department Director

12/5/06  
Date

Approved by:

  
County Administrator

12/19/06  
Date



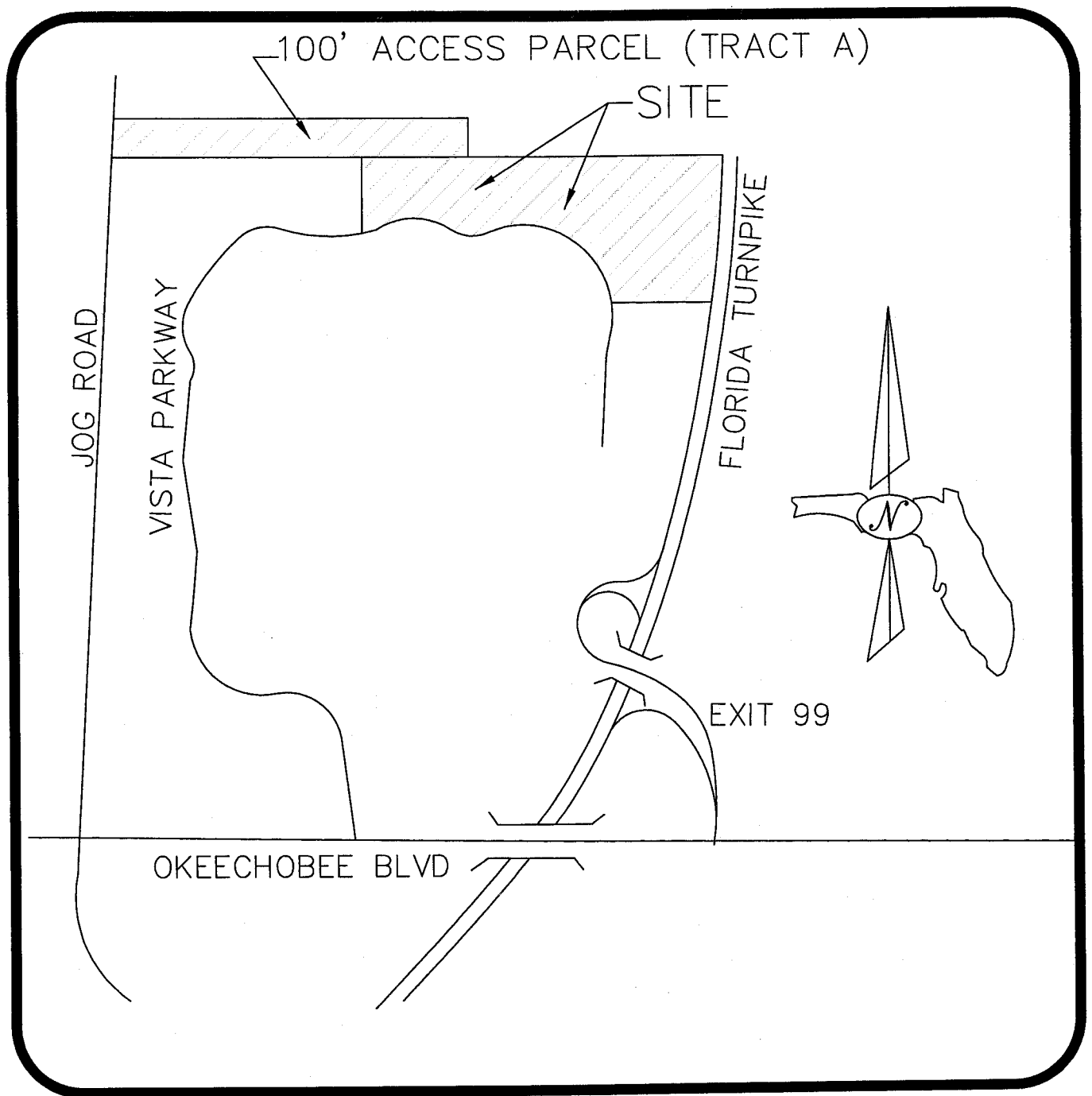

LOCATION MAP

(NOT TO SCALE)

**ATTACHMENT #/**

FACILITIES DEVELOPMENT & OPERATIONS  
BUDGET AVAILABILITY STATEMENT

REQUEST DATE: <sup>11/29/06</sup> 10/23/06

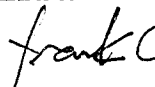
REQUESTED BY:  Frank Coutts

PHONE: 233-0258  
FAX: 233-0270

PROJECT TITLE: Operations & Support Center

PROJECT NO.: 01245

ORIGINAL CONTRACT AMOUNT:

BCC RESOLUTION#: R2004-1626

REQUESTED AMOUNT: \$143,757.60

DATE:

CSA or CHANGE ORDER NUMBER: 19

CONSULTANT/CONTRACTOR: Catalfumo Construction, Ltd.

PROVIDE A BRIEF STATEMENT OF THE SCOPE OF SERVICES TO BE PROVIDED BY THE CONSULTANT/CONTRACTOR:

Provide Builder's Risk Insurance

CONSTRUCTION	\$143,757.60
PROFESSIONAL SERVICES	_____
STAFF COSTS	_____
MISC.	_____
TOTAL	\$143,757.60

\*\* By signing this BAS your department agrees to these staff costs and your account will be charged upon receipt of this BAS by FD&O. Unless there is a change in the scope of work, no additional staff charges will be billed.

BUDGET ACCOUNT NUMBER (IF KNOWN)

FUND: 3018 DEPT: 411 UNIT: B027 OBJ: 6502

FUNDING SOURCE (CHECK ALL THAT APPLY):  
 AD VALOREM  OTHER  
 FEDERAL/DAVIS BACON

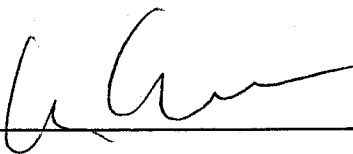
BAS APPROVED BY: 

DATE: 11-30-06

ENCUMBRANCE NUMBER: 091005-1487

RECEIVED  
CAPITAL IMPROVEMENTS DIV.

NOV 30 2006

FILE: #01245-A  
CC: \_\_\_\_\_  
\_\_\_\_\_

Revised 03/30/04

ATTACHMENT # 2

**CHANGE ORDER BRIEF**  
**Operations & Support Center**  
Project No. 01245  
November 27, 2006

---

Prime Contractor ..... Catalfumo Construction Ltd.  
Change Order No. .... 19  
Change Order Amount ..... \$143,757.60  
Changed Contract Time ..... 0 calendar days

Description of CCP:

CCP #037: Provide Builders Risk insurance ..... \$143,757.60

Explanation and Reason-for-Change Code:

CCP #037: (O) It was determined, subsequent to issuance of the GMP, that it would be cost-effective to have Builders Risk insurance provided by the Construction Manager, rather than by the County, which was originally intended.

Reason-for-change codes

D = Differing Site Conditions	R = Request by another Agency/Outside Party
E = Errors/Omissions in Design	X = Other (Specify: Direct Owner Purchase)
O = Owner-Initiated	Z = Zoning/Code/Ordinance Change
Q = Quantity Adjustments	

Estimated premium value of errors/omissions for this change order: \$0.

SUBMITTED:

---

Frank Coutts, Project Manager	Date
Capital Improvements Division	

**CHANGE ORDER HISTORY  
OPERATIONS & SUPPORT CENTER  
PROJECT NO. 01245**

CO #	DESCRIPTION	DATE APPROVED	SALES TAX RECOVERY	AMOUNT APPROVED BY DIR	AMOUNT APPROVED BY CRC	AMOUNT APPROVED BY BCC	DAYS APPROVED BY DIR	DAYS APPROVED BY CRC	DAYS APPROVED BY BCC	CODE
1	Deduct for PBC #01245 - 001/002/003 sales tax recovery PO, CCP 8-9-10	6/13/05	(\$498,449.90)							
2	Deduct for PBC #01245 - 7,8,9,10,12,13,14,15 sales tax recovery PO, CCP 19-20	11/04/05	(\$1,565,428.00)							
3	Deduct for PBC #01245 - 001/002/003 sales tax recovery PO, CCP 28-35	2/21/06	(\$706,696.67)							
4	CCP # 36,40,41,42,43,44, 45,46,49,51 & 52	3/01/06	(\$1,408,649.87)							
5	CCP # 50,53-55	3/10/06	(\$512,774.34)							
6	CCP # 61-63, 67-69, 71-77	4/04/06	(\$669,794.47)							
7	CCP #78, 80, 81, 82	4/13/06	(\$514,171.44)							
8	CCP #84,85,86,87,88,89 & 90	5/16/06	(\$306,385.69)							
9	CCP #92,93 & 94	6/21/06	(\$77,253.06)							

**CHANGE ORDER HISTORY  
OPERATIONS & SUPPORT CENTER  
PROJECT NO. 01245**

CO #	DESCRIPTION	DATE APPROVED	SALES TAX RECOVERY	AMOUNT APPROVED BY DIR	AMOUNT APPROVED BY CRC	AMOUNT APPROVED BY BCC	DAYS APPROVED BY DIR	DAYS APPROVED BY CRC	DAYS APPROVED BY BCC	CODE
10	CCP#39,78,96,97,107,110,111,112, 113 & 114	6/21/06	(\$664,358.67)							
11	CCP #115,116,117,118,120 & 126	6/22/06	(\$57,488.22)							
12	CCP # 109	8/01/06	\$58,088.00							
13	CCP #119,120,121,122, 123 & 128	8/10/06	(\$970,879.17)							
14	CCP #048,058,070 & 101	8/17/06		\$41,055.26						
15	CCP #134,132,133 & 135	8/17/06	(\$469,974.77)							
16	CCP #148, 152, 154, 155, 157, 159, 160, 161 & 162	9/21/06	(\$503,892.04)							
17	CCP #183,184,185 & 187	Pending	(\$141,849.89)							
18	CCP #100 & 151	Pending		\$49,490.25						
19	CCP #037	Pending				\$143,757.60				
				<b>TOTAL APPROVED TO DATE</b>	<b>TOTAL \$ BY DIR</b>	<b>TOTAL \$ BY CRC</b>	<b>TOTAL \$ BY BCC</b>	<b>TOTAL DAYS BY DIR</b>	<b>TOTAL DAYS BY CRC</b>	<b>TOTAL DAYS BY BCC</b>
				(\$9,009,958.20)	\$90,545.51	\$0.00	\$143,757.60	0	0	0
					<b>DIR + CRC DOLLARS TO DATE</b>			<b>DIR+ CRC TOTAL DAYS TO DATE</b>		
					\$90,545.51			0		

**PALM BEACH COUNTY  
CHANGE ORDER**

ISSUED TO: Catalfumo Construction, Ltd.  
4300 Catalfumo Way  
Palm Beach Gardens, FL. 33410  
PROJECT: Operations & Support Center

CHANGE ORDER NO.: 19  
REFERENCE CCP NO.: 037  
RESOLUTION NO.: R2004-1626

PROJECT NO. 01245

DISTRICT NO.: 2

The completion date, contract price, and all terms, covenants, and conditions of the above referenced contract, except as duly modified by this and previous Change Orders, if any, shall remain in full force and effect.

DESCRIPTION OF CHANGE:

CCP #037: Provide Builders Risk Insurance, in accordance with CCP #037 ..... \$143,757.60

Original Contract	\$ 2,500,000.00	Contract Completion Date will be (increased) (decreased) by <u>0</u> calendar days
Amendment #1:	\$ 2,676,803.00	
Amendment #2:	\$ 8,236,456.00	Contract Notice To Proceed Date: <u>Mar 01, 2005</u>
Amendment #3:	\$28,870,353.00	
Previous Change Orders	\$ 90,545.51	Contract Substantial Completion Date: <u>Dec 08, 2006</u> ADJUSTED Substantial Completion Date: <u>NA</u>
Previous Sales Tax COs	(\$ 9,009,958.20)	
This Change Order	\$ 143,757.60	
ADJUSTED Contract Price:	\$33,507,956.91	

<p><b>CONSTRUCTION MANAGER</b> Execution of this change order acknowledges final settlement of, and releases, all claims for costs and time associated, directly or indirectly, with the above stated modification(s), including all claims for cumulative delays or disruptions resulting from, caused by, or incident to such modification(s), and including any claim that the above stated modification(s) constitutes, in whole or part, a cardinal change to the contract. The above changes are accepted:</p> <p>Catalfumo Construction Construction Manager</p> <p>By: <u>Edward E. Mangano Jr.</u> Title: <u>Sr VP</u> Date: <u>11/29/06</u></p>	<p><b>DESIGN PROFESSIONAL</b> The above changes are recommended for approval by the Owner:</p> <p>BRPH Architects/Engineers, Inc. Design Professional</p> <p>By: <u>[Signature]</u> Title: <u>Vice President</u> Date: <u>11/29/06</u></p>	<p><b>PALM BEACH COUNTY</b> Recommended By:</p> <p>By: <u>Frank Conty</u> Title: <u>Project Manager</u> Date: <u>11/29/06</u></p> <p>By: <u>John Chesher</u> Title: <u>Director - CID</u> Date: <u>11/29/06</u></p> <p>By: <u>Anthony Wolf</u> Title: <u>Director - FD&amp;O</u> Date: <u>11/30/06</u></p> <p>By: _____ Legal Sufficiency - CAO Date: _____</p> <p>Approved By:</p> <p>By: _____ Addie L. Greene Title: <u>Chairperson, BCC</u> Date: _____</p>
---	--	---

**PALM BEACH COUNTY**

**CONSTRUCTION CHANGE PROPOSAL (CCP)**

<b>TO:</b>	Palm Beach County Capital Improvements Division	<b>CCP NUMBER:</b>	037
<b>ATTENTION:</b>	Frank Coutts, Project Manager	<b>DATE:</b>	8/16/2006
<b>REFERENCE:</b>	Builders Risk Insurance	<b>PROJECT NAME:</b>	PBC Operations & Support Center
		<b>PBC PROJECT NUMBER:</b>	01245
		<b>CONTRACT NUMBER:</b>	R2004-1626

We propose to accomplish the MODIFICATIONS identified in (N/A) and as described herein. Except as modified below, the original contract and all prior amendments shall remain in full force and effect.

**DESCRIPTION:**

We hereby request a change order to provide Builders Risk Insurance coverage as requested by the county. The coverage to be provided is described in the following policies.

- Hartford Insurance Company Policy Number 21MSTT9988: Policy expiration January 3, 2007.
- Zurich/Assurance Company of America Policy Number EC45006526: Policy expiration February 3, 2007.

The policies have been forwarded directly to the county by the insurer. policies, and for all deductible amounts related to any particular loss. structures in question begin coverage under the County property policies.

App line	Bid Pkg	CSI code	Description	Amount
90	CAT	01-810-O	Builders Risk Insurance	\$ 137,127.00
<b>SECTION SUBTOTAL</b>				<b>\$ 137,127.00</b>

**OVERALL SUBTOTAL \$ 137,127.00**

6	CAT	01-810-O	Liability insurance and bond (0.3%)	\$ 411.38
7	CAT	01-820-O	Payment & Performance Bonds (1.0%)	\$ 1,371.27
<b>SUBTOTAL</b>				<b>\$ 138,909.65</b>

Catalfumo OH&P (3.49%) \$ 4,847.95

**TOTAL \$ 143,757.60**

<b>PROPOSED CONTRACT PRICE CHANGE:</b>	(increases)	<b>TOTAL</b>	<b>\$ 143,757.60</b>
	(decrease)		-
	(unchanged)		-
<b>PROPOSED CONTRACT TIME CHANGE:</b>	(increases)	<u>0</u>	<b>DAYS</b>
	(unchanged)	-	
<b>PROPOSED NEW SUBSTANTIAL COMPLETION:</b>		<u>TBD</u>	<b>DATE</b>

**FROM:** Catalfumo Construction, Ltd.  
Contractor

**DISTRIBUTION:**

**SIGNED:** \_\_\_\_\_  
**DATE:** \_\_\_\_\_

# Collinsworth, Alter, Fowler, Dowling & French Group, Inc.

## Insurance and Bonds

5979 N.W. 151 Street • Suite 105 • P.O. Box 9315 • Miami Lakes, Florida 33014 • Dade (305) 822-7800 • Broward (954) 463-8601  
Mkt Fax (305) 558-4294 • C/L Fax (305) 362-2443

November 17, 2005

Catalfumo Construction Ltd  
4300 Catalfumo Way  
Palm Beach Gardens, FL 33410

Policy Number: 21MSTT9888  
Policy Description: Builder Risk – Palm Beach County BOC  
Insurance Company: Hartford Ins Co of the SE  
Effective/Expiration Dates: 11/03/2005 - 01/03/2007

Dear Mr. Simonson:

We would like to thank you for placing your insurance with our agency. We will make every effort to meet your insurance service expectations.

Enclosed is the above captioned policy.

Please review it carefully to see that it is correct in all details. Should you require any changes please notify our office.

Sincerely,



Lourdes Randolph, EIC  
lrandolph@canfd.com  
Account Manager



# Collinsworth, Alter, Fowler, Dowling & French Group, Inc.

## Insurance and Bonds

5979 N.W. 151 Street • Suite 105 • P.O. Box 9315 • Miami Lakes, Florida 33014 • Dade (305) 822-7800 • Broward (954) 463-8601  
Mkt Fax (305) 558-4294 • C/L Fax (305) 362-2443

November 17, 2005

Catalfumo Construction Ltd  
4300 Catalfumo Way  
Palm Beach Gardens, FL 33410

Policy Number: EC45006526  
Policy Description: Builder Risk – Palm Beach County BOC  
Insurance Company: Assurance Company of America  
Effective/Expiration Dates: 11/03/2005 - 02/03/2007

Dear Mr. Simonson:

We would like to thank you for placing your insurance with our agency. We will make every effort to meet your insurance service expectations.

Enclosed is the above captioned policy.

Please review it carefully to see that it is correct in all details. Should you require any changes please notify our office.

Sincerely,

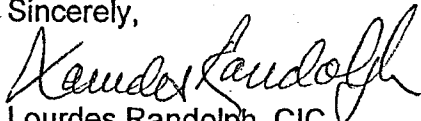

Lourdes Randolph, CIC  
lrandolph@canfd.com  
Account Manager

**BUILDERS RISK AND INSTALLATION COVERAGE  
DECLARATIONS**

Named Insured: PALM BEACH COUNTY, BOARD OF COMMISSIONERS      Policy Number: EC45006526

Producer: GOLLINSWORTH, ALTER, FOWLER, DOWLING  
ZO 19076033 ORLANDO

Policy Period:  
From: 11/3/05      To: 2/3/07

Coverage:                     Builders Risk                     Installation                     Reporting Form

Description of Project(s)  
**ONE-STORY, MASONRY NON-COMBUSTIBLE VEHICLE MAINTENANCE BUILDING**  
Location of Project Site(s)  
**2555-2633 VISTA PARKWAY, WEST PALM BEACH, FL 33411**

Project Completion Date:	2/3/07	
<b>LIMITS OF INSURANCE</b>	<b>COVERAGE</b>	<b>PREMIUM</b>
\$14,518,963.	Coverage Limit at the project site(s)	\$91,615.
\$ 100,000.	Property while in Transits	Incl
\$ 100,000.	Property at Temporary location	Incl
\$14,518,963.	For all covered property	Incl
	<b>COVERAGE EXTENSIONS</b>	
NOT COVERED	Soft Costs	
NOT COVERED	Ordinance or Law - Undamaged Portion - Demolition Cost - Increased Cost of Construction	
NOT COVERED	Business Income and Extra Expense Coverage - During any consecutive 30 day period - Total Limit for Business Income/Extra Expense	
NOT COVERED	Existing Building(s) or Structure(s)	
NOT COVERED	<b>SUBLIMITS OF INSURANCE</b>	
	Earth movement –	
	Water –	
	<b>Total Premium</b>	<b>\$91,615.</b>

**DEDUCTIBLE APPLICABLE TO:**

\$10,000.      All Covered Causes of Loss unless a different deductible is specified below  
 \$              Loss Caused by Windstorm or Hail  
 \$              5%      The Coverage Limit at the Project site(s) for loss caused by Windstorm or Hail  
 \$              Theft  
 \$              Loss caused by Earth Movement  
 \$              %      The Coverage Limit at the project site(s) for loss caused by Earth Movement  
 \$              %      Loss caused by Water  
                  %      The Coverage Limit at the project site(s) for loss caused by Water  
                  Consecutive days      Soft Costs  
                  Consecutive days      Business Income  
 \$45,808.      Minimum Earned Premium

Forms applicable to this coverage part: 40858(1/97), 40660(10/98), 801640(10/98), IL0017(11/98), 47681(9/93), CM0001(6/95), 801650(4/04), U-GU-692-A(8/04), 960039(10/98), CM0101(11/85), CM0116(4/89), IL0175(9/93), IL0255(3/98)

SCHEDULE 1

LIST OF PROPOSED M/WBE SUBCONTRACTORS  
CHANGE ORDER WORK

PROJECT NAME: VISTA OPERATIONS & SUPPORT CENTER

PROJECT NO: R2004-1626

NAME OF GENERAL CONTRACTOR: CATALFUMO CONSTRUCTION, Ltd.

CONTACT PERSON: TERRY LILLING

CCP#'s 037

PHONE NO: 561-296-1008

Builders Risk Insurance

Name, Address and Phone Number of M/WBE	Type of Work To Be Performed	Subcontract Amount			Other (SBE)
		Black	Hispanic	Woman	
Not MWBE					

Total Price: \$0.00      Total Value of M/WBE Participation: \$0.00      M/WBE Participation %: #####