

II. FISCAL IMPACT ANALYSIS

A. Five Year Summary of Fiscal Impact:

Fiscal Years	2006	2007	2008	2009	2010
Capital Expenditures	<u>\$31,068</u>	<u>-0-</u>	<u>-0-</u>	<u>-0-</u>	<u>-0-</u>
Operating Costs	<u>-0-</u>	<u>-0-</u>	<u>-0-</u>	<u>-0-</u>	<u>-0-</u>
External Revenues	<u>-0-</u>	<u>-0-</u>	<u>-0-</u>	<u>-0-</u>	<u>-0-</u>
Program Income (County)	<u>-0-</u>	<u>-0-</u>	<u>-0-</u>	<u>-0-</u>	<u>-0-</u>
In-Kind Match (County)	<u>-0-</u>	<u>-0-</u>	<u>-0-</u>	<u>-0-</u>	<u>-0-</u>
NET FISCAL IMPACT	<u>\$31,068</u>	<u>-0-</u>	<u>-0-</u>	<u>-0-</u>	<u>-0-</u>

ADDITIONAL FTE
POSITIONS (Cumulative) _____

Is Item Included in Current Budget? Yes X No _____
Budget Acct No.: Fund 3503 Dept. 361 Unit 1140 Object 6551
Program

B. Recommended Sources of Funds/Summary of Fiscal Impact:

Road Impact Fee Fund - Zone 3
Seminole Pratt/Sycamore Dr to N of Sycamore

C. Departmental Fiscal Review: *[Signature]*

III. REVIEW COMMENTS

A. OFMB Fiscal and/or Contract Dev. and Control Comments:

[Signature] 4-3-07
OFMB
CN 4/2/1
[Circular Stamp]
[Signature] 4/4/07
Contract Dev. and Control

B. Approved as to Form and Legal Sufficiency:

[Signature] 4/10/07
Assistant County Attorney

C. Other Department Review:

Department Director

This summary is not to be used as a basis for payment.

PROJECT LOCATION

SEMINOLE PRATT WHITNEY ROAD SYCAMORE DRIVE TO NORTH OF SYCAMORE DRIVE PROJECT NO. 1997511C1-A

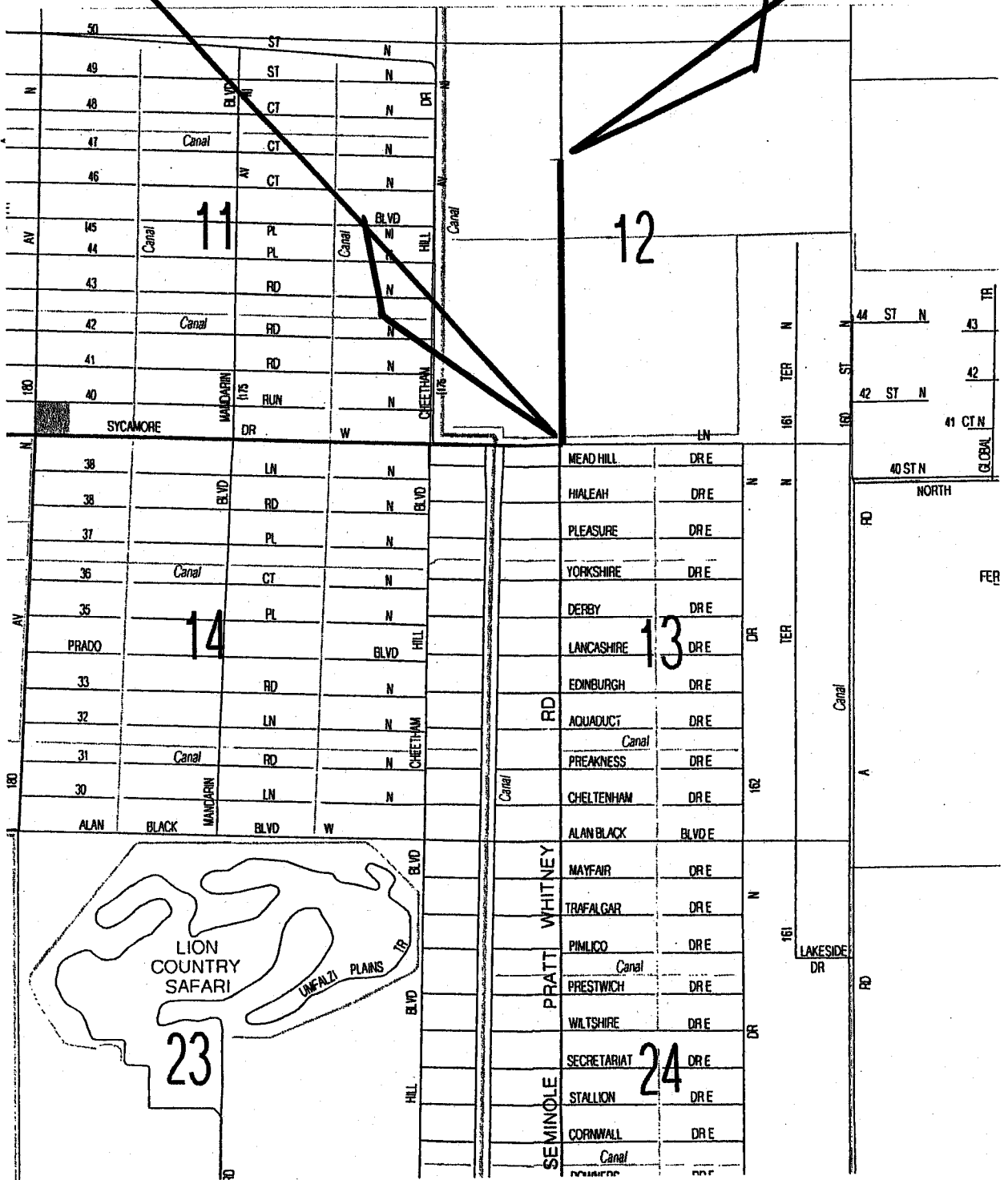

LOCATION SKETCH

RECEIVED JUN 08 2006

100 S. Delaware Blvd. Jupiter, Florida 33458



June 2, 2006

Mr. Carl Hussey, P.E.
Dept. of Engineering & Public Works
Palm Beach County
P.O Box 21229
West Palm Beach, Florida
33416-1229

**RE: Seminole Pratt Whitney Rd @ Seminole Ridge High School
Palm Beach County Project # 1997511C1**

Dear Mr. Hussey,

Enclosed, please find a final invoice in the amount of \$31,067.25. This cost is associated with the relocation of the overhead feeder along Seminole Pratt Whitney Rd. The overhead feeder was in conflict with the construction of the new roadway on the above referenced project. This work was completed in April of 2006.

This final bill is associated with FPL work request #2065762.

Thank you for allowing me to be of service in this matter and please feel free to contact me at (561) 575-6334 if you have any further questions or concerns.

Sincerely,

A handwritten signature in black ink that reads "Joel Linton". The signature is written in a cursive style with a long, sweeping underline.

Joel Linton
Project Manager

**Work Request Charges Quotation
FPL-Power Systems**

To: Sam Rahoni w/PBC
3477-031-0454
4401 SEMINOLE PRATT WHITNEY RD
LOXAHATCHEE, 33470
TRAFFIC SIGNALIZATION

Quote Number: WB20657621
Description: Cost included to relocate overhead feeder, for PBC project #97511C1

Quote Date: 3/16/2006
Preferred Option: Yes
No. Payments:
Project: PBC#97511C
SEMINOLE PRATT - ORANGE TO SYCAMORE

Quotation Details

Description	Refundable?	Unit Cost	Quantity	Total	Due Before Work	Paid
Lump Sum	No	31,067.25	1	31,067.25	N	
Charges Due Before Work Starts:				0.00		
Tax:				0.00		
				Subtotal:		0.00
Charges Due On Completion:				31,067.25		
Tax:				0.00		
				Subtotal:		31,067.25
				Total Charges:		31,067.25
				Total Tax:		0.00
				Total Including Tax:		31,067.25
				Total Refundable:		0.00
				Total Non-Refundable:		31,067.25