

II. FISCAL IMPACT ANALYSIS

A. Five Year Summary of Fiscal Impact:

Fiscal Years	<u>2007</u>	<u>2008</u>	<u>2009</u>	<u>2010</u>	<u>2011</u>
Capital Expenditures	-0-	-0-	-0-	-0-	-0-
Operating Costs	-0-	-0-	-0-	-0-	-0-
External Revenues	-0-	-0-	-0-	-0-	-0-
Program Income (County)	-0-	-0-	-0-	-0-	-0-
In-Kind Match (County)	-0-	-0-	-0-	-0-	-0-
NET FISCAL IMPACT	-0-	-0-	-0-	-0-	-0-
# ADDITIONAL FTE	-0-	-0-	-0-	-0-	-0-
POSITIONS (CUMULATIVE)	-0-	-0-	-0-	-0-	-0-

Is Item Included in Current Budget? Yes No

Budget Account No.:

Fund Agency Organization Object Amount



B. Recommended Sources of Funds/Summary of Fiscal Impact:

This item has no fiscal impact.

C. Departmental Fiscal Review: _____

III. REVIEW COMMENTS

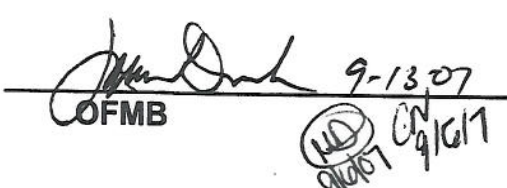
A. OFMB Fiscal and/or Contract Administration Comments:

B. Legal Sufficiency:

 Assistant County Attorney

This item complies with current County policies.

C. Other Department Review:

Department Director

This summary is not to be used as a basis for payment.

PROJECT LOCATION

PROJECT NO. 2002502S
CENTRAL BOULEVARD AND I-95
INTERCHANGE JUSTIFICATION REPORT

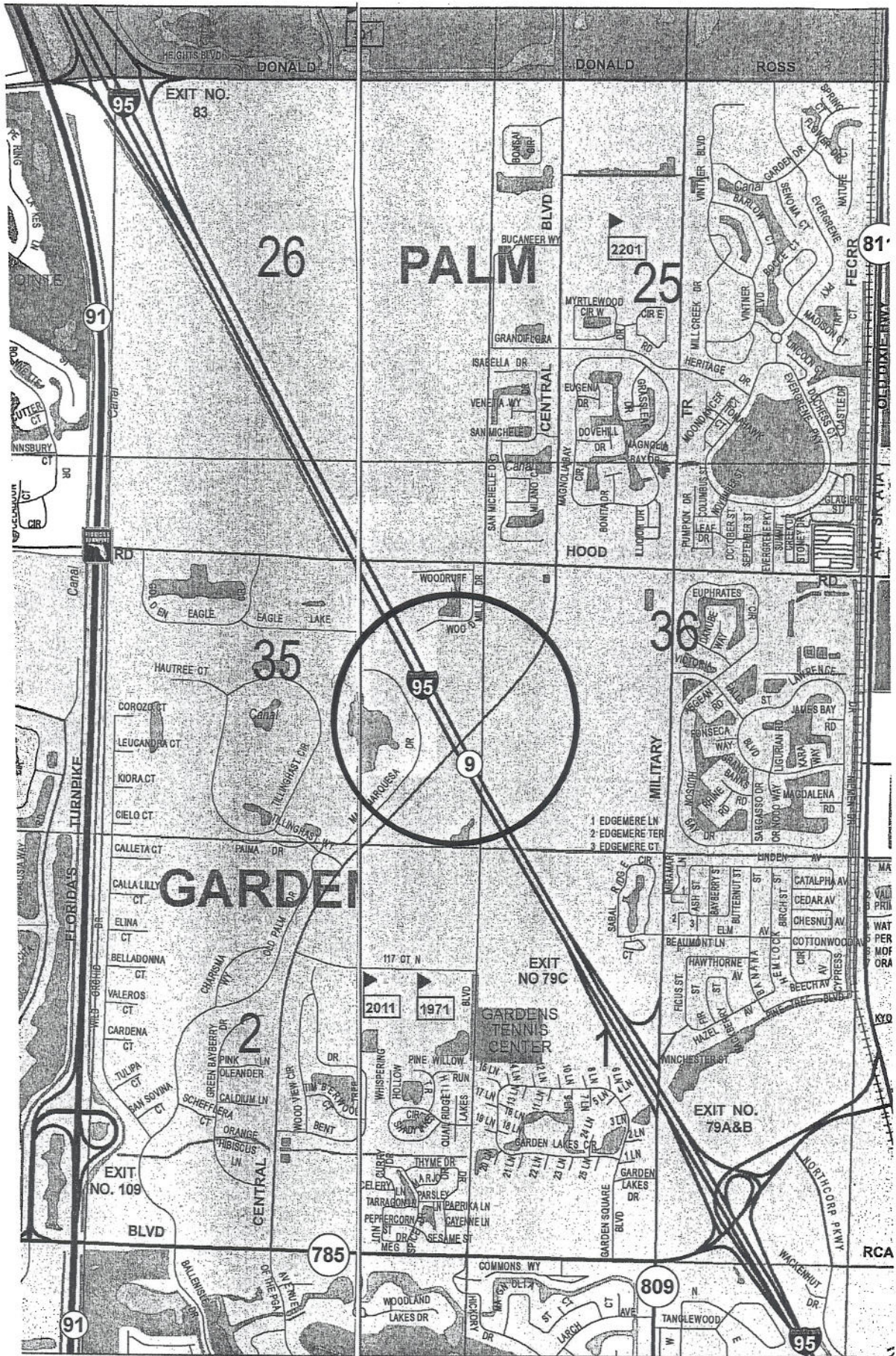

LOCATION SKETCH



375-040-12
PROCUREMENT
OGC - 02/99

Florida Department of Transportation

CHARLIE CRIST
GOVERNOR

PROFESSIONAL AND OTHER CONTRACTUAL SERVICES - DISTRICT IV
3400 W. Commercial Boulevard, Ft. Lauderdale, Florida 33309-3421
Telephone: (954) 777-4603 • Fax (954) 777-4602

STEPHANIE C. KOPELOUSOS
SECRETARY

8/31/2007

Mr. Dan Weisberg, P.E.
Palm Beach County
Dept of Engineering & Public Works
2300 West Jog Road
West Palm Beach, FL 33406

RE: **Time Extension**
Contract Number: AN-269, FM# 413303-1-28-01

Dear Mr. Weisberg:

Time allotted for completion of services per subject Agreement expires 9/30/2007.
The Department recognizes that the delay in completing the services within the time allotted was beyond the control of the Contract Vendor.

The Department hereby extends the time for completion of said services until 9/30/2008.
All other terms of subject agreement and any supplements thereof will remain in full force and effect. It is noted that this letter does not include any additional compensation.

Please acknowledge receipt of this letter and agreement to the extension of time by signing and dating both letters and returning one signed letter to Mr. Leos A. Kennedy, Jr., Florida Department of Transportation
Professional Services Unit, 3400 W. Commercial Blvd., Fort Lauderdale, FL 33309

This "Letter of Time Extension" must be executed on or before 9/30/2007
to be in full force and effect.

Sincerely,

Title: Director of Transportation Support

Professional Services Administrator

This will acknowledge agreement to the above letter:

Board of County Commissioners

Signature: _____

Title Addie L. Greene, CHAIRPERSON

Date: _____

**Palm Beach County, Florida, a
Political Subdivision of the
State of Florida**

Re: Time Extension
Contract Number: AN-269; FM# 413303-1-28-01
PBC Proj. No.: 2002502S

ATTEST:
Sharon R. Bock, Clerk & Comptroller
Circuit Court

BY: _____
Deputy Clerk

S E A L

APPROVED AS TO TERMS
AND CONDITIONS:

BY: *5/29* *Ornela A. Hernandez*

APPROVED AS TO FORM & LEGAL
SUFFICIENCY:

COUNTY ATTORNEY