



**II. FISCAL IMPACT ANALYSIS**

**A. Five Year Summary of Fiscal Impact:**

Fiscal Years	2008	2009	2010	2011	2012
Capital Expenditures	_____	_____	_____	_____	_____
Operating Costs	_____	_____	_____	_____	_____
External Revenues	_____	_____	_____	_____	_____
Program Income (County)	_____	_____	_____	_____	_____
In-Kind Match (County)	_____	_____	_____	_____	_____
<b>NET FISCAL IMPACT</b>	<b><u>- 0 -</u></b>	<b><u>_____</u></b>	<b><u>_____</u></b>	<b><u>_____</u></b>	<b><u>_____</u></b>
# ADDITIONAL FTE POSITIONS (Cumulative)	_____	_____	_____	_____	_____

Is Item Included in Current Budget: Yes \_\_\_\_\_ No \_\_\_\_\_  
 Budget Account No: Fund \_\_\_\_\_ Dept \_\_\_\_\_ Unit \_\_\_\_\_ Object \_\_\_\_\_  
 Program \_\_\_\_\_

**B. Recommended Sources of Funds/Summary of Fiscal Impact:**

NO FISCAL IMPACT AS THIS IS A ZERO DOLLAR LEASE. THE PROGRAM IS  
 MOVING TO A COUNTY-OWNED FACILITY; AND THEREFORE, THERE WILL BE  
 NO LEASE COST.

**C. Departmental Fiscal Review:** \_\_\_\_\_

**III. REVIEW COMMENTS**

**A. OFMB Fiscal and/or Contract Development Comments:**

Jan Doherty 9-24-07  
 OFMB  
 9/24/07

Ann J. Sweet 9/26/07  
 Contract Development and Control  
 9/25/07

**B. Legal Sufficiency:**

James Butler 9/27/07  
 Assistant County Attorney  
 For IF

**C. Other Department Review:**

[Signature]  
 Department Director

**This summary is not to be used as a basis for payment.**

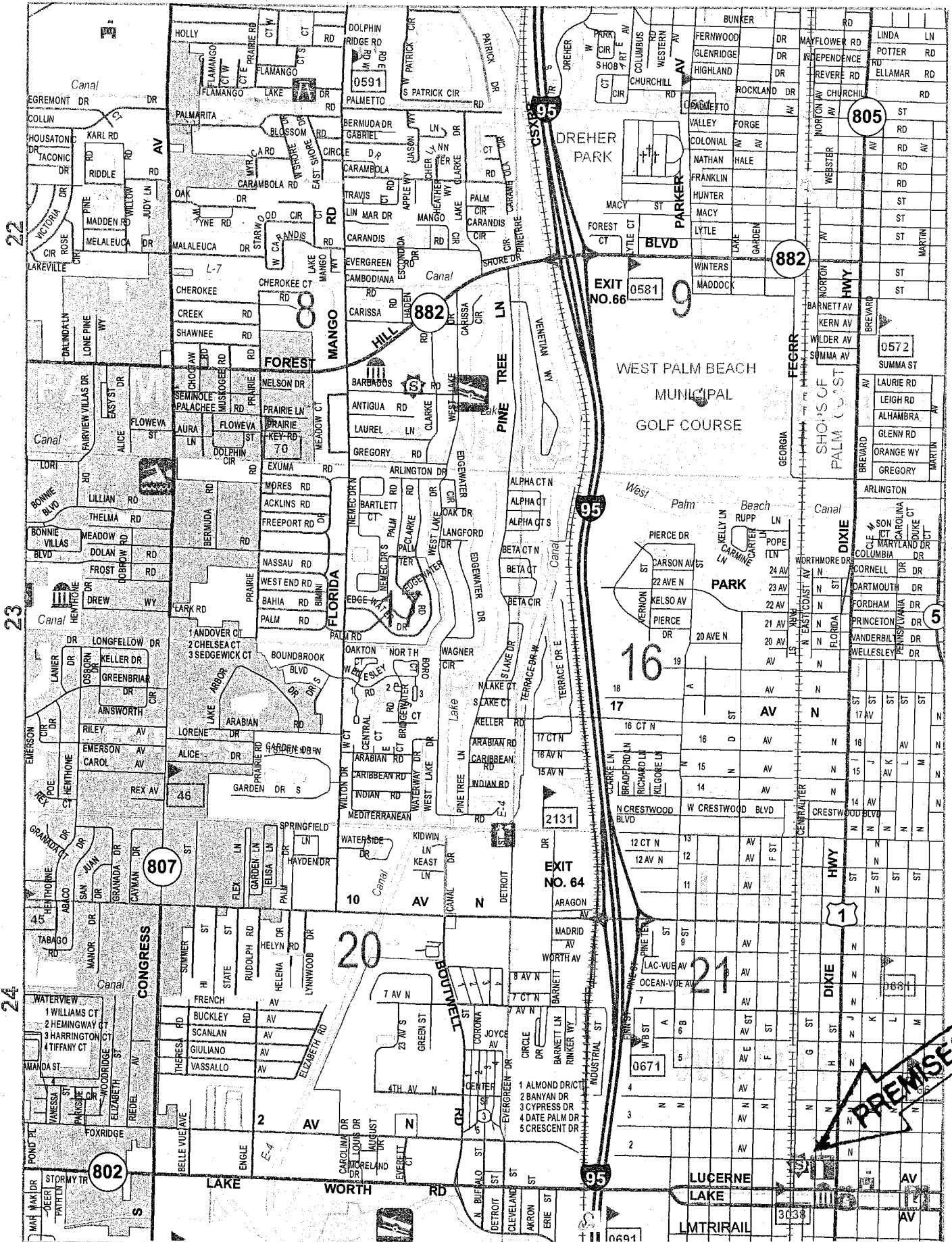

T44

T44

T44

# LOCATION MAP

# ATTACHMENT # 1

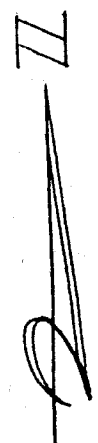



**Facilities Development &  
Operations Department  
Property & Real Estate  
Management Division**

2633 Vista Parkway  
West Palm Beach, FL 33411-5605  
(561) 233-0200  
FAX: (561) 233-0210  
[www.pbcgov.com/fdo](http://www.pbcgov.com/fdo)



**Palm Beach County  
Board of County  
Commissioners**

Addie L. Greene, Chairperson

Jeff Koons, Vice Chair

Karen T. Marcus

Robert J. Kanjian

Mary McCarty

Burt Aaronson

Jess R. Santamaria

**County Administrator**

Robert Weisman

*"An Equal Opportunity  
Affirmative Action Employer"*

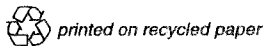

October 2, 2007

Certified Mail #70060100000579510650  
Return Receipt Requested

Jeff Clemens, Mayor  
City of Lake Worth  
7 North Dixie Highway  
Lake Worth, Florida 33460

Re: Notice of Termination of Lease

Dear Mayor Clemens:

Pursuant to Section 6 of the Agreement dated July 7, 1978, between Palm Beach County, a political subdivision of the State of Florida ("County"), and the City of Lake Worth, a municipal corporation of the State of Florida ("City") (R78-828), as amended ("Lease"), County hereby notifies City that County will terminate the Lease at the end of the Lease term on December 31, 2007.

County shall remove County's personal property and surrender the leased premises to City on or prior to December 31, 2007, and thereafter all performance of this Lease shall cease.

Please direct any questions concerning this matter to Nicholas Lambiase, Jr., Property Specialist, who may be reached at (561) 233-0237 or by e-mail at [nlambiase@pbcgov.com](mailto:nlambiase@pbcgov.com).

**ATTACHMENT #2**

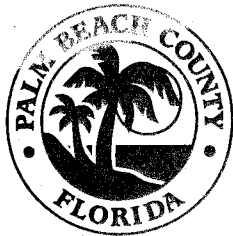

**Facilities Development &  
Operations Department  
Property & Real Estate  
Management Division**

2633 Vista Parkway  
West Palm Beach, FL 33411-5605  
(561) 233-0200  
FAX: (561) 233-0210  
www.pbcgov.com/fdo



**Palm Beach County  
Board of County  
Commissioners**

Addie L. Greene, Chairperson  
Jeff Koons, Vice Chair  
Karen T. Marcus  
Robert J. Kanjian  
Mary McCarty  
Burt Aaronson  
Jess R. Santamaria

**County Administrator**

Robert Weisman

*"An Equal Opportunity  
Affirmative Action Employer"*

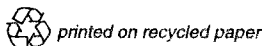

October 2, 2007  
Notice of Termination of Lease  
Page 2

**ATTEST:**

**SHARON R. BOCK,  
CLERK & COMPTROLLER**

By: \_\_\_\_\_  
Deputy Clerk

**APPROVED AS TO FORM  
LEGAL SUFFICIENCY**

By: \_\_\_\_\_  
Assistant County Attorney

**PALM BEACH COUNTY, a Political  
Subdivision of the State of Florida**

By: \_\_\_\_\_  
Addie L. Greene, Chairperson

**APPROVED AS TO TERMS AND  
CONDITIONS**

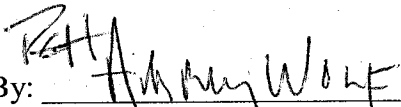
By:  \_\_\_\_\_  
Audrey Wolf, Director  
Facilities Development & Operations

G:\Property Mgmt Section\Out Lease\Mid.County Senior Care\Termination\Notice of Lease  
Termination.001.JBappr09.06.07.doc