

II. FISCAL IMPACT ANALYSIS

A. Five Year Summary of Fiscal Impact:

Fiscal Years	2008	2009	2010	2011	2012
Capital Expenditures	<\$219,816>	-0-	-0-	-0-	-0-
Operating Costs	-0-	-0-	-0-	-0-	-0-
External Revenues	-0-	-0-	-0-	-0-	-0-
Program Income (County)	-0-	-0-	-0-	-0-	-0-
In-Kind Match (County)	-0-	-0-	-0-	-0-	-0-
NET FISCAL IMPACT	<\$219,816>	-0-	-0-	-0-	-0-

ADDITIONAL FTE
POSITIONS (Cumulative) _____

Is Item Included in Current Budget? Yes X No _____
 Budget Acct No.: Fund 305 Dept. 301 Unit 005 Object 055
 Program

B. Recommended Sources of Funds/Summary of Fiscal Impact:

Road Impact Fee Fund - Zone 5
 Jog Rd/W Atlantic to S of Lake Ida Rd

Change Order # 3 (Credit) <\$219,816.00>
 PO CSEP110806-2

C. Departmental Fiscal Review: R. D. Ward 10/23/07

III. REVIEW COMMENTS

A. OFMB Fiscal and/or Contract Dev. and Control Comments:

[Signature] 11-15-07
 OFMB
 MD 11/5/07
 SP 11/4/07
 CV 11/8/07

[Signature] 11/16/07
 Contract Dev. and Control
 11/16/07

B. Approved as to Form and Legal Sufficiency:

[Signature] 11/20/07
 Assistant County Attorney

This item complies with current County policies.

C. Other Department Review:

 Department Director

This summary is not to be used as a basis for payment.

PROJECT LOCATION
PROJECT #2000502
JOG ROAD
WEST ATLANTIC AVE. TO SOUTH OF LAKE IDA ROAD

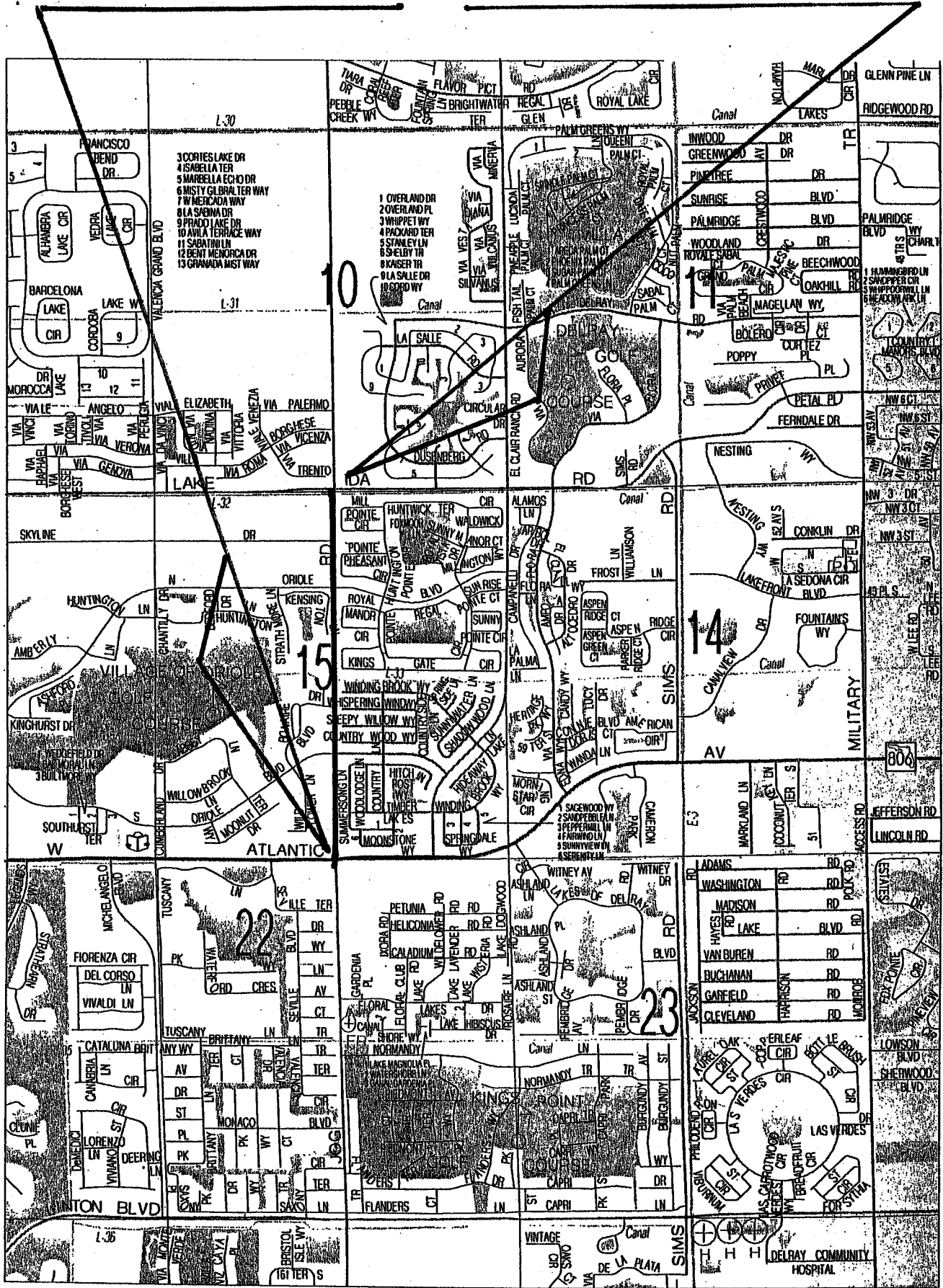

LOCATION SKETCH

CHANGE ORDER

ORIGINAL

- Owner Initiated
- Differing Site Conditions
- Zoning/Code/Ordinance Changes
- Errors/Omissions/In Design
- Quantity Overruns/Underruns
- Request By Another Agency/Outside Party
- A. Reimbursable B. Non-Reimbursable
- Other:

PROJECT: **JOG ROAD/ WEST ATLANTIC AVNEUE**
 (Name) **TO SOUTH OF LAKE IDA ROAD**
 TO:
 (Contractor) **Bergeron Land Development, Inc.**

CHANGE ORDER NO: **3 (three)**
 COUNTY PROJECT NO: **2000502**
 CONTRACT DATE: **09/12/06**
 RESOLUTION NO: **R2006-1864**
 DISTRICT NO: **5**

You are directed to make the following changes in this Contract:

Modifications to drainage structures and deletion of Palm Beach Count
 Water Utilities Department items as per Attachment 'A' – Lump Sum \$ (219,816.00)

The original Contract Sum was	\$6,274,889.65
Net change by previous Change Orders.	\$ 29,265.18
The Contract Sum prior to this Change Order was	\$6,304,154.83
The Contract Sum will be decreased by this Change Order	\$ (219,816.00)
The new Contract Sum including this Change Order will be	\$6,084,338.83
The Contract Time will be unchanged by	(0) Days
The Date of Completion as of the date of this Change Order therefore is	December 4, 2007

EXECUTION OF THIS CHANGE ORDER ACKNOWLEDGES FINAL SETTLEMENT OF, AND RELEASES ALL CLAIMS FOR, COSTS AND TIME ASSOCIATED, DIRECTLY OR INDIRECTLY, WITH THE ABOVE-STATED MODIFICATION(S). INCLUDING ALL CLAIMS FOR CUMULATIVE DELAYS OR DISRUPTIONS RESULTING FROM, CAUSED BY, OR INCIDENT TO, SUCH MODIFICATION(S), AND INCLUDING ANY CLAIM THAT THE ABOVE-STATED MODIFICATION(S) CONSTITUTES, IN WHOLE OR PART, A CARDINAL CHANGE TO THE CONTRACT.

<u>ENGINEER (If Applicable)</u>	<u>Bergeron Land Development, Inc.</u> CONTRACTOR 19612 S.W. 69 TH Place	<u>P.B.Co. Board of County Commissioners</u> OWNER P.O. Box 21229	
<u>Address</u>	<u>Address</u> Fort Lauderdale, FL 33332	<u>Address</u> West Palm Beach, FL 33416-1229	
<u>BY</u>	<u>BY</u>	<u>BY</u>	
<u>DATE</u>	<u>DATE</u>	<u>DATE</u>	

ATTEST: Sharon R. Bock,
Clerk & Comptroller

10/19/07

Approved as to Form and Legal Sufficiency:

(Deputy Clerk) Date

(County Attorney)

Attachment 'A'

Add Items

Construct modified tops as per attached sketch for the following structures:

S-1; S-4; S-8; S-18; S-22; S-36; S-40; S-47; S-47B

9each @ 2464.00 = 22176.00

Delete Items;

Item No.

81 16" DIP WM	120lf @ 224.00= 26880.00
82 16' Sleeve	3ea @ 1120.00= 3360.00
83 16"x 45 Bend	12ea @ 1680.00= 20160.00
84 16" Mega Lug Joint Restraint	24ea @ 364.00= 8736.00
85 16" to 20" Connection to Existing	5ea @ 2800.00= 14000.00
87 20" DIP WM	200lf @ 179.00= 35800.00
88 20"x 45 Bend	20ea @ 2800.00= 56000.00
89 20"x6" Tee	1ea @ 3360.00= 3360.00
90 20" Sleeve	5ea @ 2240.00= 11200.00
91 20" Mega Lug Joint Restraint	34ea @ 560.00= 19040.00
99 Restrain Existing 20" WM	388lf @ 112.00= 43456.00

 241992.00

Net Deduct

[-219816.00]

510
2P2

REVISED COMMUNITY ASPHALT CORP.

DATE 12/9/03

PROJECT NO. 229769-1-52-9

REVIEWED BY *[Signature]*

FILE COPY

- Reviewed

- Reviewed As Noted

BY *[Signature]*

DEC - 8 2003

Johnson - Davis Inc.
Contractor
804 Hibrath Drive
Larimore, Florida 33482
561-585-1170

12/09/03

TUE 08:20 FAX 1 561 585 6262

JOHNSON-DAVIS INC.

Attachment # 4

F-106

P.004/U09

T-043

15617901073

FROM-Community Asphalt WPB

04:50PM

DEC-09-03

ET TOP, TYPE 5 OR 6 (INDEX 211)

SLAB & WALLS
#4 AT 12" MIN. O.C.

CONST. 16" H. x 42" W
OPENING

6" MIN. COMPACTED SUBGRADE
MAX. DENSITY PER AASHTO T-180

DOWEL (6" MIN.) INTO EXIST. WALL
WITH #4 BARS @ 12" O.C.
USE EPOXY BONDING COMPOUND TO
SECURE (TYPE J) PER FOOT
SPECIFICATIONS.

EP VARIES

#6 BARS @ 6" MIN. O.C.

DEVELOP BAR FULLY INTO
TOP SLAB. FOLLOW STANDARD
REINFORCEMENT DETAILS FOR
MANHOLE INTEGRATION

DOWEL (6" MIN.) INTO EXIST. WALL

USE EPOXY BONDING COMPOUND TO
SECURE (TYPE J) PER FOOT
SPECIFICATIONS.

OFFSET MAY VARY (SEE PLAN)

NOTE: COST OF STRUCTURE MODIFICATION TO BE INCLUDED IN UNIT PRICE
OF NEW INLET TOP. CONTRACTOR MUST BE AWARE OF THE EXTENT
OF STRUCTURE MODIFICATION AND INCLUDE COMPLETE INSTALLATION
FOR EACH LOCATION IN HIS BASE BID.

TYPE 5 OR 6 INLET PLACEMENT
EXISTING P-BOX (OFFSET BEHIND BOX)

NTS
Re: 12/6/03 Jan

APPROVED AS NOTED

By Bureau of Structures Design
Department of Transportation
STATE OF FLORIDA

DEC 10 2003

Review is for general compliance with Contract Documents. Sole responsibility for correctness of dimensions, detail, quantities and safety during fabrication and erection shall remain with the Contractor.

003



Attachment #5
Page 1 of 2

19612 S.W. 69 Place
Fort Lauderdale, FL 33332
Office Phone (954) 680-6100

Fax Numbers
Accounting (954) 680-3737
Engineering (954) 680-0666

September 27, 2007

Palm Beach County
Department of Engineering & Public Works
PO Box 21229
West Palm Beach, Florida 33416-1229

ATTN: Robert I. Gunnel

REFERENCE: Project No. 2000502
Jog Road (From Atlantic Avenue to North Oriole Boulevard)
BLD Job No.: 624

SUBJECT: Request for Change Order of Underground work - Revision

Dear Mr. Gunnell,

Please find enclosed pricing for the changes at East side of Jog Rd as requested in the amount of
-\$219,816.00

We look forward to your early approval of the above in order have a timely completion of the
project.

Sincerely,

Bergeron Land Development, Inc.

A handwritten signature in black ink, appearing to read "Glance Brasil", is written over the typed name.

Glance Brasil
Project Manager

GB/gh
K:\BLD Jobs\624 Jog Road\Letters\PBC Construction\PBC023.wpd

BERGERON LAND DEVELOPMENT, INC.

Attachment #5
Page 2 of 2

JOG RD - REQUEST FOR CHANGE ORDER

To add these Items:

Structure	Be paid as	Quantity	Unit	Unit Price	Total
S-36	Inlet Top Modification	1	EA	\$2,464.00	\$ 2,464.00
S-40	Inlet Top Modification	1	EA	\$2,464.00	\$ 2,464.00
S-47	Inlet Top Modification	1	EA	\$2,464.00	\$ 2,464.00
S-47B	Inlet Top Modification	1	EA	\$2,464.00	\$ 2,464.00
S-22	Inlet Top Modification	1	EA	\$2,464.00	\$ 2,464.00
S-18	Inlet Top Modification	1	EA	\$2,464.00	\$ 2,464.00
S-8	Inlet Top Modification	1	EA	\$2,464.00	\$ 2,464.00
S-4	Inlet Top Modification	1	EA	\$2,464.00	\$ 2,464.00
S-1	Inlet Top Modification	1	EA	\$2,464.00	\$ 2,464.00

TOTAL	\$ 22,176.00
--------------	---------------------

To delete these Items:

Item	Description	Quantity	Unit	Unit Price	Total
81	16" DIP WM	(120.00)	LF	\$ 224.00	\$ (26,880.00)
82	16" Sleeve	(3.00)	EA	\$1,120.00	\$ (3,360.00)
83	16" x 45 Bend	(12.00)	EA	\$1,680.00	\$ (20,160.00)
84	16" Mega Lug Joint Restraint	(24.00)	EA	\$ 364.00	\$ (8,736.00)
85	16"to 20" Connection to Existing	(5.00)	EA	\$2,800.00	\$ (14,000.00)
87	20" DIP WM	(200.00)	LF	\$ 179.00	\$ (35,800.00)
88	20" x 45 Bend	(20.00)	EA	\$2,800.00	\$ (56,000.00)
89	20" x 6" Tee	(1.00)	EA	\$3,360.00	\$ (3,360.00)
90	20" Sleeve	(5.00)	EA	\$2,240.00	\$ (11,200.00)
91	20" Mega Lug joint Restraint	(34.00)	EA	\$ 560.00	\$ (19,040.00)
99	Restrain Existing 20"WM	(388.00)	LF	\$ 112.00	\$ (43,456.00)

TOTAL	\$(241,992.00)
--------------	-----------------------

Net Deduct	\$(219,816.00)
-------------------	-----------------------

FILE
R10



INTER-OFFICE MEMORANDUM

**Department of Engineering
and Public Works**
P.O. Box 21229
West Palm Beach, FL 33416-1229
(561) 684-4000
www.pbcgov.com

DATE: October 5, 2007
TO: Ellis Ross, Director
Construction Coordination Division
Tony W. Miller
FROM: Tony W. Miller, P.E., Project Engineer
Roadway Production Division
RE: ROADWAY CONSTRUCTION REVISION
JOG ROAD - WEST ATLANTIC AVENUE TO
NORTH ORIOLE BOULEVARD
PALM BEACH COUNTY PROJECT NO. 2000502

**Palm Beach County
Board of County
Commissioners**
Addie L. Greene, Chairperson
Jeff Koons, Vice Chair
Karen T. Marcus
Robert J. Kanjlan
Mary McCarty
Burt Aaronson
Jess R. Santamaria

County Administrator
Robert Weisman

Roadway Production Division agrees with the revision to use an additional offset inlet top instead of relocating the water main. This additional offset inlet modification will cost an additional \$2,464.00. It is Roadway Production Division's understanding that the additional cost of \$22,176.00 for the modifications to a total of nine affected inlets (eight previously approved) will be more than offset by the greater savings of not relocating the water main (total savings of \$219,816.00).

If you have any questions, contact me at (561) 684-4075.

TWM

ec: Omelio A. Fernandez, P.E., Director, Eng. & Public Works Oper.
David L. Young, P.E., Special Projects Mgr., Roadway Prod. Div.

F:\ROADWAY\TWM\2000502 Jog,Atlantic-N Oriole\InletTopOffsetRevision2ConstCoord-ER2.doc

RECEIVED
OCT - 5 2007

"An Equal Opportunity
Affirmative Action Employer"

printed on recycled paper

CHANGE ORDER HISTORY

PALM BEACH COUNTY PROJECT Jog Road from West Atlantic Avenue to South of Lake Worth Road; Project no. 2000502

C.O. #	DATE APPROVED	COUNTY ENGINEER		C.R. COMMITTEE		TOTAL DEPT. & C.R. APPROVALS		BOARD OF CO. COMM.	
		AMOUNT	TIME	AMOUNT	TIME	AMOUNT	TIME	AMOUNT	TIME
1	7/16/2007	23,795.18	5						
2	9/25/2007	5,470.00	0						
	TOTAL	29,265.18	5			29,265.18	5		
	CUMULATIVE TOTAL	29,265.18	5			29,265.18	5		
		MAX. AMT. \$100,000.00	MAX. TIME 30 DAYS	MAX. AMT. \$100,000.00	MAX. TIME 90 DAYS	MAXIMUM CUMULATIVE CO. ENG. & C.R. COMM. \$200,000.00	MAX. CUM. CO.ENG.&C.R. 120 DAYS		

SCHEDULE 1

LIST OF PROPOSED SBE-M/WBE SUBCONTRACTORS

PROJECT NAME: Jog Road/West Atlantic to S. of Lake Ida Rd. PROJECT NO. 2000502
 NAME OF PRIME BIDDER: Bergeron Land Development Inc.
 CONTACT PERSON: Glauce BRASIL PHONE NO: 954-275-8495 FAX NO: 954-680-0666
 BID DATE: 9-12-06 DEPARTMENT: Eng.

PLEASE IDENTIFY ALL APPLICABLE CATEGORIES OF SUBCONTRACTORS

Name, Address and Phone Number	(Check one or both Categories)		Dollar Amount				
	Minority Business	Small Business	Small	Black	Hispanic	Women	Other (Please Specify)
1. <u>N/A</u>	<input type="checkbox"/>	<input type="checkbox"/>	\$ _____	\$ _____	\$ _____	\$ _____	\$ _____
2. <u>.</u>	<input type="checkbox"/>	<input type="checkbox"/>	\$ _____	\$ _____	\$ _____	\$ _____	\$ _____
3.	<input type="checkbox"/>	<input type="checkbox"/>	\$ _____	\$ _____	\$ _____	\$ _____	\$ _____
4.	<input type="checkbox"/>	<input type="checkbox"/>	\$ _____	\$ _____	\$ _____	\$ _____	\$ _____
5.	<input type="checkbox"/>	<input type="checkbox"/>	\$ _____	\$ _____	\$ _____	\$ _____	\$ _____
6.	<input type="checkbox"/>	<input type="checkbox"/>	\$ _____	\$ _____	\$ _____	\$ _____	\$ _____
(Please use additional sheets if necessary)	Total		\$ _____	\$ _____	\$ _____	\$ _____	\$ _____

Total Bid Price \$ _____ Total Value of SBE Participation \$ _____

- NOTE:
- The amounts listed on this form must be supported by the Subcontractors prices included on Schedule 2 in order to be counted toward goal attainment.
 - Firms may be certified by Palm Beach County as an SBE and/or M/WBE. If firms are certified as both an SBE and M/WBE, please indicate the dollar amount under the appropriate category.
 - M/WBE information is being collected for tracking purposes only.