

Agenda Item is over 50 pages can be reviewed
in the Minutes Department.

Agenda Item #: 3-C-15

**PALM BEACH COUNTY
BOARD OF COUNTY COMMISSIONERS**

AGENDA ITEM SUMMARY

Meeting Date: November 18, 2008 Consent Regular
 Workshop Public Hearing
Department:
Submitted By: Engineering & Public Works Department
Submitted For: Roadway Production Division

I. EXECUTIVE BRIEF

Motion and Title: Staff recommends motion to approve: Supplemental Agreement No. 1 to Project No. 2005506 under contract R2006-0955 in the amount of \$318,614.78 with Wantman Group, Inc. for professional services.

SUMMARY: This Supplemental Agreement will provide the services necessary for the preparation of design plan revisions for Roebuck Road from S.R. 7 to Jog Road.

Districts 2 and 6 (PK)

Background and Justification: On June 6, 2006, the Board of County Commissioners (Board) approved an Agreement R2006-0955 with Wantman Group, Inc. (WGI) to provide professional services required to prepare design plans and construction bid documents for Roebuck Road from S.R. 7 to Jog Road (Project). Palm Beach County now desires WGI to revise the roadway typical section to provide for required berms, to develop alternative configurations for the intersection of Roebuck Road at S.R. 7 and Jog Road, and to provide additional Environmental Services for the Project, as detailed in Exhibit "A" of the attached Supplemental Agreement. The Small Business Enterprise (SBE) goal for the Project is 15%. The SBE participation committed for this supplement by WGI is 30.43% overall. The fee, as detailed in Exhibit "A" of the attached Supplemental Agreement, has been negotiated as just and reasonable compensation as follows:

Basic Services (Lump Sum)	\$ 299,644.78	(Revise Plans, Environmental, Survey and Structural).
Reimbursable Expenses (Not to Exceed)....	\$ 18,970.00	(Geotechnical and Reprographics).
Total:	<u>\$ 318,614.78</u>	

After reviewing the attached Supplemental Agreement and finding it in proper order, staff recommends the Board's approval.

Attachments:

1. Location Map
2. Supplemental Agreement with Exhibits and Certificate of Insurance (2)
3. Project Work Schedule

Recommended by: *[Signature]* 10/2/08
Division Director Date

Approved By: *[Signature]* 10/30/08
County Engineer Date

II. FISCAL IMPACT ANALYSIS

A. Five Year Summary of Fiscal Impact:

Fiscal Years	2009	2010	2011	2012	2013
Capital Expenditures	<u>\$382,350</u>	<u>-0-</u>	<u>-0-</u>	<u>-0-</u>	<u>-0-</u>
Operating Costs	<u>-0-</u>	<u>-0-</u>	<u>-0-</u>	<u>-0-</u>	<u>-0-</u>
External Revenues	<u>-0-</u>	<u>-0-</u>	<u>-0-</u>	<u>-0-</u>	<u>-0-</u>
Program Income (County)	<u>-0-</u>	<u>-0-</u>	<u>-0-</u>	<u>-0-</u>	<u>-0-</u>
In-Kind Match (County)	<u>-0-</u>	<u>-0-</u>	<u>-0-</u>	<u>-0-</u>	<u>-0-</u>
NET FISCAL IMPACT	<u>\$382,350</u>	<u>-0-</u>	<u>-0-</u>	<u>-0-</u>	<u>-0-</u>

ADDITIONAL FTE
POSITIONS (Cumulative) _____

Is Item Included in Current Budget? Yes X No _____
Budget Acct No.: Fund 3500 Dept. 361 Unit 1157 Object 6505
Program

B. Recommended Sources of Funds/Summary of Fiscal Impact:

Transportation Improvement Fund
Roebuck Rd/SR7 to Jog Rd

Supplement #1- Basic Services	\$299,644.78
- Reimbursables	\$ 18,970.00
Contract Amount	\$318,614.78
Contingency	\$ 15,935.22
Staff Costs-Roadway	\$ 31,865.00
-Traffic	\$ 15,935.00
Fiscal Impact	<u>\$382,350.00</u>

C. Departmental Fiscal Review: _____ *[Signature]*

III. REVIEW COMMENTS

A. OFMB Fiscal and/or Contract Dev. and Control Comments:

A. White 11.4.08
OFMB *[Signature]* SA *[Signature]* 11/7/08 CN 10/30/08

Jim J. Jacobson 11/5/08
Contract Dev. and Control
[Signature] 11/5/08
This item complies with current County policies.

B. Approved as to Form and Legal Sufficiency:
Paul F. [Signature] 11/7/08
Assistant County Attorney

C. Other Department Review:

Department Director

This summary is not to be used as a basis for payment.

Roebuck Road from S. R. 7 to Jog Road
Project No. 2005506

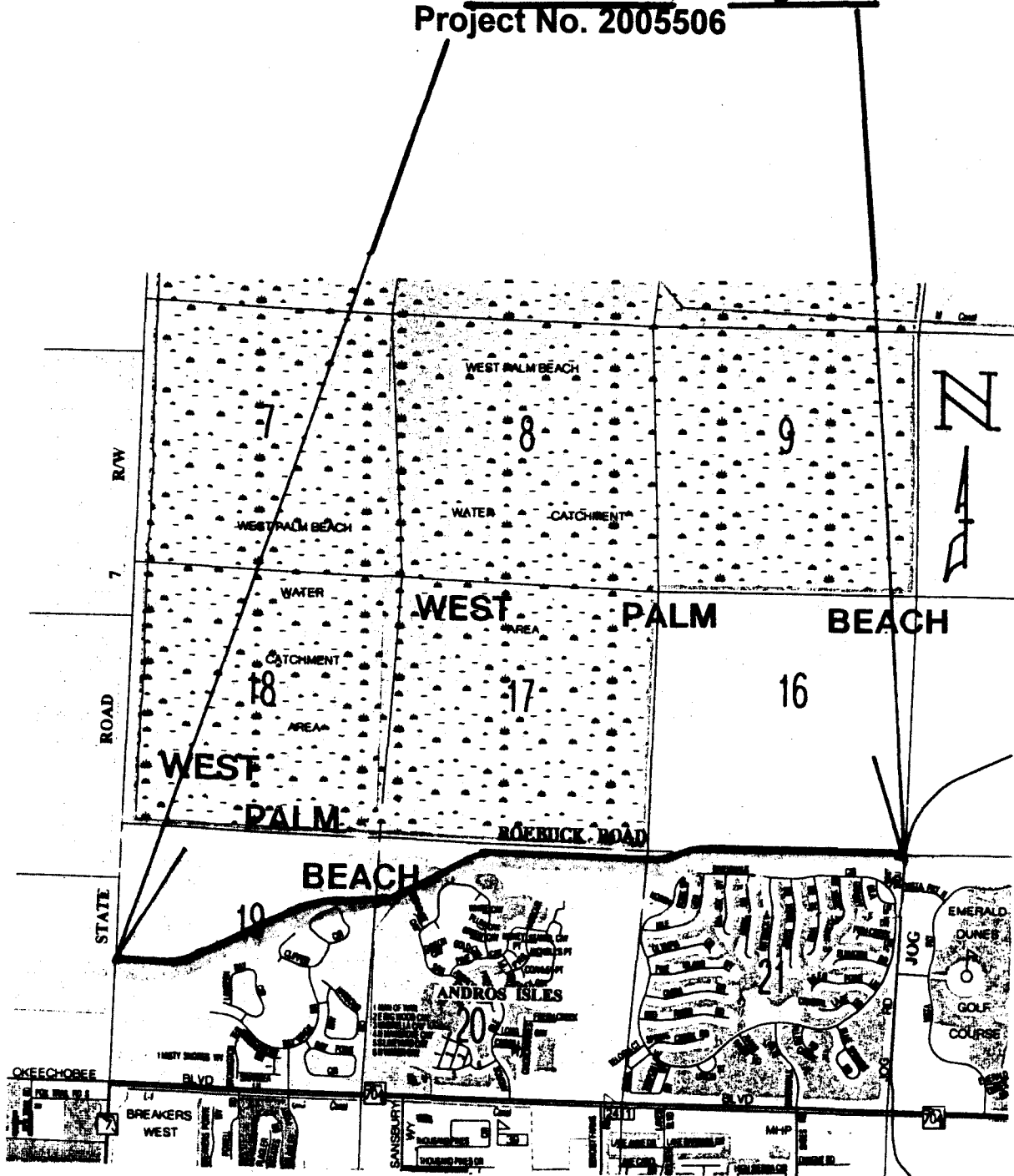

LOCATION SKETCH

ATTACHMENT 2

SUPPLEMENTAL AGREEMENT BETWEEN

**PALM BEACH COUNTY
AND
WANTMAN GROUP, INC.**

FOR PROFESSIONAL ENGINEERING SERVICES ON

ROEBUCK ROAD FROM S.R. 7 TO JOG ROAD

**PROJECT #: 2005506
PALM BEACH COUNTY, FLORIDA**

THIS SUPPLEMENTAL AGREEMENT No. 1, made and entered into this day of _____ 2008 by and between Palm Beach County, hereinafter COUNTY, and, Wantman Group, Inc., a Florida Corporation with an address of 2035 Vista Parkway, Suite 100, West Palm Beach, Florida 33411, hereinafter CONSULTANT.

WITNESSETH

WHEREAS, the COUNTY and CONSULTANT entered into a Project Agreement dated June 6, 2006 (R2006-0955), to provide professional engineering services for the design of Roebuck Road from S.R. 7 to Jog Road, Palm Beach County, Florida (hereinafter PROJECT); and.

WHEREAS, the COUNTY now desires for the CONSULTANT to revise the roadway typical section to provide for required berms, to develop alternative configurations for the intersection of Roebuck Road at S.R. 7 and Jog Road, and to provide additional Environmental Services for the PROJECT; and

WHEREAS, the following fee has been negotiated as just and reasonable compensation for these professional services to be performed by the CONSULTANT:

**RE: Roebuck Road from S.R. 7 to Jog Road
Project No. 2005506**

Basic Services in a lump sum fee of **\$299,644.78**;

Reimbursable Services (Not to Exceed) \$ 18,970.00;

Totaling \$318,614.78

NOW, THEREFORE, THIS INDENTURE WITNESSETH: That for and in consideration of the mutual benefits to flow from each to the other, the parties hereto agree as follows:

1. The **CONSULTANT** agrees to provide professional services as described in Exhibit "A" of the Agreement known as "SCOPE OF WORK & FEE".
2. The **CONSULTANT** agrees to "CERTIFICATION" statements as described in Exhibit "B" of the Agreement.
3. The **CONSULTANT** agrees to Small Business Enterprise (SBE) Participation, described in Exhibit "C" of the Agreement.
4. The **CONSULTANT** has provided sub-consultants Letter of Intent to perform as an SBE as described in Exhibit "D" of the Authorization.
5. The **COUNTY** agrees to pay the **CONSULTANT** a fee of Three Hundred Eighteen Thousand Six Hundred Fourteen Dollars and Seventy-Eight Cents (\$318,614.78).
6. The **CONSULTANT** agrees to indemnify, defend and hold harmless the **COUNTY** against all claims that may arise as a result of negligence, wrongdoing, misconduct or want of care by the **CONSULTANT**.

Except as hereby amended, changed or modified, all other terms and conditions of the original Agreement dated **June 6, 2006 (R2006-0955)**, and;

Supplements and Amendments thereto, shall remain in full force and effect.

**RE: Roebuck Road from S.R. 7 to Jog Road
Project No. 2005506**

IN WITNESS WHEREOF, the parties hereto have made and executed this Authorization as of the day and year first above written.

OWNER:

**Palm Beach County, Florida, a
Political Subdivision of the
State of Florida**

BOARD OF COUNTY COMMISSIONERS

BY: _____
**Addie L. Greene, Chairperson
Chair**

ATTEST:
Sharon R. Bock, Clerk & Comptroller
Circuit Court

BY: _____
Deputy Clerk

SEAL

**APPROVED AS TO TERMS
AND CONDITIONS:**

BY: _____
Department Head

**APPROVED AS TO FORM & LEGAL
SUFFICIENCY:**

County Attorney

CONSULTANT:

**Wantman Group, Inc.
a Florida Corporation**

BY: _____
**David Wantman, P.E.
President**

CORPORATE SEAL

WITNESS:

BY: _____
**Hathleen Fontaine
(Printed Name)**

BY: _____
**Pasquale Volpe
(Printed Name)**

EXHIBIT "A"



Wantman Group, Inc.

Engineering ♦ Planning ♦ Surveying ♦ Mapping

RECEIVED AUG 01 2008

July 31, 2008

Javier Lopez, PE
Palm Beach County
Engineering & Public Works Department
Roadway Production Division
2300 North Jog Road, Third Floor
West Palm Beach, Florida 33411-2745

Approved for processing
[Signature]
8/27/08

RE: Roebuck Road Extension – SR 7 to Jog Road
PBC Project No: 2005506
WGI Project No: 205548.00
NEGOTIATED SCOPE, STAFF HOURS & FEE ESTIMATE – SA NO. 1

Dear Mr. Lopez:

Wantman Group, Inc. (WGI) is pleased to submit the attached scope, staff hours, and fee estimate for Palm Beach County approval to complete additional effort associated with the subject project. All changes included in your letter response dated July 30, 2008 to our previous submittal of this Supplemental Agreement have been incorporated. Additionally, our subconsultant Tierra, Inc. recognized additional geotechnical work associated with the signal pole and mast arm designs had not been previously included in their effort. As a result, their portion of fees associated with this Supplemental Agreement have been modified accordingly.

WGI appreciates the opportunity to be of service to Palm Beach County on this project. Should you have any questions regarding the attachments or need additional information, please do not hesitate to call.

Sincerely,

WANTMAN GROUP, INC.

Gary Williams, PE
Project Manager / Senior Vice President

cc: M. Mufleh, D. Boyer, L. Kiefer (KHA)
T. Brown (B&P)
B. Rheault (BDA)
R. Krishnasamy (Tierra)
File 205548.00 (A.7) (w/encl)

encl

T:\548 Roebuck Road\Cor\110 LET_PBC_Lopez (SA #1 Rev).doc

2035 Vista Parkway ♦ Suite 100 ♦ West Palm Beach, Florida 33411
561.687.2220 ♦ Fax: 561.687.1110 ♦ www.wantmangroup.com ♦ wgi@wantmangroup.com

**EXTENSION OF ROEBUCK ROAD
FROM SR 7 TO JOG ROAD
PALM BEACH COUNTY PROJECT
NO. 2005506**

**SCOPE, STAFF HOUR AND
FEE ESTIMATE**

SUPPLEMENTAL AGREEMENT NO. 1

PREPARED FOR:



PREPARED BY:



Wantman Group, Inc.
2035 Vista Parkway, Suite 100 • West Palm Beach, Florida 33411
(561) 687-2220 • (561) 687-1110 (fax)
e-mail: wgi@wantmangroup.com
Cert. No. 6091

Revised: July 31, 2008

SCOPE OF SERVICES

TABLE OF CONTENTS

Supplemental Agreement No. 1

Extension of Roebuck Road ~~to~~ SR 7 to Jog Road
Palm Beach County Project Number: 2005506

July 31, 2008

I.	DESCRIPTION	1
II.	OBJECTIVES	2
III.	SCOPE OF SERVICES	3
	A. ROADWAY DESIGN	3
	B. DRAINAGE DESIGN AND PERMITTING	5
	C. ENVIRONMENTAL RESEARCH	7
	D. UTILITIES	8
	E. STRUCTURAL DESIGN	8
	F. LIGHTING	9
	G. SIGNING AND PAVEMENT MARKING PLANS	9
	H. SIGNAL DESIGN	9
	I. SURVEY	9
	J. RIGHT OF WAY MAPPING/PARCEL SKETCHES	9
	K. GEOTECHNICAL SERVICES	9
	L. PUBLIC INVOLVEMENT	10
	M. POST DESIGN SERVICES	10
IV.	REIMBURSABLE EXPENSES	10
V.	GENERAL REQUIREMENTS FOR WORK	10
VI.	COUNTY RESPONSIBILITY	10
VII.	LEGNTH OF SERVICES	10

SCOPE OF SERVICES

Supplemental Agreement No. 1

Extension of Roebuck Road to SR 7 to Jog Road Palm Beach County Project Number: 2005506

July 31, 2008

I. DESCRIPTION

As requested by Palm Beach County Engineering & Public Works (PBC), the Roebuck Road design project (PBC Project No. 2005506) will be expanded to include the following additional services not previously anticipated as part of the original design effort:

- a) Conceptual layout of roadway and signing/pavement marking improvements to approximately 1800' of SR 7 to accommodate turn lane requirements at the intersection of Roebuck Road and SR 7. This information will be forwarded to Palm Beach County for possible inclusion in an existing construction contract. This effort will also include the development of conceptual geometrics for as many as two intersection alternatives.
- b) Additional roadway and drainage design to revise approximately 1400' of preliminary plans and 1900' of signing/pavement marking plans of Jog Road to accommodate turn lane requirements at the intersection of Roebuck Road and Jog Road. This effort will also include the development of conceptual geometrics for as many as three intersection alternatives.
- c) Roadway, drainage, and signing/pavement marking improvements to approximately 250' of Snelgrove Way, the east approach of the Roebuck Road/Jog Road intersection.
- d) Evaluation of sidewalk location alternatives (north side or south side) on the Roebuck Road typical section for the entire length of the project at the request of Palm Beach County. This evaluation will also consider adjustments in the horizontal alignment of Roebuck Road for the section of the project located adjacent to the Baywinds development. A cost analysis will be completed using updated cross sections and plan sheets.
- e) Modification of drainage maps, typical sections, plan sheets, profile sheets, cross sections, roadway detail sheets, signing and pavement marking sheets, etc. delivered to Palm Beach County on December 6, 2007 that are affected by the County's decision to modify the proposed typical section and alignment as it relates to the sidewalk location.

- f) Relocation of an existing berm located within the roadway right-of-way of Roebuck Road within Section 16 of Township 43 and Range 42. This effort will include an evaluation of the berm location as it relates to the proposed sidewalk using updated plan sheets and cross sections for up to 3 alternatives. The recommended alternative will then be included in the plans.
- g) Modification of the proposed drainage design based on the proposed sidewalk location.
- h) Assist PBC with utility coordination on Jog Road within the additional roadway improvements described.
- i) Supplemental Survey work to locate (x,y,z) of an existing berm located along the northern property line of the Baywinds development, full topographic survey of up to 500' of the east approach of Snelgrove Way at Jog Road, and updates to the roadway alignment reference points resulting from modifications in the proposed alignment of Roebuck Road. See attached scope from Brown & Phillips, Inc. for additional information.
- j) Retaining Wall design for 7700' of 10' average height wall along Roebuck Road where proposed embankment side slopes would otherwise extend beyond existing R/W set aside for the construction of Roebuck Road. Also, box culvert design for three separate animal crossings underneath Roebuck Road. Two of the box culverts will be 10' x 10' (8' x 10' opening) and the third will be 10' x 24'. See attached scope from Bridge Design Associates, Inc. for additional information.
- k) Additional geotechnical work for the retaining wall design. See attached scope from Tierra, Inc. for additional information.

Elements of the current design that will be impacted by the additional services described above will be expanded in the sections to follow of this Scope of Services.

II. OBJECTIVES

The Wantman Group, Inc. (Design Team) shall design and incorporate the additional additional services described above into a complete set of contract plans and specifications for construction previously identified in the original Scope of Services dated March 27, 2006. Elements of work for **Supplemental Agreement No. 1** shall include the following:

- A. Roadway Design
- B. Drainage Design
- C. Environmental Research and Permitting
- D. Utilities
- E. Structural Design
- F. Lighting (**NOT REQUIRED**)

- G. Signing and Pavement Marking Plans
- H. Signal Design (S.A. **WORK NOT REQUIRED**)
- I. Survey
- J. Right of Way Mapping/Parcel Sketches
- K. Geotechnical Services
- L. Public Involvement
- M. Post Design Services (S.A. **NOT REQUIRED**)

III. SCOPE OF SERVICES

The additional services required for the effort described above shall address Items A through M in Section II, where applicable, in accordance with the Palm Beach County Thoroughfare and Roadway Design Procedures, February 2006 and the latest State criteria, as applicable and as expanded below.

A. ROADWAY DESIGN

Some of the additional roadway design services identified in Section I of this scope will require the development of conceptual sketches, cost estimates, etc. for PBC review and approval prior to incorporation of the approved concepts into the final set of roadway plans, specifications, and permits required for construction. Specific elements of work associated with each additional roadway design service include the following:

1. As many as five different concepts will be developed for PBC review and approval for these intersections (i.e., Roebuck Road @ SR 7 and Roebuck Road @ Jog Road). Additional preliminary plan sheet effort anticipated with the intersection improvements will impact the following:
 - Key Sheet – Revise to describe the additional limits of work.
 - Drainage Maps – Additional effort required to include drainage basin boundaries on Jog Road and Snelgrove Way that will be impacted by the additional roadway, drainage, and structures improvements.
 - Summary of Quantities – Additional quantities required because of the additional roadway, drainage, structures, and signing/pavement marking needs at the intersection of Roebuck Road @ Jog Road and along Roebuck Road.
 - Typical Sections – One additional sheet of typical sections for Jog Road. A typical section or detail will not be provided for the relatively short length of improvements required on Snelgrove Way.
 - Plan Sheets – One additional plan sheet for Jog Road improvements and one additional plan sheet for Snelgrove Way improvements. All plan sheets will be developed at a scale of 1"=40' and will reference raster imagery provided by Palm Beach County. Plateauing of Roebuck Road/SR 7 and Roebuck Road/Jog

Road intersections is included in the Original Scope of services dated March 27, 2006.

- Quantities and Computation Books – Minor additional effort required because of the additional roadway, drainage, and structures improvements.
2. As many as two preliminary concepts will be developed for PBC review and approval that would modify the location of the sidewalk from the previously approved location on the south side to the north side. One concept will be developed for consideration that simply moves the sidewalk to the north side while leaving the previously approved horizontal alignment of Roebuck Road as is. The second concept will also show the sidewalk on the north side but allow account for some adjustments in the horizontal alignment of Roebuck Road. A cost analysis will be completed with each option based in part on proposed cross sections that reflect proposed conditions shown in each concept.

Once PBC has approved the sidewalk location change, additional plan sheet effort will be required to incorporate the change. The following sheets will be affected:

- Drainage Maps – Additional effort required to modify drainage basin boundaries on Roebuck Road that will be impacted by the change in sidewalk location and adjustments in the Roebuck Road alignment, if required.
 - Typical Sections – All Roebuck Road typical sections will need to be modified to reflect the new location of the sidewalk. Any changes in wall type and location will also need to be shown. Dimensions shown identifying distances between the centerline of construction and the proposed R/W will also require revisions if the alignment is modified. This may require an additional typical section sheet to reflect the berm location and adjustments in the alignment.
 - Plan Sheets – All plan sheets will require revisions with the change in sidewalk location. Alignment adjustments will result in changes to the stationing shown, station/offset callouts, labels for roadway elements, etc.
 - Cross Sections – Cross sections previously developed will require modifications to reflect the new sidewalk location and any adjustments in wall size, type, and location resulting from the new sidewalk location. Changes in the horizontal alignment will also require revisions to the cross sections.
3. The relocation of proposed berm condition as described in Section I (f) of this scope will affect the following sheets:
- Drainage Maps – Additional effort required to modify drainage basin boundaries on Roebuck Road that will be impacted by the

relocation of an existing berm along the northern R/W line and adjustments in the Roebuck Road alignment, if required.

- Typical Sections – Roebuck Road typical sections will need to be modified to reflect the relocated berm. Any changes in wall type and location resulting from the addition of a berm will also need to be shown. This may require an additional typical section sheet to reflect the berm location and adjustments in the alignment.
 - Plan Sheets – All plan sheets where the berm will be constructed will require revisions to show this proposed condition.
 - Cross Sections – Cross sections previously developed will require modifications to reflect the new berm
4. The Design Team will attend as many as three additional meetings to discuss PBC's approval of the conceptual intersection designs, evaluate storage length requirements for turning movements, etc. The Design Team will also attend as many as three additional meetings to discuss modifying the typical section of Roebuck to reflect a sidewalk on the north side, evaluating the cost of this change, discussing the relocation of berm to the project, and evaluating horizontal alignment modifications that may be required to accommodate either the sidewalk change or the berm relocation.

B. DRAINAGE DESIGN

The Design Team will complete the following additional tasks associated with the drainage design:

1. At the County's request, the Design Team will review the proposed roadway base clearance recommendations in lieu of the SR 7 findings by the KF Group. This analysis will entail obtaining the KF Group's SR 7 drainage report from the County, and the appropriate SFWMD permits for SR 7, Target, Okeechobee Road, etc. The documentation will be reviewed and compared to the hydrological conditions adjacent to the proposed Roebuck Road right of way behind the Baywinds and Andros Isles subdivisions. A summary conclusion will be incorporated into the design.
2. The drainage design for the additional improvements to Jog Road and Snelgrove Way will involve documentation research to identify the existing conditions. These conditions were not reviewed with the original scope of work. Specific activities include:
 - Review of existing and proposed plans for Jog Road;
 - Identifying existing drainage patterns and outfalls;
 - Reviewing existing and proposed SFWMD permits for Jog Road;
 - Identifying locations of potential/required cross drains.

3. Once the existing conditions have been accurately determined, the proposed drainage system will be laid out and evaluated using the existing data and the following criteria:
 - Design storm sewer systems to meet County hydrologic design criteria for hydraulic clearances;
 - Evaluate proposed inlet locations for spread;
 - Design of floodplain encroachment compensation, as necessary.

The drainage system will consist of the following elements:

A drainage system, including outfalls, for the Roebuck Road/Jog Road intersection per the original scope dated March 27, 2006 will be expanded to include another 750' (+/-) south, 650' (+/-) north and 250' east in additional improvements. The additional improvements to the east reflect recently constructed Snelgrove Way.

4. An additional special drainage system consisting of a linear water management area will be designed in the west Jog Road Right of Way, to provide treatment for the turn lanes associated with the Jog Road turn lanes. This system will either discharge to the existing Jog Road system or west onto City of West Palm Beach owned property similar in fashion to the linear swale along the north side of Roebuck Road.
5. The original scope drainage design will be expanded to include the additional analysis necessary to evaluate the inclusion of the relocated berm condition that runs parallel to the north R/W line of Roebuck Road as described in Section I (g) above. This evaluation will also consider an analysis to accommodate discharge restrictions to meet the C-51 basin rule assuming no discharge to City of West Palm Beach property north of the above proposed berm, and sizing of an offsite water management area. An exfiltration trench analysis will be performed to determine how much trench is required to meet water quality criteria, and to determine if the C-51 rule can be met with exfiltration trench. As a part of the original Scope of Services Agreement, an assessment of the City / County Agreement regarding outfalls will also accompany this task.
- 6A & 6B. The original scope drainage design will also be modified based on the proposed sidewalk shift, described above, and based on comments received from Palm Beach County on December 20, 2007 to reduce the number of outfall points into the Baywinds and Andros Isle communities. This analysis will combine 3 outfalls into 1 outfall in both the Baywinds and Andros Isle communities. The system into Baywinds will also have to traverse the extended pipes from the SFWMD pump station. The structure redesign will require 2/3's of the original effort due to relocating inlets, resizing and redirecting pipes and determining new inverts.

- 6C. The original scope drainage design will also be modified based on the proposed sidewalk location, described above, for the section along the Riverwalk community. The structure redesign will require 1/3 of the original effort due to relocating inlets, resizing pipes and determining new inverts.
7. One additional field review to evaluate the existing conditions along Jog Road will be required after the plan and permit review is complete. The field review will be to verify plan and permit conditions as they relate to the proposed drainage system design.
8. The project is expected to be extended at least one more year. It is anticipated that drainage staff will be required to attend the regular quarterly meetings and that the meetings will continue.
9. The inclusion of the Jog Road turn lane improvements will also result in minor drainage involvement with permitting. This involvement will entail additional documentation for each permit application.

C. ENVIRONMENTAL RESEARCH AND PERMITTING

The Design Team will complete the following additional tasks associated with Environmental Research and Permitting:

1. Snail Kite Survey

The Design Team will conduct snail kite surveys to identify potential nesting sites on and adjacent to the Roebuck Road right-of-way. Snail kites are known to utilize the wetlands adjacent to the corridor and mitigation was specifically designed to enhance their habitat. The survey will be conducted in accordance with standard survey protocols, including a mapping of potential habitats along the proposed corridor. Standard protocol consists of 6 to 8 non-consecutive days of surveys. Due to the sizes of the project area to be surveyed, the Design Team proposes to have 2 teams of 2 people for each survey day. Location of observed nesting, roosting and feeding sites, if applicable, will be mapped on an aerial photograph. Additionally, the *Natural Resource Assessment Technical Memorandum* will be updated to include a summary of the snail kite survey results.

2. Wading Bird Survey

The Design Team began wading bird surveys in Spring 2007 but had to cease survey due to drought conditions. The Design Team completed two days of the survey. However, the survey protocol is 5 days. Because of the duration between surveys, the wading bird survey will have to be re-initiated for the full five days. This scope includes two additional survey days.

3. Additional Permitting Support

The Design Team will review existing permit documentation regarding the tree mitigation for Snelgrove Way and the revised plans for SR 7 and Jog Road to determine if there are additional environmental impacts. We will attend one meeting each with ERM as required to address the potential tree mitigation. It is our understanding that improvements along Jog Road and SR 7 will not result in additional wetland impact and thus this scope does not include environmental permitting.

As part of the original scope, the Design Team obtained the USACE permit documentation for Baywinds and Andros Isles, consisting of 3 large binders of information. The Design Team will continue to review this past permit documentation along with ongoing County permitting activities to determine effects on the Roebuck Road permit and to identify specific issues that should be addressed in the applications.

Since NTP, USACE has revised its guidance regarding wetland jurisdictional determinations (JD) requiring greater detail and a revised form. This JD information is referred to as the Rapanos Guidance. The Design Team will complete the new forms and required documentation for submittal to USACE.

4. Meetings

It is anticipated that the project schedule will extend at least one year past the original 24 month schedule to June 2009. Also, given the City of West Palm Beach's position on the permit, it is anticipated that additional progress meetings may be required. The Design Team will attend bi-monthly progress meetings for a total of six meetings.

D. UTILITIES

The Design Team will assist Palm Beach County with the additional utility coordination effort associated with the Jog Road improvements and the expansion to Florida Power and Light transmission lines adjacent to Roebuck Road R/W. We will review additional utility company "red-lined" plans, and plot applicable utility information on the roadway plans.

E. STRUCTURAL DESIGN

Based on pre-application meetings held with the USFWS and the USACE, three animal crossings will be required on this project. Two animal crossings will be designed as 10' x 10' (8' x 10' opening) box culverts while the third animal crossing will be designed as a 10' x 24' box culvert. The Agencies' requests for these box culverts will require the development of localized "humps" in the proposed profile of Roebuck Road as the road is elevated to accommodate the crossings. The Design Team plans to utilize retaining walls where the localized "humps" occur to avoid excessive embankment needs while minimizing wetland impacts outside the limits of Roebuck Road R/W.

The effort associated with the work described will be compared with the effort previously negotiated. Additions or deletions in fee are noted on the Fee Estimate for this supplemental agreement.

See Bridge Design & Associates, Inc. attached Scope of Services for additional information regarding their scope and fee for this supplemental agreement as well as credit for services negotiated under the original contract that are no longer required.

F. LIGHTING DESIGN

Not required.

G. SIGNING AND PAVEMENT MARKING PLANS

The Design Team shall prepare additional signing and marking plans for the extended limits of the project (1900' along Jog Road and 250' along Snelgrove Way). Since the horizontal alignment was shifted after signing and marking plans had been prepared in November 2007, the Design Team shall redo the entire signing and marking sheets for the segments where the horizontal alignment of Roebuck Road has been changed. This includes an alignment length of 1 mile west of Jog Road and 1 mile east of SR 7 for a total rework of 2 miles. It also includes redoing the sheet layout for the entire project because the centerline stations were revised due to the change in alignment.

H. SIGNAL DESIGN

No additional signal design effort will be required as a result of the additional work required. As a point of clarification with the original Scope of Services, signal designs at Roebuck and SR 7 and Roebuck and Jog must account for the ultimate designs for SR 7 and Jog Road. PBC will provide direction regarding the number of lanes and movements ultimately anticipated on those facilities.

I. SURVEY

Brown & Phillips Inc. will provide additional surveying services as detailed in their attached Scope of Services.

J. RIGHT OF WAY MAPPING/PARCEL SKETCHES AND LEGAL DESCRIPTIONS

Brown & Phillips Inc. will provide additional R/W Mapping and Parcel Sketches services, as detailed in their attached Scope of Services.

K. GEOTECHNICAL SERVICES

Tierra, Inc. will provide additional geotechnical services as detailed in their attached Scope of Services.

L. PUBLIC INVOLVEMENT

At the County's request, WGI will provide support services for Public Involvement activities that the County must provide to local municipalities and other special interest groups.

M. POST DESIGN SERVICES

No additional post design services are anticipated.

IV. REIMBURSABLE EXPENSES

The Design Team will be reimbursed for all additional expenses related to the to the additional work outlined in this Scope of Services.

Parcel Sketches (if required) are also reimbursable expenses.

V. GENERAL REQUIREMENTS FOR WORK

See original Scope of Services dated March 27, 2006.

VI. COUNTY RESPONSIBILITIES

See original Scope of Services dated March 27, 2006.

VII. LENGTH OF SERVICES

The Basic Services will be completed an additional 12 months from the date of the original Letter of Authorization.

FEE ESTIMATE

Master Summary - Estimate of Work Effort & Fee Proposal - SA No. 1

PBC Project No. 2005506
 WGI Project No. 205548.00
 Job Description: ROEBUCK ROAD EXTENSION

Consultant: WANTMAN GROUP, INC
 Date Prepared: Negotiated June 9, 2008
 From: SR 7
 To: JOG ROAD
 Length: 3.2 MILES

Work Element / Activity	Project Manager		Senior Engineer		Engineer		Engineer Intern		Senior CADD Technician		Total Man Hours By Activity	Salary Cost By Activity
	Staff Hours	Hourly Rate	Staff Hours	Hourly Rate	Staff Hours	Hourly Rate	Staff Hours	Hourly Rate	Staff Hours	Hourly Rate		
A. ROADWAY PLANS	88	\$48.20	244	\$43.00	244	\$34.85	244	\$25.75	147	\$23.50	977	\$33,211.70
B. DRAINAGE PLANS & PERMITTING	6	\$48.20	14	\$43.00	14	\$34.85	14	\$25.75	8	\$23.50	66	\$1,912.80
C. SIGNING & MARKING PLANS	0	\$48.20	0	\$43.00	0	\$34.85	0	\$25.75	0	\$23.50	0	\$0.00
D. SIGNAL PLANS	0	\$48.20	0	\$43.00	0	\$34.85	0	\$25.75	0	\$23.50	0	\$0.00
E. ENVIRONMENTAL SERVICES	0	\$48.20	0	\$43.00	0	\$34.85	0	\$25.75	0	\$23.50	0	\$0.00
Totals	104	\$4,804.80	268	\$11,084.00	268	\$8,939.70	268	\$8,843.80	166	\$3,642.80	1033	\$36,124.80

Total Burdened Salary Costs By Activity	
A. ROADWAY PLANS	\$89,835.04
B. DRAINAGE PLANS & PERMITTING	\$5,738.40
C. SIGNING & MARKING PLANS	\$0.00
D. SIGNAL PLANS	\$0.00
E. ENVIRONMENTAL SERVICES	\$0.00
Total	\$106,373.44

Subconsultant Fees	
A. Brown & Phillips, Inc.	\$14,871.00
B. Kimley-Horn & Associates, Inc.	\$114,754.34
C. Bridge Design Assoc., Inc.	\$64,646.00
D. Tierra, Inc.	\$17,520.00
Total	\$211,791.34

Optional Services	
A.	\$0.00
B.	\$0.00
C.	\$0.00
D.	\$0.00
Total	\$0.00

Permit Fees	
A.	\$0.00
B.	\$0.00
C.	\$0.00
Total	\$0.00

Total Contract Fee Computations	
Total Activity Salary Costs	\$35,124.50
1.) Overhead Additives	
a.) Combined Administrative & General & Fringe Benefits Cost (limited to PBC maximum)	167.857% \$58,958.93
Subtotal (Salaries + Combined Overhead)	\$94,083.43
2.) Operating Margin Cost (Fixed Fee)	12% \$11,290.01
Subtotal (Burdened Salaries + Operating Margin)	\$106,373.44
BASIC LUMP SUM FEE (WGI)	\$106,373.44
Subconsultants	
a) Brown and Phillips	\$14,871.00
b) Kimley-Horn & Associates, Inc.	\$114,754.34
c) Bridge Design Assoc., Inc.	\$64,646.00
TOTAL LUMP SUM FEE	\$299,644.78
REIMBURSABLE EXPENSES	
Permit Fees (WGI)	\$0.00
Tierra, Inc.	\$17,520.00
Reproduction (WGI)	\$1,450.00
TOTAL REIMBURSABLE EXPENSES	\$18,970.00
OPTIONAL SERVICES	\$0.00
TOTAL MAXIMUM LIMITING FEE	\$318,614.78

7/31/2008 . Printed Date * 3.0% multiple

