

II. FISCAL IMPACT ANALYSIS

A. Five Year Summary of Fiscal Impact:

Fiscal Years	2009	2010	2011	2012	2013
Capital Expenditures	\$243,811	0	0	0	0
Operating Costs	_____	0	0	0	0
External Revenues	_____	0	0	0	0
Program Income (County)	_____	0	0	0	0
In-Kind Match (County)	_____	0	0	0	0
NET FISCAL IMPACT	<u>\$243,811</u>	_____	_____	_____	_____
# ADDITIONAL FTE POSITIONS (Cumulative)	_____	_____	_____	_____	_____

Is Item Included in Current Budget? Yes x No _____

Budget Account No: Fund 3700 Dept 441 Unit F093 Object 6505

Reporting Category _____
 Construction \$ 199,811
 Staff Cost 44,000
 Total \$ 243,811

B. Recommended Sources of Funds/Summary of Fiscal Impact:

Ad Valorem Taxes - MSTU

III. REVIEW COMMENTS:

A. OFMB Fiscal and/or Contract Development and Control Comments:

Jan Owl 29-09
 OFMB
 2/9/09 (NO) CN
 2/10/09 2/16/09

Dr. J. Judd 2/19/09
 Contract Administrator
 E. Jones 2/19/09

B. Legal Sufficiency:

James C. King 2/10/09
 Assistant County Attorney

This item complies with current County policies.

C. Other Department Review:

Herman Brice
 Chief Herman W Brice, Administrator

This summary is not to be used as a basis for payment.

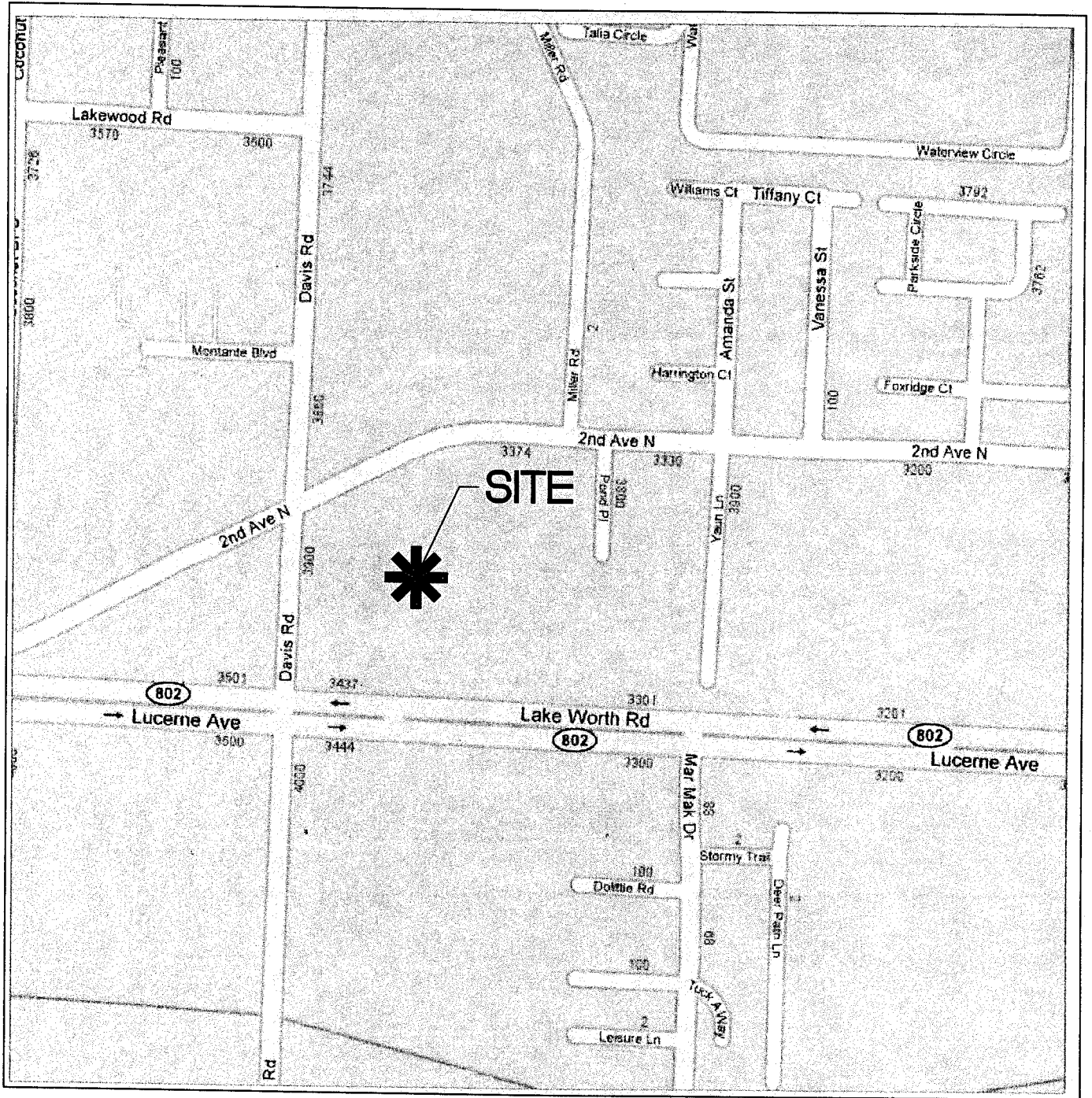

LOCATION MAP

N.T.S.

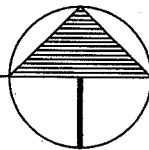

ATTACHMENT # 1

FACILITIES DEVELOPMENT & OPERATIONS
BUDGET AVAILABILITY STATEMENT

REQUEST DATE: 01/13/09

REQUESTED BY: Anil Patel

PHONE: 233-0271

FAX: 233-0270

PROJECT TITLE: Fire Station #31 - Lake Worth

PROJECT NO.: 08210

ORIGINAL CONTRACT AMOUNT:

BCC RESOLUTION#: _____
DATE: _____

REQUESTED AMOUNT: \$199,811

CSA or CHANGE ORDER NUMBER: CSA #2

CONSULTANT/CONTRACTOR: MPA Architects

PROVIDE A BRIEF STATEMENT OF THE SCOPE OF SERVICES TO BE PROVIDED BY THE CONSULTANT/CONTRACTOR:

CSA No. 2: Professional architectural and engineering services for the design, development of construction documents, permitting, bidding and construction phase services for the replacement of the existing ±5,600 sq. ft. fire station.

CONSTRUCTION	\$199,811
PROFESSIONAL SERVICES	
STAFF COSTS** (CONSTRUCTION PHASE)	\$ 44,000
MISC. (permits, prints, advertising, etc)	\$243,811
TOTAL	

** By signing this BAS your department agrees to these staff costs and your account will be charged upon receipt of this BAS by FD&O. Unless there is a change in the scope of work, no additional staff charges will be billed.

BUDGET ACCOUNT NUMBER (IF KNOWN)

FUND: 3700 DEPT: 441 UNIT: F093 OBJ: 6505

FUNDING SOURCE (CHECK ALL THAT APPLY): AD VALOREM OTHER

FEDERAL/DAVIS BACON

BAS APPROVED BY: John A. Mc

DATE: 1/14/09

ENCUMBRANCE NUMBER: _____

ATTACHMENT # 2

CONSULTANT SERVICES AUTHORIZATION

MPA ARCHITECTS, INC.

**FIRE STATION NO. 31
PROJECT NO. 08210**

This consultant services authorization is for architectural and engineering services for the Fire Station No. 31 located at 3439 Lake Worth Road in Lake Worth.

Professional services shall include professional architectural and engineering services relative to the design, development of construction documents, permitting, bidding and construction phase services for the replacement of the existing $\pm 5,600$ sq. ft. fire station.

Replacement of Fire Station No. 31 is part of Fire-Rescue's Capital Program and the new station will be designed to comply with current Fire-Rescue standards. In addition, the new fire-station will be designed to comply with USGBC (LEED) standards.

SBE participation for this Authorization is 69%. When added to the Consultant's participation to date, the resulting SBE participation is 76%. The Consultant's contract goal is 80%.

ATTACHMENT # 3

CONSULTANT SERVICES AUTHORIZATION

CONSULTANT SERVICES AUTHORIZATION

MPA ARCHITECTS, INC.
Annual Fire-Rescue Consultant

FIRE STATION NO. 31
PROJECT NO. 08210
DISTRICT NO. 3

THIS AUTHORIZATION NO. 2 to the Contract dated 3/13/07 (R-2007-0394) between Palm Beach County and the Consultant identified herein is for the Consultant Services described in Item 3 of this Authorization.

1. **CONSULTANT:** **MPA ARCHITECTS, INC.**
1801 CENTREPARK DRIVE EAST, SUITE 175
WEST PALM BEACH, FL 33401
2. **Services completed to date:** Not applicable. This authorization is for a new project.
3. **Description of Services to be provided by Consultant:** Professional services shall include architectural and engineering services relative to the design, development of construction documents, permitting, bidding and construction phase services for the replacement of the existing $\pm 5,600$ sq. ft. fire station as detailed on the attached proposal dated January 27, 2009.
4. **History:** Not applicable. This authorization is for a new project.
5. **Time of Commencement:** Consultant shall begin work promptly on the requested services upon receipt of this executed document which shall constitute official "Notice to Proceed".
6. **Compensation:** The compensation to be paid to the Consultant for the requested services shall be:

Lump Sum charge of \$199,811
7. **This Authorization may be terminated by the County without cause or prior notice. In the event of termination not the fault of the Consultant, the Consultant shall be compensated for all services performed to termination date, together with reimbursable expenses (if applicable) then due.**

Consultant agrees to waive any and all claims for lost profits or anticipated future profits in the event of a termination with or without the cause under this Contract.

6

8. If not previously provided or for a new project, the Consultant shall provide County with an executed Conflict of Interest Disclosure Form, attached hereto and incorporated herein.
9. **EXCEPT AS HEREBY AMENDED, CHANGED OR MODIFIED**, all other terms and conditions of the original Contract remain in full force and effect.

IN WITNESS WHEREOF, this Authorization is accepted, subject to the terms and conditions of the aforementioned Contract.

COUNTY

ATTEST:
Sharon R. Bock, Clerk & Comptroller

PALM BEACH COUNTY
BOARD OF COUNTY COMMISSIONERS

By: _____
Deputy Clerk

By: _____
John F. Koons, Chairman

CONSULTANT

MPA ARCHITECTS, INC.

WITNESS:
APatel

By: [Signature]
Name: RICHARD J. LOGAN

ANIL PATEL
Name (type or print)

Title: PRESIDENT

Date: 1/27/09.

Approved as to Form and Legal Sufficiency

Approved as to terms and conditions

Assistant County Attorney

[Signature]
Director - F D & O

Est. 1959

License #

AAC000630

1801 Centrepark
Drive East
Suite 175
West Palm Beach
FL 33401

(561) 683-7000

Fax

(561) 478-3922

E-Mail

info@mpa-pb.com

January 27, 2009

Mr. Anil Patel, R.A., Project Manager
CAPITAL IMPROVEMENTS DIVISION
FACILITIES DEVELOPMENT & OPERATIONS DEPARTMENT
2633 Vista Parkway
West Palm Beach, FL 33411-5604

**Re: Revised Proposal for Professional Architectural/Engineering Services
Palm Beach Fire Rescue
Fire Station #31 Replacement**

Dear Mr. Patel:

MPA would like to thank you for the opportunity to present the following proposal to Palm Beach County Capital Improvements Division for the replacement of Fire Station No. 31. The existing $\pm 5,600$ fire station is located on a site between Lake Worth Road and 2nd Avenue. The site is $\pm 100\%$ paved over and has several adverse soil conditions including, but not limited to, peat, buried debris (cars, bikes, washing machines, etc.) and possible petroleum contaminants. There are three monitoring wells shown on the survey by Brown & Philips. It is our understanding that the project will be designed to comply with House Bill 7135 which states that all county and municipal buildings shall be constructed to meet the USGBC (LEED) or any other nationally recognized green building rating system. The effective date of HB7135 was July 1, 2008.

The following is our proposed scope of services:

- I. Schematic Design Phase
 - A. Facilitate kick off meeting with Owner and consultants to establish green building (LEED) expectations.
 - B. Review and redesign (if required) Owner supplied site plan to comply with LEED approach.
 - C. Supply exterior building redesign drawings as required for site plan approval and LEED requirements.
 - D. Coordinate all consultants' site plan submittal requirements for use by Palm Beach County site plan approval consultant.

Mr. Patel
January 27, 2008
Page 2

- E. Attend meetings with Village of Palm Springs and Owner's consultant during site plan approval process (Item VII - 3).
- F. Submit schematic design documents to and meet with Palm Beach County to review program requirements.
- G. Incorporate any revisions from F.

II. Design Development Phase

- A. Based on approved schematic design submittal, prepare design development drawings for architectural, civil engineering, landscape and irrigation as applicable (Note: site plan approval process requires extensive civil and landscape documents at schematic design phase), structural engineering, mechanical, electrical, plumbing engineering and specifications.
- B. At 50% design development, meet with Owner and consultants to review green building (LEED) design objectives.
- C. Submit design development documents to and meet with Palm Beach County to review.
- D. Incorporate any revisions from C.

III. Construction Document Phase

- A. Based on approved design development documents, prepare 50% construction documents including architectural, civil, landscape and irrigation, structural engineering, mechanical, electrical, plumbing engineering and specifications.
- B. Submit 50% construction documents to and meet with Palm Beach County to review.
- C. Meet with Owner and consultants to review green building (LEED) design objectives.

Mr. Patel

January 27, 2008

Page 3

- D. Based on approved 50% construction documents, prepare 95% construction documents including architectural, civil, landscape and irrigation, structural engineering, mechanical, electrical, plumbing engineering and specifications.
- E. Prepare preliminary estimate of probable construction cost based on 95% construction documents.
- F. Submit 95% construction documents to and meet with Palm Beach County to review and submit for permitting.
- G. Based on 95% construction document review and permit comments, complete 100% construction documents for bidding.
- H. Collect and complete all LEED templates for USGBC certification (to meet the intent of HB7135).

IV. Bidding Phase

- A. Submit one original copy of 100% construction documents (plans and specifications) to Palm Beach County for reproduction for bidding phase.
- B. Prepare addenda as required during the bidding phase that address contractor RFIs.

V. Construction Administration Phase

- A. Conduct two job site meetings per month with Owner and Contractor. One meeting will focus on review of Contractor's pay application and one meeting will focus on Contractor's progress. One meeting will be extended to accommodate a second meeting to coordinate LEED requirements mentioned in item B.
- B. Facilitate meetings with consultants, Owner and Contractor to assure that the project is being constructed by the USGBC (LEED) requirements by LEED consultant.
- C. Review shop drawing submittals.

Mr. Patel
January 27, 2008
Page 4

- D. Respond to RFIs from General Contractor.
- E. Review change order request and provide justification to Owner.
- F. Prepare punch list at substantial completion.
- G. Prepare substantial and final completion documents.

VI. Items Specifically Excluded

- A. Re-zoning, plat/unity of title services, site plan approval services or any services required in the due diligence report.
- B. Site surveys.
- C. Geotechnical services.
- D. Variances.
- E. Traffic study services.
- F. Site environmental or asbestos studies related to demolition of existing building.
- G. Any services not mentioned in this proposal.

VII. Compensation

A. The services described in paragraphs 1 through 4 shall be performed in accordance with the Continuing Contract Agreement Between Palm Beach County and MPA Architects, Inc. for a fixed fee of \$199,811.

1. Basic Fee: Based on DMS fee guidelines, 5,600 sf x \$200/sf = \$1,120,000. \$1,120,000 x 8.33366% (B curve) = \$93,337

Basic Fee \$ 93,337.00
Architectural, Structural, MEP Engineering

Mr. Patel
January 27, 2008
Page 5

2.	Additional Services (per DMS guidelines):	
	Civil Engineering	\$ 18,500.00
	Site Structural	\$ 3,700.00
	Landscape	\$ 4,914.00
	Irrigation	\$ 4,350.00
	Vehicle Fueling System	\$ 2,000.00
	Cost Estimate (CD stage)	\$ 2,500.00
	Demolition Plan/Spec	\$ 2,000.00
	Site Lighting	\$ 2,500.00
	Voice/Data System, Signalization @ L.W.R.D. (electrical panel, conduit, pull box)	\$ 2,700.00
	Graphic, Signage, Room Identity	\$ N/C
	Record Drawings 68 Sheets x .50 x \$90	\$ 3,060.00
	Facilitate County Art Coordinator	\$ N/C
	Expenses	\$ 2,000.00
	Subtotal	\$ 48,224.00
	MPA Administration @ 20%	\$ 9,645.00
		\$ 57,869.00

3. Palm Springs Approval Process

Architectural	
3 Meetings x 2 Hours x \$150.00	\$ 900.00
Landscape	
2 Meetings x 2 Hours x \$130.00	\$ 520.00
Civil	
2 Meetings x 2 Hours x \$140.00	\$ 560.00
Renderings	\$ 2,000.00
Subtotal	\$ 3,980.00

4. Additional services required to provide a LEED certifiable project per HB7135, page 51, Section 22, paragraph (2). See attached proposals for scope of work breakdowns.

- a. MPA Architects, Inc. will facilitate all LEED meetings and be directly involved

Mr. Patel
January 27, 2008
Page 6

- involved in all aspects with respect to the LEED design issues and preparation of LEED specification requirements during design and construction \$ 9,500.00
- b. Sequil - (LEED consultant) will provide the fundamental building commissioning services (a prerequisite), register the project with USGBC and collect all data from consultants and fill out LEED template documents \$ 20,825.00
- c. Bridge Design will supply calculation input for recycled and regional material \$ 950.00
- d. JLRD will provide LEED services related to sustainable sites, water efficiency, energy, atmosphere and indoor environmental quality \$ 11,400.00
- e. Civil Design, Inc. will provide LEED services applicable to sustainable site and civil engineering items In Basic Fee
- f. Landscape Architecture (Roy-Fisher) \$ 950.00
- g. Irrigation Design (NSA) \$ 1,000.00
- Subtotal \$ 44,625.00

VIII. Owner Supplied Items

- A. CADD drawing files for prototype fire station for consultant's use.
- B. All printing for bidding and construction.
- C. Any additional survey, geotechnical and/or environmental studies related to the site or building demolition (asbestos studies, etc.).

Mr. Patel
January 27, 2008
Page 7

IX. Additional Services

- A. Any services not specifically mentioned as provided.

Respectfully,

MPA ARCHITECTS, INC.

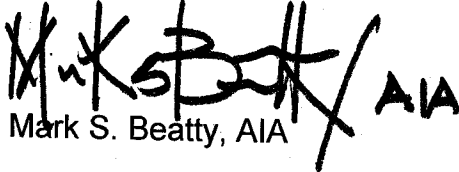
 AIA
Mark S. Beatty, AIA

Enclosures

O:\0821\0821agree\FireStation#31ReplacementRevised4.wpd



MPA ARCHITECTS, INC.

ARCHITECTS • PLANNERS • INTERIOR DESIGNERS

Est. 1959
License #
AAC000630

1801 Centrepark
Drive East
Suite 175
West Palm Beach
FL 33401

(561) 683-7000
Fax

(561) 478-3922
E-Mail

info@mpa-pb.com

EXHIBIT "A"
FEE BREAKDOWN BY CONSULTANT
FIRE STATION #31 REPLACEMENT

I. BASIC SERVICE

MPA (Architectural).....	\$ 63,137.00
JLRD (MEP Engineering)	\$ 22,400.00
Bridge Design (Structural)	\$ 7,800.00

II. ADDITIONAL SERVICES

Civil Design (Civil Engineering).....	\$ 18,500.00
Bridge Design (Site Structural)	\$ 3,700.00
Roy-Fisher (Landscape Architecture)	\$ 4,914.00
NSA (Irrigation Design).....	\$ 4,350.00
MPA (Vehicle Fueling System).....	\$ 2,000.00
Owner/Builder Consulting (Cost Estimating).....	\$ 2,500.00
MPA (Demolition Plan/Spec)	\$ 2,000.00
JLRD (Site Lighting).....	\$ 2,500.00
JLRD (Voice/Data Systems)	\$ 2,700.00
MPA (Administration).....	\$ 9,645.00
Project Expenses (Expenses, Record Drawings)	\$ 5,060.00

III. PALM SPRINGS APPROVAL

MPA (Architectural & Rendering).....	\$ 2,900.00
Roy-Fisher (Landscape)	\$ 520.00
Civil Design (Civil Engineering).....	\$ 560.00

IV. USGBC LEED SERVICES

MPA (Architectural).....	\$ 9,500.00
Sequil (LEED Consultant).....	\$ 20,825.00
Bridge Design (Structural)	\$ 950.00
JLRD (MEP).....	\$ 11,400.00
Roy-Fisher (Landscape)	\$ 950.00
NSA (Irrigation Design).....	\$ 1,000.00

5



Exhibit "A"
Fee Breakdown by Consultant
Fire Station #31 Replacement
Page 2

RECAP

MPA (Architectural) (SBE).....	\$ 89,182.00
JLRD (MEP Consultant).....	\$ 39,000.00
Civil Design (SBE).....	\$ 19,060.00
Roy-Fisher (Landscape) (SBE).....	\$ 6,384.00
NSA (Irrigation) (SBE).....	\$ 5,350.00
Bridge Design (Structural) (SBE).....	\$ 12,450.00
Sequil (LEED Consultant).....	\$ 20,825.00
Owner Builder (Cost Estimate).....	\$ 2,500.00
Expenses.....	\$ 5,060.00
TOTAL.....	<u>\$199,811.00</u>

O:\0821\0821agree\ExhibitA.wpd

14

SCHEDULE 1

LIST OF PROPOSED SBE-M/WBE SUBCONSULTANTS

PROJECT NAME: FIRE STATION NO. 31 REPLACEMENT PROJECT NO. 08210

NAME OF PRIME CONSULTANT: MPA ARCHITECTS, INC.

DESCRIPTION OF WORK: ARCHITECTURAL/ENGINEERING DESIGN SERVICES

PLEASE IDENTIFY ALL APPLICABLE CATEGORIES OF SUBCONSULTANTS

Name, Address and Phone Number	(Check one or both Categories)		Subcontract Amount				
	Minority Business	Small Business	Black	Hispanic	Women	Caucasian	Other (Please Specify)
1. MPA Architects, Inc. 1801 Centrepark Drive East, Suite 175 West Palm Beach, FL 33401 561-683-7000	<input checked="" type="checkbox"/>	<input checked="" type="checkbox"/>	\$ 94,242.00				
2. Civil Design, Inc. 120 S. Olive Avenue, Suite 403 West Palm Beach, FL 33401 561-659-5760	<input type="checkbox"/>	<input checked="" type="checkbox"/>				\$ 19,060.00	
3. Roy-Fisher Associates, Inc. 381 Tequesta Drive Tequesta, FL 33469 561-747-3462	<input checked="" type="checkbox"/>	<input type="checkbox"/>			\$ 6,384.00		
4. Neal, Smith & Associates 7901 Pine Tree Lane West Palm Beach, FL 33406 561-586-6633	<input type="checkbox"/>	<input checked="" type="checkbox"/>				\$ 5,350.00	
5. Bridge Design, Inc. 1402 Royal Palm Beach Blvd., Bldg. 200 Royal Palm Beach, FL 33411 561-686-3660	<input type="checkbox"/>	<input checked="" type="checkbox"/>				\$ 12,450.00	
(Please use additional sheets if necessary)			Total				
			\$ 94,242.00		\$ 6,384.00	\$ 36,860.00	

Total Price \$ \$199,811.00 Total SBE Participation \$ \$137,486.00 SBE % 68.80%

Note: 1. The amounts listed on this form must be supported by the Subconsultant prices included on Schedule 2 in order to be counted toward goal attainment.
 2. Firms may be certified by Palm Beach County as an SBE and/or M/WBE. If firms are certified as both an SBE and M/WBE, please indicate the dollar amount under the appropriate category.
 3. M/WBE information is being collected for tracking purposes only.

17

SCHEDULE # 2

LETTER OF INTENT TO PERFORM AS AN SBE OR M/WBE SUBCONSULTANT

PROJECT NO. 08210 PROJECT NAME: Palm Beach County Fire Rescue – Fire Station 31

TO: MPA Architects, Inc.

The undersigned is certified by Palm Beach County as a (check one):

Small Business Enterprise Black Business Enterprise Hispanic Business Enterprise

Women Business Enterprise Other (Please Specify)

Date of Palm Beach County Certification: March 2, 2007

The undersigned is prepared to perform the following described work in connection with the above project (Specify in detail particular work items or parts thereof to be performed):

Civil Engineering services (water, sewer, paving & drainage) to include design and construction phase services.

and will enter into a formal agreement for work with you conditioned upon your execution of a contract with Palm Beach County.

If undersigned intends to sub-subcontract any portion of this subcontract to a non-certified SBE subcontractant, the amount of any such subcontract must be stated: \$ NA

The undersigned subcontractant understands that the provision of this form to prime consultant does not prevent subcontractant from providing services to other consultants.

Civil Design Inc.

(Print name of SBE-M/WBE Subconsultant)

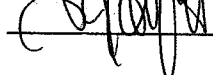
By:  (Signature)

T. Jeff Trompeter, President

(Print name/title of person executing on behalf of SBE-M/WBE Subconsultant)

Date: 12/15/08

SCHEDULE #2

LETTER OF INTENT TO PERFORM AS AN SBE OR M/WBE SUBCONSULTANT

PROJECT NO. N/A

PROJECT NAME: Palm Beach County Fire Station 31

TO: MPA Architects, Inc.
(Name of Prime Consultant)

The undersigned is certified by Palm Beach County as a(n) - (check one or more, as applicable):

Small Business Enterprise _____ Minority Business Enterprise X
Black _____ Hispanic _____ Women X Caucasian _____ Other (Please Specify) _____

Date of Palm Beach County Certification: March 17, 2007-March 16, 2010

The undersigned is prepared to perform the following described work in connection with the above project
(Specify in detail, particular work items or parts thereof to be performed):

Landscape Architecture: Planting, Paving Layout, Irrigation Design, Construction Documents and Construction Administration

and will enter into a formal agreement for work with you conditioned upon your execution of a contract with Palm Beach County.

If undersigned intends to sub-subcontract any portion of this subcontract to a non-certified SBE subcontractor, the name of any such subcontract must be stated:

The undersigned subcontractant understands that the provision of this form to prime Consultant does not prevent subcontractant from providing quotations to others.

Roy-Fisher Associates, Inc.
(Print name of SBE-M/WBE
Subconsultants)

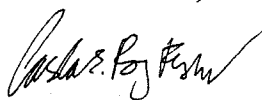
By: 
(Signature)

Constance Roy-Fisher
(Print name/title of person executing on
behalf of SBE-M/WBE Subconsultant)

Date: December 16, 2008

SCHEDULE # 2

LETTER OF INTENT TO PERFORM AS AN SBE OR M/WBE SUBCONSULTANT

PROJECT NO. 08210 PROJECT NAME: Palm Beach County Fire Rescue - Fire Station 31

TO: MPA Architects, Inc.
(Name of Prime Consultant)

The undersigned is certified by Palm Beach County as a(n) - (check one or more, as applicable):

Small Business Enterprise Minority Business Enterprise

Date of Palm Beach County Certification: March 2, 2007

The undersigned is prepared to perform the following described work in connection with the above project (Specify in detail particular work items or parts thereof to be performed):

Landscape Irrigation System Design

and will enter into a formal agreement for work with you conditioned upon your execution of a contract with Palm Beach County.

If undersigned intends to sub-subcontract any portion of this subcontract to a non-certified SBE subcontractant, the amount of any such subcontract must be stated: \$ N/A

The undersigned subcontractant understands that the provision of this form to prime consultant does not prevent subcontractant from providing services to other consultants.

Neal, Smith & Associates
(Print name of SBE-M/WBE Subconsultant)

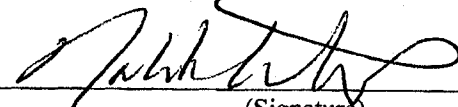
By: 
(Signature)

Robert C. Smith -Principal
(Print name/title of person executing on behalf of SBE-M/WBE Subconsultant)

Date: December 30, 2008

20

SCHEDULE # 2

LETTER OF INTENT TO PERFORM AS AN SBE OR M/WBE SUBCONSULTANT

PROJECT NO. 08210

PROJECT NAME: Fire Station No. 31

TO: MPA ARCHITECTS (Name of Prime Consultant)

The undersigned is certified by Palm Beach County as a(n) - (check one or more, as applicable):

Small Business Enterprise X Minority Business Enterprise

Black Hispanic Women Caucasian X Other (Please Specify)

Date of Palm Beach County Certification: October 24, 2007

The undersigned is prepared to perform the following described work in connection with the above project (Specify in detail particular work items or parts thereof to be performed):

Structural Engineering

at the following price \$ 12,450.00 (Subconsultant's fee)

and will enter into a formal agreement for work with you conditioned upon your execution of a contract with Palm Beach County.

If undersigned intends to sub-subcontract any portion of this subcontract to a non-certified SBE subconsultant, the amount of any such subcontract must be stated: \$ 0.00

The undersigned subconsultant understands that the provision of this form to prime consultant does not prevent subconsultant from providing services to other consultants.

BRIDGE DESIGN ASSOCIATES, INC. (Print name of SBE-M/WBE Subconsultant)

By: [Signature] (Signature)

Brian C. Rheault, P.E., President (Print name/title of person executing on behalf of SBE-M/WBE Subconsultant)

Date: January 27, 2009