

II. FISCAL IMPACT ANALYSIS

A. Five Year Summary of Fiscal Impact:

Fiscal Year	2009	2010	2011	2012	2013
Capital Expenditures	\$840,958.07	0	0	0	0
Operating Costs	0	0	0	0	0
External Revenues	0	0	0	0	0
Program Income (County)	0	0	0	0	0
In-Kind Match (County)	0	0	0	0	0
NET FISCAL IMPACT	\$840,958.07	0	0	0	0

Additional FTE Positions (Cumulative) — — — —

Is Item Included in Current Budget? Yes X No

Budget Account No: 3804-411-B433-02-4907 (\$440,000.00)
 3804-411-B420-4907 (\$400,958.07)

Reporting Category _____

B. Recommended Sources of Funds/Summary of Fiscal Impact:

\$440,000.00 is from the PBSO budget.
 \$400,958.07 is from the Renewal/Replacement Fund

C. Departmental Fiscal Review: _____

III. REVIEW COMMENTS

A. OFMB Fiscal and/or Contract Development & Control Comments:

[Signature] 9/2/09
 OFMB *OK* 08/31/09 *OK* 09/2/09 *OK* 8/29/09

[Signature] 9/3/09
 Contract Dev. and Control

This item complies with current County policies.

A. Legal Sufficiency:

[Signature] 9/4/09
 Assistant County Attorney

A. Other Department Review:

 Department Director

Palm Beach County Sheriff's Office
3228 Gun Club Road
West Palm Beach, FL 33406

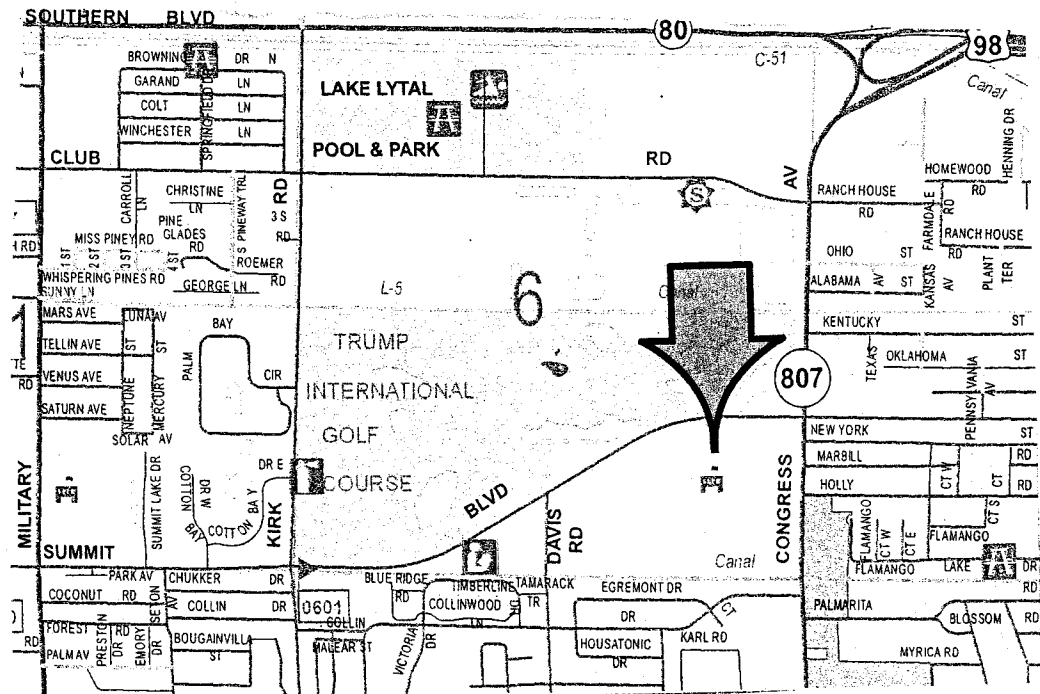

ATTACHMENT #1

August 11, 2009	JOC Work Order Job Order Construction Services	
08631.01	PBSO - ISS HVAC CJC Bldg A, Administration, 3228 Gun Club Road 3228 Gun Club Road, WEST PALM BEACH	

Brief Description: Provide ISS HVAC.

Contractor: HA Contracting Corp.
9500 NW 12th Street
Miami, FL 33172
Contract: R-2007-0944 Dated June 17, 2009



AMOUNT: \$ 750,855.27 DISTRICT: 2

Funding: 3804-411-B433-02-4907 \$440,000; 3804-411-B420-4907
\$400,958.07

JOC Work Order #: 09-147

Project Duration: 9 Months (Liquidated damages will apply)

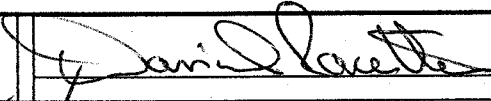
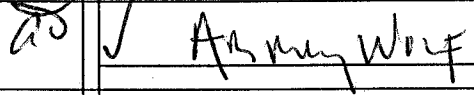
Approval Signatures

Daniel Racette, Project Coordinator		8-11-09 Date
Audrey Wolf, Director Facilities Development & Operations		8/25/09 Date
Chair Contract Review Committee	(NOT REQUIRED FOR PROJECTS <\$100,000 OR >\$200,000)	
Approved as to form and legal sufficiency County Attorney		Date
John F. Koons, Chairman Board of County Commissioners		Date
President HA Contracting Corp.		8-11-09 Date

COPY: Project File

ATTACHMENT #2

Job Order Contract

Proposal Review - CSI Summary

Date August 13, 2009
Job Order Number: 08631.01
Job Order Name: PBSO - ISS HVAC
Review: PBSO - ISS HVAC - 8/7/2009 2:24:29PM

Section 01	Subtotal for 01	\$97,777.83
Section 02	Subtotal for 02	\$14,350.22
Section 03	Subtotal for 03	\$1,859.89
Section 05	Subtotal for 05	\$5,230.69
Section 07	Subtotal for 07	\$16,256.48
Section 09	Subtotal for 09	\$9,857.59
Section 10	Subtotal for 10	\$5,352.18
Section 15	Subtotal for 15	\$527,559.86
Section 16	Subtotal for 16	\$71,690.53
Section 18	Subtotal for 18	\$920.00
Proposal Review Total		\$750,855.27

This job order proposal total represents the correct total for the proposal. Any discrepancy between line totals, sub-totals and the proposal total is due to rounding of the line totals and sub-totals.

ATTACHMENT #3

Job Order Contract
Proposal Review - CSI Detail

Date August 13, 2009
 Job Order Number: 08631.01
 Job Order Name: PBSO - ISS HVAC
 Review: PBSO - ISS HVAC - 8/7/2009 2:24:29PM

Sect.	Item	Mod.	UOM	Description	Line Total		
Section 01							
1	01204	1001	EA	Reimbursable Fees	\$15,842.00		
				Quantity	Unit Price	Factor	Total
				Installation 158.42 x	100.00 x	1.0000 =	\$15,842.00
				Permit Fees			
2	01352	1051	HR	Carpenter, Note: Line items in the CTC include appropriate costs to cover labor. These items will be requested specifically by the owner for miscellaneous work not covered in the CTC.	\$4,634.95		
				Quantity	Unit Price	Factor	Total
				Installation 180.00 x	23.86 x	1.0792 =	\$4,634.95
				Ceiling modifications			
3	01352	1091	HR	Electrician, Note: Line items in the CTC include appropriate costs to cover labor. These items will be requested specifically by the owner for miscellaneous work not covered in the CTC.	\$6,729.03		
				Quantity	Unit Price	Factor	Total
				Installation 160.00 x	38.97 x	1.0792 =	\$6,729.03
				Deactivate & reactivate exist. Halon sys., R/R exist detectors & speakers			
4	01352	1201	HR	Painter, Ordinary, Note: Line items in the CTC include appropriate costs to cover labor. These items will be requested specifically by the owner for miscellaneous work not covered in the CTC.	\$1,140.93		
				Quantity	Unit Price	Factor	Total
				Installation 40.00 x	26.43 x	1.0792 =	\$1,140.93
				T/Up walls			
5	01352	1311	HR	Sheet Metal Worker, Note: Line items in the CTC include appropriate costs to cover labor. These items will be requested specifically by the owner for miscellaneous work not covered in the CTC.	\$7,007.03		
				Quantity	Unit Price	Factor	Total
				Installation 160.00 x	40.58 x	1.0792 =	\$7,007.03
				Fabricate Pipe hangers			
6	01352	3020	HR	Programming And Certification Of New Devices To Existing Panels	\$46,621.44		
				Quantity	Unit Price	Factor	Total
				Installation 360.00 x	120.00 x	1.0792 =	\$46,621.44
				Fire Alarm Allowance			
7	01510	2015	EA	20 CY Dumpster (7 Ton Capacity) "Construction Debris" Note: Price Includes Service To Deliver And Pick-up Of Dumpster, Hauling Of Debris, Rental Of Dumpster And Disposal Fee.	\$1,375.98		
				Quantity	Unit Price	Factor	Total
				Installation 3.00 x	425.00 x	1.0792 =	\$1,375.98
8	01560	4001	LF	Temporary Safety Fence, Plastic Mesh, 48" High With Posts At 8' On Center	\$111.16		
				Quantity	Unit Price	Factor	Total
				Installation 100.00 x	1.03 x	1.0792 =	\$111.16
9	01560	5101	SF	Temporary Stud Wall, Includes 5/8" Gypsum Board On One Side, Wood Studs At 16" O.C., Taped And Finished, One Coat Of Flat Paint. Remove After Use	\$917.32		
				Quantity	Unit Price	Factor	Total
				Installation 500.00 x	1.70 x	1.0792 =	\$917.32
				Temp dust barriers			
10	01560	5302	SF	1/2" Plywood For Floor Protection	\$1,003.66		
				Quantity	Unit Price	Factor	Total
				Installation 3,000.00 x	0.31 x	1.0792 =	\$1,003.66

Proposal Review - CSI Detail (Continued)

Job Order Number: 08631.01

Job Order Name: PBSO - ISS HVAC

Review: PBSO - ISS HVAC - 8/7/2009 2:24:29PM

11	01560	7129	WK	Type II Traffic Control Barricade, 2' Wide x 3' High A-Frame, 2 2' Wide x 8" High ReflectORIZED Rails Each Side					\$1,113.09	
				Installation	Quantity	Unit Price	Factor	Total		
					60.00	17.19	1.0792 =	\$1,113.09		
12	01590	9118	WK	50 Ton Lift Hydraulic Crane, With Full-Time Operator					\$5,677.38	
				Installation	Quantity	Unit Price	Factor	Total		
					1.00	5,260.73	1.0792 =	\$5,677.38		
13	01590	9702	WK	4000 To 5999 LB Forklift With Full-Time Operator					\$1,514.27	
				Installation	Quantity	Unit Price	Factor	Total		
					1.00	1,403.14	1.0792 =	\$1,514.27		
14	01591	3134	DAY	3 Ton Flat Bed Truck, 4 x 2, With Full-Time Truck Driver Note: Includes hydraulic tiltbed.					\$512.27	
				Installation	Quantity	Unit Price	Factor	Total		
					1.00	474.68	1.0792 =	\$512.27		
				Transfer removed split unit to surplus						
15	01591	4103	EA	40 To 50 Ton Move On/Off Cost, Truck Mounted Crane					\$453.44	
				Installation	Quantity	Unit Price	Factor	Total		
					1.00	420.16	1.0792 =	\$453.44		
16	01591	4207	EA	Backhoe, Dozer Or Roller > 250 HP Delivery/Mob/Demob Note: Use for backhoe, dozer, roller, loader, excavator or similar sized equipment. Includes delivery fee, delivery, set-up and return.					\$506.82	
				Installation	Quantity	Unit Price	Factor	Total		
					1.00	469.63	1.0792 =	\$506.82		
				Fork lift delivery						
17	01740	1111	CSF	Clean Miscellaneous Surfaces, Wipe Down With Mild Detergent					\$2,617.06	
				Installation	Quantity	Unit Price	Factor	Total		
					500.00	4.85	1.0792 =	\$2,617.06		

Subtotal for 01 \$97,777.83

Section 02

18	02112	1111	SY	Break-up 1" To 3" Thick Bituminous Pavement					\$119.58	
				Installation	Quantity	Unit Price	Factor	Total		
					40.00	2.77	1.0792 =	\$119.58		
				Remove asphalt und. new cond. conc. pad						
19	02112	6001	LF	Saw Cut Bituminous Paving Up To 4" (10 cm) Depth					\$94.97	
				Installation	Quantity	Unit Price	Factor	Total		
					100.00	0.88	1.0792 =	\$94.97		
				Saw cut asphalt for new cond. pads						
20	02112	6041	EA	Saw Cut Minimum Charge For projects where the total saw cutting charge is less than the minimum charge. Use this item exclusively. This item should not be used in conjunction with any other items in this section.					\$374.19	
				Installation	Quantity	Unit Price	Factor	Total		
					1.00	346.73	1.0792 =	\$374.19		
21	02112	7142	EA	Drill 3" (76 mm) Diameter Core In 10" (25 cm) Concrete					\$2,200.53	
				Installation	Quantity	Unit Price	Factor	Total		
					48.00	42.48	1.0792 =	\$2,200.53		
22	02112	7143	EA	Drill 4" (10 cm) Diameter Core In 10" (25 cm) Concrete					\$4,540.80	
				Installation	Quantity	Unit Price	Factor	Total		
					84.00	50.09	1.0792 =	\$4,540.80		
23	02119	1201	CY	Dump Fee, Traditional Materials, Building Construction Materials					\$809.40	
				Installation	Quantity	Unit Price	Factor	Total		
					60.00	12.50	1.0792 =	\$809.40		

Proposal Review - CSI Detail (Continued)

Job Order Number: 08631.01

Job Order Name: PBSO - ISS HVAC

Review: PBSO - ISS HVAC - 8/7/2009 2:24:29PM

24	02119	2001	CYM	Hauling On Paved Roads, First 15 Miles					\$388.51
				Installation	Quantity	Unit Price	Factor	Total	
					900.00	0.40	1.0792 =	\$388.51	
25	02720	1102	LF	6" Steel Pipe Bollard, Schedule 40, Painted Or Powder Coated					\$3,842.38
				Installation	Quantity	Unit Price	Factor	Total	
					72.00	49.45	1.0792 =	\$3,842.38	
26	02720	1102	1113	LF	For Each Surface Mounted Bollard, Add Includes base plate and anchor bolts.				\$1,979.86
				Installation	Quantity	Unit Price	Factor	Total	
					72.00	25.48	1.0792 =	\$1,979.86	
Subtotal for 02									\$14,350.22

Section 03

27	03110	1111	SF	Continuous Footings Foundation Wood Formwork					\$243.90
				Installation	Quantity	Unit Price	Factor	Total	
					100.00	2.26	1.0792 =	\$243.90	
28	03220	1001	SF	6 x 6 x #10, 21#/CSF, Welded Wire Reinforcement In Slabs, (W 1.4 x W 1.4)					\$125.36
				Installation	Quantity	Unit Price	Factor	Total	
					352.00	0.33	1.0792 =	\$125.36	
29	03302	1002	CY	Poly Fibers Reinforcing Concrete Mix - 1 1/2 Lb. Per CY					\$43.17
				Installation	Quantity	Unit Price	Factor	Total	
					8.00	5.00	1.0792 =	\$43.17	
30	03311	1161	CY	Pour Slab On Grade, < 6", Crane And Bucket, 3000 PSI Concrete					\$1,076.78
				Installation	Quantity	Unit Price	Factor	Total	
					8.00	124.72	1.0792 =	\$1,076.78	
31	03311	1161	3023	CY	For High Early Strength, Type 3 ASTM C150, Add				\$74.03
				Installation	Quantity	Unit Price	Factor	Total	
					7.00	9.80	1.0792 =	\$74.03	
32	03311	2011	CY	Delivery Fee For Concrete Purchases Per CY For Each CY Less Than 9 CY					\$129.50
				Installation	Quantity	Unit Price	Factor	Total	
					8.00	15.00	1.0792 =	\$129.50	
33	03350	1005	SF	Concrete Floor Finishes, Steel Trowel					\$167.15
				Installation	Quantity	Unit Price	Factor	Total	
					352.00	0.44	1.0792 =	\$167.15	
Subtotal for 03									\$1,859.89

Section 05

34	05502	7007	EA	3/8" Diameter x 3" Long Concrete Sleeve Anchor					\$766.23
				Installation	Quantity	Unit Price	Factor	Total	
					200.00	3.55	1.0792 =	\$766.23	
35	05506	1011	LF	Unistrut Channel 1-5/8" Wide x 1-5/8" High, 12 Gauge					\$1,265.15
				Installation	Quantity	Unit Price	Factor	Total	
					190.00	6.17	1.0792 =	\$1,265.15	
36	05506	1015	LF	Unistrut Channel 1-5/8" Wide x 13/16" High, 16 Gauge, P4000HS					\$611.26
				Installation	Quantity	Unit Price	Factor	Total	
					120.00	4.72	1.0792 =	\$611.26	
37	05506	4013	EA	Unistrut Nut Without Spring, 1-5/8" Channel 1/2"					\$579.44
				Installation	Quantity	Unit Price	Factor	Total	
					433.00	1.24	1.0792 =	\$579.44	

Proposal Review - CSI Detail (Continued)

Job Order Number: 08631.01

Job Order Name: PBSO - ISS HVAC

Review: PBSO - ISS HVAC - 8/7/2009 2:24:29PM

38	05506	5011	EA	Unistrut Beam Clamp, 1-5/8" Channel P2675						\$2,008.61
					Quantity	Unit Price	Factor		Total	
				Installation	220.00	8.46	1.0792	=	\$2,008.61	
					x	x				
									Subtotal for 05	\$5,230.69
Section 07										
39	07131	6001	CSF	10 Mil PVC Vapor Barrier						\$4,752.80
					Quantity	Unit Price	Factor		Total	
				Installation	200.00	22.02	1.0792	=	\$4,752.80	
				Temp. dust barriers						
40	07131	6001	CSF	10 Mil PVC Vapor Barrier						\$83.17
					Quantity	Unit Price	Factor		Total	
				Installation	3.50	22.02	1.0792	=	\$83.17	
				A/C conc. slab						
41	07840	1018	EA	Firestopping 3" Diameter Hole With 3/4" Pipe						\$579.66
					Quantity	Unit Price	Factor		Total	
				Installation	48.00	11.19	1.0792	=	\$579.66	
42	07840	1023	EA	Firestopping 3" Diameter Hole With 2" Pipe						\$611.85
					Quantity	Unit Price	Factor		Total	
				Installation	85.00	6.67	1.0792	=	\$611.85	
43	07840	2003	EA	3" Fire Stop Collar						\$2,158.05
					Quantity	Unit Price	Factor		Total	
				Installation	96.00	20.83	1.0792	=	\$2,158.05	
44	07840	2004	EA	4" Fire Stop Collar						\$4,465.56
					Quantity	Unit Price	Factor		Total	
				Installation	168.00	24.63	1.0792	=	\$4,465.56	
45	07840	3015	CLF	Fire Caulk And Seal, 1"x1" Joint						\$3,605.39
					Quantity	Unit Price	Factor		Total	
				Installation	5.00	668.16	1.0792	=	\$3,605.39	
									Subtotal for 07	\$16,256.48
Section 09										
46	09511	6001	SF	Remove And Reinstall Acoustical Ceiling Tile And Grid, 2x2 Or 2x4						\$3,574.70
					Quantity	Unit Price	Factor		Total	
				Installation	9,201.00	0.36	1.0792	=	\$3,574.70	
47	09910	6212	LF	Paint Conduit, Steel Pipe 2" To 3-1/2" Diameter, One Coat Primer						\$1,442.35
					Quantity	Unit Price	Factor		Total	
				Installation	2,430.00	0.55	1.0792	=	\$1,442.35	
				Paint exposed pipe insulation with latex paint						
48	09910	6222	LF	Paint Conduit, Steel Pipe 2" To 3-1/2" Diameter, One Coat Paint						\$1,442.35
					Quantity	Unit Price	Factor		Total	
				Installation	2,430.00	0.55	1.0792	=	\$1,442.35	
				Paint exposed pipe insulation with latex paint						
49	09945	1821	SF	Cut And Patch Hole To Match Existing, To 10 SF						\$3,398.18
					Quantity	Unit Price	Factor		Total	
				Installation	640.00	4.92	1.0792	=	\$3,398.18	
									Subtotal for 09	\$9,857.59
Section 10										

Proposal Review - CSI Detail (Continued)

Job Order Number: 08631.01

Job Order Name: PBSO - ISS HVAC

Review: PBSO - ISS HVAC - 8/7/2009 2:24:29PM

50	10271	4028		EA	Cut Round Hole In Raised Floor And Trim Carpet Install 4" Plastic Insert (Gromtec#GT003)					\$4,073.33	
					Quantity	Unit Price	Factor		Total		
					Installation	280.00 x	13.48 x	1.0792 =	\$4,073.33		
					Computer floor modifications						
51	10271	6001		SF	Vacuum Raised Floor Carpet Panel, Wipe Dirt/Dust From Stringers And Floor Beneath Raised Floor					\$1,278.85	
					Quantity	Unit Price	Factor		Total		
					Installation	1,500.00 x	0.79 x	1.0792 =	\$1,278.85		
Subtotal for 10									\$5,352.18		
Section 15											
52	15063	2115		EA	1-1/4" 90 Degree Elbow, Copper					\$1,151.29	
					Quantity	Unit Price	Factor		Total		
					Installation	40.00 x	26.67 x	1.0792 =	\$1,151.29		
53	15063	2115	2003	EA	For Brazed Fittings Instead Of 95/5 Solder, Add					\$132.53	
					Quantity	Unit Price	Factor		Total		
					Installation	40.00 x	3.07 x	1.0792 =	\$132.53		
54	15063	2115	2004	EA	For Street Fitting, Add					\$107.06	
					Quantity	Unit Price	Factor		Total		
					Installation	40.00 x	2.48 x	1.0792 =	\$107.06		
55	15063	2115	2006	EA	For Work In Restricted Working Space, Add					\$265.05	
					Quantity	Unit Price	Factor		Total		
					Installation	40.00 x	6.14 x	1.0792 =	\$265.05		
56	15063	2116		EA	1-1/2" 90 Degree Elbow, Copper					\$1,731.04	
					Quantity	Unit Price	Factor		Total		
					Installation	50.00 x	32.08 x	1.0792 =	\$1,731.04		
57	15063	2116	2003	EA	For Brazed Fittings Instead Of 95/5 Solder, Add					\$181.31	
					Quantity	Unit Price	Factor		Total		
					Installation	50.00 x	3.36 x	1.0792 =	\$181.31		
58	15063	2116	2004	EA	For Street Fitting, Add					\$208.83	
					Quantity	Unit Price	Factor		Total		
					Installation	50.00 x	3.87 x	1.0792 =	\$208.83		
59	15063	2116	2006	EA	For Work In Restricted Working Space, Add					\$362.61	
					Quantity	Unit Price	Factor		Total		
					Installation	50.00 x	6.72 x	1.0792 =	\$362.61		
60	15063	2118		EA	2-1/2" 90 Degree Elbow, Copper					\$1,276.69	
					Quantity	Unit Price	Factor		Total		
					Installation	20.00 x	59.15 x	1.0792 =	\$1,276.69		
61	15063	2118	2003	EA	For Brazed Fittings Instead Of 95/5 Solder, Add					\$82.88	
					Quantity	Unit Price	Factor		Total		
					Installation	20.00 x	3.84 x	1.0792 =	\$82.88		
62	15063	2118	2006	EA	For Work In Restricted Working Space, Add					\$165.77	
					Quantity	Unit Price	Factor		Total		
					Installation	20.00 x	7.68 x	1.0792 =	\$165.77		
63	15063	2185		EA	1" Straight Copper Coupling					\$1,372.74	
					Quantity	Unit Price	Factor		Total		
					Installation	60.00 x	21.20 x	1.0792 =	\$1,372.74		
64	15063	2185	2003	EA	For Brazed Fittings Instead Of 95/5 Solder, Add					\$183.90	
					Quantity	Unit Price	Factor		Total		
					Installation	60.00 x	2.84 x	1.0792 =	\$183.90		

Proposal Review - CSI Detail (Continued)

Job Order Number: 08631.01

Job Order Name: PBSO - ISS HVAC

Review: PBSO - ISS HVAC - 8/7/2009 2:24:29PM

65	15063	2185	2006	EA	For Work In Restricted Working Space, Add					\$367.14
					Installation	Quantity	Unit Price	Factor		Total
						60.00	5.67	1.0792	=	\$367.14
66	15063	2186		EA	1-1/4" Straight Copper Coupling					\$1,637.97
					Installation	Quantity	Unit Price	Factor		Total
						62.00	24.48	1.0792	=	\$1,637.97
67	15063	2186	2003	EA	For Brazed Fittings Instead Of 95/5 Solder, Add					\$205.41
					Installation	Quantity	Unit Price	Factor		Total
						62.00	3.07	1.0792	=	\$205.41
68	15063	2186	2006	EA	For Work In Restricted Working Space, Add					\$410.83
					Installation	Quantity	Unit Price	Factor		Total
						62.00	6.14	1.0792	=	\$410.83
69	15063	2188		EA	2" Straight Copper Coupling					\$292.94
					Installation	Quantity	Unit Price	Factor		Total
						8.00	33.93	1.0792	=	\$292.94
70	15063	2188	2003	EA	For Brazed Fittings Instead Of 95/5 Solder, Add					\$32.55
					Installation	Quantity	Unit Price	Factor		Total
						8.00	3.77	1.0792	=	\$32.55
71	15063	2188	2006	EA	For Work In Restricted Working Space, Add					\$65.01
					Installation	Quantity	Unit Price	Factor		Total
						8.00	7.53	1.0792	=	\$65.01
72	15063	2188		EA	2" Straight Copper Coupling					\$366.17
					Installation	Quantity	Unit Price	Factor		Total
						10.00	33.93	1.0792	=	\$366.17
73	15063	2188	2003	EA	For Brazed Fittings Instead Of 95/5 Solder, Add					\$40.69
					Installation	Quantity	Unit Price	Factor		Total
						10.00	3.77	1.0792	=	\$40.69
74	15063	2188	2006	EA	For Work In Restricted Working Space, Add					\$81.26
					Installation	Quantity	Unit Price	Factor		Total
						10.00	7.53	1.0792	=	\$81.26
75	15063	2189		EA	2-1/2" Straight Copper Coupling					\$556.35
					Installation	Quantity	Unit Price	Factor		Total
						12.00	42.96	1.0792	=	\$556.35
76	15063	2189	2003	EA	For Brazed Fittings Instead Of 95/5 Solder, Add					\$47.01
					Installation	Quantity	Unit Price	Factor		Total
						12.00	3.63	1.0792	=	\$47.01
77	15063	2189	2006	EA	For Work In Restricted Working Space, Add					\$93.89
					Installation	Quantity	Unit Price	Factor		Total
						12.00	7.25	1.0792	=	\$93.89
78	15063	5004		LF	1" Inside Diameter (25 mm) Copper Pipe/Tubing Type L, Prices Include All Hangers And Couplings, Elbow, Tee, Reducer Fittings. All Hangers Are Complete Assemblies					\$7,770.24
					Installation	Quantity	Unit Price	Factor		Total
						600.00	12.00	1.0792	=	\$7,770.24
79	15063	5004	5025	LF	For Work In Restricted Working Space, Add					\$1,392.17
					Installation	Quantity	Unit Price	Factor		Total
						600.00	2.15	1.0792	=	\$1,392.17

Proposal Review - CSI Detail (Continued)

Job Order Number: 08631.01

Job Order Name: PBSO - ISS HVAC

Review: PBSO - ISS HVAC - 8/7/2009 2:24:29PM

80	15063	5005	LF	1-1/4" Inside Diameter (32 mm) Copper Pipe/Tubing Type L, Prices Include All Hangers And Couplings, Elbow, Tee, Reducer Fittings. All Hangers Are Complete Assemblies						\$8,748.00
			Installation	Quantity	Unit Price	Factor			Total	
				600.00	13.51	1.0792	=		\$8,748.00	
81	15063	5005	5025	LF	For Work In Restricted Working Space, Add					\$1,450.44
			Installation	Quantity	Unit Price	Factor			Total	
				600.00	2.24	1.0792	=		\$1,450.44	
82	15063	5007	LF	2" Inside Diameter (50 mm) Copper Pipe/Tubing Type L, Prices Include All Hangers And Couplings, Elbow, Tee, Reducer Fittings. All Hangers Are Complete Assemblies						\$1,778.52
			Installation	Quantity	Unit Price	Factor			Total	
				80.00	20.60	1.0792	=		\$1,778.52	
83	15063	5007	5025	LF	For Work In Restricted Working Space, Add					\$236.56
			Installation	Quantity	Unit Price	Factor			Total	
				80.00	2.74	1.0792	=		\$236.56	
84	15063	5008	LF	2-1/2" Inside Diameter (60 mm) Copper Pipe/Tubing Type L, Prices Include All Hangers And Couplings, Elbow, Tee, Reducer Fittings. All Hangers Are Complete Assemblies						\$2,963.48
			Installation	Quantity	Unit Price	Factor			Total	
				100.00	27.46	1.0792	=		\$2,963.48	
85	15063	5008	5025	LF	For Work In Restricted Working Space, Add					\$317.28
			Installation	Quantity	Unit Price	Factor			Total	
				100.00	2.94	1.0792	=		\$317.28	
86	15094	4111	LF	3/8" Diameter Continuous Threaded Rod, Plain Steel, Bright Finish						\$321.60
			Installation	Quantity	Unit Price	Factor			Total	
				200.00	1.49	1.0792	=		\$321.60	
87	15094	4111	5391	LF	For Work In Restricted Working Space, Add					\$32.38
			Installation	Quantity	Unit Price	Factor			Total	
				200.00	0.15	1.0792	=		\$32.38	
88	15094	4131	EA	3/8" Washer, Flat						\$77.70
			Installation	Quantity	Unit Price	Factor			Total	
				400.00	0.18	1.0792	=		\$77.70	
89	15094	4131	5391	EA	For Work In Restricted Working Space, Add					\$21.58
			Installation	Quantity	Unit Price	Factor			Total	
				400.00	0.05	1.0792	=		\$21.58	
90	15094	4151	EA	3/8" Nut, Hex						\$55.84
			Installation	Quantity	Unit Price	Factor			Total	
				199.00	0.26	1.0792	=		\$55.84	
91	15094	4151	5391	EA	For Work In Restricted Working Space, Add					\$15.11
			Installation	Quantity	Unit Price	Factor			Total	
				200.00	0.07	1.0792	=		\$15.11	
92	15094	5323	EA	1-1/4" Pipe Saddle, Type 39 (For 1" Insulation)						\$678.08
			Installation	Quantity	Unit Price	Factor			Total	
				66.00	9.52	1.0792	=		\$678.08	
93	15094	5323	5391	EA	For Work In Restricted Working Space, Add					\$134.62
			Installation	Quantity	Unit Price	Factor			Total	
				66.00	1.89	1.0792	=		\$134.62	
94	15094	5324	EA	1-1/2" Pipe Saddle, Type 39 (For 1" Insulation)						\$734.35
			Installation	Quantity	Unit Price	Factor			Total	
				66.00	10.31	1.0792	=		\$734.35	

Proposal Review - CSI Detail (Continued)

Job Order Number: 08631.01

Job Order Name: PBSO - ISS HVAC

Review: PBSO - ISS HVAC - 8/7/2009 2:24:29PM

95	15094	5324	5391	EA	For Work In Restricted Working Space, Add					\$146.02
					Installation	Quantity	Unit Price	Factor	=	Total
						66.00	2.05	1.0792	=	\$146.02
96	15094	5326		EA	2-1/2" Pipe Saddle, Type 39 (For 1" Insulation)					\$100.84
					Installation	Quantity	Unit Price	Factor	=	Total
						8.00	11.68	1.0792	=	\$100.84
97	15094	5326	5391	EA	For Work In Restricted Working Space, Add					\$21.24
					Installation	Quantity	Unit Price	Factor	=	Total
						8.00	2.46	1.0792	=	\$21.24
98	15094	5327		EA	3" Pipe Saddle, Type 39 (For 1" Insulation)					\$182.60
					Installation	Quantity	Unit Price	Factor	=	Total
						12.00	14.10	1.0792	=	\$182.60
99	15094	5327	5391	EA	For Work In Restricted Working Space, Add					\$35.35
					Installation	Quantity	Unit Price	Factor	=	Total
						12.00	2.73	1.0792	=	\$35.35
100	15094	7003		EA	2" Hanger Assembly For Pipe Includes Hanger, Rod, Saddle And Clamp					\$5,790.73
					Installation	Quantity	Unit Price	Factor	=	Total
						128.00	41.92	1.0792	=	\$5,790.73
101	15094	9107		LF	2-1/2"x 2-1/2" x 1/4" Angle Iron					\$11,520.41
					Installation	Quantity	Unit Price	Factor	=	Total
						1,493.00	7.15	1.0792	=	\$11,520.41
102	15106	1104		EA	7/8" Refrigeration Ball Valve, Sweated					\$1,589.40
					Installation	Quantity	Unit Price	Factor	=	Total
						36.00	40.91	1.0792	=	\$1,589.40
103	15161	4403		EA	550-1920# Rubber In Shear Vibration Isolation With 0.48" Deflection					\$11,705.48
					Installation	Quantity	Unit Price	Factor	=	Total
						36.00	301.29	1.0792	=	\$11,705.48
104	15164	5203		EA	2" Diameter x 24" Long, Flexible Hose Connectors, Braided Stainless Steel Over Braided Carbon Steel Connection, Welded					\$16,850.54
					Installation	Quantity	Unit Price	Factor	=	Total
						72.00	216.86	1.0792	=	\$16,850.54
105	15185	1304		LF	1-1/4" Diameter Pipe, 1-1/2" Thick Fiberglass Insulation					\$3,665.83
					Installation	Quantity	Unit Price	Factor	=	Total
						440.00	7.72	1.0792	=	\$3,665.83
106	15185	1304	1902	LF	For Calcium Silicate With Canvas Jacket, Add					\$446.36
					Installation	Quantity	Unit Price	Factor	=	Total
						440.00	0.94	1.0792	=	\$446.36
107	15185	1304	1999	LF	For Work In Restricted Working Space, Add					\$650.54
					Installation	Quantity	Unit Price	Factor	=	Total
						440.00	1.37	1.0792	=	\$650.54
108	15185	1305		LF	1-1/2" Diameter Pipe, 1-1/2" Thick Fiberglass Insulation					\$10,525.01
					Installation	Quantity	Unit Price	Factor	=	Total
						1,210.00	8.06	1.0792	=	\$10,525.01
109	15185	1305	1902	LF	For Calcium Silicate With Canvas Jacket, Add					\$1,292.77
					Installation	Quantity	Unit Price	Factor	=	Total
						1,210.00	0.99	1.0792	=	\$1,292.77
110	15185	1305	1999	LF	For Work In Restricted Working Space, Add					\$1,867.34
					Installation	Quantity	Unit Price	Factor	=	Total
						1,210.00	1.43	1.0792	=	\$1,867.34

Proposal Review - CSI Detail (Continued)

Job Order Number: 08631.01

Job Order Name: PBSO - ISS HVAC

Review: PBSO - ISS HVAC - 8/7/2009 2:24:29PM

111	15185	1306	LF	2" Diameter Pipe, 1-1/2" Thick Fiberglass Insulation						\$4,050.45
				Installation	Quantity	Unit Price	Factor		Total	
					440.00	8.53	1.0792	=	\$4,050.45	
112	15185	1306	1902	LF	For Calcium Silicate With Canvas Jacket, Add					\$512.84
					Quantity	Unit Price	Factor		Total	
					440.00	1.08	1.0792	=	\$512.84	
113	15185	1306	1999	LF	For Work In Restricted Working Space, Add					\$702.78
					Quantity	Unit Price	Factor		Total	
					440.00	1.48	1.0792	=	\$702.78	
114	15185	1307		LF	2-1/2" Diameter Pipe, 1-1/2" Thick Fiberglass Insulation					\$3,328.04
					Quantity	Unit Price	Factor		Total	
					340.00	9.07	1.0792	=	\$3,328.04	
115	15185	1307	1902	LF	For Calcium Silicate With Canvas Jacket, Add					\$436.64
					Quantity	Unit Price	Factor		Total	
					340.00	1.19	1.0792	=	\$436.64	
116	15185	1307	1999	LF	For Work In Restricted Working Space, Add					\$561.40
					Quantity	Unit Price	Factor		Total	
					340.00	1.53	1.0792	=	\$561.40	
117	15186	1003		SF	0.010" Stainless Steel Insulation Jacket With Bands Fire Retardant					\$7,623.47
					Quantity	Unit Price	Factor		Total	
					800.00	8.83	1.0792	=	\$7,623.47	
118	15671	2008		EA	50 Ton Packaged Chiller With Remote Air Cooled Condensers					\$114,961.13
					Quantity	Unit Price	Factor		Total	
					2.00	53,262.20	1.0792	=	\$114,961.13	
					Liebert Chiller unit # XDC160AA - (2) ea. with remote Condensing unit # DCDL-830A - (2) ea.					
119	15671	2008	2032	EA	For Semi-Hermatic Compressor, Add					\$20,154.60
					Quantity	Unit Price	Factor		Total	
					2.00	9,337.75	1.0792	=	\$20,154.60	
					'Liebert Chiller unit # XDC160AA - (2) ea. with remote Condensing unit # DCDL-830A - (2) ea.'					
120	15773	1001		EA	3 Ton Air Cooled Computer Room Air Conditioner, Direct Expansion Type, Includes Remote Condenser					\$212,579.67
					Quantity	Unit Price	Factor		Total	
					15.00	13,077.98	1.0792	=	\$211,706.34	
					Demolition	1.00	809.24	1.0792	=	\$873.33
					Liebert Cooling modules # XDV10SKE-1 - (11) ea. & XDV8SKR-1 - (4) ea.					
121	15773	1001	9902	EA	For Liebert Unit, Add					\$24,004.38
					Quantity	Unit Price	Factor		Total	
					15.00	1,482.85	1.0792	=	\$24,004.38	
					'Liebert Cooling modules # XDV10SKE-1 - (11) ea. & XDV8SKR-1 - (4) ea.'					
122	15867	5753		EA	24" x 24" Steel Security Grille					\$5,632.91
					Quantity	Unit Price	Factor		Total	
					12.00	434.96	1.0792	=	\$5,632.91	
					A/C Floor grilles - MD-AF200 w/ dampers					
123	15867	5753	5791	EA	For Anchoring Tabs, Add					\$509.99
					Quantity	Unit Price	Factor		Total	
					12.00	39.38	1.0792	=	\$509.99	
					'A/C Floor grilles - MD-AF200 w/ dampers'					
124	15867	5753	5792	EA	For Angle Iron Frame, Add					\$818.34
					Quantity	Unit Price	Factor		Total	
					12.00	63.19	1.0792	=	\$818.34	
					'A/C Floor grilles - MD-AF200 w/ dampers'					

Proposal Review - CSI Detail (Continued)

Job Order Number: 08631.01

Job Order Name: PBSO - ISS HVAC

Review: PBSO - ISS HVAC - 8/7/2009 2:24:29PM

125	15867	5753	5793	EA	For Rear Operated Opposed Blade Damper, Add					\$1,838.31
					Installation	Quantity	Unit Price	Factor	=	Total
						12.00	141.95	x	1.0792	\$1,838.31
					'A/C Floor grilles - MD-AF200 w/ dampers'					
126	15938	1203		EA	1" Pneumatic 3-Way Mixing Valve Spring Loaded, Self Adjusting					\$15,420.82
					Installation	Quantity	Unit Price	Factor	=	Total
						36.00	396.92	x	1.0792	\$15,420.82
					7/8" By pass control valve at modules					
127	15938	1203	2121	EA	For Low Pressure Steam, Add					\$1,118.91
					Installation	Quantity	Unit Price	Factor	=	Total
						36.00	28.80	x	1.0792	\$1,118.91
128	15938	1205		EA	1-1/2" Pneumatic 3-Way Mixing Valve Spring Loaded, Self Adjusting					\$2,437.91
					Installation	Quantity	Unit Price	Factor	=	Total
						4.00	564.75	x	1.0792	\$2,437.91
					1-3/8" By pass controller valve RCH 1&2					
129	15938	1205	2121	EA	For Low Pressure Steam, Add					\$188.47
					Installation	Quantity	Unit Price	Factor	=	Total
						4.00	43.66	x	1.0792	\$188.47
130	15938	1207		EA	2-1/2" Pneumatic 3-Way Mixing Valve Spring Loaded, Self Adjusting					\$5,659.50
					Installation	Quantity	Unit Price	Factor	=	Total
						4.00	1,311.04	x	1.0792	\$5,659.50
					2-3/8" By pass controller valve RCH 1 & 2					
131	15938	1207	2121	EA	For Low Pressure Steam, Add					\$481.97
					Installation	Quantity	Unit Price	Factor	=	Total
						4.00	111.65	x	1.0792	\$481.97
Subtotal for 15										\$527,559.86

Section 16

132	16101	1003		EA	Lock Out/Tag Out Circuit Breaker					\$206.24
					Installation	Quantity	Unit Price	Factor	=	Total
						13.00	14.70	x	1.0792	\$206.24
133	16112	1106		LF	1350 Amp Bus Duct 600 V, 3 Phase, 3 Wire Copper Conductors					\$519.73
					Installation	Quantity	Unit Price	Factor	=	Total
						1.00	481.59	x	1.0792	\$519.73
134	16120	1222		MLF	#14 AWG Cable - XLP (XHHW), 600 V, Single Stranded, Placed In Conduit					\$1,297.98
					Installation	Quantity	Unit Price	Factor	=	Total
						2.50	481.09	x	1.0792	\$1,297.98
135	16120	1223		MLF	#12 AWG Cable - XLP (XHHW), 600 V, Single Stranded, Placed In Conduit					\$1,408.32
					Installation	Quantity	Unit Price	Factor	=	Total
						2.15	606.96	x	1.0792	\$1,408.32
136	16120	1224		MLF	#10 AWG Cable - XLP (XHHW), 600 V, Single Stranded, Placed In Conduit					\$424.26
					Installation	Quantity	Unit Price	Factor	=	Total
						0.50	786.24	x	1.0792	\$424.26
137	16120	1225		MLF	#8 AWG Cable - XLP (XHHW), 600 V, Single Stranded, Placed In Conduit					\$1,513.89
					Installation	Quantity	Unit Price	Factor	=	Total
						1.50	935.19	x	1.0792	\$1,513.89
138	16120	1228		MLF	#3 AWG Cable - XLP (XHHW), 600 V, Single Stranded, Placed In Conduit					\$6,250.13
					Installation	Quantity	Unit Price	Factor	=	Total
						2.50	2,316.58	x	1.0792	\$6,250.13

Proposal Review - CSI Detail (Continued)

Job Order Number: 08631.01

Job Order Name: PBSO - ISS HVAC

Review: PBSO - ISS HVAC - 8/7/2009 2:24:29PM

Item #	Material #	Quantity	Unit Price	Factor	Total
139	16120 8213	MLF	4/c #18 300 V Thermostat Cable, Low Volt Cable For HVAC System Controls		\$853.31
		Installation	1.00 x	790.69 x	1.0792 = \$853.31
140	16120 8214	MLF	6/c #18 300 V Twisted Shielded Cable, In Conduit		\$1,890.43
		Installation	2.60 x	673.73 x	1.0792 = \$1,890.43
141	16120 8302	CLF	Red Teflon 2-Pair #18 Gauge, Twisted Shielded Solid CU		\$1,302.81
		Installation	12.00 x	100.60 x	1.0792 = \$1,302.81
142	16120 8401	MLF	4/c #18 AWG "TC" Copper Conductor Cable		\$3,213.03
		Installation	3.00 x	992.41 x	1.0792 = \$3,213.03
143	16121 1401	EA	#8 Or #6 AWG Cable Termination Lugs, Wrapped, No Stress Cones, Low Volt, To 600 Volts		\$1,871.33
		Installation	60.00 x	28.90 x	1.0792 = \$1,871.33
144	16121 1511	EA	Terminal Block, 12 Pt, Wire Size #22-#10 SCW Type, No Labor Wire Termination, 600 V		\$606.34
		Installation	4.00 x	140.46 x	1.0792 = \$606.34
145	16121 1908	EA	#12 AWG Fixture Connection, Mechanical Solderless Type		\$2,189.27
		Installation	460.00 x	4.41 x	1.0792 = \$2,189.27
146	16131 2152	EA	RGS 3/4" Plastic Bushing Set With Locknuts, Mounted Exposed On Flat Wall		\$12.32
		Installation	2.00 x	5.71 x	1.0792 = \$12.32
147	16131 2152 2821	EA	For Work In Restricted Working Space, Add		\$3.48
		Installation	2.00 x	1.61 x	1.0792 = \$3.48
148	16131 2153	EA	RGS 1" Plastic Bushing Set With Locknuts, Mounted Exposed On Flat Wall		\$23.80
		Installation	3.00 x	7.35 x	1.0792 = \$23.80
149	16131 2153 2821	EA	For Work In Restricted Working Space, Add		\$6.60
		Installation	3.00 x	2.04 x	1.0792 = \$6.60
150	16131 2154	EA	RGS 1-1/4" Plastic Bushing Set With Locknuts, Mounted Exposed On Flat Wall		\$97.13
		Installation	10.00 x	9.00 x	1.0792 = \$97.13
151	16131 2154 2821	EA	For Work In Restricted Working Space, Add		\$26.76
		Installation	10.00 x	2.48 x	1.0792 = \$26.76
152	16131 2154	EA	RGS 1-1/4" Plastic Bushing Set With Locknuts, Mounted Exposed On Flat Wall		\$97.13
		Installation	10.00 x	9.00 x	1.0792 = \$97.13
153	16131 2154 2821	EA	For Work In Restricted Working Space, Add		\$26.76
		Installation	10.00 x	2.48 x	1.0792 = \$26.76
154	16131 2174	EA	RGS 1-1/4" Steel Insulated Bushing Set With Locknuts, Mounted Exposed On Flat Wall		\$115.69
		Installation	10.00 x	10.72 x	1.0792 = \$115.69

Proposal Review - CSI Detail (Continued)

Job Order Number: 08631.01

Job Order Name: PBSO - ISS HVAC

Review: PBSO - ISS HVAC - 8/7/2009 2:24:29PM

155	16131	2174	2821	EA	For Work In Restricted Working Space, Add						\$26.76
					Installation	Quantity	Unit Price	Factor		Total	
						10.00	x 2.48	x 1.0792	=	\$26.76	
156	16131	2193		EA	RGS 1" Steel Insulated Grounding Bushing Set With Locknuts, Mounted Exposed On Flat Wall						\$53.49
					Installation	Quantity	Unit Price	Factor		Total	
						4.00	x 12.39	x 1.0792	=	\$53.49	
157	16131	2193	2821	EA	For Work In Restricted Working Space, Add						\$11.61
					Installation	Quantity	Unit Price	Factor		Total	
						4.00	x 2.69	x 1.0792	=	\$11.61	
158	16131	2372		EA	RGS 3/4" Threaded Hubs, Rain Tight, Die Cast Zinc						\$21.56
					Installation	Quantity	Unit Price	Factor		Total	
						2.00	x 9.99	x 1.0792	=	\$21.56	
159	16131	2373		EA	RGS 1" Threaded Hubs, Rain Tight, Die Cast Zinc						\$13.26
					Installation	Quantity	Unit Price	Factor		Total	
						1.00	x 12.29	x 1.0792	=	\$13.26	
160	16131	2433		EA	RGS 1" Coupling						\$7.73
					Installation	Quantity	Unit Price	Factor		Total	
						2.00	x 3.58	x 1.0792	=	\$7.73	
161	16131	2434		EA	RGS 1-1/4" Coupling						\$9.67
					Installation	Quantity	Unit Price	Factor		Total	
						2.00	x 4.48	x 1.0792	=	\$9.67	
162	16131	2434	2821	EA	For Work In Restricted Working Space, Add						\$2.33
					Installation	Quantity	Unit Price	Factor		Total	
						2.00	x 1.08	x 1.0792	=	\$2.33	
163	16131	2611		LF	1/2" EMT Conduit, Mounted Exposed On Flat Wall						\$1,104.02
					Installation	Quantity	Unit Price	Factor		Total	
						550.00	x 1.86	x 1.0792	=	\$1,104.02	
164	16131	2611	2821	LF	For Work In Restricted Working Space, Add						\$290.84
					Installation	Quantity	Unit Price	Factor		Total	
						550.00	x 0.49	x 1.0792	=	\$290.84	
165	16131	2612		LF	3/4" EMT Conduit, Mounted Exposed On Flat Wall						\$1,976.55
					Installation	Quantity	Unit Price	Factor		Total	
						825.00	x 2.22	x 1.0792	=	\$1,976.55	
166	16131	2612	2821	LF	For Work In Restricted Working Space, Add						\$480.78
					Installation	Quantity	Unit Price	Factor		Total	
						825.00	x 0.54	x 1.0792	=	\$480.78	
167	16131	2613		LF	1" EMT Conduit, Mounted Exposed On Flat Wall						\$645.79
					Installation	Quantity	Unit Price	Factor		Total	
						220.00	x 2.72	x 1.0792	=	\$645.79	
168	16131	2613	2821	LF	For Work In Restricted Working Space, Add						\$140.08
					Installation	Quantity	Unit Price	Factor		Total	
						220.00	x 0.59	x 1.0792	=	\$140.08	
169	16131	2614		LF	1-1/4" EMT Conduit, Mounted Exposed On Flat Wall						\$2,584.04
					Installation	Quantity	Unit Price	Factor		Total	
						730.00	x 3.28	x 1.0792	=	\$2,584.04	
170	16131	2614	2821	LF	For Work In Restricted Working Space, Add						\$527.84
					Installation	Quantity	Unit Price	Factor		Total	
						730.00	x 0.67	x 1.0792	=	\$527.84	

Proposal Review - CSI Detail (Continued)

Job Order Number: 08631.01

Job Order Name: PBSO - ISS HVAC

Review: PBSO - ISS HVAC - 8/7/2009 2:24:29PM

171	16131	2634		EA	1-1/4" EMT 90 Degree Elbow, Mounted Exposed On Flat Wall					\$177.12
					Installation	Quantity	Unit Price	Factor		Total
						22.00	7.46	1.0792	=	\$177.12
172	16131	2634	2821	EA	For Work In Restricted Working Space, Add					\$38.23
					Installation	Quantity	Unit Price	Factor		Total
						22.00	1.61	1.0792	=	\$38.23
173	16131	2651		EA	1/2" EMT Set Screw Coupling, Mounted Exposed On Flat Wall					\$115.15
					Installation	Quantity	Unit Price	Factor		Total
						55.00	1.94	1.0792	=	\$115.15
174	16131	2651	2821	EA	For Work In Restricted Working Space, Add					\$32.05
					Installation	Quantity	Unit Price	Factor		Total
						55.00	0.54	1.0792	=	\$32.05
175	16131	2652		EA	3/4" EMT Set Screw Coupling, Mounted Exposed On Flat Wall					\$211.50
					Installation	Quantity	Unit Price	Factor		Total
						82.00	2.39	1.0792	=	\$211.50
176	16131	2652	2821	EA	For Work In Restricted Working Space, Add					\$57.52
					Installation	Quantity	Unit Price	Factor		Total
						82.00	0.65	1.0792	=	\$57.52
177	16131	2653		EA	1" EMT Set Screw Coupling, Mounted Exposed On Flat Wall					\$69.09
					Installation	Quantity	Unit Price	Factor		Total
						22.00	2.91	1.0792	=	\$69.09
178	16131	2653	2821	EA	For Work In Restricted Working Space, Add					\$17.81
					Installation	Quantity	Unit Price	Factor		Total
						22.00	0.75	1.0792	=	\$17.81
179	16131	2654		EA	1-1/4" EMT Set Screw Coupling, Mounted Exposed On Flat Wall					\$306.92
					Installation	Quantity	Unit Price	Factor		Total
						72.00	3.95	1.0792	=	\$306.92
180	16131	2654	2821	EA	For Work In Restricted Working Space, Add					\$75.37
					Installation	Quantity	Unit Price	Factor		Total
						72.00	0.97	1.0792	=	\$75.37
181	16131	2672		EA	3/4" EMT Compression Coupling, Mounted Exposed On Flat Wall					\$6.15
					Installation	Quantity	Unit Price	Factor		Total
						2.00	2.85	1.0792	=	\$6.15
182	16131	2672	2821	EA	For Work In Restricted Working Space, Add					\$1.62
					Installation	Quantity	Unit Price	Factor		Total
						2.00	0.75	1.0792	=	\$1.62
183	16131	2673		EA	1" EMT Compression Coupling, Mounted Exposed On Flat Wall					\$4.48
					Installation	Quantity	Unit Price	Factor		Total
						1.00	4.15	1.0792	=	\$4.48
184	16131	2673	2821	EA	For Work In Restricted Working Space, Add					\$1.17
					Installation	Quantity	Unit Price	Factor		Total
						1.00	1.08	1.0792	=	\$1.17
185	16131	2691		EA	1/2" EMT Box Connector With Set Screw					\$105.76
					Installation	Quantity	Unit Price	Factor		Total
						50.00	1.96	1.0792	=	\$105.76
186	16131	2691	2821	EA	For Work In Restricted Working Space, Add					\$29.14
					Installation	Quantity	Unit Price	Factor		Total
						50.00	0.54	1.0792	=	\$29.14

Proposal Review - CSI Detail (Continued)

Job Order Number: 08631.01

Job Order Name: PBSO - ISS HVAC

Review: PBSO - ISS HVAC - 8/7/2009 2:24:29PM

187	16131	2692		EA	3/4" EMT Box Connector With Set Screw						\$130.58
					Installation	Quantity	Unit Price	Factor		Total	
						50.00	2.42	1.0792	=	\$130.58	
188	16131	2692	2821	EA	For Work In Restricted Working Space, Add						\$35.07
					Installation	Quantity	Unit Price	Factor		Total	
						50.00	0.65	1.0792	=	\$35.07	
189	16131	2693		EA	1" EMT Box Connector With Set Screw						\$18.78
					Installation	Quantity	Unit Price	Factor		Total	
						6.00	2.90	1.0792	=	\$18.78	
190	16131	2693	2821	EA	For Work In Restricted Working Space, Add						\$4.86
					Installation	Quantity	Unit Price	Factor		Total	
						6.00	0.75	1.0792	=	\$4.86	
191	16131	2694		EA	1-1/4" EMT Box Connector With Set Screw						\$82.36
					Installation	Quantity	Unit Price	Factor		Total	
						18.00	4.24	1.0792	=	\$82.36	
192	16131	2694	2821	EA	For Work In Restricted Working Space, Add						\$20.98
					Installation	Quantity	Unit Price	Factor		Total	
						18.00	1.08	1.0792	=	\$20.98	
193	16131	2732		EA	3/4" EMT Box Connector, Compression						\$40.69
					Installation	Quantity	Unit Price	Factor		Total	
						10.00	3.77	1.0792	=	\$40.69	
194	16131	2732	2821	EA	For Work In Restricted Working Space, Add						\$8.09
					Installation	Quantity	Unit Price	Factor		Total	
						10.00	0.75	1.0792	=	\$8.09	
195	16131	2733		EA	1" EMT Box Connector, Compression						\$10.99
					Installation	Quantity	Unit Price	Factor		Total	
						2.00	5.09	1.0792	=	\$10.99	
196	16131	2733	2821	EA	For Work In Restricted Working Space, Add						\$1.86
					Installation	Quantity	Unit Price	Factor		Total	
						2.00	0.86	1.0792	=	\$1.86	
197	16131	2802		EA	3/4" LB, LR, Or LL Fitting With Cover And Set Screw						\$62.55
					Installation	Quantity	Unit Price	Factor		Total	
						4.00	14.49	1.0792	=	\$62.55	
198	16131	2802	2821	EA	For Work In Restricted Working Space, Add						\$11.61
					Installation	Quantity	Unit Price	Factor		Total	
						4.00	2.69	1.0792	=	\$11.61	
199	16131	2803		EA	1" LB, LR, Or LL Fitting With Cover And Set Screw						\$41.57
					Installation	Quantity	Unit Price	Factor		Total	
						2.00	19.26	1.0792	=	\$41.57	
200	16131	2803	2821	EA	For Work In Restricted Working Space, Add						\$7.19
					Installation	Quantity	Unit Price	Factor		Total	
						2.00	3.33	1.0792	=	\$7.19	
201	16131	2804		EA	1-1/4" LB, LR, Or LL Fitting With Cover And Set Screw						\$54.65
					Installation	Quantity	Unit Price	Factor		Total	
						2.00	25.32	1.0792	=	\$54.65	
202	16131	2804	2821	EA	For Work In Restricted Working Space, Add						\$8.83
					Installation	Quantity	Unit Price	Factor		Total	
						2.00	4.09	1.0792	=	\$8.83	

Proposal Review - CSI Detail (Continued)

Job Order Number: 08631.01

Job Order Name: PBSO - ISS HVAC

Review: PBSO - ISS HVAC - 8/7/2009 2:24:29PM

203	16131	4112		LF	3/4" PVC Schedule 40 Conduit With Coupling, Direct Burial, Glued Coupling					\$70.80
					Installation	Quantity	Unit Price	Factor	Total	
						40.00	1.64	1.0792	\$70.80	
204	16131	4112	4189	LF	For Schedule 80, Add					\$5.61
					Installation	Quantity	Unit Price	Factor	Total	
						20.00	0.26	1.0792	\$5.61	
205	16131	4132		EA	3/4" PVC Schedule 40 Elbow 90 Degree Direct Burial, Glued Coupling					\$54.65
					Installation	Quantity	Unit Price	Factor	Total	
						6.00	8.44	1.0792	\$54.65	
206	16131	4132	4189	EA	For Schedule 80, Add					\$6.35
					Installation	Quantity	Unit Price	Factor	Total	
						6.00	0.98	1.0792	\$6.35	
207	16131	4152		EA	3/4" PVC Schedule 40 Adapter, Direct Burial, Glued Coupling					\$102.39
					Installation	Quantity	Unit Price	Factor	Total	
						16.00	5.93	1.0792	\$102.39	
208	16131	4152	4189	EA	For Schedule 80, Add					\$11.57
					Installation	Quantity	Unit Price	Factor	Total	
						16.00	0.67	1.0792	\$11.57	
209	16131	8212		LF	1/2" Flexible Metallic Conduit					\$271.96
					Installation	Quantity	Unit Price	Factor	Total	
						180.00	1.40	1.0792	\$271.96	
210	16131	8212	9199	LF	For Work In Restricted Working Space, Add					\$67.99
					Installation	Quantity	Unit Price	Factor	Total	
						180.00	0.35	1.0792	\$67.99	
211	16131	8213		LF	3/4" Flexible Metallic Conduit					\$25.58
					Installation	Quantity	Unit Price	Factor	Total	
						15.00	1.58	1.0792	\$25.58	
212	16131	8213	9199	LF	For Work In Restricted Working Space, Add					\$6.15
					Installation	Quantity	Unit Price	Factor	Total	
						15.00	0.38	1.0792	\$6.15	
213	16131	8214		LF	1" Flexible Metallic Conduit					\$20.94
					Installation	Quantity	Unit Price	Factor	Total	
						10.00	1.94	1.0792	\$20.94	
214	16131	8214	9199	LF	For Work In Restricted Working Space, Add					\$4.42
					Installation	Quantity	Unit Price	Factor	Total	
						10.00	0.41	1.0792	\$4.42	
215	16131	8215		LF	1-1/4" Flexible Metallic Conduit					\$70.90
					Installation	Quantity	Unit Price	Factor	Total	
						30.00	2.19	1.0792	\$70.90	
216	16131	8215	9199	LF	For Work In Restricted Working Space, Add					\$14.25
					Installation	Quantity	Unit Price	Factor	Total	
						30.00	0.44	1.0792	\$14.25	
217	16131	8232		EA	1/2" Flexible Straight Connectors, Plain					\$59.79
					Installation	Quantity	Unit Price	Factor	Total	
						20.00	2.77	1.0792	\$59.79	
218	16131	8232	9199	EA	For Work In Restricted Working Space, Add					\$12.73
					Installation	Quantity	Unit Price	Factor	Total	
						20.00	0.59	1.0792	\$12.73	

Proposal Review - CSI Detail (Continued)

Job Order Number: 08631.01

Job Order Name: PBSO - ISS HVAC

Review: PBSO - ISS HVAC - 8/7/2009 2:24:29PM

219	16131	8233		EA	3/4" Flexible Straight Connectors, Plain						\$6.91
					Installation	Quantity	Unit Price	Factor		Total	
						2.00	3.20	1.0792	=	\$6.91	
220	16131	8233	9199	EA	For Work In Restricted Working Space, Add						\$1.53
					Installation	Quantity	Unit Price	Factor		Total	
						2.00	0.71	1.0792	=	\$1.53	
221	16131	8235		EA	1-1/4" Flexible Straight Connectors, Plain						\$30.13
					Installation	Quantity	Unit Price	Factor		Total	
						4.00	6.98	1.0792	=	\$30.13	
222	16131	8235	9199	EA	For Work In Restricted Working Space, Add						\$5.09
					Installation	Quantity	Unit Price	Factor		Total	
						4.00	1.18	1.0792	=	\$5.09	
223	16131	8235		EA	1-1/4" Flexible Straight Connectors, Plain						\$7.53
					Installation	Quantity	Unit Price	Factor		Total	
						1.00	6.98	1.0792	=	\$7.53	
224	16131	8235	9199	EA	For Work In Restricted Working Space, Add						\$1.27
					Installation	Quantity	Unit Price	Factor		Total	
						1.00	1.18	1.0792	=	\$1.27	
225	16131	8272		EA	1/2" Flexible 90 Degree Connector, Plain						\$70.97
					Installation	Quantity	Unit Price	Factor		Total	
						16.00	4.11	1.0792	=	\$70.97	
226	16131	8272	9199	EA	For Work In Restricted Working Space, Add						\$14.33
					Installation	Quantity	Unit Price	Factor		Total	
						16.00	0.83	1.0792	=	\$14.33	
227	16131	8273		EA	3/4" Flexible 90 Degree Connector, Plain						\$11.37
					Installation	Quantity	Unit Price	Factor		Total	
						2.00	5.27	1.0792	=	\$11.37	
228	16131	8273	9199	EA	For Work In Restricted Working Space, Add						\$2.03
					Installation	Quantity	Unit Price	Factor		Total	
						2.00	0.94	1.0792	=	\$2.03	
229	16131	8274		EA	1" Flexible 90 Degree Connector, Plain						\$7.87
					Installation	Quantity	Unit Price	Factor		Total	
						1.00	7.29	1.0792	=	\$7.87	
230	16131	8274	9199	EA	For Work In Restricted Working Space, Add						\$1.27
					Installation	Quantity	Unit Price	Factor		Total	
						1.00	1.18	1.0792	=	\$1.27	
231	16131	8275		EA	1-1/4" Flexible 90 Degree Connector, Plain						\$47.87
					Installation	Quantity	Unit Price	Factor		Total	
						4.00	11.09	1.0792	=	\$47.87	
232	16131	8275	9199	EA	For Work In Restricted Working Space, Add						\$6.09
					Installation	Quantity	Unit Price	Factor		Total	
						4.00	1.41	1.0792	=	\$6.09	
233	16131	8413		LF	3/4" Non-Metallic Liquid Tight Flex Conduit						\$41.31
					Installation	Quantity	Unit Price	Factor		Total	
						12.00	3.19	1.0792	=	\$41.31	
234	16131	8433		EA	3/4" Non-Metallic Straight Connector						\$20.74
					Installation	Quantity	Unit Price	Factor		Total	
						2.00	9.61	1.0792	=	\$20.74	

Proposal Review - CSI Detail (Continued)

Job Order Number: 08631.01

Job Order Name: PBSO - ISS HVAC

Review: PBSO - ISS HVAC - 8/7/2009 2:24:29PM

235	16131	8453	EA	3/4" Non-Metallic 90 Degree Angle Connector						\$32.57
				Quantity	Unit Price	Factor		Total		
				Installation	2.00 x	15.09 x	1.0792 =	\$32.57		
236	16134	1102	EA	4" Square Steel Box X 2-1/8" Deep						\$618.99
				Quantity	Unit Price	Factor		Total		
				Installation	52.00 x	11.03 x	1.0792 =	\$618.99		
237	16134	1104	EA	4" Square Steel Blank Cover						\$161.49
				Quantity	Unit Price	Factor		Total		
				Installation	43.00 x	3.48 x	1.0792 =	\$161.49		
238	16134	4301	EA	3/4", 4" Square Cut Tile Ring, 1 Gang, Flush Mount						\$59.93
				Quantity	Unit Price	Factor		Total		
				Installation	9.00 x	6.17 x	1.0792 =	\$59.93		
239	16134	6216	EA	1 Gang, Weatherproof, 4-1/2" x 2-5/8" Box, Concealed With Cover, 3/4" Knock Out, Solid Outlet Box						\$43.47
				Quantity	Unit Price	Factor		Total		
				Installation	1.00 x	40.28 x	1.0792 =	\$43.47		
240	16135	1131	EA	6"x6"x6" NEMA 1 Enclosure, Hinged Cover Included						\$95.31
				Quantity	Unit Price	Factor		Total		
				Installation	2.00 x	44.16 x	1.0792 =	\$95.31		
241	16135	1132	EA	8"x8"x6" NEMA 1 Enclosure, Hinged Cover Included						\$239.71
				Quantity	Unit Price	Factor		Total		
				Installation	4.00 x	55.53 x	1.0792 =	\$239.71		
242	16135	1211	EA	4"x4"x3" NEMA 1 Enclosure, Screw Cover Included						\$27.25
				Quantity	Unit Price	Factor		Total		
				Installation	1.00 x	25.25 x	1.0792 =	\$27.25		
243	16140	1243	EA	20 A, 120 V Isolated Ground Receptacles, Duplex						\$246.41
				Quantity	Unit Price	Factor		Total		
				Installation	9.00 x	25.37 x	1.0792 =	\$246.41		
244	16140	1284	EA	20 Amp, 120 V, GFI, Weatherproof Duplex Receptacle						\$31.67
				Quantity	Unit Price	Factor		Total		
				Installation	1.00 x	29.35 x	1.0792 =	\$31.67		
245	16140	1284	EA	20 Amp, 120 V, GFI, Weatherproof Duplex Receptacle						\$31.67
				Quantity	Unit Price	Factor		Total		
				Installation	1.00 x	29.35 x	1.0792 =	\$31.67		
246	16140	4131	EA	1 Gang, 302 Stainless Steel Switch Plate Note: With Satin Finish						\$32.83
				Quantity	Unit Price	Factor		Total		
				Installation	9.00 x	3.38 x	1.0792 =	\$32.83		
247	16140	4204	EA	Thermoplastic Weatherproof Cover, For Vertical Device Mounting Note: Duplex receptacle						\$38.74
				Quantity	Unit Price	Factor		Total		
				Installation	1.00 x	35.90 x	1.0792 =	\$38.74		
248	16170	1121	EA	30 A, Fused Disconnect Switch, NEMA 1, Heavy Duty, With Fuses, 600 V, 1 Phase, 2 Pole						\$330.20
				Quantity	Unit Price	Factor		Total		
				Installation	1.00 x	305.97 x	1.0792 =	\$330.20		
249	16170	1143	EA	100 A, Fused Disconnect Switch, NEMA 1, Heavy Duty, With Fuses, 600 V, 3 Phase						\$1,503.54
				Quantity	Unit Price	Factor		Total		
				Installation	2.00 x	696.60 x	1.0792 =	\$1,503.54		
250	16170	2236	EA	600 A Non-Fused, NEMA 3R, Heavy Duty Disconnect Switch, 240 V, 3 Phase						\$8,229.07
				Quantity	Unit Price	Factor		Total		
				Installation	2.00 x	3,812.58 x	1.0792 =	\$8,229.07		

Proposal Review - CSI Detail (Continued)

Job Order Number: 08631.01

Job Order Name: PBSO - ISS HVAC

Review: PBSO - ISS HVAC - 8/7/2009 2:24:29PM

251	16181	2221	EA	30 Amp, 250 Volt, Current Limiting Fuse RK1, Ferrule Type						\$80.68
				Installation	Quantity	Unit Price	Factor		Total	
					6.00	12.46	1.0792	=	\$80.68	
252	16181	1254	EA	100 Amp, 250 Volt, Current Limiting Fuse RK1, Blade Type						\$325.06
				Installation	Quantity	Unit Price	Factor		Total	
					8.00	37.65	1.0792	=	\$325.06	
253	16190	1911	EA	Lay-in/Troffer Support - Straight Lip Type						\$29.53
				Installation	Quantity	Unit Price	Factor		Total	
					16.00	1.71	1.0792	=	\$29.53	
254	16190	2211	EA	EMT Conduit Clamps, P1426, 1/2"						\$212.60
				Installation	Quantity	Unit Price	Factor		Total	
					100.00	1.97	1.0792	=	\$212.60	
255	16190	2212	EA	EMT Conduit Clamps, P1427, 3/4"						\$339.95
				Installation	Quantity	Unit Price	Factor		Total	
					150.00	2.10	1.0792	=	\$339.95	
256	16190	2212	5601	EA	For Work In Restricted Working Space, Add					\$76.08
				Installation	Quantity	Unit Price	Factor		Total	
					150.00	0.47	1.0792	=	\$76.08	
257	16190	2213	EA	EMT Conduit Clamps, P1428, 1"						\$104.90
				Installation	Quantity	Unit Price	Factor		Total	
					40.00	2.43	1.0792	=	\$104.90	
258	16190	2213	5601	EA	For Work In Restricted Working Space, Add					\$23.74
				Installation	Quantity	Unit Price	Factor		Total	
					40.00	0.55	1.0792	=	\$23.74	
259	16190	2214	EA	EMT Conduit Clamps, P1429, 1-1/4"						\$377.72
				Installation	Quantity	Unit Price	Factor		Total	
					140.00	2.50	1.0792	=	\$377.72	
260	16190	2214	5601	EA	For Work In Restricted Working Space, Add					\$83.10
				Installation	Quantity	Unit Price	Factor		Total	
					140.00	0.55	1.0792	=	\$83.10	
261	16190	2518	EA	Offset Bracket 6-TI-O, 3/8"						\$24.17
				Installation	Quantity	Unit Price	Factor		Total	
					16.00	1.40	1.0792	=	\$24.17	
262	16190	2615	EA	2-BR-B, Bridle Ring, 1/2"						\$38.31
				Installation	Quantity	Unit Price	Factor		Total	
					50.00	0.71	1.0792	=	\$38.31	
263	16190	2616	EA	2-BR-12, Bridle Ring, 3/4"						\$54.39
				Installation	Quantity	Unit Price	Factor		Total	
					70.00	0.72	1.0792	=	\$54.39	
264	16190	2617	EA	2-BR-20, Bridle Ring, 1-1/4"						\$75.76
				Installation	Quantity	Unit Price	Factor		Total	
					90.00	0.78	1.0792	=	\$75.76	
265	16190	2734	C	14-1/2" Nylon Cable Ties, 50# Tensile Strength						\$38.85
				Installation	Quantity	Unit Price	Factor		Total	
					3.00	12.00	1.0792	=	\$38.85	
266	16190	3103	EA	1/4" x 4" Toggle Bolt, Including Drilling In Concrete, CMU, Wood Or Steel						\$949.70
				Installation	Quantity	Unit Price	Factor		Total	
					800.00	1.10	1.0792	=	\$949.70	

Proposal Review - CSI Detail (Continued)

Job Order Number: 08631.01

Job Order Name: PBSO - ISS HVAC

Review: PBSO - ISS HVAC - 8/7/2009 2:24:29PM

267	16190	4801	EA	1/4" Multi-Set Anchor 1" Min Depth In Concrete					\$2,456.26
				Installation	Quantity	Unit Price	Factor	Total	
					400.00	5.69	1.0792 =	\$2,456.26	
268	16190	4801	9911	EA	For Work In Restricted Working Space, Add				\$712.27
				Installation	Quantity	Unit Price	Factor	Total	
					400.00	1.65	1.0792 =	\$712.27	
269	16330	2603	EA	75 KVA, 480 x 480 Y / 277 V, Transformer, 3 Phase, 60 Hz, General Purpose, Dry					\$7,426.95
				Installation	Quantity	Unit Price	Factor	Total	
					1.00	6,881.90	1.0792 =	\$7,426.95	
270	16470	7151	EA	70-225 A 3 Pole Molded Case Circuit Breaker Conventional					\$2,789.28
				Installation	Quantity	Unit Price	Factor	Total	
					2.00	1,292.29	1.0792 =	\$2,789.28	
271	16470	7157	EA	Shunt Trip, Factory Installed					\$1,136.87
				Installation	Quantity	Unit Price	Factor	Total	
					4.00	263.36	1.0792 =	\$1,136.87	
272	16470	8202	EA	70-100 A, Type EHB, 2 Pole Circuit Breaker Panel Mounted, WRI, 600 V, Molded Case					\$641.39
				Installation	Quantity	Unit Price	Factor	Total	
					2.00	297.16	1.0792 =	\$641.39	
273	16471	2207	EA	100 A With 20 - 20 A Breakers, 120/240 V, 3 Wire, 1 Phase Panelboard, Main Lugs, Assembled, 24 Circuit Capacity					\$1,317.11
				Installation	Quantity	Unit Price	Factor	Total	
					1.00	1,220.45	1.0792 =	\$1,317.11	
274	16471	4311	EA	1 Pole, 240 Volt, 15-60 A, Branch Circuit Breaker, 18,000 Amp Interrupting Capacity					\$463.46
				Installation	Quantity	Unit Price	Factor	Total	
					7.00	61.35	1.0792 =	\$463.46	
275	16471	4311	4391	EA	For Bolt-On, Add				\$78.72
				Installation	Quantity	Unit Price	Factor	Total	
					7.00	10.42	1.0792 =	\$78.72	
276	16502	6406	EA	Daybrite 15' Whip PC-12-2E-15					\$164.56
				Installation	Quantity	Unit Price	Factor	Total	
					4.00	38.12	1.0792 =	\$164.56	
277	16510	1332	EA	2' x 2' Lay-In/Troffer Prismatic Lens Fluorescent Fixture, (4T8) Note: With electronic ballast.					\$673.59
				Installation	Quantity	Unit Price	Factor	Total	
					4.00	156.04	1.0792 =	\$673.59	
278	16510	1341	EA	2' x 4' Lay-In/Troffer Prismatic Lens Fluorescent Fixture, (2T8) Note: With electronic ballast.					\$72.13
				Installation	Quantity	Unit Price	Factor	Total	
					0.00	99.89	1.0792 =	\$0.00	
				Demolition	Quantity	Unit Price	Factor	Total	
					4.00	16.71	1.0792 =	\$72.13	
279	16514	1001	EA	Remove And Reinstall Lay-In Fluorescent Light Fixture					\$586.16
				Installation	Quantity	Unit Price	Factor	Total	
					13.00	41.78	1.0792 =	\$586.16	
280	16915	1003	EA	Industrial Control Relay 20 A 120 V Coil 12 Contacts					\$3,889.17
				Installation	Quantity	Unit Price	Factor	Total	
					15.00	240.25	1.0792 =	\$3,889.17	
				F/A - Control module # SIGA-CR					

Subtotal for 16 \$71,690.53

Section 18

Proposal Review - CSI Detail (Continued)

Job Order Number: 08631.01

Job Order Name: PBSO - ISS HVAC

Review: PBSO - ISS HVAC - 8/7/2009 2:24:29PM

281	18000	8631	EA	Structural Design A/C pads					\$920.00
					Quantity		Unit Price	Factor	Total
			Installation		1.00	x	800.00	x	\$920.00
								1.1500 =	
Subtotal for 18									\$920.00

Proposal Review Total

\$750,855.27

This job order proposal total represents the correct total for the proposal. Any discrepancy between line totals, sub-totals and the proposal total is due to rounding of the line totals and sub-totals.

August 11, 2009	Detailed Scope of Work Job Order Construction Services	
Loc # 108 Joc#: 08631.01	PBSO - ISS HVAC CJC Bldg A, Administration, 3228 Gun Club Road 3228 Gun Club Road, WEST PALM BEACH	

Preliminary
 Revised
 Final

JOC Coordinator: Daniel Racette

Scope of Work:

Project #08631.01
PBSO ISS -HVAC

Location: 3228 Gun Club Road West Palm Beach, Fl

Scope of work:

The Contractor shall provide all labor, materials, structural engineering, Fire alarm drawings and permits required to install (2) two Liebert 45 tons refrigerant chillers model XDC160. The system shall include all utilities associates with this system to include, piping, electrical, cooling module and suspended track system to support all refrigerant piping .All work shall done in accordance with the drawings provided by Gartek engineering. The scope will also include the installation of (2) two concrete pads surrounded by 8 concrete bollards .The Contractor shall include the installation of 4 new 2 x 2 lighting fixtures. The contractor shall purchase and install 12 new floor grilles.

Responsibility

- 1- PBSO or Facilities management shall provide escort when working in area such as Armory or evidence section
- 2- PBSO ISS shall remove all equipment in the area where the new chillers are to be installed
- 3- PBSO ISS shall remove the shelving within the ISS located on the south wall where the electrical panel and both a/c disconnect are to be installed.

Mechanical

All work shall be done in accordance with the drawings provided by Gartek engineering.

Electrical

All work shall be done in accordance with the drawings provided by Gartek engineering.

- 1- Any exterior disconnect shall be of Stainless steel construction.
- 2- Any exterior piping shall be of ridgit pipe construction EMT will be acceptable on the interior of the building.

Structural (concrete pads)

- 1- The Contractor shall provide engineering for the concrete pads
- 2- The contractor shall install 8 Concrete bollards.
- 3- The bollards shall be painted yellow

Ceiling Grid and tiles

- 1- The Contractor shall responsible to replace any ceiling grid damage due to construction
- 2- Any damage ceiling tiles shall be replaced with Armstrong 823 cortega ceiling tiles.
- 3- Any ceiling tiles penetration to support either piping or cooling shall include the installation of a fire sprinkler escusion.

ISS Raise floor air flow tiles

1- The contractor shall purchase and install (12) ASM AF Series mODEL #AF200 color to selected By Facilities management

Fire Alarm

- 1- The Contractor shall be responsible to secure the service from a fire alarm company to provide permit, engineering and scope of work to tie a HVAC unit shutdown into the existing fire alarm system.

Project requirement:

- 1- Working hours are Monday to Friday from 7:00am to Friday 5:00
- 2- Any request for alternate working hours/ night or weekend work shall be address in writing to the Project Manager.
- 3- The Contractor shall protect existing equipment from construction debris within the construction area at all times.
- 4- The Contractor/or Sub- Contractor shall report on a daily base with Facilities management to let them be aware of their presence on site.
- 5- The Contractor shall clean-up their work area on a daily bases.

EMPLOYEE CLEARANCE

- 1- Every employee that works on this project is subject to a PBSO security background check prior to starting the project.
- 2- **Every employee shall attend a 3 hours class on working around inmates**
- 3- Badges are to be worn and displayed at all times that the worker is on the job site.
- 4- A tool list is to be in workers tool box or bag at all times.
- 5- The Contractor shall comply with the provisions of Ordinance 2003-030 (Criminal History Record Check Ordinance), if a Contractors' employee or subcontractor are required under this contract to enter a "critical facilities" as identified in resolution R2003-1274. The Contractor acknowledges and agrees that all employee and subcontractors who are to perform work in a "critical facility" will undergo a fingerprint based criminal history check.

Prior to commencement of work within a critical facility, the Contractor shall make arrangements through the County's Electronic Services and Security Division/Access Section for its employees and those of its subcontractors to have a fingerprint based Criminal history record check performed. Those employees cleared of disqualifying offences will be granted an ID badge which must be worn at all times. A list of

disqualifying offenses is available upon request. Any person found to have a disqualifying criminal offense will be denied unescorted access to the project. The Contractor will be charged a nominal fee for any lost cards.

Palm Beach County agrees to pay for all applicable FDLE/FBI fees required for criminal History record check. The Contractor shall be solely responsible for all direct and indirect Cost associated with complying with Ordinance 2003-030

DATE August 11, 2009	GC 06 - SBE Estimate		
Job# 08631.01 Loc# 108	CJC Bldg A, Administration, 3228 Gun Club Road PBSO - ISS HVAC		
SUBMITTED BY	HA Contracting Corp. 9500 NW 12th Street Miami, FL 33172	Contract: R-2007-0944 Awarded: 06/17/2009	

Proposal Value: \$ 750,855.27

Contractor/Sub-Contractor	Trade	SBE Status	SBE \$	% of Job
Kerney & Associates, Inc.		SBE-Non MWBE	482,763.00	482,763.00

Total estimate SBE participation

1

64.30%



ATTACHMENT #4

BUDGET AVAILABILITY STATEMENT

REQUEST DATE: 07/16/09

REQUESTED BY: Daniel Racette

PHONE: 233-2057

PROJECT TITLE: PBSO - ISS HVAC

PROJECT NO.: #08631.01

Memo # 3797730

LOCATION: 3228 Gun Club Road, WPB

LOCATION DESCRIPTION:

BUILDING NUMBER: 108

JUL 30 2009

CONTRACTOR/CONSULTANT NAME: H.A. Contracting Corp.

PROVIDE A BRIEF STATEMENT OF THE SCOPE OF SERVICES TO BE PROVIDED BY THE CONSULTANT/CONTRACTOR: Furnish all material, labor, structural engineering, fire alarm drawings, supervision and permits required to install two (2) Liebert 45-ton refrigerant chillers model XDC160 per proposal submitted by H.A. Contracting Corp.

WILL THIS AMENDMENT CHANGE THE ESTIMATED COST OF THE PROJECT? IF YES, PROVIDE ESTIMATES OF THE NEW COSTS:

CONSTRUCTION	<u>\$750,855.41</u>	(Option 2)
ARCHITECTURE/ENGINEER	<u>\$ 11,262.83</u>	1.5 WORK ORDER AMOUNT FOR TGG FEE
*STAFF COSTS	<u>\$ 3,754.28</u>	
EQUIPMENT/ OTHER	<u>NA</u>	
CONTINGENCY	<u>\$ 75,085.55</u>	
TOTAL	<u>\$840,958.07</u>	

By signing this BAS your department agrees to these staff costs and your account will be charged upon receipt of this BAS by FD&O. Unless there is a change in the scope of work, no additional staff charges will be billed.

BUDGET ACCOUNT NUMBERS (IDENTIFY ALL SOURCES) FUNDING SOURCE (CHECK ALL THAT APPLY)

FUND: 3804-411-13433-02-4907-440,000
AGENCY: 3804-411-13420-4907-400,958.07
ORG: OBJ: SUBOBJ:

AD VALOREM OTHER FEDERAL/DAVIS BACON

SUPPLEMENTAL AGREEMENT TO BE APPROVED BY: Department Director (WO<\$50,000)

ANTICIPATED DATE OF APPROVAL:

BAS APPROVED BY: [Signature]

DATE: 7/20/09

ENCUMBRANCE NUMBER: _____

ATTACHMENT #5