

II. FISCAL IMPACT ANALYSIS

A. Five Year Summary of Fiscal Impact:

Fiscal Years	2012	2013	2014	2015	2016
Capital Expenditures	\$356,755	0	0	0	0
Operating Costs	0	0	0	0	0
External Revenues	0	0	0	0	0
Program Income (County)	0	0	0	0	0
In-Kind Match (County)	0	0	0	0	0
NET FISCAL IMPACT	\$356,755				
# ADDITIONAL FTE POSITIONS (Cumulative)					

Is Item Included in Current Budget? Yes X No _____
 Budget Account No: Fund 3804 Dept 411 Unit B545 Object 4907
 Reporting Category _____

B. Recommended Sources of Funds/Summary of Fiscal Impact:

This item is funded from the Public Building Improvement Fund.

C. Departmental Fiscal Review: [Signature] 9/15/11

III. REVIEW COMMENTS:

A. OFMB Fiscal and/or Contract Development and Control Comments:

- Ad Valorem Funded.

[Signature] 9/21/11
 OFMB
 9/19/11
 9/15/11

[Signature] 9/21/11
 Contract Administrator

B. Legal Sufficiency:

This item complies with current County policies.

[Signature]
 Assistant County Attorney

C. Other Department Review:

 Department Director

This summary is not to be used as a basis for payment.

Palm Beach County Sheriff's Office
3228 Gun Club Road
West Palm Beach, FL 33406

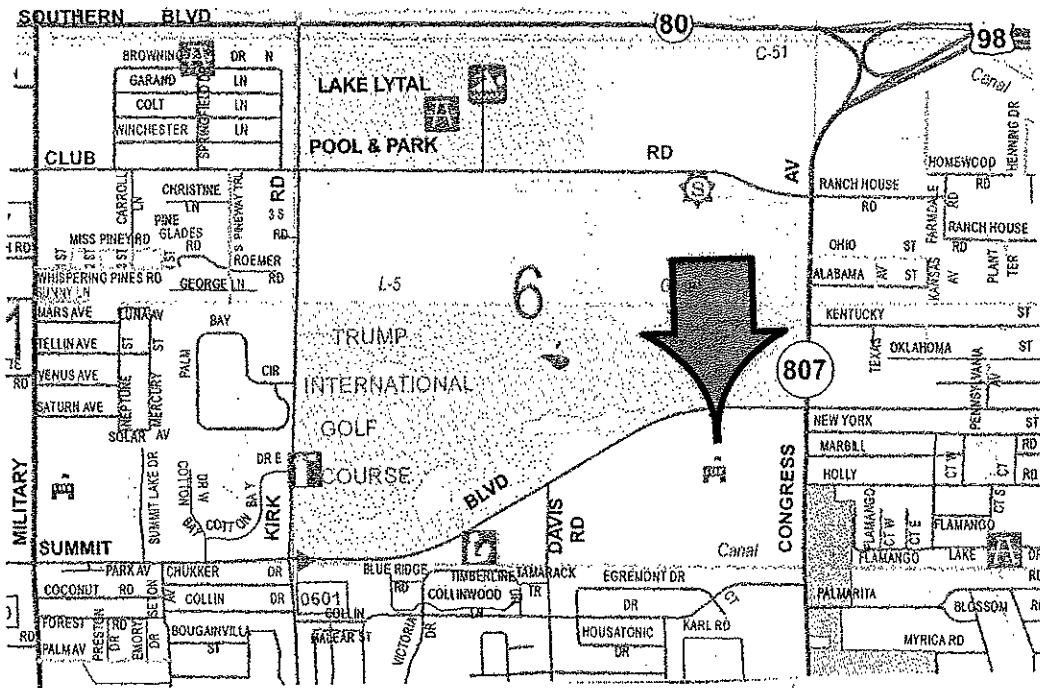

**FACILITIES DEVELOPMENT & OPERATIONS
BUDGET AVAILABILITY STATEMENT**

REQUEST DATE: 08/01/11

REQUESTED BY: Anil Patel

PHONE: 233-0271

FAX: 233-0270

PROJECT TITLE: PBSDO – Main Detention Center Generator Replacement PROJECT NO.: 11208

ORIGINAL CONTRACT AMOUNT: NA - Annual

BCC RESOLUTION#: _____
DATE _____

REQUESTED AMOUNT: \$356,755

CSA or CHANGE ORDER NUMBER: CSA #2

CONSULTANT/CONTRACTOR: Leo A. Daly

PROVIDE A BRIEF STATEMENT OF THE SCOPE OF SERVICES TO BE PROVIDED BY THE CONSULTANT/CONTRACTOR:

Professional services shall include design, permitting, bidding and negotiations, and construction administration services for a one story addition and renovation of the existing Facilities Maintenance Building.

CONSTRUCTION	<u>\$356,755</u>
PROFESSIONAL SERVICES	_____
STAFF COSTS** (Design/Construction Phase)	_____
MISC. (permits, prints, advertising)	_____
TOTAL	\$356,755

** This is an estimate of staff charges. Actual(s) will be billed at the end of each fiscal year.

BUDGET ACCOUNT NUMBER (IF KNOWN)

FUND: 3804 DEPT: 411 UNIT: B545

OBJ: 4907 ~~is~~ subject to BCC Budget Approval 10-1-11

FUNDING SOURCE (CHECK ALL THAT APPLY):

AD VALOREM OTHER
 FEDERAL/DAVIS BACON

SUBJECT TO IG FEE? YES NO

BAS APPROVED BY: _____

DATE: 8-2-11

ENCUMBRANCE NUMBER: _____

CONSULTANT SERVICES AUTHORIZATION

LEO A DALY
Annual Architectural Contract

**PBSO - MAIN DETENTION CENTER
GENERATOR REPLACEMENT
PROJECT NO. 11208
DISTRICT NO. 2**

THIS AUTHORIZATION NO. 2 to the Contract dated 02/01/11 (R-2011-0112) between Palm Beach County and the Consultant identified herein is for the Consultant Services described in Item 3 of this Authorization.

1. **CONSULTANT:** **LEO A. DALY**
1400 CENTREPARK BOULEVARD, SUITE 500
WST PALM BEACH, FL 33401
2. **History:** Not applicable. This authorization is for a new project.
3. **Services completed to date:** Not applicable. This authorization is for a new project.
4. **Description of Services to be provided by Consultant:** Professional services shall include design, permitting, bidding and negotiations, and construction administration services for a one story addition and renovation of the existing PBSO Mechanical Building as detailed on the attached proposal dated April 8, 2011.
5. **Time of Commencement:** Consultant shall begin work promptly on the requested services upon receipt of this executed document which shall constitute official "Notice to Proceed".
6. **Compensation:** The compensation to be paid to the Consultant for the requested services shall be:

Lump Sum charge of \$356,755.00
7. **This Authorization may be terminated by the County without cause or prior notice. In the event of termination not the fault of the Consultant, the Consultant shall be compensated for all services performed to termination date, together with reimbursable expenses (if applicable) then due.**

Consultant agrees to waive any and all claims for lost profits or anticipated future profits in the event of a termination with or without the cause under this Contract.

8. If not previously provided or for a new project, the Consultant shall provide County with an executed Conflict of Interest Disclosure Form, attached hereto and incorporated herein.
9. **EXCEPT AS HEREBY AMENDED, CHANGED OR MODIFIED**, all other terms, conditions, and obligations of the original Contract shall remain in full force and effect.

IN WITNESS WHEREOF, this Authorization is accepted, subject to the terms and conditions of the aforementioned Contract.

COUNTY

ATTEST:
Sharon R. Bock, Clerk & Comptroller

PALM BEACH COUNTY, FLORIDA, a
Political Subdivision of the State of Florida

BOARD OF COUNTY COMMISSIONERS

By: _____
Deputy Clerk

By: _____
Karen T. Marcus, Chair

Approved as to Form and Legal
Sufficiency

Approved as to Terms and Conditions

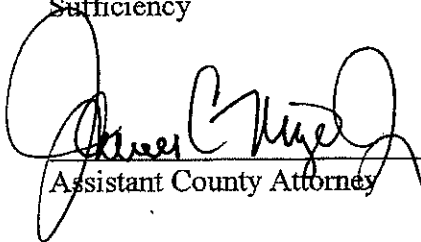

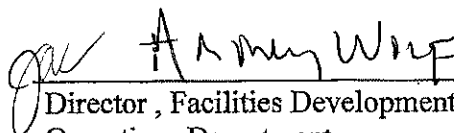
Assistant County Attorney

Director, Facilities Development &
Operations Department

WITNESS:

CONSULTANT

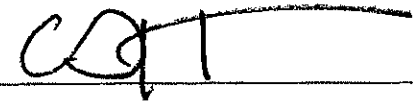

By: 
Name: _____

FERNANDO DELDISCO
Name (type or print)

Title: U.P.

Date: 8/25/11

LEO A DALY

PLANNING
ARCHITECTURE
ENGINEERING
INTERIORS



EST. 1915
ABU DHABI
ATLANTA
AUSTIN
BEIJING
BRYAN
CHICAGO
DALLAS
DENVER
FORT WORTH
HONG KONG
HONOLULU
HOUSTON
ISTANBUL
LAS VEGAS
LOS ANGELES
MIAMI
MINNEAPOLIS
MOSCOW
OMAHA
PHOENIX
SACRAMENTO
SAN ANTONIO
SAN MARCOS
TAMPA
TIANJIN
WACO
WASHINGTON, DC
WEST PALM BEACH

Revised April 8, 2011
March 22, 2011

Mr. Anil Patel
Project Manager
Capital Improvements Division
2633 Vista Parkway
West Palm Beach, FL 33411

Re: Palm Beach County Main Detention Center
PBSO-Main Detention Center Generator Replacement
PBC Project #11208

Dear Anil,

We thank you for being given the opportunity to continue our long relationship with Palm Beach County pursuant to the Palm Beach County Main Detention Center PBSO Mechanical Building Additions/Renovations Project. We are pleased to offer this proposal as follows:

SCOPE OF SERVICES:

The scope of the project shall include Architectural, Structural, Mechanical, Electrical, Plumbing, Fire Protection and Geotechnical Services for the one story addition and renovations planned for the existing PBSO Mechanical Building located at the Main Detention Center campus. The scope of work shall include the following:

A. Architectural Services:

- 1) Architectural Demolition Plans. Please refer to Exhibit "A" attached for diagrammatic description of proposed work.
- 2) Architectural floor plans, elevations and details required to define the additions and renovations. Please refer to Exhibit "B" attached for diagrammatic description of proposed work.
- 3) Coordination of consultant work.
- 4) Coordination meetings between Owner and Design team.
- 5) Review and responses to Owner's comments.
- 6) Bidding and Negotiation Phase Services
- 7) Permitting
- 8) Construction Administration.

Florida License
No. AAC000734

1400 CENTREPARK BOULEVARD
SUITE 500
WEST PALM BEACH, FL 33401
TEL 561.688.2111
FAX 561.697.8040
www.leoadaly.com

LEO A DALY

PLANNING
ARCHITECTURE
ENGINEERING
INTERIORS



EST. 1915
ABU DHABI
ATLANTA
AUSTIN
BEIJING
BRYAN
CHICAGO
DALLAS
DENVER
FORT WORTH
HONG KONG
HONOLULU
HOUSTON
ISTANBUL
LAS VEGAS
LOS ANGELES
MIAMI
MINNEAPOLIS
MOSCOW
OMAHA
PHOENIX
SACRAMENTO
SAN ANTONIO
SAN MARCOS
TAMPA
TIANJIN
WACO
WASHINGTON, DC
WEST PALM BEACH

Mr. Anil Patel
Re: PBSO Mechanical Building Addition/Renovations
March 21, 2011
Page 2 of 5

B. Geotechnical Services:

- 1) As identified in Tierra Engineering's Proposal Dated March 17, 2011. Attached as Exhibit "C".

C. Structural Engineering Services:

- 1) As identified in Martinez Engineering Group's Proposal Dated March 21, 2011. Attached as Exhibit "D".

D. Mechanical, Electrical, Plumbing and Fire Protection Services:

- 1) As identified in Gartek Engineering's Revised Proposal Dated April 8, 2011. Attached as Exhibit "E".

DESIGN/CONSTRUCTION DOCUMENTS PHASE:

A total of two submissions have been assumed for this project. One submission at the Schematic/Design Development Phase and one submission at the Construction Documents phase. Written responses to Owner comments will be furnished at each submission and any related information will be incorporated into the documents. Two sets of signed and sealed construction documents will be prepared and submitted to the building department at the end of the construction documents period.

CONSTRUCTION ADMINISTRATION PHASE:

The construction administration phase shall include shop drawing review and processing and related activities. The construction administration has been assumed to be a six month duration. Site visits by the Architectural Design Team will occur two times per month. Site visits by the consultants will be as required.

DELIVERABLES:

One submission which is to include three (3) half size and seven (7) full size sets of plans and ten sets of specifications for review and comment will be provided at the conclusion of the Schematic/Design Development Phase and one submission which is to include three (3) half size and seven (7) full size sets of plans and ten sets of specifications for review and comment will be provided at the conclusion of the Construction Documents Phase. Two Signed and Sealed sets of drawings and specifications will be submitted for Building Department permitting.

Florida License
No. AAC000734

1400 CENTREPARK BOULEVARD
SUITE 500
WEST PALM BEACH, FL 33401
TEL 561.688.2111
FAX 561.697.8040
www.leoadaly.com

LEO A DALY

PLANNING
ARCHITECTURE
ENGINEERING
INTERIORS



EST. 1915
ABU DHABI
ATLANTA
AUSTIN
BEIJING
BRYAN
CHICAGO
DALLAS
DENVER
FORT WORTH
HONG KONG
HONOLULU
HOUSTON
ISTANBUL
LAS VEGAS
LOS ANGELES
MIAMI
MINNEAPOLIS
MOSCOW
OMAHA
PHOENIX
SACRAMENTO
SAN ANTONIO
SAN MARCOS
TAMPA
TIANJIN
WACO
WASHINGTON, DC
WEST PALM BEACH

Mr. Anil Patel
Re: PBSO Mechanical Building Addition/Renovations
March 21, 2011
Page 3 of 5

PROJECT LIMITATIONS/ASSUMPTIONS:

- Limited field verification will be provided. We will spot check field dimensions as required. Field verification will not include hidden conditions or removing or damaging existing portions of the building. Extensive field verification is not anticipated.
- Owner equipment, owner furniture, placement and specifications are provided by the Owner
- Security Electronic camera additions or renovations are not included in this scope of work.
- Survey work is not included in this scope of work.
- Material testing is not included in this scope of service.
- Cost Estimating services are not included in this scope of service.

SCHEDULE:

Twelve (12) weeks from the Execution of this Document. This schedule is based on a five week SD/DD phase, one week of owner review and comment and six weeks to finalize the drawings for Construction Documents/Building Department Permitting. A six month construction administration phase has been assumed for this project.

COMPENSATION:

Compensation to Leo A Daly shall be as stipulated below. Billing shall be on a monthly basis based on the percentage of completion of the work.

• Leo A. Daly	\$ 133,625.00 *
• Gartek Engineering	\$ 205,780.00
• Martinez Engineering Group, Inc.	\$ 12,000.00
• Tierra	\$ 5,350.00

Total Compensation Requested: \$ 356,755.00

* Includes Project Expenses.

Florida License
No. AAC000734

1400 CENTREPARK BOULEVARD
SUITE 500
WEST PALM BEACH, FL 33401
TEL 561.688.2111
FAX 561.697.8040
www.leoadaly.com

LEO A DALY

PLANNING
ARCHITECTURE
ENGINEERING
INTERIORS



EST. 1915
ABU DHABI
ATLANTA
AUSTIN
BEIJING
BRYAN
CHICAGO
DALLAS
DENVER
FORT WORTH
HONG KONG
HONOLULU
HOUSTON
ISTANBUL
LAS VEGAS
LOS ANGELES
MIAMI
MINNEAPOLIS
MOSCOW
OMAHA
PHOENIX
SACRAMENTO
SAN ANTONIO
SAN MARCOS
TAMPA
TIANJIN
WACO
WASHINGTON, DC
WEST PALM BEACH

Mr. Anil Patel
Re: PBSO Mechanical Building Addition/Renovations
March 21, 2011
Page 4 of 5

CHANGE IN SERVICES:

Services that are required of Leo A Daly that are not defined in the scope of work above, or for revisions to the above scope, shall be considered as change in services. Compensation for additional services shall be based upon the Standard Personnel Rates schedule which is currently included in the Contract for Architectural/Professional Services Agreement.

Category:	Billing Rate:
Principal	\$ 275.00
Senior Designer	\$ 145.00
Designer	\$ 110.00
Project Manager	\$ 160.00
Job Captain	\$ 115.00
Specification Writer	\$ 130.00
Graphic Designer	\$ 95.00
Technician (Draftsperson)	\$ 85.00
Clerical	\$ 55.00

EXPENSES:

Expenses for printing, travel, long-distance communications-telephone, fax and video conference, communications (including postage, express mail and couriers), computer time, printing, plotting and copying are included in our compensation noted above.

PAYMENTS:

The stipulated compensation shall be billed according to the current Contract for Architectural/Professional Services Agreement.

Mr. Patel, we, at Leo A Daly, look forward to working on this project. Should this proposal meet your needs, please countersign one copy and return it to us, keeping the other copy for your records. Upon receipt of the countersigned copy of the document, we will proceed with the professional services required for this project.

Florida License
No. AAC000734

1400 CENTREPARK BOULEVARD
SUITE 500
WEST PALM BEACH, FL 33401
TEL 561.688.2111
FAX 561.697.8040
www.leoadaly.com

LEO A DALY

PLANNING
ARCHITECTURE
ENGINEERING
INTERIORS



Mr. Anil Patel
Re: PBSO Mechanical Building Addition/Renovations
March 21, 2011
Page 5 of 5

Very truly yours
LEO A DALY COMPANY

Fernando Del Dago, AIA
Project Manager

Attachments:
Exhibit "A": Proposed Architectural Demolition Plan
Exhibit "B": Proposed Architectural Floor Plan
Exhibit "C": Tierra Proposal
Exhibit "D": Martinez Engineering Proposal
Exhibit "E": Gartek Engineering Proposal

Approved by:
Palm Beach County-Capital improvements Division

Anil Patel,
Project Manager

Florida License
No. AAC000734

1400 CENTREPARK BOULEVARD
SUITE 500
WEST PALM BEACH, FL 33401
TEL 561.688.2111
FAX 561.697.8040
www.leoadaly.com

Leo A Daly

FEE TABULATION WORKSHEET

DATE: 4/0711
 PROJECT: PBSO Main Detention Center Generator Replacement
 PROJECT NO: 11208
 LOCATION: West Palm Beach, FL
 OWNER: Palm Beach County
 PBC REP: Anil Patel
 SCOPE: A/E Services

TASK DESCRIPTION	Principal	Project Executive	Project Manager	Spec Writer	Project Designer	Job Captain	Senior Designer	CADD Operator	Admin	TASK HOURS	TASK BUDGET
Preliminary											\$4,110.00
Project Start-up & Administration			4							4	\$640.00
As-Built Gathering & Review										0	\$0.00
Field Verify As-Built Conditions			4					4		8	\$980.00
Owner Review Meeting			2							2	\$320.00
Drawings (Layout Studies)			2					18		20	\$1,850.00
Review of Budget Information			2							2	\$320.00
QA/QR										0	\$0.00
										0	\$0.00
Schematic Design & Design Development Phase											\$33,330.00
Project Start-up & Administration	2		4							6	\$1,190.00
Field Verify As-Built Conditions			6					6		12	\$1,470.00
Team Meetings/Coresp/Consultant Coordination			48							48	\$7,880.00
Drawings			24					130		154	\$14,890.00
Specifications			4	32						36	\$4,800.00
Responses to Owner Comments			10					20		30	\$3,300.00
Construction Documents											\$29,580.00
Team Meetings/Coresp/Interface			48							48	\$7,680.00
Drawings			22					140		162	\$15,420.00
Specifications			4	22						26	\$3,500.00
Responses to Owner Comments			8					20		28	\$2,980.00
CD Submittal Revisions											\$3,480.00
Team Meetings/Coresp/Interface			4							4	\$640.00
Drawings			4					16		20	\$2,000.00
Specifications				4						4	\$520.00
QA/QR			2							2	\$320.00
PERMITS											\$3,790.00
Respond to Comments			8					22			\$3,150.00
Permit Processing			4								\$640.00
BIDDING											\$6,720.00
Respond to RFIs			34								\$5,440.00
Meetings/ Team Interface/Bld Review			8								\$1,280.00
CONSTRUCTION											\$46,665.00
Schedule Reviews			2								\$320.00
Requisitions Review											\$0.00
CPR / COP Review			12								\$1,920.00
Submittals Review/ RFIs			59			175					\$29,565.00
OAC/Coordination Meetings			9			27					\$4,545.00
Special Meetings			6								\$960.00
Observations / Site Visits			9			27					\$4,545.00
Update Contract Documents			2					26			\$2,530.00
Substantial Completion Inspection			4								\$640.00
Final Completion Inspection			4								\$640.00
CONTRACT CLOSEOUT											\$640.00
Closeout Documents/Review			4								\$640.00
Maintenance Related Issues											\$0.00
TOTAL HOURS	2	0	367	58	0	229	0	402	0	616	
RATES	\$275	\$175	\$160	\$130	\$110	\$115	\$145	\$85	\$55		
BUDGET	\$550	\$0	\$58,720	\$7,540	\$0	\$26,335	\$0	\$34,170	\$0		\$127,315.00
SUBTOTAL											\$127,315.00
EXPENSES											\$6,310.00
Surveys											
Photographs											\$500.00
Mail/Federal Express/Courier Services											\$5,560.00
Reproductions/ Printing /Computer Time											\$250.00
Photocopies											
Travel/ Auto Mileage											
Long Distance Communication											
SUB-CONSULTANTS											\$0.00
MEP Engineer-Not included in this breakdown, refer to Consultant Proposal											
Structural Engineer-Not included in this breakdown, refer to Consultant Proposal											
Geotechnical -Not included in this breakdown, refer to Consultant Proposal											

TOTAL: \$133,625.00

FOOTNOTES

EXHIBIT 'A'

EXHIBIT 'B'

EXHIBIT 'C'



Revised March 17, 2011
March 15, 2011

TO: Leo A Daly
1400 Centrepark Boulevard, Suite 500
West Palm Beach, FL 33401

Attention: Mr. Fernando Del Dago, Senior Associate

SUBJECT: Geotechnical Engineering Study and
Existing Foundation Investigation
PBSO Mechanical Building Addition
Palm Beach County, Florida
TSF Proposal No. 1103-098

Dear Fernando:

TIERRA SOUTH FLORIDA, Inc. (TSF) is pleased to submit this proposal for performing subsurface exploration and investigating the existing foundation for the proposed PBSO Mechanical building addition/renovation in Palm Beach County, Florida. This letter presents our proposed scope of services, anticipated schedule and fees for the geotechnical work.

SCOPE OF WORK

We understand that the proposed construction will consist of a 1-story addition to the existing PBSO Mechanical building. We propose to perform two (2) Standard penetration Tests (SPT) borings to a depth of 20 feet below grade.

Prior to drilling at the project site, TSF will notify the local utility companies and request that underground utilities be marked. We have assumed that the site is accessible with a truck mounted drill rig.

In order to investigate the foundation at the two locations indicated in the drawing provided by Leo A Daly, a section of about 2'X2' slab will be cut and removed. Efforts will be made to excavate the soil in the cut area so as to investigate the depth of the footing. Please note that the excavated soil will be backfilled but not compacted, and efforts will be made to place the slab piece back in the cut area. No patching is anticipated.

A final report will be issued containing subsurface soil types and geotechnical recommendations for foundation support, and a narrative of what is encountered in the two test excavations.

SCHEDULE

TSF will proceed with the work immediately upon approval. With our present schedule, upon utility clearance, the fieldwork will take two days to complete. The written report can be submitted within two weeks after completion of the field test. For our records, please sign and fax a copy of this proposal to our office.

COMPENSATION

The work will be billed on a not to exceed basis, at the unit rates shown below.

I. <u>Mobilization and Project Initiation</u>	
Lump Sum	\$350.00
II. <u>Utility Coordination/Layout</u>	
Senior Engineering Technician, 6 hours @ \$65.00/hr	\$390.00
III. <u>Field Work</u>	
SPT tests, 40 feet @ \$12.00/ft	\$480.00
SPT Grout backfill, 40 @ \$5.50/ft	\$220.00
Slab cut, 2 sections (2'X2')	\$600.00
Excavation, 2 man crew, 8 hrs@\$50/hr	\$800.00
Foundation observation and coordination, 8 hrs@\$125/hr	\$1000.00
IV. <u>Coordination and Reporting Results</u>	
Senior Geotechnical Engineer-Report preparation	\$1,250.00
Estimate 10 hours @ \$125.00/hr	<u>260.00</u>
Drafting/CADD, 4 hours @ \$65.00/hr	
TOTAL PROJECT COST:	\$5,350.00

We appreciate the opportunity to submit this proposal and look forward to working with you on this project. If you should have any questions concerning our proposal, please contact our office.

Respectfully submitted,

TIERRA SOUTH FLORIDA, INC.

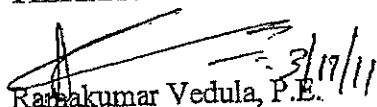
Raghakumar Vedula, P.E.
Principal Engineer



Francois Thomas, P.E.
Vice President

EXHIBIT 'D'

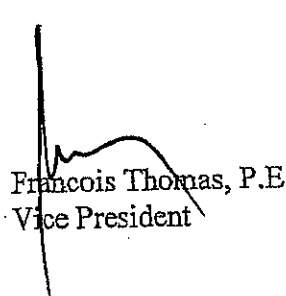

Martinez Engineering Group, Inc.

Structural Engineers

2655 S Le Jeune Road, Suite 700
Coral Gables, Florida 33134
305-629-8318 / Fax 305-444-5575

March 21, 2011

Mr. Fernando Del Dago, AIA
Leo A Daly, Formerly STH Architectural Group
1400 Centrepark Boulevard, Suite 500
West Palm Beach, Florida 33401

Re: Revised Proposal for Structural Engineering Services
PBSO Mechanical Building Addition/Renovation
Palm Beach County, Florida
MEG Proposal No. 21111R

Dear Fernando:

We are pleased to submit this revised proposal for structural engineering services for the above referenced project. Our proposal is based on the information you provided on your emails of March 9, March 11, and March 21, 2011, and our recent phone conversations.

We understand that the scope of work consists of providing full structural design and construction administration services for a new Mechanical Room addition and the renovation of an existing Mechanical Room at the Palm Beach County Main Detention Center. We also understand the Owner may want the new addition to be designed for a higher basic wind speed (180 mph as opposed to the Code prescribed 140 mph). The Owner shall give a directive on which basic wind speed to use for the design prior to commencement of our design.

We anticipate that our services for the scope described above will consist of:

1. One site visit to ascertain existing conditions;
2. Attendance to scheduled design coordination meetings;
3. Design of new building addition, including foundations;
4. Design/detailing of modifications to existing building as needed by project requirements;
5. Preparation of structural drawings;
6. Preparation of structural specifications to match your office's format;
7. Two submittals for the project;
8. Responses to Building Official's review comments on the Permit Documents;
9. Review of structural shop drawings;
10. Responses to construction questions on the structural drawings; and
11. Site visits during construction to verify structural design intent.

Our proposed fee for the services described above is \$12,000.00.

Fernando Del Dago, AIA
March 21, 2011
Page 2

Reimbursable expenses shall include any printing required for official submittals, communication expenses, transportation and subsistence away from South Florida, if any, and other miscellaneous expenses directly related to the work. We estimate our reimbursable expenses shall not exceed \$500.00.

Please let me know if you have any questions or comments regarding the scope of work or our understanding of the project. Should this proposal be acceptable to you, please sign below and forward one copy back to us. We look forward to working with you and your firm on this project and to continue our professional relationship.

Sincerely,

MARTINEZ ENGINEERING GROUP, INC.

On behalf of

LEO A DALY

Carlos F. Sanz, P.E.
Senior Engineer

Fernando Del Dago, AIA

cc: Josefina Martinez, MEG
Proposal File

EXHIBIT 'E'



April 8th, 2011

Mr. Fernando Del Dago
Senior Associate, Principal
Leo A. Daly
1400 Centrepark Boulevard
Suite 500
West Palm Beach, FL 33401

*** Via-Email ***
FDeldago@leoadaly.com

RE: PBC CJC Building A, Option C
Replace Generators, Chillers on Emergency Power -- Fee reduction 3-22-11

Dear Fernando:

We are pleased to present our proposal on Engineering Services for the referenced project.

We will provide Plumbing, Fire Protection, HVAC and Electrical Engineering for a lump sum fee as indicated below and on the attached fee breakdown.

Our fee is based on the following breakdown:

• Existing Conditions, Relocation, Demolition of MEP/FP (note: Continuity of service will be developed in this phase)	\$ 37,020.00
• 50% construction documents	\$ 68,760.00
• 100% construction documents	\$ 54,160.00
• Bid and Permit Phase	\$ 10,880.00
• Construction Phase	<u>\$ 34,960.00</u>
TOTAL	<u>\$205,780.00</u>

Please refer to attached fee breakdown for additional task description in each project phase. Our fee is based on a six (6) month construction period. If actual condition of the Work extends the construction period beyond six months, we would request that PBC consider increasing our fee commensurate with the extension of construction time.

Principal items in the scope of the project consist of the following:

- Replacement of three (3) 800kW existing generators with (2) new 1750kW generators.
- Replacement of the existing generator paralleling gear and Emergency Distribution Switchboard.
- Conversion of the existing 3,000A feeder supplying Building A from Normal to Emergency Power.
- Conversion of existing distribution system in Main electrical room of Building A to accept new emergency power feeder from new emergency generators.

Gartek Engineering Corporation

7210 SW 39 Terrace • Miami, Florida 33155 • Phone (305) 266-8997 • Fax (305) 264-9496
4723 W. Atlantic Ave. • Suite A18 • Delray Beach, Florida 33445 • Phone (561) 637-8909 • Fax (561) 637-8959
730 East Prospect Road #100 • Oakland Park, Florida 33334 • Phone (954) 399-2347

www.gartek-engineering.com



April 8th, 2011

Mr. Fernando Del Dago

Re: PBC CJC Building A, Option C - revised
Replace Generators, Chillers on Emergency Power

Page 2 of 3

- Repowering from the new generators the existing chillers, chilled water pumps, and cooling towers to allow any one chiller to operate on emergency power under loss of normal power.
- Installation of chilled water lines motorized isolation valves to limit chilled water flow to all buildings except Building A under loss of normal power.
- Modification of the Energy Management system to allow operation of chillers, pumps, and cooling towers as described above
- Re routing of all existing MEP/FP and natural gas utilities in conflict with construction of new generator room.
- Demolition of the existing wood shop and break room addition for construction of the new generator room
- Removal of existing generators and conversion of generator room to break room

The Fee will include the following:

1. Fire Protection, Plumbing, HVAC, and Electrical Plans.
- ✓ 2. Lightning Protection.
3. Our fee includes all reproduction internal to our office and three sets signed and sealed.
4. Specifications.
5. Shop Drawing review.
6. Site visits for the purpose of familiarizing ourselves with existing conditions.
7. We will coordinate our work with FPL and the Gas company.
8. Our fee includes services during construction as indicated on the attached breakdown.

The following will not be included in the Basic Fee:

1. Re-design as a result of value engineering recommendations received after completion of design.
2. Landscape irrigation design.
3. Design of sewage treatment plant, lift station, or water supply treatment plant.
4. Civil Engineering, Paving, grading, drainage and site water and sewer distribution and collection. If new lines are required, our design of water and sewer will be based on connecting to existing water and sanitary lines available in the building.

Work approved by you to be completed on an hourly basis will be charged at the following rates:

Principals	US\$170.00/hr
Sr. Engineer	US\$140.00/hr
Engineer	US\$130.00/hr
CAD Designer	US\$ 80.00/hr
Administrative	US\$ 45.00/hr

Our fee will be invoiced and payable on a percentage of completion basis during the design period.

Gartek Engineering Corporation

7210 SW 39 Terrace • Miami, Florida 33155 • Phone (305) 266-8997 • Fax (305) 264-9496
4723 W. Atlantic Ave. • Suite A18 • Delray Beach, Florida 33445 • Phone (561) 637-8909 • Fax (561) 637-8959
730 East Prospect Road #100 • Oakland Park, Florida 33334 • Phone (954) 399-2347

www.gartek-engineering.com



April 8th, 2011

Mr. Fernando Del Dago

Re: **PBC CJC Building A, Option C - revised**
Replace Generators, Chillers on Emergency Power

Page 3 of 3

We will invoice in proportion to services rendered and payment will be expected within thirty (30) days. Interest on overdue accounts beyond 30 days of billing date will be charged at a rate of 1.5% per month beginning at the invoice date. Payment for services is your direct obligation and is not contingent upon any other payment schedules pursuant to other contracts or financial arrangements. If payment is not received within thirty (30) days of your receiving our invoice, we have the option to cease providing services during that time and we cannot be held responsible for costs generated by our work stoppage. The successful party to litigation related to agreement will be entitled to collect legal fees. Our fee is valid provided that the design of this project is completed within six (6) months of the date of this proposal. For reimbursable expenses such as travel, lodging, reproduction costs or special mailing instructions, we will invoice at a multiple of 1.1 times the amount expended in the interest of the project.

Thank you for the opportunity to present this proposal. If you are in agreement with our proposal, kindly return a signed copy as authorization. We will be ready to start upon receipt of final architectural backgrounds.

Sincerely,
GARTEK ENGINEERING, CORP.,

Mel F. Garcia

M. F. Garcia, P.E. LEED AP
Vice President
MFG:pcy

Authorized by **LEO A. DALY** for Gartek
Engineering Corp., to provide the above services:

Attachment

Signed: _____

Name: _____

Title: _____

Date: _____

Gartek Engineering Corporation

7210 SW 39 Terrace • Miami, Florida 33155 • Phone (305) 266-8997 • Fax (305) 264-9496
4723 W. Atlantic Ave. • Suite A18 • Delray Beach, Florida 33445 • Phone (561) 637-8909 • Fax (561) 637-8959
730 East Prospect Road #100 • Oakland Park, Florida 33334 • Phone (954) 399-2347

www.gartek-engineering.com



Project: **Palm Beach County Criminal Justice Center, PBSO Building A, Option C - Modifications to place entire facility on emergency generator, replace (3) existing 800kW with (2) 1750kW, provide emergency power to chillers.** 4/8/11

Gartek Engineering Corp

Position:	PRINCIPAL		FIRE PROT ENGINEER		PLUMBING ENGINEER		HVAC ENGINEER		ELECTRICAL ENGINEER		TECHNICIAN		MISC Other		TOTAL		
	M-H	Cost	M-H	Cost	M-H	Cost	M-H	Cost	M-H	Cost	M-H	Cost	M-H	Cost	M-H	Avg. Hrly Rate	
Existing Conditions, Demolition, Continuity Plans																	
<u>Plumbing:</u> establish underground routing of existing gas line in coordination with Utility Co, prepare relocation plan for minimal interruption of gas supply, re-route gas line inside building service away from generators and electrical gear. Prepare plumbing demolition plans related to existing domestic water and sanitary lines in conflict with new construction. Make provisions to supply new generators from existing fuel lines while maintaining fuel supply to existing generators.	2	\$340		\$0	40	\$5,600		\$0		\$0	30	\$2,400		\$0	72	\$8,340	\$118
<u>HVAC:</u> Re route existing chilled water and hot water lines supplying existing-to-remain HVAC equipment. Remove HVAC equipment in conflict with new construction, Re-route/remove existing exhaust fans/ducts. Remove existing generator room exhaust. Survey existing installation to establish exact location for new motorized chilled water lines. Establish control scheme for operation of only one chiller from generator power.	2	\$340	0	\$0	0	\$0	32	\$4,480	0	\$0	24	\$1,920	0	\$0	58	\$6,740	\$118
<u>Fire Protection:</u> Survey existing installation and prepare demolition plan for shop and break room area. Make provisions for coverage continuation in other areas. Order and review flow and pressure test.	2	\$340	16	\$2,240	0	\$0	0	\$0	0	\$0	8	\$640	0	\$0	26	\$3,220	\$124
<u>Electrical:</u> Identify all feeders and panelboards being supplied from existing panelboards which will be affected by removal of existing paralleling gear including all feeders out of SWBD "X", the motor control center, all fire pumps, domestic water booster systems, all life safety and equipment branch panelboards. Prepare plan for alternate power supply to allow removal. Prepare demolition plan of existing shop and break area. Make provisions to re-route existing feeders affected by demolition including feeders on exterior wall and feeders out of the main electrical room. Coordinate with FPL addition of new 3,000A feeder simultaneously with existing 3,000A to Building A, new 1,200A feeder simultaneously with existing supplying SWBD "X". Identify size and routing of existing feeders supplying 5 ATS's presently installed remotely from Utility building to prepare alternate bid for replacing existing feeders. Develop plan for splicing existing feeders to remain in present location of distribution section of paralleling gear. Prepare plan of everything supplied from existing 3,000A SWBD in Building A in preparation for transition to new feeder (under 50% CD's).	16	\$2,720	0	\$0	0	\$0	0	\$0	80	\$11,200	80	\$4,800	0	\$0	166	\$18,720	\$120
Sub-total Exist Conditions, Demo, & Continuity Plan	22	\$3,740	16	\$2,240	40	\$5,600	32	\$4,480	80	\$11,200	122	\$9,760	0	\$0	312	\$37,020	18%



Project: **Palm Beach County Criminal Justice Center, PBSO Building A, Option C - Modifications to place entire facility on emergency generator, replace (3) existing 800kW with (2) 1750kW, provide emergency power to chillers.** 4/6/11

Gartek Engineering Corp

Position:	PRINCIPAL		FIRE PROT ENGINEER		PLUMBING ENGINEER		HVAC ENGINEER		ELECTRICAL ENGINEER		TECHNICIAN		MISC Other		TOTAL			
	\$170.00		\$140.00		\$140.00		\$140.00		\$140.00		\$80.00		\$45.00		M-H	Cost	Avg. Hrlly Rate	
	M-H	Cost	M-H	Cost	M-H	Cost	M-H	Cost	M-H	Cost	M-H	Cost	M-H	Cost				
50% Construction Documents																		
Plumbing: Plumbing for new restrooms, new fuel supply and exhaust for new generators, demolition of existing fuel lines, remote radiator, and exhaust piping of existing generators.	4	\$680	0	\$0	40	\$5,600	0	\$0	0	\$0	40	\$3,200	0	\$0	84	\$9,480	\$113	
HVAC: New HVAC for break area, ventilation for new generator room, HVAC of new switchgear room.	0	\$0	0	\$0	0	\$0	40	\$5,600	0	\$0	16	\$1,280	0	\$0	56	\$6,880	\$123	
Fire Protection: FP of new generator room and break room areas	0	\$0	16	\$2,240	0	\$0	0	\$0	0	\$0	8	\$640	0	\$0	24	\$2,880	\$120	
Electrical: New generator room design including layout, feeder route, sequence of installation to minimize electrical outages, selection and layout of new electrical switchgear supplying existing chillers, pumps, cooling towers, and all equipment supplied from normal and emergency swbds which will be affected by removal of paralleling gear. Electrical Riser diagram, panel schedules, generator load simulation, new electrical associated with break room. New electrical design and sequence to allow transition of connections for all equipment presently connected to existing 3,000A feeder to be removed and to be connected to new feeder that will be supplying Building A. Layout of new/expanded electrical room in Building A. Prepare SCCS for new installation, verify existing OCPD's ratings and settings, replace with proper OCPD's where necessary.	40	\$6,800	0	\$0	0	\$0	0	\$0	160	\$22,400	80	\$6,400	0	\$0	280	\$35,600	\$127	
Meetings during design	16	\$2,720	0	\$0	8	\$1,120	8	\$1,120	24	\$3,360	0	\$0	0	\$0	56	\$8,320	\$149	
Address 50% review comments	4	\$680	2	\$280	4	\$560	4	\$560	16	\$2,240	16	\$1,280	0	\$0	46	\$5,600	\$122	
Sub-Total Existing Conditions and Demolition	64	\$ 10,880	16	\$ 2,520	52	\$ 7,280	52	\$ 7,280	200	\$ 28,000	160	\$ 12,800	0	\$ -	546	\$ 68,760	\$126	
100% CD's																		
Finalize MEPFP drawings	16	\$2,720	8	\$1,120	24	\$3,360	24	\$3,360	80	\$11,200	80	\$6,400	0	\$0	232	\$28,160	\$121	
Update SCCS	8	\$1,360	0	\$0	0	\$0	0	\$0	0	\$0	0	\$0	0	\$0	8	\$1,360	\$170	
Final Coordination	4	\$680	8	\$1,120	8	\$1,120	8	\$1,120	24	\$3,360	24	\$1,920	0	\$0	76	\$9,320	\$123	
Meetings during design	16	\$2,720	0	\$0	8	\$1,120	8	\$1,120	24	\$3,360	0	\$0	0	\$0	56	\$8,320	\$149	
Address 100% review comments	4	\$680	4	\$560	8	\$1,120	8	\$1,120	16	\$2,240	16	\$1,280	0	\$0	56	\$7,000	\$128	
	0	\$0	0	\$0	0	\$0	0	\$0	0	\$0	0	\$0	0	\$0	0	\$0	#DIV/0!	
Sub-Total 100% CD's	48	\$ 8,160	20	\$ 2,800	48	\$ 6,720	48	\$ 6,720	144	\$ 20,160	120	\$ 9,600	0	\$ -	428	\$54,160	\$127	
Bid and Permit Phase																		
RFI's during bidding	2	\$340	4	\$560	4	\$560	4	\$560	16	\$2,240	16	\$1,280	16	\$720	62	\$8,260	\$101	
Permitting	2	\$340	2	\$280	4	\$560	4	\$560	16	\$2,240	8	\$640	0	\$0	36	\$4,620	\$128	
		\$0		\$0		\$0		\$0		\$0		\$0		\$0	0	\$0	#DIV/0!	
Sub-Total Bid and Permit	4	\$680	6	\$840	8	\$1,120	8	\$1,120	32	\$4,480	24	\$1,920	16	\$720	98	\$ 10,880	\$111	
Construction and closeout Phase																		
Pre-bid conference	2	\$340	0	\$0	2	\$280	2	\$280	2	\$280	0	\$0	0	\$0	8	\$1,180	\$148	
Shop Drawing review	4	\$680	2	\$280	4	\$560	4	\$560	24	\$3,360	0	\$0	4	\$180	42	\$5,620	\$134	
Allowance for contractor RFI's	0	\$1,360	2	\$280	8	\$1,120	8	\$1,120	24	\$3,360	20	\$1,600	16	\$720	86	\$9,560	\$111	
Observation of the work during construction (based on 6 months construction)	8	\$1,360	12	\$1,680	16	\$2,240	16	\$2,240	48	\$6,720	16	\$1,280	0	\$0	116	\$15,520	\$134	
As built	4	\$680	2	\$280	2	\$280	2	\$280	4	\$560	8	\$640	8	\$360	30	\$3,080	\$103	
		\$0		\$0		\$0		\$0		\$0		\$0		\$0	0	\$0	#DIV/0!	
Sub-Total Construction Phase	26	\$4,420	18	\$2,520	32	\$4,480	32	\$4,480	102	\$14,280	44	\$3,520	28	\$1,260	282	\$34,960	\$124	

33% \$68,760

26% \$54,160

5% \$ 10,880

17% \$34,960

Gartek

Project:

Palm Beach County Criminal Justice Center, PBSO Building A, Option C - Modifications to place entire facility on emergency generator, replace (3) existing 800kW with (2) 1750kW, provide emergency power to chillers.

4/6/11

Gartek Engineering Corp

Position:	PRINCIPAL		FIRE PROT ENGINEER		PLUMBING ENGINEER		HVAC ENGINEER		ELECTRICAL ENGINEER		TECHNICIAN		MISC Other		TOTAL		Avg. Hrrly Rate	
	M-H	Cost	M-H	Cost	M-H	Cost	M-H	Cost	M-H	Cost	M-H	Cost	M-H	Cost	M-H	Cost		
Rate (\$/Hour):		\$170.00		\$140.00		\$140.00		\$140.00		\$140.00		\$80.00		\$45.00				
Not Used	0	\$0	0	\$0	0	\$0	0	\$0	0	\$0	0	\$0	0	\$0	0	\$0	\$0	#DIV/0!
	0	\$0	0	\$0	0	\$0	0	\$0	0	\$0	0	\$0	0	\$0	0	\$0	\$0	#DIV/0!
Not Used	0	\$0	0	\$0	0	\$0	0	\$0	0	\$0	0	\$0	0	\$0	0	\$0	\$0	#DIV/0!
	0	\$0	0	\$0	0	\$0	0	\$0	0	\$0	0	\$0	0	\$0	0	\$0	\$0	#DIV/0!
TOTAL LUMP SUM FEE:	142	\$27,880	62	\$10,920	140	\$25,200	140	\$24,080	478	\$78,120	348	\$37,600	44	\$1,980	1354	\$205,780	\$152	

0%

0%

100% \$ 205,780



SCHEDULE 1

**LIST OF PROPOSED SBE-M/WBE SUBCONTRACTORS
CHANGE ORDER WORK**

PROJECT NAME: PBSO Main Detention Center Generator Replacement PROJECT NO. 11208

NAME OF GENERAL CONTRACTOR: Leo A Daly CONTACT PERSON: Fernando Del Dago

PHONE NO: 561-688-2111 CCP #: _____

PLEASE IDENTIFY ALL APPLICABLE CATEGORIES OF SUBCONTRACTORS

Name, Address and Phone Number	(Check one or both Categories)		Subcontract Amount				
	Minority Business	Small Business	Black	Hispanic	Women	Caucasian	Other (Please Specify)
1. <u>Tierra</u> <u>2765 Vleta Parkway Suite 10</u> <u>West Palm Beach, FL 33481</u>	<input type="checkbox"/>	<input checked="" type="checkbox"/>	\$ 0.00	\$ 5,350.00	\$ 0.00	\$ 0.00	\$ 0.00
2. <u>Gartek Engineering</u> <u>7210 SW 39th Terrace</u> <u>Miami, FL 33165</u>	<input type="checkbox"/>	<input checked="" type="checkbox"/>	\$ 0.00	\$ 205,780.00	\$ 0.00	\$ 0.00	\$ 0.00
3. <u>Martinez Eng Group</u> <u>7220 NW 18TH ST # 304</u> <u>Miami, FL 33126-1212</u>	<input checked="" type="checkbox"/>	<input type="checkbox"/>	\$ 0.00	\$ 0.00	\$ 12,000.00	\$ 0.00	\$ 0.00
4. _____ _____	<input type="checkbox"/>	<input type="checkbox"/>	\$ 0.00	\$ 0.00	\$ 0.00	\$ 0.00	\$ 0.00
5. _____ _____	<input type="checkbox"/>	<input type="checkbox"/>	\$ 0.00	\$ 0.00	\$ 0.00	\$ 0.00	\$ 0.00
(Please use additional sheets if necessary)	Total		\$ 0.00	\$ 211,130.00	\$ 12,000.00	\$ 0.00	\$ 0.00

Change Order Price \$ 356,755.00 Total Value of SBE Participation \$ 211,130.00 M/WBE Participation \$ 12,000.00