

II. FISCAL IMPACT ANALYSIS

A. Five Year Summary of Fiscal Impact:

Fiscal Years	2012	2013	2014	2015	2016
Capital Expenditures	\$526,120	-0-	-0-	-0-	-0-
Operating Costs	-0-	-0-	-0-	-0-	-0-
External Revenues	-0-	-0-	-0-	-0-	-0-
Program Income (County)	-0-	-0-	-0-	-0-	-0-
In-Kind Match (County)	-0-	-0-	-0-	-0-	-0-
NET FISCAL IMPACT	\$526,120	-0-	-0-	-0-	-0-
# ADDITIONAL FTE POSITIONS (Cumulative)					

Is Item Included in Current Budget? Yes No X

Budget Account No:

Fund 3511 Dept 365 Unit S175 Object 6551

Recommended Sources of Funds/Summary of Fiscal Impact:

MSTU Improvement Fund
Reserves
Michlar Dr/Tamis Trail to 105th South

Construction Contract	\$435,519.20
Contingency	\$ 43,600.80
Testing Lab	\$ 10,000.00
Staff Costs	
Engineering Services	\$ 2,000.00
Construction Coordination	\$ 35,000.00
Fiscal Impact	<u>\$526,120.00</u>

C. Departmental Fiscal Review: Atwill

III. REVIEW COMMENTS

A. OFMB Fiscal and/or Contract Dev. and Control Comments:

50% of the total costs will be assessed to the residents.
OFMB 9/20/11
Contract Dev. and Control 10-3-11
 cc 9/19/11

B. Approved as to Form and Legal Sufficiency:

This Contract complies with our contract review requirements.

Mark R. Pitt 10/17/11
Assistant County Attorney

C. Other Department Review:

Department Director

This summary is not to be used as a basis for payment.

2002136

MICHLAR DR, TAMIS TRL & 105TH AVE. S

STREET IMPROVEMENT PROJECT

LOCATION MAP

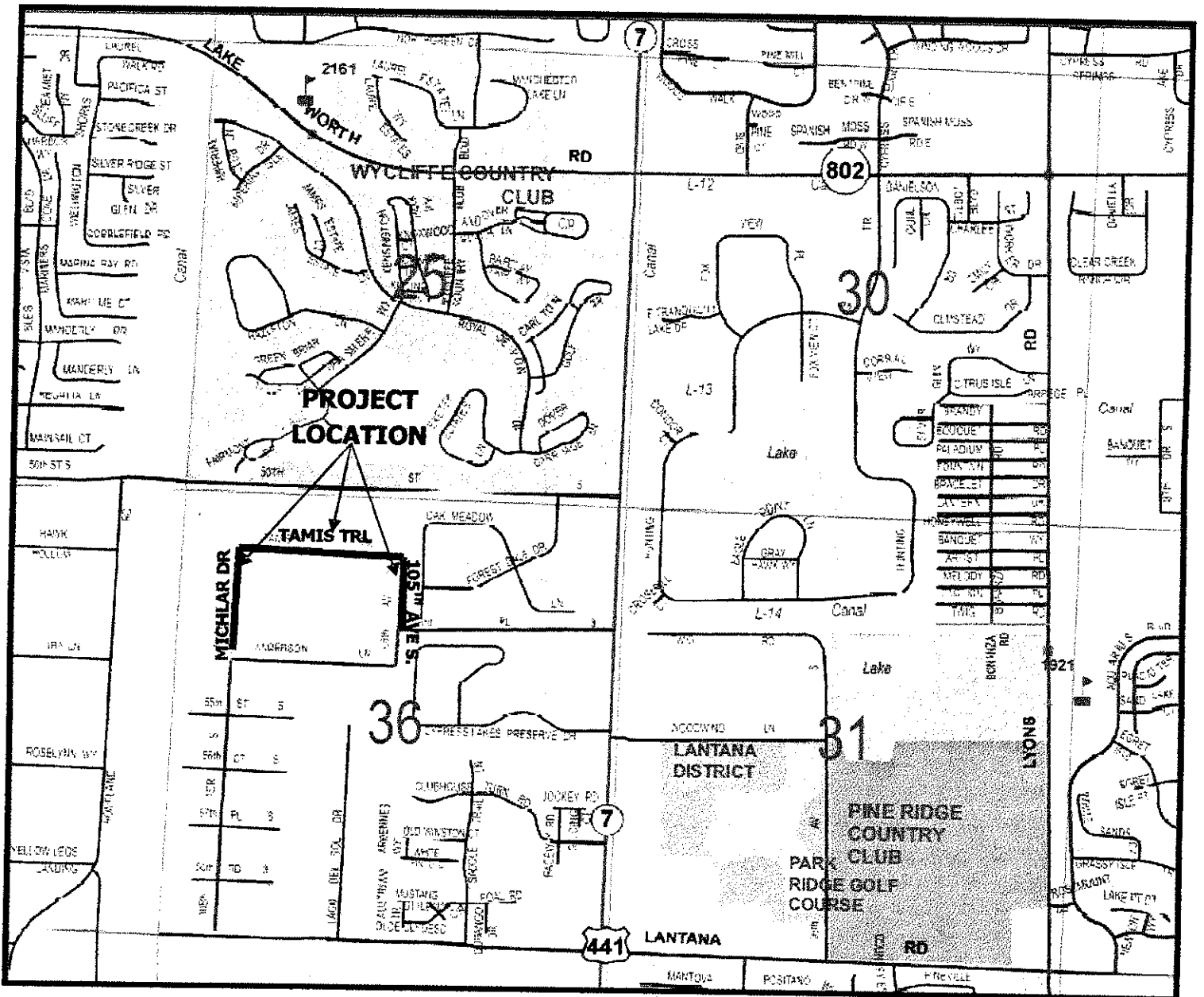

RESOLUTION NO. R-2011-

RESOLUTION OF THE BOARD OF COUNTY COMMISSIONERS OF PALM BEACH COUNTY, FLORIDA CONFIRMING THE SPECIAL ASSESSMENT FOR MICHLAR DRIVE, TAMIS TRAIL AND 105TH AVENUE SOUTH, SECTION 36, TOWNSHIP 44 SOUTH, RANGE 41 EAST, PAVING AND DRAINAGE IMPROVEMENT PROJECT, PURSUANT TO A PUBLIC HEARING HELD THEREON.

WHEREAS, Michlar Drive, Tamis Trail and 105th Avenue South is a Municipal Services Taxing Unit (MSTU) project; and

WHEREAS, the cost of this MSTU Project is \$668,526.56 of which the property owners will pay \$19,662.55 per lot and the MSTU Program will contribute \$19,662.55 per lot; and

WHEREAS, a special assessment process was initiated for the Michlar Drive, Tamis Trail and 105th Avenue South Paving and Drainage Improvement Project, authorized pursuant to Palm Beach County Ordinance No. 94-11, as amended by Ordinance No. 95-53 and 2008-063, known as the MSTU Special Assessment Ordinance; and

WHEREAS, 50 percent of the estimated cost or \$19,662.55 per lot of the paving and drainage improvements, which is funded through the MSTU Program, will be repaid by special assessment upon benefited parcels of land; and

WHEREAS, the method of assessment is to be on a per lot basis; and

WHEREAS, pursuant to Section 18 of Ordinance No. 94-11, as amended by Ordinance No. 95-53 and 2008-063, the Board of County Commissioners did hold a public hearing on the 18th day of October, 2011 at the Commission Chambers of the Board of County Commissioners of Palm Beach County, Florida, so as to satisfy the requirements of Ordinance 94-11 as amended by Ordinance No. 95-53 and 2008-063; and

WHEREAS, the Board of County Commissioners finds that the public notice and public hearing requirements of Ordinance No. 94-11, as amended by Ordinance No. 95-53 and 2008-063, have been substantially met.

NOW, THEREFORE, BE IT RESOLVED BY THE BOARD OF COUNTY COMMISSIONERS OF PALM BEACH COUNTY, FLORIDA, THAT:

The Special Assessment Roll for the improvement project for Michlar Drive, Tamis Trail and 105th Avenue South, Section 36, Township 44 South, Range 41 East, as on file in the Clerk of this Board and attached hereto as EXHIBIT II, is hereby approved and confirmed and shall be recorded by the Clerk of the Board of County Commissioners in a special book to be known as "The Improvement Lien Book" and the record of the lien in said book shall constitute prima facie evidence of the validity of said lien.

1. The said special assessments are hereby made upon all parcels of land described in said Special Assessment Roll in the amount shown thereon.

2. Pursuant to Ordinance No. 94-11 as amended by Ordinance No. 95-53 and 2008-063, the following project is hereby approved: Michlar Drive from 72 feet north of Anderson Lane, north to Tamis Trail, Tamis Trail from Michlar Drive, east to 105th Avenue South and 105th Avenue South from Tamis Trail, south to 52nd Place South in Section 36, Township 44 South, Range 41 East, Palm Beach County, Florida.

3. The said special assessments are hereby made upon all parcels of land described in said Special Assessment Roll (EXHIBIT II) in the amount shown thereon.

4. Pursuant to Ordinance No. 94-11 as amended by Ordinance No. 95-53 and 2008-063, any and all special assessments made pursuant to this Resolution, which have not been paid in full within thirty (30) days after notice of completion of the subject improvements for which said assessment was made, shall be subject to interest at a rate of five and one-half (5¹/₂%) percent per annum from the date of the acceptance of said improvement by Palm Beach County and shall be payable in ten (10) equal annual installments.

5. The total cost of the paving and drainage improvements funded through the MSTU Program is estimated at \$668,526.56 attached hereto as EXHIBIT I \$334,263.28 of the total costs of the paving and drainage improvement funded through the MSTU Program will be paid by special assessment.

6. Pursuant to Section 21 of Ordinance No. 94-11 as amended by Ordinance No. 95-53 and 2008-063, if any special assessment made under this resolution shall be either in whole or part vacated or set aside by the judgment of any court, or the Board of County Commissioners shall be satisfied that any such assessment is so defective that the same cannot be enforced or collected, or if the Board will have omitted to make any such assessment when it might have done so, the Board of County Commissioners will take all necessary steps to cause a new assessment to be made for any improvement against any property specially benefited by such improvement.

7. The Board of County Commissioners further finds that each parcel listed on EXHIBIT II will obtain a special benefit which is at least equal to the amount of special assessment made against each such parcel.

**THIS SPACE LEFT BLANK
INTENTIONALLY**

The foregoing Resolution was offered by Commissioner _____ who moved its adoption. The motion was seconded by Commissioner _____, and upon being put to a vote, the vote was as follows:

Commissioner Karen T. Marcus, Chair	-
Commissioner Shelley Vana, Vice Chair	-
Commissioner Paulette Burdick	-
Commissioner Steven L. Abrams	-
Commissioner Burt Aaronson	-
Commissioner Jess R. Santamaria	-
Commissioner Priscilla A. Taylor	-

The Chairman thereupon declared the Resolution duly passed and adopted this

_____ day of _____, 2011.

PALM BEACH COUNTY, FLORIDA, BY ITS
BOARD OF COUNTY COMMISSIONERS

SHARON R. BOCK
CLERK & COMPTROLLER

BY: _____
Deputy Clerk

APPROVED AS TO FORM AND
LEGAL SUFFICIENCY:

By: _____
County Attorney

PROJECT NO. 2002136

REPORT OF COST

MICHLAR DR., TAMIS TR., AND 105TH AVE. S.
PAVING & DRAINAGE IMPROVEMENTS

LEGAL ADVERTISING	\$	<u>2,500.00</u>
CONSTRUCTION COSTS	\$	<u>435,519.20</u>
PERMITTING FEES	\$	<u>15,211.74</u>
ENGINEERING & SURVEY COSTS	\$	<u>73,228.09</u>
ROW ACQUISITION	\$	<u>61,932.00</u>
SUB-TOTAL	\$	<u>588,391.03</u>
ADMINISTRATIVE COSTS, FEES, CONSTRUCTION COORDINATION CONTINGENCIES	\$	<u>1,742.08</u> <u>34,841.54</u> <u>43,551.92</u>
TOTAL	\$	<u>668,526.56</u>
<u>SUPPLEMENTAL FUNDING</u>		
CCRT ALLOCATIONS	\$	<u> </u>
DISTRICT RESERVES	\$	<u> </u>
TOTAL MSTU FUNDING	\$	<u>668,526.56</u>
ASSESSABLE COST = 50% of MSTU FUNDING	\$	<u>334,263.28</u>
ABUTTING LOTS - - - -	<u>17</u>	
ASSESSMENT PER LOT	\$	<u>19,662.55</u>

Assessment Roll - Tentative

MICHLAR DR. (ANDERSON LN-TAMIS TR)
TAMIS TR. (52ND PLACE - TAMIS TRAIL)
105TH AVE. SOUTH (52ND PL-TAMIS TR)
PROJECT 2002136

FUND AGENCY ORG	COMMISSION DISTRICT	SECTION TOWNSHIP RANGE
	3 SHELLEY VANA	36 44S 41E

No.	Homeowner	PCN/Legal Description	Parcel	Total Assessment	Annual Cost/Per Year	Notes
1	FOX DOUGLAS M	00-41-44-36-00-000-300.0 36-44-41, W 1/2 OF SE 1/4 OF NE 1/4 OF NW 1/4	1	\$19,662.55	\$2,760.45	
2	TRUST # 201104 UDT	00-41-44-36-00-000-302.0 36-44-41, E 1/2 OF NE 1/4 OF NE 1/4 OF NW 1/4	1	\$19,662.55	\$2,760.45	
3	SANTA TERESITA POLO LLC	00-41-44-36-00-000-303.0 36-44-41, E 1/2 OF NW 1/4 OF NE 1/4 OF NW 1/4	1	\$19,662.55	\$2,760.45	
4	DOROSARIO ANTONIO S	00-41-44-36-00-000-304.0 36-44-41, E 1/2 OF NE 1/4 OF NW 1/4 OF NW 1/4	1	\$19,662.55	\$2,760.45	
5	TEPPER HAIM	00-41-44-36-00-000-305.0 36-44-41, W 1/2 OF NE 1/4 OF NW 1/4 OF NW 1/4	1	\$19,662.55	\$2,760.45	

Assessments which have not been paid in full within thirty days after completion of the subject improvements for which said assessment was made, will be charged interest at a rate of six and a half (6.5) percent per annum from the date of the acceptance of said improvement by Palm Beach County and shall be payable in ten equal annual installments of principal and interest.

Assessment Roll - Tentative

MICHLAR DR. (ANDERSON LN-TAMIS TR)
TAMIS TR. (52ND PLACE - TAMIS TRAIL)
105TH AVE. SOUTH (52ND PL-TAMIS TR)
PROJECT 2002136

FUND AGENCY ORG	COMMISSION DISTRICT	SECTION TOWNSHIP RANGE
	3 SHELLEY VANA	36 44S 41E

No.	Homeowner	PCN/Legal Description	Parcel	Total Assessment	Annual Cost/Per Year	Notes
6	SCHWENK JOHN H &	00-41-44-36-00-000-306.0 36-44-41, W 1/2 OF NW 1/4 OF NW 1/4 OF NW 1/4	1	\$19,662.55	\$2,760.45	
7	LASSILA MARK &	00-41-44-36-00-000-307.0 36-44-41, E 1/2 OF SE 1/4 OF NW 1/4 OF NW 1/4	1	\$19,662.55	\$2,760.45	
8	LASSILA MARK &	00-41-44-36-00-000-308.0 36-44-41, W 1/2 OF SE 1/4 OF NW 1/4 OF NW 1/4	1	\$19,662.55	\$2,760.45	
9	CUMMINS GEORGE J JR	00-41-44-36-00-000-309.0 36-44-41, N 1/2 OF SW 1/4 OF NW 1/4 OF NW 1/4	1	\$19,662.55	\$2,760.45	
10	GIAQUINTO FRANK J	00-41-44-36-00-000-318.0 36-44-41, W 1/2 OF SW 1/4 OF NE 1/4 OF NW 1/4	1	\$19,662.55	\$2,760.45	

Assessments which have not been paid in full within thirty days after completion of the subject improvements for which said assessment was made, will be charged interest at a rate of six and a half (6.5) percent per annum from the date of the acceptance of said improvement by Palm Beach County and shall be payable in ten equal annual installments of principal and interest.

Assessment Roll - Tentative

MICHLAR DR. (ANDERSON LN-TAMIS TR)
TAMIS TR. (52ND PLACE - TAMIS TRAIL)
105TH AVE. SOUTH (52ND PL-TAMIS TR)
PROJECT 2002136

FUND AGENCY ORG	COMMISSION DISTRICT	SECTION TOWNSHIP RANGE
	3 SHELLEY VANA	36 44S 41E

No.	Homeowner	PCN/Legal Description	Parcel	Total Assessment	Annual Cost/Per Year	Notes
11	SAADETDIN TARIK &	00-41-44-36-00-000-321.0 36-44-41, E 1/2 OF SW 1/4 OF NE 1/4 OF NW 1/4	1	\$19,662.55	\$2,760.45	
12	MARRERO CASIMIRO	00-41-44-36-00-000-322.0 36-44-41, W 1/2 OF NW 1/4 OF NE 1/4 OF NW 1/4	1	\$19,662.55	\$2,760.45	
13	ELDRED KENNETH S &	00-41-44-36-00-000-323.0 36-44-41, S 1/2 OF SW 1/4 OF NW 1/4 OF NW 1/4	1	\$19,662.55	\$2,760.45	
14	GRANAN FAMILY LIMITED LIABILITY COMPANY	00-41-44-36-00-000-326.0 36-44-41, W 1/2 OF NE 1/4 OF NE 1/4 OF NW 1/4	1	\$19,662.55	\$2,760.45	
15	PETROVICH BRETT &	00-41-44-36-00-000-327.0 36-44-41, E 1/2 OF SE 1/4 OF NE 1/4 OF NW 1/4	1	\$19,662.55	\$2,760.45	

Assessments which have not been paid in full within thirty days after completion of the subject improvements for which said assessment was made, will be charged interest at a rate of six and a half (6.5) percent per annum from the date of the acceptance of said improvement by Palm Beach County and shall be payable in ten equal annual installments of principal and interest.

Assessment Roll - Tentative

MICHLAR DR. (ANDERSON LN-TAMIS TR)
TAMIS TR. (52ND PLACE - TAMIS TRAIL)
105TH AVE. SOUTH (52ND PL-TAMIS TR)
PROJECT 2002136

FUND AGENCY ORG	COMMISSION DISTRICT	SECTION TOWNSHIP RANGE
	3 SHELLEY VANA	36 44S 41E

No.	Homeowner	PCN/Legal Description	Parcel	Total Assessment	Annual Cost/Per Year	Notes
16	TEPPER HAIM	00-41-44-36-00-000-329.0 36-44-41, E 1/2 OF NW 1/4 OF NW 1/4 OF NW 1/4	1	\$19,662.55	\$2,760.45	
17	SLATTERY ROBERT S &	00-41-44-36-00-000-330.0 36-44-41, N 1/2 OF NW 1/4 OF SW 1/4 OF NW 1/4	1	\$19,662.55	\$2,760.45	
			Totals:	17	\$334,263.35	

Note Description/Totals	
1	ASSIGNED FRONT FOOTAGE 0
2	ASSIGNED AVERAGE FRONT FOOTAGE 0
3	50% OF SUM OF ALL ABUTTING FOOTAGE 0

Assessments which have not been paid in full within thirty days after completion of the subject improvements for which said assessment was made, will be charged interest at a rate of six and a half (6.5) percent per annum from the date of the acceptance of said improvement by Palm Beach County and shall be payable in ten equal annual installments of principal and interest.

CONTRACT

STATE OF FLORIDA)
) SS
COUNTY OF PALM BEACH)

This Contract, made this _____ day of _____ A.D. 20____, by and between PALM BEACH COUNTY, a Political Subdivision of the State of Florida, (hereinafter called the party of the first part), and ROSSO PAVING & DRAINAGE, INC., of WEST PALM BEACH, FL and (his) (its) (their) heirs, executors, administrators and assigns, (hereinafter called the part of the second part):

WITNESSETH: The party of the second part agrees with the said party of the first part, for the consideration herein mentioned at his, its or their own proper cost and expense to do all the work and furnish all necessary labor, materials, equipment, machinery, tools, apparatus, services, state workmen's compensation and unemployment compensation taxes incurred in the performance of the contract, and means of transportation for the complete construction of:

Michlar Drive, Tamis Trail & 105th Avenue South Paving & Drainage Improvements, Palm Beach County Project No. 2002136

IN THE AMOUNT OF:

FOUR HUNDRED THIRTY FIVE THOUSAND FIVE HUNDRED NINETEEN AND 20/100
(IN WORDS)

\$435,519.20
(IN FIGURES)

in Palm Beach County, Florida, in the manner and to the full extent as set forth in the Contract Documents therefore and the Contract Documents relative thereto, are made a part of this agreement as completely as if set forth herein, to the satisfaction of the party of the first part, or its duly authorized representative.

The said party of the second part further agrees for the consideration herein mentioned to commence the work adequate forces and equipment within fourteen (14) calendar days of the date set forth in the "Notice to Proceed". The time limit for the completion of all work under this contract shall be as set forth in the Proposal. The date fixing this period upon the calendar shall be established and stated in the "Notice to Proceed". After commencement of the work, it shall be properly dispatched toward completion, to the satisfaction of the Engineer, and shall be fully completed within the time limit. It is understood and agreed that the time limit for completion of said work is the essence of the contract and should the contractor fail to complete the work within the time limit, it is agreed that for such calendar day that any work provided for in these Contract Documents shall remain incomplete after the time limit has expired, including any official extension of the time limit; the sum per day given in the contained schedules shall be deducted from monies due the Contractor, not as a penalty, but as liquidated damages and added expense for supervision.

The Contractor shall take into account all contingent work which has to be done by other parties arising from any cause whatsoever, and shall not plead his want of knowledge of such contingent work as an excuse for delay in his work, or for its non-performance.

IN WITNESS WHEREOF, the parties have caused this Contract to be executed and sealed the day and year first written above.

ATTEST:
SHARON R. BOCK, Clerk and Comptroller

PALM BEACH COUNTY, a Political
Subdivision of the State of Florida
BOARD OF COUNTY COMMISSIONERS

By: _____
Deputy Clerk

By: _____
Karen T. Marcus, Chair

APPROVED AS TO FORM
AND LEGAL SUFFICIENCY

APPROVED AS TO TERMS
AND CONDITIONS

COUNTY ATTORNEY

Charles Rich
ENGINEERING

ATTEST
Joe Rasso

Rosso Paving & Drainage Inc.
(Corporate Name)

Joe Rasso II - Vice-President
PRINT NAME & TITLE

a Florida corporation
(Insert state of corporation)

(CORPORATE SEAL)

By: Nancy G. Rasso
(Signature)

Nancy G. Rasso
(Print signatory's name)

It's: President
(Print title)



Office of
Small Business Assistance
 50 South Military Trail, Suite 2N-172
 West Palm Beach, FL 33415
 (561) 616-6840
 Fax: (561) 616-6850
 www.pbcgov.com/osba



**Palm Beach County
 Board of County
 Commissioners**

- Karen T. Marcus, Chair
- Shelley Vana, Vice Chair
- Paulette Burdick
- Steven L. Abrams
- Burt Aaronson
- Jess R. Santamaria
- Priscilla A. Taylor

County Administrator (WB)
 Robert Weisman

DATE: August 8, 2011
TO: Charles W. Rich, P.E., Director
 Engineering Services Division
Through: Allen Gray, Manager - Office of Small Business
 Assistance *A. Gray*
FROM: Tanoy Williams, Compliance Specialist I *TW*
SUBJECT: **Compliance Review on Project No. 2002136
 Michlar Drive, Tamis Trail & 105th Avenue S.
 Paving & Drainage Improvements**

The following is a Compliance Review of SBE participation on the above-mentioned project.

LOW BIDDER: **ROSSO PAVING & DRAINAGE, INC.**
 350 Martin Lane
 West Palm Beach, FL 33413
 Phone: 561-688-0288
 Bid Opening: July 19, 2011
 Bid Amount: \$433,156.70
Goal: 15% Overall
Goal Achieved: 50.61%

SBE Participation:
 Rosso Paving **\$219,247.86** **50.61%**

*"An Equal Opportunity
 Affirmative Action Employer"*

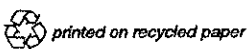



2ND LOW BIDDER: **B & B UNDERGROUND CONTRACTORS, IN C.**
6900 Dwight Road
West Palm Beach, FL 33411
Phone: 561-682-3310
Bid Amount: \$451,586.75
Goal: **15% Overall**
Goal Achieved: **16.61%**

SBE Participation:
(WB) Southeast Atten. \$15,014.80 3.32%
(HB) Tru Trucking \$60,000.00 13.29%
\$75,014.80 16.61%

3RD LOW BIDDER **DEVLAND SITE, INC.**
1302 Wingfield Street
Lake Worth, FL
Phone: 561-585-6370
Bid Amount: \$473,870.95
Goal: **15% Overall**
Goal Achieved: **74.26%**

SBE Participation:
(BL) Devland Site **\$351,920.00 74.26%**

EVALUATION

The low bidder, **ROSSO PAVING & DRAINAGE, INC.** has met the SBE goal for this project.

cc: Tammy Fields, Assistant County Attorney
File

PROJECT NAME: MICHLAR DRIVE, TAMIS TRAIL & 105TH AVENUE SOUTH PAVING & DRAINAGE IMPROVEMENTS

PROJECT NUMBER: 2002136

BID OPENING DATE: JULY 19, 2011

CONTRACT DAYS: ONE HUNDRED TWENTY (120) CALENDAR DAYS

ITEM	QTY	UNITS	ROSSO PAVING & DRAINAGE, INC.		B&B UNDERGROUND CONTRACTORS, INC.		DEVLAND SITE, INC.		AVERAGE UNIT PRICE
			UNIT PRICE	AMOUNT	UNIT PRICE	AMOUNT	UNIT PRICE	AMOUNT	
1 MOBILIZATION	1	LS	\$18,107.75	\$18,107.75	\$18,000.00	\$18,000.00	\$3,500.00	\$3,500.00	\$13,202.58
2 MAINTENANCE OF TRAFFIC (INCLUDES PEDESTRIAN MOT)	1	LS	\$738.30	\$738.30	\$5,000.00	\$5,000.00	\$2,500.00	\$2,500.00	\$2,746.10
3 RECORD DRAWINGS	1	LS	\$4,650.25	\$4,650.25	\$6,000.00	\$6,000.00	\$22,400.00	\$22,400.00	\$11,016.75
4 NPDES COMPLIANCE (SEE SP PAGES)	1	LS	\$3,647.00	\$3,647.00	\$3,000.00	\$3,000.00	\$2,200.00	\$2,200.00	\$2,949.00
5 CLEARING & GRUBBING	1	LS	\$5,250.00	\$5,250.00	\$18,000.00	\$18,000.00	\$23,506.00	\$23,506.00	\$15,585.33
6 PRE-CONSTRUCTION VIDEO TAPING	1	LS	\$200.00	\$200.00	\$14,700.00	\$14,700.00	\$650.00	\$650.00	\$5,183.33
7 REGULAR EXCAVATION	5,585	CY	\$1.00	\$5,585.00	\$3.00	\$16,755.00	\$2.00	\$11,170.00	\$2.00
8 EMBANKMENT (COMPACTED IN PLACE)	4,858	CY	\$1.00	\$4,858.00	\$1.50	\$7,287.00	\$3.00	\$14,574.00	\$1.83
9 12" COMPACTED SUBGRADE - ROADWAY	10,917	SY	\$1.80	\$19,650.60	\$1.50	\$16,375.50	\$1.75	\$19,104.75	\$1.68
10 OPTIONAL BASEROCK - ROADWAY AND DRIVEWAYS	10,414	SY	\$8.30	\$86,436.20	\$9.50	\$98,933.00	\$8.60	\$89,560.40	\$8.80
11 1½" TYPE S-III ASPHALTIC CONCRETE - ROADWAY & DRIVEWAYS	865	TN	\$112.65	\$97,442.25	\$110.00	\$95,150.00	\$120.00	\$103,800.00	\$114.22
12 BAHIA SODDING	16,407	SY	\$3.00	\$49,221.00	\$1.75	\$28,712.25	\$2.00	\$32,814.00	\$2.25
13 12" RCP	102	LF	\$59.85	\$6,104.70	\$50.00	\$5,100.00	\$30.00	\$3,060.00	\$46.62
14 15" RCP	163	LF	\$65.10	\$10,611.30	\$40.00	\$6,520.00	\$28.00	\$4,564.00	\$44.37
15 18" RCP	100	LF	\$68.25	\$6,825.00	\$38.00	\$3,800.00	\$34.80	\$3,480.00	\$47.02
16 23" X 14" ERCP	163	LF	\$106.05	\$17,286.15	\$41.00	\$6,683.00	\$46.00	\$7,498.00	\$64.35
17 24" RCP	43	LF	\$74.55	\$3,205.65	\$68.00	\$2,924.00	\$51.00	\$2,193.00	\$64.52
18 24" TYPE II TRENCH DRAIN (FDOT INDEX NO. 206) - INCLUDES GRATE, PARTS, CONCRETE & INSTALLATION	35	LF	\$349.65	\$12,237.75	\$350.00	\$12,250.00	\$330.00	\$11,550.00	\$343.22
19 30" RCP	80	LF	\$84.00	\$6,720.00	\$79.00	\$6,320.00	\$53.41	\$4,272.80	\$72.14
20 36" CMP	5	LF	\$429.45	\$2,147.25	\$160.00	\$800.00	\$60.00	\$300.00	\$216.48
21 12" DOUBLE MITERED END SECTION	6	EA	\$584.85	\$3,509.10	\$1,100.00	\$6,600.00	\$1,415.00	\$8,490.00	\$1,033.28
22 15" MITERED END SECTION	16	EA	\$459.90	\$7,358.40	\$550.00	\$8,800.00	\$1,360.00	\$21,760.00	\$789.97
23 23" X 14" MITERED END SECTION	14	EA	\$479.85	\$6,717.90	\$760.00	\$10,640.00	\$1,600.00	\$22,400.00	\$946.62
24 18" MITERED END SECTION	8	EA	\$474.60	\$3,796.80	\$660.00	\$5,280.00	\$1,450.00	\$11,600.00	\$861.53
25 TYPE "C" DITCH BOTTOM INLET	1	EA	\$3,249.75	\$3,249.75	\$1,800.00	\$1,800.00	\$1,600.00	\$1,600.00	\$2,216.58
26 TYPE "E" DITCH BOTTOM INLET W/ RETICULINE GRATES	2	EA	\$3,900.75	\$7,801.50	\$3,650.00	\$7,300.00	\$3,265.00	\$6,530.00	\$3,605.25
27 INLET TYPE E (CONTROL STRUCTURE)	1	EA	\$7,602.00	\$7,602.00	\$7,800.00	\$7,800.00	\$5,410.00	\$5,410.00	\$6,937.33
28 CONCRETE HEADWALL (30")	1	EA	\$4,305.00	\$4,305.00	\$3,600.00	\$3,600.00	\$1,600.00	\$1,600.00	\$3,168.33
29 SAND CEMENT HEADWALL 36" (PER FDOT INDEX 258)	4.2	CY	\$992.25	\$4,167.45	\$550.00	\$2,310.00	\$650.00	\$2,730.00	\$730.75
30 SAND CEMENT RIP RAP (SLOPE PROTECTION)	4.74	CY	\$472.50	\$2,239.65	\$550.00	\$2,607.00	\$650.00	\$3,081.00	\$557.50
31 GUARDRAIL, NEW	840	LF	\$24.90	\$20,916.00	\$26.00	\$21,840.00	\$30.20	\$25,368.00	\$27.03
32 GUARDRAIL END TREATMENT (TYPE II)	1	EA	\$569.00	\$569.00	\$700.00	\$700.00	\$605.00	\$605.00	\$624.67
TOTAL BASE BID	****	****	*****	\$433,156.70	*****	\$451,586.75	*****	\$473,870.95	*****

BIDS RECEIVED BY: CHARLES W. RICH, P.E.

BIDS RECORDED BY: JAYNE CANALE, TECHNICAL AIDE

PROJECT NAME: MICHLAR DRIVE, TAMIS TRAIL & 105TH AVENUE SOUTH PAVING & DRAINAGE IMPROVEMENTS

PROJECT NUMBER: 2002136

BID OPENING DATE: JULY 19, 2011

CONTRACT DAYS: ONE HUNDRED TWENTY (120) CALENDAR DAYS

			ROSSO PAVING & DRAINAGE, INC.		B&B UNDERGROUND CONTRACTORS, INC.		DEVLAND SITE, INC.		AVERAGE
ITEM	QTY	UNITS	UNIT PRICE	AMOUNT	UNIT PRICE	AMOUNT	UNIT PRICE	AMOUNT	UNIT PRICE
CONTINGENCY ITEM			*****	*****	*****	*****	*****	*****	*****
33 ADJUST EXISTING GATES/FENCES (AS NEEDED)	3	EA	\$787.50	\$2,362.50	\$300.00	\$900.00	\$150.00	\$450.00	*****
TOTAL CONTINGENCY ITEM			*****	\$2,362.50	*****	\$900.00	*****	\$450.00	*****
TOTAL BID			*****	\$435,519.20	*****	\$452,486.75	*****	\$474,320.95	*****

BIDS RECEIVED BY: CHARLES W. RICH, P.E.
 BIDS RECORDED BY: JAYNE CANALE, TECHNICAL AIDE

PROJECT NAME: MICHLAR DRIVE, TAMIS TRAIL & 105TH AVENUE SOUTH P.
PROJECT NUMBER: 2002136
BID OPENING DATE: JULY 19, 2011
CONTRACT DAYS: ONE HUNDRED TWENTY (120) CALENDAR DAYS

**MANCIL'S TRACTOR
SERVICE, INC.**

CHARLES S. WHITESIDE, INC.

H&R OF BELLE GLADE, INC.

ITEM	QTY	UNITS	UNIT PRICE	AMOUNT	UNIT PRICE	AMOUNT	UNIT PRICE	AMOUNT
1 MOBILIZATION	1	LS	\$33,500.00	\$33,500.00	\$29,000.00	\$29,000.00	\$34,500.00	\$34,500.00
2 MAINTENANCE OF TRAFFIC (INCLUDES PEDESTRIAN MOT)	1	LS	\$3,500.00	\$3,500.00	\$15,000.00	\$15,000.00	\$5,000.00	\$5,000.00
3 RECORD DRAWINGS	1	LS	\$9,500.00	\$9,500.00	\$3,900.00	\$3,900.00	\$19,834.00	\$19,834.00
4 NPDES COMPLIANCE (SEE SP PAGES)	1	LS	\$11,600.00	\$11,600.00	\$4,500.00	\$4,500.00	\$5,000.00	\$5,000.00
5 CLEARING & GRUBBING	1	LS	\$11,500.00	\$11,500.00	\$30,000.00	\$30,000.00	\$45,000.00	\$45,000.00
6 PRE-CONSTRUCTION VIDEO TAPING	1	LS	\$12,500.00	\$12,500.00	\$750.00	\$750.00	\$1,900.00	\$1,900.00
7 REGULAR EXCAVATION	5,585	CY	\$7.75	\$43,283.75	\$1.75	\$9,773.75	\$2.30	\$12,845.50
8 EMBANKMENT (COMPACTED IN PLACE)	4,858	CY	\$4.20	\$20,403.60	\$2.75	\$13,359.50	\$5.20	\$25,261.60
9 12" COMPACTED SUBGRADE - ROADWAY	10,917	SY	\$2.00	\$21,834.00	\$1.50	\$16,375.50	\$6.00	\$65,502.00
10 OPTIONAL BASEROCK - ROADWAY AND DRIVEWAYS	10,414	SY	\$7.25	\$75,501.50	\$8.50	\$88,519.00	\$12.70	\$132,257.80
11 1½" TYPE S-III ASPHALTIC CONCRETE - ROADWAY & DRIVEWAYS	865	TN	\$98.00	\$84,770.00	\$115.00	\$99,475.00	\$109.00	\$94,285.00
12 BAHIA SODDING	16,407	SY	\$1.40	\$22,969.80	\$1.95	\$31,993.65	\$1.37	\$22,477.59
13 12" RCP	102	LF	\$39.85	\$4,064.70	\$50.00	\$5,100.00	\$12.00	\$1,224.00
14 15" RCP	163	LF	\$53.45	\$8,712.35	\$50.00	\$8,150.00	\$15.00	\$2,445.00
15 18" RCP	100	LF	\$63.60	\$6,360.00	\$60.00	\$6,000.00	\$18.00	\$1,800.00
16 23" X 14" ERCP	163	LF	\$46.40	\$7,563.20	\$60.00	\$9,780.00	\$18.00	\$2,934.00
17 24" RCP	43	LF	\$49.10	\$2,111.30	\$62.00	\$2,666.00	\$24.00	\$1,032.00
18 24" TYPE II TRENCH DRAIN (FDOT INDEX NO. 206) - INCLUDES GRATE, PARTS, CONCRETE & INSTALLATION	35	LF	\$400.65	\$14,022.75	\$275.00	\$9,625.00	\$100.00	\$3,500.00
19 30" RCP	80	LF	\$62.65	\$5,012.00	\$70.00	\$5,600.00	\$30.00	\$2,400.00
20 36" CMP	5	LF	\$890.00	\$4,450.00	\$300.00	\$1,500.00	\$36.00	\$180.00
21 12" DOUBLE MITERED END SECTION	6	EA	\$980.00	\$5,880.00	\$1,575.00	\$9,450.00	\$1,000.00	\$6,000.00
22 15" MITERED END SECTION	16	EA	\$970.00	\$15,520.00	\$1,275.00	\$20,400.00	\$500.00	\$8,000.00
23 23" X 14" MITERED END SECTION	14	EA	\$1,190.00	\$16,660.00	\$1,575.00	\$22,050.00	\$700.00	\$9,800.00
24 18" MITERED END SECTION	8	EA	\$1,065.00	\$8,520.00	\$1,525.00	\$12,200.00	\$800.00	\$6,400.00
25 TYPE "C" DITCH BOTTOM INLET	1	EA	\$1,860.00	\$1,860.00	\$2,500.00	\$2,500.00	\$500.00	\$500.00
26 TYPE "E" DITCH BOTTOM INLET W/ RETICULINE GRATES	2	EA	\$2,795.00	\$5,590.00	\$4,000.00	\$8,000.00	\$900.00	\$1,800.00
27 INLET TYPE E (CONTROL STRUCTURE)	1	EA	\$6,225.00	\$6,225.00	\$5,300.00	\$5,300.00	\$1,000.00	\$1,000.00
28 CONCRETE HEADWALL (30")	1	EA	\$2,770.00	\$2,770.00	\$2,600.00	\$2,600.00	\$800.00	\$800.00
29 SAND CEMENT HEADWALL 36" (PER FDOT INDEX 258)	4.2	CY	\$750.00	\$3,150.00	\$750.00	\$3,150.00	\$200.00	\$840.00
30 SAND CEMENT RIP RAP (SLOPE PROTECTION)	4.74	CY	\$750.00	\$3,555.00	\$550.00	\$2,607.00	\$200.00	\$948.00
31 GUARDRAIL, NEW	840	LF	\$25.83	\$21,697.20	\$30.00	\$25,200.00	\$15.90	\$13,356.00
32 GUARDRAIL END TREATMENT (TYPE II)	1	EA	\$650.00	\$650.00	\$750.00	\$750.00	\$480.00	\$480.00
TOTAL BASE BID	****	****	*****	\$495,236.15	*****	\$505,274.40	*****	\$529,302.49

BIDS RECEIVED BY: CHARLES W. RICH, P.E.
 BIDS RECORDED BY: JAYNE CANALE, TECHNICAL AIDE

PROJECT NAME: MICHLAR DRIVE, TAMIS TRAIL & 105TH AVENUE SOUTH P,
 PROJECT NUMBER: 2002136
 BID OPENING DATE: JULY 19, 2011
 CONTRACT DAYS: ONE HUNDRED TWENTY (120) CALENDAR DAYS

**MANCIL'S TRACTOR
 SERVICE, INC.**

CHARLES S. WHITESIDE, INC.

H&R OF BELLE GLADE, INC.

ITEM	QTY	UNITS	UNIT PRICE	AMOUNT	UNIT PRICE	AMOUNT	UNIT PRICE	AMOUNT
CONTINGENCY ITEM	****	****	*****	*****	*****	*****	*****	*****
33 ADJUST EXISTING GATES/FENCES (AS NEEDED)	3	EA	\$800.00	\$2,400.00	\$500.00	\$1,500.00	\$1,500.00	\$4,500.00
TOTAL CONTINGENCY ITEM	****	****	*****	\$2,400.00	*****	\$1,500.00	*****	\$4,500.00
TOTAL BID	****	****	*****	\$497,636.15	*****	\$506,774.40	*****	\$533,802.49

BIDS RECEIVED BY: CHARLES W. RICH, P.E.
 BIDS RECORDED BY: JAYNE CANALE, TECHNICAL AIDE

PROJECT NAME: MICHLAR DRIVE, TAMIS TRAIL & 105TH AVENUE SOUTH P.
 PROJECT NUMBER: 2002136
 BID OPENING DATE: JULY 19, 2011
 CONTRACT DAYS: ONE HUNDRED TWENTY (120) CALENDAR DAYS

ITEM	QTY	UNITS	JW CHEATHAM, LLC		LANZO CONSTRUCTION COMPANY, FLORIDA		RANGER CONSTRUCTION INDUSTRIES, INC.	
			UNIT PRICE	AMOUNT	UNIT PRICE	AMOUNT	UNIT PRICE	AMOUNT
1 MOBILIZATION	1	LS	\$44,370.00	\$44,370.00	\$20,000.00	\$20,000.00	\$92,000.00	\$92,000.00
2 MAINTENANCE OF TRAFFIC (INCLUDES PEDESTRIAN MOT)	1	LS	\$7,011.00	\$7,011.00	\$6,000.00	\$6,000.00	\$9,200.00	\$9,200.00
3 RECORD DRAWINGS	1	LS	\$500.00	\$500.00	\$15,000.00	\$15,000.00	\$5,100.00	\$5,100.00
4 NPDES COMPLIANCE (SEE SP PAGES)	1	LS	\$9,332.00	\$9,332.00	\$10,000.00	\$10,000.00	\$11,000.00	\$11,000.00
5 CLEARING & GRUBBING	1	LS	\$102,022.00	\$102,022.00	\$20,000.00	\$20,000.00	\$19,400.00	\$19,400.00
6 PRE-CONSTRUCTION VIDEO TAPING	1	LS	\$500.00	\$500.00	\$2,000.00	\$2,000.00	\$850.00	\$850.00
7 REGULAR EXCAVATION	5,585	CY	\$1.00	\$5,585.00	\$4.00	\$22,340.00	\$9.00	\$50,265.00
8 EMBANKMENT (COMPACTED IN PLACE)	4,858	CY	\$1.00	\$4,858.00	\$4.00	\$19,432.00	\$16.30	\$79,185.40
9 12" COMPACTED SUBGRADE - ROADWAY	10,917	SY	\$2.30	\$25,109.10	\$2.00	\$21,834.00	\$2.20	\$24,017.40
10 OPTIONAL BASEROCK - ROADWAY AND DRIVEWAYS	10,414	SY	\$8.10	\$84,353.40	\$15.00	\$156,210.00	\$8.30	\$86,436.20
11 1½" TYPE S-III ASPHALTIC CONCRETE - ROADWAY & DRIVEWAYS	865	TN	\$99.00	\$85,635.00	\$150.00	\$129,750.00	\$105.00	\$90,825.00
12 BAHIA SODDING	16,407	SY	\$1.48	\$24,282.36	\$2.50	\$41,017.50	\$2.40	\$39,376.80
13 12" RCP	102	LF	\$49.00	\$4,998.00	\$47.00	\$4,794.00	\$51.00	\$5,202.00
14 15" RCP	163	LF	\$52.00	\$8,476.00	\$40.00	\$6,520.00	\$54.00	\$8,802.00
15 18" RCP	100	LF	\$54.00	\$5,400.00	\$46.00	\$4,600.00	\$57.00	\$5,700.00
16 23" X 14" ERCP	163	LF	\$71.00	\$11,573.00	\$52.00	\$8,476.00	\$75.00	\$12,225.00
17 24" RCP	43	LF	\$56.00	\$2,408.00	\$54.00	\$2,322.00	\$59.00	\$2,537.00
18 24" TYPE II TRENCH DRAIN (FDOT INDEX NO. 206) - INCLUDES GRATE, PARTS, CONCRETE & INSTALLATION	35	LF	\$324.00	\$11,340.00	\$275.00	\$9,625.00	\$340.00	\$11,900.00
19 30" RCP	80	LF	\$76.00	\$6,080.00	\$60.00	\$4,800.00	\$80.00	\$6,400.00
20 36" CMP	5	LF	\$173.00	\$865.00	\$190.00	\$950.00	\$180.00	\$900.00
21 12" DOUBLE MITERED END SECTION	6	EA	\$1,188.00	\$7,128.00	\$1,000.00	\$6,000.00	\$1,250.00	\$7,500.00
22 15" MITERED END SECTION	16	EA	\$1,166.00	\$18,656.00	\$900.00	\$14,400.00	\$1,230.00	\$19,680.00
23 23" X 14" MITERED END SECTION	14	EA	\$1,242.00	\$17,388.00	\$1,000.00	\$14,000.00	\$1,300.00	\$18,200.00
24 18" MITERED END SECTION	8	EA	\$1,188.00	\$9,504.00	\$1,000.00	\$8,000.00	\$1,250.00	\$10,000.00
25 TYPE "C" DITCH BOTTOM INLET	1	EA	\$1,944.00	\$1,944.00	\$2,000.00	\$2,000.00	\$2,100.00	\$2,100.00
26 TYPE "E" DITCH BOTTOM INLET W/ RETICULINE GRATES	2	EA	\$3,240.00	\$6,480.00	\$2,800.00	\$5,600.00	\$3,400.00	\$6,800.00
27 INLET TYPE E (CONTROL STRUCTURE)	1	EA	\$5,940.00	\$5,940.00	\$5,500.00	\$5,500.00	\$6,200.00	\$6,200.00
28 CONCRETE HEADWALL (30")	1	EA	\$2,268.00	\$2,268.00	\$2,300.00	\$2,300.00	\$2,400.00	\$2,400.00
29 SAND CEMENT HEADWALL 36" (PER FDOT INDEX 258)	4.2	CY	\$540.00	\$2,268.00	\$650.00	\$2,730.00	\$600.00	\$2,520.00
30 SAND CEMENT RIP RAP (SLOPE PROTECTION)	4.74	CY	\$540.00	\$2,559.60	\$650.00	\$3,081.00	\$1,000.00	\$4,740.00
31 GUARDRAIL, NEW	840	LF	\$24.90	\$20,916.00	\$28.00	\$23,520.00	\$27.00	\$22,680.00
32 GUARDRAIL END TREATMENT (TYPE II)	1	EA	\$585.00	\$585.00	\$750.00	\$750.00	\$620.00	\$620.00
TOTAL BASE BID	****	****	*****	\$540,334.46	*****	\$593,551.50	*****	\$664,761.80

BIDS RECEIVED BY: CHARLES W. RICH, P.E.
 BIDS RECORDED BY: JAYNE CANALE, TECHNICAL AIDE

PROJECT NAME: MICHLAR DRIVE, TAMIS TRAIL & 105TH AVENUE SOUTH P
 PROJECT NUMBER: 2002136
 BID OPENING DATE: JULY 19, 2011
 CONTRACT DAYS: ONE HUNDRED TWENTY (120) CALENDAR DAYS

	JW CHEATHAM, LLC				LANZO CONSTRUCTION COMPANY, FLORIDA		RANGER CONSTRUCTION INDUSTRIES, INC.	
ITEM	QTY	UNITS	UNIT PRICE	AMOUNT	UNIT PRICE	AMOUNT	UNIT PRICE	AMOUNT
CONTINGENCY ITEM	****	****	*****	*****	*****	*****	*****	*****
33 ADJUST EXISTING GATES/FENCES (AS NEEDED)	3	EA	\$900.00	\$2,700.00	\$900.00	\$2,700.00	\$850.00	\$2,550.00
TOTAL CONTINGENCY ITEM	****	****	*****	\$2,700.00	*****	\$2,700.00	*****	\$2,550.00
TOTAL BID	****	****	*****	\$543,034.46	*****	\$596,251.50	*****	\$667,311.80

**BOARD OF COUNTY COMMISSIONERS
PALM BEACH COUNTY
BUDGET Transfer**

BGEX 081011-1997

FUND MSTU Improvement

ACCOUNT NUMBER	ACCOUNT NAME	ORIGINAL BUDGET	CURRENT BUDGET	INCREASE	DECREASE	ADJUSTED BUDGET	EXPENDED/ ENCUMBERED AS OF 10/01/11	REMAINING BALANCE
<u>MICHLAR/TAMIS/105 AVENUE STR IMP</u>								
3511-365-S175-6551	Road & Street Improvement	0	0	526,120	0	526,120	0	526,120
<u>RESERVES</u>								
3511-365-9900-9919	Res-St & Drng Improvement	9,173,756	9,173,756	<u>0</u>	<u>526,120</u>	8,647,636		
				526,120	526,120			

SIGNATURE

DATE

By Board of County Commissioners
At Meeting of 10/18/11

Engineering & Public Works

A. Willhite

10/10/11

Administration / Budget Approval

OFMB Department – Posted

Deputy Clerk to the
Board of County Commissioners