

**PALM BEACH COUNTY
BOARD OF COUNTY COMMISSIONERS
AGENDA ITEM SUMMARY**

=====

Meeting Date: May 15, 2012 {X} Consent { } Regular
 { } Workshop { } Public Hearing

Department:
Submitted By: Engineering & Public Works
Submitted For: Engineering Services Division

=====

I. EXECUTIVE BRIEF

Motion and Title: Staff recommends motion to approve:

- a)** a 120 calendar day contract (Contract) with AKA Services, Inc. (Contractor), the lowest, responsive, responsible bidder, in the amount of \$1,265,492 for Limestone Creek Drainage Improvements Phase IIC (Project), Project No. 2011056;
- b)** a Budget Transfer of \$1,438,179 in the Disaster Recovery Initiative Fund to the Capital Outlay Fund for the Limestone Creek Phase IIC project, and
- c)** a Budget Amendment of \$1,438,179 in the Capital Outlay Fund to recognize the transfer from the Disaster Initiative Recovery Fund and appropriate it to the project.

SUMMARY: Approval of this Contract will permit the construction of a drainage system for Limestone Creek Road and Mitchell Street; construction or reconstruction of the roads to coordinate with the storm water improvements and provide pedestrian circulation. The Contractor is a Palm Beach County business. The Contract is funded with Federal Grant funds; therefore the Small Business Enterprise Ordinance does not apply to this Project. Approval for award of this Contract has been received from the State of Florida Department of Economic Opportunity (DEO). The budget transfer and amendment allow for the proper accounting of the project in a capital fund. District 1 (MRE)

Background and Justification: The bids were received by the Board of County Commissioners on February 28, 2012. The cost of construction is fully funded by a Tropical Storm Fay Grant Disaster Recovery initiative, administered through the Palm Beach County Department of Economic Sustainability (DES). The Project will provide a storm drainage system for Limestone Creek Road north of Church Street and all of Mitchell Street. Sidewalks will be constructed along both roadways.

Attachments:

- 1. Location Sketch
- 2. Contracts
- 3. Contract Pages C-1 and C-2
- 4. DEO Approval
- 5. Bid Tabulation
- 6. Budget Transfer
- 7. Budget Amendment

Recommended by: _____

Division Director

Date

Approved By: *Sy T. Webb*
County Engineer

 5/14/12
Date

II. FISCAL IMPACT ANALYSIS

A. Five Year Summary of Fiscal Impact:

Fiscal Years	2012	2013	2014	2015	2016
Capital Expenditures	<u>\$1,438,179</u>	<u>-0-</u>	<u>-0-</u>	<u>-0-</u>	<u>-0-</u>
Operating Costs	<u>-0-</u>	<u>-0-</u>	<u>-0-</u>	<u>-0-</u>	<u>-0-</u>
External Revenues	<u>(\$1,438,179)</u>	<u>-0-</u>	<u>-0-</u>	<u>-0-</u>	<u>-0-</u>
Program Income (County)	<u>-0-</u>	<u>-0-</u>	<u>-0-</u>	<u>-0-</u>	<u>-0-</u>
In-Kind Match (County)	<u>-0-</u>	<u>-0-</u>	<u>-0-</u>	<u>-0-</u>	<u>-0-</u>
NET FISCAL IMPACT	<u>\$ -0-</u>	<u>-0-</u>	<u>-0-</u>	<u>-0-</u>	<u>-0-</u>
# ADDITIONAL FTE POSITIONS (Cumulative)	_____	_____	_____	_____	_____

Is Item Included in Current Budget? Yes No **x**

Budget Account No:

Fund 3900 Dept 361 Unit 1374 Object 6551

Recommended Sources of Funds/Summary of Fiscal Impact:

Disaster Recovery Initiative/Department of Economic Stability
Capital Outlay Fund/Limestone Creek Storm Drainage

Construction Contract	\$1,265,492.00
Contingency	\$ 62,687.00
Testing Lab	\$ 10,000.00
Staff Costs	<u>\$ 100,000.00</u>
Total Cost	<u>\$1,438,179.00</u>
Disaster Recovery Grant	<u>(\$1,438,179.00)</u>
Fiscal Impact	-0-

C. Departmental Fiscal Review: J. White

III. REVIEW COMMENTS

A. OFMB Fiscal and/or Contract Dev. and Control Comments:

 N. [Signature] 5/14/2012
OFMB
JB
5/14 5/14/12
cc
5/14/12
JS

 D. J. [Signature] 5/14/12
Contract Dev. and Control
5-14-12
B. [Signature]

B. Approved as to Form and Legal Sufficiency:

This Contract complies with our contract review requirements.

 M. [Signature] 5/14/12
Assistant County Attorney

C. Other Department Review:

Department Director

This summary is not to be used as a basis for payment.

**PROJECT LOCATION
LIMESTONE CREEK DRAINAGE
IMPROVEMENTS PHASE IIC
PROJECT NO. 2011056**

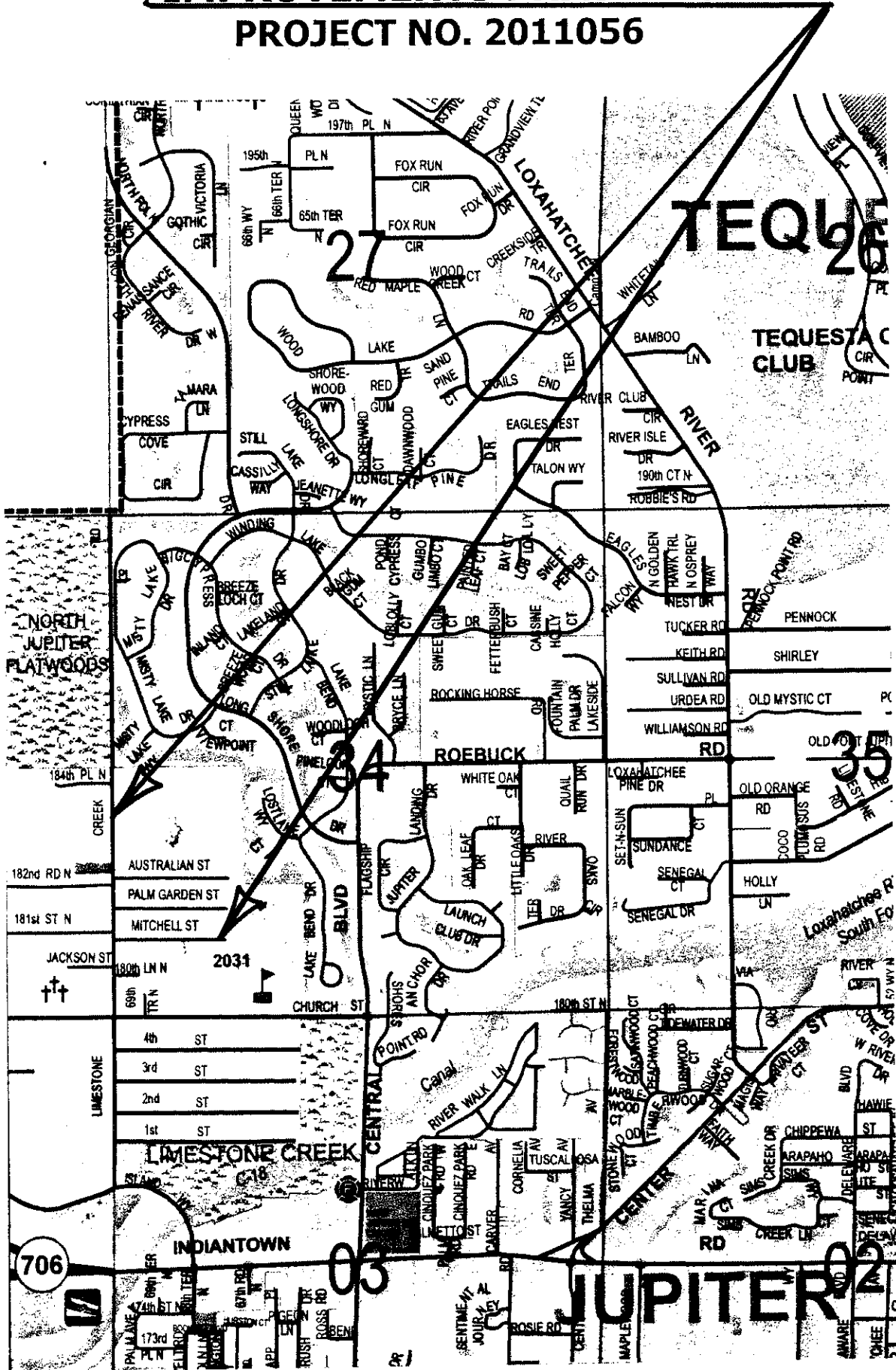

LOCATION SKETCH

CONTRACT

STATE OF FLORIDA)
) SS
COUNTY OF PALM BEACH)

This Contract, made this _____ day of _____ A.D. 20____, by and between PALM BEACH COUNTY, a Political Subdivision of the State of Florida, (hereinafter called the party of the first part), and AKA SERVICES, INC., of LOXAHATCHEE, FL and (his) (its) (their) heirs, executors, administrators and assigns, (hereinafter called the part of the second part):

WITNESSETH: The party of the second part agrees with the said party of the first part, for the consideration herein mentioned at his, its or their own proper cost and expense to do all the work and furnish all necessary labor, materials, equipment, machinery, tools, apparatus, services, state workmen's compensation and unemployment compensation taxes incurred in the performance of the contract, and means of transportation for the complete construction of:

Limestone Creek Drainage – Phase IIC (Limestone Creek Road & Mitchell Street), Palm Beach County Project No. 2011056

IN THE AMOUNT OF:

One Million Two Hundred Sixty Five Thousand Four Hundred Ninety-Two Dollars and 00/100
(IN WORDS)

\$1,265,492.00
(IN FIGURES)

in Palm Beach County, Florida, in the manner and to the full extent as set forth in the Contract Documents therefore and the Contract Documents relative thereto, are made a part of this agreement as completely as if set forth herein, to the satisfaction of the party of the first part, or its duly authorized representative.

The said party of the second part further agrees for the consideration herein mentioned to commence the work adequate forces and equipment within fourteen (14) calendar days of the date set forth in the "Notice to Proceed". The time limit for the completion of all work under this contract shall be as set forth in the Proposal. The date fixing this period upon the calendar shall be established and stated in the "Notice to Proceed". After commencement of the work, it shall be properly dispatched toward completion, to the satisfaction of the Engineer, and shall be fully completed within the time limit. It is understood and agreed that the time limit for completion of said work is the essence of the contract and should the contractor fail to complete the work within the time limit, it is agreed that for such calendar day that any work provided for in these Contract Documents shall remain incomplete after the time limit has expired, including any official extension of the time limit; the sum per day given in the contained schedules shall be deducted from monies due the Contractor, not as a penalty, but as liquidated damages and added expense for supervision.

The Contractor shall take into account all contingent work which has to be done by other parties arising from any cause whatsoever, and shall not plead his want of knowledge of such contingent work as an excuse for delay in his work, or for its non-performance.

IN WITNESS WHEREOF, the parties have caused this Contract to be executed and sealed the day and year first written above.

ATTEST:
SHARON R. BOCK, Clerk and Comptroller

PALM BEACH COUNTY, a Political
Subdivision of the State of Florida
BOARD OF COUNTY COMMISSIONERS

By: _____
Deputy Clerk

By: _____
Shelley Vana, Chair

APPROVED AS TO FORM
AND LEGAL SUFFICIENCY

APPROVED AS TO TERMS
AND CONDITIONS

COUNTY ATTORNEY

Charles Rich
ENGINEERING

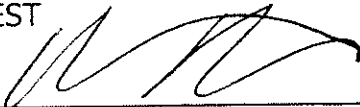
ATTEST

AKA Services, Inc.
(Corporate Name)

Mario Basile Sec.
PRINT NAME & TITLE

a Florida corporation
(Insert state of corporation)

(CORPORATE SEAL)

By: Josephine Basile
(Signature)

Josephine Basile
(Print signatory's name)

It's: President
(Print title)

**PALM BEACH COUNTY
INTER-OFFICE MEMORANDUM**

DATE: April 18, 2012

TO: Charlie Rich, Director
PBC Engineering Services Division

FROM:  Bud Cheney, Manager
CREIS

RE: 2005 and 2008 Disaster Recovery Initiative Program
Limestone Creek Project
Contract Award Approval
AKA Services, Inc.

The State of Florida Department of Economic Opportunity has approved the award of the construction contract for this project. In this regard, please note the requirements applicable to the above stated project as follows:

1. Contract: Please provide DES with a copy of the executed construction contract and the payment and performance bond. Assure that the executed contract contains the previously transmitted "Requirements for Federally Funded Projects" (including the wage decision applicable to this project).

Note 1: Please notify Joe Greco at 233-3672 of the contract award date.

Once you notify us of the award date, we shall schedule and conduct our portion of the pre-construction conference in connection with matters related to the Federal Requirements associated with this project. We shall not require an invitation to attend the construction portion of the pre-construction conference that you will conduct.

Note 2: The wage decision (copy attached) for this project has changed and the decision applicable to this project is:

- **FL 20120173 – Mod 0 (Heavy)**

Accordingly, in compliance with regulations pertaining to the Davis-Bacon and Related Acts, you will have to incorporate into said contract this wage decision change. Such changes will need to be incorporated into the contract by means of a change order.

Please Note: This attached wage decision change will not impact the cost of the project.

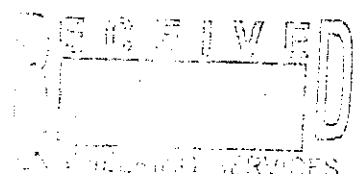

PROJECT NAME: LIMESTONE CREEK DRAINAGE - PHASE IIC
 PROJECT NUMBER: 2011056
 BID OPENING DATE: FEBRUARY 28, 2012
 CONTRACT DAYS: ONE HUNDRED TWENTY (120) CALENDAR DAYS

ITEM	QTY	UNITS	AKA SERVICES, INC.		RANGER CONSTRUCTION INDUSTRIES, INC.		OCEAN BAY CONSTRUCTION, INC.		AVERAGE UNIT PRICE
			UNIT PRICE	AMOUNT	UNIT PRICE	AMOUNT	UNIT PRICE	AMOUNT	
LIMESTONE CREEK ROAD ITEMS	****	****	*****	*****	*****	*****	*****	*****	*****
1 MOBILIZATION	1	LS	\$8,000.00	\$8,000.00	\$74,000.00	\$74,000.00	\$55,249.52	\$55,249.52	\$45,749.84
2 MAINTENANCE OF TRAFFIC (INCLUDES PEDESTRIAN MOT)	1	LS	\$4,000.00	\$4,000.00	\$6,400.00	\$6,400.00	\$9,000.00	\$9,000.00	\$6,466.67
3 RECORD DRAWINGS	1	LS	\$8,000.00	\$8,000.00	\$5,500.00	\$5,500.00	\$5,000.00	\$5,000.00	\$6,166.67
4 NPDES COMPLIANCE (SEE SP PAGES)	1	LS	\$500.00	\$500.00	\$6,000.00	\$6,000.00	\$2,500.00	\$2,500.00	\$3,000.00
5 SFWMD COMPLIANCE CERTIFICATE	1	LS	\$1,000.00	\$1,000.00	\$1,100.00	\$1,100.00	\$500.00	\$500.00	\$866.67
6 CLEARING & GRUBBING	1	LS	\$10,000.00	\$10,000.00	\$30,000.00	\$30,000.00	\$27,480.00	\$27,480.00	\$22,493.33
7 GRADING	1	LS	\$8,000.00	\$8,000.00	\$23,000.00	\$23,000.00	\$25,200.00	\$25,200.00	\$18,733.33
8 PROTECT/REPLACE TRAFFIC CIRCLE	1	LS	\$4,000.00	\$4,000.00	\$1,800.00	\$1,800.00	\$1,000.00	\$1,000.00	\$2,266.67
9 18" RCP W/PLUG	320	LF	\$30.00	\$9,600.00	\$36.00	\$11,520.00	\$58.00	\$18,560.00	\$41.33
10 24" RCP	886	LF	\$40.00	\$35,440.00	\$43.00	\$38,098.00	\$42.00	\$37,212.00	\$41.67
11 42" RCP W/2 PLUGS	80	LF	\$81.00	\$6,480.00	\$110.00	\$8,800.00	\$96.00	\$7,680.00	\$95.67
12 48" RCP	154	LF	\$98.00	\$15,092.00	\$109.00	\$16,786.00	\$138.00	\$21,252.00	\$115.00
13 54" RCP	1510	LF	\$123.00	\$185,730.00	\$121.00	\$182,710.00	\$144.00	\$217,440.00	\$129.33
14 TYPE "C" INLET	14	EA	\$2,100.00	\$29,400.00	\$2,050.00	\$28,700.00	\$2,016.00	\$28,224.00	\$2,055.33
15 TYPE P-7 MANHOLE (5' DIA)	2	EA	\$2,600.00	\$5,200.00	\$2,600.00	\$5,200.00	\$2,800.00	\$5,600.00	\$2,666.67
16 TYPE J-7 MANHOLE (5' DIA)	1	EA	\$2,600.00	\$2,600.00	\$2,800.00	\$2,800.00	\$2,780.00	\$2,780.00	\$2,726.67
17 TYPE J-7 MANHOLE (8' DIA)	10	EA	\$8,000.00	\$80,000.00	\$6,300.00	\$63,000.00	\$9,390.00	\$93,900.00	\$7,896.67
18 CONNECT 54" RCP TO EXIST. INLET	1	EA	\$1,100.00	\$1,100.00	\$5,400.00	\$5,400.00	\$2,232.00	\$2,232.00	\$2,910.67
19 12" STABILIZED SUBGRADE	8050	SY	\$4.00	\$32,200.00	\$3.70	\$29,785.00	\$2.50	\$20,125.00	\$3.40
20 BASEROCK (INCLUDES DRIVEWAY)	7750	SY	\$12.00	\$93,000.00	\$9.20	\$71,300.00	\$10.50	\$81,375.00	\$10.57
21 1¾" TYPE S-1 ASPHALT (INCLUDES DRIVEWAY)	780	TN	\$112.00	\$87,360.00	\$92.50	\$72,150.00	\$110.00	\$85,800.00	\$104.83
22 6" CONCRETE DRIVEWAYS	100	SY	\$40.00	\$4,000.00	\$44.00	\$4,400.00	\$31.00	\$3,100.00	\$38.33
23 4" CONCRETE SIDEWALK	2706	SY	\$27.00	\$73,062.00	\$27.80	\$75,226.80	\$21.00	\$56,826.00	\$25.27
24 6" CONCRETE SIDEWALK	110	SY	\$40.00	\$4,400.00	\$36.50	\$4,015.00	\$31.00	\$3,410.00	\$35.83
25 SODDING (FLORATAM OR EQUAL)	3750	SY	\$3.50	\$13,125.00	\$4.60	\$17,250.00	\$2.30	\$8,625.00	\$3.47
TOTAL BASE BID	****	****	*****	\$721,289.00	*****	\$784,940.80	*****	\$820,070.52	*****

PROJECT NAME: LIMESTONE CREEK DRAINAGE - PHASE IIC
 PROJECT NUMBER: 2011056
 BID OPENING DATE: FEBRUARY 28, 2012
 CONTRACT DAYS: ONE HUNDRED TWENTY (120) CALENDAR DAYS

ITEM	QTY	UNITS	AKA SERVICES, INC.		RANGER CONSTRUCTION INDUSTRIES, INC.		OCEAN BAY CONSTRUCTION, INC.		AVERAGE UNIT PRICE
			UNIT PRICE	AMOUNT	UNIT PRICE	AMOUNT	UNIT PRICE	AMOUNT	
CONTINGENT ITEMS									
26 ADJUST WATER SERVICE	8	EA	\$3,000.00	\$24,000.00	\$720.00	\$5,760.00	\$100.00	\$800.00	\$1,273.33
27 ADJUST SEWER SERVICE	15	EA	\$4,000.00	\$60,000.00	\$860.00	\$12,900.00	\$200.00	\$3,000.00	\$1,686.67
28 ADJUST VALVES	13	EA	\$2,000.00	\$26,000.00	\$800.00	\$10,400.00	\$150.00	\$1,950.00	\$983.33
29 ADJUST MANHOLES	16	EA	\$3,500.00	\$56,000.00	\$650.00	\$10,400.00	\$250.00	\$4,000.00	\$1,466.67
30 SUPPORT & PROTECT 8" FM	10	LF	\$80.00	\$800.00	\$36.00	\$360.00	\$100.00	\$1,000.00	\$72.00
34 SUPPORT & PROTECT 8" GRAVITY SEWER	220	LF	\$100.00	\$22,000.00	\$29.00	\$6,380.00	\$10.00	\$2,200.00	\$46.33
32 SUPPORT & PROTECT 12" WM	50	LF	\$80.00	\$4,000.00	\$35.00	\$1,750.00	\$10.00	\$500.00	\$41.67
33 SUPPORT & PROTECT 16" WM	10	LF	\$120.00	\$1,200.00	\$96.00	\$960.00	\$10.00	\$100.00	\$75.33
LIMESTONE TOTAL CONTINGENT ITEMS	****	****	*****	\$194,000.00	*****	\$48,910.00	*****	\$13,550.00	*****
LIMESTONE TOTAL BASE & CONTINGENT ITEMS	****	****	*****	\$915,289.00	*****	\$833,850.80	*****	\$833,620.52	*****
MITCHELL STREET ITEMS									
1 MOBILIZATION	1	LS	\$8,000.00	\$8,000.00	\$25,000.00	\$25,000.00	\$40,498.46	\$40,498.46	\$24,499.49
2 MAINTENANCE OF TRAFFIC (INCLUDES PEDESTRIAN MOT)	1	LS	\$4,000.00	\$4,000.00	\$1,800.00	\$1,800.00	\$3,000.00	\$3,000.00	\$2,933.33
3 RECORD DRAWINGS	1	LS	\$8,000.00	\$8,000.00	\$2,200.00	\$2,200.00	\$2,500.00	\$2,500.00	\$4,233.33
4 NPDES COMPLIANCE (SEE SP PAGES)	1	LS	\$500.00	\$500.00	\$2,500.00	\$2,500.00	\$500.00	\$500.00	\$1,166.67
5 SFWMD COMPLIANCE CERTIFICATE	1	LS	\$1,000.00	\$1,000.00	\$550.00	\$550.00	\$500.00	\$500.00	\$683.33
6 CLEARING & GRUBBING	1	LS	\$5,000.00	\$5,000.00	\$2,300.00	\$2,300.00	\$10,374.00	\$10,374.00	\$5,891.33
7 GRADING	1	LS	\$5,000.00	\$5,000.00	\$4,600.00	\$4,600.00	\$2,300.00	\$2,300.00	\$3,966.67
8 30" RCP	325	LF	\$47.00	\$15,275.00	\$53.00	\$17,225.00	\$64.00	\$20,800.00	\$54.67
9 36" RCP	712	LF	\$59.00	\$42,008.00	\$67.50	\$48,060.00	\$63.00	\$44,856.00	\$63.17
10 TYPE J-9 INLET	3	EA	\$5,000.00	\$15,000.00	\$4,900.00	\$14,700.00	\$6,250.00	\$18,750.00	\$5,383.33
11 TYPE J-7 MANHOLE	1	EA	\$4,000.00	\$4,000.00	\$3,100.00	\$3,100.00	\$3,360.00	\$3,360.00	\$3,486.67
12 12" COMPACTED SUBGRADE	3835	SY	\$3.00	\$11,505.00	\$2.00	\$7,670.00	\$2.50	\$9,587.50	\$2.50
13 BASEROCK (INCLUDES DRIVEWAY)	3105	SY	\$12.00	\$37,260.00	\$8.50	\$26,392.50	\$11.50	\$35,707.50	\$10.67
14 1½" TYPE S-1 ASPHALT (INCLUDES DRIVEWAY)	285	TN	\$143.00	\$40,755.00	\$90.00	\$25,650.00	\$142.00	\$40,470.00	\$125.00
15 6" CONCRETE DRIVEWAYS	556	SY	\$30.00	\$16,680.00	\$44.00	\$24,464.00	\$31.00	\$17,236.00	\$35.00
16 4" CONCRETE SIDEWALK	1200	SY	\$28.00	\$33,600.00	\$27.80	\$33,360.00	\$21.00	\$25,200.00	\$25.60
17 6" CONCRETE SIDEWALK	278	SY	\$30.00	\$8,340.00	\$36.50	\$10,147.00	\$31.00	\$8,618.00	\$32.50
18 TYPE F CURB & GUTTER	2660	LF	\$12.00	\$31,920.00	\$13.00	\$34,580.00	\$13.00	\$34,580.00	\$12.67
19 SODDING (FLORATAM OR EQUAL)	960	SY	\$3.50	\$3,360.00	\$4.60	\$4,416.00	\$2.30	\$2,208.00	\$3.47
TOTAL BASE BID	****	****	*****	\$291,203.00	*****	\$288,714.50	*****	\$321,045.46	*****

PROJECT NAME: LIMESTONE CREEK DRAINAGE - PHASE IIC
 PROJECT NUMBER: 2011056
 BID OPENING DATE: FEBRUARY 28, 2012
 CONTRACT DAYS: ONE HUNDRED TWENTY (120) CALENDAR DAYS

ITEM	QTY	UNITS	AKA SERVICES, INC.		RANGER CONSTRUCTION INDUSTRIES, INC.		OCEAN BAY CONSTRUCTION, INC.		AVERAGE UNIT PRICE
			UNIT PRICE	AMOUNT	UNIT PRICE	AMOUNT	UNIT PRICE	AMOUNT	
CONTINGENT ITEMS	****	****	*****	*****	*****	*****	*****	*****	*****
20 ADJUST WATER SERVICE	9	EA	\$3,000.00	\$27,000.00	\$720.00	\$6,480.00	\$100.00	\$900.00	\$1,273.33
21 ADJUST SEWER SERVICE	8	EA	\$4,000.00	\$32,000.00	\$860.00	\$6,880.00	\$200.00	\$1,600.00	\$1,686.67
MITCHELL TOTAL CONTINGENT ITEMS	****	****	*****	\$59,000.00	*****	\$13,360.00	*****	\$2,500.00	*****
MITCHELL TOTAL BASE & CONTINGENT ITEMS	****	****	*****	\$350,203.00	*****	\$302,074.50	*****	\$323,545.46	*****
TOTAL LIMESTONE & MITCHELL BASE BIDS	****	****	*****	\$1,012,492.00	*****	\$1,073,655.30	*****	\$1,141,115.98	*****
GRAND TOTAL ALL ITEMS	****	****	*****	\$1,265,492.00	*****	\$1,135,925.30	*****	\$1,157,165.98	*****

*DENOTES CORRECTED FIGURE
 BIDS RECEIVED BY: CHARLES W. RICH, P.E.
 BIDS RECORDED BY: JAYNE CANALE, TECHNICAL AIDE

PROJECT NAME: LIMESTONE CREEK DRAINAGE - PHASE IIC
PROJECT NUMBER: 2011056
BID OPENING DATE: FEBRUARY 28, 2012
CONTRACT DAYS: ONE HUNDRED TWENTY (120) CALENDAR DAYS

SUNSHINE LAND DESIGN, INC.

ITEM	QTY	UNITS	UNIT PRICE	AMOUNT
LIMESTONE CREEK ROAD ITEMS				
	****	****	*****	*****
1 MOBILIZATION	1	LS	\$25,520.00	\$25,520.00
2 MAINTENANCE OF TRAFFIC (INCLUDES PEDESTRIAN MOT)	1	LS	\$13,200.00	\$13,200.00
3 RECORD DRAWINGS	1	LS	\$11,000.00	\$11,000.00
4 NPDES COMPLIANCE (SEE SP PAGES)	1	LS	\$14,847.40	\$14,847.40
5 SFWMD COMPLIANCE CERTIFICATE	1	LS	\$1,100.00	\$1,100.00
6 CLEARING & GRUBBING	1	LS	\$89,356.80	\$89,356.80
7 GRADING	1	LS	\$14,410.00	\$14,410.00
8 PROTECT/REPLACE TRAFFIC CIRCLE	1	LS	\$2,750.00	\$2,750.00
9 18" RCP W/PLUG	320	LF	\$27.98	\$8,953.60
10 24" RCP	886	LF	\$42.67	\$37,805.62
11 42" RCP W/2 PLUGS	80	LF	\$115.47	\$9,237.60
12 48" RCP	154	LF	\$121.53	\$18,715.62
13 54" RCP	1510	LF	\$115.85	\$174,933.50
14 TYPE "C" INLET	14	EA	\$1,635.48	\$22,896.72
15 TYPE P-7 MANHOLE (5' DIA)	2	EA	\$2,680.37	\$5,360.74
16 TYPE J-7 MANHOLE (5' DIA)	1	EA	\$2,680.37	\$2,680.37
17 TYPE J-7 MANHOLE (8' DIA)	10	EA	\$9,369.94	\$93,699.40
18 CONNECT 54" RCP TO EXIST. INLET	1	EA	\$2,750.00	\$2,750.00
19 12" STABILIZED SUBGRADE	8050	SY	\$5.80	\$46,690.00
20 BASEROCK (INCLUDES DRIVEWAY)	7750	SY	\$11.31	\$87,652.50
21 1¾" TYPE S-1 ASPHALT (INCLUDES DRIVEWAY)	780	TN	\$117.57	\$91,704.60
22 6" CONCRETE DRIVEWAYS	100	SY	\$39.86	\$3,986.00
23 4" CONCRETE SIDEWALK	2706	SY	\$27.22	\$73,657.32
24 6" CONCRETE SIDEWALK	110	SY	\$39.86	\$4,384.60
25 SODDING (FLORATAM OR EQUAL)	3750	SY	\$2.52	\$9,450.00
TOTAL BASE BID	****	****	*****	\$866,742.39

PROJECT NAME: LIMESTONE CREEK DRAINAGE - PHASE IIC
 PROJECT NUMBER: 2011056
 BID OPENING DATE: FEBRUARY 28, 2012
 CONTRACT DAYS: ONE HUNDRED TWENTY (120) CALENDAR DAYS

SUNSHINE LAND DESIGN, INC.

ITEM	QTY	UNITS	UNIT PRICE	AMOUNT
CONTINGENT ITEMS				
26 ADJUST WATER SERVICE	8	EA	\$1,274.18	\$10,193.44
27 ADJUST SEWER SERVICE	15	EA	\$1,115.54	\$16,733.10
28 ADJUST VALVES	13	EA	\$220.00	\$2,860.00
29 ADJUST MANHOLES	16	EA	\$440.00	\$7,040.00
30 SUPPORT & PROTECT 8" FM	10	LF	\$55.00	\$550.00
34 SUPPORT & PROTECT 8" GRAVITY SEWER	220	LF	\$55.00	\$12,100.00
32 SUPPORT & PROTECT 12" WM	50	LF	\$55.00	\$2,750.00
33 SUPPORT & PROTECT 16" WM	10	LF	\$55.00	\$550.00
LIMESTONE TOTAL CONTINGENT ITEMS	****	****	*****	\$52,776.54
LIMESTONE TOTAL BASE & CONTINGENT ITEMS	****	****	*****	\$919,518.93
MITCHELL STREET ITEMS				
1 MOBILIZATION	1	LS	\$10,450.00	\$10,450.00
2 MAINTENANCE OF TRAFFIC (INCLUDES PEDESTRIAN MOT)	1	LS	\$5,692.50	\$5,692.50
3 RECORD DRAWINGS	1	LS	\$2,200.00	\$2,200.00
4 NPDES COMPLIANCE (SEE SP PAGES)	1	LS	\$7,337.80	\$7,337.80
5 SFWMD COMPLIANCE CERTIFICATE	1	LS	\$550.00	\$550.00
6 CLEARING & GRUBBING	1	LS	\$34,378.00	\$34,378.00
7 GRADING	1	LS	\$2,832.50	\$2,832.50
8 30" RCP	325	LF	\$52.92	\$17,199.00
9 36" RCP	712	LF	\$74.28	\$52,887.36
10 TYPE J-9 INLET	3	EA	\$6,553.28	\$19,659.84
11 TYPE J-7 MANHOLE	1	EA	\$3,316.39	\$3,316.39
12 12" COMPACTED SUBGRADE	3835	SY	\$1.38	\$5,292.30
13 BASEROCK (INCLUDES DRIVEWAY)	3105	SY	\$10.58	\$32,850.90
14 1½" TYPE S-1 ASPHALT (INCLUDES DRIVEWAY)	285	TN	\$117.57	\$33,507.45
15 6" CONCRETE DRIVEWAYS	556	SY	\$39.86	\$22,162.16
16 4" CONCRETE SIDEWALK	1200	SY	\$27.22	\$32,664.00
17 6" CONCRETE SIDEWALK	278	SY	\$39.86	\$11,081.08
18 TYPE F CURB & GUTTER	2660	LF	\$12.98	\$34,526.80
19 SODDING (FLORATAM OR EQUAL)	960	SY	\$2.52	\$2,419.20
TOTAL BASE BID	****	****	*****	\$331,007.28

PROJECT NAME: LIMESTONE CREEK DRAINAGE - PHASE IIC
 PROJECT NUMBER: 2011056
 BID OPENING DATE: FEBRUARY 28, 2012
 CONTRACT DAYS: ONE HUNDRED TWENTY (120) CALENDAR DAYS

SUNSHINE LAND DESIGN, INC.

ITEM	QTY	UNITS	UNIT PRICE	AMOUNT
CONTINGENT ITEMS	****	****	*****	*****
20 ADJUST WATER SERVICE	9	EA	\$1,274.18	\$11,467.62
21 ADJUST SEWER SERVICE	8	EA	\$1,115.54	\$8,924.32
MITCHELL TOTAL CONTINGENT ITEMS	****	****	*****	\$20,391.94
MITCHELL TOTAL BASE & CONTINGENT ITEMS	****	****	*****	\$351,399.22
TOTAL LIMESTONE & MITCHELL BASE BIDS	****	****	*****	\$1,197,749.67 *
GRAND TOTAL ALL ITEMS	****	****	*****	\$1,270,918.15

*DENOTES CORRECTED FIGURE
 BIDS RECEIVED BY: CHARLES W. RICH, P.E.
 BIDS RECORDED BY: JAYNE CANALE, TECHNICAL AIDE

12- *OPP2*

BOARD OF COUNTY COMMISSIONERS
PALM BEACH COUNTY, FLORIDA
BUDGET TRANSFER

1469

BGEX-143-0514120000000000XXXX

FUND 1106 - Disaster Recovery Initiative

Use this form to provide budget for items not anticipated in the budget.

ACCOUNT NUMBER	ACCOUNT NAME	ORIGINAL BUDGET	CURRENT BUDGET	INCREASE	DECREASE	ADJUSTED BUDGET	EXPENDED/ ENCUMBERED	REMAINING BALANCE
EXPENDITURES								
143-1421-8101	Contributions Other Governmental Agency	0	3,591,515	0	620,853	2,970,662		
143-1427-8201	Contributions Non Governmental Agency	6,355,070	6,244,265	0	817,326	5,426,939		
820-1421-9207	Transfer to Capital Outlay Fund 3900	0	0	620,853	0	620,853		
820-1427-9207	Transfer to Captial Outlay Fund 3900	0	0	817,326	0	817,326		
TOTAL EXPENDITURES								
				1,438,179	1,438,179			

Department of Economic Sustainability
INITIATING DEPARTMENT/DIVISION
Administration/Budget Department Approval
OFMB Department - Posted

Signatures	Date
<i>[Signature]</i>	5-14-2012
<i>[Signature]</i>	5/14/2012

By Board of County Commissioners
At Meeting of
May 15, 2012
Deputy Clerk to the
Board of County Commissioners

2012- 0881

**BOARD OF COUNTY COMMISSIONERS
PALM BEACH COUNTY
BUDGET Amendment**

FUND Capital Outlay

BGRV-360-051012*534
BGEX-360-051012*1444

ACCOUNT NUMBER	ACCOUNT NAME	ORIGINAL BUDGET	CURRENT BUDGET	INCREASE	DECREASE	ADJUSTED BUDGET	EXPENDED/ ENCUMBERED AS OF 05/10/12	REMAINING BALANCE
REVENUES								
Transfers								
3900-800- 1374 -8319	Tr Fr Disaster Recovery Initiative	0	0	1,438,179	0	1,438,179		
TOTAL RECEIPTS & BALANCES		20,395,042	19,084,746	1,438,179	0	20,522,925		
EXPENDITURES								
Limestone Creek Drainage – Phase IIC								
3900-361-1374-6551	Road & Street Improvements	0	0	1,438,179	0	1,438,179	0	1,438,179
TOTAL APPROPRIATIONS & EXPENDITURES		20,395,042	19,084,746	1,438,179	0	20,522,925		

	SIGNATURE	DATE	By Board of County Commissioners At Meeting of <u>05/15/12</u>
Engineering & Public Works	<u><i>Arthur White</i></u>	<u>5/14/12</u>	
Administration / Budget Approval	<u><i>N. Diaz</i></u>	<u>5/14/2012</u>	
OFMB Department – Posted		<u>5/14/12 cc</u>	Deputy Clerk to the Board of County Commissioners