

II. FISCAL IMPACT ANALYSIS

A. Five Year Summary of Fiscal Impact:

Fiscal Years	2012	2013	2014	2015	2016
Capital Expenditures	_____	_____	_____	_____	_____
Operating Costs	_____	<u>\$10</u>	<u>\$10</u>	<u>\$10</u>	<u>\$10</u>
External Revenues	_____	_____	_____	_____	_____
Program Income (County)	_____	_____	_____	_____	_____
In-Kind Match (County)	_____	_____	_____	_____	_____
NET FISCAL IMPACT	<u>\$-0-</u>	<u>\$10</u>	<u>\$10</u>	<u>\$10</u>	<u>\$10</u>
# ADDITIONAL FTE POSITIONS (Cumulative)	_____	_____	_____	_____	_____

Is Item Included in Current Budget: Yes X No

Budget Account No: Fund 5000 Dept 410 Unit 7220 Object 4909
 Program n/a

B. Recommended Sources of Funds/Summary of Fiscal Impact:

C. Departmental Fiscal Review: _____ *[Signature]* 7-23-12

III. REVIEW COMMENTS

A. OFMB Fiscal and/or Contract Development Comments:

<p>_____ <i>[Signature]</i> 7/24/12 OFMB 7/24/12</p>	<p>_____ <i>[Signature]</i> 7/26/12 Contract Development and Control 7-26-12 B. Wheeler</p>
--	---

B. Legal Sufficiency:

_____ *[Signature]* 7/27/12
 Assistant County Attorney

C. Other Department Review:

 Department Director

This summary is not to be used as a basis for payment.

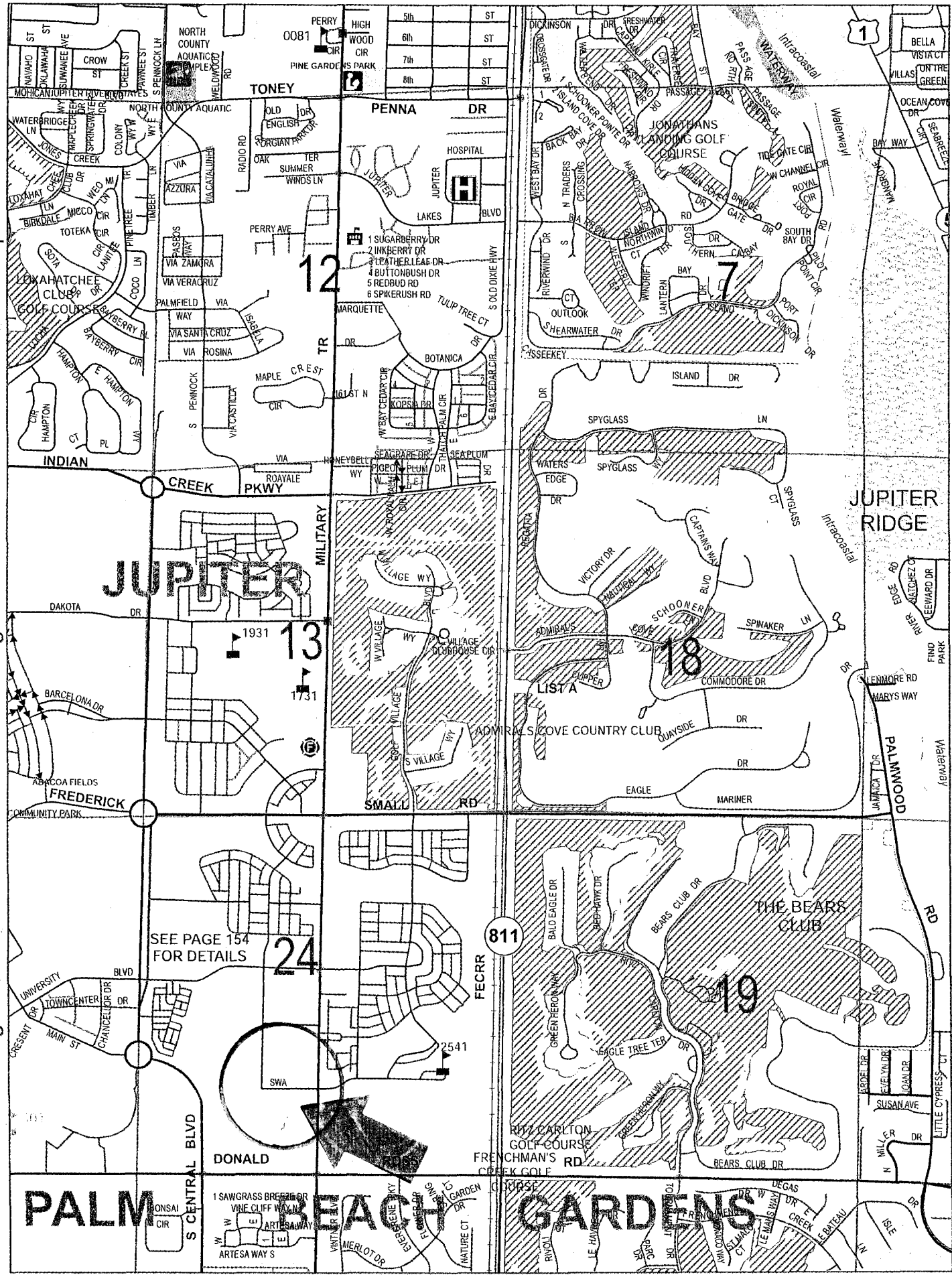

T41

11

T41

LOCATION MAP





Facilities Development & Operations Department
Property & Real Estate Management Division

2633 Vista Parkway

West Palm Beach, FL 33411-5605

(561) 233-0217

FAX: (561) 233-0210

www.pbcgov.com/fdo

Palm Beach County Board of County Commissioners

Shelley Vana, Chair

Steven L. Abrams, Vice Chairman

Karen T. Marcus

Paulette Burdick

Burt Aaronson

Jess R. Santamaria

Priscilla A. Taylor

County Administrator

Robert Weisman

**CERTIFIED MAIL
RETURN RECEIPT REQUESTED
#7010 0290 0000 7884 4589 /**

August 14, 2012

Solid Waste Authority
Attn: Mark Hammond, Executive Director
7501 North Jog Road
West Palm Beach, FL 33412

Re: Exercise of Third Option to Extend Land Lease Agreement (R97-2119D) dated December 16, 1997

Dear Mr. Hammond:

Pursuant to the provisions of Section 1.03 of the above referenced Lease, Palm Beach County, as Lessee, is hereby exercising its third option to extend the term of said Lease for an additional period of five (5) years from December 16, 2012, through December 15, 2017.

ATTEST:
SHARON R. BOCK
CLERK & COMPTRROLLER

PALM BEACH COUNTY, a political subdivision of the State of Florida

By: _____
Deputy Clerk

By: _____
Shelley Vana, Chair

APPROVED AS TO FORM AND LEGAL SUFFICIENCY

APPROVED AS TO TERMS AND CONDITIONS

By:
Assistant County Attorney

By:
Audrey Wolf, Director
Facilities Development & Operations

