

**PALM BEACH COUNTY  
BOARD OF COUNTY COMMISSIONERS  
AGENDA ITEM SUMMARY**

<b>Meeting Date:</b>	<b>October 2, 2012</b>	<b>Consent [X]</b>	<b>Regular [ ]</b>
		<b>Public Hearing [ ]</b>	
<b>Department:</b>	<b>Water Utilities Department</b>		

**I. EXECUTIVE BRIEF**

**Motion and Title:** Staff recommends motion to approve: a Contract with Hinterland Group, Inc. for the Glades Utility Authority's (GUA) Strategic Wastewater Infrastructure Project Sewer Collection - City of Belle Glade in an amount of \$1,877,979, contingent upon approval of the local match requirement by the United States Department of Commerce - Economic Development Administration (EDA).

**Summary:** This item is the result of the rebid of this project directed by the Board of County Commissioners (BCC) at their June 5, 2012, meeting. On August 15, 2012, four (4) bids were received for the Glades Utility Authority's (GUA) Strategic Wastewater Infrastructure Project Sewer Collection - City of Belle Glade. Palm Beach County Water Utilities Department (WUD) is implementing this project under its Management & Operations Contract with the GUA. Hinterland Group, Inc. was the lowest responsive responsible bidder in the amount of \$1,877,979. The project is subject to a 22.4% minority participation goal and a 6.9% female participation goal for trades rather than the County's SBE goals. This contract with Hinterland Group, Inc. provides for 3.19% participation utilizing M/WBE certified suppliers (3.19% minority and 0.00% female participation). Based on acceptance of these goals by EDA, staff recommends award to Hinterland Group, Inc, a Palm Beach County company. This project utilizes Federal EDA funds (EDA award number 04-79-06327) which require a 25% local match. The local match proposed includes two (2) GUA Community Development Block Grant (CDBG) funded projects. EDA approval of these projects as eligible local matches is still pending, so this award is being made contingent on that approval. (WUD Project No. 10-062R) District 6 (JM)

**Background and Justification:** On April 7, 2010, a grant from the EDA was awarded to Glades Utility Authority (GUA) and Palm Beach County. On September 8, 2010, Consultant Service Authorization No. 7 for \$98,155 was approved by the County's Contract Review Committee with AECOM for the design and preparation of plans and technical specifications Strategic Wastewater Infrastructure Project Sewer Collection - City of Belle Glade. There were a number of minor irregularities identified in all bid documents which are detailed in Attachment 7. Staff waived these irregularities as they did not provide the low bidder with any competitive or monetary advantage. There is no bid protest associated with this item.

**Attachments:**

1. Two (2) Original Contracts
2. Location Map
3. Engineer's Recommendation & Bid Tabulation Sheet
4. Letter from Hinterland Group, Inc. – M/WBE Participation
5. Hinterland Group, Inc. – Documentation of Good Faith Efforts
6. Approval by the U.S. Department of Commerce EDA
7. List of minor irregularities

Recommended By:	<u><i>Brenda Beardslee</i></u>	<u>9/19/12</u>
	<b>Department Director</b>	<b>Date</b>

Approved By:	<u><i>Sharon G. Lyerly</i></u>	<u>9/24/12</u>
	<b>Assistant County Administrator</b>	<b>Date</b>

**II. FISCAL IMPACT ANALYSIS**

**A. Five Year Summary of Fiscal Impact:**

Fiscal Years	2013	2014	2015	2016	2017
Capital Expenditures	\$1,877,979.00	\$0	\$0	0	0
External Revenues	(\$1,877,979.00)	0	0	0	0
Program Income (County)	0	0	0	0	0
In-Kind Match County	\$0	0	0	0	0
<b>NET FISCAL IMPACT</b>	<b>\$0</b>	<b>\$0</b>	<b>\$0</b>	<b>0</b>	<b>0</b>
<b># ADDITIONAL FTE POSITIONS (Cumulative)</b>	<b>0</b>	<b>0</b>	<b>0</b>	<b>0</b>	<b>0</b>

**Budget Account No.:** Fund 4011 Dept 721 Unit W026 Object 6547

Is Item Included in Current Budget? Yes X No     

Reporting Category N/A

**B. Recommended Sources of Funds/Summary of Fiscal Impact:**

This contract is part of a larger EDA funded project. WUD will manage the project for the GUA. The project will be funded from CDBG funding for 25% match. The GUA will be reimbursed by EDA for 75% of the project costs and repay WUD from these funds. Portions of WUD Project #12-040 (~\$300,000) and WUD Project #12-041 (~\$1,200,000) will be used to fund the required project match (\$1,330,000).

**C. Department Fiscal Review:**

**III. REVIEW COMMENTS**

**A. OFMB Fiscal and/or Contract Development and Control Comments:**

9/20/2012  
OFMB 9/19

9/24/12  
Contract Development and Control 9-24-12

**B. Legal Sufficiency:**

9/25/12  
Assistant County Attorney

**C. Other Department Review:**

\_\_\_\_\_  
Department Director

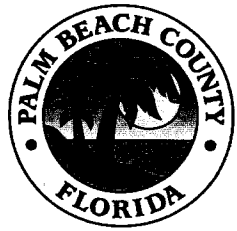

Palm Beach County Water Utilities Department Service Area (SA) and Major Facilities

Attachment 2

- Legend**
- P.B.C.W.U.D. SA
  - Mandatory Reclaimed SA
  - - - - - Palm Beach County Limits
  - ★ Administration
  - Water Reclamation Facility
  - ▲ Water Treatment Facility
  - ⊙ Wetlands

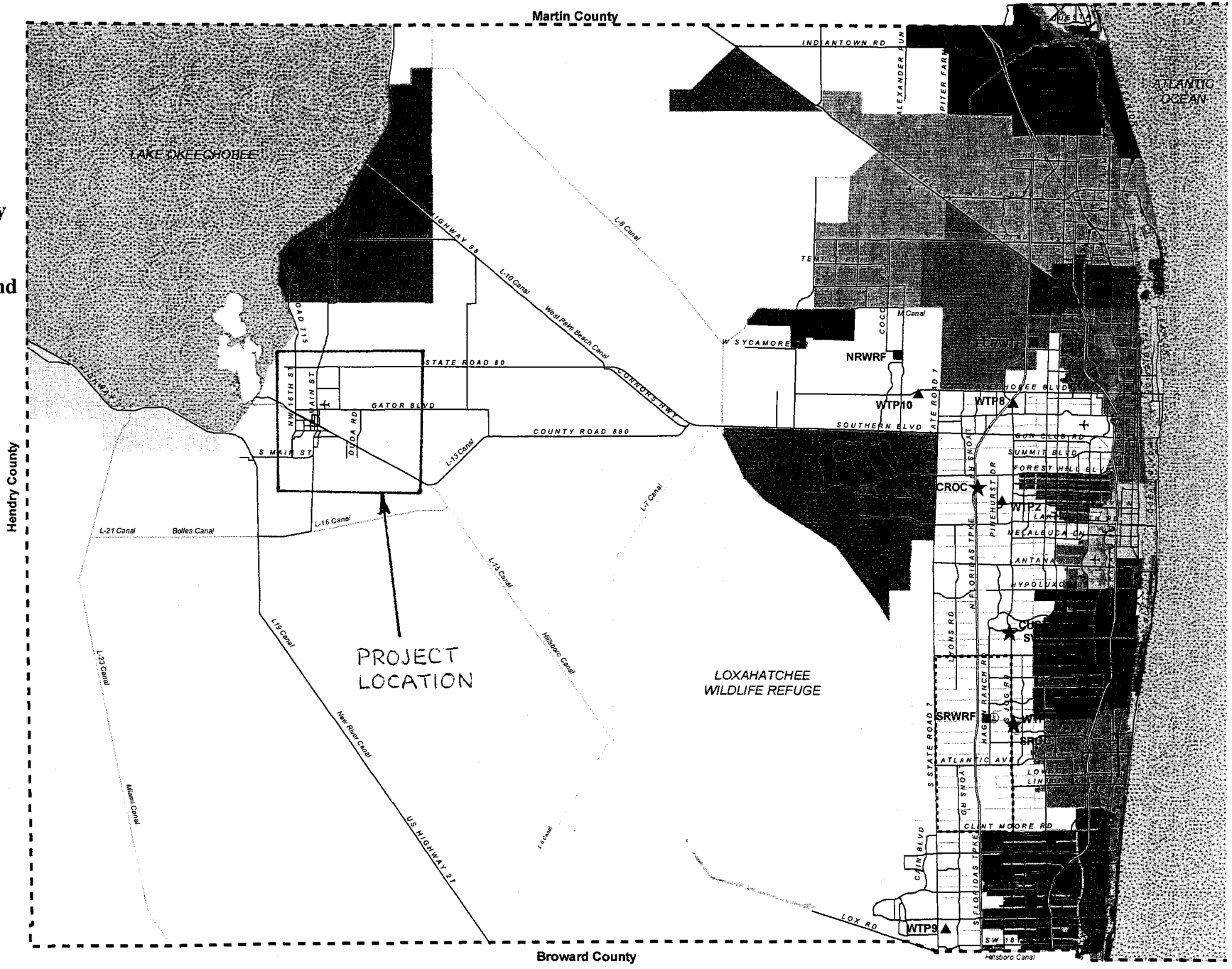

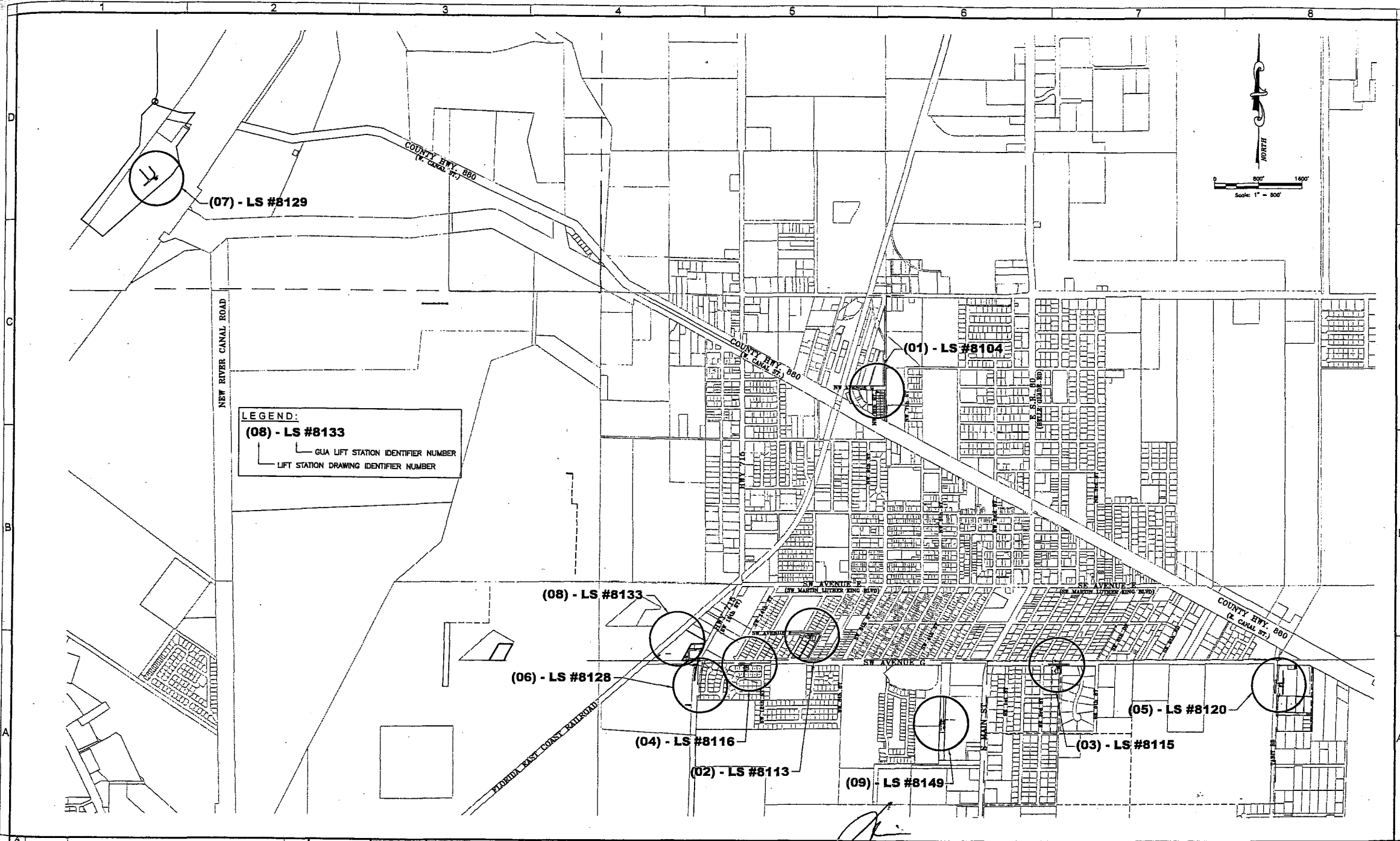

10/31/11 ADD'L REVISIONS PER PRCWUD/RE-ISSUED FOR BIDDING  
 6/17/11 ISSUED FOR BIDDING  
 REV DATE DESCRIPTION APPR

REV	DATE	DESCRIPTION	APPR
1			
2			

<b>VERIFY SCALES</b> 1/8" = 1" ON ORIGINAL DRAWING IF NOT ONE INCH ON THIS SHEET, ADJUST SCALES ACCORDINGLY	DESIGNED BY LAL	PROJECT ENGINEER LAWRENCE A. LARDIERI, P.E.
	DRAWN BY DLP	REG NUMBER FL 26948
	CHECKED BY LAL	PROJECT NUMBER 60185970
	DATE 01/20/11	CADD STANDARDS AECOM

  
**AECOM**  
AECOM Technical Services, Inc.  
 3500 S.W. Corporate Parkway  
 Palm City, Florida 34980  
 T 772.286.3883 F 772.286.3925  
 Certificate of Authorization #115  
 www.aecom.com

**Lawrence A. Lardieri, P.E.**  
 No. 26948  
 NOV 15 2011

GLADES UTILITY AUTHORITY  
 - SEWER COLLECTION - CITY OF BELLE GLADE  
**KEY SHEET PLAN**

DRAWING	00-G-004
SHEET	00-G-004
OF SHEETS	00-G-004
WUD	10-062

Date: August 22, 2012

Asa R. Williams, E.I., Civil Engineer/Project Manager  
 U.S. Department of Commerce  
 Economic Development Administration  
 Atlanta Regional Office  
 401 West Peachtree Street, N.W., Suite 1820  
 Atlanta, Georgia 30308-3510

Re: EDA Award Number: 04-79-06327  
 City, State

Subject: **RECOMMENDED AWARD**

Dear Mr. Williams:

On August 15, 2012, sealed bids for the **Wastewater Infrastructure Project Sewer Collection - City of Belle Glade** portion of the subject-referenced project were opened in public in the presence of the duly authorized representative. Enclosed please find items requested by the EDA Bid Opening Checklist. The proposed recommended contractor is:

Project Description	Contractor Name	Contract Amount	A/E Estimate
W.I.P. Sewer Collection - City of Belle Glade	Hinterland Group, Inc.	\$1,877,979.00	\$1,800,000.00

We have reviewed the website <http://epls.arnet.gov/> and the recommended firm does not appear on the Federal list of debarred contractors.

Please review the documents, sign below indicating EDA's acceptance, and (*choose one*) email a copy of this letter for our records to our project manager, Dimitrios Scarlatos at [dscarlatos@pbcwater.com](mailto:dscarlatos@pbcwater.com) (*or*) fax a copy of this letter for our records to (561) 493-6113.

Should you require additional information please contact me at (561) 493-6118.

Sincerely,



Dimitrios Scarlatos  
 Project Designer II, Palm Beach County Water Utilities

c: Greg Vaday, AICP, Economic Development Coordinator

EDA Concurrence:

  
 Asa R. Williams  
 Civil Engineer/Project Manager

  
 Date

STRATEGIC WASTEWATER INFRASTRUCTURE PROJECT - SEWER COLLECTION CITY OF BELLE GLADE

WUD 10-062R

BID TABULATION

Wednesday, August 15, 2012

Bid Item	ITEM DESCRIPTION	UNIT	QUANTITY	American Infrastructure Technologies Corp.		Foster Marine Contractors, Inc.		Hinterland Group, Inc.		Lanzo Construction Co., Florida	
				UNIT COST	TOTAL	UNIT COST	TOTAL	UNIT COST	TOTAL	UNIT COST	TOTAL
1	Lift Station 8104	LS	1	\$ 146,000.00	\$ 146,000.00	\$ 121,000.00	\$ 121,000.00	\$ 104,145.00	\$ 104,145.00	\$ 103,000.00	\$ 103,000.00
2	Lift Station 8113	LS	1	\$ 180,000.00	\$ 180,000.00	\$ 145,000.00	\$ 145,000.00	\$ 120,975.00	\$ 120,975.00	\$ 123,000.00	\$ 123,000.00
3	Lift Station 8115	LS	1	\$ 120,000.00	\$ 120,000.00	\$ 143,000.00	\$ 143,000.00	\$ 117,325.00	\$ 117,325.00	\$ 119,000.00	\$ 119,000.00
4	Lift Station 8116	LS	1	\$ 109,000.00	\$ 109,000.00	\$ 138,000.00	\$ 138,000.00	\$ 113,780.00	\$ 113,780.00	\$ 117,000.00	\$ 117,000.00
5	Lift Station 8120	LS	1	\$ 184,000.00	\$ 184,000.00	\$ 140,000.00	\$ 140,000.00	\$ 124,775.00	\$ 124,775.00	\$ 120,000.00	\$ 120,000.00
6	Lift Station 8128	LS	1	\$ 91,000.00	\$ 91,000.00	\$ 140,000.00	\$ 140,000.00	\$ 119,795.00	\$ 119,795.00	\$ 119,000.00	\$ 119,000.00
7	Lift Station 8129	LS	1	\$ 141,000.00	\$ 141,000.00	\$ 129,000.00	\$ 129,000.00	\$ 99,110.00	\$ 99,110.00	\$ 121,000.00	\$ 121,000.00
8	Lift Station 8133	LS	1	\$ 148,000.00	\$ 148,000.00	\$ 123,000.00	\$ 123,000.00	\$ 125,350.00	\$ 125,350.00	\$ 110,000.00	\$ 110,000.00
9	Lift Station 8149	LS	1	\$ 147,000.00	\$ 147,000.00	\$ 126,000.00	\$ 126,000.00	\$ 123,855.00	\$ 123,855.00	\$ 117,000.00	\$ 117,000.00
10	Install 8-inch Diameter Liner	19,800	LF	\$ 29.00	\$ 574,200.00	\$ 28.50	\$ 564,300.00	\$ 27.20	\$ 538,560.00	\$ 26.40	\$ 522,720.00
11	Install 10-inch Diameter Liner	200	LF	\$ 47.00	\$ 9,400.00	\$ 35.00	\$ 7,000.00	\$ 30.00	\$ 6,000.00	\$ 28.60	\$ 5,720.00
12	Install 12-inch Diameter Liner	0	LF	\$ 60.00	\$ -	\$ 45.00	\$ -	\$ 60.00	\$ -	\$ 63.80	\$ -
13	Point Repairs 8" and 10" pipe at depths up to 5 feet	12	EA	\$ 2,400.00	\$ 28,800.00	\$ 8,885.00	\$ 106,620.00	\$ 3,220.00	\$ 38,640.00	\$ 4,490.00	\$ 53,880.00
14	Point Repairs 8" and 10" pipe at depths 5 feet to 8 feet	24	EA	\$ 2,600.00	\$ 62,400.00	\$ 10,400.00	\$ 249,600.00	\$ 3,320.00	\$ 79,680.00	\$ 5,400.00	\$ 129,600.00
15	Point Repairs 8" and 10" pipe at depths 8 feet to 10 feet	6	EA	\$ 2,800.00	\$ 16,800.00	\$ 13,000.00	\$ 78,000.00	\$ 3,420.00	\$ 20,520.00	\$ 6,280.00	\$ 37,680.00
16	Point Repairs 8" and 10" pipe at depths 10 feet to 12 feet	1	EA	\$ 6,300.00	\$ 6,300.00	\$ 15,000.00	\$ 15,000.00	\$ 3,520.00	\$ 3,520.00	\$ 8,000.00	\$ 8,000.00
17	Point Repairs 12" pipe at depths up to 5 feet	1	EA	\$ 3,000.00	\$ 3,000.00	\$ 9,500.00	\$ 9,500.00	\$ 3,250.00	\$ 3,250.00	\$ 4,600.00	\$ 4,600.00
18	Point Repairs 12" pipe at depths 5 feet to 8 feet	1	EA	\$ 3,300.00	\$ 3,300.00	\$ 11,500.00	\$ 11,500.00	\$ 3,350.00	\$ 3,350.00	\$ 5,500.00	\$ 5,500.00
19	Point Repairs 12" pipe at depths 8 feet to 10 feet	1	EA	\$ 3,700.00	\$ 3,700.00	\$ 13,800.00	\$ 13,800.00	\$ 3,450.00	\$ 3,450.00	\$ 6,400.00	\$ 6,400.00
20	Point Repairs 12" pipe at depths 10 feet to 12 feet	1	EA	\$ 5,500.00	\$ 5,500.00	\$ 16,000.00	\$ 16,000.00	\$ 3,550.00	\$ 3,550.00	\$ 8,000.00	\$ 8,000.00
21	Smoke Testing	30,000	LF	\$ 0.75	\$ 22,500.00	\$ 0.30	\$ 9,000.00	\$ 0.50	\$ 15,000.00	\$ 0.60	\$ 18,000.00
22	Clean and video 8" to 10" Pipe	31,800	LF	\$ 1.75	\$ 55,650.00	\$ 1.00	\$ 31,800.00	\$ 1.20	\$ 38,160.00	\$ 1.20	\$ 38,160.00
23	Clean and video 12" Pipe	1,700	LF	\$ 2.00	\$ 3,400.00	\$ 1.30	\$ 2,210.00	\$ 1.50	\$ 2,550.00	\$ 1.20	\$ 2,040.00
24	Mechanical root removal (8-inch piping)	100	LF	\$ 3.00	\$ 300.00	\$ 4.00	\$ 400.00	\$ 3.90	\$ 390.00	\$ 2.50	\$ 250.00
25	Mechanical root removal (10-inch piping)	40	LF	\$ 4.00	\$ 160.00	\$ 4.00	\$ 160.00	\$ 3.90	\$ 156.00	\$ 3.00	\$ 120.00
26	Mechanical root removal (12-inch piping)	20	LF	\$ 5.00	\$ 100.00	\$ 4.00	\$ 80.00	\$ 3.90	\$ 78.00	\$ 3.50	\$ 70.00
27	Install missing cleanout lid	10	EA	\$ 115.00	\$ 1,150.00	\$ 235.00	\$ 2,350.00	\$ 50.00	\$ 500.00	\$ 50.00	\$ 500.00
28	Furnish and install Inflow Protector	75	EA	\$ 150.00	\$ 11,250.00	\$ 36.00	\$ 2,700.00	\$ 90.00	\$ 6,750.00	\$ 180.00	\$ 13,500.00
29	Manhole Inspection	100	EA	\$ 100.00	\$ 10,000.00	\$ 75.00	\$ 7,500.00	\$ 50.00	\$ 5,000.00	\$ 45.00	\$ 4,500.00
30	Asphalt Pavement Removal and Restoration	100	S.Y.	\$ 95.00	\$ 9,500.00	\$ 95.00	\$ 9,500.00	\$ 70.00	\$ 7,000.00	\$ 55.00	\$ 5,500.00
31	Concrete Sidewalk Removal and Restoration	50	S.Y.	\$ 65.00	\$ 3,250.00	\$ 68.00	\$ 3,400.00	\$ 60.00	\$ 3,000.00	\$ 50.00	\$ 2,500.00
32	Concrete Driveway Removal and Restoration	50	S.Y.	\$ 85.00	\$ 4,250.00	\$ 73.00	\$ 3,650.00	\$ 60.00	\$ 3,000.00	\$ 63.00	\$ 3,150.00
33	Concrete Curb and Gutter Restoration	50	LF	\$ 55.00	\$ 2,750.00	\$ 40.00	\$ 2,000.00	\$ 23.00	\$ 1,150.00	\$ 55.00	\$ 2,750.00
34	Sod Replacement	1,000	S.Y.	\$ 4.00	\$ 4,000.00	\$ 11.00	\$ 11,000.00	\$ 3.50	\$ 3,500.00	\$ 5.50	\$ 5,500.00
35	Tree Removal (4" to 10" Dia. Trunk)	5	EA	\$ 350.00	\$ 1,750.00	\$ 462.00	\$ 2,310.00	\$ 200.00	\$ 1,000.00	\$ 440.00	\$ 2,200.00
36	24-hour emergency mobilization - 700 GPM 300' to next MH	1	EA	\$ 1,500.00	\$ 1,500.00	\$ 2,750.00	\$ 2,750.00	\$ 1,000.00	\$ 1,000.00	\$ 4,800.00	\$ 4,800.00
37	Proctor Test	4	EA	\$ 100.00	\$ 400.00	\$ 110.00	\$ 440.00	\$ 95.00	\$ 380.00	\$ 275.00	\$ 1,100.00
38	Density Test	10	EA	\$ 55.00	\$ 550.00	\$ 33.00	\$ 330.00	\$ 25.00	\$ 250.00	\$ 72.00	\$ 720.00
39	Concrete Cylinder Test	10	EA	\$ 100.00	\$ 1,000.00	\$ 110.00	\$ 1,100.00	\$ 150.00	\$ 1,500.00	\$ 110.00	\$ 1,100.00
40	Maintenance of Traffic	1	Lump	\$ 25,000.00	\$ 25,000.00	\$ 16,600.00	\$ 16,600.00	\$ 3,000.00	\$ 3,000.00	\$ 4,400.00	\$ 4,400.00
41	4-inch Line Stop	1	EA	\$ 2,250.00	\$ 2,250.00	\$ 3,400.00	\$ 3,400.00	\$ 2,000.00	\$ 2,000.00	\$ 6,475.00	\$ 6,475.00
42	6-inch Line Stop	1	EA	\$ 2,500.00	\$ 2,500.00	\$ 3,700.00	\$ 3,700.00	\$ 2,350.00	\$ 2,350.00	\$ 6,880.00	\$ 6,880.00
43	8-inch Line Stop	1	EA	\$ 3,000.00	\$ 3,000.00	\$ 4,300.00	\$ 4,300.00	\$ 2,635.00	\$ 2,635.00	\$ 7,400.00	\$ 7,400.00
44	Pre-construction video	1,500	LF	\$ 4.00	\$ 6,000.00	\$ 1.25	\$ 1,875.00	\$ 2.00	\$ 3,000.00	\$ 1.50	\$ 2,250.00
45	Allowance	1			\$ 25,000.00		\$ 25,000.00		\$ 25,000.00		\$ 25,000.00
	<b>TOTAL</b>				<b>\$ 2,176,610.00</b>		<b>\$ 2,423,875.00</b>		<b>\$ 1,877,979.00</b>		<b>\$ 1,989,945.00</b>

**From:** Daniel A. Duke III [mailto:dduke1@hinterlandgroup.com]  
**Sent:** Wednesday, August 29, 2012 9:16 AM  
**To:** Dimitrios Scarlatos  
**Subject:** RE: WUD10-062R belle glade: Request For Backup Documentation on Good Faith Efforts (Attachment No.3)

Dimitrios,

I have included quotations and email backup documentation showing our companies additional "good faith efforts" to solicit and obtain additional M/WBE participation on this contract.

After reviewing the list of companies on the <https://vendorstrator.dms.myflorida.com/directory> website and searching within the relative vicinity of palm beach county, as well as extending our inquiry to additional mbe/wbe companies whom we routinely do business with we acquired the following list.

Corcel Corp- We received a quotation upon request and will be utilized on this project. We notified Corcel Corp of this project and provided information for them to provide quotation.

Valve Depot- They were also contacted but a quote could not be received in time for bid. Valve Depot will be utilized for purchase of pipe and valve material. They are a WBE.

Worsheim Underground- A quote from this M/WBE company was received for the lift station rehabilitation work portion of this bid. They're quote was not utilized as they were approximately \$200,000 higher than the cost for the work to be performed directly by Hinterland Group, Inc.

LP Video- A quote was received and mistakenly not indicated on bid. M/WBE company will be utilized for Preconstruction Video of project. \$1,475

Birds Eye Video- Received quote. Will not be utilized as LP Video had better pricing and were an M/WBE company. Birds Eye was found to only be County SBE.

Dennis Leavy Assoc.- Solicited and received quote. Will not be utilized as quotation is not competitive and company was found to possess only SBE certification.

Adeimy Concrete- Only concrete company to quote the project. They are an SBE certified company and will be utilized for this project.

Half of this project consisted of cured in place pipe lining (Schedule 2 of bid, which made up 45% of total bid amount), of which there are 3 specified companies listed for use, none of which are M/WBE certified. Therefore, essentially all possible participation of M/WBE came from the remaining \$1,000,000 of the contract for lift station rehabilitation work. Over 46% of this portion of the bid has been contracted with M/WBE firms and will be utilized. This is a specialty work contract with many work items limited to allowable specifications and a select handful of approved products/contractors allowed to supply materials/services to Palm Beach County specification. This aspect placed constraints on the total amount of M/WBE utilization that could be obtained. Despite this, Hinterland Group made

their best effort and took steps to obtain this goal and utilized a substantial portion of the contract that created any opportunity for M/WBE participation.

If you have any further questions or require any further backup, please do not hesitate to contact us.

Thank you,

Daniel Duke  
Hinterland Group



Documentation of Good Faith Efforts  
**DENNIS J. LEAVY & ASSOC.**

LAND SURVEYORS • MAPPERS

February 13, 2012

via Email: [asharpe@hinterlandgroup.com](mailto:asharpe@hinterlandgroup.com)

Ms. Andie Sharpe  
 Hinterland Group, Inc.  
 5580 S.R. 524  
 Cocoa, FL 32926

**RE: PROFESSIONAL LAND SURVEYING SERVICES - BELLE GLADE STRATEGIC  
 WASTEWATER IMPROVEMENTS (DJLA# 12-017-001)**

The following proposal references the project specifications and the civil engineering plans entitled "Construction Plans and Specifications for Glades Utility Authority - Sewer Collection - City of Belle Glade, Palm Beach County, Florida - WUD Project Number 10-062 - EDA Project Number 04-79-06327", dated January 20, 2011, last revised October 31, 2011, Engineer's Project No.60185970, prepared by AECOM Technical Services, Inc., including Addendum No. 1.

Ms. Sharpe:

In response to your request for professional land surveying services, we are pleased to offer the following tasks and their respective fees. This proposal is based upon our review of the above referenced engineering plans and our interpretation of the necessary land surveying services required to successfully construct this project. Based on this approach, our professional fees associated with this project are \$69,960.00. In your review of this proposal you may find tasks that you may not require or you may find there are additional tasks that you do require and we have not addressed. In either event, feel free to contact our office and we will work with you to revise this proposal to accommodate your specific requirements.

**I. HORIZONTAL & VERTICAL CONTROL:**

- A. Establish a secondary horizontal and vertical control network from those reference points provided in the construction plans. It is beyond the scope of this proposal to determine if the survey control shown on the construction plans, as placed by others, is in accordance with those minimum surveying practices as set forth by the Florida Board of Surveyors and Mappers. It is assumed that the other survey firm is a recognized Florida surveying and mapping organization, in good standing, and that they have complied with all requirements for a "Control Survey."

**FEE FOR ABOVE SERVICE:.....\$6,700.00**

**II. SANITARY MANHOLE LOCATIONS:**

- A. Provide "GPS" locations for the upstream and downstream manholes (100) for the joint testing work.
- B. Provide the engineer with the "GPS" locations of the sanitary manholes. This information will be provided as State Plane Coordinates based upon the North American Datum of 1983 on the 1990 Adjustment for the Florida Transverse Mercator - East Zone per Palm Beach Survey Department's Horizontal Control information. This information will be provided in tabular form and will also include the distances between consecutive manholes.

**FEE FOR ABOVE SERVICE:.....\$6,800.00**

**III. LIFT STATION #8104**

**A. ESTABLISH HORIZONTAL & VERTICAL CONTROL:**

- 1.) Locate and verify existing horizontal field survey control (boundary locations) for the layout of the concrete top slab for the Lift Station.
- 2.) We will also obtain the elevation of the existing top slab for the Lift Station prior to construction based upon a vertical datum provided by the engineer.

**B. CONSTRUCTION LAYOUT:**

- 1.) Provide a graded lath at the extreme corners of the concrete slab together with one (1) 5 foot offset hub and tack with graded lath **for concrete top slab construction**. Grades will reference the original elevation of the existing concrete slab prior to construction.

**NOTE:** *Dennis J. Leavy and Associates, Inc. will provide a brass disk for placement by the contractor in the concrete top slab. It is the contractor's responsibility to insure the brass disk is placed flush within the concrete top slab at a location provided by the engineer.*

**C. RECORD DRAWINGS:**

Provide the record engineer with as-built locations of the completed infrastructure. These as-builts will depict:

- 1.) **The structure inverts and rim elevation together with pipe size, length, material composition.**
- 2.) **The horizontal and vertical location of the concrete top slab.**
- 3.) **The horizontal locations of driveways, vault location and electric panel,**

- as required.**
- 4.) Record information will also be provided for **top slab elevation, influent invert elevation, bottom of wet well elevation, high water alarm elevation, standby pump on elevation, the duty pump on elevation and both pump off elevation.**
  - 5.) Provide a **final constructed elevation of the brass disk set in the concrete top slab.**

**As required in the project specifications** we will provide one (1) set of the horizontal above ground locations of the completed infrastructure which will be in a digital format and plotted on 11"x17" sheets at a scale of 1"=10'.

**Also as required in the project specifications** we will provide Record information in a digital format and plotted on a digital copy of the engineering plans which will be provided to the surveyor. A total of ten (10) record drawing 24"x36" prints, one (1) mylar copy at completion of project and an AUTOCAD digital file will be provided under this agreement; additional copies will be provided at a cost of \$5.00 per sheet.

**NOTE:** *A Sketch and Description for the proposed Lift Station Utility Easement is not included within the scope of services in this proposal.*

**FEE FOR ABOVE SERVICES:.....\$6,260.00**

**IV. LIFT STATION #8113**

**A. ESTABLISH HORIZONTAL & VERTICAL CONTROL:**

- 1.) Locate and verify existing horizontal field survey control (boundary locations) for the layout of the concrete top slab for the Lift Station.
- 2.) We will also obtain the elevation of the existing top slab for the Lift Station prior to construction based upon a vertical datum provided by the engineer.

**B. CONSTRUCTION LAYOUT:**

- 1.) Provide a graded lath at the extreme corners of the concrete slab together with one (1) 5 foot offset hub and tack with graded lath **for concrete top slab construction.** Grades will reference the original elevation of the existing concrete slab prior to construction.
- 2.) Provide a lath at the extreme corners of the railroad ties together with one (1) 5 foot offset hub and tack with graded lath **for railroad tie construction.**

**NOTE:** *Dennis J. Leavy and Associates, Inc. will provide a brass disk for placement by the*

*contractor in the concrete top slab. It is the contractor's responsibility to insure the brass disk is placed flush within the concrete top slab at a location provided by the engineer.*

**C. RECORD DRAWINGS:**

Provide the record engineer with as-built locations of the completed infrastructure. These as-builts will depict:

- 1.) The structure inverts and rim elevation together with pipe size, length, material composition.
- 2.) The horizontal and vertical location of the concrete top slab.
- 3.) The horizontal locations of driveways, vault location and electric panel, as required.
- 4.) Record information will also be provided for top slab elevation, influent invert elevation, bottom of wet well elevation, high water alarm elevation, standby pump on elevation, the duty pump on elevation and both pump off elevation.
- 5.) Provide a final constructed elevation of the brass disk set in the concrete top slab.

As required in the project specifications we will provide one (1) set of the horizontal above ground locations of the completed infrastructure which will be in a digital format and plotted on 11"x17" sheets at a scale of 1"=10'.

Also as required in the project specifications we will provide Record information in a digital format and plotted on a digital copy of the engineering plans which will be provided to the surveyor. A total of ten (10) record drawing 24"x36" prints, one (1) mylar copy at completion of project and an AUTOCAD digital file will be provided under this agreement; additional copies will be provided at a cost of \$5.00 per sheet.

**FEE FOR ABOVE SERVICES:.....\$6,380.00**

**V. LIFT STATION #8115**

**A. ESTABLISH HORIZONTAL & VERTICAL CONTROL:**

- 1.) Locate and verify existing horizontal field survey control (boundary locations) for the layout of the concrete top slab for the Lift Station.
- 2.) We will also obtain the elevation of the existing top slab for the Lift Station prior to construction based upon a vertical datum provided by the engineer.

**B. CONSTRUCTION LAYOUT:**

- 1.) Provide a graded lath at the extreme corners of the concrete slab together with one (1) 5 foot offset hub and tack with graded lath **for concrete top slab construction**. Grades will reference the original elevation of the existing concrete slab prior to construction.

**NOTE:** *Dennis J. Leavy and Associates, Inc. will provide a brass disk for placement by the contractor in the concrete top slab. It is the contractor's responsibility to insure the brass disk is placed flush within the concrete top slab at a location provided by the engineer.*

**C. RECORD DRAWINGS:**

Provide the record engineer with as-built locations of the completed infrastructure. These as-builts will depict:

- 1.) The structure inverts and rim elevation together with pipe size, length, material composition.
- 2.) The horizontal and vertical location of the concrete top slab.
- 3.) The horizontal locations of driveways, vault location and electric panel, as required.
- 4.) Record information will also be provided for top slab elevation, influent invert elevation, bottom of wet well elevation, high water alarm elevation, standby pump on elevation, the duty pump on elevation and both pump off elevation.
- 5.) Provide a final constructed elevation of the brass disk set in the concrete top slab.

As required in the project specifications we will provide one (1) set of the horizontal above ground locations of the completed infrastructure which will be in a digital format and plotted on 11"x17" sheets at a scale of 1"=10'.

Also as required in the project specifications we will provide Record information in a digital format and plotted on a digital copy of the engineering plans which will be provided to the surveyor. A total of ten (10) record drawing 24"x36" prints, one (1) mylar copy at completion of project and an AUTOCAD digital file will be provided under this agreement; additional copies will be provided at a cost of \$5.00 per sheet.

**NOTE:** *A Sketch and Description for the proposed Lift Station Utility Easement is not included within the scope of services in this proposal.*

FEE FOR ABOVE SERVICES:.....\$6,260.00

**VI. LIFT STATION #8116**

**A. ESTABLISH HORIZONTAL & VERTICAL CONTROL:**

- 1.) Locate and verify existing horizontal field survey control (boundary locations) for the layout of the concrete top slab for the Lift Station.
- 2.) We will also obtain the elevation of the existing top slab for the Lift Station prior to construction based upon a vertical datum provided by the engineer.

**B. CONSTRUCTION LAYOUT:**

- 1.) Provide a graded lath at the extreme corners of the concrete slab together with one (1) 5 foot offset hub and tack with graded lath **for concrete top slab construction**. Grades will reference the original elevation of the existing concrete slab prior to construction.

**NOTE:**

*Dennis J. Leavy and Associates, Inc. will provide a brass disk for placement by the contractor in the concrete top slab. It is the contractor's responsibility to insure the brass disk is placed flush within the concrete top slab at a location provided by the engineer.*

**C. RECORD DRAWINGS:**

Provide the record engineer with as-built locations of the completed infrastructure. These as-builts will depict:

- 1.) **The structure inverts and rim elevation together with pipe size, length, material composition.**
- 2.) **The horizontal and vertical location of the concrete top slab.**
- 3.) **The horizontal locations of driveways, vault location and electric panel, as required.**
- 4.) **Record information will also be provided for top slab elevation, influent invert elevation, bottom of wet well elevation, high water alarm elevation, standby pump on elevation, the duty pump on elevation and both pump off elevation.**
- 5.) **Provide a final constructed elevation of the brass disk set in the concrete top slab.**

**As required in the project specifications** we will provide one (1) set of the horizontal above ground locations of the completed infrastructure which will be in a digital format and plotted on 11"x17" sheets at a scale of 1"=10'.

**Also as required in the project specifications** we will provide Record information in a digital format and plotted on a digital copy of the engineering plans which will be provided to the surveyor. A total of ten (10) record drawing 24"x36" prints, one (1) mylar copy at completion of project and an AUTOCAD digital file will be provided under this

agreement; additional copies will be provided at a cost of \$5.00 per sheet.

**FEE FOR ABOVE SERVICES:.....\$6,260.00**

**VII. LIFT STATION #8120**

**A. ESTABLISH HORIZONTAL & VERTICAL CONTROL:**

- 1.) Locate and verify existing horizontal field survey control (boundary locations) for the layout of the concrete top slab for the Lift Station.
- 2.) We will also obtain the elevation of the existing top slab for the Lift Station prior to construction based upon a vertical datum provided by the engineer.

**B. CONSTRUCTION LAYOUT:**

- 1.) Provide a graded lath at the extreme corners of the concrete slab together with one (1) 5 foot offset hub and tack with graded lath for concrete top slab construction. Grades will reference the original elevation of the existing concrete slab prior to construction.

**NOTE:** *Dennis J. Leavy and Associates, Inc. will provide a brass disk for placement by the contractor in the concrete top slab. It is the contractor's responsibility to insure the brass disk is placed flush within the concrete top slab at a location provided by the engineer.*

**C. RECORD DRAWINGS:**

Provide the record engineer with as-built locations of the completed infrastructure. These as-builts will depict:

- 1.) The structure inverts and rim elevation together with pipe size, length, material composition.
- 2.) The horizontal and vertical location of the concrete top slab.
- 3.) The horizontal locations of driveways, vault location and electric panel, as required.
- 4.) Record information will also be provided for top slab elevation, influent invert elevation, bottom of wet well elevation, high water alarm elevation, standby pump on elevation, the duty pump on elevation and both pump off elevation.
- 5.) Provide a final constructed elevation of the brass disk set in the concrete top slab.

As required in the project specifications we will provide one (1) set of the horizontal above ground locations of the completed infrastructure which will be in a digital format and plotted on 11"x17" sheets at a scale of

1"=10'.

**Also as required in the project specifications** we will provide Record information in a digital format and plotted on a digital copy of the engineering plans which will be provided to the surveyor. A total of ten (10) record drawing 24"x36" prints, one (1) mylar copy at completion of project and an AUTOCAD digital file will be provided under this agreement; additional copies will be provided at a cost of \$5.00 per sheet.

**NOTE:** *A Sketch and Description for the proposed Lift Station Utility Easement is not included within the scope of services in this proposal.*

**FEE FOR ABOVE SERVICES:.....\$6,260.00**

**VIII. LIFT STATION #8128**

**A. ESTABLISH HORIZONTAL & VERTICAL CONTROL:**

- 1.) Locate and verify existing horizontal field survey control (boundary locations) for the layout of the concrete top slab for the Lift Station.
- 2.) We will also obtain the elevation of the existing top slab for the Lift Station prior to construction based upon a vertical datum provided by the engineer.

**B. CONSTRUCTION LAYOUT:**

- 1.) Provide a graded lath at the extreme corners of the concrete slab together with one (1) 5 foot offset hub and tack with graded lath **for concrete top slab construction**. Grades will reference the original elevation of the existing concrete slab prior to construction.

**NOTE:** *Dennis J. Leavy and Associates, Inc. will provide a brass disk for placement by the contractor in the concrete top slab. It is the contractor's responsibility to insure the brass disk is placed flush within the concrete top slab at a location provided by the engineer.*

**C. RECORD DRAWINGS:**

Provide the record engineer with as-built locations of the completed infrastructure. These as-builts will depict:

- 1.) **The structure inverts and rim elevation together with pipe size, length, material composition.**
- 2.) **The horizontal and vertical location of the concrete top slab.**
- 3.) **The horizontal locations of driveways, vault location and electric panel, as required.**



- 4.) Record information will also be provided for **top slab elevation, influent invert elevation, bottom of wet well elevation, high water alarm elevation, standby pump on elevation, the duty pump on elevation and both pump off elevation.**
- 5.) Provide a **final constructed elevation of the brass disk set in the concrete top slab.**

**As required in the project specifications** we will provide one (1) set of the horizontal above ground locations of the completed infrastructure which will be in a digital format and plotted on **11"x17"** sheets at a scale of **1"=10'**.

**Also as required in the project specifications** we will provide Record information in a digital format and plotted on a digital copy of the engineering plans which will be provided to the surveyor. A total of ten (10) record drawing **24"x36"** prints, one (1) mylar copy at completion of project and an AUTOCAD digital file will be provided under this agreement; additional copies will be provided at a cost of \$5.00 per sheet.

**NOTE:** *A Sketch and Description for the proposed Lift Station Utility Easement is not included within the scope of services in this proposal.*

**FEE FOR ABOVE SERVICES:.....\$6,260.00**

**IX. LIFT STATION #8129**

**A. ESTABLISH HORIZONTAL & VERTICAL CONTROL:**

- 1.) Locate and verify existing horizontal field survey control (boundary locations) for the layout of the concrete top slab for the Lift Station.
- 2.) We will also obtain the elevation of the existing top slab for the Lift Station prior to construction based upon a vertical datum provided by the engineer.

**B. CONSTRUCTION LAYOUT:**

- 1.) Provide a graded lath at the extreme corners of the concrete slab together with one (1) 5 foot offset hub and tack with graded lath **for concrete top slab construction.** Grades will reference the original elevation of the existing concrete slab prior to construction.

**NOTE:** *Dennis J. Leavy and Associates, Inc. will provide a brass disk for placement by the contractor in the concrete top slab. It is the contractor's responsibility to insure the brass disk is placed flush within the concrete top slab at a location provided by the engineer.*

**C. RECORD DRAWINGS:**

Provide the record engineer with as-built locations of the completed infrastructure. These as-builts will depict:

- 1.) The structure inverts and rim elevation together with pipe size, length, material composition.
- 2.) The horizontal and vertical location of the concrete top slab.
- 3.) The horizontal locations of driveways, vault location and electric panel, as required.
- 4.) Record information will also be provided for top slab elevation, influent invert elevation, bottom of wet well elevation, high water alarm elevation, standby pump on elevation, the duty pump on elevation and both pump off elevation.
- 5.) Provide a final constructed elevation of the brass disk set in the concrete top slab.

As required in the project specifications we will provide one (1) set of the horizontal above ground locations of the completed infrastructure which will be in a digital format and plotted on 11"x17" sheets at a scale of 1"=10'.

Also as required in the project specifications we will provide Record information in a digital format and plotted on a digital copy of the engineering plans which will be provided to the surveyor. A total of ten (10) record drawing 24"x36" prints, one (1) mylar copy at completion of project and an AUTOCAD digital file will be provided under this agreement; additional copies will be provided at a cost of \$5.00 per sheet.

**NOTE:** *A Sketch and Description for the proposed Lift Station Utility Easement is not included within the scope of services in this proposal.*

**FEE FOR ABOVE SERVICES:.....\$6,260.00**

**X. LIFT STATION #8133**

**A. ESTABLISH HORIZONTAL & VERTICAL CONTROL:**

- 1.) Locate and verify existing horizontal field survey control (boundary locations) for the layout of the concrete top slab for the Lift Station.
- 2.) We will also obtain the elevation of the existing top slab for the Lift Station prior to construction based upon a vertical datum provided by the engineer.

**B. CONSTRUCTION LAYOUT:**

- 1.) Provide a graded lath at the extreme corners of the concrete slab together

with one (1) 5 foot offset hub and tack with graded lath for concrete top slab construction. Grades will reference the original elevation of the existing concrete slab prior to construction.

**NOTE:** *Dennis J. Leavy and Associates, Inc. will provide a brass disk for placement by the contractor in the concrete top slab. It is the contractor's responsibility to insure the brass disk is placed flush within the concrete top slab at a location provided by the engineer.*

**C. RECORD DRAWINGS:**

Provide the record engineer with as-built locations of the completed infrastructure. These as-builts will depict:

- 1.) The structure inverts and rim elevation together with pipe size, length, material composition.
- 2.) The horizontal and vertical location of the concrete top slab.
- 3.) The horizontal locations of driveways, vault location and electric panel, as required.
- 4.) Record information will also be provided for top slab elevation, influent invert elevation, bottom of wet well elevation, high water alarm elevation, standby pump on elevation, the duty pump on elevation and both pump off elevation.
- 5.) Provide a final constructed elevation of the brass disk set in the concrete top slab.

As required in the project specifications we will provide one (1) set of the horizontal above ground locations of the completed infrastructure which will be in a digital format and plotted on 11"x17" sheets at a scale of 1"=10'.

Also as required in the project specifications we will provide Record information in a digital format and plotted on a digital copy of the engineering plans which will be provided to the surveyor. A total of ten (10) record drawing 24"x36" prints, one (1) mylar copy at completion of project and an AUTOCAD digital file will be provided under this agreement; additional copies will be provided at a cost of \$5.00 per sheet.

**NOTE:** *A Sketch and Description for the proposed Lift Station Utility Easement is not included within the scope of services in this proposal.*

FEE FOR ABOVE SERVICES:.....\$6,260.00

**XI. LIFT STATION #8149**

**A. ESTABLISH HORIZONTAL & VERTICAL CONTROL:**

- 1.) Locate and verify existing horizontal field survey control (boundary locations) for the layout of the concrete top slab for the Lift Station.
- 2.) We will also obtain the elevation of the existing top slab for the Lift Station prior to construction based upon a vertical datum provided by the engineer.

**B. CONSTRUCTION LAYOUT:**

- 1.) Provide a graded lath at the extreme corners of the concrete slab together with one (1) 5 foot offset hub and tack with graded lath **for concrete top slab construction**. Grades will reference the original elevation of the existing concrete slab prior to construction.

**NOTE:**

*Dennis J. Leavy and Associates, Inc. will provide a brass disk for placement by the contractor in the concrete top slab. It is the contractor's responsibility to insure the brass disk is placed flush within the concrete top slab at a location provided by the engineer.*

**C. RECORD DRAWINGS:**

Provide the record engineer with as-built locations of the completed infrastructure. These as-builts will depict:

- 1.) The structure inverts and rim elevation together with pipe size, length, material composition.
- 2.) The horizontal and vertical location of the concrete top slab.
- 3.) The horizontal locations of driveways, vault location and electric panel, as required.
- 4.) Record information will also be provided for top slab elevation, influent invert elevation, bottom of wet well elevation, high water alarm elevation, standby pump on elevation, the duty pump on elevation and both pump off elevation.
- 5.) Provide a final constructed elevation of the brass disk set in the concrete top slab.

**As required in the project specifications** we will provide one (1) set of the horizontal above ground locations of the completed infrastructure which will be in a digital format and plotted on 11"x17" sheets at a scale of 1"=10'.

**Also as required in the project specifications** we will provide Record information in a digital format and plotted on a digital copy of the engineering plans which will be provided to the surveyor. A total of ten (10) record drawing 24"x36" prints, one (1) mylar copy at completion of project and an AUTOCAD digital file will be provided under this agreement; additional copies will be provided at a cost of \$5.00 per sheet.

**NOTE:**

*A Sketch and Description for the proposed Lift Station Utility Easement is not*

February 13, 2012

Strategic Wastewater Infrastructure Sewer Collection - City of Belle Glade (DJLA #12-017-001)

Page 13

*included within the scope of services in this proposal.*

**FEE FOR ABOVE SERVICES:.....\$6,260.00**

**TOTAL FEES FOR PROJECT: .....\$69,960.00**

**It is the contractor's/owner's responsibility to review the scope of services proposed within this contract to insure that the services required to successfully complete this project will be provided.**

February 13, 2012

Strategic Wastewater Infrastructure Sewer Collection - City of Belle Glade (DJLA #12-017-001)

Page 14

Work outside the scope of this proposal will be performed at the below hourly rates or at our current unit price rates:

**Hourly Rates:**

Principle .....	\$140.00/hr
Field Survey crew (truck, conventional survey equipment) .....	\$120.00/hr
Professional land surveyor.....	\$95.00/hr
GPS Robotics .....	\$ 50.00/hr
Computations, research, description composition .....	\$95.00/hr
Computer draftsman .....	\$ 65.00/hr
Secretarial .....	\$ 60.00/hr
Prints .....	\$ 00.75/sf
GPS receivers .....	\$ 50.00/pair

**The above fees are subject to the following conditions:**

1. Orders for construction staking will be requested via fax using a Remote Requisition Form which will be provided to you by our office.
2. Orders for construction staking are to go through our office for scheduling, not through field personnel and require a minimum of forty-eight (48) hours notice.
3. The fees shown herein are for the staking of each item one (1) time only.
4. Two (2) sets of approved plans for each item are to be furnished to our office with CAD disc of same along with one (1) copy of the existing survey of the subject property.
5. All information necessary to build this project must be provided to this firm both digitally and in hard format from the design engineer in a timely fashion.
6. All fees stated herein are based on the site being clear and void of all vegetation and debris, if not, a fee of \$1.00 per linear foot of manually cleared line will be applied to the task being performed. In the event the contractor can supply machinery and labor to clear line, a fee of \$0.50, for supervision, per linear foot of cleared line be applied to the task being performed.

February 13, 2012

Strategic Wastewater Infrastructure Sewer Collection - City of Belle Glade (DJLA #12-017-001)

Page 15

These fees do not include the cost of any governmental agency submittal fee or hard costs for printing, reproductions or fees for full-time construction supervision. Representation before public bodies, review agencies, etc., will be done at applicable hourly rates. This includes, but is not limited to, any administrative processing that may be required for submittal to the various municipal and county agencies. Payment is due upon receipt of the invoice and will be considered delinquent if payment is not received within thirty (30) days of the date of said invoice. A late payment finance charge will be assessed at the rate of 1.5% per month (18% annual percentage) if payment is not received within thirty (30) days of the invoice date.

The obligation to provide services under this agreement may be terminated by either party upon receipt of written notice within seven (7) days in the event of a substantial failure by the other party to perform in accordance with the terms thereof through no fault of the terminating party. In the event of termination, Dennis J. Leavy and Associates, Incorporated shall be paid for all services rendered to the date of termination including all reimbursable expenses and termination expenses. Liability of this contract is limited to not exceed the fees stated herein. Revisions and/or additional services requested outside of this agreement will be invoiced as an addendum to this contract. Fees for revisions and/or additional services will be invoiced based on our current hourly/unit rates.

This agreement, consisting of sixteen (16) pages, represents the entire understanding between **Dennis J. Leavy and Associates, Incorporated** and **Hinterland Group, Inc.**, with respect to the project and may only be modified in writing, signed by all parties.

Thank you for giving us the opportunity to bid this project. We hope to hear from you shortly. If the terms and conditions contained herein are acceptable, please sign and return a copy of this proposal to our office.

Should you have any questions regarding the above, please do not hesitate to contact me.

Sincerely,

DENNIS J. LEAVY & ASSOCIATES, INC.

Gary H. Coe

Digitally signed by Gary H. Coe  
DN: cn=Gary H. Coe, o=Dennis J. Leavy and  
Associates, Inc., ou,  
email=gjleavy@hinterland.com, c=US  
Date: 2012.02.13 13:04:35 -0500

Gary H. Coe, P.S.M.  
Vice President

February 13, 2012

Strategic Wastewater Infrastructure Sewer Collection - City of Belle Glade (DJLA #12-017-001)

Page 16

ACCEPTANCE OF PROPOSAL: The fees, terms and conditions, and specifications contained herein are satisfactory and are hereby accepted. Dennis J. Leavy and Associates, Incorporated is authorized to perform the work as specified.

**RE: PROFESSIONAL LAND SURVEYING SERVICES - BELLE GLADE STRATEGIC WASTEWATER IMPROVEMENTS (DJLA# 12-017-001)**

The following proposal references the project specifications and the civil engineering plans entitled "Construction Plans and Specifications for Glades Utility Authority - Sewer Collection - City of Belle Glade, Palm Beach County, Florida - WUD Project Number 10-062 - EDA Project Number 04-79-06327", dated January 20, 2011, last revised October 31, 2011, Engineer's Project No.60185970, prepared by AECOM Technical Services, Inc., including Addendum No. 1.

**PROPOSAL ACCEPTED BY:**

\_\_\_\_\_  
Name and title

\_\_\_\_\_  
Firm name

\_\_\_\_\_  
Date of acceptance



# CORCEL CORP - ESTABLISHED IN 1990 - DOT M/WDBE CERTIFIED

2461 NW 23 St., Miami, FL 33142 - 305-636-1880 Fx 305-6361897 email: vernie@corcelcorp.com

## Quotation: Belle Glade Sewer Collection Bids 08/15/2012

Item	Description	Size	Qty	Unit	Unit Price	Total
<b>LS 8104 Rehab</b>						
	MJ Long Sleeve C-153 P401 Less Accy's	4"	1	EA	98.00	98.00
	MJ RS OL Gate Valve Less Accy's	4"	1	EA	325.56	325.56
	461S Sewer Valve Box	5-1/4"	1	EA	32.67	32.67
	DIP Joint Restraint Accy Set	4"	4	EA	16.50	66.00
	Flg 90 C-110 P401 Less Accy's	4"	2	EA	145.50	291.00
	Flg x Flg Spool P401	4"x8'	2	EA	483.50	967.00
	316 SS FF Neoprene B&G Set	4"	6	EA	18.66	111.96
<b>Water Service</b>						
	SCH 80 PVC BE Pipe	1-1/2"	100	LF	1.36	136.00
	SCH 80 90 S x S	1-1/2"	1	EA	2.88	2.88
	PVC PJ x PVC PJ L/W Curb Stop	1-1/2"	1	EA	163.94	163.94
	PVC PJ x MIP Adapter	1-1/2"	1	EA	43.53	43.53
	Brass 90	1-1/2"	4	EA	10.47	41.88
	Brass Tee	1-1/2"	1	EA	14.41	14.41
	Brass Solid Plug	1-1/2"	1	EA	4.99	4.99
	Back Flow Device	1-1/2"	1	EA	250.00	250.00
	Brass Nipple	1-1/2"x4"	1	EA	10.26	10.26
	Brass Nipple	1-1/2"x2"	2	EA	5.72	11.44
	Brass Reducing Tee	1-1/2"x3/4"	1	EA	20.27	20.27
	Brass Locking Ball Valve	1-1/2"	1	EA	21.56	21.56
	Brass Part F Camlock	1-1/2"	1	EA	23.67	23.67
	Brass Part DC Camlock Cap	1-1/2"	1	EA	40.64	40.64
<b>LS 8113 Rehab</b>						
	MJ Long Sleeve C-153 P401 Less Accy's	10"	1	EA	284.50	284.50
	MJ RS OL Gate Valve Less Accy's	10"	1	EA	1,030.00	1,030.00
	461S Sewer Valve Box	5-1/4"	1	EA	32.67	32.67
	DIP Joint Restraint Accy Set	10"	4	EA	40.22	160.88
	MJ Tee C-153 P401 Less Accy's	10"x6"	1	EA	327.00	327.00
	MJ RS OL Gate Valve Less Accy's	6"	1	EA	414.44	414.44
	461S Sewer Valve Box	5-1/4"	1	EA	32.67	32.67
	Flg x Pe Spool P401	6"x4'	1	EA	294.50	294.50
	Flg 90 C-110 P401 Less Accy's	6"	1	EA	223.00	223.00
	Cl Companion Flg	6"	1	EA	19.00	19.00
	Aluminum Part F Camlock	6"	1	EA	40.64	40.64
	Aluminum Part DC Camlock Cap	6"	1	EA	71.67	71.67
	MJ RS OL Gate Valve Less Accy's	10"	1	EA	1,030.00	1,030.00
	461S Sewer Valve Box	5-1/4"	1	EA	32.67	32.67
	MJ Tee C-153 P401 Less Accy's	10"x6"	1	EA	327.00	327.00
	MJ 90 C-153 P401 Less Accy's	6"	1	EA	166.00	166.00
	MJ Reducer C-153 P401 Less Accy's	10"x6"	1	EA	234.00	234.00
	Flg RS OL Gate Valve W/Handwheel	6"	2	EA	431.11	862.22
	Flg L/W Check Valve	6"	2	EA	1,277.78	2,555.56
	Flg x Pe Spool P401	6"x5'	2	EA	349.50	699.00

Flg 90 C-110 P401 Less Accy's	6"	2	EA	223.00	446.00
Flg x Flg Spool P401	6"x8'	3	EA	568.50	1,705.50
<b>Guage Assy</b>					
Nylon Coat Dbl SS Strap IP Tapping Saddle	6"x3/4"	2	EA	78.37	156.74
Brass Reducer Bushing	3/4"x1/4"	2	EA	2.20	4.40
Brass Nipple	1/4"x2"	2	EA	1.21	2.42
Brass 45	1/4"	2	EA	2.59	5.18
0-200 Presure Gauge	1/4"x2.5"	2	EA	12.39	24.78
<b>Water Service</b>					
SCH 80 PVC BE Pipe	1-1/2"	100	LF	1.36	136.00
SCH 80 90 S x S	1-1/2"	1	EA	2.88	2.88
PVC PJ x PVC PJ L/W Curb Stop	1-1/2"	1	EA	163.94	163.94
PVC PJ x MIP Adapter	1-1/2"	1	EA	43.53	43.53
Brass 90	1-1/2"	4	EA	10.47	41.88
Brass Tee	1-1/2"	1	EA	14.41	14.41
Brass Solid Plug	1-1/2"	1	EA	4.99	4.99
Back Flow Device	1-1/2"	1	EA	250.00	250.00
Brass Nipple	1-1/2"x4"	1	EA	10.26	10.26
Brass Nipple	1-1/2"x2"	2	EA	5.72	11.44
Brass Reducing Tee	1-1/2"x3/4"	1	EA	20.27	20.27
Brass Locking Ball Valve	1-1/2"	1	EA	21.56	21.56
Brass Part F Camlock	1-1/2"	1	EA	23.67	23.67
Brass Part DC Camlock Cap	1-1/2"	1	EA	40.64	40.64
<b>LS 8115 Rehab</b>					
461S Sewer Valve Box	5-1/4"	1	EA	32.67	32.67
MJ RS OL Gate Valve Less Accy's	6"	2	EA	414.44	828.88
461S Sewer Valve Box	5-1/4"	2	EA	32.67	65.34
MJ Tee C-153 P401 Less Accy's	6"	1	EA	200.50	200.50
MJ Long Sleeve C-153 P401 Less Accy's	6"	1	EA	158.50	158.50
MJ 90 C-153 P401 Less Accy's	6"	1	EA	166.00	166.00
DIP Joint Restraint Accy Set	6"	11	EA	20.00	220.00
Flg x Pe Spool P401	6"x4'	1	EA	294.50	294.50
Flg 90 C-110 P401 Less Accy's	6"	1	EA	223.00	223.00
CI Companion Flg	6"	1	EA	19.00	19.00
Aluminum Part F Camlock	6"	1	EA	82.78	82.78
Aluminum Part DC Camlock Cap	6"	1	EA	71.67	71.67
Flg L/W Check Valve	6"	3	EA	1,277.78	3,833.34
Flg RS OL Gate Valve W/Handwheel	6"	2	EA	431.11	862.22
Flg x Pe Spool P401	6"x5'	2	EA	349.50	699.00
Flg 90 C-110 P401 Less Accy's	6"	2	EA	223.00	446.00
Flg x Flg Spool P401	6"x10'	3	EA	675.50	2,026.50
316 SS FF Neoprene B&G Set	6"	12	EA	29.36	352.32
<b>Guage Assy</b>					
Nylon Coat Dbl SS Strap IP Tapping Saddle	6"x3/4"	2	EA	78.37	156.74
Brass Reducer Bushing	3/4"x1/4"	2	EA	2.20	4.40
Brass Nipple	1/4"x2"	2	EA	1.21	2.42
Brass 45	1/4"	2	EA	2.59	5.18
0-200 Presure Gauge	1/4"x2.5"	2	EA	12.39	24.78
<b>LS 8116 Rehab</b>					
MJ 45 C-153 P401 Less Accy's	4"	2	EA	98.00	196.00
MJ Long Sleeve C-153 P401 Less Accy's	4"	1	EA	98.00	98.00
MJ 90 C-153 P401 Less Accy's	4"	1	EA	106.00	106.00
MJ RS OL Gate Valve Less Accy's	4"	1	EA	325.56	325.56

461S Sewer Valve Box	5-1/4"	1	EA	32.67	32.67
Class 350 Tyton Joint DIP P401	4"	100	LF	31.23	3,123.00
MJ RS OL Gate Valve Less Accy's	4"	2	EA	325.56	651.12
461S Sewer Valve Box	5-1/4"	2	EA	32.67	65.34
MJ Tee C-153 P401 Less Accy's	4"	1	EA	120.50	120.50
MJ 45 C-153 P401 Less Accy's	4"	1	EA	98.00	98.00
Flg x Pe Spool P401	4"x2'	1	EA	161.00	161.00
CI Companion Flg	4"	1	EA	14.80	14.80
Aluminum Part F Camlock	4"	1	EA	39.11	39.11
Aluminum Part DC Camlock Cap	4"	1	EA	29.14	29.14
MJ 90 C-153 P401 Less Accy's	4"	1	EA	106.00	106.00
Flg x Pe Spool P401	4"x5'	2	EA	307.00	614.00
Flg x Flg Spool P401	4"x10'	3	EA	588.50	1,765.50
DIP Joint Restraint Accy Set	4"	15	EA	16.50	247.50
316 SS FF Neoprene B&G Set	4"	12	EA	18.66	223.92
Flg 90 C-110 P401 Less Accy's	4"	2	EA	145.50	291.00

**Water Service**

SCH 80 PVC BE Pipe	1-1/2"	100	LF	1.36	136.00
SCH 80 90 S x S	1-1/2"	1	EA	2.88	2.88
PVC PJ x PVC PJ L/W Curb Stop	1-1/2"	1	EA	163.94	163.94
PVC PJ x MIP Adapter	1-1/2"	1	EA	43.53	43.53
Brass 90	1-1/2"	4	EA	10.47	41.88
Brass Tee	1-1/2"	1	EA	14.41	14.41
Brass Solid Plug	1-1/2"	1	EA	4.99	4.99
Back Flow Device	1-1/2"	1	EA	250.00	250.00
Brass Nipple	1-1/2"x4"	1	EA	10.26	10.26
Brass Nipple	1-1/2"x2"	2	EA	5.72	11.44
Brass Reducing Tee	1-1/2"x3/4"	1	EA	20.27	20.27
Brass Locking Ball Valve	1-1/2"	1	EA	21.56	21.56
Brass Part F Camlock	1-1/2"	1	EA	23.67	23.67
Brass Part DC Camlock Cap	1-1/2"	1	EA	40.64	40.64

**Gauge Assy**

Nylon Coat Dbl SS Strap IP Tapping Saddle	6"x3/4"	2	EA	78.37	156.74
Brass Reducer Bushing	3/4"x1/4"	2	EA	2.20	4.40
Brass Nipple	1/4"x2"	2	EA	1.21	2.42
Brass 45	1/4"	2	EA	2.59	5.18
0-200 Pressure Gauge	1/4"x2.5"	2	EA	12.39	24.78

**LS 8120 Rehab**

MJ 45 C-153 P401 Less Accy's	4"	2	EA	98.00	196.00
MJ Long Sleeve C-153 P401 Less Accy's	4"	1	EA	98.00	98.00
MJ RS OL Gate Valve Less Accy's	4"	1	EA	325.56	325.56
461S Sewer Valve Box	5-1/4"	1	EA	32.67	32.67
MJ Tee C-153 P401 Less Accy's	4"	1	EA	120.50	120.50
MJ RS OL Gate Valve Less Accy's	4"	2	EA	325.56	651.12
461S Sewer Valve Box	5-1/4"	2	EA	32.67	65.34
DIP Joint Restraint Accy Set	4"	15	EA	16.50	247.50
Flg x Pe Spool P401	4"x3'	1	EA	213.00	213.00
CI Companion Flg	4"	1	EA	14.80	14.80
Aluminum Part F Camlock	4"	1	EA	39.11	39.11
Aluminum Part DC Camlock Cap	4"	1	EA	29.14	29.14
Flg RS OL Gate Valve W/Handwheel	4"	2	EA	322.22	644.44
Flg L/W Check Valve	4"	2	EA	950.00	1,900.00
Flg 90 C-110 P401 Less Accy's	4"	2	EA	145.50	291.00

Flg Tee C-110 P401 Less Accy's	4"	2	EA	215.50	431.00
316 SS FF Neoprene B&G Set	4"	12	EA	18.66	223.92
<b>Guage Assy</b>					
Nylon Coat Dbl SS Strap IP Tapping Saddle	4"x34"	2	EA	69.62	139.24
Brass Reducer Bushing	3/4"x1/4"	2	EA	2.20	4.40
Brass Nipple	1/4"x2"	2	EA	1.21	2.42
Brass 45	1/4"	2	EA	2.59	5.18
0-200 Presure Gauge	1/4"x2.5"	2	EA	12.39	24.78
<b>LS 8128 Rehab</b>					
MJ Long Sleeve C-153 P401 Less Accy's	4"	1	EA	98.00	98.00
MJ Tee C-153 P401 Less Accy's	4"	1	EA	120.50	120.50
Flg x Pe Spool P401	4"x3'	1	EA	213.00	213.00
CI Companion Flg	4"	1	EA	14.80	14.80
Aluminum Part F Camlock	4"	1	EA	39.11	39.11
Aluminum Part DC Camlock Cap	4"	1	EA	29.14	29.14
Flg 90 C-110 P401 Less Accy's	4"	1	EA	145.50	145.50
MJ RS OL Gate Valve Less Accy's	4"	1	EA	325.56	325.56
461S Sewer Valve Box	5-1/4"	1	EA	32.67	32.67
MJ Tee C-153 P401 Less Accy's	4"	1	EA	120.50	120.50
MJ 90 C-153 P401 Less Accy's	4"	1	EA	106.00	106.00
Flg RS OL Gate Valve W/Handwheel	4"	2	EA	322.22	644.44
Flg L/W Check Valve	4"	2	EA	950.00	1,900.00
<b>Guage Assy</b>					
Nylon Coat Dbl SS Strap IP Tapping Saddle	4"x34"	2	EA	69.62	139.24
Brass Reducer Bushing	3/4"x1/4"	2	EA	2.20	4.40
Brass Nipple	1/4"x2"	2	EA	1.21	2.42
Brass 45	1/4"	2	EA	2.59	5.18
0-200 Presure Gauge	1/4"x2.5"	2	EA	12.39	24.78
<b>Water Service</b>					
SCH 80 PVC BE Pipe	1-1/2"	100	LF	1.36	136.00
SCH 80 90 S x S	1-1/2"	1	EA	2.88	2.88
PVC PJ x PVC PJ L/W Curb Stop	1-1/2"	1	EA	163.94	163.94
PVC PJ x MIP Adapter	1-1/2"	1	EA	43.53	43.53
Brass 90	1-1/2"	4	EA	10.47	41.88
Brass Tee	1-1/2"	1	EA	14.41	14.41
Brass Solid Plug	1-1/2"	1	EA	4.99	4.99
Back Flow Device	1-1/2"	1	EA	250.00	250.00
Brass Nipple	1-1/2"x4"	1	EA	10.26	10.26
Brass Nipple	1-1/2"x2"	2	EA	5.72	11.44
Brass Reducing Tee	1-1/2"x3/4"	1	EA	20.27	20.27
Brass Locking Ball Valve	1-1/2"	1	EA	21.56	21.56
Brass Part F Camlock	1-1/2"	1	EA	23.67	23.67
Brass Part DC Camlock Cap	1-1/2"	1	EA	40.64	40.64
<b>LS 8133 Rehab</b>					
MJ Long Sleeve C-153 P401 Less Accy's	4"	1	EA	98.00	98.00
MJ 45 C-153 P401 Less Accy's	4"	2	EA	98.00	196.00
MJ 90 C-153 P401 Less Accy's	4"	1	EA	106.00	106.00
MJ RS OL Gate Valve Less Accy's	4"	2	EA	325.56	651.12
461S Sewer Valve Box	5-1/4"	2	EA	32.67	65.34
MJ Tee C-153 P401 Less Accy's	4"	2	EA	120.50	241.00
Flg x Pe Spool P401	4"x3'	1	EA	213.00	213.00
CI Companion Flg	4"	1	EA	14.80	14.80
Aluminum Part F Camlock	4"	1	EA	39.11	39.11

Aluminum Part DC Camlock Cap	4"	1	EA	29.14	29.14
Fig 90 C-110 P401 Less Accy's	4"	1	EA	145.50	145.50
Fig RS OL Gate Valve W/Handwheel	4"	2	EA	322.22	644.44
Fig L/W Check Valve	4"	3	EA	950.00	2,850.00
Fig 90 C-110 P401 Less Accy's	4"	2	EA	145.50	291.00
Fig x Fig Spool P401	4"x6'	2	EA	407.50	815.00
DIP Joint Restraint Accy Set	4"	18	EA	16.50	297.00
316 SS FF Neoprene B&G Set	4"	12	EA	18.66	223.92
<b>Gauge Assy</b>					
Nylon Coat Dbl SS Strap IP Tapping Saddle	4"x34"	2	EA	69.62	139.24
Brass Reducer Bushing	3/4"x1/4"	2	EA	2.20	4.40
Brass Nipple	1/4"x2"	2	EA	1.21	2.42
Brass 45	1/4"	2	EA	2.59	5.18
0-200 Pressure Gauge	1/4"x2.5"	2	EA	12.39	24.78
<b>Water Service</b>					
SCH 80 PVC BE Pipe	1-1/2"	100	LF	1.36	136.00
SCH 80 90 S x S	1-1/2"	1	EA	2.88	2.88
PVC PJ x PVC PJ L/W Curb Stop	1-1/2"	1	EA	163.94	163.94
PVC PJ x MIP Adapter	1-1/2"	1	EA	43.53	43.53
Brass 90	1-1/2"	4	EA	10.47	41.88
Brass Tee	1-1/2"	1	EA	14.41	14.41
Brass Solid Plug	1-1/2"	1	EA	4.99	4.99
Back Flow Device	1-1/2"	1	EA	250.00	250.00
Brass Nipple	1-1/2"x4"	1	EA	10.26	10.26
Brass Nipple	1-1/2"x2"	2	EA	5.72	11.44
Brass Reducing Tee	1-1/2"x3/4"	1	EA	20.27	20.27
Brass Locking Ball Valve	1-1/2"	1	EA	21.56	21.56
Brass Part F Camlock	1-1/2"	1	EA	23.67	23.67
Brass Part DC Camlock Cap	1-1/2"	1	EA	40.64	40.64
<b>LS 8149 Rehab</b>					
MJ Long Sleeve C-153 P401 Less Accy's	4"	1	EA	98.00	98.00
MJ RS OL Gate Valve Less Accy's	4"	1	EA	325.56	325.56
461S Sewer Valve Box	5-1/4"	1	EA	32.67	32.67
MJ RS OL Gate Valve Less Accy's	4"	2	EA	325.56	651.12
461S Sewer Valve Box	5-1/4"	2	EA	32.67	65.34
MJ Tee C-153 P401 Less Accy's	4"	1	EA	120.50	120.50
Fig x Pe Spool P401	4"x3'	1	EA	213.00	213.00
CI Companion Fig	4"	1	EA	14.80	14.80
Aluminum Part F Camlock	4'	1	EA	39.11	39.11
Aluminum Part DC Camlock Cap	4'	1	EA	29.14	29.14
Fig 90 C-110 P401 Less Accy's	4"	1	EA	145.50	145.50
316 SS FF Neoprene B&G Set	4"	17	EA	18.66	317.22
DIP Joint Restraint Accy Set	4"	15	EA	16.50	247.50
Fig RS OL Gate Valve W/Handwheel	4"	2	EA	322.22	644.44
Fig L/W Check Valve	4"	3	EA	950.00	2,850.00
Fig Tee C-110 P401 Less Accy's	4"	1	EA	215.50	215.50
Fig 90 C-110 P401 Less Accy's	4"	2	EA	145.50	291.00
Fig x Fig Spool P401	4"x10'	3	EA	588.50	1,765.50
-					
Nylon Coat Dbl SS Strap IP Tapping Saddle	4"x34"	2	EA	69.62	139.24
Brass Reducer Bushing	3/4"x1/4"	2	EA	2.20	4.40
Brass Nipple	1/4"x2"	2	EA	1.21	2.42
Brass 45	1/4"	2	EA	2.59	5.18

0-200 Pressure Gauge

1/4"x2.5" 2 EA

12.39

24.78

(\*)Total:

61,282.07

***Pricing is valid for 30 days***

***(\*) Prices are based on order for total quantities shown on this quotation. PLUS applicable sales Tax.***

# **LP VIDEO PRODUCTIONS, INC.**

1818 Elsa St., Orlando, FL 32806  
5190 Palm Drive, Melbourne Beach, FL  
Phone 407-896-9727  
Fax 866-702-5438

*M/WBE*

[www.lp-video.com](http://www.lp-video.com) [laurie@lp-video.com](mailto:laurie@lp-video.com)

***Serving the Construction Industry Coast to Coast since 1991!***

---

Attention: Project Estimator

Date: August 13, 2012

## **Quotation for Project:**

**Project:** Strategic Wastewater Infrastructure Project Sewer Collection

**Location:** Belle Glade, FL

**LP Video Productions will provide Pre-Construction HDV video / audio documentation for the proposed project.**

Prior to scheduling the audio / video documentation the contractor should:

- Have a guide to show project route before beginning the documentation and / or have project site surveyed and staked.
- Have a set of plans available for LP Video Productions, Inc.

Note: If job is not staked with survey numbers than the survey numbers will not be included in the written documentation.

LP Video Productions will provide the following:

- Audio / Visual Documentation
- 3 sets of DVD's
- Detailed documentation of video tapes with time code reference
- 3 sets of the written documentation

STATED PRICE LS.... Pre Construction.....\$1,475.00

- ADDITIONAL DVD'S CAN BE SUPPLIED AT A COST OF \$75.00 PER SET

*PLEASE CONTACT Pamela Stimpson at 321-482-0549 if you have questions.*

### REFERENCES AVAILABLE UPON REQUEST

LP VIDEO PRODUCTIONS, INC is a registered W/ MBE -WF with Orange County & the City of Tampa.

This fax is being sent to your company for subcontract work. Your name and company information was supplied by a plan room stating that your company is a contract bidder for the above referenced project. If You have received this fax in error and would like to be taken off our bid list please contact Pamela Stimpson by phone at 321-482-0549. Messages will not be accepted. Pamela must be contacted directly in order for your company to be removed from our list.

# BIRD'S EYE VIEW

## AUDIO VIDEO PRODUCTIONS

*Setting the Standard for 31 Years*

AUGUST 14, 2012

**RE: STRATEGIC WASTEWATER INFRASTRUCTURE SEWER COLLECTION-  
BELLE GLADE-REHAB OF NINE (9) LIFT STATIONS**

BID DATE: 08/15/12

***RECORDED IN HDV (High Definition Video) WITH DETAIL RESOLUTION  
THREE TIMES BETTER THAN SPECIFIED. THE RECORD IS SUPPLIED ON  
DVD TO PLAY ON YOUR COMPUTER.***

Bid specifications may require **PRE**-construction audio video recording. Bird's Eye View Audio Video Productions proposes to offer this **valuable**, ground based recording of pre-existing job site conditions. All around each side of the **NINE (9)** wastewater lift stations there are abundant opportunities for property owner claims of damage during construction. Don't be caught paying for damage that could have been documented as existing prior to construction. This type record will dissuade property owners along the right of way from filing for and receiving compensation for spurious damage claims.

All recording will be foot born and accomplished with the recording system elevated 6' above ground level to insure broad coverage of the zone of construction influence. It will be the prime contractor's responsibility to insure all obstructions to the views captured during recording will be removed prior to the recording session. **Optical Image Stabilization** is an integral part of the recording system and will be utilized to insure "**unwanted image motion**" is reduced to the minimum.

**Above all, our considerable experience providing this type service will provide you with the most complete record of pre-existing job site conditions. We have completed hundreds of projects similar in nature (more than all our competitors combined) and through this experience have gained considerable knowledge as to the areas of importance in a recording of this type. We do not subcontract this service. The owner of Bird's Eye View Audio Video Productions personally produces the AV recording. Unlike our competitors, we have never had a recording rejected by an engineer. Engineer rejection is the least of your worries. Failure to capture the necessary detail of pre-existing defects within zone of construction influence will cost you money.**



**NOTE:** We are NOT wedding or event videographers. We possess the specialized knowledge necessary to record the pre-existing conditions on a construction site.

We will NOT be complying with a spec which requires **continuous** date, time and stationing info to be displayed on the screen upon playback. At this time there are no video recorders available that export this data on the image files with 1080 resolution. This display is possible but at greatly reduced resolution and therefore not recommended. There will be no periodic video display of info such as the project name, contract number, name of street, house address, direction of travel and the viewing side as this would require after the fact editing which is usually strictly prohibited in the specifications.

However, the leader will include contract information and there will be an audio description of pertinent info as mentioned above as well as a complete log to provide easy access to the various portions of the project record.

**As part of our bid price, you will receive three (3) copies of the complete recording on DVD. We will keep the original digital HDV recording in the Bird's Eye View archives for safekeeping. *Still photographic images may be extracted from the original high definition file should the need arise..***

**Additional copies of the record are available at a cost of \$50.00 for each DVD if ordered with the original set. A complete written video log will be supplied to insure quick access to the various project locations shown on the DVD.**

**The LUMP SUM price for performing pre-construction audio video recording of the NINE (9) lift stations will be \$2383.60 including 6% Florida State Sales Tax and FED EX Ground Shipping.**

**FILE: STRATEGIC WASTEWATER INFRASTRUCTURE SEWER COLLECTION-  
BELLE GLADE-REHAB OF NINE (9) LIFT STATIONS**

**KATHY ROBINSON  
CERTIFIED WBE-PALM BEACH COUNTY-SFWMD**

**10906 DENOEU ROAD – BOYNTON BEACH, FLORIDA 33472  
PHONE: 561-732-3250 E-MAIL: BeyeView@aol.com**

**Worsham Underground Utilities, Inc.**  
 1600 5th St.  
 Daytona Beach, FL 32117  
 Phone: (386)255-7387 \* Fax: (386)257-2303  
 Email: pworsham@cfl.rr.com

Date: 08/14/2012

**Submitted To:**  
 Hinterland Group, Inc.  
 5580 State Road 524  
 Cocoa, FL 32926-2492

**Proposal Expires On:**  
 09/13/2012

**Project Description:** Lift Stations

We propose to furnish all materials, labor, and equipment for the work as described below:

Division: 330000 UTILITIES

CSI	Code	Item Description	Quantity	Unit	Unit Price	Ext. Price
333219		Lift Station 8149	1	LS	138,800.00	138,800.00
333219		Lift Station 8133	1	LS	138,800.00	138,800.00
333219		Lift Station 8129	1	LS	135,600.00	135,600.00
333219		Lift Station 8128	1	LS	135,600.00	135,600.00
333219		Lift Station 8120	1	LS	140,600.00	140,600.00
333219		Lift Station 8116	1	LS	128,600.00	128,600.00
333219		Lift Station 8115	1	LS	131,600.00	131,600.00
333219		Lift Station 8113	1	LS	133,600.00	133,600.00
333219		Lift Station 8104	1	LS	126,200.00	126,200.00
<b>Division Total:</b>						<b>1,209,400.00</b>
<b>Total Price</b>						<b>\$1,209,400.00</b>

Exclusions to the above proposal are: Seawall by others.

**Offered By:**

Signature: *Jonathan Worsham Jr.*  
 Name (print): Jonathan Worsham, Jr.  
 Title: President  
 Company: Worsham Underground Utilities, Inc.  
 Date: 8/16/12

**Accepted By:**

Signature: \_\_\_\_\_  
 Name (print): \_\_\_\_\_  
 Title: \_\_\_\_\_  
 Company: \_\_\_\_\_  
 Date: \_\_\_\_\_

Date: August 22, 2012

Asa R. Williams, E.I., Civil Engineer/Project Manager  
 U.S. Department of Commerce  
 Economic Development Administration  
 Atlanta Regional Office  
 401 West Peachtree Street, N.W., Suite 1820  
 Atlanta, Georgia 30308-3510

Re: EDA Award Number: 04-79-06327  
 City, State

Subject: **RECOMMENDED AWARD**

Dear Mr. Williams:

On August 15, 2012, sealed bids for the Wastewater Infrastructure Project Sewer Collection - City of Belle Glade portion of the subject-referenced project were opened in public in the presence of the duly authorized representative. Enclosed please find items requested by the EDA Bid Opening Checklist. The proposed recommended contractor is:

<u>Project Description</u>	<u>Contractor Name</u>	<u>Contract Amount</u>	<u>A/E Estimate</u>
W.I.P. Sewer Collection - City of Belle Glade	Hinterland Group, Inc.	\$1,877,979.00	\$1,800,000.00

We have reviewed the website <http://epls.arnet.gov/> and the recommended firm does not appear on the Federal list of debarred contractors.

Please review the documents, sign below indicating EDA's acceptance, and (*choose one*) email a copy of this letter for our records to our project manager, Dimitrios Scarlatos at [dscarlatos@pbwater.com](mailto:dscarlatos@pbwater.com) (*or*) fax a copy of this letter for our records to (561) 493-6113.

Should you require additional information please contact me at (561) 493-6118.

Sincerely,



Dimitrios Scarlatos  
 Project Designer II, Palm Beach County Water Utilities

c: Greg Vaday, AICP, Economic Development Coordinator

EDA Concurrence:

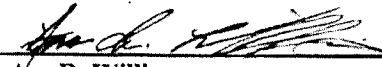
  
 Asa R. Williams  
 Civil Engineer/Project Manager

8/23/12  
 Date

**WUD 10-062R Strategic Wastewater Infrastructure Sewer Collection - City of Belle  
Glade**

**Bid Review Comments**

The four (4) bids received for the Strategic Wastewater Infrastructure Sewer Collection - City of Belle Glade project have been reviewed. The errors, omissions or minor irregularities found in three out of the four bids have been noted below.

**American Infrastructure Technologies Corp.**

1. Boxes for nondiscrimination clause Executive Order 10925, 11114 or 11246 not checked on Bid Form-4.
2. OSBA Letter of Intent - Schedule 2 forms (Bid Form-14) is incomplete. It is missing the General Contractor's name and signature.
3. Trench Safety Affidavit - Attachment No. 5 (Bid Form-18) is incomplete. It is missing the schedule item, cost per linear foot of trench or square feet of shoring and the total cost.

**Hinterland Group, Inc.**

1. OSBA Letter of Intent - Schedule 2 forms (Bid Form-14) is incomplete. Type of minority (i.e., WBE or MBE) not indicated for L&L Worldwide, LLC.
2. List of Major Subcontractors (NON-SBE) - Attachment No.4 is incomplete. License/Certificate number is missing.

**Lanzo Construction Co., Florida**

1. OSBA Letter of Intent - Schedule 2 forms (Bid Form-14) is incomplete. The project number and the General Contractor's name is not filled out.