

**PALM BEACH COUNTY
BOARD OF COUNTY COMMISSIONERS**

AGENDA ITEM SUMMARY

Meeting Date: April 2, 2013	<input checked="" type="checkbox"/> Consent	<input type="checkbox"/> Regular
	<input type="checkbox"/> Workshop	<input type="checkbox"/> Public Hearing

Department:

Submitted By: Engineering and Public Works
Submitted For: Construction Coordination Division

I. EXECUTIVE BRIEF

Motion and Title: Staff recommends motion to approve: Change Order No. 6 in the amount of \$44,677.38 and a 45 day time extension to the construction contract R2012-0674 with AKA Services, Inc. for the Limestone Creek Drive Improvements, Phase IIC project (Project).

SUMMARY: Approval of Change Order No. 6 will compensate for the costs and additional time associated with added drainage and structures along with the connection to and relocation of existing structures per Attachments 2A, B, and C. Per PPM CW-F-050, the threshold to decide approval authority must be calculated by multiplying the number of days by the daily delay charge and actual cost. This total of \$108,712.38 puts Change Order Number 6 over the threshold requiring Board approval.

District 1 (MRE)

Background and Justification: During construction it was determined that existing residential driveways on Limestone Creek Road prohibited proper grading of swales and additional drainage was necessary to provide collection of storm water.

Attachments:

1. Location Sketch
2. Change Order No. 6 w/Attachments "A", "B" and "C"
3. Change Order History
4. Schedule 1

Recommended By: _____

Division Director

3-13-13

Date

Approved By: _____

County Engineer

3/18/13

Date

II. FISCAL IMPACT ANALYSIS

A. Five Year Summary of Fiscal Impact:

Fiscal Years	2013	2014	2015	2016	2017
Capital Expenditures	<u>\$44,678</u>	<u>-0-</u>	<u>-0-</u>	<u>-0-</u>	<u>-0-</u>
Operating Costs	<u>-0-</u>	<u>-0-</u>	<u>-0-</u>	<u>-0-</u>	<u>-0-</u>
External Revenues	<u>-0-</u>	<u>-0-</u>	<u>-0-</u>	<u>-0-</u>	<u>-0-</u>
Program Income (County)	<u>-0-</u>	<u>-0-</u>	<u>-0-</u>	<u>-0-</u>	<u>-0-</u>
In-Kind Match (County)	<u>-0-</u>	<u>-0-</u>	<u>-0-</u>	<u>-0-</u>	<u>-0-</u>
NET FISCAL IMPACT	<u>\$44,678</u>	<u>-0-</u>	<u>-0-</u>	<u>-0-</u>	<u>-0-</u>
# ADDITIONAL FTE					
POSITIONS (Cumulative)					

Is Item Included in Current Budget? Yes X No

Budget Account No:

Fund 3900 Dept 361 Unit 1374 Object 6551

Recommended Sources of Funds/Summary of Fiscal Impact:

Capital Outlay Fund

Limestone Creek Drainage Phase IIC

Change Order #6

\$44,677.38

C. Departmental Fiscal Review: Abrell-Hite

III. REVIEW COMMENTS

A. OFMB Fiscal and/or Contract Dev. and Control Comments:

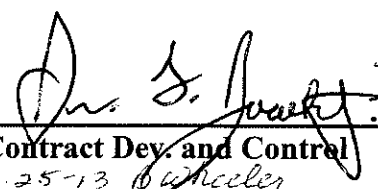
 _____ OFMB 3/14/2013 3/12/13 3/18	 _____ Contract Dev. and Control 3-25-13 10 Wheeler 3/25/13
---	---

B. Approved as to Form and Legal Sufficiency:



Assistant County Attorney
2/26/13

C. Other Department Review:

Department Director

This summary is not to be used as a basis for payment.

PROJECT LOCATION
LIMESTONE CREEK DRAINAGE
IMPROVEMENTS PHASE IIC
PROJECT NO. 2011056

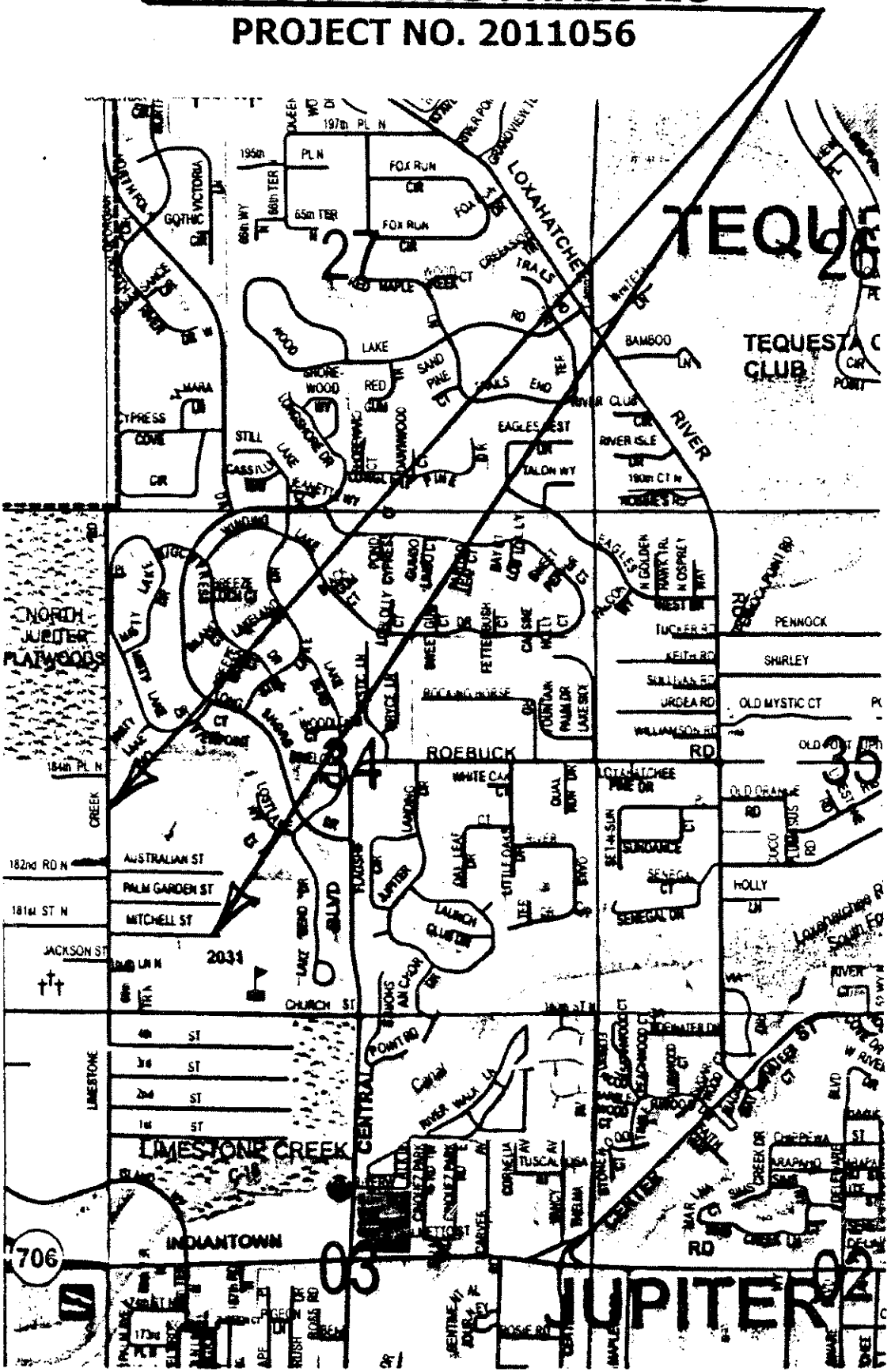

LOCATION SKETCH

CHANGE ORDER

ORIGINAL

Attachment #2

Owner Initiated
☒ Differing Site Conditions
Zoning/Code/Ordinance Changes
Errors/Omissions/In Design
Quantity Overruns/Underruns
Request By Another Agency/Outside Party
A. Reimbursable B. Non-Reimbursable
Other:

PROJECT: LIMESTONE CREEK DRIVE IMPROVEMENTS, PHASE IIC
(Name)
TO:
(Contractor) AKA Services, Inc.
CHANGE ORDER NO: 6 (six)
COUNTY PROJECT NO: 2011056
CONTRACT DATE: 05/15/12
RESOLUTION NO: R2012-0674
DISTRICT NO: 1

You are directed to make the following changes in this Contract:

Limestone Creek Road

- | | |
|--|------------------------------------|
| 1. Core existing drainage structures to connect additional pipe, | 9 @ \$865.21 = \$ 7,786.89 |
| 2. Relocate existing drainage structures, | 2 @ \$1,713.76 = \$ 3,427.52 |
| 3. Install 7 yard drains and 585 L.F. of 12" PVC pipe, | 1 L.S. @ \$27,013.36 = \$27,013.36 |
| 4. Install mitered end sections on existing drainage pipe, | 3 @ \$696.56 = \$ 2,089.68 |
| 5. Additional survey work for additional drainage, | 1 L.S. @ \$4,359.93 = \$ 4,359.93 |

Total \$44,677.38

Attachment 'A' – Contractor proposal and backup
Attachment 'B' – Roadway production concurrence
Attachment 'C' – Locations of drainage modifications

3-11-13
[Signature]

The original Contract Sum was.	\$1,265,492.00
Net change by previous Change Orders.	\$ 28,774.98
The Contract Sum prior to this Change Order was	\$1,294,266.98
The Contract Sum will be increased by this Change Order	\$ 44,677.38
The new Contract Sum including this Change Order will be	\$1,338,944.36
The Contract Time will be increased by	(45) Days
The Date of Completion as of the date of this Change Order therefore is	March 1, 2013

EXECUTION OF THIS CHANGE ORDER ACKNOWLEDGES FINAL SETTLEMENT OF, AND RELEASES ALL CLAIMS FOR, COSTS AND TIME ASSOCIATED, DIRECTLY OR INDIRECTLY, WITH THE ABOVE-STAIED MODIFICATION(S). INCLUDING ALL CLAIMS FOR CUMULATIVE DELAYS OR DISRUPTIONS RESULTING FROM, CAUSED BY, OR INCIDENT TO, SUCH MODIFICATION(S), AND INCLUDING ANY CLAIM THAT THE ABOVE-STAIED MODIFICATION(S) CONSTITUTES, IN WHOLE OR PART, A CARDINAL CHANGE TO THE CONTRACT.

ENGINEER (If Applicable)	AKA Services, Inc. CONTRACTOR 15551 Okeechobee Boulevard Address Loxahatchee, FL 33470	P.B.Co. Board of County Commissioners OWNER P.O. Box 21229 Address West Palm Beach, FL 33416-1229
BY	BY <i>[Signature]</i>	BY
DATE	DATE 2/11/2013	DATE

AKA Services, Inc.
15551 Okcechobee Blvd.
Loxahatchee, Florida 33470
Phone (561) 791-7561 Fax (561) 791-7565

January 21, 2013

Steve O'Neil
Construction Coordination Division
Palm Beach County Engineering and Public Works
PO Box 21229
West Palm Beach, FL 33416

Re: Limestone Creek Drainage Phase IIC – Limestone Creek Rd. Change Orders

Attached please find the backup information for the additional work requested on Limestone Creek Road. Please keep in mind that the days requested for each change order not only include the days necessary to perform the additional work, but also the time we were delayed while waiting for direction from the County after we issued the RFIs, as well as the time to order and receive the necessary materials. Additionally, more days will be necessary if the change order for this work is not issued in a timely manner.

- **Total Price: \$44,677.38**
- **Total Additional Days: 51 45 16**

Please let us know if you have any questions or comments.

Sincerely,
AKA Services, Inc.

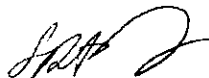

Stephen Fowler, P.E.

DESCRIPTION:

Limestone Creek Drainage Phase II C - Core Existing Structure Change Order 13

Item Description	Quantity	Labor	Equipment	Materials	Subcontract Work	Total
Core Existing Structure	9 Each	467.81	\$ 42.12	\$ 265.00	\$ -	\$ 774.93
	Totals	\$ 4,210.29	\$ 379.08	\$ 2,385.00	\$ -	\$ 6,974.37
Total Work AKA Services Inc.						\$ 6,974.37
Contractor's Fee Per Contract Section - 10%						\$ 697.44
Subtotal "A"						\$ 7,671.81
Total Work Subcontractors						\$ -
Contractor's Fee Per Contract Section - 10.0%						\$ -
Subtotal "B"						\$ -
Total Cost A+B						\$ 7,671.81
Bond Cost 1.50%						\$ 115.08
Total Change Order Amount						\$ 7,786.89
Total Change Order Day(s)						7

DESCRIPTION

Limestone Creek Drainage Phase II C - Change Order 14

Item Description	Quantity	Labor	Equipment	Materials	Subcontract Work	Total
Relocate Existing Structures	2 Each	587.72	\$ 947.22	\$ -	\$ -	\$ 1,534.94
	Totals	\$ 1,175.44	\$ 1,894.44	\$ -	\$ -	\$ 3,069.88
Total Work AKA Services Inc.						\$ 3,069.88
Contractor's Fee Per Contract Section - 10%						\$ 306.99
Subtotal "A"						\$ 3,376.87
Total Work Subcontractors						\$ -
Contractor's Fee Per Contract Section - 10.0%						\$ -
Subtotal "B"						\$ -
Total Cost A+B						\$ 3,376.87
Bond Cost 1.50%						\$ 50.65
Total Change Order Amount						\$ 3,427.52
Total Change Order Day(s)						4

DESCRIPTION:

Limestone Creek Drainage Phase II C - Change Order 15

Item Description	Quantity	Labor	Equipment	Materials	Subcontract Work	Total
Yard Drains (585' 12" PVC, 7 inlets)	1 LS	6,435.44	\$ 7,543.50	\$ 10,215.74	\$ -	\$ 24,194.68
	Totals	\$ 6,435.44	\$ 7,543.50	\$ 10,215.74	\$ -	\$ 24,194.68
Total Work AKA Services Inc.						\$ 24,194.68
Contractor's Fee Per Contract Section - 10%						\$ 2,419.47
Subtotal "A"						\$ 26,614.15
Total Work Subcontractors						\$ -
Contractor's Fee Per Contract Section - 10.0%						\$ -
Subtotal "B"						\$ -
Total Cost A+B						\$ 26,614.15
Bond Cost 1.50%						\$ 399.21
Total Change Order Amount						\$ 27,013.36
Total Change Order Day(s)						21

DESCRIPTION:

Limestone Creek Drainage Phase II C - Change Order 16

Item Description	Quantity	Labor	Equipment	Materials	Subcontract Work	Total
MES	3 EA	330.80	\$ 28.08	\$ 265.00	\$ -	\$ 623.88
	Totals	\$ 992.40	\$ 84.24	\$ 795.00	\$ -	\$ 1,871.64
Total Work AKA Services Inc.						\$ 1,871.64
Contractor's Fee Per Contract Section - 10%						\$ 187.16
Subtotal "A"						\$ 2,058.80
Total Work Subcontractors						\$ -
Contractor's Fee Per Contract Section - 10.0%						\$ -
Subtotal "B"						\$ -
Total Cost A+B						\$ 2,058.80
Bond Cost 1.50%						\$ 30.88
Total Change Order Amount						\$ 2,089.68
Total Change Order Day(s)						5

DESCRIPTION:

Limestone Creek Drainage Phase II C - Change Order 17

Item Description	Quantity	Labor	Equipment	Materials	Subcontract Work	Total
Additional Survey work on Limestone Creek Rd.: Stake out 1 additional Type C inlet and asbuilt 11 additional structures (7 yard drains, 2 new Type C inlets and 2 relocated Type C inlets)	1 LS	-	\$ -	\$ -	\$ -	\$ -
	Totals	\$ -	\$ -	\$ -	\$ -	\$ -
	Total Work AKA Services Inc.					\$ -
	Contractor's Fee Per Contract Section - 10%					\$ -
	Subtotal "A"					\$ -
	Total Work Subcontractors					\$ 3,905.00
	Contractor's Fee Per Contract Section - 10.0%					\$ 390.50
	Subtotal "B"					\$ 4,295.50
	Total Cost A+B					\$ 4,295.50
	Bond Cost 1.50%					\$ 64.43
Total Change Order Amount \$ 4,359.93						
Total Change Order Day(s) 14						

Attachment #2
"A" Page 6 of 7

Additional Survey Work on Limestone Creek

Calculate and stake additional structures	\$ 406.25
Calculate and stake new C inlet near Church	\$ 215.00
Calculate and stake 7 yard drains and MESs	\$1,540.00
Asbuilt 11 additional structures	\$1,743.75
	<hr/>
	\$3,905.00

Additional Survey Work on Mitchell Street

Restake subgrade per first revision	\$1,425.20
Restake subgrade per second revision	\$1,425.20
Calc, stake, and asbuilt new structure	\$ 355.00
	<hr/>
	\$3,205.40

Stephen O'Neil

From: Charles Rich
Sent: Monday, January 28, 2013 11:03 AM
To: Stephen O'Neil
Subject: FW: Limestone Creek Drainage Project Change Orders
Attachments: Mitchell COs.pdf; Limestone COs.pdf

Steve:

After meeting with you to review the above Change Orders, I am in agreement with the associated costs. As discussed, the additional days they have requested could be reduced, especially the survey time.

Charlie

From: Stephen O'Neil
Sent: Tuesday, January 22, 2013 9:32 AM
To: Charles Rich; Mark Tomlinson
Subject: FW: Limestone Creek Drainage Project Change Orders

Charlie,

For your review.

I am in the process of reviewing these 2 change order requests.

Thank You,
Steve

Stephen O'Neil
Chief Construction Coordinator
Palm Beach County Department of Engineering & Public Works
Construction Coordination Division

Office 561-684-4180
Cellular 561-267-0015
soneil@pbcgov.org

From: Stephen Fowler [<mailto:stephen.fowler@akaservicesinc.com>]
Sent: Monday, January 21, 2013 3:33 PM
To: Stephen O'Neil; Mark Tomlinson
Cc: 'Tom Richardson'; akaservices@bellsouth.net; 'Mario Basile'; 'F. Martin Perry'
Subject: Limestone Creek Drainage Project Change Orders

Good Afternoon Steve,

Attached please find the Change Orders that we discussed at our meeting last Thursday morning. The only items not included in the change orders are the two additional Type C inlets on Limestone Creek, as there is already a line item in the contract for them. If you would like me to include them in the change order for Limestone, please let me know and I will revise it.

Best Regards,

Limestone Creek Drainage Phase IIC

Project No. 2011056

Change Order No. 6 Limestone Creek Road

1. Core existing structures at nine (9) locations:
 - a. Sta. 24+56, S-22
 - b. Sta. 26+35, S-20A, north
 - c. Sta. 26+35, S-20A, south
 - d. Sta. 36+65, S-3B
 - e. Sta. 29+90, S-14B
 - f. Sta. 43+60, S-1A
 - g. Sta. 43+60, S-1B
 - h. Sta. 21+26, S-23B
 - i. Sta. 34+74, S-7
2. Relocate two (2) existing drainage structures:
 - a. Sta. 34+50, connect to S-7
 - b. Sta. 24+56, connect to S-22
3. Install yard drains and connect to existing inlets at six (6) locations:
 - a. Sta. 26+35, 20' RT
 - b. Sta. 27+46, 20' RT
 - c. Sta. 29+50, LT
 - d. Sta. 42+15, LT
 - e. Sta. 44+10, RT
 - f. Sta. 44+50, RT
 - g. Sta. 45+00, RT
4. Install mitered end sections drainage pipe at three (3) locations:
 - a. Sta. 35+10, south end of existing 24" RCP
 - b. Sta. 27+00, south of driveway for address 18225/18227 Limestone Creek Rd.
 - c. Sta. 28+00, north of driveway for address 18225/18227 Limestone Creek Rd.
5. Additional survey work per attached breakdown

ATTACHMENT 'C'

CHANGE ORDER HISTORY

PALM BEACH COUNTY PROJECT Limestone Creek Drive Improvements, Phase IIC; Project No. 2011056

C.O. #	DATE APPROVED	COUNTY ENGINEER		C.R. COMMITTEE		TOTAL DEPT. & C.R. APPROVALS		BOARD OF CO. COMM.	
		AMOUNT	TIME	AMOUNT	TIME	AMOUNT	TIME	AMOUNT	TIME
1	10/2/2012	7,325.00	2						
2	10/16/2012	0.00	9						
3	12/5/2012	17,399.98	5						
4	12/19/2012			0.00	70				
5	pending	4,050.00	10						
	TOTAL	28,774.98	26	0.00	70	28,774.98	96		
	CUMULATIVE TOTAL	28,774.98	26	0.00	70	28,774.98	96		
	As of PPM CW-F-050 Dated February 27, 2012	SINGLE AMT. \$50,000.00 MAX. AMT. \$250,000.00 or 5% of contract	MAX. TIME 30 DAYS	SINGLE AMT. \$100,000.00 MAX. AMT. \$250,000.00 or 5% of contract	MAX. TIME 90 DAYS	MAXIMUM CUMULATIVE CO. ENG. & C.R. COMM. \$250,000.00 or 5% of contract	MAX. CUM. CO.ENG.&C.R. 120 DAYS		

SCHEDULE 1

LIST OF PROPOSED SBE-M/WBE SUBCONTRACTORS

PROJECT NAME Limestone Creek PROJECT NO. 2011056
NAME OF PRIME BIDDER: AKA Services, Inc.
ADDRESS: _____
CONTACT PERSON: _____ PHONE NO: _____ FAX NO: _____
BID DATE: _____ DEPARTMENT: _____

PLEASE IDENTIFY ALL APPLICABLE CATEGORIES OF SUBCONTRACTORS

Name, Address and Phone Number	(Check one or both Categories)		Dollar Amount				
	Minority Business	Small Business	Small	Black	Hispanic	Women	Other (Please Specify)
1.	<input type="checkbox"/>	<input type="checkbox"/>	\$ _____	\$ _____	\$ _____	\$ _____	\$ _____
2.	<input type="checkbox"/>	<input type="checkbox"/>	\$ _____	\$ _____	\$ _____	\$ _____	\$ _____
3.	<input type="checkbox"/>	<input type="checkbox"/>	\$ _____	\$ _____	\$ _____	\$ _____	\$ _____
4.	<input type="checkbox"/>	<input type="checkbox"/>	\$ _____	\$ _____	\$ _____	\$ _____	\$ _____
5.	<input type="checkbox"/>	<input type="checkbox"/>	\$ _____	\$ _____	\$ _____	\$ _____	\$ _____
Total			\$ _____	\$ _____	\$ _____	\$ _____	\$ _____

(Please use additional sheets if necessary, _____)

Total Bid Price \$ 44,677.38 Total Value of SBE Participation \$ NA

- NOTE:
- 1. The amounts listed on this form must be supported by the Subcontractors prices included on Schedule 2 in order to be counted toward goal attainment.
 - 2. Firms may be certified by Palm Beach County as an SBE and/or M/WBE. If firms are certified as both an SBE and M/WBE, please indicate the dollar amount under the appropriate category.
 - 3. M/WBE information is being collected for tracking purposes only.