

PALM BEACH COUNTY BOARD OF COUNTY COMMISSIONERS AGENDA ITEM SUMMARY

[X] Consent

[] Workshop

Department: Facilities Development & Operations

I. EXECUTIVE BRIEF

Motion and Title: Staff recommends motion to approve:

A) Consultant Services Authorization (CSA) No. 8 to the contract with Leo A. Daly Company (R2011-0112) in the amount of \$349,602 to provide architectural/engineering design services for a new Library Annex to be located on Cherry Road in West Palm Beach; and

B) A budget transfer in the amount of \$614,602 in the Library Impact Fees Fund from the Reserves to the Annex capital project.

Summary: Since 1999, the County on behalf of the Library Department has leased space within the Mil-Lake Plaza located on Lake Worth Road in Greenacres. On November 20, 2012, the Board approved a final renewal option to extend the lease to March 31, 2015. This CSA will provide design services for a stand-alone facility to meet the Library Department needs to replace the existing leased space. These services will include the architectural and structural design with mechanical and electrical, parking, landscaping, irrigation and site lighting. Leo A. Daly Company has a continuing services contract for architectural services which provides for a Small Business Enterprise (SBE) participation goal of 32% SBE, 12% M/WBE. The participation on this CSA is 39.5% SBE, 14.0% M/WBE. When added to the consultant's participation to date, the SBE participation is 28.2%, M/WBE participation is 6.6%. Leo A. Daly Company is a Palm Beach County firm using all Palm Beach County subconsultants. The estimated construction cost is \$3,500,000 and will be funded from Library Impact Fees. (Capital Improvements Division) District 7 (JM)

Background and Justification: On July 27, 1999, the Board approved the initial lease agreement for a period of six years with two options to extend each for one year. The Board approved to exercise each of these options. On January 15, 2008, the Board approved Amendment No. 1 extending the term for 3 years and for two options to extend each for two years. On November 20, 2012, the Board approved the final renewal option to March 31, 2015. The County does not currently have any County-owned space available for the Library Department's use. The Library Annex provides for acquisition, preparation, and storage of library materials, as well as the Outreach Services Section which includes talking books, books by mail, the bookmobile, and the volunteer literacy tutoring program. The space requirements for this facility will be approximately 30,000 sf.

Attachments:

1. Location Map
2. Budget Availability Statement
3. CSA No. 8
4. Budget Transfer

3/21/12
Date

County Administrator

4/5/13
Date

II. FISCAL IMPACT ANALYSIS

A. Five Year Summary of Fiscal Impact:

Fiscal Years	2013	2014	2015	2016	2017
Capital Expenditures	<u>\$614,602</u>	<u>0</u>	<u>0</u>	<u>0</u>	<u>0</u>
Operating Costs	<u>0</u>	<u>0</u>	<u>0</u>	<u>0</u>	<u>0</u>
External Revenues	<u>0</u>	<u>0</u>	<u>0</u>	<u>0</u>	<u>0</u>
Program Income (County)	<u>0</u>	<u>0</u>	<u>0</u>	<u>0</u>	<u>0</u>
In-Kind Match (County)	<u>0</u>	<u>0</u>	<u>0</u>	<u>0</u>	<u>0</u>
NET FISCAL IMPACT	<u>\$614,602</u>				
# ADDITIONAL FTE					
POSITIONS (Cumulative)					

Is Item Included in Current Budget? Yes X No

Budget Account No: Fund 3752 Dept 321 Unit L066 Object 6502 Reporting Category
Fund 3752 Dept 321 Unit L066 Object 6505 Reporting Category

Architectural/Engineering Services	\$349,602
Staff Costs	\$100,000
Misc. (Permits & Pre-Construction Costs)	<u>\$165,000</u>
Total	\$614,602

B. Recommended Sources of Funds/Summary of Fiscal Impact:

Library Impact Fees.

C. Departmental Fiscal Review: *4/9 3/19/13*

III. REVIEW COMMENTS:

A. OFMB Fiscal and/or Contract Development and Control Comments:

 3/25/2013
OFMB *cc 3/25/13 3/25/13 3/25/13*

 4/2/13
Contract Administrator
4-2-13 B.W. Haskin

B. Legal Sufficiency:

 4/2/13
Assistant County Attorney

C. Other Department Review:

Department Director

**FACILITIES DEVELOPMENT & OPERATIONS
BUDGET AVAILABILITY STATEMENT**

REQUEST DATE: 03/01/13 REQUESTED BY: Mike McPherson PHONE: 233-0278
FAX: 233-0270

PROJECT TITLE: Library Annex

PROJECT NO.: 13201

ORIGINAL CONTRACT AMOUNT: NA – Annual Architect

BCC RESOLUTION#: R-2011-0112
DATE: 2/01/2011

REQUESTED AMOUNT: \$449,602

CSA or CHANGE ORDER NUMBER: CSA #8

CONSULTANT/CONTRACTOR: Leo A. Daly Company

PROVIDE A BRIEF STATEMENT OF THE SCOPE OF SERVICES TO BE PROVIDED BY THE
CONSULTANT/CONTRACTOR:

Architectural/Engineering Services for Design of New Facility

CONSTRUCTION

PROFESSIONAL SERVICES

STAFF COSTS** (Design/Construction Phase)

MISC. (permits, prints, advertising)

TOTAL

\$349,602

\$100,000

\$449,602

*** This is an estimate of staff charges. Actual(s) will be billed at the end of each fiscal year. If this BAS is for construction costs of \$250,000 or greater, staff charges will be billed as actual and reconciled at the end of the project.*

BUDGET ACCOUNT NUMBER (IF KNOWN)

FUND: 3752 DEPT: 321 UNIT: L066 OBJ: 6505

FUNDING SOURCE (CHECK ALL THAT APPLY):

☐ AD VALOREM ☐ OTHER

☐ FEDERAL/DAVIS BACON

SUBJECT TO IG FEE? ☐ YES ☐ NO

BAS APPROVED BY: _____

DATE: 3/18/2013

ENCUMBRANCE NUMBER: _____

CONSULTANT SERVICES AUTHORIZATION

LEO A. DALY COMPANY
Annual Architectural Consultant

**LIBRARY ANNEX
PROJECT NO. 13201
DISTRICT NO. 2**

THIS AUTHORIZATION NO. 8 to the Contract dated 02/01/2011 (R-2011-0112) between Palm Beach County and the Consultant identified herein is for the Consultant Services described in Item 3 of this Authorization.

1. **CONSULTANT:** LEO A. DALY COMPANY
2. **History:** Not applicable. This authorization is for a new project.
3. **Services completed to date:** Not applicable. This authorization is for a new project.
4. **Description of Services to be provided by Consultant:** Professional services shall include architectural and engineering design services as detailed on the attached proposal dated February 25, 2013.
5. **Compensation:** The compensation to be paid to the Consultant for the requested services shall be:

Lump Sum charge of \$349,602

6. **This Authorization may be terminated by the County without cause or prior notice. In the event of termination not the fault of the Consultant, the Consultant shall be compensated for all services performed to termination date, together with reimbursable expenses (if applicable) then due.**

Consultant agrees to waive any and all claims for lost profits or anticipated future profits in the event of a termination with or without the cause under this Contract.

7. If not previously provided or for a new project, the Consultant shall provide County with an executed Conflict of Interest Disclosure Form, attached hereto and incorporated herein.
8. **EXCEPT AS HEREBY AMENDED, CHANGED OR MODIFIED,** all other terms, conditions, and obligations of the original Contract shall remain in full force and effect.

9. **Time of Commencement:** Consultant shall begin work promptly on the requested services upon receipt of this executed document which shall constitute official "Notice to Proceed".

IN WITNESS WHEREOF, this Authorization is accepted, subject to the terms and conditions of the aforementioned Contract.

ATTEST:
SHARON R. BOCK, CLERK &
COMPTROLLER

PALM BEACH COUNTY BOARD, FLORIDA
Political Subdivision of the State of Florida
BOARD OF COUNTY COMMISSIONERS

By: _____
Deputy Clerk

By: _____
Steven L. Abrams, Mayor

APPROVED AS TO FORM
AND LEGAL SUFFICIENCY

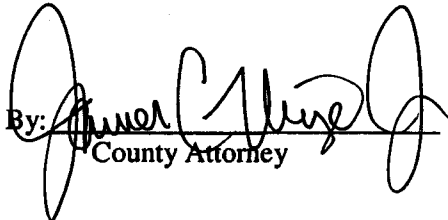
By: 
County Attorney

APPROVED AS TO TERMS
AND CONDITIONS

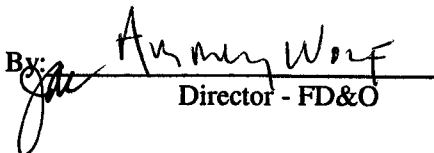
By: 
Director - FD&O

WITNESS:

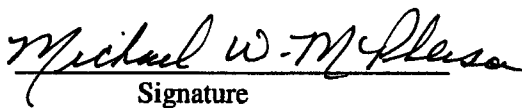
Signature

MICHAEL W. MCPHERSON
Name (type or print)

CONSULTANT:

Signature

PAUL TWITTY
Name (type or print)

PRINCIPAL
Title

(Corporate Seal)

LEO A DALY

PLANNING
ARCHITECTURE
ENGINEERING
INTERIORS



EST. 1915

ABU DHABI
ATLANTA
AUSTIN
BEIJING
BENGHAZI
BRYAN
CHICAGO
DALLAS
DENVER
FORT WORTH
HONG KONG
HONOLULU
HOUSTON
ISTANBUL
LAS VEGAS
LOS ANGELES
MIAMI
MINNEAPOLIS
MOSCOW
OMAHA
PHOENIX
SACRAMENTO
SAN ANTONIO
SAN MARCOS
TAMPA
TRIPOLI
WACO
WASHINGTON, DC
WEST PALM BEACH

February 25, 2013 - Revised
February 6, 2013

Mr. Mike McPherson
Project Manager
Capital Improvements Division
2633 Vista Parkway
West Palm Beach, FL 33411

Re: LIBRARY ANNEX
Palm Beach County
West Palm Beach, Florida
PBC Project #13201

Dear Mike:

LEO A DALY is pleased to present this proposal to provide professional services for the proposed Library Annex. This letter will serve as an Agreement between Palm Beach County Capital Improvements Division (Client) and the LEO A DALY Company (Design Architect) for professional services to be performed for you.

SCOPE OF SERVICES

The scope of the project shall include Architectural, Landscape Architecture, Geotechnical, Civil, Structural, Mechanical, Electrical & Plumbing Engineering Services for the proposed one-story, 30,000 gsf Library Annex along with one (1) depressed loading dock and a fenced bookmobile storage area to be located at the PBC Cherry Road site identified on Attachment A. The exact, final location of the Library Annex on the site is to be determined as part of the Schematic Design Phase.

The scope of work also includes Civil Engineering Services for the off-site left turn lane on Cherry Street as outlined in Attachment B.

The proposed scope of work shall include the following:

A. ARCHITECTURAL SERVICES

1. Program verification
2. Architectural floor plans, elevations, **sections, schedules, details & specifications**
3. Coordination of Architect / Consultant work
4. Coordination meetings between PBC and Design Team
5. Respond to PBC's review comments
6. Bidding assistance
7. Permitting
8. Construction administration

Florida License
No. AAC000734

1400 CENTREPARK BLVD
SUITE 500
WEST PALM BEACH, FL 33401
TEL 561.888.2111
FAX 561.887.8040
www.leoadaly.com

Mr. Mike McPherson
Re: Palm Beach County Library Annex
February 25, 2013
Page 2 of 6

PLANNING

ARCHITECTURE

ENGINEERING

INTERIORS



EST. 1915

ABU DHABI

ATLANTA

AUSTIN

BEIJING

BENGAZI

BRYAN

CHICAGO

DALLAS

DENVER

FORT WORTH

HONG KONG

HONOLULU

HOUSTON

ISTANBUL

LAS VEGAS

LOS ANGELES

MIAMI

MINNEAPOLIS

MOSCOW

OMAHA

PHOENIX

SACRAMENTO

SAN ANTONIO

SAN MARCOS

TAMPA

TRIPOLI

WACO

WASHINGTON, DC

WEST PALM BEACH

B. STRUCTURAL ENGINEERING SERVICES – As outlined in Attachment E – ONMJ Engineering Proposal, dated 2/22/13.

C. MECHANICAL, ELECTRICAL, PLUMBING & FIRE PROTECTION SERVICES - As outlined in Attachment F – Gartek Engineering Proposal, dated 2/25/13.

D. CIVIL ENGINEERING SERVICES - As outlined in Attachment G – CDI Engineering Proposal (Rev 1), dated 1/25/13.

E. LANDSCAPE ARCHITECTURAL SERVICE – As outlined in Attachment H – LDS Proposal, dated 2/25/13.

F. GEOTECHNICAL ENGINEERING SERVICES - As outlined in Attachment I – Tierra Engineering Proposal, dated 2/22/13.

PHASES OF SERVICES

A. PROGRAM VERIFICATION

A total of two (2) meetings with PBC representatives to review the PBC-developed Space Program confirm and record the space needs for the project.

B. SCHEMATIC DESIGN PHASE

One (1) submission reflecting the PBC-approved Space Program has been assumed for this project phase. **The PBC review will include a matrix with all the design comments shown and a response from the design team entered on each of the comments.** PBC comments will be reflected in the Design Development Phase.

C. DESIGN DEVELOPMENT & CONSTRUCTION DOCUMENT PHASES

Upon PBC's approval of the Schematic Design Phase the Design Development Phase will commence and continue through the Construction Document Phase with the following submissions for PBC review:

- Design Development Submission
- 50% Construction Document Submission
- 95% Construction Document Submission

Each PBC deliverable review will include a matrix with all the design comments shown and a response from the design team entered on each of the comments.

Florida License
No. AAC000734

1400 CENTREPARK BLVD
SUITE 500
WEST PALM BEACH, FL 33401
TEL 561.688.2111
FAX 561.687.8040
www.leoadaly.com

Mr. Mike McPherson
Re: Palm Beach County Library Annex
February 25, 2013
Page 3 of 6

PLANNING

ARCHITECTURE

ENGINEERING

INTERIORS

Upon receiving the final building permit comments the 95% Construction Documents will be updated as the 100% Construction Documents for bidding and construction.

D. BIDDING & CONSTRUCTION ADMINISTRATION PHASES

Bidding will consist of responding to questions and clarification requests from the PBC-selected CM. The Construction Administration Phase shall include shop drawing review and processing and related activities. The Construction Administration has been assumed to be a nine (9) month duration. Site visits by the Architect will occur **weekly**. Site visits by the Consultants will be as required.

DELIVERABLES

One submission which is to include three (3) half size and seven (7) full size sets of plans and ten sets of specifications for review and comment will be provided at the conclusion of the Schematic Design & Design Development Phases and one submission which is to include three (3) half size and seven (7) full size sets of plans and ten sets of specifications for review and comment will be provided at the conclusion of the Construction Document Phase. Two Signed and Sealed sets of drawings and specifications will be submitted for Building Department permitting.

CONDITIONS

- A. The project design will reflect the PBC Policy & Procedures Manual for Design Professional, dated May, 2009.
- B. Site surveying services are not included in this scope of service.
- C. PBC will provide drawings and specifications for the existing book conveying system to be relocated into the new facility. PBC will directly contract with the system vendor to relocate the system.
- D. Leo A Daly will field measure and document the existing shelving system to be relocated into the new facility. No other existing furniture is anticipated to be relocated.
- E. The site has already been rezoned by PBC to accommodate this project. As discussed on 1/28/13, no Site Plan Approval processes are anticipated or included in this proposal.
- F. Landscape improvements are limited to the area immediately around the new building, the new parking area islands and possible limited extension of the existing north perimeter buffer adjacent to the new building.
- G. On 1/24/13 the PBC User confirmed the space does not require special humidity control to protect the contents. The design will be based on ASHRAE standards for this type of facility.
- H. On 1/24/13 the PBC User confirmed the facility does not require an emergency generator.

Florida License
No. AAC000734

1400 CENTREPARK BLVD
SUITE 500
WEST PALM BEACH, FL 33401
TEL 561.688.2111
FAX 561.687.8040
www.leoadaly.com

Mr. Mike McPherson
Re: Palm Beach County Library Annex
February 25, 2013
Page 4 of 6

PLANNING

ARCHITECTURE

ENGINEERING

INTERIORS

EST. 1916

ABU DHABI

ATLANTA

AUSTIN

BEIJING

BENGHAZI

BRYAN

CHICAGO

DALLAS

DENVER

FORT WORTH

HONG KONG

HONOLULU

HOUSTON

ISTANBUL

LAS VEGAS

LOS ANGELES

MIAMI

MINNEAPOLIS

MOSCOW

OMAHA

PHOENIX

SACRAMENTO

SAN ANTONIO

SAN MARCOS

TAMPA

TRIPOLI

WACO

WASHINGTON, DC

WEST PALM BEACH

I. Voice / Data services are limited to providing IT raceways and/or cable trays which would allow a PBC-contracted IT Contractor to route cabling from the dedicated IT equipment room to locations coordinated with PBC. This proposal assumes the IT cabling infrastructure ESS/ISS design will be provided by the PBC-contracted IT Contractor. An IT room as defined by NFPA75 is not anticipated or included in the proposed scope.

J. Cost estimating services are not included in this scope of service.

K. LEED certification services are not required or included in this scope of service.

SCHEDULE

It is anticipated Construction Documents will be complete and ready for building department submission within six (6) months of receiving our formal notice to proceed. A nine (9) month Construction Administration Phase has been assumed for this project.

COMPENSATION

Compensation to Leo A Daly shall be a lump sum as stipulated below. Billing shall be on a monthly basis based on the percentage of completion of the work.

BASIC SERVICES*

1. Architectural	\$189,830
2. Structural Engineering	\$20,070
3. Mechanical, Electrical, Plumbing & Fire Protection Engineering	\$39,830
SUB-TOTAL 1 -3	\$249,730

SUPPLEMENTAL SERVICES*

4. Program Verification	\$5,790
5. Existing Furniture Inventory (Shelving Only)	\$1,940
6. Civil Engineering (On Site)	\$32,360
7. Civil Engineering (Off Site – Left Turn Lane)	\$20,750
8. Landscape Architecture & Irrigation	\$16,000
9. Supplemental Services Consultant Coordination	\$6,700
10. Site Lighting	\$2,000
11. ISS Raceway Design & Documentation	\$2,500
12. Geotechnical Engineering	\$4,860
13. Reimbursables	\$7,000
SUB-TOTAL 4 -13	\$99,872

TOTAL 1 -13 **\$349,602**

* Includes referenced project expenses.

Florida License
No. AAC000734

1400 CENTREPARK BLVD
SUITE 500
WEST PALM BEACH, FL 33401
TEL 561.888.2111
FAX 561.897.8040
www.leoadaly.com

Mr. Mike McPherson
Re: Palm Beach County Library Annex
February 25, 2013
Page 5 of 6

PLANNING

ARCHITECTURE

ENGINEERING

INTERIORS

CHANGE IN SERVICES

Services required of Leo A Daly that are not defined in the scope of work above, or for revisions to the above scope, shall be considered as change in services. Compensation for additional services shall be based upon the Standard Personnel Rates schedule which is currently included in the Contract for Architectural/Professional Services Agreement.

EST. 1915

ABU DHABI

ATLANTA

AUSTIN

BEIJING

BENGHAZI

BRYAN

CHICAGO

DALLAS

DENVER

FORT WORTH

HONG KONG

HONOLULU

HOUSTON

ISTANBUL

LAS VEGAS

LOS ANGELES

MIAMI

MINNEAPOLIS

MOSCOW

OMAHA

PHOENIX

SACRAMENTO

SAN ANTONIO

SAN MARCOS

TAMPA

TRIPOLI

WACO

WASHINGTON, DC

WEST PALM BEACH

CATEGORY

BILLING RATE

Principal	\$ 275.00
Project Manager	\$ 160.00
Senior Designer	\$ 145.00
Architect Designer	\$ 135.00
Specification Writer	\$ 130.00
Job Captain	\$ 115.00
Designer	\$ 110.00
Technician (Draftsperson)	\$ 85.00
Clerical	\$ 55.00

EXPENSES

Expenses for printing, travel, long-distance communications-telephone, fax and video conference, communications (including postage, express mail and couriers), computer time, printing, plotting and copying are included in our compensation noted above.

PAYMENTS

The stipulated compensation shall be billed according to the current Contract for Architectural/Professional Services Agreement.

We look forward to working on this project. Should this proposal meet your needs, please countersign one copy and return it to us, keeping the other copy for your records. Upon receipt of the countersigned copy of the document, we will proceed with the preparation of a comprehensive agreement for professional services.

Very truly yours

LEO A DALY COMPANY



Paul Twitty, AIA
Vice President, Executive Director

Florida License
No. AAC000734

1400 CENTREPARK BLVD
SUITE 500
WEST PALM BEACH, FL 33401
TEL 561.688.2111
FAX 561.697.8040
www.leoadaly.com

PLANNING

ARCHITECTURE

ENGINEERING

INTERIORS



EST. 1915

ABU DHABI

ATLANTA

AUSTIN

BEIJING

BENGHAZI

BRYAN

CHICAGO

DALLAS

DENVER

FORT WORTH

HONG KONG

HONOLULU

HOUSTON

ISTANBUL

LAS VEGAS

LOS ANGELES

MIAMI

MINNEAPOLIS

MOSCOW

OMAHA

PHOENIX

SACRAMENTO

SAN ANTONIO

SAN MARCOS

TAMPA

TRIPOLI

WACO

WASHINGTON, DC

WEST PALM BEACH

Mr. Mike McPherson
Re: Palm Beach County Library Annex
February 25, 2013
Page 6 of 6

ATTACHMENTS:

Attachment A – Owner-provided Conceptual Site Plan, dated 3/4/08
Attachment B – Resolution Voluntary Commitments (Left Turn Lane highlighted)
Attachment C - LAD Fee Tabulation Worksheet - Basic Services, **dated 2/25/13**
Attachment D - LAD Fee Tabulation Worksheet - Supplemental Services, **dated 2/25/13**
Attachment E – ONMJ Engineering Proposal, **dated 2/22/13**
Attachment F – Gartek Engineering Proposal, **dated 2/25/13**
Attachment G – CDI Engineering Proposal (Rev 1), **dated 1/25/13**
Attachment H – LDS Engineering Proposal, **dated 2/25/13**
Attachment I – Tierra Engineering Proposal, **dated 2/22/13**

Approved by:

Palm Beach County Capital Improvements Division

Mike McPherson
Project Manager

J:\PBC library annex\proposal\022513 proposal letter.doc

Florida License
No. AAC000734

1400 CENTREPARK BLVD
SUITE 500
WEST PALM BEACH, FL 33401
TEL 561.688.2111
FAX 561.687.8040
www.leoadaly.com

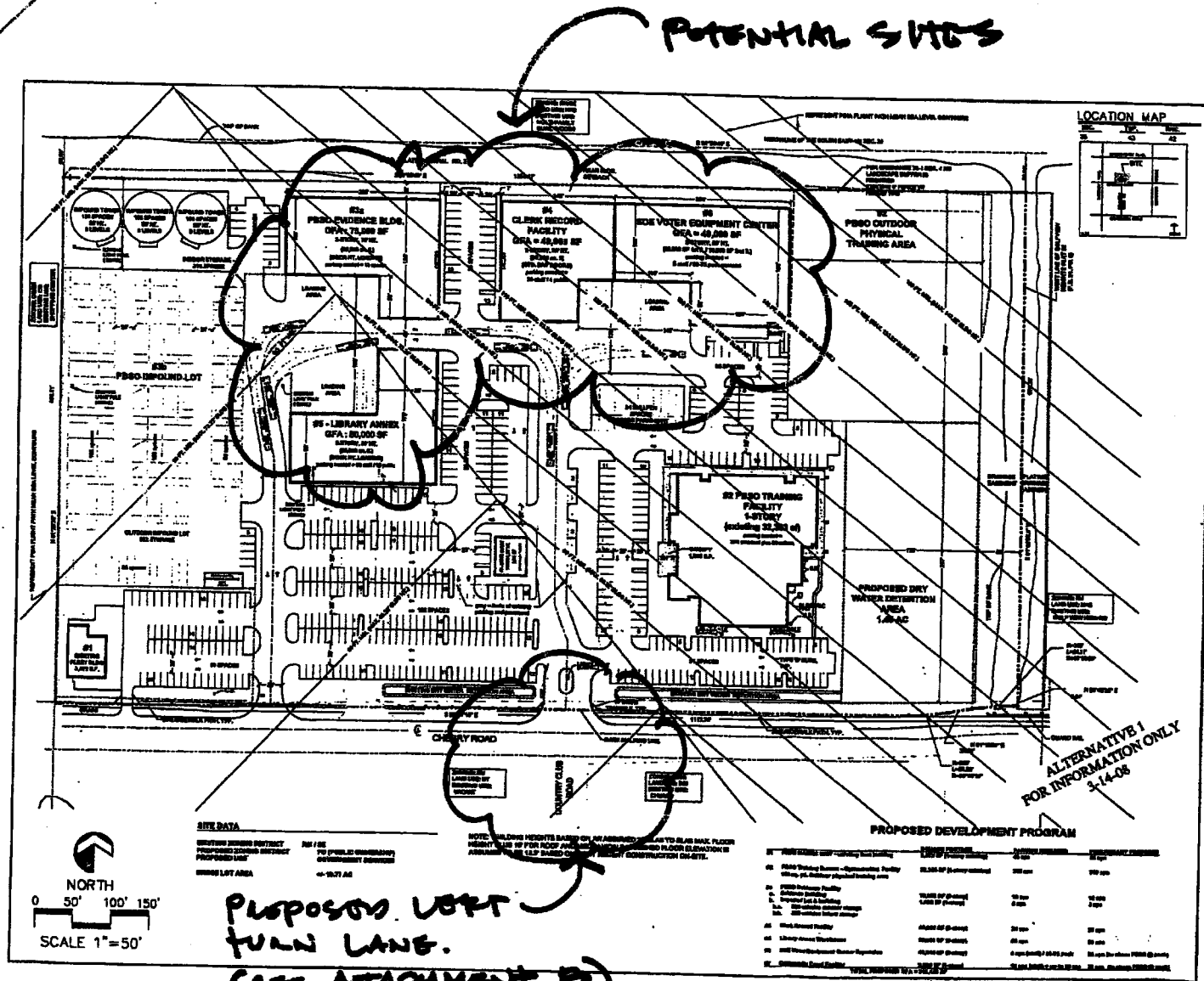

Kidley & Associates
10000 N. W. 11th Ave., Suite 100
Miami, FL 33150
Tel: 305.555.1234
Fax: 305.555.1235
www.kidley.com

CONCEPTUAL SITE PLAN
PALM BEACH COUNTY, FLORIDA
FORMER TKA - CHERRY RD. SITE
REDEVELOPMENT ANALYSIS

100' 200' 300' 400' 500' 600' 700' 800' 900' 1000' 1100' 1200' 1300' 1400' 1500' 1600' 1700' 1800' 1900' 2000' 2100' 2200' 2300' 2400' 2500' 2600' 2700' 2800' 2900' 3000' 3100' 3200' 3300' 3400' 3500' 3600' 3700' 3800' 3900' 4000' 4100' 4200' 4300' 4400' 4500' 4600' 4700' 4800' 4900' 5000' 5100' 5200' 5300' 5400' 5500' 5600' 5700' 5800' 5900' 6000' 6100' 6200' 6300' 6400' 6500' 6600' 6700' 6800' 6900' 7000' 7100' 7200' 7300' 7400' 7500' 7600' 7700' 7800' 7900' 8000' 8100' 8200' 8300' 8400' 8500' 8600' 8700' 8800' 8900' 9000' 9100' 9200' 9300' 9400' 9500' 9600' 9700' 9800' 9900' 10000' 10100' 10200' 10300' 10400' 10500' 10600' 10700' 10800' 10900' 11000' 11100' 11200' 11300' 11400' 11500' 11600' 11700' 11800' 11900' 12000' 12100' 12200' 12300' 12400' 12500' 12600' 12700' 12800' 12900' 13000' 13100' 13200' 13300' 13400' 13500' 13600' 13700' 13800' 13900' 14000' 14100' 14200' 14300' 14400' 14500' 14600' 14700' 14800' 14900' 15000' 15100' 15200' 15300' 15400' 15500' 15600' 15700' 15800' 15900' 16000' 16100' 16200' 16300' 16400' 16500' 16600' 16700' 16800' 16900' 17000' 17100' 17200' 17300' 17400' 17500' 17600' 17700' 17800' 17900' 18000' 18100' 18200' 18300' 18400' 18500' 18600' 18700' 18800' 18900' 19000' 19100' 19200' 19300' 19400' 19500' 19600' 19700' 19800' 19900' 20000' 20100' 20200' 20300' 20400' 20500' 20600' 20700' 20800' 20900' 21000' 21100' 21200' 21300' 21400' 21500' 21600' 21700' 21800' 21900' 22000' 22100' 22200' 22300' 22400' 22500' 22600' 22700' 22800' 22900' 23000' 23100' 23200' 23300' 23400' 23500' 23600' 23700' 23800' 23900' 24000' 24100' 24200' 24300' 24400' 24500' 24600' 24700' 24800' 24900' 25000' 25100' 25200' 25300' 25400' 25500' 25600' 25700' 25800' 25900' 26000' 26100' 26200' 26300' 26400' 26500' 26600' 26700' 26800' 26900' 27000' 27100' 27200' 27300' 27400' 27500' 27600' 27700' 27800' 27900' 28000' 28100' 28200' 28300' 28400' 28500' 28600' 28700' 28800' 28900' 29000' 29100' 29200' 29300' 29400' 29500' 29600' 29700' 29800' 29900' 30000' 30100' 30200' 30300' 30400' 30500' 30600' 30700' 30800' 30900' 31000' 31100' 31200' 31300' 31400' 31500' 31600' 31700' 31800' 31900' 32000' 32100' 32200' 32300' 32400' 32500' 32600' 32700' 32800' 32900' 33000' 33100' 33200' 33300' 33400' 33500' 33600' 33700' 33800' 33900' 34000' 34100' 34200' 34300' 34400' 34500' 34600' 34700' 34800' 34900' 35000' 35100' 35200' 35300' 35400' 35500' 35600' 35700' 35800' 35900' 36000' 36100' 36200' 36300' 36400' 36500' 36600' 36700' 36800' 36900' 37000' 37100' 37200' 37300' 37400' 37500' 37600' 37700' 37800' 37900' 38000' 38100' 38200' 38300' 38400' 38500' 38600' 38700' 38800' 38900' 39000' 39100' 39200' 39300' 39400' 39500' 39600' 39700' 39800' 39900' 40000' 40100' 40200' 40300' 40400' 40500' 40600' 40700' 40800' 40900' 41000' 41100' 41200' 41300' 41400' 41500' 41600' 41700' 41800' 41900' 42000' 42100' 42200' 42300' 42400' 42500' 42600' 42700' 42800' 42900' 43000' 43100' 43200' 43300' 43400' 43500' 43600' 43700' 43800' 43900' 44000' 44100' 44200' 44300' 44400' 44500' 44600' 44700' 44800' 44900' 45000' 45100' 45200' 45300' 45400' 45500' 45600' 45700' 45800' 45900' 46000' 46100' 46200' 46300' 46400' 46500' 46600' 46700' 46800' 46900' 47000' 47100' 47200' 47300' 47400' 47500' 47600' 47700' 47800' 47900' 48000' 48100' 48200' 48300' 48400' 48500' 48600' 48700' 48800' 48900' 49000' 49100' 49200' 49300' 49400' 49500' 49600' 49700' 49800' 49900' 50000' 50100' 50200' 50300' 50400' 50500' 50600' 50700' 50800' 50900' 51000' 51100' 51200' 51300' 51400' 51500' 51600' 51700' 51800' 51900' 52000' 52100' 52200' 52300' 52400' 52500' 52600' 52700' 52800' 52900' 53000' 53100' 53200' 53300' 53400' 53500' 53600' 53700' 53800' 53900' 54000' 54100' 54200' 54300' 54400' 54500' 54600' 54700' 54800' 54900' 55000' 55100' 55200' 55300' 55400' 55500' 55600' 55700' 55800' 55900' 56000' 56100' 56200' 56300' 56400' 56500' 56600' 56700' 56800' 56900' 57000' 57100' 57200' 57300' 57400' 57500' 57600' 57700' 57800' 57900' 58000' 58100' 58200' 58300' 58400' 58500' 58600' 58700' 58800' 58900' 59000' 59100' 59200' 59300' 59400' 59500' 59600' 59700' 59800' 59900' 60000' 60100' 60200' 60300' 60400' 60500' 60600' 60700' 60800' 60900' 61000' 61100' 61200' 61300' 61400' 61500' 61600' 61700' 61800' 61900' 62000' 62100' 62200' 62300' 62400' 62500' 62600' 62700' 62800' 62900' 63000' 63100' 63200' 63300' 63400' 63500' 63600' 63700' 63800' 63900' 64000' 64100' 64200' 64300' 64400' 64500' 64600' 64700' 64800' 64900' 65000' 65100' 65200' 65300' 65400' 65500' 65600' 65700' 65800' 65900' 66000' 66100' 66200' 66300' 66400' 66500' 66600' 66700' 66800' 66900' 67000' 67100' 67200' 67300' 67400' 67500' 67600' 67700' 67800' 67900' 68000' 68100' 68200' 68300' 68400' 68500' 68600' 68700' 68800' 68900' 69000' 69100' 69200' 69300' 69400' 69500' 69600' 69700' 69800' 69900' 70000' 70100' 70200' 70300' 70400' 70500' 70600' 70700' 70800' 70900' 71000' 71100' 71200' 71300' 71400' 71500' 71600' 71700' 71800' 71900' 72000' 72100' 72200' 72300' 72400' 72500' 72600' 72700' 72800' 72900' 73000' 73100' 73200' 73300' 73400' 73500' 73600' 73700' 73800' 73900' 74000' 74100' 74200' 74300' 74400' 74500' 74600' 74700' 74800' 74900' 75000' 75100' 75200' 75300' 75400' 75500' 75600' 75700' 75800' 75900' 76000' 76100' 76200' 76300' 76400' 76500' 76600' 76700' 76800' 76900' 77000' 77100' 77200' 77300' 77400' 77500' 77600' 77700' 77800' 77900' 78000' 78100' 78200' 78300' 78400' 78500' 78600' 78700' 78800' 78900' 79000' 79100' 79200' 79300' 79400' 79500' 79600' 79700' 79800' 79900' 80000' 80100' 80200' 80300' 80400' 80500' 80600' 80700' 80800' 80900' 81000' 81100' 81200' 81300' 81400' 81500' 81600' 81700' 81800' 81900' 82000' 82100' 82200' 82300' 82400' 82500' 82600' 82700' 82800' 82900' 83000' 83100' 83200' 83300' 83400' 83500' 83600' 83700' 83800' 83900' 84000' 84100' 84200' 84300' 84400' 84500' 84600' 84700' 84800' 84900' 85000' 85100' 85200' 85300' 85400' 85500' 85600' 85700' 85800' 85900' 86000' 86100' 86200' 86300' 86400' 86500' 86600' 86700' 86800' 86900' 87000' 87100' 87200' 87300' 87400' 87500' 87600' 87700' 87800' 87900' 88000' 88100' 88200' 88300' 88400' 88500' 88600' 88700' 88800' 88900' 89000' 89100' 89200' 89300' 89400' 89500' 89600' 89700' 89800' 89900' 90000' 90100' 90200' 90300' 90400' 90500' 90600' 90700' 90800' 90900' 91000' 91100' 91200' 91300' 91400' 91500' 91600' 91700' 91800' 91900' 92000' 92100' 92200' 92300' 92400' 92500' 92600' 92700' 92800' 92900' 93000' 93100' 93200' 93300' 93400' 93500' 93600' 93700' 93800' 93900' 94000' 94100' 94200' 94300' 94400' 94500' 94600' 94700' 94800' 94900' 95000' 95100' 95200' 95300' 95400' 95500' 95600' 95700' 95800' 95900' 96000' 96100' 96200' 96300' 96400' 96500' 96600' 96700' 96800' 96900' 97000' 97100' 97200' 97300' 97400' 97500' 97600' 97700' 97800' 97900' 98000' 98100' 98200' 98300' 98400' 98500' 98600' 98700' 98800' 98900' 99000' 99100' 99200' 99300' 99400' 99500' 99600' 99700' 99800' 99900' 100000' 100100' 100200' 100300' 100400' 100500' 100600' 100700' 100800' 100900' 101000' 101100' 101200' 101300' 101400' 101500' 101600' 101700' 101800' 101900' 102000' 102100' 102200' 102300' 102400' 102500' 102600' 102700' 102800' 102900' 103000' 103100' 103200' 103300' 103400' 103500' 103600' 103700' 103800' 103900' 104000' 104100' 104200' 104300' 104400' 104500' 104600' 104700' 104800' 104900' 105000' 105100' 105200' 105300' 105400' 105500' 105600' 105700' 105800' 105900' 106000' 106100' 106200' 106300' 106400' 106500' 106600' 106700' 106800' 106900' 107000' 107100' 107200' 107300' 107400' 107500' 107600' 107700' 107800' 107900' 108000' 108100' 108200' 108300' 108400' 108500' 108600' 108700' 108800' 108900' 109000' 109100' 109200' 109300' 109400' 109500' 109600' 109700' 109800' 109900' 110000' 110100' 110200' 110300' 110400' 110500' 110600' 110700' 110800' 110900' 111000' 111100' 111200' 111300' 111400' 111500' 111600' 111700' 111800' 111900' 112000' 112100' 112200' 112300' 112400' 112500' 112600' 112700' 112800' 112900' 113000' 113100' 113200' 113300' 113400' 113500' 113600' 113700' 113800' 113900' 114000' 114100' 114200' 114300' 114400' 114500' 114600' 114700' 114800' 114900' 115000' 115100' 115200' 115300' 115400' 115500' 115600' 115700' 115800' 115900' 116000' 116100' 116200' 116300' 116400' 116500' 116600' 116700' 116800' 116900' 117000' 117100' 117200' 117300' 117400' 117500' 117600' 117700' 117800' 117900' 118000' 118100' 118200' 118300' 118400' 118500' 118600' 118700' 118800' 118900' 119000' 119100' 119200' 119300' 119400' 119500' 119600' 119700' 119800' 119900' 120000' 120100' 120200' 120300' 120400' 120500' 120600' 120700' 120800' 120900' 121000' 121100' 121200' 121300' 121400' 121500' 121600' 121700' 121800' 121900' 122000' 122100' 122200' 122300' 122400' 122500' 122600' 122700' 122800' 122900' 123000' 123100' 123200' 123300' 123400' 123500' 123600' 123700' 123800' 123900' 1

ATTACHMENT B

EXHIBIT C VOLUNTARY COMMITMENTS

ENGINEERING

1. The property owner shall construct a west approach left turn lane on Cherry Rd at the easterly driveway. Any and all costs associated with the construction shall be paid by the property owner. These costs shall include, but are not limited to, utility relocations and acquisition of any additional required right-of-way.

a. Permits required by Palm Beach County for this construction shall be obtained prior to the issuance of Building Permits for more than the 32,383 sf PBC Sheriff's Training facility (currently existing as gymnasium) and the 3,072 sf ancillary maintenance building (currently existing as maintenance building). (BLDG PERMIT: MONITORING Eng)

b. Construction of the improvement shall be completed prior to the issuance of the first Certificate of Occupancy after the COs have been issued for the 32,383 sf Sheriff's Training Facility and 3,072 sf of maintenance building. (CO: MONITORING Eng)

2. Prior to March 30, 2010 or to the issuance of new building construction permit, whichever shall occur first, the property owner shall combine the property into a single lot of record in accordance with provisions of Article 11 of the Unified Land Development Code. (BLDG PERMIT: MONITORING-Eng)

COMPLIANCE

1. In granting this approval, the Board of County Commissioners relied upon the oral and written representations of the petitioner both on the record and as part of the application process. Deviations from or violation of these representations shall cause the approval to be presented to the Board of County Commissioners for review under the compliance condition of this approval. (ONGOING: MONITORING - Zoning)

2. Failure to comply with any of the voluntary commitments of approval for the subject property at any time may result in:

a. The issuance of a stop work order; the issuance of a cease and desist order; the denial or revocation of a building permit; the denial or revocation of a Certificate of Occupancy; the denial of any other permit, license or approval to any developer, owner, lessee, or user of the subject property; the revocation of any other permit, license or approval from any developer, owner, lessee, or user of the subject property; revocation of any concurrency; and/or

b. The revocation of the Official Map Amendment, Conditional Use, Requested Use, Development Order Amendment, and/or any other zoning approval; and/or

c. A requirement of the development to conform with the standards of the ULDC at the time of the finding of non-compliance, or the addition or modification of conditions reasonably related to the failure to comply with existing conditions; and/or

d. Referral to code enforcement; and/or

e. Imposition of entitlement density or intensity.

Staff may be directed by the Executive Director of PZ&B or the Code Enforcement Special Master to schedule a Status Report before the body which approved the Conditional Use, Type II Variance, Development Order Amendment, and/or other zoning approval, in accordance with the provisions of Section 2.E of the ULDC, in response to any flagrant violation and/or continued violation of any condition of approval.

Departmental administrative actions made pursuant to this condition may be appealed as provided in the Unified Land Development Code (ULDC), as amended. Appeals of any revocation of a Conditional Use, Type II Variance, Development Order Amendment or other actions based on a Zoning Commission decision shall be by petition for writ of certiorari to the Circuit Court, Appellate Division, 15th Judicial Circuit of Florida. (ONGOING: MONITORING - Zoning)

Leo A Daly

FEE TABULATION WORKSHEET- Attachment C

DATE: 2/22/13
PROJECT: PBC Library Annex - Basic Services
PROJECT NO:
LOCATION: West Palm Beach, FL
OWNER: Palm Beach County
PBC REP: Michael McPherson
SCOPE: A/E Services

TASK DESCRIPTION	Principal	Project Manager	Senior Designer	Spec Writer	Job Captain	Designer	Technician	Clerical	TASK HOURS	TASK BUDGET
PRELIMINARY										\$8.00
Programming									0	\$0.00
Supplemental Services Coordination									0	\$0.00
Furniture Inventory									0	\$0.00
SCHEMATIC DESIGN PHASE										\$23,300.00
Design		4	60		12		80		158	\$17,520.00
Team Meetings		8	12		12				32	\$4,400.00
Correspondence/Consultant Coord.									0	\$0.00
Drawings/Specifications									0	\$0.00
Responses to Owner Review					12				12	\$1,380.00
QA/QC									0	\$0.00
DESIGN DEVELOPMENT PHASE										\$44,020.00
Field Verify As-Built Conditions									0	\$0.00
Team Meetings		8	8		32				48	\$6,120.00
Correspondence/Consultant Coord.					72				72	\$8,280.00
Drawings/Specifications				20	40		240		300	\$27,600.00
Responses to Owner Review					12				12	\$1,380.00
QA/QC		4							4	\$640.00
CONSTRUCTION DOCUMENT PHASE										\$68,780.00
Team Meetings		8	8		48				64	\$7,960.00
Correspondence/Consultant Coord.					72				72	\$8,280.00
Drawings					60		320		380	\$34,100.00
Specifications				80					80	\$10,400.00
Responses to Owner Review				8	20		40		68	\$8,740.00
QA/QC		8							8	\$1,280.00
PERMITS										\$3,180.00
Permit Processing									0	\$0.00
Respond to Bldg Dept. Comments					20		10		30	\$3,150.00
GMP PRICING										\$3,680.00
Respond to RFIs and Questions					32				32	\$3,680.00
CONSTRUCTION (9 months)										\$46,000.00
Regulations Review/Processing					12				12	\$1,380.00
CPR / COP Review					32				32	\$3,680.00
Submitale Review/ RFIs					120		24		144	\$15,840.00
OAC/Coord.Meetings (40 mtgs)		16			180				196	\$23,280.00
Punch-Out & Report					16				16	\$1,840.00
CONTRACT CLOSEOUT										\$820.00
Closeout Documents/Review					8				8	\$820.00
TOTAL HOURS	0	56	88	108	812	0	714	0	1778	
RATES	\$275	\$180	\$145	\$130	\$115	\$110	\$85	\$55		
BUDGET	\$0	\$8,960	\$12,760	\$14,040	\$93,360	\$0	\$60,690	\$0		\$189,830.00
SUBTOTAL										\$189,830.00
EXPENSES										\$0.00
Surveys										
Photographs										
Mail/Federal Express/Courier Services										
Reproductions/ Printing /Computer Time										
Photocopies										
Travel/ Auto Mileage										
Long Distance Communication										
SUB-CONSULTANTS										\$89,960.00
MEP Engineer										\$39,830.00
Structural Engineer										\$20,070.00
Geotechnical Engineer										
Civil Engineer										
Landscape & Irrigation										

TOTAL

\$248,790.00

Leo A Daly

FEE TABULATION WORKSHEET - Attachment D

DATE: 2/6/13
PROJECT: PBC Library Annex - Supplemental Services
PROJECT NO:
LOCATION: West Palm Beach, FL
OWNER: Palm Beach County
PBC REP: Michael McPherson
SCOPE: AE Services

TASK DESCRIPTION	Principal	Project Manager	Senior Designer	Spec Writer	Job Captain	Designer	Technician	Clerical	TASK HOURS	TASK BUDGET
PRELIMINARY										\$14,430.00
Programming		10	10		20			8	48	\$5,790.00
Supplemental Services Coordination					40				40	\$8,700.00
Furniture Inventory (Shelving Only)					8		12		20	\$1,940.00
SCHEMATIC DESIGN PHASE										\$0.00
Design									0	\$0.00
Team Meetings									0	\$0.00
Correspondence/Consultant Coord.									0	\$0.00
Drawings/Specifications									0	\$0.00
Responses to Owner Comments & Review									0	\$0.00
QA/QC									0	\$0.00
DESIGN DEVELOPMENT PHASE										\$0.00
Field Verify As-Built Conditions									0	\$0.00
Team Meetings									0	\$0.00
Correspondence/Consultant Coord.									0	\$0.00
Drawings/Specifications									0	\$0.00
Responses to Owner Comments & Review									0	\$0.00
QA/QC									0	\$0.00
CONSTRUCTION DOCUMENT PHASE										\$0.00
Team Meetings									0	\$0.00
Correspondence/Consultant Coord.									0	\$0.00
Drawings									0	\$0.00
Specifications									0	\$0.00
Responses to Owner Comments & Review									0	\$0.00
QA/QC									0	\$0.00
PERMITS										\$0.00
Permit Processing									0	\$0.00
Respond to Bldg Dept. Comments									0	\$0.00
BIDDING/PRICING										\$0.00
Respond to RFIs and questions									0	\$0.00
CONSTRUCTION										\$0.00
Requests Review/Processing									0	\$0.00
CPR / COP Review									0	\$0.00
Submittals Review/ RFIs									0	\$0.00
OAC/Coord. Meetings (4 mtgs)									0	\$0.00
Punch-Out & Report									0	\$0.00
CONTRACT CLOSEOUT										\$0.00
Closeout Documents/Review									0	\$0.00
TOTAL HOURS	0	10	10	0	68	0	12	8	108	
RATES	\$275	\$180	\$145	\$130	\$115	\$110	\$85	\$55		
BUDGET	\$0	\$1,800	\$1,450	\$0	\$7,820	\$0	\$1,020	\$440		\$14,430.00
SUBTOTAL										\$14,430.00
EXPENSES										\$7,000.00
Surveys										
Photographs										
Mail/Federal Express/Courier Services										
Reproductions/ Printing /Computer Time										\$6,500.00
Photocopies										\$500.00
Travel/ Auto Mileage										
Long Distance Communication										
SUB-CONSULTANTS										\$78,442.00
MEP Engineer (Site Lighting & ESS Design/Documentation)										\$4,500.00
Structural Engineer										
Geotechnical Engineer										\$4,832.00
Civil Engineer (Including Off-Site Left Turn Lane)										\$63,110.00
Landscape & Irrigation										\$16,000.00

TOTAL

\$89,872.00

ATTACHMENT E

Structural Engineers | Special Inspectors | Construction Managers



February 22, 2013

Leo A Daly Company, Inc.
Mr. Mark Ugowski
1400 Centrepark Blvd, Ste 500
West Palm Beach, FL 33401

Re: PBC Library Annex Warehouse
Palm Beach County, FL
Project No.: 319.496

We are pleased to submit the following revised proposal for Consulting Structural Engineering Services for the subject project. Our proposal is based on information supplied by your office. This project consists of the structural design and drafting of a one-story 30,000 sq. ft. distribution warehouse facility with some office and loading dock.

- Envelope will be flat roof with CMU/stucco or tilt-up exterior walls. There will be a depressed loading dock.
- PBC will provide information for the existing (small) automated conveying system to be relocated from the current facility.
- "Green" design strategies to be considered but the project will not require LEED certification.

Our services during the construction document phase will include the following:

1. Consultation to determine structural requirements.
2. Preparation of structural drawings, which will be signed and sealed for building permit application.

Our services during construction administration phase will include the following:

1. Review of structural shop drawings only for their general conformance with the design of the project.
2. Make up to (4) field visits/meetings to the site during construction when requested by the architect.
3. Responding to the Building Department or construction questions.

Our fee for these services will be broken down as follows:

Schematic Design	\$ 2,000.00	\$ 1,800.00
Design Development	\$ 6,000.00	\$ 5,400.00
Construction Documents	\$ 8,840.00	\$ 7,970.00
Bidding	\$ 1,000.00	\$ 900.00
Construction Administration	\$ 4,460.00	\$ 4,000.00
Total	\$22,300.00	\$20,070.00

If additional field visits are required, they will be billed on an hourly basis, plus expenses, but only if requested by the client.

This proposal is valid for six (6) months from the date issued. If work is stopped for more than three (3) months, additional fees will be required to restart the project. Additional services beyond the scope of this proposal may be provided on a flat fee basis or on an hourly basis.

Our hourly rates are as follows:

RATE SCHEDULE

Principal	\$190.00/ hour
Project Manager	\$160.00/ hour
Senior Engineer	\$130.00/ hour
Project Engineer	\$120.00/ hour
CADD Operator	\$ 95.00/ hour

PBC Library Annex Warehouse
February 22, 2013
Page 2 of 2

The prevailing rates and contract amount shall be effective on January 1, 2013 and are expected to remain as stated through December 31, 2013. Should circumstances require an adjustment to these rates prior to December 31, 2013, 30 days written notification shall be submitted in advance of the effective date of change.

Payment is due upon receipt of services.

Contract Terms:

1. A Geotechnical Engineer will be retained by others and we will coordinate our foundation design with his findings.
2. A conventional spread footing foundation system will be used. If deep foundations, grade beams or structurally supported slabs are required, we will increase the fee accordingly.
3. Design of sheathing, shoring, scaffolding, formwork and other means and methods of construction will be provided by engineers retained by the contractors.
4. Our fee will be increased for revisions of design or drawings to suit changes after work is released for pricing or permits.
5. Miscellaneous iron items such as stairs, ladders, catwalk and railings will be designed and signed and sealed by the fabricator's engineer and reviewed by O'Donnell, Naccarato, Mignogna & Jackson, Inc.
6. Services related to mold, asbestos materials, detection, modification or process will be provided by others.
7. The scope of services for this project does not include design and drafting of specialty engineering items such as heavy timber, wood trusses, precast concrete or aluminum framing. We will provide performance specifications only for any cold-formed steel framing where required at the exterior walls and soffits. We will require signed and sealed shop drawings and calculations from the cold-formed steel contractor's engineer. If the cold form designer requests additional structural steel for the purpose of reducing cost or complexity of exterior curtain wall system, this will be considered value engineering and will be treated as an additional service.
8. The creation of record documents, which generally include incorporation of RFI information into our drawings or construction related changes to contract documents, is considered additional services.

Please call if you have any questions or if additional information is required. Kindly indicate your acceptance by signing and returning this document within ten (10) days. Should this document not be executed and returned to us, all parties acknowledge and agree that "authorization to proceed" through any other means constitutes formal acceptance of all terms and conditions contained herein.

O'DONNELL, NACCARATO, MIGNOGNA & JACKSON, INC.

Dwayne R. Jackson, P.E.
President

DRJ/mc

ACCEPTED BY _____ DATE _____
NAME _____ TITLE _____

ATTACHMENT F



Mechanical, Electrical,
Plumbing and Fire
Protection Engineers

February 25th, 2013

Mr. Mark A. Ugowski
Project Manager
Leo A. Daly
1400 Centrepark Boulevard, Suite 500
West Palm Beach, FL 33401

*** Via-Email ***
MAUgowski@leoadaly.com

Re: PBC Library Annex at Cherry Road, West Palm Beach - Rev

Dear Mark:

This proposal supersedes prior proposals dated 01-28-13 and 02-06-13.

We are pleased to present our proposal on Engineering Services for the referenced project.

We will provide Plumbing, Fire Protection, HVAC and Electrical Engineering for a lump sum fee of \$44,330.00, as indicated below. As requested, the breakdown identifies the fee associated with site lighting (\$2,000) and the fee associated with work related with ISS requirements (\$2,500).

Basic services, design through Construction services:	\$39,830
Site Lighting	\$ 2,000
ISS Design/documentation	<u>\$ 2,500</u>
Total	<u>\$44,330</u>

The scope of our services includes electrical design associated with providing four (4) 20A, 120V dedicated circuits to supply the existing sorter assembly which will be relocated from the existing Annex.

According to our site visit on January 24th, 2013, the following is relevant to our scope:

1. The client has indicated that special humidity control is not required; that is, the design will be based on ASHRAE standards for this type occupancy.
2. The existing modular furniture is to be re-used at the new location. It was noted that the present panels are not electrified.
3. Generator emergency power is not desired. Emergency egress lighting will be designed using battery back-up type luminaires.
4. The existing server room consists of servers installed on two racks. UPS power is provided by rack mounted UPS. Our design does not include design of an "IT" room as defined by NFPA 75. It does not appear that the Annex will require that level of design for the server room.

The project consists of a new single story building of approximately 30,000 S.F. replacing the existing Annex in accordance with preliminary information received by our office on January 23rd, 2013, and subsequent site visit to the existing Annex.

Gartek Engineering Corporation

Miami-Dade County CBE, Broward County CBE, Florida DBE, M/WBE and SBE

7210 S.W. 39 Terrace / Miami, FL 33155 / Voice 305-266-8997 / Fax 305-264-9496

730 East Prospect Road - Suite 100 - Oakland Park, Florida 33334 - Voice 954-399-2347

4723 West Atlantic Avenue, Suite A18 / Delray Beach, FL 33445 / Voice 561-637-8909 / Fax 561-637-8959

www.gartek-engineering.com

Gartek

Mechanical, Electrical,
Plumbing and Fire
Protection Engineers

February 25th, 2013

Mr. Mark A. Ugowski, Leo A. Daly

Re: PBC Library Annex at Cherry Road, West Palm Beach – Rev.

Page 2 of 3

The following information and material, which will impact the design, shall be provided to Gartek Engineering:

- Provide electronic data files of pre-bordered architectural floor plan backgrounds and reflected ceiling plans, complete with room names, numbers, and sensitive walls. Architect shall also provide site plans, life safety plans, elevations, and sections, if applicable.
- Updated Civil and Structural Engineering design documents for coordination.
- Existing civil and site drawings indicating all underground and overhead mechanical, plumbing, and electrical site utilities which may affect the design.
- Catalog cut sheets and room plan layouts for Owner-furnished equipment and equipment provided by other consultants which will be connected to or which impacts the design, indicating all utility connection requirements, utility consumption and heat rejection, including information on any system with special clearance requirements.

The Fee will include the following:

1. Fire Protection, Plumbing, HVAC, and Electrical Plans.
2. Design of Lightning Protection system.
3. The fee does not include IT cabling infrastructure design. This function is usually carried out by the IT Contractor selected by ISS. The fee is based on providing IT raceways, and/or cable trays which would allow an IT contractor to route cabling to a dedicated IT room. Gartek is to be provided with IT outlet locations and conduit size requirements.
4. We will coordinate services requirements with Comcast and ATT.
5. Specifications.
6. Blueprinting for design coordination. Our fee includes all reproduction internal to our office; one set of reproducibles and three sets signed and sealed. Printing for progress reviews, additional reproducibles or reproduction, if requested by you, will be invoiced at cost plus 10% administration fee.
7. Shop Drawing review.
8. We will coordinate our work with FPL.
9. Our fee includes services during construction as indicated on the attached breakdown.
10. Site lighting is included in the fee.
11. We will design a new fire alarm system per code requirements.

The following will not be included in the Basic Fee:

1. Re-design as a result of value engineering recommendations received after completion of design.
2. Design of stand-by emergency generation system.
3. The fee does not include specialized lighting design services such as decorative luminaire selection, programmed dimming systems nor special effects lighting (facade display, etc.). The basic fee includes selection of common luminaire types only.

Gartek Engineering Corporation

7210 SW 39 Terrace • Miami, Florida 33155 • Phone (305) 266-8997 • Fax (305) 264-9496
730 East Prospect Road • Suite 100 • Oakland Park, Florida 33334 • Phone (954) 399-2347
4723 W. Atlantic Ave. • Suite A18 • Delray Beach, Florida 33445 • Phone (561) 637-8909 • Fax (561) 637-8959
www.gartek-engineering.com

Gartek

Mechanical, Electrical,
Plumbing and Fire
Protection Engineers

February 25th, 2013

Mr. Mark A. Ugowski, Leo A. Daly

Re: PBC Library Annex at Cherry Road, West Palm Beach – Rev.

Page 3 of 3

4. Our Scope of services does not include the Preparation of estimates of probable construction cost.
5. Our Scope of services does not include Permit expeditor services.
6. Civil Engineering, Paving, grading, drainage and site water and sewer distribution and collection. Our design of water and sewer will be for the building only and will terminate 5 feet outside the building for continuation by the Civil Engineer. Architect's office will provide coordination with the Civil Engineer.

Work approved by you to be completed on an hourly basis will be charged at the following rates:

Principal	US\$140.00/hr
Engineer	US\$120.00/hr
CAD Designer	US\$ 60.00/hr

Our fee will be invoiced on a percentage of completion basis.

Thank you for the opportunity to present this proposal. If you are in agreement with our proposal, kindly return a signed copy as authorization. We will be ready to start upon receipt of final architectural backgrounds.

Sincerely

GARTEK ENGINEERING CORPORATION



Mel F. Garcia, P.E. LEED AP
Vice President

MFG:pcy

Authorized by **LEO A. DALY** for Gartek
Engineering Corp., to provide the above services:

Signed: _____

Name: _____

Title: _____

Date: _____

Gartek Engineering Corporation

7210 SW 39 Terrace • Miami, Florida 33155 • Phone (305) 266-8997 • Fax (305) 264-9496
730 East Prospect Road • Suite 100 • Oakland Park, Florida 33334 • Phone (954) 399-2347
4723 W. Atlantic Ave. • Suite A18 • Delray Beach, Florida 33445 • Phone (561) 637-8909 • Fax (561) 637-8959
www.gartek-engineering.com

ATTACHMENT G



CIVIL DESIGN, INC.
ENGINEERING CONSULTANTS

**PBC Annual Architectural Continuing Services Contract
Scope & Fee for
Library Annex, West Palm Beach
January 25, 2013 (Rev 1)**

Project Description

The project is generally described as site civil engineering services associated with a $\pm 30,000$ SF library annex building, associated parking, utility extensions and an east bound left turn lane into the site to be located at the existing Cherry Road facility in West Palm Beach, FL.

Work includes onsite and offsite components as detailed below.

Scope of Services

ONSITE

1. **Plan Preparation Services (SD, DD, CD Phases).** Consultant will provide services as follows:
 - 1.1. Preparation of plans and narratives per PBC CID design manual dated May 2009.
 - 1.2. Plans are anticipated to include signing & striping, potable water, sanitary sewer, paving, grading & drainage.
 - 1.3. Preparation of civil permitting requirements including agency, applications and fees.
 - 1.4. Preparation of drainage computations to support the plans and details.
 - 1.5. Specifications for civil items (i.e. water, sewer, drainage, site concrete, asphalt, base rock).
 - 1.6. Provide three sets of deliverables (CD plans) to Client for Building Permit submittal.
2. **Civil Permitting Services.** Consultant will assist Client/Owner with making permit applications to the following agencies having jurisdiction over the project:
 - 2.1. South Florida Water Management District
 - 2.2. Lake Worth Drainage District
 - 2.3. Palm Beach County Water Utilities Department
 - 2.4. Palm Beach County Health Department
3. **Bidding Services.** Consultant will provide bidding services as follows:
 - 3.1. Respond to RFI's related to Consultant designed elements.
4. **Construction Phase.** Consultant will provide construction phase services as follows:
 - 4.1. Review site civil shop drawings for Consultant design elements.
 - 4.2. Attend up to one preconstruction meeting.
 - 4.3. Periodic site visits (not to exceed 10 visits) required to certify Consultant designed elements.



CIVIL DESIGN, INC.
ENGINEERING CONSULTANTS

- 4.4. Furnish certification letters to permitting agencies based on completed work in compliance with the approved construction documents.

OFF SITE

5. Plan Preparation Services (SD, DD, CD Phases). Consultant will provide services as follows:

- 5.1. Preparation of plans and narratives per PBC CID design manual dated May 2009.
- 5.2. Plans are anticipated to include horizontal control, signing & striping and, paving, grading & drainage plans and details.
- 5.3. Preparation of civil permitting requirements including agency, applications and fees.
- 5.4. Preparation of drainage computations to support the plans and details.
- 5.5. Specifications for civil items (i.e. striping, drainage, asphalt, base rock).
- 5.6. Provide three sets of deliverables (CD plans) to Client for Building Permit submittal.

6. Civil Permitting Services. Consultant will assist Client/Owner with making permit applications to the following agencies having jurisdiction over the project:

- 6.1. South Florida Water Management District
- 6.2. Lake Worth Drainage District
- 6.3. Palm Beach County Land Development Department

7. Bidding Services. Consultant will provide bidding services as follows:

- 7.1. Respond to RFI's related to Consultant designed elements.

8. Construction Phase. Consultant will provide construction phase services as follows:

- 8.1. Review site civil shop drawings for Consultant design elements.
- 8.2. Attend up to one preconstruction meeting.
- 8.3. Periodic site visits (not to exceed 8 visits) required to certify Consultant designed elements.
- 8.4. Furnish certification letters to permitting agencies based on completed work in compliance with the approved construction documents.

9. Project Limitations and Assumptions. Services to be provided by Consultant are predicated upon and subject to the following conditions:

- 9.1. Client will provide Consultant a complete base file in AutoCAD format from which to prepare Consultant's documents.
- 9.2. Client will provide Consultant with copies (hard copies and digital files (AutoCAD compatible as appropriate) of site plan, full survey and geotechnical report for Consultant's use.
- 9.3. Potable water will be extended from the existing water main onsite as previously constructed. No offsite extensions or upgrades are included.
- 9.4. Sanitary sewer will be extended from the onsite gravity sewer as previously constructed. No offsite extensions or upgrades are included.



CIVIL DESIGN, INC.
ENGINEERING CONSULTANTS

- 9.5. Drainage will be accommodated in the existing dry detention area with continued outfall to the adjacent canal. Per site feasibility report, detention area is sized to accommodate expansion, therefore no additional upgrades or expansions are included.
- 9.6. Offsite work is limited to an east bound (i.e. west approach) left turn lane into the existing east entrance as specified in the site feasibility report. Assumes there is sufficient right-of-way to accommodate turn lane and that sufficient area is available to accommodate additional pavement as required. No other offsite work is included.
- 9.7. Per discussion with Client, site plan will account for existing water and sewer infrastructure such that utility relocations will not be required. As such, utility relocation is not included.

10. Professional Fees for Services.

ONSITE

10.1. Schematic Design (SD) Phase (15%).....	\$4,854.00
10.2. Design Development (DD) Phase (20%).....	\$6,472.00
10.3. Construction Document (CD) Phase (40%)	\$12,944.00
10.4. Bidding & Negotiation (BN) Phase (5%).....	\$1,618.00
10.5. Construction Administration (CA) Phase (20%)	<u>\$6,472.00</u>
SubTotal (Lump Sum)	32,360.00

OFFSITE

10.6. Schematic Design (SD) Phase (15%).....	\$3,112.50
10.7. Design Development (DD) Phase (20%).....	\$4,150.00
10.8. Construction Document (CD) Phase (40%)	\$8,300.00
10.9. Bidding & Negotiation (BN) Phase (5%).....	\$1,037.50
10.10. Construction Administration (CA) Phase (20%)	<u>\$4,150.00</u>
SubTotal (Lump Sum)	20,750.00

Total (Lump Sum)53,110.00

By: 
T. Jeff Trompeter, P.E., LEED AP BD+C
President

ATTACHMENT H



www.landdesignsouth.com

February 25, 2013
Mark Ugowski
Leo A. Daly
1400 Centrepark Blvd. Suite 500
West Palm Beach, FL 33401

PROPOSAL for PBC Library Annex – Cherry Road

SECTION I: SCOPE OF SERVICES AND PROFESSIONAL FEE SCHEDULE

The following Scope of Services and Professional Fee amounts listed are typically hourly for Representation Services and fixed fees for Preparation Services to complete the services listed. Due to the volatile nature of governmental land use approvals, it is impossible to determine a fixed flat fee for the representation aspects of a project. The actual Representation fees are based on our current hourly rates. Please note, although preparation fees are fixed flat amounts, they are subject to the restrictions and limitations listed under the "Scope of Services" and "Additional Work" sections of the proposal. The project will be billed monthly based on the hours worked for each phase.

LANDSCAPE DESIGN SERVICES

\$9,750.00

- Development of design concept and theory integrating the landscape and feature elements.
- Preparation of conceptual planting plans for all planting areas. These plans will depict species, size and relationships of plant materials.
- Meet with architect, client, engineer or other professional concerning the landscape design.
- Preparation of landscape drawings for submittal and representation of drawings before Palm Beach County, if necessary.
- Preparation of base maps from architects and engineer's construction drawings.
- Preparation of final working drawings for landscaped areas including exterior landscape strips, accent areas, and planters.
- Preparation of final plant schedule identifying the plant species, common name, botanical name, size, quantity, specifications and special requirements.
- This proposal anticipates four (4) submittals for review

\$2,500.00	Design Development
\$3,000.00	50% Construction Documentation
\$3,000.00	100% Construction Documentation
\$ 250.00	Bidding Assistance
\$1,000.00	Construction Administration

IRRIGATION DESIGN SERVICES

- **Contract Documentation** **\$6,250.00**
 - Preparation of base maps from engineer's and surveyor's drawings.
 - Preparation of irrigation design and construction drawings.
 - Preparation of construction documents suitable for submittal to local governmental body for a building permit.

\$1,000.00	Design Development
\$2,000.00	50% Construction Documentation
\$2,000.00	100% Construction Documentation
\$ 250.00	Bidding Assistance
\$1,000.00	Construction Administration

SECTION II: ADDITIONAL SERVICES

The Scope of Services which is identified under this proposal as being included with the fee schedule cannot contemplate certain elements which are not controlled by our firm. The changes created by our clients, by governmental agencies, or yet a third entity which are beyond control of our firm, are not included in this proposal and are considered additional work. The following are some examples of items which are included in the proposal and those that are not:

Items included in this proposal are as follows:

- Documents and drawings for a complete application to a listed governmental agency if noted under Scope of Services.
- Attendance and representation at the number and types of meetings described under Scope of Services.
- Modification to documents prepared by Land Design South of Florida, Inc. to bring them into conformance with written code requirements through Development Review Committee.

Items not considered as part of this proposal are as follows:

- Additional revisions to drawings above the number listed in this proposal.
- Preparation of revisions to documents after governmental submittal or changes requested by client, governmental agencies or third entities that are not listed as code requirement.
- Revisions to documents based on Conditions of Approval placed on a project.
- Attendance at additional meetings, site observation, public hearings, or other events which are not specified in this proposal.
- Preparation of additional documents, drawings or coordination with other professionals is not considered part of this proposal.
- Preparation of revisions to drawings based on incomplete information being provided by client or other consultants, or changes in the project program.

At the request of the client, or as identified in the Scope of Services, Land Design South of Florida, Inc. shall provide additional work on an hourly basis based on our current hourly rates.

Rate Range/Hr.

Principal	\$175 - \$195
Director	\$135 - \$150
Sr. Project Manager	\$125
Project Manager	\$110
Environmental Scientist	\$110
Planner	\$85
Designer	\$85

Land Design South of Florida, Inc. retains the right to post a marketing/information sign on the subject property.

If the terms of this proposal are acceptable, please sign and return to our office as soon as possible.

Sincerely,

LAND DESIGN SOUTH OF FLORIDA, INC.



Brian Terry, RLA, ASLA, LEED AP
Principal

BKT/cm

ACCEPTED AND APPROVED:

I have read the foregoing proposal and accept the terms and conditions contained herein.

Authorized Agent

Date

Name Printed

Firm Name (if other than addressed)

Billing Address

Phone #

Fax #



February 22, 2013
January 25, 2013

Leo A Daly
1400 Centrepark Boulevard, Suite 500
West Palm Beach, Florida 33401

Attention: Mr. Mark A. Ugowski, AIA
Senior Associate, Senior Project Manager

Re: Proposal for Geotechnical Engineering Study
Proposed Palm Beach County Library Annex
West Palm Beach, Florida
TSF Proposal No. 1301-042 Revised

Dear Mark:

TIERRA SOUTH FLORIDA, Inc. (TSF) is pleased to submit this proposal for providing subsurface exploration at the site of the subject project. This proposal includes a summary of our understanding of the project, an outline of our proposed scope of work, an estimate of the total job cost, and our anticipated schedule for completion of the work.

PROJECT INFORMATION

Limited information regarding the proposed development is available at this time. We understand that the proposed construction will consist of a 1-story structure that will include material receiving, cataloguing & distribution facility with office and tractor trailer loading dock. The proposed building will cover an area of approximately 30,000 square feet. The project site is located along Cherry Road, in West Palm Beach, Florida. We assume the entire site is accessible to truck mounted drill rigs. Loading information has not been provided at this time.

PROPOSED SCOPE OF WORK

We propose to drill five (5) Standard Penetration Test (SPT) borings to a depth of 20 feet below existing grade, and three (3) auger borings to a depth of 6 feet below existing grade. Additionally, we propose to perform one (1) Bore Hole Permeability (BHP) test per South Florida Water Management District (SFWMD) standards. Some adjustments in the boring depths may be necessary depending upon the subsurface conditions encountered.

Within the borings, penetration resistance testing will be performed in general accordance with the requirements of ASTM designations D 1586. Borings will be approximately located in the field by our drilling personnel by measuring distances with a tape from known reference points. Elevations at boring locations can be interpreted from a topographic plan if furnished by others.

Prior to drilling at the project site, TSF will notify the local utility companies and request that underground utilities be marked. Our experience, however, is that the utility companies will not mark privately owned utilities. Our proposal assumes that private utility lines will be located in the field by others prior to mobilization of the drill rig. TSF will recommend a utility line locating service upon request.

Upon completion of the field exploration, visual classifications will be performed and some laboratory testing, if necessary, will be performed on select samples.

A geotechnical engineer will evaluate the results of all drilling and laboratory testing. A report will be issued for each phase that contains the exploration data, a discussion of the site and subsurface conditions, geotechnical recommendations for foundation and pavement design, and a discussion of some construction considerations.

ESTIMATED COST

It is proposed that the fee for the performance of the services outlined above is determined in accordance with the attached fee schedule, and that the work is performed pursuant to the TSF General Conditions enclosed herewith and incorporated into this proposal.

SCHEDULE AND AUTHORIZATION

TSF will proceed with the work after receipt of a signed copy of this proposal. With our present drilling schedule, we can commence work within several days of project approval (weather permitting) and fieldwork will take about one day to complete. The written report can be submitted about two weeks after completion of the field exploration, depending on the extent of the laboratory-testing program. Verbal preliminary recommendations can be made to appropriate parties prior to submittal of the written report.

**PBC Library Annex
Proposal No. 1301-042 Revised**

- 3 -

We appreciate the opportunity to submit this proposal and look forward to working with you on this project. If you should have any questions concerning our proposal, please contact our office.

Respectfully submitted,

TIERRA SOUTH FLORIDA, INC.



Francois Thomas, P.E.
Principal Engineer

Attachment: Exhibit A (Detailed Fee Schedule--Tierra South Florida)
TSF General Conditions

AUTHORIZED BY:	INVOICE TO:
Firm:	Firm:
Name:	Name:
Title:	Address:
Date:	Phone #:
	Fax #:

TIERRA SOUTH FLORIDA, INC.
FEE SCHEDULE FOR GEOTECHNICAL SERVICES

	Unit	# of Units	Unit Price		Total
I. FIELD INVESTIGATION					
Mobilization of Men and Equipment	Trip	1	\$	350.00	\$ 350.00
Track-Mounted Equipment					
Standard Penetration Test Borings (By Track-Mounted Equipment)					
0 - 50 ft depth	L.F.	100	\$	12.00	\$ 1,200.00
50 - 100 ft depth	L.F.	0	\$	14.00	\$ 0.00
Grout-Seal Boreholes (By Track-Mounted Equipment)					
0 - 50 ft depth	L.F.	100	\$	5.50	\$ 550.00
50 - 100 ft depth	L.F.	0	\$	4.00	\$ 0.00
Casing Allowance (By Track-Mounted Equipment)					
0 - 50 ft depth	L.F.	0	\$	6.00	\$ 0.00
50 - 100 ft depth	L.F.	0	\$	8.00	\$ 0.00
Auger-Borings	L.F.	18	\$	9.00	\$ 162.00
Borehole Permeability Test	Each	1	\$	275.00	\$ 275.00
II. LABORATORY TESTING					
Visual Examination by Engineer	Hour	4	\$	115.00	\$ 460.00
Grain-Size Analysis - Full Gradation	Test	1	\$	75.00	\$ 75.00
Organic Content Tests	Test	1	\$	50.00	\$ 50.00
III. FIELD ENGINEERING AND TECHNICAL SERVICES					
Boring Layout/Utility Coordination					
Engineering Technician	Hour	4	\$	60.00	\$ 240.00
IV. ENGINEERING AND TECHNICAL SERVICES					
Principal Engineer	Hour	2	\$	145.00	\$ 290.00
Senior Geotechnical Engineer	Hour	8	\$	125.00	\$ 1,000.00
Engineer, P.E.	Hour	0	\$	115.00	\$ 0.00
Draftperson	Hour	3	\$	60.00	\$ 180.00
Administrative Assistant	Hour	0	\$	40.00	\$ <u>0.00</u>
TOTAL FEE FOR GEOTECHNICAL SERVICES			\$		4,832.00

SC. EDULE 1

LIST OF PROPOSED SBE-M/WBE PRIME AND/OR SUBCONSULTANT PARTICIPATION

PROJECT NAME OR BID NAME: PBC Library Annex

PROJECT NO: 13201

NAME OF PRIME CONSULTANT: Leo A Daly

THIS DOCUMENT IS TO BE COMPLETED BY THE PRIME CONSULTANT AND SUBMITTED WITH PROPOSAL. PLEASE LIST THE NAME, CONTACT INFORMATION AND DOLLAR AMOUNT OR PERCENTAGE OF WORK TO BE COMPLETED BY ALL SBE -M/WBE SUBCONSULTANTS ON THIS PROJECT. IF THE PRIME IS AN SBE-M/WBE, PLEASE ALSO LIST THE NAME, CONTACT INFORMATION AND DOLLAR AMOUNT OR PERCENTAGE OF WORK TO BE COMPLETED BY THE PRIME ON THIS PROJECT. THE PRIME AFFIRMS THAT IT WILL MONITOR THE SBES LISTED TO ENSURE THE SBES PERFORM THE WORK WITH ITS OWN FORCES.

Name	(Check one or both Categories)		DOLLAR AMOUNT OR PERCENTAGE OF WORK				
	M/WBE Minority Business	SBE Small Business	Black	Hispanic	Woman	Caucasian	Other (Please Specify)
1. Gartek Engineering 4723 West Atlantic Ave. #A18 Delray Beach, FL	<input checked="" type="checkbox"/>	<input checked="" type="checkbox"/>	\$ _____	\$44,330	\$ _____	\$ _____	\$ _____
2. Civil Design, Inc 312 9 th Street West Palm Beach, FL	<input type="checkbox"/>	<input checked="" type="checkbox"/>	\$ _____	\$ _____	\$ _____	\$53,110	\$ _____
3. ONMJ 321 LA Kirksey St, Ste 200 West Palm Beach, FL	<input type="checkbox"/>	<input checked="" type="checkbox"/>	\$ _____	\$ _____	\$ _____	\$20,070	\$ _____
4. Land Design South 2101 Centrepark West Ste 100 West Palm Beach, FL	<input type="checkbox"/>	<input checked="" type="checkbox"/>	\$ _____	\$ _____	\$ _____	\$16,000	\$ _____
5. Tierra South 2765 Vista Parkway West Palm Beach, FL	<input checked="" type="checkbox"/>	<input checked="" type="checkbox"/>	\$ _____	\$ _____	\$ _____	\$ _____	\$4,860

(Please use additional sheets if necessary)

Total Price \$349,602

Total SBE-M/WBE Participation Dollar Amount or Percentage of Work: \$138,370

I hereby certify that the above information accurate to the best of my knowledge:

[Signature]
Signature

Vice President
Title

Note:

1. The amount listed on this form for a subconsultant must be supported by price or percentage listed on the signed Schedule 2 or signed proposal in order to be counted toward goal attainment.
2. Firms may be certified by Palm Beach County as an SBE and/or and M/WBE. If firms are certified as both an SBE and M/WBE, please indicate the dollar amount or percentage under the appropriate category.
3. M/WBE information is being collected for tracking purposes only.

Revised 9/7/2011
Revised 7/30/2012

SCHEDULE # 2

LETTER OF INTENT TO PERFORM AS AN SBE OR M/WBE SUBCONSULTANT

PROJECT NO. #13201 PROJECT NAME: Library Annex

TO: LFO A DALY
(Name of Prime Consultant)

The undersigned is certified by Palm Beach County as a(n) - (check one or more, as applicable):

Small Business Enterprise X

Black _____ Hispanic X Women _____ Caucasian _____ Other (Please Specify) _____

Date of Palm Beach County Certification: August 30, 2013

The undersigned is certified by the State of Florida:

Minority Business Enterprise X

The undersigned is prepared to perform the following described work in connection with the above project (Specify in detail particular work items or parts thereof to be performed):

Mechanical Electrical Plumbing (MEP) Engineering Design

at the following price \$ 44,330
(Subconsultant's fee)

and will enter into a formal agreement for work with you conditioned upon your execution of a contract with Palm Beach County.

If undersigned intends to sub-subcontract any portion of this subcontract to a non-certified SBE subconsultant, the amount of any such subcontract must be stated: \$ _____

The undersigned subconsultant understands that the provision of this form to prime consultant does not prevent subconsultant from providing services to other consultants.

Gartek Engineering Corporation

(Print name of SBE-M/WBE Subconsultant)

By: 
(Signature)

Mel Garcia, PE, LEED AP, Vice President
(Print name/title of person executing on behalf of SBE-M/WBE Subconsultant)

Date: 3/1/13

SCHEDULE # 2

LETTER OF INTENT TO PERFORM AS AN SBE OR M/WBE SUBCONSULTANT

PROJECT NO. #13201

PROJECT NAME: Library Annex

TO: LEO A DALY
(Name of Prime Consultant)

The undersigned is certified by Palm Beach County as a(n) - (check one or more, as applicable):

Small Business Enterprise X

Black _____ Hispanic _____ Women _____ Caucasian X Other (Please Specify) _____

Date of Palm Beach County Certification: May 20, 2010

The undersigned is certified by the State of Florida:

Minority Business Enterprise _____

The undersigned is prepared to perform the following described work in connection with the above project (Specify in detail particular work items or parts thereof to be performed):

Civil Engineering to include water, sewer, paving, grading and drainage related services along with off-site left turn lane.

at the following price \$ 53,110
(Subconsultant's fee)

and will enter into a formal agreement for work with you conditioned upon your execution of a contract with Palm Beach County.

If undersigned intends to sub-subcontract any portion of this sub-contract to a non-certified SBE subconsultant, the amount of any such subcontract must be stated: \$ _____

The undersigned subconsultant understands that the provision of this form to prime consultant does not prevent subconsultant from providing services to other consultants.

Civil Design, Inc.
(Print name of SBE-M/WBE Subconsultants)

By: [Signature]
(Signature)

T. Jeff Trompeter, President
(Print name/title of person executing on behalf of SBE-M/WBE Subconsultant)

Date: 3/1/13

SCHEDULE # 2

LETTER OF INTENT TO PERFORM AS AN SBE OR M/WBE SUBCONSULTANT

PROJECT NO. #13201

PROJECT NAME: Library Annex

TO: LEO A DALY

(Name of Prime Consultant)

The undersigned is certified by Palm Beach County as a(n) - (check one or more, as applicable):

Small Business Enterprise X

Black _____ Hispanic _____ Women _____ Caucasian X Other (Please Specify) _____

Date of Palm Beach County Certification: 7/18/2011

The undersigned is certified by the State of Florida:

Minority Business Enterprise _____

The undersigned is prepared to perform the following described work in connection with the above project (Specify in detail particular work items or parts thereof to be performed):

Structural Architecture

at the following price \$ 20,070

(Subconsultant's fee)

and will enter into a formal agreement for work with you conditioned upon your execution of a contract with Palm Beach County.

If undersigned intends to sub-subcontract any portion of this subcontract to a non-certified SBE subconsultant, the amount of any such subcontract must be stated: \$ _____

The undersigned subconsultant understands that the provision of this form to prime consultant does not prevent subconsultant from providing services to other consultants.

ONM&J
(Print name of SBE/M/WBE Subconsultants)

By [Signature]
(Signature)

Dwayne Jackson, P.E.
(Print name/title of person executing on behalf of SBE-M/WBE Subconsultant)

Date: 3/1/13

SCHEDULE # 2

LETTER OF INTENT TO PERFORM AS AN SBE OR M/WBE SUBCONSULTANT

PROJECT NO. #13201

PROJECT NAME: Library Annex

TO: LEO A DALY
(Name of Prime Consultant)

The undersigned is certified by Palm Beach County as a(n) - (check one or more, as applicable):

Small Business Enterprise X

Black _____ Hispanic _____ Women _____ Caucasian X Other (Please Specify) _____

Date of Palm Beach County Certification: _____

The undersigned is certified by the State of Florida:

Minority Business Enterprise _____

The undersigned is prepared to perform the following described work in connection with the above project (Specify in detail particular work items or parts thereof to be performed):

Landscape Architecture

at the following price \$ \$16,000
(Subconsultant's fee)

and will enter into a formal agreement for work with you conditioned upon your execution of a contract with Palm Beach County.

If undersigned intends to sub-subcontract any portion of this subcontract to a non-certified SBE subconsultant, the amount of any such subcontract must be stated: \$ _____

The undersigned subconsultant understands that the provision of this form to prime consultant does not prevent subconsultant from providing services to other consultants.

Land Design South of Florida, Inc.
(Print name of SBE-M/WBE Subconsultants)

By: Karen Bentz
(Signature)

Karen Bentz
(Print name/title of person executing on behalf of SBE-M/WBE Subconsultant)

Date: 3/1/13

SCHEDULE # 2

LETTER OF INTENT TO PERFORM AS AN SBE OR M/WBE SUBCONSULTANT

PROJECT NO. #13201 PROJECT NAME: Library Annex

TO: LEO A DALY
(Name of Prime Consultant)

The undersigned is certified by Palm Beach County as a(n) - (check one or more, as applicable):

Small Business Enterprise X

Black _____ Hispanic _____ Women _____ Caucasian _____ Other (Please Specify) X (Asian)

Date of Palm Beach County Certification: 2/16/2012 - 2/15/2015

The undersigned is certified by the State of Florida:

Minority Business Enterprise X

The undersigned is prepared to perform the following described work in connection with the above project (Specify in detail particular work items or parts thereof to be performed):

Geotechnical Engineering Services

at the following price \$ 4,860
(Subconsultant's fee)

and will enter into a formal agreement for work with you conditioned upon your execution of a contract with Palm Beach County.

If undersigned intends to sub-subcontract any portion of this subcontract to a non-certified SBE subconsultant, the amount of any such subcontract must be stated: \$ _____.

The undersigned subconsultant understands that the provision of this form to prime consultant does not prevent subconsultant from providing services to other consultants.

Tierra South Florida, Inc.
(Print name of SBE-M/WBE Subconsultants)
By: [Signature]
(Signature)
Raj Krishnasamy, P.E. / President
(Print name/title of person executing on behalf of SBE-M/WBE Subconsultant)
Date: 3/1/13

13-0770

BOARD OF COUNTY COMMISSIONERS
PALM BEACH COUNTY, FLORIDA

BGEX - 321 - 031813 - 1285

BUDGET TRANSFER
FUND 3752 LIBRARY IMPACT FEES

ACCOUNT NAME AND NUMBER		ORIGINAL BUDGET	CURRENT BUDGET	INCREASE	DECREASE	ADJUSTED BUDGET	EXPENDED/ ENCUMBERED AS OF 03/15/13	REMAINING BALANCE
<u>EXPENDITURES</u>								
<u>ANNEX</u>								
321-L066	6502 Design/Eng/Mgmt-Cip Admin	0	0	165,000	0	165,000	0	165,000
321-L066	6505 Design/Eng/Mgmt-Cip Admin	0	0	449,602		449,602	0	449,602
<u>RESERVES</u>								
321-9900	9909 Res-Improvement Program	628,370	669,231	0	614,602	54,629	0	54,629
TOTAL APPROPRIATIONS & EXPENDITURES				614,602	614,602			

PALM BEACH COUNTY
LIBRARY SYSTEM

INITIATING DEPARTMENT/DIVISION

Administration/Budget Department Approval
OFMB Department - Posted

Signatures & Dates

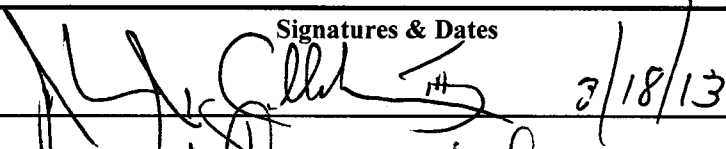
 3/18/13

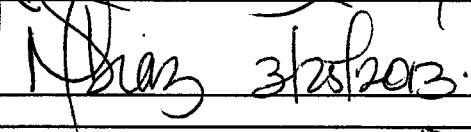
 3/25/2013

2013-2245

BY BOARD OF COUNTY COMMISSIONERS
AT MEETING OF APRIL 16, 2013

Deputy Clerk to the
Board of County Commissioners