

II. FISCAL IMPACT ANALYSIS

A. Five Year Summary of Fiscal Impact:

Fiscal Years	2013	2014	2015	2016	2017
Capital Expenditures	_____	_____	_____	_____	_____
Operating Costs	<u>0</u>	<u>\$1.00</u>	<u>\$1.00</u>	<u>\$1.00</u>	<u>\$1.00</u>
External Revenues	_____	_____	_____	_____	_____
Program Income (County)	_____	_____	_____	_____	_____
In-Kind Match (County)	_____	_____	_____	_____	_____
NET FISCAL IMPACT	<u>0</u>	<u>\$1.00</u>	<u>\$1.00</u>	<u>\$1.00</u>	<u>\$1.00</u>
# ADDITIONAL FTE POSITIONS (Cumulative)	_____	_____	_____	_____	_____

Is Item Included in Current Budget: Yes No

Budget Account No: Fund 0001 Dept 660 Unit 7150 Object 4401
 Program _____

B. Recommended Sources of Funds/Summary of Fiscal Impact:

C. Departmental Fiscal Review: *W* 6-17-13

III. REVIEW COMMENTS

A. OFMB Fiscal and/or Contract Development Comments:

[Signature] 6/20/13
 OFMB *AM 6/19* *6/19* *6/19*

[Signature] 6/21/13
 Contract Development and Control *6-21-13* *[Signature]*

B. Legal Sufficiency:

[Signature] 6/21/13
 Assistant County Attorney

C. Other Department Review:

 Department Director

This summary is not to be used as a basis for payment.

TWP 42

TWP 42

TWP 42

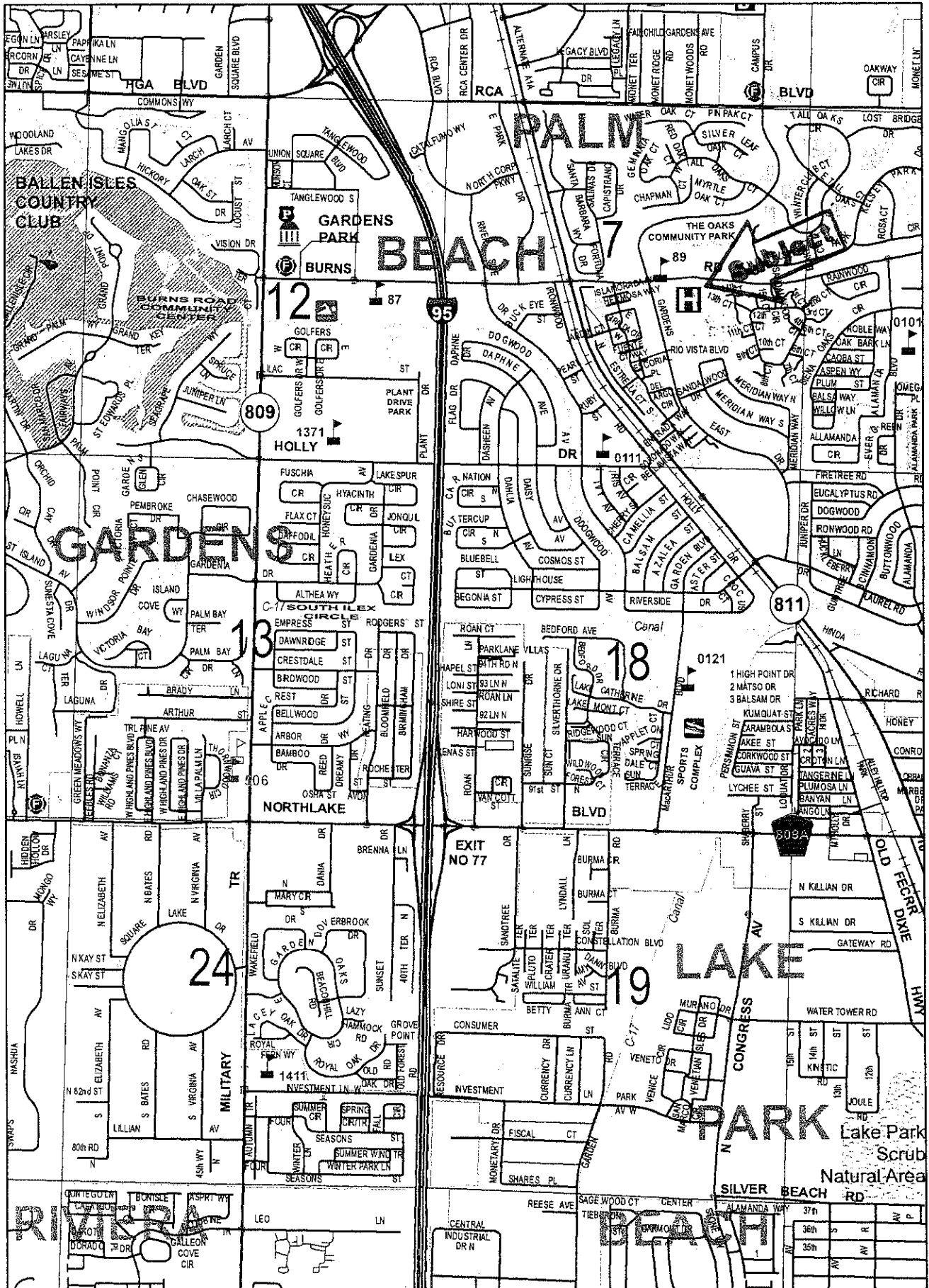

RNG 42

See pg 46

RNG 43

Page 34

LOCATION MAP





July 16, 2013

CERTIFIED MAIL
RETURN RECEIPT REQUESTED

Facilities Development &
Operations Department

Property & Real Estate
Management Division

2633 Vista Parkway

West Palm Beach, FL 33411-5605

(561) 233-0217

FAX: (561) 233-0210

www.pbcgov.com/fdo



Palm Beach County
Board of County
Commissioners

Steven L. Abrams, Mayor

Priscilla A. Taylor, Vice Mayor

Hal R. Valeche

Paulette Burdick

Shelley Vana

Mary Lou Berger

Jess R. Santamaria

County Administrator

Robert Weisman

Lawrence M. Coomes, President
Palm Beach Gardens Community Hospital, Inc.
3360 Burns Road
Palm Beach Gardens, FL 33410

Re: Exercise of Second Option to Extend Agreement (R2004-0324) dated February 24, 2004, by and between the Palm Beach Gardens Community Hospital, Inc. (Lessor) and Palm Beach County (Lessee)

Dear Mr. Coomes:

Pursuant to the provisions of Section 11 of the above referenced Agreement, Palm Beach County, as Lessee, is hereby exercising its second option to extend the term of said Agreement for an additional period of five (5) years from February 24, 2014, through February 23, 2019.

ATTEST:

SHARON R. BOCK,
CLERK & COMPTROLLER

PALM BEACH COUNTY,
a political subdivision of the
State of Florida

By: _____
Deputy Clerk

By: _____
Steven A. Abrams, Mayor

APPROVED AS TO FORM
AND LEGAL SUFFICIENCY

APPROVED AS TO TERMS
AND CONDITIONS

By: 
Assistant County Attorney

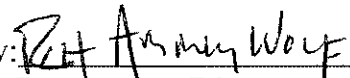
By: 
Department Director

"An Equal Opportunity
Affirmative Action Employer"

G:\PREM\PM\Out Lease\EMS PBG Hospital Relo\Opt 2\OPT 2 05 13 13.hf app 5-16-2013.docx

 printed on recycled paper

BUDGET AVAILABILITY STATEMENT

1104-07

REQUEST DATE: June 4, 2013 REQUESTED BY: Richard C. Bogatin PHONE: 561.233.0214
FAX: 561.233.0210

PROJECT TITLE: EMS PBG Hospital Opt #2 PROJECT NO.: 2013-5.013

Fiscal Years	2014	2015	2016	2017	2018
Capital Expenditures					
Operating Costs	\$1.00	\$1.00	\$1.00	\$1.00	\$1.00
External Revenues					
Program Income (County)					
In-Kind Match (County)					
NET FISCAL IMPACT	\$1.00	\$1.00	\$1.00	\$1.00	\$1.00
# ADDITIONAL FTE POSITIONS (Cumulative)					

** By signing this BAS your department agrees to these staff costs and your account will be charged upon receipt of this BAS by FD&O. Unless there is a change in the scope of work, no additional staff charges will be billed.

BUDGET ACCOUNT NUMBER

FUND: 0001 DEPT: 660 UNIT: 7150 OBJ: 4401
SUB OBJ:

IS ITEM INCLUDED IN CURRENT BUDGET: YES NO

IDENTIFY FUNDING SOURCE FOR EACH ACCOUNT: (check all that apply)

- Ad Valorem (source/type: _____)
- Non-Ad Valorem (source/type: _____)
- Grant (source/type: _____)
- Park Improvement Fund (source/type: _____)
- General Fund
- Operating Budget
- Federal/Davis Bacon

SUBJECT TO IG FEE? YES NO

Department: Public Safety

BAS APPROVED BY: Stephanie Depina DATE: 6/6/13

ENCUMBRANCE NUMBER: 0001-660-7150-4401