

**PALM BEACH COUNTY
BOARD OF COUNTY COMMISSIONERS
AGENDA ITEM SUMMARY**

Meeting Date: September 10, 2013

Consent Regular
 Workshop Public Hearing

Department:

Submitted By: Department of Airports

Submitted For:

I. EXECUTIVE BRIEF

Motion and Title: Staff recommends motion to approve: Amendment No. 3 to the General Consulting Agreement with CH2M Hill, Inc. for Consulting/Professional Services in the amount of \$317,582.26 and to exercise the first one (1) year renewal option for the continued performance of professional planning and design services related to the approved Palm Beach County Airports Capital Improvement Program.

Summary: The Consulting Agreement (R-2011-1333) with CH2M Hill, Inc. for general airport planning and design was approved on September 13, 2011 in the amount of \$1,521,708 in order to carry out the approved Capital Improvement Programs for the County's Airports. The agreement is for 2 years with two, one (1) year renewal options. Approval of Amendment No. 3 in the amount of \$317,582.26 approves the first one (1) year renewal option for the continuation of services provided under this Agreement and will provide funds to complete the following tasks and services: Task I Services –Palm Beach International Airport (PBIA) 3400 Belvedere Road Overflow Parking Design Services; PBIA Navigational Aids (NAVAIDS) Relocation Design and Bidding Services; PBIA Federal Inspection Services (FIS) Expansion Construction Administration Services; Level II Tasks – 2013 Annual Environmental Compliance Monitoring, Inspection and Training Services; Task III Services – Miscellaneous Planning and Engineering Services; Miscellaneous Financial Consulting and Capital Programming Services; and Miscellaneous Environmental Consulting Services. CH2M Hill, Inc. is an Englewood, Colorado based firm, however, the majority of the work to be completed in this Agreement will be completed and/or managed through their Palm Beach Gardens, Florida office in conjunction with several Palm Beach County-based subconsultants and firms. Certain tasks performed during the term of this Amendment may be eligible for State and Federal grant participation. The Disadvantaged Business Enterprise (DBE) goal for the agreement was established at 25.00%. The DBE participation for this Amendment is 41.98%. The total anticipated DBE participation to date is 29.60%. **Countywide (JCM)**

Background and Justification: In order to carry out the approved Capital Improvement Program for the County, the Department of Airports requires professional planning and design engineering services. This agreement is for 2 years with 2 one (1) year renewal options. This amendment allows for the continuation of services necessary for the development and operation of the County's airport system, by exercising the first one (1) year renewal option.

Attachments:

- 1. Amendment No. 3 with CH2M Hill, Inc. – 3 Originals

Recommended By: JA Sam Kelly 8/15/13
Department Director Date

Approved By: [Signature] 8/14/13
County Administrator Date

II. FISCAL IMPACT ANALYSIS

A. Five Year Summary of Fiscal Impact:

Fiscal Years	2013	2014	2015	2016	2017
Capital Expenditures	\$317,582.26	_____	_____	_____	_____
Operating Costs	_____	_____	_____	_____	_____
External Revenues (Grants)	_____	_____	_____	_____	_____
Program Income (County)	_____	_____	_____	_____	_____
In-Kind Match (County)	_____	_____	_____	_____	_____
NET FISCAL IMPACT	\$317,582.26	_____	_____	_____	_____
# ADDITIONAL FTE POSITIONS (Cumulative)	_____	_____	_____	_____	_____

Is Item Included in Current Budget? Yes X No _____

Budget Account No: Fund 4111/4100 Department 121/120 Unit A107/1140/A306 Object 6505/3140/6211
Reporting Category _____

B. Recommended Sources of Funds/Summary of Fiscal Impact:

Funds are available in the above referenced accounts. Funding for the FIS Expansion is from PFC's. Funding for all other tasks is from Airport Local Revenue.

C. Departmental Fiscal Review: CM Sumner

III. REVIEW COMMENTS

A. OFMB Fiscal and/or Contract Development and Control Comments:

[Signature] 8/20/13
OFMB [Signature] 8/21/13

[Signature] 8/22/13
Contract Dev. and Control
8-22-13 B. Wheeler

B. Legal Sufficiency:

[Signature] 8/27/13
Assistant County Attorney

C. Other Department Review:

Department Director

AMENDMENT NO. 3 TO CONTRACT
BETWEEN
PALM BEACH COUNTY DEPARTMENT OF AIRPORTS
AND
CH2M HILL, INC.
FOR
GENERAL CONSULTING SERVICES FOR
ARCHITECTURAL, ENGINEERING, CONSTRUCTION
MANAGEMENT AND LAND DEVELOPMENT

AMENDMENT NO. 3 TO CONTRACT

BETWEEN

PALM BEACH COUNTY DEPARTMENT OF AIRPORTS

AND

CH2M HILL, INC.

FOR

**GENERAL CONSULTING SERVICES FOR ARCHITECTURAL, ENGINEERING,
CONSTRUCTION MANAGEMENT, AND LAND DEVELOPMENT**

This Amendment No. 3 to the Contract is made as of the _____ day of _____, 2013, by and between Palm Beach County, Florida (County) and CH2M HILL, Inc., a corporation authorized to do business in the State of Florida, hereinafter referred to as the CONSULTANT, having its office and principal place of business at 3001 PGA Boulevard, Suite 300, Palm Beach Gardens, Florida 33410 whose Federal Tax I.D. number is 59-0918189.

WITNESSETH

WHEREAS, on September 13, 2011, the County entered in to an Agreement (R2011 1333) with the CONSULTANT for the CONSULTANT to provide General Airport Consulting Services for the Palm Beach County Department of Airports, for a period of twenty-four (24) months with up to two (2) additional twelve (12) month renewals at the County's Option (the Contract); and

WHEREAS, on June 5, 2012 the County approved Amendment No. 1 (R2012 0826) to agreement (R2011 1333) with the CONSULTANT; and

WHEREAS, on May 7, 2013 the County approved Amendment No. 2 (R2013 0532) to agreement (R2011 1333) with the CONSULTANT; and

WHEREAS, Article 2 of the Contract defines the performance period of the contract as twenty-four (24) months, with up to two (2) additional twelve (12) month renewal options, the exercise of which are within County's sole control and discretion, and

WHEREAS, it is the County's desire to exercise the first twelve (12) month renewal option for the continuation of services provided by the CONSULTANT under this contract, and

WHEREAS, Article 25 of the Contract requires an amendment when the parties are able to define additional services and the parties have now defined those services.

NOW THEREFORE, in considerations of the mutual covenants herein contained, and such other good and valuable consideration, the receipt of which the parties hereby acknowledge, the parties agree to the following terms and conditions.

1. The parties hereby agree to amend the Contract to include the Scope of Services and Fees as outlined in Attachment "A". The total amount to be paid by the County to the CONSULTANT for professional services, including any out of pocket expenses shall not exceed \$317,582.26 (Three Hundred Seventeen Thousand Five Hundred Eight Two Dollars and Twenty Six Cents) for services included in this Amendment No. 3 to the original Contract.

2. Reference Amendment No. 3 Index as attached hereto for the full and complete list of Task and Attachment documents which reflect and summarize all additions and revisions as incorporated hereto by this Amendment No. 3. All documents as included in the Amendment No. 3 Index are incorporated fully by reference into this Amendment.
3. **EXHIBIT "B"**

TABLE I SCHEDULE OF HOURLY LABOR BILLING RATES

Hourly Billing Rates and Descriptions revised as indicated in EXHIBIT "B" Table I Schedule of Hourly Labor Billing Rates.

4. The parties hereby agree to amend the Contract to include the first of one (1) year renewal option for the continuation of services provided by the CONSULTANT under this Contract.
5. Except as specifically amended herein, all other terms and conditions of the Contract shall remain in full force and effect.

IN WITNESS WHEREOF, the parties have caused the Third Amendment to the Contract to be signed by the Chairman of the Board of County Commissioners and the Seal of said Board to be fixed hereto and attested by the Clerk of said board, and the CONSULTANT, CH2M HILL, has caused these present to be signed in its corporate name by its duly authorized officer Mark Callahan, acting on behalf of said CONSULTANT, and the Seal of said CONSULTANT to be affixed hereto and attested by the Secretary of said CONSULTANT, the day and year first written above.

ATTEST:

PALM BEACH COUNTY, FLORIDA
BOARD OF COUNTY COMMISSIONERS

SHARON R. BOCK
CLERK AND COMPTROLLER

By: _____
Deputy Clerk

By: _____
Steven L. Abrams, Mayor

WITNESS:

CONSULTANT:

[Signature]
SIGNATURE

CH2M Hill, Inc.
COMPANY NAME

Kwana Felton
Name (type or print)

[Signature]
Signature

Mark Callahan, P.E.
Name (type or print)

APPROVED AS TO FORM
AND LEGAL SUFFICIENCY

Business Vice President
Title

BY: _____

County Attorney

(Corporate Seal)

APPROVED AS TO TERMS
AND CONDITIONS

By: [Signature]
Department Director



AMENDMENT NO. 3

INDEX

CERTIFICATE OF INSURANCE

ATTACHMENT "A" AMENDMENT NO. 3

EXHIBIT "A" SCOPE OF WORK FOR TASK I AND II SPECIFIC PROJECTS

EXHIBIT A-I-17	TASK I-13-PBI-C-017 Palm Beach International Airport PBI 3400 Belvedere Road Overflow Parking Design Services.....	1-4
EXHIBIT A-I-18	TASK I-13-PBI-C-018 Palm Beach International Airport NAVAIDS Relocation Design and Bidding Services.....	5-9
EXHIBIT A-I-19	TASK I-13-PBI-C-019 Palm Beach International Airport FIS Expansion Construction Administration Services	10-12
EXHIBIT A-II-2	TASK II-13-DOA-C-002 Palm Beach County Department of Airports 2013 Annual Environmental Compliance Monitoring, Inspection and Training Services.....	13-19

EXHIBIT B – DETAILED FEES, EXPENSES, AND PAYMENTS

EXHIBIT B – TABLE I Schedule of Hourly Labor Billing Rates.....	1-1
EXHIBIT B-I Summary of Fees	1-3
EXHIBIT B-II Schedule of Payments.....	1-2
EXHIBIT C – PROPOSED SCHEDULES.....	C-1
EXHIBIT D – Disadvantaged Business Enterprise Compliance	D-1

CERTIFICATE OF INSURANCE



CERTIFICATE OF LIABILITY INSURANCE

DATE (MM/DD/YYYY)
05/08/2013

THIS CERTIFICATE IS ISSUED AS A MATTER OF INFORMATION ONLY AND CONFERS NO RIGHTS UPON THE CERTIFICATE HOLDER. THIS CERTIFICATE DOES NOT AFFIRMATIVELY OR NEGATIVELY AMEND, EXTEND OR ALTER THE COVERAGE AFFORDED BY THE POLICIES BELOW. THIS CERTIFICATE OF INSURANCE DOES NOT CONSTITUTE A CONTRACT BETWEEN THE ISSUING INSURER(S), AUTHORIZED REPRESENTATIVE OR PRODUCER, AND THE CERTIFICATE HOLDER.

IMPORTANT: If the certificate holder is an ADDITIONAL INSURED, the policy(ies) must be endorsed. If SUBROGATION IS WAIVED, subject to the terms and conditions of the policy, certain policies may require an endorsement. A statement on this certificate does not confer rights to the certificate holder in lieu of such endorsement(s).

PRODUCER MARSH USA INC. 1225 17TH STREET, SUITE 2100 DENVER, CO 80202-5534 15114-12345-5EX5P-13/14 027382	CONTACT NAME: PHONE (A/C, No, Ext): FAX (A/C, No): E-MAIL ADDRESS:	
	INSURER(S) AFFORDING COVERAGE	
INSURED CH2M HILL, INC. 9191 SOUTH JAMAICA STREET ENGLEWOOD, CO 80112	INSURER A: Greenwich Insurance Company NAIC # 22322	
	INSURER B: National Union Fire Ins Co Pittsburgh PA 19445	
	INSURER C: XL Insurance America, Inc. 24554	
	INSURER D: Zurich American Insurance Co 16535	
	INSURER E: INSURER F:	

COVERAGES **CERTIFICATE NUMBER:** SEA-002405041-01 **REVISION NUMBER:** 1

THIS IS TO CERTIFY THAT THE POLICIES OF INSURANCE LISTED BELOW HAVE BEEN ISSUED TO THE INSURED NAMED ABOVE FOR THE POLICY PERIOD INDICATED. NOTWITHSTANDING ANY REQUIREMENT, TERM OR CONDITION OF ANY CONTRACT OR OTHER DOCUMENT WITH RESPECT TO WHICH THIS CERTIFICATE MAY BE ISSUED OR MAY PERTAIN, THE INSURANCE AFFORDED BY THE POLICIES DESCRIBED HEREIN IS SUBJECT TO ALL THE TERMS, EXCLUSIONS AND CONDITIONS OF SUCH POLICIES. LIMITS SHOWN MAY HAVE BEEN REDUCED BY PAID CLAIMS.

INSR LTR	TYPE OF INSURANCE	ADDL INSR	SUBR WVD	POLICY NUMBER	POLICY EFF (MM/DD/YYYY)	POLICY EXP (MM/DD/YYYY)	LIMITS
A	GENERAL LIABILITY <input checked="" type="checkbox"/> COMMERCIAL GENERAL LIABILITY <input type="checkbox"/> CLAIMS-MADE <input checked="" type="checkbox"/> OCCUR <input checked="" type="checkbox"/> \$500,000 SIR GEN'L AGGREGATE LIMIT APPLIES PER: <input type="checkbox"/> POLICY <input type="checkbox"/> PRO-JECT <input type="checkbox"/> LOC	X	X	RGE500025602	05/01/2013	05/01/2014	EACH OCCURRENCE \$ 1,500,000 DAMAGE TO RENTED PREMISES (Ea occurrence) \$ 1,500,000 MED EXP (Any one person) \$ PERSONAL & ADV INJURY \$ 1,500,000 GENERAL AGGREGATE \$ 5,000,000 PRODUCTS - COMP/OP AGG \$ 5,000,000
A	AUTOMOBILE LIABILITY <input checked="" type="checkbox"/> ANY AUTO <input type="checkbox"/> ALL OWNED AUTOS <input type="checkbox"/> SCHEDULED AUTOS <input type="checkbox"/> HIRED AUTOS <input type="checkbox"/> NON-OWNED AUTOS	X	X	RAD500025402 (AOS) RAD500025602 (MA)	05/01/2013	05/01/2014	COMBINED SINGLE LIMIT (Ea accident) \$ 2,000,000 BODILY INJURY (Per person) \$ BODILY INJURY (Per accident) \$ PROPERTY DAMAGE (Per accident) \$
B	<input checked="" type="checkbox"/> UMBRELLA LIAB <input checked="" type="checkbox"/> OCCUR <input type="checkbox"/> EXCESS LIAB <input type="checkbox"/> CLAIMS-MADE DED RETENTION \$	X		BE23465121	05/01/2013	05/01/2014	EACH OCCURRENCE \$ 5,000,000 AGGREGATE \$ 5,000,000
C	WORKERS COMPENSATION AND EMPLOYERS' LIABILITY ANY PROPRIETOR/PARTNER/EXECUTIVE OFFICER/MEMBER EXCLUDED? (Mandatory in NH) If yes, describe under DESCRIPTION OF OPERATIONS below	Y/N	N/A	RWD500025202 (AOS) RWR500025302 (WI)	05/01/2013	05/01/2014	<input checked="" type="checkbox"/> WC STATU-TORY LIMITS <input type="checkbox"/> OTH-ER E.L. EACH ACCIDENT \$ 1,000,000 E.L. DISEASE - EA EMPLOYEE \$ 1,000,000 E.L. DISEASE - POLICY LIMIT \$ 1,000,000
D	PROFESSIONAL LIABILITY*			EOC3829621-11	05/01/2013	05/01/2014	Each Claim & Aggregate \$5,000,000 Each Policy Period

DESCRIPTION OF OPERATIONS / LOCATIONS / VEHICLES (Attach ACORD 101, Additional Remarks Schedule, if more space is required)
PALM BEACH COUNTY BOARD OF COUNTY COMMISSIONERS, A POLITICAL SUBDIVISION OF THE STATE OF FLORIDA, ITS OFFICERS, EMPLOYEES AND AGENTS ARE INCLUDED AS AN ADDITIONAL INSURED ON THE GENERAL LIABILITY AND AUTOMOBILE LIABILITY POLICIES AS REQUIRED BY WRITTEN CONTRACT OR AGREEMENT. PALM BEACH COUNTY BOARD OF COUNTY COMMISSIONERS, A POLITICAL SUBDIVISION OF THE STATE OF FLORIDA, ITS OFFICERS, EMPLOYEES AND AGENTS ARE INCLUDED AS ADDITIONAL INSURED ON THE UMBRELLA POLICY ABOVE. COVERAGE PROVIDED BY THE ABOVE GENERAL LIABILITY AND AUTO POLICIES SHALL BE PRIMARY AND NON-CONTRIBUTORY AND IS LIMITED TO THE LIABILITY RESULTING FROM THE NAMED INSURED'S OWNERSHIP AND/OR OPERATIONS. GENERAL LIABILITY AND AUTO LIABILITY INCLUDE SEPARATION OF INSUREDS AND NO CROSS SUITS EXCLUSION.

CERTIFICATE HOLDER PALM BEACH COUNTY BOARD OF COUNTY COMMISSIONERS ATTN: JERRY ALLEN, DEPUTY DIRECTOR OF AIRPORTS 846 PALM BEACH INTERNATIONAL AIRPORT WEST PALM BEACH, FL 33406	CANCELLATION SHOULD ANY OF THE ABOVE DESCRIBED POLICIES BE CANCELLED BEFORE THE EXPIRATION DATE THEREOF, NOTICE WILL BE DELIVERED IN ACCORDANCE WITH THE POLICY PROVISIONS. AUTHORIZED REPRESENTATIVE of Marsh USA Inc. Sharon A. Hammer <i>Sharon A. Hammer</i>
---	---

© 1988-2010 ACORD CORPORATION. All rights reserved.



ADDITIONAL REMARKS SCHEDULE

AGENCY MARSH USA INC.		NAMED INSURED CH2M HILL, INC. 9191 SOUTH JAMAICA STREET ENGLEWOOD, CO 80112
POLICY NUMBER		
CARRIER	NAIC CODE	EFFECTIVE DATE:

ADDITIONAL REMARKS
 THIS ADDITIONAL REMARKS FORM IS A SCHEDULE TO ACORD FORM,
 FORM NUMBER: 25 FORM TITLE: Certificate of Liability Insurance

GENERAL LIABILITY AND AUTOMOBILE LIABILITY POLICIES INCLUDE A WAIVER OF SUBROGATION. *FOR PROFESSIONAL LIABILITY COVERAGE, THE AGGREGATE LIMIT IS THE TOTAL INSURANCE AVAILABLE FOR CLAIMS PRESENTED WITHIN THE POLICY PERIOD FOR ALL OPERATIONS OF THE INSURED. THE LIMIT WILL BE REDUCED BY PAYMENTS OF INDEMNITY AND EXPENSE.

AMENDMENT NO. 3
TO
CONTRACT FOR CONSULTING/PROFESSIONAL
SERVICES
(CONTRACT R2011 1333)

ATTACHMENT "A"

AMENDMENT NO. 3

This Amendment No. 3 is in accordance with the Contract for Consultant/Professional Services by and between Palm Beach County (COUNTY) and CH2M HILL (CONSULTANT) dated September 13, 2011. The fees to be paid CH2M HILL are as estimated by the CONSULTANT and shown on Exhibit 'B'.

The following Exhibits outline the Scope of Services included within this Amendment for the following Services:

EXHIBIT A-I-17	TASK I-13-PBI-C-017	Palm Beach International Airport PBI 3400 Belvedere Road Overflow Parking Design Services
EXHIBIT A-I-18	TASK I-13-PBI-C-018	Palm Beach International Airport NAVAIDS Relocation Design and Bidding Services
EXHIBIT A-I-19	TASK I-13-PBI-C-019	Palm Beach International Airport FIS Expansion Construction Administration Services
EXHIBIT A-II-2	TASK II-13-DOA-C-002	Palm Beach County Department of Airports 2013 Annual Environmental Compliance Monitoring, Inspection and Training Services

PALM BEACH COUNTY GENERAL CONSULTING SERVICES

EXHIBIT "A-I-17"

Task Scope Sheet

Task No. I-13-PBI-C-017

Palm Beach International Airport
PBI 3400 Belvedere Road Overflow Parking Design Services

Overview

The Palm Beach County Department of Airports (DOA) has requested that CH2M HILL (CONSULTANT) provide professional services associated with the design of an overflow parking lot proposed on the west side of 8th Street, directly across from Building 3400 Belvedere Road. In addition, the existing parking lot located at Building 3400 currently experiences flooding during heavy rainfall events. The DOA has requested that CONSULTANT evaluate the existing flooding issues and include recommended improvements as a part of the overflow parking lot contract documents.

The improvements included in the contract documents are construction of a parking lot to accommodate 60 vehicle spaces, drainage improvements, signage (stop signs), pavement markings, landscape buffer, parking lot protection (curbing), and lighting. CONSULTANT understands based on discussions held during a pre-scoping meeting on June 26, 2013 that a site plan approval, landscaping and irrigation will not be required for the overflow parking lot improvements based on prior communication between DOA and PBC Planning, Building and Zoning. The DOA has requested that a landscape buffer be provided along Belvedere Road on the north side of the parking lot. Therefore, preparation of a site plan for County approval, landscape and irrigation improvements within the limits of the overflow parking lot are not included in this scope of work. The basis for this scope of services is the June 17, 2013 overflow parking lot concept (Option 4) and is attached to this scope of work. The estimated construction cost for the overflow parking lot and drainage improvements is \$300,000.

CONSULTANT understands that the DOA will utilize Palm Beach County's annual contract for construction. Therefore, no bidding or construction services are anticipated to be required and are not included in this scope of work.

CONSULTANT will provide professional services including: storm water design and permitting; lighting design, and preparation of construction documents. Bid and Award, Construction Administration and Construction Management Services are not included in this scope of services and will be included in a separate task authorization, if necessary. Preliminary design, topographic survey, geotechnical investigations and subsurface investigation services will be completed under Task III-13-PBI-C-001-022.

As part of this project, CONSULTANT will perform the following tasks 1 through 7:

1. Attend One (1) DOA Design Kick-Off Meeting;

Task I-13-PBI-C-017
Palm Beach International Airport
PBI 3400 Belvedere Road Overflow Parking Design Services

A-1

July 2013

-
2. Attend One (1) DOA Design Submittal Review Meeting (90% Submittal);
 3. Prepare 90%, and 100% Contract Documents including: Technical Specifications, Drawings, Project Schedule, and Cost Estimate;
 4. Prepare and Submit South Florida Water Management District (SFWMD) Conceptual ERP Letter Modification;
 5. Task Management;
 6. Task Coordination (DOA, SFWMD, other Consultants, and other interested project Stakeholders);
 7. Task Independent Technical Review (ITR) - Quality Assurance/ Quality Control.

This document outlines the proposed approach to accomplish these tasks.

Scope of Services

CONSULTANT's performance will be divided into two categories of services, Basic Services and Special Services. Basic Services will be performed as detailed in this Scope of Services. Special Services will be performed by CONSULTANT as authorized by the DOA's representative under a separate Task Authorization.

Project Team

CONSULTANT's subcontractors include ADA Engineering, Inc. (Drainage Design and SFWMD Permitting) and Hillers Electrical Engineering, Inc. (Electrical).

1.0 TASK 1 - PRELIMINARY DESIGN

Preliminary design, topographic survey, geotechnical investigations and subsurface investigation services will be completed by CONSULTANT under Task III-13-PBI-C-001-022.

2.0 TASK 2 – 90% CONTRACT DOCUMENTS

The 90% complete Contract Documents Deliverables will include the following items 1-21:

1. 90% Cover;
2. 90% Drawing Index and Summary of Quantities;
3. 90% General, Safety, and Security Notes;
4. 90% Safety Plan;
5. 90% Survey Control Plan;
6. 90% Boring/Coring Location Plan and Logs;
7. 90% Typical Sections and Details;
8. 90% Storm Water Pollution Prevention Plan and Details;
9. 90% Demolition Plan;
10. 90% Paving and Geometry Plan;
11. 90% Grading and Drainage Plans;
12. 90% Drainage Details;
13. 90% Landscape Buffer Plan and Details;
14. 90% Marking and Signage Plan;
15. 90% Marking and Signage Details;
16. 90% Electrical Legend, Notes, and Details;
17. 90% Electrical Demolition Plan;

-
18. 90% Electrical Lighting Layout and Circuitry Plan;
 19. 90% Project Schedule;
 20. 90% Technical Specifications;
 21. 90% Project Construction Cost Estimate.

CONSULTANT will prepare a letter modification and submit to SFWMD. A Construction ERP is not anticipated to be required and is not included in this scope of work. CONSULTANT will attend one design review meeting with the DOA.

3.0 TASK 3 – 100% CONTRACT DOCUMENTS

The 100% complete Contract Documents Deliverables will include the following items 1-21:

1. 100% Cover;
2. 100% Drawing Index and Summary of Quantities;
3. 100% General, Safety, and Security Notes;
4. 100% Safety Plan;
5. 100% Survey Control Plan;
6. 100% Boring/Coring Location Plan and Logs;
7. 100% Typical Sections and Details;
8. 100% Storm Water Pollution Prevention Plan and Details;
9. 100% Demolition Plan;
10. 100% Paving and Geometry Plan;
11. 100% Grading and Drainage Plans;
12. 100% Drainage Details;
13. 100% Landscape Buffer and Details;
14. 100% Marking and Signage Plan;
15. 100% Marking and Signage Details;
16. 100% Electrical Legend, Notes, and Details;
17. 100% Electrical Demolition Plan;
18. 100% Electrical Lighting Layout and Circuitry Plan;
19. 100% Project Schedule;
20. 100% Technical Specifications;
21. 100% Project Construction Cost Estimate.

CONSULTANT will submit final drawings for DOA submittal of permit applications. CONSUTLANT will prepare and submit a letter modification to the current SFWMD Master ERP for PBIA. In consideration that the project has minimal additional impervious area and will utilize complete onsite retention, it is anticipated that submittal of a letter modification will be sufficient with no additional coordination or correspondence with SFWMD staff necessary. No permitting services, other than preparation of the SFWMD letter modification, are included in this scope of services.

Project Deliverables

The Project Design Deliverables will include the following items 1-3:

1. 90% Contract Documents (Drawings, Technical Specifications and Cost Estimate);
2. 100% Contract Documents (Drawings, Technical Specifications and Cost Estimate);
3. SFWMD ERP Letter Modification.

Project Schedule

This task will be completed within 45 calendar days from issuance of Notice to Proceed.

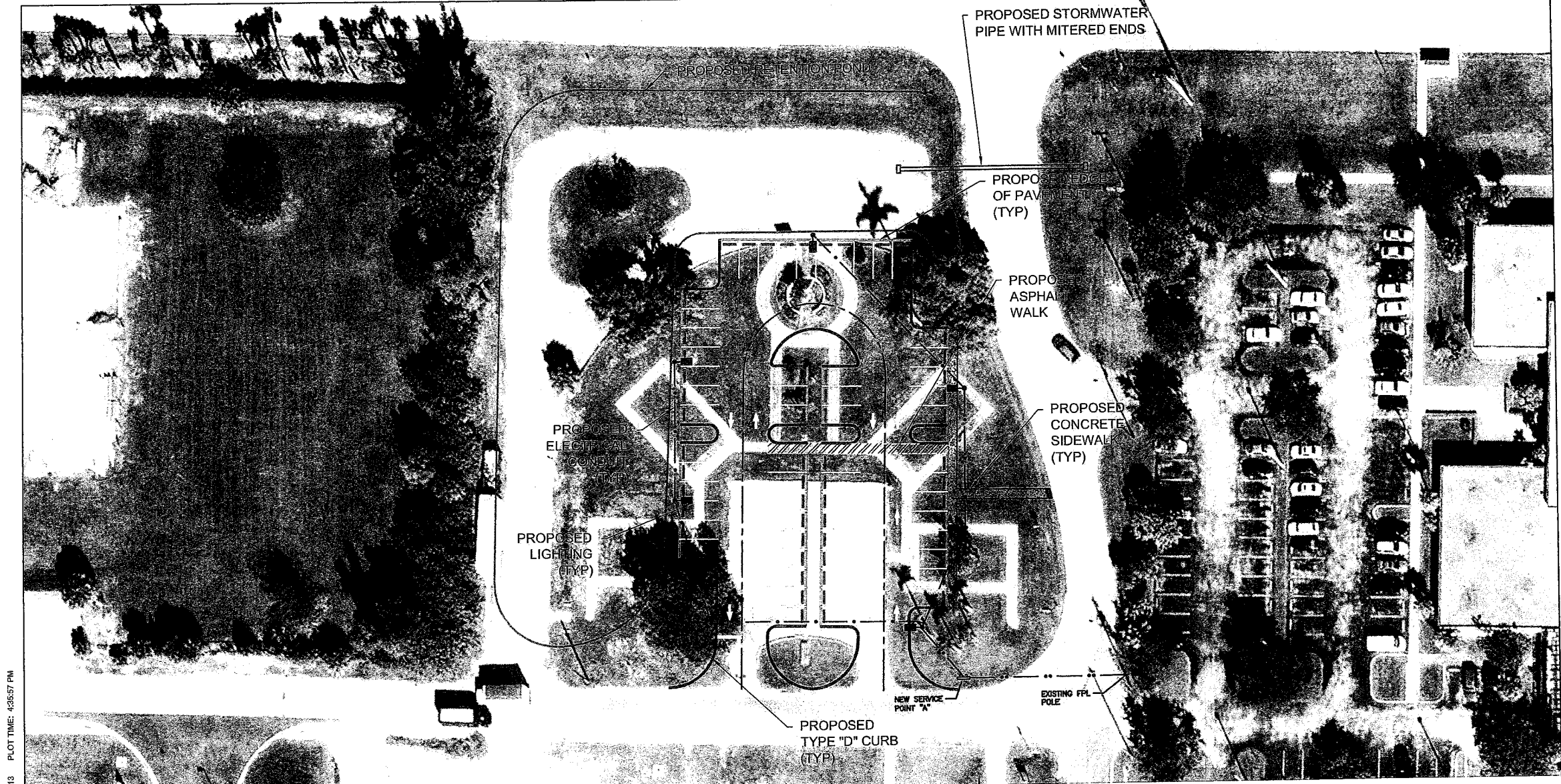

FILENAME: 38PBK06concept04.dwg PLOT DATE: 6/17/2013 PLOT TIME: 4:35:57 PM

DRAFT - FOR DISCUSSION PURPOSES ONLY

PALM BEACH INTERNATIONAL AIRPORT
 3400 BELVEDERE ROAD
 CONCEPTUAL PARKING LOT - OPTION 4
 VEHICLE PARKING SPACES = 60

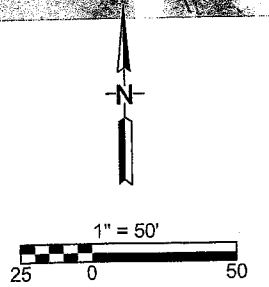

PALM BEACH COUNTY GENERAL CONSULTING SERVICES

EXHIBIT "A-I-18"

Task Scope Sheet

Task I-13-PBI-C-018

Palm Beach International Airport
NAVAIDS Relocation Design and Bidding Services

Overview

The Palm Beach County Department of Airports (DOA) has requested that CH2M HILL, INC. (CONSULTANT) and Hillers Electrical Engineering, Inc. (SUBCONSULTANT) provide professional engineering services for relocation of existing NAVAIDS including Runway 32 PAPI and REIL power / control pedestal system modifications within Runway 14-32 safety area, new elevated Runway Guard Lights (RGL) at the West End of Taxiway L, and new Runway 28L Approach holding position sign and marking on Taxiway F south at Palm Beach International Airport (PBI). These modifications and improvements will be incorporated into the construction documents associated with the North-South Taxiway Project (Task I-13-PBI-C-009) at PBI.

Scope of Services

CONSULTANT's performance will be divided into two categories of services, Basic Services and Special Services. Basic Services will be performed as detailed in this Scope of Services. Special Services will be performed by CONSULTANT as authorized by the DOA's representative under a separate Task Authorization.

Project Team

CONSULTANT's subconsultant for this task is Hillers Electrical Engineering, Inc. (Airfield Electrical / NAVAIDS).

Basic Services

Basic Services for this task will follow four (4) distinct Phases, Phases 1-4. Phase 1 will consist of Preliminary Design (Approx. 15% Design Completion). Phase 2 is Design Development (Approx. 30% Design Completion). Phase 3 will consist of progress submittals of sixty percent (60%, Phase 3A), ninety percent (90%, Phase 3B), and final design completion (100%, Phase 3C) of the Contract Documents. Phase 4 will consist of Bidding and Award of the Contract Documents.

A brief definition follows for each of the Phases included in this scope of services:

Phase 1 – CONSULTANT will prepare graphics and a written preliminary design report narrative for inclusion in the North-South Taxilane project documents including conceptual development of significant project elements and the projected cost for the project.

Phase 2 – CONSULTANT will perform site verification, data collection and preliminary layout of the work. CONSULTANT will coordinate with the DOA and receive approval of the design concept. CONSULTANT will develop the approved preliminary design documents (30% Completion) from approved DOA concept developed in Phase 1. CONSULTANT will estimate the project budget for construction costs and develop preliminary work staging, phasing and maintenance of traffic, airfield electrical, signage and marking plans.

Phase 3A – CONSULTANT will develop the Contract Documents to a predetermined completion milestone (60% Completion). CONSULTANT will update the project preliminary cost budget estimate, project manual, work staging, phasing and maintenance of traffic, airfield electrical, signage and marking plans.

Phase 3B – CONSULTANT will develop the Contract Documents to a predetermined completion milestone (90% Completion) to allow the project to be permitted and reviewed by the appropriate agencies including the Federal Aviation Administration (FAA), as required. CONSULTANT will update the project cost budget estimate, project manual, work staging, phasing and maintenance of traffic, airfield electrical, signage and marking plans.

Phase 3C – CONSULTANT will complete the Contract Documents to 100% to allow the project to be bid and constructed. CONSULTANT will prepare the final project cost budget estimate, project manual, work staging, phasing and maintenance of traffic, airfield electrical, signage and marking plans.

Phase 4 – CONSULTANT will assist the DOA in obtaining Bids and in the Award of the Construction Contract including responding to bidders questions associated with the scope of work specified herein.

The following summarizes CONSULTANT's Basic Services tasks 1 through 13:

1. Task Management and Coordination (CONSULTANT);
2. Conduct on-site verifications and perform preliminary records research / data collection of existing FAA and DOA records for Runway 14-32, Taxiway L, Taxiway F, and Runway 10R-28L survey control, NAVAIDS, electrical, lighting, and signage system modifications and improvements (CONSULTANT and SUBCONSULTANT);
3. Prepare electrical calculations to define electrical loading of proposed work on each affected circuit (SUBCONSULTANT);
4. Design Runway 32 Precision Approach Path Indicator (PAPI) / Runway End Identifier Light (REIL) power / control pedestals relocated outside of Runway 32 Safety Area (RSA) including new conductor and conduit systems, disconnects, transformers, grounding, new equipment mounting pedestal, installation details and layouts and modifications to the existing 4 Box PAPI lighting units (SUBCONSULTANT);
5. Design new elevated Runway Guard Lighting (RGL) System at the West End of Taxiway L runway holding position per the FAA AC 150/5300-13A, current edition including new conductor and conduit systems, elevated guard light units and mounting pads,

-
- connections to existing RGL lighting circuit and installation details and layout plans (SUBCONSULTANT);
6. Design new Runway 28L Approach holding position sign and markings including relocation of an existing taxiway guidance sign (CONSULTANT and SUBCONSULTANT);
 7. Prepare Survey Control Plans based on owner furnished survey of Runway 14-32 and 10R-28L ends performed by Woolpert, November 2009 (CONSULTANT);
 8. Prepare Safety, Work Staging, Phasing and Maintenance of Traffic Plans for inclusion in the North-South Taxilane Contract Documents (CONSULTANT);
 9. Incorporate / Update North-South Taxilane Contract Documents Drawing Index, Summary of Quantities, General, Safety and Security Notes associated with the NAVAIDs relocation and improvements (CONSULTANT);
 10. Provide FAA specifications, electrical bid line items and cost estimates (SUBCONSULTANT);
 11. Update the 60%, 90% and 100% North-South Taxilane Project Manual to incorporate NAVAIDs Relocation scope of work including invitation to bid, bid price form, table of contents, etc. (CONSULTANT);
 12. Provide one set of phasing, maintenance of traffic, general notes, and electrical design drawings at the 30%, 60%, 90%, 100% and Bid & Award submittals for inclusion in the North-South Taxilane Contract Documents (CONSULTANT and SUBCONSULTANT);
 13. Provide Bid & Award Services associated with the NAVAIDs relocation and improvements (CONSULTANT and SUBCONSULTANT).

Project Deliverables

As required under Phases 1, 2, 3A, 3B, 3C and 4 summarized in this scope of services.

Project Schedule

CONSULTANT will complete this project within 305 calendar days in accordance with the schedule outlined in the North-South Taxilane Project (Task I-13-PBI-C-009).

Special Services

Special Services will be authorized in writing by the DOA, describing the scope and fee for the services prior to beginning. Special Services cannot be included as Basic Services because their need or exact scope cannot be fully established until underway.

Special Services during Phases 1, 2, 3, and 4 may be, but are not limited to, a selection(s) from the following:

1. Perform or obtain the services of a subconsultant to perform subsurface investigations, including performance of test borings, soil samples, foundation investigations, laboratory analyses of the samples, and engineering analyses not anticipated as Basic Services. CONSULTANT or the subconsultant will prepare a draft final and final report of all findings and CONSULTANT will deliver to the DOA representative two (2) copies of the draft final and final report.

2. Perform or obtain the services of a registered professional land surveyor subconsultant to perform field surveys and investigations in order to establish or verify boundaries and monuments, perform topographic surveys, perform route surveys, prepare property or easement descriptions, perform associated office work under the direction of a registered professional surveyor, and deliver to the DOA representative a Mylar of all final plats with field notes in bound standard size field books and electronic format of said information, or in such other form as approved by the DOA.
3. Make revisions to drawings, specifications, or other documents when such revisions are inconsistent with approvals or instructions previously given by the DOA representative.
4. Perform or obtain the services of a specialized subconsultant to perform aerial photography and computer mapping.
5. Travel to points outside the DOA if such travel is reasonably necessary to accomplish the task.
6. Prepare special studies and reports, such as environmental documents including representation and testimony at hearings and community meetings, grant applications, etc.
7. Provide the services of an independent cost estimator, as a subconsultant, to make a comprehensive cost estimate for the project in a form satisfactory to the DOA, which independent cost estimate will be in addition to the cost estimate prepared by CONSULTANT.
8. Provide, in the event of termination, such services as are reasonable and necessary for preserving partially finished work products or for the recording of work products in a particular manner, including the making of record prints of drawings, etc.
9. Assist the DOA representative in securing any special licenses or permits, South Florida Water Management District, DER, etc., which may be required for the completion of the project, it being understood by the parties that the fees for said special licenses and permits will be paid by the DOA.
10. Reproduce plans, specifications, reports, and other materials other than those reproductions included in the Basic Services and excluding reproduction for the office use of CONSULTANT and CONSULTANT'S subconsultants.
11. Provide a scale model or renderings of the project when requested by the DOA.
12. Provide any other additional services related to the project not otherwise included in the Basic Services of other Special Services and not customarily furnished in accordance with generally accepted architectural and engineering practice.

Special Services may also be requested for the Phase 5 construction phase. These services will include, but not limited to, the following:

1. Consult with the DOA concerning replacement of any construction work damaged by fire or other causes and furnish professional services as may be required in connection with the replacement of such work.
2. Assist the DOA in making arrangements for the work to proceed in the event that the construction contractor is declared in default by the DOA for any reason.
3. Assist the DOA as expert witnesses and/or factual witnesses in any legal proceedings or litigation arising from the development, permitting, or construction of the project. The witnesses will be designated by and at the sole discretion of the DOA Attorney.
4. Travel to points outside the DOA if such travel is reasonably necessary to accomplish a task.

-
5. Prepare special studies and reports, such as environmental documents, including representation and testimony at hearings and community meetings, grant applications, etc.
 6. Reproduce plans, specifications, reports, and other materials other than those reproductions included in the Basic Services and excluding reproduction for the office use of CONSULTANT and CONSULTANT's subconsultants.
 7. Provide the services of an independent cost estimator, as a subconsultant, to make a comprehensive cost estimate for the project in a form satisfactory to the DOA, which independent cost estimate will be in addition to the cost estimate prepared by CONSULTANT.
 8. Provide, in the event of termination, such services as are reasonable and necessary for preserving partially finished work products or for the recording of work products in a particular manner, including the making of record prints of drawings, etc.
 9. Provide, in the event the project construction exceeds the time stated in the project contract documents, the continuing services required to be accomplished by CONSULTANT during the construction of the project.
 10. Provide any other additional services related to the project not otherwise included in the Basic Services of other Special Services and not customarily furnished in accordance with generally accepted architectural and engineering practice.

PALM BEACH COUNTY GENERAL CONSULTING SERVICES

EXHIBIT "A-I-19"

Task Scope Sheet

Task I-13-PBI-C-019

**Palm Beach County Department of Airports
Palm Beach International Airport
FIS Expansion Construction Administration Services**

Overview

Palm Beach County Department of Airports (DOA) has requested that CH2M HILL, Inc. (CONSULTANT) and its Subconsultants, Michael Baker Jr., Inc. and Tierra South Florida, Inc., provide professional construction administration services associated with the FIS Expansion project at Palm Beach International Airport. The project will be constructed by the County's CM at Risk Contractor, Morganti (Contractor).

The DOA previously retained the professional services of Michael Baker Jr. Inc., the "Notice to Proceed" being issued on March 4, 2009, to design and develop the necessary Construction Documents for the modernization and expansion of the existing Custom/FIS facilities to meet then current Federal guidelines and requirements.

The Scope of Services for this task authorization consists of providing Professional Construction Administration and Threshold Inspection Services for renovating approximately 6,000 S.F. of Immigration and Customs offices, passenger area and baggage claim area. In addition three immigration positions will be added and an existing flat plate carousel will be replaced with a larger sloped plate carousel capable of handling new incoming flights as specified by the DOA. An exterior existing wall will be removed to allow for an expansion of approximately 2,100 S.F. of additional space. The existing exterior canopy will be expanded by approximately 1,600 S.F. to allow for a covered baggage loading area. Total affected area will be 9,700 S.F.

Because of the sensitive nature of the space, the need to maintain continuous operation during construction and the required expansion and upgrades to the existing security and communication system, close coordination with the DOA and the Custom and Immigration Services will be required.

Scope of Services

CONSULTANT and SUBCONSULTANTS will perform the following tasks 1 through 13:

1. Task management (CONSULTANT);
2. Coordination with DOA and Contractor during construction phase (Michael Baker Jr., Inc.);
3. Prepare a threshold inspection plan in accordance with 2010 Palm Beach County Amendments to FBC-110.3.7.1 (Michael Baker Jr., Inc.);

-
4. Attend the pre-construction meeting and review minutes prepared by the Contractor (Michael Baker Jr., Inc.);
 5. Attend a maximum of eighteen (18) bi-weekly construction progress meetings and review minutes prepared by the Contractor (Michael Baker Jr. Inc.);
 6. Review shop drawings and submittals and approve (or take appropriate action in respect of) shop drawings, samples and other data required to be submitted by the Contractor, but only for conformance with the design concept of the project and compliance with the information provided in the Contract Documents (Michael Baker Jr. Inc.);
 7. Review pay applications and estimate the amounts to be paid to the Contractor (Michael Baker Jr., Inc.);
 8. Review test results or other data required to be submitted by the Contractor, but only for conformance with the design concept of the project and compliance with the information provided in the Contract Documents (Michael Baker Jr. Inc.);
 9. Perform a maximum of thirty-six (36) weekly site visits to observe the construction progress of the project and determine in general if such work is proceeding in accordance with the Contract Documents and keep the DOA informed of the progress of the work (Michael Baker Jr., Inc.);
 10. Respond to Requests for Information (RFIs) issued by the Contractor during the construction phase (Michael Baker Jr., Inc);
 11. Provide threshold inspection and quality acceptance materials testing services (Tierra South Florida, Inc.);
 12. Conduct a maximum of one (1) substantial, prepare punch list, and conduct one (1) final completion site inspections and verify, in conjunction with the DOA, that all punch list items have been completed in accordance with the Contract Documents (Michael Baker Jr., Inc.);
 13. Prepare Record Drawings based on Contractor red-line as-builts (Michael Baker Jr., Inc.).

For the purposes of this project, Michael Baker Jr., Inc. will coordinate directly with the DOA, Contractor and Tierra South Florida, Inc. CH2M HILL's scope of services for this project is limited to task management consisting of preparation of subconsultant agreements, review and processing of SUBCONSULTANT invoices, and general project administration duties with respect to the CONSUTLANT's prime contract agreement with DOA throughout the 270 Calendar Day construction schedule.

Assumptions

1. DOA will provide SUBCONSULTANTS access to the site and all available information pertinent to the project.
2. CONSULTANT's scope of services is limited to task management and does not include preparation of reports, site visits, inspections, and attendance at meetings, review and approval of shop drawings, samples or submittals. SUBCONSULTANTS will be responsible for those portions of the scope of services as indicated herein.
3. SUBCONSUTLANTS will coordinate directly with DOA and Contractor.

Project Deliverables

1. Threshold Inspection Plan in PDF format (Michael Baker Jr. Inc.);

-
2. Review of pre-construction meeting minutes and provide comments via email (Michael Baker Jr., Inc);
 3. Review of bi-weekly construction progress meeting minutes and provide comments via email (Michael Baker Jr., Inc.);
 4. Review of shop drawings/submittals and provide review via email in PDF format (Michael Baker Jr., Inc);
 5. Review of monthly pay applications and provide comments via email (Michael Baker Jr., Inc.);
 6. Provide a maximum of 36 site inspection reports via email in PDF format (Michael Baker Jr., Inc.);
 7. Provide responses to RFIs via email in PDF format (Michael Baker Jr., Inc.);
 8. Provide threshold inspection and quality acceptance testing reports via email in PDF format (Tierra South Florida, Inc.);
 9. Provide substantial and final completion inspection punch lists via email in PDF format (Michael Baker, Jr. Inc.);
 10. Provide one (1) hard copy of Record Drawings in 11x17 and 24x36 and CD containing electronic AutoCAD and PDF files (Michael Baker Jr., Inc.).

Project Schedule

CONSULTANT will complete this project within 270 calendar days from receipt of Notice-to-Proceed. The Notice-to-Proceed is anticipated to be issued to the Construction Contractor in December 2013 with Final Completion / Project Closeout in August 2014.

PALM BEACH COUNTY GENERAL CONSULTING SERVICES

EXHIBIT A-II-2

Task Scope Sheet

Task II-13-DOA-C-002

Palm Beach County Department of Airports
2013 Environmental Compliance Monitoring, Inspection &
Training Services

PROJECT DESCRIPTION

To comply with various state regulatory compliance permit conditions at its four airports (Palm Beach International Airport, North Palm Beach County General Aviation Airport, Palm Beach County Park Airport and Palm Beach Glades Airport), the Palm Beach County Department of Airports (DOA) has requested that CH2M HILL and its Subconsultant Cyriacks Environmental Consulting Services, Inc. (CECOS), provide environmental monitoring, inspection and training services on an annual basis. This scope of work is associated with the 2013 annual environmental compliance monitoring, inspection and training services.

SCOPE OF WORK

The scope of work required to provide a complete project has been developed to meet state regulatory permit conditions and will consist of the following tasks:

1.0 SWPPP REVISIONS, INSPECTIONS AND TRAINING

A Stormwater Pollution Prevention Plan (SWPPP) is mandated by the United States Environmental Protection Agency (EPA) National Pollutant Discharge Elimination System (NPDES) as defined in 40 CFR 122.2. The NPDES is the national program for issuing, modifying, or revoking permits under Sections 307, 318, 402, and 405 of the Clean Water Act. The Florida Department of Environmental Protection (FDEP) is the permitting agency responsible for overseeing the NPDES Program in Florida. According to EPA document 833-B-09-002, *Developing Your Stormwater Pollution Prevention Plan* (February 2009), when new facilities are constructed that affect stormwater control practices; the SWPPP is revised to reflect the changes to the stormwater system. Therefore, as a part of this task, SWPPP revisions will involve Drainage and Basin Delineation Map updates as well as editorial changes to the previous SWPPP documents associated with the four airports managed by the DOA. Editorial changes will be limited to editing and replacing pages related to the tenant list including contact information and Stormwater Best Management Practices (BMPs). This task also includes the 2013 annual compliance inspections and the 2013 training workshop for employees and tenants.

1.1 In-House Data Collection

Upon receipt of the Notice to Proceed, CH2M HILL will forward a Request for Information (RFI) letter to DOA for the following information associated with each airport:

- Updated contact information for the members of the SWPPP Team;

- Updated list of tenants and their contact information;
- Preventive maintenance records;
- Procedural changes to spill response and containment;
- Facility Response Plan (if available).

1.1.1 Tenant Questionnaire

For new tenants, CH2M HILL will distribute a questionnaire to verify the tenant's contact information, identify the type of industrial activities that are currently being conducted in the leasehold, compile a preliminary list of the types of significant materials used and stored in the facility, and compile a preliminary list of BMP's that are currently being employed by the new tenant.

1.1.2 Tenant Notification

Prior to the 2013 annual compliance inspections, CH2M HILL will provide the DOA with the draft Tenant Notification of Inspection letter, NPDES Compliance Commitment Certificate, SWPPP brochure, and Spill Prevention, Control, and Countermeasure (SPCC) pamphlet. These documents will be reviewed and approved by DOA prior to distribution to the tenants. CH2M HILL will distribute the letter for DOA.

Assumptions:

- DOA will provide all SWPPP data from the most recent update, including electronic files;
- DOA will provide Material Safety Data Sheets (MSDS) of significant materials for Airport operated facilities. Significant materials are defined as raw materials; fuels; finished materials such as diesel, gasoline, petroleum products, hydraulic fluid, fertilizer, pesticide, herbicides, sealants, and paint; and waste products that have the potential to be released with stormwater discharges;
- DOA will provide the most recent Drainage and Basin Delineation maps of each Airport in AutoCAD format;
- CH2M HILL will review the as-built plans of new facilities constructed at each airport since the last ALP and Drainage Master Plan updates at DOA's file room;
- CH2M HILL will provide updates to Drainage and Basin Delineation Maps for the four DOA airports based on conditions observed in the field. CH2M HILL assumes field review updates will be minor as the DOA will provide the most current Drainage and Basin Delineation Maps and recently constructed and on-going project files in AutoCAD format for each Airport;
- There are approximately forty-four (44) industrial use tenants at Palm Beach International Airport (PBI);
- There are nine (9) industrial use tenants at North Palm Beach County General Aviation Airport (F45);
- There are approximately twenty (20) industrial use tenants at Palm Beach County Park Airport (Lantana);
- There is one (1) industrial use tenant (Pahokee Aviation) at Palm Beach County Glades Airport (Pahokee).

1.2 Annual Compliance Inspections

1.2.1 Annual Site Compliance Inspections

CH2M HILL's subconsultant, CECOS, will conduct the 2013 annual site compliance inspections to coincide with the drainage structure inspections and tenant inspections for each Airport. During the annual site compliance inspections, CECOS will:

- Field verify identified potential pollutant sources;
- Identify new potential pollutant sources that resulted from recent development projects at the Airports, since the last SWPPP update;
- Field verify as-built maps of structures and facilities that were constructed after the last SWPPP update, necessary for updating the Drainage and Basin Maps;
- Photograph and document the location of new and/or modified drainage patterns and structures;
- Review and photograph current conditions at each Airport; and;
- Verify, photograph, and evaluate current stormwater controls.

1.2.2 Visual NPDES Permitted Drainage Structure Inspections

CECOS will perform a visual drainage structure inspection for each NPDES permitted outfall at each airport. The NPDES permitted drainage structure inspection will be conducted concurrently with annual compliance and tenant inspections. This inspection will document the condition of the structure and visually determine whether the discharge is stormwater runoff or from some other sources that may potentially be an illicit discharge. If an illicit or non-stormwater discharge is identified and further investigation is necessary, additional investigative services will be performed under a separate task authorization. As a part of this inspection, additional drainage structures that are located near buildings or facilities will be inspected at each of the airports to determine the condition of structure, whether it is functioning, blocked or flow is impeded; or if the structure requires maintenance and/or repair. The results of the drainage structure inspections will be documented in the Annual Compliance Inspection Report for each airport. Cost estimates for maintenance and repair activities are not included in this scope of services and if necessary, will be performed under a separate task authorization.

1.2.3 Tenant and DOA Facility Inspections

CECOS will perform Tenant and DOA Facility Inspections in conjunction with the annual compliance and NPDES permitted drainage structure inspections, which will consist of tenant leased hangars, buildings, and DOA Facilities. The inspections will be conducted to field verify the type of industrial activity being performed in the hangars or buildings, identify potential sources of stormwater pollution and BMP's being implemented, compile a list of general significant materials in hangars or buildings, and document the storage locations of these materials and waste disposal methods. This information will be documented in the Annual Compliance Inspection Reports.

Assumptions:

- The Tenant and DOA Facility Inspections will be performed concurrently with the non-stormwater discharge and annual compliance inspections.
- Hangars or buildings that are inaccessible at the time of inspection will not be inspected and will be noted as "Inaccessible" in the Inspection Reports.

1.3 Report Preparation

1.3.1 Annual Compliance Inspection Report

CECOS will prepare the Annual Compliance Inspection Reports that will consist of the following:

- Date of Inspection;
- Results of the visual Non-Stormwater Discharge Inspections including photographs and signed inspection forms from the non-stormwater discharge inspections;
- Results of the tenant inspections including photographs and signed completed industrial tenant inspection forms, tenant questionnaire, and NPDES compliance certificate for each tenant;
- Results of the DOA facility inspections, i.e. fences, waste management, parking areas, buildings, runways, taxiways, and aprons;
- A summary of Recommended BMP's for the airports and tenants.

Assumptions:

- The DOA will provide comments on the revised sections of the SWPPP's and Inspection Reports to CH2M HILL within 30 calendar days of receiving the Plans and Reports;
- One (1) copy of each of the Drafts and two (2) copies of each of the Final Inspection Reports and the revised SWPPP sections will be submitted to the DOA;
- One (1) electronic copy of final revised section of each SWPPP and the Inspection Reports in both Microsoft Word and Adobe Acrobat format will be provided to the DOA;
- If necessary, the development of an Emergency Response Plan will be performed under a separate task authorization;
- If necessary, the design of secondary containment structures for refueling trucks will be performed under a separate task authorization;
- If necessary, the design of stormwater management and control structures will be performed under a separate task authorization;
- If necessary, renewal of the DOA's NPDES Multi-sector General Permit will be performed under a separate task authorization.

1.3.2 Editorial Update of SWPPP's

CECOS will incorporate new tenant and BMP information in the following sections:

- SWPPP Team;
- Tenant List and Contact Information
- Facility description - Tenants (if necessary).
- BMPs for the New Facilities.

An editorial revision for the airports SWPPP's will be completed to update the tenant list and new or modified BMP's. These revisions will consist of replacement pages for the SWPPP.

1.3.3 Tenant Compliance Coordination

CECOS will coordinate with the tenants at each airport to provide the results of the inspections. The results will be mailed to the tenants on behalf of DOA and the results will indicate the types of BMP's that were implemented or that are recommended for each facility necessary for compliance with the NPDES permits for each airport. In addition, tenants with Multi-Sector General Permits (MSGP's) will

use the result of the inspections to comply with their permits. The inspection result package will contain the following items:

1. Cover letter on DOA letterhead;
2. Industrial Tenant Inspection Checklist;
3. Applicable BMP's Checklist(s);
4. Significant Materials Inventory Data Sheet.

Deliverables:

- One (1) compact disc containing both Acrobat files and Microsoft Word files of the revised sections of the SWPPP and Annual Compliance Inspection Report for each airport;
- Two (2) copies of the Updated SWPPP and Annual Inspection Report for each airport.

1.3.4 SWPPP Drainage Map Update

Based on information provided by the DOA, Drainage and Basin Delineation Map updates due to a new facility construction and/or stormwater system or a change to the stormwater system will be performed at the four County airports.

CH2M HILL will update the Drainage and Basin Delineation Map at Palm Beach International Airport to reflect projects recently constructed, permitted, and expected to be under construction at the airport during this task:

- North-South Taxilane, modifications and related stormwater modifications and improvements
- Golfview Development Area ultimate outfall, retention pond and related stormwater modifications and improvements
- Golfview Utilities and Infrastructure and related stormwater modifications and improvements
- Building 3400 Overflow Vehicle Parking Lot and related stormwater modifications and improvements
- Galaxy Parcel S-5 Hangar and Apron Development, and related stormwater modifications and improvements
- Galaxy Apron Expansion and related stormwater modifications and improvements
- Air Traffic Control Tower site redevelopment (TRACON) and related stormwater modifications and improvements
- PBIA Taxiway B, D and E rehabilitation and reconstruction – related geometric modifications and stormwater improvements

CH2M HILL will update the Drainage and Basin Delineation Map at North Palm Beach County General Aviation Airport to reflect projects recently constructed, permitted, and expected to be under construction at the airport during this task:

- Taxiway D and related stormwater modifications and improvements
- Drainage Modifications and related stormwater improvements on the north and east side of the internal cul-de-sac
- Wetland Wildlife Mitigation and related stormwater modifications and improvements

CH2M HILL will update the Drainage and Basin Delineation Map at Palm Beach County Park Airport to reflect projects recently constructed, permitted, and expected to be under construction at the airport during this task:

- Runway 15-33, Taxiway A1, Taxiway B and GA Apron Repairs and Rehabilitation related stormwater modifications and improvements
- Airport Redevelopment – Phase 1 and related stormwater modifications and improvements
- Out Parcel Development and related stormwater modifications and improvements

CH2M HILL will update the Drainage and Basin Delineation Map at Palm Beach County Glades Airport to reflect projects recently constructed, permitted, and expected to be under construction at the airport during this task:

- Airfield Electrical Improvements (Vault) and related stormwater modifications and improvements

The following tasks will be performed:

1. Confirm that all projects have been identified;
2. Research permits to determine permitted and subbasin delineation boundary changes;
3. Coordinate with DOA to acquire latest Basin Delineation and Drainage Map files in AutoCAD format;
4. Coordinate with Design Consultants to acquire individual design files in AutoCAD format;
5. Update Drainage and Basin Delineation Maps.

Assumptions:

- The DOA will provide CH2M HILL with an electronic copy of the latest Drainage and Basin Delineation Map in AutoCAD format;
- The DOA or other Consultants will provide CH2M HILL design files and permitting files associated with projects currently under construction and/or constructed since the last SWPPP update in AutoCAD format.

1.4 Training Workshop

CECOS will conduct a training workshop tailored to existing conditions at each of the Airports to comply with SWPPP requirements. The purpose of the training workshop is to educate Airport staff and tenants regarding the Stormwater Management Pollution Prevention Program and comply with the training requirement of the DOA's MSGP for each Airport.

Assumptions:

- DOA will provide meeting space at each of the Airports at no cost to CH2M HILL;
- DOA will provide electronic copies of the 2012 training materials (Microsoft PowerPoint presentation, a training handout, a class test questionnaire, and a certificate of attendance) to CH2M HILL for modification and use in 2013;
- The training classes will be held after the annual compliance inspections are completed;
- The training classes will be approximately 1.5 to 2 hours in length including the test;

- Reproduction expenses for training class materials are based on the assumption that a maximum number of MS PowerPoint handouts and compact discs would be reproduced for the classes based upon the number of industrial use tenants.

Deliverable:

- Forty-four (44) training booklets, examination forms, and certificates of attendance for the Palm Beach International Airport (PBI);
- Nine (9) training booklets, examination forms, and certificates of attendance for the North Palm Beach County General Aviation Airport (F45);
- Twenty (20) training booklets, examination forms, and certificates of attendance for the Palm Beach County Park Airport (Lantana);
- One (1) training booklet, examination form, and certificate of attendance for the Palm Beach County Glades Airport (Pahokee).

2.0 CONTINGENCY SERVICES

CH2M HILL and its Subconsultant CECOS will provide the following services under a separate task authorization as required for each Airport:

- A. Emergency response and containment including initial containment and evaluation of the spill;
- B. Monitoring of the construction of a fuel system upgrade
- C. Soil sampling of suspect spills;
- D. Supervision of large scale fuel clean ups or remediation;
- E. Other tasks as requested that are related to Tasks 1 and Task 2

Services under Task 2 will be provided based upon the contracted hourly rate plus direct expenses or per event rate.

3.0 CLIENT COORDINATION AND MEETING

3.1 Client Coordination

CECOS will coordinate all project activities with DOA. A maximum of two (2) meetings are anticipated.

3.2 Telephone Meetings

CECOS will coordinate, schedule, and attend a telephone meeting with DOA to discuss the preliminary inspection results of the project with DOA staff. Another meeting will be conducted after the draft inspection reports are submitted to DOA to discuss the results of the inspections, discuss items that require attention and answer any questions that the DOA may have.

3.3 Project Status Reports

All completed activities and project activity schedules for each month will be included in a monthly project progress report.

SCHEDULE

CH2M HILL will initiate project activities immediately upon receipt of authorization to proceed. The anticipated duration of the project is thirteen (13) months.

EXHIBIT "B"
DETAILED FEES, EXPENSES AND PAYMENTS

EXHIBIT "B"
TABLE I
SCHEDULE OF HOURLY LABOR BILLING RATES

The following hourly billing rates are for use during 2013 and apply to the Palm Beach County Department of Airports General Engineering Services Contract.

The CONSULTANT'S key personnel include:

CONSULTANT: Michael Baker Jr, Inc.

DESCRIPTION	HOURLY BILLING RATES
Principal	\$ 201.00
Program Manager	\$ 201.00
Project Manager	\$ 171.00
Senior Engineer/Planner/Architect/Environmental Scientist	\$ 171.00
Engineer/Planner/Architect/Environmental Scientist	\$ 171.00
Designer	\$ 108.00
Technician	\$ 82.00
Senior Inspector	\$ 127.00
Inspector/RPR	\$ 91.00
Clerical	\$ 76.00

CONSULTANT: Tierra South Florida, Inc.

DESCRIPTION	HOURLY BILLING RATES
Threshold Inspector	\$ 70.00

EXHIBIT "B-I"
SUMMARY OF FEES
AMENDMENT NO. 3

TASK		BUDGET
TASK I-13-PBI-C-017	Palm Beach International Airport PBI 3400 Belvedere Road Overflow Parking Design Services	\$ 40,979.75
TASK I-13-PBI-C-018	Palm Beach International Airport NAVAIDS Relocation Design and Bidding Services	\$ 29,668.00
TASK I-13-PBI-C-019	Palm Beach International Airport FIS Expansion Construction Administration Services	\$ 82,333.00
TASK II-13-DOA-C-002	Palm Beach County Department of Airports 2013 Annual Environmental Compliance Monitoring, Inspection and Training Services	\$ 114,601.51
TOTAL - TASK I SERVICES		\$ 267,582.26
TASK III -001	Misc. Planning and Engineering Services	\$ 50,000.00
TASK III -002	Misc. Financial Consulting and Capital Programming Services	\$ -
TASK III -003	Misc. Environmental Consulting Services	\$ -
TOTAL - TASK III SERVICES		\$ 50,000.00
TOTAL CONTRACT AMOUNT		\$ 317,582.26

EXHIBIT "B"
DETAILED FEES, EXPENSES, AND PAYMENTS

A. METHOD OF PAYMENT FOR SERVICES AND EXPENSES OF CONSULTANT:

TASK I AND II SPECIFIC PROJECTS FOR 2013:

For labor and expenses expended by CONSULTANT for Specific 2013 Projects, COUNTY shall pay CONSULTANT the amounts as follows:

Task	Lump Sum Labor Amount	T&M Labor Amount	Lump Sum Expense	Reimbursable Expense	Total Cost
TASK I-13-PBI-C-017 Palm Beach International Airport PBI 3400 Belvedere Road Overflow Parking Design Services	\$40,729.75	\$0.00	\$250.00	\$0.00	\$40,979.75
TASK I-13-PBI-C-018 Palm Beach International Airport NAVAIDS Relocation Design and Bidding Services	\$29,668.00	\$0.00	\$0.00	\$0.00	\$29,668.00
TASK I-13-PBI-C-019 Palm Beach International Airport FIS Expansion Construction Administration Services	\$7,572.00	\$71,882.00	\$0.00	\$2,879.00	\$82,333.00
TASK II-13-DOA-C-002 Palm Beach County Department of Airports 2013 Annual Environmental Compliance Monitoring, Inspection and Training Services	\$110,376.81	\$0.00	\$4,224.70	\$0.00	\$114,601.51
TOTALS	\$188,346.56	\$71,882.00	\$4,474.70	\$2,879.00	\$267,582.26
				T&M SUBTOTAL	\$74,761.00
				LUMP SUM SUBTOTAL	\$192,821.26
				TOTAL COST	\$267,582.26

Paid vacations, holidays, sick leave and leaves of absence are included in the billing rates as CONSULTANT'S overhead and shall not be billed separately.

The Total Time and Materials payment for Task I and II projects as described in Exhibits "A-I-17", "A-1-18", "A-1-19", and "A-II-2" including labor costs is \$71,882.00. Reimbursable Expenses for Task I and II services is \$2,879.00. The Total Lump Sum payment for Task I and II projects as described in Exhibits "A-I-17", "A-1-18", "A-1-19", and "A-II-2" including labor costs is \$188,346.56. Lump Sum Expenses for Task I and II services are \$4,474.70. The Total for Labor and Expenses for Task I and II services shall be \$267,582.26.

If it necessary to increase the compensation beyond said allowances, prior to written approval shall be obtained from the COUNTY authorizing said increase in compensation.

TASK III MISCELLANEOUS AND ADMINISTRATIVE SERVICES FOR 2013:

For labor and expenses expended by CONSULTANT for Miscellaneous Services, COUNTY shall pay CONSULTANT the amounts as follows:

Task	Annual Lump Sum Labor Amount	Annual T&M Amount	Annual Lump Sum Expense	Annual Reimbursable Expense	Annual Total Cost
TASK III -001 Misc. Planning and Engineering Services				\$50,000.00	
TASK III -002 Misc. Financial Consulting and Capital Programming Services				\$0.00	
TASK III -003 Misc. Environmental Consulting Services				\$0.00	
TOTALS					\$50,000.00

Paid vacations, holidays, sick leave and leaves of absence are included in the billing rates as CONSULTANT'S overhead and shall not be billed separately.

EXHIBIT "B-II"

SCHEDULE OF PAYMENTS

The Scope of Work to be completed by CONSULTANT as defined in Exhibit "A" consists of specific completion phases which shall be clearly identified on a phase-by-phase basis upon submission to the COUNTY of certain "deliverables"* as expressly indicated below. Compensation for the work tasks stated herein shall be in accordance with the following Schedule of Payments:

PHASE 1

TASK I-13-PBI-C-017
Palm Beach International Airport
PBI 3400 Belvedere Road Overflow Parking Design Services

Completion Time: 45 Calendar Days
Compensation for Phase 1: \$40,979.75

See Exhibit A for list of deliverables.

TASK I-13-PBI-C-018
Palm Beach International Airport
NAVAIDS Relocation Design and Bidding Services

Completion Time: 305 Calendar Days
Compensation for Phase 1: \$29,668.00

See Exhibit A for list of deliverables.

TASK I-13-PBI-C-019
Palm Beach International Airport
FIS Expansion Construction Administration Services

Completion Time: 270 Calendar Days
Compensation for Phase 1: \$82,333.00

See Exhibit A for list of deliverables.

PHASE 2

TASK II-13-DOA-C-002
Palm Beach County Department of Airports
2013 Annual Environmental Compliance Monitoring,
Inspection and Training Services

Completion Time: 395 Calendar Days
Compensation for Phase 2:

\$114,601.51

See Exhibit A for list of deliverables.

PHASE 3

Task(s) to be Completed:

TASK III -001 Misc. Planning and Engineering Services
Completion Time: TBD Compensation for Phase 3:

\$50,000.00

Deliverable(s) Required: As required in accordance with specific Task Authorizations.

TASK III -002 Misc. Financial Consulting and Capital Programming Services
Completion Time: TBD Compensation for Phase 3:

\$0.00

Deliverable(s) Required: As required in accordance with specific Task Authorizations.

TASK III -003 Misc. Environmental Consulting Services
Completion Time: TBD Compensation for Phase 3:

\$0.00

Deliverable(s) Required: As required in accordance with specific Task Authorizations.

* "Deliverables" shall be defined as progress reports, prepared maps, bid documents, completed drawings, specific reports, work plans, documentation of meetings attended, assessment study reports, analysis reports, summary reports, recommendation reports and related draft reports and verifiable deliverables.

EXHIBIT "B"
AMENDMENT NO. 3
DETAILED FEES, EXPENSES AND PAYMENTS
TASK I-13-PBI-C-017
PALM BEACH INTERNATIONAL AIRPORT
PBI 3400 BELVEDERE ROAD OVERFLOW
PARKING DESIGN SERVICES

Exhibit B

Labor/Fee Estimate Summary - PBI 3400 Belvedere Road Overflow Parking Design Services

Billing Rate:	\$ 227.34	\$ 186.51	\$ 145.86	\$ 117.05	\$ 96.22	\$ 72.80	\$ 71.24	\$ 60.80	\$ 127.51
---------------	-----------	-----------	-----------	-----------	----------	----------	----------	----------	-----------

Task Description	Labor Estimate (Hours)										Fee Estimate (\$)	
	Program Manager / Principal / Senior Consultant	Senior Technologist / Senior Project Manager	Project Manager / Design Manager / Task Leader	Project Engineer / Planner / Associate Project Manager	Staff Engineer / Planner	Design Technician	Graphics Support / Administrative Manager	Admin.	Project Estimator / Scheduler	Total Labor Hours	Total Fee	
Task No I-13-PBI-C-017												
2.0 Contract Documents (Task 2 - 90% Design)	Total	0	0	14	39	51	61	4	14	0	183	\$ 17,181.17
2.01 90% Cover (1 drawing)	0	0	0	0	0	1	0	0	0	0	1	\$ 72.80
2.02 90% Drawing Index and Summary of Quantities (1 drawing)	0	0	0	0	2	2	0	0	0	0	4	\$ 338.04
2.03 90% General and Security Notes (1 drawing)	0	0	0	0	2	2	0	0	0	0	4	\$ 338.04
2.04 90% Safety Notes (1 drawing)	0	0	0	0	2	2	0	0	0	0	4	\$ 338.04
2.05 90% Safety Plan (1 drawing)	0	0	0	2	2	4	0	0	0	0	8	\$ 717.74
2.06 90% Survey Control Plan (1 drawing)	0	0	0	2	4	2	0	0	0	0	8	\$ 764.58
2.07 90% Boring/Coring Location Plan and Logs (1 drawing)	0	0	0	1	1	2	0	0	0	0	4	\$ 358.87
2.08 90% Typical Sections and Details (1 drawing)	0	0	0	2	4	6	0	0	0	0	12	\$ 1,055.78
2.09 90% Demolition Plan (1 drawing)	0	0	0	2	4	4	0	0	0	0	10	\$ 910.18
2.10 90% Paving and Geometry Plan (1 drawing)	0	0	0	2	4	8	0	0	0	0	14	\$ 1,201.38
2.11 90% Grading Plan (1 drawings)	0	0	2	6	8	12	0	0	0	0	28	\$ 2,637.38
2.12 90% Landscape Buffer Plan and Details (1 drawing)	0	0	0	4	4	8	0	0	0	0	16	\$ 1,435.48
2.13 90% Marking and Signage Plan (1 drawing)	0	0	0	2	4	4	0	0	0	0	10	\$ 910.18
2.14 90% Marking and Signage Details (1 drawing)	0	0	0	2	2	4	0	0	0	0	8	\$ 717.74
2.15 90% Project Schedule	0	0	0	0	2	0	0	0	0	0	2	\$ 192.44
2.16 90% Technical Specifications	0	0	2	10	4	0	0	10	0	0	26	\$ 2,455.10
2.17 90% Project Construction Cost Budget Estimate	0	0	0	2	2	0	0	0	0	0	4	\$ 426.54
2.18 Client Review Submittal Meeting, Agenda and Minutes (1)	0	0	2	2	0	0	0	2	0	0	6	\$ 647.42
2.19 Task Management	0	0	4	0	0	0	4	2	0	0	10	\$ 990.00
2.20 Task Independent Technical Review (ITR) – Quality Assurance / Quality Control	0	0	4	0	0	0	0	0	0	0	4	\$ 583.44
2.21 Lump Expenses (Travel, Mailings and Reprographics)	N/A	N/A	N/A	N/A	N/A	N/A	N/A	N/A	N/A	N/A	N/A	\$ 90.00
CH2M HILL Task 2 Total	0	0	14	39	51	61	4	14	0	183	\$ 17,181.17	

Exhibit B

Labor/Fee Estimate Summary - PBI 3400 Belvedere Road Overflow Parking Design Services

Billing Rate:	\$ 227.34	\$ 186.51	\$ 145.86	\$ 117.05	\$ 96.22	\$ 72.80	\$ 71.24	\$ 60.80	\$ 127.51
----------------------	-----------	-----------	-----------	-----------	----------	----------	----------	----------	-----------

Task Description	Labor Estimate (Hours)										Total Labor Hours	Total Fee
	Program Manager / Principal / Senior Consultant	Senior Technologist / Senior Project Manager	Project Manager / Design Manager / Task Leader	Project Engineer / Planner / Associate Project Manager	Staff Engineer / Planner	Design Technician	Graphics Support / Administrative Manager	Admin.	Project Estimator / Scheduler			
Task No I-13-PBI-C-017												
3.0 Contract Documents (Task 3 - 100% Design)	Total	0	0	8	14	26	33	2	8	0	91	\$ 8,428.58
3.01 100% Cover (1 drawing)		0	0	0	0	0	1	0	0	0	1	\$ 72.80
3.02 100% Drawing Index and Summary of Quantities (1 drawing)		0	0	0	0	1	1	0	0	0	2	\$ 169.02
3.03 100% General and Security Notes (1 drawing)		0	0	0	0	1	1	0	0	0	2	\$ 169.02
3.04 100% Safety Notes (1 drawing)		0	0	0	0	1	1	0	0	0	2	\$ 169.02
3.05 100% Safety Plan (1 drawing)		0	0	0	0	1	1	0	0	0	2	\$ 169.02
3.06 100% Survey Control Plan (1 drawing)		0	0	0	1	1	2	0	0	0	4	\$ 358.87
3.07 100% Boring/Coring Location Plan and Logs (1 drawing)		0	0	0	0	1	1	0	0	0	2	\$ 169.02
3.08 100% Typical Sections and Details (1 drawing)		0	0	0	1	2	3	0	0	0	6	\$ 527.89
3.09 100% Demolition Plan (1 drawing)		0	0	0	1	2	2	0	0	0	5	\$ 455.09
3.10 100% Paving and Geometry Plan (1 drawing)		0	0	0	1	2	3	0	0	0	6	\$ 527.89
3.11 100% Grading and Drainage Plan (2 drawings)		0	0	0	2	4	6	0	0	0	12	\$ 1,055.78
3.12 100% Landscape Buffer Plan and Details (1 drawing)		0	0	0	2	2	6	0	0	0	10	\$ 863.34
3.13 100% Marking and Signage Plan (1 drawing)		0	0	0	1	2	3	0	0	0	6	\$ 527.89
3.14 100% Marking and Signage Details (1 drawing)		0	0	0	1	1	2	0	0	0	4	\$ 358.87
3.15 100% Project Schedule		0	0	0	0	1	0	0	0	0	1	\$ 96.22
3.16 100% Technical Specifications		0	0	2	4	2	0	0	6	0	14	\$ 1,317.16
3.17 100% Project Construction Cost Budget Estimate		0	0	0	0	2	0	0	0	0	2	\$ 192.44
3.18 Task Management		0	0	2	0	0	0	2	2	0	6	\$ 555.80
3.19 Task Independent Technical Review (ITR) – Quality Assurance / Quality Control		0	0	4	0	0	0	0	0	0	4	\$ 583.44
3.20 Lump Expenses (Travel, Mailings and Reprographics)		N/A	N/A	N/A	N/A	N/A	N/A	N/A	N/A	N/A	N/A	\$ 90.00
CH2M HILL Task 3 Total		0	0	8	14	26	33	2	8	0	91	\$ 8,428.58
CH2M HILL Grand Total Fee		0	0	22	53	77	94	6	22	0	274	\$ 25,609.75
Subconsultant Fees												
Total Subconsultant Lump Sum Fee - Hillers Electrical Engineering, Inc. LS	\$	8,000.00										
Total Subconsultant Lump Sum Labor Fee - ADA Engineering, Inc. LS	\$	7,300.00										
Total Subconsultant Lump Sum Expense Fee - ADA Engineering, Inc. LS	\$	70.00										
Subconsultant Grand Total	\$	15,370.00										
Total Fee - Basic Engineering Services	\$	40,979.75										
LS	\$	40,729.75										
T&M	\$	-										
LS Expenses	\$	250.00										
Total	\$	40,979.75										

Prepared by: CH2M HILL, INC.



HILLERS ELECTRICAL ENGINEERING, INC.

July 8, 2013

Mr. Daniel Tompkins, P.E., PM
CH2M HILL, Inc.
3001 PGA Blvd., Suite 300
Palm Beach Gardens, FL. 33410

Subject: Electrical Engineering Services Fee Proposal for the Palm Beach County
Department of Airports (DOA) – TASK I-13-PBI-C-017 (PBI 3400
NEW PARKING LOT ELECTRICAL & LIGHTING SYSTEMS.

Dear Dan:

Hillers Electrical Engineering, Inc. (HEE) is pleased to provide CH2M HILL (CH) an electrical design services fee proposal for the DOA PBI Building 3400 New Parking Lot.

The following tasks are included in our scope:

- Includes design coordination meetings with the DOA, PBC Planning & Zoning, FP&L Co. and CH Design Team.
- Electrical Calculations & Design shall meet all County Standards / Codes and permitting reviews.
- Includes DOA approved style & type lighting pole & fixture to be utilized.
- Includes point by point lighting calculations for County P&Z for permit reviews & approvals. Includes entrance roadway & parking lot.
- Includes electrical service point, power & control systems, underground cable & conduit systems, lightning protection systems with installations details & layouts for all electrical & lighting equipment.
- Does not include any type of design for security, irrigation, landscape lighting equipment/systems.
- CH shall provide new base plan sheets for parking lot.
- HEE shall provide proposed lighting & electrical systems equipment layouts, installation details on AutoCAD 2010 to CH.
- HEE shall provide one electronic set for 90%, 100% construction set to CH. CH shall provide all printing of plans & specifications to the County for all reviews and construction phases.
- Does not include Bid & Award Services.
- Does not include Construction Services.

Our proposed lump-sum electrical design fee is:

\$ 8,000.

Sincerely,

A handwritten signature in cursive script, appearing to read 'Thomas Doran'.

Thomas Doran, Vice-President

PALM BEACH COUNTY DEPARTMENT OF AIRPORTS- PBI Building 3400 New Parking Lot Electrical & Lighting Design.										
HILLERS ELECTRICAL ENGINEERING, INC.										
SCOPE FEE SUMMARY										
FEE PROPOSAL ELECTRICAL DESIGN to CH 7-08-13										
	Rate	\$110.00	\$100.00	\$95.00	\$75.00		\$45.00			
	Proj. Mgr.	Prof. Eng	Proj. Eng	CADD/Tech		Clerical	Total		TOTAL	
PHASE OF WORK	Hours	Hours	Hours	Hours	Hours	Hours	Hours	Expenses	TASK COST	
Design									\$0.00	
Dsgn Mtgs DOA, FPL, P&Z, CH, Contractor	1	4	4			1	10		\$935.00	
On site verifications\Discovery Ph			1				1		\$95.00	
Electrical & Lighting Calculations	1	3	3	2			9		\$845.00	
Lighting System Permit Plans	1	8	12	12		1	34		\$2,995.00	
Electrical Service Point Design	1	4	4	2		1	12		\$1,085.00	
Installation Details & Layouts		2	2	2			6		\$540.00	
Specifications & Cost Estimates & Bid Items	1	8	2			9	20		\$1,505.00	
							0		\$0.00	
							0		\$0.00	
							0		\$0.00	
							0		\$0.00	
							0		\$0.00	
Subtotal	5	29	28	18	0	12	92		\$8,000.00	
									\$0.00	
									\$0.00	
							0		\$0.00	
							0		\$0.00	
							0		\$0.00	
							0		\$0.00	
							0		\$0.00	
Subtotal	0	0	0	0	0	0	0		\$0.00	
									\$0.00	
Grand Total Hours	5	29	28	18	0	12	92			
									\$0.00	
Grand Total Labor Cost	\$550.00	\$2,900.00	\$2,660.00	\$1,350.00	\$0.00	\$540.00			\$8,000.00	



1800 Old Okeechobee Road,
Suite 202
West Palm Beach, Florida 33409
Phone: (561) 615-8880
Fax: (561) 615-8858
www.adaengineering.com

July 8, 2013

Dan Tompkins, PE
CH2M Hill, Inc.
3001 PGA Blvd, Suite 300
Palm Beach Gardens, Florida 33410

VIA EMAIL

**REFERENCE: PALM BEACH INTERNATIONAL AIRPORT (PBI A)
3400 Belvedere Road – Overflow Parking Lot
Drainage Design Support
Task I-13-PBI-C-017**

Dear Mr. Tompkins:

A.D.A. Engineering, Inc. (ADA) is pleased to submit this Scope and Fee Proposal to assist CH2M HILL with Design Support for the drainage infrastructure associated with the design of a parking lot at the southwestern corner of 8th Street and Belvedere Road. In addition to providing drainage infrastructure design, the scope of services includes providing the necessary regulatory documentation to the South Florida Water Management District. The following sections outline the Scope of Services, Compensation and Schedule, Method of Payment, and Limitation of Liability associated with this Scope and Fee Proposal.

I. SCOPE OF SERVICES

ADA will provide basic services including preparation of construction documents (Tasks 2 and 3). Task 1 will be performed under Task III-13-PBI-C-001-022. Bid and Award, Construction Administration and Construction Management services are not included in this scope of services. This scope of services (Tasks 2 and 3) includes the following meetings:

- One (1) Client Submittal Meeting (Task 2)

I-1 Task 1 Preliminary Design

Task 1 Preliminary Design will be performed under Task III-13-PBI-C-001-022.

I-2 Task 2 90% Submittal

The 90% complete Contract Documents Deliverables will include the following items.

1. 90% Grading and Drainage Plans – (Modifications to a maximum of 2 plan sheets prepared by CH2M HILL at no more than 1" = 30' scale)
2. 90% Stormwater Pollution Prevention Plan (Notes & Details) - 1 plan and detail at 1" = 50' scale
3. 90% Drainage Details - 1 sheet for details, notes and possible cross-sections

With respect to the grading and drainage plans, the sheets will be the result of a collaborative effort between CH2M HILL and ADA where the layout and grading of the parking lot and associated curbing and sidewalks will be provided by CH2M HILL, while notes and minor modifications with respect to drainage will be provided by ADA. Where applicable, ADA is to provide CH2M HILL AutoCAD Master Drainage Files to be incorporated by CH2M HILL in the preparation of the actual construction contract documents.

I-3 Task 3 100% Submittal

The 100% complete Contract Documents Deliverables will include the following items:

1. 100% Grading and Drainage Plans – (Modifications to a maximum of 2 plan sheets prepared by CH2M HILL at no more than 1" = 30' scale)
2. 100% Stormwater Pollution Prevention Plan (Notes & Details) - 1 plan and detail at 1" = 50' scale
3. 100% Drainage Details - 1 sheet for details, notes and possible cross-sections

During Task 3, ADA will prepare and submit a letter modification to the current SFWMD Master ERP for PBIA. In consideration that the project has minimal additional impervious area and will utilize complete onsite retention, it is anticipated that submittal of a letter modification will be sufficient with no additional coordination or correspondence with SFWMD staff necessary.

Where applicable, ADA is to provide CH2M HILL AutoCAD Master Drainage Files to be incorporated by CH2M HILL in the preparation of the actual construction contract documents.

II. KEY ASSUMPTIONS

The scope of work outlined in Section I was developed with the following key assumptions:

1. Bid and Award, Construction Administration and Construction Management services are not included in this scope of services.
2. No additional permit coordination will be required from the SFWMD with respect to a dewatering permit or a response to a Request for Additional Information (RAI)
3. CH2M HILL will provide to ADA copies of as-built plans, survey and geotechnical investigations.
4. CH2M HILL will provide electronic files with some of the standard sheets used by Palm Beach County DOA in AutoCAD format to be easily edited for this project including:
 - Title Block
 - Standard Details
 - Airport base map, topographic/aerial survey and utility locate information

5. CH2M HILL will coordinate with applicable surveying and geotechnical engineering firms.
6. Permits will not be obtained from the Lake Work Drainage District or the Palm Beach County Water Utilities Department.
7. Wetland permitting is not required as part of this project.
8. CH2M HILL will develop Division 0 and 1 specifications and all other specifications not associated with the drainage components of the project.
9. Reproduction of required sets for review and construction will be by CH2M HILL. ADA will provide electronic files for reproduction at each design phase submittal.

III. COMPENSATION

ADA will be compensated in accordance with the terms and conditions outlined in the PBI General Consultant Services Agreement between CH2M HILL and ADA dated _____.

Total compensation for the tasks included in the Scope of Work will be on a lump sum basis not to exceed \$7,370.00, including \$70.00 in lump sum expenses. Table 1 attached includes a detailed breakdown of man-hours associated with each task outlined in the Scope of Work.

IV. METHOD OF PAYMENT

ADA will submit monthly invoices relative to percent complete of each task included in the Scope of Services. Payment is due within 30 days unless other arrangements are agreed upon by both parties prior to the commencement of the project.

ADA will begin with the work as soon as we receive written authorization from your office. It is understood that CH2M HILL will not give notice to proceed unless they have written authorization from the DOA or guarantee payment to ADA for the work. CH2M HILL will invoice the DOA within 10 days of receipt of ADA's invoice. CH2M HILL will have five (5) days after receipt of ADA's invoice to review and/or comment. If no comments or questions are made to ADA during the review period, ADA's invoice will stand as submitted. In the event that an invoice is disputed, CH2M HILL shall notify ADA in writing of any or all disputed items during the timeframe mentioned herein.

IV. LIMITATION OF LIABILITY

To the fullest extent permitted by law, the total liability, in aggregate, of ADA, Agents, Professional Associates and Consultants, and any of them to Owner and anyone claiming by, through or under Owner, for any and all injuries, claims, losses, expenses, or damages whatsoever arising out of or in any way related to this project from any cause, including but not limited to negligence, errors, omissions, strict liability or breach of contract, shall not exceed the total compensation received by ADA under this agreement.

Thank you for considering this proposal. Should the terms of this proposal be acceptable, please affix the signature of a duly authorized officer or individual in the space provided under Execution of Contract. One original copy of the executed document shall be returned to our office. We shall consider our copy of the approved proposal as a binding contract and written Notice to Proceed.

Sincerely,
A.D.A. ENGINEERING, INC.

Alex Vazquez, P.E.
Project Manager

**PALM BEACH DOA INTERNATIONAL (PBI) AIRPORT
3400 Belvedere Road – Supplemental Parking Lot
Design Services
Task I-13-PBI-C-017**

EXECUTION OF CONTRACT

The fees, terms, conditions, and specifications of this contract for Professional Services are acceptable and A.D.A. Engineering, Inc. is authorized to do the work as specified.

APPROVED

BY:

SIGNATURE

DATE

NAME AND TITLE

Exhibit B

Labor/Fee Estimate Summary - 3400 Belvedere Road Parking Lot Drainage Design

Billing Rate:	\$ 235.00	\$ 216.00	\$ 175.00	\$ 130.00	\$ 86.00	\$ 74.00
----------------------	-----------	-----------	-----------	-----------	----------	----------

Task Description	Labor Estimate (Hours)						Total Labor Hours	Total Fee	
	Program Manager / Principal / Senior Consultant	Project Manager / Design Manager / Task Leader	Project Engineer / Planner / Associate Project Manager	Staff Engineer / Planner	Design Technician	Admin.			
PBI Task No I-13-PBI-C-017									
2.0 Contract Documents (Task 2 - 90% Design)	Total	0	2	0	15	16	0	33	\$ 3,760.00
2.02 90% Drainage Plans (Modifications to a Max of 2 sheets prepared by CH2M HILL)	0	1	0	8	4	0	0	5	\$ 474.00
2.03 90% Stormwater Pollution Prevention Plan Notes and Details (1 sheet)	0	0	0	1	4	0	0	13	\$ 1,424.00
2.05 90% Drainage Details (1 sheet)	0	1	0	4	8	0	0	2	\$ 260.00
2.08 Client Review Submittal Meeting (Agenda and Minutes by Others)	0	0	0	2	0	0	0	33	\$ 3,760.00
ADA Task 2 Total	0	2	0	15	16	0	0	29	\$ 3,540.00
3.0 Contract Documents (Task 3 - 100% Design)	Total	0	3	0	15	10	1	9	\$ 1,080.00
3.02 100% Drainage Plans (Modifications to a Max of 2 sheets prepared by CH2M HILL)	0	1	0	4	4	0	0	3	\$ 302.00
3.03 100% Stormwater Pollution Prevention Plan Notes and Details (1 sheet)	0	0	0	1	2	0	0	7	\$ 820.00
3.05 100% Drainage Details (1 sheet)	0	1	0	8	4	0	1	10	\$ 1,330.00
3.08 Prepare and Submit SFWMD Letter Modification	0	1	0	15	10	1	1	29	\$ 3,540.00
ADA Task 3 Total	0	3	0	15	10	1	1	62	\$ 70.00
Expenses (Lump Sum)									
ADA Grand Total Lump Sum Fee	0	5	0	30	26	1	1	62	\$ 7,370.00

Prepared by: ADA Engineering, Inc.

EXHIBIT "B"
AMENDMENT NO. 3
DETAILED FEES, EXPENSES AND PAYMENTS
TASK I-13-PBI-C-018
PALM BEACH INTERNATIONAL AIRPORT
NAVAIDS RELOCATION DESIGN AND BIDDING
SERVICES

Exhibit B

Labor/Fee Estimate Summary - PBIA NAVAIDS Relocation Design and Bidding Services

Billing Rate:	\$ 186.51	\$ 145.86	\$ 117.05	\$ 96.22	\$ 102.00	\$ 72.80	\$ 71.24	\$ 60.80
---------------	-----------	-----------	-----------	----------	-----------	----------	----------	----------

Task Description	Labor Estimate (Hours)									Total Labor Hours	Total Fee
	Senior Technologist / Senior Project Manager	Project Manager / Design Manager / Task Leader	Project Engineer / Planner / Associate Project Manager	Staff Engineer / Planner	Senior Technician	Design Technician	Graphics Support / Administrative Manager	Admin.			
PBI Task No I-13-PBI-C-018											
1.0 Phase 1, Preliminary Design	Total	0	6	10	4	0	10	2	4	36	\$ 3,544
1.01 Task Management and Coordination	0	2	0	0	0	0	4	0	0	8	\$ 759
1.02 Records Research / Data Collection	0	0	4	2	0	2	0	2	0	8	\$ 694
1.03 Preliminary Engineer's Report Narratives, Exhibits, Specifications and Cost Estimate	0	0	2	2	0	4	0	0	0	12	\$ 1,244
1.04 Preliminary Work Staging, Phasing and Maintenance of Traffic Plans	0	2	4	2	0	4	0	0	0	2	\$ 292
1.05 Task Independent Technical Review (ITR) - Quality Assurance/ Quality Control	0	2	0	0	0	0	2	4	0	36	\$ 3,544
CH2M HILL Phase 1 Total	0	6	10	4	0	10	2	4			
2.0 Phase 2, Design Development	Total	0	5	4	8	0	14	1	2	34	\$ 3,179
2.01 Task Management and Coordination	0	1	0	0	0	0	2	0	2	6	\$ 501
2.02 30% Engineer's Report Narratives, Exhibits, Specifications and Cost Estimate	0	0	2	2	0	2	0	0	0	4	\$ 338
2.03 30% General Drawing Updates (Drawing Index, General Notes, Summary of Qty's)	0	0	0	2	0	6	0	0	0	12	\$ 1,155
2.04 30% Work Staging, Phasing, Maintenance of Traffic Plans, Notes and Details	0	2	2	4	0	4	0	0	0	8	\$ 676
2.05 30% Survey Control and Marking Plans	0	0	0	4	0	0	0	0	0	2	\$ 292
2.06 Task Independent Technical Review (ITR) - Quality Assurance/ Quality Control	0	2	0	0	0	14	1	2	0	34	\$ 3,179
CH2M HILL Phase 2 Total	0	5	4	8	0	14	1	2			
3.0 Phase 3A, 60% Submittal	Total	0	4	9	6	0	10	1	4	34	\$ 3,257
3.01 Task Management and Coordination	0	1	0	0	0	0	1	0	0	2	\$ 217
3.02 60% Engineer's Report Narratives, Exhibits, Specifications and Cost Estimate	0	0	4	0	0	0	0	2	0	6	\$ 590
3.03 60% General Drawing Updates (Drawing Index, General Notes, Summary of Qty's)	0	0	0	2	0	2	0	0	0	4	\$ 338
3.04 60% Work Staging, Phasing, Maintenance of Traffic Plans, Notes and Details	0	0	2	2	0	4	0	0	0	8	\$ 718
3.05 60% Survey Control and Marking Plans	0	0	2	2	0	4	0	0	0	8	\$ 718
3.06 60% Project Manual Updates	0	1	1	0	0	0	0	2	0	4	\$ 385
3.07 Task Independent Technical Review (ITR) - Quality Assurance/ Quality Control	0	2	0	0	0	0	1	4	0	2	\$ 292
CH2M HILL Phase 3A Total	0	4	9	6	0	10	1	4			
4.0 Phase 3B, 90% Submittal	Total	0	4	5	3	0	7	1	4	24	\$ 2,281
4.01 Task Management and Coordination	0	1	0	0	0	0	0	2	0	4	\$ 356
4.02 90% Engineer's Report Narratives, Exhibits, Specifications and Cost Estimate	0	0	2	0	0	2	0	0	0	2	\$ 146
4.03 90% General Drawing Updates (Drawing Index, General Notes, Summary of Qty's)	0	0	0	0	0	3	0	0	0	6	\$ 528
4.04 90% Work Staging, Phasing, Maintenance of Traffic Plans, Notes and Details	0	0	1	2	0	2	0	0	0	4	\$ 359
4.05 90% Survey Control and Marking Plans	0	0	1	1	0	0	0	2	0	4	\$ 385
4.06 90% Project Manual Updates	0	1	1	0	0	0	0	0	0	2	\$ 292
4.07 Task Independent Technical Review (ITR) - Quality Assurance/ Quality Control	0	2	0	0	0	0	1	4	0	24	\$ 2,281
CH2M HILL Phase 3B Total	0	4	5	3	0	7	1	4			

Exhibit B

Labor/Fee Estimate Summary - PBJA NAVAIDS Relocation Design and Bidding Services

Billing Rate:	\$ 186.51	\$ 145.86	\$ 117.05	\$ 96.22	\$ 102.00	\$ 72.80	\$ 71.24	\$ 60.80
----------------------	-----------	-----------	-----------	----------	-----------	----------	----------	----------

Task Description	Labor Estimate (Hours)									Total Labor Hours	Total Fee
	Senior Technologist / Senior Project Manager	Project Manager / Design Manager / Task Leader	Project Engineer / Planner / Associate Project Manager	Staff Engineer / Planner	Senior Technician	Design Technician	Graphics Support / Administrative Manager	Admin.			
PBJ Task No I-13-PBJ-C-018											
5.0 Phase 3C, 100% Submittal	Total	1	4	5	2	0	6	1	3	22	\$ 2,238
5.01 Task Management and Coordination		0	1	0	0	0	0	1	0	2	\$ 217
5.02 100% Engineer's Report Narratives, Exhibits, Specifications and Cost Estimate		0	0	1	0	0	0	0	1	2	\$ 146
5.03 100% General Drawing Updates (Drawing Index, General Notes, Summary of Qtys)		0	0	0	0	0	2	0	0	6	\$ 622
5.04 100% Work Staging, Phasing, Maintenance of Traffic Plans, Notes and Details		0	1	2	1	0	2	0	0	4	\$ 359
5.05 100% Survey Control and Marking Plans		0	0	1	1	0	0	0	2	4	\$ 385
5.06 100% Project Manual Updates		0	1	1	0	0	0	0	0	2	\$ 332
5.07 Task Independent Technical Review (ITR) - Quality Assurance/ Quality Control		1	1	0	0	0	0	0	0	2	\$ 332
CH2M HILL Phase 3C Total		1	4	5	2	0	6	1	3	22	\$ 2,238
6.0 Phase 4, Bid and Award	Total	0	1	2	2	0	0	1	0	6	\$ 644
6.01 Task Management and Coordination		0	1	0	0	0	0	1	0	2	\$ 217
6.02 Respond to Contractor Requests for Information (RFIs)		0	0	2	2	0	0	0	0	4	\$ 427
CH2M HILL Phase 4 Total		0	1	2	2	0	0	1	0	6	\$ 644
CH2M HILL Grand Total Lump Sum Fee		1	24	35	25	0	47	7	17	156	\$ 15,143

Subconsultant Fees

Total Subconsultant Lump Sum Fee - Hillers Electrical Engineering LS \$ 14,525

Subconsultant Grand Total Lump Sum Fee \$ 14,525

Total Lump Sum Fee - Basic Engineering Services \$ 29,668

Prepared by: CH2M HILL, INC.



HILLERS ELECTRICAL ENGINEERING, INC.

July 8, 2013

Mr. Daniel Tompkins, P.E., PM
CH2M HILL, Inc.
3001 PGA Blvd., Suite 300
Palm Beach Gardens, FL. 33410

Subject: Electrical Engineering Services Fee Proposal for the Palm Beach County Department of Airports (DOA) – TASK I-13-PBI-C-018 (PBIA NAVAIDS RELOCATION DESIGN AND BIDDING SERVICES FOR RUNWAY 32 NAVAIDS PAPI / REIL SYSTEMS MODIFICATIONS WITHIN RUNWAY SAFETY AREA, TAXIWAY “L” WEST END NEW ELEVATED RUNWAY GUARD LIGHTING / HOLD POSITION SYSTEM, AND RUNWAY 28L APPROACH HOLDING POSITION SIGNAGE IMPROVEMENTS AND MODIFICATIONS.

Note: **Includes Design and Incorporation of RW 32 NAVAIDS Modifications, TW “L” West New RGL Design, and RW 28L Approach Hold Sign into New North / South Taxiway Design Documents.**

Dear Dan:

Hillers Electrical Engineering, Inc. (HEE) is pleased to provide CH2M HILL (CH) an electrical engineering services fee proposal for the DOA PBIA RW 32 NAVAIDS Modifications, TW “L” Westend new elevated RGL lighting system, and RW 28L Approach hold sign tasks.

The following tasks are included in our scope of services:

- Includes project design coordination meetings with DOA, FAA and CH Design Team.
- Conduct on-site verifications and perform preliminary records research / data collection for existing FAA & DOA Record Drawings for RW 32 and Taxiway “L” NAVAIDS, electrical, lighting, signage systems.
- Includes all electrical calculations.
- Design includes existing RW 32 PAPI / REIL power / control pedestals being relocated outside of RW 32 RSA. All new conductor & conduit systems, disconnects, transformers, grounding, new equipment mounting pedestal, installation details & layouts and modifications to the existing 4 Box lighting units complete in place.

Mr. Daniel Tompkins, P.E., P.M.

Subject: Hillers Scope & Fee for PBCDOA Task I-13-PBI-C-018 NAVAIDs Relocation Design and Bidding Services:

- Design includes new elevated runway guard lighting system at the TW L Westend runway holding position per the FAA AC 150/5300-13A, current edition. All new conductor & conduit systems, elevated guard light units and mounting pads, connections to existing RGL lighting circuit and installation details and layout plans.
- CH shall provide all base drawings to HEE on AutoCAD 2010.
- HEE shall provide electrical design to CH 1- electronic set for 30%, 60%, 90%, 100% reviews, permits and bid phases.
- HEE shall provide all FAA specifications electrical bid line items and cost estimates to CH.
- Includes bid & award.
- Does not include construction services.

Our proposed Lump-Sum Fee for Miscellaneous Planning & Engineering Services:

RW32 PAPI / REIL/ Sign Power & Control Systems Relocation / Modifications	\$10,410.
TW "L" West New elevated RGL lighting system is:	<u>\$ 4,115.</u>
Grand Total	\$ 14,525.

(See attachment breakdown)

Sincerely,

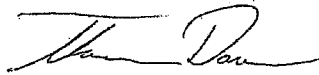

Thomas Doran, Vice-President

PALM BEACH COUNTY DEPARTMENT OF AIRPORTS- PBIA RW 32 PAPI / REIL Systems Modification, Taxiway "L" Elevated RGL Design, HILLERS ELECTRICAL ENGINEERING, INC. and 28L Approach sign Incorporated into North / South Taxiway Project Design Documents.
SCOPE FEE SUMMARY
FEE PROPOSAL ELECTRICAL DESIGN to CH 7-8-13

	Rate	\$110.00	\$100.00	\$95.00	\$75.00		\$45.00	-	
	Proj. Mgr.	Prof. Eng	Proj. Eng	CADD/Tech		Clerical	Total		TOTAL
PHASE OF WORK	Hours	Hours	Hours	Hours	Hours	Hours	Hours	Expenses	TASK COST
PAPI / REIL/ Sign Systems Mod.- Design									\$0.00
Dsgn Mtgs FAA, DOA, Contractor, CH	1	2	2			1	6		\$545.00
On site verifications\Discovery Ph			2			1	3		\$235.00
PAPI / REIL Systems Modifications	1	10	20	10		1	42		\$3,805.00
RW 28L Holding Position Signage Improve Mod.	1	8	8	8		1	26		\$2,315.00
Installation Details & Layouts		1	3	3			7		\$610.00
Specifications & Cost Estimates & Bid Items	1	16				10	27		\$2,160.00
Bid & Award	1	2	2	2		2	9		\$740.00
							0		\$0.00
							0		\$0.00
							0		\$0.00
							0		\$0.00
							0		\$0.00
Subtotal	5	39	37	23	0	16	120		\$10,410.00
									\$0.00
Elevated RGL System- Design									\$0.00
Dsgn Mtgs FAA, DOA, Contractor, CH	1	1	1			1	4		\$350.00
On site verifications\Discovery Ph			2			1	3		\$235.00
Elevated RGL System	1	4	8	8		1	22		\$1,915.00
Installation Details & Layouts		1	1	2			4		\$345.00
Specifications & Cost Estimates & Bid Items	1	8				8	17		\$1,270.00
Subtotal	3	14	12	10	0	11	50		\$4,115.00
Grand Total Hours	8	53	49	33	0	27	170		
Grand Total Labor Cost	\$880.00	\$5,300.00	\$4,655.00	\$2,475.00	\$0.00	\$1,215.00			\$14,525.00

EXHIBIT "B"
AMENDMENT NO. 3
DETAILED FEES, EXPENSES AND PAYMENTS
TASK I-13-PBI-C-019
PALM BEACH INTERNATIONAL AIRPORT
FIS EXPANSION CONSTRUCTION
ADMINISTRATION SERVICES

Table B-1

Labor/Fee Estimate Summary (CH2M Hill) - Palm Beach International Airport - FIS Expansion Construction Administration Services

Billing Rate: \$ 227.34 \$ 186.51 \$ 145.86 \$ 71.24 \$ 60.80

Task Description	Program Manager / Principal / Senior Consultant	Senior Technologist / Senior Project Manager	Project Manager / Design Manager / Task Leader	Graphics Support / Administrative Manager	Admin.	Total	Fee Estimate (\$)		
							Labor	Expenses	Total
Task I-13-PBI-C-019 - FIS Expansion Construction Administration Services									
1.0 Task Management	Total	0	0	32	22	76	\$ 7,572	\$ -	\$ 7,572
1.1 Task Management		0	0	20	10	42	\$ 4,359	\$ -	\$ 4,359
1.2 Coordination with Subconsultants		0	0	12	12	34	\$ 3,213	\$ -	\$ 3,213
CH2M HILL Total Lump Sum Fee		0	0	32	22	76	\$ 7,572	\$ -	\$ 7,572
Subconsultant Fees									
Total Subconsultant Time & Materials Labor Fee - Michael Baker Jr., Inc.	T&M						\$57,582		
Total Subconsultant Reimbursable Expenses Fee - Michael Baker Jr., Inc.	T&M						\$2,879		
Total Subconsultant Time & Materials Fee - Tierra South Florida	T&M						\$14,300		
Subconsultant Grand Total							\$74,761		
Total Fee - PBIA Air Service Support Task 4							\$82,333		
LS							\$7,572		
T&M							\$71,882		
Reimbursable Expenses							\$2,879		
Total							\$82,333		

Prepared by: CH2M HILL, INC.

Baker

Michael Baker Corporation
2000 Palm Beach Lakes Blvd, Suite 600
West Palm Beach, FL 33409
Phone (561) 686-5130

August 7, 2013

Daniel Thompkins
CH2M HILL
1 Harvard Circle
West Palm Beach, FL 33409

Subject: Palm Beach International Airport
FIS Customs Project

Mr. Thompkins,

Per your request, Michael Baker Corporation is pleased to provide you with the Professional Construction Administration Services proposal for the PBIA FIS Customs Project.

If you have any questions, please feel free to contact me.

Sincerely,



Fernando R. Prieto
Senior Project Manager

Attachments: Scope of Work
Fee Proposal
Schedule
Rate Schedule
Subconsultants Proposal

EXHIBIT A

SCOPE OF WORK

Task No. I-13-PBI-C-019

FIS EXPANSION PALM BEACH INTERNATIONAL AIRPORT PALM BEACH COUNTY, FLORIDA

PROJECT BACKGROUND

The Palm Beach County Board of County Commissioners, through the Palm Beach County Department of Airports (COUNTY), had retained the Professional Services of The LPA Group, INCORPORATED, now known as Michael Baker Corporation (CONSULTANT), the "Notice to Proceed" being issued on March 4, 2009, to Design and Develop the necessary Construction Documents for the modernization and expansion of the existing Custom/FIS facilities to meet then current Federal guidelines and requirements.

During the development of 90% Construction Documents (Architectural) for this Project, the USDHS Customs and Border Protection (CBP) had been developing new Federal mandated guidelines and space requirements. These new Program requirements impact the Design of the Immigration and Customs area. The main element being that a new "Secondary Admissibility Processing Area" is now required beyond the existing functions. In order to accommodate for these new areas, the "Secondary Traditional Areas" needs to be relocated to the existing Baggage Exam Podium/X-ray Processing to consolidate the services, and provide for the required areas and functions.

In order to expedite without further delay the development of the Construction Documents; Per the "Reallocation of Funds – Design Scope Change, PBI – FIS Expansion & Renovation, Reference task I-03-PBI-L-02"1, dated March 29, 2012, DOA and the CONSULTANT agreed to reallocate the originally contracted "Construction Administration" monies to fund the revisions of the Preliminary Design through 100% Construction Documents. The Scope of Work and Construction Time estimated for the Project also have grown from the initial agreement between the COUNTY and the CONSULTANT, hence this request for additional monies.

PROJECT DESCRIPTION

The Scope of Work consists of providing Professional Construction Administration Services for renovating approximately 6,000 S.F. of Immigration and Customs offices, passenger area and baggage claim area. In addition three immigration positions will be added and an existing flat plate carousel will be replaced with a larger sloped plate carousel capable of handling new incoming flights as specified by the DOA. An exterior existing wall will be removed to allow for an expansion of approximately

2,100 S.F. of additional space. The existing exterior canopy will be expanded by approximately 1600 S.F. to allow for a covered baggage loading area. Total affected area will be 9,700 S.F.

Because of the sensitive nature of the space, the need to maintain continuous operation during construction and the required expansion and upgrades to the existing security and communication system, close coordination with the DOA and the Custom and Immigration Services will be imperative.

The CONSULTANT, in coordination with our SUB-CONSULTANTS, will perform the following Basic Services for this project;

Phase 1A – Revised Programming – No Additional Work in this Phase

Phase 2 – Preliminary Design – No Additional Work in this Phase

Phase 3 – Design Development – No Additional Work in this Phase

Phase 4 – Construction Documents – No Additional Work in this Phase

Phase 5– Bidding and Award of Contract – No Additional Work in this Phase

Phase 6 – Construction Administration Service

CONSULTANT will provide Professional Services Construction Administration services, and as shown in the attached Exhibit B, Man Hour and Fee Estimate, as follows;

- CONSULTANT shall coordinate with the County through-out this Phase.
- CONSULTANT shall coordinate with the Contractor through-out this Phase.
- CONSULTANT shall coordinate with the Structural SUB-CONSULTANT, the Engineer of the Project, in the preparation of a "Threshold Inspection Plan" in accordance with Palm Beach County Amendments to 2010 FBC 110.3.7.1.
- CONSULTANT shall attend the Pre-Construction Conference and review the Minutes prepared by the Contractor and prepare any appropriate responses.
- CONSULTANT shall attend Bi-weekly meetings (18 meetings) Construction Progress Meetings and review the Minutes prepared by the Contractor and prepare any appropriate responses.
- CONSULTANT shall Review Shop Drawings/Submittals Review and approve (or take other appropriate action in respect of) Shop Drawings, samples and other data which Contractor(s) are required to submit, but only for conformance with the design concept of the Project and compliance with the information given in the Contract Documents.
- CONSULTANT shall review Pay Applications shall determine the amounts owing to Contractor(s) and recommend in writing payments to Contractor(s)

in such amounts.

- CONSULTANT shall review Test Results or other data which Contractor is required to submit, but only for conformance with the design concept of the Project and compliance with the information given in the Contract Documents.
- CONSULTANT shall perform weekly Site Visits (36 Visits) to observe the Progress of the Project, and shall endeavor to determine in general if such work is proceeding in accordance with the Contract Documents and keep the County informed of the progress of the Project Work.
- CONSULTANT shall review and Respond to RFI's issued by the Contractor during, in coordination with the County and the Sub-consultants, through-out this Phase.
- CONSULTANT shall conduct a Substantial Completion Inspection, in coordination with the County, and prepare a Punch List to be used by the Contractor to complete this Phase of the Project.
- CONSULTANT shall conduct a Final Inspection and verify, in coordination With the County, that all of the Punch List items have been completed and the Work are acceptable per the Construction Documents.
- CONSULTANT shall review the Record Drawings and Closeout Documents submitted by the Contractor for completeness, as required by the Contract Documents, and will submit to the County for their Records and use.

Deliverables (Phase 6): The CONSULTANT will provide the County on a monthly basis electronic copies of Field Reports, Recommendation of Payments, and other pertinent documentation to the Project Work. The CONSULTANT will provide the County with an electronic and hard copy of the executed "Certificate of Project Substantial Completion" and a letter documenting the Project has been completed per the Construction and Contract Documents. The CONSULTANT will provide the COUNTY a hard-copy of "Record Drawings", both 24x36 and 11x17, along with a Compact Disc (CD) with the electronic AUTOCADD and PDF files.

Other Provisions

- a) The County will provide the CONSULTANT and their SUBCONSULTANTS access to the site and all available information pertinent to this project. The County will also provide the CONSULTANT all criteria and requirements, including all design and construction standards, which the County will require to be included in the Drawings and Specifications.
- b) The County will provide access to pertinent information regarding airport property, boundary, easement, right-of-way and other information necessary for the design and permitting of the project.

Exhibit B
Task No. I-13-PBI-C-019
FIS Expansion - Palm Beach International Airport

Manhour and Fee Estimate - CA Services

Item/Task Description	Program Manager	Project Manager	Senior (Engineer / Arch / Planner / Scientist)	Designer	Technician	Clerical	Total
2011 Rate	\$201.00	\$171.00	\$171.00	\$108.00	\$82.00	\$76.00	
Phase 1A - Revised Programming (15%) - No Additional Work in this Phase							
Phase 2 - Preliminary Design (30%) - No Additional Work in this Phase							
Phase 3 - Design Development (60%) - No Additional Work in this Phase							
Phase 4 - Construction Documents (90% & 100%) - No Additional Work in this Phase							
Phase 5 - Bidding Phase Services - No Additional Work in this Phase							
Phase 6: Construction Administration							
General Coordination with the County		18	9	36		1	64
General Coordination with the Contractor		18	9	36		1	64
Coordination with Structural SUB-CONSULTANT in preparing "Threshold Inspection Plan" and AHJ		1		8		1	10
Pre-Construction Conference		3		3		1	7
Bi-weekly meetings (18 meetings)		9		18			27
Review Shop Drawings/Submittals		8		40	8	2	58
Review Pay Applications		9		18		2	29
Review Test Results		2		12			14
Weekly Site Visits (36 Visits)		9		36			45
Review and Respond to RFI's		4		32			36
Substantial Completion Inspection / Prep Punch List		8		8		2	18
Final Inspection/ Punch List items		8		8		1	17
Review/ Submit Record Drawings		1		4	8	1	14
Review Contractor's Closeout Documents		1		2	4		7
Phase 6: Construction Administration Hours	0	99	18	261	20	12	410
Phase 6: Construction Administration Fee	\$0	\$16,929	\$3,078	\$28,188	\$1,640	\$912	\$50,747
Labor Totals							
Total Estimated Hours	0	99	18	261	20	12	410
Total Estimated Labor Costs	0	\$16,929	\$3,078	\$28,188	\$1,640	\$912	\$50,747
Subconsultants							
Bowen Engineering Corporation - Structural Engineering (Expanded CA Services)							\$ 2,000
Bobes Associates Consulting Engineers - MEP Engineering (CA Service Fees)							\$ 4,835
Subconsultant Sub-total Fees:							\$ 6,835
Expenses							
Reimbursable Expenses Estimate							\$ 2,879
TOTAL NOT TO EXCEED AMOUNT:							\$60,461

August 6, 2013

THE LPA GROUP INC
2000 Palm Beach Lakes Blvd, Suite 600
West Palm Beach, FL 33409
PH (561) 686-5130 FX (561) 686-5131

**Re: FIS (CUSTOMS) EXPANSION AT PALM BEACH INTERNATIONAL AIRPORT
CA Services**

Dear Mr. Prieto:

We are pleased to offer the following proposal for the provision of limited structural engineering services for the referenced project. These basic services shall be provided in accordance with the following fee schedules.

SCOPE OF WORK: Structural Engineering Services design for Construction Administration services including shop drawing review, answering RFI's and shop drawings.

Any meetings during design, site visits, etc will be on an hourly basis.

FEES: CA (RFI's, shop dwg review) \$ 2,000.00

Site visits at \$ 1,000.00 each.

Thank You for the opportunity to offer you this proposal and please do not hesitate to call if you have any questions.

Sincerely,

BOWEN ENGINEERING CORPORATION.



Fred J Bowen, P.E.
President

Accepted by _____, The LPA Group, Inc; Date _____

1528 Vassar Street, Orlando, Florida 32804 (407) 423-7585

BOBES ASSOCIATES CONSULTING ENGINEERS, INC.

150 CIRCLE DRIVE

MAITLAND, FL 32751

ADDITIONAL SERVICES AUTHORIZATION #1

Date: August 6, 2013

Project: Palm Beach International Air Airport
Customs Renovation
West Palm Beach, Florida
Bobes Project #12-04

The architect: The LPA Group
2000 Palm Beach Lakes Blvd., Suite 600
West Palm Beach, Florida 33409

hereby authorizes: Bobes Associates Consulting Engineers, Inc.
150 Circle Drive
Maitland, Florida 32751

to: Proceed with Additional Services

as follows: The scope of this work involves the following:

Construction Administration

This work involves MEP/FP Construction Administration services including shop drawing review, answering RFIs during construction, reviewing change orders and attendance of construction administration site visits for review of the installation. It is anticipated that one site visit will be required midway through construction along with the Substantial Completion inspection. In addition the scope includes project closeout services involving review of the O&M Manuals and preparation of As Builts from the contractor's redlined drawings.

Compensation shall be adjusted as follows:

Construction Administration

Shop Drawing Review

HVAC Engineer (Shop Drawings)	2 hrs X \$95.00/hr.	= \$	190.00
Plumbing Engineer (Shop Drawings)	2 hrs X \$95.00/hr.	= \$	190.00

Fire Protection Engineer (Shop Drawings)	2 hrs X \$95.00/hr.	= \$ 190.00
Electrical Engineer (Shop Drawings)	4 hrs X \$95.00/hr.	= \$ 380.00
Clerical (Shop Drawings)	3 hrs X \$55.00/hr.	= \$ 165.00
Subtotal		= \$ 1,115.00

RFIs/Change Orders

HVAC Engineer (RFIs/Change Orders)	2 hrs X \$95.00/hr.	= \$ 180.00
Plumbing Engineer (RFIs/Change Orders)	2 hrs X \$95.00/hr.	= \$ 180.00
Fire Protection Engineer (RFIs/Change Orders)	1 hrs X \$95.00/hr.	= \$ 95.00
Electrical Engineer (RFIs/Change Orders)	5 hrs X \$95.00/hr.	= \$ 475.00
Clerical (RFIs/Change Orders)	4 hrs X \$55.00/hr.	= \$ 220.00
Subtotal		= \$ 1,150.00

CA Site Visit during Construction

HVAC/Plumb/FP Engineer (CA site visit)	4 hrs X \$95.00/hr.	= \$ 380.00
Electrical Engineer (CA site visit)	4 hrs X \$95.00/hr.	= \$ 380.00
Clerical (CA site visit Report)	1 hrs X \$55.00/hr.	= \$ 55.00
Subtotal		= \$ 815.00

Substantial Completion Inspection

HVAC/Plumb/FP Engineer (CA site visit)	4 hrs X \$95.00/hr.	= \$ 380.00
Electrical Engineer (CA site visit)	4 hrs X \$95.00/hr.	= \$ 380.00
Clerical (CA site visit Report)	1 hrs X \$55.00/hr.	= \$ 55.00
Subtotal		= \$ 815.00

Project Closeout – O&M/As Builts

HVAC Engineer (O&M/Close Out/As Builts)	1 hrs X \$95.00/hr.	= \$ 95.00
Plumbing Engineer (O&M/Close Out/As Builts)	1 hrs X \$95.00/hr.	= \$ 95.00
Fire Protection Engineer (O&M/Close Out)	1 hrs X \$95.00/hr.	= \$ 95.00
Electrical Engineer (O&M/Close Out/As Builts)	3 hrs X \$95.00/hr.	= \$ 285.00
Cadd Operator (O&M/Close Out/As Builts)	4 hrs X \$65.00/hr.	= \$ 260.00
Clerical (O&M/Close Out/As Builts)	2 hrs X \$55.00/hr.	= \$ 110.00
Subtotal		= \$ 940.00

Total Construction Administration = \$ 4,835.00

Upon return of a fully executed authorization, this authorization shall become a part of the Agreement identified above.

Approved:
Bobes Associates
Consulting Engineers, Inc.

Approved:
The LPA Group

~~XXXXXXXXXX~~
Augusto E. Bobes, P.E.
President
Date: 8/6/13

Fernando Prieto, AIA
Senior Project Manager
Date: _____

PHONE
(407) 628-0882

FAX
(407) 628-7024



August 7th, 2013

CH2MHill, Inc.
3001 PGA Boulevard, Suite 300
Palm Beach Gardens, Florida 33410

Attention: Mr. Dan Tompkins, P.E.

Re: Proposal for Inspection and Testing Services
Palm Beach International Airport-FIS Expansion
Palm Beach County, Florida
Task No: I-13-PBI-C-019
TSF Proposal No. 1308-327

Dear Dan:

TIERRA SOUTH FLORIDA (TSF), Inc. is pleased to submit this proposal for Inspection and Construction Materials Testing Services at the Palm Beach International Airport site in Palm Beach County, Florida. This proposal includes a summary of our understanding of the project, an outline of our proposed scope of work, and an estimate of the total job cost.

We understand that the project will include renovating existing custom offices, passenger area and baggage claim area, as well as expanding custom offices, new canopies. It is estimated that the total fees will be as follows:

- Inspection Services-24 trips, 120 hours @ \$70.00/hour \$8,400.00
- Concrete Tests, 15 sets @ \$140.00/set \$2,100.00
- Grout Tests, 5 sets @ \$80.00/set \$ 400.00
- Mortar Tests, 5 sets @ \$80.00/set \$ 400.00
- Nuclear Density Tests, 50 tests @ \$25.00/each \$1,250.00
- Proctor tests, 2 tests @ \$125.00/each \$ 250.00
- Principal Engineer/Threshold, P.E., 10 hours @ \$150.00/hour \$1,500.00

TOTAL: \$14,300.00

We at TSF appreciate the opportunity to submit this proposal and look forward to working with you on this project. If you should have any questions concerning our proposal, please contact our office.

Respectfully submitted,

TIERRA SOUTH FLORIDA, INC.

Francois Thomas, P.E.
Principal Engineer
FL # 56381

EXHIBIT "B"
AMENDMENT NO. 3
DETAILED FEES, EXPENSES AND PAYMENTS
TASK II-13-DOA-C-002
PALM BEACH COUNTY
DEPARTMENT OF AIRPORTS
2013 ANNUAL ENVIRONMENTAL COMPLIANCE
MONITORING, INSPECTION AND TRAINING
SERVICES

Exhibit B

Labor/Fee Estimate Summary - 2013 Environmental Compliance Monitoring, Inspection & Training Services

Billing Rate:	\$ 227.34	\$ 186.51	\$ 145.86	\$ 117.05	\$ 96.22	\$ 72.80	\$ 71.24	\$ 60.80	\$ 133.71	\$ 157.48	\$ 127.51
----------------------	-----------	-----------	-----------	-----------	----------	----------	----------	----------	-----------	-----------	-----------

Task Description	Labor Estimate (Hours)											Total Labor Hours	Total	
	Program Manager / Principal / Senior Consultant	Senior Technologist / Senior Project Manager	Project Manager / Design Manager / Task Leader	Project Engineer / Planner / Associate Project Manager	Staff Engineer / Planner	Design Technician	Graphics Support / Administrative Manager	Admin.	Threshold Inspector	Construction Manager	Project Estimator / Scheduler			
DOA Task No II-13-DOA-C-002												244	\$ 25,455.31	
1.0 Basic Services	Total	0	16	28	49	40	91	8	12	0	0	0	8	\$ 1,051.64
1.01 Task Kick-off and Coordination Meetings/Conf Calls		0	0	4	4	0	0	0	0	0	0	0	32	\$ 3,384.60
1.02 Task Management and Subconsultant Coordination		0	0	8	12	0	0	8	4	0	0	0	36	\$ 3,494.90
1.03 DOA, Tenant and Consultant Coordination		0	0	4	10	8	10	0	4	0	0	0		
1.04 Drainage and Basin Map Update		0	0	0	1	2	7	0	0	0	0	0	10	\$ 819.09
PBA - North/South Taxiway		0	0	0	1	3	4	0	0	0	0	0	8	\$ 696.91
PBA - Golfview Development Area Ultimate Outfall		0	0	0	1	3	8	0	0	0	0	0	12	\$ 988.11
PBA - Golfview Utilities and Infrastructure		0	0	0	1	4	7	0	0	0	0	0	12	\$ 1,011.53
PBA - Galaxy Parcel S-5		0	0	0	1	2	5	0	0	0	0	0	8	\$ 673.49
PBA - Galaxy Apron Expansion		0	0	0	1	1	4	0	0	0	0	0	6	\$ 504.47
PBA - Taxiway B, D and E Rehabilitation		0	0	0	1	3	8	0	0	0	0	0	12	\$ 988.11
F45 - Taxiway D		0	0	0	1	3	8	0	0	0	0	0	12	\$ 988.11
F45 - Drainage Modifications		0	0	0	2	3	9	0	0	0	0	0	14	\$ 1,177.96
F45 - Wetland Wildlife Mitigation		0	0	0	1	2	5	0	0	0	0	0	8	\$ 673.49
LNA - Runway 15-33, Taxiway A1, Taxiway B and GA Apron Rehab		0	0	0	1	2	7	0	0	0	0	0	12	\$ 1,032.36
LNA - Airport Redevelopment - Phase 1		0	0	0	2	3	5	0	0	0	0	0	8	\$ 673.49
LNA - Out Parcel Development		0	0	0	1	2	4	0	0	0	0	0	6	\$ 504.47
PHK - Airfield Electrical Improvements (Vault)		0	0	0	1	1	4	0	0	0	0	0	16	\$ 1,763.04
1.05 Monthly Progress Reporting		0	0	4	8	0	0	0	0	0	0	0	24	\$ 4,151.04
1.06 Quality Control/Quality Assurance		0	16	8	0	0	0	0	0	0	0	0		\$ 878.50
1.07 Expenses (Mileage, Mailings and Reprographics)		N/A	N/A	N/A	N/A	N/A	N/A	N/A	N/A	N/A	N/A	N/A	N/A	
CH2M HILL Grand Total		0	16	28	49	40	91	8	12	0	0	0	244	\$ 25,455.31
Subconsultant Fees														
Total Subconsultant Lump Sum Fee - Cyriacks Environmental Consulting Services (CECOS) \$ 89,146.20														
Subconsultant Grand Total \$ 89,146.20														
Total Lump Sum Fee-Basic Engineering Services \$ 114,601.51														

Prepared by: CH2M HILL, INC.



June 24, 2013

Dan C. Tompkins, P.E.
Project Manager
CH2M HILL, INC.
3001 PGA Blvd, Suite 300
Palm Beach Gardens, FL 33410

Re: **Task II-13-DOA-C-002**
Palm Beach County Department of Airports (PBCDOA)
2013 Environmental Compliance Monitoring, Inspection & Training Services
Palm Beach County, Florida

Dear Mr. Tompkins:

Cyriacks Environmental Consulting Services, Inc. (CECOS) is pleased to submit the revised proposal to provide environmental consulting services for the subject project. Our fee estimate is based on the scope of services identified as Exhibit A-II-1 of Task II-13-DOA-C-002 and information provided by CH2M HILL.

Estimated Fee Summary

The lump sum fee (labor and expenses) to complete the identified scope of work is \$89,146.20. Please refer to Attachment I, for the Fee Estimate Table detailing the cost for these environmental services. The cost presented in this document takes into consideration the information provided in the Exhibit 1 (Scope of Services). Also, our fee estimate takes into consideration the following assumptions:

- No special graphics or technical meeting material is anticipated to be prepared.
- Preparation of a new drainage map is not anticipated. Comments (mark-ups) to drainage map (based on field observation during SWPPP inspections) will be provided to CH2M HILL by CECOS. Copy of the drainage maps must be provided in PDF and AutoCAD format.
- Copies of all previous documents, reports, files, inspections forms, SWPPP brochure, SPCC pamphlet and training material (e.g. Power Point Presentation) will be provided to CECOS.
- It is assumed that SWPPP brochure and SPCC pamphlet will require minor revisions.
- Our cost and scope is limited to the update of previous SWPPP documents, inspections, SWPPP brochure, SPCC pamphlet and training (i.e. Power Point Presentation).
- Permit renewal, or NPDES Individual Permit is not included.
- No as-built and land survey plans preparation anticipated.
- Development of numeric effluent limitations is not included.

Cyriacks Environmental Consulting Services, Inc
3001 SW 15th Street, Suite B
Deerfield Beach, FL 33442
954.571.0290 Fax: 954.571.7112

- Environmental Site Assessment Investigations (Phase I / II) are not included as part of this scope and cost estimate.
- The cost of the proposal does not include any activity related to permit application preparation, renewal or modification, amendments, mitigation, restoration, groundwater modeling, analytical testing and laboratory analysis, among others. Also does not include services described in Section 2 of Exhibit A-II-1 (Special Services).
- Only one SWPPP general site inspection is anticipated per airport (PBI, F45, Lantana, and Pahokee).
- Documents will be subject to one round of revisions by the Client.
- The Client will be responsible to provide all necessary information for the implementation of this scope.
- The Client shall pay additional compensation associated with efforts not specified in this proposal, if required. CECOS will notify in advance to the Client if this situation arise. Any additional effort shall be negotiated between the Client and CECOS, and must be approved before the required action.
- Agency permit application/processing fees are not included.
- SWPPP's update due to a new facility construction and/or stormwater system or a change to the stormwater system at the airports, this shall be conducted and compensated under a separate agreement.

Schedule

Upon receipt of project authorization, preparation of work activities will begin. We will perform our scope of work within the thirteen (13) months from NTP

We are very excited about continuing to work with you on this project and appreciate the opportunity to provide these services to you. Please contact me if you have any questions or need additional information.

Very truly yours,
Cyriacks Environmental Consulting Services, Inc.

Wendy Cyriacks

Wendy Cyriacks

Attachments:

- Exhibit A - CH2M HILL Scope of Services
- Exhibit B - CECOS Fee Estimate – SWPPP Services

Cyriacks Environmental Consulting Services, Inc
3001 SW 15th Street, Suite B
Deerfield Beach, FL 33442
954.571.0290 Fax: 954.571.7112

Exhibit B

Fee Estimate - CECOS - Revised Rates

ATTACHMENT I

PALM BEACH COUNTY DEPARTMENT OF AIRPORTS
 2013 Environmental Compliance Monitoring, Inspection & Training Services
 Prepared: 06-20-13 (wc)

Hourly Billing Rate (2011)	\$175.00	\$118.00	\$85.00	\$78.00	\$63.00	
Task Description	Classification					Total
	Principle	Sr. Environmental Scientist	Environmental Scientist	GIS Analyst	Administrative Assistant	
1.0 SWPPP Editorial Revisions, Inspections & Training						
Palm Beach International Airport > Total Hours	16	107	61	6	32	222
1.1 In-House Data Collection	3	18	2	0	11	34
1.2 Annual Compliance Inspections (44 Tenants)	6	30	16	0	0	52
1.3 Report Preparation	5	42	42	6	15	110
1.4 Training Workshop	2	17	1	0	6	26
North County General Aviation Airport (F45) > Total Hours	15	78	53	3	23	172
1.1 In-House Data Collection	3	10	4	0	4	21
1.2 Annual Compliance Inspections (9 Tenants)	6	18	8	0	0	32
1.3 Report Preparation	5	34	40	3	17	99
1.4 Training Workshop	1	16	1	0	2	20
Palm Beach County Park Airport (Lantana) > Total Hours	11	92	52	6	27	188
1.1 In-House Data Collection	3	10	4	0	4	21
1.2 Annual Compliance Inspections (20 Tenants)	2	26	9	0	0	37
1.3 Report Preparation	5	40	38	6	21	110
1.4 Training Workshop	1	16	1	0	2	20
Palm Beach County Glades Airport > Total Hours	9	56	17	8	14	104
1.1 In-House Data Collection	2	2	8	0	3	15
1.2 Annual Compliance Inspections (1 Tenant)	0	11	3	0	0	14
1.3 Report Preparation	4	29	6	8	9	56
1.4 Training Workshop	3	14	0	0	2	19
1.0 SWPPP Editorial Revisions, Inspections & Training Fee	\$8,925.00	\$39,294.00	\$15,555.00	\$1,794.00	\$6,048.00	\$71,616.00
2.0 Special Services	N/A	N/A	N/A	N/A	N/A	N/A
3.0 Client Coordination, Meetings and Management						
3.1 - 3.2 Coordination & Meetings with PBCDOA > Hours	10	55	14	0	2	81
3.3 Project status reports > Hours	13	13	0	0	13	39
3.0 Client Coordination, Meetings and Management Fee	\$4,025.00	\$8,024.00	\$1,190.00	\$0.00	\$945.00	\$14,184.00
Labor Totals						
Total Estimated Hours:	74	401	197	23	111	806
Sub-Total Estimated Labor Costs:	\$12,950	\$47,378	\$16,745	\$1,794	\$6,993	\$85,800.00
Sub-consultants	N/A	N/A	N/A	N/A	N/A	N/A
Expenses						
Expenses (3.9%)	\$505.05	\$1,845.40	\$653.06	\$69.97	\$272.73	\$3,346.20
Agency Permit Fee (NPDES - NOI) - N/A						\$0
TOTAL						\$89,146.20

EXHIBIT "C"
AMENDMENT NO. 3
PROPOSED SCHEDULES

PALM BEACH COUNTY GENERAL CONSULTING SERVICES

EXHIBIT C

Proposed Schedules

Task I-13-PBI-C-017

Palm Beach International Airport
PBI 3400 Belvedere Road Overflow Parking
Design Services
45 Calendar Days from NTP

Task I-13-PBI-C-018

Palm Beach International Airport
NAVAIDS Relocation Design and Bidding Services
305 Calendar Days from NTP

Task I-13-PBI-C-019

Palm Beach International Airport
FIS Expansion Construction Administration Services
270 Calendar Days from NTP

Task II-13-DOA-C-002

Palm Beach County Department of Airports
2013 Annual Environmental Compliance Monitoring,
Inspection and Training Services
395 Calendar Days from NTP

EXHIBIT "D"

AMENDMENT NO. 3

DBE

SCHEDULE 1-PARTICIPATION BY DBE

SCHEDULE 2-LETTERS OF INTENT

**SCHEDULE 1(A)
LIST OF PROPOSED DBE FIRMS
(Professional Services)**

LOI/SOQ Project Description: Palm Beach County Dept. of Airports General Consulting Services Contract

Name of Respondent: CH2M Hill, Inc.

Change Order/Task/Amendment No. (if applicable): Amendment No. 3

Contact Person: Daniel Tompkins, P.E.

E-mail Address: dtompkin@ch2m.com

Address: 3001 PGA Boulevard, Suite 300, Palm Beach Gardens, FL 33410 Phone No.: 561.904.7510 Fax No.: 561.904.7401

Name, Address & Phone No. of DBE Firm	Description of Type of Work	Classification (Check applicable box)	Percentage of DBE Participation			
			Black	Hispanic	Women	Other (Please Specify)
ADA Engineering, Inc. 1800 Old Okeechobee Road, Suite 202 West Palm Beach, FL 33409 Ph: 561-615-8880	Drainage Design and Permitting	<input type="checkbox"/> Prime Consultant <input checked="" type="checkbox"/> Subcontractor <input type="checkbox"/> Supplier <input type="checkbox"/> Manufacturer	_____ %	2.32%	_____ %	_____ %
Cyriacks Environmental Consulting Services, Inc. 3001 SW 15 th Street, Suite B Deerfield Beach, FL 33442 Ph: 954-571-0290	Environmental Compliance Monitoring, Inspection, Training and Permitting	<input type="checkbox"/> Prime Consultant <input checked="" type="checkbox"/> Subcontractor <input type="checkbox"/> Supplier <input type="checkbox"/> Manufacturer	_____ %	_____ %	28.07%	_____ %
Hillers Electrical Engineering, Inc. 23257 State Rd 7, Suite 100 Boca Raton, FL 33428 Ph: 561-451-9165	Electrical Design	<input type="checkbox"/> Prime Consultant <input checked="" type="checkbox"/> Subcontractor <input type="checkbox"/> Supplier <input type="checkbox"/> Manufacturer	_____ %	7.09%	_____ %	_____ %

Total Percentage of DBE Participation: 41.98%

Notes:

- The percentages listed on this form for each DBE Firm must be supported by the percentages included on Schedule 2(A), "Letter of Intent to Perform as a Disadvantaged Business Enterprise", in order to be counted toward attainment of the DBE goal.
- Firms identified on this form must be certified as a DBE by the State of Florida's Unified Certification Program. Certification status can be verified on the Florida Department of Transportation's Biznet website at <https://www3.dot.state.fl.us/EqualOpportunityOffice/biznet/mainmenu.asp>.
- If materials or supplies are proposed to be purchased from a DBE regular dealer, the undersigned acknowledges that only sixty percent (60%) of the proposed expenditure will be counted toward attainment of the DBE goal.

By signing this form the undersigned Respondent is committing to utilize the above referenced DBE Firms on the Project and that the Respondent will monitor the DBE Firms to ensure that the work is actually performed by the by the DBE Firms.

By: 
Signature

Date: 8/12/2013

Daniel Tompkins – Project Manager
Print Name/Title of Person Executing on Behalf of the Respondent

**SCHEDULE 1(A)
LIST OF PROPOSED DBE FIRMS
(Professional Services)**

LOI/SOQ Project Description: Palm Beach County Dept. of Airports General Consulting Services Contract

Name of Respondent: CH2M Hill, Inc. Change Order/Task/Amendment No. (if applicable): Amendment No. 3

Contact Person: Daniel Tompkins, P.E. E-mail Address: dtompkin@ch2m.com

Address: 3001 PGA Boulevard, Suite 300, Palm Beach Gardens, FL 33410 Phone No.: 561.904.7510 Fax No.: 561.904.7401

Name, Address & Phone No. of DBE Firm	Description of Type of Work	Classification (Check applicable box)	Percentage of DBE Participation			
			Black	Hispanic	Women	Other (Please Specify)
Tierra South Florida, Inc. 2765 Vista Parkway, Suite 10 West Palm Beach, FL 33411 Ph: 561-687-8539	Geotechnical Investigations	<input type="checkbox"/> Prime Consultant <input checked="" type="checkbox"/> Subcontractor <input type="checkbox"/> Supplier <input type="checkbox"/> Manufacturer	_____ %	_____ %	_____ %	4.50% (Asian/Pacific)
		<input type="checkbox"/> Prime Consultant <input type="checkbox"/> Subcontractor <input type="checkbox"/> Supplier <input type="checkbox"/> Manufacturer	_____ %	_____ %	_____ %	_____ %
		<input type="checkbox"/> Prime Consultant <input type="checkbox"/> Subcontractor <input type="checkbox"/> Supplier <input type="checkbox"/> Manufacturer	_____ %	_____ %	_____ %	_____ %

Total Percentage of DBE Participation: 41.98%

Notes:

- The percentages listed on this form for each DBE Firm must be supported by the percentages included on Schedule 2(A), "Letter of Intent to Perform as a Disadvantaged Business Enterprise", in order to be counted toward attainment of the DBE goal.
- Firms identified on this form must be certified as a DBE by the State of Florida's Unified Certification Program. Certification status can be verified on the Florida Department of Transportation's Biznet website at <https://www3.dot.state.fl.us/EqualOpportunityOffice/biznet/mainmenu.asp>.
- If materials or supplies are proposed to be purchased from a DBE regular dealer, the undersigned acknowledges that only sixty percent (60%) of the proposed expenditure will be counted toward attainment of the DBE goal.

By signing this form the undersigned Respondent is committing to utilize the above referenced DBE Firms on the Project and that the Respondent will monitor the DBE Firms to ensure that the work is actually performed by the by the DBE Firms.

By: 
Signature

Date: 8/12/2013

Daniel Tompkins – Project Manager
Print Name/Title of Person Executing on Behalf of the Respondent

**SCHEDULE 2(A)
LETTER OF INTENT TO PERFORM AS A DISADVANTAGED BUSINESS ENTERPRISE
(Professional Services)**

LOI/SOQ Project Description: Palm Beach County Department of Airports – General Consulting Services

Change Order/Task /Amendment No. (if applicable): Amendment No. 3

Name of Prime Respondent: CH2M Hill

Name of DBE Firm: A.D.A. Engineering, Inc.

The undersigned is certified as a Disadvantaged Business Enterprise by the State of Florida's Unified Certification Program. Check one or more classifications as applicable:

- Black Hispanic Women Other (Please Specify) _____
 Prime Consultant Subcontractor Manufacturer Supplier

The undersigned is prepared to perform the following described work in connection with the above-referenced project (specify in detail the particular work and/or parts thereof to be performed):

Drainage Design and Permitting

(Additional Sheets may be used as necessary.)

Total Percentage of Participation by DBE Firm for this Project: 2.32 %

and will enter into a formal agreement for work with you conditioned upon your execution of a contract with Palm Beach County.

If the undersigned intends to subcontract any portion of the work described above to another subcontractor, please complete the following:

_____ % DBE Certified
 (Name of Subcontractor) (Percentage of work to be subcontracted) Non-DBE

The undersigned affirms that it has the resources necessary to perform the work described above without subcontracting the work to another subcontractor, except as noted above.

A.D.A. Engineering, Inc.
Printed Name of DBE Subcontractor

By: 
Signature ALEX VARQUEZ, VICE PRESIDENT

Date: 8/15/2013

BizNet Profile: A D A ENGINEERING INC

Name: A D A ENGINEERING INC
Business Description: ENGINEERING FIRMS
Street: 8550 NW 33RD ST STE 101
City: DORAL State: FL Zip: 33122
County: DADE District: DISTRICT SIX
Phone: (305) 551-4608 Fax: (305) 551-8977
E-mail: aargudinjr@adaengineering.com
Work Location:
County: CNTY/ST-WIDE
District: DIST/ST WIDE
Contact: IVETTE O ARGUDIN
UCP Cert. DBE State Cert.: MBE UCP Certifying Member: FDOT
First SC: 950 First NAICS: 54133
2nd SC: 963 3rd SC: 947 4th SC: 5th SC: 6th SC: 7th SC: 8th SC: 9th SC: 10th SC:
2nd NAICS: 3rd NAICS: 4th NAICS: 5th NAICS: 6th NAICS: 7th NAICS: 8th NAICS: 9th NAICS: 10th NAICS:
ACDBE: No

NOTE:
 OBE stands for Other Business Enterprise indicating that the firm is not certified.

[Return to the Main Menu](#)

[Back to Search Results](#)

Florida Department of Transportation 2008.

SCHEDULE 2(A)
LETTER OF INTENT TO PERFORM AS A DISADVANTAGED BUSINESS ENTERPRISE
(Professional Services)

LOI/SOQ Project Description: Palm Beach County Department of Airports – General Consulting Services

Change Order/Task /Amendment No. (if applicable): Amendment No. 3

Name of Prime Respondent: CH2M Hill

Name of DBE Firm: Cyriacks Environmental Consulting Services, Inc

The undersigned is certified as a Disadvantaged Business Enterprise by the State of Florida's Unified Certification Program. Check one or more classifications as applicable:

- Black Hispanic Women Other (Please Specify) _____
 Prime Consultant Subcontractor Manufacturer Supplier

The undersigned is prepared to perform the following described work in connection with the above-referenced project (specify in detail the particular work and/or parts thereof to be performed):

Environmental Compliance Monitoring, Inspection, Training and Permitting Services

(Additional Sheets may be used as necessary.)

Total Percentage of Participation by DBE Firm for this Project: 28.07 %

and will enter into a formal agreement for work with you conditioned upon your execution of a contract with Palm Beach County.

If the undersigned intends to subcontract any portion of the work described above to another subcontractor, please complete the following:

_____ % DBE Certified
(Name of Subcontractor) (Percentage of work to be subcontracted) Non-DBE

The undersigned affirms that it has the resources necessary to perform the work described above without subcontracting the work to another subcontractor, except as noted above.

Cyriacks Environmental Consulting Services, Inc
Printed Name of DBE Subcontractor

By: Wanda Cyriack
Signature

Date: 8/15/13

BizNet Profile: CYRIACKS ENVIRONMENTAL CONSULTING SERVICES INC

Name: CYRIACKS ENVIRONMENTAL CONSULTING SERVICES INC
Business Description: ENVIRONMENTAL CONSULTING SERVICES; MITIGATION SERVICES
Street: 3001 SW 15TH STREET SUITE B
City: DEERFIELD BEACH State: FL Zip: 33442
County: BROWARD District: DISTRICT FOUR
Phone: (954) 571-0290 Fax: (954) 480-9962
E-mail: wc@cecosenvironmental.com
Work Location:
County:
District: DIST/ST WIDE
Contact: WENDY CYRIACKS
UCP Cert. DBE State Cert.: OBE UCP Certifying Member: FDOT
First SC: 950 First NAICS: 54162
2nd SC: 954 3rd SC: 4th SC: 5th SC: 6th SC: 7th SC: 8th SC: 9th SC: 10th SC:
2nd NAICS: 56291 3rd NAICS: 4th NAICS: 5th NAICS: 6th NAICS: 7th NAICS: 8th NAICS: 9th NAICS: 10th NAICS:
ACDBE: No

NOTE:

OBE stands for Other Business Enterprise indicating that the firm is not certified.

[Return to the Main Menu](#)

[Back to Search Results](#)

Florida Department of Transportation 2008.

SCHEDULE 2(A)
LETTER OF INTENT TO PERFORM AS A DISADVANTAGED BUSINESS ENTERPRISE
(Professional Services)

LOI/SOQ Project Description: Palm Beach County Department of Airports – General Consulting Services

Change Order/Task /Amendment No. (if applicable): Amendment No. 3

Name of Prime Respondent: CH2M Hill

Name of DBE Firm: Hillers Electrical Engineering, Inc.

The undersigned is certified as a Disadvantaged Business Enterprise by the State of Florida's Unified Certification Program. Check one or more classifications as applicable:

- Black Hispanic Women Other (Please Specify) _____
 Prime Consultant Subcontractor Manufacturer Supplier

The undersigned is prepared to perform the following described work in connection with the above-referenced project (specify in detail the particular work and/or parts thereof to be performed):

Electrical Engineering

(Additional Sheets may be used as necessary.)

Total Percentage of Participation by DBE Firm for this Project: 7.09 %

and will enter into a formal agreement for work with you conditioned upon your execution of a contract with Palm Beach County.

If the undersigned intends to subcontract any portion of the work described above to another subcontractor, please complete the following:

(Name of Subcontractor)

(Percentage of work to be subcontracted)

% DBE Certified
 Non-DBE

The undersigned affirms that it has the resources necessary to perform the work described above without subcontracting the work to another subcontractor, except as noted above.

Hillers Electrical Engineering, Inc.
Printed Name of DBE Subcontractor

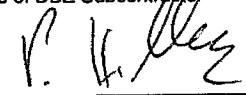
By: 
Signature

Date: 8/14/2013

BizNet Profile: HILLERS ELECTRICAL ENGINEERING INC

Name: HILLERS ELECTRICAL ENGINEERING INC
Business Description: ENGINEERING SERVICES
Street: 23257 STATE RD 7 STE 100
City: BOCA RATON State: FL Zip: 33428
County: PALM BEACH District: DISTRICT FOUR
Phone: (561) 451-9165 Fax: (561) 451-4886
E-mail: PHILLERS@HILLERSEE.COM
Work Location:
County: ST. LUCIE BROWARD INDIAN RIVER MARTIN PALM BEACH
District: DISTRICT FOUR
Contact: PAUL HILLERS
UCP Cert. DBE State Cert.: OBE UCP Certifying Member: FDOT
First SC: 942 First NAICS: 54133
2nd SC: 3rd SC: 4th SC: 5th SC: 6th SC: 7th SC: 8th SC: 9th SC: 10th SC:
2nd NAICS: 3rd NAICS: 4th NAICS: 5th NAICS: 6th NAICS: 7th NAICS: 8th NAICS: 9th NAICS: 10th NAICS:
ACDBE: No

NOTE:
OBE stands for Other Business Enterprise indicating that the firm is not certified.

[Return to the Main Menu](#)

[Back to Search Results](#)

Florida Department of Transportation 2008.

BizNet Profile: TIERRA SOUTH FLORIDA INC

Name: TIERRA SOUTH FLORIDA INC
Business Description: GEOTECHNICAL ENGINEERING CONSTRUCTION MATERIAL TESTING THRESHOLD/SPECIAL
Street: 2765 VISTA PARKWAY SUITE 10
City: WEST PALM BEACH State: FL Zip: 33411
County: PALM BEACH District: DISTRICT FOUR
Phone: (561) 687-8536 Fax: (561) 687-8570
E-mail: RAJ@TIERRASF.COM
Work Location:
County:
District:
Contact: RAJ KRISHNASAMY
UCP Cert. DBE State Cert.: MBE UCP Certifying Member: FDOT
First SC: 943 First NAICS: 54133
2nd SC: 944 3rd SC: 4th SC: 5th SC: 6th SC: 7th SC: 8th SC: 9th SC: 10th SC:
2nd NAICS: 54138 3rd NAICS: 4th NAICS: 5th NAICS: 6th NAICS: 7th NAICS: 8th NAICS: 9th NAICS: 10th NAICS:
ACDBE: No

NOTE:
OBE stands for Other Business Enterprise indicating that the firm is not certified.

[Return to the Main Menu](#)

[Back to Search Results](#)

Florida Department of Transportation 2008.