

**PALM BEACH COUNTY  
BOARD OF COUNTY COMMISSIONERS  
AGENDA ITEM SUMMARY**

**Meeting Date:** September 10, 2013  
**Department:** Water Utilities Department

**Consent [ X ]**      **Regular [ ]**  
**Public Hearing [ ]**

**I. EXECUTIVE BRIEF**

**Motion and title: Staff recommends motion to approve:** Consultant Services Authorization (CSA) No. 8 with Holtz Consulting Engineers, Inc., (R2011-0635) for State Road (SR) 15 (Main Street) and Gator Boulevard 16" and 12" Water Main Extension in the amount of \$119,905.49.

**Summary:** On May 3, 2011, the Palm Beach County Board of County Commissioners (BCC) approved the Water Utilities Department (WUD) Engineering/Professional Services Contract with Holtz Consulting Engineers, Inc. (R2011-0635). This CSA No. 8 provides design services relating to the environmental and geotechnical investigation, design and permitting of 3.2 miles of a new water main installation along SR15 (SR 80 to Gator Blvd) and along Gator Blvd (SR15 to East Sugarhouse Rd) in the City of Belle Glade. The Small Business Enterprise (SBE) participation goal established by the SBE Ordinance (R2002-0064) is 15% overall. The contract with Holtz Consulting Engineers, Inc. provides for SBE participation of 95%. This Authorization includes 82.26% overall participation. The cumulative SBE participation including this CSA is 73.58% overall. Holtz Consulting Engineers, Inc. is a local company. (WUD Project No. 13-052) District 6 (JM)

**Background and Justification:** On January 15, 2013, (R2013-0094) the BCC approved the First Amendment to the Interlocal Agreement by and among Palm Beach County (County) and the Cities of Belle Glade, Pahokee and South Bay (R2009-1033, R2009-1034 and R2009-1035). By this Amendment the County committed to make a capital contribution of \$17,500,000 to repair and replace the utility system in the City of Belle Glade in the first five (5) years following the transfer date (March 31, 2013).

WUD has determined that an additional 16" water main pipe along SR 15 from south of SR 80 to Gator Blvd and a 12" water main along Gator Blvd from SR 15 to East Sugarhouse Road will improve the service level and system reliability in the Belle Glade Area. Also these pipes will provide additional water to the Sugar Cane Growers sugar mill at East Sugarhouse Rd.

**Attachments:**

1. Location Maps
2. Two (2) Original Consultant Services Authorization No. 8

Recommended By:  8/15/13  
Department Director. Date

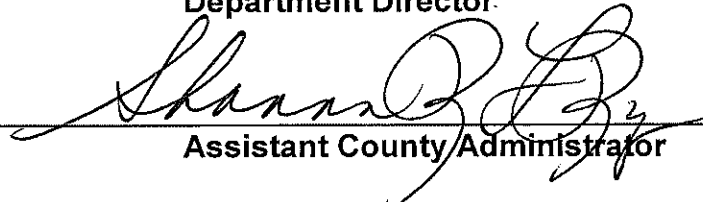
Approved By:  8/28/13  
Assistant County Administrator Date

**II. FISCAL IMPACT ANALYSIS**

**A. Five Year Summary of Fiscal Impact:**

<b>Fiscal Years</b>	<b>2013</b>	<b>2014</b>	<b>2015</b>	<b>2016</b>	<b>2017</b>
Capital Expenditures	<u>\$119,905.49</u>	<u>0</u>	<u>0</u>	<u>0</u>	<u>0</u>
External Revenues	<u>0</u>	<u>0</u>	<u>0</u>	<u>0</u>	<u>0</u>
Program Income (County)	<u>0</u>	<u>0</u>	<u>0</u>	<u>0</u>	<u>0</u>
In-Kind Match County	<u>0</u>	<u>0</u>	<u>0</u>	<u>0</u>	<u>0</u>
<b>NET FISCAL IMPACT</b>	<b><u>\$119,905.49</u></b>	<b><u>0</u></b>	<b><u>0</u></b>	<b><u>0</u></b>	<b><u>0</u></b>
<b># ADDITIONAL FTE POSITIONS (Cumulative)</b>	<b><u>0</u></b>	<b><u>0</u></b>	<b><u>0</u></b>	<b><u>0</u></b>	<b><u>0</u></b>
<b>Budget Account No.:</b>	<b>Fund <u>4011</u></b>	<b>Dept <u>721</u></b>	<b>Unit <u>W038</u></b>	<b>Object <u>6543</u></b>	

Is Item Included in Current Budget?      Yes X      No

Reporting Category N/A

**B. Recommended Sources of Funds/Summary of Fiscal Impact:**

One (1) time capital expenditure from the user fees and balance brought forward

**C. Department Fiscal Review:** Submittal

**III. REVIEW COMMENTS**

**A. OFMB Fiscal and/or Contract Development and Control Comments:**

[Signature] 8/19/2013  
OFMB [Signature] 8/16/13

[Signature] 8/22/13  
Contract Development and Control  
8-22-13 [Signature]

**B. Legal Sufficiency:**

[Signature] 8/27/13  
Assistant County Attorney

**C. Other Department Review**

\_\_\_\_\_  
Department Director

This summary is not to be used as a basis for payment.



**Palm Beach County  
Water Utilities  
Department  
Service Area (SA) and  
Major Facilities**

Attachment 1

- Legend**
- Administration
  - Water Treatment Facility
  - Reclamation Facility
  - Wastewater Reclamation Facility
  - Wastewater Treatment Facility
  - Mandatory Reclaimed SA
  - Palm Beach County Limits
  - P.B.C.W.U.D. Service Area



NOT TO SCALE

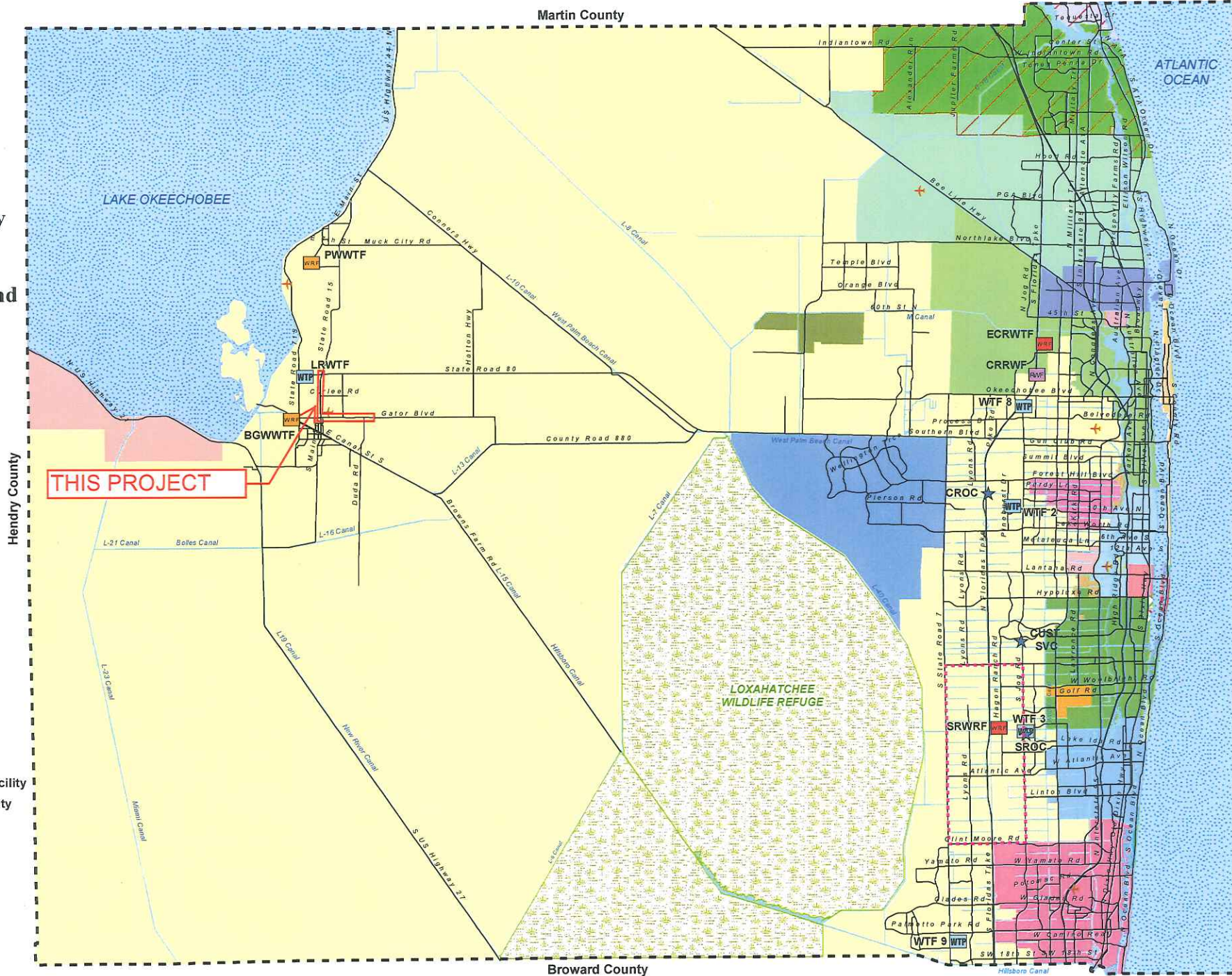



LOCATION MAP

NN

MM

TWP 43

TWP 43

TWP 43

17

18

19

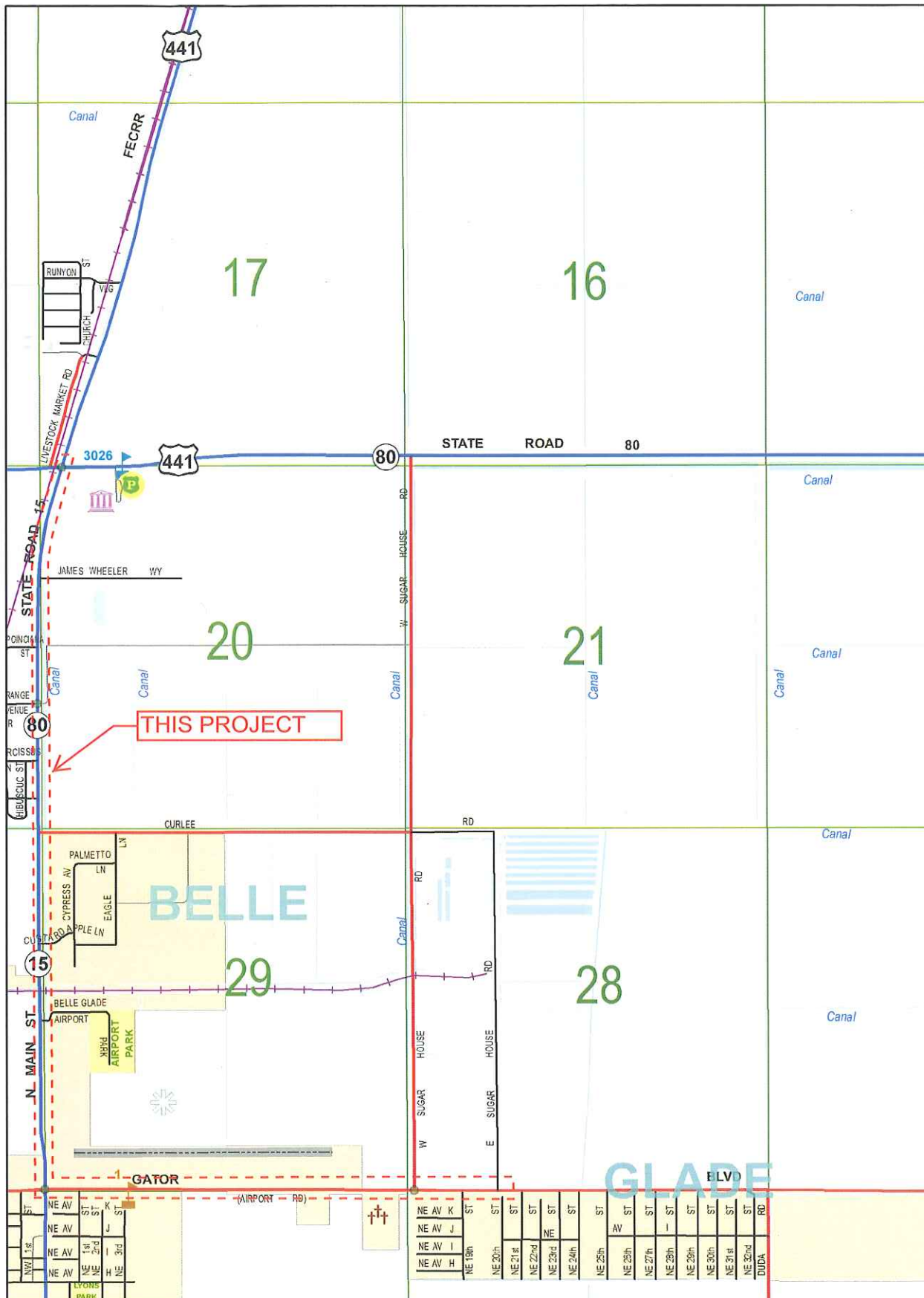

RNG 37

RNG 37

CONSULTANT SERVICES AUTHORIZATION NO. 08

Project No. WUD 13-052

Budget Line Item No. 4011-721-W038-6543

Project Title: SR-15 (Main St.) & Gator Blvd.; 16-inch and 12-inch Water Main Extension; City of Belle Glade

District No.: 6

**THIS AUTHORIZATION # 08** to the Contract for Consulting/Professional Services dated 5/3/2011 (R2011-0635), by and between Palm Beach County and the Consultant identified herein, is for the Consultant Services described in Item 3 of this Authorization. The Contract provides for 95% SBE participation overall. This Consultant Services Authorization includes 82.26% overall participation. The cumulative SBE participation, including this authorization is 73.58% overall. Additional authorization will be utilized to meet or exceed the stated overall participation goal.

1. CONSULTANT: Holtz Consulting Engineers, Inc. (HCE)
2. ADDRESS: 50 South US Highway One, Suite 206, Jupiter, FL 33477
3. Description of Services to be provided by the Consultant:  
Design and permitting services for the preparation of plans and specifications sufficient for bidding a new 16-inch and 12-inch water main in Belle Glade. The new water main will start at the intersection of State Road 80 (Hooker Highway) and State Road 15 (N. Main Street), run south to Gator Blvd, and then east to the entrance of the Sugar Cane Growers sugar mill, for a total approximate length of 3.2 miles. A more detailed description of the scope is presented in EXHIBIT "A".  
  
**See ATTACHMENT A.**
4. Services completed by the Consultant to date (Summary and Status of Authorizations):  
  
**See ATTACHMENT E.**
5. Consultant shall begin work promptly on the requested services.
6. The compensation to be paid to the Consultant for providing the requested services shall be:
  - A. Computation of time charges plus expenses, not to exceed \$N/A
  - B. Fixed price of \$119,905.49
7. This Authorization may be terminated by the County without cause or prior notice. In the event of termination not the fault of the Consultant, the Consultant shall be compensated for all services performed through the date of termination, together with reimbursable expenses (if applicable) then due.

**Project No. WUD 13-052 Consultant Services Authorization No. 08**

**Project Title SR-15 (Main St.) & Gator Blvd.: 16-inch and 12-inch Water Main Extension; City of Belle Glade Belle**

8. As described in Section 7.5 of the CONTRACT, SBE participation is included in Attachment D under this Authorization. The attached Schedule 1 defines the SBE applied to this Authorization and Schedule 2 establishes the SBE contribution from each subconsultant (Letter of Intent to perform as an SBE).
9. EXCEPT AS HEREBY AMENDED, CHANGED OR MODIFIED, all other terms, conditions and obligations of the Contract dated 5/3/2011 remain in full force and effect.

Project No. WUD 13-052 Consultant Services Authorization No. 08

Project Title SR-15 (Main St.) & Gator Blvd.; 16-inch and 12-inch Water Main Extension; City of Belle Glade Belle

IN WITNESS WHEREOF, this Authorization is accepted, subject to the terms, conditions and obligations of the aforementioned Contract.

PALM BEACH COUNTY, A POLITICAL SUBDIVISION OF THE STATE OF FLORIDA

Sharon R. Bock, Clerk & Comptroller,  
Palm Beach County

Palm Beach County,  
Board of County Commissioners

ATTEST:

Signed: \_\_\_\_\_

Signed: \_\_\_\_\_  
Steven L. Abrams, Mayor

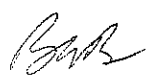

Typed Name: \_\_\_\_\_  
Deputy Clerk

\_\_\_\_\_ Date

Approved as to Form and Legal  
Sufficiency

Signed: \_\_\_\_\_

Typed Name: \_\_\_\_\_  
County Attorney

CONTRACTOR: \_\_\_\_\_

ATTEST:

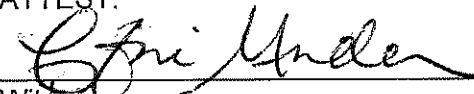
  
\_\_\_\_\_  
Witness

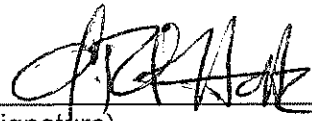
  
\_\_\_\_\_  
(Signature)

Christine Miranda, PE, Principal Engineer  
(Name and Title)

Andrea Holtz, PE, President  
(Name and Title)

(CORPORATE SEAL)

7-23-13  
Date

## LIST OF ATTACHMENTS

Project No. WUD 13-052 Consultant Services Authorization No. 08

Project Title SR-15 (Main St.) & Gator Blvd.; 16-inch and 12-inch Water  
Main Extension; City of Belle Glade

ATTACHMENT - A	Scope of Work
ATTACHMENT - B	Budget Summary
ATTACHMENT - C	Project Schedule
ATTACHMENT - D	SBE Schedule 1 and Schedule 2
ATTACHMENT - E	Authorization Status Report - Summary and Status of Authorizations
ATTACHMENT - F	Authorization Status Report – Summary of SBE/MWBE Tracking
ATTACHMENT - G	Location Map



## ATTACHMENT A

### CONSULTANT SERVICES AUTHORIZATION NO. 08

#### PALM BEACH COUNTY WATER UTILITIES DEPARTMENT ENGINEERING/PROFESSIONAL SERVICES

#### SCOPE OF WORK FOR SR-15 (MAIN ST.) & GATOR BLVD.; 16-INCH AND 12-INCH WATER MAIN EXTENSION; CITY OF BELLE GLADE

### INTRODUCTION

Palm Beach County (COUNTY) entered into an agreement entitled Contract for Engineering/ Professional Services - Palm Beach County Utilities Department Project No. WUD 11-005 (CONTRACT) with Holtz Consulting Engineers, Inc. (CONSULTANT) to provide engineering services for various general activities on (Reference Document R2011-0635). This Consultant Service Authorization will be performed under that CONTRACT.

This Consultant Services Authorization encompasses the design and permitting services for the preparation of plans and specifications sufficient for bidding a new 16-inch and 12-inch water main in Belle Glade. The new water main will start at the intersection of State Road 80 (Hooker Highway) and State Road 15 (N. Main Street), run south to Gator Blvd, and then east to the entrance of the Sugar Cane Growers sugar mill, for a total approximate length of 3.2 miles. A more detailed description of the scope is presented below.

### BACKGROUND

PBCWUD recently acquired the utilities that were previously owned and operated under the Glades Utility Authority (GUA) including the service area in the City of Belle Glade. Now under PBCWUD's ownership, improvements to the water distribution system are being made that will improve service levels and system reliability, and replace aging infrastructure. As part of the planned improvements, a new 16-inch transmission water main is proposed to connect to the existing 16-inch water main on State Road 80 (Hooker Highway) at the intersection of State Road 15 (N. Main Street), and run south to the intersection of Gator Blvd. At the intersection of Gator Blvd., the 16-inch main will be reduced to a 12-inch main and run east to the entrance of the Sugar Cane Growers sugar mill. The new water main will connect to the Repump Station located on State Road 15, hydrants and stub-outs for future connection will be provided, isolation valves will be installed approximately every 1,500 feet and air release or combination valves will be provided at high points along the pipeline.

A portion of the proposed water main alignment runs along the periphery of the Belle Glade Airport Park along both State Road 80 (west airport boundary) and Gator Boulevard (south airport boundary). The airport operated a crop dusting business for at least 70 years. During the course of the operations, agri-chemical mixing/loading occurred as did illegal discharge of chemicals onto the runways and storage areas. Chemical containers and bags were also regularly burned at the airport property. These activities were ceased in 1991. Assessment performed in the early to mid 1990s found

that the soil was impacted with several organochlorine pesticide compounds, but the primary contaminants of concern were toxaphene and DDT. There are concerns that pesticide-impacted soils exist along the alignment where the water main is to be installed. Therefore, included in this scope of services is a program of soil sampling and analysis to address the potential pesticide chemical concerns.

## **SCOPE OF SERVICES**

CONSULTANT shall perform the engineering Scope of Services as described herein.

The Consultant will be responsible for the following items:

### **Task 1– Environmental & Geotechnical Investigation**

Exploration of the subsurface conditions along the pipeline alignment will be conducted to understand the nature, sequence and relative density/consistency of the soils and/or rock that will be disclosed during excavation for the pipeline, including an environmental assessment of the pesticide contaminated soils near the Belle Glade Airport.

CONSULTANT, through SUB-CONSULTANT, Dunkelberger Engineering & Testing, Inc., a Terracon Company, will perform the following services:

#### **Environmental Investigation**

- 1.1 Prior to geotechnical drilling, mobilize to the site and drill hand auger borings at the locations of the geotechnical borings (estimated 8 boring locations). Collect soil samples from vertical intervals of 0 to 0.5 foot, 0.5 to 2 feet and 2 to 4 feet bls which is the recommended sampling interval per Chapter 62-780, FAC (Contaminated Site Cleanup Criteria).
- 1.2 Laboratory analyze the soil samples for organochlorine pesticide compounds using EPA Method 8081. After the initial data is received from the laboratory, select three of the samples for synthetic precipitation leaching procedure (SPLP) testing for pesticides.
- 1.3 Evaluate the data and compare it to the State of Florida soil cleanup target levels (SCTLs). The data will be utilized to evaluate safety concerns for drillers and future utility workers. It will also used to determine appropriate management/disposal procedures for soil excavated during utility construction.
- 1.4 Prepare a brief summary of the results of the sampling and analysis as well as discussion of safety concerns and soils management during construction which will be incorporated into the geotechnical report.

#### **Geotechnical Investigation**

- 1.5 Submit a Right-of-Way-Use Permit application for work within the State of Florida Department of Transportation right-of way.
- 1.6 Stake borings along the pipeline alignment on a nominal spacing of 500 feet. The boring locations will be cleared through the Sunshine utility network.
- 1.7 The borings will be drilled to a depth of 10 feet using a conventional truck-mounted drilling rig and samples of the sub-soils will be obtained at frequent vertical intervals in accordance with protocol established by ASTM D 1586 (the

Standard Penetration Test). Two of the borings will be deepened to 30 feet in the event that directional drilling is needed for utility installations. These will be located at the intersection of SR 80 and Gator Boulevard, and at the intersection of Gator Boulevard and Sugar House Road. The boreholes will be backfilled with neat cement grout upon their completion.

- 1.8 Samples from the borings will be transported to SUB-CONSULTANT's West Palm Beach laboratory where they will be reviewed by a geotechnical engineer and classified in accordance with the Unified Soil Classification System (ASTM D 2487) and geologic nomenclature and appropriate. A limited scope of laboratory testing will be completed to verify the classifications.
- 1.9 Submit a geotechnical engineering report with factual data from the borings, recommendations for excavations, dewatering, pipe bedding, backfill material composition and compaction requirements, and lateral earth pressure design criteria.

## **Task 2 – Engineering Design**

- 2.1 The CONSULTANT will provide engineering services consisting of preparation of Plans and Specifications for the proposed new water main. The Plans and Specifications will be sufficient to convey the extent and nature of the work to be accomplished. Survey information, including location and layout of existing facilities, topographic information, easements and rights-of-way, etc. shall be as provided by the COUNTY under separate Contract with Dennis J. Leavy & Assoc. This information will be used to prepare base drawings for the existing facilities and the proposed water main. The CONSULTANT will also utilize available plans and record drawing information provided by the COUNTY for the preparation of engineering base drawings. COUNTY aerial photos will also be utilized to aid in the preparation of the engineering base drawings to be used in the plans.
- 2.2 CONSULTANT is aware of the pesticide contaminated soils in the vicinity of the Belle Glade Airport, and will ensure that the design of the new water main and materials specified will meet regulatory and site condition requirements. Discussions held between the CONSULTANT and FDEP indicate no permitting or permit forms related to waste cleanup will be required, and therefore, these services are not included as part of this CSA.
- 2.3 The plans will include plan and profiles for the water main pipe routing, addressing all known conflict resolutions, and connection details to existing water mains. Palm Beach County standard typical details will be utilized to prepare the project plans. The COUNTY's Minimum Design & Construction Standards will be supplemented with the CONSULTANT's standard specifications as applicable to the project for preparation of the project technical specifications to be included in the bidding documents. Drawings will be prepared on a 1" = 20' scale. It is anticipated that thirty-four (34) engineering plan sheets will be required for the new water main, 28 sheets for plan and profile of the water main, cover sheet, index sheet, legend & general notes, and three detail sheets.
- 2.4 CONSULTANT shall request record information from other utility companies including, but not limited to: Florida Power and Light, AT&T, Bellsouth, Comcast Cable, Teco Gas, Palm Beach County Traffic Operations, etc. for location of their utilities so that they may be added to the plans.

- 2.5 The CONSULTANT will provide two (2) full size (24" x 36") sets of plans for review and comment by the COUNTY at the 30% and 90% complete stages. The submittals will also include a draft outline of the specifications table of contents with the 30% complete submittal, and an updated table of contents and complete draft of the technical specifications sections with the 90% complete submittal. The CONSULTANT will provide CAD files and PDF files of the final (100% complete) drawings and "Word" files and one set of un-bound technical specifications and a bid schedule for preparation of bid sets. The COUNTY will prepare the front end bidding documents utilizing their standard documents. The CONSULTANT will provide the COUNTY three (3) full size (24" x 36") signed-and-sealed sets of final plans and three (3) signed-and-sealed copies of the technical specifications upon final completion for COUNTY's use.

### **Task 3 – Permitting**

- 3.1 CONSULTANT shall prepare permit applications for construction of the water mains for submittal to the following agencies:
- Florida Department of Environmental Protection (FDEP) (Drinking Water Permit & Coordination with the FDEP regarding the Pesticide Contaminated Site at the Airport)
  - Florida Department of Transportation (FDOT) Right-of-Way Permit
  - East Beach Water Control District Improvement District
  - City of Belle Glade
- 3.2 Engineer will coordinate with the permitting agencies during the review process on a regular basis in an effort to keep the project on schedule and respond to their review comments.
- 3.3 Permit fees will be paid by PBCWUD. CONSULTANT will respond to requests for information (RFIs) from the permitting agencies.

### **Task 4 - Project Management**

Project management includes Consultant Services Authorization administration, QA/QC, and project meetings (other than workshops) with COUNTY staff.

- 4.1 Consultant Services Authorization Administration: The progress of the project will be monitored and resources will be managed to achieve the schedule, budget, and work quality goals of the project. The CONSULTANT will keep the COUNTY informed as to the status and progress of the project. Communications with the COUNTY will be conducted under this Task.
- 4.2 QA/QC: The CONSULTANT will be conducting internal QA/QC review of the deliverables for conformance to Contract requirements and internal program requirements. The results of these reviews will be incorporated into the deliverables prior to submission to the COUNTY for review and comment.
- 4.3 Project Meetings and Site Visits: Attend and participate in project meetings with COUNTY staff. A total of up to four (4) meetings and two (2) site visits have been budgeted for as follows:

- a. Attend up to four (4) meetings total during the design phase of the project. Meetings are anticipated as follows: one (1) design kick-off meeting and interview/discussions with COUNTY staff, one (1) 30% complete submittal review meeting, one (1) 90% complete submittal review meeting, and one (1) 100% (final plans & specifications) submittal review meeting.
- b. Conduct up to two (2) site visits to coordinate the completion of the project and review/verify the conditions with COUNTY staff related to the visual field review of proposed water main route.

#### **COUNTY RESPONSIBILITIES**

1. Designate a Project Representative, as COUNTY's representative and primary contact for CONSULTANT. CONSULTANT will rely on COUNTY's designated Project representative for instructions and approval of CONSULTANT's services.
2. Provide survey base drawings for the water main route for CONSULTANT's use in preparing project drawings depicting existing conditions and the project work for the plans.
3. Payment for all permit fees.
4. Provide any existing drawings and other pertinent information to the project and project schedule.
5. Provide prompt review and comment on all deliverables.
6. Attendance of key COUNTY personnel at meetings as requested.

#### **COMPENSATION**

The CONSULTANT will be compensated in accordance with the attached budget summary (Attachment A), a lump sum amount of \$119,905.49. Monthly progress payments will be authorized based on percent complete as determined by CONSULTANT and approved by the COUNTY.

## ATTACHMENT – B CONSULTANT SERVICES AGREEMENT NO. 08

Task No.	Sub Task	Task Description	Labor Classifications and Hourly Rates					HCE Totals		Total Sub-Consultant Services
			Principal/ Associate QA/QC \$56.25	Project Manager \$56.25	Project Engineer \$38.95	Project Engineer \$32.00	CADD Technician \$30	Technical Typist Admin \$17	Total Hours	
1		Environmental & Geotechnical Investigation								\$21,262.00
2		Design	33	132		264	264	693	\$25,649.25	
3		Permitting	4	8		32	16	60	\$2,179.00	
4		Project Management	20	60		20		100	\$5,140.00	
									\$32,968.25	\$21,262.00

LABOR TOTAL HOURS	57	200	0	316	280	0	853	/
LABOR RAW COSTS	\$3,206.25	\$11,250.00	\$0.00	\$10,112.00	\$8,400.00	\$0.00	/	\$32,968.25
LABOR MULTIPLIER	2.92	2.92	2.92	2.92	2.92	2.92	/	/
LOADED LABOR COST	\$9,362.25	\$32,850.00	\$0.00	\$29,527.04	\$24,528.00	\$0.00	/	\$96,267.29
TOTAL LABOR COST	\$96,267.29							
SUB-CONSULTANT COSTS TOTAL	\$21,262.00							
SUB-CONSULTANT MULTIPLIER	1.1							
SUB-CONSULTANT TOTAL	\$23,388.20							
REIMBURSABLE EXPENSES	\$250.00							
TOTAL PROJECT FEE	\$119,905.49							



## ATTACHMENT - C

### PROJECT SCHEDULE

The completion dates for this work will be as follows (starting from CONSULTANT'S receipt of Notice-to-Proceed).

<u>Engineering Services</u>	<u>Completion Date From Notice to Proceed</u>
Task 1 – Environmental & Geotechnical Investigation	60 days
Task 2 – Engineering Design	30% Submittal - 45 days from receipt of complete survey or 30 days upon completion of Task 1, whichever is later  90% Submittal – 60 days from receipt of PBC written review comments on 30% submittal  100% Final Submittal – 30 days from receipt of PBC review comments on 90% complete submittal
Task 3 – Permitting	60 days after completion of Task 2
Task 4 – Project Management	Throughout CSA duration

## ATTACHMENT D SCHEDULE #1

### LIST OF PROPOSED SBE-M/WBE PRIME/SUBCONTRACTORS

PROJECT NAME: Belle Glade SR-15 and Gator Blvd. New 16-Inch and 12-Inch Water Main PROJECT NUMBER: WUD 13-052

PROJECT OF PRIME BIDDER: Holtz Consulting Engineers, Inc. ADDRESS: 50 South US Highway One, Suite 206, Jupiter FL 33477

CONTACT PERSON: Christine Miranda, PE PHONE NO.: 561-575-2005 FAX NO.: 561-575-2009

BID OPENING DATE: N/A DEPARTMENT: Water Utilities

#### PLEASE IDENTIFY ALL APPLICABLE CATEGORIES

Name, Address and Telephone Number of Minority Contractor	(Check one or both Categories)		Dollar Amount				
	Minority Business	Small Business	Black	Hispanic	Woman	Caucasian	Other (Please Specify)
Holtz Consulting Engineers, Inc. 50 South US Highway One, Suite 206 Jupiter, FL 33477 (561) 575 - 2005	<input checked="" type="checkbox"/>	<input checked="" type="checkbox"/>	\$ -	\$98,643.49	\$ -	\$ -	
	<input type="checkbox"/>	<input type="checkbox"/>	\$ -	\$ -	\$ -	\$ -	\$ -
	<input type="checkbox"/>	<input type="checkbox"/>	\$ -	\$ -	\$ -	\$ -	\$ -
	<input type="checkbox"/>	<input type="checkbox"/>	\$ -	\$ -	\$ -	\$ -	\$ -
	<input type="checkbox"/>	<input type="checkbox"/>	\$ -	\$ -	\$ -	\$ -	\$ -
PRIME CONTRACTOR TO COMPLETE:		TOTAL	\$ -	\$98,643.49	\$ -	\$ -	\$ -

BID PRICE: \$ 119,905.49 Total Value of SBE Participation \$ 98,643.49

- NOTE:
1. The amount listed on this form for a Subconsultant must be supported by price or percentage included on Schedule 2 or a proposal from each Subconsultant listed in order to be counted toward goal attainment.
  2. Firms may be certified by Palm Beach County as an SBE and/or an M/WBE. If firms are certified as both an SBE and M/WBE, please indicate the dollar amount under the appropriate category.
  3. M/WBE information is being collected for tracking purposes only.

# ATTACHMENT - E

## AUTHORIZATION STATUS REPORT

### SUMMARY AND STATUS OF REQUESTS FOR AUTHORIZATIONS

Auth. No.	Description	Status	Project Total Amount	Date Approved	WUD No. Assigned	Consultant's Project No.
1	South County Pre-stressed Concrete Cylinder Pipe (PCCP) Evaluation	Approved	\$173,791.53	10/18/2011	11-032	
2	Services During Construction for the Southern Region Pumping Facility Concentrate Bypass Project	Cancelled	\$45,805.35	12/15/2011	12-012	
3	South County Pre-stressed Concrete Cylinder Pipe (PCCP) Bathymetric Surveys of Aerial Crossings No. 3 & No. 4	Approved	\$7,590.00	8/31/2012	11-032	
4	Conversion of Dry Can Lift Stations No. 941, 948, 970,973,1040, 1056, 1082, & 1083	Approved	\$99,959.24	10/24/12	13-001	
4.1	Conversion of Dry Can Lift Stations No. 941, 948, 970,973,1040, 1056, 1082, & 1083 – FM Addition	Approved	\$6,786.80	1/16/13	13-001	
5	Condition and Risk Assessment of Master Wastewater Repump Stations	Approved	\$59,864.54	3/13/2013	13-042	
5.1	Condition and Risk Assessment of Master Wastewater Repump Stations – Supplement – Addition of Master Repump Stations Nos. 4200, 5133, 5195, 265, 5015, 8101, South Bay Master Station, 8201, 8202, 8146, & 8302	Pending	\$19,022.59			
6	Conversion of Dry Can Lift Stations Nos. 169, 171, 263, 966, 1023, 1051, 1057, & 5240 and Demolition of Dry Can Lift Station No. 265	Approved	\$99,959.24	3/27/13	13-034	
6.1	Conversion of Dry Can Lift Stations Nos. 169, 171, 263, 966, 1023, 1051, 1057, & 5240 and Demolition of Dry Can Lift Station No. 265 – Supplement - Addition of New Lift Station at No. 265, Conversion of Dry Can Lift Station No. 5056, Re-Route Force Main Tie-Ins for Lift Stations Nos. 1051 and 1057, and add new manhole and gravity main for future connections at Lift Station No. 171	Approved	\$34,963.31	4/30/13	13-034	
7	Capital Improvement Plan Prioritization	Pending	\$30,632.98			
8	Belle Glade SR-15 And Gator Blvd. New 16-Inch and 12-Inch Water Main	Pending	\$119,905.49			
<b>Total</b>			<b>\$698,281.07</b>			

**ATTACHMENT - F**

**AUTHORIZATION STATUS REPORT  
UTILITY DISTRIBUTION & COLLECTION SYSTEM CONSULTING SERVICES**

SUMMARY OF  
SMALL BUSINESS TRACKING SYSTEM

Work Authorization No. 7

	Total	SBE
<b>Current Proposal</b>		
Value of Authorization No. 8	\$119,905.49	0
Value of SBE Letters of Intent	\$98,643.49	98,643.49
Actual Percentage	82.26%	82.26%
<b>Signed Authorizations</b>		
Total Value of Authorizations	\$528,720.01	0
Total Value of SBE Signed Subcontracts	\$378,620.01	\$378,620.01
Actual Percentage	71.61%	71.61%
<b>Signed Authorizations Plus Current Proposal</b>		
Total Value of Authorizations	\$648,625.50	0
Total Value of Subcontracts & Letters of Intent	\$477,263.50	\$477,263.50
Actual Percentage	73.58%	73.58%
<b>Goal</b>	<b>95.00%</b>	<b>95.00%</b>

# ATTACHMENT G

## PROJECT LOCATION MAP

ATTACHMENT G



Palm Beach County  
Water Utilities  
Department  
Service Area (SA) and  
Major Facilities

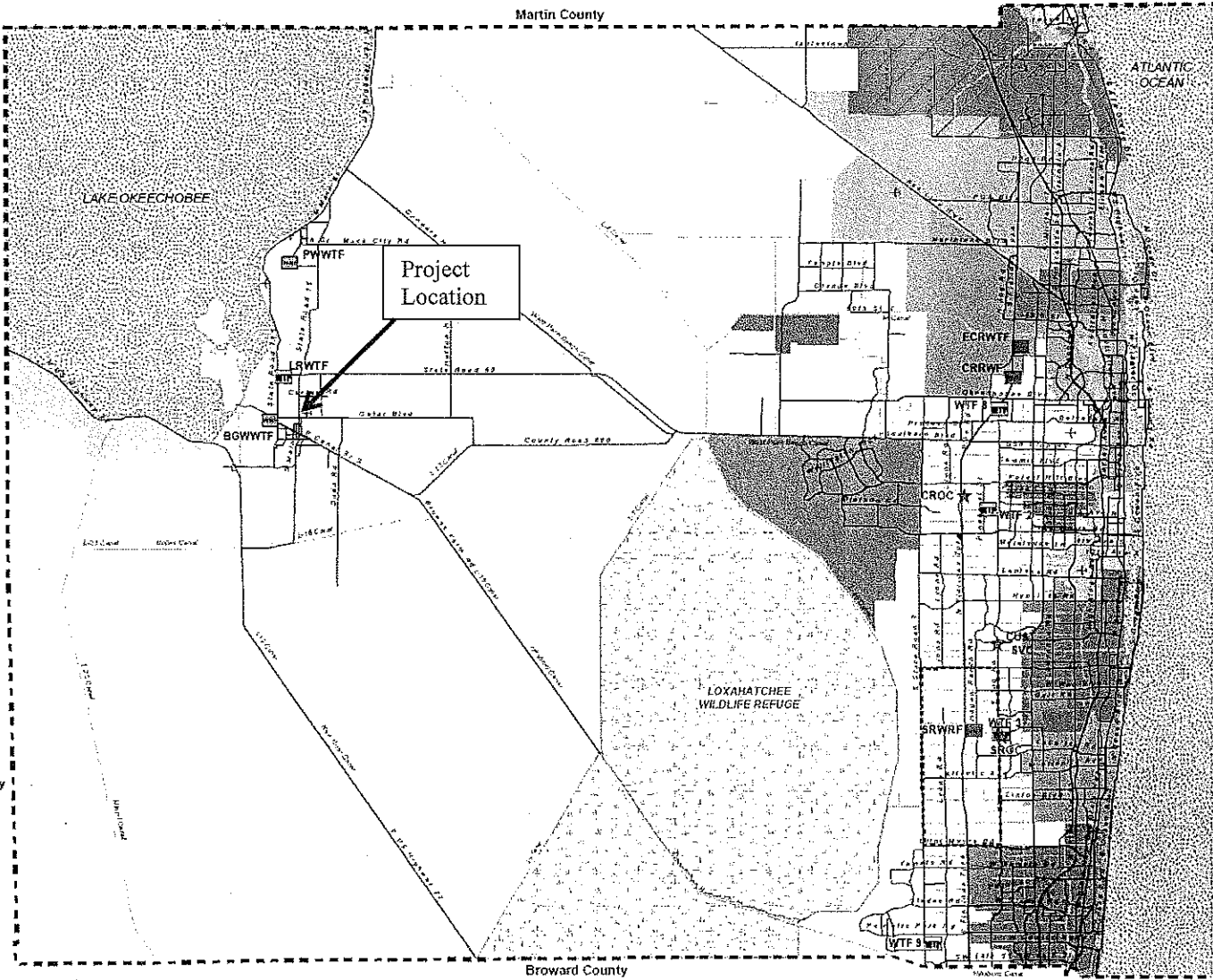

**Legend**

- ★ Administration
- Water Treatment Facility
- Reclamation Facility
- Wastewater Reclamation Facility
- Wastewater Treatment Facility
- Mandatory Reclaimed SA
- ▬ Palm Beach County Limits
- ▬ P.B.C.W.U.D. Service Area



Holtz Consulting Engineers, Inc.  
50 South US Highway One, Suite 206  
Jupiter, Florida 33407

June 27, 2013

Attention: Ms. Christine Miranda, P.E.

Subject: *Proposal - Geotechnical Engineering Services*  
**Palm Beach County Water Utilities Glades Water Main Project**  
**Belle Glade, Florida**

Dear Ms. Miranda:

### INTRODUCTION

Pursuant to your June 24, 2013 request for proposal, Dunkelberger Engineering & Testing, A Terracon Company (Dunkelberger/Terracon) is pleased to submit this proposal for geotechnical engineering services in connection with the above referenced project. We understand that the project will consist of the design and construction of a new water main in the City of Belle Glade, within the jurisdiction of Palm Beach County Water Utilities. We anticipate that the water main will be constructed using conventional cut and cover methods, and will bottom approximately 5 feet below surface grades. The new pipeline will follow the alignment as described below:

- Beginning at the intersection of State Road (SR) 80 and US 441, trending south to the intersection of SR 80 and Gator Boulevard (distance of approximately 2 miles).
- From the intersection of SR 80 and Gator Boulevard, trending east to Sugar House Road (distance of approximately 1 mile).
- The total length of the project is estimated to be 3 miles.
- The new pipeline will be within the existing roadway right-of-way; however, for much of the SR 80 portion, the alignment will be east of the existing canal that parallels the east side of the highway. It may follow either the north or south sides of Gator Boulevard.

### PROJECT CONSIDERATIONS

A portion of the proposed water main alignment runs along the periphery of the Belle Glade Airport Park along both State Road 80 (west airport boundary) and Gator Boulevard (south airport boundary). The airport operated a crop dusting business for at least 70 years. During the course of the operations, agri-chemical mixing/loading occurred as did illegal discharge of chemicals onto the runways and storage areas. Chemical containers and bags were also regularly burned at the airport property. These activities were ceased in 1991. Assessment performed in the early to mid 1990s found that the soil was impacted with several organochlorine pesticide compounds, but the primary contaminants of concern were toxaphene and DDT. There are concerns that pesticide impacted soils exist along the alignment where the water main is to be installed. Therefore, a program of soil sampling and analysis is needed to address potential pesticide chemical concerns.

From a geotechnical engineering viewpoint, exploration of the subsurface conditions along the pipeline alignment is to be conducted to understand the nature, sequence and relative density/consistency of the soils and/or rock that will be disclosed during excavation for the pipeline.



### SCOPE OF WORK

Our proposed work scope, a schedule for its completion, and cost estimate are presented below. The work has been subdivided into that required for environmental and that for geotechnical.

#### Environmental

- Prior to geotechnical drilling, mobilize to the site and drill hand auger borings at the locations of the geotechnical borings (estimated 8 boring locations). Collect soil samples from vertical intervals of 0 to 0.5 foot, 0.5 to 2 feet and 2 to 4 feet bls which is the recommended sampling interval per Chapter 62-780, FAC (Contaminated Site Cleanup Criteria).
- Laboratory analyze the soil samples for organochlorine pesticide compounds using EPA Method 8081. After the initial data is received from the laboratory, select three of the samples for synthetic precipitation leaching procedure (SPLP) testing for pesticides.
- Evaluate the data and compare it to the State of Florida soil cleanup target levels (SCTLs). The data will be utilized to evaluate safety concerns for drillers and future utility workers. It will also used to determine appropriate management/disposal procedures for soil excavated during utility construction.
- Prepare a brief summary of the results of the sampling and analysis as well as discussion of safety concerns and soils management during construction which will be incorporated into the geotechnical report.

#### Geotechnical

For the subsurface exploration along the pipeline alignment, we propose the following scope of work.

- Submit a Right-of-Way Use Permit application for work within the State of Florida Department of Transportation right-of way.
- Stake borings along the pipeline alignment on a nominal spacing of 500 feet. The boring locations will be cleared through the Sunshine utility network.
- The borings will be drilled to a depth of 10 feet using a conventional truck-mounted drilling rig and samples of the subsoils will be obtained at frequent vertical intervals in accordance with protocol established by ASTM D 1586 (the Standard Penetration Test). Two of the borings will be deepened to 30 feet in the event that directional drilling is needed for utility installations. These will be located at the intersection of SR 80 and Gator Boulevard, and at the intersection of Gator Boulevard and Sugar House Road. The boreholes will be backfilled with neat cement grout upon their completion.
- Samples from the borings will be transported to Dunkelberger's West Palm Beach laboratory where they will be reviewed by a geotechnical engineer and classified in accordance with the Unified Soil Classification System (ASTM D 2487) and geologic nomenclature and appropriate. A limited scope of laboratory testing will be completed to verify the classifications.

**DUNKELBERGER**

- Submit a geotechnical engineering report with factual data from the borings, recommendations for excavations, dewatering, pipe bedding, backfill material composition and compaction requirements, and lateral earth pressure design criteria.

### SCHEDULE

Following is an outline of the schedule which we anticipate for this project:

#### Week 1

- Notice to Proceed and Executed Contract
- Submit FDOT Right-of-Way Use Permit Application

#### Weeks 2 and 3

- Field Mark Geotechnical Boring Locations and Begin Utility Clearance Process
- Begin Environmental Sampling and Laboratory Testing Work

#### Weeks 4 thru 6

- Complete Utility Clearance Process
- Complete Environmental Laboratory Testing
- Obtain FDOT Right-of-Way Use Permit Application
- Drill Geotechnical Borings

#### Weeks 7 and 8

- Complete Geotechnical Laboratory Testing
- Compile and Submit Geotechnical Engineering Report

### FEE ESTIMATE

Based upon our understanding of the proposed construction, the project considerations described previously, and our general knowledge of the subsurface conditions of the site area, we suggest our work be compensated for on a unit fee basis with a maximum limiting amount of **\$21,262**. This amount will not be exceeded without due cause and your prior written authorization. An itemized breakdown of this amount is provided on Attachment 1. Unit rates provided on the attachment are consistent with our current continuing services contract with Palm Beach County.

(THIS SPACE INTENTIONALLY LEFT BLANK)

**DUNKELBERGER**

Thank you for considering Dunkelberger for this assignment. If the terms of this proposal are satisfactory, kindly sign and return one copy of this letter for our files. Other terms of this contract are provided on the General Conditions (Attachment 2), which are hereby made part of this contract. If the proposal contents require any clarification or amplification, please feel free to contact us.

Very truly yours,

**DUNKELBERGER ENGINEERING & TESTING, A TERRACON COMPANY**



Kevin E. Aubry, P.E.  
Geotechnical Services Manager

Attachments: 1 – Fee Estimate  
2 - General Conditions

Accepted this \_\_\_\_\_ day of \_\_\_\_\_, 2013.

\_\_\_\_\_  
Company

\_\_\_\_\_  
Signature

\_\_\_\_\_  
Name and Title

**DUNKELBERGER**

**ATTACHMENT 1  
PALM BEACH COUNTY GLADES WATER MAIN PROJECT  
DUNKELBERGER ENGINEERING & TESTING, A TERRACON COMPANY  
GEOTECHNICAL ENGINEERING SERVICES**

ITEM DESCRIPTION	UNITS	QUANT.	UNIT RATE	FEE
<b>ENVIRONMENTAL</b>				
A. Soil Sampling	hours	8	\$ 75.22	\$601.76
B. Environmental Sampling Supplies	LS	1	\$ 100.00	\$100.00
C. Soil Pesticide Lab Analysis (EPA 8081)	each	24	\$ 130.00	\$3,120.00
D. SPLP Testing for Pesticides	each	3	\$ 225.00	\$675.00
E. Reporting (Engineer/ geologist)	hours	8	\$ 84.64	\$677.12
F. Project Manager	hours	4	\$ 124.77	\$499.08
			<b>SUBTOTAL - ENVIRONMENTAL</b>	<b>\$5,672.96</b>
<b>GEOTECHNICAL</b>				
<b>I. PROJECT START UP &amp; MOBILIZATION</b>				
A. FDOT Permit Application	hours	6	\$ 84.64	\$507.84
B. Stake Boring Locations & Utility Clearance	hours	16	\$ 75.22	\$1,203.52
C. Drilling Rig Mobilization	each	1	\$ 350.00	\$350.00
			<b>SUBTOTAL - START UP &amp; MOB</b>	<b>\$2,061.36</b>
<b>II. FIELD EXPLORATION</b>				
A. SPT Borings (30 to 10' and 2 to 30' deep)	feet	360	\$ 12.00	\$4,320.00
B. Grout Seal Boreholes	feet	360	\$ 4.00	\$1,440.00
C. Field Inspector	hours	24	\$ 75.22	\$1,805.28
			<b>SUBTOTAL - FIELD EXPLORATION</b>	<b>\$7,565.28</b>
<b>III. LABORATORY TESTING</b>				
A. Visual Engineering Classification	hours	4	\$ 75.22	\$300.88
B. Moisture Content Test	each	16	\$ 10.00	\$160.00
C. Organic Content Test	each	8	\$ 50.00	\$400.00
D. Grain Size Distribution	each	8	\$ 65.00	\$520.00
			<b>SUBTOTAL - LABORATORY TESTING</b>	<b>\$1,380.88</b>
<b>IV. ENGINEERING &amp; REPORT PREPARATION</b>				
A. Senior Geotechnical Engineer	hours	8	\$ 124.77	\$998.16
B. Project Engineer, P.E.	hours	32	\$ 84.64	\$2,708.48
C. CADD	hours	8	\$ 63.72	\$509.76
D. Engineering Technician	hours	8	\$ 45.62	\$364.96
			<b>SUBTOTAL - ENGINEERING</b>	<b>\$4,581.36</b>
			<b>SUBTOTAL - GEOTECHNICAL</b>	<b>\$15,588.88</b>

**Maximum Limiting Amount**

**\$21,262**

**GENERAL CONDITIONS**

"Dunkelberger Engineering & Testing, Inc. (Dunkelberger) and Client Agreement"

1. **Payment Terms:** Invoices are due and payable upon receipt. Invoices not paid within 30 days of date rendered will be assessed a finance charge of one percent per month, or fraction thereof, for each month beyond 30 days past due. Invoices not paid within 60 days will result in Dunkelberger stopping work until such invoices rendered are paid in full. Invoices not paid within 90 days of the date rendered will be referred for collection. Client will be responsible for all expenses incurred by Dunkelberger in the collection of any unpaid invoice, including the actual attorneys' fees and costs charged by our legal counsel.
2. **Insurance:** Dunkelberger maintains Workers' Compensation and Employer's Liability Insurance in conformance with applicable State law. In addition, Dunkelberger maintains Professional Liability Insurance with Limits of \$2,000,000 each claim, \$3,000,000 aggregate; General Liability Insurance with Limits of \$1,000,000 each occurrence, \$2,000,000 aggregate; Automobile Liability Insurance with a Limit of \$1,000,000 each occurrence and Commercial Umbrella Excess Liability Insurance with Limits of \$4,000,000 each occurrence, \$4,000,000 aggregate. A certificate of insurance can be supplied evidencing such coverage, upon request.
3. **Access to Site:** Client will arrange and provide such access to the site as is necessary for Dunkelberger to perform the work. Dunkelberger shall take reasonable measures and precautions to minimize damage to the site and any improvements located thereon as the result of its work or the use of its equipment; however, Dunkelberger has not included in its fee the cost of restoration of damage which may occur. If Client desires or requires Dunkelberger to restore the site to its former condition, upon written request Dunkelberger will perform such additional work as is necessary to do so and Client agrees to pay to Dunkelberger the cost thereof.
4. **Damage to existing man-made objects:** Unless Dunkelberger has assumed in writing the responsibility of locating subsurface or latent conditions, Client agrees to indemnify and save Dunkelberger harmless from all claims, suits, losses, costs and expenses, including reasonable attorneys' fees as a result of personal injury, death or property damage occurring with respect to Dunkelberger's performance of its work and arising from subsurface or latent conditions or damage to subsurface or latent objects, structures, lines or conduits where the actual or potential presence and location thereof was not revealed to Dunkelberger by Client.
- 5a. **Warranty:** Dunkelberger's services will be performed, its findings obtained, and its reports prepared in accordance with its proposal, Client's acceptance thereof, these General Conditions, and with generally accepted principles and practices. In performing its professional services, Dunkelberger will use that degree of care and skill ordinarily exercised under similar circumstances by members of its profession. This warranty is in lieu of all other warranties or representations, either expressed or implied.
- 5b. **Risk Allocation:** Should Dunkelberger or any of its professional employees be found to have been negligent in the performing of professional services or work or to have made and breached any expressed or implied warranty, representation or contract, Client, all parties claiming through Client, and all parties claiming to have in any way relied upon Dunkelberger's services or work agree that the maximum aggregate amount of the liability of Dunkelberger, its officers, employees, and agents shall be limited to \$50,000 or the total amount of the fee paid to Dunkelberger for its work performed with respect to the project, whichever amount is greater. Client expressly agrees that it has received consideration for this agreement to limit liability in the form of a lower contract price.  
  
Client may, upon written request received within five days of Client's acceptance hereof, increase the limit of Dunkelberger's liability to \$500,000 or the amount of Dunkelberger's fee, whichever is the greater, by agreeing to pay Dunkelberger a sum equivalent to an additional amount of 5% of the total fee, or \$400, whichever is greater. This charge is not to be construed as being a charge for insurance of any type but is increased consideration for the greater liability involved.
6. **Indemnity:** Subject to the above limitations, Dunkelberger agrees to indemnify and hold Client harmless from and against any and all claims, suits, costs and expenses including reasonable attorney's fees and court costs arising out of Dunkelberger's negligence to the extent of Dunkelberger's negligence. Client shall provide the same protection to the extent of its negligence. In the event that Client shall bring any suit or claim against Dunkelberger, the Client shall pay to Dunkelberger the costs and expenses incurred by Dunkelberger to answer and defend it, including reasonable attorneys' fees and court costs, to the extent that Dunkelberger shall prevail in such suit.
7. **Governing Law:** This agreement shall be governed in all respects by the laws of the State of Florida.