

II. FISCAL IMPACT ANALYSIS

A. Five Year Summary of Fiscal Impact:

| Fiscal Years | 2014 | 2015 | 2016 | 2017 | 2018 |
|--------------------------------|-------------------------|-------------------|-------------------|-------------------|-------------------|
| Capital Expenditures | <u>\$137,710</u> | <u>-0-</u> | <u>-0-</u> | <u>-0-</u> | <u>-0-</u> |
| Operating Costs | <u>-0-</u> | <u>-0-</u> | <u>-0-</u> | <u>-0-</u> | <u>-0-</u> |
| External Revenues | <u>-0-</u> | <u>-0-</u> | <u>-0-</u> | <u>-0-</u> | <u>-0-</u> |
| Program Income (County) | <u>-0-</u> | <u>-0-</u> | <u>-0-</u> | <u>-0-</u> | <u>-0-</u> |
| In-Kind Match (County) | <u>-0-</u> | <u>-0-</u> | <u>-0-</u> | <u>-0-</u> | <u>-0-</u> |
| NET FISCAL IMPACT | <u>\$137,710</u> | <u>-0-</u> | <u>-0-</u> | <u>-0-</u> | <u>-0-</u> |
| # ADDITIONAL FTE | | | | | |
| POSITIONS (Cumulative) | | | | | |

Is Item Included in Current Budget? Yes X No

Budget Account No:

Fund 3501 Dept 361 Unit 0994 Object 6505

Recommended Sources of Funds/Summary of Fiscal Impact:

Road Impact Fee Fund - Zone 1

Silver Beach Rd/E of Congress to Old Dixie Hwy

| | |
|---------------------------------|---------------------|
| Supplement #11 - Basic Services | \$120,703.21 |
| - Optional Services | <u>\$ 17,006.00</u> |
| Supplement Total | \$137,709.21 |

C. Departmental Fiscal Review:

III. REVIEW COMMENTS

A. OFMB Fiscal and/or Contract Dev. and Control Comments:

A. OFMB Fiscal and/or Contract Dev. and

[Signature] 9/11/2012

OFMB 9/11/13 9/11/13

Comments:

Dr. J. Jacoby 9/26/13

Contract Dev. and Control

9-26-13 B. Wick

**B. Approved as to Form
and Legal Sufficiency:**

Marcus P. Smith 9/27/13
Assistant County Attorney

C. Other Department Review:

• _____ •
Department Director

This summary is not to be used as a basis for payment.

**SILVER BEACH ROAD
E. OF CONGRESS AVENUE TO OLD DIXIE HIGHWAY
PALM BEACH COUNTY PROJECT NO. 2003514**

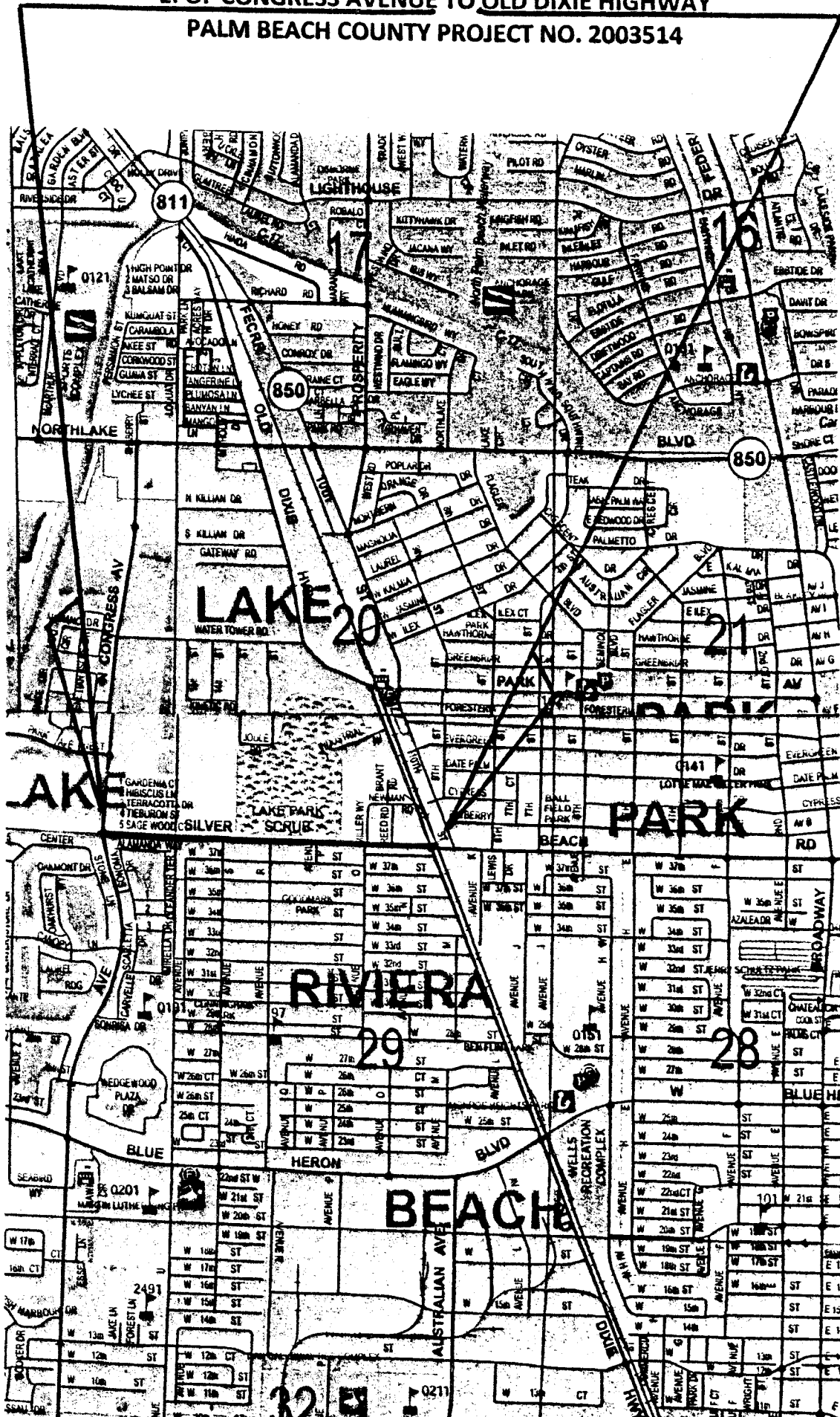

LOCATION SKETCH

ATTACHMENT 2

SUPPLEMENTAL AGREEMENT BETWEEN

**PALM BEACH COUNTY
AND
METRIC ENGINEERING, INC.**

FOR PROFESSIONAL ENGINEERING SERVICES ON

**SILVER BEACH ROAD
E. OF CONGRESS AVENUE TO OLD DIXIE HIGHWAY**

**PROJECT NO.: 2003514
PALM BEACH COUNTY, FLORIDA**

THIS SUPPLEMENTAL AGREEMENT No. 11, made and entered into this day of _____ 2013 by and between Palm Beach County, hereinafter COUNTY, and, Metric Engineering, Inc., a Florida Corporation with an address of 13940 S.W. 136 Street, Miami, Florida 33186, hereinafter CONSULTANT.

WITNESSETH

WHEREAS, the COUNTY and CONSULTANT entered into a Project Agreement dated January 13, 2004 (R2004-0053), to provide professional engineering services for the design of Silver Beach Road from E. of Congress Avenue to Old Dixie Highway, Palm Beach County, Florida (hereinafter PROJECT); and.

WHEREAS, the COUNTY now desires for the CONSULTANT to revise the design plans due to proposed typical section and alignment change for the PROJECT; and

WHEREAS, the following fee has been negotiated as just and reasonable compensation for these professional services to be performed by the CONSULTANT:

RE: Silver Beach Road from E. of Congress Avenue to Old Dixie Highway
Project No. 2003514

Basic Services in a lump sum fee of **\$120,703.21**;

Optional Services (Not to Exceed) \$17,006.00

Totaling **\$137,709.21**

NOW, THEREFORE, THIS INDENTURE WITNESSETH: That for and in consideration of the mutual benefits to flow from each to the other, the parties hereto agree as follows:

1. The **CONSULTANT** agrees to provide professional services as described in Exhibit "A" of the Agreement known as "SCOPE OF WORK & FEE".
2. The **CONSULTANT** agrees to "CERTIFICATION" statements as described in Exhibit "B" of the Agreement.
3. The **CONSULTANT** agrees to Small Business Enterprise (SBE) Participation, described in Exhibit "C" of the Agreement.
4. The **CONSULTANT** has provided sub-consultants Letter of Intent to perform as an SBE as described in Exhibit "D" of the Authorization.
5. The **COUNTY** agrees to pay the **CONSULTANT** a fee of One Hundred Thirty-Seven Thousand Seven Hundred Nine Dollars and Twenty-One Cents (\$137,709.21).

Except as hereby amended, changed or modified, all other terms and conditions of the original Agreement dated **January 13, 2004 (R2004-0053)**, and;

Supplements and Amendments thereto, shall remain in full force and effect.

**RE: Silver Beach Road from E. of Congress Avenue to Old Dixie Highway
Project No. 2003514**

IN WITNESS WHEREOF, the parties hereto have made and executed this Authorization as of the day and year first above written.

OWNER:

**Palm Beach County, Florida, a
Political Subdivision of the
State of Florida**

CONSULTANT:

**Metric Engineering, Inc.
a Florida Corporation**

BOARD OF COUNTY COMMISSIONERS

BY: _____
Steven L. Abrams, Mayor

ATTEST:
Sharon R. Bock, Clerk & Comptroller
Circuit Court

BY: _____
Deputy Clerk

S E A L

**APPROVED AS TO TERMS
AND CONDITIONS:**

BY: *Orlando A. Fernandez*

**APPROVED AS TO FORM & LEGAL
SUFFICIENCY:**

County Attorney

BY: *[Signature]*
Roberto A. Linares, P.E.
Senior Vice President
CORPORATE SEAL

WITNESS:

BY: *Diana Tome*

Diana Tome
(Printed Name)

BY: *Vicky Garcia*

Vicky Garcia
(Printed Name)

EXHIBIT “A”

SCOPE OF SERVICES

SILVER BEACH ROAD

**From
East of Congress Avenue
To
East of Old Dixie Highway**

Palm Beach County Project No. 2003514

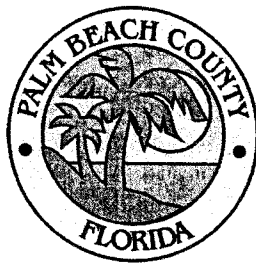

Supplement 11

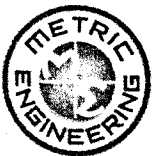

**Prepared by:
Metric Engineering, Inc.
13940 SW 136 Street
Miami, FL 33186**

*OK to process.
8/22/13
8/21/13*

Silver Beach Road
Supplement 11

Exhibit "A" – Page 2 of 24

PBC Project No. 2003514S

Exhibit "A"

Scope of Services

Supplement 11

Introduction

Metric Engineering, Inc. proposes to provide additional professional services required in connection with the proposed roadway construction and improvements of Silver Beach Road from Congress Avenue to Old Dixie Highway, a distance of approximately 0.9 miles in Palm Beach County, Florida. Additional services shall include roadway and drainage plans related to the requested changes as well as additional signing and pavement marking analysis and plans.

The scope of changes includes the required modifications to be done to the design files and construction documents per the meeting held on March 27, 2013.

These changes are needed to complete the production of final plans per the design changes. The services account for a new submittal of plans for 65%, 96%, 100% and final plans. Metric will provide the Services listed below.

A. Basic Services

Roadway, drainage plans, drainage calculations, signing and pavement marking, and signalization components will need to be revised to accommodate new proposed typical section and alignment change. The additional supplement is needed to complete the above mentioned areas of design as related to:

- Changes to the typical section and geometry including profiles, cross sections, side street and driveway profiles. Utilize three (3) lane design from Congress Ave to Old Dixie Highway. Shift alignment to the south to avoid impacts to PBC/ERM property. Remove roundabout at Silver Beach and Avenue S. Provide sidewalk east of Old Dixie Highway along south side of Silver Beach.

- Changes to the proposed storm water management system. Remove pond location, enlarge existing pond at approximately station 110+00. Pond design includes evaluation of existing Congress Avenue profile to confirm drainage revisions will not impact roadway. Revise drainage to current SFWMD regulations.
- Changes to the signing and pavement markings as approved on the latest master plan version.

B. Reimbursable Services:

None anticipated at this time.

C. Optional Services:

- Topographic survey of the area of the proposed pond. Complete scope follows.
 - Soil exploration of the area of the proposed pond. Complete scope follows.
- 

ESTIMATE OF WORK EFFORT AND COST - PRIME CONSULTANT

Name of Project:
County:
FPN:
FAP No.:

Silver Beach Rd from Congress Avenue to Old Dixie Hwy Supplement No. 11
Palm Beach
2003514

Consultant Name: Metric Engineering, Inc.
Consultant No.: 2 1643 10
Date: 8/21/2013
Estimator: MS

| Staff Classification | Hours From "SH Summary - Firm" | Project Manager | Sr. Struct. Engineer | Sr. Roadway Eng. | Project Eng. Struct. | Project Eng. Road. | Sr. Cadd | Staff Classi- fication 7 | Staff Classi- fication 8 | Staff Classi- fication 9 | Staff Classi- fication 10 | Staff Classi- fication 11 | Staff Classi- fication 12 | SH By Activity | Salary Cost By Activity | Average Rate Per Task |
|---|---|--------------------|-------------------------|---------------------|-------------------------|-----------------------|--------------|-----------------------------|-----------------------------|-----------------------------|------------------------------|------------------------------|------------------------------|----------------------|-------------------------------|-----------------------------|
| 3. Project General and Project Common Tasks | ✓ 32 | 5 | | 8 | | ✓ 42.00 | ✓ 27.61 | | | | | | | 32 | \$1,413 | \$44.16 |
| 4. Roadway Analysis | ✓ 286 | 29 | | 72 | | 143 | 42 | | | | | | | 286 | \$12,662 | \$44.27 |
| 5. Roadway Plans | ✓ 275 | 14 | | 55 | | 98 | 110 | | | | | | | 275 | \$10,627 | \$39.37 |
| 6. Drainage Analysis | ✓ 302 | 30 | | 78 | | 151 | 45 | | | | | | | 302 | \$13,352 | \$44.21 |
| 7. Utilities | | | | | | | | | | | | | | | | #DIV/0! |
| 8. Environmental Permits, Compliance & Clearances | | | | | | | | | | | | | | | | #DIV/0! |
| 9. Structures - Misc. Tasks, Dwgs, Non-Tech. | | | | | | | | | | | | | | | | #DIV/0! |
| 10. Structures - Bridge Development Report | | | | | | | | | | | | | | | | #DIV/0! |
| 11. Structures - Temporary Bridge | | | | | | | | | | | | | | | | #DIV/0! |
| 12. Structures - Short Span Concrete Bridge | | | | | | | | | | | | | | | | #DIV/0! |
| 13. Structures - Medium Span Concrete Bridge | | | | | | | | | | | | | | | | #DIV/0! |
| 14. Structures - Structural Steel Bridge | | | | | | | | | | | | | | | | #DIV/0! |
| 15. Structures - Segmental Concrete Bridge | | | | | | | | | | | | | | | | #DIV/0! |
| 16. Structures - Movable Span | | | | | | | | | | | | | | | | #DIV/0! |
| 17. Structures - Retaining Walls | | | | | | | | | | | | | | | | #DIV/0! |
| 18. Structures - Miscellaneous | | | | | | | | | | | | | | | | #DIV/0! |
| 19. Signing & Pavement Marking Analysis | ✓ 44 | 4 | | 11 | | 22 | 7 | | | | | | | 44 | \$1,933 | \$43.93 |
| 20. Signing & Pavement Marking Plans | ✓ 27 | 2 | | 5 | | 9 | 11 | | | | | | | 27 | \$1,064 | \$39.42 |
| 21. Signalization Analysis | | | | | | | | | | | | | | | | #DIV/0! |
| 22. Signalization Plans | | | | | | | | | | | | | | | | #DIV/0! |
| 23. Lighting Analysis | | | | | | | | | | | | | | | | #DIV/0! |
| 24. Lighting Plans | | | | | | | | | | | | | | | | #DIV/0! |
| 25. Landscape Architecture Analysis | | | | | | | | | | | | | | | | #DIV/0! |
| 26. Landscape Architecture Plans | | | | | | | | | | | | | | | | #DIV/0! |
| 27. Survey (Field & Office Support) | | | | | | | | | | | | | | | | #DIV/0! |
| 28. Photogrammetry | | | | | | | | | | | | | | | | #DIV/0! |
| 29. Mapping | | | | | | | | | | | | | | | | #DIV/0! |
| 30. Geotechnical | | | | | | | | | | | | | | | | #DIV/0! |
| 31. Architecture Development | | | | | | | | | | | | | | | | #DIV/0! |
| 32. Noise Barriers Impact Design Assessment | | | | | | | | | | | | | | | | #DIV/0! |
| 33. Intelligent Transportation Systems Analysis | | | | | | | | | | | | | | | | #DIV/0! |
| 34. Intelligent Transportation Systems Plans | | | | | | | | | | | | | | | | #DIV/0! |
| Total Staff Hours | ✓ 968 | ✓ 84 | | ✓ 225 | | ✓ 437 | ✓ 220 | | | | | | | ✓ 968 | | |
| Total Staff Cost | | ✓ \$4,704.00 | | ✓ \$12,075.75 | | ✓ \$18,354.00 | ✓ \$8,118.20 | | | | | | | | ✓ \$41,251.95 | \$42.70 |

Survey Field Days by Subconsultant
4 - Person Crew:

Notes:

1. This sheet to be used by Prime Consultant to calculate the Grand Total fee.
2. Manually enter fee from each subconsultant. Unused subconsultant rows may be hidden.

✓ 2,926 multiple

SALARY RELATED COSTS:
OVERHEAD:
Subtotal
Operating Margin

✓ 100.00%
✓ 10.000%

4-man crew
days @ \$ / day

Survey (Field - if by Prime)
SUBTOTAL ESTIMATED FEE:

TOTAL BASIC SERVICES:

REIMBURSABLES:

Subconsultant: Brown & Phillips, Inc.
Lotspeich and Associates, Inc.
Tierra South Florida

Optional Services
Optional Services

TOTAL REIMBURSABLES:

GRAND TOTAL ESTIMATED FEE:

Check = \$41,251.95

✓ \$41,251.95
✓ \$68,478.24
✓ \$109,730.19
✓ \$10,973.02

✓ \$120,703.21
✓ \$120,703.21

✓ \$8,821.00

✓ \$10,185.00
✓ \$17,008.00

✓ \$137,708.21

Exhibit "A" - Page 4 of 24

Project Staff Hour Summary

Name of Consultant:

Metric Engineering, Inc.

ach Rd from Congress Avenue to Old Dixie Hwy Supplement No. 11
2003514

| | | Project Staff Hours | | | | | | | | | | | | | 2003514 |
|---------------|--|--------------------------|-------|-------|-------|-------|-------|-------|-------|-------|-------|--------|--------|--------|-------------|
| Activity No. | Activity | Metric Engineering, Inc. | Sub 1 | Sub 2 | Sub 3 | Sub 4 | Sub 5 | Sub 6 | Sub 7 | Sub 8 | Sub 9 | Sub 10 | Sub 11 | Sub 12 | Total Hours |
| 3 | Project Common and General Tasks | 32 | | | | | | | | | | | | | 32 |
| 4 | Roadway Analysis | 286 | | | | | | | | | | | | | 286 |
| 5 | Roadway Plans | 275 | | | | | | | | | | | | | 275 |
| 6 | Drainage Analysis | 302 | | | | | | | | | | | | | 302 |
| 7 | Utilities | | | | | | | | | | | | | | |
| 8 | Env. Permits, Compliance & Clearances | | | | | | | | | | | | | | |
| 9 | Structures - Summary, Misc. Tasks, Dwgs. | | | | | | | | | | | | | | |
| 10 | BDR | | | | | | | | | | | | | | |
| 11 | Temporary Bridge | | | | | | | | | | | | | | |
| 12 | Short Span Concrete Bridge | | | | | | | | | | | | | | |
| 13 | Medium Span Concrete Bridge | | | | | | | | | | | | | | |
| 14 | Structural Steel Bridge | | | | | | | | | | | | | | |
| 15 | Segmental Concrete Bridge | | | | | | | | | | | | | | |
| 16 | Movable Span | | | | | | | | | | | | | | |
| 17 | Retaining Walls | | | | | | | | | | | | | | |
| 18 | Miscellaneous Structures | | | | | | | | | | | | | | |
| 19 | Signing & Pavement Marking Analysis | 44 | | | | | | | | | | | | | 44 |
| 20 | Signing & Pavement Marking Plans | 27 | | | | | | | | | | | | | 27 |
| 21 | Signalization Analysis | | | | | | | | | | | | | | |
| 22 | Signalization Plans | | | | | | | | | | | | | | |
| 23 | Lighting Analysis | | | | | | | | | | | | | | |
| 24 | Lighting Plans | | | | | | | | | | | | | | |
| 25 | Landscape Architecture Analysis | | | | | | | | | | | | | | |
| 26 | Landscape Architecture Plans | | | | | | | | | | | | | | |
| 27 | Survey - Field and Office Support | | | | | | | | | | | | | | |
| 28 | Photogrammetry | | | | | | | | | | | | | | |
| 29 | Mapping | | | | | | | | | | | | | | |
| 30 | Geotechnical | | | | | | | | | | | | | | |
| 31 | Architecture Development | | | | | | | | | | | | | | |
| 32 | Noise Barriers Impact Design Assessment | | | | | | | | | | | | | | |
| 33 | ITS Analysis | | | | | | | | | | | | | | |
| 34 | ITS Plans | | | | | | | | | | | | | | |
| Project Total | | ✓ 988 | | | | | | | | | | | | | ✓ 988 |
| 27 | Survey Field Crew Days | | | | | | | | | | | | | | |

- Notes: 1. Staff hours for prime consultant come directly from each discipline's worksheet.
2. Staff hours for subconsultants are to be entered manually into columns D through O.
3. For workbooks prepared by subconsultants, their project hours will be totaled in column C.

Exhibit "A" - Page 5 of 24

Project Activity 3: Project Common and Project General Tasks

Estimator:
Updated 080818

Silver Beach Rd from Congress Avenue to Old Dixie Hwy Supplement No. 11
2003514

| Task No. | Task | Units | No of Units | Hours/ Unit | Total Hours | Comments |
|---------------------------------|--|-------|-------------|-------------|-------------|---|
| 3.1 | Public Involvement | | | | | |
| 3.1.1 | Community Awareness Plan | LS | 1 | | | |
| 3.1.2 | Notifications | LS | 1 | | | |
| 3.1.3 | Prepare Mailing Lists | LS | 1 | | | |
| 3.1.4 | Median Modification Letters | LS | 1 | | | |
| 3.1.5 | Driveway Modification Letters | LS | 1 | | | |
| 3.1.6 | Newsletters | LS | 1 | | | |
| 3.1.7 | Renderings and Fly Throughs | LS | 1 | | | |
| 3.1.8 | PowerPoint Presentation | LS | 1 | | | |
| 3.1.9 | Public Meeting Preparations | LS | 1 | | | |
| 3.1.10 | Public Meeting Attendance/Followup | LS | 1 | | | |
| 3.1.11 | Meetings with municipalities | LS | 1 | 12 | 12 | 2 meetings x 2 people x 3 hours (Lake Park + Riviera Beach) |
| 3.1.12 | Web Site | LS | 1 | | | |
| 3.1 Public Involvement Subtotal | | | | | ✓ 12 | |
| 3.2 | Joint Project Agreements | EA | | | | N/A |
| 3.3 | Specifications Package Preparation | LS | 1 | | | |
| 3.4 | Contract Maintenance | LS | 1 | | | |
| 3.5 | Value Engineering (Multi-Discipline Team) Review | LS | 1 | | | N/A |
| 3.6 | Submittal review meetings with PBC (65%, 96%, R/W) | LS | 1 | 20 | 20 | 2 additional meetings x 5 hours each x 2 people |
| 3.7 | Plans Update | LS | 1 | | | |

Exhibit "A" – Page 6 of 24

Project Activity 3: Project Common and Project General Tasks

| Task No. | Task | Units | No of Units | Hours/ Unit | Total Hours | Comments |
|--|-----------------------------|-------|-------------|-------------|-------------|----------|
| 3.8 | Post Design Services | LS | 1 | | | |
| 3.9 | Electronic Delivery | LS | 1 | | | |
| 3.10 | Other Project General Tasks | LS | 1 | | | |
| 3. Project Common and Project General Tasks Total | | | | | 32 | |

3.6 - List of Project Manager Meetings

| | |
|---------------------------------------|----|
| Roadway Analysis | EA |
| Drainage | EA |
| Utilities | EA |
| Environmental | EA |
| Structures | EA |
| Signing & Pavement Marking | EA |
| Signalization | EA |
| Lighting | EA |
| Landscape Architecture | EA |
| Survey | EA |
| Photogrammetry | EA |
| ROW & Mapping | EA |
| Geotechnical | EA |
| Architecture | EA |
| Noise Barriers | EA |
| ITS Analysis | EA |
| Other meetings with involved agencies | EA |
| Progress Meetings | EA |
| Phase Reviews | EA |
| Field Reviews | EA |

Total Project Manager Meetings

Notes:

1. If the hours per meeting vary in length (hours) enter the average in the hour/unit column.
2. Do not double count agency meetings between permitting agencies.
3. Project manager meetings are calculated in each discipline sheet and brought forward to column D except for Photogrammetry.

Exhibit "A" – Page 7 of 24

Project Activity 4: Roadway Analysis

Estimator:

Silver Beach Rd from Congress Avenue to Old Dixie Hwy Supplement No. 11
2003514

| Task No. | Task | Units | No of Units | Hours/ Unit | Total Hours | Comments |
|-------------------------------------|---|-------|-------------|-------------|-------------|--|
| 4.1 | Typical Section Package | LS | 1 | 8 | 8 | Modifications per final configuration. |
| 4.2 | Pavement Design Package | LS | 1 | | | |
| 4.3 | Access Management | LS | 1 | | | |
| 4.4 | Horizontal/Vertical Master Design Files | LS | 1 | 120 | 120 | Revise alignment and typical section. |
| 4.5 | Cross Section Design Files | LS | 1 | 48 | 48 | Revise cross sections based on new alignment and typical section |
| 4.6 | Traffic Control Analysis | LS | 1 | | | |
| 4.7 | Master TCP Design Files | LS | 1 | | | |
| 4.8 | Design Variations and Exceptions | LS | 1 | | | |
| 4.9 | Design Report | LS | 1 | | | |
| 4.10 | Computation Book & Quantities | LS | 1 | 36 | 36 | Updating to latest design. |
| 4.11 | Cost Estimate | LS | 1 | 8 | 8 | |
| 4.12 | Technical Special Provisions | LS | 1 | | | |
| 4.13 | Other Roadway Analysis | LS | 1 | | | |
| Roadway Analysis Technical Subtotal | | | | | 220 | |

Exhibit "A" – Page 8 of 24

Project Activity 4: Roadway Analysis

| Task No. | Task | Units | No of Units | Hours/ Unit | Total Hours | Comments |
|--|-----------------------------------|-------|-------------|-------------|-------------|---|
| 4.14 | Field Reviews | LS | 1 | 54 | 54 | 3 reviews x 6 hours x 3 people |
| 4.15 | Technical Meetings | LS | 1 | 12 | 12 | 1 additional meetings x 6 hours each x 2 people |
| 4.16 | Quality Assurance/Quality Control | LS | % | | | |
| 4.17 | Independent Peer Review | LS | % | | | |
| 4.18 | Supervision | LS | % | | | |
| Roadway Analysis Nontechnical Subtotal | | | | | ✓ 66 | |
| 4.19 | Coordination | LS | % | | | |
| 4. Roadway Analysis Total | | | | | ✓ 286 | |

Technical Meetings

| | |
|---|----|
| Typical Section | EA |
| Pavement | EA |
| Access Management | EA |
| 15% Line and Grade | EA |
| Driveways | EA |
| Local Governments (cities, counties, MPO) | EA |
| Work Zone Traffic Control | EA |
| 30/60/90/100% Comment Review Meeting | EA |
| Other Meetings | EA |

Subtotal Technical Meetings

| | |
|---|----|
| Progress Meetings (if required by FDOT) | EA |
| Phase Review Meetings | EA |

Total Meetings

Carries to 4.15

Note: Project Manager attendance at progress, phase and field review meetings are manually entered on General Task 3

Exhibit "A" – Page 9 of 24

Project Activity 5: Roadway Plans

Estimator:

Silver Beach Rd from Congress Avenue to Old Dixie Hwy Supplement No. 11
2003514

| Task No. | Task | Scale | Units | No. of Units | Hours/ Unit | No. of Sheets | Total Hours | Comments |
|----------|---|-------|-------|--------------|-------------|---------------|-------------|--|
| 5.1 | Key Sheet | | Sheet | 1 | 2 | 1 | 2 | |
| 5.2 | Summary of Pay Items Including Quantity Input | | Sheet | 1 | 12 | 1 | 12 | |
| 5.3 | Drainage Map | | Sheet | 3 | 4 | 3 | 12 | |
| 5.4 | Interchange Drainage Map | | Sheet | | | | | |
| 5.5 | Typical Section Sheets | | Sheet | | | | | |
| 5.6 | General Notes/Pay Item Notes | | Sheet | 1 | 4 | 1 | 4 | Update to latest. |
| 5.7 | Summary of Quantities | | Sheet | 1 | 12 | 1 | 12 | Modify per changes. |
| 5.8 | Box Culvert Data Sheet | | Sheet | | | | | |
| 5.9 | Bridge Hydraulics Recommendation Sheets | | Sheet | | | | | |
| 5.10 | Summary of Drainage Structures | | Sheet | 1 | 12 | 1 | 12 | |
| 5.11 | Optional Pipe/Culvert Material | | Sheet | | | | | |
| 5.12 | Project Layout | | Sheet | | | | | |
| 5.13 | Plan/Profile Sheet | | Sheet | 13 | 6 | 13 | 78 | Modifications to latest plan and profiles. |
| 5.14 | Profile Sheet | | Sheet | | | | | |

Exhibit "A" - Page 10 of 24

Project Activity 5: Roadway Plans

| Task No. | Task | Scale | Units | No. of Units | Hours/ Unit | No. of Sheets | Total Hours | Comments |
|----------|--|-------|-------|--------------|-------------|---------------|-------------|--|
| 5.15 | Plan Sheet | | Sheet | | | | | |
| 5.16 | Special Profile | | Sheet | | | | | |
| 5.17 | Back of Sidewalk Profile Sheet | | Sheet | | | | | |
| 5.18 | Interchange Layout Sheet | | Sheet | | | | | |
| 5.19 | Ramp Terminal Details (Plan View) | | Sheet | | | | | |
| 5.20 | Intersection Layout Details | | LS | 1 | 10 | 1 | 10 | Silver Beach and Ave S |
| 5.21 | Miscellaneous Detail Sheets | | Sheet | | | | | |
| 5.22 | Drainage Structure Sheet (Per Structure) | | EA | 47 | 1.5 | | 71 | Revise dr str location and system due to change in typical section, alignment and pond location. |
| 5.23 | Miscellaneous Drainage Detail Sheets | | Sheet | 1 | 6 | 1 | 6 | New bleeder connection |
| 5.24 | Lateral Ditch Plan/Profile | | Sheet | | | | | |
| 5.25 | Lateral Ditch Cross Sections | | EA | | | | | |
| 5.26 | Retention/Detention Ponds Detail Sheet | | Sheet | 1 | 24 | 1 | 24 | |
| 5.27 | Retention Pond Cross Sections | | EA | 10 | 1.5 | | 15 | |
| 5.28 | Cross-Section Pattern Sheet | | Sheet | | | | | |
| 5.29 | Roadway Soil Survey Sheet | | Sheet | | | | | |
| 5.30 | Cross Sections | | EA | 56 | 0.3 | | 17 | Revise Silver Beach xs due to change in alignment and typical section |
| 5.31 | Traffic Control Plan Sheets | | Sheet | | | | | |
| 5.32 | Traffic Control Cross Section Sheets | | EA | | | | | |
| 5.33 | Traffic Control Detail Sheets | | Sheet | | | | | |
| 5.34 | Utility Adjustment Sheets | | Sheet | | | | | |

Exhibit "A" - Page 11 of 24

Project Activity 5: Roadway Plans

| Task No. | Task | Scale | Units | No. of Units | Hours/ Unit | No. of Sheets | Total Hours | Comments |
|---|---------------------------------------|-------|-------|--------------|-------------|---------------|--------------|----------|
| 5.35 | Selective Clearing and Grubbing | | Sheet | | | | | |
| 5.36 | Erosion Control Plan | | Sheet | | | | | |
| 5.37 | SWPPP | | Sheet | | | | | |
| 5.38 | Project Control Network Sheet | | Sheet | | | | | |
| 5.39 | Environmental Detail Sheets | | LS | | | | | |
| 5.40 | Utility Verification Sheet (SUE Data) | | Sheet | | | | | |
| Roadway Plans Technical Subtotal | | | | | | 24 | ✓ 275 | |
| 5.41 | Quality Assurance/Quality Control | | LS | % | | | | |
| 5.42 | Supervision | | LS | % | | | | |
| 5. Roadway Plans Total | | | | | | 24 | ✓ 275 | |

Exhibit "A" – Page 12 of 24

Project Activity 6: Drainage Analysis

Estimator:

Silver Beach Rd from Congress Avenue to Old Dixie Hwy Supplement No. 11
2003514

| Task No. | Task | Units | No of Units | Hours/ Unit | Total Hours | Comments |
|----------|--|-------------------------------|-------------|-------------|-------------|---|
| 6.1 | Determine Base Clearance Water Elevation | Per Location | | | | |
| 6.2 | Pond Siting Analysis and Report | Per Basin | | | | |
| 6.3 | Design of Cross Drains | EA | | | | |
| 6.4 | Design of Roadway Ditches | LS | 1 | 32 | 32 | Existing Silver Beach Frontage Road |
| 6.5 | Design of Outfalls | EA | 2 | 20 | 40 | Due to new pond location |
| 6.6 | Design of Stormwater Management Facility (Offsite Pond) | LS | | | | Due to new pond location, size pond, check against Congress Ave roadway elevations |
| 6.7 | Design of Stormwater Management Facility (Roadside Ditch as Linear Pond or Infield Pond) | Per System | 1 | 64 | 80 | Due to new pond location, size pond, check against Congress Ave roadway elevations |
| 6.8 | Design of Flood Plain Compensation Area | Per Encroachment | | | | |
| 6.9 | Design of Storm Drains | EA | 47 | 2.5 | 118 | Structures to be modified per drainage modifications and change in typical section and alignment. |
| 6.10 | Optional Culvert Material | LS | | | | |
| 6.11 | Analysis/Design of Drainage | Per 1000 Feet of French Drain | | | | |
| 6.12 | Drainage Wells | EA | | | | |
| 6.13 | Drainage Design Documentation Report | LS | 1 | 32 | 32 | Revise report due to change in pond location, typical section and alignment |
| 6.14 | Bridge Hydraulic Report | EA | | | | |
| 6.15 | Temporary Drainage Analysis | LS | | | | |
| 6.16 | Cost Estimate | LS | | | | |
| 6.17 | Technical Special Provisions | LS | | | | |

Exhibit "A" - Page 13 of 24

Project Activity 6: Drainage Analysis

| Task No. | Task | Units | No of Units | Hours/ Unit | Total Hours | Comments |
|--|-----------------------------------|-------|-------------|-------------|-------------|----------|
| 6.18 | Other Drainage Analysis | LS | 1 | | | |
| Drainage Analysis Technical Subtotal | | | | | 302 | |
| 6.19 | Field Reviews | LS | | | | |
| 6.20 | Technical Meetings | LS | | | | |
| 6.21 | Quality Assurance/Quality Control | LS | % | | | |
| 6.22 | Independent Peer Review | LS | % | | | |
| 6.23 | Supervision | LS | % | | | |
| Drainage Analysis Nontechnical Subtotal | | | | | | |
| 6.24 | Coordination | LS | % | | | |
| 6. Drainage Analysis Total | | | | | 302 | |

Technical Meetings

| | |
|--------------------------------------|----|
| Base Clearance Water Elevation | EA |
| Pond Siting | EA |
| Agency | EA |
| Local Governments (cities, counties) | EA |
| FDOT Drainage | EA |
| Other Meetings | EA |

Subtotal Technical Meetings

| | |
|---|----|
| Progress Meetings (if required by FDOT) | EA |
| Phase Review Meetings | EA |

Total Meetings

Carries to 6.20

Note: Project Manager attendance at progress, phase and field review meetings are manually entered on General Task 3

Exhibit "A" – Page 14 of 24

Project Activity 19: Signing and Pavement Marking Analysis

Estimator:

Silver Beach Rd from Congress Avenue to Old Dixie Hwy Supplement No. 11
2003514

| Task No. | Task | Units | No. of Units | Hours/ Units | Total Hours | Comments |
|--|---------------------------------------|-------|--------------|--------------|-------------|---|
| 19.1 | Traffic Data Analysis | LS | 1 | | | |
| 19.2 | No Passing Zone Study | LS | 1 | | | |
| 19.3 | Reference and Master Design File | LS | 1 | 32 | 32 | Modify final design per latest modifications. |
| 19.4 | Multi-Post Sign Support Calculations | EA | | | | |
| 19.5 | Sign Panel Design Analysis | EA | | | | |
| 19.6 | Sign Lighting/Electrical Calculations | EA | 1 | | | |
| 19.7 | Quantities | LS | 1 | 2 | 2 | |
| 19.8 | Computation Book | LS | 1 | 2 | 2 | |
| 19.9 | Cost Estimate | LS | 1 | 2 | 2 | |
| 19.10 | Technical Special Provisions | LS | 1 | | | |
| 19.11 | Other Signing and Pavement Marking | LS | 1 | | | |
| Signing and Pavement Marking Analysis Technical Subtotal | | | | | ✓ 38 | |
| 19.12 | Field Reviews | LS | 1 | 6 | 6 | 1 visit x 1 people x 6 hours for remaining field reviews. |
| 19.13 | Technical Meetings | LS | 1 | | | |
| 19.14 | Quality Assurance/Quality Control | LS | % | | | |
| 19.15 | Independent Peer Review | LS | % | | | |
| 19.16 | Supervision | LS | % | | | |
| Signing and Pavement Marking Analysis Nontechnical Subtotal | | | | | ✓ 6 | |
| 19.17 | Coordination | LS | % | | | |
| 19. Signing and Pavement Marking Analysis Total | | | | | ✓ 44 | |

Exhibit "A" – Page 15 of 24

Project Activity 19: Signing and Pavement Marking Analysis

| | |
|--------------------------------------|----|
| Technical Meetings | |
| Sign Panel Design | EA |
| Queue Length Analysis | EA |
| Local Governments (cities, counties) | EA |
| Other Meetings | EA |
| Subtotal Technical Meetings | |
| Progress Meetings | EA |
| Phase Review Meetings | EA |
| Total Meetings | |

Carries to 19.13

Note: Project Manager attendance at progress, phase and field review meetings are manually entered on General Task 3

Exhibit "A" -- Page 16 of 24

Project Activity 20: Signing and Pavement Marking Plans

Estimator:

Silver Beach Rd from Congress Avenue to Old Dixie Hwy Supplement No. 11
2003514

| Task No. | Task | Scale | Units | No of Units | Hours/ Unit | No. of Sheets | Total Hours | Comments |
|--|--|-------|-------|-------------|-------------|---------------|-------------|---|
| 20.1 | Key Sheet | | Sheet | 1 | 1 | 1 | 1 | |
| 20.2 | Summary of Pay Items Including CES Input | | LS | 1 | | | | |
| 20.3 | Tabulation of Quantities | | Sheet | 1 | 6 | 1 | 4 | Revise and update latest quantities |
| 20.4 | General Notes/Pay Item Notes | | Sheet | 1 | 4 | 1 | 2 | |
| 20.5 | Project Layout | | Sheet | | | | | |
| 20.6 | Plan Sheet | | Sheet | 13 | 1.5 | 13 | 20 | To update labeling per latest design modifications. |
| 20.7 | Typical Details | | EA | | | | | |
| 20.8 | Guide Sign Worksheet(s) | | EA | | | | | |
| 20.9 | Traffic Monitoring Site | | EA | | | | | |
| 20.10 | Cross Sections | | EA | | | | | |
| 20.11 | Special Service Point Details | | EA | | | | | |
| 20.12 | Special Details | | LS | 1 | | | | |
| 20.13 | Interim Standards | | LS | 1 | | | | |
| Signing and Pavement Marking Plans Technical Subtotal | | | | | | 16 | ✓ 27 | |
| 20.14 | Quality Assurance/Quality Control | | LS | % | | | | |
| 20.15 | Supervision | | LS | % | | | | |
| 20. Signing and Pavement Marking Plans Total | | | | | | 16 | ✓ 27 | |

Exhibit "A" – Page 17 of 24



August 21, 2013

Mr. Manuel A. Sauleda, P.E.
Metric Engineering
13940 SW 136th Street, Suite 200
Miami, FL 33186

Re: Silver Beach Road Supplemental Survey to Enlarge Existing Pond

Dear Manny,

Thank you for the opportunity to provide you with the following services for the subject site. This proposal is based on documentation and information provided by your office. The scope of services is as follows:

SCOPE OF SERVICES

I. CONTROL

Utilizing the survey previously prepared by this office (Project 04-018), we will re-establish horizontal and vertical control. The limits of the survey are shown on Attachment 'B'.

II. TOPOGRAPHY

A complete topographic survey will be done at the site tying in all above ground features. This will include but not be limited to buildings, pavement, walks, utilities, trees, lakes, canals and drainage structures.

III. CROSS SECTIONS

We will obtain elevations on the site on a one hundred (100) foot grid. We will locate sufficient points to give an accurate representation of the lay of the land. No soundings are proposed.

IV. PARCEL SKETCHES AND LEGAL DESCRIPTIONS

We will prepare a legal description and sketch for the pond parcel. This sketch will be based on record ownership data and record plats provided by Palm Beach County. The sketch will be consistent with the requirements of Palm Beach County and Florida Minimum Technical Standards. We have estimated one (1) parcel for this project at \$450.00.

Sauleda
August 21, 2013
Page 2

IV. CLOSURE

A drawing will be produced which will show all the features located. We propose to provide Metric Engineering with six (6) hard copies and an AutoCAD file in the version requested. Any additional work will be done ~~on an hourly basis~~ as approved by you. We will perform the scope of services for a **lump sum fee of \$6,821.00** (\$6,371.00 for survey and \$450.00 for legal description & sketch), see Attachment 'A' for an hourly breakdown. Please do not hesitate to call me with any questions you might have regarding this proposal. We look forward to working with you on this project.

Sincerely,

Brown & Phillips, Inc.

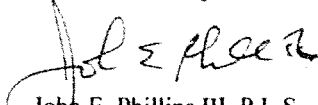
John E. Phillips III, P.L.S.
Principal

Attachment

JEP/mb

Accepted This _____ Day Of _____, 2013.

Metric Engineering

By: _____

Print Name: _____

ATTACHMENT 'A'

Silver Beach Road Supplemental Survey to Enlarge Existing Pond

Type of Survey: Topographic

Size: 800' x 450' ±

Date: August 21, 2013

| TASK | 2 MAN CREW | CADD TECH | SURVEY TECH | PLS | COMMENTS |
|------------------------------------|---------------|--------------|----------------|------------|--|
| Meetings and Coordination | | | | | |
| Horizontal Project Network Control | 3 | | 6 | 2 | Set traverse points - establish boundary lines |
| Vertical Project Network Control | 4 | | | | Establish onsite benchmarks |
| Tie In Improvements | 20 | | 3 | 1 | Locate above ground features including trees |
| Cross Sections | 8 | | 6 | 2 | 100' cross sections & spot elevation shots - prepare TIN |
| Asbuilt | 1 | | | | Obtain asbuilt data |
| Drawing | | 12 | 3 | 2 | Prepare topographic survey with trees |
| | | | | | |
| | | | | | |
| Total Hours: | ✓ 36 | ✓ 12 | ✓ 18 | ✓ 7 | |
| Rate/Hour | ✓ \$98.00 | ✓ \$66.00 | ✓ \$70.00 | ✓ \$113.00 | |
| Subtotal: | ✓ \$3,528.00 | ✓ \$792.00 | ✓ \$1,260.00 | ✓ \$791.00 | |
| Total Labor Cost: | | | | | ✓ \$6,371.00 |

Other Direct Costs:

| | quantity | unit | cost/unit | total |
|----------------------------|----------|---------------|------------|------------|
| Legal Description & Sketch | 1 | each | ✓ \$450.00 | ✓ \$450.00 |
| Prints | | sheet | \$1.50 | \$0.00 |
| Shipping | | cost x markup | 1.20 | \$0.00 |
| Other | | | | \$0.00 |

Total Other Direct Costs:

2.744 multiplier ✓ \$450.00

Subcontractor Costs:

Utility Locating Services \$0.00

Total Subcontractor Costs:

\$0.00

TOTAL PRICE

✓ \$6,821.00

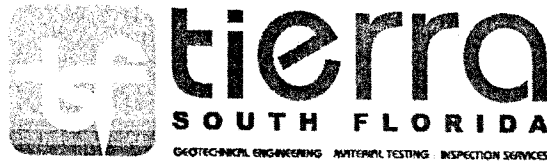

Exhibit "A" – Page 21 of 24

August 16, 2013

Metric Engineering, Inc.
13940 SW 136th Street, Suite 200
Miami, FL 33186

Attn: Mr. Manuel A. Sauleda, PE
Chief Engineer

Re: **Proposal for Additional Geotechnical Services – Pond Borings**
Proposed Silver Beach Road from East of Congress Avenue to Old Dixie Highway
Palm Beach County, Florida
TSF Proposal No.: 1308-341

Dear Manny:

As requested, TIERRA SOUTH FLORIDA, INC. (TSF) is pleased to submit this proposal for the above-referenced project. The proposal is based on a new proposed pond. This proposal includes an outline of our proposed scope of work, an estimate of the total fees, and our anticipated schedule for completion of the work.

PROPOSED SCOPE OF WORK

All work performed by TSF will be in general accordance with Palm Beach County and FDOT standards. We understand the proposed pond is expected to be about 5 acres in size (approximately 300' x 650') and the site is currently wooded. We understand that the proposed pond will be a wet pond and percolation tests are not required.

To explore the subsurface conditions at the proposed pond location we propose to drill a total 10 Standard Penetration Test (SPT) borings to a depth 25 feet below existing grades.

Boring locations will be approximately located in the field by our personnel by measuring distances with a tape from known reference points. Elevations at boring locations can be interpreted from topographic plans if furnished by others.

Prior to drilling at the project site, TSF will notify the local utility companies and request that underground utilities be marked. Our experience, however, is that the utility companies will not mark privately owned utilities. Our proposal assumes that private utility lines will be located in the field by others prior to mobilization of the drill rig.

Upon completion of the field exploration, laboratory testing will be performed on selected samples. The study will be summarized in accordance with the FDOT's Soil and Foundation Manual.

A geotechnical engineer will evaluate the results of all drilling and laboratory testing. A report will be issued that contains the exploration data, a discussion of the site and subsurface conditions and a discussion of some construction considerations.

ESTIMATED FEES

It is proposed that the fee for the performance of the services outlined above be determined on a unit price basis in accordance with the attached Fee Schedule and that the work be performed pursuant to TSF's General Conditions enclosed herewith and incorporated into this proposal. The estimated fees for the project are attached.

Our estimate covers the work needed to present our findings and recommendations in a formal report. Not included are reviews of drawings, preparation of construction specifications, special conferences and any other work requested after submittal of our report.

SCHEDULE AND AUTHORIZATION

TSF will proceed with the work after receipt of a signed copy of this proposal. With our present schedule, we can commence work within several days of project approval (weather permitting and permit approval). The fieldwork will take about one week to complete. The written report can be submitted about one week after completion of the field exploration, depending on the extent of the laboratory-testing program. Verbal preliminary recommendations can be made to appropriate parties prior to submittal of the written report.

Metric Engineering, Inc.
TSF Proposal No. 1308-341

Exhibit "A" – Page 23 of 24

3

We at TSF appreciate the opportunity to submit this proposal and look forward to working with you on this project. If you should have any questions concerning our proposal, please contact our office.

Respectfully submitted,

TIERRA SOUTH FLORIDA, INC.

Raj Krishnasamy, P.E.
Principal/Geotechnical Engineer/ President

Attachments: 1. Fee Estimate

| AUTHORIZED BY: | INVOICE TO: |
|----------------|-------------|
| Name: | Firm: |
| Title: | Name: |
| Date: | Address: |

Exhibit "A" – Page 24 of 24

TIERRA SOUTH FLORIDA, INC.

| | Unit | # of Units | Unit Price | | Total |
|--|------|------------|------------|-----------|--------------------|
| I. FIELD INVESTIGATION | | | | | |
| Mobilization of Men and Equipment Truck-Mounted Equipment | Trip | 1 | \$ | ✓ 350.00 | \$ ✓ 350.00 |
| SPT Borings 0 - 50 ft depth | L.F. | 250 | \$ | ✓ 12.00 | \$ ✓ 3,000.00 |
| Grout Boreholes 0 - 50 ft depth | L.F. | 250 | \$ | ✓ 5.50 | \$ ✓ 1,375.00 |
| Casing Allowance 0 - 50 ft depth | L.F. | 0 | \$ | ✓ 7.00 | \$ 0.00 |
| Borehole Permeability Test | Each | 0 | \$ | ✓ 275.00 | \$ 0.00 |
| Site Clearing | Day | 2 | \$ | 1200.00 | \$ ✓ 2,400.00 |
| II. LABORATORY TESTING | | | | | |
| Visual Examination by Staff Engineer | Hour | 2 | \$ | ✓ 85.00 | \$ ✓ 170.00 |
| Natural Moisture Content Tests | Test | 4 | \$ | ✓ 10.00 | \$ ✓ 40.00 |
| Grain-Size Analysis - Full Gradation | Test | 8 | \$ | ✓ 60.00 | \$ ✓ 480.00 |
| Corrosion Test | Test | 0 | \$ | ✓ 185.00 | \$ 0.00 |
| Organic Content Tests | Test | 4 | \$ | ✓ 45.00 | \$ ✓ 180.00 |
| III. FIELD ENGINEERING AND TECHNICAL SERVICES | | | | | |
| Site Recon./Utility & site Clearing Coordination Sr. Engineering Technician | Hour | 12 | \$ | ✓ 65.00 | \$ ✓ 780.00 |
| IIIA. ENGINEERING AND TECHNICAL SERVICES | | | | | |
| Principal Engineer | Hour | 0 | \$ | ✓ 145.00 | \$ 0.00 |
| Senior Geotechnical Engineer | Hour | 2 | \$ | ✓ 125.00 | \$ ✓ 250.00 |
| Project Engineer | Hour | 8 | \$ | ✓ 115.00 | \$ ✓ 920.00 |
| Draftperson | Hour | 4 | \$ | ✓ 60.00 | \$ ✓ 240.00 |
| TOTAL FEE FOR GEOTECHNICAL SERVICES-Pond | | | | \$ | ✓ 10,185.00 |

✓ 2.45 multi p...

EXHIBIT “B”

CERTIFICATION STATEMENTS

Project: Silver Beach Road from E. of Congress Avenue to Old Dixie Highway

Project No.: 2003514

Consultant/Annual Consultant: Metric Engineering, Inc.

TRUTH-IN-NEGOTIATION STATEMENT

By entering into this Agreement, the **CONSULTANT/ANNUAL CONSULTANT** certifies that the wage rates and costs used to determine the lump sum fees contained in herein are accurate, complete and current as of the date of this Agreement.

The said lump sum fees shall be adjusted to exclude any significant sums should the **COUNTY** determine that the lump sum fees were increased due to inaccurate, incomplete or non-current wage rates or due to inaccurate representations of fees paid to outside consultants.

The **COUNTY** shall exercise its right under this "Certificate" within one year following final payment.

PROHIBITION AGAINST CONTINGENT FEES STATEMENT

By entering into this Agreement the **CONSULTANT/ANNUAL CONSULTANT** warrants that they have not employed or retained any company or person other than a bonafide employee working solely for the **CONSULTANT/ANNUAL CONSULTANT** to solicit or secure this Agreement and that they have not paid or agreed to pay any person, company, corporation, individual or firm other than a bonafide employee working solely for the **CONSULTANT/ANNUAL CONSULTANT**, any fee, commission, percentage, gift or other consideration contingent upon or resulting from the award of making of this agreement.

PUBLIC ENTITY CRIMES STATEMENT

As provided in F.S. 287.132-133, by entering this Agreement or performing any work in furtherance hereof, the **CONSULTANT/ANNUAL CONSULTANT** certifies that it, its affiliates, suppliers, sub-contractors and consultants who will perform hereunder, have not been placed on the convicted vendor list maintained by the State of Florida Department of Management Services within the 36 months immediately preceding the date hereof. This notice is required by F.S. 287.133 (3) (a).

NON-DISCRIMINATION STATEMENT

The **CONSULTANT/ANNUAL CONSULTANT** warrants and represents that all of its employees are treated equally during employment without regard to race, color, religion, disability, sex, age, national origin, ancestry, marital status, familial status sexual orientation, gender identity and expression.

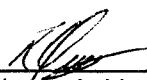

Roberto A. Linares, Senior Vice President

CONFLICT OF INTEREST DISCLOSURE FORM

Project: Silver Beach Road from E. of Congress Avenue to Old Dixie Highway
Project No.: 2003514

CONSULTANT/ANNUAL CONSULTANT represents that it presently has no interest, either direct or indirect, which would or could conflict in any manner with the performance of services for the County, except as follows:

(Attach additional sheets as needed.)

CONSULTANT/ANNUAL CONSULTANT further represents that no person having any interest shall be employed for said performance. By signing below, CONSULTANT/ANNUAL CONSULTANT certifies that the information contained herein is true and correct and constitutes all current potential conflicts of interest which may influence or appear to influence CONSULTANT'S/ANNUAL CONSULTANT'S judgment or quality of services being provided to the County.

CONSULTANT/ANNUAL CONSULTANT shall promptly notify the COUNTY in writing by certified mail of all potential conflicts of interest that may arise in the future through any prospective business association, interest or other circumstance which may influence or appear to influence CONSULTANT'S/ANNUAL CONSULTANT'S judgment or quality of services being provided to the County. Such written notification shall identify the prospective business association, interest or circumstance, the nature of work that CONSULTANT/ANNUAL CONSULTANT may undertake and request an opinion of the COUNTY as to whether the association, interest or circumstance would, in the opinion of the COUNTY, constitute an unacceptable conflict of interest if entered into by the CONSULTANT/ANNUAL CONSULTANT.

If, in the sole opinion of the COUNTY, the prospective business association, interest or circumstance of CONSULTANT/ANNUAL CONSULTANT would constitute an unacceptable conflict of interest to the COUNTY, the COUNTY shall so state in the notification and the CONSULTANT/ANNUAL CONSULTANT shall not enter into said association, interest or circumstance.

THIS DISCLOSURE is submitted by Roberto A. Linares, as
 (Name of Individual)
Senior Vice President, of Metric Engineering Inc.
 (Title/Position) (Firm Name of CONSULTANT/ANNUAL CONSULTANT)

who hereby certifies that the information stated above is true and correct. Further, it is hereby acknowledged that any misrepresentation by the CONSULTANT/ANNUAL CONSULTANT on this Disclosure is considered an unethical business practice and is grounds for sanctions against future County business with the CONSULTANT/ANNUAL CONSULTANT.

 (Signature)

8/23/13
 (Date)

EXHIBIT "C"

Palm Beach County
Engineering & Public Works Roadway Production

Exhibit "C" – Page 1 of 2

PARTICIPATION FOR MWBE/SBE CONSULTANTS

Supplement Number 11 Date

Project Name: Silver Beach Rd. - E. of Congress Ave. to Old Dixie Hwy.

Project Number: 2003514S

Prime Vendor: Metric Engineering, Inc.

Resolution Number:

Telephone: (305) 235-5098

Resolution Date:

Contact: Manny Sauleda

Department: Engineering & Public Works

Total Supplement Amount \$137,709.21

| Minority Sub-Consultant | Type of Work Performed | Contract Dollar Amount for Sub-Consultant | | | | | |
|--|---------------------------|---|----------|-------|-----------|------------|-------|
| | | Black | Hispanic | Women | Other | White Male | Pct |
| Brown & Phillips, Inc. 1860 OLD OKEECHOBEE ROAD, SUI WEST PALM BEACH, FL 33409 (561) 615-3988 | MWBE | 0.00 | 0.00 | 0.00 | 0.00 | | 0.0% |
| | SBE | 6,821.00 | 0.00 | 0.00 | 0.00 | 0.00 | 5.0% |
| Tierra South Florida, Inc. 2765 VISTA PKY STE 10 WEST PALM BEACH, FL 33411 (561) 687-8536 | MWBE | 0.00 | 0.00 | 0.00 | 0.00 | | 0.0% |
| | SBE | 0.00 | 0.00 | 0.00 | 10,185.00 | 0.00 | 7.4% |
| Total MWBE | | 0.00 | 0.00 | 0.00 | 0.00 | | 0.0% |
| Percentage | | 0.00% | 0.00% | 0.00% | 0.00% | | |
| Total SBE | | 6,821.00 | 0.00 | 0.00 | 10,185.00 | 0.00 | 12.3% |
| Percentage | | 4.95% | 0.00% | 0.00% | 7.40% | 0.00% | |

SCHEDULE 1

LIST OF PROPOSED SBE-M/WBE PRIME AND/OR SUBCONTRACTOR PARTICIPATION

PROJECT NAME OR BID NAME: Silver Beach Rd.-E. of Congress Ave. to Old Dixie Hwy. PROJECT NO. OR BID NO.: 2003514

NAME OF PRIME BIDDER: Metric Engineering, Inc. ADDRESS: 13940 SW 136 St., Suite 200, Miami, FL 33186

CONTACT PERSON: Robert Linares, PE PHONE NO.: 305-235-5098 FAX NO.: 305-251-5894

BID OPENING DATE: _____ USER DEPARTMENT: Engineering & Public Works

THIS DOCUMENT IS TO BE COMPLETED BY THE PRIME CONTRACTOR AND SUBMITTED WITH BID PACKET. PLEASE LIST THE NAME, CONTACT INFORMATION AND DOLLAR AMOUNT OR PERCENTAGE OF WORK TO BE COMPLETED BY ALL SBE -M/WBE SUBCONTRACTORS ON THIS PROJECT. IF THE PRIME IS AN SBE-M/WBE, PLEASE ALSO LIST THE NAME, CONTACT INFORMATION AND DOLLAR AMOUNT OR PERCENTAGE OF WORK TO BE COMPLETED BY THE PRIME ON THIS PROJECT.

| Name, Address and Phone Number | (Check one or both Categories) | | DOLLAR AMOUNT OR PERCENTAGE OF WORK | | | | |
|---|-------------------------------------|-------------------------------------|-------------------------------------|----------|-------|-----------|------------------|
| | M/WBE Minority Business | SBE Small Business | Black | Hispanic | Women | Caucasian | Other (Asian) |
| 1. Tierra South Florida, Inc. 2765 Vista Parkway, Suite 10 West Palm Beach, FL 33411 (561) 687-8536 | <input checked="" type="checkbox"/> | <input checked="" type="checkbox"/> | | | | | 7.40% |
| 2. Brown & Phillips, Inc. 901 Northpoint Parkway, Suite 305 West Palm Beach, FL 33407 (561) 615-3988 | <input checked="" type="checkbox"/> | <input checked="" type="checkbox"/> | 4.95% | | | | |
| 3. | <input type="checkbox"/> | <input type="checkbox"/> | | | | | |
| 4. | <input type="checkbox"/> | <input type="checkbox"/> | | | | | |
| 5. | <input type="checkbox"/> | <input type="checkbox"/> | | | | | |
| (Please use additional sheets if necessary) | | | | | | | |
| Total | | | 4.95% | | | | 7.40% |

Total Bid Price \$ 137,709.21

Total SBE-M/WBE Participation Dollar Amount or Percentage of Work 12.35%

- Note:
1. The amount listed on this form for a subcontractor must be supported by price or percentage listed on the signed Schedule 2 or signed proposal in order to be counted toward goal attainment.
 2. Firms may be certified by Palm Beach County as an SBE and/or and M/WBE. If firms are certified as both an SBE and N/WBE, please indicate the dollar amount or percentage under the appropriate category.
 3. M/WBE information is being collected for tracking purposes only.

Revised 03/15/2011

F:\ROADWAY\CCNA\2003\2003514S\Project\Supp11\ComplianceSchedule1.docx

Exhibit "C" - Page 2 of 2

EXHIBIT “D”

USBA SCHEDULE 2
LETTER OF INTENT TO PERFORM AS AN SBE-M/WBE SUBCONTRACTOR

Exhibit "D" – Page 1 of 2

This document must be completed by the SBE-M/WBE Subcontractor and submitted with bid packet. Specify in detail, the particular work items to be performed and the dollar amount and/or percentage for each work item. SBE credit will only be given for items which the SBE-M/WBE Subcontractor is SBE certified to perform. Failure to properly complete Schedule 2 may result in your SBE participation not being counted.

PROJECT NUMBER: 2003514 PROJECT NAME: Silver Beach Road from E. of Congress Avenue to Old Dixie Highway

TO: Metric Engineering, Inc.
(Name of Prime Bidder)

The undersigned is certified by Palm Beach County as a - (check one or more, as applicable):

Small Business Enterprise ☒ Minority Business Enterprise ☒

Black ☒ Hispanic ☐ Women ☐ Caucasian ☐ Other (Please Specify) ☐

Date of Palm Beach County Certification: January 28, 2013 to January 27, 2016

The undersigned is prepared to perform the following described work in connection with the above project. Additional Sheets May Be Used As Necessary

| Line Item/ Lot No. Item Description | Qty/Units | Unit Price | Total Price/ Percentage |
|--|-----------------|-------------------|----------------------------|
| <u>Topographic Survey</u> | <u>1 / LS</u> | <u>\$6,371.00</u> | <u>\$6,371.00</u> |
| <u>Legal Description & Sketch</u> | <u>1 / Each</u> | <u>\$450.00</u> | <u>\$450.00</u> |
| <u></u> | <u></u> | <u></u> | <u></u> |
| <u></u> | <u></u> | <u></u> | <u></u> |
| <u></u> | <u></u> | <u></u> | <u></u> |
| <u></u> | <u></u> | <u></u> | <u></u> |

at the following price or percentage 4.95% (\$6,821.00)
(Subcontractor's quote)

and will enter into a formal agreement for work with you conditioned upon your execution of a contract with Palm Beach County.

If undersigned intends to subcontract any portion of this job to a certified SBE or a non-SBE subcontractor, please list the name of the subcontractor and the amount below.

Price and/or Percentage /
(Name of Subcontractor)

The Prime affirms that it will monitor the SBE's listed to ensure the SBE's perform the work with its own forces. The undersigned subcontractor affirms that it has the resources necessary to perform the work listed without subcontracting to non-certified SBE or any other certified SBE subcontractors except as noted above.

The undersigned subcontractor understands that the provision of this form to Prime Bidder does not prevent Subcontractor from providing quotations to other bidders.

Metric Engineering, Inc.
Print name of Prime Contractor

By: [Signature]
Signature

Robert Linares, Sr. Vice President
Print name/title of person executing on behalf
Prime Contractor

Brown & Phillips, Inc.
Print name of SBE-M/WBE Subcontractor

By: [Signature]
Signature

Anthony Brown / CEO
Print name/title of person executing on behalf
of SBE-M/WBE Subcontractor

OSBA SCHEDULE 2
LETTER OF INTENT TO PERFORM AS AN SBE-M/WBE SUBCONTRACTOR

This document must be completed by the SBE-M/WBE Subcontractor and submitted with bid packet. Specify in detail, the particular work items to be performed and the dollar amount and/or percentage for each work item. SBE credit will only be given for items which the SBE-M/WBE Subcontractor is SBE certified to perform. Failure to properly complete Schedule 2 may result in your SBE participation not being counted.

PROJECT NUMBER: 2003514 PROJECT NAME: Silver Beach Road from E. of Congress Avenue to Old Dixie Highway

TO: Metric Engineering, Inc.
(Name of Prime Bidder)

The undersigned is certified by Palm Beach County as a - (check one or more, as applicable):

Small Business Enterprise X Minority Business Enterprise X

Black Hispanic Women Caucasian Other (Please Specify) X (Asian)

Date of Palm Beach County Certification: 2/15/2015

The undersigned is prepared to perform the following described work in connection with the above project. Additional Sheets May Be Used As Necessary

| Line Item/ Lot No. Item Description | Qty/Units | Unit Price | Total Price/ Percentage |
|---|-------------------|-------------------|----------------------------|
| <u>Field Investigation</u> | <u> </u> | <u> </u> | <u>\$7125.00</u> |
| <u>Laboratory Testing</u> | <u> </u> | <u> </u> | <u>\$870.00</u> |
| <u>Field Engineering & Technical Services</u> | <u> </u> | <u> </u> | <u>\$780.00</u> |
| <u>Engineering & Technical Services</u> | <u> </u> | <u> </u> | <u>\$1410.00</u> |
| <u> </u> | <u> </u> | <u> </u> | <u> </u> |
| <u> </u> | <u> </u> | <u> </u> | <u> </u> |

at the following price or percentage 7.40% \$10,185.00
(Subcontractor's quote)

and will enter into a formal agreement for work with you conditioned upon your execution of a contract with Palm Beach County.

If undersigned intends to subcontract any portion of this job to a certified SBE or a non-SBE subcontractor, please list the name of the subcontractor and the amount below.

Price and/or Percentage /
(Name of Subcontractor)

The Prime affirms that it will monitor the SBE's listed to ensure the SBE's perform the work with its own forces. The undersigned subcontractor affirms that it has the resources necessary to perform the work listed without subcontracting to non-certified SBE or any other certified SBE subcontractors except as noted above.

The undersigned subcontractor understands that the provision of this form to Prime Bidder does not prevent Subcontractor from providing quotations to other bidders.

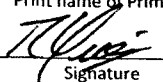
Metric Engineering, Inc.
Print name of Prime Contractor
By: 
Signature
Robert Linares, Sr. Vice President
Print name/title of person executing on behalf
Prime Contractor

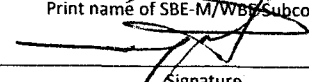
Tierra South Florida, Inc.
Print name of SBE-M/WBE Subcontractor
By: 
Signature
Raj Krishnasamy, P.E. / President
Print name/title of person executing on behalf
of SBE-M/WBE Subcontractor



CERTIFICATE OF LIABILITY INSURANCE

METRI-4 OP ID: TLS

DATE (MM/DD/YYYY)
07/10/2013

THIS CERTIFICATE IS ISSUED AS A MATTER OF INFORMATION ONLY AND CONFERS NO RIGHTS UPON THE CERTIFICATE HOLDER. THIS CERTIFICATE DOES NOT AFFIRMATIVELY OR NEGATIVELY AMEND, EXTEND OR ALTER THE COVERAGE AFFORDED BY THE POLICIES BELOW. THIS CERTIFICATE OF INSURANCE DOES NOT CONSTITUTE A CONTRACT BETWEEN THE ISSUING INSURER(S), AUTHORIZED REPRESENTATIVE OR PRODUCER, AND THE CERTIFICATE HOLDER.

IMPORTANT: If the certificate holder is an ADDITIONAL INSURED, the policy(ies) must be endorsed. If SUBROGATION IS WAIVED, subject to the terms and conditions of the policy, certain policies may require an endorsement. A statement on this certificate does not confer rights to the certificate holder in lieu of such endorsement(s).

| | | | | | | |
|--|--|--|--|--|--|---------------|
| PRODUCER MDW Insurance (North) 362 Minorca Ave Coral Gables, FL 33134 Craig Weinstein | | Phone: 305-444-2324 Fax: 305-444-4980 | | CONTACT NAME: Carrie Worley PHONE (A/C, No, Ext): 954-616-6408 FAX (A/C, No): 954-616-6410 E-MAIL ADDRESS: cworley@mdwinsurance.com | | |
| INSURED Metric Engineering, Inc. 13940 SW 136th St, #200 Miami, FL 33186 | | INSURER(S) AFFORDING COVERAGE | | | | NAIC # |
| | | INSURER A : Hartford Casualty Insurance Co | | | | 29424 |
| | | INSURER B : Hartford Fire Ins. Co. | | | | |
| | | INSURER C : Hartford Casualty Insurance Co | | | | 29424 |
| | | INSURER D : Hartford Insurance Co of SE | | | | 38261 |
| | | INSURER E : Lexington Insurance Company | | | | 19437 |
| INSURER F : | | | | | | |

COVERAGES**CERTIFICATE NUMBER:****REVISION NUMBER:**

THIS IS TO CERTIFY THAT THE POLICIES OF INSURANCE LISTED BELOW HAVE BEEN ISSUED TO THE INSURED NAMED ABOVE FOR THE POLICY PERIOD INDICATED. NOTWITHSTANDING ANY REQUIREMENT, TERM OR CONDITION OF ANY CONTRACT OR OTHER DOCUMENT WITH RESPECT TO WHICH THIS CERTIFICATE MAY BE ISSUED OR MAY PERTAIN, THE INSURANCE AFFORDED BY THE POLICIES DESCRIBED HEREIN IS SUBJECT TO ALL THE TERMS, EXCLUSIONS AND CONDITIONS OF SUCH POLICIES. LIMITS SHOWN MAY HAVE BEEN REDUCED BY PAID CLAIMS.

| INSR LTR | TYPE OF INSURANCE | ADDL SUBR INSR | POLICY NUMBER | POLICY EFF (MM/DD/YYYY) | POLICY EXP (MM/DD/YYYY) | LIMITS | |
|----------|---|-------------------------------------|----------------------|-------------------------|--------------------------------------|---|-----------------------------------|
| A | <input checked="" type="checkbox"/> GENERAL LIABILITY | <input checked="" type="checkbox"/> | 21UUNAN3986 | 03/01/2013 | 03/01/2014 | EACH OCCURRENCE \$ 1,000,000 | |
| | <input type="checkbox"/> CLAIMS-MADE <input checked="" type="checkbox"/> OCCUR | | | | | DAMAGE TO RENTED PREMISES (Ea occurrence) \$ 300,000 | |
| | | | | | | MED EXP (Any one person) \$ 10,000 | |
| | | | | | | PERSONAL & ADV INJURY \$ 1,000,000 | |
| | GEN'L AGGREGATE LIMIT APPLIES PER POLICY <input checked="" type="checkbox"/> PROJECT <input type="checkbox"/> LOC | | | | GENERAL AGGREGATE \$ 2,000,000 | | |
| | | | | | PRODUCTS - COM/PROP AGG \$ 2,000,000 | | |
| B | <input checked="" type="checkbox"/> AUTOMOBILE LIABILITY | <input checked="" type="checkbox"/> | 21UENAN4048 | 03/01/2013 | 03/01/2014 | COMBINED SINGLE LIMIT (Ea accident) \$ 1,000,000 | |
| | <input checked="" type="checkbox"/> ANY AUTO | | | | | <input type="checkbox"/> SCHEDULED AUTOS <input checked="" type="checkbox"/> NON-OWNED AUTOS | BODILY INJURY (Per person) \$ |
| | <input type="checkbox"/> ALL OWNED AUTOS | | | | | | BODILY INJURY (Per accident) \$ |
| | <input checked="" type="checkbox"/> HIRED AUTOS | | | | | | PROPERTY DAMAGE (Per accident) \$ |
| C | <input checked="" type="checkbox"/> UMBRELLA LIAB | <input checked="" type="checkbox"/> | 21XHUAN3161 | 03/01/2013 | 03/01/2014 | EACH OCCURRENCE \$ 1,000,000 | |
| | <input type="checkbox"/> EXCESS LIAB | | | | | AGGREGATE \$ 1,000,000 | |
| | <input type="checkbox"/> DED <input checked="" type="checkbox"/> RETENTION \$ 10,000 | | | | | | |
| | <input type="checkbox"/> CLAIMS-MADE | | | | | | |
| D | WORKERS COMPENSATION AND EMPLOYERS' LIABILITY | <input type="checkbox"/> | 21WBAH4207 | 03/01/2013 | 03/01/2014 | <input checked="" type="checkbox"/> WC STATUTORY LIMITS OTH-ER | |
| | ANY PROPRIETOR/PARTNER/EXECUTIVE OFFICER/MEMBER EXCLUDED? (Mandatory in NH) | | | | | E.L. EACH ACCIDENT \$ 1,000,000 | |
| | If yes, describe under DESCRIPTION OF OPERATIONS below | | | | | E.L. DISEASE - EA EMPLOYEE \$ 1,000,000 | |
| | | | | | | E.L. DISEASE - POLICY LIMIT \$ 1,000,000 | |
| E | Professional Liab | | 031428218 | 03/01/2013 | 03/01/2014 | Ea Claim 1,000,000 | |
| | Full Prior Acts | | | | | Aggregate 2,000,000 | |
| | | | \$100,000 DEDUCTIBLE | | | | |

DESCRIPTION OF OPERATIONS / LOCATIONS / VEHICLES (Attach ACORD 101, Additional Remarks Schedule, if more space is required)

Ref: For all projects Metric Engineering has with Palm Beach County Palm Beach County Board of County Commissioners, a Political Subdivision of the State of Florida, its officers, Employees and Agents are named as additional insured on the General & Auto liability

CERTIFICATE HOLDER**CANCELLATION**

Palm Beach County Board of
County Commissioners
c/o Engineering & Public Works
2300 N. Jog Road
West Palm Beach, FL 33411-2745

SHOULD ANY OF THE ABOVE DESCRIBED POLICIES BE CANCELLED BEFORE THE EXPIRATION DATE THEREOF, NOTICE WILL BE DELIVERED IN ACCORDANCE WITH THE POLICY PROVISIONS.

AUTHORIZED REPRESENTATIVE

Silver Beach Road
E. of Congress Avenue to Old Dixie Highway
Palm Beach County Project No. 2003514

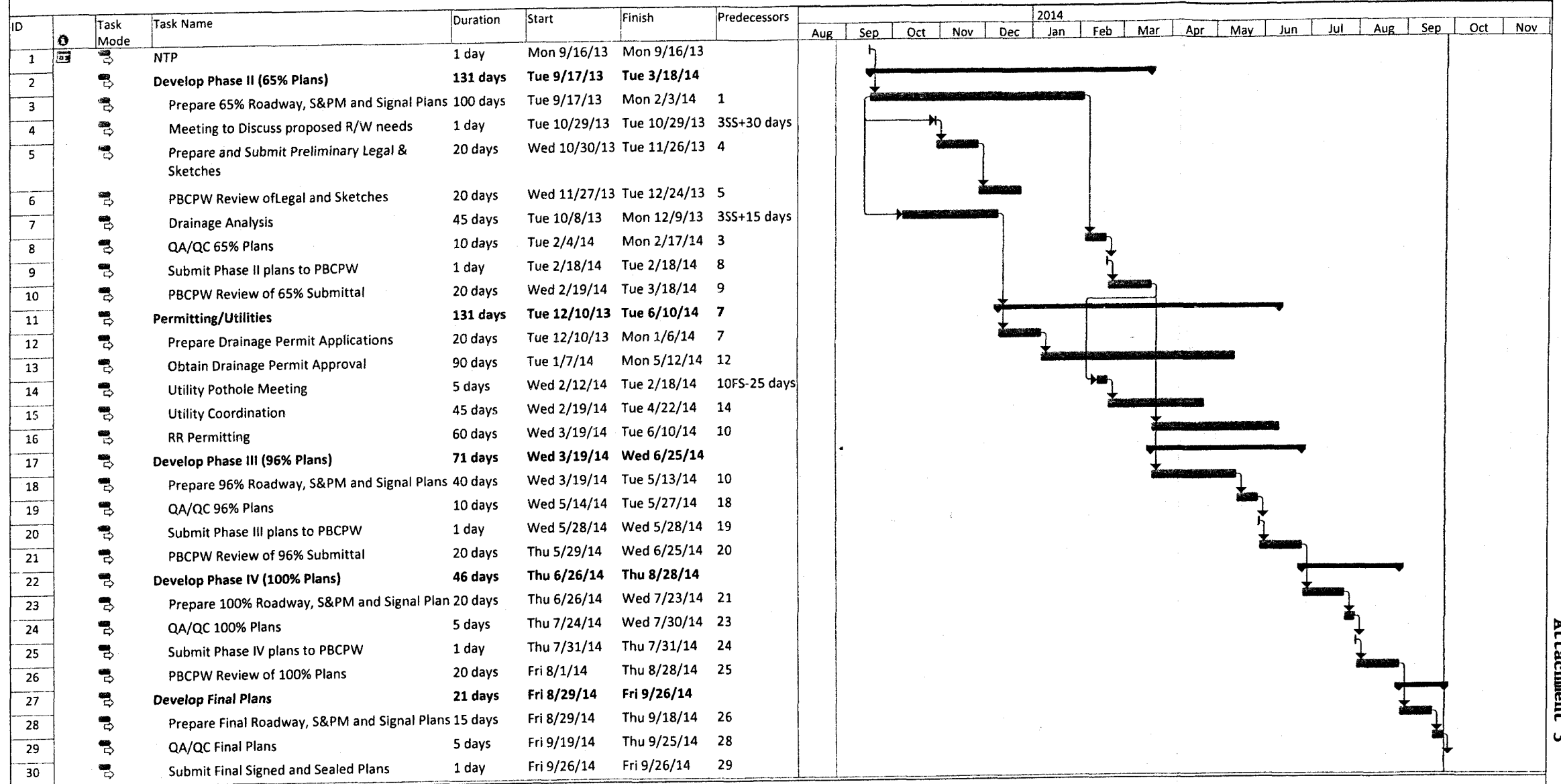

Project: Silver Beach Road
Date: Mon 8/26/13

| | | | | | | | | | |
|-----------|--|--------------------|--|--------------------|--|-----------------------|--|----------|--|
| Task | | Project Summary | | Inactive Milestone | | Manual Summary Rollup | | Deadline | |
| Split | | External Tasks | | Inactive Summary | | Manual Summary | | Progress | |
| Milestone | | External Milestone | | Manual Task | | Start-only | | | |
| Summary | | Inactive Task | | Duration-only | | Finish-only | | | |