

II. FISCAL IMPACT ANALYSIS

A. Five Year Summary of Fiscal Impact:

Fiscal Years	2014	2015	2016	2017	2018
Capital Expenditures	\$ -0-	-0-	-0-	-0-	-0-
Operating Costs	\$1,115	-0-	-0-	-0-	-0-
External Revenues	-0-	-0-	-0-	-0-	-0-
Program Income (County)	-0-	-0-	-0-	-0-	-0-
In-Kind Match (County)	-0-	-0-	-0-	-0-	-0-
NET FISCAL IMPACT	\$1,115	-0-	-0-	-0-	-0-
# ADDITIONAL FTE POSITIONS (Cumulative)					

Is Item Included in Current Budget? Yes X No

Budget Account No:

Fund 1201 Dept 360 Unit 2270 Object 4607

Recommended Sources of Funds/Summary of Fiscal Impact:

County Transportation Trust Fund
Railroad Crossing Maintenance

C. Departmental Fiscal Review:

Alicia Rodamen

III. REVIEW COMMENTS

A. OFMB Fiscal and/or Contract Dev. and Control Comments:

J. M. W. L. 2/11/14

OFMB
5/10/14

Dr. J. Jacobson 2/12/14

Contract Dev. and Control
2-12-14 B. Jacobson

B. Approved as to Form and Legal Sufficiency:

Mark R. Smith 2/20/14

Assistant County Attorney

C. Other Department Review:

Department Director

This summary is not to be used as a basis for payment.

OLD DIXIE HIGHWAY ALONG FEC RAILROAD Yamato Road to Linton Boulevard

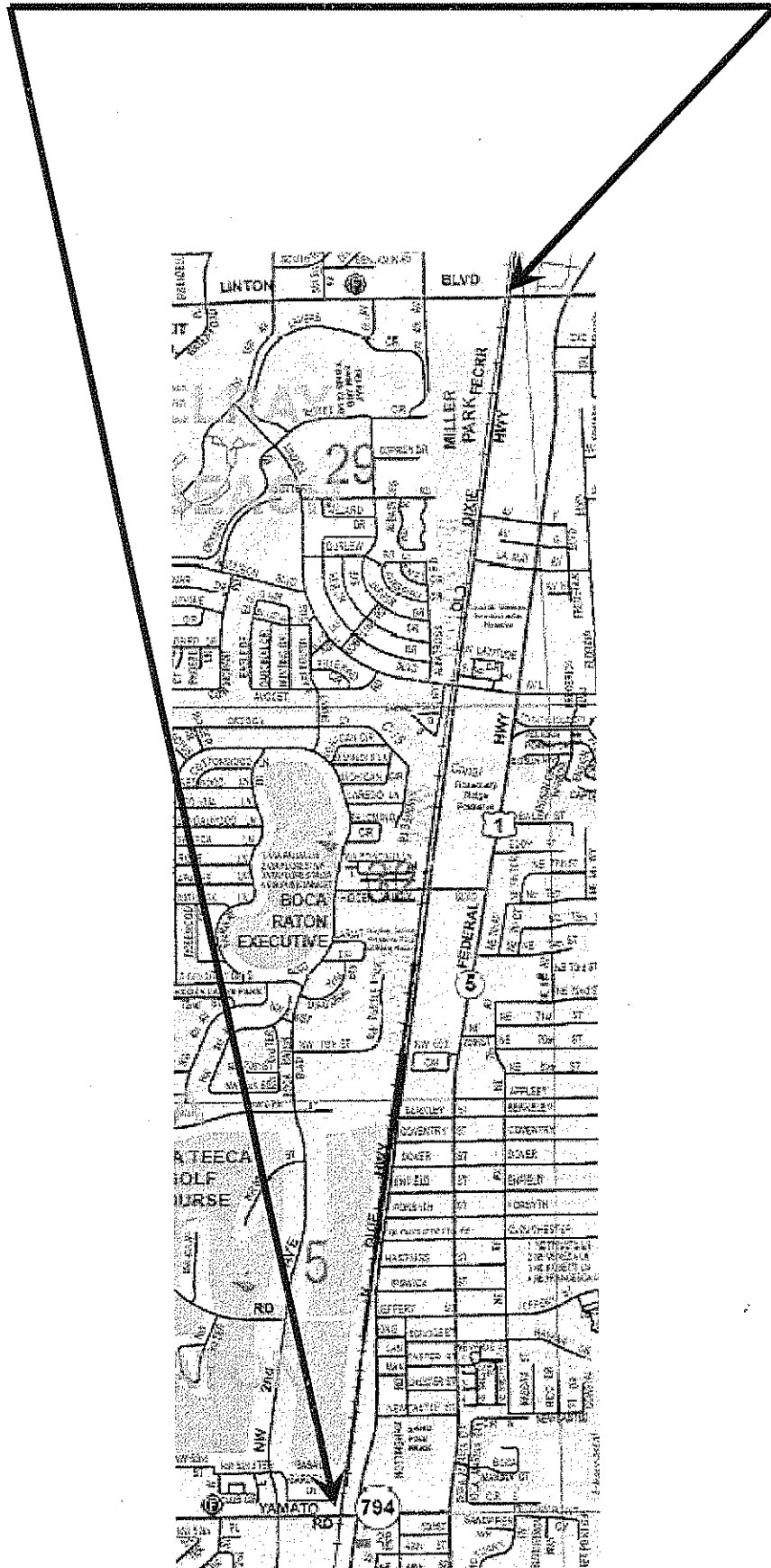

LOCATION MAP



REC'D NOV 06 2012

Invoice

Please make checks payable to:

Florida East Coast Railway, LLC
P. O. Box 863029
Orlando, FL 32886-3029

Page No	1 of 1
Invoice No	41981742
Invoice Date	10/18/2012
Due Date	11/2/2012
Customer	696311

NOV 7 2012

Billing Address:

PALM BEACH COUNTY-BOARD CNTY COMM
ALEXIS WILLHITE-3RD FLR E WING
2300 N JOG ROAD
WEST PALM BEACH FL 33411-2745

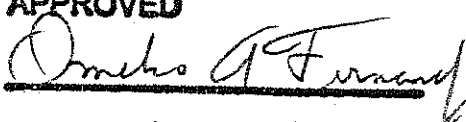
Invoice	Vendor Invoice	Remark	Amount
41981742		FLAGGING JOB 10291	1,114.18
FEC WO # 2275855 MP 319 + 2280 BTWN YAMATO RD & LINTON BLVD CUSTOMER JOB # 545.542 SERVICE PERIOD 9/10/12 PROGRESS BILL #1 <i>Old Dixie Survey 2004503</i>			
APPROVED  <u>OK-KFS 11/9/12</u> <i>K.M. Verifal</i>			
Due Date:	Amount Invoiced:	Tax Amount:	Payments Received
11/2/2012	1,114.18		0.00
			Balance Due:
			1,114.18

Tear Here

Please detach this portion of the invoice and mail it with your check



Invoice Remittance Slip

Customer:

PALM BEACH COUNTY-BOARD CNTY COMM
ALEXIS WILLHITE-3RD FLR E WING
2300 N JOG ROAD
WEST PALM BEACH FL 33411-2745

Make Checks Payable to:

Florida East Coast Railway, LLC
P. O. Box 863029
Orlando, FL 32886-3029

Invoice No	41981742
Invoice Date	10/18/2012
Due Date	11/2/2012
Amount Due	1,114.18
Customer	696311

BILL COLLECTIBLE
FLORIDA EAST COAST RAILWAY

ORIGINAL

BILL REF NO.	BILL DATE
41981742	10/12/12

DATE DUE	CUSTOMER NUMBER
	696311

CUSTOMER Name & Address

Palm Beach County
Board of County Commissioners
2300 N Congress Ave
West Palm Beach, FL 33411-2745

DESCRIPTION:

FLAGGING JOB 10291
FEC WO# 2275855
MP 319+2280 Btwn Yamato Rd & Linton Blvd
Customer Job # 545.542
Service Period 9/10/12
Progress Bill # 1

Invoice total \$ 1,114.18

DISTRIBUTION:	Account Number	Amount
	2.0709.09/WO#2275855	\$ 1,114.18
	TOTAL	\$ 1,114.18

Florida East Coast Railway

FEC WO# 2275855

FJ# 10291

MP 319+2280

Job Location Btwn Yamato Rd & Linton Blvd

Customer Job # 545.542

Service Period 9/10/12

Progress Bill # 1

NON-CONTRACT LABOR (salaried FEC employees)

Engineering Manager	2	Hour	@	46.68	= \$	93.36
Engineering Admin.	1	Hour	@	25.06	= \$	25.06
Billing & Collection	1	Hour	@	26.92	= \$	26.92
Subtotal					\$	145.34
Overhead	81.77%				\$	118.84
Total non-contract labor					\$	264.18

FLAGGING

See attached for flagging detail \$ 850.00

TOTAL \$ 1,114.18

FLAGGING

FLAGGING JOB 10291

Progress Bill # 1

Weekday = \$850 per day, time & a half for OT (\$127.50/OT hr)

Saturday & Holidays = time & a half = \$1,275 daily rate

Sunday = double time = \$1,700 daily rate

	<u>Date</u>	<u>Day</u>	<u>Daily Rate</u>	<u>OT (hrs)</u>	<u>OT Amount</u>	<u>Total</u>
Flagman	9/10/12	Monday	\$ 850.00	0	\$ -	\$ 850.00

TOTAL FLAGGING						\$ 850.00
-----------------------	--	--	--	--	--	------------------

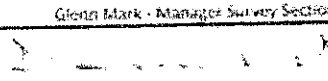
Florida East Coast Railway Flagging Order		
1	Date of Request	05-Sep-12
2	Company Requestings Name	Palm Beach County Engineering
3	Sub Contractor	None
4	Person Requesting	Glenn Mark - Manager Survey Section
5	Email	gmark@pbcegov.org
6	Phone	561.684.4054
7	Fax	561.684.4171
8	Field Contact name	Scott Adams
9	Phone	561.386.0630
10	Email	sadams1@pbcegov.org
11	Bill to	Board of County Commissioners
12	Billing Address	Jog Rd 2300 N. Congress Avenue
13	City, State, Zip	West Palm Beach, FL 33411-2745
14	PO Number	
15	Start date	10-Sep-12
16	Start time	8:00 AM
17	Expected Duration	1 Day
18	Job Location	Between Yamato Rd. & Uinton Blvd. (Along Dixie Hwy)
19	Job Description	Locate East R/W line from ties to the centerline of the Tracks
20	Print Name:	Glenn Mark - Manager Survey Section
21	Accepted by: <small>electronic signature is acceptable when selected</small>	
Note: By signing this form your company is responsible for the costs associated with the work.		
Daily Rates (Based on 10 hr day)	\$850.00/Weekday \$1,275.00/Saturday & Holiday \$1,700.00/Sunday	
Overtime Rate	\$127.50/Hour	
The above daily rates do not include the cost for Engineering and Accounting time associated with this flagging job request. Estimates are provided, however, the responsible party is responsible for paying actual costs.		
PLEASE ENSURE THE INFORMATION ON THE ORDER IS CORRECT WHEN YOU RECEIVE YOUR CONFIRMATION.		
Any work that requires excavating on RR property a SDL (signal dig location) number must be issued by the FEC by calling 1-800-342-1131 ext. 2377. IT IS YOUR RESPONSIBILITY to call BOTH the FEC Railway for SDL number and Sunshine state one call (dial 811) prior to doing any excavating		
Information below will be completed and Job Confirmation will be sent to you by Railroad Protective Services. Please refer to FJ number below when calling about job		
SDL Number (assigned by FEC)	0	
FEC MP	Near MP 319+ 2280	
Job Number #	FJ 10291	
Work Order #	2275855	
ALL CANCELLATIONS or RESCHEDULING must be provided with 12 hours notice!! Cancellations, Rescheduling, Callbacks of assigned jobs provided by Railroad Protective Services should be managed with: David Shaffer DR5@rrprotective.com ph 904.588.3433 or Patsy Crisafi PJCrisafi@rrtrainers.com ph 904.813.9905		
FAILURE TO DO SO WILL RESULT IN A FULL DAY CHARGE!		

Attn:
Alex
Wil

Florida East Coast Railway Daily Flagging \ Inspection Report

1	Date	9/10/12
2	Time on Duty	0800
3	Time off Duty	1500
4	Total Hours	7
5	Job Site POC Printed Name	Scott T. Adams Sr
6	Job Site POC Phone number	561-386-0630
7	Job Site POC Signature	<i>Scott T. Adams Sr</i>

By signing this form I acknowledge that the RWIC was on site for the time indicated above

8	Contractors Name	PALM BEACH COUNTY
9	Job number	FS10291
10	Location	VILLA BICA
11	Milepost Location	MP 319 + 2280

10	Type of work	SURVEYING
11	Type of protection required	Train Approach Warning <input checked="" type="checkbox"/> Working Limits
12	Incidents \ Comments	
13	Incidents \ Comments	

14	RWIC Name	Jimmie Marshall
15	RWIC Signature	<i>Jimmie Marshall</i>

Phone Numbers	
Patsy Crisafi	(904) 813-9905 Nextel 160*34*6775
Dave Shafier	(904) 588-3433
RPS Office (Susan)	(904) 296-8088
RPS Office Fax	(866) 864-9798
FEC Dispatcher	1-800-342-1131 ext. 2500 or 2302
FEC Police	1-800-342-1131 ext. 5634
Charles Stone-FEC	(904) 669-1142
Jeff Roden-FEC	(904) 669-1282