

Agenda Item #: 3-C-9

**PALM BEACH COUNTY
BOARD OF COUNTY COMMISSIONERS
AGENDA ITEM SUMMARY**

Meeting Date: July 1, 2014	<input checked="" type="checkbox"/>	Consent	<input type="checkbox"/>	Regular
	<input type="checkbox"/>	Workshop	<input type="checkbox"/>	Public Hearing

Department:
Submitted By: Engineering & Public Works Department
Submitted For: Roadway Production Division

I. EXECUTIVE BRIEF

Motion and Title: Staff recommends motion to approve: a task order to the annual contract, R2014-0119, in the amount of \$115,271.52, with Alan Gerwig & Associates, Inc. (AGA), for professional services for the Florida Mango Road over Lake Worth Drainage District L-6 Canal bridge replacement project (Project).

SUMMARY: Approval of this task order will provide the professional services necessary for the preparation of design plans and construction bid documents for the Project. The Small Business Enterprise (SBE) goal for the Project is 15%. AGA has achieved 93.41% for this Project. AGA is a Palm Beach County company and is a certified SBE.

District 2 (MRE).

Background and Justification: On February 4, 2014, the Board of County Commissioners (Board) approved an annual contract, R2014-0119, with AGA to provide professional services required for Palm Beach Countywide (County) structural engineering projects. The County now desires AGA to prepare design plans and construction bid documents for the Project, as detailed in Exhibit "A" of the attached task order. The fee, as detailed in Exhibit "A" of the attached task order, has been negotiated as just and reasonable compensation as follows:

Basic Services (Lump Sum)	\$ 68,923.00	(Roadway Design, Utility Coordination, Permitting).
Reimbursable Expenses (Not to Exceed)...	\$ 28,909.48	(Survey, Geotechnical, Permit Fees, Reprographics).
Optional Services (Not to Exceed).....	\$ <u>17,439.04</u>	(Utility Relocation Design, Survey).
Total:	\$ <u>115,271.52</u>	

After reviewing the attached task order and finding it in proper order, staff recommends the Board's approval.

Attachments:

1. Location Map
2. Task Order with Exhibits "A", "B", "C" and "D" and Certificates of Insurance (2)
3. Project Work Schedule

=====

Recommended by:	<u><i>Domeo A. Fernandez</i></u>	<u>6/2/14</u>	
	Division Director	Date	
Approved By:	<u><i>S.T. Wald</i></u>	<u>6/4/14</u>	
	County Engineer	Date	

II. FISCAL IMPACT ANALYSIS

A. Five Year Summary of Fiscal Impact:

Fiscal Years	2014	2015	2016	2017	2018
Capital Expenditures	<u>\$160,000</u>	<u>-0-</u>	<u>-0-</u>	<u>-0-</u>	<u>-0-</u>
Operating Costs	<u>-0-</u>	<u>-0-</u>	<u>-0-</u>	<u>-0-</u>	<u>-0-</u>
External Revenues	<u>-0-</u>	<u>-0-</u>	<u>-0-</u>	<u>-0-</u>	<u>-0-</u>
Program Income (County)	<u>-0-</u>	<u>-0-</u>	<u>-0-</u>	<u>-0-</u>	<u>-0-</u>
In-Kind Match (County)	<u>-0-</u>	<u>-0-</u>	<u>-0-</u>	<u>-0-</u>	<u>-0-</u>
NET FISCAL IMPACT	<u>\$160,000</u>	<u>-0-</u>	<u>-0-</u>	<u>-0-</u>	<u>-0-</u>
# ADDITIONAL FTE POSITIONS (Cumulative)	_____	_____	_____	_____	_____

Is Item Included in Current Budget? Yes X No

Budget Account No:

Fund 3502 Dept 361 Unit 1440 Object 6505

Recommended Sources of Funds/Summary of Fiscal Impact:

Road Impact Fee Zone-2 Fund
Florida Mango Road over LWDD L-6 Canal

New Task Authorization	
Basic Services	\$ 68,923.00
Reimbursables	\$ 28,909.48
Optional Services	\$ 17,439.04
Total Task Authorization	\$ 115,271.52
Staff Charges	
Roadway Production	\$ 21,668.00
Right of Way	\$ 5,765.00
Survey	\$ 5,765.00
Traffic	\$ 11,530.00
Fiscal Impact	\$ 159,999.52

C. Departmental Fiscal Review:

Alicia Kovalainen

III. REVIEW COMMENTS

A. OFMB Fiscal and/or Contract Dev. and Control Comments:

[Signature]
OFMB
5/10 5/14/14
6/5 6/5/14

[Signature]
Contract Dev. and Control
6-11-14 [Signature]

B. Approved as to Form and Legal Sufficiency:

[Signature]
6/12/14
Assistant County Attorney

C. Other Department Review:

Department Director

This summary is not to be used as a basis for payment.

Florida Mango Road over LWDD L-6 Canal
Bridge Replacement
Palm Beach County Project No. 2014511

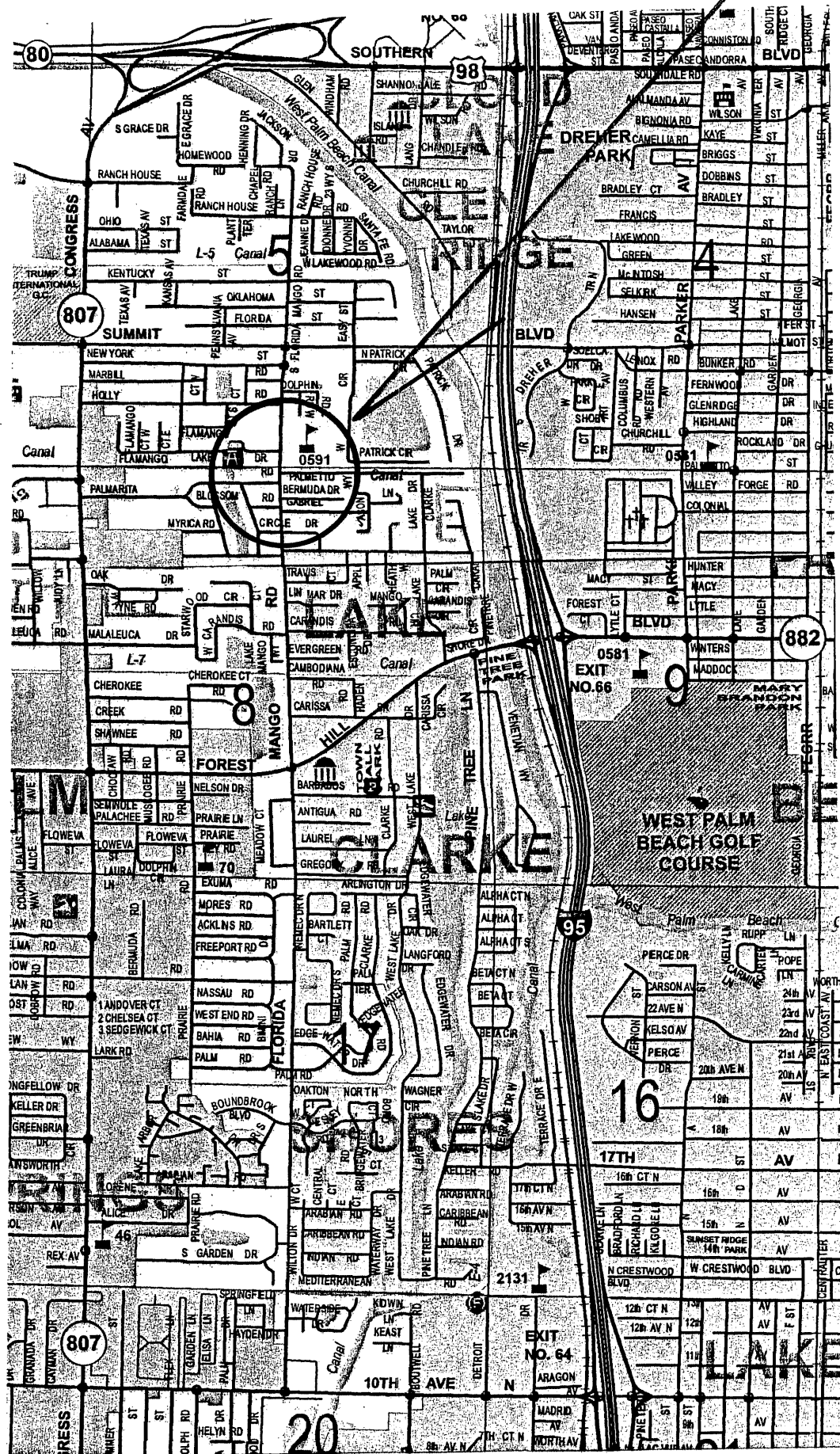

LOCATION MAP

WORK TASK ORDER TO ANNUAL CONTRACT BETWEEN

**PALM BEACH COUNTY
AND
ALAN GERWIG & ASSOCIATES, INC.**

FOR PROFESSIONAL ENGINEERING SERVICES ON

**FLORIDA MANGO ROAD OVER LWDD L-6 CANAL
BRIDGE REPLACEMENT**

**PROJECT NO.: 2014511
PALM BEACH COUNTY, FLORIDA**

THIS WORK TASK ORDER TO THE ANNUAL CONTRACT, made and entered into this day of _____ 2014 by and between Palm Beach County, hereinafter called the **COUNTY**, and Alan Gerwig & Associates, Inc., a Florida Corporation with an address of 12798 W. Forest Hill Boulevard, Suite 204, Wellington, Florida 33414, hereinafter called the **CONSULTANT**.

WITNESSETH

WHEREAS, the **COUNTY** and **CONSULTANT** entered into an Annual Contract for Structural Engineering Services on a task order basis on February 4, 2014 (R2014-0119).

WHEREAS, the **COUNTY** desires the **CONSULTANT** to perform structural engineering services for Florida Mango Road over LWDD L-6 Canal Bridge Replacement, Palm Beach County, Florida (hereinafter called the **PROJECT**); and,

WHEREAS, the **CONSULTANT** agrees to perform the structural engineering services required for preparing design plans and construction bid documents, including related documents for the **PROJECT**; and,

**Re: Florida Mango Road over LWDD L-6 Canal Bridge Replacement
Project No.: 2014511**

WHEREAS, the following fee has been negotiated and found to be reasonable compensation for these professional services to be performed by the **CONSULTANT**:

Basic Services in a lump sum fee of \$68,923.00;

Reimbursable Expenses capped at \$28,909.48;

Optional Services capped at \$17,439.04;

Totaling \$115,271.52

NOW, THEREFORE, THIS INDENTURE WITNESSETH: That for and in consideration of the mutual benefits to flow from each to the other, the parties hereto agree as follows:

1. The **CONSULTANT** agrees to provide professional services as described in Exhibit "A" of the Work Task Order known as "SCOPE OF WORK & FEE".
2. The **CONSULTANT** agrees to "CERTIFICATION" statements as described in Exhibit "B" of the Work Task Order.
3. The **CONSULTANT** agrees to Small Business Enterprise (SBE) Participation, described in Exhibit "C" of the Work Task Order.
4. The **CONSULTANT** has provided a sub-consultant Letter of Intent to perform as an SBE as described in Exhibit "D" of the Work Task Order.
5. The **COUNTY** agrees to pay the **CONSULTANT** a fee of One Hundred Fifteen Thousand Two Hundred Seventy-One Dollars and Fifty-Two Cents (\$115,271.52).
6. The **CONSULTANT** agrees to indemnify, defend and hold harmless the **COUNTY** against all claims that may arise as a result of negligence, wrongdoing, misconduct or want of care by the **CONSULTANT**.

Except as hereby amended, changed or modified, all other terms, conditions and obligations of the Contract dated **February 4, 2014 (R2014-0119)**, shall remain in full force and effect.

Re: Florida Mango Road over LWDD L-6 Canal Bridge Replacement
Project No.: 2014511

IN WITNESS WHEREOF, the parties hereto have made and executed this Work Task Order as of the day and year first above written.

OWNER:

Palm Beach County, Florida, a
Political Subdivision of the
State of Florida

BOARD OF COUNTY COMMISSIONERS

BY: _____
Priscilla A. Taylor, Mayor

ATTEST:
Sharon R. Bock, Clerk & Comptroller
Circuit Court

BY: _____
Deputy Clerk

SEAL

APPROVED AS TO TERMS
AND CONDITIONS:

BY: _____
Orlando A. Fernandez

APPROVED AS TO FORM & LEGAL
SUFFICIENCY:

COUNTY ATTORNEY

CONSULTANT:

Alan Gerwig & Associates, Inc.
a Florida Corporation

BY: _____
Alan Gerwig, P.E., LEED A.P.
President

CORPORATE SEAL

WITNESS:

BY: _____
Claudio Costa Jr

Claudio Costa Jr
(Printed Name)

BY: _____
Michael Gambarrini

MICHAEL GAMBARRINI
(Printed Name)

EXHIBIT "A"

12798 W. Forest Hill Boulevard
Suite 201
Wellington, FL 33414
Phone: (561) 792-9000
Fax: (561) 792-9901
CA No. 7969

Alan Gerwig & Associates, Inc.
Consulting Engineers



DMED OK 5/5/2014

March 24, 2014

Chris Dudek, P.E.
Palm Beach County
Roadway Production Division
2300 N. Jog Road, Suite 3W-33
West Palm Beach, FL 33411

*OK to process
DMED
5/5/14*

**RE: Florida Mango Road over LWDD L-6 Canal
From South of Palmarita Road to Holly Road
Palm Beach County Proj. No. 2014511**

Dear Mr. Dudek,

Alan Gerwig & Associates (AGA) ("Consultant") is pleased to submit this letter of agreement ("Agreement") for providing professional engineering services to Palm Beach County, ("Client") for the above referenced project. Our project understanding, scope of services and fees are as follows.

Project Understanding

Palm Beach County Roadway Production Division is proposing to widen a stretch of Florida Mango Road on either side of the Lake Worth Drainage District (LWDD) L-6 Canal. The widening will involve expanding the existing 2 lane road to a three lane road with a central left turn lane primarily for south-bound vehicles turning left into Meadow Park Elementary School on the east side of Florida Mango Road. The third lane will start south of the crossing of the LWDD L-6 Canal and will end north of the northern most entrance to the school. With the distance required to transition to and from the 3-lane section, the limits of the project are expected to be from just south of Palmarita Road to Holly Road, which is approximately 1200 LF.

The existing crossing of the L-6 Canal consists of a short single-span bridge, which needs to be replaced. The bridge will be replaced with a circular concrete culvert with concrete headwalls.

The widened section of road will include a new drainage system to convey the runoff from the right-of-way to the canal. The drainage system will incorporate exfiltration trench to provide water quality treatment. The existing drainage outfalls to the canal will be incorporated into the proposed culvert in the canal.

Scope of Work – Basic Services

AGA will provide the design services required to prepare construction documents and specifications for the road widening, drainage modifications and replacement of the existing bridge over the L-6 Canal with a pipe culvert. Design surveying services and geotechnical engineering services will be provided by AGA with sub consultants. The sub consultants' fees for these professional services are included in this proposal. The scope of services includes the following design tasks:

- Design Survey – see attached details from sub-consultant HSQ Group.
- Geotechnical Investigation – see attached details from sub-consultant Dunkelberger Engineering and Testing.
- Design of the roadway widening within the required limits of construction.
- Design of new drainage system including exfiltration trench for water quality treatment with outfalls into the L-6 Canal.
- Design of culvert and headwalls in canal.
- Identify and address exiting utility conflicts within the right-of-way. Existing utility coordination will be managed by Palm Beach County.
- Plan submittals at 35%, 65%, 96% and 100%. Preliminary calculations will be submitted with the 65% and 96% submittals. Final design calculations will be furnished with the 100% submittal.
- Provide preliminary quantities and cost estimates with the 65% and 96% submittals.
- Provide final quantities and cost estimate with the 100% submittal.

The basic scope of services will include obtaining the following permits:

- Lake Worth Drainage District Culvert Crossing Permit.
- Lake Worth Drainage District Drainage Permit.
- Joint South Florida Water Management District and Army Corp of Engineers, Environmental Resource Permit.
- South Florida Water Management District Dewatering Permit

Optional Services

The following optional design and permitting services are offered in relation to relocating the existing water utilities.

- Prepare preliminary design and layout for the relocation of the existing water utilities at the L-6 Canal crossing.
- Coordinate with Palm Beach County Water Utility Department (WUD) on design requirements.
- Prepare final construction documents for the relocation of the existing utilities including standard WUD details and specifications.

The scope of services will include obtaining the following permits:

- Lake Worth Drainage District Culvert Crossing Permit.
- Lake Worth Drainage District Drainage Permit.
- Joint South Florida Water Management District and Army Corp of Engineers, Environmental Resource Permit.
- South Florida Water Management District Dewatering Permit

The optional scope of services will include obtaining the following permits:

- Palm Beach County Health Department Permits for Water and Force Main relocation.

Assumptions

- Palm Beach County will be responsible for utility coordination.
- Sufficient cover and clearance will be available for the water utilities using circular pipe culvert(s).
- As Built drawings will be provided by the contractor.
- Relocation of school zone flashing signal and electrical utility will be the responsibility of Palm Beach County.

Basic Services Fees

Prime Consultant Fee ✓ \$ 68,923.00

Optional Services

Utility Relocation Design ✓ \$ 15,624.00
Additional Surveying Services ✓ \$ 1,815.04
Total: ✓ \$ 17,439.04

Reimbursable Fees

Surveying Services	\$ 14,414.44
Geotechnical Engineering Services	\$ 7,595.04
Allowance for Permit Fess	\$ 6,000.00
Reprographics	<u>\$ 900.00</u>
Total:	✓ \$ 28,909.48

Deliverables

Construction documents will be prepared on 11" x 17" plan sheets. Three sets of plans and two sets of calculations will be submitted at each plan review stage for review and comment. The geotechnical report will be submitted only at the 35% submittal phase. Three sets of plans plus one signed and sealed set will be submitted after the 100% plans are reviewed and approved.

A breakdown of the fee for the scope of work is attached, which details the man hours and rates for your review. If you have any questions, please do not hesitate to contact me.

Sincerely,

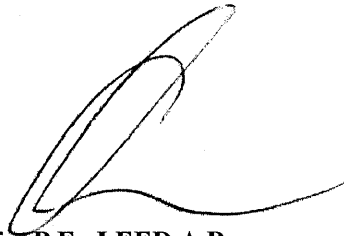

Alan Gerwig, P.E., LEED A.P.
President

FINANCIAL MANAGEMENT PLAN

Project Florida Mango & LWDD L-7 Canal
 Project No. _____
 PM _____

REV. Date 22-Mar-14

Task Outline	TOTALS	Total Hours	Estimated Labor									
			Chief Eng	Snr. Eng	Snr. Proj Eng	Proj. Man	Proj Eng	Engineer	Engineer Int	Eng Tech	Designer	
Miscellaneous Tasks and Drawings												
Overall Project Layout	\$1,460.00	12		4	4							
Field Reviews	\$1,124.00	8		4	4						4	
Project Coord., Technical Mtgs, QC	\$2,008.00	16		4	8							4
Misc Task Subtotal	\$4,592.00											
35% Plan Submittal												
General Layout Design and Plans												
Develop Typical Road Section	\$1,446.00	12		2	6							4
Source Existing Water Utilities	\$548.00	4			4							
Survey Coordination	\$548.00	4			4							
Geotech Coordination	\$548.00	4			4							
Cover Sheet	\$442.00	4			2							2
Key Sheet	\$442.00	4			2							2
General Notes	\$716.00	6			4							2
Existing & Proposed Roadway Plan & Profile	\$4,372.00	38		2	20							2
Culvert/Headwalls Layout & Preliminary Details	\$1,782.00	16		2	6							16
Incorporate Soil Boring Log	\$305.00	3			1							8
Establish LWDD Canal Design Section	\$1,326.00	12			6							2
Subtotal 35% Plans	\$12,475.00											6
65% Plan Submittal												
Address Comments on 35% Submittal	\$2,104.00	20			8							12
Drainage Design & Computations	\$5,022.00	38		4	30							4
Proposed Drainage in Plan & Profile	\$4,660.00	40		4	20							16
Add Existing Utilities to Plans	\$1,052.00	10			4							6
Identify Utility Conflicts	\$1,432.00	12			8							4
Proposed Driveway Profiles	\$1,768.00	16			8							8
Proposed Geometrics	\$1,768.00	16			8							8
Proposed Cross Sections	\$3,536.00	32			16							16
Culvert Design & Details	\$3,488.00	30		2	16							12
Canal Sections & Canal Stabilization	\$1,220.00	12			4							8
Establish limits of Construction	\$442.00	4			2							2
Preliminary Quantities	\$1,432.00	12			8							4
Preliminary Cost Estimate	\$548.00	4			4							
Utility Coordination	\$1,264.00	10			8							2
Subtotal 65% Plans	\$29,736.00											
96% Plan Submittal												
Address Comments on 65% Submittal	\$2,104.00	20			8							12
Final Drainage Design & Computations	\$1,432.00	12			8							4
Final Drainage in Plan & Profile	\$2,104.00	20			8							12
Final Culvert Design & Details	\$1,768.00	16			8							8
Address/Resolve Utility Conflicts	\$1,432.00	12			8							4
Final Utility Coordination	\$548.00	4			4							
Revised Quantities & Cost Estimate	\$884.00	8			4							4
Subtotal 96% Plans	\$10,272.00											
100% Plan Submittal												
Address Comments on 96% Submittal	\$1,768.00	16			8							8
Final Quantities & Cost Estimate	\$884.00	8			4							4
Prepare Final Documents	\$884.00	8			4							4
Subtotal 100% Plans	\$3,536.00											

Task Outline	TOTALS	Total Hours	Estimated Labor									
			Chief Eng	Snr. Eng	Snr. Proj Eng	Proj. Man	Proj Eng	Engineer	Engineer Int	Eng Tech	Designer	
Permits												
Pre-Application Meeting with LWDD	\$576.00	4		4								
Pre-Application Meeting with SFWMD	\$576.00	4		4								
Lake Worth Drainage District Culvert Permit	\$1,432.00	12			8						4	
Lake Worth Drainage District Drainage Permit	\$1,432.00	12			8						4	
SFWMD ERP	\$2,316.00	20			12						8	
SFWMD Dewatering Permit	\$1,980.00	16			12						4	
Subtotal Permitting	\$8,312.00											
Basic Svcs Total Fee	\$68,923.00											
Opt. Services - Utility Reloc.												
Conceptual Plan Layout	\$3,368.00	30			16						14	
Coord. and Review meetings with WJD (2 ea.)	\$1,264.00	10			8						2	
Design, details and specifications	\$7,552.00	64		8	32						24	
PBCHD Permitting	\$3,440.00	28		4	16						8	
Subtotal - Opt. Svcs.	\$15,624.00											
TOTAL HOURS	723		0	48.0	395.0	0	0	0	0	0	280	0
BILLING RATE			\$183.00	\$144.00	\$137.00	\$105.00	\$98.00	\$87.00	\$86.00	\$75.00	\$84.00	\$0.00
TOTAL DOLLARS	\$84,547.00		\$0.00	\$6,912.00	\$54,115.00	\$0.00	\$0.00	\$0.00	\$0.00	\$0.00	\$23,520.00	\$0.00
Subcontractors			Cost		Notes							
Surveyor			16,229.48									
Geotechnical Engineer			7,595.04									
Landscape Architect												
Total Subcontracts			\$ 23,824.52									
Reimbursable Charges					Summary							
Supplies, Printing, Copies, Etc.			\$ 900.00		Total Hours			723				
					Total Labor Dollars			\$84,547.00				
					Material Dollars			\$900.00				
					Miscellaneous Dollars			\$6,000.00				
Permit Fees					Subcontractors			\$23,824.52				
SFWMD, LWDD (see below)			\$ 6,000.00		Total Project			\$115,271.52				
Distribution												
() Accounting				() Project Notebook				() Other _____				

Reimbursable Charges				
Item:	Quantity	Unit	Unit Cost	Total
Printing/Copies	8.5"x11"	500 page	\$0.10	\$50
	11"x17"	1000 page	\$0.25	\$250
Electronic Media	CD's	6 ea	\$25.00	\$150
Currier Services		8 ea	\$45.00	\$360
Overnight Shipping		6 ea	\$15.00	\$90
Total				\$900.00

Permit Fees		
Agency	Permit	Estimated Fee (\$)
SFWMD	ERP	
SFWMD	Dewatering	
LWDD	Culvert	
LWDD	Drainage	
Total		\$ 6,000

**Surveying Services for
Florida Mango Road over LWDD L-6 Canal
Palm Beach County**

Project Limits:

The project limits for the survey are as follow:

- 1- From Bermuda Drive to Holly Rd for a distance of approximately 1300'.
- 2- 100' along each side streets (Palmarita Rd, Palmetto Rd, and Flamango Lake Dr), for a total distance of 300'.
- 3- Nine driveways

Scope:

1. Review title search supplied by Palm Beach County prior to commencement of field topo to establish right-of-way width, and compile all plats and deeds into a map.
2. Collect benchmarks and global positioning control data.
3. Set control points tied to State plane at 600-foot intervals. "NAD 83, 1990 adjustment"
4. Run a closed level loop and set Benchmarks at 600-foot intervals outside the limits of constructions. Survey to be prepared based on the NAVD 1988 datum.
5. Locate subdivision corners, section corners and any other existing control monuments that will assist in the establishment of the location of the right-of-way lines for this project.
6. Locate above ground features with elevations.
7. Cross-section the project at 100' intervals extending 25 feet outside the right of way.
8. Acquire cross sections of L-6 canal at 50-foot intervals as follow; at face of headwall, 50' 100' and 150' away from the headwall for both east and west directions.
9. Perform a detailed survey of the existing bridge over the L- 6 canal.
10. Acquire the finished floor elevation for all structures that adjoin the right of way and show on the survey. The elevations will be obtained from either as built or approved site plans but not from actual survey.
11. Detail drainage structures within the right of way including culverts. Locate drainage outfall pipes
12. Acquire topo. on each side street up to 100'
13. Acquire topo and elevations at driveways up to either a low point or a high point
14. Locate all trees with size and type within right of way and 25' beyond right of way.

Optional Services

- 1- Prepare sketch and legal descriptions for temporary construction easements. Assume 3 for the purpose of the fee proposal.
- 2- Provide assistance to the Geotechnical Engineer in locating the soil borings in relationship to the alignment.
- 3- Obtain horizontal and vertical locations of existing utilities that possibly will be in conflict with proposed drainage structures.

Survey Deliverables

- 1- Two signed and sealed 11" X 17" copies of the Specific Purpose Survey and a copy of the CADD file.
- 2- One copy of the topographic file, drainage file, utility file, right of way file, and point file in a Microstation digital CADD format or ACADD format
- 3- One copy of the ASCII file of all elevations in terms of x,y,z, description.
- 4- Four signed and sealed copies of the cross sections for the LWDD L-7 at 1" = 10' both horizontal and vertical.
- 5- Create DTM drawing.

EXHIBIT "D"

**OSBA SCHEDULE 2
LETTER OF INTENT TO PERFORM AS AN SBE-M/WBE SUBCONTRACTOR**

This document must be completed by the SBE-M/WBE Subcontractor and submitted with bid packet. Specify in detail, the particular work items to be performed and the dollar amount and/or percentage for each work item. SBE credit will only be given for items which the SBE-M/WBE Subcontractor is SBE certified to perform. Failure to properly complete Schedule 2 may result in your SBE participation not being counted.

PROJECT NUMBER: 2014514 PROJECT NAME: Florida Mango Road over LWDD L-6 Canal Bridge Replacement

TO: Alan Gerwig & Associates, Inc.
(Name of Prime Bidder)

The undersigned is certified by Palm Beach County as a - (check one or more, as applicable):

Small Business Enterprise Minority Business Enterprise

Black Hispanic Women Caucasian Other (Please Specify)

Date of Palm Beach County Certification: ~~JUNE 2005~~ ^{yo} March 13, 2012 - March 12, 2015

The undersigned is prepared to perform the following described work in connection with the above project. Additional Sheets May Be Used As Necessary

Line Item/ Lot No. Item Description	Qty/Units	Unit Price	Total Price/ Percentage
<u>SURVEY</u>	<u>1</u>	<u>16229.48</u>	<u>14.08%</u>
_____	_____	_____	_____
_____	_____	_____	_____
_____	_____	_____	_____
_____	_____	_____	_____
_____	_____	_____	_____

at the following price or percentage
14.08%
 (Subcontractor's quote)

and will enter into a formal agreement for work with you conditioned upon your execution of a contract with Palm Beach County.

If undersigned intends to subcontract any portion of this job to a certified SBE or a non-SBE subcontractor, please list the name of the subcontractor and the amount below.

Price and/or Percentage ~~14.08%~~ ^{yo} ~~HSQ GROUP INC.~~

 (Name of Subcontractor)

The Prime affirms that it will monitor the SBE's listed to ensure the SBE's perform the work with its own forces. The undersigned subcontractor affirms that it has the resources necessary to perform the work listed without subcontracting to non-certified SBE or any other certified SBE subcontractors except as noted above.

The undersigned subcontractor understands that the provision of this form to Prime Bidder does not prevent Subcontractor from providing quotations to other bidders.

Alan Gerwig & Associates, Inc.
 Print name of Prime Contractor
 By: _____
 Signature
Alan Gerwig, Pres.
 Print name/title of person executing on behalf
 Prime Contractor

HSQ Group, Inc.
 Print name of SBE-M/WBE Subcontractor
 By: _____
 Signature
NOUR SHEHADEH, PE/VICE PRESIDENT
 Print name/title of person executing on behalf
 of SBE/M/WBE Subcontractor

Revised 10/11/2011

Date: May - 6 - 14

**CERTIFICATE OF LIABILITY INSURANCE**DATE (MM/DD/YYYY)
12/5/2013

THIS CERTIFICATE IS ISSUED AS A MATTER OF INFORMATION ONLY AND CONFERS NO RIGHTS UPON THE CERTIFICATE HOLDER. THIS CERTIFICATE DOES NOT AFFIRMATIVELY OR NEGATIVELY AMEND, EXTEND OR ALTER THE COVERAGE AFFORDED BY THE POLICIES BELOW. THIS CERTIFICATE OF INSURANCE DOES NOT CONSTITUTE A CONTRACT BETWEEN THE ISSUING INSURER(S), AUTHORIZED REPRESENTATIVE OR PRODUCER, AND THE CERTIFICATE HOLDER.

IMPORTANT: If the certificate holder is an ADDITIONAL INSURED, the policy(ies) must be endorsed. If SUBROGATION IS WAIVED, subject to the terms and conditions of the policy, certain policies may require an endorsement. A statement on this certificate does not confer rights to the certificate holder in lieu of such endorsement(s).

PRODUCER Collinsworth, Alter, Fowler & French, LLC 8000 Governors Square Blvd Suite 301 Miami Lakes, FL 33016	CONTACT NAME: Zoraida Gonzalez	
	PHONE (A/C, No, Ext): (305) 822-7800 FAX (A/C, No): (305) 362-2443 E-MAIL ADDRESS: zgonzalez@cafflic.com	
INSURED Alan Gerwig & Assoc. Inc. 12798 W. Forest Hill Blvd. Ste. 204 Wellington, FL 33414	INSURER(S) AFFORDING COVERAGE	NAIC #
	INSURER A: Hartford Casualty	
	INSURER B: First Mercury Ins. Company	10657
	INSURER C:	
	INSURER D:	
	INSURER E:	

COVERAGES**CERTIFICATE NUMBER:****REVISION NUMBER:**

THIS IS TO CERTIFY THAT THE POLICIES OF INSURANCE LISTED BELOW HAVE BEEN ISSUED TO THE INSURED NAMED ABOVE FOR THE POLICY PERIOD INDICATED. NOTWITHSTANDING ANY REQUIREMENT, TERM OR CONDITION OF ANY CONTRACT OR OTHER DOCUMENT WITH RESPECT TO WHICH THIS CERTIFICATE MAY BE ISSUED OR MAY PERTAIN, THE INSURANCE AFFORDED BY THE POLICIES DESCRIBED HEREIN IS SUBJECT TO ALL THE TERMS, EXCLUSIONS AND CONDITIONS OF SUCH POLICIES. LIMITS SHOWN MAY HAVE BEEN REDUCED BY PAID CLAIMS.

INSR LTR	TYPE OF INSURANCE	ADDL SUBR INSR WVD	POLICY NUMBER	POLICY EFF (MM/DD/YYYY)	POLICY EXP (MM/DD/YYYY)	LIMITS
A	<input checked="" type="checkbox"/> GENERAL LIABILITY <input checked="" type="checkbox"/> COMMERCIAL GENERAL LIABILITY <input type="checkbox"/> CLAIMS-MADE <input checked="" type="checkbox"/> OCCUR GEN'L AGGREGATE LIMIT APPLIES PER: <input checked="" type="checkbox"/> POLICY <input type="checkbox"/> PRO-JECT <input type="checkbox"/> LOC	X	21SBARM9558	12/9/2013	12/9/2014	EACH OCCURRENCE \$ 1,000,000
						DAMAGE TO RENTED PREMISES (Ea occurrence) \$ 300,000
						MED EXP (Any one person) \$ 10,000
						PERSONAL & ADV INJURY \$ 1,000,000
						GENERAL AGGREGATE \$ 2,000,000
						PRODUCTS - COMP/OP AGG \$ 2,000,000
						\$
A	<input type="checkbox"/> AUTOMOBILE LIABILITY <input type="checkbox"/> ANY AUTO ALL OWNED AUTOS <input checked="" type="checkbox"/> HIRED AUTOS <input checked="" type="checkbox"/> SCHEDULED AUTOS NON-OWNED AUTOS		21SBARM9558	12/9/2013	12/9/2014	COMBINED SINGLE LIMIT (Ea accident) \$ 1,000,000
						BODILY INJURY (Per person) \$
						BODILY INJURY (Per accident) \$
						PROPERTY DAMAGE (Per accident) \$
						\$
A	<input checked="" type="checkbox"/> UMBRELLA LIAB <input checked="" type="checkbox"/> OCCUR <input type="checkbox"/> EXCESS LIAB <input type="checkbox"/> CLAIMS-MADE DED <input checked="" type="checkbox"/> RETENTION \$ 10,000		21SBARM9558	12/9/2013	12/9/2014	EACH OCCURRENCE \$ 1,000,000
						AGGREGATE \$
						\$ 1,000,000
	<input type="checkbox"/> WORKERS COMPENSATION AND EMPLOYERS' LIABILITY ANY PROPRIETOR/PARTNER/EXECUTIVE OFFICER/MEMBER EXCLUDED? (Mandatory in NH) If yes, describe under DESCRIPTION OF OPERATIONS below	Y/N				<input type="checkbox"/> WC STATU-TORY LIMITS <input type="checkbox"/> OTH-ER
						E.L. EACH ACCIDENT \$
						E.L. DISEASE - EA EMPLOYEE \$
						E.L. DISEASE - POLICY LIMIT \$
B	Professional Liab.		FMFE101967	8/25/2013	8/25/2014	Each Claim 1,000,000
B	Claims-Made Basis		FMFE101967	8/25/2013	8/25/2014	Annual Aggregate 1,000,000

DESCRIPTION OF OPERATIONS / LOCATIONS / VEHICLES (Attach ACORD 101, Additional Remarks Schedule, if more space is required)
 Professional Liability Retroactive Date 08/25/1998; Professional Liability Deductible \$20,000 Each Claim

RE: Project Name - "FOR ALL PROJECTS WITH PALM BEACH COUNTY".

Palm Beach County Board of County Commissioners, a Political Subdivision of the State of Florida, its Officers, Employees, and Agents, shall be named Additional Insured as to General Liability.

CERTIFICATE HOLDER**CANCELLATION**

Palm Beach County Board of County Commissioners
 c/o Engineering & Public Works Operations
 2300 N. Jog Road
 West Palm Beach, FL 33411

SHOULD ANY OF THE ABOVE DESCRIBED POLICIES BE CANCELLED BEFORE THE EXPIRATION DATE THEREOF, NOTICE WILL BE DELIVERED IN ACCORDANCE WITH THE POLICY PROVISIONS.

AUTHORIZED REPRESENTATIVE

© 1988-2010 ACORD CORPORATION. All rights reserved.



CERTIFICATE OF LIABILITY INSURANCE

DATE (MM/DD/YYYY)
11/30/2013

THIS CERTIFICATE IS ISSUED AS A MATTER OF INFORMATION ONLY AND CONFERS NO RIGHTS UPON THE CERTIFICATE HOLDER. THIS CERTIFICATE DOES NOT AFFIRMATIVELY OR NEGATIVELY AMEND, EXTEND OR ALTER THE COVERAGE AFFORDED BY THE POLICIES BELOW. THIS CERTIFICATE OF INSURANCE DOES NOT CONSTITUTE A CONTRACT BETWEEN THE ISSUING INSURER(S), AUTHORIZED REPRESENTATIVE OR PRODUCER, AND THE CERTIFICATE HOLDER.

IMPORTANT: If the certificate holder is an ADDITIONAL INSURED, the policy(ies) must be endorsed. If SUBROGATION IS WAIVED, subject to the terms and conditions of the policy, certain policies may require an endorsement. A statement on this certificate does not confer rights to the certificate holder in lieu of such endorsement(s).

PRODUCER COMPUPAY INSURANCE SERVICES INC 250725 P: (877) 287-1316 F: (877) 287-1315 PO BOX 33015 SAN ANTONIO TX 78265	CONTACT NAME: PHONE (A/C, No, Ext): (877) 287-1316		FAX (A/C, No): (877) 287-1315
	E-MAIL ADDRESS:		
INSURED ALAN GERWIG & ASSOCIATES, INC 12798 FOREST HILL BLVD STE 201 WELLINGTON FL 33414	INSURER(S) AFFORDING COVERAGE		NAIC#
	INSURER A: Twin City Fire Ins Co		
	INSURER B:		
	INSURER C:		
	INSURER D:		
	INSURER E:		

COVERAGES	CERTIFICATE NUMBER:	REVISION NUMBER:
------------------	----------------------------	-------------------------

THIS IS TO CERTIFY THAT THE POLICIES OF INSURANCE LISTED BELOW HAVE BEEN ISSUED TO THE INSURED NAMED ABOVE FOR THE POLICY PERIOD INDICATED. NOTWITHSTANDING ANY REQUIREMENT, TERM OR CONDITION OF ANY CONTRACT OR OTHER DOCUMENT WITH RESPECT TO WHICH THIS CERTIFICATE MAY BE ISSUED OR MAY PERTAIN, THE INSURANCE AFFORDED BY THE POLICIES DESCRIBED HEREIN IS SUBJECT TO ALL THE TERMS, EXCLUSIONS AND CONDITIONS OF SUCH POLICIES. LIMITS SHOWN MAY HAVE BEEN REDUCED BY PAID CLAIMS.

INSR LTR	TYPE OF INSURANCE	ADDL INSR	SUBR WTD	POLICY NUMBER	POLICY EFF (MM/DD/YYYY)	POLICY EXP (MM/DD/YYYY)	LIMITS	
	GENERAL LIABILITY						EACH OCCURRENCE	\$
	<input type="checkbox"/> COMMERCIAL GENERAL LIABILITY						DAMAGE TO RENTED PREMISES (Ea occurrence)	\$
	<input type="checkbox"/> CLAIMS-MADE <input type="checkbox"/> OCCUR						MED EXP (Any one person)	\$
							PERSONAL & ADV INJURY	\$
							GENERAL AGGREGATE	\$
	GEN'L AGGREGATE LIMIT APPLIES PER:						PRODUCTS - COMP/OP AGG	\$
	<input type="checkbox"/> POLICY <input type="checkbox"/> PRO-JECT <input type="checkbox"/> LOC							\$
	AUTOMOBILE LIABILITY						COMBINED SINGLE LIMIT (Ea accident)	\$
	<input type="checkbox"/> ANY AUTO						BODILY INJURY (Per person)	\$
	<input type="checkbox"/> ALL OWNED AUTOS <input type="checkbox"/> SCHEDULED AUTOS						BODILY INJURY (Per accident)	\$
	<input type="checkbox"/> HIRED AUTOS <input type="checkbox"/> NON-OWNED AUTOS						PROPERTY DAMAGE (Per accident)	\$
								\$
	UMBRELLA LIAB						EACH OCCURRENCE	\$
	<input type="checkbox"/> OCCUR						AGGREGATE	\$
	EXCESS LIAB							\$
	<input type="checkbox"/> CLAIMS-MADE							\$
	DED RETENTION \$							\$
A	WORKERS COMPENSATION AND EMPLOYERS' LIABILITY						X WC STATUTORY LIMITS	OTHERS
	ANY PROPRIETOR/PARTNER/EXECUTIVE/IN OFFICER/MEMBER EXCLUDED? (Mandatory in NH) <input type="checkbox"/>	N/A		76 WBS ZX7495	12/09/2013	12/09/2014	E.L. EACH ACCIDENT	\$1,000,000
	If yes, describe under DESCRIPTION OF OPERATIONS below						E.L. DISEASE - EA EMPLOYEE	\$1,000,000
							E.L. DISEASE - POLICY LIMIT	\$1,000,000

DESCRIPTION OF OPERATIONS / LOCATIONS / VEHICLES (MAX Line Length is 79; Attach ACORD 101, Additional Remarks Schedule, if more space is required)

Those usual to the Insured's Operations. Project Name: FOR ALL PROJECTS WITH PALM BEACH COUNTY

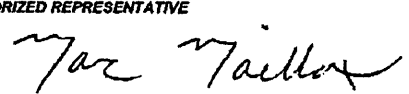
CERTIFICATE HOLDER Palm Beach Cty Bd of Cty Commissioners c/o Engineering & Public Works Dept Palm Beach County 2300 N JOG RD STE 3W-33 WEST PALM BEACH, FL 33411	CANCELLATION SHOULD ANY OF THE ABOVE DESCRIBED POLICIES BE CANCELLED BEFORE THE EXPIRATION DATE THEREOF, NOTICE WILL BE DELIVERED IN ACCORDANCE WITH THE POLICY PROVISIONS. AUTHORIZED REPRESENTATIVE 
---	--

12798 W. Forest Hill Boulevard
Suite 204
Wellington, FL 33414
Phone: (561) 792-9000
Fax: (561) 792-9901
www.aga-engineering.com
CA No. 7969

Alan Gerwig & Associates, Inc.
Consulting Engineers



REC'D JUL 27 2012

July 26, 2012

JaeAnn Dean, Consultant Contract Management Specialist
Roadway Production Division / CCNA Section
2300 N. Jog Road, Suite 3W-33
West Palm Beach, FL 33411-2745

RE: AGA Statement of No Corporately Owned Automobiles

Ms. Dean:

This letter is to declare that Alan Gerwig & Associates, Inc. does not own any automobiles.

Sincerely,

Alan Gerwig, P.E., LEED A.P.
President

Florida Mango Road over LWDD L-6 Canal Bridge Replacement

