

PALM BEACH COUNTY
BOARD OF COUNTY COMMISSIONERS
AGENDA ITEM SUMMARY

Meeting Date:	July 22, 2014	<input checked="" type="checkbox"/>	Consent	<input type="checkbox"/>	Regular
		<input type="checkbox"/>	Workshop	<input type="checkbox"/>	Public Hearing
Department:					
Submitted By:	Engineering & Public Works Department				
Submitted For:	Roadway Production Division				

I. EXECUTIVE BRIEF

Motion and Title: Staff recommends motion to approve: a task order to the annual agreement, R2013-0415, in the amount of \$133,690.25, with Simmons & White, Inc. (S&W), for professional services for the Church Street from Limestone Creek Road to west of Central Boulevard project (Project).

SUMMARY: Approval of this task order will provide the professional services necessary for the preparation of design plans and construction bid documents for the Project. The Small Business Enterprise (SBE) goal for the Project is 15%. S&W has achieved 100% SBE participation for this Project. S&W is a Palm Beach County company and is a certified SBE.

District 1 (MRE)

Background and Justification: On April 16, 2013, the Board of County Commissioners (Board) approved an annual agreement, R2013-0415, with S&W to provide professional services required for Palm Beach Countywide (County) civil engineering projects. The County now desires S&W to prepare design plans and construction bid documents for the Project, as detailed in Exhibit "A" of the attached task order. The fee, as detailed in Exhibit "A" of the attached task order, has been negotiated as just and reasonable compensation as follows:

Basic Services (Lump Sum)	\$ 83,910.00	(Roadway Plans, Drainage, Utilities, Environmental Permits, Signing and Pavement Marking Plans).
Reimbursable Expenses (Not to Exceed)...	\$ 25,910.25	(Survey, Geotechnical, Permit Fees and Reprographics).
Optional Services (Not to Exceed).....	\$ 23,870.00	(Post Design Services, Easements).
Total:	\$133,690.25	

After reviewing the attached task order and finding it in proper order, staff recommends the Board's approval.

Attachments:

1. Location Sketch
2. Task Order with Exhibits "A", "B", "C" and "D" and Certificate of Insurance (2)
3. Project Work Schedule

=====

Recommended by: [Signature] 6/6/14
Division Director Date

Approved By: [Signature] 7/1/14
County Engineer Date

II. FISCAL IMPACT ANALYSIS

A. Five Year Summary of Fiscal Impact:

Fiscal Years	2014	2015	2016	2017	2018
Capital Expenditures	<u>\$187,171</u>	<u>-0-</u>	<u>-0-</u>	<u>-0-</u>	<u>-0-</u>
Operating Costs	<u>-0-</u>	<u>-0-</u>	<u>-0-</u>	<u>-0-</u>	<u>-0-</u>
External Revenues	<u>-0-</u>	<u>-0-</u>	<u>-0-</u>	<u>-0-</u>	<u>-0-</u>
Program Income (County)	<u>-0-</u>	<u>-0-</u>	<u>-0-</u>	<u>-0-</u>	<u>-0-</u>
In-Kind Match (County)	<u>-0-</u>	<u>-0-</u>	<u>-0-</u>	<u>-0-</u>	<u>-0-</u>
NET FISCAL IMPACT	<u>\$187,171</u>	<u>-0-</u>	<u>-0-</u>	<u>-0-</u>	<u>-0-</u>
# ADDITIONAL FTE					
POSITIONS (Cumulative)					

Is Item Included in Current Budget? Yes X No

Budget Account No:

Fund 3501 Dept 361 Unit 1443 Object 6505

Recommended Sources of Funds/Summary of Fiscal Impact:

Road Impact Fee Zone-1 Fund
Church St., Limestone Creek Rd to W. of Central Blvd.

New Task Authorization	
Basic Services	\$ 83,910.00
Reimbursables	\$ 25,910.25
Optional Services	\$ 23,870.00
Total Task Authorization	\$ 133,690.25
Staff Charges	
Roadway Production	\$ 26,740.00
Right of Way	\$ 6,685.00
Survey	\$ 6,685.00
Traffic	\$ 13,370.00
Fiscal Impact	\$ 187,170.25

C. Departmental Fiscal Review:

_____ *Alice Kovalainen*

III. REVIEW COMMENTS

A. OFMB Fiscal and/or Contract Dev. and Control Comments:

[Signature] 7/3/2014
OFMB *[Signature]* 7/2/14

[Signature] 7/8/14
Contract Dev. and Control
2-2-14 *[Signature]*

B. Approved as to Form and Legal Sufficiency:

[Signature] 7/10/14
Assistant County Attorney

C. Other Department Review:

Department Director

This summary is not to be used as a basis for payment.

CHRUCH STREET
LIMESTONE CREEK ROAD TO W. OF CENTRAL BOULEVARD
PALM BEACH COUNTY PROJECT NO. 2014503

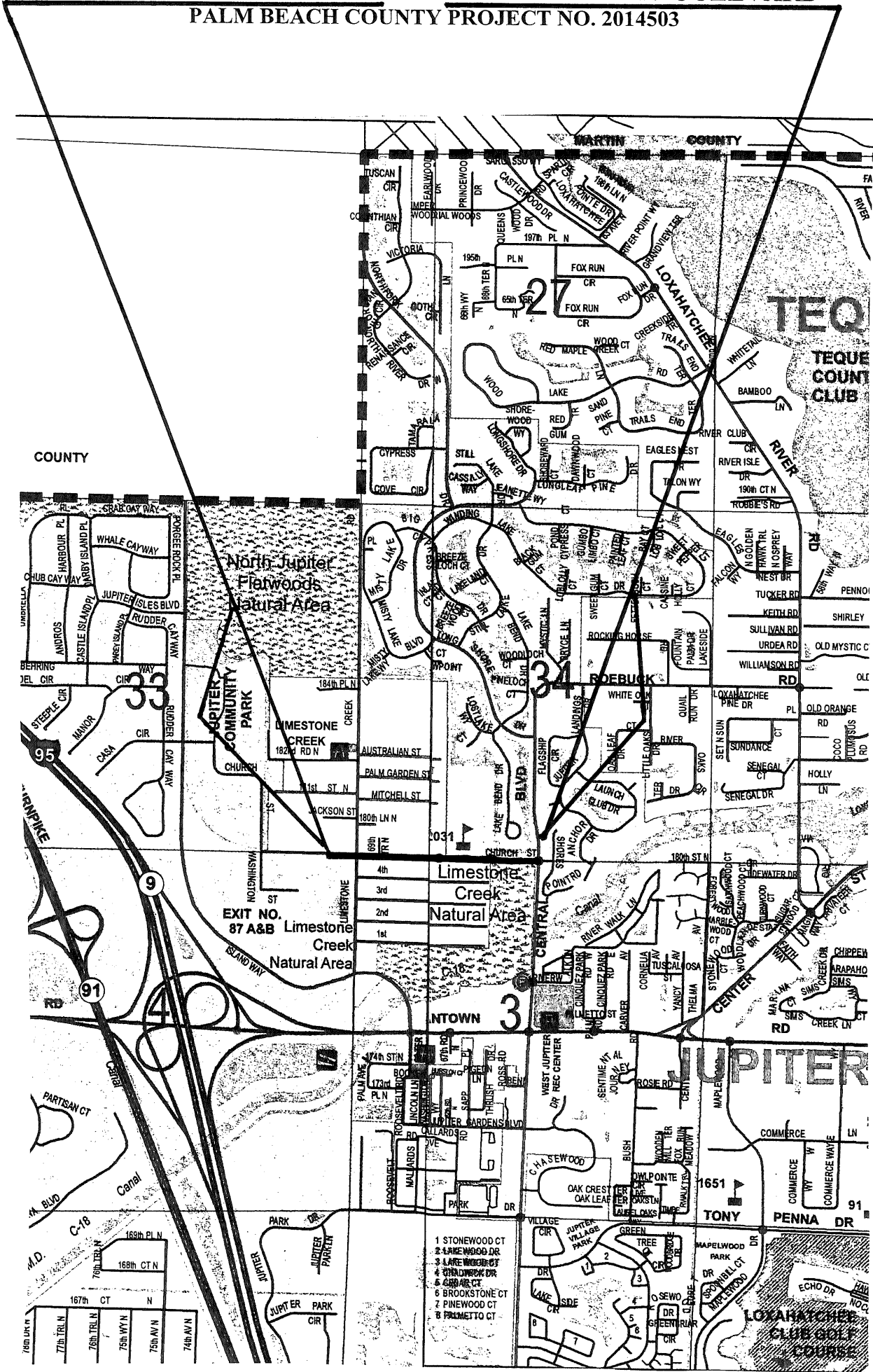

LOCATION SKETCH

ATTACHMENT 2

WORK TASK ORDER TO ANNUAL AGREEMENT BETWEEN

**PALM BEACH COUNTY
AND
SIMMONS & WHITE, INC.**

FOR PROFESSIONAL ENGINEERING SERVICES ON

**CHURCH STREET
LIMESTONE CREEK ROAD TO W. OF CENTRAL BOULEVARD**

**PROJECT NO.: 2014503
PALM BEACH COUNTY, FLORIDA**

THIS WORK TASK ORDER TO THE ANNUAL AGREEMENT, made and entered into this day of _____ 2014 by and between Palm Beach County, hereinafter called the **COUNTY**, and Simmons & White, Inc., a Florida Corporation with an address of 5601 Corporate Way, Suite 200, West Palm Beach, Florida 33407, hereinafter called the **CONSULTANT**.

W I T N E S S E T H

WHEREAS, the **COUNTY** and **CONSULTANT** entered into an Annual Agreement for civil engineering on a work task order basis on April 16, 2013 (R2013-0415).

WHEREAS, the **COUNTY** desires the **CONSULTANT** to perform civil engineering services for Church Street from Limestone Creek Road to W. of Central Boulevard, Palm Beach County, Florida (hereinafter called the **PROJECT**); and,

WHEREAS, the **CONSULTANT** agrees to perform the civil engineering services required for preparing design plans and construction bid documents, including related documents for the **PROJECT**; and,

Re: Church Street from Limestone Creek Road to W. of Central Boulevard
Project No.: 2014503

WHEREAS, the following fee has been negotiated and found to be reasonable compensation for these professional services to be performed by the **CONSULTANT**:

Basic Services in a lump sum fee of \$83,910.00;

Reimbursable Expenses capped at \$25,910.25;

Optional Services capped at \$23,870.00;

Totaling \$133,690.25

NOW, THEREFORE, THIS INDENTURE WITNESSETH: That for and in consideration of the mutual benefits to flow from each to the other, the parties hereto agree as follows:

1. The **CONSULTANT** agrees to provide professional services as described in Exhibit "A" of the Work Task Order known as "SCOPE OF WORK & FEE".
2. The **CONSULTANT** agrees to "CERTIFICATION" statements as described in Exhibit "B" of the Work Task Order.
3. The **CONSULTANT** agrees to Small Business Enterprise (SBE) Participation, described in Exhibit "C" of the Work Task Order.
4. The **CONSULTANT** has provided sub-consultants Letter of Intent to perform as an SBE as described in Exhibit "D" of the Work Task Order.
5. The **COUNTY** agrees to pay the **CONSULTANT** a fee of One Hundred Thirty-Three Thousand Six Hundred Ninety Dollars and Twenty-Five Cents (\$133,690.25).

Except as hereby amended, changed or modified, all other terms, conditions and obligations of the Agreement dated **April 16, 2013 (R2013-0415)**, shall remain in full force and effect.

Re: Church Street from Limestone Creek Road to W. of Central Boulevard
Project No.: 2014503

IN WITNESS WHEREOF, the parties hereto have made and executed this Work Task Order
as of the day and year first above written.

OWNER:

Palm Beach County, Florida, a
Political Subdivision of the
State of Florida

CONSULTANT:

Simmons & White, Inc.
a Florida Corporation

BOARD OF COUNTY COMMISSIONERS

BY: _____
Priscilla A. Taylor, Mayor

BY: _____
Robert F. Rennebaum, P.E.
President

ATTEST:
Sharon R. Bock, Clerk & Comptroller
Circuit Court

C O R P O R A T E S E A L

BY: _____
Deputy Clerk

WITNESS:

BY: _____

S E A L

Sandi Abernethy
(Printed Name)

APPROVED AS TO TERMS
AND CONDITIONS:

BY: _____

BY: _____

APPROVED AS TO FORM & LEGAL
SUFFICIENCY:

Jamie Allbritton
(Printed Name)

COUNTY ATTORNEY



Exhibit "A" – Page 1 of 25

*Scope - Fee okay
HPS 4/28/14*

March 7, 2014
Revised 03/28/2014
Revised 04/10/2014
Revised 04/23/2014

*OK to proceed
HPS 4/28/14*

Palm Beach County Roadway Production
2300 N. Jog Road
Floor 3W
West Palm Beach, Florida 33411

Attention: Ms. Kristine Frazell-Smith

Reference: Church Street
Palm Beach County Project #2014503

Dear Ms. Frazell-Smith:

We are pleased to submit the following proposal for professional services in connection with the surveying, design and permitting for the approximately 2000 LF of Church Street paving and drainage improvements. Plans will comply with Palm Beach County Thoroughfare Road Design Procedures, Manual of Uniform Minimum Standards for design, construction and maintenance for streets and highways (Florida Green Book), and the Florida Department of Transportation Roadway and Traffic Design Standards. Simmons & White, Inc., hereinafter referred to as the Consultant, proposes to furnish professional services for Palm Beach County, hereinafter referred to as the Client of the scope outlined below for the fees stipulated herein.

Scope of Services

The Consultant will perform the following:

1. Project Planning and Initial Construction Coordination:

1. Obtain available project data. Meet with Palm Beach County representatives for project coordination. Perform field review of project limits for existing conditions, visible utilities, and possible conflicts with proposed design. Coordinate with Surveyor for survey requirements.

Ms. Kristine Frazell-Smith
March 7, 2014 – Page 2
Revised 03/28/2014
Revised 04/10/2014
Revised 04/23/2014

Scope of Services (Continued)

2. Survey Requirements – Survey to include necessary data to produce construction plans for Church Street. Survey to include drainage as-builts on Church Street. Existing inverts for all utilities in right-of-way, curbing, sidewalk, edge of pavement for Church Street extending from the east entrance of Limestone Creek Elementary to Limestone Creek Road west right-of-way approximately \pm 2600 LF including turn lane on Limestone Creek Road for a right turn lane south approach. Survey for Church Street Construction Plans to include Finished Floor Elevations of existing homes along Church Street, existing grades from face of houses to edge of pavement, existing driveways including driveway cross sections, Church Street right-of-way, existing edge of pavement and center line, Church Street cross sections every 100', staking to be performed at a 100' interval and in accordance with the Design Standards Page 20 Phase IIE, existing utilities, mailboxes, vegetation in right-of-way and property lines. Topographic Survey to extend outside right-of-way 25'. Striping at the intersection of Limestone Creek Road and Church Street intersection, driveway connections to begin at the centerline of Church Street. Surveyor to write Legal Descriptions and Sketches for each lot 10' temporary construction easement as an option if needed.

II. Submittal Phases:

1. Phase I:
 - a. Initial Utility Contact Plans (35% Plans) – Plan to include the approved Typical Section with aerial, centerline, proposed right-of-way and intersecting street names.
 - b. 35% Submittal – Will include:
 1. Title Sheet
 2. Approved Typical Section
 3. Preliminary Drainage Map at 1" = 200'
 4. Preliminary Geometrics
 5. Benchmarks, Reference Points and Sectional Corners
 6. Right-of-Way Lines, Baseline of Survey and Centerline of Construction

Ms. Kristine Frazell-Smith
March 7, 2014 – Page 3
Revised 03/28/2014
Revised 04/10/2014
Revised 04/23/2014

Scope of Services (Continued)

7. Preliminary Drainage Design
8. Preliminary Profile Grade Lines (existing and proposed)
9. Existing Drainage
10. Back of Sidewalk Profiles (if applicable)
11. Existing Cross Sections
12. List of Required Permits
13. Engineer's Cost Estimate

2. Phase II:

- a. Utility Pothole Coordination Plans (65% Plans) – Plan to include existing utilities and proposed drainage and an initial utility conflict matrix.

A request for a potholing meeting and a set of Pothole Coordination Plans to be submitted to Palm Beach County Utility Coordinator.

- b. First Utility Coordination (Pothole) Meeting – Attend meeting to set pot holing and survey date. Surveyor to mark either the centerline of construction on baseline of survey by painting station call-outs at 100' intervals.
- c. Pothole Underground Utilities at Possible Conflict Points – Surveyor to survey potholed utilities.
- d. 65% Submittal – Will include:
 1. Phase I Comments Addressed
 2. Summary of Quantities (items only)
 3. Drainage Design Computations
 4. Drainage Map
 5. Proposed Drainage in Plan
 6. Final Geometrics
 7. Final Profiles
 8. Limits of Construction

Ms. Kristine Frazell-Smith
March 7, 2014 – Page 4
Revised 03/28/2014
Revised 04/10/2014
Revised 04/23/2014

Scope of Services (Continued)

9. Proposed Cross Sections
 10. Existing Utilities
 11. Driveway Profile Sheets (existing and proposed)
 12. Special Detail Sheets
 13. Preliminary Signing and Pavement Marking Plans
 14. Engineer's Cost Estimate
- e. Stake Proposed Right-of-Way – Surveyor to stake proposed right-of-way.
- f. Field review of proposed right-of-way easements, restorations, etc.
- g. Permit Packages – Includes the application for all applicable permits. Permitting to include the South Florida Water Management District (SFWMD) and Northern Palm Beach County Improvement District.

NPDES permitting and Palm Beach County Environmental Resource Management (ERM) permits are not anticipated or included.

3. Phase III:
- a. Utility Conflict Resolution Plans and Meetings – Utility coordination prior to the 96% submittal plans shall be done in accordance with Appendix A of the Palm Beach County Thoroughfare Roadway Design Procedures.
 - b. 96% Submittal – Will include:
 1. Phase II Comments Addressed
 2. Summary of Quantities Sheet
 3. Utilities on the Plan and Profile
 4. Drainage on Drainage Map, Plan and Profile Sheets
 5. Signing and Pavement Marking Plans
 6. Drainage Structure Sheets
 7. Special Detail Sheets

Ms. Kristine Frazell-Smith
March 7, 2014 – Page 5
Revised 03/28/2014
Revised 04/10/2014
Revised 04/23/2014

Scope of Services (Continued)

8. Cross Sections
9. Quantity Computation Book
10. Engineers Cost Estimate

4. Phase IV:

- a. Final Utility Coordination Meeting – Coordination to take place prior to 100% plan submittal.

Coordination to be done in accordance with the Palm Beach County Thoroughfare Road Design Procedures.

- b. 100% Submittal – Will include:

1. Phase III Comments Addressed
2. All Permits Received

- c. Final Submittal

1. One complete set of signed and sealed plans (11" x 17")
2. Complete set of plans unbound (11" x 17")
3. Final Cost Estimate
4. Electronic copy of the pay items
5. One signed and sealed package computation book
6. One signed and sealed quantity computation book
7. All electronic files
8. All permits required for the project

III. Reimbursables:

1. Printing – The cost of printing will be billed to the County as shown on the fee proposal. AutoCAD files will be provided with the final submittal.
2. Permit fees will be billed to the County per the governing agency fee schedule.

Ms. Kristine Frazell-Smith
March 7, 2014 – Page 6
Revised 03/28/2014
Revised 04/10/2014
Revised 04/23/2014

Scope of Services (Continued)

IV. Optional Services:

We have allocated 40 hours of Post Design Services to address pre-bid meeting attendance, RFI's, shop drawing review, pre-construction meeting attendance and other services as requested by Palm Beach County.

V. Project Limitation & Assumptions:

1. Survey Work will be subcontracted to Brown & Phillips, Inc.
2. Geotechnical Engineering will be subcontracted to Tierra South Florida, Inc.
3. Plan submittals (5 sets of 11 x 17" plans (not bound) and a PDF version) will be prepared and submitted at the Typical Section 35%, 65%, 96% and 100% stages for Palm Beach County review and approval. The Final Plan deliverable will include one (1) set of 11" x 17" signed and sealed prints, three (3) sets of 11 x 17" unsigned prints (for reproduction and file purposes) and two (2) CD-R with PDF versions of the plans and associated AutoCAD files.
4. Stormwater design will be based on the drainage outfall to Limestone Creek Road. Exfiltration trench may be used for water quality.
5. Details sufficient to construct the project will be referenced or provided on the plans. Therefore, preparation of technical specifications is not included in this Scope of Services.
6. Church Street roadway to drain to Limestone Creek Road. Design section to be three-lanes with east and westbound lanes to be 11' wide, center lane to be 12', 3' shoulders, 2' curb, 2.5' for grass and 5' wide sidewalk.

Ms. Kristine Frazell-Smith
March 7, 2014 – Page 7
Revised 03/28/2014
Revised 04/10/2014
Revised 04/23/2014

Scope of Services (Continued)

7. Limestone Creek is included in the Prime Consultant work effort and cost sheets. Right turn lane to be standard County right turn lane.
8. Bidding and construction observation services are not included in this Scope of Services Post Design Phase Optional Services are provided and are available by Palm Beach County as needed.
9. Sanitary sewer and potable water permitting and design are not included in this proposal.

Please contact our office with any questions.

Sincerely,

SIMMONS & WHITE, INC.

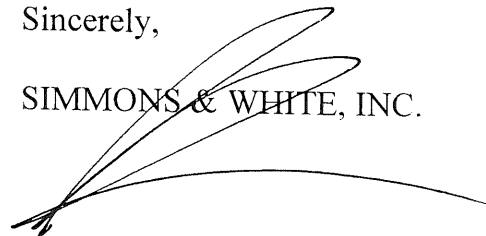
A handwritten signature in black ink, appearing to read 'Robert F. Rennebaum', is written over the company name.

Robert F. Rennebaum, P.E.
President

Enclosures

ESTIMATE OF WORK EFFORT AND COST - PRIME CONSULTANT

Name of Project:
County:
FPN:
FAP No.:

Church Street
Palm Beach
2014503

Simmons and White

5/22/2014
ERC

Staff Classification	Hours From "SH Summary - Firm"	Chief Engineer	Senior Engineer	Senior UT Coordinator/Engineer	Senior Designer	SH By Activity	Salary Cost By Activity	Average Rate Per Task
Phase: 35%, 65%, 96%, 100%, and Final Plans		✓ \$160.00	✓ \$135.00	✓ \$100.00	✓ \$90.00			
4. Roadway Analysis	272	12	136	8	116	✓ 272	\$31,520.00	\$115.88
5. Roadway Plans	171	4	22	0	145	✓ 171	\$16,660.00	\$97.43
6. Drainage Analysis	172	2	75	0	95	✓ 172	\$18,995.00	\$110.44
7. Utilities	35	1	2	22	10	✓ 35	\$3,530.00	\$100.86
8. Environmental Permits, Compliance & Clearances	36	3	13	0	20	✓ 36	\$4,035.00	\$112.08
19. Signing & Pavement Marking Analysis	36	3	20	0	13	✓ 36	\$4,350.00	\$120.83
20. Signing & Pavement Marking Plans	46	2	12	0	32	✓ 46	\$4,820.00	\$104.78
Total Phase	✓ 768	✓ 27	✓ 280	✓ 30	✓ 431	✓ 768	✓ \$83,910.00	\$109.26
Total Staff Cost		✓ \$1,224.00	✓ \$37,800.00	✓ \$3,000.00	✓ \$35,790.00	✓	✓ \$83,910.00	\$109.26

Check = \$0.00

SALARY RELATED COSTS: \$83,910.00

SUBTOTAL ESTIMATED FEE: ✓ \$83,910.00

Expenses: permit fees and prints ✓ \$5,916.25

Subconsultant: Brown and Phillips ✓ \$14,674.00

Subconsultant: Tierra South Florida ✓ \$5,320.00

Subconsultant Estimated Fee \$25,910.25

SUBTOTAL ESTIMATED FEE: \$109,820.25

Brown and Phillips Easments \$18,450.00

Simmons and White Post Design Services \$5,420.00

SUBTOTAL OPTIONAL SERVICES \$23,870.00

GRAND TOTAL ESTIMATED FEE: \$133,690.25

- 30 minutes

Project Activity 4: Roadway Analysis

Estimator: ERC

Church Street
2014503

Task No.	Task	Units	No of Units	Hours/ Unit	Total Hours	Comments
4.1	Cross Sections	LS	22	2	44	Cross sections
4.3	Access management	LS	1	36	36	Safe Recovery, Sight Distances
4.4	Horizontal/Vertical Master Design Files	LS	1	100	100	
4.10	Computation Book & Quantities	LS	1	24	24	
4.11	Cost Estimate	LS	4	16	64	
Roadway Analysis Technical Subtotal					268	
4.15	Technical Meetings	LS	2	2	4	PBC
Roadway Analysis Nontechnical Subtotal					4	
4. Roadway Analysis Total					272	

Project Activity 5: Roadway Plans

Estimator:ERC

Church Street
2104503

Task No.	Task	Scale	Units	No. of Units	Hours/ Unit	No. of Sheets	Total Hours	Comments
5.1	Key Sheet		Sheet	1	8	1	8	
5.2	Summary of Pay Items Including Quantity Input		Sheet	1	12	1	12	
5.3	Drainage Map		Sheet	1	8	1	8	
5.6	General Notes/Pay Item Notes		Sheet	1	8	1	8	
5.7	Summary of Quantities		Sheet	1	8	1	8	
5.13	Plan/Profile Sheet		Sheet	4	8	4	32	
5.20	Intersection Layout Details		Sheet	30	1	30	30	Driveways Sections
5.21	Miscellaneous Detail Sheets		Sheet	2	4	1	8	
5.22	Drainage Structure Sheet (Per Structure)		EA	14	1	1	14	
5.23	Miscellaneous Drainage Detail Sheets		Sheet	1	8	1	8	
5.30	Cross Sections		EA	23	1	1	23	Cross Sections
5.36	Erosion Control Plan		Sheet	2	4	2	8	
5.37	SWPPP		Sheet	2	2	2	4	
5. Roadway Plans Total						47	171	

Project Activity 6: Drainage Analysis

Estimator:ERC

Church Street
2014503

Task No.	Task	Units	No of Units	Hours/ Unit	Total Hours	Comments
6.3	Design of Cross Drains	EA	32	2	64	
6.4	Design of Roadway Ditches	Per Ditch Mile	1	24	24	
6.5	Design of Outfalls	EA	1	40	40	
6.9	Design of Storm Drains	EA	14	2	28	
6.13	Drainage Design Documentation Report	LS	1	16	16	
Drainage Analysis Technical Subtotal					172	
6. Drainage Analysis Total					172	

Project Activity 7: Utilities

Estimator:ERC

Church Street
2014503

Task No.	Task	Units	No of Units	Hours/ Unit	Total Hours	Comments
7.2	Identify Existing UAO(s)	LS	1	12	12	
7.5	Preliminary Utility Meeting	LS	1	3	3	Kickoff meeting with PBC
7.7	Collect and Review Plans and Data from UAO(s)	LS	1	20	20	
7. Utilities Total					✓ 35	

Project Activity 8: Environmental Permits, Compliance and Clearances

Estimator:ERC

Church Street
2014503

Task No	Task	Units	No. of Units	Hours/ Units	Total Hours	Comments
8.1	Preliminary Project Research	LS	1	16	16	
8.5	Complete And Submit All Required Permit Applications	LS	1	16	16	SFWMD Permits
Environmental Permits, Compliance and Clearances Technical Subtotal					32	
8.16	Technical Meetings	LS	2	2	4	SFWMD, PBC
Environmental Permits, Compliance and Clearances Nontechnical Subtotal					4	
8 Environmental Permits, Compliance and Clearances Total					36	

Project Activity 19: Signing and Pavement Marking Analysis

Estimator:ERC

Church Street
2014503

Task No.	Task	Units	No. of Units	Hours/ Units	Total Hours	Comments
19.3	Reference and Master Design File	LS	1	24	24	
19.7	Quantities	LS	1	12	12	
Signing and Pavement Marking Analysis Technical Subtotal					36	
19. Signing and Pavement Marking Analysis Subtotal					36	

Project Activity 20: Signing and Pavement Marking Plans

Estimator:ERC

Church Street
2014503

Task No.	Task	Scale	Units	No of Units	Hours/ Unit	No. of Sheets	Total Hours	Comments
20.3	Tabulation of Quantities		Sheet	1	10	1	10	
20.4	General Notes/Pay Item Notes		Sheet	1	12	1	12	
20.6	Plan Sheet		Sheet	1	24	1	24	
Signing and Pavement Marking Plans Technical Subtotal						3	46	
20. Signing and Pavement Marking Plans Total						3	46	

POST DESIGN SERVICES

Name of Project:
County:
FPN:
FAP No.:

Church Street 2014503
Palm Beach

Consultant Name: Simmons and White
Consultant No.:
Date: 4/11/2014
Estimator: ERC

Staff Classification	Total Staff Hours From	Chief Engineer	Senior Engineer	Senior UT Cordinat	Senior Designe r	SH By Activity	Salary Cost By Activity	Average Rate Per Task
		✓ \$160.00	✓ \$135.00	✓ \$100.00	✓ \$90.00			
Post Design Services	40	12	20	8	0	40	\$5,420	\$135.50
Total Staff Hours	✓ 40	✓ 12	✓ 20	8	0	✓ 40		
Total Staff Cost		✓ \$1,920.00	\$2,700.00	✓ \$800.00	\$0.00		✓ \$5,420.00	\$135.50

Check = \$5,420.00

\$5,420.00

✓ \$5,420.00

✓ 3.0 x 180.00 = 540.00

Reimbursables

Estimator:ERC

Church Street 2014503

Task No.	Task	Scale	Units	No. of Units	Sets	\$/Sheet	Total Costs	Comments
1	Prints for SFWMD	11"x17"	Sheet	15	4	\$ ✓ 0.75	\$ ✓ 45.00	4 sets of 10 sheets
2	SFWMD Permit Fee		EA	1	1	\$ 3,500.00	\$ 3,500.00	Permit fee for SFWMD Permit
3.0	NPBCID Permit Fee		EA	1		\$ 2,000.00	\$ 2,000.00	Actual fee is based on engineering cost for review
3a	NPBCID Prints	11"x17"	Sheet	15	3	\$ ✓ 0.75	\$ ✓ 33.75	
3a	Prints for Palm Beach County	11"x17"	Sheet	15	30	\$ ✓ 0.75	\$ ✓ 337.50	5 sets of 10 sheets for 5 submittals
Reimbursable Costs							\$ 5,916.25	

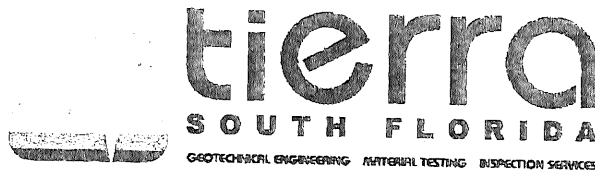

March 5, 2014

Simmons and White
5601 Corporate Way, Suite 200
West Palm Beach, FL 33407

Attn: Mr. Erik Cooper, P.E.
Project Manager

**Subject: Geotechnical Study
Church Street Improvement
Jupiter, Florida
TSF Proposal No. 1403-132**

Dear Erik:

In accordance with your request, **TIERRA SOUTH FLORIDA, Inc.** is pleased to submit the following proposal for the performance of a Geotechnical Study for the proposed improvements for Church Street in Jupiter, Florida. Presented hereafter are descriptions of the services to be undertaken, a schedule for execution of the work, and a cost estimate for the proposed services.

Site Information:

It is our understanding that drainage and roadway improvements are being proposed for Church Street. The improvement will include widening the existing street to 3 lanes.

Scope - Geotechnical Investigation:

The subsurface exploration will include the following scope of work:

- ☐ Sampling and testing of the subsurface materials, and observations of the groundwater conditions on the site;
- ☐ Identification of the physical and engineering characteristics of subsurface materials

- encountered during the sampling and testing;
- ☐ Borehole Permeability results; and
 - ☐ Pavement subgrade recommendations.

The subsurface exploration will consist of:

- Fourteen (14) auger borings to a depth of 10 feet below existing grade; and
- Four (4) Bore Hole Permeability (BHP) tests for the Master Plan

Borings will be approximately located in the field by our drilling personnel by measuring distances with a tape from known reference points.

The subsurface exploration will include laboratory testing of the samples obtained to evaluate the classification, and other characteristics of the subsurface materials. The results of the BHP tests, subsurface exploration, including our pavement subgrade recommendations and the data on which they are based, will be presented in a written report prepared by a professional engineer.

Cost - Geotechnical Investigation:

It is proposed that the fee for the performance of the above services as per "Testing Lab Annual Services Agreement on a Task Order Basis" will be **\$5,320** and that the work be performed in accordance with the owner and consultant agreement. The estimated cost will not be exceeded without prior authorization from the client. The fee breakdown sheet is attached.

Prior to drilling at the project site, TSF will notify and coordinate with the local utility companies and request that underground utilities be marked.

Our proposed cost covers the work needed to present our findings in a report form, assuming the site is accessible with a truck rig with no clearing requirements. Not included are reviews of foundation and pavement drawings, preparation of construction specifications, special conferences, and any other services not specifically related to this proposal.

SCHEDULE AND AUTHORIZATION

TSF will proceed with the work after receipt of a signed copy of this proposal. With our present drilling schedule, we can commence work immediately after project approval (weather permitting) and the fieldwork will take about 1 to 2 days to complete. The report can be submitted within two weeks after completion of the field exploration.

TSF appreciates this opportunity to be of service to you on this important project. Please feel free to contact us to answer any questions you may have concerning this proposal.

Respectfully submitted,

TIERRA SOUTH FLORIDA, INC.

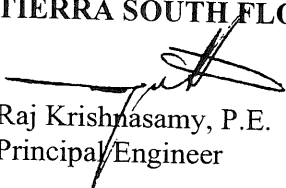
Raj Krishnasamy, P.E.
Principal Engineer

Attachments: Attachment 1 – Fee Breakdown

AUTHORIZED BY:	INVOICE TO:
Firm:	Firm:
Name:	Name:
Title:	Address:
Date:	Phone #:
	Fax #:

ATTACHMENT 1 - FEE BREAKDOWN
CHURCH STREET
JUPITER, FLORIDA

I. <u>Field Exploration</u>		
A.	Mobilization, 1 Truck Rig @ \$350.00/each	✓ \$ 350.00
B.	Boring Layout/Utility Clearance Estimate 6 hours @ \$65.00/hr	✓ 390.00
C.	Auger Borings, Estimate 140 feet @ \$9.00/ft	✓ 1,260.00
D.	Bore Hole Permeability (BHP) Estimate 4 @ \$275/test	✓ 1,100.00
	Subtotal – Field Exploration:	✓ \$3,100.00
II. <u>Laboratory Testing</u>		
A.	Visual Classification, 3 hours @ \$85.00/hr	✓ \$ 255.00
B.	Organic Contents test, 2 @ \$50/test	✓ 100.00
	Subtotal – Laboratory Testing:	✓ \$ 355.00
III. <u>Office Engineering, Evaluation and Reporting and Project Meeting</u>		
A.	Principal Engineer, P.E. Estimate 1 hour @ \$145.00/hour	✓ \$ 145.00
B.	Engineer, P.E. Estimate 4 hours @ \$115.00/hour	✓ 460.00
C.	Staff Engineer Estimate 12 Hours @ \$85.00/hour	✓ 1,020.00
D.	CADD, Estimate 4 hours @ \$60.00/hour	✓ 240.00
	Subtotal – Office Engineering, etc.:	✓ \$1,865.00
	PROJECT TOTAL:	✓ <u>\$5,320.00</u>

Q 45 2000 4 2001

BROWN & PHILLIPS, Inc.
PROFESSIONAL SURVEYING CORPORATION

May 16, 2014

Mr. Erik Cooper
Simmons & White
5601 Corporate Way, Suite 200
West Palm Beach, FL 33407

Re: Church Street and Limestone Creek Road in Jupiter - Roadway Design Survey

Dear Mr. Cooper:

Thank you for the opportunity to provide you with the following services for the subject site. This proposal is based on documentation and information provided by your office. We will review any title work supplied by you. The scope of services is as follows:

SCOPE OF SERVICES

I. HORIZONTAL PROJECT NETWORK CONTROL

Using the information supplied by Palm Beach County, we will establish the Right-of-Way for Church Street and Limestone Creek Road. A traverse will be run through the route and all found monumentation will be tied in. The survey will be oriented to Palm Beach County horizontal control (NAD 83/90 Adjustment). We will obtain the sectional and geodetic control information from the Palm Beach County Survey Department. The limits of the survey are shown on Attachment "B".

II. VERTICAL PROJECT NETWORK CONTROL

A level run will be performed along the route using the existing Palm Beach County benchmarks (NAVD 1988). Benchmarks will be set along the route, not exceeding 600 feet apart, so that we will have at least one benchmark per plan sheet. All benchmarks will be set outside of the proposed right of way.

III. BASELINE LAYOUT

We will lay out the baseline at 100-foot intervals, staking to be performed at a 100' interval and in accordance with the Design Standards Page 20 Phase IIE, setting appropriate points at each station. The baseline will be laid out within the limits of the 2600'± route. These baseline points will be used in the topographic and cross section phase to locate features and facilitate checks.

IV. REFERENCE POINTS

We will reference the baseline at intervals not exceeding 1400 feet along the route and in accordance with the Design Standards Page 10, e4, referencing all existing monumentation to be reset after construction. These points will be used to replace disturbed baseline stations. We propose to set three (3) references to meet the pre-construction requirement and so that the post-construction monuments can be reset by the contractor's surveyor.

V. SECTION TIES AND PROPERTY TIES

We will tie in section corners and property corners along the route to check the present alignment of Church Street and Limestone Creek Road. We will try to locate as many corners as possible to positively establish the current right of ways.

1860 Old Okeechobee Road • Suite 509 • West Palm Beach, Florida 33409
(561) 615-3488 • Fax (561) 615-3991

ALL PROPOSALS BY COMPANY SIMMONS & WHITE Church Street and Limestone Creek Road in Jupiter Roadway Design Survey

Cooper
May 16, 2014
Page 2

VI. TOPOGRAPHY

A topographic survey will be performed along the route. This survey will tie in all visible features such as, but not limited to, signs, light poles, guardrails, trees, utilities, walks, edge of pavement, curbing, drainage structures, etc. We will also include driveways, finish floors, mailboxes, etc. These locations will show all features within the corridor from right of way to right of way extending to 25 feet outside the proposed right of way (if provided prior to start of the field work).

VII. CROSS SECTIONS

Cross sections will be done along the route at 100-foot intervals. These cross sections will cover the roadway to the right of way lines and extend to 25 feet outside of the right of way (if provided prior to start of the field work).

VIII. ASBUILTS

We will attempt to get asbuilt information on all the pipes leading out of any storm or sanitary sewer structures found. We will show invert elevations, pipe sizes and materials for all pipes located including outfall pipes.

IX. OPTIONAL SERVICES: PARCEL SKETCHES AND LEGAL DESCRIPTIONS

We will prepare legal descriptions and sketches as an optional service, if needed, for 10 feet onto each property for temporary construction easements. These sketches will be based on record ownership data and record plats provided by Palm Beach County. All sketches will be consistent with the requirements of Palm Beach County and Florida Minimum Technical Standards. We have estimated forty-one (41) temporary construction easements at \$450.00 each for a total of \$18,450.00.

X. CLOSURE

A drawing will be produced which will show all the features located. We propose to provide Simmons and White, Inc. with an AutoCAD file in the version requested. Any additional work will be done on an hourly basis as approved by you. We will perform the scope of services for a lump sum fee of ~~\$14,674.00~~ (\$16,174.00 for survey less \$1,500.00 Persimmon credit) plus optional services (legal descriptions and sketches) in the amount of \$18,450.00 for a **total fee of \$33,124.00**. See Attachment 'A' for an hourly breakdown. Please do not hesitate to call me with any questions you might have regarding this proposal. We look forward to working with you on this project.

Brown & Phillips, Inc.

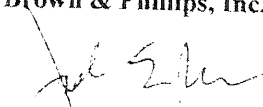
John H. Phillips III, P.L.S.
Principal

Attachment

JEP/mb

This Proposal accepted this ____ day of _____, 2014

By: _____
Simmons & White

Print Name: _____

Title: _____

ATTACHMENT 'A'

Church Street and Limestone Creek Road in Jupiter

Type of Survey: Roadway Design
 Size: 2600'±
 Date: May 16, 2014

TASK	3 MAN CREW	CADD TECH	SURVEY TECH	PLS	COMMENTS
Meetings and Coordination					
Horizontal Project Network Control	6		16	6	Establish control and right-of-way (41+ deeds)
Vertical Project Network Control	7		1		Set benchmarks along corridor
Baseline Layout	3		0.5		Layout baseline at 100' intervals
Reference Points	3		1		Set references
Section Ties	3		1		Tie in PBCo. Horizontal control
Subdivision & Property Ties	6		4	1	Tie in adjoining property corners
Topography	26		7	2	Locate all above ground features, lot of trees
Cross Sections	18		3		At 100' intervals to 25' outside R/W w/ FF of houses
Asbuilts	6		2		Asbuilt storm structures and lot of culverts
CADD Base Drawing		30	7	4	Prepare cadd drawing
Total Hours:	✓ 78	✓ 30	✓ 42.5	✓ 13	
Rate/Hour	✓\$125.00	✓\$66.00	✓\$70.00	✓\$113.00	
Subtotal:	✓\$9,750.00	✓\$1,980.00	✓\$2,975.00	✓\$1,469.00	
Total Labor Cost:					✓ \$16,174.00
Less Persimmon Credit:					✓ -\$1,500.00
Adjusted Labor Cost:					✓ \$14,674.00

Other Direct Costs:	quantity	unit	cost/unit	total
Legal Description & Sketch	41	each	✓ \$450.00	\$18,450.00 (Optional Services)
Prints		sheet	\$1.50	\$0.00
Shipping		cost x markup	1.20	\$0.00
Other				\$0.00
Total Other Direct Costs:				

2,711.11

14,674.00

✓ \$18,450.00

✓ \$33,124.00

TOTAL PRICE

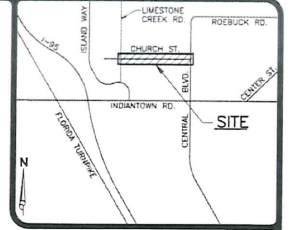
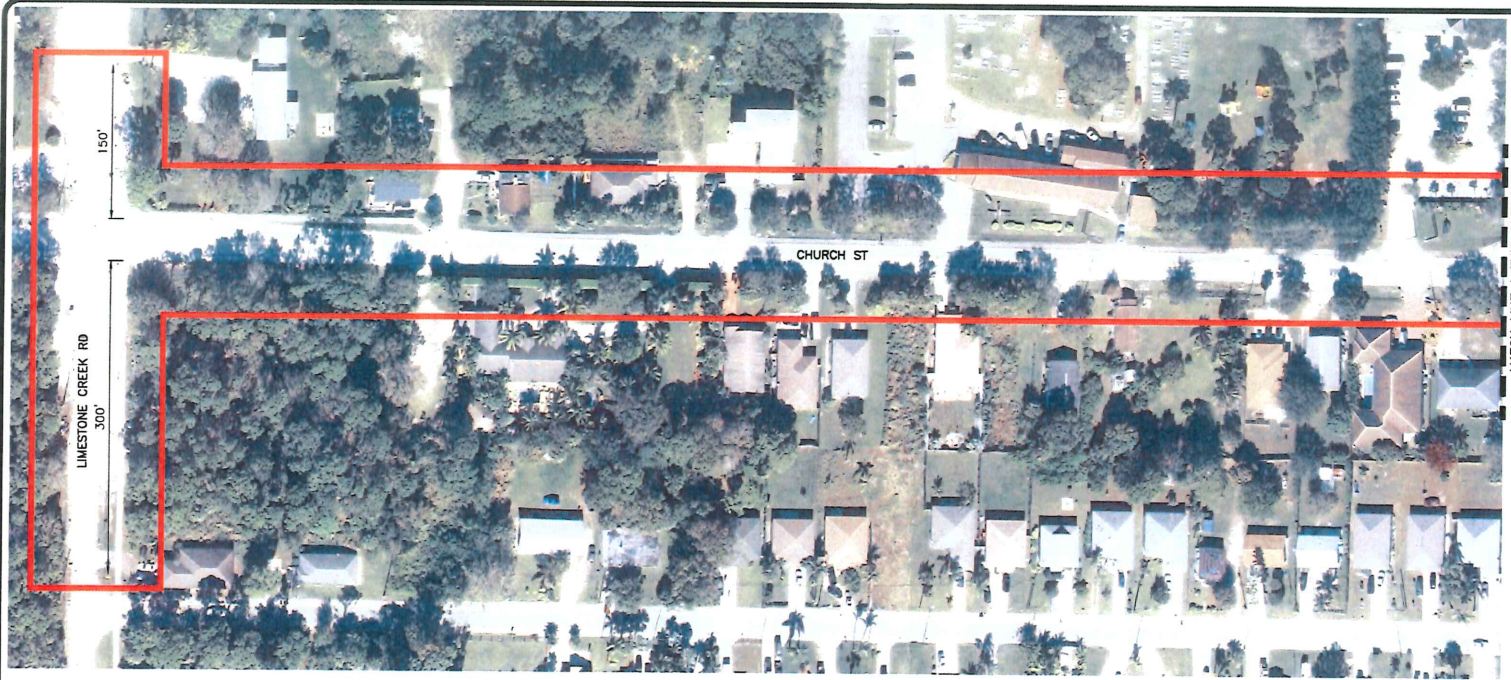

LOCATION MAP
NOT TO SCALE

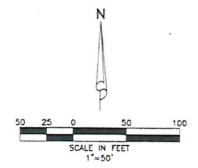

Attachment 'B'

CHURCH ST.
TOWN OF JUPITER, FLORIDA
CHURCH ST. WIDENING EXHIBIT



DESIGN: G.B. DRAWN: D.B. CHECKED: APPROVED: DATE:

REVISIONS

JOB NO. 14-002 DRAWING NO. 14002201 SHEET 1 OF 1

CERTIFICATION STATEMENTS

Exhibit "B" – Page 1 of 2

Project: Church Street from Limestone Creek Road to W. of Central Boulevard
Project No.: 2014503

Consultant/Annual Consultant Simmons & White, Inc.

TRUTH-IN-NEGOTIATION STATEMENT

By entering into this Agreement, the **CONSULTANT/ANNUAL CONSULTANT** certifies that the wage rates and costs used to determine the lump sum fees contained in herein are accurate, complete and current as of the date of this Agreement.

The said lump sum fees shall be adjusted to exclude any significant sums should the **COUNTY** determine that the lump sum fees were increased due to inaccurate, incomplete or non-current wage rates or due to inaccurate representations of fees paid to outside consultants.

The **COUNTY** shall exercise its right under this "Certificate" within one year following final payment.

PROHIBITION AGAINST CONTINGENT FEES STATEMENT

By entering into this Agreement the **CONSULTANT/ANNUAL CONSULTANT** warrants that they have not employed or retained any company or person other than a bonafide employee working solely for the **CONSULTANT/ANNUAL CONSULTANT** to solicit or secure this Agreement and that they have not paid or agreed to pay any person, company, corporation, individual or firm other than a bonafide employee working solely for the **CONSULTANT/ANNUAL CONSULTANT**, any fee, commission, percentage, gift or other consideration contingent upon or resulting from the award of making of this agreement.

PUBLIC ENTITY CRIMES STATEMENT

As provided in F.S. 287.132-133, by entering this Agreement or performing any work in furtherance hereof, the **CONSULTANT/ANNUAL CONSULTANT** certifies that it, its affiliates, suppliers, sub-contractors and consultants who will perform hereunder, have not been placed on the convicted vendor list maintained by the State of Florida Department of Management Services within the 36 months immediately preceding the date hereof. This notice is required by F.S. 287.133 (3) (a).

NON-DISCRIMINATION STATEMENT

The **CONSULTANT/ANNUAL CONSULTANT** warrants and represents that all of its employees are treated equally during employment without regard to race, color, religion, disability, sex, age, national origin, ancestry, marital status, familial status sexual orientation, gender identity and expression, or genetic information.

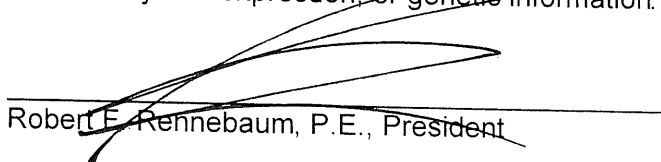
Robert E. Rennebaum, P.E., President

CONFLICT OF INTEREST DISCLOSURE FORM

Project: Church Street from Limestone Creek Road to W. of Central Boulevard
Project No.: 2014503

CONSULTANT/ANNUAL CONSULTANT represents that it presently has no interest, either direct or indirect, which would or could conflict in any manner with the performance of services for the County, except as follows:

(Attach additional sheets as needed.)

CONSULTANT/ANNUAL CONSULTANT further represents that no person having any interest shall be employed for said performance. By signing below, CONSULTANT/ANNUAL CONSULTANT certifies that the information contained herein is true and correct and constitutes all current potential conflicts of interest which may influence or appear to influence CONSULTANT'S/ANNUAL CONSULTANT'S judgment or quality of services being provided to the County.

CONSULTANT/ANNUAL CONSULTANT shall promptly notify the COUNTY in writing by certified mail of all potential conflicts of interest that may arise in the future through any prospective business association, interest or other circumstance which may influence or appear to influence CONSULTANT'S/ANNUAL CONSULTANT'S judgment or quality of services being provided to the County. Such written notification shall identify the prospective business association, interest or circumstance, the nature of work that CONSULTANT/ANNUAL CONSULTANT may undertake and request an opinion of the COUNTY as to whether the association, interest or circumstance would, in the opinion of the COUNTY, constitute an unacceptable conflict of interest if entered into by the CONSULTANT/ANNUAL CONSULTANT.

If, in the sole opinion of the COUNTY, the prospective business association, interest or circumstance of CONSULTANT/ANNUAL CONSULTANT would constitute an unacceptable conflict of interest to the COUNTY, the COUNTY shall so state in the notification and the CONSULTANT/ANNUAL CONSULTANT shall not enter into said association, interest or circumstance.

THIS DISCLOSURE is submitted by Robert F. Rennebaum, P.E., as
(Name of Individual)
President, of Simmons & White, Inc.
(Title/Position) (Firm Name of CONSULTANT/ANNUAL CONSULTANT)
who hereby certifies that the information stated above is true and correct. Further, it is hereby acknowledged that any misrepresentation by the CONSULTANT/ANNUAL CONSULTANT on this Disclosure is considered an unethical business practice and is grounds for sanctions against future County business with the CONSULTANT/ANNUAL CONSULTANT.

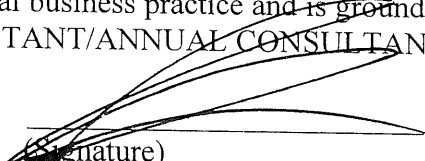
(Signature) 5/22/14
(Date)

Palm Beach County
Engineering & Public Works Roadway Production

Exhibit “C” – Page 1 of 2

PARTICIPATION FOR MWBE/SBE CONSULTANTS
Contract

Project Name: Church Street from Limestone Creek Road to W. of Central Boulev

Project Number: 2014503

Prime Vendor: Simmons & White, Inc.

Resolution Number:

Telephone: (561) 478-7848

Resolution Date: 5/20/2014

Contact: Sarah Abercrombie

Department: Engineering & Public Works

MINORITY SUBCONTRACTORS

Minority Sub-Consultant	Type of Work Performed	Contract Dollar Amount for Sub-Consultant				
		Black	Hispanic	Women	Other	White Male
Simmons & White, Inc. 5601 CORPORATE WAY STE 200 WEST PALM BEACH, FL 33407 (561) 478-7848	MWBE	0.00	0.00	0.00	0.00	
	SBE	0.00	0.00	0.00	0.00	83,910.00
Simmons & White, Inc. 5601 CORPORATE WAY STE 200 WEST PALM BEACH, FL 33407 (561) 478-7848	MWBE	0.00	0.00	0.00	0.00	
	SBE	0.00	0.00	0.00	0.00	5,916.25
Brown & Phillips, Inc. 1860 OLD OKEECHOBEE ROAD, SUI WEST PALM BEACH, FL 33409 (561) 615-3988	MWBE	0.00	0.00	0.00	0.00	
	SBE	16,174.00	0.00	0.00	0.00	0.00
Tierra South Florida, Inc. 2765 VISTA PKY STE 10 WEST PALM BEACH, FL 33411 (561) 687-8536	MWBE	0.00	0.00	0.00	0.00	
	SBE	0.00	0.00	0.00	5,320.00	0.00
Brown & Phillips, Inc. 1860 OLD OKEECHOBEE ROAD, SUI WEST PALM BEACH, FL 33409 (561) 615-3988	MWBE	0.00	0.00	0.00	0.00	
	SBE	18,450.00	0.00	0.00	0.00	0.00
Simmons & White, Inc. 5601 CORPORATE WAY STE 200 WEST PALM BEACH, FL 33407 (561) 478-7848	MWBE	0.00	0.00	0.00	0.00	
	SBE	0.00	0.00	0.00	0.00	5,420.00
Total Contract Authorizaton \$135,190.25	Total MWBE	0.00	0.00	0.00	0.00	
	Percentage	0.00%	0.00%	0.00%	0.00%	
	Total SBE	34,624.00	0.00	0.00	5,320.00	95,246.25
	Percentage	25.61%	0.00%	0.00%	3.94%	70.45%

SCHEDULE 1

LIST OF PROPOSED SBE-M/WBE PRIME AND/OR SUBCONTRACTOR PARTICIPATION

PROJECT NAME OR BID NAME: Church St. – Limestone Creek Rd. to W. of Central Blvd. PROJECT NO. OR BID NO.: 2014503

NAME OF PRIME BIDDER: Simmons & White, Inc. ADDRESS: 5601 Corporate Way, Suite 200, West Palm Beach, FL 33407

CONTACT PERSON: Robert F. Rennebaum PHONE NO.: (561) 478-7848 FAX NO.: (561) 478-3738

BID OPENING DATE: USER DEPARTMENT: Engineering & Public Works

THIS DOCUMENT IS TO BE COMPLETED BY THE PRIME CONTRACTOR AND SUBMITTED WITH BID PACKET. PLEASE LIST THE NAME, CONTACT INFORMATION AND DOLLAR AMOUNT OR PERCENTAGE OF WORK TO BE COMPLETED BY ALL SBE -M/WBE SUBCONTRACTORS ON THIS PROJECT. IF THE PRIME IS AN SBE-M/WBE, PLEASE ALSO LIST THE NAME, CONTACT INFORMATION AND DOLLAR AMOUNT OR PERCENTAGE OF WORK TO BE COMPLETED BY THE PRIME ON THIS PROJECT.

(Check one or both Categories)		DOLLAR AMOUNT OR PERCENTAGE OF WORK				
		M/WBE	SBE			
Name, Address and Phone Number		Minority Business	Small Business	Black	Hispanic	Women Caucasian Other (Please Specify)
1.	Simmons & White, Inc. 5601 Corporate Way, Suite 200 West Palm Beach, FL 33407 (561) 478-7848	<input type="checkbox"/>	<input checked="" type="checkbox"/>			70.45%
2.	Brown & Phillips, Inc. 901 Northpoint Parkway, Suite 119 West Palm Beach, FL 33407 (561) 615-3988	<input checked="" type="checkbox"/>	<input checked="" type="checkbox"/>	25.61%		
3.	Tierra South Florida, Inc. 2765 Vista Parkway, Suite 10 West Palm Beach, FL 33411 (561) 687-8539	<input checked="" type="checkbox"/>	<input checked="" type="checkbox"/>			3.94% (Asian)
4.		<input type="checkbox"/>	<input type="checkbox"/>			
(Please use additional sheets if necessary)						
Total				25.61%		70.45% 3.94% (Asiar
Total Bid Price \$ 133,690.25		Total SBE-M/WBE Participation Dollar Amount or Percentage of Work 100%				

Exhibit "C" – Page 2 of 2

Note:

1. The amount listed on this form for a subcontractor must be supported by price or percentage listed on the signed Schedule 2 or signed proposal in order to be counted toward goal attainment.

2. Firms may be certified by Palm Beach County as an SBE and/or and M/WBE. If firms are certified as both an SBE and N/WBE, please indicate the dollar amount or percentage under the appropriate category.

3. M/WBE information is being collected for tracking purposes only.

Revised 03/15/2011

Exhibit "D" – Page 1 of 2

PROJECT NUMBER: 2014503 PROJECT NAME: Church Street from Limestone Creek Road to W. of Central Boulevard
TO: Simmons & White, Inc.
(Name of Prime Bidder)

Date of Palm Beach County Certification: January 28, 2013 to January 27, 2016

Line Item/ Lot No.	Item Description	Qty/Units	Unit Price	Total Price/ Percentage
	Roadway Design Survey	1 / LS	\$14,674.00	\$14,674.00
	Legal Description & Sketch	41 / EA	\$450.00	\$18,450.00

and will enter into a formal agreement for work with you conditioned upon your execution of a contract with Palm Beach County.

Price and/or Percentage _____

(Name of Subcontractor)

The undersigned subcontractor understands that the provision of this form to Prime Bidder does not prevent Subcontractor from providing quotations to other bidders.

Brown & Phillips, Inc.
Print name of SBE-M/WBE Subcontractor

By: Anthony Brown Signature

Anthony Brown, CEO
Print name/title of person executing on behalf
of SBE/M/WBE Subcontractor

Exhibit "D" – Page 2 of 2

PROJECT NUMBER: 2014503 PROJECT NAME: Church Street from Limestone Creek Road to W. of Central Boulevard
TO: Simmons & White, Inc.
(Name of Prime Bidder)

Date of Palm Beach County Certification: 2/15/2015

Line Item/

Lot No.	Item Description	Qty/Units	Unit Price	Total Price/ Percentage
I.	Field Exploration	Lump Sum	\$3,100.00	\$3,100.00
II.	Laboratory Testing	Lump Sum	\$ 355.00	\$ 355.00
III.	Office Engineering	Lump Sum	\$1,865.00	\$1,865.00
	Total Sum			\$5,320.00

3.94%
(Subcontractor's quote)

If undersigned intends to subcontract any portion of this job to a certified SBE or a non-SBE subcontractor, please list the name of the subcontractor and the amount below.

The undersigned subcontractor understands that the provision of this form to Prime Bidder does not prevent Subcontractor from providing quotations to other bidders.

 Tierra South Florida, Inc.
 Print name of SBE/M/WBE Subcontractor

By: _____

 Signature

 Raj Krishnasamy, PE, President
 Print name/title of person executing on behalf
 of SBE/M/WBE Subcontractor



CERTIFICATE OF LIABILITY INSURANCE

SIMM&WH-01 MCDANIELT

DATE (MM/DD/YYYY)
11/15/2013

THIS CERTIFICATE IS ISSUED AS A MATTER OF INFORMATION ONLY AND CONFERS NO RIGHTS UPON THE CERTIFICATE HOLDER. THIS CERTIFICATE DOES NOT AFFIRMATIVELY OR NEGATIVELY AMEND, EXTEND OR ALTER THE COVERAGE AFFORDED BY THE POLICIES BELOW. THIS CERTIFICATE OF INSURANCE DOES NOT CONSTITUTE A CONTRACT BETWEEN THE ISSUING INSURER(S), AUTHORIZED REPRESENTATIVE OR PRODUCER, AND THE CERTIFICATE HOLDER.

IMPORTANT: If the certificate holder is an ADDITIONAL INSURED, the policy(ies) must be endorsed. If SUBROGATION IS WAIVED, subject to the terms and conditions of the policy, certain policies may require an endorsement. A statement on this certificate does not confer rights to the certificate holder in lieu of such endorsement(s).

PRODUCER
Insurance Office of America-JUP
Abacoa Town Center
1200 University Blvd, Suite 200
Jupiter, FL 33458

CONTACT NAME: Stephanie Averhart
PHONE (A/C, No, Ext): (561) 776-0660 FAX (A/C, No): (561) 776-0670
E-MAIL ADDRESS: Stephanie.Averhart@ioausa.com

INSURED

Simmons & White
5601 Corporate Way
Suite 200
West Palm Beach, FL 33407

INSURER(S) AFFORDING COVERAGE	NAIC #
INSURER A: Hartford Casualty Insurance Company	29424
INSURER B: Transportation Insurance Company	20494
INSURER C: Wesco-Financial Insurance Company	19500
INSURER D:	
INSURER E:	
INSURER F:	

COVERAGES

CERTIFICATE NUMBER:

REVISION NUMBER:

THIS IS TO CERTIFY THAT THE POLICIES OF INSURANCE LISTED BELOW HAVE BEEN ISSUED TO THE INSURED NAMED ABOVE FOR THE POLICY PERIOD INDICATED. NOTWITHSTANDING ANY REQUIREMENT, TERM OR CONDITION OF ANY CONTRACT OR OTHER DOCUMENT WITH RESPECT TO WHICH THIS CERTIFICATE MAY BE ISSUED OR MAY PERTAIN, THE INSURANCE AFFORDED BY THE POLICIES DESCRIBED HEREIN IS SUBJECT TO ALL THE TERMS, EXCLUSIONS AND CONDITIONS OF SUCH POLICIES. LIMITS SHOWN MAY HAVE BEEN REDUCED BY PAID CLAIMS.

INSR LTR	TYPE OF INSURANCE	ADDL SUBR INSR WVD	POLICY NUMBER	POLICY EFF (MM/DD/YYYY)	POLICY EXP (MM/DD/YYYY)	LIMITS
GENERAL LIABILITY						
A	<input checked="" type="checkbox"/> COMMERCIAL GENERAL LIABILITY CLAIMS-MADE <input checked="" type="checkbox"/> OCCUR	X	21SBABV7694	10/19/2013	10/19/2014	EACH OCCURRENCE \$ 1,000,000 DAMAGE TO RENTED PREMISES (Ea occurrence) \$ 300,000 MED EXP (Any one person) \$ 10,000 PERSONAL & ADV INJURY \$ 1,000,000 GENERAL AGGREGATE \$ 2,000,000 PRODUCTS - COMP/OP AGG \$ 2,000,000 EB RETRO DATE 1 \$
AUTOMOBILE LIABILITY						
A	<input type="checkbox"/> ANY AUTO <input type="checkbox"/> ALL OWNED AUTOS <input checked="" type="checkbox"/> HIRED AUTOS <input type="checkbox"/> SCHEDULED AUTOS <input checked="" type="checkbox"/> NON-OWNED AUTOS		21SBABV7694	10/19/2013	10/19/2014	COMBINED SINGLE LIMIT (Ea accident) \$ 1,000,000 BODILY INJURY (Per person) \$ BODILY INJURY (Per accident) \$ PROPERTY DAMAGE (PER ACCIDENT) \$
UMBRELLA LIAB						
A	<input checked="" type="checkbox"/> UMBRELLA LIAB EXCESS LIAB CLAIMS-MADE DED <input checked="" type="checkbox"/> RETENTION \$ 10,000	X	21SBABV7694	10/19/2013	10/19/2014	EACH OCCURRENCE \$ 2,000,000 AGGREGATE \$ 2,000,000
WORKERS COMPENSATION AND EMPLOYERS' LIABILITY						
B	ANY PROPRIETOR/PARTNER/EXECUTIVE OFFICER/MEMBER EXCLUDED? (Mandatory in NH) If yes, describe under DESCRIPTION OF OPERATIONS below	Y/N N/A	WC588160062	1/1/2014	1/1/2015	X WC STATUTORY LIMITS E.L. EACH ACCIDENT \$ 1,000,000 E.L. DISEASE - EA EMPLOYEE \$ 1,000,000 E.L. DISEASE - POLICY LIMIT \$ 1,000,000
C	Professional Liabili		ARA109274200	10/3/2013	10/3/2014	DedPer Claim \$25,000 1,000,000
C	Retro Date 10/3/83		ARA109274200	10/3/2013	10/3/2014	

DESCRIPTION OF OPERATIONS / LOCATIONS / VEHICLES (Attach ACORD 101, Additional Remarks Schedule, if more space is required)
Palm Beach County Board of County Commissioners, a Political Subdivision of the State of Florida, its officers, employees, and agents are listed as Additional Insured as respects General Liability as required by written contract per form CC008 (04/05).

All Projects with Palm Beach County

Retroactive Date: 10/3/83 For Professional Liability

CERTIFICATE HOLDER

CANCELLATION

Palm Beach County Board of County Commissioners
(BPCBCC)
C/O Engineering & Public Works
2300 N Jog Road
West Palm Beach, FL 33411

SHOULD ANY OF THE ABOVE DESCRIBED POLICIES BE CANCELLED BEFORE THE EXPIRATION DATE THEREOF, NOTICE WILL BE DELIVERED IN ACCORDANCE WITH THE POLICY PROVISIONS.

AUTHORIZED REPRESENTATIVE

C. Ray Dorsey III

© 1988-2010 ACORD CORPORATION. All rights reserved.



June 15, 2012

Palm Beach County Engineering
Roadway Production Division
2300 N. Jog Road
Floor 3W
West Palm Beach, Florida 33411

Attention: Mr. David Young, P.E.

Reference: Traffic Signal Annual Renewal

Dear Mr. Young:

The purpose of this letter is state that Simmons & White, Inc. does not own any company vehicles. If you have any questions or require further clarification, please contact me directly.

Sincerely,

SIMMONS & WHITE, INC.

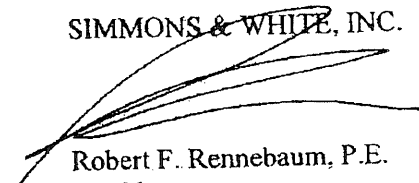

Robert F. Rennebaum, P.E.
President

RFR/sa x:/docs/marketing/rfp/2011/pbctrfficsignal.word

Simmons & White, Inc.
5601 Corporate Way Suite 200 West Palm Beach Florida 33407
T: 561.478.7848 F: 561.478.3738 www.simmonsandwhite.com
Certificate of Authorization Number 3452

