

**Agenda Item #: 3-C-11**

**PALM BEACH COUNTY  
BOARD OF COUNTY COMMISSIONERS**

**AGENDA ITEM SUMMARY**

---

**Meeting Date:** November 18, 2014 ☒ Consent ☐ Regular  
☐ Workshop ☐ Public Hearing

**Department:**

**Submitted By:** Engineering & Public Works Department

**Submitted For:** Roadway Production Division

---

**I. EXECUTIVE BRIEF**

**Motion and Title:** Staff recommends motion to receive and file: Supplement No. 12 to project agreement dated January 13, 2004, R2004-0053 (Supplement), with Metric Engineering, Inc. (MEI), in a total amount of \$13,908.53, for professional services for the Silver Beach Road from east of Congress Avenue to Old Dixie Highway project (Project).

**SUMMARY:** Filing of this Supplement will provide notification to the Board of County Commissioners, required under PPM CW-F-050, that the cumulative value of the additional services exceeds \$250,000. This Supplement, with a total amount of \$13,908.53, resulted in a cumulative value of \$259,789.58, for approved additional services. MEI is under contract as a Palm Beach County project consultant.



District 7 (MRE)

**Background and Justification:** On October 7, 2014, the Deputy County Engineer approved this Supplement with MEI to provide professional services required for the Project. Approval of this Supplement, with a total amount of \$13,908.53, results in a cumulative value of \$259,789.58, for approved additional services authorized by the Engineering & Public Works Department and the Deputy County Engineer. In accordance with PPM No. CW-F-050, this Supplement must be received and filed by the Board of County Commissioners since the cumulative value of approved additional services now exceeds \$250,000.

**Attachments:**

1. Location Sketch
2. Supplement No. 12

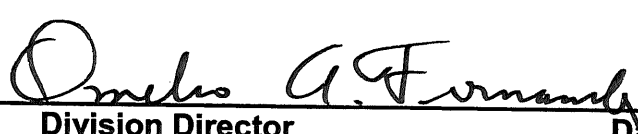
=====

**Recommended by:** \*  10/14/14   
Division Director Date

**Approved By:**  10/23/14  
County Engineer Date

II. FISCAL IMPACT ANALYSIS

A. Five Year Summary of Fiscal Impact:

Fiscal Years	2015	2016	2017	2018	2019
Capital Expenditures	\$13,909	-0-	-0-	-0-	-0-
Operating Costs	-0-	-0-	-0-	-0-	-0-
External Revenues	-0-	-0-	-0-	-0-	-0-
Program Income (County)	-0-	-0-	-0-	-0-	-0-
In-Kind Match (County)	-0-	-0-	-0-	-0-	-0-
NET FISCAL IMPACT	\$13,909	-0-	-0-	-0-	-0-
# ADDITIONAL FTE POSITIONS (Cumulative)					

Is Item Included in Current Budget? Yes X No

Budget Account No:

Fund 3501 Dept 361 Unit 0994 Object 6505

Recommended Sources of Funds/Summary of Fiscal Impact:

Road Impact Fee Fund - Zone 1  
Silver Beach Rd/E of Congress to Old Dixie Hwy

Supplement #12 - Basic Services	\$13,908.53
- Optional Services	\$ .00
Supplement Total	\$13,908.53

C. Departmental Fiscal Review: . Alice Kovalainen

III. REVIEW COMMENTS

A. OFMB Fiscal and/or Contract Dev. and Control Comments:

[Signature]  
10/23 10/24 OFMB

[Signature]  
Contract Dev. and Control  
10-27-14 B. Schuler

B. Approved as to Form  
and Legal Sufficiency:

[Signature]  
Assistant County Attorney

C. Other Department Review:

\_\_\_\_\_  
Department Director

This summary is not to be used as a basis for payment.

**SILVER BEACH ROAD  
E. OF CONGRESS AVENUE TO OLD DIXIE HIGHWAY  
PALM BEACH COUNTY PROJECT NO. 2003514**

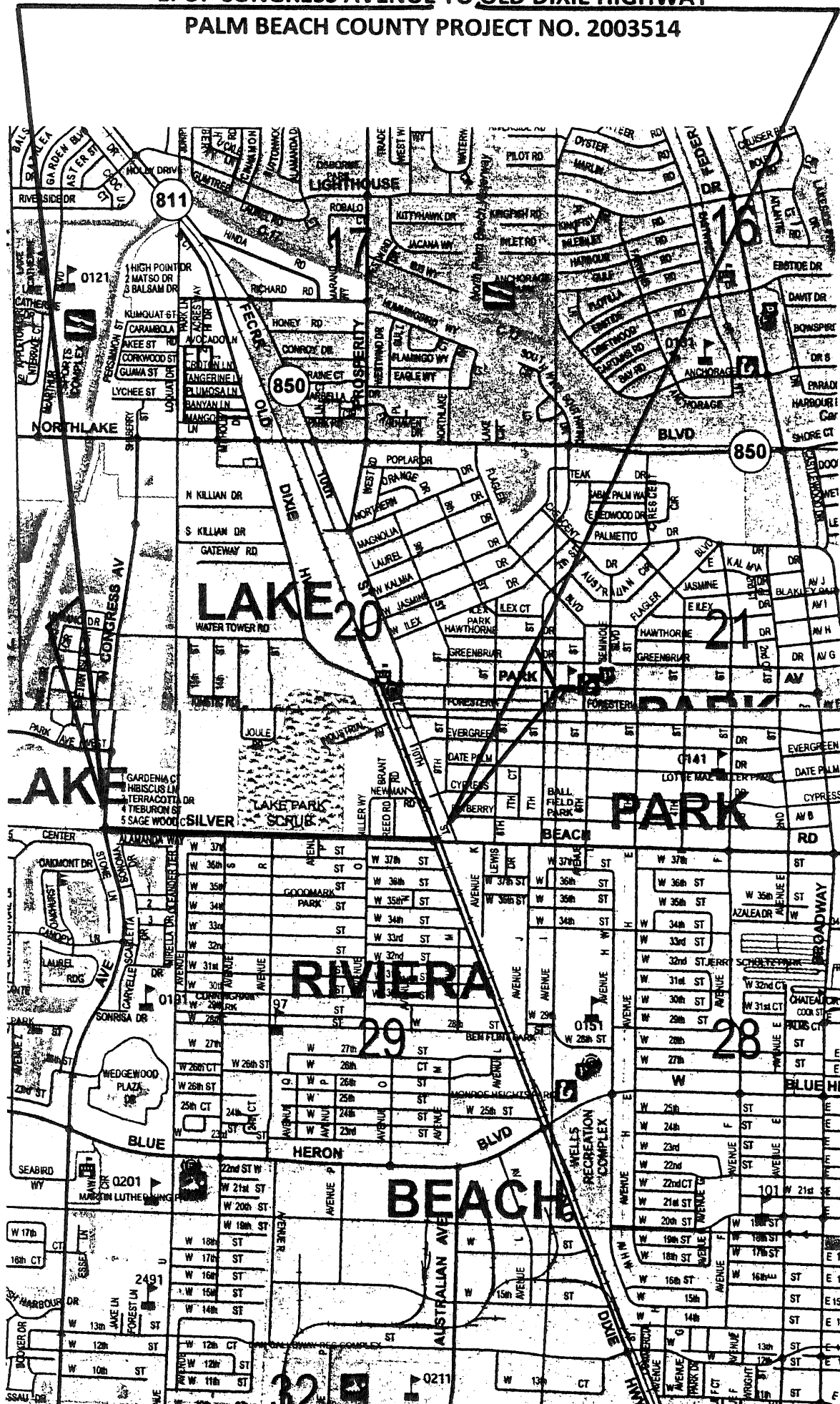

**LOCATION SKETCH**



**Department of Engineering  
and Public Works**

P.O. Box 21229  
West Palm Beach, FL 33416-1229  
(561) 684-4000  
FAX: (561) 684-4050  
www.pbcgov.com

**Palm Beach County  
Board of County  
Commissioners**

Priscilla A. Taylor, Mayor  
Paulette Burdick, Vice Mayor  
Hal R. Valeche  
Shelley Vana  
Steven L. Abrams  
Mary Lou Berger  
Jess R. Santamaria

**County Administrator**

Robert Weisman

"An Equal Opportunity  
Affirmative Action Employer"

October 7, 2014

Attachment 2 – Page 1 of 24

Metric Engineering, Inc.  
2081 Vista Parkway, Suite 310  
West Palm Beach, Florida 33411  
Attn: Mr. Roberto Linares, Vice President

**Re: SILVER BEACH ROAD  
E. OF CONGRESS AVENUE TO OLD DIXIE HIGHWAY  
PALM BEACH COUNTY PROJECT NO.: 2003514  
SUPPLEMENT NO. 12 TO PROJECT AGREEMENT  
DATED JANUARY 13, 2004 (R2004-0053)  
ACCT. NO.: 3501-361-0994-6505**

**COMMISSION DISTRICT: 7**

Dear Mr. Linares:

This letter serves as your "**Notice to Proceed**" with the supplemental services for the above referenced project. These services shall be performed in accordance with the original agreement referenced above and your proposal letter dated August 20, 2014. Please note that the Agreement requires separate specific authorization from the County prior to proceeding with any **Optional Services**.

Compensation for these services are approved as follows, and are not to be exceeded without authorization from Palm Beach County: **Basic Services** (Lump Sum) \$13,908.53; for a total amount of **\$13,908.53**.

Final completion of services under this authorization shall be performed in an expeditious manner so as not to impact the current schedule, or as otherwise requested by the County in writing.

If you have any questions please contact Holly B. Knight, P.E., Contracts Section Manager, at 561-684-4122.

Sincerely,

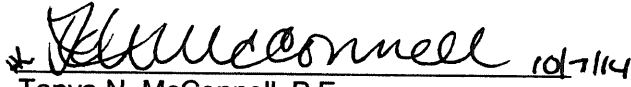
  
Tanya N. McConnell, P.E.  
Deputy County Engineer

TNM:HBK:jd  
Attachment

cc: Administrative Services, Fiscal (NTP)  
Contract Development & Control  
Finance Department  
CCNA File (w/original)  
Roadway Project File

ec: Omelio A. Fernandez, P.E., Director, Roadway Production Division  
L. Morton Rose, P.E., Assistant Director, Roadway Production Division  
Kathleen O. Farrell, P.E., Thoroughfare Roads Section Manager,  
Roadway Production Division  
Holly B. Knight, P.E., Contracts Section Manager, Roadway Production Division  
William R. Sears, P.E., Project Engineer, Roadway Production Division  
Rose Ann Clements, TA III, Roadway Production Division  
Vanessa Jagoo, TA II, Roadway Production Division

OK as to  
scope & fee  
KOF 9/3/14

**SCOPE OF SERVICES**

**SILVER BEACH ROAD**

**From**  
**East of Congress Avenue**  
**To**  
**East of Old Dixie Highway**

**Palm Beach County Project No. 2003514**



**Supplement 12**  
RUSD 8/20/14

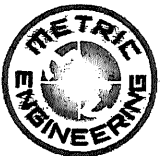

**Prepared by:**  
**Metric Engineering, Inc.**  
**13940 SW 136 Street**  
**Miami, FL 33186**

OK/wrp  
8/27/14

## **Exhibit “A”**

### **Scope of Services**

#### **Supplement 12**

##### **Introduction**

Metric Engineering, Inc. proposes to provide additional professional services required in connection with the re-alignment of the proposed roadway construction and improvements of Silver Beach Road from Approximate Sta.124+85 to Sta. 135+58, a distance of approximately 1,073.00 feet including the re-stationing of the alignment from Sta. 135+58 to the end project in Palm Beach County, Florida. Additional services shall include roadway and drainage plans related to the requested changes as well as additional signing and pavement marking analysis and plans.

These changes are needed to complete the production of final plans per the design changes. The services account for a new submittal of plans for 65%, 96%, 100% and final plans. Metric will provide the Services listed below.

##### **A. Basic Services**

Roadway, drainage map, drainage calculations, signing and pavement marking, and signalization components will need to be revised to accommodate the proposed alignment change. The additional supplement is needed to complete the above mentioned areas of design as related to:

- Changes to the geometry including drainage map, plans & profiles, cross sections, Side Street and driveway profiles.
- Changes to the proposed storm water management system. Enlarge portion of the proposed detention ditch.

Silver Beach Road  
Supplement 12

PBC Project No. 2003514S

- ~~Changes to the signing and pavement markings plans.~~
- Revise the stationing on the Signal Plans due to the new alignment

**B. Reimbursable Services:**

None anticipated at this time.

**C. Optional Services:**

None anticipated at this time.

ESTIMATE OF WORK EFFORT AND COST - PRIME CONSULTANT

Name of Project: Silver Beach Rd from Congress Avenue to Old Dixie Hwy Supplement No. 12  
County: Palm Beach  
FPN: 2003514  
FAP No.:

Consultant Name: Metric Engineering, Inc.  
Consultant No.: 2.1648.10  
Date: 9/23/2014  
Estimator: MS

Staff Classification	Hours From "SH Summary - Firm"	Project Manager	Sr. Struct. Engineer	Sr. Roadway Eng.	Project Eng. Struct.	Project Eng. Road.	Sr. Cadd	Staff Classification 7	Staff Classification 8	Staff Classification 9	Staff Classification 10	Staff Classification 11	Staff Classification 12	SH By Activity	Salary Cost By Activity	Average Rate Per Task
3. Project General and Project Common Tasks		✓ \$56.00		✓ \$53.67		✓ \$42.00	✓ \$27.81									#DIV/0!
4. Roadway Analysis	20	2		5		10	3							✓ 20	\$883.78	\$44.19
5. Roadway Plans	39	2		8		14	15							✓ 39	\$1,546.51	\$39.65
6. Drainage Analysis	32	3		8		16	5							✓ 32	\$1,408.41	\$44.01
7. Utilities																#DIV/0!
8. Environmental Permits, Compliance & Clearances																#DIV/0!
9. Structures - Misc. Tasks, Dwgs, Non-Tech.																#DIV/0!
10. Structures - Bridge Development Report																#DIV/0!
11. Structures - Temporary Bridge																#DIV/0!
12. Structures - Short Span Concrete Bridge																#DIV/0!
13. Structures - Medium Span Concrete Bridge																#DIV/0!
14. Structures - Structural Steel Bridge																#DIV/0!
15. Structures - Segmental Concrete Bridge																#DIV/0!
16. Structures - Movable Span																#DIV/0!
17. Structures - Retaining Walls																#DIV/0!
18. Structures - Miscellaneous																#DIV/0!
19. Signing & Pavement Marking Analysis	8	1		2		4	1							✓ 8	\$359.15	\$44.89
20. Signing & Pavement Marking Plans	16	2		1		2	11							✓ 16	\$555.58	\$34.72
21. Signalization Analysis																#DIV/0!
22. Signalization Plans																#DIV/0!
23. Lighting Analysis																#DIV/0!
24. Lighting Plans																#DIV/0!
25. Landscape Architecture Analysis																#DIV/0!
26. Landscape Architecture Plans																#DIV/0!
27. Survey (Field & Office Support)																#DIV/0!
28. Photogrammetry																#DIV/0!
29. Mapping																#DIV/0!
30. Geotechnical																#DIV/0!
31. Architecture Development																#DIV/0!
32. Noise Barriers Impact Design Assessment																#DIV/0!
33. Intelligent Transportation Systems Analysis																#DIV/0!
34. Intelligent Transportation Systems Plans																#DIV/0!
Total Staff Hours	✓ 115	✓ 10		✓ 24		✓ 46	✓ 35							✓ 115		
Total Staff Cost		✓ \$560.00		✓ \$1,288.08		✓ \$1,932.00	✓ \$873.35								✓ \$4,753.43	\$41.33

Survey Field Days by Subconsultant  
4 - Person Crew:

- Notes:
1. This sheet to be used by Prime Consultant to calculate the Grand Total fee.
  2. Manually enter fee from each subconsultant. Unused subconsultant rows may be hidden.

2.926 multiplier

SALARY RELATED COSTS:  
OVERHEAD: ✓ 166.00% \$4,753.43  
Subtotal ✓ \$7,890.69  
Operating Margin ✓ 10.000% ✓ \$1,264.41  
4-man crew  
days @ \$ - / day  
SUBTOTAL ESTIMATED FEE: ✓ \$13,908.53  
TOTAL BASIC SERVICES: ✓ \$13,908.53  
REIMBURSABLES:  
Subconsultant: Optional Services  
Optional Services  
TOTAL REIMBURSABLES:  
GRAND TOTAL ESTIMATED FEE: ✓ \$13,908.53

Attachment 2 – Page 5 of 24



ESTIMATE OF WORK EFFORT FOR TECHNICAL PROPOSALS - FIRM TOTAL

Financial Project Number: 6/6/7385  
FAP Number:

Date: 9/23/2014

Project Name: Silver Beach Rd from Congress Avenue  
Name of Consultant: Metric Engineering, Inc.

WORK ACTIVITY	EMPLOYEE CLASSIFICATION														TOTAL STAFF HOURS		ON CADD		
	Hours from "Summary" sheet	Project Manager	Sr. Struct. Engineer	Sr. Roadway Eng.	Project Eng. Struct.	Project Eng. Road.	Sr. Cadd	Staff Classi- fication 7	Staff Classi- fication 8	Staff Classi- fication 9	Staff Classi- fication 10	Staff Classi- fication 11	Staff Classi- fication 12	RANGE	PERCENT				
	Firm Total Hours	Hours	Hours	Hours	Hours	Hours	Hours	Hours	Hours	Hours	Hours	Hours	Hours						
3. Project General and Project Common Tasks																			
4. Roadway Analysis	✓ 20	2		5		10	3							✓ 20					
5. Roadway Plans	✓ 39	2		8		14	15							✓ 39					
6. Drainage Analysis	✓ 32	3		8		16	5							✓ 32					
7. Utilities																			
8. Environmental Permits, Compliance & Clearances																			
9. Structures - Misc. Tasks, Dwgs, Non-Tech.																			
10. Structures - Bridge Development Report																			
11. Structures - Temporary Bridge																			
12. Structures - Short Span Concrete Bridge																			
13. Structures - Medium Span Concrete Bridge																			
14. Structures - Structural Steel Bridge																			
15. Structures - Segmental Concrete Bridge																			
16. Structures - Movable Span																			
17. Structures - Retaining Walls																			
18. Structures - Miscellaneous																			
19. Signing & Pavement Marking Analysis	✓ 8	1		2		4	1							✓ 8					
20. Signing & Pavement Marking Plans	✓ 16	2		1		2	11							✓ 16					
21. Signalization Analysis																			
22. Signalization Plans																			
23. Lighting Analysis																			
24. Lighting Plans																			
25. Landscape Architecture Analysis																			
26. Landscape Architecture Plans																			
27. Survey (Field & Office Support)																			
28. Photogrammetry																			
29. Mapping																			
30. Geotechnical																			
31. Architecture Development																			
32. Noise Barriers Impact Design Assessment																			
33. Intelligent Transportation Systems Analysis																			
34. Intelligent Transportation Systems Plans																			
TOTALS	✓ 115	✓ 10		✓ 24		✓ 46	✓ 35							✓ 115					
Notes: 1. This worksheet provides the distribution of a firm's total staff hours for a project. 2. Percentages for staff hour distribution by classification are entered below in rows 56 to 84 of this sheet. 3. Total Staff Hours (column P) may not match staff hours from Summary worksheet (column C) due to rounding. Staff hours calculated for employee classifications are to be adjusted so totals in columns C and P match. 4. Formulas under "Total Staff Hours Range" (columns P & Q) may be adjusted to provide desired range.															Field Survey Estimate: _____ 4-man crew days		FIRM TOTAL ✓ 115		
Form R-613 9/2005																			

Attachment 2 – Page 6 of 24

### Project Activity 4: Roadway Analysis

Estimator:

Silver Beach Rd from Congress Avenue to Old Dixie Hwy Supplement No. 12  
2003514

Task No.	Task	Units	No of Units	Hours/ Unit	Total Hours	Comments
4.1	Typical Section Package	LS	1			Modifications per final configuration.
4.2	Pavement Design Package	LS	1			
4.3	Access Management	LS	1			
4.4	Horizontal/Vertical Master Design Files	LS	1	10	10	Revise alignment from Sta. 127+80 to Sta.135+60
4.5	Cross Section Design Files	LS	1	8	8	Revise cross sections based on new alignment
4.6	Traffic Control Analysis	LS	1			
4.7	Master TCP Design Files	LS	1			
4.8	Design Variations and Exceptions	LS	1			
4.9	Design Report	LS	1			
4.10	Computation Book & Quantities	LS	1			
4.11	Cost Estimate	LS	1			
4.12	Technical Special Provisions	LS	1			
4.13	Other Roadway Analysis	LS	1			
Roadway Analysis Technical Subtotal					✓ 18	

Attachment 2 – Page 7 of 24

**Project Activity 4: Roadway Analysis**

Task No.	Task	Units	No of Units	Hours/ Unit	Total Hours	Comments
4.14	Field Reviews	LS	1			
4.15	Technical Meetings	LS	1			1 additional meetings x 6 hours each x 1 person
4.16	Quality Assurance/Quality Control	LS	%	5%	1	
4.17	Independent Peer Review	LS	%			
4.18	Supervision	LS	%	5%	1	
<b>Roadway Analysis Nontechnical Subtotal</b>					<b>✓ 20</b>	
4.19	Coordination	LS	%			
<b>4. Roadway Analysis Total</b>					<b>✓ 20</b>	

**Technical Meetings**

Typical Section	EA
Pavement	EA
Access Management	EA
15% Line and Grade	EA
Driveways	EA
Local Governments (cities, counties, MPO)	EA
Work Zone Traffic Control	EA
30/60/90/100% Comment Review Meeting:	EA
Other Meetings	EA

**Subtotal Technical Meetings**

Progress Meetings (if required by FDOT)	EA
Phase Review Meetings	EA

**Total Meetings**

Carries to 4.15

**Note:** Project Manager attendance at progress, phase and field review meetings are manually entered on General Task 3

Attachment 2 – Page 8 of 24

## Project Activity 5: Roadway Plans

Estimator:

Silver Beach Rd from Congress Avenue to Old Dixie Hwy Supplement No. 12  
2003514

Task No.	Task	Scale	Units	No. of Units	Hours/ Unit	No. of Sheets	Total Hours	Comments
5.1	Key Sheet		Sheet					
5.2	Summary of Pay Items Including Quantity Input		Sheet					
5.3	Drainage Map		Sheet	2	2	2	4	Revise Drainage Map to show new alignment
5.4	Interchange Drainage Map		Sheet					
5.5	Typical Section Sheets		Sheet					
5.6	General Notes/Pay Item Notes		Sheet					
5.7	Summary of Quantities		Sheet					
5.8	Box Culvert Data Sheet		Sheet					
5.9	Bridge Hydraulics Recommendation Sheets		Sheet					
5.10	Summary of Drainage Structures		Sheet					
5.11	Optional Pipe/Culvert Material		Sheet					
5.12	Project Layout		Sheet					
5.13	Plan/Profile Sheet		Sheet	3	4	3	12	Modifications to latest plan and profiles.
5.14	Profile Sheet		Sheet					

Attachment 2 – Page 9 of 24

**Project Activity 5: Roadway Plans**

Task No.	Task	Scale	Units	No. of Units	Hours/ Unit	No. of Sheets	Total Hours	Comments
5.15	Plan Sheet		Sheet					
5.16	Special Profile		Sheet					
5.17	Back of Sidewalk Profile Sheet		Sheet					
5.18	Interchange Layout Sheet		Sheet					
5.19	Ramp Terminal Details (Plan View)		Sheet					
5.20	Intersection Layout Details		LS	1	8	1	8	Silver Beach and Ave P
5.21	Miscellaneous Detail Sheets		Sheet					
5.22	Drainage Structure Sheet (Per Structure)		EA	5	1.5		8	Revise dr str location and system due to change in alignment.
5.23	Miscellaneous Drainage Detail Sheets		Sheet					
5.24	Lateral Ditch Plan/Profile		Sheet					
5.25	Lateral Ditch Cross Sections		EA					
5.26	Retention/Detention Ponds Detail Sheet		Sheet					
5.27	Retention Pond Cross Sections		EA					
5.28	Cross-Section Pattern Sheet		Sheet					
5.29	Roadway Soil Survey Sheet		Sheet					
5.30	Cross Sections		EA	10	0.3		3	Revise Silver Beach xs due to change in alignment.
5.31	Traffic Control Plan Sheets		Sheet					
5.32	Traffic Control Cross Section Sheets		EA					
5.33	Traffic Control Detail Sheets		Sheet					
5.34	Utility Adjustment Sheets		Sheet					

Attachment 2 – Page 10 of 24

**Project Activity 5: Roadway Plans**

Task No.	Task	Scale	Units	No. of Units	Hours/ Unit	No. of Sheets	Total Hours	Comments
5.35	Selective Clearing and Grubbing		Sheet					
5.36	Erosion Control Plan		Sheet					
5.37	SWPPP		Sheet					
5.38	Project Control Network Sheet		Sheet					
5.39	Environmental Detail Sheets		LS					
5.40	Utility Verification Sheet (SUE Data)		Sheet					
<b>Roadway Plans Technical Subtotal</b>						<b>6</b>	<b>✓ 35</b>	
5.41	Quality Assurance/Quality Control		LS	%	2%		2	
5.42	Supervision		LS	%	2%		2	
<b>5. Roadway Plans Total</b>						<b>6</b>	<b>✓ 39</b>	

Attachment 2 – Page 11 of 24

## Project Activity 6: Drainage Analysis

Estimator:

Silver Beach Rd from Congress Avenue to Old Dixie Hwy Supplement No. 12  
2003514

Task No.	Task	Units	No of Units	Hours/ Unit	Total Hours	Comments
6.1	Determine Base Clearance Water Elevation	Per Location				
6.2	Pond Siting Analysis and Report	Per Basin				
6.3	Design of Cross Drains	EA				
6.4	Design of Roadway Ditches	LS	1	4	4	Due to the revised alignment
6.5	Design of Outfalls	EA				
6.6	Design of Stormwater Management Facility (Offsite Pond)	LS				
6.7	Design of Stormwater Management Facility (Roadside Ditch as Linear Pond or Infield Pond)	Per System				
6.8	Design of Flood Plain Compensation Area	Per Encroachment				
6.9	Design of Storm Drains	EA	10	2.5	25	Structures to be modified per drainage modifications and change in typical section and alignment.
6.10	Optional Culvert Material	LS				
6.11	Analysis/Design of Drainage	Per 1000 Feet of French Drain				
6.12	Drainage Wells	EA				
6.13	Drainage Design Documentation Report	LS	1			
6.14	Bridge Hydraulic Report	EA				
6.15	Temporary Drainage Analysis	LS				
6.16	Cost Estimate	LS				
6.17	Technical Special Provisions	LS				

Attachment 2 – Page 12 of 24

**Project Activity 6: Drainage Analysis**

Task No.	Task	Units	No of Units	Hours/ Unit	Total Hours	Comments
6.18	Other Drainage Analysis	LS	1			
Drainage Analysis Technical Subtotal					✓ 29	
6.19	Field Reviews	LS				
6.20	Technical Meetings	LS				
6.21	Quality Assurance/Quality Control	LS	%	5%	1.5	
6.22	Independent Peer Review	LS	%			
6.23	Supervision	LS	%	5%	1.5	
Drainage Analysis Nontechnical Subtotal					✓ 3	
6.24	Coordination	LS	%			
6. Drainage Analysis Total					✓ 32	

**Technical Meetings**

Base Clearance Water Elevation	EA
Pond Siting	EA
Agency	EA
Local Governments (cities, counties)	EA
FDOT Drainage	EA
Other Meetings	EA

**Subtotal Technical Meetings**

Progress Meetings (if required by FDOT)	EA
Phase Review Meetings	EA

**Total Meetings**

Carries to 6.20

**Note:** Project Manager attendance at progress, phase and field review meetings are manually entered on General Task 3



**Project Activity 19: Signing and Pavement Marking Analysis**

Estimator:

Silver Beach Rd from Congress Avenue to Old Dixie Hwy Supplement No. 12  
2003514

Task No.	Task	Units	No. of Units	Hours/ Units	Total Hours	Comments
19.1	Traffic Data Analysis	LS	1			
19.2	No Passing Zone Study	LS	1			
19.3	Reference and Master Design File	LS	1	8	8	Modify final design per latest modifications.
19.4	Multi-Post Sign Support Calculations	EA				
19.5	Sign Panel Design Analysis	EA				
19.6	Sign Lighting/Electrical Calculations	EA	1			
19.7	Quantities	LS	1			
19.8	Computation Book	LS	1			
19.9	Cost Estimate	LS	1			
19.10	Technical Special Provisions	LS	1			
19.11	Other Signing and Pavement Marking	LS	1			
<b>Signing and Pavement Marking Analysis Technical Subtotal</b>					<b>8</b>	
19.12	Field Reviews	LS	1			1 visit x 1 people x 6 hours for remaining field reviews.
19.13	Technical Meetings	LS	1			
19.14	Quality Assurance/Quality Control	LS	%			
19.15	Independent Peer Review	LS	%			
19.16	Supervision	LS	%			
<b>Signing and Pavement Marking Analysis Nontechnical Subtotal</b>						
19.17	Coordination	LS	%			
<b>19. Signing and Pavement Marking Analysis Total</b>					<b>8</b>	

Attachment 2 – Page 14 of 24

**Project Activity 19: Signing and Pavement Marking Analysis**

<b>Technical Meetings</b>	
Sign Panel Design	EA
Queue Length Analysis	EA
Local Governments (cities, counties)	EA
Other Meetings	EA
<b>Subtotal Technical Meetings</b>	
Progress Meetings	EA
Phase Review Meetings	EA
<b>Total Meetings</b>	

Carries to 19.13

**Note: Project Manager attendance at progress, phase and field review meetings are manually entered on General Task 3**

**Project Activity 20: Signing and Pavement Marking Plans**

Estimator:

Silver Beach Rd from Congress Avenue to Old Dixie Hwy Supplement No. 12  
2003514

Task No.	Task	Scale	Units	No of Units	Hours/ Unit	No. of Sheets	Total Hours	Comments
20.1	Key Sheet		Sheet					
20.2	Summary of Pay Items Including CES Input		LS					
20.3	Tabulation of Quantities		Sheet					
20.4	General Notes/Pay Item Notes		Sheet					
20.5	Project Layout		Sheet					
20.6	Plan Sheet		Sheet	4	4	4	16	To update labeling per latest design modifications.
20.7	Typical Details		EA					
20.8	Guide Sign Worksheet(s)		EA					
20.9	Traffic Monitoring Site		EA					
20.10	Cross Sections		EA					
20.11	Special Service Point Details		EA					
20.12	Special Details		LS	1				
20.13	Interim Standards		LS	1				
<b>Signing and Pavement Marking Plans Technical Subtotal</b>						<b>4</b>	<b>16</b>	
20.14	Quality Assurance/Quality Control		LS	%				
20.15	Supervision		LS	%				
<b>20. Signing and Pavement Marking Plans Total</b>						<b>4</b>	<b>✓ 16</b>	

Attachment 2 – Page 16 of 24

Palm Beach County  
Engineering & Public Works Roadway Production

PROJECT HISTORY

Attachment 2 – Page 17 of 24

PROJECT NAME: Silver Beach Rd. - E. of Congress Ave. to Old Dixie Hwy.  
PROJECT NUMBER: 2003514S DEPARTMENT: Engineering & Public Works  
RESOLUTION DATE: RESOLUTION NO

----- APPROVALS -----			
	LEAD	CRC	BCC
PRIME CONTRACT AMOUNT:	0.00	0.00	269,762.78

Supplements

Number	Date	Description			
11	10/9/2013	Roadway, drainage plans, drainage calcs., S&P Markings & signalization components revised for new alignment change.	0.00	0.00	137,709.21
1	4/6/2004	Drainage analysis at Northern Palm Beach County Business park...	6,160.17	0.00	0.00
2	10/19/2004	Data collection related to Congress Avenue drainage calculations and report.	4,531.47	0.00	0.00
3	3/8/2005	Additional drainage review services.	6,566.53	0.00	0.00
4	6/22/2005	Preparation of alignment and right-of-way study report.	0.00	0.00	93,214.23
5	10/23/2007	Add'l. svcs. for revisions to Master Plan + 2 alternate Master Plan layouts for changes to proposed alignment & typical sections	27,327.40	0.00	0.00
6	3/12/2008	Add'l. svcs. on Silver Bch Rd.: Pond Siting Rpt. Analysis, Drainage & revisions to plans & signalization. Plans for intersection	0.00	57,287.24	0.00
7	11/12/2008	Rdwy. & drain. analysis, plan changes. Changes to Environmental, Geotechnical & Survey related to offsite stormwater mgmt. pond.	0.00	62,852.55	0.00
8	9/21/2009	Rdwy. & drainage analysis for req'd. changes & add'l. surveying and mapping services. Revise ten lgl. descript. & parcel sketch.	33,612.50	0.00	0.00
9	1/21/2010	Roadway & drainage plans. S&P marking analysis. Extend project 800 feet west to Congress. Add'l. plans/exhibits for railroad.	47,543.19	0.00	0.00
10	2/1/2012	Modifications to design files & construction documents per final accepted alignment provided in the last master plan of 6/2010.	0.00	0.00	111,450.96
Supplement Totals:			125,741.26	120,139.79	342,374.40

**CERTIFICATION STATEMENTS**

Attachment 2 – Page 18 of 24

**Project:** Silver Beach Road from E. of Congress Avenue to Old Dixie Highway

**Project No.:** 2003514

**Consultant/Annual Consultant** Metric Engineering, Inc.

**TRUTH-IN-NEGOTIATION STATEMENT**

By entering into this Agreement, the **CONSULTANT/ANNUAL CONSULTANT** certifies that the wage rates and costs used to determine the lump sum fees contained in herein are accurate, complete and current as of the date of this Agreement.

The said lump sum fees shall be adjusted to exclude any significant sums should the **COUNTY** determine that the lump sum fees were increased due to inaccurate, incomplete or non-current wage rates or due to inaccurate representations of fees paid to outside consultants.

The **COUNTY** shall exercise its right under this "Certificate" within one year following final payment.

**PROHIBITION AGAINST CONTINGENT FEES STATEMENT**

By entering into this Agreement the **CONSULTANT/ANNUAL CONSULTANT** warrants that they have not employed or retained any company or person other than a bonafide employee working solely for the **CONSULTANT/ANNUAL CONSULTANT** to solicit or secure this Agreement and that they have not paid or agreed to pay any person, company, corporation, individual or firm other than a bonafide employee working solely for the **CONSULTANT/ANNUAL CONSULTANT**, any fee, commission, percentage, gift or other consideration contingent upon or resulting from the award of making of this agreement.

**PUBLIC ENTITY CRIMES STATEMENT**

As provided in F.S. 287.132-133, by entering this Agreement or performing any work in furtherance hereof, the **CONSULTANT/ANNUAL CONSULTANT** certifies that it, its affiliates, suppliers, sub-contractors and consultants who will perform hereunder, have not been placed on the convicted vendor list maintained by the State of Florida Department of Management Services within the 36 months immediately preceding the date hereof. This notice is required by F.S. 287.133 (3) (a).

**NON-DISCRIMINATION STATEMENT**

The **CONSULTANT/ANNUAL CONSULTANT** warrants and represents that all of its employees are treated equally during employment without regard to race, color, religion, disability, sex, age, national origin, ancestry, marital status, familial status sexual orientation, gender identity and expression or genetic information.

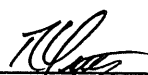
  
\_\_\_\_\_  
Roberto A. Linares, Senior Vice President

**CONFLICT OF INTEREST DISCLOSURE FORM** Attachment 2 – Page 19 of 24

**Project:** Silver Beach Road from E. of Congress Avenue to Old Dixie Highway  
**Project No.:** 2003514

CONSULTANT/ANNUAL CONSULTANT represents that it presently has no interest, either direct or indirect, which would or could conflict in any manner with the performance of services for the County, except as follows:

\_\_\_\_\_  
\_\_\_\_\_

(Attach additional sheets as needed.)

CONSULTANT/ANNUAL CONSULTANT further represents that no person having any interest shall be employed for said performance. By signing below, CONSULTANT/ANNUAL CONSULTANT certifies that the information contained herein is true and correct and constitutes all current potential conflicts of interest which may influence or appear to influence CONSULTANT’S/ANNUAL CONSULTANT’S judgment or quality of services being provided to the County.

CONSULTANT/ANNUAL CONSULTANT shall promptly notify the COUNTY in writing by certified mail of all potential conflicts of interest that may arise in the future through any prospective business association, interest or other circumstance which may influence or appear to influence CONSULTANT’S/ANNUAL CONSULTANT’S judgment or quality of services being provided to the County. Such written notification shall identify the prospective business association, interest or circumstance, the nature of work that CONSULTANT/ANNUAL CONSULTANT may undertake and request an opinion of the COUNTY as to whether the association, interest or circumstance would, in the opinion of the COUNTY, constitute an unacceptable conflict of interest if entered into by the CONSULTANT/ANNUAL CONSULTANT.

If, in the sole opinion of the COUNTY, the prospective business association, interest or circumstance of CONSULTANT/ANNUAL CONSULTANT would constitute an unacceptable conflict of interest to the COUNTY, the COUNTY shall so state in the notification and the CONSULTANT/ANNUAL CONSULTANT shall not enter into said association, interest or circumstance.

**THIS DISCLOSURE** is submitted by Roberto A. Linares, as  
(Name of Individual)  
Senior Vice President, of Metric Engineering, Inc.  
(Title/Position) (Firm Name of CONSULTANT/ANNUAL CONSULTANT)

who hereby certifies that the information stated above is true and correct. Further, it is hereby acknowledged that any misrepresentation by the CONSULTANT/ANNUAL CONSULTANT on this Disclosure is considered an unethical business practice and is grounds for sanctions against future County business with the CONSULTANT/ANNUAL CONSULTANT.

\_\_\_\_\_  
(Signature) 9/24/19  
(Date)

PARTICIPATION FOR MWBE/SBE CONSULTANTS

Supplement Number 12    Date

Project Name:	Silver Beach Rd. - E. of Congress Ave. to Old Dixie Hwy.	Project Number:	2003514S
Prime Vendor:	Metric Engineering, Inc.	Resolution Number	
Telephone:	(305) 235-5098	Resolution Date	
Contact:	Manny Sauleda	Department:	Engineering & Public Works
Total Supplement Amount		\$13,908.53	

There are no minority subcontractors for this supplemen

**SCHEDULE 1**

**LIST OF PROPOSED SBE-M/WBE PRIME AND/OR SUBCONTRACTOR PARTICIPATION**

PROJECT NAME OR BID NAME: Silver Beach Rd.-E. of Congress Ave. to Old Dixie Hwy. PROJECT NO. OR BID NO.: 2003514

NAME OF PRIME BIDDER: Metric Engineering, Inc. ADDRESS: 13940 SW 136 St., Suite 200, Miami, FL 33186

CONTACT PERSON: Manuel Sauleda, PE PHONE NO.: 305-235-5098 FAX NO.: 305-251-5894

BID OPENING DATE: \_\_\_\_\_ USER DEPARTMENT: Engineering & Public Works

THIS DOCUMENT IS TO BE COMPLETED BY THE PRIME CONTRACTOR AND SUBMITTED WITH BID PACKET. PLEASE LIST THE NAME, CONTACT INFORMATION AND DOLLAR AMOUNT OR PERCENTAGE OF WORK TO BE COMPLETED BY ALL SBE -M/WBE SUBCONTRACTORS ON THIS PROJECT. IF THE PRIME IS AN SBE-M/WBE, PLEASE ALSO LIST THE NAME, CONTACT INFORMATION AND DOLLAR AMOUNT OR PERCENTAGE OF WORK TO BE COMPLETED BY THE PRIME ON THIS PROJECT.

Name, Address and Phone Number	(Check one or both Categories)		DOLLAR AMOUNT OR PERCENTAGE OF WORK				
	M/WBE	SBE	Black	Hispanic	Women	Caucasian	Other (Please Specify)
	Minority Business	Small Business					
1.	<input type="checkbox"/>	<input type="checkbox"/>	_____	_____	_____	_____	_____
2.	<input type="checkbox"/>	<input type="checkbox"/>	_____	_____	_____	_____	_____
3.	<input type="checkbox"/>	<input type="checkbox"/>	_____	_____	_____	_____	_____
4.	<input type="checkbox"/>	<input type="checkbox"/>	_____	_____	_____	_____	_____
5.	<input type="checkbox"/>	<input type="checkbox"/>	_____	_____	_____	_____	_____
(Please use additional sheets if necessary)							
Total			_____	_____	_____	_____	_____
Total Bid Price \$ <u>13,908.53</u>			Total SBE-M/WBE Participation Dollar Amount or Percentage of Work <u>0.00%</u>				

Note: 1.The amount listed on this form for a subcontractor must be supported by price or percentage listed on the signed Schedule 2 or signed proposal in order to be counted toward goal attainment.  
2. Firms may be certified by Palm Beach County as an SBE and/or and M/WBE. If firms are certified as both an SBE and N/WBE, please indicate the dollar amount or percentage under the appropriate category.  
3. M/WBE information is being collected for tracking purposes only.



**INTEROFFICE COMMUNICATION  
PALM BEACH COUNTY  
BUDGET AVAILABILITY STATEMENT**

**DATE:** September 26, 2014

**TO:** Omelio Fernandez, Director  
Roadway Production  
Attn: Kathleen Farrell/JaeAnn Dean

**FROM:** Alice Kovalainen, Fiscal Manager *ak*  
Administrative Services

**RE:** Silver Beach Rd/E of Congress to Old Dixie Hwy  
Project # 2003514  
Metric Engineering, Inc. (METR0006)  
Consultant Services Authorization  
Supplement #12 \$13,908.53

**BOARD MEETING DATE:** N/A

**FISCAL IMPACT LOCATION:** F:\COMMON\WP\AgendaPage2\ \_\_\_\_\_,

**FUNDING STATUS:** FULLY FUNDED

---

Is Item Included in Current Budget?      Yes    X    No

**Budget Account No:**

Fund 3501    Dept 361    Unit 0994    Object 6505

**Recommended Sources of Funds/Summary of Fiscal Impact:**

Road Impact Fee Fund - Zone 1  
Silver Beach Rd/E of Congress to Old Dixie Hwy

Supplement #12 - Basic Services	\$13,908.53
- Optional Services	\$ .00
Supplement Total	<u>\$13,908.53</u>

REQUEST FOR BUDGET AVAILABILITY STATEMENT  
FOR  
SUPPLEMENT NO. 12 TO A PROJECT AGREEMENT

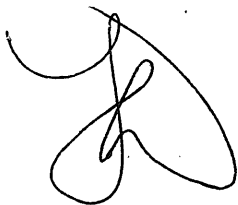

TO: *Ruth Pannunzio*  
*Fiscal Specialist III*

REQUEST DATE: September 24, 2014

PROJECT TITLE/LIMITS: Silver Beach Road from E. of Congress Avenue to Old Dixie Highway

PROJECT NUMBER: 2003514

CONTRACT TYPE CODE: PSC COMMISSION DISTRICT: 7

CONSULTANT NAME: Metric Engineering, Inc.

~~SUPPLEMENT NO. 12~~ to project agreement dated January 13, 2004 (R2004-0053)

AUTHORIZATION AMOUNT: ~~\$13,908.53~~

Basic Services (Lump Sum): \$13,908.53 (Roadway Analysis and Plans,  
Drainage Analysis, Signing & Pavement  
Marking Analysis and Plans).

Please Provide A Brief Statement Of The Scope Of Services To Be Provided By The Consultant.  
Consultant Services authorization to provide additional professional services required in connection  
with the re-alignment of the proposed roadway construction and improvements of Silver Beach Road  
from approx. Sta. 124+85 to Sta. 135+58, a distance of approx. 1,073 feet including the re-stationing of  
the alignment from Sta. 135+58 to the end project. Additional services shall include roadway and  
drainage plans related to the requested changes as well as additional signing and pavement marking  
analysis and plans. These change are needed to complete the production of final plans per the design  
changes. The services account for a new submittal of plans for 65%, 96%, 100% and final plans.

DESIRED CONTINGENCY: \$ 0.00

ESTIMATED ADDITIONAL PROJECT SUPPORT COSTS RELATED TO THIS SUPPLEMENT:

STAFF COSTS (BY DIVISION)	
ROADWAY ENGINEERING	<u>\$0.00</u>
RIGHT OF WAY	<u>\$0.00</u>
SURVEY	<u>\$0.00</u>
TRAFFIC	<u>\$0.00</u>

BUDGET ACCOUNT NUMBER (IF KNOWN): PLEASE PROVIDE

FUND	DEPT	UNIT	OBJECT
_____	_____	_____	_____

BAS REQUESTED BY: Kathleen Farrell / JaeAnn Dean / Roadway Production Division

CONSULTANT SERVICES AUTHORIZATION TO BE APPROVED BY: Deputy County Engineer

ANTICIPATED DATE OF APPROVAL: Upon receipt of BAS



CERTIFICATE OF LIABILITY INSURANCE

DATE (MM/DD/YYYY)  
2/27/2014

THIS CERTIFICATE IS ISSUED AS A MATTER OF INFORMATION ONLY AND CONFERS NO RIGHTS UPON THE CERTIFICATE HOLDER. THIS CERTIFICATE DOES NOT AFFIRMATIVELY OR NEGATIVELY AMEND, EXTEND OR ALTER THE COVERAGE AFFORDED BY THE POLICIES BELOW. THIS CERTIFICATE OF INSURANCE DOES NOT CONSTITUTE A CONTRACT BETWEEN THE ISSUING INSURER(S), AUTHORIZED REPRESENTATIVE OR PRODUCER, AND THE CERTIFICATE HOLDER.

IMPORTANT: If the certificate holder is an ADDITIONAL INSURED, the policy(ies) must be endorsed. If SUBROGATION IS WAIVED, subject to the terms and conditions of the policy, certain policies may require an endorsement. A statement on this certificate does not confer rights to the certificate holder in lieu of such endorsement(s).

PRODUCER MDW Insurance Group 362 Minorca Ave Coral Gables FL 33134	CONTACT NAME: Carrie Worley PHONE (A/C No. Ext): 954-616-6409 FAX (A/C No.): 954-616-6410 E-MAIL: ADDRESS: c.worley@mdwinsurance.com
INSURED Metric Engineering, Inc. 13940 SW 136th Street, #200 Miami FL 33186	INSURER(S) AFFORDING COVERAGE INSURER A: Hartford Insurance Group 914 INSURER B: Hartford Fire Ins. Co. INSURER C: Hartford Casualty Insurance Co 29424 INSURER D: Lexington Insurance Company 19437 INSURER E: Hartford Insurance Co of SE 38261 INSURER F:

COVERAGES CERTIFICATE NUMBER: 741336576 REVISION NUMBER:

THIS IS TO CERTIFY THAT THE POLICIES OF INSURANCE LISTED BELOW HAVE BEEN ISSUED TO THE INSURED NAMED ABOVE FOR THE POLICY PERIOD INDICATED. NOTWITHSTANDING ANY REQUIREMENT, TERM OR CONDITION OF ANY CONTRACT OR OTHER DOCUMENT WITH RESPECT TO WHICH THIS CERTIFICATE MAY BE ISSUED OR MAY PERTAIN, THE INSURANCE AFFORDED BY THE POLICIES DESCRIBED HEREIN IS SUBJECT TO ALL THE TERMS, EXCLUSIONS AND CONDITIONS OF SUCH POLICIES. LIMITS SHOWN MAY HAVE BEEN REDUCED BY PAID CLAIMS.

INSR LTR	TYPE OF INSURANCE	ADDL/SUBR INSR	WVD	POLICY NUMBER	POLICY EFF (MM/DD/YYYY)	POLICY EXP (MM/DD/YYYY)	LIMITS
A	GENERAL LIABILITY <input checked="" type="checkbox"/> COMMERCIAL GENERAL LIABILITY <input type="checkbox"/> CLAIMS-MADE <input checked="" type="checkbox"/> OCCUR  GENTL AGGREGATE LIMIT APPLIES PER: <input type="checkbox"/> POLICY <input checked="" type="checkbox"/> PROJECT <input type="checkbox"/> LOC	Y		21UUNAN3986	3/1/2014	3/1/2015	EACH OCCURRENCE \$1,000,000 DAMAGE TO RENTED PREMISES (Ea occurrence) \$300,000 MED EXP (Any one person) \$10,000 PERSONAL & ADV INJURY \$1,000,000 GENERAL AGGREGATE \$2,000,000 PRODUCTS - COMP/OP AGG \$2,000,000 \$
B	AUTOMOBILE LIABILITY <input checked="" type="checkbox"/> ANY AUTO <input type="checkbox"/> ALL OWNED AUTOS <input checked="" type="checkbox"/> HIRED AUTOS <input type="checkbox"/> SCHEDULED AUTOS <input checked="" type="checkbox"/> NON-OWNED AUTOS			21UENAN4048	3/1/2014	3/1/2015	COMBINED SINGLE LIMIT (Ea accident) \$1,000,000 BODILY INJURY (Per person) \$ BODILY INJURY (Per accident) \$ PROPERTY DAMAGE (Per accident) \$ \$
C	UMBRELLA LIAB <input checked="" type="checkbox"/> EXCESS LIAB <input checked="" type="checkbox"/> OCCUR <input type="checkbox"/> CLAIMS-MADE DED <input checked="" type="checkbox"/> RETENTION \$10,000			21XHUAN3161	3/1/2014	3/1/2015	EACH OCCURRENCE \$1,000,000 AGGREGATE \$1,000,000 \$
E	WORKERS COMPENSATION AND EMPLOYERS' LIABILITY ANY PROPRIETOR/PARTNER/EXECUTIVE OFFICER/MEMBER EXCLUDED? (Mandatory in NH) If yes, describe under DESCRIPTION OF OPERATIONS below	Y/N N	N/A	21WBAJ5341	3/1/2014	3/1/2015	<input checked="" type="checkbox"/> WC STATUTORY LIMITS E.L. EACH ACCIDENT \$1,000,000 E.L. DISEASE - EA EMPLOYEE \$1,000,000 E.L. DISEASE - POLICY LIMIT \$1,000,000
D	Professional Liability Full Prior Acts			031428218	3/1/2014	3/1/2015	Each Claim \$1,000,000 Aggregate \$2,000,000 Deductible \$100,000

DESCRIPTION OF OPERATIONS / LOCATIONS / VEHICLES (Attach ACORD 101, Additional Remarks Schedule, if more space is required)

Ref: For all projects Metric Engineering has with Palm Beach County Palm Beach County Board of County Commissioners, a Political Subdivision of the State of Florida, its officers, Employees and Agents are named as additional insured on the General & Auto liability

CERTIFICATE HOLDER Palm Beach County Board of County Commissioners c/o Engineering & Public Works 2300 N. Jog Road West Palm Beach FL 33411-2745	CANCELLATION SHOULD ANY OF THE ABOVE DESCRIBED POLICIES BE CANCELLED BEFORE THE EXPIRATION DATE THEREOF, NOTICE WILL BE DELIVERED IN ACCORDANCE WITH THE POLICY PROVISIONS. AUTHORIZED REPRESENTATIVE 
--	---