

PALM BEACH COUNTY
BOARD OF COUNTY COMMISSIONERS
AGENDA ITEM SUMMARY

Meeting Date: May 5, 2015

Consent [X]
Public Hearing []

Regular []

Department: Water Utilities Department

I. EXECUTIVE BRIEF

Motion and Title: Staff recommends motion to approve: Consultant Services Authorization (CSA) No. 8 for CD03 South County Water Services Replacement Phase 4 project with Mock Roos and Associates, Inc. (R2014-0826) in the amount of \$149,210.

Summary: On June 3, 2014, the Board of County Commissioners (BCC) approved the Water Utilities Department (WUD) Engineering/Professional Services Contract with Mock Roos and Associates, Inc. CSA No. 8 provides for services relating to the surveying, design, and permitting of water main replacements in the southwest area of Boca Raton. The Small Business Enterprise (SBE) participation goal established by the SBE Ordinance (R2002-0064) is 15% overall. The contract with Mock Roos and Associates, Inc. provides for SBE participation of 97%. CSA No. 8 includes 100% overall participation. The cumulative SBE participation is 100% overall. Mock Roos and Associates, Inc. is a Palm Beach County company. (WUD Project No. 15-038) District 5 (JM)

Background and Justification: WUD provides potable water service in Sandalfoot Cove and the surrounding area in southwest Boca Raton. The existing water distribution system in this area is over 30 years old and has been experiencing frequent pipe and service line failures. The existing water mains are asbestos cement pipe, undersized and lack fire hydrants. The water service lines to the individual residences are composed of aging polyethylene pipe that is currently failing or leaking. The scope of the project is to replace the water system in this neighborhood with materials currently meeting WUD design and performance standards while decreasing service interruptions to customers and improving fire protection.

Attachments:

1. Location Map
2. Two (2) Original Consultant Services Authorization No. 8

Recommended By:

Department Director

4-28-15
Date

Approved By:

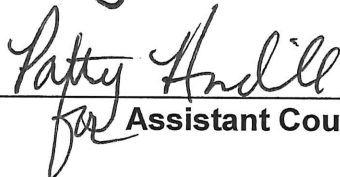
for Assistant County Administrator

5/4/15
Date

II. FISCAL IMPACT ANALYSIS

A. Five Year Summary of Fiscal Impact:

Fiscal Years	2015	2016	2017	2018	2019
Capital Expenditures	<u>\$149,210.1</u>	<u>0</u>	<u>0</u>	<u>0</u>	<u>0</u>
External Revenues	<u>\$0</u>	<u>0</u>	<u>0</u>	<u>0</u>	<u>0</u>
Program Income (County)	<u>0</u>	<u>0</u>	<u>0</u>	<u>0</u>	<u>0</u>
In-Kind Match County	<u>0</u>	<u>0</u>	<u>0</u>	<u>0</u>	<u>0</u>
CCRT Funds	<u>0</u>				
NET FISCAL IMPACT	<u>\$149,210</u>	<u>0</u>	<u>0</u>	<u>0</u>	<u>0</u>
# ADDITIONAL FTE POSITIONS (Cumulative)	<u>0</u>	<u>0</u>	<u>0</u>	<u>0</u>	<u>0</u>
Budget Account No.:	Fund <u>4011</u>	Dept <u>721</u>	Unit <u>W031</u>	Object <u>6543</u>	

Is Item Included in Current Budget? Yes X No

Reporting Category N/A

B. Recommended Sources of Funds/Summary of Fiscal Impact:

One (1) time expenditure from user fees, connection fees, and balance brought forward.

C. Department Fiscal Review: Debra M. West

III. REVIEW COMMENTS

A. OFMB Fiscal and/or Contract Development and Control Comments:

Sherry Brown
4/23/15 OFMB

Dr. J. Jacobson 4/29/15
Contract Development and Control
4-28-15 Michael

B. Legal Sufficiency:

James C. Mayo 4/28/15
Assistant County Attorney

C. Other Department Review:

Department Director

This summary is not to be used as a basis for payment.

L

K

TWP
47

43

TWP
47

44

TWP
47

45

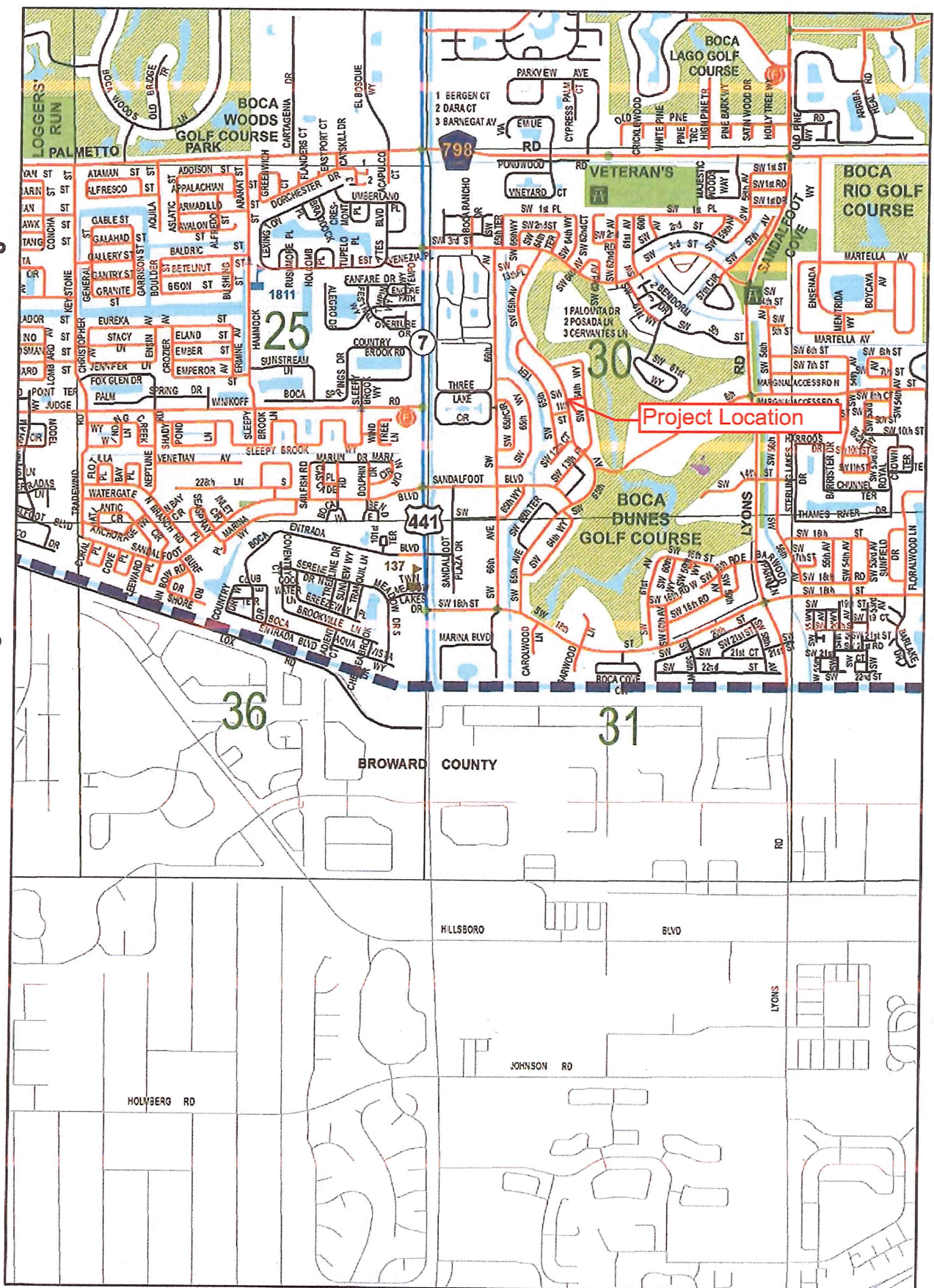

RNG 41

RNG 42

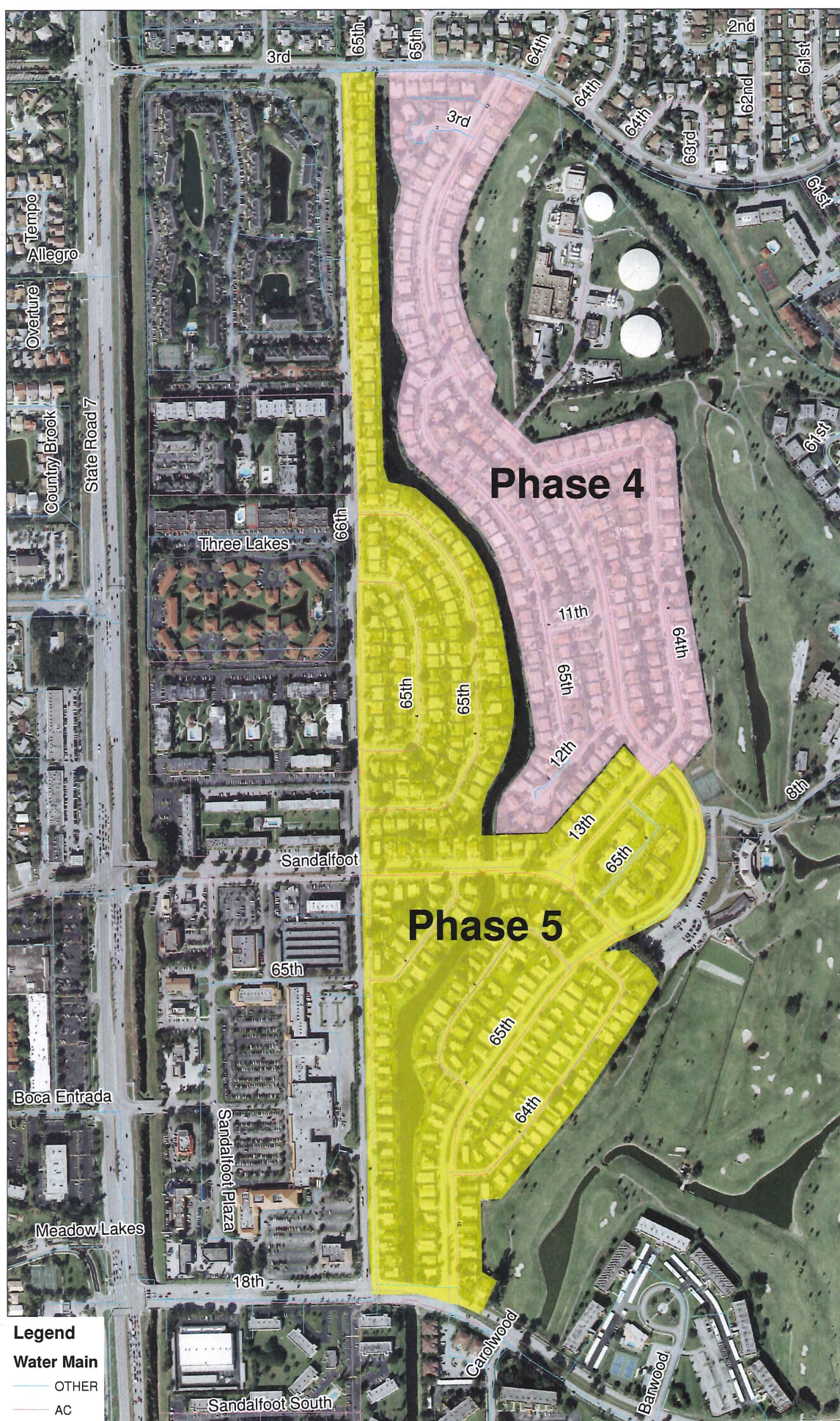



Palm Beach County
Water Utilities
Department
Service Area (SA) and
Major Facilities

Project
Location

- Legend
- P.B.C.W.U.D. SA
 - MANDATORY RECLAIMED SA
 - COUNTY LIMITS
 - Administration
 - Water Reclamation Plant
 - Water Treatment Plant
 - Wetlands

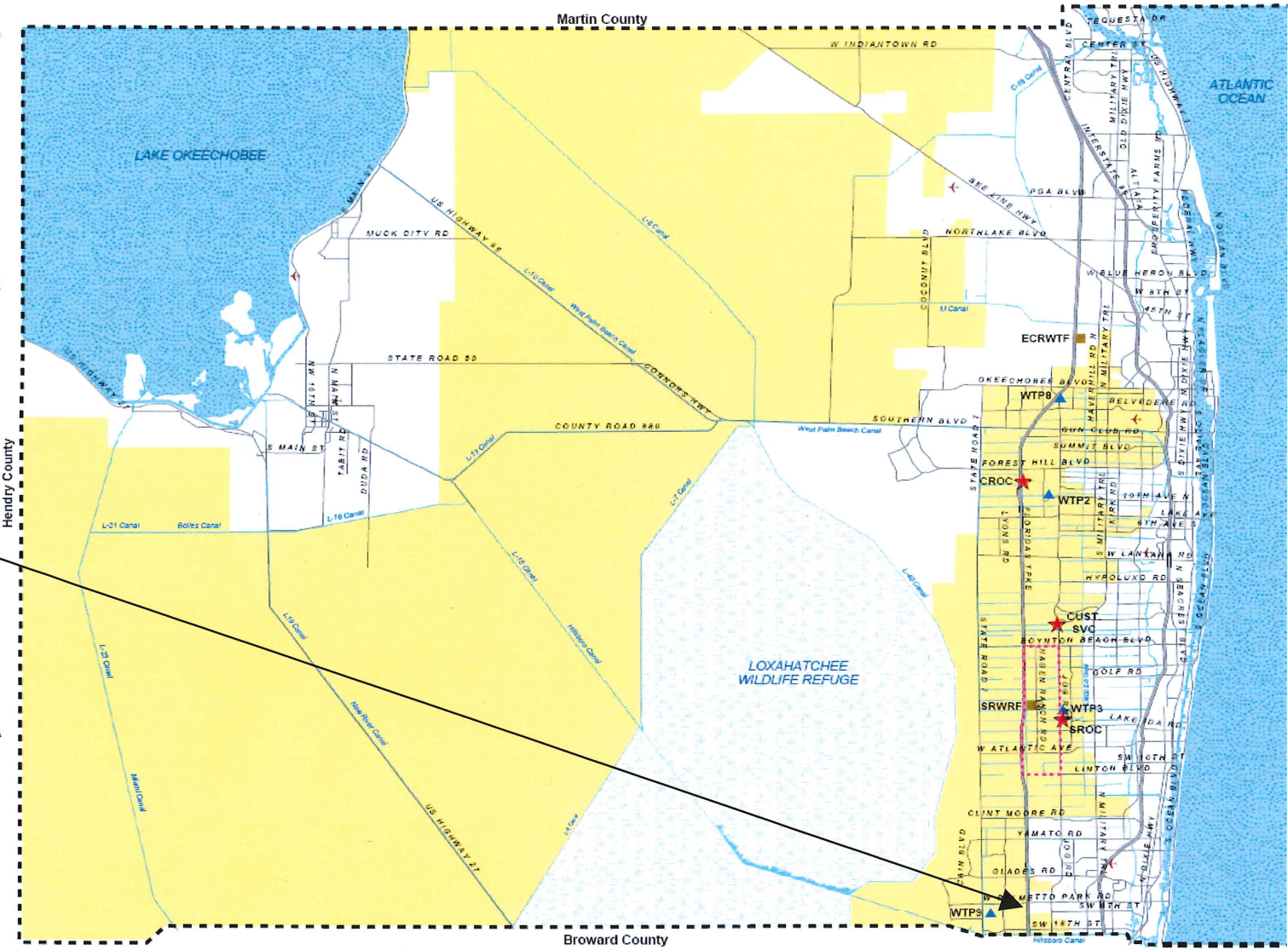

Project Name – CD03 South County Water Services Replacement Phase 4- WUD # 15-038

CONSULTANT SERVICES AUTHORIZATION NO. 8Project Title CD03 South County Water Services Replacement Phase 4Project No. WUD 15-038Budget Line Item No. 4011-721-W031-6543District No.: 5

THIS AUTHORIZATION No. 8 to the Contract for Consulting/Professional Services dated June 3, 2014 (R2014-0826), by and between Palm Beach County and the Consultant identified herein, is for the Consultant Services described in Item 3 of this Authorization. The Contract provides for 97% SBE participation overall. This Consultant Services Authorization includes 100% overall participation. The cumulative SBE participation, including this authorization is 100% overall. Additional authorization will be utilized to meet or exceed the stated overall participation goal.

1. CONSULTANT: Mock, Roos & Associates, Inc.
2. ADDRESS: 5720 Corporate Way, West Palm Beach, FL 33407
3. Description of Services to be provided by the Consultant:
Provide engineering services, including survey, subsurface investigation, design and permitting for the replacement of approximately 9,350 linear feet of existing asbestos cement (AC) pipe, and approximately 200 water service lines located along SW 65th Avenue between SW 3rd Street and Sandalfoot Blvd. in Boca Raton.

See ATTACHMENT A.

4. Services completed by the Consultant to date (Summary and Status of Authorizations):

See ATTACHMENT E.

5. Consultant shall begin work promptly on the requested services.
6. The compensation to be paid to the Consultant for providing the requested services shall be:
 - A. Computation of time charges plus expenses, not to exceed \$ _____
 - B. Fixed price of \$149,210.00
7. This Authorization may be terminated by the County without cause or prior notice. In the event of termination not the fault of the Consultant, the Consultant shall be compensated for all services performed through the date of termination, together with reimbursable expenses (if applicable) then due.

Project No. 15-038 Consultant Services Authorization No. 8

Project Title CD03 South County Water Services Replacement Phase 4

8. SBE participation is included in Attachment D under this Authorization. The attached Schedule 1 defines the SBE applied to this Authorization and Schedule 2 establishes the SBE contribution from each subconsultant (Letter of Intent to perform as an SBE).
9. EXCEPT AS HEREBY AMENDED, CHANGED OR MODIFIED, all other terms, conditions and obligations of the Contract dated June 3, 2014 remain in full force and effect.

IN WITNESS WHEREOF, this Authorization is accepted, subject to the terms, conditions and obligations of the aforementioned Contract.

PALM BEACH COUNTY, A POLITICAL SUBDIVISION OF THE STATE OF FLORIDA

Palm Beach County
Water Utilities Department

Shelley Vana, Mayor

Date

JCS

Mock, Roos & Associates, Inc.

ATTEST:

Debra C. McCray
Witness

Thomas A. Biggs
(Signature)

Debra C. McCray, Corp. Secretary
(Name and Title)

Thomas A. Biggs, P.E., Executive Vice President
(Name and Title)

March 23, 2015
Date

LIST OF ATTACHMENTS

Project No. WUD 15-038 Consultant Services Authorization No. 8

Project Title CD03 South County Water Services Replacement Phase 4

ATTACHMENT - A	Scope of Work
ATTACHMENT - B	Budget Summary
ATTACHMENT - C	Project Schedule
ATTACHMENT - D	SBE Schedule 1 and Schedule 2
ATTACHMENT - E	Authorization Status Report - Summary and Status of Authorizations
ATTACHMENT - F	Authorization Status Report – Summary of SBE Tracking
ATTACHMENT - G	Location Map

ATTACHMENT A

CONSULTANT SERVICES AUTHORIZATION NO. 8

PALM BEACH COUNTY WATER UTILITIES DEPARTMENT ENGINEERING/PROFESSIONAL SERVICES

SCOPE OF WORK FOR South County Water Services Replacement Phase 4

INTRODUCTION

Palm Beach County (COUNTY) entered into an agreement entitled Contract for Engineering/ Professional Services - Palm Beach County Utilities Department (CONTRACT) with. Mock, Roos & Associates, Inc. (CONSULTANT) to provide engineering services for various general activities on R2014-0826. This Consultant Service Authorization will be performed under that CONTRACT.

This Consultant Services Authorization encompasses providing services related to the South County Water Services Replacement Phase 4.

BACKGROUND

PBCWUD (WUD) owns and operates the Water Distribution System in Sandalfoot Cove and surrounding area. The WUD has been experiencing frequent pipe failures (both services and mains) in this portion of the system and has implemented a multi-year replacement program. The replacement program has been divided into phases with Phase 3 currently under construction contract. The WUD wishes to proceed with design of Phase 4 which is in close proximity to WTP #9.

The area is immediately west and south of WTP#9 and includes approximately 9,350 lf of 2" galvanized steel, 6", 8", & 12" asbestos cement pipe primarily along SW 65th Avenues between SW 3rd Street and Sandalfoot Blvd. All piping and valves (originally constructed in 1969) do not meet current county standards, are of deteriorated or questionable condition, and require replacement.

This area also contains approximately 200 house service lines that have proven to be unreliable and also require replacement between the watermain and the existing water meter assemblies.

It is the WUD's desire to replace the system with materials currently meeting County design and performance standards and at the same time improve fire protection in this residential neighborhood.

SCOPE OF SERVICES

CONSULTANT shall perform the engineering Scope of Services as described herein.

- A. Mock•Roos will provide engineering and related services and act as the Project's Engineer of Record for the above-described project as more specifically set forth below.
- B. Preliminary Engineering Services:
 1. Meet with the WUD staff to review the scope of the project, general location of proposed improvements, and obtain the WUD's input regarding expectations for the project.
 2. Perform field review of the proposed watermain and water services replacement locations.
 3. Provide a topographic survey of the area in the immediate vicinity of the proposed pipeline routes and provide base maps of the survey data. (Services to be provided by subconsultant.) The topographic survey will provide GPS coordinates for all found existing water meter locations. The topographic survey will consist of field topography and horizontal and vertical locations for the project (approximately 9,350 linear feet of right-of-way) and will include the following:
 - a. Obtain topography at 100-foot intervals and at major ground elevation changes to depict existing ground profile at the proposed project area along streets. This shall be accomplished by creating a baseline in the field to collect pertinent data.
 - b. Locate all visible fixed improvements within the right-of-way or easements of the project limits, including physical objects, roadway pavement, driveways, sidewalks, curb, trees, signs, fences, power poles, buildings, and other encumbrances, including point of curvature and point of tangency.
 - c. Locate of all known above and below ground existing utilities: FPL, AT&T, Cable TV, Natural Gas, Potable Water (valves, fire hydrants, and water meters, including state plane coordinate values on the meter boxes), Force Mains (valves), Sanitary Sewer (pipe diameter, manhole inverts and direction, rim elevations, clean-outs), Reclaimed Water Mains (valves), Storm Sewers (pipe diameter, manhole inverts and direction, catch basins, and rim/grate elevations). Identify platted rights-of-way (including bearing and distances for centerline), lot numbers, addresses, ownership lines (per platted lot lines), block numbers and dedicated easements per the plats.
 - d. Depict elevations along road right-of-way or easement, as appropriate, every 100 feet, at a minimum, to indicate centerline grades, edge of pavement grades and

shoulder grades, low points and all right-of-way or easement lines. Intermediate grades shall be indicated at all grade breaks, driveways, sidewalks and 10 feet beyond R-O-W/easement line.

- e. Provide and reference benchmarks at maximum 600-foot intervals. Elevations to be referenced to an existing established County Benchmark.
 - f. Prepare topographical survey data in AutoCAD Civil 3D (Version 2015) format at a scale of 1"=20'.
- 4. Develop preliminary Pipeline Alignment Plan.
 - 5. Submit base drawings to local utilities for mark-up of their existing utilities. Plot utility locations received on the drawing base sheets. Local utilities include telephone, cable, and gas, as well as Palm Beach County Utilities.
 - 6. Provide subsurface utility targeting service and subsurface utility locating by test hole, maximum test hole 20 locations. (Services to be provided by subconsultant.)
 - 7. Submit preliminary base sheets with utility information included to WUD for review and comment. Consultant will collect, compile, organize, and address all comments in the PBCWUD Quality Review Form Spreadsheet that will be provided by the County.
 - 8. Develop preliminary construction sequencing plan to facilitate construction of proposed improvements while maintaining water service and vehicle access to existing homes during project construction.
 - 9. Meet with WUD staff to review preliminary submittal and respond to questions or comments.

C. Design Phase Services:

- 1. Provide design phase engineering services to develop the details of the replacement watermain and services design.
- 2. Develop one set of construction drawings consisting of a cover sheet, key sheet, plan and profile sheets, and detail sheets. Construction drawings will include depictions of conflict resolutions.
- 3. Prepare technical specifications and a bid form for the project anticipated to be bid as a single project.
- 4. Submit progress drawings at the 60-percent and 90-percent completion for review and comment. Consultant will collect, compile, organize, and address all comments in the PBCWUD Quality Review Form Spreadsheet that will be provided by the County

5. Meet with the WUD after each submittal to review progress drawings, discuss design options, and respond to questions.
6. Estimate quantities and prepare an Engineer's Opinion of Probable Construction Cost.
7. Prepare a Health Department and Fire Marshal permit application packages including attachments and submit for approval. (WUD will pay application fees.) Prepare and submit responses to Health Department comments, if required.
8. Prepare a PBC Roadway permit application for utility construction in the PBC right-of-way and submit for approval. (WUD will pay application fees.) Prepare and submit responses to PBC Roadway comments, if required.
9. Provide final design phase deliverables consisting of construction drawings and bid form in paper copies, electronic PDF files, and AutoCAD and word files, if requested.

COMPENSATION

The CONSULTANT shall provide assistance to the County in accordance with the attached budget, for a project total of \$149,210.00. The budget summary is shown in Attachment B.

SBE PARTICIPATION

SBE participation is included in the **ATTACHMENT F** under this authorization. The attached Schedule 1 defines the SBE applied to this CSA/Contract and Schedule 2 establishes the SBE contribution from each subcontractor (Letter of Intent to perform as an SBE).

ATTACHMENT B									
CSA NO. 8									
BUDGET SUMMARY									
		Labor Classification and Hourly Rate							
		Mock•Roos							
Task	Task Description	Corporate	Senior	Project	Designer	Senior	Mock•Roos	Subconsultant	Total
No.		Officer	Manager	Engineer III	CADD Technician	Admin. Assist.	Total Labor		Labor
A	Engineering & Related Services						-		-
	Subtotal Task 1	0	0	0	0	0	-		-
B	Preliminary Engineering Services								
	1. Meet w/WUD staff review scope	2	4	4			1,530		1,530
	2. Perform field review		8	8			2,360		2,360
	3. Provide topographic survey	1	8	12		2	3,195	46,725	49,920
	4. Develop preliminary pipeline alignment	2	8	16	32		6,830		6,830
	5. Submit base drawings to local utilities to mark-up		4	8	40	5	5,820		5,820
	6. Provide subsurface utility targeting service	1	4	4	2	2	1,665	10,000	11,665
	7. Submit Prel. Base sheets to WUD for review/Respond to Comm.	1	24	16	8	2	7,055		7,055
	8. Develop sequencing plan		16	4	8	2	3,980		3,980
	9. Meet with WUD staff to review prel. Submittal	2	4	4			1,530		1,530
	Subtotal Task 2	9	80	76	90	13	33,965		90,690
C	Design Phase Services								
	1. Provide DPS engineering services for replacement of watermain	2	10	16			4,110		4,110
	2. Develop const. dwgs w/cover sheet, key sheet, plan & profile	2	30	40	120		21,950		21,950
	3. Prepare Technical Specifications & Bid Form		16	16		16	5,680		5,680
	4. Submit progress drawings (2 submittals)/Respond to Comm.		20	8		4	4,520		4,520
	5. Meet w/WUD after each submittal to review progress	4	8	8	8	4	4,060		4,060
	6. Estimate quantities & prepare EOPC		8	12	16	4	4,660		4,660
	7. Prepare Health Dept and Fire Marshal Permit Package		8	16	16	4	5,200		5,200
	8. Prepare PBC Roadway permit application		10	16	8	4	4,760		4,760
	9. Provide final design phase deliverables	4	4		8	8	2,580		2,580
	Subtotal Task 3	12	114	132	176	44	57,520		57,520
	Labor Subtotal Hours	21	194	208	266	57	91,485	56,725	
	Labor Hourly Rate	175	160	135	95	60			
	Labor Totals	3,675	31,040	28,080	25,270	3,420	91,485	56,725	148,210
	Subconsultant Multiplier								
	Subconsultant Total with Markup								
	Reimbursable Expenses (Reproducibles, etc.)	1,000							149,210.00
	Project Totals	\$149,210.00							

ATTACHMENT - C

PROJECT SCHEDULE

The completion dates for this work will be as follows (starting from CONSULTANT'S receipt of Notice-to-Proceed).

Engineering Services

		<u>From Notice to Proceed</u>
Task B-7	Preliminary Design Submittal (30%)	120 Days
Task B-8	Preliminary Sequencing Plan	130 Days
Task C-4	60% Design Submittal	150 Days
Task C-4	90% Design Submittal	180 Days
Task C-7, 8	Permitting Applications	200 Days
Task C-9	100% Design Submittal	210 Days

ATTACHMENT D

SCHEDULE #1

LIST OF PROPOSED SBE-M/WBE PRIME/SUBCONSULTANTS

PROJECT NAME:

CD03 South County Water Services Replacement Phase 4

PROJECT NUMBER:

15-038

NAME OF PRIME BIDDER:

Mock, Roos & Associates, Inc.

ADDRESS:

5720 Corporate Way, WPB, FL 33407

CONTACT PERSON:

Thomas A. Biggs, P.E.

PHONE NO.

(561) 683-3113

FAX NO.

(561) 478-7248

BID OPENING DATE:

DEPARTMENT

Name, Address and Telephone Number of Minority Consultant	PLEASE IDENTIFY ALL APPLICABLE CATEGORIES (Check one or both Categories)					Dollar Amount	
	Minority Business	Small Business	Black	Hispanic	Women	Caucasian	Other (Please Specify)
Mock, Roos & Associates, Inc. 5720 Corporate Way, WPB, FL Dennis J. Leavy	<input type="checkbox"/>	<input checked="" type="checkbox"/>	\$	\$	\$	\$ 92,485.00	\$
460 Business Park Way, RPB, FL Ground Hound Detection Services	<input type="checkbox"/>	<input checked="" type="checkbox"/>	\$	\$	\$	\$ 46,725.00	\$
2930 NW Commerce Pk Dr, BB, FL	<input type="checkbox"/>	<input checked="" type="checkbox"/>	\$	\$	\$	\$10,000.00	\$
	<input type="checkbox"/>	<input type="checkbox"/>	\$	\$	\$	\$	\$
	<input type="checkbox"/>	<input type="checkbox"/>	\$	\$	\$	\$	\$
PRIME CONSULTANT TO COMPLETE:	TOTAL		\$ -	\$ -	\$ -	\$ 149,210.00	\$ -

BID PRICE:

Total Value of SBE Participation:

\$149,210 - 100%

NOTE:

1. The amount listed on this form for a Subconsultant must be supported by price or percentage included on Schedule 2 or a proposal from each Subconsultant listed in order to be counted toward goal attainment.

2. Firms may be certified by Palm Beach County as an SBE and/or an M/WBE. If firms are certified as both an SBE and M/WBE, please indicate the dollar amount under the appropriate category.

3. M/WBE information is being collected for tracking purposes only.

ATTACHMENT D

SCHEDULE 2

LETTER OF INTENT TO PERFORM AS AN SBE OR M/WBE SUBCONSULTANT

PROJECT NO. 15-038

PROJECT NAME: CD03 South County
Water Services Replacement Phase 4

TO: Mock, Roos & Associates, Inc.
(Name of Prime Bidder)

The undersigned is certified by Palm Beach County as a(n) – (check one or more, as applicable):

Small Business Enterprise X Minority Business Enterprise _____

Black _____ Hispanic _____ Women _____ Caucasian X Other (Please Specify) _____

Date of Palm Beach County Certification: 10/16/13

The undersigned is prepared to perform the following described work in connection with the above project
(Specify in detail, particular work items or parts thereof to be performed):

Line Item/Lot No.	Item Description	Qty / Units	Unit Price	Total Price
<u>1</u>	<u>Civil</u>	<u>I-LS</u>	<u>\$92,485.00</u>	<u>\$92,485.00</u>

at the following price

\$ Ninety Two Thousand Four Hundred and Eighty Five Dollars
(Subconsultant's Quote)

And will enter into a formal agreement for work with you conditioned upon your execution of a contract with Palm Beach County. If undersigned intends to sub-subcontract any portion of this subcontract to a non-certified SBE subconsultant, the amount of any such subcontract must be stated:
\$ _____

The undersigned subcontractor understands that the provision of this form to prime bidder does not prevent subcontractor from providing quotations to other bidders

Mock, Roos & Associates, Inc.
(Print Name of SBE/M/WBE Subconsultant)

By: 
(Signature)

Thomas A. Biggs, P.E. Executive Vice President
(Print name/title of person executing on
behalf of SBE-M/WBE Subconsultant)

Date: March 23, 2015

Rev. 12-09-14

I:\mklb5007.00\csa#8.doc

ATTACHMENT D

SCHEDULE 2

LETTER OF INTENT TO PERFORM AS AN SBE OR M/WBE SUBCONSULTANT

PROJECT NO. 15-038

PROJECT NAME: CD03 South County
Water Services Replacement Phase 4

TO: Mock, Roos & Associates, Inc.
(Name of Prime Bidder)

The undersigned is certified by Palm Beach County as a(n) – (check one or more, as applicable):

Small Business Enterprise X Minority Business Enterprise _____

Black _____ Hispanic _____ Women _____ Caucasian X Other (Please Specify) _____

Date of Palm Beach County Certification: 02/25/13 thru 02/24/16

_____ The undersigned is prepared to perform the following described work in connection with the above project (Specify in detail, particular work items or parts thereof to be performed):

Item/Lot No.	Item Description	Qty / Units	Unit Price	Total Price
<u>2</u>	<u>Surveyor</u>	<u>1 LS</u>	<u>\$46,725.00</u>	<u>\$46,725.00</u>

at the following price

\$ Forty Six Thousand Seven Hundred and Twenty Five Dollars
(Subconsultant's Quote)

And will enter into a formal agreement for work with you conditioned upon your execution of a contract with Palm Beach County. If undersigned intends to sub-subcontract any portion of this subcontract to a non-certified SBE subconsultant, the amount of any such subcontract must be stated: \$ _____.

The undersigned subcontractor understands that the provision of this form to prime bidder does not prevent subcontractor from providing quotations to other bidders

Dennis J. Leavy & Associates
(Print Name of SBE-M/WBE Subconsultant)

By: Daniel A. Bower
(Signature)

David A. Bower, Vice President
(Print name/title of person executing on behalf of SBE-M/WBE Subconsultant)

Date: March 23, 2015

ATTACHMENT D

SCHEDULE 2

LETTER OF INTENT TO PERFORM AS AN SBE OR M/WBE SUBCONSULTANT

PROJECT NO. 15-038

PROJECT NAME: CD03 South County
Water Services Replacement Phase 4

TO: Mock, Roos & Associates, Inc.
(Name of Prime Bidder)

The undersigned is certified by Palm Beach County as a(n) – (check one or more, as applicable):

Small Business Enterprise X

Minority Business Enterprise _____

Black _____ Hispanic _____ Women _____ Caucasian X Other (Please Specify) _____

Date of Palm Beach County Certification: 08/18/14

The undersigned is prepared to perform the following described work in connection with the above project
(Specify in detail, particular work items or parts thereof to be performed):

Line Item/Lot No.	Item Description	Qty / Units	Unit Price	Total Price
<u>3</u>	<u>Utility Locator</u>	<u>1 LS</u>	<u>\$10,000.00</u>	<u>\$10,000.00</u>

at the following price

\$ Ten Thousand Dollars
(Subconsultant's Quote)

And will enter into a formal agreement for work with you conditioned upon your execution of a contract with Palm Beach County. If undersigned intends to sub-subcontract any portion of this subcontract to a non-certified SBE subconsultant, the amount of any such subcontract must be stated:
\$ _____.

The undersigned subcontractor understands that the provision of this form to prime bidder does not prevent subcontractor from providing quotations to other bidders

Ground Hound Detection
(Print Name of SBE-M/WBE Subconsultant)

By: [Signature]
(Signature)

Sean Halsey, South Florida Director
(Print name/title of person executing on
behalf of SBE-M/WBE Subconsultant)

Date: March 23, 2015

Rev. 12-09-14

I:\mk\lb5007.00\csa#8.doc

ATTACHMENT E

AUTHORIZATION STATUS REPORT

SUMMARY AND STATUS OF REQUESTS FOR AUTHORIZATIONS

Auth. No.	Description	Status	Project Total Amount	SBE Total Amount	SBE Participation %	Approved By	Date Approved	WUD No. Assigned	Consultant's Project No.
1	Water Distribution System Improvements in Seminole Pratt Whitney Road from South of Northlake Boulevard to Northlake Boulevard; Utility Relocation Project	Approved	27,950.00	27,950.00	100%	WUD	11/7/14	15-008	B4034.00
2	Runyon Village; Water and Wastewater System Improvements	Approved	9,495.00	9,495.00	100%	WUD	12/02/14	14-037	B4035.00
3	Reclaimed Pipeline Route Study	Approved	93,060.00	93,060.00	100%	CRC	12/03/14	15-011	B4039.00
4	Wastewater System Improvements at Lake Worth Road and Sherwood Forest Blvd.	Approved	13,660.00	13,660.00	100%	WUD	01/16/15	14-105	B4047.00
5	10-Inch FM Replacement at Sansbury Way and LWDD L-2 Canal	Approved	13,660.00	13,660.00	100%	WUD	01/16/15	15-016	B4052.00
6	12-Inch Watermain Extension to Rosenwald Elementary School in South Bay	Approved	29,250.00	29,250.00	100%	WUD	01/16/15	15-025	B4053.00
7	Pump Station 5229 Forcemain Improvements	Approved	97,075.00	97,075.00	100%	CRC	03/11/15	11-035	B4054.00
8	CD03 South County Water Services Replacement Phase 4	Pending	149,210.00	149,210	100%	BCC		15-038	B5007.00
Total			\$433,360						

Rev. 12-09-14

I:\mk\b5007.00\csa#8.doc

ATTACHMENT - F
AUTHORIZATION STATUS REPORT

SUMMARY OF
SBE / MINORITY BUSINESS TRACKING

	Total	SBE
Current Proposal		
Value of Authorization No.	149,210.00	
Value of SBE Letters of Intent	149,210.00	149,210.00
Actual Percentage	100%	100%
Signed/Approved Authorizations		
Total Value of Authorizations	284,150.00	
Total Value of SBE Signed Subcontracts	284,150.00	284,150.00
Actual Percentage	100.00%	100%
Signed/Approved Authorizations Plus Current Proposal		
Total Value of Authorizations	433,360.00	
Total Value of Subcontracts & Letters of Intent	433,360.00	433,360.00
Actual Percentage	100%	100%
GOAL	97%	

TWP
47

TWP
47

TWP
47

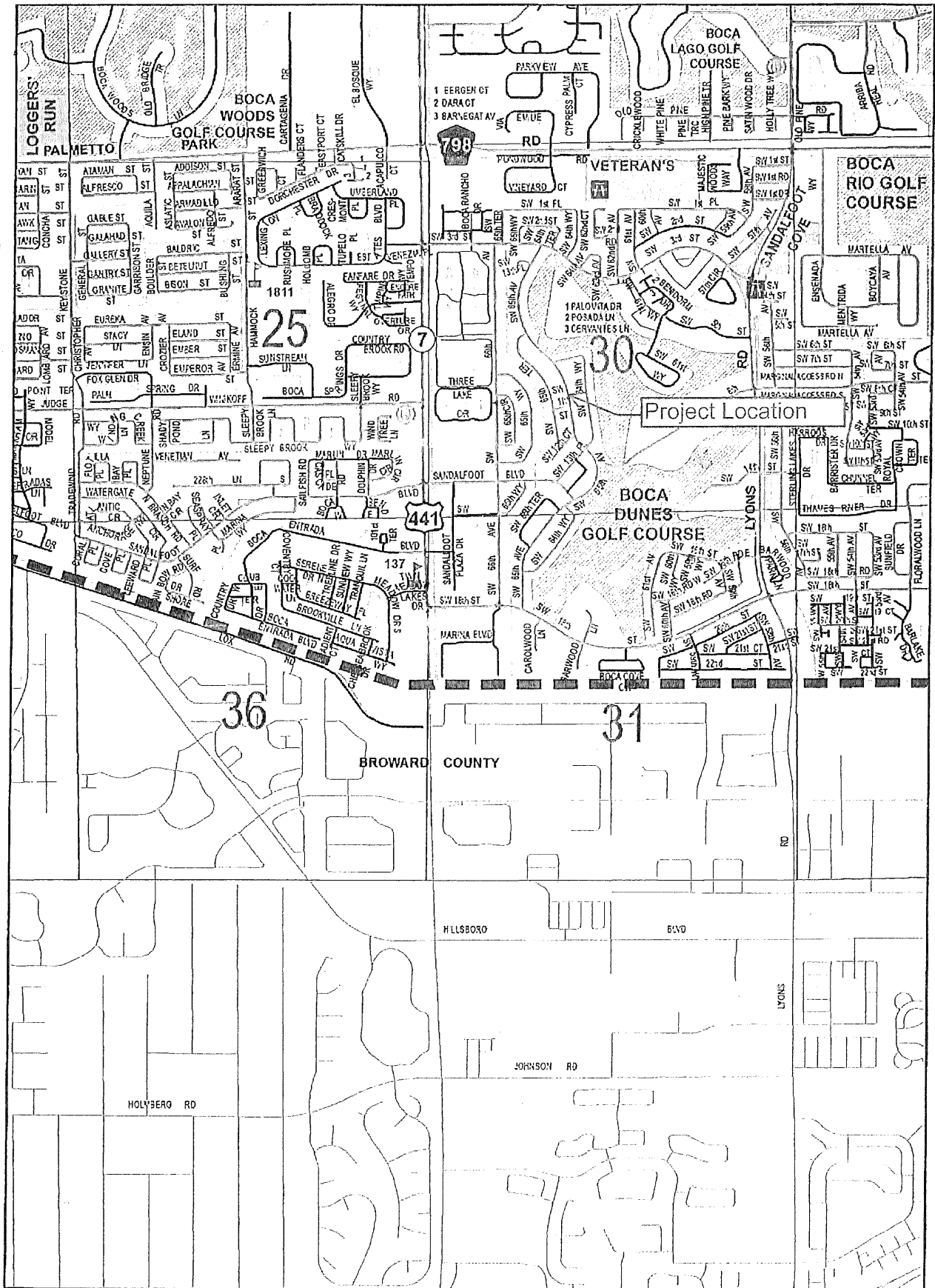

43

44

45

RNG 41

RNG 42

Attachment G



Palm Beach County
Water Utilities
Department
Service Area (SA) and
Major Facilities

Project Location

Legend

- P.B.C.W.U.D. SA
- MANDATORY RECLAIMED SA
- COUNTY LIMITS
- ★ Administration
- Water Reclamation Plant
- ▲ Water Treatment Plant
- Wetlands

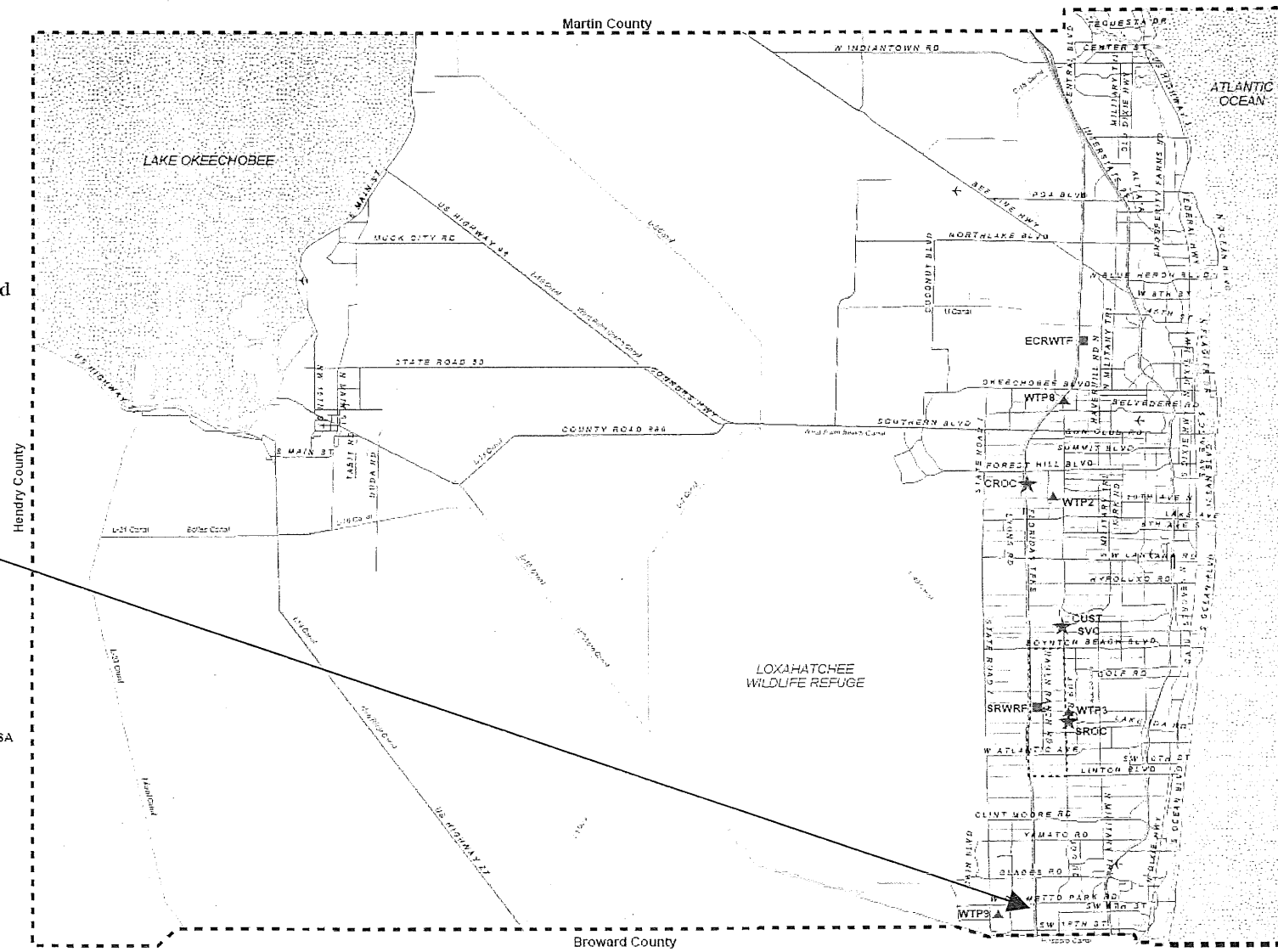

Project Name – CD03 South County Water Services Replacement Phase 4- WUD # 15-038