

PALM BEACH COUNTY BOARD OF COUNTY COMMISSIONERS AGENDA ITEM SUMMARY

Meeting Date: July 7, 2015 [x] Consent [] Regular [] Workshop [] Public Hearing

Department: Engineering & Public Works Department Roadway Production Division

I. EXECUTIVE BRIEF

Motion and Title: Staff recommends motion to approve: a contract in the amount of \$543,612.43, with Alan Gerwig & Associates, Inc. (AGA), for professional services for the CR 880 Bridge over South Florida Water Management District C-51 Canal Bridge Replacement project (Project).

SUMMARY: Approval of this contract will provide the professional services necessary for the preparation of design plans and construction bid documents for the Project. The Small Business Enterprise (SBE) goal for the Project is 15%. AGA previously proposed 100% SBE participation for the Project; however due to the necessity of AGA adding a specialty sub-consultant, whom is not a certified SBE company; the SBE participation proposed for this Project is now 94.32%. AGA is a Palm Beach County company and is certified as an SBE. Simon Coleman of with AGA serves on the Environmental Appeals Board (Board). The Board provides no regulation, oversight, management, or policy-setting recommendations regarding the disclosed contract(s). Disclosure of the contractual relationship at a duly noticed public meeting is being provided in accordance with the provisions of Sect. 2-443, of the Palm Beach County Code of Ethics. District 6 (MRE)

Background and Justification: On September 30, 2014, the Consultant's Competitive Negotiations Act Selection Committee selected AGA and, in accordance with PPM No. CW-O-048, the Board of County Commissioners (Board) was notified of the selection on September 30, 2014. Palm Beach County now desires AGA to provide the services necessary for the Project. The fee, as detailed in Exhibit "B" of the attached contract, has been negotiated as just and reasonable compensation as follows:

Table with 3 columns: Service Category, Amount, and Description. Rows include Basic Services (\$310,627.20), Reimbursable Expenses (\$157,825.03), Optional Services (\$75,160.20), and Total (\$543,612.43).

After reviewing the attached contract and finding it in proper order, staff recommends the Board of County Commissioners' approval.

- Attachments: 1. Location Map 2. Contract with Exhibits "A", "B", "C", "D" and "E" and Certificates of Insurance (2) 3. Project Work Schedule

Recommended by: [Signature] Division Director Date [6/23/15] Approved By: [Signature] County Engineer Date [6/23/15]

II. FISCAL IMPACT ANALYSIS

A. Five Year Summary of Fiscal Impact:

Fiscal Years	2015	2016	2017	2018	2019
Capital Expenditures	<u>\$761,073</u>	<u>-0-</u>	<u>-0-</u>	<u>-0-</u>	<u>-0-</u>
Operating Costs	<u>-0-</u>	<u>-0-</u>	<u>-0-</u>	<u>-0-</u>	<u>-0-</u>
External Revenues	<u>-0-</u>	<u>-0-</u>	<u>-0-</u>	<u>-0-</u>	<u>-0-</u>
Program Income (County)	<u>-0-</u>	<u>-0-</u>	<u>-0-</u>	<u>-0-</u>	<u>-0-</u>
In-Kind Match (County)	<u>-0-</u>	<u>-0-</u>	<u>-0-</u>	<u>-0-</u>	<u>-0-</u>
NET FISCAL IMPACT	<u>\$761,073</u>	<u>-0-</u>	<u>-0-</u>	<u>-0-</u>	<u>-0-</u>
# ADDITIONAL FTE POSITIONS (Cumulative)					

Is Item Included in Current Budget? Yes X No

Budget Account No:
Fund 3500 Dept 361 Unit 1480 Object 6505

Recommended Sources of Funds/Summary of Fiscal Impact:
Transportation Improvement Fund
CR 880 Bridge over C-51 Canal

Basic Services	\$310,627.20
Reimbursable Services	\$157,825.03
Optional Services	\$ 75,160.20
Total Task Authorization	\$543,612.43
Staff Charges	
Roadway Engineering	\$108,725.00
Right of Way	\$ 27,185.00
Survey	\$ 27,185.00
Traffic	\$ 54,365.00
Fiscal Impact	\$761,072.43

Project funding is contingent upon the approval of \$800,000 in the 5 Year Road Program Mid-year adjustment by the Board of County Commissioners on June 23, 2015.

C. Departmental Fiscal Review: Alicia Kovalainen

III. REVIEW COMMENTS

A. OFMB Fiscal and/or Contract Dev. and Control Comments:

[Signature]
5/10 ASD OFMB [initials]
6/10 6/10

[Signature] 6/17/15
Contract Dev. and Control
6-17-15 [initials]

B. Approved as to Form and Legal Sufficiency:

[Signature] 6/18/15
Assistant County Attorney

C. Other Department Review:

Department Director

This summary is not to be used as a basis for payment.

**CR 880 Bridge over SFWMD C-51 Canal
Bridge Replacement
Palm Beach County Project No. 2015500**

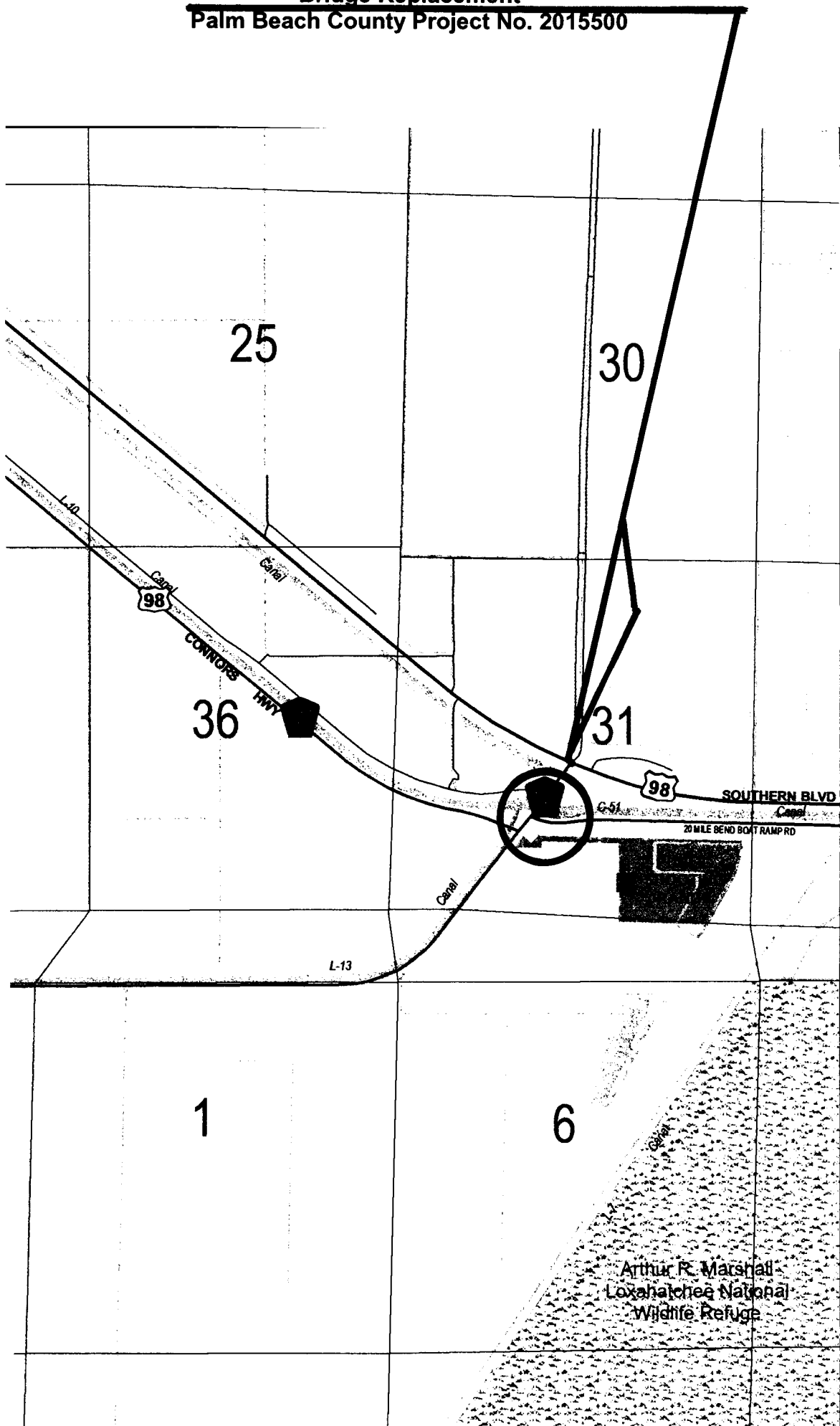

LOCATION MAP