

**PALM BEACH COUNTY
BOARD OF COUNTY COMMISSIONERS
AGENDA ITEM SUMMARY**

Meeting Date:	July 7, 2015	Consent [X] Public Hearing []	Regular []
----------------------	--------------	---	--------------------

Department: Water Utilities Department

I. EXECUTIVE BRIEF

Motion and Title: Staff recommends motion to approve: Consultant Services Authorization (CSA) No. 7 with JLA Geosciences, Inc. (R2014-0822) for the System-Wide Wellfield Improvements Project (TR07) in the amount of \$181,420.

Summary: On June 3, 2014, the Board of County Commissioners (BCC) approved the Master Contract for Utility Hydrogeologic Engineering Services with JLA Geosciences, Inc. CSA No. 7 will provide design and bidding service for improvements on 18 existing wells at Water Treatment Plants (WTP) Nos. 3 and 9. The Small Business Enterprise (SBE) participation goal established by the SBE Ordinance (R2002-0064) is 15% overall. The contract with JLA Geosciences, Inc. provides for SBE participation of 66% overall. This CSA includes 65.99% overall participation. The cumulative SBE participation, including this CSA is 86.23% overall. JLA Geosciences, Inc. is a Palm Beach County company. The project is included in the FY15-16 Capital Improvement Plan adopted by the BCC. (WUD Project No. 15-035) District 5 (n/r)

Background and Justification: The rehabilitation of production wells is necessary to regain lost capacity that naturally occurs over time. The Water Utilities Department has a multiyear plan (TR07) to replace or repair wells to increase raw water supply production to the WTPs. On October 30, 2013, the Contract Review Committee approved CSA No. 13 with MWH Americas, Inc. for production well prioritization planning. The System-Wide Wellfield Improvements project will rehabilitate 18 production wells recommended by the prioritization plan. CSA No. 7 provides for hydrogeologic consulting services for the first phase of the System-Wide Wellfield Improvements project.

Attachments:

1. Location Map
2. Two (2) Original Consultant Services Authorization No. 7

Recommended By:	<u>Jim Stebo</u> Department Director	<u>6-18-15</u> Date
------------------------	---	------------------------

Approved By:	<u>Sharon R. Lopez</u> Assistant County Administrator	<u>6-29-2015</u> Date
---------------------	--	--------------------------

II. FISCAL IMPACT ANALYSIS

A. Five Year Summary of Fiscal Impact:

Fiscal Years	2015	2016	2017	2018	2019
Capital Expenditures	<u>\$181,420.</u>	0	0	0	0
External Revenues	0	0	0	0	0
Program Income (County)	0	0	0	0	0
In-Kind Match County	0	0	0	0	0
NET FISCAL IMPACT	<u>\$181,420.</u>	<u>0</u>	<u>0</u>	<u>0</u>	<u>0</u>
# ADDITIONAL FTE POSITIONS (Cumulative)	0	0	0	0	0

Budget Account No.: Fund 4011 Dept 721 Unit W004 Object 6541

Is Item Included in Current Budget? Yes No

Reporting Category N/A

B. Recommended Sources of Funds/Summary of Fiscal Impact:

One (1) time capital expenditure from user fees with balances brought forward.

C. Department Fiscal Review: Delia M. West

III. REVIEW COMMENTS

A. OFMB Fiscal and/or Contract Development and Control Comments:

Sherry Brown
 5/19/15
 6/19/15
 OFMB

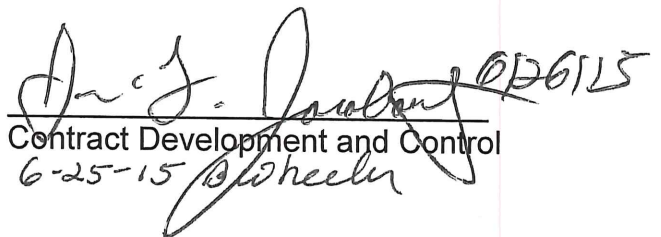
David J. Jacobson
 Contract Development and Control
 6-25-15
 @wheeler

B. Legal Sufficiency:

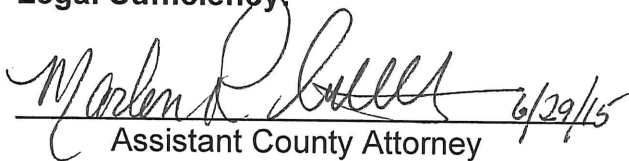
Gordon R. Sull
 6/29/15
 Assistant County Attorney

C. Other Department Review:

 Purchasing Department Director

This summary is not to be used as a basis for payment.



**Palm Beach County
Water Utilities
Department
Service Area (SA) and
Major Facilities**

Legend

- ★ Administration
- WTP Water Treatment Plant
- RMF Reclamation Facility
- WWRW Wastewater Reclamation Facility
- WWT Wastewater Treatment Plant
- Mandatory Reclaimed SA
- - - Palm Beach County Limits
- Yellow P.B.C.W.U.D. Service Area

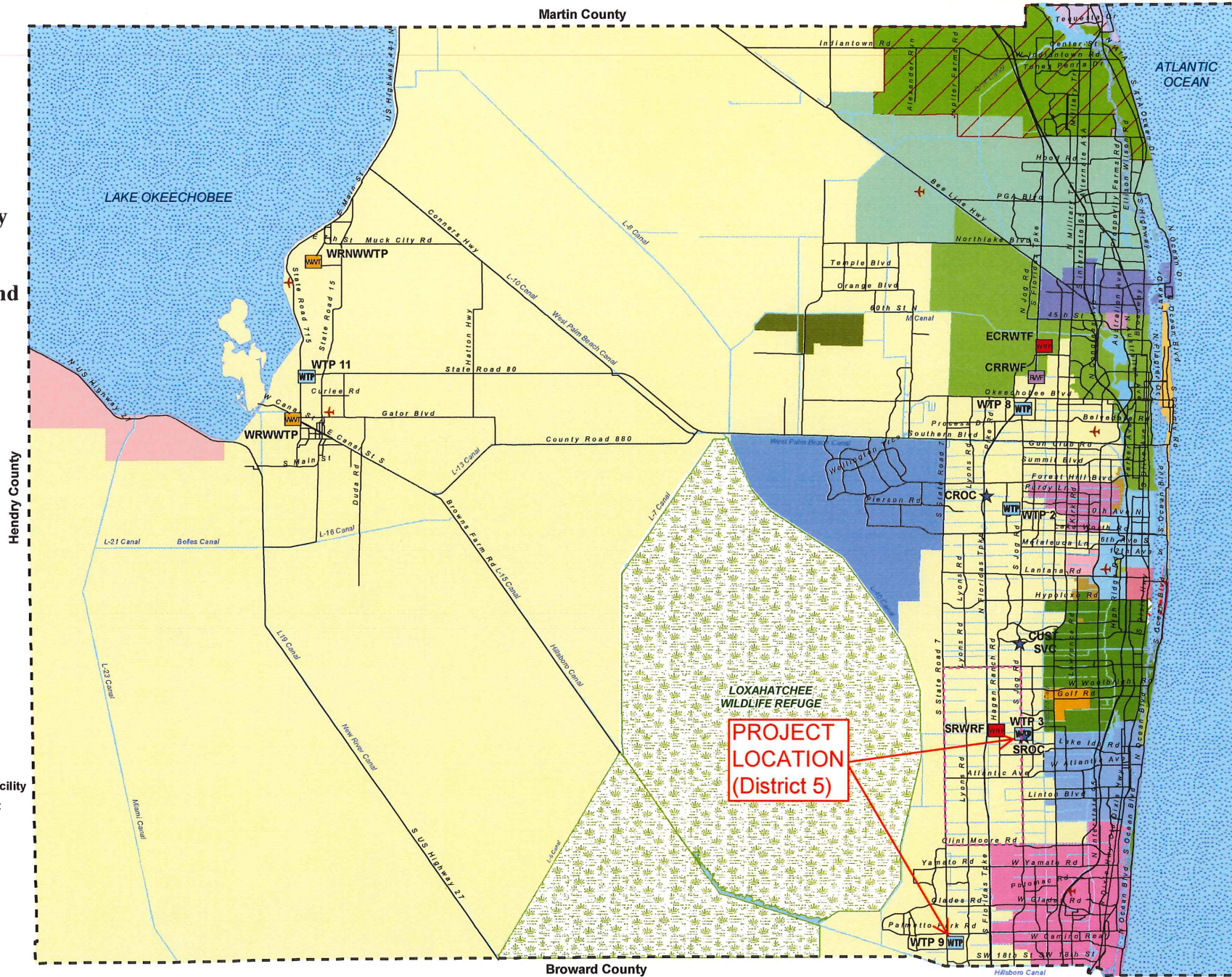

SYSTEM 3 WELLFIELD

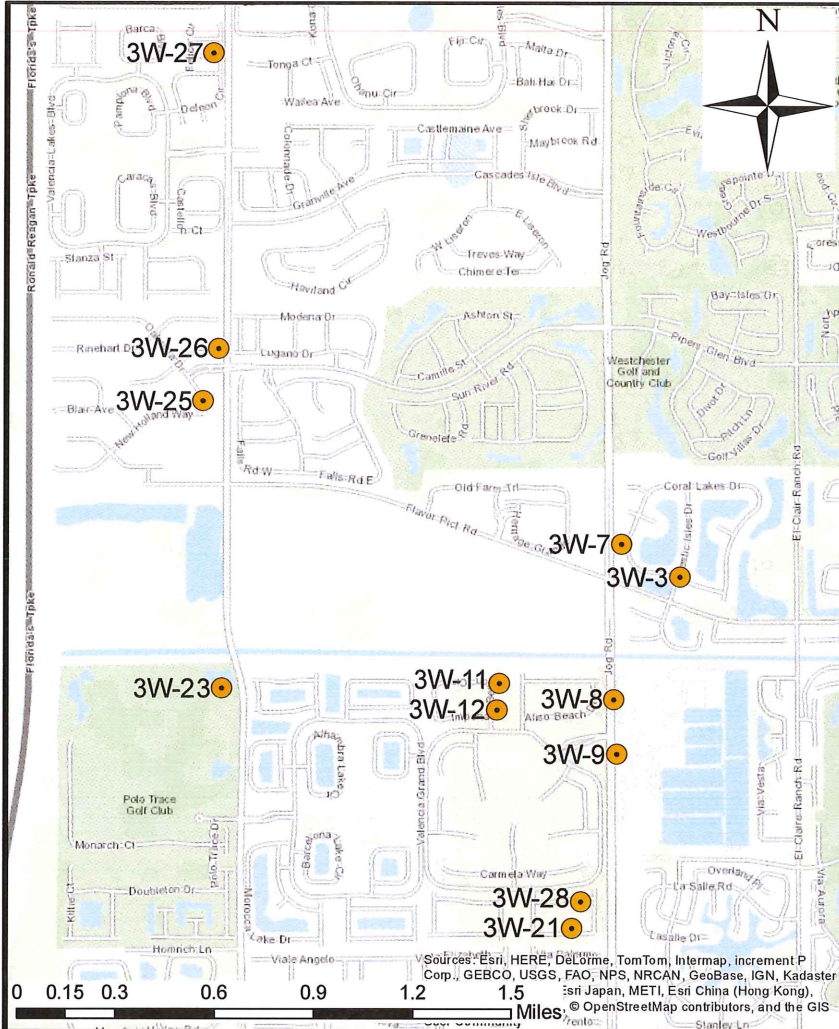

SYSTEM 9 WELLFIELD

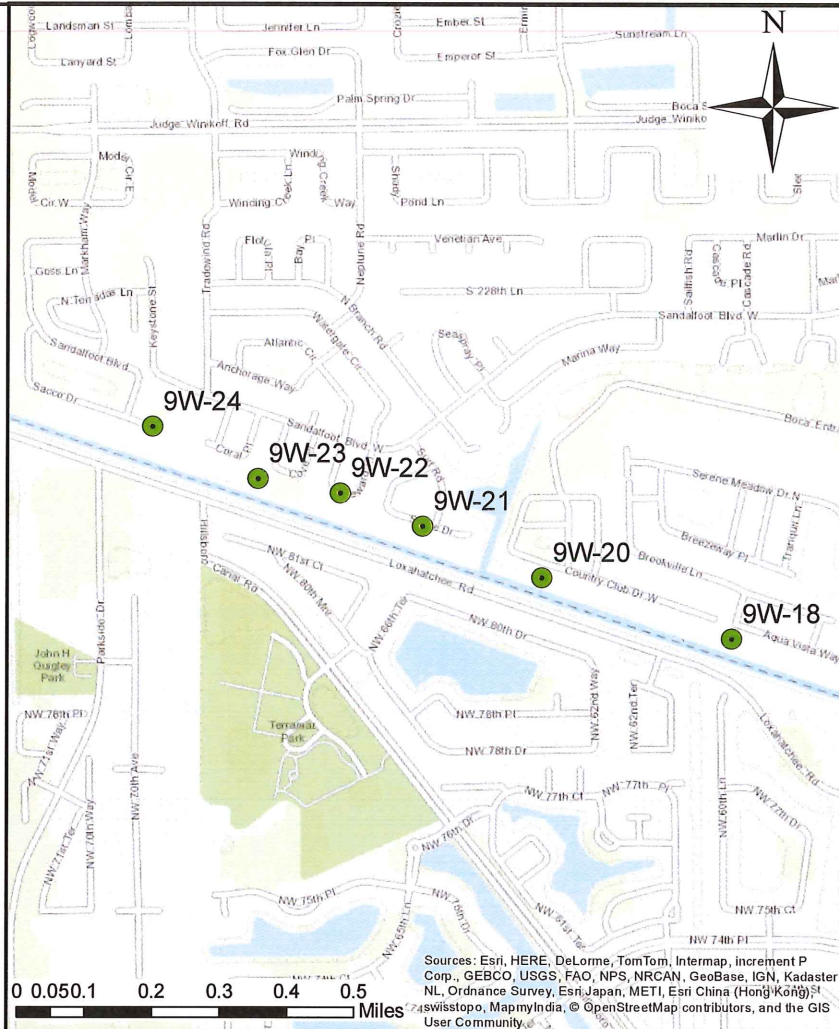

Legend

- System 9 Well Locations
- System 3 Well Locations

FIGURE TITLE:

**PALM BEACH COUNTY WATER UTILITIES DEPARTMENT
CONSULTANT SERVICES AUTHORIZATION NO. 7
WUD 15-035 SYSTEM-WIDE WELLFIELD IMPROVEMENTS**

JLA Geosciences, Inc.

DATE: 04/07/2015
DRAWN BY: RKS
PROJECT NO.: WUD 15-035

FIGURE NO.:
1

CONSULTANT SERVICES AUTHORIZATION NO. 7

Project Title System-Wide Wellfield Improvements

Project No. WUD 15-035

Budget Line Item No. 4011-721-W004-6541

District No.: 5

THIS AUTHORIZATION No. 7 to the Contract for Consulting/Professional Services dated June 3, 2014 (R2014-0822), by and between Palm Beach County and the Consultant identified herein, is for the Consultant Services described in Item 3 of this Authorization. The Contract provides for 100% SBE participation overall. This Consultant Services Authorization includes 65.99% overall participation. The cumulative SBE participation, including this authorization is 86.23% overall. Additional authorization will be utilized to meet or exceed the stated overall participation goal.

1. CONSULTANT: JLA Geosciences, Inc.
2. ADDRESS: 1931 Commerce Lane, Suite 3, Jupiter, Florida 33458
3. Description of Services to be provided by the Consultant:
This Consultant Services Authorization encompasses providing hydrogeologic consulting services to assist the County in performing System-Wide Wellfield Improvements for 2015 Capital Improvement Projects.

See ATTACHMENT A.

4. Services completed by the Consultant to date (Summary and Status of Authorizations):

See ATTACHMENT E.

5. Consultant shall begin work promptly on the requested services.
6. The compensation to be paid to the Consultant for providing the requested services shall be:
 - A. Computation of time charges plus expenses, not to exceed \$N/A
 - B. Fixed price of \$ 181,420.00
7. This Authorization may be terminated by the County without cause or prior notice. In the event of termination not the fault of the Consultant, the Consultant shall be compensated for all services performed through the date of termination, together with reimbursable expenses (if applicable) then due.

Project No. WUD 15-035 Consultant Services Authorization No. 7

Project Title System-Wide Wellfield Improvements

IN WITNESS WHEREOF, this Authorization is accepted, subject to the terms, conditions and obligations of the aforementioned Contract.

PALM BEACH COUNTY, A POLITICAL SUBDIVISION OF THE STATE OF FLORIDA

Sharon R. Bock, Clerk & Comptroller,
Palm Beach County

Palm Beach County,
Board of County Commissioners

ATTEST:

Signed: _____

Signed: _____

Shelley Vana, Mayor

Typed Name: _____
Deputy Clerk

_____ Date

JCS

Approved as to Form and Legal
Sufficiency

Signed: _____

Typed Name: _____
County Attorney

CONSULTANT: _____

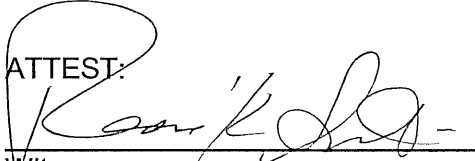
ATTEST:

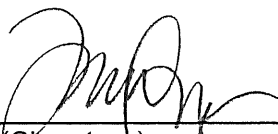
Witness

(Signature)

Rani K. Smith, Hydrogeologist
(Name and Title)

James L. Andersen, President
(Name and Title)

5/5/2015
Date

LIST OF ATTACHMENTS

Project No. WUD 15-035 Consultant Services Authorization No. 7

Project Title System-Wide Wellfield Improvements

ATTACHMENT - A	Scope of Work
ATTACHMENT - B	Budget Summary
ATTACHMENT - C	Project Schedule
ATTACHMENT - D	SBE Schedule 1 and Schedule 2
ATTACHMENT - E	Authorization Status Report - Summary and Status of Authorizations
ATTACHMENT - F	Authorization Status Report – Summary of SBE Tracking
ATTACHMENT - G	Location Map
APPENDIX A	Scope of Well Work Summary Table
FIGURE 1	Well Location Map

ATTACHMENT A

CONSULTANT SERVICES AUTHORIZATION NO. 7

PALM BEACH COUNTY WATER UTILITIES DEPARTMENT ENGINEERING/PROFESSIONAL SERVICES

SCOPE OF WORK FOR System-Wide Wellfield Improvements

INTRODUCTION

Palm Beach County (COUNTY) entered into an agreement entitled Contract for Engineering/ Professional Services - Palm Beach County Utilities Department Project No. WUD 15-035 (CONTRACT) with JLA Geosciences, Inc. (CONSULTANT) to provide engineering services for various general activities on (Reference Document R2014-0822). This Consultant Service Authorization will be performed under that CONTRACT.

This Consultant Services Authorization encompasses providing hydrogeologic consulting services to assist the County in performing System-Wide Wellfield Improvements for 2015 Capital Improvement Projects.

BACKGROUND

As part of Palm Beach County's system wide wellfield improvements, modifications to WTP 3 and WTP 9 wells are necessary in order to improve and restore performance and capacity to these wells. The Well Rehabilitation & Replacement Action Plan Report prepared by MWH in September 2014 defined a list of capital improvement projects (CIP) to be completed in 2015 and is the basis of this scope.

The CONSULTANT shall assist the COUNTY in the preparation of technical specifications and project drawings, permitting, and bidding assistance in the reconstruction and modification of eighteen (18) wells located in WTP 3 and WTP 9. This scope of work will include the design of the rehabilitation wells, wellhead assembly, pumping equipment, panels and appurtenances, hard-wired telemetry, well pads, fencing, lighting. The project will also include development of an opinion of probable cost. JLA Geosciences will provide Hydrogeologic Services with assistance from Kimley-Horn and Associates (Engineering) and Hillers Electrical Engineering (Electrical Engineering).

The individual well specific scope of rehabilitation work to be performed is outlined as Appendix A. A Well Location Map identifying individual well locations is included as Figure 1.

The CONSULTANT shall also assist the COUNTY in permit applications and modifications. Since major modifications may be required for numerous wells, such as well pump replacement, wellhead modifications requiring water quality testing and disinfection of well and wellhead piping, and possible raising of wellhead pad and/or flange to have adequate vertical separation and protection from a 100-yr flood elevation, permitting for well modifications will be required with Palm Beach County Health Department (PBCHD). It is believed that up to twelve (12) wells will require some type of permit modification with the PBCHD. The CONSULTANT shall also

coordinate with Lake Worth Drainage District in the approval of discharging of development water during project duration.

The CONSULTANT shall also provide bidding assistance to the COUNTY as indicated in the scope of services below.

SCOPE OF SERVICES

CONSULTANT shall perform the engineering Scope of Services as described herein.

TASK 1.0 Project Meetings and Review of Historical Data

- 1.1 The CONSULTANT shall review PBCWUD provided historical well construction information including well videos and well construction reports prior to preparing design specifications.
- 1.2 The CONSULTANT shall prepare for and attend up to seven (7) project meetings including one (1) kickoff meeting, three (3) design meetings (preliminary, 60%, 90%), one (1) permitting regulatory meetings, one (1) pre-bid meeting, one (1) construction kickoff meeting. Meetings shall also be attended by SUB-CONSULTANTS.
- 1.3 The CONSULTANT shall coordinate with civil and electrical engineering SUB-CONSULTANTS, provide communications with county, review and pay invoices for approved SUB-CONSULTANTS services.

TASK 2.0 Design Phase Services

- 2.1 The CONSULTANT shall prepare and submit to the COUNTY 60% design phase specifications and drawings for review. The COUNTY shall review the 60% specifications and provide comments in electronic format. The CONSULTANT shall review and respond to the COUNTY comments and utilize the agreed upon changes for the 90% design phase. The CONSULTANT shall also prepare an opinion of probable construction costs (OPC) based on current industry trends and similar type projects of this type. The 60% design phase OPC shall include costs for well construction, development costs for electrical and instrumentation, wellhead, pump, wellhead piping, valves, instrumentation, well pad and appurtenances similar to the existing wells. Specific electrical design shall include: Design of new pressure transducers for the pump discharge on each of the wells listed for rehabilitation (3W-8, 3W-9, 3W-13, and 3W-14); design of new VFD's for wells scheduled for new control panels (3W-4, 3W-7, 3W-8, 3W-9, and 3W-10); investigate wells not scheduled to have new control panels as to whether or not these panels have sufficient room within the panels to install VFD's (3W-11, 3W-12, 3W-21, 3W-23, 3W-25, 3W-26, 3W-27, and 3W-28); design to replace Motors for wells 3W-11, 3W-23, and 3W-25; and design to replace flow meter junction box at well 9W-18.

The CONSULTANT shall review flood maps (FIRM) and flood control elevations within the wells being modified to determine 100-yr flood elevations for each wellsite and adjust pad and/or wellhead flange and piping to accommodate vertical separation required by FAC 62-532 Water Well Permitting and Construction Requirements.

The CONSULTANT shall conduct site surveys by a registered land surveyor to confirm existing pad and surrounding wellsite elevations.

- 2.2 The CONSULTANT shall prepare and submit to the COUNTY 90% design phase specifications and drawings for review. The COUNTY shall review the 90%

specifications and provide comments in electronic format. The CONSULTANT shall review and respond to the COUNTY comments and utilize the agreed upon changes for the final design phase. The 90% design phase OPC shall include costs for well construction, development costs for electrical and instrumentation, wellhead, pump, wellhead piping, valves, instrumentation, well pad and appurtenances similar to the existing wells.

- 2.3 The CONSULTANT shall prepare and submit to the COUNTY final design phase specifications and signed and sealed project drawings. The CONSULTANT shall also finalize the opinion of probable construction costs (OPC) including costs for well construction, development costs for electrical and instrumentation, wellhead, pump, wellhead piping, valves, instrumentation, well pad and appurtenances similar to the existing wells.
- 2.4 The CONSULTANT shall coordinate with civil and electrical engineering SUB-CONSULTANTS, provide communications with county, review and pay invoices for approved SUB-CONSULTANTS services.

TASK 3.0 Permitting Assistance

- 3.1 The CONSULTANT shall prepare documents and permit applications (FAC 62-555.900(1) for each individual well and submit to PBCHRS. The CONSULTANT will assemble and coordinate application package with JLA Geosciences and Hillers Electrical for submission to PBCHRS. The CONSULTANT will provide up to eight (8) signed/sealed copies of drawings and specifications. The CONSULTANT shall respond to reasonable requests for additional information from PBCHD.
- 3.2 The CONSULTANT shall communicate with Lake Worth Drainage District to coordinate discharge of development water.
- 3.3 The CONSULTANT shall coordinate with civil and electrical engineering SUB-CONSULTANTS, provide communications with county, review and pay invoices for approved SUB-CONSULTANTS services.

TASK 4.0 Bidding Assistance

- 4.1 The CONSULTANT will assist the COUNTY with the bidding and award of the construction contract for the project. The CONSULTANT shall provide written responses to contractor requests for information (RFIs). The CONSULTANT shall review submitted contractor bids and prepare a written award recommendation to the COUNTY.
- 4.2 The CONSULTANT shall coordinate with civil and electrical engineering SUB-CONSULTANTS, provide communications with county, review and pay invoices for approved SUB-CONSULTANTS services.

ASSUMPTIONS AND CLARIFICATIONS

Raw water main exists to the well site locations. Only tie-in is required.

Any temporary or permanent construction easements or easement agreements necessary for access to or construction of the work will be provided by the COUNTY. This scope of work does not include assistance with property or easements acquisition, including boundary surveys, Ownership and Encumbrances (O&E) Investigations, appraisals, or land negotiations.

All new wells will be installed at above-grade and landscaping shall not be required.

Electronic files exchanged between the COUNTY and the CONSULTANT will be in a format compatible with MS Office 2007, Adobe Acrobat, and AutoCAD.

The COUNTY shall provide COUNTY standard engineering details to the CONSULTANT. A copy of available record drawings, in CAD format, depicting the layout, construction and details of the existing wellfield, will be furnished by the COUNTY for the CONSULTANT's use in preparing the contract documents.

If different than existing well pumps, hydraulic modeling and pump hydraulic selection will be performed by the COUNTY.

This CSA does not include Construction phase services and final certifications

All permit application fees shall be paid for by the COUNTY.

DELIVERABLES

60% Design Specifications and OPC – Seven (7) sets of Project Specifications, six (6) sets of full size drawings, one (1) set of half size drawing.

90% Design Specifications and OPC – Seven (7) sets of Project Specifications, six (6) sets of full size drawings, one (1) set of half size drawing.

Final Design Phase - Seven (7) sets of Project Specifications, six (6) sets of signed and sealed full size drawings, one (1) set of signed and sealed half size drawing.

Permitting - Up to eight (8) sets of signed/sealed copies of drawings and specifications.

COMPENSATION

The County shall pay CONSULTANT on time charges for providing the services described in this scope of work not to exceed \$181,420.00 in accordance with Attachment B. Such fee shall be invoiced and paid for under the terms of the CONTRACT by a Fixed Price Method of Payment.

SBE PARTICIPATION

SBE participation is included in the **ATTACHMENT F** under this authorization. The attached Schedule 1 defines the SBE applied to this CSA/Contract and Schedule 2 establishes the SBE contribution from each subcontractor (Letter of Intend to perform as an SBE).

ATTACHMENT - B

BUDGET SUMMARY

Task Number	Task Description	Labor Classification and Hourly Rate											TASK TOTAL			
		Prin. Hydro	Prof. Geol	Senior Hydro II	Senior Hydro I	Geol / Hydro II	Geol / Hydro I	Geol Tech	Admin	Total Labor	Mileage (\$0.56/mi)	ODC		Sub Consultant Services		
1.0	Project Meetings and Review of Historical Data															
1.1	Review of historical well capacity data, well videos, as built drawings (provided by PBCWUD)	12		16												
1.2	Prepare for and attend up to seven (7) meetings including one (1) pre-bid meeting, one (1) kickoff meeting, three (3) design meetings, two (2) permitting regulatory meetings	35		42								\$ 204.20				
1.3	Sub-consultant coordination and communication	8														
	Sub-contractor - Kimley Horn and Associates															\$ 9,500.00
	Sub-contractor - Hillers Electrical Engineering															\$ 3,068.00
	Subtotal Task 1	55	0	58	0	0	0	0	0	0	113	\$ 204.20	\$ -	\$ 12,568.00	\$ 29,677.20	
2.0	Design Phase Services															
2.1	60% Design including 60% project drawings	16	8	30												
	Prepare Opinion of Probable Cost	8	6	16												
2.2	90% Design including 90% project drawings	12	20	24												
2.3	Final Design including Final project drawings	6	12	20												
	Finalize Opinion of Probable Cost	4		8												
	Production Costs (including well video production)								12				\$ 1,000.00			
2.4	Sub-consultant coordination and communication	16	12	24												
	Sub-contractor - Kimley Horn and Associates															\$ 33,200.00
	Sub-contractor - Hillers Electrical Engineering															\$ 45,016.40
	Subtotal Task 2	62	58	122	0	0	0	0	12	254	\$ -	\$ 1,000.00	\$ 78,216.40	\$ 115,336.40		
3.0	Permitting Assistance															
3.1	PBCHD Permitting	12		6												
3.2	Communications with Lake Worth Drainage District	6		4												
3.3	Sub-consultant coordination and communication	10														
	Sub-contractor - Kimley Horn and Associates															\$ 12,500.00
	Sub-contractor - Hillers Electrical Engineering															\$ 4,050.80
	Subtotal Task 3	28	0	10	0	0	0	0	0	38	\$ -	\$ -	\$ 16,550.80	\$ 22,520.80		
4.0	Bidding Assistance															
4.1	Respond to Contractor Requests for Additional Information	6		2												
4.2	Assist PBC to review bids and provide award recommendation	6		2												
4.3	Sub-consultant coordination and communication	6														
	Sub-contractor - Kimley Horn and Associates															\$ 6,500.00
	Sub-contractor - Hillers Electrical Engineering															\$ 2,875.60
	Subtotal Task 4	18		4	0	0	0	0	0	0	\$ -	\$ 1,000.00	\$ 9,375.60	\$ 13,885.60		
	Labor Subtotal Hours	163	58	194	0	0	0	0	12							
	Labor Hourly Billing Rates	\$ 165.00	\$ 150.00	\$ 135.00	\$ 120.00	\$ 100.00	\$ 80.00	\$ 60.00	\$ 60.00							
	Labor Raw Costs	\$ 58.83	\$ 53.57	\$ 48.21	\$ 42.86	\$ 35.71	\$ 28.57	\$ 21.43	\$ 21.43							
	Labor Multiplier	2.8	2.8	2.8	2.8	2.8	2.8	2.8	2.8							
	Labor Sub Total	\$ 26,895.00	\$ 8,700.00	\$ 26,190.00	\$ -	\$ -	\$ -	\$ -	\$ 720.00							
	Labor Total															\$62,505.00
	Mileage/ODC															\$2,204.20
	Subconsultant Total															\$116,710.80
	Project Total															\$181,420.00

ATTACHMENT - C

PROJECT SCHEDULE

The completion dates for this work will be as follows (starting from CONSULTANT'S receipt of Notice-to-Proceed).

<u>Engineering Services</u>	<u>Completion Date</u> <u>From Notice to Proceed</u>
Task 1.0 – Meetings	As Required
Task 2.1 – 60% Design Phase*	8 weeks from NTP
PBCWUD review and review meeting	10 weeks from NTP
Task 2.2 – 90% Design Phase*	14 weeks from NTP
PBCWUD review and review meeting	16 weeks from NTP
Task 2.3 – Final Design Phase	18 weeks from NTP
PBCWUD review and review meeting	20 weeks from NTP
Task 3.0 – Permitting^	4-6 weeks from Task 2.3 Completion
Task 4.0 – Bidding	8 weeks from Task 3 Completion

**Project Schedule assumes 2 week review period for PBCWUD design comments from receipt of deliverables.*

^Permitting Schedule is estimated, however, is subject to regulatory review and turnaround times.

ATTACHMENT D

SCHEDULE #1

LIST OF PROPOSED SBE-M/WBE PRIME/SUBCONSULTANTS

PROJECT NAME: System-Wide Wellfield Improvements PROJECT NUMBER: 15-035

NAME OF PRIME BIDDER: JLA Geosciences, Inc ADDRESS: 1931 Commerce Lane, Suite 3, Jupiter Florida 33458

CONTACT PERSON: James L. Andersen, P.G. PHONE NO. 561 746-0228 FAX NO. 561 746-0119

BID OPENING DATE: _____ DEPARTMENT Water Utilities Department

PLEASE IDENTIFY ALL APPLICABLE CATEGORIES

Name, Address and Telephone Number of Minority Consultant	(Check one or both Categories)		Dollar Amount					
	Minority Business	Small Business	Black	Hispanic	Women	Caucasian	Other (Please Specify)	
JLA Geosciences, Inc 1931 Commerce Ln, Ste 3, Jupiter FL 33458 (561) 746-0228	<input type="checkbox"/>	<input checked="" type="checkbox"/>	\$	\$	\$	\$ 64,709.20	\$	
Hillers Electrical Engineering, Inc. 23257 State Road 7, Suite 100, Boca Raton, FL 33428	<input type="checkbox"/>	<input checked="" type="checkbox"/>	\$	\$ 55,010.80	\$	\$	\$	
	<input type="checkbox"/>	<input type="checkbox"/>	\$	\$	\$	\$	\$	
	<input type="checkbox"/>	<input type="checkbox"/>	\$	\$	\$	\$	\$	
	<input type="checkbox"/>	<input type="checkbox"/>	\$	\$	\$	\$	\$	
PRIME CONSULTANT TO COMPLETE:		TOTAL	\$	\$ -	\$ 55,010.80	\$ -	\$ 64,709.20	\$ -
BID PRICE: <u>\$181,420.00</u>		Total Value of SBE Participation:	<u>\$ 119,720.00</u>					

- NOTE:
1. The amount listed on this form for a Subconsultant must be supported by price or percentage included on Schedule 2 or a proposal from each Subconsultant listed in order to be counted toward goal attainment.
 2. Firms may be certified by Palm Beach County as an SBE and/or an M/WBE. If firms are certified as both an SBE and M/WBE, please indicate the dollar amount under the appropriate category.
 3. M/WBE information is being collected for tracking purposes only.

ATTACHMENT D

SCHEDULE 2

LETTER OF INTENT TO PERFORM AS AN SBE OR M/WBE SUBCONSULTANT

PROJECT NO. 15-035 PROJECT NAME: System-Wide Wellfield Improvements

TO: JLA Geosciences, Inc.
(Name of Prime Bidder)

The undersigned is certified by Palm Beach County as a(n) – (check one or more, as applicable):

Small Business Enterprise Minority Business Enterprise

Black Hispanic Women Caucasian Other (Please Specify) _____

Date of Palm Beach County Certification: _____

The undersigned is prepared to perform the following described work in connection with the above project
(Specify in detail, particular work items or parts thereof to be performed):

Line Item/Lot No.	Item Description	Qty / Units	Unit Price	Total Price
<u>1.0</u>	<u>Meetings and Review Data</u>	<u>1 L.S</u>	<u>\$17,109.20</u>	<u>\$17,109.20</u>
<u>2.0</u>	<u>Design Phase Services</u>	<u>1 L.S</u>	<u>\$37,120.00</u>	<u>\$37,120.00</u>
<u>3.0</u>	<u>Permitting Assistance</u>	<u>1 L.S</u>	<u>\$5,970.00</u>	<u>\$5,970.00</u>
<u>4.0</u>	<u>Bidding Assistance</u>	<u>1 L.S</u>	<u>\$4,510.00</u>	<u>\$4,510.00</u>

Hydrogeological Services for System-Wide Wellfield Improvements

at the following price
\$ \$64,709.20
(Subconsultant's Quote)

And will enter into a formal agreement for work with you conditioned upon your execution of a contract with Palm Beach County. If undersigned intends to sub-subcontract any portion of this subcontract to a non-certified SBE subconsultant, the amount of any such subcontract must be stated:
\$ _____

The undersigned subcontractor understands that the provision of this form to prime bidder does not prevent subcontractor from providing quotations to other bidders.

JLA Geosciences, Inc.
(Print Name of SBE-M/WBE Subconsultant)

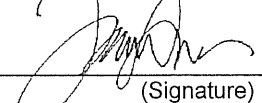
By: 
(Signature)

James L. Andersen, President
(Print name/title of person executing on behalf of SBE-M/WBE Subconsultant)

Date: 05/05/2015

ATTACHMENT D

SCHEDULE 2

LETTER OF INTENT TO PERFORM AS AN SBE OR M/WBE SUBCONSULTANT

PROJECT NO. 15-035 PROJECT NAME: System-Wide Wellfield Improvements

TO: JLA Geosciences, Inc.
(Name of Prime Bidder)

The undersigned is certified by Palm Beach County as a(n) – (check one or more, as applicable):

Small Business Enterprise Minority Business Enterprise

Black Hispanic Women Caucasian Other (Please Specify)

Date of Palm Beach County Certification: _____

The undersigned is prepared to perform the following described work in connection with the above project
(Specify in detail, particular work items or parts thereof to be performed):

Line Item/Lot No.	Item Description	Qty / Units	Unit Price	Total Price
<u>1.0</u>	<u>Meetings and Review Data</u>	<u>1 L.S</u>	<u>\$ 3,068.00</u>	<u>\$ 3,068.00</u>
<u>2.0</u>	<u>Design Phase Services</u>	<u>1 L.S</u>	<u>\$ 45,016.40</u>	<u>\$ 45,016.40</u>
<u>3.0</u>	<u>Permitting Assistance</u>	<u>1 L.S</u>	<u>\$ 4,050.80</u>	<u>\$ 4,050.80</u>
<u>4.0</u>	<u>Bidding Assistance</u>	<u>1 L.S</u>	<u>\$ 2,875.60</u>	<u>\$ 2,875.60</u>

at the following price:

\$55,010.80
(Subconsultant's Quote)

And will enter into a formal agreement for work with you conditioned upon your execution of a contract with Palm Beach County. If undersigned intends to sub-subcontract any portion of this subcontract to a non-certified SBE subconsultant, the amount of any such subcontract must be stated: \$ _____

The undersigned subcontractor understands that the provision of this form to prime bidder does not prevent subcontractor from providing quotations to other bidders

Hillers Electrical Engineering, Inc.
(Print Name of SBE-M/WBE Subconsultant)

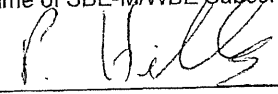
By: 
(Signature)

(Print name/title of person executing on behalf of SBE-M/WBE Subconsultant)

Date: 5/4/2015

ATTACHMENT - E

AUTHORIZATION STATUS REPORT

SUMMARY AND STATUS OF REQUESTS FOR AUTHORIZATIONS

Auth. No.	Description	Status	Project			Date	WUD No.	Consultant's
			Total Amount	SBE Total Amount	SBE Participation %	Approved	Assigned	Project No.
1	Miscellaneous Hydrogeology & Water Resources Services	Approved	\$39,980.00	\$39,980.00	100.00%	7/18/2014	14-076	TBD
2	Lake Region Wellfield Water Quality Evaluation	Approved	\$24,810.00	\$24,810.00	100.00%	7/18/2014	14-077	TBD
3	WTP 3 & 9 Well Replacement and Rehabilitation	Approved	\$219,061.00	\$210,061.00	95.89%	3/10/2015	13-080	TBD
4	WTP 11 Floridan Aquifer Production Well PW-11, Preliminary Well Design	Approved	\$36,171.00	\$25,171.00	69.59%	12/15/2014	11-101	TBD
5	WTP 11 Acid Treatment and Rehabilitation of Wells PW-1 to PW-7	Approved	\$45,722.00	\$45,722.00	100.00%	1/26/2015	15-019	TBD
6	Hydrogeologic Consulting Services to Assist in the Rehab of the Deep Injection Well at WRWWTP	Approved	\$46,240.00	\$46,240.00	100.00%	4/13/2015	13-081	TBD
7	System-Wide Wellfield Improvements	Pending	\$181,420.00	\$119,720.00	65.99%		15-035	
	Total		\$593,404					

ATTACHMENT - F

AUTHORIZATION STATUS REPORT

SUMMARY OF SBE / MINORITY BUSINESS TRACKING

	Total	SBE
Current Proposal		
Value of Authorization No. 7	\$181,420.00	\$181,420.00
Value of SBE Letters of Intent	\$119,720.00	\$119,720.00
Actual Percentage	65.99%	65.99%
Signed/Approved Authorizations		
Total Value of Authorizations	\$411,984.00	\$411,984.00
Total Value of SBE Signed Subcontracts	\$391,984.00	\$391,984.00
Actual Percentage	95.15%	95.15%
Signed/Approved Authorizations Plus Current Proposal		
Total Value of Authorizations	\$593,404.00	\$593,404.00
Total Value of Subcontracts & Letters of Intent	\$511,704.00	\$511,704.00
Actual Percentage	86.23%	86.23%
GOAL	<i>66%</i>	<i>66%</i>

ATTACHMENT G



Palm Beach County Water Utilities Department Service Area (SA) and Major Facilities

Legend

- ☆ Administration
- WTP Water Treatment Plant
- RWF Reclamation Facility
- WWRWF Wastewater Reclamation Facility
- WWT Wastewater Treatment Plant
- Mandatory Reclaimed SA
- - - Palm Beach County Limits
- P.B.C.W.U.D. Service Area



NOT TO SCALE

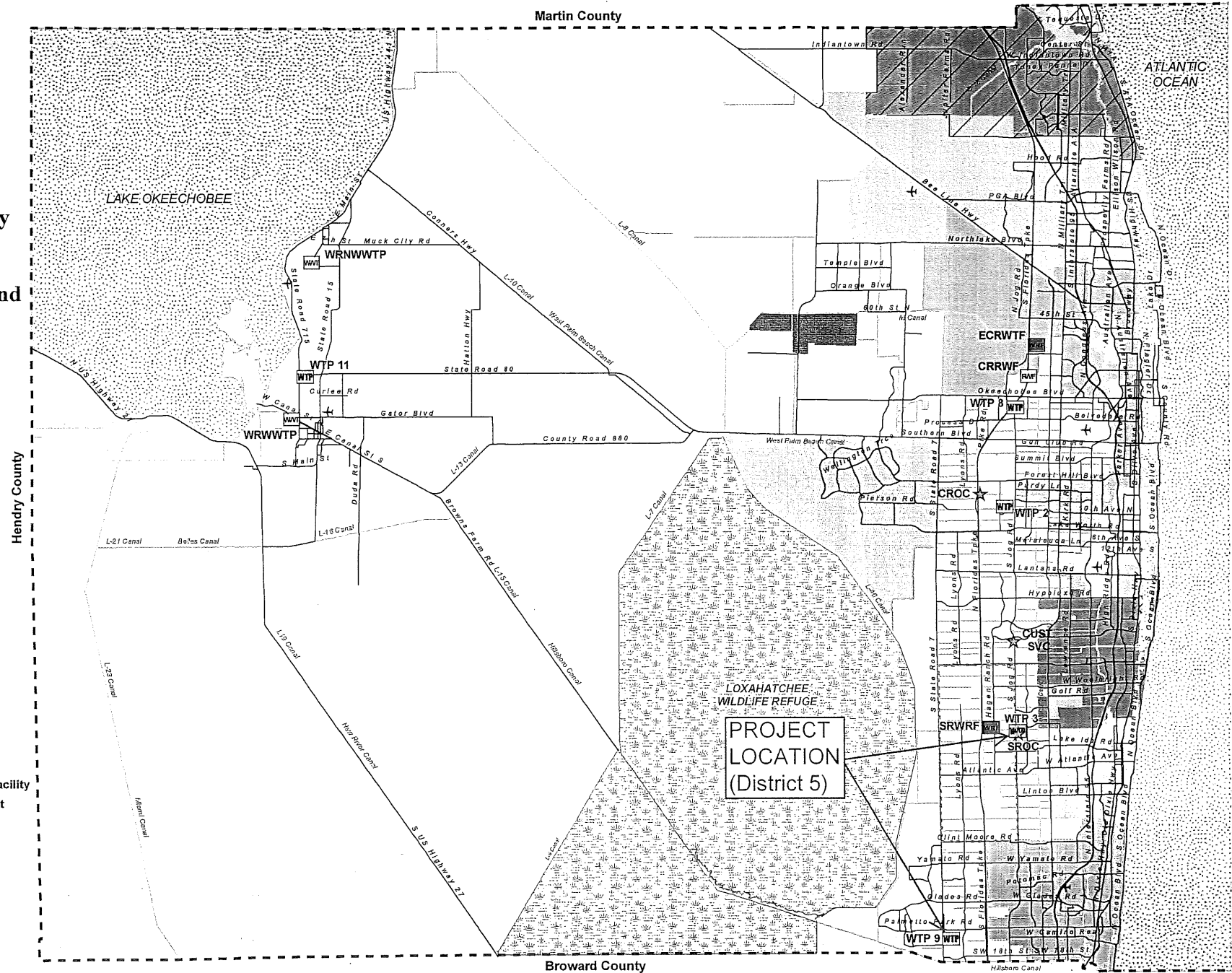

CSA#7 WUD 15-035

APPENDIX A

Water Treatment Plant 3

Well	Scope of Work*
3W-4	Replace control panel
3W-7	Replace control panel
3W-8	Replace control panel
3W-9	Replace control panel
3W-11	Acidize and Develop. Pending results, Replace Screen and Gravel Pack
	Replace pump and motor
	Replace air release valve
3W-12	Acidize and Develop. Pending results, Replace Screen and Gravel Pack
	Replace pressure gauge
3W-21	Acidize and Develop, inspect valve pressure and correct, install casing vent
3W-23	Replace pump and motor
	Acidize and Develop, install casing vent
	Secure testing ports
3W-25	Acidize and Develop, install casing vent
	Replace pump and motor
3W-26	Acidize and Develop, inspect check valve pressure and correct, install casing vent
	Replace air release valve
3W-27	Replace check valve
	Acidize and Develop, install casing vent
3W-28	Acidize and Develop, inspect check valve pressure and correct, install casing vent

*Provided by MWH Well Rehabilitation and Replacement Action Plan Report

Water Treatment Plant 9

Well	Scope of Work*
9W-18	Acidize and Develop. Pending results, Replace Screen and Gravel Pack
	Repair discharge pipe
	Casing flange replacement
	Replace flow meter junction box
9W-20	Replace Screen and Gravel Pack
9W-21	Replace Screen and Gravel Pack
9W-22	Replace Screen and Gravel Pack
9W-23	Replace Screen and Gravel Pack
9W-24	Replace Screen and Gravel Pack
	Replace pipe supports
	Casing flange replacement

**Provided by MWH Well Rehabilitation and Replacement Action Plan Report

SYSTEM 3 WELLFIELD

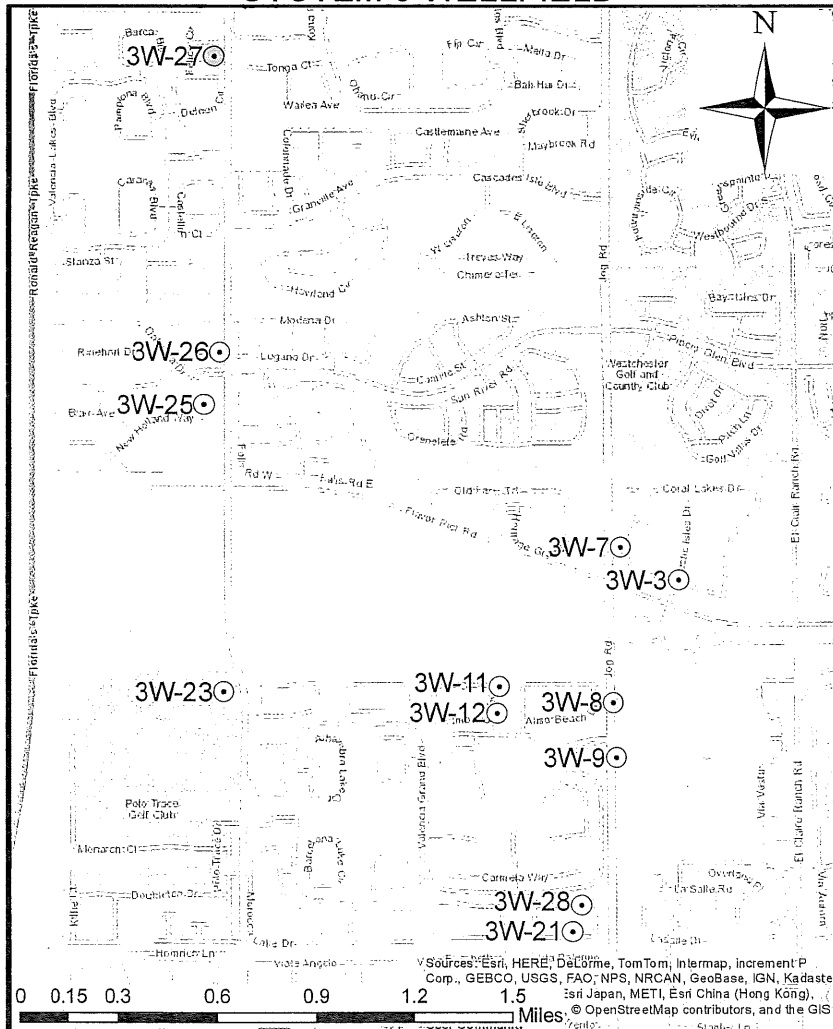

SYSTEM 9 WELLFIELD

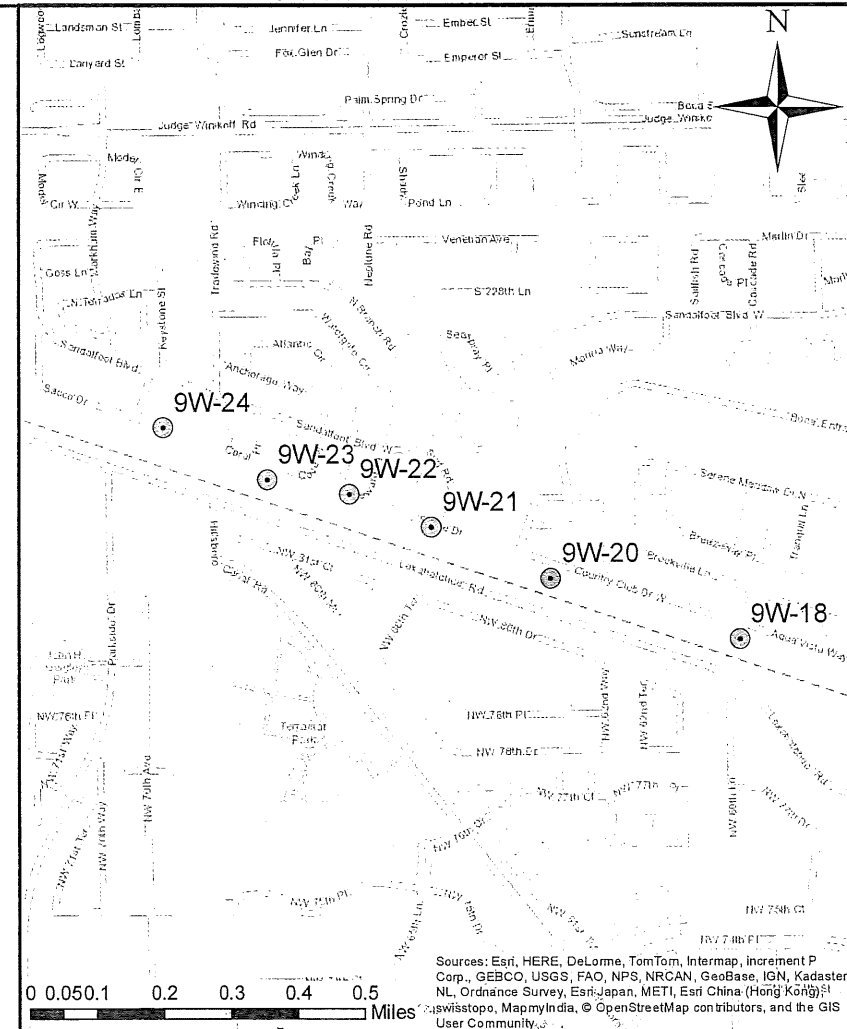

- Legend**
- System 9 Well Locations
 - System 3 Well Locations

<p>FIGURE TITLE:</p> <h2 style="text-align: center;">PALM BEACH COUNTY WATER UTILITIES DEPARTMENT CONSULTANT SERVICES AUTHORIZATION NO. 7 WUD 15-035 SYSTEM-WIDE WELLFIELD IMPROVEMENTS</h2>		<p style="text-align: right;">JLA Geosciences, Inc.</p>	
DATE:	04/07/2015	FIGURE NO.:	
DRAWN BY:	RKS	1	
PROJECT NO.:	WUD 15-035		

Kimley»»Horn

April 29, 2015

Mr. Jim Andersen, P.G.
JLA Geosciences, Inc.
1931 Commerce Lane, Suite 3
Jupiter, FL 33458

**RE: Work Authorization #7
Palm Beach County Water Utilities Department
WTP 3 & WTP 9 Well Design and Bidding Phase Services
System-Wide Wellfield Improvements
WUD 15-035**

Dear Mr. Andersen:

We are pleased to provide this proposal for professional services for rehabilitation of Palm Beach County Water Utilities Department wells for Water Plant #3 and #9. As part of Palm Beach County's system wide wellfield improvements, modifications to WTP 3 and WTP 9 wells are necessary in order to improve and restore performance and capacity to these wells. The Well Rehabilitation & Replacement Action Plan Report prepared by MWH in September 2014 defined a list of capital improvement projects (CIP) to be completed in 2015 and is the basis of this scope. The Report identified up to 18 wells to rehabilitate and is included as attachment #1.

SCOPE OF SERVICES

CONSULTANT (Kimley-Horn and Associates) shall perform the engineering Scope of Services as described herein.

Task 1 – Design & Preparation of Documents

Consultant will review documents and reports on existing wells. Consultant will collect and review record drawings, furnished by PBCWUD and in electronic form, and use these as basefiles for the design drawings.

Consultant will prepare up to 24 drawings to include wellhead plans, details, and modifications. Consultant will prepare technical specifications for wellhead modifications and pump replacement.

Consultant will prepare 60% and 90% review documents (drawings and specifications) for PBCWUD review. Review comments from PBCWUD and team (JLA & Hillers) will be incorporated into the final set of documents.

kimley-horn.com

1920 Wekiva Way Suite 200 West Palm Beach, FL 33411

561-845-0665

Consultant will provide design of mechanical improvements listed on the MWH report CIP 2015, consisting of air release valve replacement, pressure gages, check valves, wellhead flange and discharge piping, and pipe supports. Detail drawings and specifications will be prepared and based on PBCWUD standards.

Consultant will review flood maps (FIRM) and flood control elevations within the wells being modified to determine 100-yr flood elevations for each wellsite and adjust pad and/or wellhead flange and piping to accommodate vertical separation required by FAC 62-532 **WATER WELL PERMITTING AND CONSTRUCTION REQUIREMENTS**.

Consultant will conduct site surveys by a registered land surveyor to confirm existing pad and surrounding wellsite elevations.

Consultant will provide up to eight (8) hard copies of signed & sealed drawings and specifications, and electronic (pdf and CADD) files.

Consultant will prepare an opinion of probable construction costs based on the final drawings and specifications.

Task 2 – PBCHRS Permitting

Since major modifications may be required for numerous wells, such as well pump replacement, wellhead modifications requiring water quality testing and disinfection of well and wellhead piping, and possible raising of wellhead pad and/or flange to have adequate vertical separation and protection from a 100-yr flood elevation, permitting for well modifications will be required with Palm Beach County Health Department (PBCHRS). It is believed that up to twelve (12) wells will require some type of permit modification with the PBCHRS.

Consultant will prepare documents and permit applications (FAC 62-555.900(1) for each individual well and submit to PBCHRS. Consultant will assemble and coordinate application package with JLA Geosciences and Hillers Electrical for submission to PBCHRS. Consultant will provide up to eight (8) signed/sealed copies of drawings and specifications.

Consultant will respond to reasonable requests for additional information from PBCHRS.

Task 3 - Meetings

Consultant will attend meetings as requested. It is anticipated that a total of up to seven (7) meetings will be attended, consisting of kick-off, preliminary design meeting, 60% and 90% review meeting, final design meeting, and bidding meetings.

Consultant will provide bullet meeting minute items to be formalized by JLA.

Task 4 - Bidding Phase Services

Consultant will provide bidding phase services, consisting of preparation of technical bidding documents (drawings and specifications), providing responses to contractor questions, preparation of addendums, if required, which will be distributed to all the contract document holders. Consultant will provide up to twelve (12) copies of drawings and specifications for bidding.

The Consultant will attend one (1) pre-bid meeting at the project site or Owner's office. It is assumed that PBCWUD purchasing department will monitor the bid process and sell project manuals, consisting of drawings, specifications, and all addendums.

Consultant will provide signed & sealed drawings for building department permit applications to be submitted by the awarded contractor.

Consultant will assist JLA and PBCWUD in review of bids and provide award recommendation.

PROJECT SCHEDULE

The completion dates for this work will be as follows (starting from CONSULTANT'S receipt of Notice-to-Proceed).

<u>Engineering Services</u>	<u>Completion Date</u>
Task 1 – Design & Preparation of Documents	8 weeks from NTP
Task 2 – Permitting	4 - 6 weeks after Task 1
Task 3 – Meetings	As Required
Task 4 – Bidding	8 weeks after Task 2

ITEMS PROVIDED BY OTHERS

1. Copies of Design drawings in electronic form.
2. Documents furnished by PBCWUD.

ITEMS NOT INCLUDED

1. Construction phase services and final certifications
2. Permit application fees by others.

Compensation

The services included in this proposal are intended to be lump sum basis with each of the following tasks with a total value of \$61,700.

Task No.	Task	Task Fee
1	Design & Prepare drawings/specifications	\$ 33,200
2	PBCHRS Permitting	\$12,500
3	Meetings	\$9,500
4	Bidding Phase Services	\$6,500
	Total Lump Sum Fee =	\$61,700

Sincerely,



Mark D. Miller, P.E.
Vice President

ATTACHMENT - B									
BUDGET SUMMARY									
Labor Classification and Hourly Rate									
Task	Principal	Senior	Project	Analyst/	Sub				
Number	Task Description	Pr. Engineer	Engineer	Designer	Intern Engineer	Snr Support Staff	Total	Consultant	
							Labor	Services	
1	Design & Preparation of Documents								
	Collect and review data, reports, asbuilts		8	12	12	5	9	\$5,355	
	Prepare 60% dwgs/specs (24 dwgs)		8	30	93	6		\$15,048	
	Prepare 90% dwgs/specs (24)	2	9	26	54			\$10,890	
	Flood map review, establish 100yr FL ELEV			6	6		3	\$1,584	
	Exp							\$323	
	Subtotal Task 1	2	25	74	165	11	12	\$33,200	\$0
2	Permitting								
	Prepare & submit documents		10	18	8		12	\$5,970	
	Respond to RAI's		14	16	8		11	\$6,426	
	Exp							\$104	
		0	24	34	16	0	23	\$12,500	\$0
3	Meetings								
	Attend meetings		16	14			6	\$5,454	
	Prepare mtg min bullets		10	12			6	\$3,996	
	Exp							\$50	
		0	26	26	0	0	12	\$9,500	\$0
4	Bidding								
	Prepare tech docs		2	10			15	\$2,736	
	Respond to contractor questions		4	6			6	\$1,998	
	Review bids & recommendation		4	5			4	\$1,731	
	Exp							\$35	
		0	10	21	0	0	25	\$6,500	\$0
	Labor Subtotal Hours	2	85	155	181	11	72		506
	Labor Raw Costs	\$69.00	\$66.00	\$45.00	\$32.00	\$27.00	\$22.00		
	Labor Multiplier	3.0	3.0	3.0	3.0	3.0	3.0		
	Labor SubTotal	207.00	198.00	135.00	96.00	81.00	66.00		
	Labor Total	\$414.00	\$16,830.00	\$20,925.00	\$17,376.00	\$891.00	\$4,752.00	61,188	
								61,700	
	Subconsultant Labor Total	\$	-						\$0
	Subconsultant Multiplier								1.1
	Subcontract Total	\$	-						\$0
	Out of Pocket Expenses (mileage, copies, printing, etc)								\$512
	Project Total								\$61,700

H E E

HILLERS ELECTRICAL ENGINEERING, INC.

May 4, 2015

Jim Andersen, P.G.
JLA Geosciences, Inc.
1931 Commerce Lane, Suite 3
Jupiter, FL 33458

Subject: System-Wide Wellfield Improvements (PBC project number: WUD 15-035)

Dear Jim:

Hillers Electrical Engineering, Inc. (HEE) is pleased to provide JLA Geosciences, Inc. (JLA) a proposal for the 60%, 90% and final electrical design services associated with the above referenced project. The scope of services is as follows:

Design Services

- Design new pressure transducers for the pump discharge on each of the wells listed for rehabilitation (3W-8, 3W-9, 3W-13, and 3W-14).
- Design new VFD's for wells 3W-4, 3W-7, 3W-8, 3W-9, and 3W-10.
- Investigate wells not scheduled to have new control panels as to whether or not these panels have sufficient room within the panels to install VFD's (3W-11, 3W-12, 3W-21, 3W-23, 3W-25, 3W-26, 3W-27, and 3W-28).
- Design to replace Motors for wells 3W-11, 3W-23, and 3W-25
- Design to replace flow meter junction box at well 9W-18
- Meeting and Review Data
- Permitting assistance, including signing and sealing permit sets
- Bidding Assistance

Assumptions:

- (1) The horsepower for wells 3W-11, 3W-23 and 3W-25 will not increase.
- (2) All background Autocad drawings will be provided by JLA.

Please find attached our proposed drawing list.

Our proposed preliminary Design Service fee is \$55,010.80. If you have any questions, please do not hesitate to call me.

Sincerely,

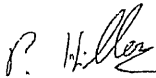

Paul Hillers
JL04

ATTACHMENT - B

BUDGET SUMMARY

Task Number	Task Description	Labor Classification and Hourly Rate					Total Labor	Sub Consultant Services
		Project Manager	Project Engineer	Engineer	Construction Coordinator	Secretarial		
		1	Meetings and Review Data	5	15			
2	Design Phase Services	80	211				\$45,016.40	
3	Permitting Assistance	5	22				\$4,050.80	
3	Bidding Assistance	4	15				\$2,875.60	
	Subtotal Task 1	94	263	0	0	0	\$55,010.80	
							0	
							0	
							0	
	Labor Subtotal Hours	94	263	0	0	0	357	
	Labor Raw Costs	\$74	\$54	\$40	\$40	\$22		
	Labor Multiplier	2.6	2.6	2.6	2.6	2.6		
	Labor SubTotal	\$ -	\$ -	\$ -	\$ -	\$ -		
	Labor Total	\$ 18,085.60	\$ 36,925.20	\$ -	\$ -	\$ -	\$ 55,010.80	
	Subconsultant Labor (ACI)							\$0.00
	Subcontract Total							\$0.00
	Project Total						\$ 55,010.80	

H E E

HILLERS ELECTRICAL ENGINEERING, INC.

PROPOSED DRAWING LIST

- E-1 ELECTRICAL LEGEND AND SYMBOLS
 - E-2 ELECTRICAL GENERAL NOTES
 - E-3 WTP-3 WELLS ELECTRICAL SITE PLAN
 - E-4 WTP-9 WELLS ELECTRICAL SITE PLAN
 - E-5 WELL 3W-4 CONTROL PANEL – DEMOLITION
 - E-6 WELL 3W-7 CONTROL PANEL – DEMOLITION
 - E-7 WELL 3W-8 CONTROL PANEL – DEMOLITION
 - E-8 WELL 3W-9 CONTROL PANEL – DEMOLITION
 - E-9 WELL 3W-10 CONTROL PANEL – DEMOLITION
 - E-10 WELLS 3W-11, 3W-23, 3W-25 MOTOR – DEMOLITION
 - E-11 WELL 9W-18 JUNCTION BOX - DEMOLITION
 - E-12 WELL 3W-4 VFD PANEL – PROPOSED
 - E-13 WELL 3W-7 VFD PANEL – PROPOSED
 - E-14 WELL 3W-8 VFD PANEL – PROPOSED
 - E-15 WELL 3W-9 VFD PANEL – PROPOSED
 - E-16 WELL 3W-10 VFD PANEL – PROPOSED
 - E-17 WELLS 3W-11, 3W-23, 3W-25 MOTOR – PROPOSED
 - E-18 WELL 9W-18 JUNCTION BOX – PROPOSED
 - E-19 WELL 3W-8 PRESSURE TRANSMITTER ADDITION
 - E-20 WELL 3W-9 PRESSURE TRANSMITTER ADDITION
 - E-21 WELL 3W-13 PRESSURE TRANSMITTER ADDITION
 - E-22 WELL 3W-14 PRESSURE TRANSMITTER ADDITION
 - E-23 ELECTRICAL RISER DIAGRAMS – SHEET 1
 - E-24 ELECTRICAL RISER DIAGRAMS – SHEET 2
 - E-25 ELECTRICAL DETAILS – SHEET 1
 - E-26 ELECTRICAL DETAILS – SHEET 2
-
- I-1 INSTRUMENTATION LEGEND AND SYMBOLS
 - I-2 P&ID - WELL 3W-4 – PROPOSED
 - I-3 P&ID - WELL 3W-7 – PROPOSED
 - I-4 P&ID - WELL 3W-8 – PROPOSED
 - I-5 P&ID - WELL 3W-9 – PROPOSED
 - I-6 P&ID - WELL 3W-10 – PROPOSED
 - I-7 P&ID - WELL 3W-13 – PROPOSED
 - I-8 P&ID - WELL 3W-14 – PROPOSED
 - I-9 INSTRUMENTATION DETAILS

H E E

HILLERS ELECTRICAL ENGINEERING, INC.