



**II. FISCAL IMPACT ANALYSIS**

**A. Five Year Summary of Fiscal Impact:**

Fiscal Years	2016	2017	2018	2019	2020
Capital Expenditures	\$1,500,000	-0-	-0-	-0-	-0-
Operating Costs	-0-	-0-	-0-	-0-	-0-
External Revenues	-0-	-0-	-0-	-0-	-0-
Program Income (County)	-0-	-0-	-0-	-0-	-0-
In-Kind Match (County)	-0-	-0-	-0-	-0-	-0-
NET FISCAL IMPACT	\$1,500,000	-0-	-0-	-0-	-0-
# ADDITIONAL FTE POSITIONS (Cumulative)					

Is Item Included in Current Budget? Yes X No

**Budget Account No:**

Fund 3500 Dept 361 Unit 1701 Object Various

**Recommended Sources of Funds/Summary of Fiscal Impact:**

Transportation Improvement Fund  
Pathway Program FY 2016

C. Departmental Fiscal Review: \_\_\_\_\_



**III. REVIEW COMMENTS**

**A. OFMB Fiscal and/or Contract Dev. and Control Comments:**

  
\_\_\_\_\_  
AD DSP OFMB 8/9/15  
9/22 9/22  
\_\_\_\_\_  
Contract Dev. and Control 9/24/15  
B Wheeler 9-24-15

**B. Approved as to Form  
and Legal Sufficiency:**

  
\_\_\_\_\_  
Assistant County Attorney 9/28/15

**C. Other Department Review:**

\_\_\_\_\_  
Department Director

This summary is not to be used as a basis for payment.

**TABLE 1  
FY 2015/2016 PROPOSED PATHWAY PROGRAM**

ATTACH #	PROJECT LOCATION	FROM > TO	ROAD SIDE	COMM DISTRICT	ESTIMATED COST	LENGTH	PATHWAY TYPE	WIDTH (FT)	ATLAS PAGE	REQUESTED BY
<b>MAJOR MAINTENANCE - EXISTING FACILITIES</b>										
N/A	EL CLAIR RANCH RD	L-29 CANAL TO L-28 CANAL	E	5	37,158	2,475	ASPHALT	8	103	R&B
N/A	GATOR BLVD	W SUGARHOUSE RD TO SR 80 (MAIN ST)	S	6	71,623	4,224	ASPHALT	6	152	R&B
N/A	KENTUCKY ST	CONGRESS AVE TO FLORIDA MANGO RD	N	2	21,624	2,160	ASPHALT	6	71	R&B
N/A	KUDZA RD	PURDY LN TO FOREST HILL BLVD	E	2	23,464	2,500	ASPHALT	6	79	R&B
N/A	LOXAHATCHEE RIVER RD	OUR ROBBIE'S RD TO EAGLES NEST DR	W	1	43,649	1,074	ASPHALT	5	6	R&B
N/A	PALM D'ORO RD	SW 18 ST TO CAMINO DEL MAR	E	4	27,644	2,300	ASPHALT	7	130	R&B
N/A	PALMETTO CIR N	PALMETTO CIR S TO FIG TREE RD	S&E	4	48,130	6,336	ASPHALT	6	122	R&B
N/A	PALMETTO PARK RD	MILITARY TR TO SW 12 AVE	S	4	74,776	6,000	ASPHALT	9	122/123	R&B
N/A	PURDY LN	HAVEN RD TO MILITARY TR	N&S	2	22,834	2,000	ASPHALT	6	80	R&B
N/A	PURDY LN	E OF MAJOR DR TO PINEWAY DR	N&S	2	25,641	1,500	ASPHALT	6	79	R&B
N/A	SANTIAGO CIR	SW 18 ST TO LAGO MAR CIR	W	4	19,400	1,755	ASPHALT	6	130	R&B
N/A	SW 8 ST	SW 54 AVE TO BOCA RIO RD	N&S	5	41,210	3,478	ASPHALT	8	129	R&B
N/A	VIA DE SONRISA DEL SUR	SW 18 ST TO SANTIAGO CIR	S&E	4	39,770	4,965	ASPHALT	6	130	R&B
<b>SUBTOTAL</b>					<b>496,923</b>					
<b>NEW CONSTRUCTION - NON- SCHOOL RELATED</b>										
1	CONGRESS AVE	CHERRY RD TO PALM TRAN BUS SHELTER #4082	W	7	49,950	595	CONCRETE	6	70	RESIDENT
2	NORTHLAKE BLVD	OSPREY ISLES BLVD TO IBIS BLVD	N	1	223,160	3,480	ASPHALT	6	31	RESIDENT
3	PALMETTO PARK RD	LYONS RD TO MIZNER WY	N	5	73,545	3,385	ASPHALT	6	121	KABBALAH
4	SANSBURYS WY	SOUTHERN BLVD TO BELVEDERE RD - MISSING LINKS	E	2	126,940	1,470	CONCRETE	6	68	TRAFFIC
<b>SUBTOTAL</b>					<b>473,595</b>					
<b>NEW CONSTRUCTION - SCHOOL RELATED</b>										
5	BAHAMA HEIGHTS / EDGEWATER PARK	COMMUNITYWIDE MISSING LINKS/TIE INS	ALL	3	97,675	1,180	CONCRETE	6	81	R&B/TRAFFIC
6	LANTANA HOMES / LEES CROSSING	COMMUNITYWIDE TIE INS	ALL	2	137,870	N/A	CONCRETE	6	89	CCRT/R&B
7	MUCK CITY RD	JOHNSON CT TO ELDORADO DR - MISSING LINK & TIE INS	S	6	33,570	330	CONCRETE	6	140	COMM
8	ROEBUCK RD	LOXAHATCHEE PINES DR TO LOXAHATCHEE RIVER RD	S	1	140,413	820	ASPHALT	6	6	RESIDENT
<b>SUBTOTAL</b>					<b>409,528</b>					
<b>MINOR MAINTENANCE AND SUPPORT</b>										
<b>TOTAL</b>					<b>\$ 1,500,000</b>					



Congress Ave  
From Cherry Rd  
To Palm Tran Bus  
Shelter #4082  
W Side/Concrete/595'  
\$49,950

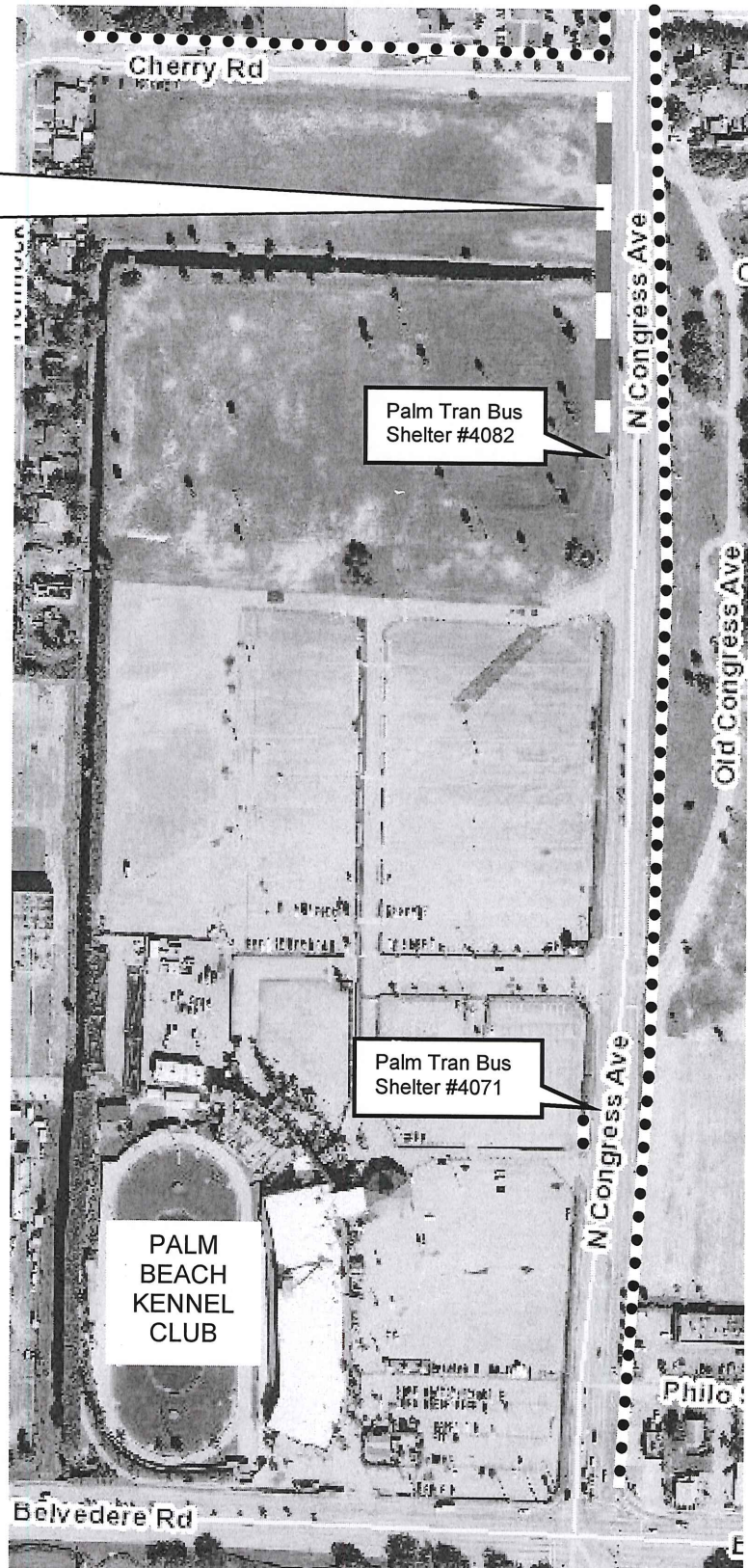

Palm Tran Bus  
Shelter #4082

Palm Tran Bus  
Shelter #4071

PALM  
BEACH  
KENNEL  
CLUB

• • • Existing sidewalk  
District 7



FY 2016 PATHWAY PROGRAM

Congress Ave.  
Location Map

ATTACH  
1

8-31-15

N:\TRAFFIC\CMW\2015\Board\BOARD FIGURES\Congress Ave LM.doc

Location Sketch



Northlake Blvd  
From Osprey Isles Blvd  
To Ibis Blvd  
N Side/Asphalt/3,480'  
\$223,160

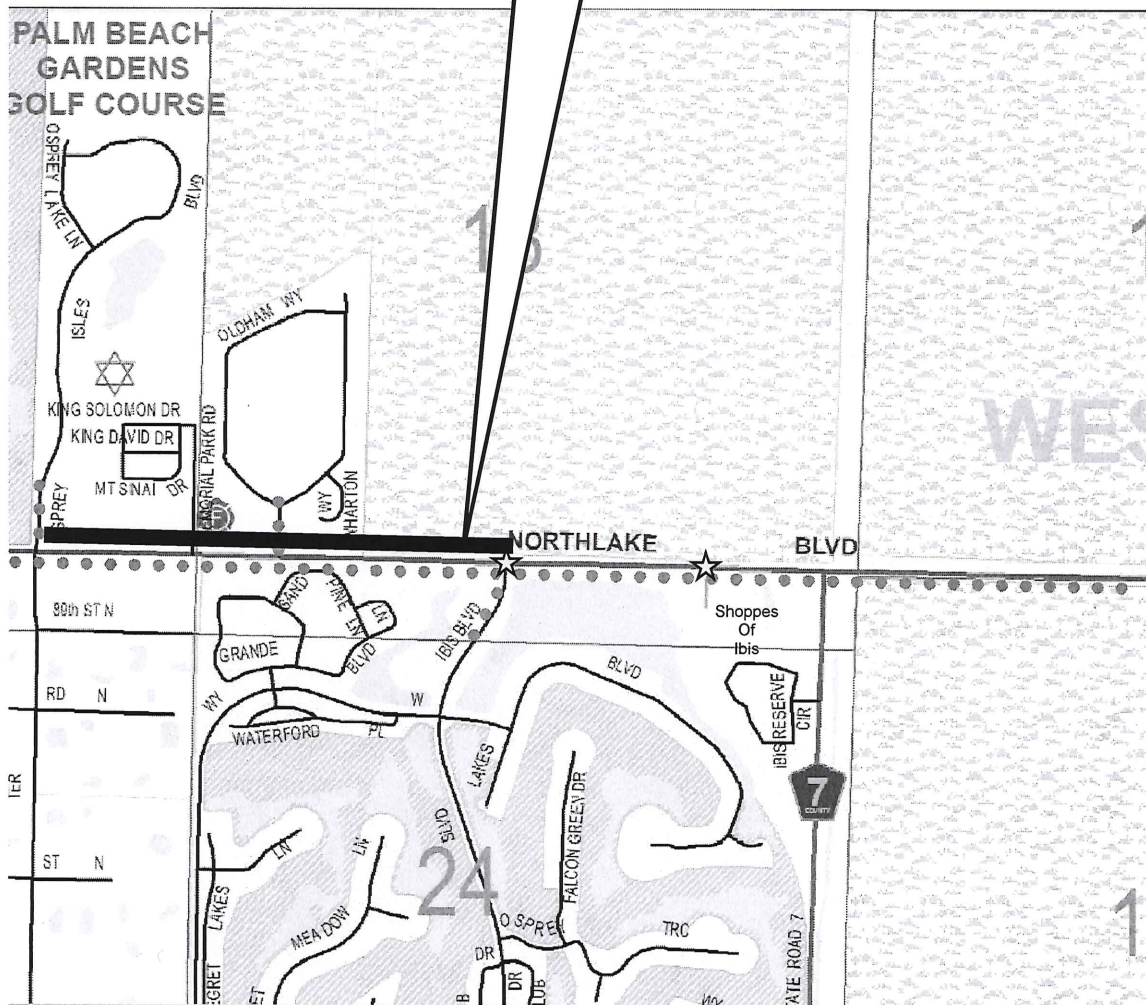

- Existing Pathway
- ☆ Signal

District 1



FY 2016 PATHWAY PROGRAM

Northlake Blvd  
Location Map

ATTACH

2

8-31-15

N:\TRAFFIC\CMW\2015\Board\BOARD FIGURES\Northlake Blvd LM.doc

Location Sketch



Palmetto Park Rd  
From Lyons Rd  
To Mizner Wy  
N Side/Asphalt/3,385'  
\$73,545

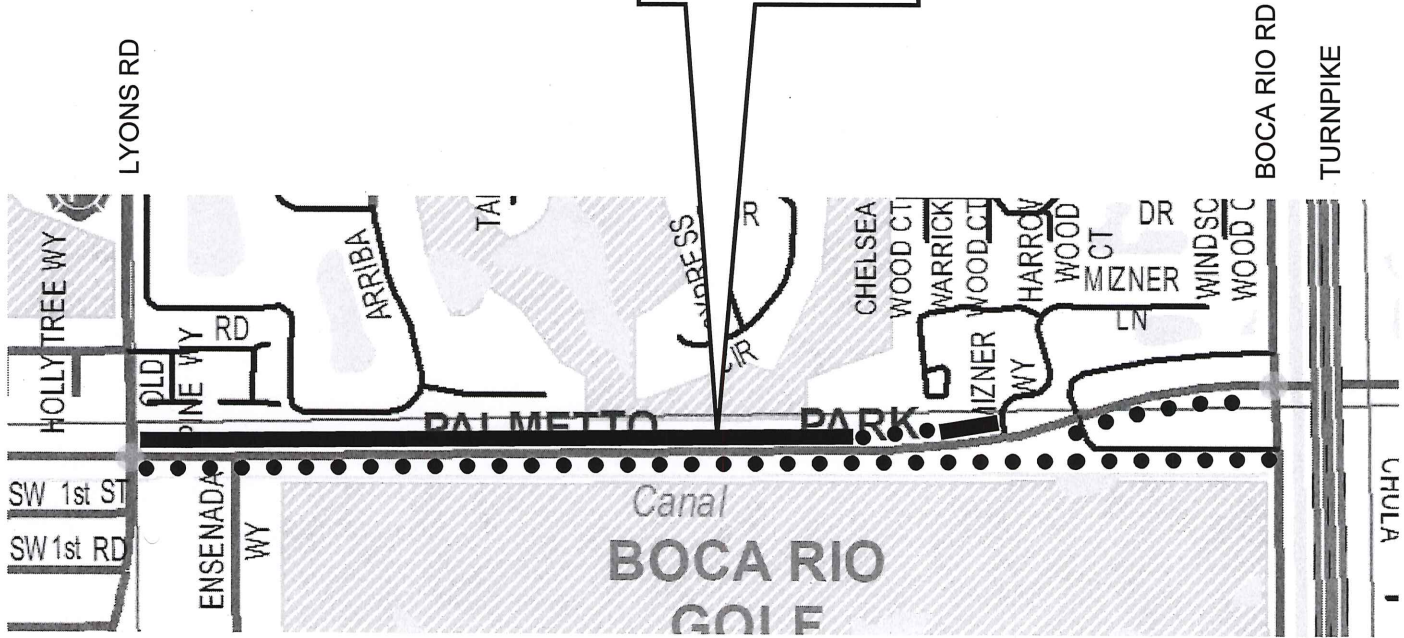

● ● ● Existing pathway

District 5



FY 2016 PATHWAY PROGRAM

Palmetto Park Road  
Location Map

ATTACH

3

8-31-15

Location Sketch



Belvedere Rd

Amphitheater

Southern Blvd

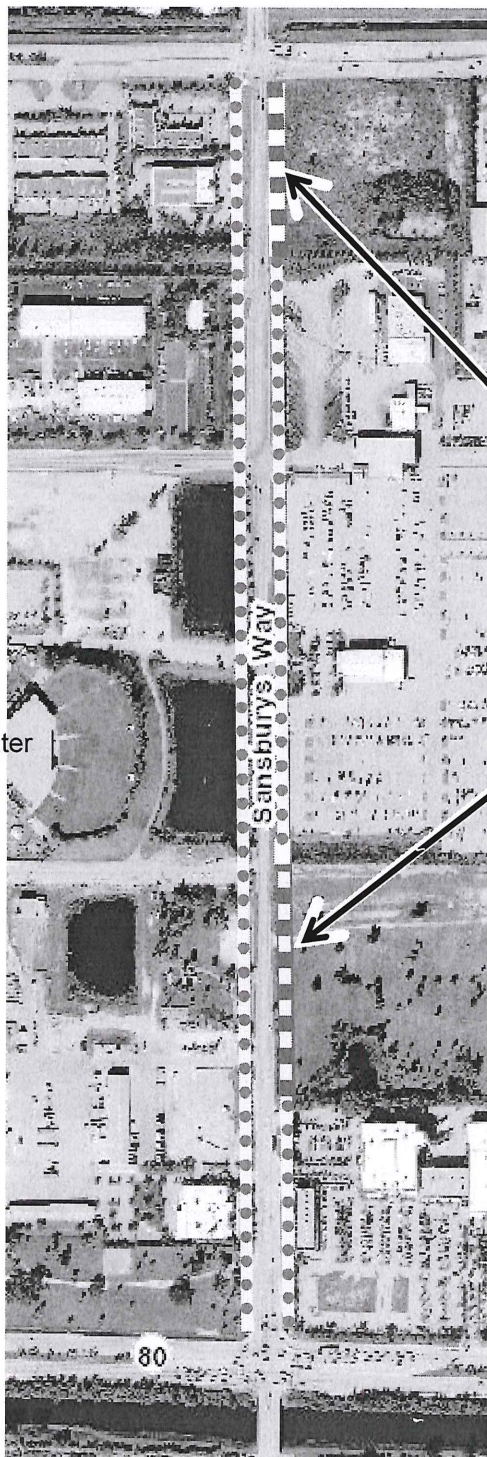

Auto Auction

Sansburys Wy  
From Southern Blvd to Belvedere Rd  
Missing Links  
E Side/Concrete/1,470'  
\$126,940

••• Existing Pathway

District 2



FY 2016 PATHWAY PROGRAM

Sansburys Way  
Location Map

ATTACH

4

9-15-15

N:\TRAFFIC\CMW\2015\Board\BOARD FIGURES\Sansburys Way LM.doc

Location Sketch

Meadow Park ES  
↑

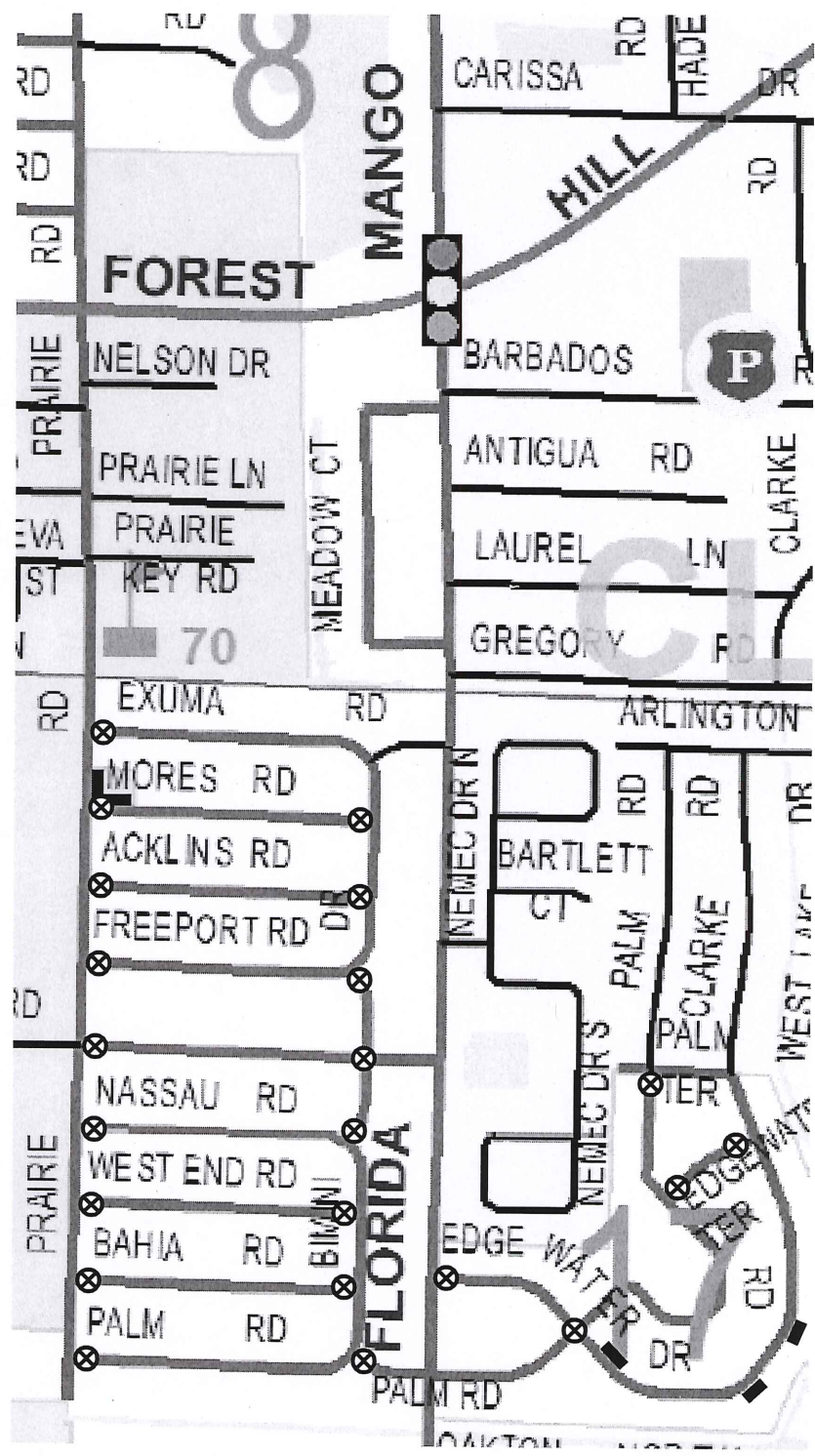

- Missing link
- ⊗ Missing tie in District 3

Bahama Heights/Edgewater Park  
Communitywide Missing Links & Tie Ins  
\$97,675



FY 2016 PATHWAY PROGRAM

Bahama Heights/Edgewater Park  
Location Map

ATTACH  
**5**

8-31-15

N:\TRAFFIC\CMW\2015\Board\BOARD FIGURES\Bahama Heights-Edgewater Park LM.doc

Location Sketch





Communitywide Tie Ins  
\$137,870

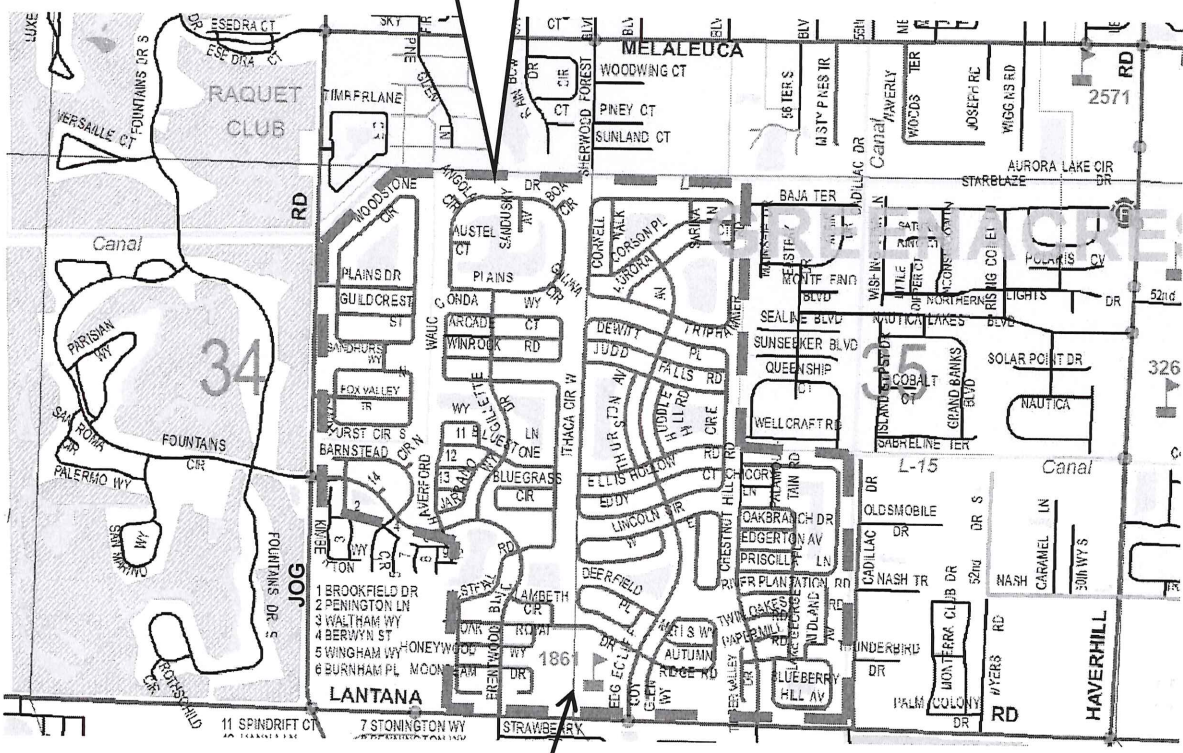

Indian Pines ES

District 2



FY 2016 PATHWAY PROGRAM

Lantana Homes/Lees Crossing  
Location Map

ATTACH  
**6**

8-31-15

N:\TRAFFIC\CMW\2015\Board\BOARD FIGURES\Lantana Homes - Lees Crossing LM.doc

Location Sketch



Muck City Rd  
From Johnson Ct to Eldorado Dr  
Missing Link & Tie Ins  
S Side/Concrete/330'  
\$33,570



- ● ● Existing pathway
- ⊗ Missing Tie In

District 6



FY 2016 PATHWAY PROGRAM

Muck City Road  
Location Map

ATTACH

7

9-15-15

N:\TRAFFIC\MMW2015\Board\BOARD FIGURES\Muck City Rd LM.doc

Location Sketch

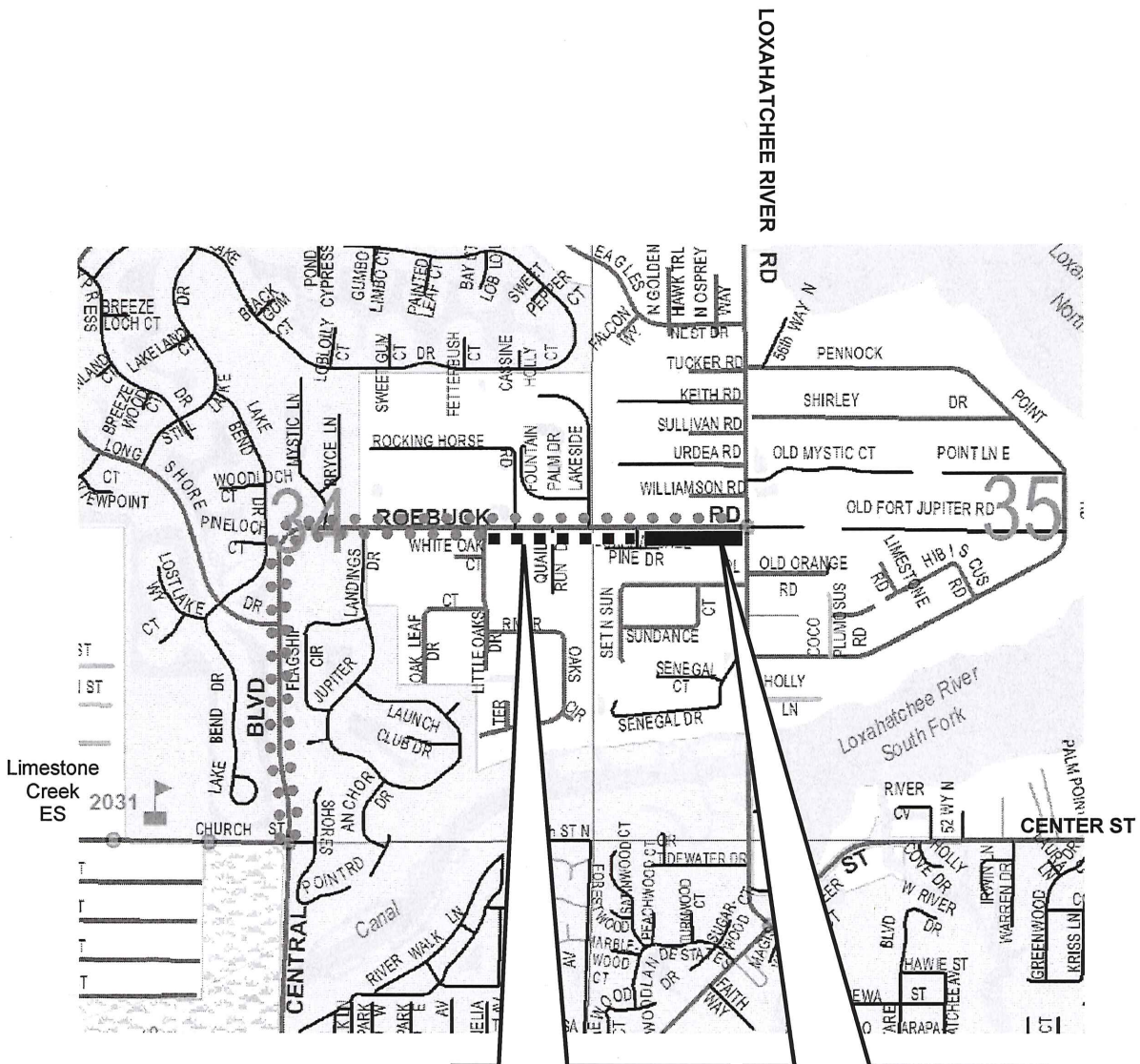

Roebuck Rd  
From Little Oaks Dr  
to Loxahatchee Pines Dr  
Funded FY 2015

Roebuck Rd  
From Loxahatchee Pines Dr  
to Loxahatchee River Rd  
S Side/Asphalt/820'  
\$140,413\*

- ● ● Existing Pathway
- \* Includes ROW acquisition/easement

District 1



FY 2016 PATHWAY PROGRAM

Roebuck Road  
Location Map

ATTACH

8

8-31-15

Location Sketch