

II. FISCAL IMPACT ANALYSIS

A. Five Year Summary of Fiscal Impact:

Table with 6 columns: Fiscal Years, 2016, 2017, 2018, 2019, 2020. Rows include Capital Expenditures, Operating Costs, External Revenues, Program Income (County), In-Kind Match (County), NET FISCAL IMPACT, # ADDITIONAL FTE, and POSITIONS (Cumulative).

Is Item Included in Current Budget? Yes No

Budget Acct No.: Fund 3511 Dept. 365 Unit S206 Object Program

Recommended Sources of Funds/Summary of Fiscal Impact:

**No fiscal impact. This Board action finalizes the assessment roll which was approved at the October 1, 2013 Public Hearing. Fiscal impact for the project was presented August 19, 2014, R-2014-1131. These roads are currently maintained by courtesy by Palm Beach County. This agenda item finalizes the paving project and formally accepts the roadway maintenance.

C. Departmental Fiscal Review: Alice Kovalainen

III. REVIEW COMMENTS

A. OFMB Fiscal and/or Contract Dev. and Control Comments:

Handwritten signature and date 2/10/16, OFMB go 2/14

Handwritten signature and date 2/12/16, Contract Dev. and Control

B. Approved as to Form and Legal Sufficiency: Handwritten signature and date 2/17/16, Assistant County Attorney

C. Other Department Review: Department Director

**El Paso Drive, Pinto Drive and Pancho Way east of
Blanchette Trail Paving and Drainage Improvement
Project Number 2013129**

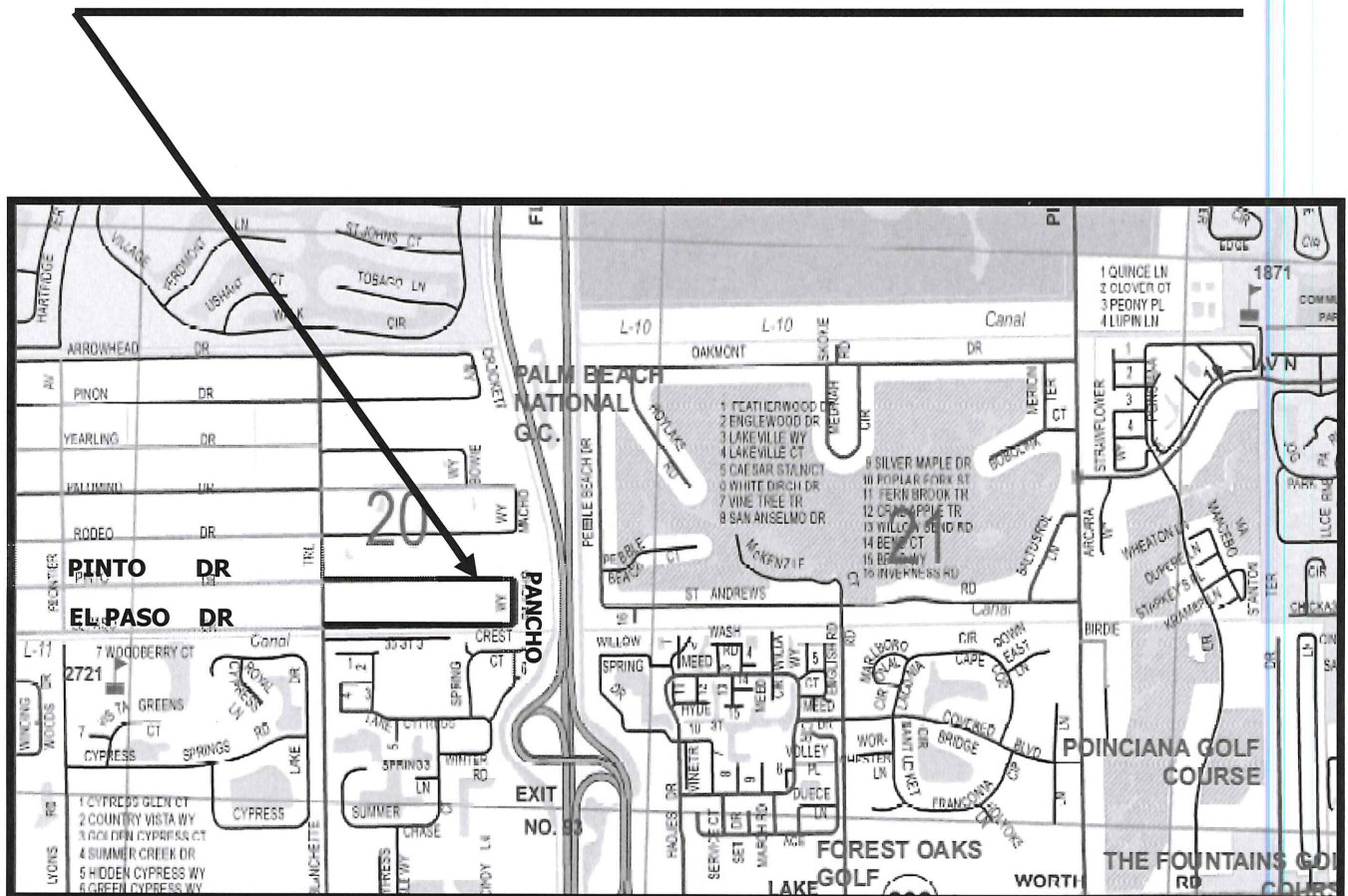

LOCATION MAP

RESOLUTION NO. R-2016-

RESOLUTION OF THE BOARD OF COUNTY COMMISSIONERS OF PALM BEACH COUNTY, FLORIDA TO FINALIZE THE SPECIAL ASSESSMENT FOR EL PASO DRIVE, PINTO DRIVE AND PANCHO WAY EAST OF BLANCHETTE TRAIL PAVING AND DRAINAGE IMPROVEMENT PROJECT, SECTION 20, TOWNSHIP 44 SOUTH, RANGE 42 EAST, PURSUANT TO A PUBLIC HEARING HELD THEREON.

WHEREAS, a special assessment process was initiated for the paving and drainage improvement of El Paso Drive, Pinto Drive and Pancho Way East of Blanchette Trail (Project), authorized pursuant to Palm Beach County Code Chapter 26, Article II, Division 1, known as the Municipal Service Taxing Unit (MSTU) Special Assessment Ordinance; and

WHEREAS, Resolution R2013-1270 confirming the special assessment for the Project was approved by the Board of County Commissioners (Board) at a Public Hearing held October 1, 2013; and

WHEREAS, this resolution will finalize the special assessment roll for the Project at a fixed amount of \$10,000 per lot payable in 20 equal annual installments at an interest rate of five percent (5%) per annum; and

WHEREAS, the Board finds that the public notice and public hearing requirements of the MSTU Special Assessment Ordinance have been met.

NOW, THEREFORE, BE IT RESOLVED BY THE BOARD OF COUNTY COMMISSIONERS OF PALM BEACH COUNTY, FLORIDA, THAT:

1. The Report of Costs and Special Assessment Roll for El Paso Drive, Pinto Drive and Pancho Way East of Blanchette Trail paving and drainage improvement, Section 20, Township 44 South, Range 42 East, is on file in the office of the Clerk of the Board of County Commissioners and attached hereto as EXHIBIT I and EXHIBIT II respectively. EXHIBIT II is hereby approved and confirmed and shall be recorded in the official records of the Clerk & Comptroller for Palm Beach County to facilitate knowledge of the lien by third parties.

2. Pursuant to the MSTU Special Assessment Ordinance, the following project is hereby approved: El Paso Drive, Pinto Drive and Pancho Way East of Blanchette Trail paving and drainage improvement, Section 20, Township 44 South, Range 42 East, Palm

Beach County, Florida.

3. The said special assessments are hereby made upon all parcels of land described in said Special Assessment Roll (EXHIBIT II) in the amount shown thereon.

4. Pursuant to the MSTU Special Assessment Ordinance, any and all special assessments made pursuant to this Resolution, which have not been paid in full within 30 days after notice of completion of the subject improvements for which said assessment was made, shall be subject to interest at a rate of five percent (5%) per annum from the date of the acceptance of said improvement by Palm Beach County and shall be payable in 20 equal annual installments.

5. The total cost of the Project is \$1,259,791.38, attached EXHIBIT I. 21.43% of the total costs (\$270,000) of the paving and drainage improvement will be paid for by special assessment.

6. Pursuant to Sec. 26-30.6 of the MSTU Code, if any special assessment made under the provisions of this division to defray part of the expense of any improvement made hereunder shall be either in whole or in part vacated or set aside by the judgment of any court, or if the Board shall be satisfied that such assessment is so irregular or defective that same cannot be enforced or collected, or if the Board omitted to make such assessment when it might have done so, the Board shall take all necessary steps to cause a new assessment to be made for any improvement and against property specially benefited by such improvement, following the provisions of this division.

7. The Board further finds that each parcel listed on EXHIBIT II will obtain a special benefit which is at least equal to the amount of special assessment made against each such parcel.

THIS SPACE LEFT BLANK

INTENTIONALLY

RESOLUTION NO. R-2016-
March 1, 2016

The foregoing Resolution was offered by Commissioner _____ who moved its adoption. The motion was seconded by Commissioner _____, and upon being put to a vote, the vote was as follows:

District 5:	Mary Lou Berger, Mayor	_____
District 1:	Hal R. Valeche, Vice Mayor	_____
District 2:	Paulette Burdick	_____
District 3:	Shelley Vana	_____
District 4:	Steven L. Abrams	_____
District 6:	Melissa McKinlay	_____
District 7:	Priscilla A. Taylor	_____

The Mayor thereupon declared the Resolution duly passed and adopted this 1st day of March, 2016.

PALM BEACH COUNTY, FLORIDA, BY ITS
BOARD OF COUNTY COMMISSIONERS

ATTEST:

SHARON R. BOCK
CLERK & COMPTROLLER

BY: _____
Deputy Clerk

APPROVED AS TO FORM AND
LEGAL SUFFICIENCY:

By: _____
County Attorney

PROJECT NUMBER 2013129

FINAL REPORT OF COST

**EL PASO DRIVE, PINTO DRIVE AND PANCHO WAY EAST OF BLANCHETTE TRAIL
PAVING & DRAINAGE IMPROVEMENTS**

DESIGN STAFF COSTS	\$ 40,484.42
DESIGN CONSULTANT COSTS	\$ 150,303.92
CONTRACTOR CONSTRUCTION COSTS	\$ 933,659.11
ADVERTISING COSTS	\$ 1,087.04
SUB-TOTAL	\$ 1,125,534.49
STAFF CHARGES DURING CONSTRUCTION	\$ 128,211.31
TESTING LAB CHARGES	\$ 3,564.30
TRAFFIC SIGNING AND MARKING COSTS	\$ 2,481.28
PROJECT TOTAL	\$ 1,259,791.38
MSTU COUNTY TOTAL COST	\$ 989,791.38
TOTAL ASSESSABLE COST = Fixed Cost per Lot	\$ 270,000.00
ABUTTING LOTS - - - -	27
ASSESSMENT PER LOT	\$ 10,000.00



Assessment Roll - Final

EL PASO DR, PINTO DR & PANCHO WAY
EAST OF BLANCHETTE TRAIL

FUND AGENCY ORG	COMMISSION DISTRICT	SECTION TOWNSHIP RANGE
	6 MELISSA MCKINLAY	20 44S 42E

No.	Homeowner	PCN/Legal Description	Parcel	Total Assessment	Annual Cost/Per Year	Notes
1	CARROLL STEPHEN M	00-42-44-19-01-021-013.0 PALM BEACH RANCHETTES UNIT A LOT 13 SEC V	1	\$10,000.00	\$810.35	
2	FITTON ROBERT S	00-42-44-19-01-021-014.0 PALM BEACH RANCHETTES UNIT A LOT 14 SEC V	1	\$10,000.00	\$810.35	
3	BASSO GIUSEPPE G &	00-42-44-19-01-021-015.0 PALM BEACH RANCHETTES UNIT A LOT 15 SEC V	1	\$10,000.00	\$810.35	
4	BASSO GIUSEPPE G &	00-42-44-19-01-021-016.0 PALM BEACH RANCHETTES UNIT A LOT 16 SEC V	1	\$10,000.00	\$810.35	
5	BASSO RENZO	00-42-44-19-01-021-017.0 PALM BEACH RANCHETTES UNIT A LOT 17 SEC V	1	\$10,000.00	\$810.35	
6	MCGUIRE EDWARD	00-42-44-19-01-021-018.0 PALM BEACH RANCHETTES UNIT A LOT 18 SEC V	1	\$10,000.00	\$810.35	

Assessments which have not been paid in full within thirty days after completion of the subject improvements for which said assessment was made, will be charged interest at a rate of five (5) percent per annum from the date of the acceptance of said improvement by Palm Beach County and shall be payable in twenty equal annual installments of principal and interest.



FUND AGENCY ORG	COMMISSION DISTRICT	SECTION TOWNSHIP RANGE
	6 MELISSA MCKINLAY	20 44S 42E

No.	Homeowner	PCN/Legal Description	Parcel	Total Assessment	Annual Cost/Per Year	Notes
7	CHANCE CHRISTOPHER	00-42-44-19-01-021-019.0 PALM BEACH RANCHETTES UNIT A LOT 19 SEC V	1	\$10,000.00	\$810.35	
8	GARCIA LILIANA	00-42-44-19-01-021-020.0 PALM BEACH RANCHETTES UNIT A LOT 20 SEC V	1	\$10,000.00	\$810.35	
9	WOLOSH CORY L	00-42-44-19-01-021-021.0 PALM BEACH RANCHETTES UNIT A LOT 21 SEC V	1	\$10,000.00	\$810.35	
10	KENNEY KYLE C &	00-42-44-19-01-021-022.0 PALM BEACH RANCHETTES UNIT A LOT 22 SEC V	1	\$10,000.00	\$810.35	
11	PARKER WINSLOW J &	00-42-44-19-01-021-023.0 PALM BEACH RANCHETTES UNIT A LOT 23 SEC V	1	\$10,000.00	\$810.35	
12	ROMAN CARLOS A	00-42-44-19-01-022-002.0 PALM BEACH RANCHETTES UNIT A LOT 2 SEC W	1	\$10,000.00	\$810.35	

Assessments which have not been paid in full within thirty days after completion of the subject improvements for which said assessment was made, will be charged interest at a rate of five (5) percent per annum from the date of the acceptance of said improvement by Palm Beach County and shall be payable in twenty equal annual installments of principal and interest.



Assessment Roll - Final

EL PASO DR, PINTO DR & PANCHO WAY
EAST OF BLANCHETTE TRAIL

FUND	AGENCY	ORG	COMMISSION DISTRICT			SECTION	TOWNSHIP	RANGE
			6 MELISSA MCKINLAY			20	44S	42E

No.	Homeowner	PCN/Legal Description	Parcel	Total Assessment	Annual Cost/Per Year	Notes
13	CERVERA NICOLA	00-42-44-19-01-022-003.0 PALM BEACH RANCHETTES UNIT A LOT 3 SEC W	1	\$10,000.00	\$810.35	
14	ROBERTS ROSE MARIE EST	00-42-44-19-01-022-004.0 PALM BEACH RANCHETTES UNIT A LOT 4 SEC W	1	\$10,000.00	\$810.35	
15	ROBERTS ROSE MARIE TR &	00-42-44-19-01-022-005.0 PALM BEACH RANCHETTES UNIT A LOT 5 SEC W	1	\$10,000.00	\$810.35	
16	FULCHER RICHARD &	00-42-44-19-01-022-006.0 PALM BEACH RANCHETTES UNIT A LOT 6 SEC W	1	\$10,000.00	\$810.35	
17	LADISLAW SHERON FIELDING TRUST	00-42-44-19-01-022-007.0 PALM BEACH RANCHETTES UNIT A LT 7 SEC W	1	\$10,000.00	\$810.35	
18	BERRA DANIEL &	00-42-44-19-01-022-008.0 PALM BEACH RANCHETTES UNIT A LOT 8 SEC W	1	\$10,000.00	\$810.35	

Assessments which have not been paid in full within thirty days after completion of the subject improvements for which said assessment was made, will be charged interest at a rate of five (5) percent per annum from the date of the acceptance of said improvement by Palm Beach County and shall be payable in twenty equal annual installments of principal and interest.



Assessment Roll - Final

EL PASO DR, PINTO DR & PANCHO WAY
EAST OF BLANCHETTE TRAIL

FUND AGENCY ORG	COMMISSION DISTRICT	SECTION TOWNSHIP RANGE
	6 MELISSA MCKINLAY	20 44S 42E

No.	Homeowner	PCN/Legal Description	Parcel	Total Assessment	Annual Cost/Per Year	Notes
19	COLLIER EARL H JR &	00-42-44-19-01-022-009.0 PALM BEACH RANCHETTES UNIT A LT 9 (LESS RTN CRV AREA PINTO DR R/W) SEC W	1	\$10,000.00	\$810.35	
20	AVNER MARK H	00-42-44-19-01-022-011.0 PALM BEACH RANCHETTES UNIT A LOT 11 SEC W	1	\$10,000.00	\$810.35	
21	LIBERTO JASON W &	00-42-44-19-01-022-012.0 PALM BEACH RANCHETTES UNIT A LOT 12 SEC W	1	\$10,000.00	\$810.35	
22	ERICHSEN PATRICIA A &	00-42-44-19-01-022-013.0 PALM BEACH RANCHETTES UNIT A LOT 13 SEC W	1	\$10,000.00	\$810.35	
23	METTS DANNY R	00-42-44-19-01-022-014.0 PALM BEACH RANCHETTES UNIT A LOT 14 SEC W	1	\$10,000.00	\$810.35	
24	GREGORY MARK A &	00-42-44-19-01-022-015.0 PALM BEACH RANCHETTES UNIT A LOT 15 SEC W	1	\$10,000.00	\$810.35	

Assessments which have not been paid in full within thirty days after completion of the subject improvements for which said assessment was made, will be charged interest at a rate of five (5) percent per annum from the date of the acceptance of said improvement by Palm Beach County and shall be payable in twenty equal annual installments of principal and interest.



FUND AGENCY ORG	COMMISSION DISTRICT	SECTION TOWNSHIP RANGE
	6 MELISSA MCKINLAY	20 44S 42E

No.	Homeowner	PCN/Legal Description	Parcel	Total Assessment	Annual Cost/Per Year	Notes
25	CHEN WILFRED G &	00-42-44-19-01-022-016.0 PALM BEACH RANCHETTES UNIT A LOT 16 SEC W	1	\$10,000.00	\$810.35	
26	CRAWFORD GLENN H III	00-42-44-19-01-022-017.0 PALM BEACH RANCHETTES UNIT A LOT 17 SEC W	1	\$10,000.00	\$810.35	
27	BREFFLE VICTOR A &	00-42-44-19-01-022-018.0 PALM BEACH RANCHETTES UNIT A LOT 18 SEC W	1	\$10,000.00	\$810.35	
Totals:			27	\$270,000.00		

Note Description/Totals	
1	ASSIGNED FRONT FOOTAGE 0
2	ASSIGNED AVERAGE FRONT FOOTAGE 0
3	50% OF SUM OF ALL ABUTTING FOOTAGE 0

Assessments which have not been paid in full within thirty days after completion of the subject improvements for which said assessment was made, will be charged interest at a rate of five (5) percent per annum from the date of the acceptance of said improvement by Palm Beach County and shall be payable in twenty equal annual installments of principal and interest.