

**PALM BEACH COUNTY
BOARD OF COUNTY COMMISSIONERS
AGENDA ITEM SUMMARY**

Meeting Date: September 13, 2016	<input checked="" type="checkbox"/>	Consent	<input type="checkbox"/>	Regular
	<input type="checkbox"/>	Workshop	<input type="checkbox"/>	Public Hearing

Department:
Submitted By: Engineering & Public Works Department
Submitted For: Roadway Production Division

I. EXECUTIVE BRIEF

Motion and Title: Staff recommends motion to approve: Supplement No. 2 (Supplement) to Project Contract, R2014-1122, with R.J. Behar & Company, Inc. (RJB) in the amount of \$116,285.43 for professional services for the Haverhill Road from north of Caribbean Boulevard to Bee Line Highway project (Project).

SUMMARY: Approval of this Supplement will provide the professional services necessary for the preparation of design plans and construction bid documents for the Project. The Small Business Enterprise (SBE) goal for the Project is 15%. RJB committed to 99% SBE participation for the project and has achieved 93.08% SBE participation to date. The SBE participation committed for this Supplement by RJB is 55.21%. It is noted that about 45% of this Supplement includes specialized services that will be performed by a non-SBE subconsultant. RJB is a Palm Beach County based company.

Districts 1 and 7 (MRE)

Background and Justification: On August 19, 2014, the Board of County Commissioners (Board) approved Contract, R2014-1122, with RJB to provide professional services required to prepare design plans and construction bid documents for the Project. Palm Beach County now desires RJB to modify the design plans and construction bid documents for the Project, as detailed in Exhibit "A" of the attached Supplement. The fee, as detailed in Exhibit "A" of the attached Supplement, has been negotiated as just and reasonable compensation as follows:

Basic Services (Lump Sum)	\$ 37,991.63	(Roadway and Drainage Design Revisions, Walkway Plan and Permit Preparation, Dewatering Analysis).
Reimbursable Expenses (Not to Exceed)	\$ 64,500.30	(Structural, Ground Water Analysis, Survey, Ecological).
Optional Services (Not to Exceed)	\$ <u>13,793.50</u>	(Ground Water Analysis, Survey, Legal Descriptions and Sketches).
Total:	<u>\$116,285.43</u>	

After reviewing the attached Supplement and finding it in proper order, staff recommends Board approval.

Attachments:

- 1. Location Sketch
- 2. Supplement No. 2 with Exhibits "A", "B", "C", and "D" and Certificate of Insurance (2)
- 3. Project Work Schedule

Recommended by: *[Signature]* Department Director 9/18/16 Date

Approved By: *[Signature]* Assistant County Administrator 9/25/16 Date

HAVERHILL ROAD N. OF CARIBBEAN BOULEVARD TO BEE LINE HIGHWAY PALM BEACH COUNTY PROJECT NO. 2013528

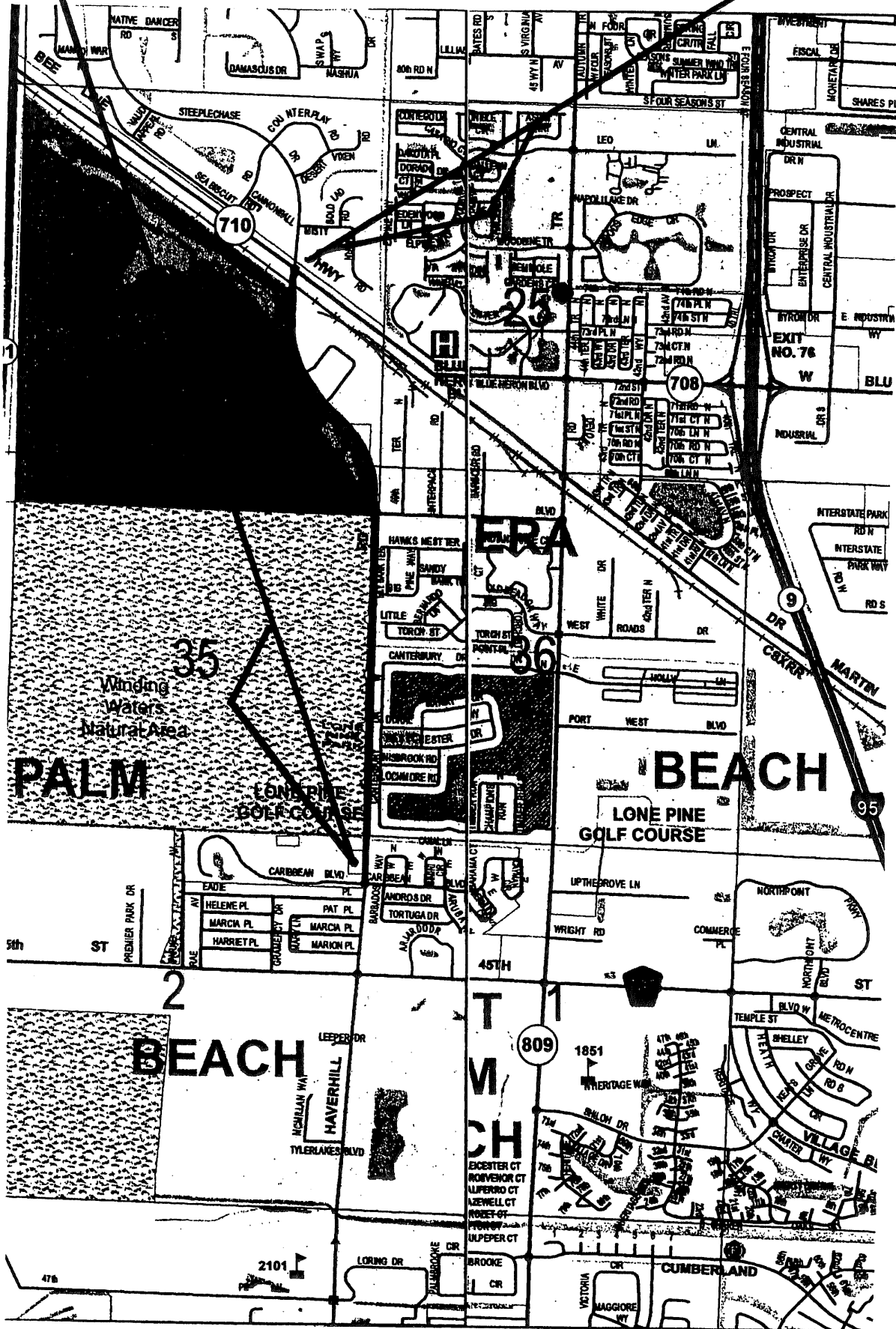

LOCATION SKETCH