



**II. FISCAL IMPACT ANALYSIS**

**A. Five Year Summary of Fiscal Impact:**

Fiscal Years	2016	2017	2018	2019	2020
Capital Expenditures	_____	_____	_____	_____	_____
Operating Costs	_____	_____	_____	_____	_____
External Revenues	_____	_____	_____	_____	_____
Program Income (County)	_____	_____	_____	_____	_____
In-Kind Match (County)	_____	_____	_____	_____	_____
<b>NET FISCAL IMPACT</b>	<u>* -0-</u>	<u>-0-</u>	<u>-0-</u>	<u>-0-</u>	<u>-0-</u>
# ADDITIONAL FTE POSITIONS (Cumulative)	_____	_____	_____	_____	_____

Is Item Included in Current Budget: Yes \_\_\_\_\_ No \_\_\_\_\_

Budget Account No: Fund \_\_\_\_\_ Dept \_\_\_\_\_ Unit \_\_\_\_\_ Object \_\_\_\_\_  
 Program \_\_\_\_\_

**B. Recommended Sources of Funds/Summary of Fiscal Impact:**

\*No fiscal impact.

Fixed Asset Number: H07930, H07917, H07927, H07931, H07929 and H07936

C. Departmental Fiscal Review: \_\_\_\_\_

*W* 8-16-14 *[Signature]* 8/27/16

**III. REVIEW COMMENTS**

**A. OFMB Fiscal and/or Contract Development Comments:**

*[Signature]* 8/25/16  
 OFMB 8/25/16 *[Signature]* 8/25

*[Signature]* 8/29/16  
 Contract Development and Control 8/29/16 *[Signature]*

**B. Legal Sufficiency:**

*[Signature]* 8/31/16  
 Assistant County Attorney

**C. Other Department Review:**

\_\_\_\_\_  
 Department Director

**This summary is not to be used as a basis for payment.**

**Attachment #1**  
Location Maps (2 pages)

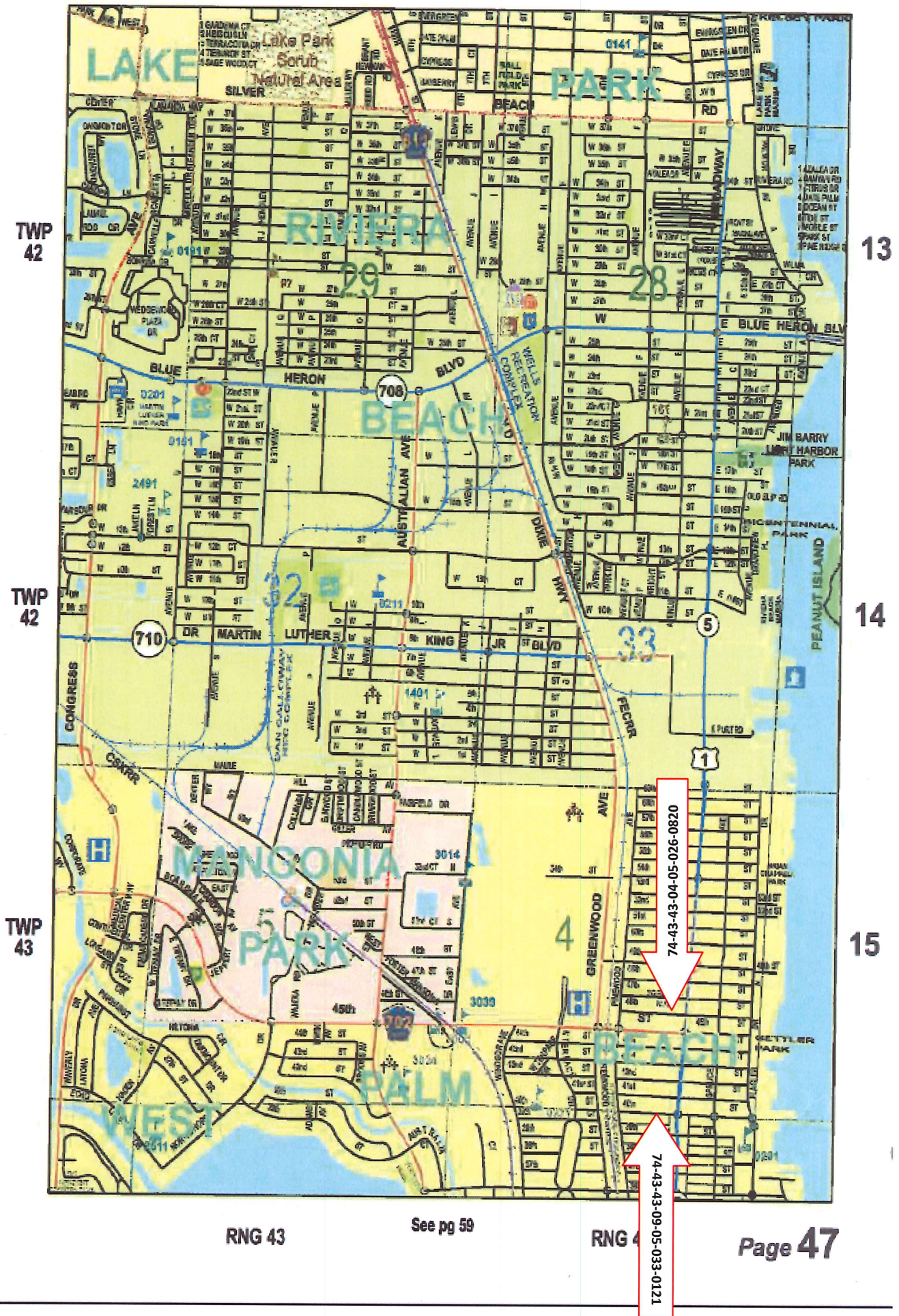

RNG 43

See pg 59

RNG 44

Page 47

LOCATION MAP



TWP 43

TWP 43

TWP 43

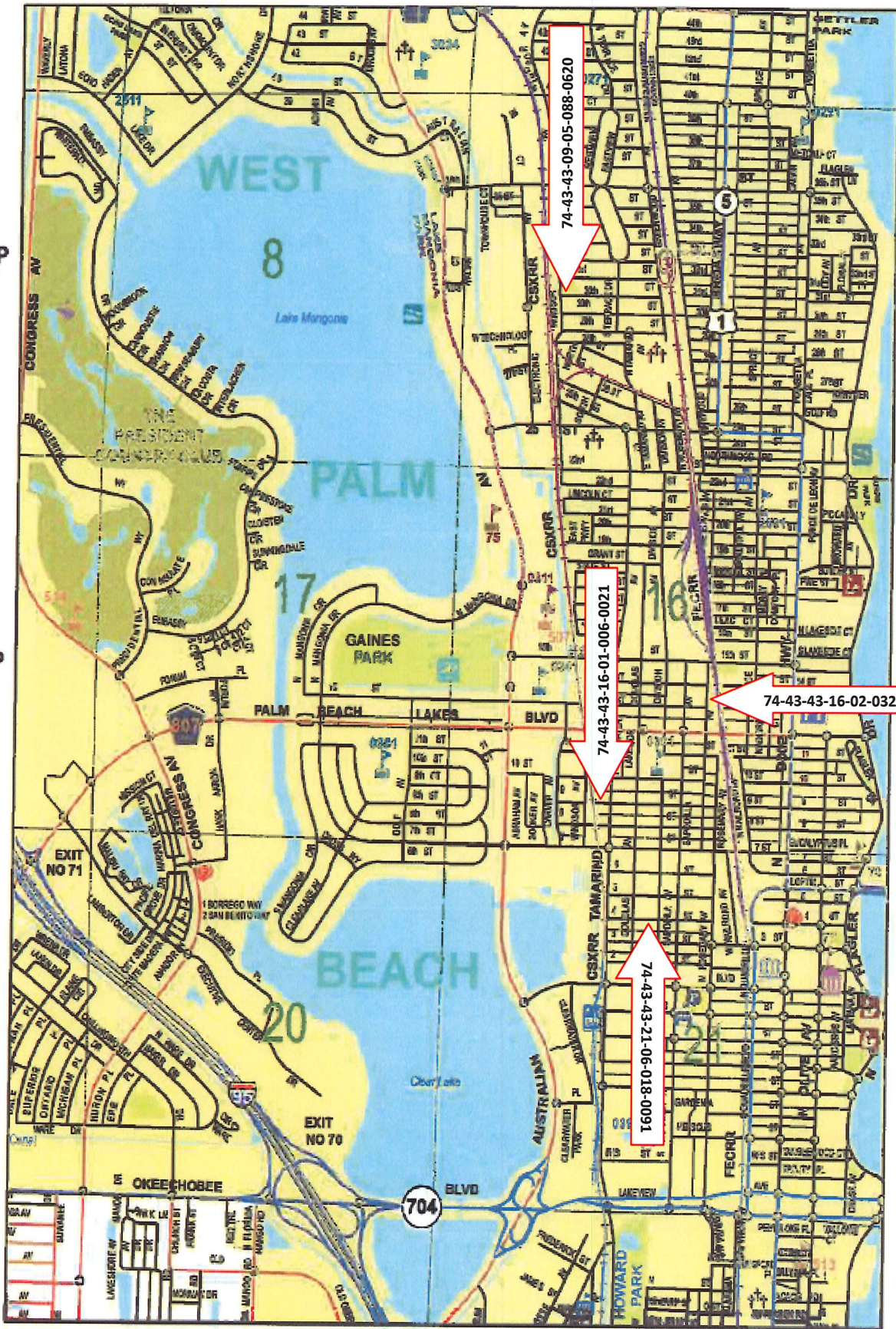

16

17

18

RNG 43

See pg 71

RNG 43

Page 59

LOCATION MAP



Attachment #2  
Resolution (9 pages)

**RESOLUTION NO. \_\_\_\_\_**

**RESOLUTION OF THE BOARD OF COUNTY COMMISSIONERS OF PALM BEACH COUNTY, FLORIDA, AUTHORIZING THE CONVEYANCE OF CERTAIN REAL PROPERTY TO THE CITY OF WEST PALM BEACH, PURSUANT TO FLORIDA STATUTE SECTION 197.592(3) WITHOUT CHARGE AND WITH MINERAL AND PETROLEUM RIGHTS RESERVATION WITHOUT RIGHTS OF ENTRY AND EXPLORATION; AND PROVIDING FOR AN EFFECTIVE DATE.**

**WHEREAS**, the County owns six (6) properties within the municipal boundaries of the City of West Palm Beach which were acquired for delinquent taxes; and

**WHEREAS**, Florida Statutes Section 197.592(3) states that under certain conditions, the County is to convey to municipalities in which they are located, properties acquired by the County for delinquent taxes and that any liens of record held by the County on such properties shall not survive the conveyance to the municipalities; and

**WHEREAS**, the subject lands have not been previously sold, acquired for infill housing, or dedicated by the Board of County Commissioners, and shall not be conveyed to the record prior fee simple title owner; and

**WHEREAS**, pursuant to Florida Statute Section 270.11, the City of West Palm Beach has requested that such property be conveyed without reservation of and release the rights of entry and exploration relating to phosphate, mineral, metals and petroleum rights; and

**WHEREAS**, the Board of County Commissioners of Palm Beach County has agreed to convey such property reserving phosphate, mineral, metals and petroleum rights but releasing any and all rights of entry and exploration relating to such rights.

**NOW, THEREFORE, BE IT RESOLVED BY THE BOARD OF COUNTY COMMISSIONERS OF PALM BEACH COUNTY, FLORIDA, that:**

**Section 1. Recitals**

The foregoing recitals are true and correct and incorporated herein by reference.

**Section 2. Authorization to Convey Real Property**

The Board of County Commissioners of Palm Beach County shall convey to the City of West Palm Beach without charge and by County Deeds attached hereto as Exhibit

“A” and incorporated herein by reference, the real property legally described in such deeds. Any liens of record held by the County on the subject lands shall not survive the conveyance to the City of West Palm Beach.

**Section 3. Conflict with Federal or State Law or County Charter**

Any statutory or Charter provisions in conflict with this Resolution shall prevail.

**Section 4. Effective Date**

The provisions of this Resolution shall be effective immediately upon adoption hereof.

The foregoing resolution was offered by Commissioner \_\_\_\_\_ who moved its adoption. The Motion was seconded by Commissioner \_\_\_\_\_, and upon being put to a vote, the vote was as follows:

- Commissioner Mary Lou Berger, Mayor
- Commissioner Hal R. Valeche, Vice Mayor
- Commissioner Paulette Burdick
- Commissioner Shelley Vana
- Commissioner Steven L. Abrams
- Commissioner Melissa McKinlay
- Commissioner Priscilla A. Taylor

The Mayor thereupon declared the resolution duly passed and adopted this day of \_\_\_\_\_, 20\_\_\_\_\_.

PALM BEACH COUNTY, a political  
subdivision of the State of Florida  
BOARD OF COUNTY COMMISSIONERS

SHARON R. BOCK  
CLERK & COMPTROLLER

By: \_\_\_\_\_  
Deputy Clerk

APPROVED AS TO FORM AND  
LEGAL SUFFICIENCY

By:   
Assistant County Attorney

APPROVED AS TO TERMS  
AND CONDITIONS

By:   
Department Director



**EXHIBIT "A"**  
**COUNTY DEEDS**

PREPARED BY AND RETURN TO:  
DELLA LOWERY, PROPERTY SPECIALIST  
PALM BEACH COUNTY  
PROPERTY & REAL ESTATE MANAGEMENT DIVISION  
2633 Vista Parkway  
West Palm Beach, FL 33411-5605

PCN: 74-43-43-16-02-032-0010  
Closing Date: \_\_\_\_\_  
Purchase Price: \_\_\_\_\_ \$0

## COUNTY DEED

This COUNTY DEED, made \_\_\_\_\_, by PALM BEACH COUNTY, a political subdivision of the State of Florida, by and through its Board of County Commissioners, whose legal mailing address is 2633 Vista Parkway, West Palm Beach, Florida 33411-5605, "County", and the CITY OF WEST PALM BEACH, a municipality duly organized and existing by virtue of the laws of the State of Florida, whose legal mailing address is 401 Clematis Street, West Palm Beach, Florida 33401, "City".

### WITNESSETH:

That County, for and in consideration of the sum of Ten and 00/100 (\$10.00) Dollars to it in hand paid by City, the receipt whereof is hereby acknowledged, has granted, bargained and sold to City, its successors and assigns forever, the following described land lying and being in Palm Beach County, Florida:

FRESHWATER 11<sup>TH</sup> & 12<sup>TH</sup> AVE ADD LT 1 BLK 32

THE ABOVE BEING THE REAL PROPERTY DESCRIBED UNDER TAX CERTIFICATE NUMBER 28122 IN THE TAX DEED RECORDED IN OFFICIAL RECORD BOOK 28067, PAGE 0932, PUBLIC RECORDS OF PALM BEACH COUNTY, FLORIDA.

Reserving, however, unto County, its successors and assigns, an undivided three-fourths ( $\frac{3}{4}$ ) interest in, and title in and to an undivided three-fourths ( $\frac{3}{4}$ ) interest in, all the phosphate, minerals, and metals that are or may be in, on, or under the said land and an undivided one-half ( $\frac{1}{2}$ ) interest in all petroleum that is or may be in, on, or under said land. The aforementioned reservation of phosphate, mineral, metals and petroleum rights shall not include and County hereby expressly releases any and all rights of entry and rights of exploration relating to such phosphate, mineral, metals and petroleum rights.

IN WITNESS WHEREOF, County has caused these presents to be executed in its name by its Board of County Commissioners acting by the Mayor or Vice Mayor of said Board, the day and year aforesaid.

### ATTEST:

SHARON R. BOCK  
CLERK & COMPTROLLER

By: \_\_\_\_\_  
Deputy Clerk

PALM BEACH COUNTY, a political  
subdivision of the State of Florida

By: \_\_\_\_\_  
Mary Lou Berger, Mayor

APPROVED AS TO FORM  
AND LEGAL SUFFICIENCY

By: \_\_\_\_\_  
Assistant County Attorney

(OFFICIAL SEAL)

PREPARED BY AND RETURN TO:  
DELLA LOWERY, PROPERTY SPECIALIST  
PALM BEACH COUNTY  
PROPERTY & REAL ESTATE MANAGEMENT DIVISION  
2633 Vista Parkway  
West Palm Beach, FL 33411-5605

PCN: 74-43-43-16-01-006-0021  
Closing Date: \_\_\_\_\_  
Purchase Price: \_\_\_\_\_ \$0

**COUNTY DEED**

**This COUNTY DEED**, made \_\_\_\_\_, by **PALM BEACH COUNTY**, a political subdivision of the State of Florida, by and through its Board of County Commissioners, whose legal mailing address is 2633 Vista Parkway, West Palm Beach, Florida 33411-5605, "County", and the **CITY OF WEST PALM BEACH**, a municipality duly organized and existing by virtue of the laws of the State of Florida, whose legal mailing address is 401 Clematis Street, West Palm Beach, Florida 33401, "City".

**WITNESSETH:**

That County, for and in consideration of the sum of Ten and 00/100 (\$10.00) Dollars to it in hand paid by City, the receipt whereof is hereby acknowledged, has granted, bargained and sold to City, its successors and assigns forever, the following described land lying and being in Palm Beach County, Florida:

FRESHWATER ADD TO WPB AMNDED W 24 FT OF LT 2 BLK 6

THE ABOVE BEING THE REAL PROPERTY DESCRIBED UNDER TAX CERTIFICATE NUMBER 39818 IN THE TAX DEED RECORDED IN OFFICIAL RECORD BOOK 28160, PAGE 0834, PUBLIC RECORDS OF PALM BEACH COUNTY, FLORIDA.

Reserving, however, unto County, its successors and assigns, an undivided three-fourths (3/4) interest in, and title in and to an undivided three-fourths (3/4) interest in, all the phosphate, minerals, and metals that are or may be in, on, or under the said land and an undivided one-half (1/2) interest in all petroleum that is or may be in, on, or under said land. The aforementioned reservation of phosphate, mineral, metals and petroleum rights shall not include and County hereby expressly releases any and all rights of entry and rights of exploration relating to such phosphate, mineral, metals and petroleum rights.

**IN WITNESS WHEREOF**, County has caused these presents to be executed in its name by its Board of County Commissioners acting by the Mayor or Vice Mayor of said Board, the day and year aforesaid.

**ATTEST:**

**SHARON R. BOCK**  
**CLERK & COMPTROLLER**

**PALM BEACH COUNTY, a political**  
**subdivision of the State of Florida**

By: \_\_\_\_\_  
Deputy Clerk

By: \_\_\_\_\_  
Mary Lou Berger, Mayor

**APPROVED AS TO FORM**  
**AND LEGAL SUFFICIENCY**

(OFFICIAL SEAL)

By: \_\_\_\_\_  
Assistant County Attorney

PREPARED BY AND RETURN TO:  
DELLA LOWERY, PROPERTY SPECIALIST  
PALM BEACH COUNTY  
PROPERTY & REAL ESTATE MANAGEMENT DIVISION  
2633 Vista Parkway  
West Palm Beach, FL 33411-5605

PCN: 74-43-43-21-06-018-0091  
Closing Date: \_\_\_\_\_  
Purchase Price: \_\_\_\_\_ \$0

## COUNTY DEED

**This COUNTY DEED**, made \_\_\_\_\_, by **PALM BEACH COUNTY**, a political subdivision of the State of Florida, by and through its Board of County Commissioners, whose legal mailing address is 2633 Vista Parkway, West Palm Beach, Florida 33411-5605, "County", and the **CITY OF WEST PALM BEACH**, a municipality duly organized and existing by virtue of the laws of the State of Florida, whose legal mailing address is 401 Clematis Street, West Palm Beach, Florida 33401, "City".

### WITNESSETH:

That County, for and in consideration of the sum of Ten and 00/100 (\$10.00) Dollars to it in hand paid by City, the receipt whereof is hereby acknowledged, has granted, bargained and sold to City, its successors and assigns forever, the following described land lying and being in Palm Beach County, Florida:

CLOWS ADDITION W ½ OF LT 9 BLK 18

THE ABOVE BEING THE REAL PROPERTY DESCRIBED UNDER TAX CERTIFICATE NUMBER 38949 IN THE TAX DEED RECORDED IN OFFICIAL RECORD BOOK 28160, PAGE 0365, PUBLIC RECORDS OF PALM BEACH COUNTY, FLORIDA.

Reserving, however, unto County, its successors and assigns, an undivided three-fourths ( $\frac{3}{4}$ ) interest in, and title in and to an undivided three-fourths ( $\frac{3}{4}$ ) interest in, all the phosphate, minerals, and metals that are or may be in, on, or under the said land and an undivided one-half ( $\frac{1}{2}$ ) interest in all petroleum that is or may be in, on, or under said land. The aforementioned reservation of phosphate, mineral, metals and petroleum rights shall not include and County hereby expressly releases any and all rights of entry and rights of exploration relating to such phosphate, mineral, metals and petroleum rights.

**IN WITNESS WHEREOF**, County has caused these presents to be executed in its name by its Board of County Commissioners acting by the Mayor or Vice Mayor of said Board, the day and year aforesaid.

### ATTEST:

**SHARON R. BOCK**  
**CLERK & COMPTROLLER**

**PALM BEACH COUNTY, a political**  
**subdivision of the State of Florida**

By: \_\_\_\_\_  
Deputy Clerk

By: \_\_\_\_\_  
Mary Lou Berger, Mayor

**APPROVED AS TO FORM**  
**AND LEGAL SUFFICIENCY**

(OFFICIAL SEAL)

By: \_\_\_\_\_  
Assistant County Attorney

PREPARED BY AND RETURN TO:  
DELLA LOWERY, PROPERTY SPECIALIST  
PALM BEACH COUNTY  
PROPERTY & REAL ESTATE MANAGEMENT DIVISION  
2633 Vista Parkway  
West Palm Beach, FL 33411-5605

PCN: 74-43-43-09-05-033-0121

Closing Date: \_\_\_\_\_

Purchase Price: \_\_\_\_\_ \$0

## COUNTY DEED

**This COUNTY DEED**, made \_\_\_\_\_, by **PALM BEACH COUNTY**, a political subdivision of the State of Florida, by and through its Board of County Commissioners, whose legal mailing address is 2633 Vista Parkway, West Palm Beach, Florida 33411-5605, "County", and the **CITY OF WEST PALM BEACH**, a municipality duly organized and existing by virtue of the laws of the State of Florida, whose legal mailing address is 401 Clematis Street, West Palm Beach, Florida 33401, "City".

### WITNESSETH:

That County, for and in consideration of the sum of Ten and 00/100 (\$10.00) Dollars to it in hand paid by City, the receipt whereof is hereby acknowledged, has granted, bargained and sold to City, its successors and assigns forever, the following described land lying and being in Palm Beach County, Florida:

NORTHWOOD ADD W 15 FT OF LT 12 & ALL LTS 13 & 14 BLK 33

THE ABOVE BEING THE REAL PROPERTY DESCRIBED UNDER TAX CERTIFICATE NUMBER 186 IN THE TAX DEED RECORDED IN OFFICIAL RECORD BOOK 28218, PAGE 1732, PUBLIC RECORDS OF PALM BEACH COUNTY, FLORIDA.

Reserving, however, unto County, its successors and assigns, an undivided three-fourths ( $\frac{3}{4}$ ) interest in, and title in and to an undivided three-fourths ( $\frac{3}{4}$ ) interest in, all the phosphate, minerals, and metals that are or may be in, on, or under the said land and an undivided one-half ( $\frac{1}{2}$ ) interest in all petroleum that is or may be in, on, or under said land. The aforementioned reservation of phosphate, mineral, metals and petroleum rights shall not include and County hereby expressly releases any and all rights of entry and rights of exploration relating to such phosphate, mineral, metals and petroleum rights.

**IN WITNESS WHEREOF**, County has caused these presents to be executed in its name by its Board of County Commissioners acting by the Mayor or Vice Mayor of said Board, the day and year aforesaid.

### ATTEST:

**SHARON R. BOCK**  
**CLERK & COMPTROLLER**

**PALM BEACH COUNTY, a political**  
**subdivision of the State of Florida**

By: \_\_\_\_\_  
Deputy Clerk

By: \_\_\_\_\_  
Mary Lou Berger, Mayor

**APPROVED AS TO FORM**  
**AND LEGAL SUFFICIENCY**

(OFFICIAL SEAL)

By: \_\_\_\_\_  
Assistant County Attorney

PREPARED BY AND RETURN TO:  
DELLA LOWERY, PROPERTY SPECIALIST  
PALM BEACH COUNTY  
PROPERTY & REAL ESTATE MANAGEMENT DIVISION  
2633 Vista Parkway  
West Palm Beach, FL 33411-5605

PCN: 74-43-43-09-05-088-0620  
Closing Date: \_\_\_\_\_  
Purchase Price: \_\_\_\_\_ \$0

## COUNTY DEED

This COUNTY DEED, made \_\_\_\_\_, by PALM BEACH COUNTY, a political subdivision of the State of Florida, by and through its Board of County Commissioners, whose legal mailing address is 2633 Vista Parkway, West Palm Beach, Florida 33411-5605, "County", and the CITY OF WEST PALM BEACH, a municipality duly organized and existing by virtue of the laws of the State of Florida, whose legal mailing address is 401 Clematis Street, West Palm Beach, Florida 33401, "City".

### WITNESSETH:

That County, for and in consideration of the sum of Ten and 00/100 (\$10.00) Dollars to it in hand paid by City, the receipt whereof is hereby acknowledged, has granted, bargained and sold to City, its successors and assigns forever, the following described land lying and being in Palm Beach County, Florida:

NORTHWOOD ADDITION LTS 62 & 63 BLK 88

THE ABOVE BEING THE REAL PROPERTY DESCRIBED UNDER TAX CERTIFICATE NUMBER 37652 IN THE TAX DEED RECORDED IN OFFICIAL RECORD BOOK 28160, PAGE 0416, PUBLIC RECORDS OF PALM BEACH COUNTY, FLORIDA.

Reserving, however, unto County, its successors and assigns, an undivided three-fourths ( $\frac{3}{4}$ ) interest in, and title in and to an undivided three-fourths ( $\frac{3}{4}$ ) interest in, all the phosphate, minerals, and metals that are or may be in, on, or under the said land and an undivided one-half ( $\frac{1}{2}$ ) interest in all petroleum that is or may be in, on, or under said land. The aforementioned reservation of phosphate, mineral, metals and petroleum rights shall not include and County hereby expressly releases any and all rights of entry and rights of exploration relating to such phosphate, mineral, metals and petroleum rights.

IN WITNESS WHEREOF, County has caused these presents to be executed in its name by its Board of County Commissioners acting by the Mayor or Vice Mayor of said Board, the day and year aforesaid.

### ATTEST:

SHARON R. BOCK  
CLERK & COMPTROLLER

PALM BEACH COUNTY, a political  
subdivision of the State of Florida

By: \_\_\_\_\_  
Deputy Clerk

By: \_\_\_\_\_  
Mary Lou Berger, Mayor

APPROVED AS TO FORM  
AND LEGAL SUFFICIENCY

(OFFICIAL SEAL)

By: \_\_\_\_\_  
Assistant County Attorney

PREPARED BY AND RETURN TO:  
DELLA LOWERY, PROPERTY SPECIALIST  
PALM BEACH COUNTY  
PROPERTY & REAL ESTATE MANAGEMENT DIVISION  
2633 Vista Parkway  
West Palm Beach, FL 33411-5605

PCN: 74-43-43-04-05-026-0820

Closing Date: \_\_\_\_\_

Purchase Price: \_\_\_\_\_ \$0

## COUNTY DEED

This COUNTY DEED, made \_\_\_\_\_, by PALM BEACH COUNTY, a political subdivision of the State of Florida, by and through its Board of County Commissioners, whose legal mailing address is 2633 Vista Parkway, West Palm Beach, Florida 33411-5605, "County", and the CITY OF WEST PALM BEACH, a municipality duly organized and existing by virtue of the laws of the State of Florida, whose legal mailing address is 401 Clematis Street, West Palm Beach, Florida 33401, "City".

### WITNESSETH:

That County, for and in consideration of the sum of Ten and 00/100 (\$10.00) Dollars to it in hand paid by City, the receipt whereof is hereby acknowledged, has granted, bargained and sold to City, its successors and assigns forever, the following described land lying and being in Palm Beach County, Florida:

LT 82 BLK 26 NORTH PALM BEACH PL 2

THE ABOVE BEING THE REAL PROPERTY DESCRIBED UNDER TAX CERTIFICATE NUMBER 38805 IN THE TAX DEED RECORDED IN OFFICIAL RECORD BOOK 27800, PAGE 0409, PUBLIC RECORDS OF PALM BEACH COUNTY, FLORIDA.

Reserving, however, unto County, its successors and assigns, an undivided three-fourths ( $\frac{3}{4}$ ) interest in, and title in and to an undivided three-fourths ( $\frac{3}{4}$ ) interest in, all the phosphate, minerals, and metals that are or may be in, on, or under the said land and an undivided one-half ( $\frac{1}{2}$ ) interest in all petroleum that is or may be in, on, or under said land. The aforementioned reservation of phosphate, mineral, metals and petroleum rights shall not include and County hereby expressly releases any and all rights of entry and rights of exploration relating to such phosphate, mineral, metals and petroleum rights.

IN WITNESS WHEREOF, County has caused these presents to be executed in its name by its Board of County Commissioners acting by the Mayor or Vice Mayor of said Board, the day and year aforesaid.

### ATTEST:

SHARON R. BOCK  
CLERK & COMPTROLLER

PALM BEACH COUNTY, a political  
subdivision of the State of Florida

By: \_\_\_\_\_  
Deputy Clerk

By: \_\_\_\_\_  
Mary Lou Berger, Mayor

APPROVED AS TO FORM  
AND LEGAL SUFFICIENCY

(OFFICIAL SEAL)

By: \_\_\_\_\_  
Assistant County Attorney

Attachment #3  
County Deeds (6 pages)



PREPARED BY AND RETURN TO:  
DELLA LOWERY, PROPERTY SPECIALIST  
PALM BEACH COUNTY  
PROPERTY & REAL ESTATE MANAGEMENT DIVISION  
2633 Vista Parkway  
West Palm Beach, FL 33411-5605

PCN: 74-43-43-16-02-032-0010  
Closing Date: \_\_\_\_\_  
Purchase Price: \_\_\_\_\_ \$0

## COUNTY DEED

This COUNTY DEED, made \_\_\_\_\_, by PALM BEACH COUNTY, a political subdivision of the State of Florida, by and through its Board of County Commissioners, whose legal mailing address is 2633 Vista Parkway, West Palm Beach, Florida 33411-5605, "County", and the CITY OF WEST PALM BEACH, a municipality duly organized and existing by virtue of the laws of the State of Florida, whose legal mailing address is 401 Clematis Street, West Palm Beach, Florida 33401, "City".

### WITNESSETH:

That County, for and in consideration of the sum of Ten and 00/100 (\$10.00) Dollars to it in hand paid by City, the receipt whereof is hereby acknowledged, has granted, bargained and sold to City, its successors and assigns forever, the following described land lying and being in Palm Beach County, Florida:

FRESHWATER 11<sup>TH</sup> & 12<sup>TH</sup> AVE ADD LT 1 BLK 32

THE ABOVE BEING THE REAL PROPERTY DESCRIBED UNDER TAX CERTIFICATE NUMBER 28122 IN THE TAX DEED RECORDED IN OFFICIAL RECORD BOOK 28067, PAGE 0932, PUBLIC RECORDS OF PALM BEACH COUNTY, FLORIDA.

Reserving, however, unto County, its successors and assigns, an undivided three-fourths ( $\frac{3}{4}$ ) interest in, and title in and to an undivided three-fourths ( $\frac{3}{4}$ ) interest in, all the phosphate, minerals, and metals that are or may be in, on, or under the said land and an undivided one-half ( $\frac{1}{2}$ ) interest in all petroleum that is or may be in, on, or under said land. The aforementioned reservation of phosphate, mineral, metals and petroleum rights shall not include and County hereby expressly releases any and all rights of entry and rights of exploration relating to such phosphate, mineral, metals and petroleum rights.

IN WITNESS WHEREOF, County has caused these presents to be executed in its name by its Board of County Commissioners acting by the Mayor or Vice Mayor of said Board, the day and year aforesaid.

### ATTEST:

SHARON R. BOCK  
CLERK & COMPTROLLER

By: \_\_\_\_\_  
Deputy Clerk

PALM BEACH COUNTY, a political  
subdivision of the State of Florida

By: \_\_\_\_\_  
Mary Lou Berger, Mayor

APPROVED AS TO FORM  
AND LEGAL SUFFICIENCY

By:   
Assistant County Attorney

(OFFICIAL SEAL)

PREPARED BY AND RETURN TO:  
DELLA LOWERY, PROPERTY SPECIALIST  
PALM BEACH COUNTY  
PROPERTY & REAL ESTATE MANAGEMENT DIVISION  
2633 Vista Parkway  
West Palm Beach, FL 33411-5605

PCN: 74-43-43-16-01-006-0021

Closing Date: \_\_\_\_\_

Purchase Price: \_\_\_\_\_ \$0

## COUNTY DEED

This COUNTY DEED, made \_\_\_\_\_, by PALM BEACH COUNTY, a political subdivision of the State of Florida, by and through its Board of County Commissioners, whose legal mailing address is 2633 Vista Parkway, West Palm Beach, Florida 33411-5605, "County", and the CITY OF WEST PALM BEACH, a municipality duly organized and existing by virtue of the laws of the State of Florida, whose legal mailing address is 401 Clematis Street, West Palm Beach, Florida 33401, "City".

### WITNESSETH:

That County, for and in consideration of the sum of Ten and 00/100 (\$10.00) Dollars to it in hand paid by City, the receipt whereof is hereby acknowledged, has granted, bargained and sold to City, its successors and assigns forever, the following described land lying and being in Palm Beach County, Florida:

FRESHWATER ADD TO WPB AMNDED W 24 FT OF LT 2 BLK 6

THE ABOVE BEING THE REAL PROPERTY DESCRIBED UNDER TAX CERTIFICATE NUMBER 39818 IN THE TAX DEED RECORDED IN OFFICIAL RECORD BOOK 28160, PAGE 0834, PUBLIC RECORDS OF PALM BEACH COUNTY, FLORIDA.

Reserving, however, unto County, its successors and assigns, an undivided three-fourths ( $\frac{3}{4}$ ) interest in, and title in and to an undivided three-fourths ( $\frac{3}{4}$ ) interest in, all the phosphate, minerals, and metals that are or may be in, on, or under the said land and an undivided one-half ( $\frac{1}{2}$ ) interest in all petroleum that is or may be in, on, or under said land. The aforementioned reservation of phosphate, mineral, metals and petroleum rights shall not include and County hereby expressly releases any and all rights of entry and rights of exploration relating to such phosphate, mineral, metals and petroleum rights.

IN WITNESS WHEREOF, County has caused these presents to be executed in its name by its Board of County Commissioners acting by the Mayor or Vice Mayor of said Board, the day and year aforesaid.

### ATTEST:

SHARON R. BOCK  
CLERK & COMPTROLLER

By: \_\_\_\_\_  
Deputy Clerk

PALM BEACH COUNTY, a political  
subdivision of the State of Florida

By: \_\_\_\_\_  
Mary Lou Berger, Mayor

APPROVED AS TO FORM  
AND LEGAL SUFFICIENCY

By:   
Assistant County Attorney

(OFFICIAL SEAL)

PREPARED BY AND RETURN TO:  
DELLA LOWERY, PROPERTY SPECIALIST  
PALM BEACH COUNTY  
PROPERTY & REAL ESTATE MANAGEMENT DIVISION  
2633 Vista Parkway  
West Palm Beach, FL 33411-5605

PCN: 74-43-43-21-06-018-0091  
Closing Date: \_\_\_\_\_  
Purchase Price: \_\_\_\_\_ \$0

**COUNTY DEED**

**This COUNTY DEED**, made \_\_\_\_\_, by **PALM BEACH COUNTY**, a political subdivision of the State of Florida, by and through its Board of County Commissioners, whose legal mailing address is 2633 Vista Parkway, West Palm Beach, Florida 33411-5605, "County", and the **CITY OF WEST PALM BEACH**, a municipality duly organized and existing by virtue of the laws of the State of Florida, whose legal mailing address is 401 Clematis Street, West Palm Beach, Florida 33401, "City".

**WITNESSETH:**

That County, for and in consideration of the sum of Ten and 00/100 (\$10.00) Dollars to it in hand paid by City, the receipt whereof is hereby acknowledged, has granted, bargained and sold to City, its successors and assigns forever, the following described land lying and being in Palm Beach County, Florida:

CLOWS ADDITION W 1/2 OF LT 9 BLK 18

THE ABOVE BEING THE REAL PROPERTY DESCRIBED UNDER TAX CERTIFICATE NUMBER 38949 IN THE TAX DEED RECORDED IN OFFICIAL RECORD BOOK 28160, PAGE 0365, PUBLIC RECORDS OF PALM BEACH COUNTY, FLORIDA.

Reserving, however, unto County, its successors and assigns, an undivided three-fourths (3/4) interest in, and title in and to an undivided three-fourths (3/4) interest in, all the phosphate, minerals, and metals that are or may be in, on, or under the said land and an undivided one-half (1/2) interest in all petroleum that is or may be in, on, or under said land. The aforementioned reservation of phosphate, mineral, metals and petroleum rights shall not include and County hereby expressly releases any and all rights of entry and rights of exploration relating to such phosphate, mineral, metals and petroleum rights.

**IN WITNESS WHEREOF**, County has caused these presents to be executed in its name by its Board of County Commissioners acting by the Mayor or Vice Mayor of said Board, the day and year aforesaid.

**ATTEST:**

**SHARON R. BOCK**  
**CLERK & COMPTROLLER**

**PALM BEACH COUNTY, a political**  
**subdivision of the State of Florida**

By: \_\_\_\_\_  
Deputy Clerk

By: \_\_\_\_\_  
Mary Lou Berger, Mayor

**APPROVED AS TO FORM**  
**AND LEGAL SUFFICIENCY**

(OFFICIAL SEAL)

By:   
Assistant County Attorney

PREPARED BY AND RETURN TO:  
DELLA LOWERY, PROPERTY SPECIALIST  
PALM BEACH COUNTY  
PROPERTY & REAL ESTATE MANAGEMENT DIVISION  
2633 Vista Parkway  
West Palm Beach, FL 33411-5605

PCN: 74-43-43-09-05-033-0121

Closing Date: \_\_\_\_\_

Purchase Price: \$0 \_\_\_\_\_

## COUNTY DEED

This COUNTY DEED, made \_\_\_\_\_, by PALM BEACH COUNTY, a political subdivision of the State of Florida, by and through its Board of County Commissioners, whose legal mailing address is 2633 Vista Parkway, West Palm Beach, Florida 33411-5605, "County", and the CITY OF WEST PALM BEACH, a municipality duly organized and existing by virtue of the laws of the State of Florida, whose legal mailing address is 401 Clematis Street, West Palm Beach, Florida 33401, "City".

### WITNESSETH:

That County, for and in consideration of the sum of Ten and 00/100 (\$10.00) Dollars to it in hand paid by City, the receipt whereof is hereby acknowledged, has granted, bargained and sold to City, its successors and assigns forever, the following described land lying and being in Palm Beach County, Florida:

NORTHWOOD ADD W 15 FT OF LT 12 & ALL LTS 13 & 14 BLK 33

THE ABOVE BEING THE REAL PROPERTY DESCRIBED UNDER TAX CERTIFICATE NUMBER 186 IN THE TAX DEED RECORDED IN OFFICIAL RECORD BOOK 28218, PAGE 1732, PUBLIC RECORDS OF PALM BEACH COUNTY, FLORIDA.

Reserving, however, unto County, its successors and assigns, an undivided three-fourths ( $\frac{3}{4}$ ) interest in, and title in and to an undivided three-fourths ( $\frac{3}{4}$ ) interest in, all the phosphate, minerals, and metals that are or may be in, on, or under the said land and an undivided one-half ( $\frac{1}{2}$ ) interest in all petroleum that is or may be in, on, or under said land. The aforementioned reservation of phosphate, mineral, metals and petroleum rights shall not include and County hereby expressly releases any and all rights of entry and rights of exploration relating to such phosphate, mineral, metals and petroleum rights.

IN WITNESS WHEREOF, County has caused these presents to be executed in its name by its Board of County Commissioners acting by the Mayor or Vice Mayor of said Board, the day and year aforesaid.

### ATTEST:

SHARON R. BOCK  
CLERK & COMPTROLLER

PALM BEACH COUNTY, a political  
subdivision of the State of Florida

By: \_\_\_\_\_  
Deputy Clerk

By: \_\_\_\_\_  
Mary Lou Berger, Mayor

APPROVED AS TO FORM  
AND LEGAL SUFFICIENCY

(OFFICIAL SEAL)

By:   
Assistant County Attorney

PREPARED BY AND RETURN TO:  
DELLA LOWERY, PROPERTY SPECIALIST  
PALM BEACH COUNTY  
PROPERTY & REAL ESTATE MANAGEMENT DIVISION  
2633 Vista Parkway  
West Palm Beach, FL 33411-5605

PCN: 74-43-43-09-05-088-0620  
Closing Date: \_\_\_\_\_  
Purchase Price: \_\_\_\_\_ \$0

## COUNTY DEED

This COUNTY DEED, made \_\_\_\_\_, by PALM BEACH COUNTY, a political subdivision of the State of Florida, by and through its Board of County Commissioners, whose legal mailing address is 2633 Vista Parkway, West Palm Beach, Florida 33411-5605, "County", and the CITY OF WEST PALM BEACH, a municipality duly organized and existing by virtue of the laws of the State of Florida, whose legal mailing address is 401 Clematis Street, West Palm Beach, Florida 33401, "City".

### WITNESSETH:

That County, for and in consideration of the sum of Ten and 00/100 (\$10.00) Dollars to it in hand paid by City, the receipt whereof is hereby acknowledged, has granted, bargained and sold to City, its successors and assigns forever, the following described land lying and being in Palm Beach County, Florida:

NORTHWOOD ADDITION LTS 62 & 63 BLK 88

THE ABOVE BEING THE REAL PROPERTY DESCRIBED UNDER TAX CERTIFICATE NUMBER 37652 IN THE TAX DEED RECORDED IN OFFICIAL RECORD BOOK 28160, PAGE 0416, PUBLIC RECORDS OF PALM BEACH COUNTY, FLORIDA.

Reserving, however, unto County, its successors and assigns, an undivided three-fourths ( $\frac{3}{4}$ ) interest in, and title in and to an undivided three-fourths ( $\frac{3}{4}$ ) interest in, all the phosphate, minerals, and metals that are or may be in, on, or under the said land and an undivided one-half ( $\frac{1}{2}$ ) interest in all petroleum that is or may be in, on, or under said land. The aforementioned reservation of phosphate, mineral, metals and petroleum rights shall not include and County hereby expressly releases any and all rights of entry and rights of exploration relating to such phosphate, mineral, metals and petroleum rights.

IN WITNESS WHEREOF, County has caused these presents to be executed in its name by its Board of County Commissioners acting by the Mayor or Vice Mayor of said Board, the day and year aforesaid.

### ATTEST:

SHARON R. BOCK  
CLERK & COMPTROLLER

By: \_\_\_\_\_  
Deputy Clerk

PALM BEACH COUNTY, a political  
subdivision of the State of Florida

By: \_\_\_\_\_  
Mary Lou Berger, Mayor

APPROVED AS TO FORM  
AND LEGAL SUFFICIENCY

By:   
Assistant County Attorney

(OFFICIAL SEAL)

PREPARED BY AND RETURN TO:  
DELLA LOWERY, PROPERTY SPECIALIST  
PALM BEACH COUNTY  
PROPERTY & REAL ESTATE MANAGEMENT DIVISION  
2633 Vista Parkway  
West Palm Beach, FL 33411-5605

PCN: 74-43-43-04-05-026-0820  
Closing Date: \_\_\_\_\_  
Purchase Price: \_\_\_\_\_ \$0

## COUNTY DEED

This COUNTY DEED, made \_\_\_\_\_, by PALM BEACH COUNTY, a political subdivision of the State of Florida, by and through its Board of County Commissioners, whose legal mailing address is 2633 Vista Parkway, West Palm Beach, Florida 33411-5605, "County", and the CITY OF WEST PALM BEACH, a municipality duly organized and existing by virtue of the laws of the State of Florida, whose legal mailing address is 401 Clematis Street, West Palm Beach, Florida 33401, "City".

### WITNESSETH:

That County, for and in consideration of the sum of Ten and 00/100 (\$10.00) Dollars to it in hand paid by City, the receipt whereof is hereby acknowledged, has granted, bargained and sold to City, its successors and assigns forever, the following described land lying and being in Palm Beach County, Florida:

LT 82 BLK 26 NORTH PALM BEACH PL 2

THE ABOVE BEING THE REAL PROPERTY DESCRIBED UNDER TAX CERTIFICATE NUMBER 38805 IN THE TAX DEED RECORDED IN OFFICIAL RECORD BOOK 27800, PAGE 0409, PUBLIC RECORDS OF PALM BEACH COUNTY, FLORIDA.

Reserving, however, unto County, its successors and assigns, an undivided three-fourths ( $\frac{3}{4}$ ) interest in, and title in and to an undivided three-fourths ( $\frac{3}{4}$ ) interest in, all the phosphate, minerals, and metals that are or may be in, on, or under the said land and an undivided one-half ( $\frac{1}{2}$ ) interest in all petroleum that is or may be in, on, or under said land. The aforementioned reservation of phosphate, mineral, metals and petroleum rights shall not include and County hereby expressly releases any and all rights of entry and rights of exploration relating to such phosphate, mineral, metals and petroleum rights.

IN WITNESS WHEREOF, County has caused these presents to be executed in its name by its Board of County Commissioners acting by the Mayor or Vice Mayor of said Board, the day and year aforesaid.

### ATTEST:

SHARON R. BOCK  
CLERK & COMPTROLLER

PALM BEACH COUNTY, a political  
subdivision of the State of Florida

By: \_\_\_\_\_  
Deputy Clerk

By: \_\_\_\_\_  
Mary Lou Berger, Mayor

APPROVED AS TO FORM  
AND LEGAL SUFFICIENCY

By:   
Assistant County Attorney

(OFFICIAL SEAL)

Attachment #4  
Letter (1 page)



City Administration  
401 Clematis Street  
West Palm Beach FL 33401  
561-822-1400  
Fax: 561-822-1424

July 27, 2016

Ross C. Hering, Director  
Facilities Development & Operations Department  
2633 Vista Parkway  
West Palm Beach, FL 33411

Re: Acceptance of County Owned Escheated Tax Deeds

Dear Mr. Hering:

In response to your letter of July 20, 2016 regarding 6 parcels of property acquired by Tax Deed, please be advised that the City will accept all 6 parcels.

If you have any further questions, please contact me.

Sincerely,

A handwritten signature in black ink, appearing to read 'Jeffrey Green'.

Jeffrey Green  
City Administrator

Copy: Armando Fana – HCD Director