

PALM BEACH COUNTY BOARD OF COUNTY COMMISSIONERS

AGENDA ITEM SUMMARY

=====

Meeting Date: October 18, 2016 (X) Consent () Regular
() Workshop () Public Hearing

Department
Submitted By: Environmental Resources Management

Submitted For: Environmental Resources Management

=====

I. EXECUTIVE BRIEF

Motion and Title: Staff recommends motion to approve: Contract with Murray Logan Construction Inc. in the amount not to exceed \$388,650 for the construction of the Old Bridge Park Public Use Facilities Project No. 2016ERM01 for a period of one hundred and eighty (180) calendar days.

Summary: This project will provide public access to Lake Worth Lagoon restoration projects with the construction of a seawall, floating dock, sidewalks and signage. Four (4) bids were received for this project located in a City of Lake Worth park. Murray Logan Construction Inc. (Murray Logan), a Palm Beach County company, was the lowest responsive, responsible bidder. The Small Business Enterprise (SBE) participation goal established by the SBE Ordinance (R2002-0064) is 15% overall. Murray Logan agreed to 24.09% SBE participation. The project is funded by grants from the Florida Inland Navigation District (FIND) and the Florida Department of Environmental Protection (DEP) totaling \$282,868 along with \$105,782 in County funds. District 7 (DC)

Background and Justification: Bids were received through the Department of Environmental Resources Management by the Board of County Commissioners on August 16, 2016. Grant Agreements from FIND (R-2014-1939) and DEP (R2014-1946) will reimburse the County amounts of \$229,375 and \$53,493, respectively. The remaining funding of \$105,782 will come from Palm Beach County.

Attachments:

- 1. Location Map
- 2. Contract http://www.co.palm-beach.fl.us/erm/contracts/docs/2016ERM01/2016ERM01_CONTRACT.zip
- 3. Bid Evaluation Summary, Bid Tabulation, SBE Compliance Review

=====

Recommended by: Robt Collins 9/21/16
Department Director Date

Approved by: [Signature] 10-11-16
Deputy County Administrator Date

II. FISCAL IMPACT ANALYSIS

A. Five Year Summary of Fiscal Impact:

Fiscal Years	2017	2018	2019	2020	2021
Capital Expenditures	_____	_____	_____	_____	_____
Operating Costs	<u>\$388,650</u>	_____	_____	_____	_____
External Revenues	<u>(\$282,868)</u>	_____	_____	_____	_____
Program Income (County)	_____	_____	_____	_____	_____
In-Kind Match (County)	_____	_____	_____	_____	_____
NET FISCAL IMPACT	<u>\$105,782</u>	_____	_____	_____	_____
# ADDITIONAL FTE POSITIONS (Cumulative)	_____	_____	_____	_____	_____

Is Item Included in Current Budget? Yes X No _____
 Budget Account No.: Fund _____ Department _____ Unit _____ Object _____
 Program _____

B. Recommended Sources of Funds/Summary of Fiscal Impact:

FIND Grant PB-14-182 \$229,375.00 (1225-380-3088-3401)
 DEP S0751 \$ 53,493.26 (1229-380-3088-3401)
 Vessel Registration Fees \$ 105,781.74 (1225-380-3088-3401)

C. Department Fiscal Review:

S. Neary

III. REVIEW COMMENTS

A. OFMB Fiscal and /or Contract Dev. and Control Comments:

J. M. Webb 9/27/16
 OFMB ET 9/26 MB 9/26 GMA 9/27
James R. ... for ...
 Contract Development and Control
 10/3/16 *JR*

B. Legal Sufficiency:

AWG 10/4/16
 Assistant County Attorney

C. Other Department Review:

 Department Director

ATTACHMENT 1

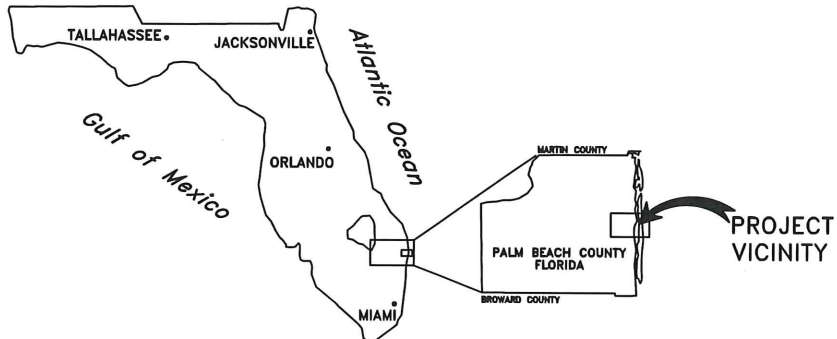

VICINITY MAP
N.T.S.

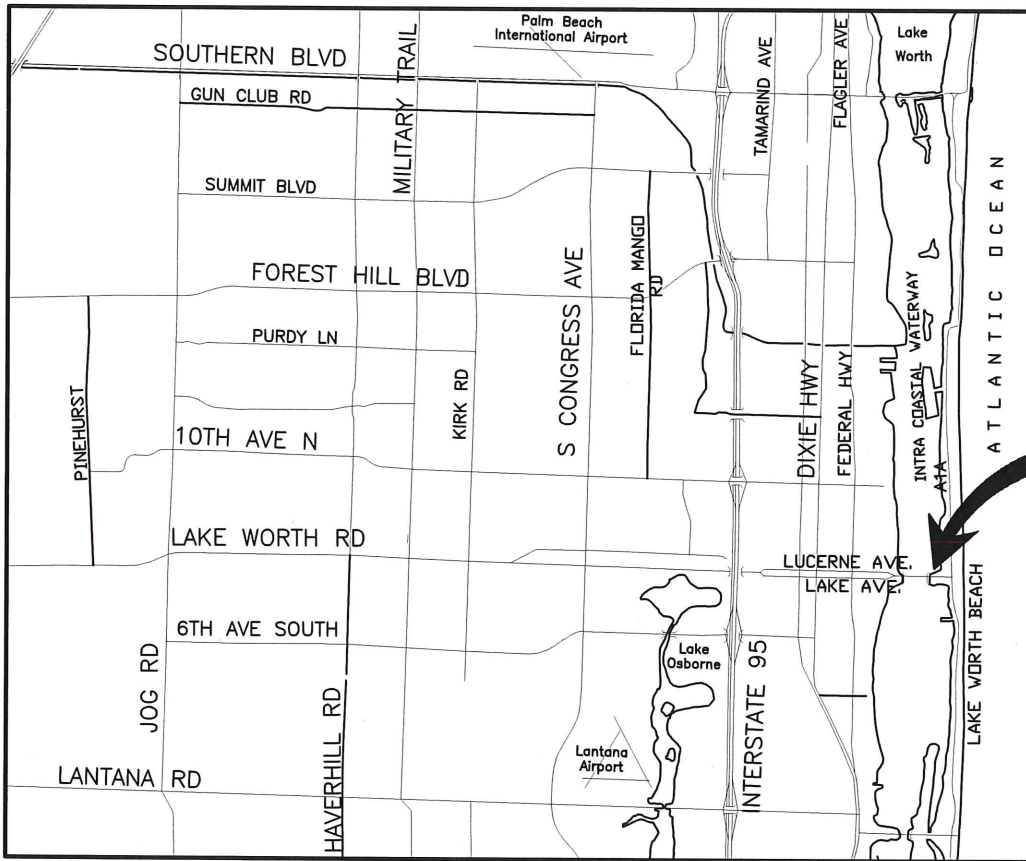

SECTION 23, 26, 27, 22 TOWNSHIP 44S, RANGE 43E

LOCATION MAP
N.T.S.

T:\eerr\her\Current Projects\Old Bridge Park\ACDE\LOCATION.dwg

Sheet 1
Of 1

Project
CITY OF LAKE WORTH
OLD BRIDGE PARK
LOCATION MAP

SEAL

Scale:	AS NOTED	No.	Revision	By	Date
Approved:	CB				
Drawn:	ME				
Checked:	CT				
Date:	09/06/2016				
Field Book No:					



PALM BEACH COUNTY
DEPARTMENT OF
ENVIRONMENTAL RESOURCES MANAGEMENT
2300 NORTH JOG ROAD, 4th FLOOR
WEST PALM BEACH, FLORIDA
(561) 233-2400

Old Bridge Park Project Location

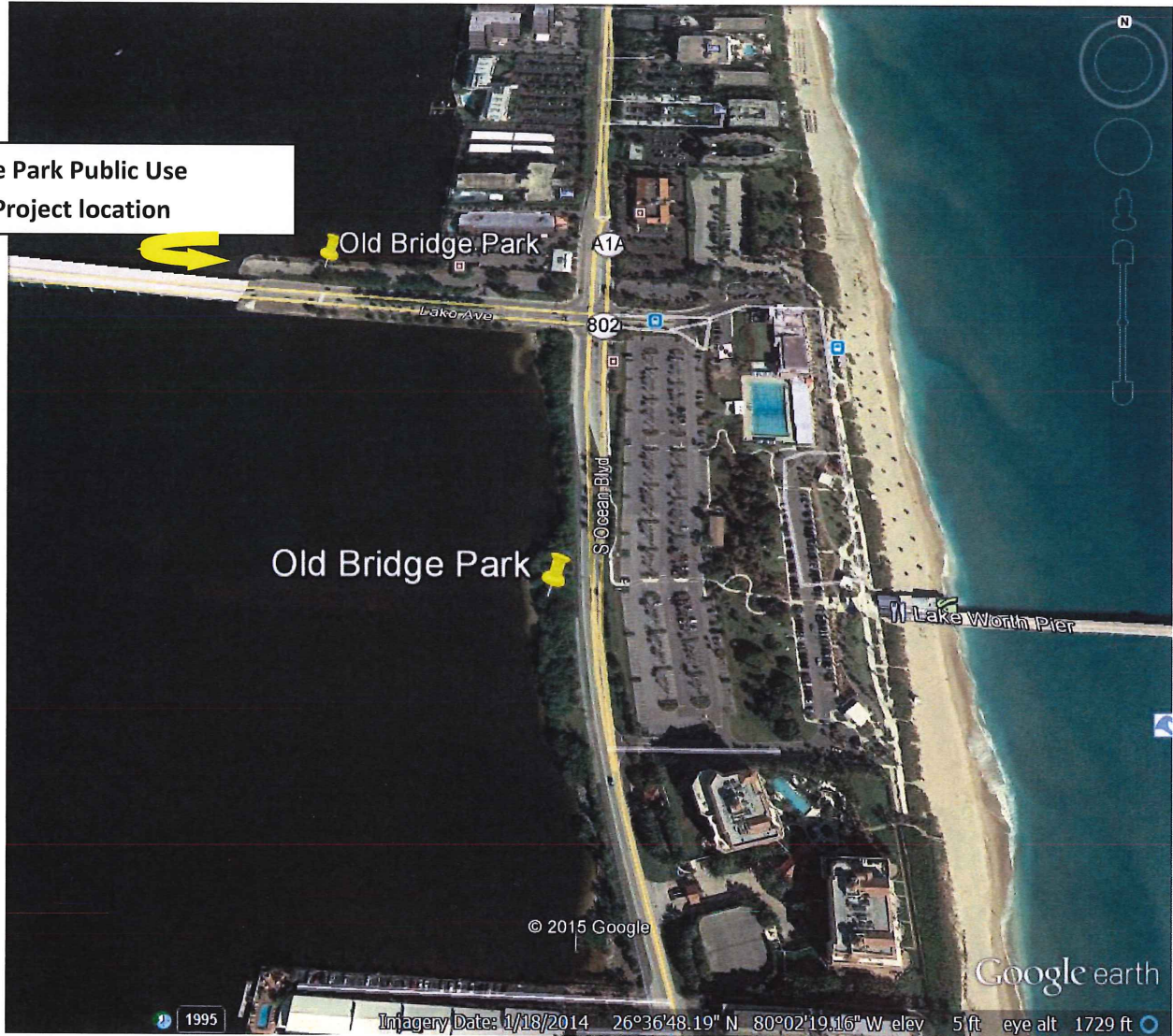

ATTACHMENT 3

**Palm Beach County
Department of Environmental Resources Management
Construction Contract Bid Evaluation Summary**

Project No.: 2016ERM01
Project Name: Old Bridge Park Public Use Facilities
Bid Opening: August 16, 2016

I. Lowest responsive, responsible bidder:

Murray Logan Construction Inc.

II. Bidders, ranked from lowest to highest:

Bidder	Evaluated Bid Amount	SBE Participation	Business Location
1. Murray Logan Construction Inc.	\$ 388,650.00	24.09%	PBC
2. Coston Marine Services, Inc.	\$ 412,391.00	78.33%	PBC
3. Ferreira Construction Southern Division Co., Inc.	\$ 449,000.00	2.02%	Regional
4. Construct Co Inc	\$ 449,739.00	N/E	N/E

N/E = Not Evaluated

III. Disqualified bidders:

Bidder	Reason
1. NONE	N/A

IV. Alternate Bid Items used to determine Evaluated Bid Amount:

NA.

V. Did SBE Participation affect bid ranking?

No.

VI. Did Local Preference affect bid ranking?

No.

VII. Will Contract Award Amount differ from Evaluated Bid Amount?

No.

**Palm Beach County
Department of Environmental Resources Management
Construction Contract Bid Tabulation**

Project No.: 2016ERM01
 Project Name: Old Bridge Park Public Use Facilities
 Bid Opening: August 16, 2016
 Contract Time: 180 calendar days

ITEM	BASE BID ITEMS	QUANTITY	UNIT	ERM Estimate		Average of All Bids	Murray Logan Construction Inc.		Coston Marine Services Inc.		Ferreira Construction Southern Division Co. Inc.		Construct Co. Inc.	
				UNIT COST	TOTAL COST		UNIT COST	TOTAL COST	UNIT COST	TOTAL COST	UNIT COST	TOTAL COST	UNIT COST	TOTAL COST
1	MOBILIZATION AND DEMOBILIZATION	1	LS	80,000.00	80,000.00	\$ 34,655.50	\$ 14,540.00	\$ 14,540.00	\$ 15,000.00	\$ 15,000.00	\$ 70,082.00	\$ 70,082.00	\$ 39,000.00	\$ 39,000.00
2	CONSTRUCTION SURVEYS & AS BUILT DRAWINGS	1	LS	6,000.00	6,000.00	7,600.00	12,000.00	12,000.00	2,000.00	2,000.00	10,400.00	10,400.00	6,000.00	6,000.00
3	DEMOLITION ASPHALT, CURB AND SIDEWALK	1	LS	4,000.00	4,000.00	5,250.00	3,500.00	3,500.00	4,000.00	4,000.00	2,300.00	2,300.00	11,200.00	11,200.00
4	DEMOLITION SEAWALL CAP & BRIDGE ABUTMENT	1	LS	12,000.00	12,000.00	7,575.00	9,000.00	9,000.00	8,000.00	8,000.00	10,200.00	10,200.00	3,100.00	3,100.00
5	EXCAVATION AND REMOVAL	100	CY	10.00	1,000.00	35.78	20.00	2,000.00	30.00	3,000.00	51.60	5,160.00	41.50	4,150.00
6	EMBANKMENT (CLEAN SAND FILL)	100	CY	20.00	2,000.00	23.98	20.00	2,000.00	20.00	2,000.00	35.30	3,530.00	20.60	2,060.00
7	SHEET PILING (SEAWALL)	2145	SF	40.00	85,800.00	56.91	57.00	122,265.00	62.00	132,990.00	52.65	112,934.25	56.00	120,120.00
8	CLASS IV CONCRETE (PROPOSED SEAWALL CAP)	40	CY	700.00	28,000.00	698.69	1,100.00	44,000.00	558.75	22,350.00	731.00	29,240.00	405.00	16,200.00
9	REINFORCING STEEL (PROPOSED SEAWALL CAP)	2715	LBS	2.00	5,430.00	3.73	1.00	2,715.00	10.00	27,150.00	1.90	5,158.50	2.00	5,430.00
10	CLASS IV CONCRETE (PROPOSED DEADMAN)	8	CY	700.00	5,600.00	930.63	700.00	5,600.00	1,062.50	8,500.00	1,050.00	8,400.00	910.00	7,280.00
11	REINFORCING STEEL (PROPOSED DEADMAN)	235	LBS	2.00	470.00	12.25	1.00	235.00	36.00	8,460.00	8.00	1,880.00	4.00	940.00
12	15' LONG, 1" DIA TIE-BACK ROD ASSEMBLY	16	EA	200.00	3,200.00	708.75	1,000.00	16,000.00	780.00	12,480.00	620.00	9,920.00	435.00	6,960.00
13	RIP-RAP SAND-CEMENT	15	TON	700.00	10,500.00	368.38	600.00	9,000.00	530.00	7,950.00	168.50	2,527.50	175.00	2,625.00
14	BEDDING STONE W/ GEOFABRIC	66	TON	100.00	6,600.00	109.59	35.00	2,310.00	105.00	6,930.00	143.35	9,461.10	155.00	10,230.00
15	ROCK RUBBLE/ARMOR STONE	143	TON	100.00	14,300.00	109.34	75.00	10,725.00	110.00	15,730.00	92.35	13,206.05	160.00	22,880.00
16	14" CONCRETE PILES (FLOATING DOCK)	145	LF	120.00	17,400.00	161.59	152.00	22,040.00	100.00	14,500.00	129.35	18,755.75	265.00	38,425.00
17	FLOATING DOCK INSTALLED COMPLETE	1	LS	60,000.00	60,000.00	45,895.00	40,000.00	40,000.00	45,000.00	45,000.00	47,580.00	47,580.00	51,000.00	51,000.00
18	DOCK GANGWAY INSTALLED COMPLETE	1	LS	30,000.00	30,000.00	22,790.00	20,000.00	20,000.00	25,000.00	25,000.00	22,660.00	22,660.00	23,500.00	23,500.00
19	4" CONCRETE SIDEWALK	150	SY	35.00	5,250.00	72.63	55.00	8,250.00	60.00	9,000.00	92.70	13,905.00	82.80	12,420.00
20	FINISHED GRADING (AREAS TO RECEIVE SOD)	220	SY	2.00	440.00	17.86	17.00	3,740.00	18.00	3,960.00	7.45	1,639.00	29.00	6,380.00
21	REMOVE ASPHALT AND BASE	375	SY	8.00	3,000.00	20.48	11.00	4,125.00	12.00	4,500.00	23.90	8,962.50	35.00	13,125.00
22	INSTALL 8" BASE AND 2" ASPHALT TYPE S-I	375	SY	24.00	9,000.00	55.63	44.00	16,500.00	48.00	18,000.00	56.50	21,187.50	74.00	27,750.00
23	SOD	220	SY	3.50	770.00	13.55	9.00	1,980.00	6.00	1,320.00	34.80	7,656.00	4.40	968.00
24	UNDERDRAIN (ALONG SEAWALL)	165	LF	50.00	8,250.00	45.69	50.00	8,250.00	35.00	5,775.00	26.75	4,413.75	71.00	11,715.00
25	TYPE "D" CURB	235	LF	15.00	3,525.00	17.15	19.00	4,465.00	21.60	5,076.00	21.00	4,935.00	7.00	1,645.00
26	CONCRETE WHEELSTOP	6	EA	30.00	180.00	50.13	55.00	330.00	60.00	360.00	37.50	225.00	48.00	288.00
27	DETECTABLE WARNING SURFACE	8	SF	10.00	80.00	87.86	110.00	880.00	120.00	960.00	45.45	363.60	76.00	608.00
28	6" SOLID WHITE STRIPE (LANE LINE)	100	LF	2.00	200.00	1.99	1.10	110.00	1.20	120.00	1.15	115.00	4.50	450.00
29	8" SOLID WHITE STRIPE (PARKING STALLS)	100	LF	2.00	200.00	2.28	1.65	165.00	1.80	180.00	1.15	115.00	4.50	450.00
30	8" SOLID BLUE STRIPE (PARKING STALLS)	100	LF	2.00	200.00	2.56	1.65	165.00	1.80	180.00	2.30	230.00	4.50	450.00
31	ACCESSIBLE PARKING SYMBOL	2	EA	750.00	1,500.00	152.50	110.00	220.00	120.00	240.00	85.00	170.00	295.00	590.00
32	END OF ROAD MARKER (ONE SIGN PER POST)	5	EA	300.00	1,500.00	241.38	220.00	1,100.00	240.00	1,200.00	255.50	1,277.50	250.00	1,250.00
33	ACCESSIBLE SIGN ASSEMBLY (TWO SIGNS PER POST)	2	EA	350.00	700.00	235.00	220.00	440.00	240.00	480.00	205.00	410.00	275.00	550.00
				BASE BID	\$ 407,095.00		\$ 388,650.00		\$ 412,391.00		\$ 449,000.00		\$ 449,739.00	

This tabulation is not a recommendation for award. All bids are subject to compliance review and approval.
 Numbers in **bold italic** indicate a calculation correction.



Office of
Small Business Assistance
 50 South Military Trail, Suite 202
 West Palm Beach, FL 33415
 (561) 616-6840
 Fax: (561) 616-6850
 www.pbcgov.com/osba

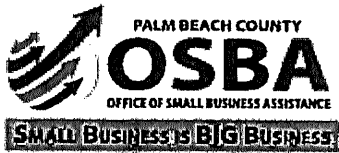

**Palm Beach County
 Board of County
 Commissioners**

Mary Lou Berger, Mayor
 Hal R. Valeche, Vice Mayor

Paulette Burdick
 Shelley Vana
 Steven L. Abrams
 Melissa McKinlay
 Priscilla A. Taylor

County Administrator
 Verdenia C. Baker

"An Equal Opportunity
 Affirmative Action Employer"



RECEIVED
 SEP 02 2016
 ENVIRONMENTAL RESOURCES MANAGEMENT

DATE: August 22, 2016
Revised: September 2, 2016

TO: Daniel Bates, Deputy Director
 Department of Environmental Resources Management

THROUGH: Allen F. Gray, Manager
 Office of Small Business Assistance *A. Gray*

FROM: Angela D. Smith, Small Business Development Specialist II
 Office of Small Business Assistance *AS*

SUBJECT: Compliance Review on Project No. 2016ERM01
 Old Bridge Park Public Use Facilities

The following is the Compliance Review of SBE participation on the above-mentioned project. The Bid Opening date was on August 16, 2016.

Low Bidder: **Murray Logan Construction, Inc.**
 313 65th Trail North
 West Palm Beach, FL 33413

Phone: 561-686-3948
Base Bid Amount: \$388,650.00

Goal: 15% Overall
Goal Achieved: 24.09%

SBE Participation:

(SB) Dennis J. Leavy & Associates	\$ 11,995.00	3.08%
(SB) Coral Steel	81,675.00	21.01%
	<u>\$ 93,670.00</u>	<u>24.09%</u>

2nd Lowest Bidder: **Coston Marine Services, Inc.**
 228 Hibiscus Street, Suite 4
 Jupiter, FL 33458

Phone: (561) 747-4382

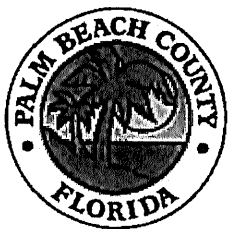

Bid Amount:	\$412,391.00	
Goal:	15% Overall	
<u>Goal Achieved:</u>	<u>78.33%</u>	
SBE Participation:		
(SB)Coston Marine Services, Inc.	\$ 323,047.75	78.33%
	<u>\$323,047.75</u>	<u>78.33%</u>

3 rd Lowest Bidder:	Ferreira Construction Southern Division Co, Inc. 100 SE Salerno Road Stuart, FL 34997	
Phone:	(772) 286-5123	
Bid Amount:	\$449,000.00	
Goal:	15% Overall	
<u>Goal Achieved:</u>	<u>2.02%</u>	
SBE Participation:		
(SB)Lidberg Land Surveying, Inc.	\$ 9,100.00	2.02%
	<u>\$9,100.00</u>	<u>2.02%</u>

EVALUATION:

The 1st low bidder, Murray Logan Construction, has met the SBE Goal for this project.

CC: Mayra Ashton, Contracts/Grants Coordinator, ERM