

**PALM BEACH COUNTY  
BOARD OF COUNTY COMMISSIONERS  
AGENDA ITEM SUMMARY**

<b>Meeting Date:</b> November 1, 2016	<input checked="" type="checkbox"/> Consent	<input type="checkbox"/> Regular
	<input type="checkbox"/> Workshop	<input type="checkbox"/> Public Hearing
<b>Department:</b>	Engineering & Public Works	
<b>Submitted By:</b>	Roadway Production Division	
<b>Submitted For:</b>	Roadway Production Division	

**I. EXECUTIVE BRIEF**

**Motion and Title:** Staff recommends motion to adopt: a resolution to endorse the State of Florida Department of Transportation (FDOT) delivery of four bridge replacement projects which include replacement of Bridge #934319 (Seminole Drive over the L-16 Canal), Bridge #934403 (Sandalford Boulevard over the E-1E Canal), Bridge #934904 (New England Boulevard over the E-1 Canal), and Bridge #934419 (El Clair Ranch Road over the L-30 Canal).

**SUMMARY:** Approval of this resolution will comply with FDOT's requirement that a local agency's governing board must adopt a resolution or equivalent when a grant funded transportation project falls within the jurisdiction of a local agency unable to deliver the project, or the project is to be delivered by FDOT for efficiency, innovation, cost or time savings, or other reasons that may optimize project delivery. The FDOT will work through a County staff liaison as they deliver the projects – from design through construction. The current cost estimate to deliver the four projects is approximately \$ 6.5M and will be funded with MPO funds.

Districts 3 & 5 (MRE)

**Background and Justification:** The Palm Beach County Metropolitan Planning Organization requested grant applications for their categorical grant funding. In response, the Engineering Department submitted an application for a number of bridge replacements, of which the four above named bridges were successful in obtaining funding. FDOT has determined that it will undertake the implementation of these projects from their inception to construction, with responsibilities that include estimating and controlling costs, ensuring the fulfillment of environmental and Federal requirements, obtaining adequate financing and performing the overall managing of the various parties involved in bringing the project to a successful completion. Before undertaking these responsibilities, FDOT requires that the County adopt a resolution to endorse FDOT's delivery of the four bridge replacement projects.

**Attachments:**

1. Location Sketch
2. Resolution (7 originals)

**Recommended by:**  10/19/16  
Department Director Date

**Approved By:**  10/24/16  
Assistant County Administrator Date



**PROJECT LOCATION  
SEMINOLE DR. OVER L-16 CANAL BRIDGE  
BRIDGE #934319**

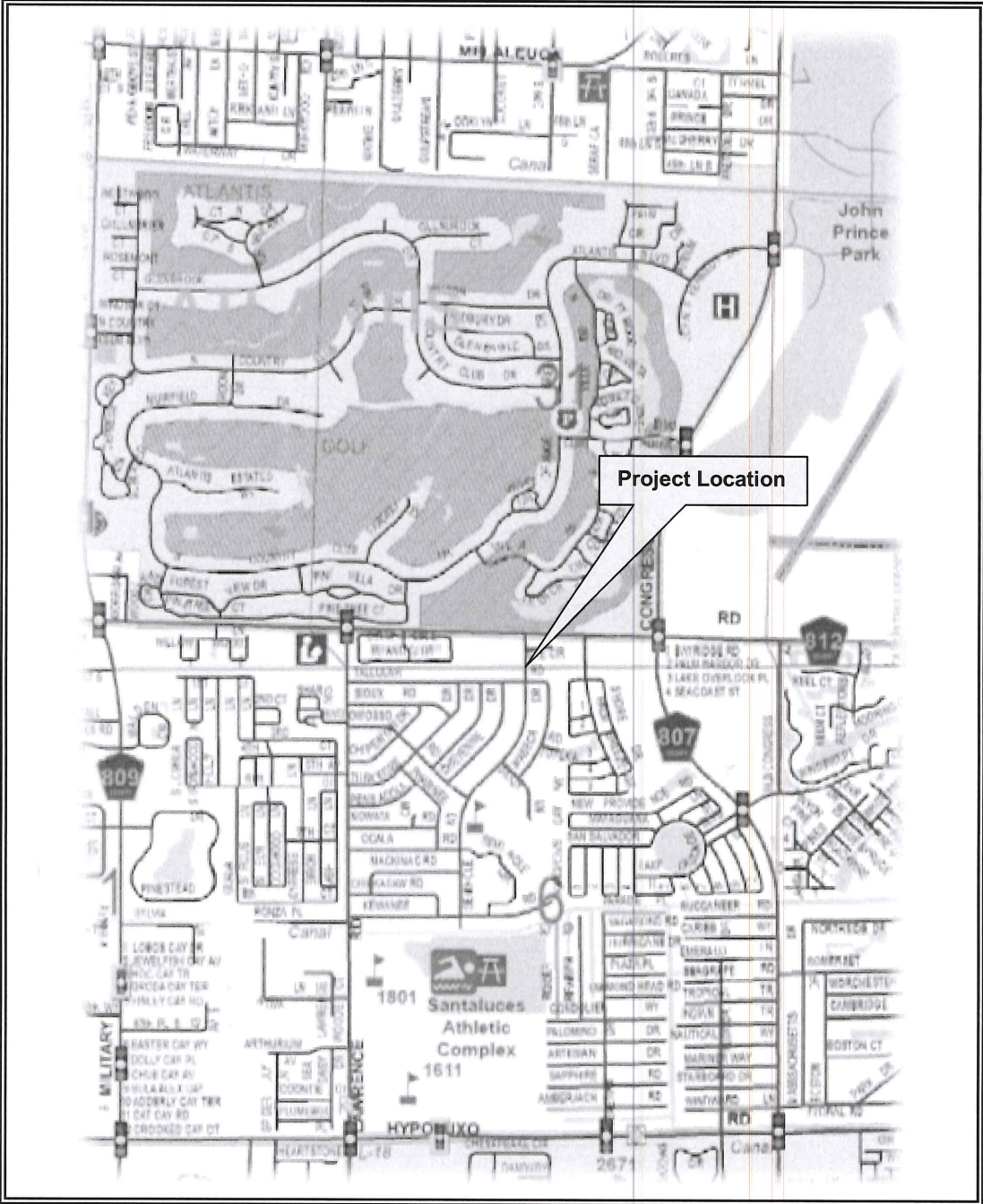

LOCATION MAP

**PROJECT LOCATION  
SANDALFOOT BOULEVARD OVER E-1E CANAL BRIDGE  
BRIDGE #934403**

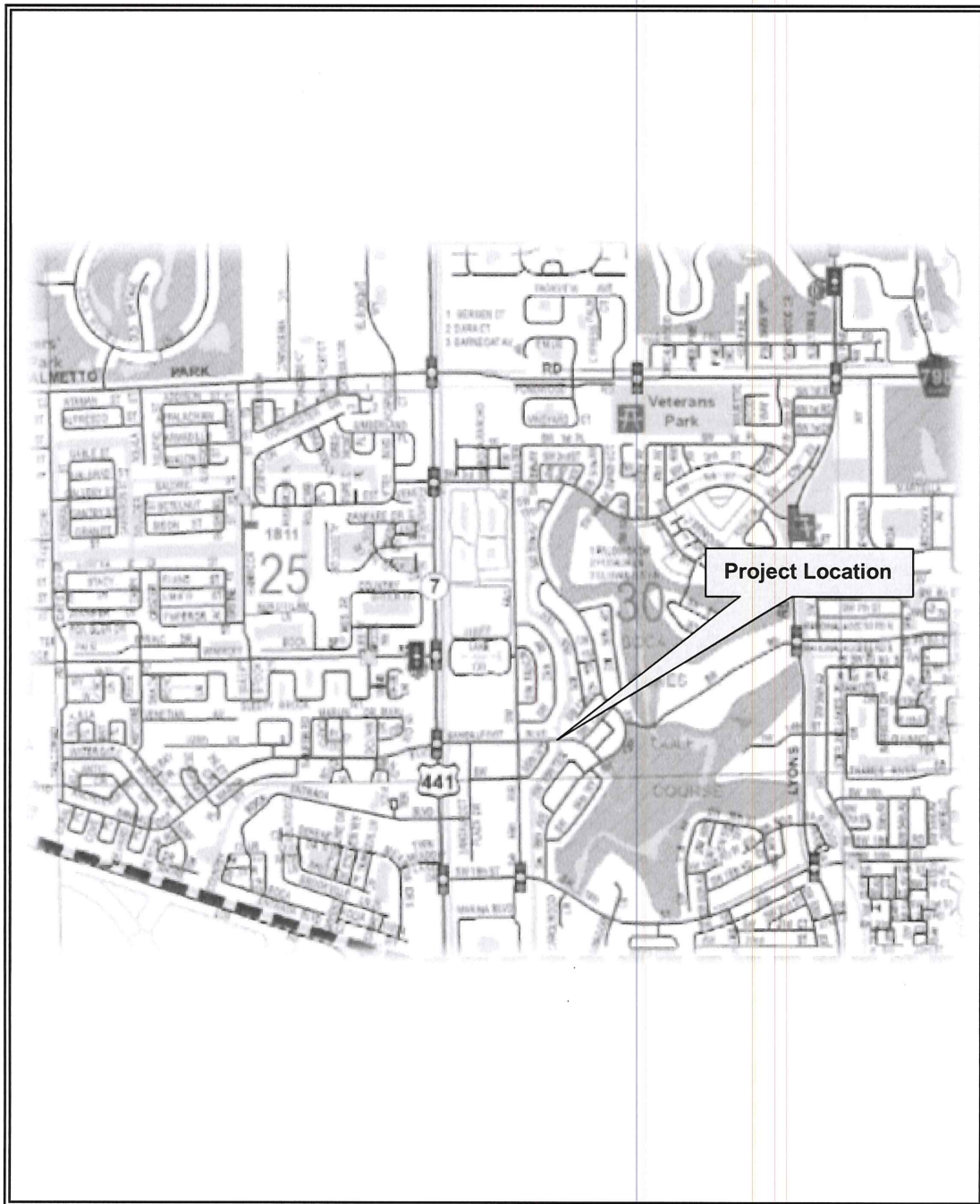

LOCATION MAP

**PROJECT LOCATION  
NEW ENGLAND BLVD OVER E-1 CANAL BRIDGE  
BRIDGE #934904**

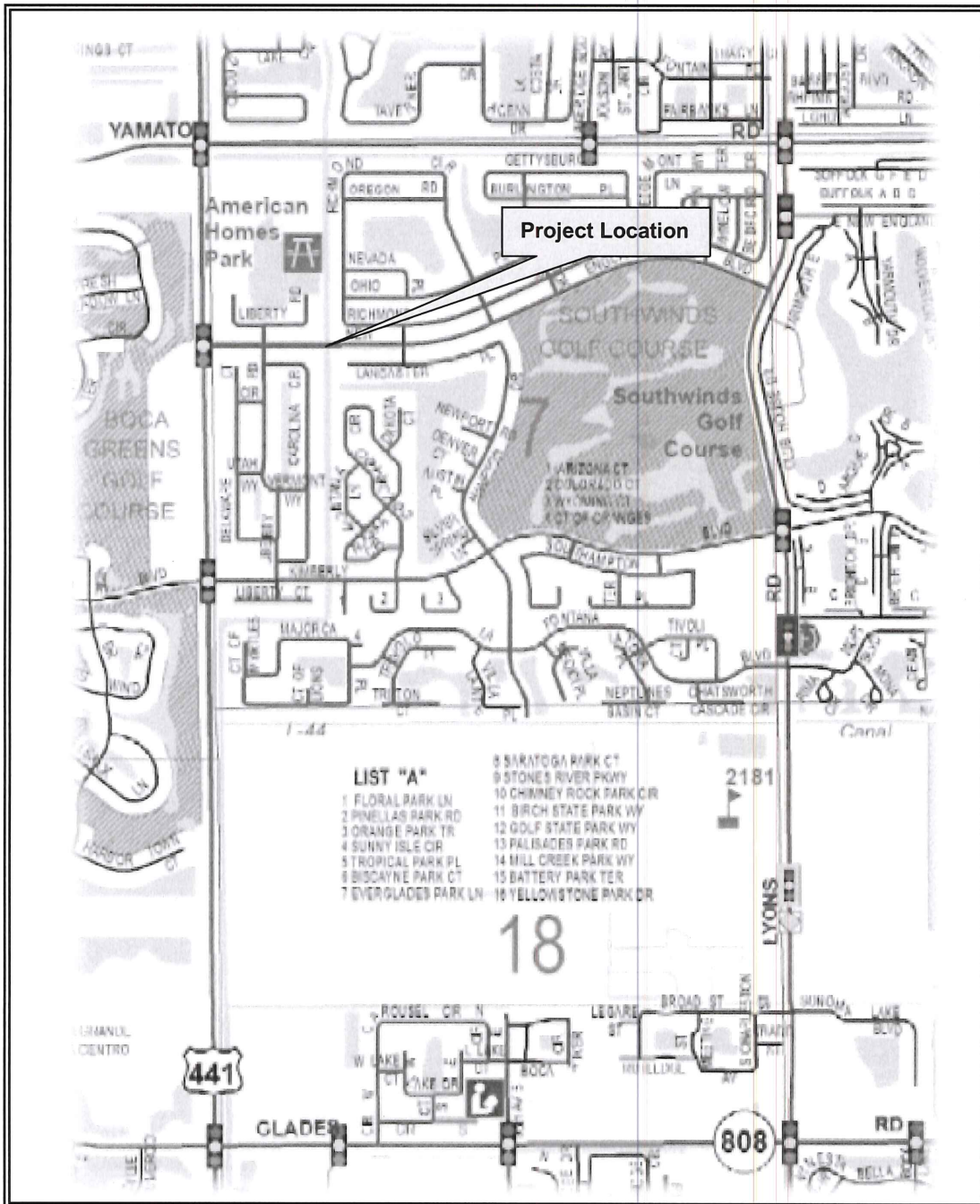

LOCATION MAP

**PROJECT LOCATION  
EL CLAIR RANCH ROAD OVER L-30 CANAL BRIDGE  
BRIDGE #934419**

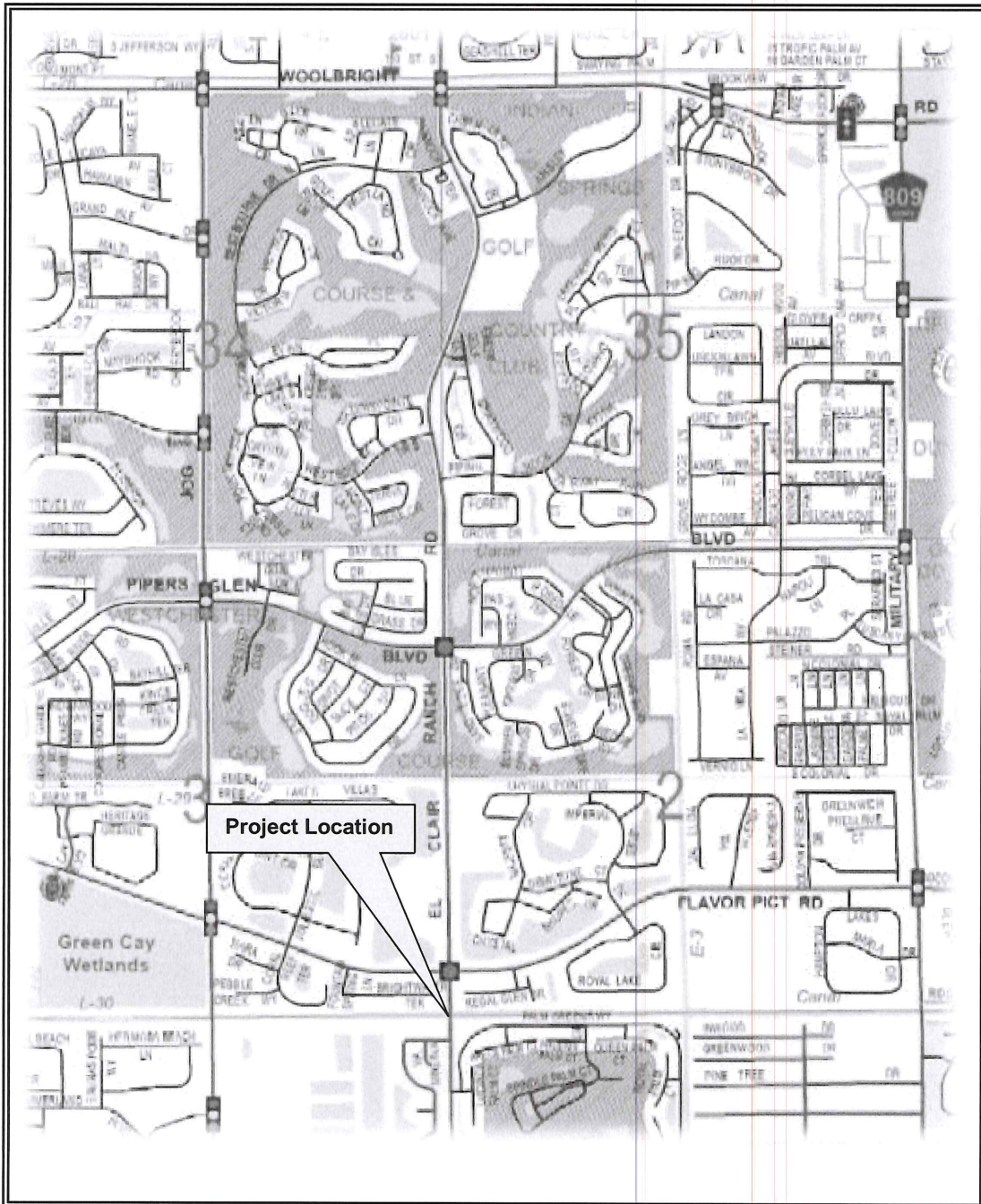

LOCATION MAP

**RESOLUTION NO. R-2016-**

**A RESOLUTION OF THE BOARD OF COUNTY COMMISSIONERS OF PALM BEACH COUNTY, FLORIDA; ENDORSING THE DELIVERY OF FOUR BRIDGE REPLACEMENT PROJECTS BY THE FLORIDA DEPARTMENT OF TRANSPORTATION.**

**WHEREAS**, the Florida Department of Transportation (FDOT) has determined that it will undertake the responsibilities for implementation of four bridge replacement projects from their inception through construction (Delivery); and

**WHEREAS**, FDOT has to deliver bridge replacements for Bridge #934319 (Seminole Drive over the L-16 Canal), Bridge #934403 (Sandalford Boulevard over the E-1E Canal), Bridge #934904 (New England Boulevard over the E-1 Canal), and Bridge #934419 (El Clair Ranch Road over the L-30 Canal); and

**WHEREAS**, FDOT has requested that Palm Beach County (County) adopt a resolution endorsing their Delivery of the referenced four bridge replacement projects; and

**WHEREAS**, through this Resolution, the FDOT will deliver the four bridge replacements; and

**WHEREAS**, the Board of County Commissioners has determined execution of this Resolution to be in the best interest of the citizens and residents of the County.

(Intentionally Left Blank)

NOW, THEREFORE be it resolved by the Board of County Commissioners (Board) of Palm Beach County, Florida, that the Mayor is hereby authorized to execute the Resolution.

- 1. The recitations set forth herein above are true, accurate and correct and are incorporated herein.
- 2. The Board does hereby endorse FDOT's Delivery of the referenced four bridge replacement projects.
- 3. This Resolution will take effect upon its adoption.

The foregoing resolution was offered by Commissioner \_\_\_\_\_ who moved its adoption. The motion was seconded by Commissioner \_\_\_\_\_ and upon being put to a vote, the vote was as follows:

Commissioner Mary Lou Berger, Mayor -  
Commissioner Hal R. Valeche, Vice Mayor -  
Commissioner Paulette Burdick -  
Commissioner Shelley Vana -  
Commissioner Steven L. Abrams -  
Commissioner Melissa McKinlay -  
Commissioner Priscilla A. Taylor -

The Mayor thereupon declared the Resolution duly passed and adopted this \_\_\_\_\_ day of \_\_\_\_\_ 2016.

PALM BEACH COUNTY, FLORIDA BY  
ITS BOARD OF COUNTY  
COMMISSIONERS

APPROVED AS TO FORM  
AND LEGAL SUFFICIENCY

SHARON R. BOCK, CLERK AND  
COMPTROLLER

By: \_\_\_\_\_

By: \_\_\_\_\_

Assistant County Attorney

Deputy Clerk