

**PALM BEACH COUNTY
BOARD OF COUNTY COMMISSIONERS
AGENDA ITEM SUMMARY**

Meeting Date:	February 6, 2018	[X] Consent	[] Regular
		[] Ordinance	[] Public Hearing
Department:	Engineering & Public Works		
Submitted By:	Engineering & Public Works		
Submitted For:	Traffic Division		

I. EXECUTIVE BRIEF

Motion and Title: Staff recommends motion to approve: A work order in the amount of \$207,576 to construct a mast arm traffic signal at the intersection of Hypoluxo Road and Rivermill Club Drive/Silverwood Drive, Palm Beach County (County) Intersection ID Number 41648 (Project), utilizing the County’s annual traffic signal contract R2017-0234 with Gerelco Traffic Controls, Inc. (Gerelco).

SUMMARY: Approval of this work order will allow Gerelco to construct the project. Per County PPM CW-F-050, this work order exceeds the threshold relating to staff approvals of contracts, thus requiring approval from the Board of County Commissioners (BCC). Gerelco is a Port St. Lucie based company with an office in Palm Beach County. The Small Business Enterprise (SBE) goal for all contracts is 15%. Gerelco’s SBE participation for the contract is 23.1%, but their SBE participation proposed for this work order is 2.67%. Their major SBE subcontractor, T.I. Electric, was in the process of renewing their SBE certification with the County at the time of signing this work order. Because Gereclo has not completed any major projects under this contract to date, their achieved SBE participation is 0%. District 3 (LBH)

Background and Justification: On March 14, 2017, the BCC approved an annual traffic signal contract R2017-0234 with Gerelco to provide for the furnishing and installation of various signal components for traffic control devices. The County desires to construct the project in accordance with the attached work order. The BCC’s approval is required to authorize the construction of the project. The County received a check for \$450,000 for design and construction on June 14, 2016 from the developer, Lennar Homes, LLC, with any additional costs to be paid upon completion of the project. The estimated construction cost is \$207,576. A contingency of \$41,515.20 will be set aside, bringing the total fiscal impact to \$249,091.20. The design costs were \$39,045.35. Funds remaining after the completion of construction will be refunded to Lennar Homes, LLC.

Attachments:

1. Location Sketch
2. Work Order with Exhibits A and B
3. Bid Tabulation
4. Signal Plan

Recommended By:		
	Department Director	Date
		1/29/2018

Approved By:		
	Assistant County Administrator	Date
		1/29/18

II. FISCAL IMPACT ANALYSIS

A. Five Year Summary of Fiscal Impact:

Fiscal Years	2018	2019	2020	2021	2022
Capital Expenditures	\$249,092	-0-	-0-	-0-	-0-
Operating Costs	-0-	-0-	-0-	-0-	-0-
External Revenues	(\$249,092)	-0-	-0-	-0-	-0-
Program Income (County)	-0-	-0-	-0-	-0-	-0-
In-Kind Match (County)	-0-	-0-	-0-	-0-	-0-
NET FISCAL IMPACT	\$ -0-	-0-	-0-	-0-	-0-
# ADDITIONAL FTE POSITIONS (Cumulative)					

Is Item Included in Current Budget? Yes No
 Does this item include the use of federal funds? Yes No

Budget Account No:

Fund 1201 Dept 360 Unit 3224-150 Object 6408

Recommended Sources of Funds/Summary of Fiscal Impact:

County Transportation Trust Fund
 JPA & Developer Agreements/Trf
 Hypoluxo Road and Rivermill Club Drive-Signalization

Annual Contract	
New Work Order	\$249,091.20
Developer Contribution	(\$249,091.20)
Fiscal Impact	\$.00

C. Departmental Fiscal Review:

Alicia Valaman

III. REVIEW COMMENTS

A. OFMB Fiscal and/or Contract Dev. and Control Comments:

[Signature] 1/18/18
 OFMB (18) 1/17/18

[Signature] 1/18/18
 Contract Dev. and Control 1/18/18

B. Approved as to Form and Legal Sufficiency:

[Signature]
 Assistant County Attorney
 1/30/18

C. Other Department Review:

 Department Director

This summary is not to be used as a basis for payment.

PROJECT LOCATION:

HYPOLUXO ROAD AND RIVERMILL CLUB DR/SILVERWOOD DR

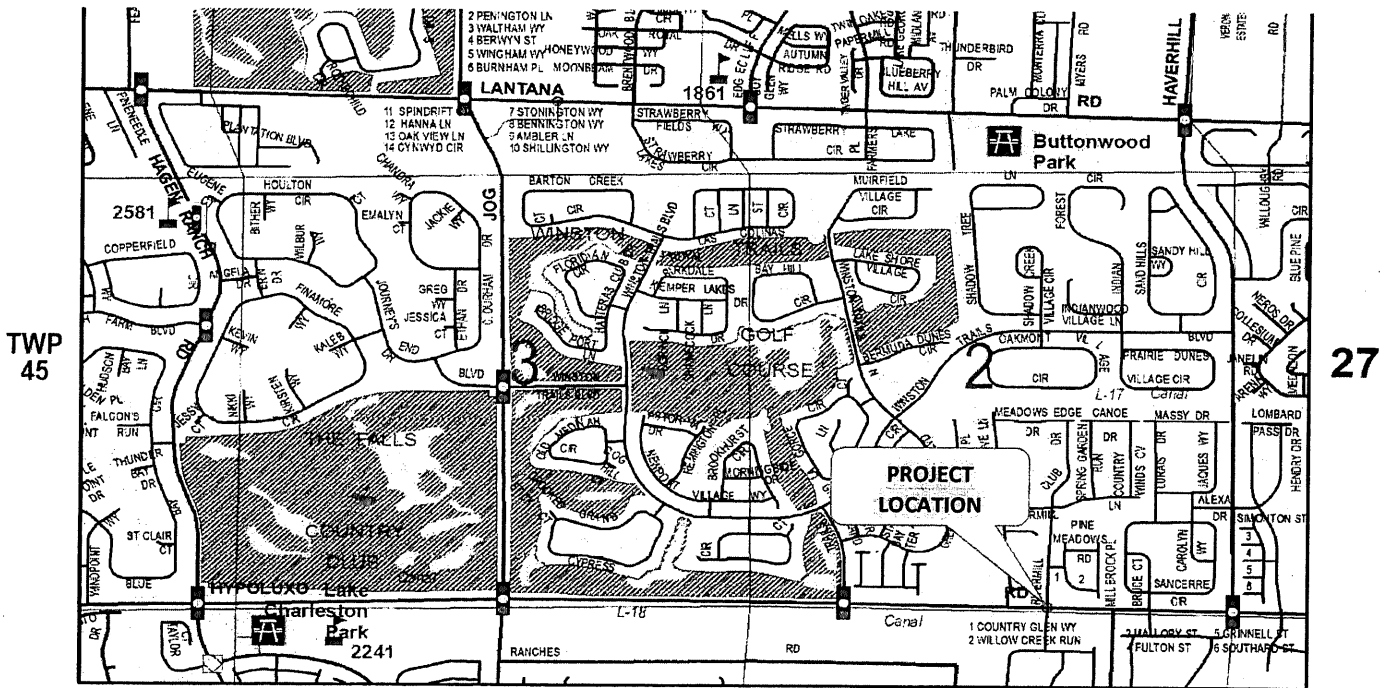

RNG 42

See pg 97

RNG 42

Page 89

Location Sketch

WORK ORDER TO ANNUAL CONTRACT (2017-051) BETWEEN

PALM BEACH COUNTY

AND

GERELCO TRAFFIC CONTROLS, INC.

TO CONSTRUCT A MAST ARM TRAFFIC SIGNAL AT THE INTERSECTION OF

HYPOLUXO ROAD AND RIVERMILL CLUB DRIVE/SILVERWOOD DRIVE,

PALM BEACH COUNTY INTERSECTION ID NUMBER 41648

SIGNAL PROJECT NUMBER 2017-35

PALM BEACH COUNTY PROJECT NUMBER 2016715

PALM BEACH COUNTY, FLORIDA

THIS WORK ORDER TO THE ANNUAL CONTRACT, is made and entered into this ___ day of _____, 2017, by and between Palm Beach County, a political subdivision of the State of Florida, by and through its Board of County Commissioners (“**COUNTY**”), and **GERELCO TRAFFIC CONTROLS, INC.**, a Florida corporation with an address of 560 NW Enterprise Drive, Port Saint Lucie, FL 34986 (“**CONTRACTOR**”).

WITNESSETH

WHEREAS, on March 14, 2017, the **COUNTY** and **CONTRACTOR** entered into an Annual Contract (“**CONTRACT**”) to provide for the furnishing and installation of various signal components for traffic control devices on a work order basis (R20170234); and

WHEREAS, the **COUNTY** desires the **CONTRACTOR** to construct a mast arm traffic signal at the intersection of Hypoluxo Road and Rivermill Club Drive/Silverwood Drive, Palm Beach County Intersection ID Number 41648, (“**PROJECT**”); and

WHEREAS, the **CONTRACTOR** agrees to construct the **PROJECT** in accordance with the terms and conditions of the **CONTRACT**, as directed and accepted by the **COUNTY**; and

WHEREAS, pursuant to the **CONTRACT**, a cost not to exceed \$249,091.20 has been calculated by **COUNTY** and found to be appropriate compensation for the services to be performed by the **CONTRACTOR** to construct the **PROJECT**.

NOW, THEREFORE, THIS INDENTURE WITNESSETH: That for and in consideration of the mutual benefits to flow from each to the other, the parties hereto agree as follows:

1. The **CONTRACTOR** agrees to provide services for the **PROJECT** in accordance with the **CONTRACT** and as further described in Exhibits "A" and "B"; and
2. The **COUNTY** agrees to pay the **CONTRACTOR** a fee not to exceed \$249,091.20 to construct the **PROJECT**. Final payment shall be per documented quantities installed.

Except as amended or modified, all other terms and conditions of the **CONTRACT** shall remain in full force and effect.

IN WITNESS WHEREOF, the parties hereto have made and executed this **WORK**

ORDER as of the day and year first above written.

OWNER:

Palm Beach County, Florida
by its Board of County Commissioners

BY: _____
Melissa McKinlay, Mayor

CONTRACTOR:

Gerelco Traffic Controls, Inc.
a Florida Corporation

BY: _____
Kenneth Geremia, Secretary

ATTEST:

Sharon R. Bock, Clerk & Comptroller
Circuit Court

BY: _____
Deputy Clerk

C O R P O R A T E S E A L

S E A L

WITNESS:

BY: _____
M. Barbosa

Millie Barbosa
(Printed Name)

APPROVED AS TO TERMS
AND CONDITIONS:

BY: _____
Tanya N. McConnell
(Printed Name)

BY: _____
Billie F. DeLong
(Printed Name)

APPROVED AS TO FORM & LEGAL
SUFFICIENCY:

BY: _____
Yelizaveta "Liz" Herman
Assistant County Attorney

EXHIBIT "A"

PALM BEACH COUNTY ENGINEERING & PUBLIC WORKS
TRAFFIC DIVISION WORK ORDER / ANNUAL CONTRACT PROJECT 2017-051
CONTRACT RESOLUTION NUMBER R2017-0234

PROJECT NAME: Hypoluxo Road and Rivermill Club Drive/Silverwood Drive (PBC Intersection 41648)
BUDGET LINE ITEM: 1201-360-3220-150-6408
KDO NUMBER: N/A
SIGNAL PROJECT NUMBER: 2017-35 PBC-PROJECT NUMBER: 2016715
DATE: 10/18/17 COMMISSION DISTRICT: 3

TO: Kenneth A. Geremia, Jr., Gerelco Traffic Controls, Inc.

In accordance with the terms of your contract dated March 14, 2017, you are directed to provide the following supplies and services: Provide for the furnishing and installation of a mast arm traffic signal as shown on the Signal Plan on pages 1 and 2 and Bidtab, dated October 10, 2017.

The above work shall be performed at: Hypoluxo Road and Rivermill Club Drive/Silverwood Drive (PBC Intersection 41648).

STARTING: The contract duration for this work is 240 days. A separate Notice to Proceed ("NTP") letter will be issued directing the contractor to commence work within the time specified in the NTP letter. The total amount of this Work Order, at the contract prices, is estimated to be \$207,576.00, which includes \$41,515.20 contingency (See attached bidtab for quantities). Final payment shall be per documented quantities installed. The Small Business Enterprise (SBE) goal for this contract is 37.7%. The estimated SBE Participation for this Work Order is 2.67%. The total SBE participation to date for this Contract is 0%.

This work shall be coordinated by, (48 hours prior notice to commencement of work):

Fattoush Jafar, P.E., Ph.D., Senior Professional Engineer (561) 684-4030
Name Title Telephone

Please indicate your receipt of this Work Order by signing and returning a duplicate copy.

[Signature] Secretary (772) 340-7474
Name Title Telephone

Please sign below and submit with invoice at the completion of the project.
Project completed in compliance with Contract and Project specifications.

Signature Title Telephone

**SCHEDULE 1
LIST OF PROPOSED SBE-M/WBE PRIME AND/OR SUBCONTRACTOR PARTICIPATION**

PROJECT NAME OR BID NAME: Hypoluxo and Rivermill PROJECT NO. OR BID NO.: 2011-35
 NAME OF PRIME BIDDER: Corelec Traffic Controls, INC ADDRESS: 560 NW Enterprise Dr. Port St. Lucie, FL 34986
 CONTACT PERSON: Jake Pickinger PHONE NO.: 772-340-7474 FAX NO.: _____
 BID OPENING DATE: _____ USER DEPARTMENT: _____

THIS DOCUMENT IS TO BE COMPLETED BY THE PRIME CONTRACTOR AND SUBMITTED WITH BID PACKET. PLEASE LIST THE NAME, CONTACT INFORMATION, AND DOLLAR AMOUNT OR PERCENTAGE OF WORK TO BE COMPLETED BY ALL SBE-M/WBE SUBCONTRACTORS ON THIS PROJECT. IF THE PRIME IS AN SBE-M/WBE, PLEASE ALSO LIST THE NAME, CONTACT INFORMATION, AND DOLLAR AMOUNT OR PERCENTAGE OF WORK TO BE COMPLETED BY THE PRIME ON THIS PROJECT. THE PRIME AFFIRMS THAT IT WILL MONITOR THE SBES LISTED TO ENSURE THE SBES PERFORM THE WORK WITH ITS OWN FORCES.

Name, Address and Phone Number	(Check one or both Categories)		DOLLAR AMOUNT OR PERCENTAGE OF WORK				
	M/WBE Minority Business	SBE Small Business	Black	Hispanic	Women	Caucasian	Other (Please Specify)
1. <u>Corral Steel</u> <u>1486 Skees Rd. WPR, FL 33411</u>	<input type="checkbox"/>	<input checked="" type="checkbox"/>	_____	_____	_____	_____	<u>SBE</u> <u>5550.51</u>
2.	<input type="checkbox"/>	<input type="checkbox"/>	_____	_____	_____	_____	_____
2.	<input type="checkbox"/>	<input type="checkbox"/>	_____	_____	_____	_____	_____
3.	<input type="checkbox"/>	<input type="checkbox"/>	_____	_____	_____	_____	_____
4.	<input type="checkbox"/>	<input type="checkbox"/>	_____	_____	_____	_____	_____
(Please use additional sheets, if necessary)			Total				
			_____	_____	_____	_____	<u>5550.51</u>

Total Bid Price: \$ 207,576.⁰⁰ Total SBE-M/WBE Participation Dollar Amount or Percentage of Work: 5,550.51 or 2.67%

I hereby certify that the above information accurate to the best of my knowledge:
 Signature: J.P. Title: Project Manager

- Note:
- The amount listed on this form for a subcontractor must be supported by price or percentage listed on the signed Schedule 2 or signed proposal in order to be counted toward goal attainment.
 - Firms may be certified by Palm Beach County as an SBE and/or M/WBE. If firms are certified as both an SBE and M/WBE, please indicate the dollar amount or percentage under the appropriate category.
 - M/WBE information is being collected for tracking purposes only.

**OSBA SCHEDULE 2
LETTER OF INTENT TO PERFORM AS AN SBE-M/WBE SUBCONTRACTOR**

This document must be completed by the SBE-M/WBE Subcontractor and submitted with bid packet. Specify in detail, the particular work items to be performed and the dollar amount and/or percentage for each work item. SBE credit will only be given for items which the SBE-M/WBE Subcontractor is SBE certified to perform. Failure to properly complete Schedule 2 may result in your SBE participation not being counted.

PROJECT NUMBER: 2017-35 PROJECT NAME: Hypoluxa: Zwermill
 TO: Cereka Traffic Controls, Inc.
 (Name of Prime Bidder)

The undersigned is certified by Palm Beach County as a (check one or more, as applicable):

Small Business Enterprise Minority Business Enterprise _____
 Black _____ Hispanic _____ Women _____ Caucasian _____ Other (Please Specify) _____

Date of Palm Beach County Certification: _____

The undersigned is prepared to perform the following described work in connection with the above project (additional sheets may be used as necessary):

Line Item/ Lot No. Item Description	Qty./Units	Unit Price	Total Price/ Percentage
<u>649-31-104</u>	<u>1</u>	<u>1568.50</u>	<u>1568.50</u>
<u>649-31-108</u>	<u>1</u>	<u>1196.41</u>	<u>1196.41</u>
<u>649-31-109</u>	<u>2</u>	<u>1392.80</u>	<u>2785.60</u>

at the following price or percentage: 5,550.51 or 2.67%
 (Subcontractor's Quote)

and will enter into a formal agreement for work with you conditioned upon your execution of a contract with Palm Beach County.

If undersigned intends to subcontract any portion of this job to a certified SBE or a non-SBE subcontractor, please list the name of the subcontractor and the amount below.

Price and/or Percentage _____ / _____
 (Name of Subcontractor)

The Prime affirms that it will monitor the SBE's listed to ensure the SBE's perform the work with its own forces. The undersigned subcontractor affirms that it has the resources necessary to perform the work listed without subcontracting to non-certified SBE or any other certified SBE subcontractors except as noted above.

The undersigned subcontractor understands that the provision of this form to Prime Bidder does not prevent Subcontractor from providing quotations to other bidders.

Cereka Traffic Controls, Inc
 Print Name of Prime Contractor

CORAL STEEL COMPANY
 Print Name of SBE-M/WBE Subcontractor

By: [Signature]
 Signature

By: [Signature] V.P.
 Signature

Jake Ridinger, Project Manager
 Print Name/Title of Person Executing on Behalf of
 Prime Contractor

LEE DISBURY
 Print Name/Title of Person Executing on Behalf of
 SBE/M/WBE Subcontractor

Revised 10/11/2011

Date: 1-4-18



PBCBCC-TRAFFIC DIVISION
2300 N. JOG ROAD
W.P.B., FL. 33411-2745
Phone: (561) 684-4030 Fax: (561) 478-5770

GERELCO BIDTAB
CONTRACT
#2017051

DATE: 10/10/2017 **CONTRACT NO. #:** 2017-35

INTERSECTION: Hypoluxo Rd and Riverview Club Dr
INTERSECTION NO. # 41648

ITEM NO. #	PRODUCT NAME	QTY	PRICE	LINE TOTAL
102-1-A	GENERAL MAINTENANCE OF TRAFFIC - [HR] [F&I]	16	\$126.00	\$2,016.00
630-2-11-2	2" PVC (SCH 40) UNDERGROUND CONDUIT - [LF] [F&I]	130	\$8.00	\$1,040.00
630-2-11-2A	ADDITIONAL 2" PVC (SCH 40) CONDUIT, IN OPEN TRENCH - [LF] [F&I]	105	\$2.50	\$262.50
630-2-12-2-2	2-2" (HDPE SDR 11) UNDER PAVEMENT CONDUIT (DIRECTIONAL BORE) - [LF] [F&I]	285	\$21.50	\$6,127.50
630-2-12-2-4	4-2" (HDPE SDR 11) UNDER PAVEMENT CONDUIT (DIRECTIONAL BORE) - [LF] [F&I]	420	\$25.00	\$10,500.00
632-7-1-19G	SIGNAL CABLE (SPAN LENGTH 751' - Greater) - [PI] [F&I]	1	\$4,800.00	\$4,800.00
632-7-1-4A	PEDESTRIAN SIGNAL CABLE - 4 CONDUCTOR - [PI] [F&I]	1	\$1,063.00	\$1,063.00
632-7-1-7A	PEDESTRIAN SIGNAL CABLE - 7 CONDUCTOR - [PI] [F&I]	1	\$2,809.00	\$2,809.00
635-2-12-A	PULL BOX (17" x 30" x 12"D) HEAVY DUTY COVERS - [EA] [F&I]	20	\$850.00	\$17,000.00
635-2-13-B	PULL BOX (17" x 30" X24"D) HEAVY DUTY SPLIT COVER (ITS) - [EA] [F&I]	1	\$1,250.00	\$1,250.00
639-1-123	ELECTRICAL POWER SERVICE (UNDERGROUND) - [AS] [F&I]	1	\$850.00	\$850.00
639-2-1	ELECTRICAL SERVICE WIRE (SINGLE PHASE 3-WIRE, TRIPLEX) - [LF] [F&I]	200	\$2.30	\$460.00
639-3-11	ELECTRICAL SERVICE DISCONNECT - [EA] [F&I]	1	\$325.00	\$325.00
641-2-12-12	PRESTRESSED CONCRETE POLE (12' TYPE P-II) - [EA] [F&I]	1	\$750.00	\$750.00
646-1-11	ALUMINUM SIGNALS POLE, PEDESTAL WITH TRANSFORMER BASE (8 FEET ABOVE GROUND) - [EA]	4	\$770.00	\$3,080.00
649-31-104	MAST ARM ASSY D6-S4 70' 6" (POWDER COATED FINISH) - [EA] [F&I]	1	\$33,651.00	\$33,651.00
649-31-108	MAST ARM ASSY D5-S23 60' W/LUM (POWDER COATED FINISH) - [EA] [F&I]	1	\$31,318.00	\$31,318.00
649-31-109	MAST ARM ASSY D6-S24 70' 6" W/LUM (POWDER COATED FINISH) - [EA] [F&I]	2	\$36,107.00	\$72,214.00
650-1-13	TRAFFIC SIGNAL HEAD ALUMINUM (3-SECTION, 1-WAY) INCLUDES BACKPLATES - [AS] [F&I]	12	\$900.00	\$10,800.00
653-191	PEDESTRIAN SIGNAL - COUNT DOWN (1-WAY) ALUMINUM - [EA] [F&I]	4	\$650.00	\$2,600.00
660-4-30-B4	VIDEO IMAGE DETECTION 4 - CAMERA SYSTEM (ITERIS) - [EA] [I]	1	\$1,280.00	\$1,280.00
665-1-11	PEDESTRIAN DETECTOR (PUSH BUTTON) - [EA] [F&I]	4	\$95.00	\$380.00

DATE: 10/10/2017 CONTRACT NO. #: 2017-35

INTERSECTION: Hypoluxo Rd and Rivermill Club Dr
INTERSECTION NO.# 41648

ITEM NO.#	PRODUCT NAME	QTY	PRICE	LINE TOTAL
700-5-42	INTERNALLY ILLUMINATED SIGN (8') INSTALL ONLY - [EA] [1]	4	\$750.00	\$3,000.00
TOTAL:				\$207,576.00

Comments: New Mast Arm Installation

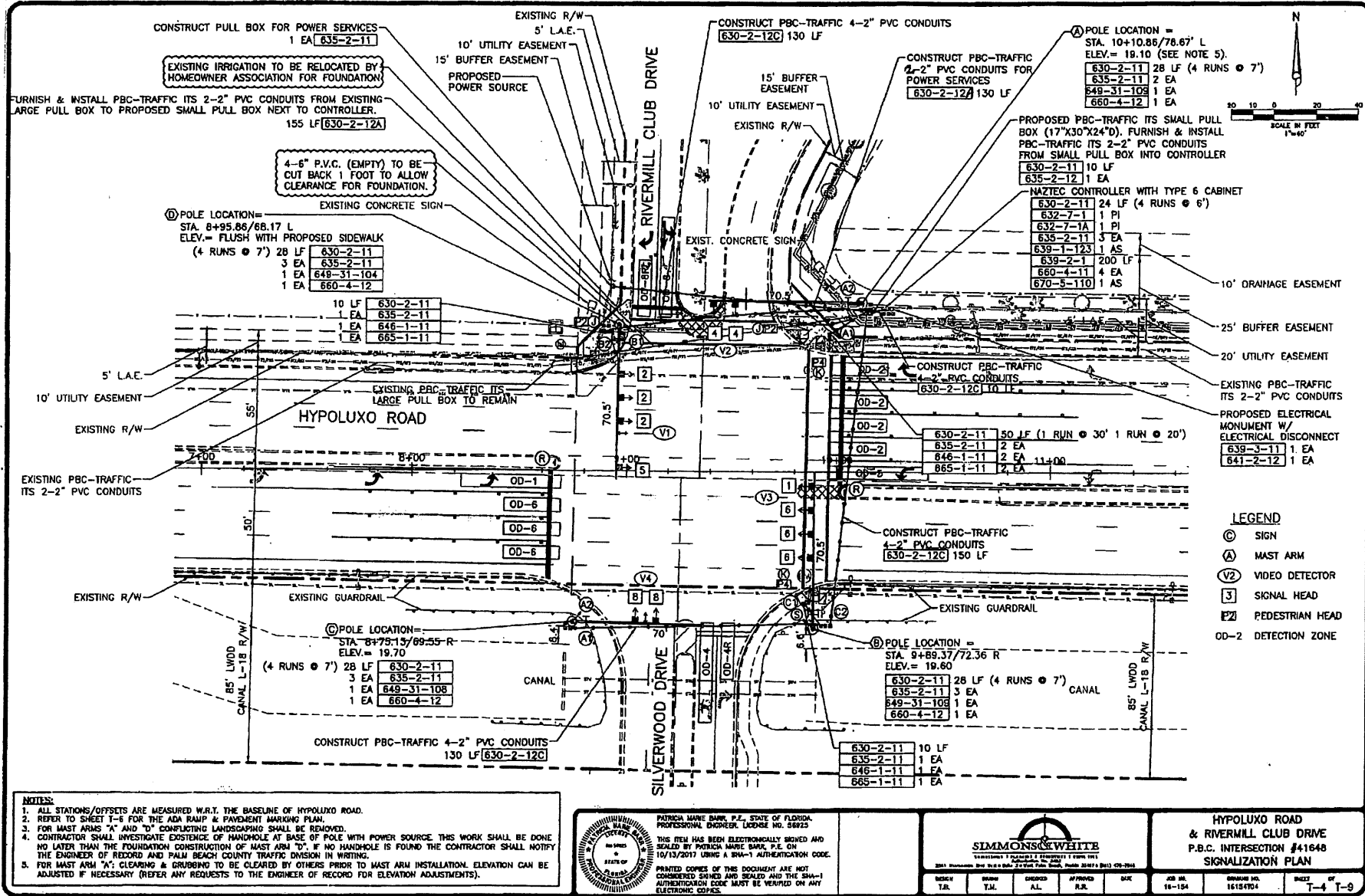

T:\PROJECTS\16154\16154704\16154704.dwg 1/11/2017 10:17:15 AM

SOP 7

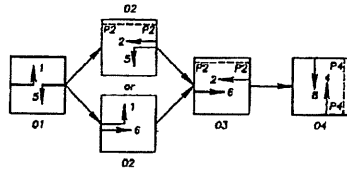

RING DIAGRAM

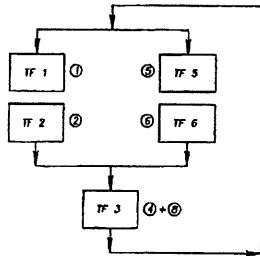

VIDEO DETECTOR CHART	
DETECTOR NO.	MOVEMENTS
V-1	2, 5
V-2	4
V-3	1, 6
V-4	8

NOTES:

- CONTROLLER OPERATIONS:
 - THE CONTROLLER SHALL OPERATE AS SIGNAL OPERATING PLAN 7.
 - MAJOR STREET IS HYPOLUXO ROAD AND MINOR STREET IS RIVERMILL CLUB DRIVE/SILVERWOOD DRIVE.
 - FLASHING OPERATION TO BE YELLOW FOR MAJOR STREET MOVEMENTS 2 AND 6, AND RED FOR ALL OTHER MOVEMENTS.
- ACTUAL SIGNAL TIMINGS AND COORDINATION PLANS ARE TO BE DETERMINED BY THE PALM BEACH COUNTY ENGINEER'S REPRESENTATIVE.
- THE SPEED LIMIT ON HYPOLUXO ROAD IS 45 MPH.

DETAIL OF SIGNAL HEADS

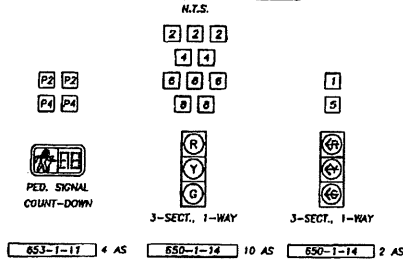

DETAIL OF STREET NAME SIGNS

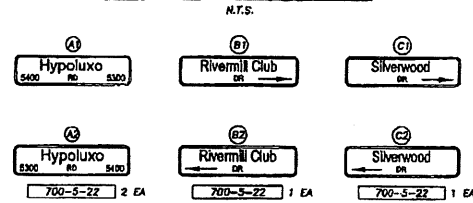

- MAXIMUM SIGN DIMENSION 5' LENGTH AND 2' HEIGHT
 - SIGNS SHALL MEET PALM BEACH COUNTY TYPICALS.
 REFER TO PALM BEACH COUNTY TYPICALS FOR DETAILS ON SIGN INSTALLATION, DIMENSIONS & LETTERING.

DETAIL OF SIGNS

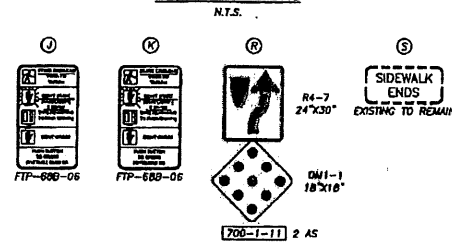

-COST OF SIGNS J & K SHALL BE INCLUDED UNDER PAY ITEM 865-1-11

	PATRICIA MARIE BARR, P.E., STATE OF FLORIDA, PROFESSIONAL ENGINEER, LICENSE NO. 68825		HYPOLUXO ROAD & RIVERMILL CLUB DRIVE P.B.C. INTERSECTION #41648 SIGNALIZATION PLAN	
	THIS ITEM HAS BEEN ELECTRONICALLY SIGNED AND SEALED BY PATRICIA MARIE BARR, P.E. ON 10/13/2017 USING A SHA-1 AUTHENTICATION CODE. PRINTED COPIES OF THIS DOCUMENT ARE NOT CONSIDERED SIGNED AND SEALED AND THE SHA-1 AUTHENTICATION CODE MUST BE VERIFIED ON ANY ELECTRONIC COPIES.		SIMMONS & WHITE 11 SIMMONS & WHITE BLVD., SUITE 100, WEST PALM BEACH, FL 33411 TEL: 561-832-1111 FAX: 561-832-1112	SHEET NO. 16-154