



**II. FISCAL IMPACT ANALYSIS**

**A. Five Year Summary of Fiscal Impact:**

Fiscal Years	2018	2019	2020	2021	2022
Capital Expenditures	<u>\$340,600</u>	_____	_____	_____	_____
Operating Costs	_____	_____	_____	_____	_____
External Revenues	_____	_____	_____	_____	_____
Program Income (County)	_____	_____	_____	_____	_____
In-Kind Match (County)	_____	_____	_____	_____	_____
<b>NET FISCAL IMPACT</b>	<u><u>\$340,600</u></u>	=====	=====	=====	=====
<b># ADDITIONAL FTE POSITIONS (Cumulative)</b>	_____	_____	_____	_____	_____

**Is Item Included in Current Budget:** Yes  **X** No

Budget Account No: Fund 3076 Dept 411 Unit B572 Object 6502  
 Program \_\_\_\_\_

**B. Recommended Sources of Funds/Summary of Fiscal Impact:**

The total budget is being increased from \$1,350,000 to \$1,690,600 with the approval of this item. A subsequent contract/item will further increase the total project budget to \$1,900,600 to accommodate the need to incorporate site lighting into the construction contract, again to meet code. The recommended source of funding for this project is the 68M Rev Bond Airport Center 2/Convention Center Parking Garage as the artwork is in satisfaction of a regulatory requirement included in the development order for the garage. The debt service for the portion of the bonds used for the Convention Center Parking Garage is funded 100% through bed tax revenues.

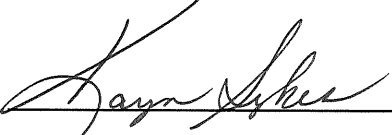
**C. Departmental Fiscal Review:** 

**III. REVIEW COMMENTS**

**A. OFMB Fiscal and/or Contract Development Comments:**

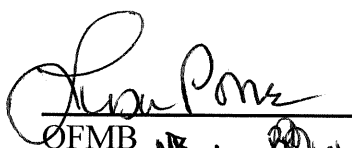
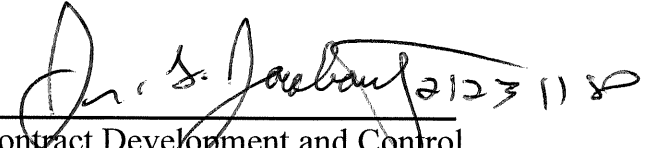
<p><u></u> 2/21/18                  OFMB 2/21/18</p>	<p><u></u> 2/23/18                  Contract Development and Control 2/23/18</p>
---	--

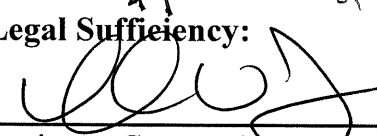
**B. Legal Sufficiency:**  
 2/26/18  
 Assistant County Attorney

**C. Other Department Review:**  
 \_\_\_\_\_  
 Department Director

**This summary is not to be used as a basis for payment.**

**FIRST AMENDMENT TO AGREEMENT FOR ART SERVICES**

A 2018-0003

THIS FIRST AMENDMENT is made and entered into this <sup>or</sup> 14 day of February, 2018, by and between Palm Beach County, a political subdivision of the State of Florida (“COUNTY”) and Susan Narduli (“ARTIST”).

WHEREAS, the COUNTY and ARTIST entered into an Agreement for the Palm Beach County Convention Center Courtyard Public Art Project (“Agreement”) on December 19, 2017; and

WHEREAS, the COUNTY and ARTIST desire to amend the Agreement to incorporate certain changes due to the addition of two additional gates to the scope of the Project; and

WHEREAS, the COUNTY and ARTIST also desire to amend the Agreement to incorporate the ARTIST’s proposal for additional Convention Center Courtyard design services and to incorporate certain other related changes.

NOW THEREFORE, in accordance with the mutual covenants herein contained, and other good and valuable consideration, the receipt and sufficiency of which are hereby acknowledged, the parties agree as follows:

1. The foregoing recitals are true and correct and are incorporated herein by this reference.
2. Exhibit 1 (Artist Proposal) to the Agreement is replaced in its entirety with Attachment A to this First Amendment.
3. Exhibit 3 (Budget) to the Agreement is replaced in its entirety with Attachment B to this First Amendment.
4. Exhibit 4 (Schedule) to the Agreement is replaced in its entirety with Attachment C to this First Amendment.
5. Exhibit 5 (Materials) to the Agreement is replaced in its entirety with Attachment D to this First Amendment.
6. Section 3.01, “Firm Fixed Price” shall be revised to increase the fixed fee to \$784,600. The fixed fee includes additional payment for services related to the design, fabrication, and installation of two additional gates (as depicted in Attachment A) as well as the additional Convention Center Courtyard design services, which are more fully described in Attachment E, which is attached hereto and incorporated into the Agreement.
7. All other terms and conditions of the Agreement shall remain the same.

**THE REST OF THIS PAGE INTENTIONALLY LEFT BLANK**

IN WITNESS WHEREOF, this AGREEMENT has been fully executed on behalf of the parties hereto by its duly authorized representatives, as of the date first written above.

**COUNTY:**

ATTEST: SHARON R. BOCK,  
Clerk & Comptroller

PALM BEACH COUNTY, FLORIDA, BY ITS  
BOARD OF COUNTY COMMISSIONERS

By: \_\_\_\_\_  
Deputy Clerk

By: \_\_\_\_\_  
Melissa McKinlay, Mayor

APPROVED AS TO FORM AND LEGAL  
SUFFICIENCY

APPROVED AS TO TERMS AND  
CONDITIONS

By:   
Senior Assistant County Attorney

By:   
Director of Facilities Dev & Ops

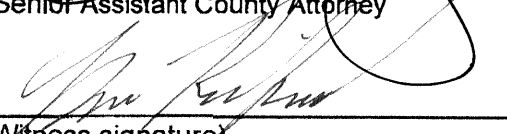
  
Witness signature)  
Chris Richard

  
Artist Signature  
Susan Narduli

Witness print

Artist's name printed

**ATTACHMENT A**

**Exhibit 1**

**Artist Proposal**

---

*Exhibit 1*  
*Artist Proposal*

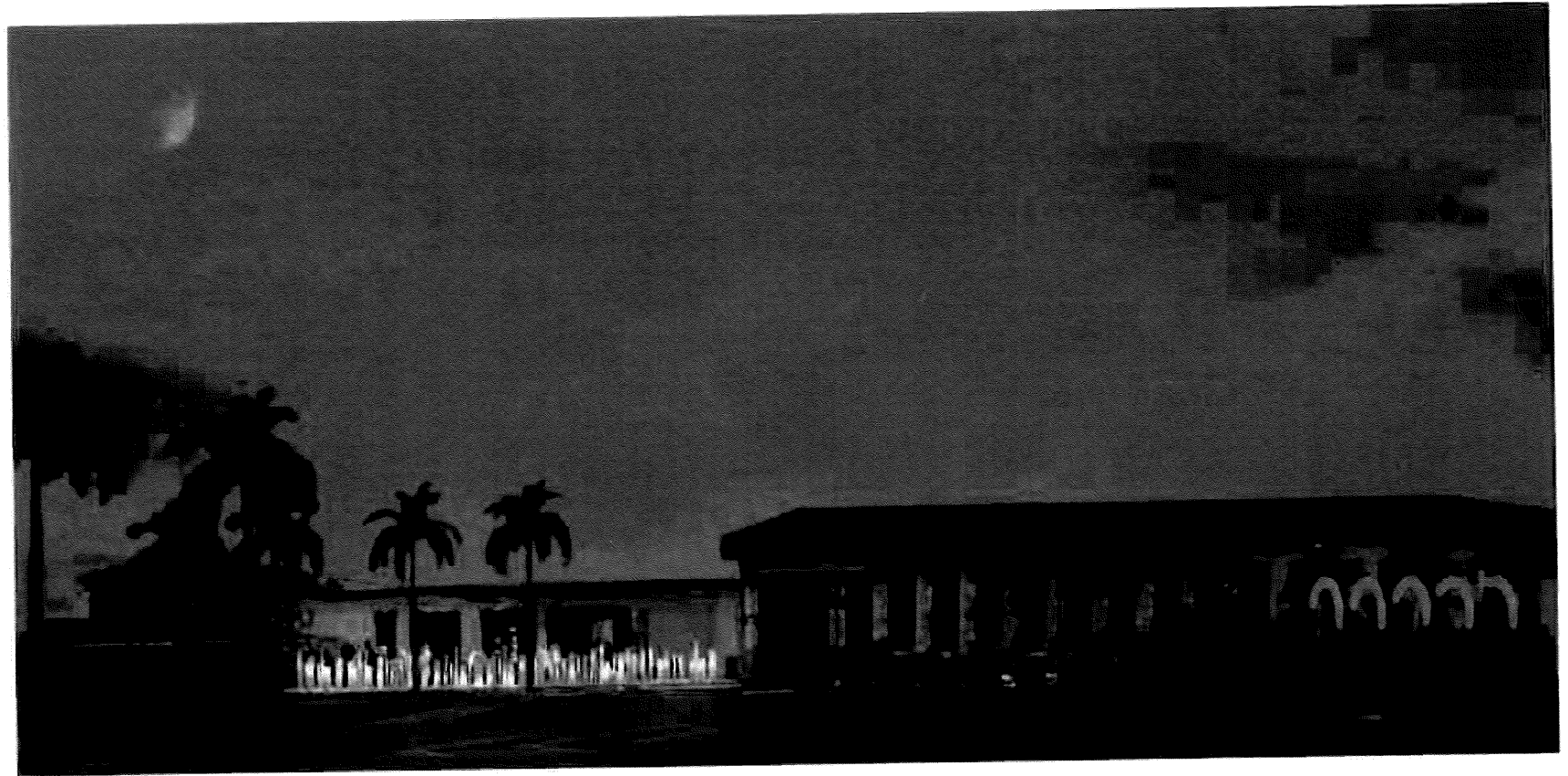

CONVENTION CENTER NORTH ELEVATION







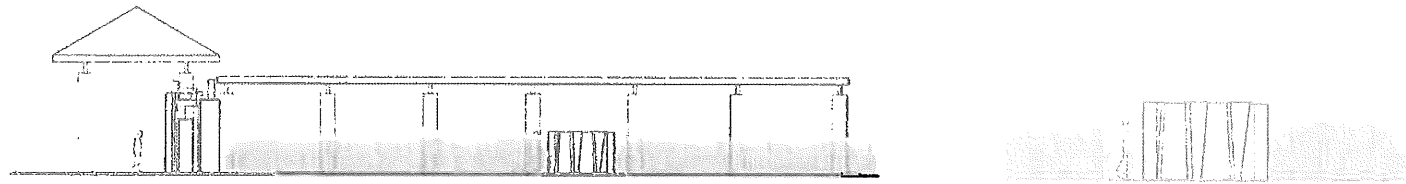

26

COURTYARD EAST GATE TO COLONNADE

light PLAY: fixtures

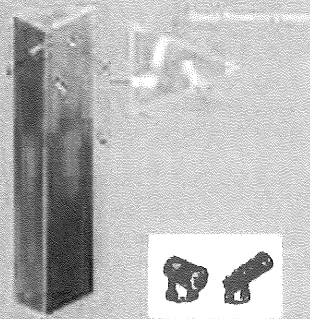

PROJECTION CUBES

Small Lights Mixed  
With Sculpture

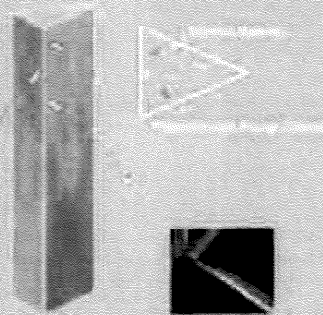

PROJECTION CUBES

Lighter, Irregularly  
Placed Hardware for  
Cove, Day and Night

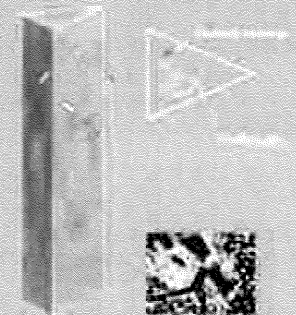

FIREFLY LIGHTS

Scenic Effect with  
Easy-Accessed Family  
Lighting Fixture

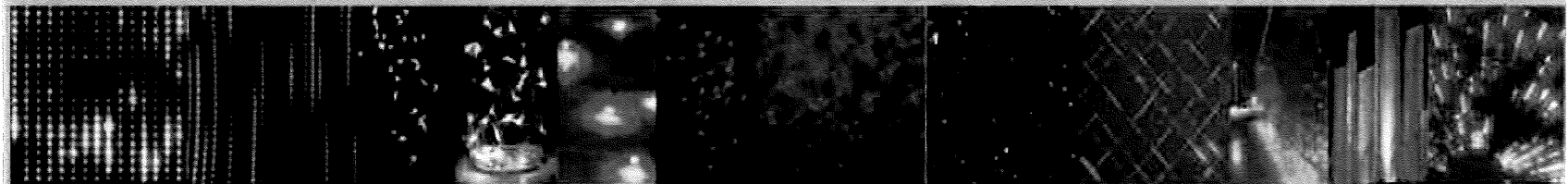

**Light PLAY**  
**Palm Beach County Convention Center**

**Narduli Studio and Horton Lees Brogden**

**We imagine an artwork that is part physical, part magic. Always changing, it comes and goes, revealing itself through shifts in light and time of day.**

**Light PLAY is site-specific.**

**The artwork takes its formal inspiration from the architecture of the Palm Beach County Convention Center. It re-conceptualizes the strong vertical rhythm seen in the building entry colonnade and its tall rows of Palm Trees.**

**Light PLAY provides counterpoint to the "Wave", an iconic sculpture in bold strokes. It is human scale and meant to be experienced slowly, at eye level and in a personal way.**

**What binds a community is complex. We conceived of Light PLAY as a LINK BETWEEN THE DIVERSE COMMUNITIES of Palm Beach County from the Everglades National Park to the metropolitan areas, from the suburban and agricultural districts to the coastline. It uses the dynamic power of light as a form of expression. It bridges demographics and time to become a means to shared common experience.**

**In Light PLAY, we are exploring the use of light - natural and artificial - as a layer that creates both a narrative and an active day/night presence. Because it is interactive, it fosters personal engagement within the public space.**

**The artwork takes its life from the path of the sun throughout the day. Sunlight sends patterns of light that track its rhythms. Dichroic lenses placed within the perforated forms cast ever-changing colors tied to time of day and season. Photovoltaics capture the sun's rays throughout the day. As the sun sets, the stored energy becomes the vehicle for the artwork, creating a self-sustaining dynamic layer of firefly light that recalls nighttime adventures in the Palm Beach County Wetlands.**

**Light PLAY uses new technologies to explore and capture narrative possibilities. Through a process of data analysis and visualization the artwork will translate the cycles of the sun and moon as experienced in Palm Beach County into patterns.**

**We envision the artwork as a "veil"- an interface between the PUBLIC and PRIVATE space. The long row of sculptural forms creates a visual and physical separation between the courtyard and the day to day goings on in the public areas. In the evening, lighting from within highlights the artwork and creates ambient light for the courtyard, a magical environment with glimpses into the world beyond.**

**Light PLAY connects us to our environment and creates an iconic and dynamic experience for the passersby and visitors to the Convention Center. It captures the daily rhythms of PALM BEACH COUNTY and makes them visible.**

---

---

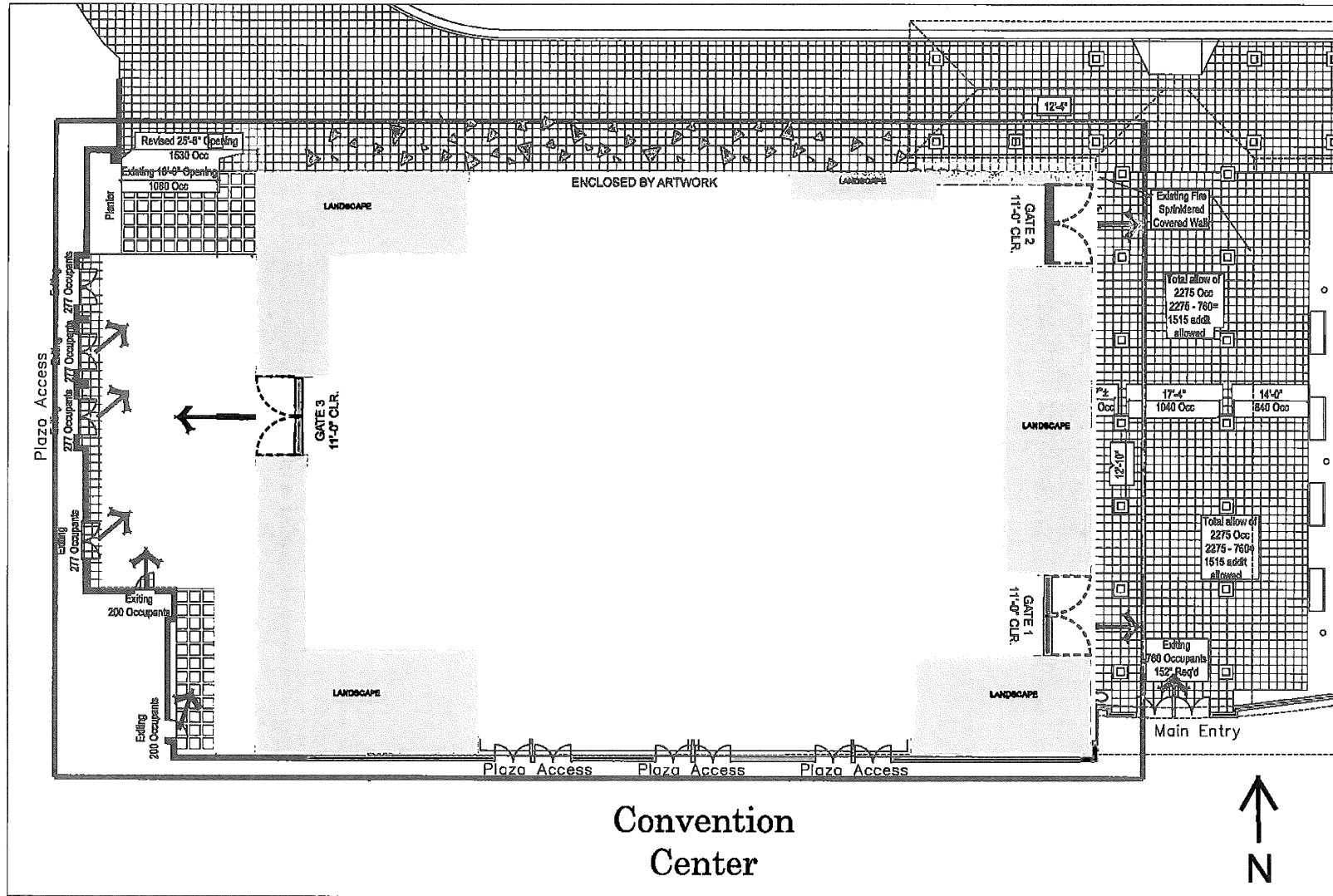

ATTACHMENT B

**Palm Beach County Convention Center Courtyard**

	<b>CONTRACT TOTAL</b>
<b>SCREEN &amp; GATES</b>	
Design Development	\$10,000.00
Construction Documents	\$14,000.00
CAD, Engineering /Permitting	\$25,000.00
Shop Drawings Coordination	\$3,000.00
Screen & Gate Materials	\$75,000.00
Screen & Gate Fabrication	\$40,500.00
Light Fixtures & Controls	\$85,200.00
Light Installation	\$50,000.00
Existing Column Demo	\$10,000.00
Screen and Gate Installation	\$60,900.00
Artist Fee	\$45,400.00
Lighting Consultant	\$20,000.00
Construction Oversight/Proj. Mgmt	\$10,000.00
Insurance	\$5,000.00
Engineering for Foundations for Screen/Gates	\$10,000.00
Installation of Foundations for Screen/Gates	\$80,000.00
Engineering for Additional Gates	\$5,000.00
Materials for Additional Gates: Perforated Panels, Framework, Hardware	\$55,000.00
Lighting for Additional Gates	\$24,600.00
Fabricate Additional Gates	\$30,000.00
Permit for Additional Gates	\$6,500.00
Installation of Additional Gates	\$20,000.00
Installation of Lighting for Additional Gates	\$10,000.00
<b>COURTYARD DESIGN</b>	
Concept /Schematic Design	\$10,000.00
Design Development	\$10,000.00
Construction Documents	\$5,000.00
Shop Drawing Review/ Detailing	\$2,000.00
CAD Drawings including Elevations	\$5,500.00
Artist Fee	\$45,000.00
Lighting Consultant	\$10,000.00
Construction Oversight/Project Management	\$10,000.00
Insurance	\$2,000.00
Credit for Column Demo	-\$10,000.00
<b>TOTAL</b>	<b>\$784,600.00</b>

ATTACHMENT C

**Palm Beach County Convention Center Courtyard**

Project Schedule

2/9/2018

Responsible Party
NARDULI STUDIO
PBC Milestone
Fabricator
Architect/Contractor/Others

	Start Date	End Date	Duration	2017	2018									
				Dec	Jan	Feb	Mar	Apr	May	June	July	Aug	Sept	
<b>ARTWORK Design</b>														
Notice to Proceed	12/19/2017													
Preliminary Design	12/19/2018	12/29/2018	1 week											
Preliminary Egress Design	12/29/2017													
Schematic Design	1/1/2018	2/9/2018	5 weeks											
Schematic Design Submittal	2/9/2018													
SD Submittal Review	2/9/2018	2/16/2018	1 week											
Design Development	2/19/2018	3/9/2018	3 weeks											
Design Development Submittal	3/9/2018													
DD Submittal Review	3/9/2018	3/16/2018	1 week											
Construction Documents	3/19/2018	4/6/2018	3 weeks											
CD Review	4/6/2018	4/13/2018	1 week											
<b>COURTYARD Design</b>														
County Commission Scope/Contract Approval	3/13/2018													
Notice to Proceed	3/14/2018													
Schematic Design	3/15/2018	4/6/2018	3 weeks											
Schematic Design Submittal	4/6/2018													
SD Submittal Review	4/6/2018	4/13/2018	1 week											
Design Development	4/16/2018	5/4/2018	3 weeks											
Design Development Submittal	5/4/2018													
DD Submittal Review	5/4/2018	5/11/2018	1 week											
Construction Documents	5/13/2018	6/1/2018	3 weeks											
CD Review	6/1/2018	6/8/2018	1 week											
<b>PERMITS</b>														
Art Specialty Engineer Permit	6/11/2018	7/6/2018	1 month											
Construction Permit	6/11/2018	7/6/2018	1 month											
<b>FABRICATION &amp; PRODUCTION</b>														
Artwork Shop Drawings	5/1-5/15	5/15/2018	2 weeks											
Shop Drawings Approved	5/15/2018													
Artwork Fabrication	5/15/2018	8/15/2018	12 weeks											
Metal Sculptures - Materials Procurement	5/15 - 7/15	7/15/2018	8 weeks											
Metal Sculptures - Fabrication	7/15-8/1	8/1/2018	1.5 weeks											
Metal Sculptures - Powder coating	8/1-8/7	8/7/2018	1 week											
Metal Sculptures - Shipping	8/7/2018	8/15/2018	1 week											
Artwork Fabrication Completion	8/15/2018													
<b>COURTYARD SITE ACCESS WINDOW</b>	6/14/2018	8/31/2018	10 weeks											
Courtyard Construction (to follow PERMITS above)	7/9/2018	8/31/2018	7 weeks											
Artwork Installation	15-Aug	31-Aug	2 weeks											
Courtyard Installation Completion	8/31/2018													
Site Plan Amendment	TBD	TBD	TBD											
				Dec	Jan	Feb	Mar	Apr	May	June	July	Aug	Sept	
				2017	2018									

**ATTACHMENT D**

***Exhibit 5***  
***Materials***

**Sculptures:** Powder-coated Perforated Aluminum, Stainless Steel Hardware, Dichroic Glass

**Lighting:** Projector Lamps, Firefly lights, Controls

**Footers:** Concrete, rebar

## ATTACHMENT E

### Narduli Studio\_Palm Beach County Convention Center Courtyard

#### SCOPE OF SERVICES\_Art Design Services

***Narduli Studio (collectively Narduli Studio, its representatives and consultants (NS) shall be responsible for the development of the aesthetic and visual design for the Palm Beach County Convention Center Courtyard remodel.***

#### **SCOPE OF SERVICES:**

***NS shall provide design services through 100% Design Development Phase and assist the Architect in the successive phases by reviewing Construction Documents, providing limited scope CD Review, Project Administration and Construction Observation Services to ensure the design intent for Courtyard is met.***

#### **CONCEPT / SCHEMATIC DESIGN**

- Review Project priorities and requirements based on project criteria by County, site survey, existing drawings and related data.
- Set design parameters and criteria including: Aesthetics, Timeline, Scope, Deliverables.
- Develop Concept Design for Courtyard and incorporate into Project Base Drawings provided by County. Concept Design will include: paving, lighting, landscape and movable furniture (tables and chairs) and perimeter screen and gates.
- Lighting:
  - Develop lighting design and review sustainability opportunities.
  - Design and layouts of proposed lighting fixtures on Project Base Drawings provided by the County to be incorporated in documents prepared by Architect's Electrical Engineer
- Coordinate Landscape Design with Gentile Glas Holloway O'Mahoney (LA)
- Research materials, fabrication and construction technologies.
- Work with County, Architect and Architect's Project Consultants to finalize Schematic Design.
- Prepare 100% Schematic Design Documents:
  - Preliminary plans, sections, elevations, selection of materials.
- **Coordination during Schematic Design Phase:**
  - Establish criteria of drawing set-up to prepare for drawing transition (hand-off) after Design Development.
  - Preliminary consultation and coordination between NS, County, Architect and Architect's Consultants.
  - Distribute and coordinate project information / drawings to County, Architect and Architect's Consultants.
  - Develop preliminary Project Timeline / Schedule / Budget in collaboration with County, Architect, and Architect's Consultants.

**Deliverables:** 100% Schematic Design Submittal for Review and Approval.

#### **DESIGN DEVELOPMENT**

- Review Schematic Design review comments
- Refine and develop design based on County, City, and Project's teams' reviews and comments.
- Prepare Design Development Documents: Plans, Sections, Elevations, Typical Construction Details, Final Material selections, Criteria for site Lighting and related Electrical.



- Lighting
  - Finalize lighting design, fixture location, specs, controls
  - Provide electric lighting calculations (illuminances, luminances), as required for in-house verification of lighting design concepts.
  - Prepare Lighting fixture schedule, lighting fixture cuts and detail sketches.
  - Provide information required to prepare a preliminary cost estimate of recommended lighting fixtures.
  - Provide general conditions specifications for the lighting fixtures.
- Review and approve plant selection proposed by LA
- Incorporate AV locations into plan set
- Integrate 100% progress drawings of Architect and Architects Consultants into Design Development set.
- Distribute and coordinate project information / drawings to project team.
- Prepare sufficient documentation to clearly describe Project in order for County to coordinate and obtain cost estimate by qualified fabricators and contractors.
- Review Design Development comments and Cost Estimate.
- Refine and develop design based on County review and Cost Estimate and prepare final 100% Design Development submittal for use in preparation of final Construction Documents.
- **Coordination during Design Development Phase:**
  - Coordinate update of Project Timeline / Schedule / Budget
  - Coordination between NS, County, Architect and Architect's Consultants.
  - Deliver 100% Design Development drawings and coordinate review for constructability, technical items, budget and aesthetic intent to ensure communication and coordination during Construction Document process.

**Deliverables:** Design Development Submittal for Review and Approval.  
Documentation Package for Cost Estimate. Project Specifications, Regulatory Agency requirement conformance.

#### **CONSTRUCTION DOCUMENTS**

- Review 50% Construction Documents by Architect for conformance to design intent.
- Review shop drawings as required.
- Review 100% Construction Documents set and Project Specifications prepared by Architect for conformance to design intent.
- Lighting
  - Review of 50% and 100% Construction Documents as prepared by Architect and Consultants.
  - Review of shop drawings and/or submittals of specified lighting equipment and associated architectural elements
- Provide detail sketches / modifications to Architect as required.
- Review of revisions
- **Coordination during Construction Document Phase:**
  - Communicate design and technical modifications needed from County's Design Development review in preparation for final construction drawings.
  - Review Project Timeline / Schedule/ Budget with Architect.

**Deliverables:** Final Design Development package for Review and Approval.

#### **AGENCY CONSULTING, REVIEWS AND APPROVALS**

- Provide detail sketches / modifications as required for permit approval.
- Assist and consult with Architect as needed

**Deliverables:** Design sketches, clarifications, modifications as required.

**OFF-SITE FABRICATION /CONSTRUCTION OBSERVATION**

- Pre-Construction Coordination
- Review submittals including Shop Drawings, Product Data, Samples, Mockups and other submittals for conformance to design intent and specifications.
- Observe site work at appropriate intervals to determine if the project is proceeding in accordance with the visual and aesthetic design intent.
- Respond to Requests for Information or Clarification during the site lighting installation
- Review of shop drawings and/or submittals of specified equipment and associated architectural elements
- Prepare design detail sketches or modifications as required
- Review and comment of Architect's punch list.

**PROJECT CLOSEOUT**

- **Coordination during Project Closeout Phase:**
  - Assist and consult as needed for Closeout Documents

**COURTYARD DESIGN, ADMINISTRATION & CONSTRUCTION OVERSIGHT  
COMPENSATION AND FEES**

**ASSUMPTIONS**

Any additional work beyond that outlined in this proposal will be considered outside of the scope of this agreement and will be considered Additional Services to be billed hourly or under a separate agreement.

**Number and Purpose of on-site meetings:** It is anticipated that the artist or artist's consultants shall make up to 4 on-site visits to provide construction consulting services, approve work done by the General Contractor and attend opening event.

County shall provide NS with existing conditions documentation and other information that records the physical conditions of the site and existing structures and NS will provide Project Base Drawing Set, including elevations and plans, into office standards (AutoCAD) depicting the complete physical characteristics of the site and existing structures to be used for the development of the Project by NS, the Architect and their Consultants and Engineers.

Any additional design, engineering, fabrication, or construction costs which arise from unforeseen site conditions shall be the responsibility of the County.

Architect shall confirm location, size and adequacy of utilities serving the site as well as critical dimensions through field measurements as required.

Architect shall provide egress and code-related requirements to NS to facilitate development of the design.

The Architect shall be responsible for all interface and coordination relative to regulatory agencies having jurisdiction over the Courtyard project.