

PALM BEACH COUNTY  
BOARD OF COUNTY COMMISSIONERS

AGENDA ITEM SUMMARY

Meeting Date: August 14, 2018

Consent [X] Regular [ ]  
Public Hearing [ ]

Department: Water Utilities Department

I. EXECUTIVE BRIEF

**Motion and Title: Staff recommends motion to approve:** Supplement No. 8 to Work Authorization (WA) No. 6 for Water Treatment Plant No. 11 (WTP 11) Odor Control Improvements Project with Globaltech, Inc., in the amount of \$354,457.36 and for an additional one hundred and eighty (180) calendar days project time extension.

**Summary:** On March 10, 2015, the Board of County Commissioners (BCC) approved the Water Utilities Department (WUD) Contract for Optimization and Improvements Design-Build with Globaltech, Inc. (R2015-0315). WA No. 6 provided for the replacement of existing wet-chemical odor scrubber at WTP 11 with a more efficient biological odor scrubber system to significantly reduce odor and chemical costs. During commissioning and subsequent operation of the biological odor scrubber, the waste stream is more acidic than anticipated. Hence, a corrosion resistant pump station needs to be installed to dispose of the waste stream into the deep injection well at WTP 11. The Small Business Enterprise (SBE) participation goal established by the SBE Ordinance is 15% overall. The Contract provides for SBE participation of 75.00%. Supplement No. 8 to WA No. 6 includes 99.85% overall SBE participation. The cumulative SBE participation, including Supplement No. 8 to WA No. 6, is 95.63% overall. Globaltech, Inc., is a Palm Beach County Company. The Project is in the FY18 Capital Improvement Plan adopted by the BCC. (WUD Project No. 16-057) District 6 (MJ)

**Background and Justification:** WA No. 6 replaced the existing wet-chemical odor scrubber at WTP 11 with a more efficient biological odor scrubber system to significantly reduce odor and chemical costs. During commissioning and operation of the biological odor scrubber, the concentration of hydrogen sulfide being removed is much higher resulting in a waste stream from the biological scrubber that is more acidic than anticipated. To reliably dispose of the biological odor scrubber waste stream requires the construction of a corrosion resistant pump station. The proposed corrosion resistant pump station will utilize polypropylene vertical turbine pumps and polymer concrete composite wet well to provide improved reliability and longevity. The new corrosion resistant pump station will pump the acidic waste from the odor control scrubbers and pump directly into the deep injection well disposal line. Additional time of one hundred and eighty (180) calendar days is needed to design, permit, construct and commission the proposed corrosion resistant pump station.

**Attachments:**

1. Four (4) Originals of Supplement No. 8 to Work Authorization No. 6
2. Location Map
3. ITS Summary of Certificates

Recommended By:

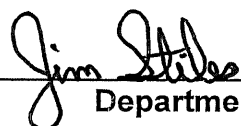

Department Director

7-17-18

Date

Approved By:



Assistant County Administrator

8/6/18

Date

II. FISCAL IMPACT ANALYSIS

A. Five Year Summary of Fiscal Impact:

Fiscal Years	2018	2019	2020	2021	2022
Capital Expenditures	\$354,458	0	0	0	0
Operating Costs	0	0	0	0	0
External Revenues	0	0	0	0	0
Program Income (County)	0	0	0	0	0
In-Kind Match County	0	0	0	0	0
NET FISCAL IMPACT	\$354,458	0	0	0	0
# ADDITIONAL FTE POSITIONS (Cumulative)	0	0	0	0	0
Budget Account No.:	Fund 4011	Dept 721	Unit W026	Object 6541	

Is Item Included in Current Budget? Yes X No

Does this item include the use of federal funds? Yes No X

Reporting Category N/A

B. Recommended Sources of Funds/Summary of Fiscal Impact:

One (1) time expenditure from user fees, connection fees and balance brought forward.

C. Department Fiscal Review:

III. REVIEW COMMENTS

A. OFMB Fiscal and/or Contract Development and Control Comments:

OFMB 7/19/18 Contract Development and Control 7/26/18

B. Legal Sufficiency:

8/6/18 Assistant County Attorney

C. Other Department Review:

Department Director

This summary is not to be used as a basis for payment.

**SUPPLEMENT No. 8 to WORK AUTHORIZATION NO. 06**

**Palm Beach County Water Utilities Department  
Optimization and Improvements Design-Build Contract  
Resolution # 2015-0315 Contract Dated March 10, 2015**

**Project Title: Water Treatment Plant No. 11 – Odor Control Improvements – Supplement 8**

**WUD Project No.: WUD 16-057**

**Design-Build Entity: Globaltech, Inc.**

**Address: 6001 Broken Sound Parkway NW, Ste. 610 Boca Raton, FL 33487**

**Budget Line Item No. 4011 - 721 – W026 - 6541**

**District: 6**

**This Supplement to Work Authorization provides for:**

A new corrosion resistant lift station will be added to dispose of the low pH waste stream from the biological odor control scrubbers at WTP 11. An additional 180 days will be added to design and construct the new lift station. See **ATTACHMENT - A** for detailed scope of services.

The Contract provides for 75% SBE participation. This Work Authorization includes **99.85%** participation. The cumulative proposed SBE participation, including this authorization is **95.63%**.

1. Services completed by the Design-Build Entity to date:

**See ATTACHMENT - B.**

2. Design-Build Entity shall begin work within ten (10) calendar days from the issuance of Notice to Proceed (NTP). Execution of the Project will be accomplished as follows from the issuance of the NTP: August 11, 2016

Substantial Completion date: August 11, 2017 (365) Calendar Days

Supplement No. 1 - Add 47 days

Supplement No. 2 - Add 49 days

Supplement No. 3 – No Change

Supplement No. 4 – No Change

Supplement No. 5 – No Change

Supplement No. 6 – No Change

Supplement No. 7 – No Change

**Supplement No. 8 – No Change**

Substantial Completion date: November 15, 2017 (461) Calendar Days

**Revised 4-12-18**

Final Construction Completion date: October 10, 2017 (425) Calendar Days  
Supplement No. 1 - Add 47 days  
Supplement No. 2 - Add 49 days  
Supplement No. 3 – No Change  
Supplement No. 4 – Add 75 days  
Supplement No. 5 – Add 60 Days  
Supplement No. 6 – No Change  
Supplement No. 7 – Add 90 Days  
**Supplement No. 8 – Add 180 Days**  
**New Final Completion date: February 23, 2019 (926) Calendar Days**

Liquidated damages will apply as follows:

**\$1,000.00** per day past substantial completion date.  
**\$500.00** per day past final completion date.

3. The Guaranteed Maximum Price compensation to be paid to the Design-Build Entity for providing the requested services in accordance with the Contract Bid Prices is:

Original Guaranteed Maximum Price: \$1,536,373.00  
Supplement No. 1 Price: \$0.00  
Supplement No.2 Price: \$0.00  
Supplement No.3 Price: \$39,625.59  
Supplement No.4 Price: \$0.00  
Supplement No.5 Price: \$0.00  
Supplement No.6 Price: \$59,992.54  
Supplement No.7 Price: \$0.00  
**Supplement No.8 Price: \$354,457.36**  
**New Guaranteed Maximum Price: \$1,990,448.49**

4. This Work Authorization does not amend, change, or modify the Contract which remains in full force and effect.
5. All attachments to this Work Authorization are incorporated herein and made a part of this Work Authorization.

**Revised 4-12-18**

Palm Beach County Water Utilities Department  
Optimization and Improvements Design-Build Contract  
Resolution # 2015-0315 Contract Dated March 10, 2015

Project Title: Water Treatment Plant No. 11 – Odor Control Improvements – Supplement 8  
WUD Project No.: WUD 16-057

IN WITNESS WHEREOF, this Work Authorization is accepted, subject to the terms, conditions and obligations of the aforementioned Contract.

Sharon R. Bock, Clerk & Comptroller,  
Palm Beach County

Palm Beach County,  
Board of County Commissioners

ATTEST:

Signed: \_\_\_\_\_

Signed: \_\_\_\_\_  
ci 7/5/18 Melissa McKinlay, Mayor

Typed Name: \_\_\_\_\_  
Deputy Clerk

\_\_\_\_\_  
Date JCS

Approved as to Form and Legal  
Sufficiency

Design-Build Entity: Globaltech, Inc.

Signed: \_\_\_\_\_

Troy L. Lyn  
(Signature)

Typed Name: \_\_\_\_\_  
County Attorney

Troy L. Lyn / Executive Vice President  
(Name and Title)

June 28, 2018  
Date

STATE OF FLORIDA  
COUNTY OF Palm Beach

The foregoing instrument was acknowledged before me this 28<sup>th</sup> day of June, 2018, by Troy L. Lyn  
as Executive Vice President for Globaltech, Inc.

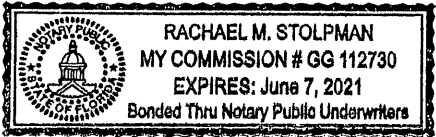

Rachael Stolpman  
(Signature of Notary Public - State of Florida)  
Rachael Stolpman  
(Print, Type, or Stamp Commissioned Name of Notary Public)

Personally Known XX OR Produced Identification \_\_\_\_\_ Type of Identification Produced \_\_\_\_\_

## LIST OF ATTACHMENTS

### SUPPLEMENT No. 8 to WORK AUTHORIZATION NO. 06

Palm Beach County Water Utilities Department  
Optimization and Improvements Design-Build Contract  
Resolution # 2015-0315 Contract Dated March 10, 2015

ATTACHMENT	A	Scope of Work
ATTACHMENT	B	Summary and Status of Work Authorizations
ATTACHMENT	C	Public Construction Bond Rider
ATTACHMENT	D	Form of Guarantee ( <b>Not Applicable</b> )
ATTACHMENT	E	Work Authorization Schedule of Bid Items
ATTACHMENT	F	SBE Schedule 1 and Schedule 2
ATTACHMENT	G	Summary of SBE/Minority Business Tracking
ATTACHMENT	H	Location Map
ATTACHMENT	I	Design-Build Criteria
ATTACHMENT	J	Vendor Quotes

Revised 4-12-18

**ATTACHMENT – A**

**Scope of Work**

# ATTACHMENT - A

## SUPPLEMENT No. 8 to SCOPE OF WORK AUTHORIZATION # 06

PROJECT NO.: WUD 16-057

PROJECT TITLE: Water Treatment Plant No. 11 – Odor Control Improvements - Supplement 8

The location of the work is:

Water Treatment Plant No. 11 (WTP 11), 39700 Hooker Highway, Belle Glade, FL 33430-5934, PCN 00-37-43-19-00-000-3060.

**Design-Build Entity shall perform the Scope of Services as described in the Design-Criteria Report and as further described herein:**

The hydrogen sulfide concentration into the odor control scrubber was higher than anticipated (150 ppm vs +200 ppm). This has resulted in a very low pH (1.6 to 2.0) waste stream from the odor control scrubbers. To increase reliability and longevity of equipment handling the waste, a new corrosion resistant lift station is to be constructed. The work shall include the following:

- Furnish and install an 8 ft diameter x 9 ft Armorock wet well with lid constructed of polymer concrete with fiberglass rebar. The wet well shall carry a 50-year manufacturer's corrosion proof warranty on the structure. The lid shall have a 30" x 30" inspection access hatch and openings for two cantilever pumps.
- Furnish and install a 4 ft x 4 ft x 6-inch square apron around the perimeter around the wetwell
- Furnish and install two (2) 7.5 Hp thermoplastic Vanton Sump-Gard® sg vertical centrifugal pump
- Furnish and install 6-inch PVC drain pipe to and from the new wet well with a bypass around wet well. The bypass will also consist of three (3) buried 6-inch PVC gate valves. The bypass will connect to inlet of the existing plant process lift station.
- Furnish and install 3-inch schedule 80 PVC pump discharge piping. Discharge piping shall include two (2) 3-inch PVC diaphragm valves for isolation and two 3-inch PVC swing check valves. Above ground piping to be supported on 316 stainless steel pipe supports.
- Furnish and install ½-inch stainless steel tubing seal water line downstream of the odor control back flow preventer. The seal water line shall include a pressure gauge, isolation ball valve, and ½" pressure reducing valve.
- Furnish and install duplex lift station pump panel. Panel shall be sized for 10 hp, 480 V, 3 Phase pumps with PLC, variable frequency drives, bypass starters, terminal junction box, transformer and alarm light. The control panel will be equipped with two remote mount ultrasonic level sensors.
- Programming of lift station PLC.
- Demolish existing RPCP panel including conduits on slab.
- Furnish and install a new 30 amp disconnect and intercept existing feeds for the RPCP panel.
- Furnish and install conduit from disconnect to new control panel for power and conduit from existing Odor Control panel LCP-2010 to new LS control panel for fiber optic.
- Furnish and install a Wilo standard epoxy coated 4-inch elbow into existing process lift station

Revised 4-12-18



**Assumptions:**

The following assumptions were assumed in developing the scope of services:

- Lift station control panel will be PBC standard with the following differences:
  - Panel shall not include: back up hi-level float, radio, solar panel, antenna tower
  - Panel shall include - two pump motor VFDs, two Endress+Hausser ultrasonic level sensors fiber-optic media converter. Two Endress+Hausser remote mount level transmitters with aluminum sunshade stanchions and surge protection. Fiberoptic patch panel and media converter. Spare Square-D 10HP VFD shipped loose. PLC and I/O modules shall be Allen Bradley CompactLogix. PLC program mileage for control panel shall be done by Hillers Electrical Engineering, Inc.
- FDEP UIC permitting will be performed by PBCWUD, if required.
- Water quality testing if required for permitting to be performed by PBCWUD
- Globaltech shall apply for the building department permit but fees are to be paid for by PBCWUD.

**Permits and Fees:**

It shall be the Design-Build Entity's responsibility to secure all permits required to complete the work under this contract. The Design-Build Entity shall be responsible for all inspections and requirements to close-out the completed permits. The Owner shall pay all permit fees. The Design-Build Entity shall be responsible for all Business tax fees for work within Palm Beach County or Municipalities. The Design-Build Entity shall notify the County of the permit fees and allow three (3) weeks for a check for the permit fee(s) to be issued to the Design-Build Entity.

**Revised 4-12-18**

## **ATTACHMENT – B**

### **Summary & Status of Work Authorizations**

**ATTACHMENT - B**  
SUMMARY AND STATUS OF AUTHORIZATIONS 07/05/2018

Work Auth. No.	WUD Project No.	Title	Status	Project Total Amount	SBE Total Amount	SBE Participation %	Approved By	Date Approved	Globaltech Project No.
WA - 1	WUD 14-073	WTP 11 Degasifier Cleaning System	Approved	\$1,051,189.81	\$1,020,112.81	97.0%	BCC	4/21/15	150479
WA - 1.1	WUD 14-073	WTP 11 Degasifier and Clearwell Improvements - Supplement 1	Approved	\$135,714.04	\$124,571.04	91.8%	BCC	2/09/16	150479
WA - 1.2	WUD 14-073	WTP 11 Degasifier and Clearwell Improvements - Supplement 2	Approved	\$16,333.64	\$13,333.64	81.6%	DIR	5/17/16	150479
WA - 1.3	WUD 14-073	WTP 11 Degasifier and Clearwell Improvements - Supplement 3	Approved	\$0.00	\$0.00	0.0%	CRC	8/17/16	150479
WA - 2	WUD 14-050	WRWWTF Power Improvements Phase 1	Approved	\$598,998.02	\$573,498.02	95.7%	BCC	9/01/15	150486
WA - 2.1	WUD 14-050	WRWWTF Power Improvements Phase 1 - Supplement 1	Approved	\$212,499.48	\$202,005.48	95.1%	BCC	5/17/16	150486
WA - 3	WUD 15-073	Improvements to the Pahokee 0.5 MG Elevated Water Storage Tank	Approved	\$504,301.41	\$498,426.41	98.8%	BCC	9/01/15	150503
WA - 3.1	WUD 15-073	Improvements to the Pahokee 0.5 MG Elevated Water Storage Tank - Supplement 1	Approved	\$59,844.24	\$53,944.24	90.1%	DIR	6/22/16	150503
WA - 3.2	WUD 15-073	Improvements to the Pahokee 0.5 MG Elevated Water Storage Tank - Supplement 2	Cancelled	\$0.00	\$0.00	0.0%	N/A	N/A	150503
WA - 4	WUD 13-003	WTP 9 - Permeate Flush System	Approved	\$1,999,288.00	\$1,954,888.00	97.8%	BCC	5/16/17	120004
WA - 4.1	WUD 13-004	WTP 9 - Permeate Flush System - Supplement 1	Pending	\$0.00	\$0.00	0.0%	Pending	-	120004
WA - 5	WUD 16-054	WTP 3 - Chemical Improvements	Approved	\$658,262.64	\$617,762.64	93.8%	BCC	7/12/16	162000
WA - 5.1	WUD 16-054	WTP 3 - Chemical Improvements - Supplement 1	Approved	\$67,262.18	\$67,262.18	100.0%	DIR	3/15/17	162000
WA - 6	WUD 16-057	WTP 11 - Odor Control Improvements	Approved	\$1,536,373.00	\$1,504,253.00	97.9%	BCC	7/12/16	162005
WA - 6.1	WUD 16-057	WTP 11 - Odor Control Improvements - Supplement 1	Approved	\$0.00	\$0.00	0.0%	DIR	8/15/17	162005
WA - 6.2	WUD 16-057	WTP 11 - Odor Control Improvements - Supplement 2	Approved	\$0.00	\$0.00	0.0%	DIR	11/8/17	162005
WA - 6.3	WUD 16-057	WTP 11 - Odor Control Improvements - Supplement 3	Approved	\$39,625.59	\$39,625.59	100.0%	DIR	1/18/18	162005
WA - 6.4	WUD 16-057	WTP 11 - Odor Control Improvements - Supplement 4	Approved	\$0.00	\$0.00	0.0%	DIR	1/18/18	162005
WA - 6.5	WUD 16-057	WTP 11- Odor Control Improvements - Supplement 5	Approved	\$0.00	\$0.00	0.0%	DIR	3/15/18	162005
WA - 6.6	WUD 16-057	WTP 11- Odor Control Improvements - Supplement 6	Approved	\$59,992.54	\$49,307.54	12.2%	DIR	4/24/18	162005
WA - 6.7	WUD 16-057	WTP 11-Odor Control Improvements - Supplement 7	Approved	\$0.00	\$0.00	0.0%	DIR	5/29/18	162005
WA - 6.8	WUD 16-057	WTP 11-Odor Control Improvements - Supplement 8	Pending	\$354,457.36	\$353,957.36	99.85%	Pending	-	162005
WA - 7	WUD 16-058	WTP 11 - Phase II WTP Improvements	Approved	\$1,965,625.00	\$1,904,407.80	96.9%	BCC	9/13/16	162002
WA - 7.1	WUD 16-058	WTP 11 - Phase II WTP Improvements - Supplement 1	Approved	\$0.00	\$0.00	0.0%	DIR	12/8/17	162002
WA - 7.2	WUD 16-058	WTP 11 - Phase II WTP Improvements - Supplement 2	Approved	-\$76,548.40	-\$90,124.46	117.7%	DIR	4/5/18	162002
WA - 7.3	WUD 16-058	WTP 11 - Phase II WTP Improvements - Supplement 3	Approved	\$0.00	\$0.00	0.0%	DIR	6/4/18	162002
WA - 8	WUD 16-056	ECRWRF Reclaimed Water Facility Improvements - Phase 1	Approved	\$1,490,603.00	\$1,395,103.00	93.6%	BCC	9/13/16	162004
WA - 8.1	WUD 16-056	ECRWRF Reclaimed Water Facility Improvements - Phase 1 - Supplement 1	Approved	\$24,878.72	\$24,878.72	100.0%	DIR	8/28/17	162004

**ATTACHMENT - B**  
SUMMARY AND STATUS OF AUTHORIZATIONS 07/05/2018

Work Auth. No.	WUD Project No.	Title	Status	Project Total Amount	SBE Total Amount	SBE Participation %	Approved By	Date Approved	Globaltech Project No.
WA - 8.2	WUD 16-056	ECRWRF Reclaimed Water Facility Improvements - Phase 1 - Supplement 2	Approved	\$48,741.75	\$37,741.75	77.4%	CRC	12/20/17	162004
WA - 9	WUD 16-055	SRWRF - Safety Improvements	Approved	\$747,650.00	\$663,570.00	88.8%	BCC	9/27/16	162001
WA - 9.1	WUD 16-055	SRWRF - Safety Improvements - Supplement 1	Approved	\$0.00	\$0.00	0.0%	DIR	11/2/17	162001
WA - 10	WUD 17-011	ECRWRF Reclaimed Water Facility Improvements - Phase 2	Approved	\$1,247,150.76	\$1,244,650.76	99.8%	BCC	1/10/17	162006
WA - 10.1	WUD 17-011	ECRWRF Reclaimed Water Facility Improvements - Phase 2- Supplement 1	Approved	\$137,954.08	\$137,954.08	100.0%	CRC	4/4/18	162006
WA - 10.2	WUD 17-011	ECRWRF Reclaimed Water Facility Improvements - Phase 2 - Supplement 2	Pending	\$0.00	\$0.00	100.0%	Pending	-	162006
WA - 11	WUD 17-050	System Wide Safety Improvements	Approved	\$711,566.57	\$671,356.57	94.3%	BCC	1/23/18	120045
WA - 12	WUD 17-059	WTP 9 Miscellaneous Improvements	Approved	\$1,127,526.57	\$973,686.57	86.4%	BCC	2/6/18	120038
WA - 13	WUD 18-007	South Bay Water Storage Tank Improvements	Approved	\$186,571.69	\$166,677.69	89.3%	CRC	3/7/18	120047
WA - 14	WUD 18-006	Belle Glade Water Storage Tank Improvements	Approved	\$183,109.16	\$164,415.16	89.8%	CRC	3/7/18	120037
WA - 15	WUD 18-019	WTP 11 Membrane Pilot Refurbishment	Approved	\$188,136.48	\$188,136.48	100.0%	CRC	3/7/18	120073
WA-16	WUD 18-028	Glades Region Pahokee Water Storage Tank Improvements	Approved	\$77,911.88	\$77,911.88	100.0%	DIR	3/8/18	120076
Total WAs				\$15,355,019.21				REVISED 4/12/2018	

## **ATTACHMENT – C**

### **Public Construction Bond Rider**

INCREASE PENALTY RIDER

No. 3

BOND NO. SU1129869

To be attached and form a part of Bond No. SU1129869 dated the 12th day of July, 2016, executed by Arch Insurance Company as surety, on behalf of Globaltech, Inc. as current principal of record, and in favor of the Palm Beach County Board of County Commissioners, as Obligee, and in the amount of One Million Five Hundred Thirty-Six Thousand Three Hundred Seventy-Three and 00/100 Dollars (\$1,536,373.00).

In consideration of the agreed premium charged for this bond, it is understood and agreed that Arch Insurance Company hereby consents that effective from the 12th day of July, 2016, said bond shall be amended as follows:

THE BOND PENALTY SHALL BE Increased in Accordance with Supplement No. 8 to Work Authorization No. 06:

FROM: One Million Six Hundred Thirty-Five Thousand Nine Hundred Ninety-One and 13/100 Dollars (\$1,635,991.13)

TO: One Million Nine Hundred Ninety Thousand Four Hundred Forty-Eight and 49/100 Dollars (\$1,990,448.49)

The Increase of said bond penalty shall be effective as of the 12th day of July, 2016, and does hereby agree that the continuity of protection under said bond subject to changes in penalty shall not be impaired hereby, provided that the aggregate liability of the above mentioned bond shall not exceed the amount of liability assumed by it at the time the act and/or acts of default were committed and in no event shall such liability be cumulative.

Signed, sealed and dated this 2nd day of July, 2018.

BY: Troy L. Lyn Globaltech, Inc.  
PRINCIPAL  
Troy L. Lyn, Executive Vice President

BY: Brett Rosenhaus Arch Insurance Company  
SURETY  
Brett Rosenhaus, Attorney-in-Fact

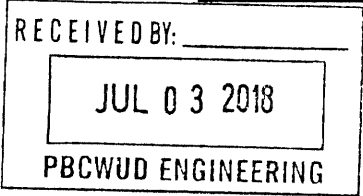

**THIS POWER OF ATTORNEY IS NOT VALID UNLESS IT IS PRINTED ON BLUE BACKGROUND.**

***This Power of Attorney limits the acts of those named herein, and they have no authority to bind the Company except in the manner and to the extent herein stated. Not valid for Note, Loan, Letter of Credit, Currency Rate, Interest Rate or Residential Value Guarantees.***

## POWER OF ATTORNEY

Know All Persons By These Presents:

That the Arch Insurance Company, a corporation organized and existing under the laws of the State of Missouri, having its principal administrative office in Jersey City, New Jersey (hereinafter referred to as the "Company") does hereby appoint:

Arthur Lawrence Colley of Charlotte, NC  
Brett Rosenhaus of Lake Worth, FL  
Charles D. Nielson, Charles J. Nielson and David R. Hoover of Miami Lakes, FL (EACH)  
F. Danny Gann, Edward T. Ward and Audria R. Ward of Atlanta, GA (EACH)  
John R. Neu and Kevin Wojtowicz of St. Petersburg, FL (EACH)  
Laura D. Mosholder of Orlando, FL

its true and lawful Attorney(s) in-Fact, to make, execute, seal, and deliver from the date of issuance of this power for and on its behalf as surety, and as its act and deed:

Any and all bonds, undertakings, recognizances and other surety obligations, in the penal sum not exceeding Ninety Million Dollars (\$90,000,000.00).

This authority does not permit the same obligation to be split into two or more bonds in order to bring each such bond within the dollar limit of authority as set forth herein.

The execution of such bonds, undertakings, recognizances and other surety obligations in pursuance of these presents shall be as binding upon the said Company as fully and amply to all intents and purposes, as if the same had been duly executed and acknowledged by its regularly elected officers at its principal administrative office in Jersey City, New Jersey.

This Power of Attorney is executed by authority of resolutions adopted by unanimous consent of the Board of Directors of the Company on September 15, 2011, true and accurate copies of which are hereinafter set forth and are hereby certified to by the undersigned Secretary as being in full force and effect:

"VOTED, That the Chairman of the Board, the President, or the Executive Vice President, or any Senior Vice President, of the Surety Business Division, or their appointees designated in writing and filed with the Secretary, or the Secretary shall have the power and authority to appoint agents and attorneys-in-fact, and to authorize them subject to the limitations set forth in their respective powers of attorney, to execute on behalf of the Company, and attach the seal of the Company thereto, bonds, undertakings, recognizances and other surety obligations obligatory in the nature thereof, and any such officers of the Company may appoint agents for acceptance of process."

This Power of Attorney is signed, sealed and certified by facsimile under and by authority of the following resolution adopted by the unanimous consent of the Board of Directors of the Company on September 15, 2011:

VOTED, That the signature of the Chairman of the Board, the President, or the Executive Vice President, or any Senior Vice President, of the Surety Business Division, or their appointees designated in writing and filed with the Secretary, and the signature of the Secretary, the seal of the Company, and certifications by the Secretary, may be affixed by facsimile on any power of attorney or bond executed pursuant to the resolution adopted by the Board of Directors on September 15, 2011 and any such power so executed, sealed and certified with respect to any bond or undertaking to which it is attached, shall continue to be valid and binding upon the Company.

In Testimony Whereof, the Company has caused this instrument to be signed and its corporate seal to be affixed by their authorized officers, this 13<sup>th</sup> day of April, 2018.

Attested and Certified

Arch Insurance Company

  
Patrick K. Nails, Secretary

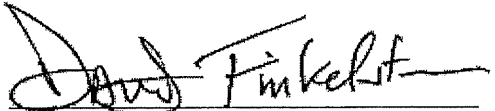

  
David M. Finkelstein, Executive Vice President

STATE OF PENNSYLVANIA SS

COUNTY OF PHILADELPHIA SS

I, Michele Tripodi, a Notary Public, do hereby certify that Patrick K. Nails and David M. Finkelstein personally known to me to be the same persons whose names are respectively as Secretary and Executive Vice President of the Arch Insurance Company, a Corporation organized and existing under the laws of the State of Missouri, subscribed to the foregoing instrument, appeared before me this day in person and severally acknowledged that they being thereunto duly authorized signed, sealed with the corporate seal and delivered the said instrument as the free and voluntary act of said corporation and as their own free and voluntary acts for the uses and purposes therein set forth.

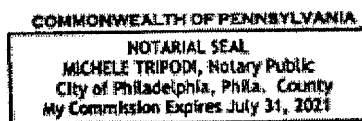

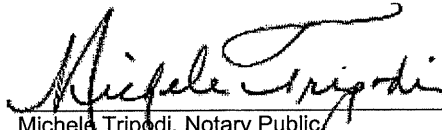
  
Michele Tripodi, Notary Public  
My commission expires 07/31/2021

#### CERTIFICATION

I, Patrick K. Nails, Secretary of the Arch Insurance Company, do hereby certify that the attached Power of Attorney dated April 13, 2018 on behalf of the person(s) as listed above is a true and correct copy and that the same has been in full force and effect since the date thereof and is in full force and effect on the date of this certificate; and I do further certify that the said David M. Finkelstein, who executed the Power of Attorney as Executive Vice President, was on the date of execution of the attached Power of Attorney the duly elected Executive Vice President of the Arch Insurance Company.

IN TESTIMONY WHEREOF, I have hereunto subscribed my name and affixed the corporate seal of the Arch Insurance Company on this 2 day of July, 2018.

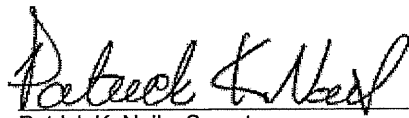
  
Patrick K. Nails, Secretary

This Power of Attorney limits the acts of those named therein to the bonds and undertakings specifically named therein and they have no authority to bind the Company except in the manner and to the extent herein stated.

**PLEASE SEND ALL CLAIM INQUIRIES RELATING TO THIS BOND TO THE FOLLOWING ADDRESS:**

Arch Insurance – Surety Division  
3 Parkway, Suite 1500  
Philadelphia, PA 19102





**ATTACHMENT - D**

**Form of Guarantee  
(Not Applicable)**

**ATTACHMENT - E**

**Work Authorization Schedule of Bid Items**

PBC Water Utilities Department  
 162005 PBCWUD WTP 11 Odor Control Imp

Description	Quote/Vendor	Unit	Quantity	Cost	Ext. Cost	Tax (%)	Markup*	Ext. Price
<b>104 BioAir LS Construction</b>								
Temporary Facilities		LOT						
Job Site Trailer		MONTH	2.000	500.00	1,000.00	7.00	1.1500	1,230.50
Sanitary		MONTH	2.000	120.00	240.00	7.00	1.1500	295.32
Job Site Office Supplies		LOT	1.000	100.00	100.00	7.00	1.1500	123.05
Waste Hauling		LOT	2.000	600.00	1,200.00	7.00	1.1500	1,476.60
General Conditions		LOT						
Submittal Labor		HR	10.00	71.08	710.80		1.2992	923.47
O&M		HR	10.00	71.08	710.80		1.2992	923.47
Progress Meeting		HR	12.00	87.79	1,053.48		1.2992	1,368.68
Scheduling Labor		HR	10.00	71.08	710.80		1.2992	923.47
Construction PM		HR	40.00	71.08	2,843.20		1.2992	3,693.89
Construction Superintendent		HR	40.00	62.13	2,485.20		1.2992	3,228.77
Purchasing & Subcontracts		HR	20.00	71.08	1,421.60		1.2992	1,846.94
Permitting Labor (Building Department)		HR	12.00	71.08	852.96		1.2992	1,108.17
Office Admin		HR	20.00	38.89	777.80		1.2992	1,010.52
Control Panel & Accessories	C.C. Controls	LOT	1.000	42,700.00	42,700.00	7.00	1.1500	52,542.35
Misc Metals, Supports & Fasteners		LOT	1.000	1,500.00	1,500.00	7.00	1.1500	1,845.75
Installation (4-Man Crew)		CR-D	2.000	1,166.16	2,332.32	7.00	1.1500	2,869.92
Programing		LOT	1.000	5,728.52	5,728.52		1.1000	6,301.37
Prep Area & Excavate (New Wet Well) (4-Man Crew)		CR-D	3.000	1,166.16	3,498.48		1.2992	4,545.23
Core Drill Wet Well & Install Underground Piping (4-Man Crew)		CR-D	7.000	1,166.16	8,163.12		1.2992	10,605.53
Install Above Ground Pipe, Valves & Supports (4-Man Crew)		CR-D	4.000	1,166.16	4,664.64		1.2992	6,060.30
Wet Well Structure	Armorock	LOT	1.000	31,304.00	31,304.00	7.00	1.1500	38,519.57
Pump (Wet Well)	RC Beach	EA	2.000	14,758.00	29,516.00	7.00	1.1500	36,319.44

## Takeoff Worksheet

06/28/18

Continued...

Description	Quote/Vendor	Unit	Quantity	Cost	Ext. Cost	Tax (%)	Markup*	Ext. Price
Start-up (Pump)	RC Beach	LOT	1.000	3,000.00	3,000.00	7.00	1.1500	3,691.50
Stone/Fill		LOT	1.000	1,500.00	1,500.00	7.00	1.1500	1,845.75
Installation (4-Man Crew)		CR-D	5.000	1,166.16	5,830.80		1.2992	7,575.38
PVC Pipe & Fittings		LOT	1.000	4,000.00	4,000.00	7.00	1.1500	4,922.00
SS Valves		LOT	1.000	2,000.00	2,000.00	7.00	1.1500	2,461.00
SS Pipe, Tubing & Ftgs		LOT	1.000	2,000.00	2,000.00	7.00	1.1500	2,461.00
6" Underground PVC Valves W/2" Nut		EA	3.000	1,646.10	4,938.30	7.00	1.1500	6,076.58
3" PVC Check Valve		EA	2.000	2,185.93	4,371.86	7.00	1.1500	5,379.57
3" PVC Isolation Valve		EA	2.000	550.00	1,100.00	7.00	1.1500	1,353.55
Valve Box & Collar		LOT	1.000	1,000.00	1,000.00	7.00	1.1500	1,230.50
Linkseal		LOT	1.000	300.00	300.00	7.00	1.1500	369.15
Pipe Supports		LOT	1.000	2,000.00	2,000.00	7.00	1.1500	2,461.00
Flange Kits & Misc Materials		LOT	1.000	3,000.00	3,000.00	7.00	1.1500	3,691.50
Signs & Labels		LOT	1.000	1,000.00	1,000.00	7.00	1.1500	1,230.50
Misc Coatings		LOT	1.000	200.00	200.00	7.00	1.1500	246.10
Misc Application Material		LOT	1.000	75.00	75.00	7.00	1.1500	92.29
Installation (3-Man Crew)		CR-D	2.000	962.88	1,925.76		1.2992	2,501.95
Concrete around Wet Well (Below Grade)								
Form & Materials		LOT	1.000	500.00	500.00	7.00	1.1500	615.25
Cast In Place Concrete		LOT	1.000	700.00	700.00	7.00	1.1500	861.35
Concrete Pump		LOT	1.000	700.00	700.00	7.00	1.1500	861.35
Testing Services		LOT	1.000	500.00	500.00		1.1000	550.00
Installation (4-Man Crew)		CR-D	2.000	1,166.16	2,332.32		1.2992	3,030.15
Concrete Around Wet Well (Above Grade)								
Form & Materials		LOT						
Cast In Place Concrete		YD	1.000	1,000.00	1,000.00	7.00	1.1500	1,230.50
Concrete Pump		YD	7.000	180.00	1,260.00	7.00	1.1500	1,550.43
Concrete Pump		LOT	1.000	700.00	700.00	7.00	1.1500	861.35
Testing Services		LOT	1.000	1,000.00	1,000.00		1.2992	1,299.20
Installation (5-Man Crew)		CR-D	3.000	1,614.24	4,842.72		1.2992	6,291.66

## Takeoff Worksheet

06/28/18

Continued...

Description	Quote/Vendor	Unit	Quantity	Cost	Ext. Cost	Tax (%)	Markup*	Ext. Price
Base Ell (Existing Process LS)		EA	2.000	1,000.00	2,000.00	7.00	1.1500	2,461.00
Installation (4-Man Crew)		CR-D	1.000	1,166.16	1,166.16		1.2992	1,515.08
Crane - 40 Ton		Hr	4.000	130.20	520.80	7.00	1.1500	640.85
Backhoe w/ forks		WEEK	1.000	1,200.00	1,200.00	7.00	1.1500	1,476.60
Confined Space Equipment		LOT	1.000	1,200.00	1,200.00	7.00	1.1500	1,476.60
Crane		Hr	10.00	194.25	1,942.50	7.00	1.1500	2,390.25
Excavator		Month	1.000	4,200.00	4,200.00	7.00	1.1500	5,168.10
Dewatering Pump & Accessories		LOT	1.000	2,000.00	2,000.00	7.00	1.1500	2,461.00
Compactor		WEEK	1.000	450.00	450.00	7.00	1.1500	553.73
Equipment Fuel		GAL	200.0	4.00	800.00	7.00	1.1500	984.40
Equipment Pickup and Delivery		LOT	3.000	350.00	1,050.00	7.00	1.1500	1,292.03
Startup Crew (3-Man Crew)		CR-D	1.000	962.88	962.88		1.2992	1,250.97
Punch Out Crew (3-Man Crew)		CR-D	1.000	962.88	962.88		1.2992	1,250.97
Safety		HR	4.000	71.08	284.32		1.2992	369.39
Safety Equipment		LOT	1.000	500.00	500.00	7.00	1.1500	615.25
Electrical Sub	Energy Efficient	LOT	1.000	22,692.00	22,692.00		1.1000	24,961.20
Excavation & Concrete Sidewalk Repair								
Cast In Place Concrete		LOT						
Form & Materials		LOT	1.000	200.00	200.00	7.00	1.1500	246.10
Cast In Place Concrete		YD	1.000	180.00	180.00	7.00	1.1500	221.49
Installation (4-Man Crew)		CR-D	4.000	1,166.16	4,664.64		1.2992	6,060.30
Engineering		LOT	1.000	44,661.48	44,661.48		1.0000	44,661.48
Bonds & Certifications		LOT	1.000	5,311.00	5,311.00		1.1500	6,107.65
Builders Risk Insurance		LOT	1.000	5,034.83	5,034.83		1.1500	5,790.05
Bid Item Totals:					297,273.97			354,457.36

Takeoff Worksheet

06/28/18

Continued...

Description	Quote/Vendor	Unit	Quantity	Cost	Ext. Cost	Tax (%)	Markup*	Ext. Price
Grand Totals:					297,273.97			354,457.36

Note: CR-D=8Hrs  
\*Contract Markups Per Master Agreement:  
Materials = 1.15, Subcontractors = 1.1, Labor at Burden = 1.2992

**ATTACHMENT - E**  
WTP 11 Odor Control Improvements - Supplement 8

**Engineering Fee Summary**

Task	Task Description	E6	E5	E4	E3	Tech 4	OS	Total Labor	*Sub-Consultant Services	Sub-Consultant
		\$77.33	\$65.24	\$57.37	\$42.97	\$41.28	\$35.43			
1	Design									
	Project Management/Coordination	2	16				6			
	Meet w/ staff to review project/options		10							
	Mechanical Design (3 sheets)		8	12		20				
	Electrical/I&C Design			4		4	2		\$ 8,328.74	HEE
	Equipment Selection/Coordination		12	4						
	Cost Estimate		6	4						
	QC/QA	4		4						
	Subtotal Task 1	6	52	28	0	24	8	\$ 6,736.98	\$ 8,328.74	
2	SDC									
	Project Management/Coordination/Site Visits	2	10	4			4			
	Submittals		2		8		4			
	Electrical I&C		4				2		\$ 3,535.84	HEE
	Programming		4							
	Record Drawings		4		4	4				
	Startup		8	12						
	Subtotal Task 2	2	32	16	12	4	10	\$ 4,195.32	\$ 3,535.84	
	Labor Hours	8	84	44	12	28	18			
	Labor Costs	\$618.64	\$5,480.16	\$2,524.28	\$515.64	\$1,155.84	\$637.74	\$10,932.30		
	Labor Multiplier	3.00	3.00	3.00	3.00	3.00	3.00	3.00		
	Labor Total	\$1,855.92	\$16,440.48	\$7,572.84	\$1,546.92	\$3,467.52	\$1,913.22	\$32,796.90		
	Subconsultant Total								\$ 11,864.58	
	TOTAL ENGINEERING FEE								\$ 44,661.48	

Hillers Electrical Engineering \$ 11,864.58

PBCWUD WTP11 Odor Control - Lift Station Addition												
HILLERS ELECTRICAL ENGINEERING, INC.												
Scope Fee Breakdown -Design + Construction Phase Services												
Date: 5/23/2018												
	Rate	\$212.38	\$154.98	\$154.98	\$114.80	\$114.80		\$63.14				
		Proj. Man.	Proj Eng	Programming	Const. Coord	CAD/Engine.		Secretarial			TOTAL	
PHASE OF WORK	Hours	Hours	Hours	Hours	Hours	Hours	Hours	Hours	Sub-total	Expenses	TASK COST	COST
Lift Station Design												
Site Visit and Drawings, Review Meeting	2	16			24						\$5,659.64	
Shop Drawings Review	1	4			16						\$2,669.10	
Field Inspection (2 visits)					12						\$1,377.60	
Loop Check and Startup (1 visit)			8	8							\$2,158.24	
PLC Programming		2	32	4							\$5,728.52	
Total Labor and Expenses												
Total Hours												
	3	22	40	40	24							
Total Labor and Expenses												
	\$637.14	\$3,409.66	\$6,199.20	\$4,692.00	\$2,755.20						\$17,593.10	



## **ATTACHMENT – F**

**SBE Schedule 1 & Schedule 2**

ATTACHMENT - F

SCHEDULE 1  
LIST OF PROPOSED SBE-M/WBE PARTICIPATION

PROJECT NAME: Water Treatment Plant Phase II Improvements  
Supplement 3  
NAME OF PRIME BIDDER Globaltech, Inc.  
CONTACT PERSON: Bernard P. Gandy, President  
BID OPENING DATE: N/A

PROJECT No: WUD 16-058  
ADDRESS: 6001 Broken Sound Parkway NW, Suite 610  
PHONE NO.: 561-997-6433 FAX NO.: 561-997-5811  
DEPARTMENT: N/A

THIS DOCUMENT IS TO BE COMPLETED BY THE PRIME CONTRACTOR AND SUBMITTED WITH BID PACKET. PLEASE LIST THE NAME, CONTACT INFORMATION AND DOLLAR AMOUNT AND/OR PERCENTAGE OF WORK TO BE COMPLETED BY ALL SBE -M/WBE's ON THIS PROJECT. IF THE PRIME IS AN SBE-M/WBE, PLEASE ALSO LIST THE NAME, CONTACT INFORMATION AND DOLLAR AMOUNT AND/OR PERCENTAGE OF WORK TO BE COMPLETED BY THE PRIME ON THIS PROJECT. THE PRIME AFFIRMS THAT IT WILL MONITOR THE SBES LISTED TO ENSURE THE SBES PERFORM THE WORK WITH ITS OWN WORKFORCE.

Name, Address and Telephone	(Check one or both Categories)		DOLLAR AMOUNT AND/OR PERCENTAGE OF WORK					
	M/WBE	Small Business	Black	Hispanic	Women	Caucasian	Other (Please Specify)	
1. Globaltech, Inc. 6001 Broken Sound Parkway NW, Suite 610, Boca Raton, FL 33487 (561) 997-6433	<input type="checkbox"/>	<input checked="" type="checkbox"/>	\$ -	\$ -	\$ -	\$ 313,672.26	\$ -	
Energy Efficient Electrical, Inc. 1600 Mercer Ave., Ste. 6 West Palm Beach, FL 33401 (561) 655-7211	<input type="checkbox"/>	<input checked="" type="checkbox"/>	\$ -	\$ -	\$ -	\$ 22,692.00	\$ -	
Hilliers Electrical Engineering , Inc. 23257 State Road 7, Ste.100 Boca Raton, FL 33428	<input type="checkbox"/>	<input checked="" type="checkbox"/>	\$ -	\$ -	\$ -	\$ 17,593.10	\$ -	
	<input type="checkbox"/>	<input type="checkbox"/>	\$ -	\$ -	\$ -	\$ -	\$ -	
TOTAL			\$ -	\$ -	\$ -	\$ 353,957.36	\$ -	

BID PRICE: \$ 354,457.36

Total SBE-M/WBE Participation Dollar Amount and/or Percentage of Work: \$ 353,957.36

I hereby certify that the above information accurate to the best of my knowledge:

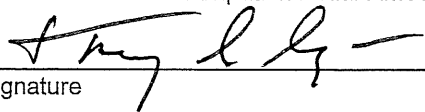
  
Signature

Executive Vice President  
Title

- NOTE:
1. The amount listed on this form for a SBE-M/WBE Prime or Subcontractor must be supported by price or percentage listed on the signed Schedule 2 or signed proposal in order to be counted toward goal attainment
  2. Firms may be certified by Palm Beach County as an SBE and/or an M/WBE. If firms are certified as both an SBE and M/WBE, please indicate the dollar amount and/or percentage under the appropriate category.
  3. M/WBE information is being collected for tracking purposes only.

# ATTACHMENT - F

## OSBA SCHEDULE 2 LETTER OF INTENT TO PERFORM AS AN SBE-M/WBE

ALL SBE-M must complete this document/WBE's and submitted with this bid packet. Specify in detail, the particular work items to be performed and the dollar amount and/or percentage for each work item. SBE credit will only be given for items which the SBE-M/WBE's is certified to perform. Failure to properly complete Schedule 2 will result in your SBE participation not being counted.

PROJECT NO.: WUD 16-057

PROJECT NAME: Water Treatment Plant No. 11  
Odor Control Improvements – Supplement 8

TO: Globaltech, Inc.  
(Name of Prime Bidder)

The undersigned is certified by Palm Beach County as a– (check one or more, as applicable):

Small Business Enterprise XX Minority Business Enterprise \_\_\_\_\_

Black \_\_\_\_\_ Hispanic \_\_\_\_\_ Women \_\_\_\_\_ Caucasian XX Other (Please Specify) \_\_\_\_\_

Date of Palm Beach County Certification: November 24, 2015

The undersigned is prepared to perform the following described work in connection with the above project

Line Item/Lot No.	Item Description	Qty / Units	Unit Price	Total Price
1	Bonds & Builders Risk	1	N/A	\$11,897.70
2	Engineering	1	N/A	\$32,796.90
3	Construction	1	N/A	\$268,977.66

at the following price: \$313,672.26 (Three Hundred Thirteen Thousand, Six Hundred Seventy-Two Dollars,  
and Twenty-Six Cents) (SBE Prime or Subcontractor's Quote)

and will enter into a formal agreement for work with you contingent upon your execution of a contract with Palm Beach County.

If undersigned intends to sub-subcontract any portion of this job to a certified SBE-M/WBE subcontractor, please list the name of that subcontractor and amount below:

Price or Percentage: \$0

None  
(Name of Subcontractor)

The Prime affirms that it will monitor the **SBE-M/WBE** listed to ensure the **SBE-M/WBE** perform the work with their own work force. The undersigned **SBE-M/WBE** Prime or **SBE-M/WBE** subcontractor affirms that it has the resources necessary to perform the work listed without subcontracting to a non-certified SBE or any other certified SBE subcontractors except as noted above.

The undersigned subcontractor understands that the provision of this form to prime bidder does not prevent subcontractor from providing quotations to other bidders

Globaltech, Inc.  
(Print Name of SBE-M/WBE Company)

By:   
(Signature)

Troy L. Lyn, P.E./Executive Vice President  
(Print name/title of person executing on  
behalf of SBE-M/WBE)

Revised 7/2/2013

Date: June 28, 2018

ATTACHMENT - F

OSBA SCHEDULE 2  
LETTER OF INTENT TO PERFORM AS AN SBE-M/WBE

ALL SBE-M must complete this document/WBE's and submitted with this bid packet. Specify in detail, the particular work items to be performed and the dollar amount and/or percentage for each work item. SBE credit will only be given for items which the SBE-M/WBE's is certified to perform. Failure to properly complete Schedule 2 will result in your SBE participation not being counted.

PROJECT NO.: WUD 16-057

PROJECT NAME: Water Treatment Plant No. 11 Odor Control Improvements -- Supplement 8

TO: Globaltech, Inc.  
(Name of Prime Bidder)

The undersigned is certified by Palm Beach County as a— (check one or more, as applicable):

Small Business Enterprise XX Minority Business Enterprise \_\_\_\_\_

Black \_\_\_\_\_ Hispanic \_\_\_\_\_ Women \_\_\_\_\_ Caucasian XX Other (Please Specify) \_\_\_\_\_

Date of Palm Beach County Certification: October 17, 2015

The undersigned is prepared to perform the following described work in connection with the above project

Line Item/Lot No.	Item Description	Qty / Units	Unit Price	Total Price
1	Electrical Subconsultant	1	N/A	\$11,864.58
2	Programming	1	N/A	\$5,728.52

at the following price: \$17,593.10 (Seventeen Thousand, Five Hundred Ninety-Three Dollars, and Ten Cents (SBE Prime or Subcontractor's Quote)

and will enter into a formal agreement for work with you contingent upon your execution of a contract with Palm Beach County.

If undersigned intends to sub-subcontract any portion of this job to a certified SBE-M/WBE subcontractor, please list the name of that subcontractor and amount below:

Price or Percentage: \$0

None  
(Name of Subcontractor)

The Prime affirms that it will monitor the **SBE-M/WBE** listed to ensure the **SBE-M/WBE** perform the work with their own work force. The undersigned **SBE-M/WBE** Prime or **SBE-M/WBE** subcontractor affirms that it has the resources necessary to perform the work listed without subcontracting to a non-certified SBE or any other certified SBE subcontractors except as noted above.

The undersigned subcontractor understands that the provision of this form to prime bidder does not prevent subcontractor from providing quotations to other bidders

Hillers Electrical Engineering, Inc.  
(Print Name of SBE-M/WBE Company)

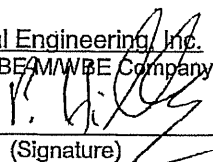
By:   
(Signature)

Paul Hillers / President  
(Print name/title of person executing on behalf of SBE-M/WBE)

Revised 7/2/2013

Date: June 28, 2018

ATTACHMENT - F

OSBA SCHEDULE 2  
LETTER OF INTENT TO PERFORM AS AN SBE-M/WBE

ALL SBE-M must complete this document/WBE's and submitted with this bid packet. Specify in detail, the particular work items to be performed and the dollar amount and/or percentage for each work item. SBE credit will only be given for items which the SBE-M/WBE's is certified to perform. Failure to properly complete Schedule 2 will result in your SBE participation not being counted.

PROJECT NO.: WUD 16-057

PROJECT NAME: Water Treatment Plant No. 11 Odor Control Improvements – Supplement 8

TO: Globaltech, Inc.  
(Name of Prime Bidder)

The undersigned is certified by Palm Beach County as a– (check one or more, as applicable):

Small Business Enterprise XX Minority Business Enterprise \_\_\_\_\_

Black \_\_\_\_\_ Hispanic \_\_\_\_\_ Women \_\_\_\_\_ Caucasian XX Other (Please Specify) \_\_\_\_\_

Date of Palm Beach County Certification: September 04, 2015

The undersigned is prepared to perform the following described work in connection with the above project

Line Item/Lot No.	Item Description	Qty / Units	Unit Price	Total Price
1	Electrical Subcontractor	1	N/A	\$22,692.00

at the following price: \$22,692.00 (Twenty-Two Thousand, Six Hundred Ninety- Two Dollars, and Zero Cents)  
(SBE Prime or Subcontractor's Quote)

and will enter into a formal agreement for work with you contingent upon your execution of a contract with Palm Beach County.

If undersigned intends to sub-subcontract any portion of this job to a certified SBE-M/WBE subcontractor, please list the name of that subcontractor and amount below:

Price or Percentage: \$0

None  
(Name of Subcontractor)

The Prime affirms that it will monitor the SBE-M/WBE listed to ensure the SBE-M/WBE perform the work with their own work force. The undersigned SBE-M/WBE Prime or SBE-M/WBE subcontractor affirms that it has the resources necessary to perform the work listed without subcontracting to a non-certified SBE or any other certified SBE subcontractors except as noted above.

The undersigned subcontractor understands that the provision of this form to prime bidder does not prevent subcontractor from providing quotations to other bidders

Energy Efficient Electrical, Inc.  
(Print Name of SBE-M/WBE Company)

By: [Signature]  
(Signature)

Rene Viau / Vice President  
(Print name/title of person executing on  
behalf of SBE-M/WBE)

Revised 7/2/2013

Date: June 28, 2018

## **ATTACHMENT – G**

### **Summary of SBE/Minority Business Tracking**

## ATTACHMENT - G

Palm Beach County Water Utilities Department  
OPTIMIZATION AND IMPROVEMENTS DESIGN-BUILD CONTRACT  
Resolution #2015-0315 Contract Dated March 10, 2015

### SUMMARY OF SBE-M/WBE MINORITY BUSINESS TRACKING

	Total
<b>Master Contract Goal</b> <u>75%</u>	<b>SBE</b>
<b>Current Proposal</b>	
Value of Authorization No. 06.08	\$354,457.36
Value of SBE - M/WBE Letters of Intent	\$353,957.36
Actual Percentage	99.85%
<b>Signed/Approved Authorizations</b>	
Total Value of Authorizations	\$14,946,561.85
Total Value of SBE - M/WBE Signed Subcontracts	\$14,279,356.59
Actual Percentage	95.53%
<b>Signed/Approved Authorizations Plus Current Proposal</b>	
Total Value of Authorization	\$15,301,019.21
Total Value of Subcontracts & Letter of Intent	\$14,633,313.95
Actual Percentage	95.63%
	REVISED 4/12/2018

# ATTACHMENT – H

## Location Map



ATTACHMENT H  
Location Map

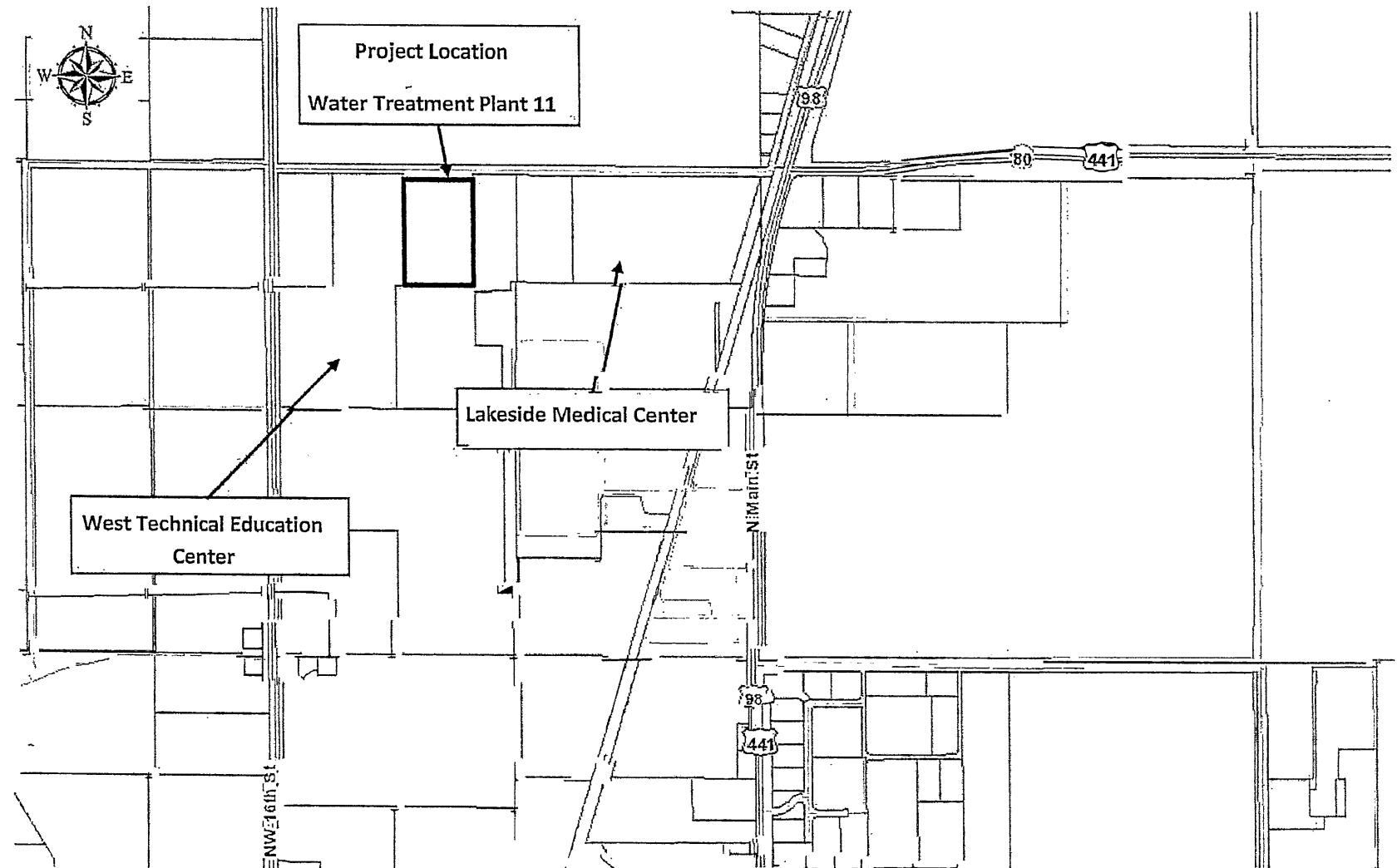

WUD 16-057: Water Treatment Plant No. 11 – Odor Control Improvements (WA-06)

# **ATTACHMENT - I**

## **Design – Build Criteria Report**

The following are amendments to the Design-Build Criteria Water Treatment Plant No.11 Odor Control Improvements Project Number WUD 16-057 dated June 24, 2016.

Section 1.2.1 add following to the end of first sentence: "and shall furnish and install a lift station and pipeline that will continuously pump the low pH waste from the biological scrubbers to the deep injection well."

Add new Section to Section 1.3.1 Biological Odor Control System:

"1.3.1.35 The Design-Build Entity shall furnish and install, commission, start-up and place into service a lift station that continuously pumps the low pH waste from the biological scrubbers to the deep injection well at Water Treatment Plant No.11. The lift station shall be a duplex lift station with a 100% duty standby arrangement. Materials used in the construction of the lift station shall be suitable for the application. In addition, the lift station will be controlled to maintain a set level within the lift station wetwell and have installed redundant ultrasonic level sensor (total number of level sensors is two (2)). The control system shall balance pump run time over a twenty-four (24) hour period. The following signals, at a minimum, will be integrated with WTP11's existing plant wide control system and displayed on HMI screens: pump status (run, fail, hand, off, auto), wetwell level, high level alarm, high-high level alarm, low level alarm, pump starts per day, and other process monitoring recommended by the WUD operations. The lift station lid shall also accommodate access into the wetwell for maintenance activities. The lift station shall also have an overflow and bypass piping which will be connected to the existing plant process lift station enabling the lift station to be completely bypassed and taken out of service for extended periods of time."

ATTACHMENT - J

Vendor Quotes

Energy Efficient Electric, Inc.  
1600 Mercer Ave. Unit 6  
West Palm Beach, FL. 33401  
Phone (561) 655-7211 Fax (561) 655-9661  
Mobile (561) 722-1381  
E-Mail Address: rene@energyeff.com  
**State License #EC 0001096**

May 21, 2018

## **Electrical Scope of Work**

PBC WTP 11 Chemical LS

Quote # 31371

We are pleased to provide your firm with our scope and proposal for the necessary electrical work on the above referenced project. Our scope and proposal is based on a scope of work from Their Win and Troy Lyn.

### **Included:**

1. Demo existing RPCP panel including conduits on slab.
2. Furnish and install a new 30 amp disconnect and intercept existing feeds for the RPCP panel.
3. Furnish and install new panel supports.
4. Assist with the installation of the new LS control panel, terminal junction box, transformer and alarm light furnished by GT.
5. Furnish and install conduit from disconnect to new control panel for power and conduit from existing Odor Control panel LCP-2010 to new LS control panel for fiber optic furnished by GT.
6. Furnish conduit and wire from the control panel to the wet well per PBC standards.

### **Excluded:**

1. Permit fees.
2. Concrete and asphalt cutting and patching.
3. Conduit and wire for antenna and solar panel.
4. Concrete ductbanks and cap.
5. Patch panels, patch cords, media converter, etc.

**Lump Sum**                **\$21,300**

We appreciate the opportunity to quote your organization on this project. If you have any questions, please call me at the office.

Thank You Very Kindly,

*Rene Viau*

Vice President

Residential ----- Lighting Systems ----- Commercial ----- Industrial

S:\CLIENT\PALM BEACH COUNTY\015 PBC MASTER CONTRACT & PROJECTS\0162005 PBC WTP 11 ODOR CONTROL (WA-08)\LIFT STATION MODIFICATIONS\ELECTRICAL INSTALL QUOTE\EE SCOPE.DOC

Energy Efficient Electric, Inc.  
1600 Mercer Ave. Unit 6  
West Palm Beach, FL. 33401  
Phone (561) 655-7211 Fax (561) 655-9661  
Mobile (561) 722-1381  
E-Mail Address: rene@energyeff.com  
**State License #EC 0001096**

February 16, 2018

## **Electrical Scope of Work**

PBC WTP 11 Lift Station

Quote # 31333

We are pleased to provide your firm with our scope and proposal for the necessary electrical work on the above referenced project. Our scope and proposal is based on a scope of work from Bruce Rahmani.

### **Included:**

1. One trip to disconnect existing pumps from terminal junction box.
2. One trip to connect new pumps to existing terminal junction box.
3. Furnish and install Chico or duct seal in seal offs.

### **Excluded:**

1. Existing control panel mods.
2. Permit fees.

**Lump Sum**                **\$1,392**

We appreciate the opportunity to quote your organization on this project. If you have any questions, please call me at the office.

Thank You Very Kindly,

*Rene Viau*

Vice President

Residential ----- Lighting Systems ----- Commercial ----- Industrial

S:\CLIENT\PALM BEACH COUNTY\2015 PBC MASTER CONTRACT & PROJECTS\162005 PBC WTP 11 ODOR CONTROL (WA-06)\LIFT STATION MODIFICATIONS\ELECTRICAL INSTALL QUOTE\EEEE SCOPE.DOC



C. C. CONTROL CORP.

5760 CORPORATE WAY SUITE 100  
WEST PALM BEACH, FLORIDA 33407

PHONE: 561 293-3975  
FAX: 561 293-3976

CUSTOMER: GLOBALTECH

ATTN: NICO  
PHONE:

PROJECT: PBCWUD WTP 11 R.O. CONCENTRATE PUMP STATION CONTROL PANEL  
PALM BEACH COUNTY

DATE: 5/21/2018 REVISED

DESCRIPTION	QUAN	TOTAL PAGES 4
C. C. CONTROL CORP. PROPOSES TO FURNISH THE FOLLOWING COMPLETE WITH EXCEPTIONS AS LISTED:		
EXCEPTIONS:		
A) QUOTE DOES NOT INCLUDE INSTALLATION.		
B) QUOTE DOES NOT INCLUDE CONDUIT SYSTEM OR SEAL OFF'S.		
C) QUOTE DOES NOT INCLUDE ANY PANEL MOUNTING RACKS.		
D) QUOTE DOES NOT INCLUDE ANY LEVEL FOLATS.		
E) QUOTE DOES NOT INCLUDE ANY LINE REACTORS OR OUTPUT FILTERS.		
F) QUOTE DOES NOT INCLUDE ANY SOLAR PANELS, CONVERTERS OR BATTERIES.		
G) QUOTE DOES NOT INCLUDE ANY MOTOR CONNECTION BOXES.		
H) QUOTE DOES NOT INCLUDE EXISTING RIO-9 OR SCADA PROGRAMMING.		
ITEM NO.1		
<b>CONCENTRATE PUMP STATION CONTROL PANEL - 10 HP 480V 3PH</b>		
SCHAEFER'S SPN123RSS-603616 NEMA 12/3R 304 S.S. ENCLOSURE WITH THE FOLLOWING:	1	
A) SIZE: 60"H X 36"W X 16"D		
B) ALUMINUM DEADFRONT		
C) 3 PT. SS PADLOCK HANDLE		
D) 304 S.S. DRIPSHIELD		
E) DOOR STOP KITS		
F) SPPAL-6036 ALUMINUM SUBPANEL	1	
G) CUTOUTS FOR 6" FAN AND EXHAUST KITS		
H) 304 S.S. HINGED RAIN HOODS		
I) FINISH: WHITE POWDER COAT		
HOFFMAN TFP61SS EXHAUST FAN	1	
HOFFMAN TEP6SS EXHAUST GRILL	1	
HOFFMAN ATEMNO TEMPERATURE SWITCH	1	
SQD HGL36100 600V 3 POLE 100A CIRCUIT BREAKERS(65KAIC)	1	
ATLANTIC SCIENTIFIC ZONE SENTINEL ZS12104 277/480V, 3PH., 4W TVSS	1	
SQD 8430 MPSV29 480V PHASE MONITOR	1	
SQD 8501 NR82 11PIN SOCKET	1	
MARATHON 1453586 3 POLE POWER DISTRIBUTION BLOCK	1	
MARATHON 1331305 SINGLE POLE POWER DISTRIBUTION BLOCK	1	
SQD HGL36030 600V 3 POLE 30A BREAKER(TVSS)	1	
SQD HGL26030 600V 2 POLE 30A BREAKER(TRANSFORMER)	1	
SQD T3000D1 3KVA 240/480-120 1PH CONTROL TRANSFORMER	1	
SQD HJL36050M72 600V MOTOR CIRCUIT PROTECTOR	2	
SQD ATV630U75N4 10 HP 480VAC VARIABLE FREQUENCY DRIVE	2	
SQD VW3A1112 REMOTE KEYPAD MOUNTING KIT	2	





WIRE, DUCT & NAMEPLATES	LOT
UL 508A LABEL	LOT
ITEM NO.2	
<u>REMOTE MATERIAL</u>	
OPTICAL CABLE CORP. DX006DWLS9KR 6 FIBER 62.5 FIBER OPTIC CABLE	1000
CHEETAH F1-STUPC-SOC-X MULTIMODE FUSION ST CONNECTORS	12
<b>NOTES: FIBER OPTIC CABLE INSTALLED BY OTHERS.</b>	
ITEM NO.3	
<u>ULTRASONIC LEVEL TRANSMITTERS</u>	
E+H PROSONIC S FMU90-N11CA111AA1A ULTRASONIC LEVEL TRANSMITTER WITH THE FOLLOWING:	2
A) POWER: 24VDC	
B) OUTPUT: 4-20MA	
C) HOUSING: IP66	
E+H FDU91-UN2AA ULTRASONIC LEVEL SENSOR WITH THE FOLLOWING:	2
A) RANGE: 1 TO 32.8 FT.	
B) CABLE: 10M	
C) HOUSING: IP68	
A & J 316 S.S. TRANSDUCER WALL MOUNT BRACKET	2
2" X 60" ALUMINUM PIPE STANCHION W/10' X 10" X 1/2" BASE	2
OVERSIZED ALUMINUM SUNSHIELD	2
SCHAEFER'S SPJHSS-1084 ENCLOSURE W/SPPJ-108 SUBPANEL	2
EDCO SLAC02036 SURGE ARRESTER - OC	2
S.S. UNISTRUT, S.S. HARDWARE, WIRE, SEALTITE & CONNECTORS	2
SUNCOVER FLAP ASSEMBLY:	
McMASTER-CARR 1605A76 HINGE, 316 S.S. 1 FOOT SECTION	2
McMASTER-CARR 8610K85 EPDM WEATHER RESISTANT RUBBER	2
McMASTER-CARR 90257A007 NUT, HEX, 316 S.S., 6-32	16
McMASTER-CARR 91500A148 SCREW, FLAT HEAD, PHILLIPS, 316 S.S., 6-32 x 1/2"	16
McMASTER-CARR 96659A102 WASHER, FLAT, 18-8 S.S., 3/8"	16
ITEM NO.4	
<u>EXISTING RIO-9 MODIFICATIONS</u>	
MOLEX WFR-00011-02 6 PORT ST LOADED WALL MOUNT FIBER PATCH PANEL	1
ALLEN BRADLEY 1756-EN2T CLX ETHERNET/IP 10/100 BRIDGE	1
ALLEN BRADLEY 1783-ETAP 3 PORT ETETHRNET/IP TAP CONNECTION	1
BLACK BOX EVNSL641-0006 6' ETHERNET PATCH CABLES	1
FIS D288M3FISC ST MULTIMODE FIBER PATCH CABLE	1
ITEM NO.5	
<u>SERVICE SUMMARY</u>	
ENGINEERING	LOT
SUBMITTALS	LOT
FIBEROPTIC CABLE, TERMINATION AND TESTING	LOT
EXISTING RIO-9 PANEL MODIFICATION	LOT
EXISTING RIO-9 DRAWING MODIFICATION	LOT
START UP	LOT
1 YEAR STANDARD WARRANTY	LOT
ITEM NO.6	
<u>PUMP STATION PLC PROGRAMMING</u>	
PROGRAMMING STATION PLC	LOT
ITEM NO.7	
<u>SPARE VFD</u>	
SQD ATV630U75N4 10 HP 480VAC VARIABLE FREQUENCY DRIVE	1

SUMMARY			SELL
ITEMS NO.1 THRU NO.:	PUMP CONTROL PANEL & INSTRUMENTS		38700.00
ITEM NO.6	PUMP CONTROL PANEL PLC PROGRAMMING		2400.00
ITEM NO.7	SPARE VFD		1600.00
			-----
TOTAL			42700.00

TOTAL: \$42,700.00 PLUS TAX IF APPLICABLE

SUBMITTALS 5-7 WEEKS  
AFTER RECEIPT OF PURCHASE ORDER  
FOB: JOB SITE  
DEL: 10-12 WEEKS  
AFTER APPROVED DRAWINGS  
TERMS: NET 30 DAYS  
(SUBJECT TO CREDIT APPROVAL)

WARRANTY: ALL WARRANTIES SHALL EXPIRE ONE (1) YEAR FROM DATE OF START-UP  
FROM SELLER TO BUYER UNLESS SPECIALLY INDICATED OTHERWISE AND  
WILL BE NULL AND VOID UNLESS MATERIALS ARE STORED UNDER PROPER  
CONDITIONS DETERMINED BY C.C. CONTROL CORP.

JOHN C. STOCK

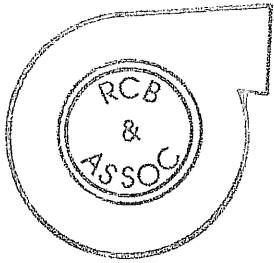

# RC BEACH & ASSOC. INC.

539 SAN CHRISTOPHER DRIVE

DUNEDIN, FLORIDA 34698 USA

PHONE (727) 736-3696

FAX (727) 733-2647

WWW.RCBEACH.COM

May 17, 2018

Mr. Troy Lyn  
Globaltech, Inc.  
6001 Broken Sound Parkway, NW  
Suite 610  
Boca Raton, FL 33487

Subject: Vanton SG-PY1200 Simplex Pump Station  
RE: Formal Proposal Blow Down Sump REV No. 1

Dear Mr. Lyn,

We are pleased to offer the following Vanton, pump and equipment proposal for your consideration:

Two (2) each Vanton Vertical Sump Pump model SG-PY1200 single stage vertical sump pump manufactured of polypropylene and encapsulated stainless steel shaft and polypropylene constructed wetted parts to pump 80 GPM to a discharge head of 64 FT when operating at 1750 RPM and driven by a 7.5 HP 1800 RPM 3 phase 60 hertz 460 volt motor with corro duty TEFC type enclosure.

Equipment as above described complete with strainer, 24" X 30" X 1.25" polypropylene cover plate, 2 inch 150LB ff flanged discharge, 120 volt solenoid valve for water flush, coupling guard and strainer basket. Pump over all depth X = 106 inch Length.

**Price net FOB factory Hillside, NJ freight allowed to the job-site is \$14,785.00 each or \$29,516.00 for lot of two (2) pumps and motors.**

~~One (1) each Duplex control panel, NEMA 4X 316 Stainless steel with sun shields and dead front construction with motor starter, motor breaker, relay, contact, hour run meter, HOA switch, run light, alarm light, horn, manual start stop, lockable, transformer, time delay relay, 120 volt duplex Ground fault receptacle and level floats.~~

~~**Price net FOB factory Tampa, Florida freight allowed to the job-site is \$27,439.00 Total**~~

~~One (1) each FRP wet well with FRP non traffic bearing support cover~~

PROCESS SYSTEMS WITH APPLICATION ENGINEERING

~~8FT diameter with inspection hatch and float pad. Wet well is 9 FT depth with one (1) 3 inch and one (1) 4 inch inlets. Unit complete with calculations and float collar.~~

~~Price net FOB factory freight allowed to the job-site is \$34,750.00 each.~~

~~**Option for wet well cover:**~~

~~One (1) each Vanton supplied three piece polypropylene cover complete with float pad, inspection port and mounting plate designed for 8FT diameter flanged lip support, non traffic bearing, circular cut, gusseted, add: \$3470.00 to above price.~~

~~One (1) Start Up services Including site inspection of delivery, installation inspection, start up and training services is Three days Two (2) trips not to exceed is: \$3000.00~~

~~No piping, wiring, installation or spare parts included.~~

No State sales or use tax included should it apply. No liquidated damages or indemnification included in this proposal as special pricing required by manufacturer. Estimated submittals 4 weeks after order entry. Delivery item 6 to 8 weeks. Delivery subject to change based on production schedules at time of release to manufacture. Panel could extend based on order to 10 weeks. This offering is valid for 45 days from above date of quotation. Standard terms and conditions are 15% net on submittal approval, 80% net 30 days on shipment and 5% net on startup and in accordance with each manufacturer domestic terms and conditions used in this proposal. Manufacturer standard warranties apply to this proposal.

Standard insurance certificates and Workman's Comp insurances apply.

After you have an opportunity to review all of this should you have any questions Please call. Once again thank you for the chance to quote Vanton Pumps to you and your organization.

Very truly yours,

R. C. Beach & Assoc., Inc.  
Representing  
Vanton Pump & Equipment

cc  
File  
Rick Reiber-RCB

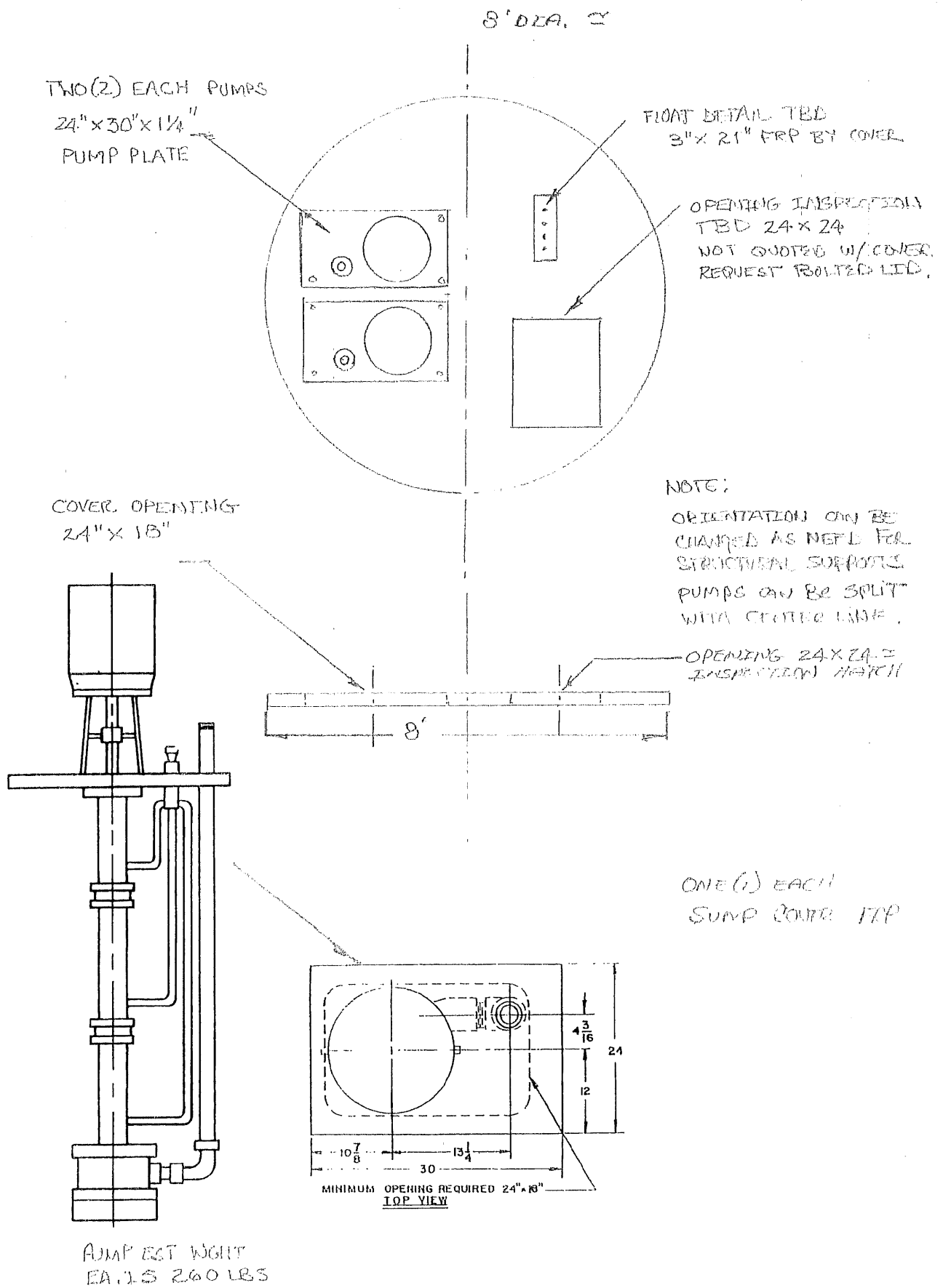

~ Sample Layout ~

## **ATTACHMENT - K**

### **Letter of Lift Station Components**

June 28, 2018

Craig Irwin  
Project Manager  
PBCWUD  
8100 Forest Hill Blvd  
West Palm Beach, FL 33416

RE: WTP 11 Odor Control Improvements (WUD Project No. 16-057) – Lift Station Components

Dear Mr. Irwin,

We have looked at various options for the components for the proposed biological odor control waste lift station. We have chosen options that provide the best corrosion protection and structural integrity in our opinion while considering cost. The various components are listed below with the associated cost. Item chosen for inclusion in our proposal are identified with an asterisk. The cost presented are for the equipment only and do not include delivery, tax, and markup.

Equipment	Description	Estimate
Pumps		
*Vanton Pumps - Vertical Column Sump Pump	Two SG-PY 1200, 7.5 HP, Strainer and solenoid valve for flush water. PE and encapsulated SS shaft	\$ 32,516.00
Fybroc Pump- Vertical Column Sump Pump	Two Model 5500 FRP, 7.5 HP, Strainer, 316 SS shaft	\$ 29,764.65
Fybroc Pump - Self Priming	Two Model 1600 FRP, 7.5 HP	\$ 33,684.80
Wetwell		
*Concrete Composite Wetwell with FRP Rebar	8' dia x 9' H Concrete Composite with top	\$ 31,304.00
Composite Wetwell with Steel Rebar with 30 x 40 hatches	8' dia x 9' H Concrete Composite with top with 30 x 30 hatch	\$ 21,861.00
FRP Wetwell with Special Resin	8' dia x 9' H FRP Wetwell and Cover - non traffic rated. Special Resin	\$ 33,650.00
FRP Wetwell with Standard Resin	8' dia x 9' H standard, high quality, polyester resin fiberglass tank with powder coated Aluminum Cover	\$ 21,000.00

Should you have any questions regarding this issue please do not hesitate to give me a call.

Sincerely,

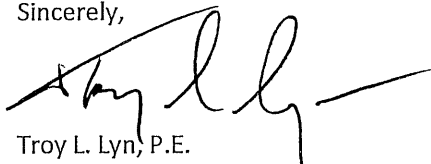

Troy L. Lyn, P.E.  
Project Manager

ATTACHMENT 2  
Location Map

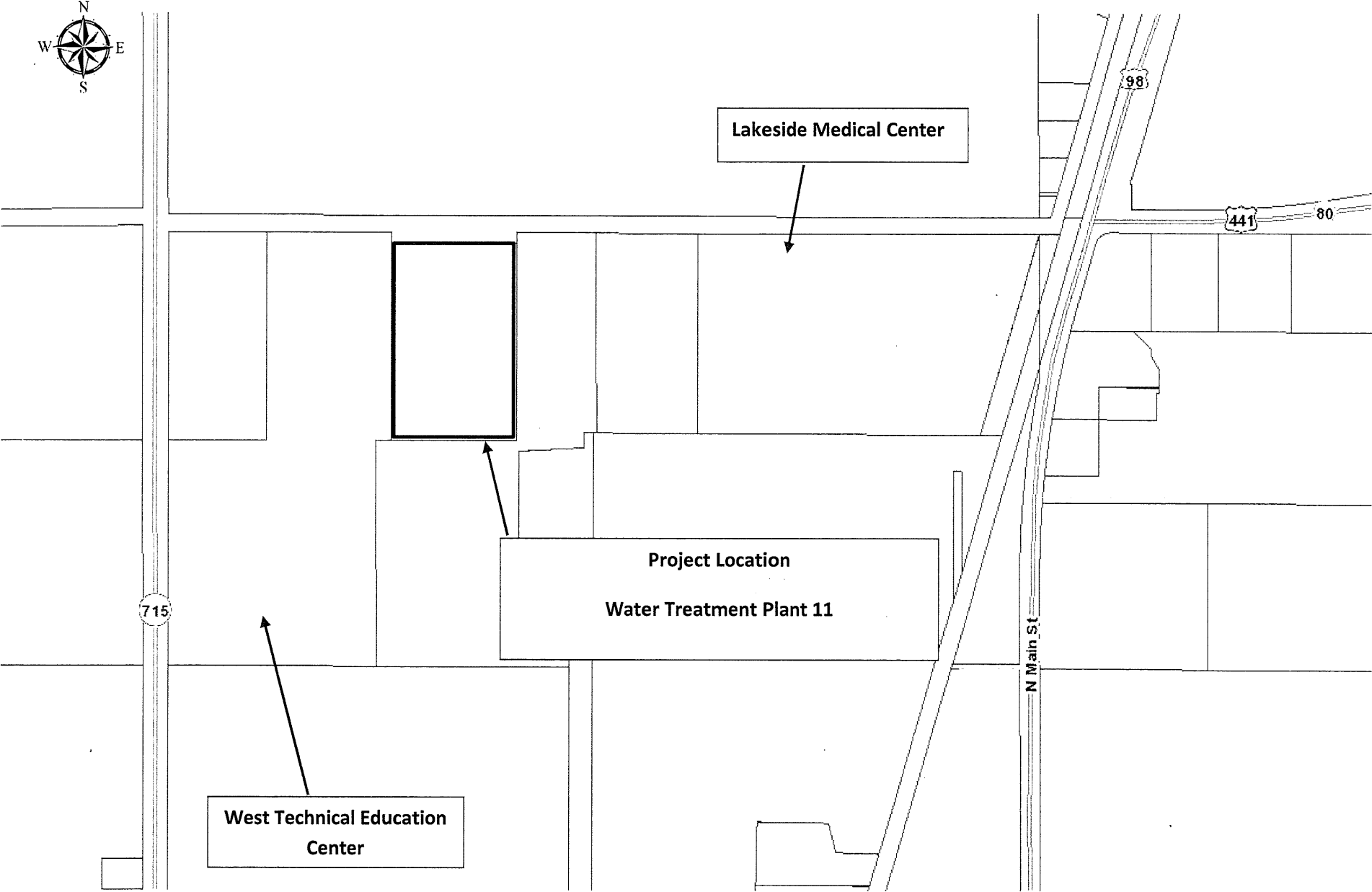



Summary of Certificates

This report displays detailed Certificate of Insurance information for a selected Insured. Any items shown in red are deficient.

Monday, July 02, 2018

Simple View

Certificate Images

Documents

Insured: Globaltech, Inc.

Insured ID: 16-057-PBC

Status: Compliant

ITS Account Number: PLC2167

Project(s): Palm Beach County - Water Utilities

Insurance Policy	Required	Provided	Override
<u>General Liability</u>			
Expiration: 11/1/2018			
General Aggregate:	\$1,000,000	\$2,000,000	
Products - Completed Operations Aggregate:	\$0	\$2,000,000	
Personal And Advertising Injury:	\$0	\$1,000,000	
Each Occurrence:	\$1,000,000	\$1,000,000	
Fire Damage:	\$0	\$100,000	
Medical Expense:	\$0	\$5,000	
<u>Automobile Liability</u>			
Expiration: 11/1/2018			
	All Owned Autos	Any Auto not provided	X
	Hired Autos	not provided	X
	Non-Owned Autos	not provided	X
Combined Single Limit:	\$1,000,000	\$1,000,000	
<u>Workers Compensation/Employers Liability</u>			
Expiration: 11/1/2018			
Each Accident:	\$100,000	\$1,000,000	
Disease - Policy Limit:	\$500,000	\$1,000,000	
Disease - Each Employee:	\$100,000	\$1,000,000	
<u>Professional Liability</u>			
Expiration: 11/1/2018			
Each Occurrence:	\$3,000,000	\$3,000,000	
Aggregate Limit:	\$3,000,000	\$3,000,000	
<u>Builder's Risk</u>			
Expiration: 2/1/2019			
	All Risk, Replacement Cost, Completed Value Form	All Risk, Replacement Cost, Completed Value Form	
	Loss Payee Endorsement	Loss Payee Endorsement	

Notifications (Show All)

**There were no deficiency letters issued.**

Do you have an updated Certificate? Click the button below to submit a Certificate.

Certificate Submittal