

Agenda Item is over 50 pages; may be viewed in the Minutes Department

Agenda Item #: 3-C-1

PALM BEACH COUNTY
BOARD OF COUNTY COMMISSIONERS
AGENDA ITEM SUMMARY

Meeting Date: September 18, 2018 Consent Regular
 Workshop Public Hearing

Department: Engineering & Public Works
Submitted By: Engineering & Public Works
Submitted For: Roadway Production Division

EXECUTIVE BRIEF

Motion and Title: Staff recommends motion to approve: a contract with R & D Paving, LLC (R&D) in the amount of \$499,575.40 for the construction of Glades Road and Butts Road Intersection Improvements (Project).

SUMMARY: Approval of this contract will allow Palm Beach County to issue a notice to proceed to R&D to begin construction of the Project. The project will provide a second southbound right turn lane on Butts Road and includes installation of new sidewalks, concrete barrier wall and two mast arm traffic signals. R&D is a Palm Beach County based company. The Small Business Enterprise (SBE) goal for all projects is 15%. The lowest responsive, responsible bidder, R&D, committed to 21% SBE participation. District 4 (LBH)

Background and Justification: Bids for the project were received by the Engineering Department on May 22, 2018. Time to complete all work under this contract shall be 180 calendar days.

Attachments:

- 1. Location Map
- 2. Contract (3)
- 3. SBE Compliance Review
- 4. Bid Tabulation
- 5. Insurance Certificate

[Handwritten Signature] Recommended by: *[Handwritten Signature]* Department Director 23 AUG 2018 Date

Approved By: *[Handwritten Signature]* Assistant County Administrator 9/4/18 Date

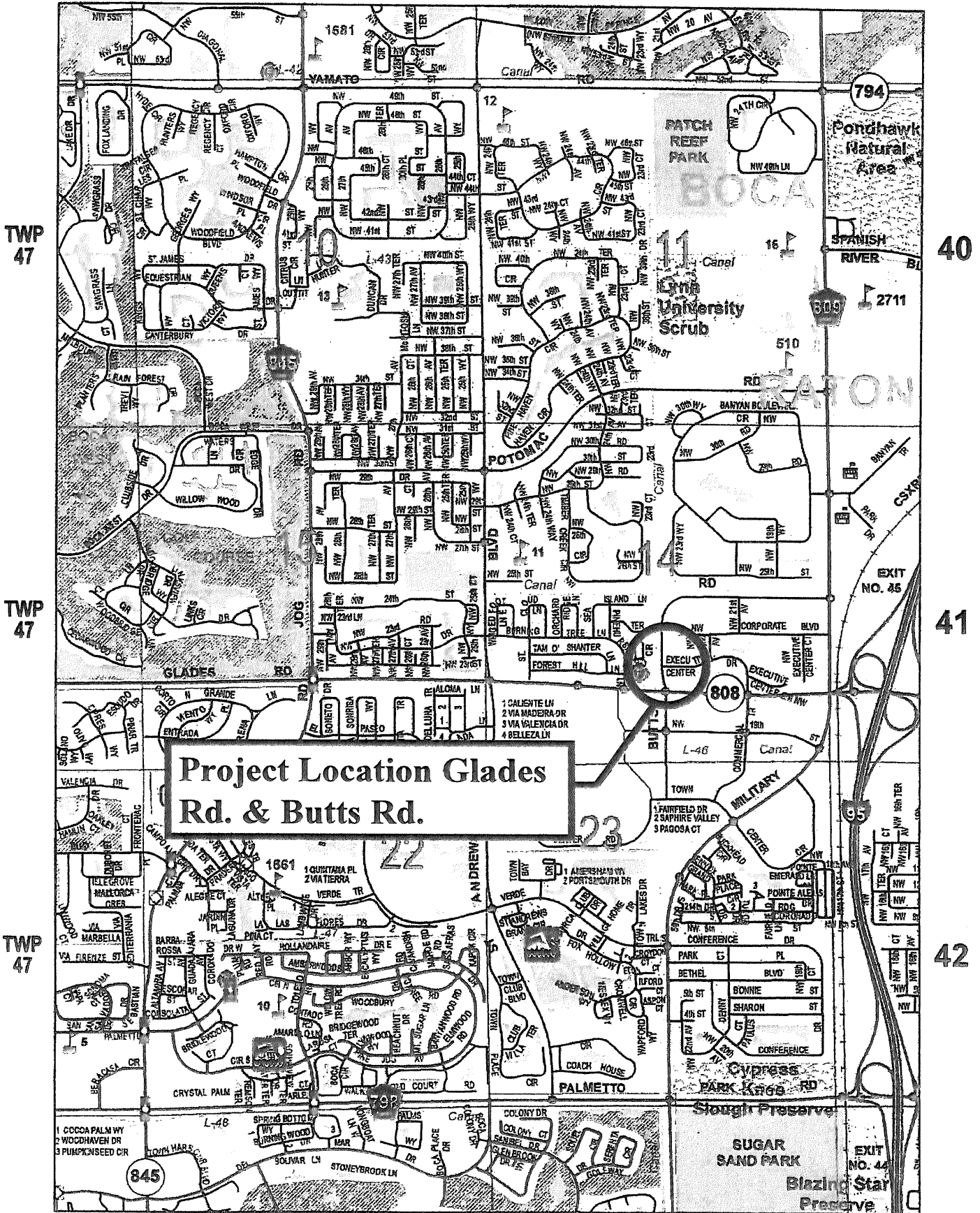

TWP 47

TWP 47

TWP 47

40

41

42



JUN 05 2018

ATTACHMENT 3
Page 1 of 2

DATE: May 31, 2018

TO: Holly B. Knight, P.E., Contracts Section Manager

THROUGH: Allen Gray, Manager
Office of Small Business Assistance *A. Gray*

FROM: Angela D. Smith, Small Business Development Specialist
Office of Small Business Assistance *AdS*

SUBJECT: **Compliance Review on Project No. 2012503**
Glades Road and Butts Road Intersection Improvements

Office of
Small Business Assistance
50 South Military Trail, Suite 202
West Palm Beach, FL 33415
(561) 616-6840
Fax: (561) 616-6850
www.pbcgov.com/osba

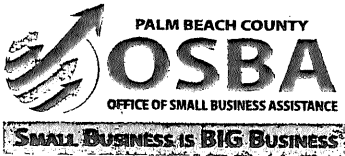

**Palm Beach County
Board of County
Commissioners**

Melissa McKinlay, Mayor
Mack Bernard, Vice Mayor

Hal R. Valeche
Paulette Burdick
Dave Kerner
Steven L. Abrams
Mary Lou Berger

County Administrator
Verdenia C. Baker

"An Equal Opportunity
Affirmative Action Employer"

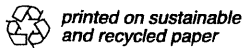

The following is a Compliance Review of SBE participation on the above-mentioned project. The Bid Opening date was May 22, 2018. SBE participation is calculated on the Amount Less Contingency.

Bidder #1: R&D Paving, LLC
400 Executive Center Drive
Suite 210
West Palm Beach, FL 33401

Phone: 561-588-6681
Bid Amount: \$499,575.40
Amount Less Contingency: \$481,350.40
Goal: 15% Overall
Goal Achieved: 21%

SBE Participation:

(WB) R&D PAVING, LLC	\$103,234.00	21%
----------------------	---------------------	------------

Bidder #2: Florida Blacktop, Inc.
1287 West Atlantic Blvd.
Pompano Beach, FL 33069

Phone: 954-943-9700
Bid Amount: \$513,187.59
Amount Less Contingency: \$475,915.18
Goal: 15%
Goal Achieved: 16%

SBE Participation:

(SB) ANZCO, INC.	\$77,085.00	16%
------------------	--------------------	------------

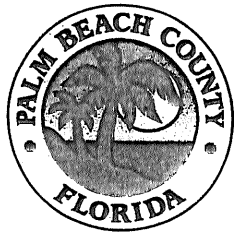

Bidder #3: Rosso Site Development, Inc.
1302 S. J Street
Lake Worth, FL 33460
Phone: 561-689-0889
Bid Amount: \$550,116.47
Amount Less Contingency: \$532,896.47
Goal: 15%
Goal Achieved: 42%

SBE Participation:

(SB)ROSSO SITE DEVELOPMENT, INC. \$225,365.43 42%

Bidder #4: Weekley Asphalt Paving, Inc.
Phone: 561-688-5004
Bid Amount: \$665,046.30
Amount Less Contingency: \$646,996.30
Goal: 15%
Goal Achieved: --%

SBE Participation:

(MB)AUM CONSTRUCTION, INC.¹ \$235,000.00 --%

EVALUATION:

The lowest bidder, R&D Paving, LLC has met the SBE goal.

¹ AUM Construction, Inc. is no longer a certified S/MBE with Palm Beach County Office of Small Business Assistance as of 2/23/2018.

GLADES ROAD AT BUTTS ROAD				Average for All Bidders	Engineer's Estimate	R & D PAVING, LLC		FLORIDA BLACKTOP, INC.	
Palm Beach County Project #2012503									
Item #	Description	Qty	Unit	Unit Price	Unit Price	Unit Price	Total	Unit Price	Total
Roadway Items									
1	MOBILIZATION	1	LS	\$ 64,628.26	10%	\$ 60,000.00	\$ 60,000.00	\$ 24,968.06	\$ 24,968.06
2	MAINTENANCE OF TRAFFIC (INCL. PEDESTRIAN M.O.T.)	1	LS	\$ 41,834.72	15%	\$ 9,000.00	\$ 9,000.00	\$ 15,529.39	\$ 15,529.39
3	CLEARING AND GRUBBING	1	LS	\$ 30,068.25	\$ 4,692.83	\$ 25,000.00	\$ 25,000.00	\$ 6,044.00	\$ 6,044.00
4	FLOATING TURBIDITY BARRIER	58	LF	\$ 14.02	\$ 12.89	\$ 5.00	\$ 290.00	\$ 9.55	\$ 553.90
5	REGULAR EXCAVATION	169	CY	\$ 22.49	\$ 12.24	\$ 18.05	\$ 3,050.45	\$ 17.09	\$ 2,888.21
6	OPTIONAL BASE GROUP 13 (TYPE B-12.5 ONLY)	306	SY	\$ 56.66	\$ 22.30	\$ 39.00	\$ 11,934.00	\$ 65.83	\$ 20,143.98
7	MILLING EXIST ASPH PAVT, 1" AVG DEPTH	1,701	SY	\$ 5.12	\$ 1.69	\$ 4.75	\$ 8,079.75	\$ 5.79	\$ 9,848.79
8	SUPERPAVE ASPHALT CONCRETE (2-1/2") (TRAFFC LEVEL C)	42	TN	\$ 195.17	\$ 100.99	\$ 150.00	\$ 6,300.00	\$ 195.67	\$ 8,218.14
9	ASPH CONCRETE FRICTION COURSE (FC-9.5) (1") (PG 76-22, ARB)	110	TN	\$ 195.92	\$ 115.82	\$ 200.00	\$ 22,000.00	\$ 188.39	\$ 20,722.90
10	INLET (CURB) (TYPE P-5) (>10')	1	EA	\$ 12,201.78	\$ 6,447.82	\$ 12,320.00	\$ 12,320.00	\$ 13,337.11	\$ 13,337.11
11	CONTROL STRUCTURE (W/ INLET (CURB) (TYPE 5) & TYPE 7 MH TOP)	1	EA	\$ 18,487.21	\$ 9,308.00	\$ 18,700.00	\$ 18,700.00	\$ 20,243.82	\$ 20,243.82
12	CONCRETE PIPE CULVERT (24")	52	LF	\$ 164.47	\$ 81.50	\$ 180.40	\$ 9,380.80	\$ 195.29	\$ 10,155.08
13	CORRUGATED ALUMINUM PIPE CULVERT (15"X21" ELLIPTICAL)	56	LF	\$ 152.35	\$ 105.84	\$ 156.20	\$ 8,747.20	\$ 169.10	\$ 9,469.60
14	FRENCH DRAIN (24" DIA) (INCL. BALLAST ROCK AND FILTER FABRIC)	82	LF	\$ 252.11	\$ 95.43	\$ 259.60	\$ 21,287.20	\$ 281.03	\$ 23,044.46
15	CONCRETE BARRIER WALL	65	LF	\$ 307.36	\$ 60.50	\$ 435.50	\$ 28,307.50	\$ 261.98	\$ 17,028.70
16	CONCRETE CURB & GUTTER (TYPE F)	415	LF	\$ 30.56	\$ 16.87	\$ 27.75	\$ 11,516.25	\$ 35.72	\$ 14,823.80
17	CONCRETE SIDEWALK (4" THICK)	270	SY	\$ 54.36	\$ 38.41	\$ 51.25	\$ 13,837.50	\$ 72.10	\$ 19,467.00
18	GUARDRAIL - REMOVAL	88	LF	\$ 14.30	\$ 1.46	\$ 10.80	\$ 950.40	\$ 8.79	\$ 773.52
19	SODDING	336	SY	\$ 7.91	\$ 2.79	\$ 5.25	\$ 1,764.00	\$ 3.93	\$ 1,320.48
20	2-2" PVC CONDUITS (SCH 40) TRAFFIC F/O CABLE	343	LF	\$ 8.77	\$ 10.00	\$ 7.25	\$ 2,486.75	\$ 10.88	\$ 3,731.84
21	PULL BOX (SMALL)	1	EA	\$ 928.36	\$ 958.06	\$ 924.00	\$ 924.00	\$ 1,007.43	\$ 1,007.43
	SUBTOTAL (ROADWAY)						\$275,875.80		\$243,320.21
22	CONDUIT - SIGNALS, F&I, OPEN TRENCH	84	LF	\$ 9.84	\$ 7.66	\$ 9.35	\$ 785.40	\$ 11.07	\$ 929.88
23	CONDUIT - SIGNALS, F&I, DIRECTIONAL BORE	307	LF	\$ 30.57	\$ 17.22	\$ 34.10	\$ 10,468.70	\$ 35.62	\$ 10,935.34
24	CABLE, SIGNAL, REPAIR/REPLACE, F&I	435	LF	\$ 10.76	\$ 3.30	\$ 9.70	\$ 4,219.50	\$ 18.10	\$ 7,873.50
25	SIGNAL CABLE, REMOVE-INTERSECTION	1	PI	\$ 1,076.10	\$ 658.05	\$ 957.00	\$ 957.00	\$ 1,933.88	\$ 1,933.88
26	SIGNAL CABLE, REMOVE-OUTSIDE OF INTERSECTION	300	LF	\$ 1.23	\$ 0.75	\$ 0.80	\$ 240.00	\$ 0.36	\$ 108.00
27	PULL & SPLICE BOX, F&I, 24" X 36" COVER SIZE	12	EA	\$ 1,183.10	\$ 1,618.50	\$ 1,331.00	\$ 15,972.00	\$ 1,130.90	\$ 13,570.80
28	ALUMINUM SIGNALS POLE, F&I, PEDESTRIAN DETECTOR POST	4	EA	\$ 1,219.56	\$ 995.25	\$ 1,353.00	\$ 5,412.00	\$ 1,133.73	\$ 4,534.92
29	STEEL MAST ARM ASSEMBLY, F&I, SINGLE ARM 70'	1	EA	\$ 59,837.00	\$ 43,950.00	\$ 58,476.00	\$ 58,476.00	\$ 63,714.01	\$ 63,714.01
30	STEEL MAST ARM ASSEMBLY, F&I, DOUBLE MAST ARM 78'-60'	1	EA	\$ 79,619.00	\$ 60,000.00	\$ 76,703.00	\$ 76,703.00	\$ 86,216.49	\$ 86,216.49
31	MAST ARM, REMOVE SHALLOW FOUNDATION, BOLT ON ATTACHMENT	2	EA	\$ 2,404.78	\$ 1,922.91	\$ 2,233.00	\$ 4,466.00	\$ 3,754.63	\$ 7,509.26
32	TRAFFIC SIGNAL, F&I, 3 SECTION, 1 WAY, LED	9	AS	\$ 1,123.29	\$ 999.84	\$ 1,045.00	\$ 9,405.00	\$ 1,350.67	\$ 12,156.03
33	TRAFFIC SIGNAL, F&I, ALUMINUM, 5 SECTION STRAIGHT, 1 WAY	1	AS	\$ 1,545.90	\$ 1,318.75	\$ 1,408.00	\$ 1,408.00	\$ 1,931.58	\$ 1,931.58
34	PEDESTRIAN SIGNAL, F&I, LED COUNTDOWN, 1 WAY	4	AS	\$ 809.19	\$ 887.39	\$ 660.00	\$ 2,640.00	\$ 846.76	\$ 3,387.04

GLADES ROAD AT BUTTS ROAD				Average for All Bidders	Engineer's Estimate	R & D PAVING, LLC		FLORIDA BLACKTOP, INC.	
Palm Beach County Project #2012503									
Item #	Description	Qty	Unit	Unit Price	Unit Price	Unit Price	Total	Unit Price	Total
35	VEHICLE DETECTION SYSTEM-VIDEO, F&I, ABOVE GROUND EQUIPMENT	2	EA	\$ 4,458.70	\$ 3,382.31	\$ 3,465.00	\$ 6,930.00	\$ 3,562.29	\$ 7,124.58
36	PEDESTRIAN DETECTOR, F&I, ACCESSIBLE	4	EA	\$ 681.95	\$ 1,459.57	\$ 308.00	\$ 1,232.00	\$ 225.78	\$ 903.12
37	INTERNALLY ILLUMINATED SIGN, F&I, OVERHEAD MOUNT, 12-18 SF	2	EA	\$ 2,722.28	\$ 3,161.65	\$ 2,211.00	\$ 4,422.00	\$ 3,667.61	\$ 7,335.22
38	LUMINAIRE & BRACKET ARM-GALV STEEL, F&I, NEW LUMINAIRE ON NEW/EXIST POLE	2	EA	\$ 1,311.27	\$ 2,500.00	\$ 869.00	\$ 1,738.00	\$ 2,346.56	\$ 4,693.12
SUBTOTAL (SIGNALIZATION)							\$ 205,474.60		\$ 234,856.77
39	CLASS I CONCRETE (MISCELLANEOUS)	10	CY	\$ 961.89	\$ 1,201.31	\$ 475.00	\$ 4,750.00	\$ 2,262.54	\$ 22,625.40
40	FLOWABLE FILL	10	CY	\$ 508.11	\$ 265.00	\$ 550.00	\$ 5,500.00	\$ 654.95	\$ 6,549.50
41	PREMIUM FOR CONFLICT CONDITION (SEE SP's)	1	EA	\$ 2,420.97	\$ 5,000.00	\$ 2,530.00	\$ 2,530.00	\$ 2,738.87	\$ 2,738.87
42	STRUCTURE BOTTOM, TYPE J	1	EA	\$ 3,005.61	\$ 13.11	\$ 3,300.00	\$ 3,300.00	\$ 3,572.44	\$ 3,572.44
43	CHANGEABLE (VARIABLE MESSAGE) SIGN (NON MOT)	30	ED	\$ 31.82	\$ 49.00	\$ 16.50	\$ 495.00	\$ 29.77	\$ 893.10
44	TRAFFIC CONTROL OFFICER (NON MOT)	30	HR	\$ 53.69	\$ 49.16	\$ 55.00	\$ 1,650.00	\$ 29.77	\$ 893.10
SUBTOTAL (CONTINGENCY)							\$ 18,225.00		\$ 37,272.41
TOTAL BID							\$ 499,575.40		\$ 515,449.39
	Indicates math error								

GLADES ROAD AT BUTTS ROAD				Average for All Bidders	Engineer's Estimate	ROSSO SITE DEVELOPMENT, INC.	WEEKLEY ASPHALT PAVING, INC.		
Palm Beach County Project #2012503									
Item #	Description	Qty	Unit	Unit Price	Unit Price	Unit Price	Total	Unit Price	Total
Roadway Items									
1	MOBILIZATION	1	LS	\$ 64,628.26	10%	\$ 96,244.96	\$ 96,244.96	\$ 77,300.00	\$ 77,300.00
2	MAINTENANCE OF TRAFFIC (INCL. PEDESTRIAN M.O.T.)	1	LS	\$ 41,834.72	15%	\$ 23,137.50	\$ 23,137.50	\$ 119,672.00	\$ 119,672.00
3	CLEARING AND GRUBBING	1	LS	\$ 30,068.25	\$ 4,692.83	\$ 47,273.99	\$ 47,273.99	\$ 41,955.00	\$ 41,955.00
4	FLOATING TURBIDITY BARRIER	58	LF	\$ 14.02	\$ 12.89	\$ 25.54	\$ 1,481.32	\$ 16.00	\$ 928.00
5	REGULAR EXCAVATION	169	CY	\$ 22.49	\$ 12.24	\$ 25.82	\$ 4,363.58	\$ 29.00	\$ 4,901.00
6	OPTIONAL BASE GROUP 13 (TYPE B-12.5 ONLY)	306	SY	\$ 56.66	\$ 22.30	\$ 37.61	\$ 11,508.66	\$ 84.20	\$ 25,765.20
7	MILLING EXIST ASPH PAVT, 1" AVG DEPTH	1,701	SY	\$ 5.12	\$ 1.69	\$ 3.94	\$ 6,701.94	\$ 6.00	\$ 10,206.00
8	SUPERPAVE ASPHALT CONCRETE (2-1/2") (TRAFFC LEVEL C)	42	TN	\$ 195.17	\$ 100.99	\$ 210.00	\$ 8,820.00	\$ 225.00	\$ 9,450.00
9	ASPH CONCRETE FRICTION COURSE (FC-9.5) (1") (PG 76-22, ARB)	110	TN	\$ 195.92	\$ 115.82	\$ 195.30	\$ 21,483.00	\$ 200.00	\$ 22,000.00
10	INLET (CURB) (TYPE P-5) (>10')	1	EA	\$ 12,201.78	\$ 6,447.82	\$ 11,760.00	\$ 11,760.00	\$ 11,390.00	\$ 11,390.00
11	CONTROL STRUCTURE (W/ INLET (CURB) (TYPE 5) & TYPE 7 MH TOP)	1	EA	\$ 18,487.21	\$ 9,308.00	\$ 17,850.00	\$ 17,850.00	\$ 17,155.00	\$ 17,155.00
12	CONCRETE PIPE CULVERT (24")	52	LF	\$ 164.47	\$ 81.50	\$ 172.20	\$ 8,954.40	\$ 110.00	\$ 5,720.00
13	CORRUGATED ALUMINUM PIPE CULVERT (15"X21" ELLIPTICAL)	56	LF	\$ 152.35	\$ 105.84	\$ 149.10	\$ 8,349.60	\$ 135.00	\$ 7,560.00
14	FRENCH DRAIN (24" DIA) (INCL. BALLAST ROCK AND FILTER FABRIC)	82	LF	\$ 252.11	\$ 95.43	\$ 247.80	\$ 20,319.60	\$ 220.00	\$ 18,040.00
15	CONCRETE BARRIER WALL	65	LF	\$ 307.36	\$ 60.50	\$ 254.96	\$ 16,572.40	\$ 277.00	\$ 18,005.00
16	CONCRETE CURB & GUTTER (TYPE F)	415	LF	\$ 30.56	\$ 16.87	\$ 22.98	\$ 9,536.70	\$ 35.80	\$ 14,857.00
17	CONCRETE SIDEWALK (4" THICK)	270	SY	\$ 54.36	\$ 38.41	\$ 42.74	\$ 11,539.80	\$ 51.35	\$ 13,864.50
18	GUARDRAIL - REMOVAL	88	LF	\$ 14.30	\$ 1.46	\$ 27.64	\$ 2,432.32	\$ 9.95	\$ 875.60
19	SODDING	336	SY	\$ 7.91	\$ 2.79	\$ 15.44	\$ 5,187.84	\$ 7.00	\$ 2,352.00
20	2-2" PVC CONDUITS (SCH 40) TRAFFIC F/O CABLE	343	LF	\$ 8.77	\$ 10.00	\$ 6.93	\$ 2,376.99	\$ 10.00	\$ 3,430.00
21	PULL BOX (SMALL)	1	EA	\$ 928.36	\$ 958.06	\$ 882.00	\$ 882.00	\$ 900.00	\$ 900.00
		SUBTOTAL (ROADWAY)					\$ 336,776.60		\$ 426,326.30
22	CONDUIT - SIGNALS, F&I, OPEN TRENCH	84	LF	\$ 9.84	\$ 7.66	\$ 8.93	\$ 750.12	\$ 10.00	\$ 840.00
23	CONDUIT - SIGNALS, F&I, DIRECTIONAL BORE	307	LF	\$ 30.57	\$ 17.22	\$ 32.55	\$ 9,992.85	\$ 20.00	\$ 6,140.00
24	CABLE, SIGNAL, REPAIR/REPLACE, F&I	435	LF	\$ 10.76	\$ 3.30	\$ 9.24	\$ 4,019.40	\$ 6.00	\$ 2,610.00
25	SIGNAL CABLE, REMOVE-INTERSECTION	1	PI	\$ 1,076.10	\$ 658.05	\$ 913.50	\$ 913.50	\$ 500.00	\$ 500.00
26	SIGNAL CABLE, REMOVE-OUTSIDE OF INTERSECTION	300	LF	\$ 1.23	\$ 0.75	\$ 0.74	\$ 222.00	\$ 3.00	\$ 900.00
27	PULL & SPLICE BOX, F&I, 24" X 36" COVER SIZE	12	EA	\$ 1,183.10	\$ 1,618.50	\$ 1,270.50	\$ 15,246.00	\$ 1,000.00	\$ 12,000.00
28	ALUMINUM SIGNALS POLE, F&I, PEDESTRIAN DETECTOR POST	4	EA	\$ 1,219.56	\$ 995.25	\$ 1,291.50	\$ 5,166.00	\$ 1,100.00	\$ 4,400.00
29	STEEL MAST ARM ASSEMBLY, F&I, SINGLE ARM 70'	1	EA	\$ 59,837.00	\$ 43,950.00	\$ 55,818.00	\$ 55,818.00	\$ 61,340.00	\$ 61,340.00
30	STEEL MAST ARM ASSEMBLY, F&I, DOUBLE MAST ARM 78'-60'	1	EA	\$ 79,619.00	\$ 60,000.00	\$ 73,216.50	\$ 73,216.50	\$ 82,340.00	\$ 82,340.00
31	MAST ARM, REMOVE SHALLOW FOUNDATION, BOLT ON ATTACHMENT	2	EA	\$ 2,404.78	\$ 1,922.91	\$ 2,131.50	\$ 4,263.00	\$ 1,500.00	\$ 3,000.00
32	TRAFFIC SIGNAL, F&I, 3 SECTION, 1 WAY, LED	9	AS	\$ 1,123.29	\$ 999.84	\$ 997.50	\$ 8,977.50	\$ 1,100.00	\$ 9,900.00
33	TRAFFIC SIGNAL, F&I, ALUMINUM, 5 SECTION STRAIGHT, 1 WAY	1	AS	\$ 1,545.90	\$ 1,318.75	\$ 1,344.00	\$ 1,344.00	\$ 1,500.00	\$ 1,500.00
34	PEDESTRIAN SIGNAL, F&I, LED COUNTDOWN, 1 WAY	4	AS	\$ 809.19	\$ 887.39	\$ 630.00	\$ 2,520.00	\$ 1,100.00	\$ 4,400.00

GLADES ROAD AT BUTTS ROAD				Average for All Bidders	Engineer's Estimate	ROSSO SITE DEVELOPMENT, INC.	WEEKLEY ASPHALT PAVING, INC.		
Palm Beach County Project #2012503				Unit Price	Unit Price	Unit Price	Total	Unit Price	Total
Item #	Description	Qty	Unit						
35	VEHICLE DETECTION SYSTEM-VIDEO, F&I, ABOVE GROUND EQUIPMENT	2	EA	\$ 4,458.70	\$ 3,382.31	\$ 3,307.50	\$ 6,615.00	\$ 7,500.00	\$ 15,000.00
36	PEDESTRIAN DETECTOR, F&I, ACCESSIBLE	4	EA	\$ 681.95	\$ 1,459.57	\$ 294.00	\$ 1,176.00	\$ 1,900.00	\$ 7,600.00
37	INTERNALLY ILLUMINATED SIGN, F&I, OVERHEAD MOUNT, 12-18 SF	2	EA	\$ 2,722.28	\$ 3,161.65	\$ 2,110.50	\$ 4,221.00	\$ 2,900.00	\$ 5,800.00
38	LUMINAIRE & BRACKET ARM-GALV STEEL, F&I, NEW LUMINAIRE ON NEW/EXIST POLE	2	EA	\$ 1,311.27	\$ 2,500.00	\$ 829.50	\$ 1,659.00	\$ 1,200.00	\$ 2,400.00
SUBTOTAL (SIGNALIZATION)							\$ 196,119.87		\$ 220,670.00
39	CLASS I CONCRETE (MISCELLANEOUS)	10	CY	\$ 961.89	\$ 1,201.31	\$ 210.00	\$ 2,100.00	\$ 900.00	\$ 9,000.00
40	FLOWABLE FILL	10	CY	\$ 508.11	\$ 265.00	\$ 577.50	\$ 5,775.00	\$ 250.00	\$ 2,500.00
41	PREMIUM FOR CONFLICT CONDITION (SEE SP's)	1	EA	\$ 2,420.97	\$ 5,000.00	\$ 2,415.00	\$ 2,415.00	\$ 2,000.00	\$ 2,000.00
42	STRUCTURE BOTTOM, TYPE J	1	EA	\$ 3,005.61	\$ 13.11	\$ 3,150.00	\$ 3,150.00	\$ 2,000.00	\$ 2,000.00
43	CHANGEABLE (VARIABLE MESSAGE) SIGN (NON MOT)	30	ED	\$ 31.82	\$ 49.00	\$ 63.00	\$ 1,890.00	\$ 18.00	\$ 540.00
44	TRAFFIC CONTROL OFFICER (NON MOT)	30	HR	\$ 53.69	\$ 49.16	\$ 63.00	\$ 1,890.00	\$ 67.00	\$ 2,010.00
SUBTOTAL (CONTINGENCY)							\$ 17,220.00		\$ 18,050.00
TOTAL BID							\$ 550,116.47		\$ 665,046.30
	Indicates math error								

GLADES ROAD AT BUTTS ROAD

PALM BEACH COUNTY PROJECT NO. 2012503

THE COUNTY DOES NOT GUARANTEE THE ACCURACY OF THE FORMULAS AND EXTENSIONS USED IN THIS SPREADSHEET.
 THE ITEMS AND QUANTITIES ABOVE, SHALL GOVERN OVER THE PLANS.
 PAY ITEM FOOTNOTES IN CONSTRUCTION PLANS SHALL ALSO BE INCLUDED IN ITEM UNIT PRICE.

Note #	PAY ITEM FOOTNOTES
1	Item # 2 - Includes all costs associated with Maintenance of Traffic (MOT) not included for payment under a separate item number. It would include but not be limited to the costs of furnishing, installing, and removal of barricades, construction signs, temporary pavement markings, flashing lights, and arrow boards.
2	Item # 3 - Includes all costs for clearing and grubbing includes removal of concrete barrier wall. Includes the cost of tree removal and one certified arborist.
3	Item # 6 - 12" compacted subgrade shall be incidental to the cost of base.
4	Item # 7 - Includes the cost of sawcutting existing pavement.
5	Item # 10 and #11 - Cost of drainage structures includes all costs for temporary shoring and sheet piling that may be required to avoid encroachment outside right-of-way or construction easement lines shown in the plans.
6	Item # 12 through #14 - Cost of pipe to include trench excavation, backfill, compaction, and disposal of surplus excavated material.
7	Item # 13 - Cost of pipe to include flowable fill to separate the proposed stormwater drainage pipe and existng 24" water main.
8	Item # 14 - Cost of 24" french drain includes ballast rock and fabrick filter.
9	Item # 16 - Includes cost off furnishing 4" Type B-12.5 asphalt curb pad.
10	Item # 17 - Cost of concerte sidewalk includes cost to install detectable warnings on existing sidewalk as shown in plans. Includes the quantity and cost of embankment.
11	Item # 18 - This item includes all costs associated with removal, stock piling, coordinating, and delivering salvagable guardrail and appurtenances to the FDOT West Palm Beach Operating Center.

Working days to complete project: 180 calendar days (See Special Provisions)

Bids as read at opening on Tuesday, MAY 22, 2018 ; 2:00 PM

All bids subject to OSBA SBE compliance and Board Approval.

Prepared by: Geraldine Lazzarino-Kelly, Technical Assistant I

Checked by: Holly B. Knight, P.E., Contracts Section Manager

ACORD™

CERTIFICATE OF LIABILITY INSURANCE

DATE (MM/DD/YYYY)
6/13/2018

THIS CERTIFICATE IS ISSUED AS A MATTER OF INFORMATION ONLY AND CONFERS NO RIGHTS UPON THE CERTIFICATE HOLDER. THIS CERTIFICATE DOES NOT AFFIRMATIVELY OR NEGATIVELY AMEND, EXTEND OR ALTER THE COVERAGE AFFORDED BY THE POLICIES BELOW. THIS CERTIFICATE OF INSURANCE DOES NOT CONSTITUTE A CONTRACT BETWEEN THE ISSUING INSURER(S), AUTHORIZED REPRESENTATIVE OR PRODUCER, AND THE CERTIFICATE HOLDER.

IMPORTANT: If the certificate holder is an ADDITIONAL INSURED, the policy(ies) must have ADDITIONAL INSURED provisions or be endorsed. If SUBROGATION IS WAIVED, subject to the terms and conditions of the policy, certain policies may require an endorsement. A statement on this certificate does not confer any rights to the certificate holder in lieu of such endorsement(s).

PRODUCER USI Insurance Services, LLC 500 Columbia Drive, Ste 102 West Palm Beach, FL 33409-2718 561 693-0500	CONTACT NAME: Kandi Schmitz
	PHONE (A/C, No, Ext): 561-693-0504 FAX (A/C, No): 855-420-6662
	E-MAIL ADDRESS: kandi.schmitz@usi.com
INSURER(S) AFFORDING COVERAGE	
	INSURER A : Southern-Owners Insurance Company NAIC # 10190
	INSURER B : Auto Owners Insurance Company 18988
	INSURER C : Federal Insurance Company 20281
	INSURER D :
	INSURER E :
	INSURER F :

COVERAGES CERTIFICATE NUMBER: REVISION NUMBER:

THIS IS TO CERTIFY THAT THE POLICIES OF INSURANCE LISTED BELOW HAVE BEEN ISSUED TO THE INSURED NAMED ABOVE FOR THE POLICY PERIOD INDICATED. NOTWITHSTANDING ANY REQUIREMENT, TERM OR CONDITION OF ANY CONTRACT OR OTHER DOCUMENT WITH RESPECT TO WHICH THIS CERTIFICATE MAY BE ISSUED OR MAY PERTAIN, THE INSURANCE AFFORDED BY THE POLICIES DESCRIBED HEREIN IS SUBJECT TO ALL THE TERMS, EXCLUSIONS AND CONDITIONS OF SUCH POLICIES. LIMITS SHOWN MAY HAVE BEEN REDUCED BY PAID CLAIMS.

INSR LTR	TYPE OF INSURANCE	ADDL INSR	SUBR WVD	POLICY NUMBER	POLICY EFF (MM/DD/YYYY)	POLICY EXP (MM/DD/YYYY)	LIMITS
A	<input checked="" type="checkbox"/> COMMERCIAL GENERAL LIABILITY <input type="checkbox"/> CLAIMS-MADE <input checked="" type="checkbox"/> OCCUR GEN'L AGGREGATE LIMIT APPLIES PER: <input type="checkbox"/> POLICY <input checked="" type="checkbox"/> PRO-JECT <input type="checkbox"/> LOC OTHER:	X	X	72072563	10/23/2017	10/23/2018	EACH OCCURRENCE \$1,000,000 DAMAGE TO RENTED PREMISES (Ea occurrence) \$300,000 MED EXP (Any one person) \$10,000 PERSONAL & ADV INJURY \$1,000,000 GENERAL AGGREGATE \$2,000,000 PRODUCTS - COMP/OP AGG \$2,000,000
B	AUTOMOBILE LIABILITY <input checked="" type="checkbox"/> ANY AUTO OWNED AUTOS ONLY <input checked="" type="checkbox"/> HIRED AUTOS ONLY <input type="checkbox"/> SCHEDULED AUTOS <input checked="" type="checkbox"/> NON-OWNED AUTOS ONLY			4930665100	10/23/2017	10/23/2018	COMBINED SINGLE LIMIT (Ea accident) \$1,000,000 BODILY INJURY (Per person) \$ BODILY INJURY (Per accident) \$ PROPERTY DAMAGE (Per accident) \$
B	<input checked="" type="checkbox"/> UMBRELLA LIAB <input type="checkbox"/> EXCESS LIAB DED <input checked="" type="checkbox"/> RETENTION \$10,000 <input checked="" type="checkbox"/> OCCUR <input type="checkbox"/> CLAIMS-MADE			4930665101	10/23/2017	10/23/2018	EACH OCCURRENCE \$3,000,000 AGGREGATE \$3,000,000
	WORKERS COMPENSATION AND EMPLOYERS' LIABILITY ANY PROPRIETOR/PARTNER/EXECUTIVE OFFICER/MEMBER EXCLUDED? <input type="checkbox"/> Y/N (Mandatory in NH) If yes, describe under DESCRIPTION OF OPERATIONS below		N/A				PER STATUTE <input type="checkbox"/> OTH-ER <input type="checkbox"/> E.L. EACH ACCIDENT \$ E.L. DISEASE - EA EMPLOYEE \$ E.L. DISEASE - POLICY LIMIT \$
C	Equipment Floater			45467356	10/23/2017	10/23/2018	\$250,000 Rented/Leased Equipment

DESCRIPTION OF OPERATIONS / LOCATIONS / VEHICLES (ACORD 101, Additional Remarks Schedule, may be attached if more space is required)
RE: Project #2012503, Glades Rd at Butts Rd
Additional Insured Entities: Palm Beach County Board of County Commissioners, A Political Subdivision of the State of Florida, Its Officers, Employees and Agents.
The General Liability policy includes automatic Additional Insured endorsement that provides Additional (See Attached Descriptions)

CERTIFICATE HOLDER Palm Beach County c/o Insurance Tracking Services, Inc. (ITS) P.O. Box 20270 Long Beach, CA 90801	CANCELLATION SHOULD ANY OF THE ABOVE DESCRIBED POLICIES BE CANCELLED BEFORE THE EXPIRATION DATE THEREOF, NOTICE WILL BE DELIVERED IN ACCORDANCE WITH THE POLICY PROVISIONS. AUTHORIZED REPRESENTATIVE <i>B. M. Cook</i>
--	--

© 1988-2015 ACORD CORPORATION. All rights reserved.

DESCRIPTIONS (Continued from Page 1)

Insured status to the Certificate Holder, only when there is a written contract that requires such status, and only with regard to work performed on behalf of the Named Insured.



CERTIFICATE OF LIABILITY INSURANCE

DATE (MM/DD/YYYY)
06/13/2018

THIS CERTIFICATE IS ISSUED AS A MATTER OF INFORMATION ONLY AND CONFERS NO RIGHTS UPON THE CERTIFICATE HOLDER. THIS CERTIFICATE DOES NOT AFFIRMATIVELY OR NEGATIVELY AMEND, EXTEND OR ALTER THE COVERAGE AFFORDED BY THE POLICIES BELOW. THIS CERTIFICATE OF INSURANCE DOES NOT CONSTITUTE A CONTRACT BETWEEN THE ISSUING INSURER(S), AUTHORIZED REPRESENTATIVE OR PRODUCER, AND THE CERTIFICATE HOLDER.

IMPORTANT: If the certificate holder is an ADDITIONAL INSURED, the policy(ies) must have ADDITIONAL INSURED provisions or be endorsed. If SUBROGATION IS WAIVED, subject to the terms and conditions of the policy, certain policies may require an endorsement. A statement on this certificate does not confer rights to the certificate holder in lieu of such endorsement(s).

PRODUCER Atlantic Pacific Insurance-PBG 11382 Prosperity Farms Rd #123 Palm Beach Gardens, FL 33410 Paul Regan Finley	<p style="text-align: center;">800-538-0487</p> CONTACT NAME: PHONE (A/C, No, Ext): 800-538-0487 FAX (A/C, No): 561-626-3153 E-MAIL ADDRESS: _____
INSURER(S) AFFORDING COVERAGE	
INSURER A : Bridgefield Casualty Ins. Co. NAIC # 10335	
INSURER B : _____	
INSURER C : _____	
INSURER D : _____	
INSURER E : _____	
INSURER F : _____	

COVERAGES CERTIFICATE NUMBER: REVISION NUMBER:

THIS IS TO CERTIFY THAT THE POLICIES OF INSURANCE LISTED BELOW HAVE BEEN ISSUED TO THE INSURED NAMED ABOVE FOR THE POLICY PERIOD INDICATED. NOTWITHSTANDING ANY REQUIREMENT, TERM OR CONDITION OF ANY CONTRACT OR OTHER DOCUMENT WITH RESPECT TO WHICH THIS CERTIFICATE MAY BE ISSUED OR MAY PERTAIN, THE INSURANCE AFFORDED BY THE POLICIES DESCRIBED HEREIN IS SUBJECT TO ALL THE TERMS, EXCLUSIONS AND CONDITIONS OF SUCH POLICIES. LIMITS SHOWN MAY HAVE BEEN REDUCED BY PAID CLAIMS.

INSR LTR	TYPE OF INSURANCE	ADDL INSD	SUBR WVD	POLICY NUMBER	POLICY EFF (MM/DD/YYYY)	POLICY EXP (MM/DD/YYYY)	LIMITS
	COMMERCIAL GENERAL LIABILITY <input type="checkbox"/> CLAIMS-MADE <input type="checkbox"/> OCCUR GEN'L AGGREGATE LIMIT APPLIES PER: <input type="checkbox"/> POLICY <input type="checkbox"/> PRO-JECT <input type="checkbox"/> LOC OTHER: _____						EACH OCCURRENCE \$ DAMAGE TO RENTED PREMISES (Ea occurrence) \$ MED EXP (Any one person) \$ PERSONAL & ADV INJURY \$ GENERAL AGGREGATE \$ PRODUCTS - COM/OP AGG \$ _____ \$
	AUTOMOBILE LIABILITY <input type="checkbox"/> ANY AUTO OWNED AUTOS ONLY <input type="checkbox"/> HIRED AUTOS ONLY <input type="checkbox"/> SCHEDULED AUTOS <input type="checkbox"/> NON-OWNED AUTOS ONLY						COMBINED SINGLE LIMIT (Ea accident) \$ BODILY INJURY (Per person) \$ BODILY INJURY (Per accident) \$ PROPERTY DAMAGE (Per accident) \$ _____ \$
	UMBRELLA LIAB <input type="checkbox"/> OCCUR EXCESS LIAB <input type="checkbox"/> CLAIMS-MADE DED RETENTION \$						EACH OCCURRENCE \$ AGGREGATE \$ _____ \$
A	WORKERS COMPENSATION AND EMPLOYERS' LIABILITY ANY PROPRIETOR/PARTNER/EXECUTIVE OFFICER/MEMBER EXCLUDED? (Mandatory in NH) <input type="checkbox"/> Y <input type="checkbox"/> N If yes, describe under DESCRIPTION OF OPERATIONS below			0196445070	10/29/2017	10/29/2018	<input checked="" type="checkbox"/> PER STATUTE <input checked="" type="checkbox"/> OTH-ER E.L. EACH ACCIDENT \$ 1,000,000 E.L. DISEASE - EA EMPLOYEE \$ 1,000,000 E.L. DISEASE - POLICY LIMIT \$ 1,000,000

DESCRIPTION OF OPERATIONS / LOCATIONS / VEHICLES (ACORD 101, Additional Remarks Schedule, may be attached if more space is required)

Project Name: Glades Rd at Butts Rd
Project No. 2012503

CERTIFICATE HOLDER <p style="text-align: center;">PALMB01</p> Palm Beach County c/o Insurance Tracking Services, Inc. (ITS) P.O. Box 20270 Long Beach, CA 90801	CANCELLATION SHOULD ANY OF THE ABOVE DESCRIBED POLICIES BE CANCELLED BEFORE THE EXPIRATION DATE THEREOF, NOTICE WILL BE DELIVERED IN ACCORDANCE WITH THE POLICY PROVISIONS. AUTHORIZED REPRESENTATIVE
--	--