

II. FISCAL IMPACT ANALYSIS

A. Five Year Summary of Fiscal Impact:

Fiscal Years	2019	2020	2021	2022	2023
Capital Expenditures	\$1,500,000	-0-	-0-	-0-	-0-
Operating Costs	-0-	-0-	-0-	-0-	-0-
External Revenues	-0-	-0-	-0-	-0-	-0-
Program Income (County)	-0-	-0-	-0-	-0-	-0-
In-Kind Match (County)	-0-	-0-	-0-	-0-	-0-
NET FISCAL IMPACT	\$1,500,000	-0-	-0-	-0-	-0-
# ADDITIONAL FTE POSITIONS (Cumulative)					

Is Item Included in Current Budget? Yes X No
 Does this item include the use of federal funds? Yes No X

Budget Account No:

Fund 3500 Dept 361 Unit 1851 Object Various

Recommended Sources of Funds/Summary of Fiscal Impact:

Transportation Improvement Fund
 Pathway Program FY 2019

C. Departmental Fiscal Review: Alicia Kovalainen

III. REVIEW COMMENTS

A. OFMB Fiscal and/or Contract Dev. and Control Comments:

 Lisa Pontz 9/17/18
 OFMB
 AK 9/17
 9/17
 9/14
 cm 9/17

 D. J. Jacobson 9/21/18
 Contract Dev and Control
 9/21/18

B. Approved as to Form and Legal Sufficiency:

 J. B. Herman 9/27/2018
 Assistant County Attorney

C. Other Department Review:

 Department Director

This summary is not to be used as a basis for payment.

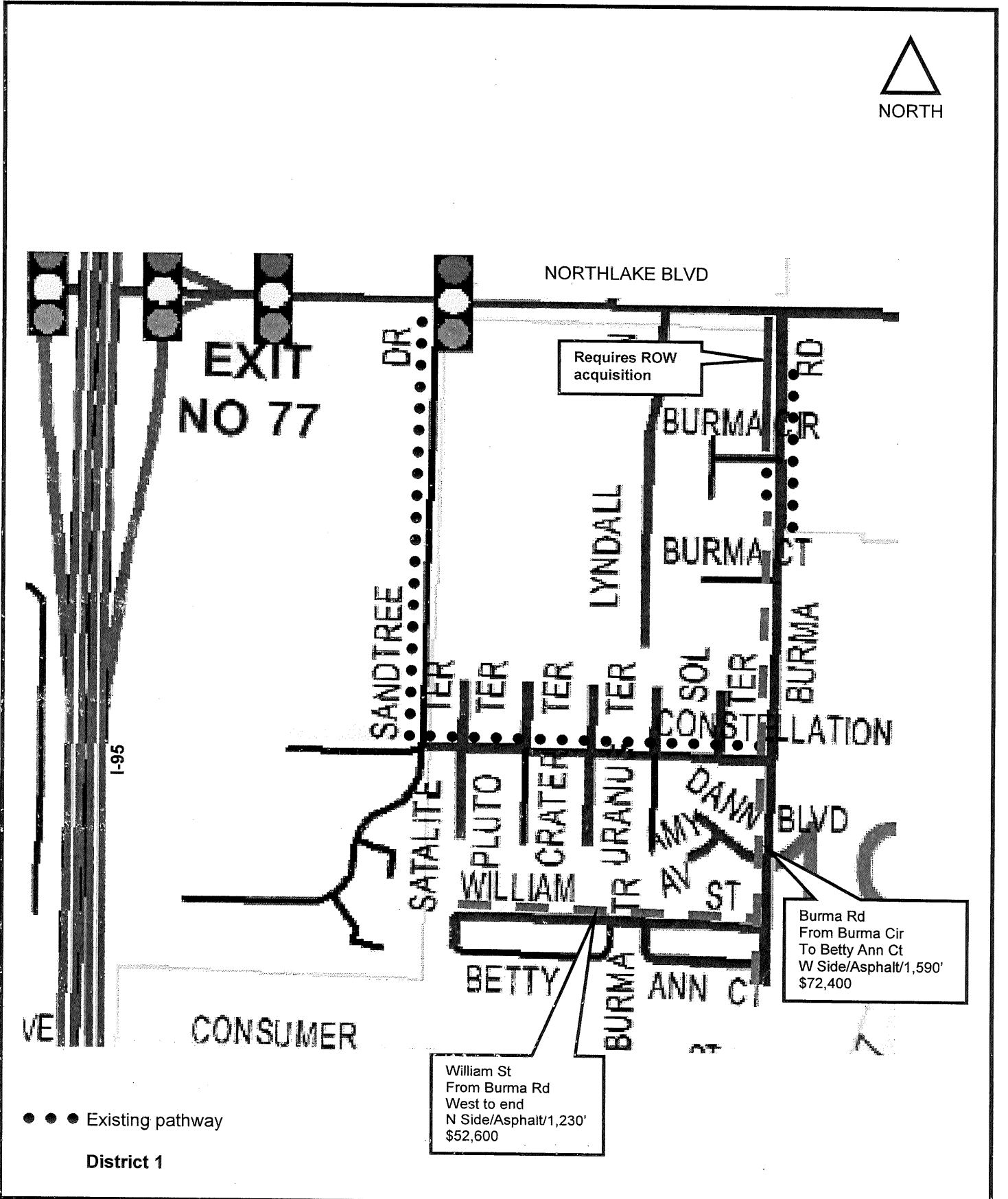

FY 2019 PATHWAY PROGRAM

Burma Rd. and William St.
Location Map

ATTACH
1B

8-22-18

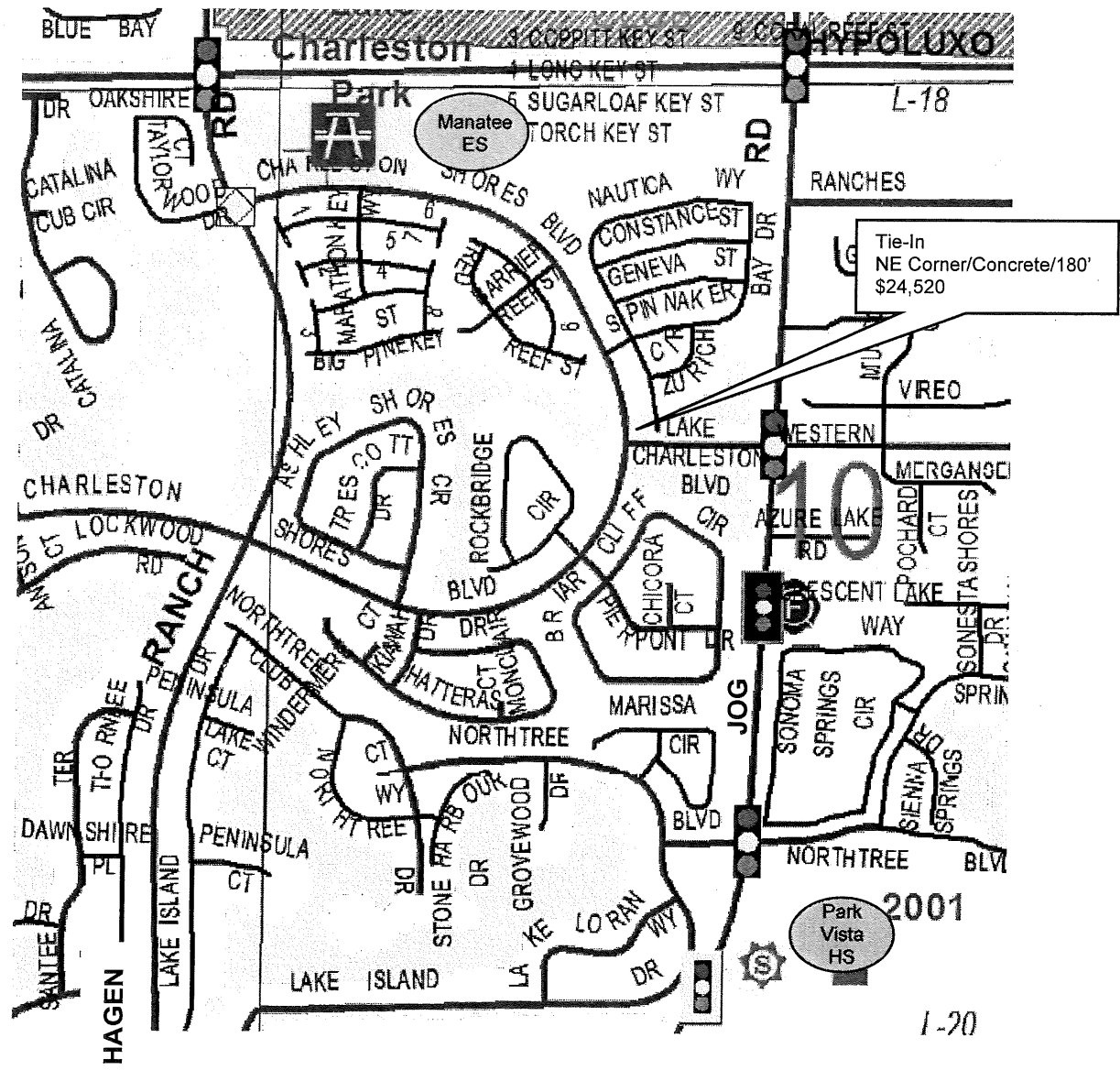

District 3



FY 2019 PATHWAY PROGRAM

Charleston Shores Blvd at
Lake Charleston Blvd.
Location Map

ATTACH
1C

8-22-18

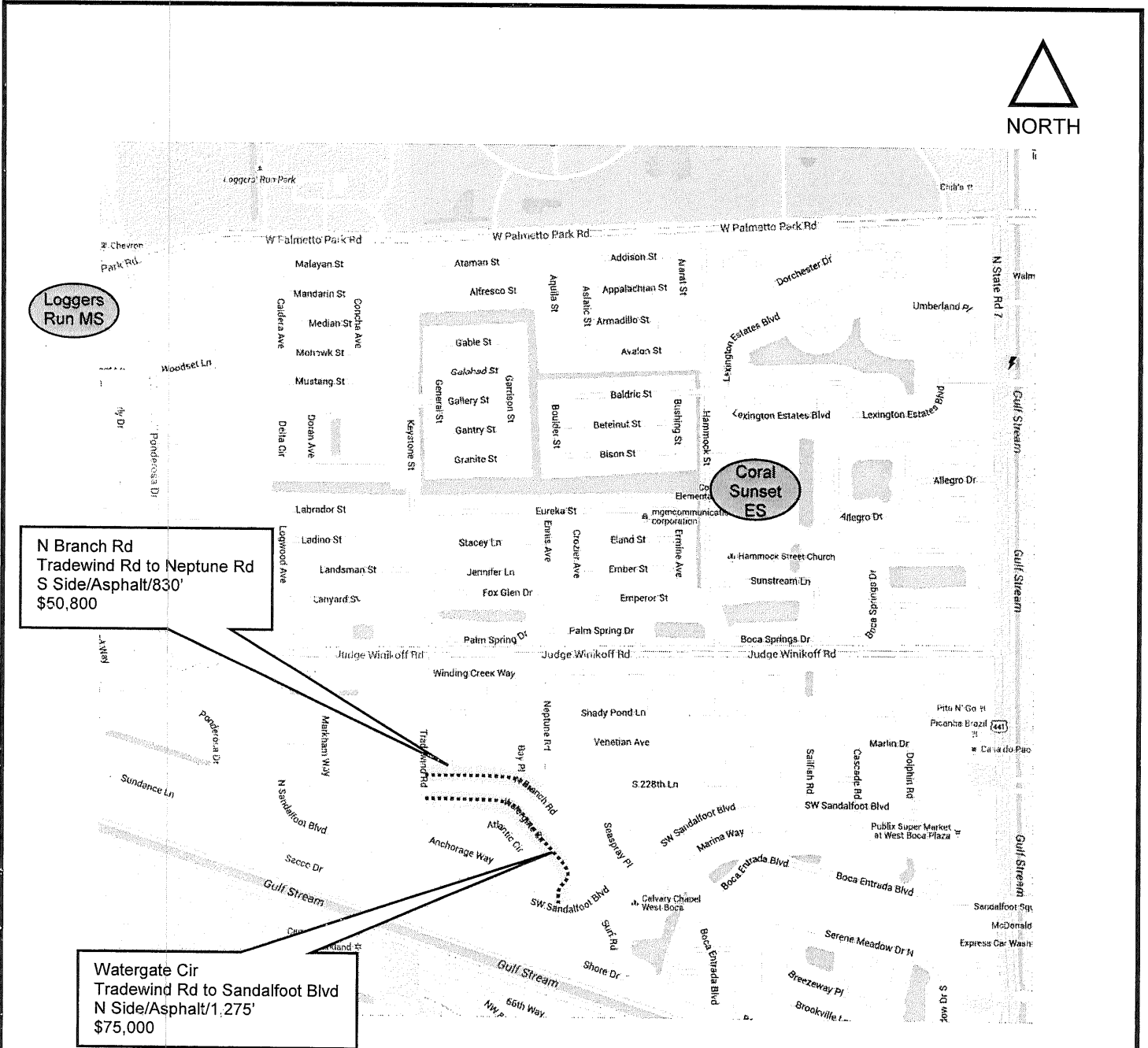

----- Missing pathway

District 5



FY 2019 PATHWAY PROGRAM

N. Branch Road
Watergate Circle
Location Map

ATTACH
1D

8-22-18

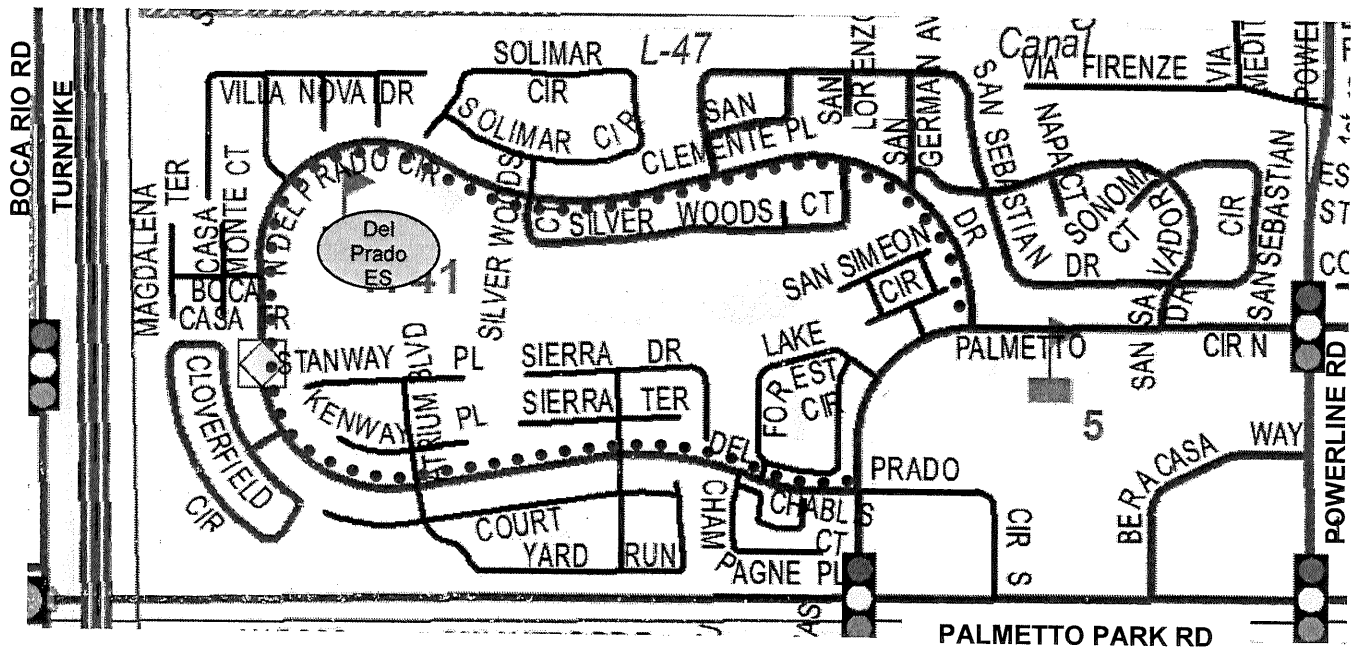

● ● ● Rehabilitate existing pathway

District 4

Asphalt/7,050'
\$146,020



FY 2019 PATHWAY PROGRAM

Del Prado Circle North & South
Location Map

ATTACH
1E

8-22-18

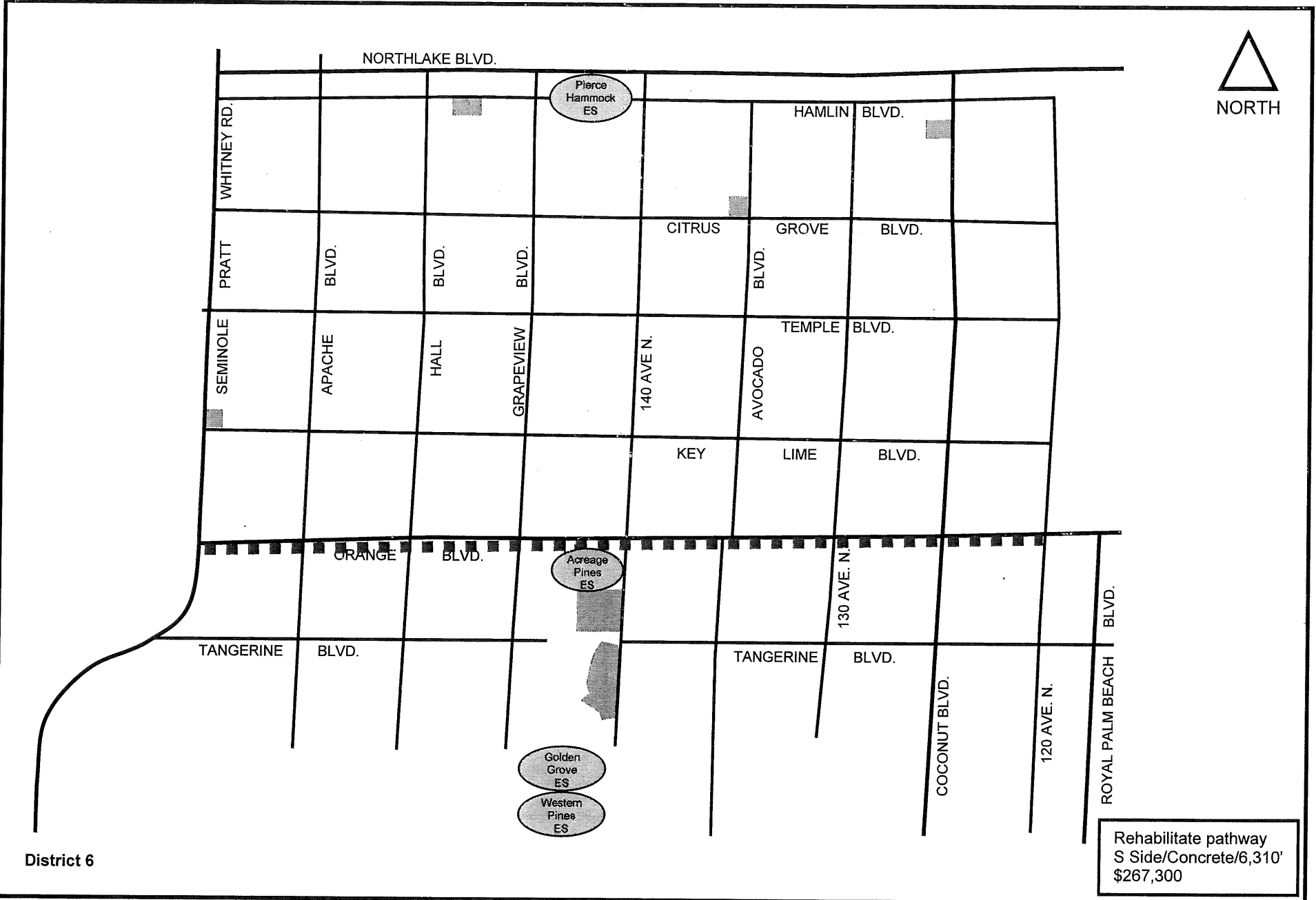

District 6

Rehabilitate pathway
S Side/Concrete/6,310'
\$267,300



FY 2019 PATHWAY PROGRAM

Orange Boulevard Pathway
Location Map

ATTACH
1F

8-22-18

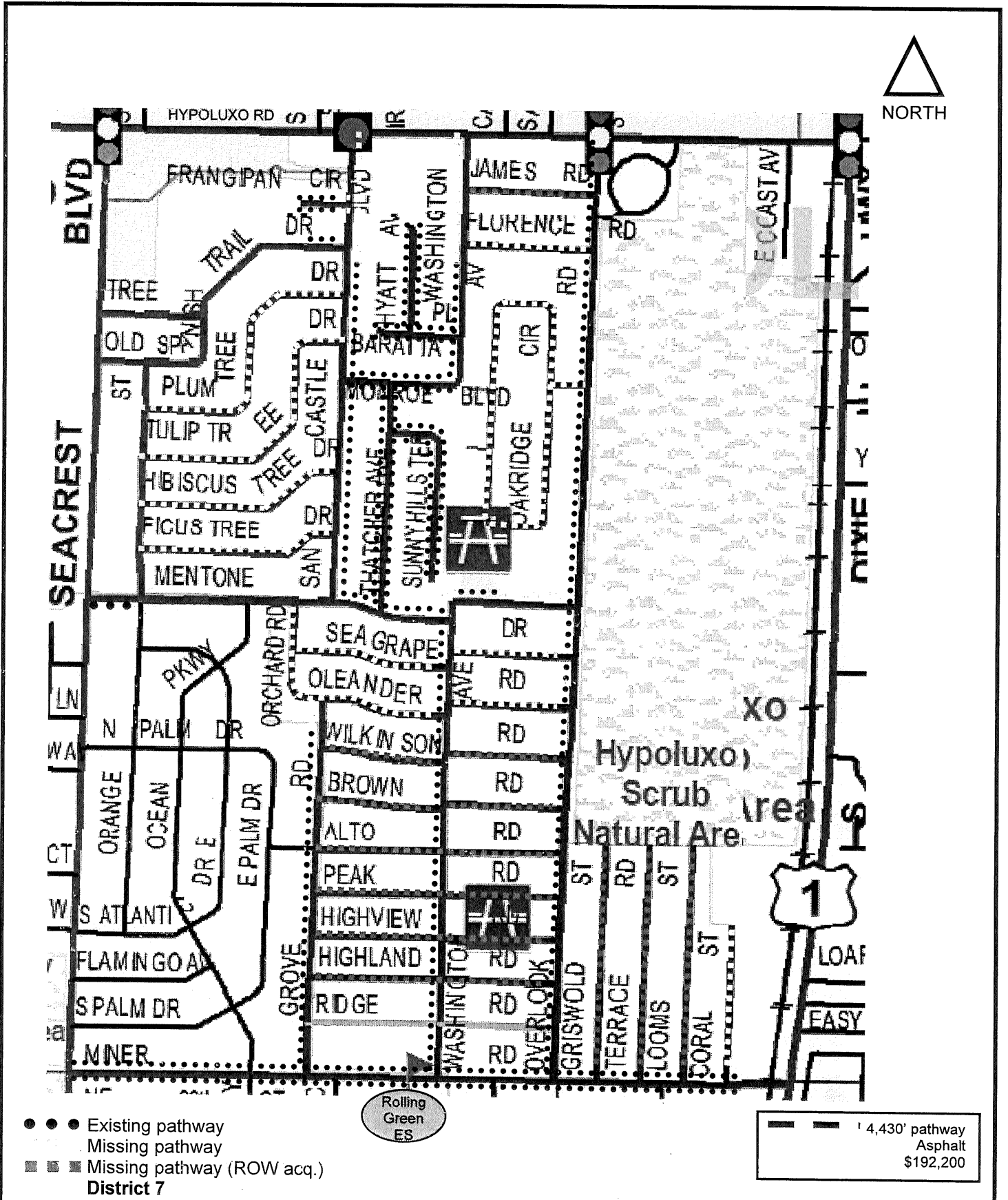

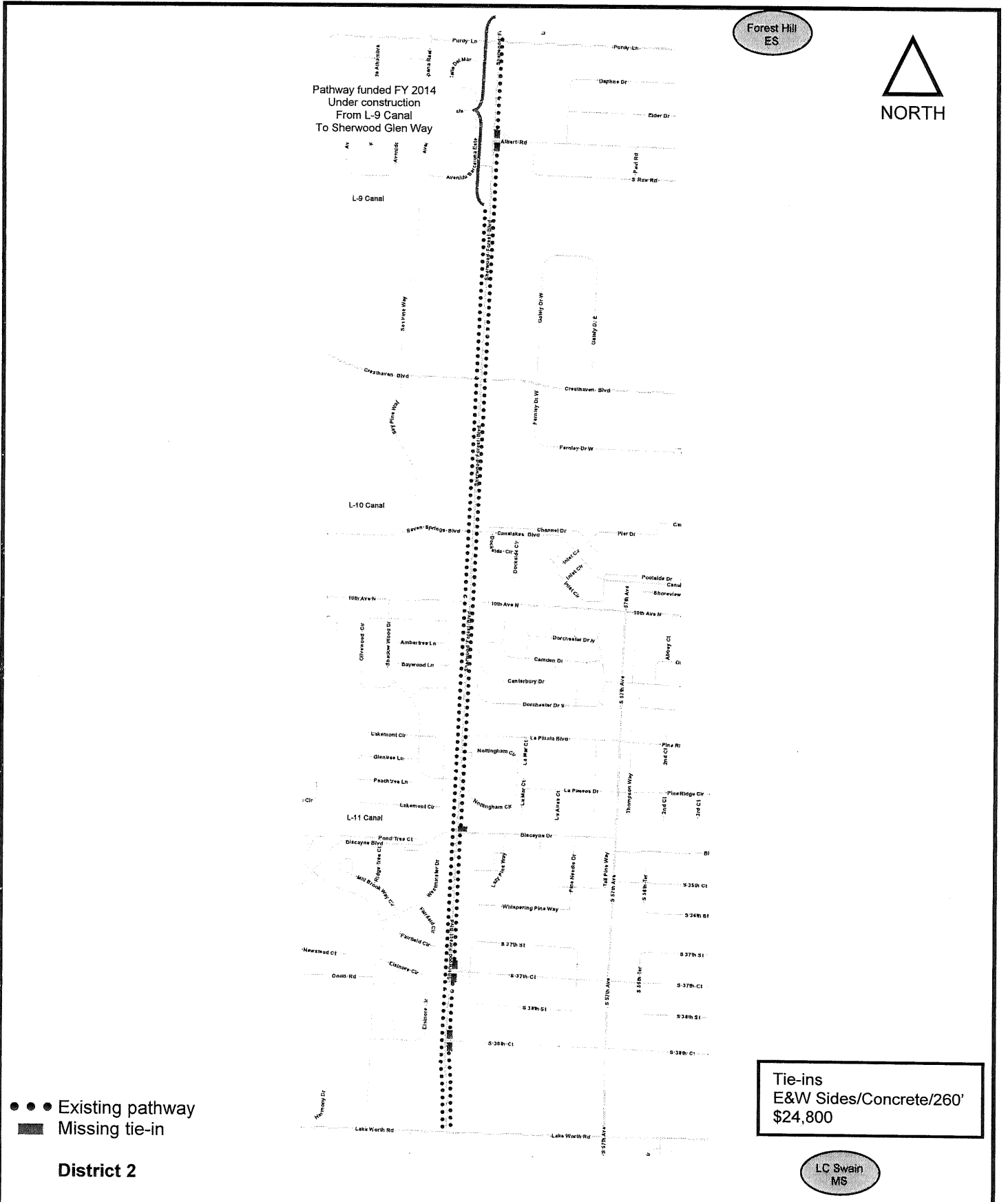

**TABLE 1
FY 2019 PROPOSED PATHWAY PROGRAM**

ATTACH #	PROJECT LOCATION	FROM > TO	ROAD SIDE	COMM DISTRICT	ESTIMATED COST	LENGTH (LF)	PATHWAY TYPE	WIDTH (FT)	ATLAS PAGE	REQUESTED BY
MAJOR MAINTENANCE - EXISTING FACILITIES										
NA	JUDGE WINIKOFF RD	PALMETTO PARK RD NORTH TO PONDEROSA DR	BOTH	5	112,057	6,000	ASPHALT	8	119	R&B
NA	EL CLAIR RANCH RD	ATLANTIC AVE TO L-33 CANAL	E	5	74,628	2,800	ASPHALT	6	109	R&B
NA	VIA FLORA	ATLANTIC AVE TO LAKE IDA RD	W	5	50,184	4,400	ASPHALT	6	109	R&B
NA	CAIN BLVD	186TH CT S TO BOCA CHASE DR	E	5	24,084	1,700	ASPHALT	8	114	R&B
NA	CAMINO REAL	POWERLINE RD TO SANIBEL DR	BOTH	4	57,465	7,000	ASPHALT	6	130	R&B
NA	ROEBUCK RD	CENTRAL BLVD TO LOXAHATCHEE RIVER RD	N	1	70,408	1,300	ASPHALT	6	6	R&B
NA	DAVIS RD	SUMMIT BLVD TO COLLIN DR	BOTH	2	21,359	1,000	ASPHALT	6	80	R&B
NA	FLORIDA MANGO RD	BRIDGEMAN RD TO BELVEDERE RD	W	2	26,111	2,400	ASPHALT	6	71	R&B
NA	LOXAHATCHEE RIVER RD	OLD MYSTIC CT NORTH TO PENNOCK POINT RD	E	1	23,663	1,382	ASPHALT	6	6	R&B
NA	LOXAHATCHEE RIVER RD	HOLLY LN TO EAGLES NEST DR	W	1	40,041	3,000	ASPHALT	6	6	R&B
SUBTOTAL					500,000					
NEW CONSTRUCTION - SCHOOL RELATED										
1A	BONANZA DR	BRANDY LN TO ARPEGE PL AND MELODY RD TO TWIG RD	E	6	63,600	555	CONCRETE	6	87	RESIDENT
1B	BURMA RD	BURMA CIR TO BETTY ANN CT	W	1	72,400	1,590	ASPHALT	6	34	RESIDENT
1B	WILLIAM ST	BURMA RD WEST TO END	N	1	52,600	1,230	ASPHALT	5	34	RESIDENT
1C	CHARLESTON SHORES BLVD	AT LAKE CHARLESTON BLVD.	NEC	3	24,520	180	CONCRETE	6	97	R&B
1D	N BRANCH RD	TRADEWIND RD TO NEPTUNE RD	S	5	50,800	830	ASPHALT	6	128	SRTS
1D	WATERGATE CIR	TRADEWIND RD TO SANDALFOOT BLVD	N	5	75,000	1,275	ASPHALT	6	128	SRTS
1E	DEL PRADO CIRCLE NORTH & SOUTH	IN A CIRCLE	N/S/E/W	4	146,020	7,050	ASPHALT	6	121	RESIDENT
1F	ORANGE BLVD	SEMINOLE PRATT WHITNEY RD TO 120th AVE N	S	6	267,300	6,260/50	CONCRETE	5/6	40,41,42	RES/R&B
1G	SAN CASTLE COMMUNITY	MENTONE RD, OLD SPANISH TRL DR, LOQUAT TREE DR, ORANGE ST	VARIOUS	7	192,200	4,430	ASPHALT	6	99	RES/OCR
1H	SHERWOOD FOREST BLVD	AT 38TH CT, 37TH CT, BISCAYNE DR, ALBERT RD	E&W	2	24,800	260	TIE-INS	6	79	CITY
SUBTOTAL					969,240					
MINOR MAINTENANCE AND SUPPORT										
SUBTOTAL					30,760					
TOTAL					\$ 1,500,000					

- R&B = ROAD AND BRIDGE
- SRTS = SAFE ROUTES TO SCHOOL - 2-MILE RADIUS
- OCR = OFFICE OF COMMUNITY REVITALIZATION
- RES = RESIDENT
- CITY = CITY OF GREENACRES