

**PALM BEACH COUNTY  
BOARD OF COUNTY COMMISSIONERS  
AGENDA ITEM SUMMARY**

---

<b>Meeting Date:</b> October 16, 2018	<input checked="" type="checkbox"/> <b>Consent</b>	<input type="checkbox"/> <b>Regular</b>
	<input type="checkbox"/> <b>Workshop</b>	<input type="checkbox"/> <b>Public Hearing</b>

---

<b>Department:</b>	Engineering and Public Works
<b>Submitted By:</b>	Engineering and Public Works
<b>Submitted For:</b>	Construction Coordination Division

---

**I. EXECUTIVE BRIEF**

**Motion and Title:** Staff recommends motion to approve: Change Order No. 1 with Community Asphalt Corporation (CAC) for a contract time extension of 150 days to the Northlake Boulevard and Military Trail Intersection Improvements project, R2017-0785. Per PPM CW-F-050, this change order exceeds the 90 day threshold relating to staff approvals of change orders to contracts, and requires the Board of County Commissioners' approval.

**SUMMARY:** Approval of Change Order No. 1 will extend the contract time 150 days due to delays associated with unforeseen utility conflicts with the proposed mast arm foundations for the project. The Small Business Enterprise (SBE) goal for all contracts is 15%. CAC proposed 11.8% SBE participation. Their SBE participation for this change order is 0% and their cumulative SBE participation to date including this change order is 0%. We expect the SBE goal to be realized in the final stages with completion of drainage, curbing, sidewalk, and paving. To date \$129,719.12 has been paid out of the total contract amount of \$1,411,513.80. District 1 (LBH)

**Background and Justification:** During construction of the project, it was determined that there are numerous conflicts between existing buried utilities and the proposed new mast arm foundations, that were not indicated on the plans, resulting in the need to extend the contract time.

**Attachments:**

1. Location Map
  2. Change Order No. 1 with Exhibits A & B and Schedule 1
- 

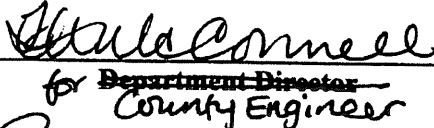
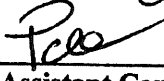
<b>Recommended by:</b>	 <del>for Department Director</del> County Engineer	10/3/18	
		Date	
<b>Approved by:</b>		10/3/18	
	Assistant County Administrator	Date	



PROJECT LOCATION  
NORTHLAKE BOULEVARD & MILITARY TRAIL  
PALM BEACH COUNTY PROJECT NO. 2013519

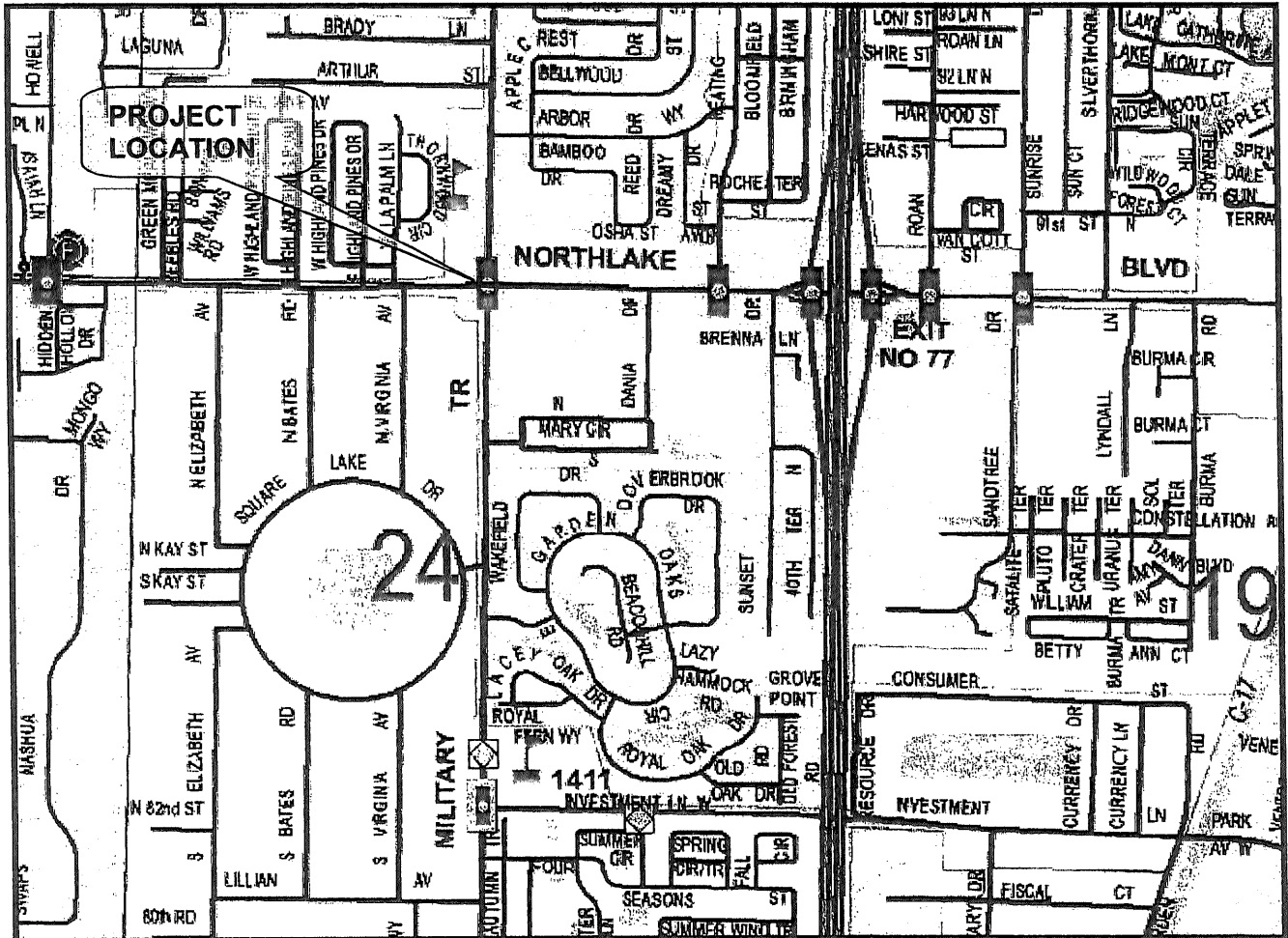

LOCATION MAP

**PALM BEACH COUNTY BOARD OF COUNTY COMMISSIONERS  
ENGINEERING & PUBLIC WORKS DEPARTMENT  
P. O. BOX 21229, WEST PALM BEACH, FL 33416-1229**



<b>REQUEST:</b>	<b>REQUESTING DIVISION:</b>	<b>INFORMATION:</b>
<input type="checkbox"/> WORK ORDER NO. _____	<input type="checkbox"/> ROAD & BRIDGE	DATE <u>August 29, 2018</u>
<input type="checkbox"/> NEW AUTHORIZATION	<input type="checkbox"/> TRAFFIC	REQUESTOR <u>Stephen O'Neil</u>
<input checked="" type="checkbox"/> CHANGE ORDER NO. <u>1</u>	<input type="checkbox"/> ROADWAY PRODUCTION	COMMISSION DISTRICT NO: <u>1</u>
<input type="checkbox"/> SUPPLEMENTAL NO. _____	<input checked="" type="checkbox"/> CONSTRUCTION COOR.	RESOLUTION NO: <u>R2017-0785</u>
<input type="checkbox"/> OTHER: _____	<input type="checkbox"/> STREETScape	PBC PO NUMBER: _____

**PROJECT LOCATION/LIMITS:** Northlake Boulevard & Military Trail  
**PROJECT NUMBER:** 2013519 **BUDGET LINE ITEM:** \_\_\_\_\_  
**CONTRACT NO:** \_\_\_\_\_ **CONTRACT DATE:** 6/20/17

**CONTRACTOR/CONSULTANT/VENDOR:** Community Asphalt Corp. **VENDOR #** \_\_\_\_\_  
**CONTACT:** Stephanie Grindell **CONTACT PHONE NUMBER:** 561-790-6467

Details: Change Order No. 1 for 150 day time extension due to delays associated with unforeseen utility conflicts with the proposed mast arm foundations.

Exhibit "A" – Change Order Details  
Exhibit "B" – Contractor's Time Extension Request

The total amount of this request, per the attached documentation, is not to exceed \$ -0-

The Small Business Enterprise (SBE) goal for this contract is 11.8%. The estimated SBE participation for this request is 0%.  
The cumulative SBE participation to date for this Contract including this request is 0%.

**Palm Beach County Engineering and Public Works Contact:**

<u>Mark A. Tomlinson</u>	<u>Director, Construction Coordination</u>	<u>561-684-4180</u>
Name	Title	Telephone Number

**CONTRACTOR/CONSULTANT/VENDOR APPROVALS**  
Please indicate your receipt of this request by signing and returning this original document to our office.

Please sign below and submit with invoice at the completion of the project. Project completed in compliance with Contract and Project Specifications.

[Signature] 9/5/2018  
Signature Date  
Paul Swellenhop, Exec. V.P.  
Print Name and Title

\_\_\_\_\_  
Signature Date  
\_\_\_\_\_  
Print Name and Title

**PALM BEACH COUNTY APPROVALS**  
[Signature] 9/6/18  
Division Approval Date  
[Signature] 9/12/18  
Deputy County Engineer Date

**BOARD APPROVAL?** YES Date: 10/16/18  
N/A  
Budget Approval Date  
PBC Board of Co. Commissioner Date

**ATTEST:** Sharon R. Bock,  
Clerk & Comptroller

**Approved as to Form and Legal Sufficiency:**

\_\_\_\_\_  
(Deputy Clerk) Date

\_\_\_\_\_  
(County Attorney)

**CHANGE ORDER**

**Exhibit "A"**

- |   |   |
|---|---|
| <input type="checkbox"/> Owner Initiated                      | <input type="checkbox"/> Quantity Overruns/Underruns                                  |
| <input checked="" type="checkbox"/> Differing Site Conditions | <input type="checkbox"/> Request By Another Agency/Outside Party:                     |
| <input type="checkbox"/> Zoning/Code/Ordinance Changes        | <input type="checkbox"/> A. Reimbursable <input type="checkbox"/> B. Non-Reimbursable |
| <input type="checkbox"/> Errors/Omissions/In Design           | <input type="checkbox"/> Other:   |

PROJECT: Northlake Blvd. and Military Trail Intersection Improvements (Name)	CHANGE ORDER NO: 1
TO: Community Asphalt Corporation (Contractor)	COUNTY PROJECT NO: 2013519
	CONTRACT DATE: 06/20/2017
	RESOLUTION NO: R2017-0785
	DISTRICT NO: 1

You are directed to make the following changes in this Contract:

In accordance with 2013 FDOT Standard Specification 8-7.3.2, you are hereby authorized to extend the Contract Time by 150 Calendar Days due to delays caused by unforeseen utility conflicts with the proposed signalization improvements. This time extension will serve as full and final settlement regarding Community's Time Extension Request dated 08/31/2018 attached and incorporated herein. This is a non-compensable Time Extension.

The original Contract Sum was . . . . .	\$ 1,411,513.80
Net change by previous Change Orders . . . . .	\$ -0-
The Contract Sum prior to this Change Order was . . . . .	\$ 1,411,513.80
The Contract Sum will be unchanged by this Change Order . . . . .	\$ -0-
The new Contract Sum including this Change Order will be . . . . .	\$ 1,411,513.80
The Contract Time will be increased by . . . . .	(150) Days
The Date of Completion including this Change Order therefore is . . . . .	January 27, 2019

EXECUTION OF THIS CHANGE ORDER ACKNOWLEDGES FINAL SETTLEMENT OF, AND RELEASES ALL CLAIMS FOR, COSTS AND TIME ASSOCIATED, DIRECTLY OR INDIRECTLY, WITH THE ABOVE-STATED MODIFICATION(S). INCLUDING ALL CLAIMS FOR CUMULATIVE DELAYS OR DISRUPTIONS RESULTING FROM, CAUSED BY, OR INCIDENT TO, SUCH MODIFICATION(S), AND INCLUDING ANY CLAIM THAT THE ABOVE-STATED MODIFICATION(S) CONSTITUTES, IN WHOLE OR PART, A CARDINAL CHANGE TO THE CONTRACT.

Community Asphalt Corp.  
 CONTRACTOR  
7795 Hooper Road  
 Address  
West Palm Beach, FL 33411  
 NAME: Tina M. LAUS  
 TITLE: Assistant Corp. Secretary  
 DATE: 9/5/2018

ATTACHMENT "A"



**OHL**  
**Community**  
**Asphalt**

Mr. Stephen O'Neil  
Chief Construction Coordinator  
Palm Beach County Department of Engineering & Public Works  
Construction Coordination Division  
PO Box 21229  
West Palm Beach, Florida 33416-1229

August 31, 2018

REF: Northlake Blvd and Military Trail Intersection Improvements  
PBC Project No. 2013519  
OHL/CA Project #7103

Subject: Time Extension Request

Dear Mr. O'Neil:

Community Asphalt requests a Time Extension of 150 Days due to utility conflicts affecting start of construction and drilled shaft foundations for signal mast arms. Please find attached our September 2018 schedule update and Baseline schedule to support the impacts. We understand that AT&T conflicts are pending resolution at Mast Arm "W", and Mast Arm "T" has been eliminated due to utility conflicts.

If you should have any questions or require additional information regarding this matter, please contact our office.

Respectfully submitted,  
Community Asphalt Corp.

ARYAIL M GOMEZ Digitally signed by ARYAIL M GOMEZ  
Date: 2018.08.31 16:40:49 -04'00'

Aryail Gomez, Project Manager

CC: Miguel Oliveras, PE, JMT, Stephanie Grindell, PE, OHL/CA VP Operations, File 7103

**Corporate:**  
9675 NW 117 Ave. – Suite 108  
Miami, FL 33178  
Phone: 305.884.9444  
Fax: 305.884.9448

**Miami Dade:**  
14005 NW 186 Street  
Hialeah, FL 33018  
Phone: 305.829.0700  
Fax: 305.829.0431

**West Palm Beach:**  
7795 Hooper Road  
West Palm Beach, FL 33411  
Phone: 561.790.6467  
Fax: 561.790.1073

**Vero Beach:**  
2975 Industrial Blvd.  
Vero Beach, FL 32967  
Phone: 772.770.3771  
Fax: 772.770.3707

**Fort Myers:**  
16560 Mass Court  
Fort Myers, FL 33912  
Phone: 239.337.9486  
Fax: 239.337.9488

Certified General Contractor. License Number: CG C011475

IMPROVEMENTS @ NORTHLAKE BLVD MILITARY TRAIL - Cost Loaded Baseline-						TASK filter: All Activities												Project # 7103-U1 / Printed: 04-Sep-18 15:50															
Activity ID	Activity Name	Orig Dur	Start	Finish	Total Float	2018						2019																					
						September	October	November	December	January	February	March	April	May	June																		
<b>IMPROVEMENTS @ NORTHLAKE BLV</b>						394	02-Jun-17 A	28-Jan-19	0																								
<b>PROJECT OVERVIEW / GENERAL CONI</b>						163	04-Dec-17 A	28-Jan-19	0																								
7103-1120	Contract Time	163	04-Dec-17 A	28-Jan-19	0	Contract Time																											
7103-1130	MOT	150	01-Sep-18	28-Jan-19	0	MOT																											
<b>PROJECT MILESTONES</b>						394	02-Jun-17 A	28-Jan-19	0																								
7103-M-2010	Award Date	0	02-Jun-17 A																														
7103-M-1010	Notice of Proceed	0	04-Dec-17 A																														
7103-M-2070	Time Impact due to Utility Conflicts	280	04-Dec-17 A	31-Aug-18	3	Time Impact due to Utility Conflicts																											
7103-M-2080	Original Start Date	0	03-Apr-18 A																														
7103-M-2020	Restart Date	0	01-Sep-18*		3	Restart Date																											
7103-M-2025	Substantial Completion	0		28-Jan-19	1	Substantial Completion																											
7103-M-2000	Final Completion Date	0		28-Jan-19	0	Final Completion Date																											
<b>SUBMITTALS</b>						255	04-Dec-17 A	24-Nov-18	39																								
<b>REVIEWS &amp; APPROVALS</b>						211	04-Dec-17 A	01-Oct-18	50																								
7103-SD-SG-1000	Prepare & Submit Signalization Shop	21	04-Dec-17 A	02-Jan-18 A																													
7103-SD-ER-1000	Prepare & Submit Erosion Control M	13	04-Dec-17 A	20-Dec-17 A																													
7103-SD-MOT-1050	Prepare & Submit MOT Plans	34	04-Dec-17 A	19-Jan-18 A																													
7103-SD-IT-1000	Prepare & Submit ITS Shop Drawings	29	04-Dec-17 A	12-Jan-18 A																													
7103-SD-ER-1010	PBC Review and Approve Erosion C	15	21-Dec-17 A	11-Jan-18 A																													
7103-SD-SG-1010	PBC Review Signalizations Shop Dre	15	03-Jan-18 A	24-Jan-18 A																													
7103-SD-ER-1020	Approval of Erosion Control Materials	1	12-Jan-18 A	12-Jan-18 A																													
7103-SD-IT-1010	PBC Review ITS Shop Drawings	15	15-Jan-18 A	06-Feb-18 A																													
7103-SD-MOT-1060	PBC Review MOT Plans	15	23-Jan-18 A	12-Feb-18 A																													
7103-SD-SG-1020	Resubmit Signalization Shop Drawing	57	25-Jan-18 A	13-Apr-18 A																													
7103-SD-IT-1020	Resubmit ITS Shop Drawings	9	06-Feb-18 A	16-Feb-18 A																													
7103-SD-MOT-1070	Resubmit MOT Plans	81	13-Feb-18 A	07-Jun-18 A																													
7103-SD-IT-1030	PBC Review ITS Resubmital	15	16-Feb-18 A	09-Mar-18 A																													
7103-SD-SG-1030	PBC Review Signalizations Resubm	15	16-Apr-18 A	07-May-18 A																													
7103-SD-SG-1040	Approval of Signalizations Shop Draw	1	31-May-18 A	31-May-18 A																													
7103-SD-MOT-1080	PBC Review MOT Resubmital	15	06-Jun-18 A	27-Jun-18 A																													
7103-SD-S-1010	Prepare & Submit Signs Shop Drawin	15	12-Jun-18 A	07-Sep-18	37	Prepare & Submit Signs Shop Drawings																											
7103-SD-DR-1000	Prepare & Submit Drainage Materials	7	20-Jun-18 A	05-Sep-18	27	Prepare & Submit Drainage Materials																											
7103-SD-MOT-1090	Approval of MOT Plans	1	27-Jun-18 A	27-Jun-18 A																													
7103-SD-IT-1040	Approval of ITS Shop Drawings	1	31-Aug-18	31-Aug-18	70	Approval of ITS Shop Drawings																											
7103-SD-DR-1020	PBC Review and Approve Drainage	5	06-Sep-18	12-Sep-18	27	PBC Review and Approve Drainage Materials																											
7103-SD-S-1030	PBC Review and Approve Signs Sho	15	10-Sep-18	28-Sep-18	37	PBC Review and Approve Signs Shop Drawings																											
7103-SD-DR-1030	Approval of Drainage Shop Drawings	1	13-Sep-18	13-Sep-18	27	Approval of Drainage Shop Drawings																											
7103-SD-S-1040	Approval of Signs Shop Drawings	1	01-Oct-18	01-Oct-18	37	Approval of Signs Shop Drawings																											
<b>PROCUREMENT / DELIVERY</b>						301	27-Jan-18 A	24-Nov-18	55																								
7103-PR-ER-1000	Procurement for Erosion Control Mat	13	27-Jan-18 A	09-Feb-18 A																													
7103-IT-1050	Procurement for ITS Materials	40	19-Mar-18 A	28-Apr-18 A																													
7103-PR-SG-1400	Procurement for Signalization	40	30-Apr-18 A	08-Jun-18 A																													
7103-PR-DR-1000	Procurement for Drainage	22	14-Sep-18	08-Oct-18	39	Procurement for Drainage																											
7103-PR-S-1010	Procurement for Signs Material	53	02-Oct-18	24-Nov-18	55	Procurement for Signs Material																											
<b>UTILITY RELOCATION BY OTHERS</b>						243	04-Dec-17 A	07-Nov-18	58																								

Remaining Level of Effort   
 Actual Work   
 Critical Remaining W...  
 Actual Level of Effort   
 Remaining Work   
 Milestone

IMPROVEMENTS @ NORTHLAKE BLVD MILITARY TRAIL - Cost Loaded Baseline-  
 01- Working Schedule

Page 1 of 3

Data Dated = 31-Aug-18



Activity ID	Activity Name	Orig Dur	Start	Finish	Total Float	2018												2019																				
						September			October			November			December			January			February			March			April			May			June					
						03	10	17	24	01	08	15	22	29	05	12	19	26	03	10	17	24	31	07	14	21	28	04	11	18	25	01	08	15	22	29	05	12
7103-C-UT-1030	Underground Utilities in Conflict with h	259	04-Dec-17 A	19-Sep-18	131	Underground Utilities in Conflict with Mast Arm Foundations																																
7103-C-UT-1020	Relocation or Removal of All Utilities	20	11-Oct-18	07-Nov-18	0	Relocation or Removal of All Utilities																																
<b>CONSTRUCTION</b>						105	04-Sep-18	28-Jan-19	0																													
7103-M-2030	Phase I	0	04-Sep-18		0	◆ Phase I																																
7103-M-2040	Phase II	0	18-Dec-18		0	◆ Phase II																																
7103-M-2050	Phase III	0	16-Jan-19		0	◆ Phase III																																
<b>PHASE I</b>						80	04-Sep-18	04-Jan-19	16																													
<b>Lighting, ITS &amp; Signalization</b>						57	04-Sep-18	21-Nov-18	39																													
<b>Signalization</b>						57	04-Sep-18	21-Nov-18	39																													
7103-IT-1150	Mobilization / Set MOT - NL (E/B)	3	04-Sep-18	06-Sep-18	0	■ Mobilization / Set MOT - NL (E/B)																																
7103-LGT-5380	Install Prestressed Concrete Pole / E	1	07-Sep-18	07-Sep-18	18	I Install Prestressed Concrete Pole / Elect Installation																																
7103-SG-3000	Drill Shaft V: Sta. 55+95	1	07-Sep-18	07-Sep-18	0	I Drill Shaft V: Sta. 55+95																																
7103-SG-3010	Drill Shaft U: Sta. 55+64	1	10-Sep-18	10-Sep-18	0	I Drill Shaft U: Sta. 55+64																																
7103-SG-3020	Drill Shaft T: Sta. 54+20.65	1	11-Sep-18	11-Sep-18	0	I Drill Shaft T: Sta. 54+20.65																																
7103-SG-3030	Drill Shaft S: Sta. 54+12.93	1	12-Sep-18	12-Sep-18	0	I Drill Shaft S: Sta. 54+12.93																																
7103-SG-3040	Drill Shaft Z: Sta. 54+18.98	1	13-Sep-18	13-Sep-18	0	I Drill Shaft Z: Sta. 54+18.98																																
7103-SG-3050	Drill Shaft Y: Sta. 54+28.28	1	14-Sep-18	14-Sep-18	0	I Drill Shaft Y: Sta. 54+28.28																																
7103-SG-3060	Drill Shaft X: Sta. 55+72.1	1	17-Sep-18	17-Sep-18	0	I Drill Shaft X: Sta. 55+72.1																																
7103-SG-3070	Drill Shaft W: Sta. 55+79.65	1	18-Sep-18	18-Sep-18	0	I Drill Shaft W: Sta. 55+79.65																																
7103-SG-3080	Signalization Conduit	3	19-Sep-18	21-Sep-18	0	■ Signalization Conduit																																
7103-SG-3120	Install Mast Arm V: Sta. 55+95	1	19-Sep-18	19-Sep-18	0	I Install Mast Arm V: Sta. 55+95																																
7103-SG-3130	Install Mast Arm U: Sta. 55+64	1	20-Sep-18	20-Sep-18	0	I Install Mast Arm U: Sta. 55+64																																
7103-SG-3140	Install Mast Arm T: Sta. 54+20.65	1	21-Sep-18	21-Sep-18	0	I Install Mast Arm T: Sta. 54+20.65																																
7103-SG-3090	Pull Boxes	2	24-Sep-18	25-Sep-18	0	■ Pull Boxes																																
7103-SG-3150	Install Mast Arm S: Sta. 54+12.93	1	24-Sep-18	24-Sep-18	0	I Install Mast Arm S: Sta. 54+12.93																																
7103-SG-3160	Install Mast Arm Z: Sta. 54+18.98	1	25-Sep-18	25-Sep-18	0	I Install Mast Arm Z: Sta. 54+18.98																																
7103-SG-3100	Install Aluminum Signal Pole, Pedeste	3	26-Sep-18	28-Sep-18	0	■ Install Aluminum Signal Pole, Pedestal, Pedestrian, Detectors & Rem SP																																
7103-SG-3170	Install Mast Arm Y: Sta. 54+28.28	1	26-Sep-18	26-Sep-18	0	I Install Mast Arm Y: Sta. 54+28.28																																
7103-SG-3180	Install Mast Arm X: Sta. 55+72.1	1	27-Sep-18	27-Sep-18	0	I Install Mast Arm X: Sta. 55+72.1																																
7103-SG-3190	Install Mast Arm W: Sta. 55+79.65	1	28-Sep-18	28-Sep-18	0	I Install Mast Arm W: Sta. 55+79.65																																
7103-SG-3200	Wiring	3	01-Oct-18	03-Oct-18	0	■ Wiring																																
7103-SG-3220	Services Point Connection, System	3	04-Oct-18	08-Oct-18	0	■ Services Point Connection, System Control Equipment																																
7103-SG-3210	Install Traffic Signals and Sign Panels	5	04-Oct-18	10-Oct-18	39	■ Install Traffic Signals and Sign Panels																																
7103-LGT-5370	Existing Light Poles to be Removed	8	09-Oct-18	18-Oct-18	29	■ Existing Light Poles to be Removed by Others																																
7103-SG-3230	County Inspection and Approval	30	11-Oct-18	21-Nov-18	39	■ County Inspection and Approval																																
<b>ITS</b>						21	26-Sep-18	24-Oct-18	54																													
7103-SG-1290	ITS Conduit, & P Boxes Sta. 61+73-	8	26-Sep-18	05-Oct-18	54	■ ITS Conduit, & P Boxes Sta. 61+73- 55+43																																
7103-SG-3110	Install VDS, Cabinet Equipment and	10	08-Oct-18	19-Oct-18	54	■ Install VDS, Cabinet Equipment and above Ground Equipment																																
7103-IT-1060	Fiber Optic Cable Sta. 61+73- 55+43	3	22-Oct-18	24-Oct-18	54	■ Fiber Optic Cable Sta. 61+73- 55+43																																
<b>North Lake Blvd E/B</b>						18	09-Oct-18	01-Nov-18	0																													
7103-IT-1160	Remove old Signalization Items	3	09-Oct-18	11-Oct-18	0	■ Remove old Signalization Items																																
7103-IT-1170	Clearing & Grubbing - NL (E/B)	3	09-Oct-18	11-Oct-18	0	■ Clearing & Grubbing - NL (E/B)																																
7103-IT-1180	Excavation - NL (E/B)	3	12-Oct-18	16-Oct-18	0	■ Excavation - NL (E/B)																																
7103-C-DR-1160	Remove Existing Inlet + S-200 @ Sta	1	12-Oct-18	12-Oct-18	5	I Remove Existing Inlet + S-200 @ Sta. 61+22.73																																
7103-IT-1190	12" Subbase / Curb Pad - NL (E/B)	3	17-Oct-18	19-Oct-18	0	■ 12" Subbase / Curb Pad - NL (E/B)																																
7103-IT-1200	Type F Curb & Gutter - NL (E/B)	3	22-Oct-18	24-Oct-18	0	■ Type F Curb & Gutter - NL (E/B)																																
7103-IT-1210	4-6 LF of Concrete Sidewalk - NL (E)	5	25-Oct-18	31-Oct-18	0	■ 4-6 LF of Concrete Sidewalk - NL (E/B)																																

Exhibit "B" (Page 3 of 4)



Activity ID	Activity Name	Orig Dur	Start	Finish	Total Float	TASK filter: All Activities														
						2018						2019								
						September	October	November	December	January	February	March	April	May	June					
7103-IT-1220	Black Base Asphalt - NL (E/B)	1	01-Nov-18	01-Nov-18	0	█ Black Base Asphalt - NL (E/B)														
<b>NorthLake Blvd W/B</b>																				
7103-RD-1180	Set MOT - NL (W/B)	1	02-Nov-18	02-Nov-18	0	█ Set MOT - NL (W/B)														
7103-RD-1190	Sawcut / Excavation - NL (W/B)	3	05-Nov-18	07-Nov-18	4	█ Sawcut / Excavation - NL (W/B)														
7103-C-S-1010	Clearing & Grubbing - NL (W/B)	3	05-Nov-18	07-Nov-18	0	█ Clearing & Grubbing - NL (W/B)														
7103-RD-1310	Remove Existing Sidewalk - NL (W/B)	5	08-Nov-18	14-Nov-18	32	█ Remove Existing Sidewalk - NL (W/B)														
7103-RD-1510	Const 6.2 CY of Gravity Wall - NL (W)	3	08-Nov-18	12-Nov-18	0	█ Const 6.2 CY of Gravity Wall - NL (W/B)														
7103-C-S-1030	Excavation/Emb - NL (W/B)	3	08-Nov-18	12-Nov-18	0	█ Excavation/Emb - NL (W/B)														
7103-C-S-1000	Erosion Control Devices - NL (W/B)	3	09-Nov-18	13-Nov-18	0	█ Erosion Control Devices - NL (W/B)														
7103-C-DR-1060	Remove Ext. S-108 & Install S-107 @	1	14-Nov-18	14-Nov-18	0	█ Remove Ext. S-108 & Install S-107 @ Sta.61+20 + 8LF of 15" Pipe														
7103-C-DR-1070	Install S-106 @ Sta. 59+45	1	15-Nov-18	15-Nov-18	0	█ Install S-106 @ Sta. 59+45														
7103-C-DR-1080	Construct 73 Lf of 18" Pipe: S-106 -	1	16-Nov-18	16-Nov-18	0	█ Construct 73 Lf of 18" Pipe: S-106 - S103														
7103-C-DR-1090	Install S-103 @ Sta. 58+78.39	1	19-Nov-18	19-Nov-18	0	█ Install S-103 @ Sta. 58+78.39														
7103-C-DR-1100	Remove Ext. S-105 @ Sta. 58+56	1	20-Nov-18	20-Nov-18	0	█ Remove Ext. S-105 @ Sta. 58+56														
7103-C-DR-1150	Construct 93 Lf of 18" Pipe: S-103 -	1	20-Nov-18	20-Nov-18	0	█ Construct 93 Lf of 18" Pipe: S-103 - S104														
7103-C-DR-1110	Install S-104 @ Sta. 57+85	1	21-Nov-18	21-Nov-18	0	█ Install S-104 @ Sta. 57+85														
7103-C-DR-1040	S-104 - S102; Install 29 Lf of 18" RCP	1	26-Nov-18	26-Nov-18	0	█ S-104 - S102; Install 29 Lf of 18" RCP														
7103-C-DR-1050	Install S-102 @ Sta. 57+56	1	27-Nov-18	27-Nov-18	0	█ Install S-102 @ Sta. 57+56														
7103-C-DR-1120	S-104 - S101; Install 122 Lf of French	1	28-Nov-18	28-Nov-18	0	█ S-104 - S101; Install 122 Lf of French Drain + 14 LF of 18" RCP														
7103-C-DR-1130	Install S-101 @ Sta. 56+20	1	29-Nov-18	29-Nov-18	0	█ Install S-101 @ Sta. 56+20														
7103-C-DR-1140	Adjust S-100 @ Sta. 57+98	1	30-Nov-18	30-Nov-18	0	█ Adjust S-100 @ Sta. 57+98														
7103-RD-1200	12" Subbase / Curb Pad - NL (W/B)	3	03-Dec-18	05-Dec-18	0	█ 12" Subbase / Curb Pad - NL (W/B)														
7103-RD-1210	Type F Curb & Gutter - NL (W/B)	3	06-Dec-18	10-Dec-18	0	█ Type F Curb & Gutter - NL (W/B)														
7103-RD-1220	Const Opt Base Gp- NL (W/B)13-	3	11-Dec-18	13-Dec-18	0	█ Const Opt Base Gp- NL (W/B)13-														
7103-RD-1330	4-6 LF of Concrete Sidewalk - NL (V)	10	11-Dec-18	02-Jan-19	16	█ 4-6 LF of Concrete Sidewalk - NL (W/B)														
7103-RD-1240	Pave Struc (Traffic-C) (1.5") - NL (V)	2	14-Dec-18	17-Dec-18	0	█ Pave Struc (Traffic-C) (1.5") - NL (W/B)														
7103-RD-1440	Install Detectable Warning-	2	03-Jan-19	04-Jan-19	16	█ Install Detectable Warning-														
<b>PHASE II</b>																				
7103-RD-1520	Set Up MOT - NL (Median)	2	18-Dec-18	19-Dec-18	0	█ Set Up MOT - NL (Median)														
7103-RD-1530	Sawcut / Excavation- NL (Median)	5	20-Dec-18	04-Jan-19	5	█ Sawcut / Excavation- NL (Median)														
7103-C-S-1020	Clearing & Grubbing - NL (Median)	3	20-Dec-18	02-Jan-19	0	█ Clearing & Grubbing - NL (Median)														
7103-RD-1540	12" Subbase / Curb Pad - NL (Media)	4	03-Jan-19	08-Jan-19	0	█ 12" Subbase / Curb Pad - NL (Median)														
7103-RD-1550	Type F Curb & Gutter - NL (Median)	3	09-Jan-19	11-Jan-19	0	█ Type F Curb & Gutter - NL (Median)														
7103-RD-1580	Back Base - NL (Median)	2	14-Jan-19	15-Jan-19	0	█ Back Base - NL (Median)														
7103-RD-1570	Traffic Separator - NL (Median)	5	14-Jan-19	18-Jan-19	0	█ Traffic Separator - NL (Median)														
7103-RD-1590	Sodding - NL (Median)	6	21-Jan-19	28-Jan-19	0	█ Sodding - NL (Median)														
<b>PHASE III</b>																				
7103-RD-1260	Mill 1.5' Main Lanes + OB + Struc (Ti)	4	16-Jan-19	21-Jan-19	0	█ Mill 1.5' Main Lanes + OB + Struc (Traffic-C) (1.5")														
7103-RD-1500	Signs Installation	7	16-Jan-19	24-Jan-19	2	█ Signs Installation;														
7103-RD-1430	Friction Course Traffic C FC-12.5 (1	5	22-Jan-19	28-Jan-19	0	█ Friction Course Traffic C FC-12.5 (1.5")														
7103-CL-3260	Punch List	5	22-Jan-19	28-Jan-19	0	█ Punch List														
7103-RD-1280	Pavement Marking	6	22-Jan-19	28-Jan-19	1	█ Pavement Marking														
7103-CL-3250	Substantial Completion	0	28-Jan-19	28-Jan-19	0	◆ Substantial Completion														

**SCHEDULE 1**

**LIST OF PROPOSED SBE-M/WBE CONSULTANT/SUBCONSULTANTS**

CO #1

PROJECT NAME: Northlake Boulevard and Military Trail

PROJECT NO. 2013519

NAME OF PRIME CONSULTANT: COMMUNITY ASPHALT CORP.

DESCRIPTION OF WORK: Roadway Construction

**PLEASE IDENTIFY ALL APPLICABLE CATEGORIES OF CONSULTANT/SUBCONSULTANTS**

Name, Address and Phone Number	(Check one or both Categories)		Consultant/Subcontractor Percentage of Work				
	M/WBE	SBE	Black	Hispanic	Women	Caucasian	Other (Please Specify)
NO SBE SUBCONTRACTOR USED	<input type="checkbox"/>	<input type="checkbox"/>	_____	_____	_____	_____	_____
	<input type="checkbox"/>	<input type="checkbox"/>	_____	_____	_____	_____	_____
	<input type="checkbox"/>	<input type="checkbox"/>	_____	_____	_____	_____	_____
	<input type="checkbox"/>	<input type="checkbox"/>	_____	_____	_____	_____	_____
	<input type="checkbox"/>	<input type="checkbox"/>	_____	_____	_____	_____	_____

(Please use additional sheets if necessary)

Total Bid Prices \$0.00

Total Value of SBE Participation 0.00%

- Note:
- The percentages listed on this form must be supported by the Subcontractor's prices included on Schedule 2 in order to be counted toward goal attainment.
  - Firms may be certified by Palm Beach County as an SBE and/or M/WBE. If firms are certified as both an SBE and M/WBE, please indicate the dollar amount uunder the appropriate category.
  - M/WBE information is being collected for tracking purposes only.