

PALM BEACH COUNTY
BOARD OF COUNTY COMMISSIONERS

AGENDA ITEM SUMMARY

Meeting Date:	January 15, 2019	Consent [X]	Regular []
		Public Hearing []	
Department:	Water Utilities Department		

I. EXECUTIVE BRIEF

Motion and Title: Staff recommends motion to approve: Work Authorization No. 4 to the Continuing Construction Contract for Wastewater Gravity Lines and Manhole Rehabilitation with Hinterland Group, Inc., for Sanitary Sewer Lining Project Lift Station Basin 4101 (Project) in the amount of \$1,062,018.68.

Summary: On December 5, 2017, the Board of County Commissioners (BCC) approved the Water Utilities Department (WUD) Continuing Contract for Wastewater Gravity Lines and Manhole Rehabilitation (R2017-1819) to Hinterland Group, Inc. Work Authorization No. 4 provides for the rehabilitation of approximately 17,000 linear feet of existing wastewater gravity pipelines and 110 manholes within Lift Station Basin 4101 located in Royal Palm Beach. The work will include cleaning of the gravity sewer pipelines and manholes, video inspection and rehabilitation of the pipelines and manholes where necessary. This Contract was procured under the requirements of the 2002 SBE Ordinance prior to the adoption of the amended Equal Business Ordinance on October 16, 2018. The Contract with Hinterland Group, Inc., provides for 94.9% SBE participation. Work Authorization No. 4 includes 100% SBE participation. The cumulative SBE participation to date, including Work Authorization No. 4 is 100%. Hinterland Group, Inc., is a Palm Beach County company. The Project is included in the FY 19 Capital Improvement Plan adopted by the BCC. (WUD Project 18-071) District 6 (MJ)

Background and Justification: Completion of the work provided for under Work Authorization No. 4 will restore the service life of the wastewater system assets, reduce ground water infiltration to sewer system, restore system capacity and improve the long-term operability of the County wastewater system.

Attachments:

1. Location Map
2. Four (4) Originals Work Authorizations No.4
3. ITS Summary of Certificates

Recommended By: Jim Steles 12-20-18
 Department Director Date

Approved By: Nancy L. Bolton 1/8/19
 Assistant County Administrator Date

II. FISCAL IMPACT ANALYSIS

A. Five Year Summary of Fiscal Impact:

Fiscal Years	2019	2020	2021	2022	2023
Capital Expenditures	<u>1,062,019</u>	<u>0</u>	<u>0</u>	<u>0</u>	<u>0</u>
Operating Costs	<u>0</u>	<u>0</u>	<u>0</u>	<u>0</u>	<u>0</u>
External Revenues	<u>0</u>	<u>0</u>	<u>0</u>	<u>0</u>	<u>0</u>
Program Income (County)	<u>0</u>	<u>0</u>	<u>0</u>	<u>0</u>	<u>0</u>
In-Kind Match County	<u>0</u>	<u>0</u>	<u>0</u>	<u>0</u>	<u>0</u>
NET FISCAL IMPACT	<u><u>1,062,019</u></u>	<u>0</u>	<u>0</u>	<u>0</u>	<u>0</u>
# ADDITIONAL FTE POSITIONS (Cumulative)	<u>0</u>	<u>0</u>	<u>0</u>	<u>0</u>	<u>0</u>

Budget Account No.: Fund 4011 Dept 721 Unit W031 Object 6547

Is Item Included in Current Budget? Yes X No

Does this item include the use of federal funds? Yes No X

Reporting Category N/A

B. Recommended Sources of Funds/Summary of Fiscal Impact:

One (1) time expenditure from user fees, connection fees and balance brought forward.

C. Department Fiscal Review: _____

III. REVIEW COMMENTS

A. OFMB Fiscal and/or Contract Development and Control Comments:

Paley 12/27/18 OFMB Dr. J. Jacobus 12/31/18 Contract Development and Control

B. Legal Sufficiency:

[Signature] 1/6/19
Assistant County Attorney

C. Other Department Review:

Department Director

This summary is not to be used as a basis for payment.

ATTACHMENT 1

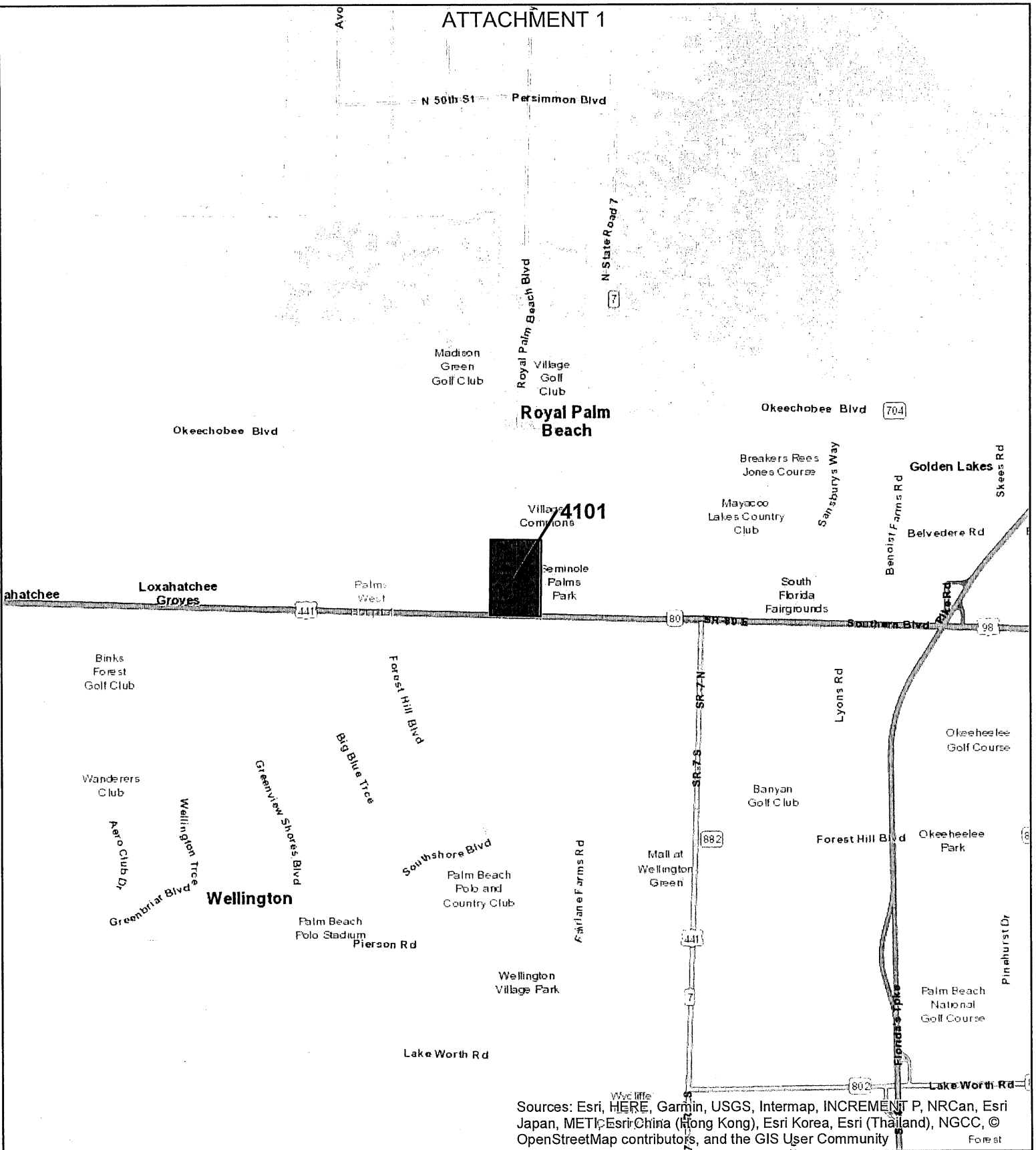

Sources: Esri, HERE, Garmin, USGS, Intermap, INCREMENT P, NRCan, Esri Japan, METI, Esri China (Hong Kong), Esri Korea, Esri (Thailand), NGCC, © OpenStreetMap contributors, and the GIS User Community



Palm Beach County
Water Utilities
Department
 8100 Forest Hill Blvd.
 West Palm Beach, FL 33416
 (561) 740-4600

Project Location Map
Sanitary Sewer Lining Project Lift Station Basin 4101
WUD No. 18-071
Legend
 Lift Station Basin Lining Project

Created by: Bill Kramer P.B.C.W.U.D. GIS Section • Date: 11/01/2018 • File: W:\GIS\PROJECTS\WUD CIP Packages\Conveyance Packages\CD-07 Collection System Rehab\WUD 18-071 Location Map.mxd

WORK AUTHORIZATION NO. 4

Palm Beach County Water Utilities Department
Wastewater Gravity Lines & Manhole Rehabilitation Continuing Construction Contract
Resolution #R2017-1819 Contract Dated 12-05-2017

Project Title: Sanitary Sewer Lining Project Lift Station Basin 4101

WUD Project No. 18-071

Contractor: Hinterland Group, Inc.

Address: 2051 W Blue Heron Blvd., West Palm Beach, FL 33404

Budget Line Item No. 4011 - 721 - W031 - 6547

District: 6

This Work Authorization provides for: Work includes rehabilitation of gravity sewer line segments in lift station network:4101. The project includes 110 manhole National Association of Sewer Service Companies (NASSCO) level 2 inspections and applicable required rehabilitation. All segments listed in attachment A will also be televised and lined accordingly. Includes all applicable restoration.

See **ATTACHMENT A** for detailed scope of services.

The Contract provides for 94.9 % SBE participation. This Work Authorization includes 100 % participation. The cumulative proposed SBE participation, including this authorization is 100 %.

1. Services completed by the Contractor to date:

See **ATTACHMENT B**.

2. Contractor shall begin work within ten (10) calendar days from the issuance of Notice to Proceed (NTP). Execution of the Project will be accomplished as follows from the issuance of the NTP:

Substantial Completion 335 Calendar Days
Final Construction Completion 365 Calendar Days

Liquidated damages will apply as follows:

\$ 1,000 per day past substantial completion date.
\$ 500 per day past final completion date.

Revised 4-12-18

3. The compensation to be paid to the Contractor for providing the requested services in accordance with the Contract Bid Prices is \$ 1,062,018.68
4. This Work Authorization does not amend, change, or modify the Contract which remains in full force and effect.
5. All Attachments to this Authorization are incorporated herein and made a part of this Work Authorization.

Revised 4-12-18

Palm Beach County Water Utilities Department

Wastewater Gravity Lines and Manhole Rehabilitation Continuing Construction Contract
Resolution # R2017-1819 Contract Dated 12-05-2017

Project Title: Sanitary Sewer Lining Project Lift Station Basin 4101

WUD Project No.: 18-071

IN WITNESS WHEREOF, this Work Authorization is accepted, subject to the terms, conditions and obligations of the aforementioned Contract.

PALM BEACH COUNTY, A POLITICAL SUBDIVISION OF THE STATE OF FLORIDA

Sharon R. Bock, Clerk &
Comptroller, Palm Beach County

Palm Beach County,
Board of County Commissioners

ATTEST:

Signed: _____

Signed: _____
Mack Bernard, Mayor

Typed Name: _____
Deputy Clerk

_____ Date
JCS

Approved as to Form and Legal
Sufficiency

CONTRACTOR:

Signed: _____

(Signature)

Typed Name: _____
County Attorney

BRETT KONCHAK, DIRECTOR
(Name and Title)

10/3/18
Date

STATE OF FLORIDA

COUNTY OF Palm Beach

The foregoing instrument was acknowledged before me this 3 day of October, 2018,
by Brett Konchak as Director of Operations
for Hinterland Group Inc.

(Signature of Notary Public - State of Florida)

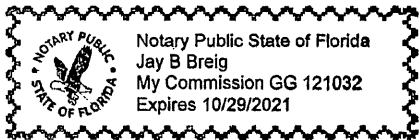

(Print, Type, or Stamp Commissioned Name of Notary Public)

Personally Known X OR Produced Identification _____ Type of Identification Produced _____

LIST OF ATTACHMENTS

WORK AUTHORIZATION NO. 4

Palm Beach County Water Utilities Department
Wastewater Gravity Lines and Manhole Rehabilitation Continuing Construction Contract
Resolution # R2017-1819 Contract Dated 12-05-2017

ATTACHMENT A	Scope of Work
ATTACHMENT B	Summary and Status of Work Authorizations
ATTACHMENT C	Public Construction Bond
ATTACHMENT D	Form of Guarantee
ATTACHMENT E	Work Authorization Schedule of Bid Items
ATTACHMENT F	SBE Schedule 1 and Schedule 2
ATTACHMENT G	Summary of SBE/Minority Business Tracking
ATTACHMENT H	Location Map

Revised 4-12-18

ATTACHMENT A

SCOPE OF WORK AUTHORIZATION # 4

PROJECT NO. 18-071

PROJECT TITLE: Sanitary Sewer Lining Project Lift Station Basin 4101

Contractor shall perform:

Work includes rehabilitation of gravity sewer line segments in lift station network:4101. The project includes 110 manhole National Association of Sewer Service Companies (NASSCO) level 2 inspections and applicable required rehabilitation. All segments listed in attachment A will also be televised and lined accordingly. Includes all applicable restoration.

Revised 4-12-18

ATTACHMENT A
PAGE 2 Segment List
WA #4 Project # 18-071

	FACILITYID	MATERIAL	DIAMETER	LENGTH (FT)		FACILITYID	MATERIAL	DIAMETER	LENGTH (FT)
1	10057-41010	VCP	8	89	36	10020-41010	VCP	8	381
2	10008-41010	VCP	8	33	37	10021-41010	VCP	8	299
3	10009-41010	VCP	8	275	38	10022-41010	VCP	8	299
4	10092-41010	VCP	8	298	39	10027-41010	VCP	8	306
5	10001-41010	VCP	8	73	40	10026-41010	VCP	8	306
6	10005-41010	VCP	8	356	41	10025-41010	VCP	8	302
7	10006-41010	VCP	10	59	42	10024-41010	VCP	8	303
8	10007-41010	DIP	10	12	43	10023-41010	VCP	8	380
9	10010-41010	VCP	8	129	44	10033-41010	VCP	8	321
10	10012-41010	VCP	8	262	45	10034-41010	VCP	8	320
11	10009-41010	VCP	8	74	46	10028-41010	VCP	8	270
12	10089-41010	VCP	8	339	47	10032-41010	VCP	8	321
13	10086-41010	VCP	8	94	48	10037-41010	VCP	8	353
14	10016-41010	VCP	8	252	49	10029-41010	VCP	8	270
15	10050-41010	VCP	8	251	50	10031-41010	VCP	8	375
16	10051-41010	VCP	8	302	51	10041-41010	VCP	8	376
17	10079-41010	VCP	8	265	52	10030-41010	VCP	8	265
18	10075-41010	VCP	8	308	53	10106-41010	VCP	8	321
19	10066-41010	VCP	8	154	54	10074-41010	VCP	8	307
20	10069-41010	VCP	8	227	55	10070-41010	VCP	8	226
21	10068-41010	VCP	8	140	56	10073-41010	VCP	8	147
22	10064-41010	VCP	8	263	57	10072-41010	VCP	8	394
23	10060-41010	VCP	8	306	58	10071-41010	VCP	8	120
24	10062-41010	VCP	8	242	59	10078-41010	VCP	8	393
25	10063-41010	VCP	8	306	60	10076-41010	VCP	8	401
26	10059-41010	VCP	8	261	61	10077-41010	VCP	8	249
27	10058-41010	VCP	8	268	62	10098-41010	VCP	8	377
28	10097-41010	VCP	8	270	63	10102-41010	VCP	8	338
29	10094-41010	VCP	8	270	64	10095-41010	VCP	8	335
30	10055-41010	VCP	8	207	65	10096-41010	VCP	8	320
31	10054-41010	VCP	8	83	66	10093-41010	VCP	8	242
32	10067-41010	VCP	8	382	67	10112-41010	VCP	8	63
33	10002-41010	VCP	8	262					
34	10003-41010	VCP	8	269					
35	10004-41010	VCP	8	141					

ATTACHMENT B

SUMMARY AND STATUS OF WORK AUTHORIZATIONS

Work Auth. No.	WUD Project No.	Title	Status	Project Total Amount	SBE Total Amount	SBE Participation %	Approved	
							By	Date
1	18-021	Gravity sewer pipe replacement of LS 8220	Approved	99,719.53	99,719.53	100	WUD	3/1/18
1.1	18-021	Supplement 1	Approved	\$19,315.49	\$19,315.49	100	WUD	6/4/18
2	18-018	Sanitary Sewer Lining Project Wellfield System 9	Approved	\$1,880,369.37	\$1,880,369.37	100	BCC	5/1/18
3	18-054	LS 244 Gravity Sewer Rehab Project	Approved	\$20,563.64	\$20,563.64	100	WUD	7/26/18
4	18-071	Sanitary Sewer Lining Project LS Basin 4101	Pending	\$1,062,018.68	\$1,062,018.68	100	BCC	Pending

ATTACHMENT C

PUBLIC CONSTRUCTION BOND – WORK AUTHORIZATION NO. 4
TO CONTINUING CONSTRUCTION CONTRACT
RESOLUTION NO. R2017-1819 Contract Dated 12-05-2017

PROJECT TITLE: Sanitary Sewer Lining Project Lift Station Basin 4101

WUD PROJECT NO.: 18-071

BOND NUMBER: 0219066

WORK AUTHORIZATION/BOND AMOUNT: \$1,062,018.68

CONTRACTOR'S NAME: Hinterland Group Inc.

CONTRACTOR'S ADDRESS: 2051 W Blue Heron Blvd

West Palm Beach, FL 33404

CONTRACTOR'S PHONE: 561-640-3503

SURETY COMPANY: Berkley Insurance Company

SURETY'S ADDRESS: 475 Steamboat Road

Greenwich, CT 06830

OWNER'S NAME: PALM BEACH COUNTY

OWNER'S ADDRESS: 8100 Forest Hill Boulevard
West Palm Beach, FL 33413

OWNER'S PHONE: (561) 493-6000

DESCRIPTION OF WORK: Sanitary Sewer Lining Project Basin 4101

PROJECT LOCATION: District 6

LEGAL DESCRIPTION: Range 41, Township 43, Section 35

Revised 4-12-18

PUBLIC CONSTRUCTION BOND

This Bond is issued in favor of the County conditioned on the full and faithful performance of the Work Authorization No. 4 to Continuing Construction Contract Resolution No. R2017-1819 dated on December 5th, 2017.

KNOW ALL MEN BY THESE PRESENTS: that Contractor and Surety, are held and firmly bound unto

Palm Beach County Board of County Commissioners
301 N. Olive Avenue
West Palm Beach, Florida 33401

as Obligee, herein called County, for the use and benefit of claimant as herein below defined, in the amount of One Million Sixty Two Thousand Eighteen Dollars and Sixty Eight Cents, \$1,062,018.68.

for the payment whereof Principal and Surety bind themselves, their heirs, personal representatives, executors, administrators, successors and assigns, jointly and severally, firmly by these presents.

WHEREAS,

Principal has by written agreement dated _____, 20____, entered into Work Authorization No. 4 to Continuing Construction Contract Resolution No. R2017-1819 with the County for

Work Authorization Project Name: Sanitary Sewer Lining Project Lift Station Basin 4101
Work Authorization Project No.: 18-071
Project Description: Contractor shall perform the construction scope of services as described herein: Work includes rehabilitation of gravity sewer lines in the following lift station network: 4101
Project Location: District 6

in accordance with Design Criteria Drawings and Specifications prepared by

Name of Design Firm: Palm Beach County Water Utilities Department
Location of Firm: 8100 Forest Hill Blvd., West Palm Beach FL 33413
Phone: 561-493-6000
Fax: _____

which Work Authorization No. 4 to Continuing Construction Contract Resolution No. R2017-1819 is by reference made a part hereof in its entirety, and is hereinafter referred to as the Work Authorization.

1. THE CONDITION OF THIS BOND is that if Principal:
 - a. Performs the Work Authorization dated _____, 20____, between Principal and County for the construction of the above project, the Work Authorization being made a part of this bond by reference, at the times and in the manner prescribed in the Work Authorization; and
 - b. Promptly makes payments to all claimants, as defined in Section 255.05, Florida Statutes, supplying Principal with labor, materials, or supplies, used directly or indirectly by Principal in the prosecution of the work provided for in the Work Authorization; and

Revised 4-12-18

c. Pays County all losses, damages (including liquidated damages), expenses, costs, and attorneys' fees, including appellate proceedings, that County sustains because of a default by Principal under the Work Authorization; and

d. Performs the guarantee of all work and materials furnished under the Work Authorization for the time specified in the Work Authorization; then this bond is void; otherwise it remains in full force.

2. Any changes in or under the contract documents and compliance or noncompliance with any formalities connected with the Work Authorization or the changes does not affect Surety's obligation under this bond and Surety waives notice of such changes.

3. The amount of this bond shall be reduced by and to the extent of any payment or payments made in good faith hereunder, inclusive of the payment by Surety of construction liens which may be filed of record against said improvement, whether or not claim for the amount of such lien be presented under and against the bond.

4. Principal and Surety expressly acknowledge that any and all provisions relating to consequential, delay and liquidated damages contained in the Work Authorization are expressly covered by and made a part of this Performance, Labor and Material Payment Bond. Principal and Surety acknowledge that any such provisions lie within their obligations and within the policy coverage's and limitations of this instrument.

5. Section 255.05, Florida Statutes, as amended, together with all notice and time provisions contained therein, is incorporated herein, by reference, in its entirety. Any action instituted by a claimant under this bond for payment must be in accordance with the notice and time limitation provisions in Section 255.05(2), Florida Statutes. This instrument regardless of its form, shall be construed and deemed a statutory bond issued in accordance with Section 255.05, Florida Statutes.

6. Any action brought under this instrument shall be brought in the state court of competent jurisdiction in Palm Beach County, Florida and not elsewhere.

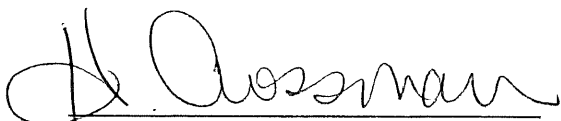

Witness



Print name



Witness

Candy Wagner

Print name

 (Seal)

Principal

Daniel Duke III

Print name

President

Title

 (Seal)

Surety

Taylor D. Wagner

Print name

Attorney-in-Fact

Title

Revised 4-12-18

ATTACHMENT D
FORM OF GUARANTEE

GUARANTEE FOR (Contractor and Surety Name) Hinterland Group Inc.
& Berkley Insurance Company

We the undersigned hereby guarantee that the **Wastewater Gravity Lines & Manhole Rehabilitation Continuing Contract, Contract, Resolution No. R2017-1819, Contract Dated 12-05-2017, WUD Project No. 18-071, Work Authorization No. 4**, Project Title: **Sanitary Sewer Lining Project Lift Station Basin 4101**, Palm Beach County, Florida, which we have constructed and bonded, has been done in accordance with the plans and specifications; that the work constructed will fulfill the requirements of the guaranties included in the Contract Documents. We agree to repair or replace any or all of our work, together with any work of others which may be damaged in so doing, that may prove to be defective in the workmanship or materials within a period of one year from the date of Final Completion of all of the above named work by the County of Palm Beach, State of Florida, without any expense whatsoever to said County of Palm Beach, ordinary wear and tear and unusual abuse or neglect excepted by the County. When correction work is started, it shall be carried through to completion.

In the event of our failure to acknowledge notice, and commence corrections of defective work within five (5) calendar days after being notified in writing by the Board of County Commissioners, Palm Beach County, Florida, we, collectively or separately, do hereby authorize Palm Beach County to proceed to have said defects repaired and made good at our expense and we will honor and pay the costs and charges therefore upon demand.

County and (contractor, engineer, architect as applicable) agree that the provisions of Florida Statute Chapter 558 shall not apply to this (contract, agreement as applicable).
(notice of completion filing date)

DATED _____
SEAL AND NOTARIAL ACKNOWLEDGMENT OF SURETY

Hinterland Group, Inc. (Seal)
(Contractor)

By:  Daniel Duke III
(Signature) (Printed Name)

Berkley Insurance Company (Seal)
(Surety)

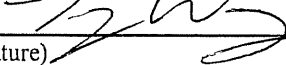
By:  Taylor D. Wagner
(Signature) (Printed Name)

Revised 4-12-18

POWER OF ATTORNEY
BERKLEY INSURANCE COMPANY
WILMINGTON, DELAWARE

NOTICE: The warning found elsewhere in this Power of Attorney affects the validity thereof. Please review carefully.

KNOW ALL MEN BY THESE PRESENTS, that BERKLEY INSURANCE COMPANY (the "Company"), a corporation duly organized and existing under the laws of the State of Delaware, having its principal office in Greenwich, CT, has made, constituted and appointed, and does by these presents make, constitute and appoint: *Daniel F. Wagner or Taylor D. Wagner of Wagner Bonding & Insurance, Inc. of Lakeland, FL* its true and lawful Attorney-in-Fact, to sign its name as surety only as delineated below and to execute, seal, acknowledge and deliver any and all bonds and undertakings, with the exception of Financial Guaranty Insurance, providing that no single obligation shall exceed **Fifty Million and 00/100 U.S. Dollars (U.S.\$50,000,000.00)**, to the same extent as if such bonds had been duly executed and acknowledged by the regularly elected officers of the Company at its principal office in their own proper persons.

This Power of Attorney shall be construed and enforced in accordance with, and governed by, the laws of the State of Delaware, without giving effect to the principles of conflicts of laws thereof. This Power of Attorney is granted pursuant to the following resolutions which were duly and validly adopted at a meeting of the Board of Directors of the Company held on January 25, 2010:

RESOLVED, that, with respect to the Surety business written by Berkley Surety, the Chairman of the Board, Chief Executive Officer, President or any Vice President of the Company, in conjunction with the Secretary or any Assistant Secretary are hereby authorized to execute powers of attorney authorizing and qualifying the attorney-in-fact named therein to execute bonds, undertakings, recognizances, or other suretyship obligations on behalf of the Company, and to affix the corporate seal of the Company to powers of attorney executed pursuant hereto; and said officers may remove any such attorney-in-fact and revoke any power of attorney previously granted; and further

RESOLVED, that such power of attorney limits the acts of those named therein to the bonds, undertakings, recognizances, or other suretyship obligations specifically named therein, and they have no authority to bind the Company except in the manner and to the extent therein stated; and further

RESOLVED, that such power of attorney revokes all previous powers issued on behalf of the attorney-in-fact named; and further

RESOLVED, that the signature of any authorized officer and the seal of the Company may be affixed by facsimile to any power of attorney or certification thereof authorizing the execution and delivery of any bond, undertaking, recognizance, or other suretyship obligation of the Company; and such signature and seal when so used shall have the same force and effect as though manually affixed. The Company may continue to use for the purposes herein stated the facsimile signature of any person or persons who shall have been such officer or officers of the Company, notwithstanding the fact that they may have ceased to be such at the time when such instruments shall be issued.

IN WITNESS WHEREOF, the Company has caused these presents to be signed and attested by its appropriate officers and its corporate seal hereunto affixed this 12th day of January, 2018.

Attest:

Berkley Insurance Company

(Seal)

By

By

Ira S. Lederman
Executive Vice President & Secretary

Jeffrey M. Hafter
Senior Vice President

WARNING: THIS POWER INVALID IF NOT PRINTED ON BLUE "BERKLEY" SECURITY PAPER.

STATE OF CONNECTICUT)

) ss:

COUNTY OF FAIRFIELD)

Sworn to before me, a Notary Public in the State of Connecticut, this 12th day of January, 2018, by Ira S. Lederman and Jeffrey M. Hafter who are sworn to me to be the Executive Vice President and Secretary and the Senior Vice President, respectively, of Berkley Insurance Company.

MARIA C. RUNDBAKEN
NOTARY PUBLIC
MY COMMISSION EXPIRES
APRIL 30, 2019

Maria C. Rundbaken
Notary Public, State of Connecticut

CERTIFICATE

I, the undersigned, Assistant Secretary of BERKLEY INSURANCE COMPANY, DO HEREBY CERTIFY that the foregoing is a true, correct and complete copy of the original Power of Attorney; that said Power of Attorney has not been revoked or rescinded and that the authority of the Attorney-in-Fact set forth therein, who executed the bond or undertaking to which this Power of Attorney is attached, is in full force and effect as of this date.

Given under my hand and seal of the Company, this _____ day of _____

(Seal)

Vincent P. Forte
Vincent P. Forte

WARNING - Any unauthorized reproduction or alteration of this document is prohibited. This power of attorney is void unless seals are readable and the certification seal at the bottom is embossed. The background imprint, warning and verification instructions (on reverse) must be in blue ink.

Please **verify the authenticity** of the instrument attached to this Power by:

Toll-Free Telephone: (800) 456-5486; or

Electronic Mail: BSGInquiry@berkleysurety.com

Any written notices, inquiries, claims or demands to the Surety on the bond attached to this Power should be directed to:

Berkley Surety
412 Mount Kemble Ave.
Suite 310N
Morristown, NJ 07960
Attention: Surety Claims Department

Or

Email: BSGClaim@berkleysurety.com

Please include with all communications the bond number and the name of the principal on the bond. Where a claim is being asserted, please set forth generally the basis of the claim. In the case of a payment or performance bond, please also identify the project to which the bond pertains.

Berkley Surety is a member company of W. R. Berkley Corporation that underwrites surety business on behalf of Berkley Insurance Company, Berkley Regional Insurance Company and Carolina Casualty Insurance Company.

ATTACHMENT E

Palm Beach County Water Utilities Department - Schedule of Bid Prices
WUD 16-094R - Continuing Contract For Wastewater Gravity Lines & Manhole Rehabilitation

Hinterland Group, Inc.

NO.	BID ITEM (Furnish and Install with Appurtenances)	QUANTITY	UNIT	UNIT PRICE	TOTAL
1	Point Repair (open trench), 4" through 8" Gravity Pipe (up to 5.9' deep)	50	L.F.	\$ 300.00	\$ 15,000.00
2	Point Repair (open trench), 4" through 8" Gravity Pipe (6' to 7.9' deep)	50	L.F.	\$ 320.00	\$ 16,000.00
3	Point Repair (open trench), 4" through 8" Gravity Pipe (8' to 9.9' deep)	50	L.F.	\$ 370.00	\$ 18,500.00
4	Point Repair (open trench), 4" through 8" Gravity Pipe (10' to 11.9' deep)	50	L.F.	\$ 450.00	\$ 22,500.00
5	Point Repair (open trench), 4" through 8" Gravity Pipe (12' to 13.9' deep)	50	L.F.	\$ 520.00	\$ 26,000.00
6	Point Repair (open trench), 4" through 8" Gravity Pipe (14' to 16' deep)	50	L.F.	\$ 620.00	\$ 31,000.00
7	Point Repair (open trench), 10" through 12" Gravity Pipe (up to 5.9' deep)	20	L.F.	\$ 200.00	\$ 4,000.00
8	Point Repair (open trench), 10" through 12" Gravity Pipe (6' to 7.9' deep)	20	L.F.	\$ 250.00	\$ 5,000.00
9	Point Repair (open trench), 10" through 12" Gravity Pipe (8' to 9.9' deep)	20	L.F.	\$ 400.00	\$ 8,000.00
10	Point Repair (open trench), 10" through 12" Gravity Pipe (10' to 11.9' deep)	20	L.F.	\$ 450.00	\$ 9,000.00
11	Point Repair (open trench), 10" through 12" Gravity Pipe (12' to 13.9' deep)	20	L.F.	\$ 520.00	\$ 10,400.00
12	Point Repair (open trench), 10" through 12" Gravity Pipe (14' to 16' deep)	20	L.F.	\$ 650.00	\$ 13,000.00
13	Single Lateral Replacement with Cleanout Installation (Removal and Installation) (up to 5.9' deep)	1	L.F.	\$ 120.00	\$ 120.00
14	Double Lateral Replacement with Cleanout Installation (Removal and Installation) (up to 5.9' deep)	1	L.F.	\$ 120.00	\$ 120.00
15	Single Lateral Replacement with Cleanout Installation (Removal and Installation) (6' to 7.9' deep)	1	L.F.	\$ 140.00	\$ 140.00
16	Double Lateral Replacement with Cleanout Installation (Removal and Installation) (6' to 7.9' deep)	1	L.F.	\$ 150.00	\$ 150.00
17	Single Lateral Replacement with Cleanout Installation (Removal and Installation) (8' to 9.9' deep)	1	L.F.	\$ 140.00	\$ 140.00
18	Double Lateral Replacement with Cleanout Installation (Removal and Installation) (8' to 9.9' deep)	1	L.F.	\$ 170.00	\$ 170.00
19	Single Lateral Replacement with Cleanout Installation (Removal and Installation) (10' to 11.9' deep)	1	L.F.	\$ 190.00	\$ 190.00
20	Double Lateral Replacement with Cleanout Installation (Removal and Installation) (10' to 11.9' deep)	1	L.F.	\$ 200.00	\$ 200.00
21	Single Lateral Replacement with Cleanout Installation (Removal and Installation) (12' to 13.9' deep)	1	L.F.	\$ 150.00	\$ 150.00
22	Double Lateral Replacement with Cleanout Installation (Removal and Installation) (12' to 13.9' deep)	1	L.F.	\$ 200.00	\$ 200.00
23	Single Lateral Replacement with Cleanout Installation (Removal and Installation) (14' to 16' deep)	1	L.F.	\$ 180.00	\$ 180.00
24	Double Lateral Replacement with Cleanout Installation (Removal and Installation) (14' to 16' deep)	1	L.F.	\$ 220.00	\$ 220.00
25	Replacement/Repair (open trench up to 20' pipe section), 4" to 8" Force Main (3' to 8' deep)	2	Each	\$ 4,000.00	\$ 8,000.00
26	Replacement/Repair (open trench up to 20' pipe section), 10" to 16" Force Main (3' to 8' deep)	2	Each	\$ 6,000.00	\$ 12,000.00
27	Replacement/Repair (open trench up to 20' pipe section), 18" to 24" Force Main (3' to 8' deep)		Each	\$ 10,000.00	\$ -
28	Gravity Sewer Main Cleaning and TV Inspection (6" through 12" Pipe)	17300	L.F.	\$ 1.25	\$ 21,625.00
29	Gravity Sewer Main Cleaning and TV Inspection (15" through 30" Pipe)		L.F.	\$ 3.50	\$ -
30	Gravity Sewer Lateral (4" through 8") Cleaning and TV Inspection from Main (up to 30')	50	Each	\$ 180.00	\$ 9,000.00
31	Gravity Sewer Lateral (4" through 8") Cleaning and TV Inspection from Main (greater than 30')	100	L.F.	\$ 0.10	\$ 10.00
32	Mechanical Root and/or Grease Removal (12" pipe or smaller)	3000	L.F.	\$ 4.00	\$ 12,000.00
33	Mechanical Root and/or Grease Removal (15" to 30" pipe)		L.F.	\$ 6.00	\$ -
34	Mechanical Tuberculation/Concrete Removal 12" pipe or smaller	700	L.F.	\$ 10.00	\$ 7,000.00
35	Internal (through Pipe) Removal of Protruding Service Connection		Each	\$ 200.00	\$ -
36	Exploratory Excavation In Grass or Non-paved Area (up to 5' deep)	2	Each	\$ 600.00	\$ 1,200.00
37	Exploratory Excavation In Asphalt or Concrete Area (up to 5' deep)	2	Each	\$ 800.00	\$ 1,600.00
38	Exploratory Excavation in Grass or Non-paved Area (greater than 5' deep)	1	V.F.	\$ 50.00	\$ 50.00
39	Exploratory Excavation in Asphalt or Concrete Area (greater than 5' deep)	1	V.F.	\$ 50.00	\$ 50.00

40	Bypass pumping 4" through 10" Force Main	50	Day	\$	750.00	\$	37,500.00
41	Bypass pumping 12" through 16" Force Main		Day	\$	1,000.00	\$	-
42	Bypass pumping 18" through 30" Force Main		Day	\$	2,000.00	\$	-
43	Cleanout installation (open trench) in grass area (up to 5' deep)	5	Each	\$	400.00	\$	2,000.00
44	Cleanout Installation (open trench) in asphalt area (up to 5' deep)	5	Each	\$	400.00	\$	2,000.00
45	Cleanout Installation (open trench) in concrete area (up to 5' deep)	5	Each	\$	500.00	\$	2,500.00
46	Cleanout Installation (for grass, asphalt or concrete surfaces) per V.F. beyond 5' in depth		V.F.	\$	100.00	\$	-
47	Install CIPP Liner for 6" Gravity Sewer Main (up to 8' deep)	1500	L.F.	\$	50.00	\$	75,000.00
48	Install CIPP Liner for 8" Gravity Sewer Main (up to 7.9')	3000	L.F.	\$	26.00	\$	78,000.00
49	Install CIPP Liner for 8" Gravity Sewer Main (8' to 11.9' deep)	12800	L.F.	\$	26.00	\$	332,800.00
50	Install CIPP Liner for 8" Gravity Sewer Main (12' to 16' deep)	1500	L.F.	\$	26.00	\$	39,000.00
51	Install CIPP Liner for 10" Gravity Sewer Main (up to 7.9')	20	L.F.	\$	32.00	\$	640.00
52	Install CIPP Liner for 10" Gravity Sewer Main (8' to 11.9' deep)	100	L.F.	\$	32.00	\$	3,200.00
53	Install CIPP Liner for 10" Gravity Sewer Main (12' to 16' deep)	10	L.F.	\$	34.00	\$	340.00
54	Install CIPP Liner for 12" Gravity Sewer Main (up to 7.9')		L.F.	\$	38.00	\$	-
55	Install CIPP Liner for 12" Gravity Sewer Main (8' to 11.9' deep)		L.F.	\$	38.00	\$	-
56	Install CIPP Liner for 12" Gravity Sewer Main (12' to 16' deep)		L.F.	\$	42.00	\$	-
57	Install CIPP Liner for 15" Gravity Sewer Main (up to 7.9')		L.F.	\$	48.00	\$	-
58	Install CIPP Liner for 15" Gravity Sewer Main (8' to 11.9' deep)		L.F.	\$	48.00	\$	-
59	Install CIPP Liner for 15" Gravity Sewer Main (12' to 16' deep)		L.F.	\$	50.00	\$	-
60	Sewer Lateral grouting in preparation for lining (max. up to 10' long)	10	Each	\$	95.00	\$	950.00
61	Install T-liner in 6" to 12" Sewer Mains with 4" to 6" Sewer Laterals (include 25' of lateral at all depths)	10	Each	\$	3,400.00	\$	34,000.00
62	Install CIPP liner in 4" to 6" laterals at all depths (25' of lateral)	20	Each	\$	2,300.00	\$	46,000.00
63	Install CIPP liner in 4" to 6" laterals at all depths (per L.F. beyond 25' of lateral length)	100	L.F.	\$	40.00	\$	4,000.00
64	Install CIPP mainline/lateral connection interface seal in any size main with 4" to 6" laterals, all depths	3	Each	\$	2,800.00	\$	8,400.00
65	8"x6" PVC Tee or Wye with Coupling	5	Each	\$	300.00	\$	1,500.00
66	10"x6" PVC Tee or Wye with Coupling	5	Each	\$	400.00	\$	2,000.00
67	12"x6" PVC Tee or Wye with Coupling		Each	\$	500.00	\$	-
68	Seal visible infiltration through manhole walls, bench and invert (brick manhole)	2	Each	\$	500.00	\$	1,000.00
69	Seal visible infiltration through manhole walls, bench and invert (concrete manhole)	10	Each	\$	500.00	\$	5,000.00
70	Repair Sewer Manhole bench and invert	10	Each	\$	350.00	\$	3,500.00
71	Replace Sewer Manhole bench and invert	5	Each	\$	450.00	\$	2,250.00
72	Wall Repair/Build Up for Excessive Interior Wall Surface Loss of Sewer Manhole	50	SQ. FT.	\$	20.00	\$	1,000.00
73	Replace Sewer Manhole Ring & Covers (in street pavement)	5	Each	\$	900.00	\$	4,500.00
74	Replace Sewer Manhole Ring & Covers (in non-paved area)	5	Each	\$	750.00	\$	3,750.00
75	Install Sewer Manhole Inflow Protectors	10	Each	\$	55.00	\$	550.00
76	Install New Standard Precast Concrete Sewer Manhole (4-ft Diam. 4' to 5.9' feet deep)		Each	\$	8,000.00	\$	-
77	Install New Standard Precast Concrete Sewer Manhole (4-ft Diam. 6' to 7.9' feet deep)		Each	\$	8,700.00	\$	-
78	Install New Standard Precast Concrete Sewer Manhole (4-ft Diam. 8' to 9.9' feet deep)		Each	\$	9,800.00	\$	-
79	Install New Standard Precast Concrete Sewer Manhole (4-ft Diam. 10' to 11.9' feet deep)		Each	\$	10,600.00	\$	-
80	Install New Standard Precast Concrete Sewer Manhole (4-ft Diam. 12' to 13.9' feet deep)		Each	\$	13,000.00	\$	-
81	Install New Standard Precast Concrete Sewer Manhole (4-ft Diam. 14' to 16' feet deep)		Each	\$	16,000.00	\$	-
82	Install New Drop Connection Precast Concrete Sewer Manhole (4-ft Diam. 4' to 5.9' feet deep)		Each	\$	6,500.00	\$	-
83	Install New Drop Connection Precast Concrete Sewer Manhole (4-ft Diam. 6' to 7.9' feet deep)		Each	\$	7,400.00	\$	-
84	Install New Drop Connection Precast Concrete Sewer Manhole (4-ft Diam. 8' to 9.9' feet deep)		Each	\$	8,600.00	\$	-

85	Install New Drop Connection Precast Concrete Sewer Manhole (4-ft Diam. 10' to 11.9' feet deep)		Each	\$	8,600.00	\$	-
86	Install New Drop Connection Precast Concrete Sewer Manhole (4-ft Diam. 12' to 13.9' feet deep)		Each	\$	10,000.00	\$	-
87	Install New Drop Connection Precast Concrete Sewer Manhole (4-ft Diam. 14' to 16' feet deep)		Each	\$	12,000.00	\$	-
88	Install 6" through 12" PVC Drop Pipe For Manholes (for all depths)		Each	\$	600.00	\$	-
89	Demolition/Removal & Disposal Existing Sewer Manhole		Each	\$	4,500.00	\$	-
90	Install Coating to Sewer Manhole (4-ft Diam. Existing Brick Manhole)		V.F.	\$	220.00	\$	-
91	Install Coating to Sewer Manhole (4-ft Diam. Existing Precast Concrete Manhole)	100	V.F.	\$	200.00	\$	20,000.00
92	Install Thermo-Plastic Cast-In Liner to Sewer Manhole (4-ft Diam. Existing Precast Concrete Manhole)		V.F.	\$	250.00	\$	-
93	Asphalt Driveway Replacement (Restoration)	110	SQ. YD.	\$	40.00	\$	4,400.00
94	Concrete Driveway Replacement (Restoration)	110	SQ. YD.	\$	40.00	\$	4,400.00
95	Asphalt Pavement Removal	110	SQ. YD.	\$	12.00	\$	1,320.00
96	Concrete Pavement Removal	110	SQ. YD.	\$	14.00	\$	1,540.00
97	Asphalt Pavement Overlay (1.5" thick, Asphalt Type S-III: 20 to 100 tons per work area)	8	Tons	\$	250.00	\$	2,000.00
98	Concrete Sidewalk Replacement		SQ. YD.	\$	45.00	\$	-
99	Asphalt Sidewalk Replacement		SQ. YD.	\$	40.00	\$	-
100	Concrete Curb and Gutter Replacement		L.F.	\$	35.00	\$	-
101	Density Test	10	Each	\$	45.00	\$	450.00
102	Proctor Test	2	Each	\$	100.00	\$	200.00
103	Sod Replacement (St Augustine, Bahia or Bermuda)	100	SQ. YD.	\$	4.00	\$	400.00
104	Demucking with Imported Clean Fill		CU. YD.	\$	15.00	\$	-
105	Maintenance of Traffic (M.O.T.)	17300	L.F.	\$	1.00	\$	17,300.00
106	Preconstruction Manhole Survey (Condition Assessment)		Each	\$	40.00	\$	-
107	Smoke Testing of Gravity Sewer Mains and Laterals		L.F.	\$	0.35	\$	-
108	4" Line Stop		Each	\$	2,500.00	\$	-
109	6" Line Stop		Each	\$	3,000.00	\$	-
110	8" Line Stop		Each	\$	3,400.00	\$	-
111	10" Line Stop		Each	\$	4,100.00	\$	-
112	12" Line Stop		Each	\$	4,400.00	\$	-
113	16" Line Stop		Each	\$	7,200.00	\$	-
114	Pre-Construction Video	17300	L.F.	\$	0.50	\$	8,650.00
115	8" DIP/PVC C-900 Gravity Sanitary Sewer Main 0' to 8' deep	20	L.F.	\$	100.00	\$	2,000.00
116	8" DIP/PVC C-900 Gravity Sanitary Sewer Main 8' to 16' deep	20	L.F.	\$	120.00	\$	2,400.00
117	8" DIP/PVC C-900 Gravity Sanitary Sewer Main 16' to 22' deep		L.F.	\$	160.00	\$	-
118	10" DIP/PVC C-900 Gravity Sanitary Sewer Main 14' to 16' deep		L.F.	\$	150.00	\$	-
119	10" DIP/PVC C-900 Gravity Sanitary Sewer Main 16' to 18' deep		L.F.	\$	160.00	\$	-
120	Removal of Existing Coating/Lining	50	SQ. FT.	\$	5.00	\$	250.00
	(A) SUBTOTAL BASE BID (Bid Item 1-120, plus Bid Item 122)						\$ 1,026,105.00
121	Mobilization/Demobilization (3.5% of Subtotal Base Bid Price (A))	1	L.S.				\$ 35,913.68
122	Additional Work not included in Bid Items (15% of Subtotal Base Bid Price (A))						\$ -
***	Level 2 MACP Manhole Inspection	110	Each	\$	150.00	\$	16,500.00
	(B) SUBTOTAL ADDITIONAL WORK BID PRICE (Bid Item 122)						\$ 16,500.00
	TOTAL BID PRICE						\$ 1,062,018.68

**ATTACHMENT F
SCHEDULE 1
LIST OF PROPOSED SBE-M/WBE PARTICIPATION**

PROJECT NAME OR BID NAME: Sanitary Sewer Lining Project Basin 4101 PROJECT NO. OR BID NO.: 18-071
 NAME OF PRIME BIDDER: Hinterland Group Inc. ADDRESS: 2051 W Blue Heron Blvd Riviera Beach
 CONTACT PERSON: Brett Konchak PHONE NO.: 954 648 7758 FAX NO.: _____
 BID OPENING DATE: _____ USER DEPARTMENT: WUD

THIS DOCUMENT IS TO BE COMPLETED BY THE PRIME CONTRACTOR AND SUBMITTED WITH BID PACKET. PLEASE LIST THE NAME, CONTACT INFORMATION AND DOLLAR AMOUNT AND/OR PERCENTAGE OF WORK TO BE COMPLETED BY ALL SBE -M/WBE'S ON THIS PROJECT. IF THE PRIME IS AN SBE-M/WBE, PLEASE ALSO LIST THE NAME, CONTACT INFORMATION AND DOLLAR AMOUNT AND/OR PERCENTAGE OF WORK TO BE COMPLETED BY THE PRIME ON THIS PROJECT. THE PRIME AFFIRMS THAT IT WILL MONITOR THE SBES LISTED TO ENSURE THE SBES PERFORM THE WORK WITH ITS OWN WORKFORCE.

Hinterland Group Inc.

Name, Address and Phone Number	(Check one or both Categories)		DOLLAR AMOUNT AND/OR PERCENTAGE OF WORK				
	<u>M/WBE</u> Minority Business	<u>SBE</u> Small Business	Black	Hispanic	Women	Caucasian	Other (Please Specify)
Hinterland Group Inc. 20151 W Blue Heron Blvd 1. Riviera Beach, Fl 33404 561-640-3503	<input type="checkbox"/>	<input checked="" type="checkbox"/>	_____	_____	_____	100%	_____
2.	<input type="checkbox"/>	<input type="checkbox"/>	_____	_____	_____	_____	_____
3.	<input type="checkbox"/>	<input type="checkbox"/>	_____	_____	_____	_____	_____
4.	<input type="checkbox"/>	<input type="checkbox"/>	_____	_____	_____	_____	_____
5.	<input type="checkbox"/>	<input type="checkbox"/>	_____	_____	_____	_____	_____
(Please use additional sheets if necessary)	Total		_____	_____	_____	100%	_____

Total Bid Price \$ 1,062,018.68 Total SBE-M/WBE Participation Dollar Amount and/or Percentage of Work \$1,062,018.68

I hereby certify that the above information accurate to the best of my knowledge: _____ CIPP Director
 Signature Title

- NOTE:
- The amount listed on this form for a SBE-M/WBE Prime or Subcontractor must be supported by price or percentage listed on the signed Schedule 2 or signed proposal in order to be counted toward goal attainment.
 - Firms may be certified by Palm Beach County as an SBE and/or M/WBE. If firms are certified as both an SBE and M/WBE, please indicate the dollar amount and/or percentage under the appropriate category.
 - M/WBE information is being collected for tracking purposes only

ATTACHMENT F

OSBA SCHEDULE 2 LETTER OF INTENT TO PERFORM AS AN SBE-M/WBE

This document must be completed by ALL SBE-M/WBE's and submitted with this bid packet. Specify in detail, the particular work items to be performed and the dollar amount and/or percentage for each work item. SBE credit will only be given for items which the SBE-M/WBE's is certified to perform. Failure to properly complete Schedule 2 will result in your SBE participation not being counted.

PROJECT NUMBER: 18-071 PROJECT NAME: SANITARY SEWER LINING PROJECT BASIN 4101

TO: Hinterland Group Inc.
(Name of Prime Bidder)

The undersigned is certified by Palm Beach County as a - (check one or more, as applicable):

Small Business Enterprise Minority Business Enterprise _____
 Black _____ Hispanic _____ Women _____ Caucasian Other (Please Specify) _____

Date of Palm Beach County Certification: DECEMBER 10th 2015

The undersigned is prepared to perform the following described work in connection with the above project. Additional Sheets May Be Used As Necessary

Line Item/ Lot No.	Item Description	Qty/Units All	Unit Price As Noted	Total Price/ Percentage 100%
	All Items			
	Detail on Attachment F Page 2-4			

at the following price or percentage 100%
(SBE Prime or Subcontractor's Quote)

and will enter into a formal agreement for work with you contingent upon your execution of a contract with Palm Beach County.

If undersigned intends to sub-subcontract any portion of this job to a certified SBE-M/WBE or a non-SBE subcontractor, please list the name of that subcontractor and the amount below.

Price or Percentage _____
(Name of Subcontractor)

The Prime affirms that it will monitor the SBE-M/WBE listed to ensure the SBE-M/WBE perform the work with their own work force. The undersigned SBE-M/WBE Prime or SBE-M/WBE subcontractor affirms that it has the resources necessary to perform the work listed without subcontracting to a non-certified SBE or any other certified SBE subcontractors except as noted above.

The undersigned subcontractor understands that the provision of this form to Prime Bidder does not prevent Subcontractor from providing quotations to other bidders.

Hinterland Group Inc

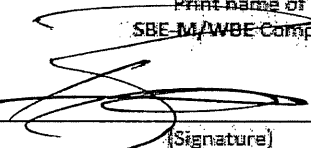
Print name of SBE-M/WBE Company
 By: 
 (Signature)

Brett Konchak / CIPP Director
 Print name/title of person executing on behalf of SBE-M/WBE

Date: 10/3/18

ATTACHMENT F Page 2

Palm Beach County Water Utility Department
 16-094R Continuing Construction Contract-Resolution: R2017-1819 Contract Dated: 12-05-2017 Work Authorization No.: 4
 Contractor Name: Hinterland Group Inc.
 Project Name: Sanitary Sewer Lining Project BASIN 4101
 WUD Project No.: 18-071

Palm Beach County Water Utilities Department - Schedule of Bid Prices					
Project No.: WUD 16-094R - Continuing Contract For Wastewater Gravity Lines & Manhole Rehabilitation					
NO.	BID ITEM (Furnish and Install with Appurtenances)	QUANTITY	UNIT	Hinterland Group, Inc. UNIT PRICE	TOTAL
1	Point Repair (open trench), 4" through 8" Gravity Pipe (up to 5.9' deep)	50	L.F.	\$ 300.00	\$ 15,000.00
2	Point Repair (open trench), 4" through 8" Gravity Pipe (6' to 7.9' deep)	50	L.F.	\$ 320.00	\$ 16,000.00
3	Point Repair (open trench), 4" through 8" Gravity Pipe (8' to 9.9' deep)	50	L.F.	\$ 370.00	\$ 18,500.00
4	Point Repair (open trench), 4" through 8" Gravity Pipe (10' to 11.9' deep)	50	L.F.	\$ 450.00	\$ 22,500.00
5	Point Repair (open trench), 4" through 8" Gravity Pipe (12' to 13.9' deep)	50	L.F.	\$ 520.00	\$ 26,000.00
6	Point Repair (open trench), 4" through 8" Gravity Pipe (14' to 16' deep)	50	L.F.	\$ 620.00	\$ 31,000.00
7	Point Repair (open trench), 10" through 12" Gravity Pipe (up to 5.9' deep)	20	L.F.	\$ 200.00	\$ 4,000.00
8	Point Repair (open trench), 10" through 12" Gravity Pipe (6' to 7.9' deep)	20	L.F.	\$ 250.00	\$ 5,000.00
9	Point Repair (open trench), 10" through 12" Gravity Pipe (8' to 9.9' deep)	20	L.F.	\$ 400.00	\$ 8,000.00
10	Point Repair (open trench), 10" through 12" Gravity Pipe (10' to 11.9' deep)	20	L.F.	\$ 450.00	\$ 9,000.00
11	Point Repair (open trench), 10" through 12" Gravity Pipe (12' to 13.9' deep)	20	L.F.	\$ 520.00	\$ 10,400.00
12	Point Repair (open trench), 10" through 12" Gravity Pipe (14' to 16' deep)	20	L.F.	\$ 650.00	\$ 13,000.00
13	Single Lateral Replacement with Cleanout Installation (Removal and Installation) (up to 5.9' deep)	1	L.F.	\$ 120.00	\$ 120.00
14	Double Lateral Replacement with Cleanout Installation (Removal and Installation) (up to 5.9' deep)	1	L.F.	\$ 120.00	\$ 120.00
15	Single Lateral Replacement with Cleanout Installation (Removal and Installation) (6' to 7.9' deep)	1	L.F.	\$ 140.00	\$ 140.00
16	Double Lateral Replacement with Cleanout Installation (Removal and Installation) (6' to 7.9' deep)	1	L.F.	\$ 150.00	\$ 150.00
17	Single Lateral Replacement with Cleanout Installation (Removal and Installation) (8' to 9.9' deep)	1	L.F.	\$ 140.00	\$ 140.00
18	Double Lateral Replacement with Cleanout Installation (Removal and Installation) (8' to 9.9' deep)	1	L.F.	\$ 170.00	\$ 170.00
19	Single Lateral Replacement with Cleanout Installation (Removal and Installation) (10' to 11.9' deep)	1	L.F.	\$ 190.00	\$ 190.00
20	Double Lateral Replacement with Cleanout Installation (Removal and Installation) (10' to 11.9' deep)	1	L.F.	\$ 200.00	\$ 200.00
21	Single Lateral Replacement with Cleanout Installation (Removal and Installation) (12' to 13.9' deep)	1	L.F.	\$ 150.00	\$ 150.00
22	Double Lateral Replacement with Cleanout Installation (Removal and Installation) (12' to 13.9' deep)	1	L.F.	\$ 200.00	\$ 200.00
23	Single Lateral Replacement with Cleanout Installation (Removal and Installation) (14' to 16' deep)	1	L.F.	\$ 180.00	\$ 180.00
24	Double Lateral Replacement with Cleanout Installation (Removal and Installation) (14' to 16' deep)	1	L.F.	\$ 220.00	\$ 220.00
25	Replacement/Repair (open trench up to 20' pipe section), 4" to 8" Force Main (3' to 8' deep)	2	Each	\$ 4,000.00	\$ 8,000.00
26	Replacement/Repair (open trench up to 20' pipe section), 10" to 16" Force Main (3' to 8' deep)	2	Each	\$ 6,000.00	\$ 12,000.00
27	Replacement/Repair (open trench up to 20' pipe section), 18" to 24" Force Main (3' to 8' deep)		Each	\$ 10,000.00	\$ -
28	Gravity Sewer Main Cleaning and TV Inspection (6" through 12" Pipe)	17300	L.F.	\$ 1.25	\$ 21,625.00
29	Gravity Sewer Main Cleaning and TV Inspection (15" through 30" Pipe)		L.F.	\$ 3.50	\$ -
30	Gravity Sewer Lateral (4" through 8") Cleaning and TV Inspection from Main (up to 30')	50	Each	\$ 180.00	\$ 9,000.00
31	Gravity Sewer Lateral (4" through 8") Cleaning and TV Inspection from Main (greater than 30')	100	L.F.	\$ 0.10	\$ 10.00
32	Mechanical Root and/or Grease Removal (12" pipe or smaller)	3000	L.F.	\$ 4.00	\$ 12,000.00
33	Mechanical Root and/or Grease Removal (15" to 30" pipe)		L.F.	\$ 6.00	\$ -
34	Mechanical Tuberculation/Concrete Removal 12" pipe or smaller)	700	L.F.	\$ 10.00	\$ 7,000.00
35	Internal (through Pipe) Removal of Protruding Service Connection		Each	\$ 200.00	\$ -
36	Exploratory Excavation in Grass or Non-paved Area (up to 5' deep)	2	Each	\$ 600.00	\$ 1,200.00
37	Exploratory Excavation in Asphalt or Concrete Area (up to 5' deep)	2	Each	\$ 800.00	\$ 1,600.00
38	Exploratory Excavation in Grass or Non-paved Area (greater than 5' deep)	1	V.F.	\$ 50.00	\$ 50.00
39	Exploratory Excavation in Asphalt or Concrete Area (greater than 5' deep)	1	V.F.	\$ 50.00	\$ 50.00
40	Bypass pumping 4" through 10" Force Main	50	Day	\$ 750.00	\$ 37,500.00
41	Bypass pumping 12" through 16" Force Main		Day	\$ 1,000.00	\$ -

ATTACHMENT F Page 3

42	Bypass pumping 18" through 30" Force Main		Day	\$	2,000.00	\$	-
43	Cleanout installation (open trench) in grass area (up to 5' deep)	5	Each	\$	400.00	\$	2,000.00
44	Cleanout installation (open trench) in asphalt area (up to 5' deep)	5	Each	\$	400.00	\$	2,000.00
45	Cleanout installation (open trench) in concrete area (up to 5' deep)	5	Each	\$	500.00	\$	2,500.00
46	Cleanout Installation (for grass, asphalt or concrete surfaces) per V.F. beyond 5' in depth		V.F.	\$	100.00	\$	-
47	Install CIPP Liner for 6" Gravity Sewer Main (up to 8' deep)	1500	L.F.	\$	50.00	\$	75,000.00
48	Install CIPP Liner for 8" Gravity Sewer Main (up to 7.9')	3000	L.F.	\$	26.00	\$	78,000.00
49	Install CIPP Liner for 8" Gravity Sewer Main (8' to 11.9' deep)	12800	L.F.	\$	26.00	\$	332,800.00
50	Install CIPP Liner for 8" Gravity Sewer Main (12' to 16' deep)	1500	L.F.	\$	26.00	\$	39,000.00
51	Install CIPP Liner for 10" Gravity Sewer Main (up to 7.9')	20	L.F.	\$	32.00	\$	640.00
52	Install CIPP Liner for 10" Gravity Sewer Main (8' to 11.9' deep)	100	L.F.	\$	32.00	\$	3,200.00
53	Install CIPP Liner for 10" Gravity Sewer Main (12' to 16' deep)	10	L.F.	\$	34.00	\$	340.00
54	Install CIPP Liner for 12" Gravity Sewer Main (up to 7.9')		L.F.	\$	38.00	\$	-
55	Install CIPP Liner for 12" Gravity Sewer Main (8' to 11.9' deep)		L.F.	\$	38.00	\$	-
56	Install CIPP Liner for 12" Gravity Sewer Main (12' to 16' deep)		L.F.	\$	42.00	\$	-
57	Install CIPP Liner for 15" Gravity Sewer Main (up to 7.9')		L.F.	\$	48.00	\$	-
58	Install CIPP Liner for 15" Gravity Sewer Main (8' to 11.9' deep)		L.F.	\$	48.00	\$	-
59	Install CIPP Liner for 15" Gravity Sewer Main (12' to 16' deep)		L.F.	\$	50.00	\$	-
60	Sewer Lateral grouting in preparation for lining (max. up to 10' long)	10	Each	\$	95.00	\$	950.00
61	Install T-liner in 6" to 12" Sewer Mains with 4" to 6" Sewer Laterals (include 25' of lateral at all depths)	10	Each	\$	3,400.00	\$	34,000.00
62	Install CIPP liner in 4" to 6" laterals at all depths (25' of lateral)	20	Each	\$	2,300.00	\$	46,000.00
63	Install CIPP liner in 4" to 6" laterals at all depths (per L.F. beyond 25' of lateral length)	100	L.F.	\$	40.00	\$	4,000.00
64	Install CIPP mainline/lateral connection interface seal in any size main with 4" to 6" laterals, all depths	3	Each	\$	2,800.00	\$	8,400.00
65	8"x6" PVC Tee or Wye with Coupling	5	Each	\$	300.00	\$	1,500.00
66	10"x6" PVC Tee or Wye with Coupling	5	Each	\$	400.00	\$	2,000.00
67	12"x6" PVC Tee or Wye with Coupling		Each	\$	500.00	\$	-
68	Seal visible infiltration through manhole walls, bench and invert (brick manhole)	2	Each	\$	500.00	\$	1,000.00
69	Seal visible infiltration through manhole walls, bench and invert (concrete manhole)	10	Each	\$	500.00	\$	5,000.00
70	Repair Sewer Manhole bench and invert	10	Each	\$	350.00	\$	3,500.00
71	Replace Sewer Manhole bench and invert	5	Each	\$	450.00	\$	2,250.00
72	Wall Repair/Build Up for Excessive Interior Wall Surface Loss of Sewer Manhole	50	SQ. FT.	\$	20.00	\$	1,000.00
73	Replace Sewer Manhole Ring & Covers (in street pavement)	5	Each	\$	900.00	\$	4,500.00
74	Replace Sewer Manhole Ring & Covers (in non-paved area)	5	Each	\$	750.00	\$	3,750.00
75	Install Sewer Manhole Inflow Protectors	10	Each	\$	55.00	\$	550.00
76	Install New Standard Precast Concrete Sewer Manhole (4-ft Diam. 4' to 5.9' feet deep)		Each	\$	8,000.00	\$	-
77	Install New Standard Precast Concrete Sewer Manhole (4-ft Diam. 6' to 7.9' feet deep)		Each	\$	8,700.00	\$	-
78	Install New Standard Precast Concrete Sewer Manhole (4-ft Diam. 8' to 9.9' feet deep)		Each	\$	9,800.00	\$	-
79	Install New Standard Precast Concrete Sewer Manhole (4-ft Diam. 10' to 11.9' feet deep)		Each	\$	10,600.00	\$	-
80	Install New Standard Precast Concrete Sewer Manhole (4-ft Diam. 12' to 13.9' feet deep)		Each	\$	13,000.00	\$	-
81	Install New Standard Precast Concrete Sewer Manhole (4-ft Diam. 14' to 16' feet deep)		Each	\$	16,000.00	\$	-
82	Install New Drop Connection Precast Concrete Sewer Manhole (4-ft Diam. 4' to 5.9' feet deep)		Each	\$	6,500.00	\$	-
83	Install New Drop Connection Precast Concrete Sewer Manhole (4-ft Diam. 6' to 7.9' feet deep)		Each	\$	7,400.00	\$	-
84	Install New Drop Connection Precast Concrete Sewer Manhole (4-ft Diam. 8' to 9.9' feet deep)		Each	\$	8,600.00	\$	-
85	Install New Drop Connection Precast Concrete Sewer Manhole (4-ft Diam. 10' to 11.9' feet deep)		Each	\$	8,600.00	\$	-
86	Install New Drop Connection Precast Concrete Sewer Manhole (4-ft Diam. 12' to 13.9' feet deep)		Each	\$	10,000.00	\$	-
87	Install New Drop Connection Precast Concrete Sewer Manhole (4-ft Diam. 14' to 16' feet deep)		Each	\$	12,000.00	\$	-
88	Install 6" through 12" PVC Drop Pipe For Manholes (for all depths)		Each	\$	600.00	\$	-
89	Demolition/Removal & Disposal Existing Sewer Manhole		Each	\$	4,500.00	\$	-
90	Install Coating to Sewer Manhole (4-ft Diam. Existing Brick Manhole)		V.F.	\$	220.00	\$	-
91	Install Coating to Sewer Manhole (4-ft Diam. Existing Precast Concrete Manhole)	100	V.F.	\$	200.00	\$	20,000.00
92	Install Thermo-Plastic Cast-In Liner to Sewer Manhole (4-ft Diam. Existing Precast Concrete Manhole)		V.F.	\$	250.00	\$	-
93	Asphalt Driveway Replacement (Restoration)	110	SQ. YD.	\$	40.00	\$	4,400.00

ATTACHMENT F Page 4

94	Concrete Driveway Replacement (Restoration)	110	SQ. YD.	\$	40.00	\$	4,400.00
95	Asphalt Pavement Removal	110	SQ. YD.	\$	12.00	\$	1,320.00
96	Concrete Pavement Removal	110	SQ. YD.	\$	14.00	\$	1,540.00
97	Asphalt Pavement Overlay (1.5" thick, Asphalt Type S-III: 20 to 100 tons per work area)	8	Tons	\$	250.00	\$	2,000.00
98	Concrete Sidewalk Replacement		SQ. YD.	\$	45.00	\$	-
99	Asphalt Sidewalk Replacement		SQ. YD.	\$	40.00	\$	-
100	Concrete Curb and Gutter Replacement		L.F.	\$	35.00	\$	-
101	Density Test	10	Each	\$	45.00	\$	450.00
102	Proctor Test	2	Each	\$	100.00	\$	200.00
103	Sod Replacement (St Augustine, Bahia or Bermuda)	100	SQ. YD.	\$	4.00	\$	400.00
104	Demucking with Imported Clean Fill		CU. YD.	\$	15.00	\$	-
105	Maintenance of Traffic (M.O.T.)	17300	L.F.	\$	1.00	\$	17,300.00
106	Preconstruction Manhole Survey (Condition Assessment)		Each	\$	40.00	\$	-
107	Smoke Testing of Gravity Sewer Mains and Laterals		L.F.	\$	0.35	\$	-
108	4" Line Stop		Each	\$	2,500.00	\$	-
109	6" Line Stop		Each	\$	3,000.00	\$	-
110	8" Line Stop		Each	\$	3,400.00	\$	-
111	10" Line Stop		Each	\$	4,100.00	\$	-
112	12" Line Stop		Each	\$	4,400.00	\$	-
113	16" Line Stop		Each	\$	7,200.00	\$	-
114	Pre-Construction Video	17300	L.F.	\$	0.50	\$	8,650.00
115	8" DIP/PVC C-900 Gravity Sanitary Sewer Main 0' to 8' deep	20	L.F.	\$	100.00	\$	2,000.00
116	8" DIP/PVC C-900 Gravity Sanitary Sewer Main 8' to 16' deep	20	L.F.	\$	120.00	\$	2,400.00
117	8" DIP/PVC C-900 Gravity Sanitary Sewer Main 16' to 22' deep		L.F.	\$	160.00	\$	-
118	10" DIP/PVC C-900 Gravity Sanitary Sewer Main 14' to 16' deep		L.F.	\$	150.00	\$	-
119	10" DIP/PVC C-900 Gravity Sanitary Sewer Main 16' to 18' deep		L.F.	\$	160.00	\$	-
120	Removal of Existing Coating/Lining	50	SQ. FT.	\$	5.00	\$	250.00
	(A) SUBTOTAL BASE BID (Bid Item 1-120)					\$	1,026,105.00
121	Mobilization/Demobilization (3.5% of Subtotal Base Bid Price (A))	1	L.S.			\$	35,913.68
122	Additional Work not included in Bid Items (15% of Subtotal Base Bid Price (A))	1	L.S.			\$	-
***	Level 2 MACP Manhole inspection	110	Each	\$	150.00	\$	16,500.00
	(B) SUBTOTAL ADDITIONAL WORK BID PRICE (Bid Item 121-122)					\$	-
	TOTAL BID PRICE (A+B)					\$	1,062,018.68

ATTACHMENT H

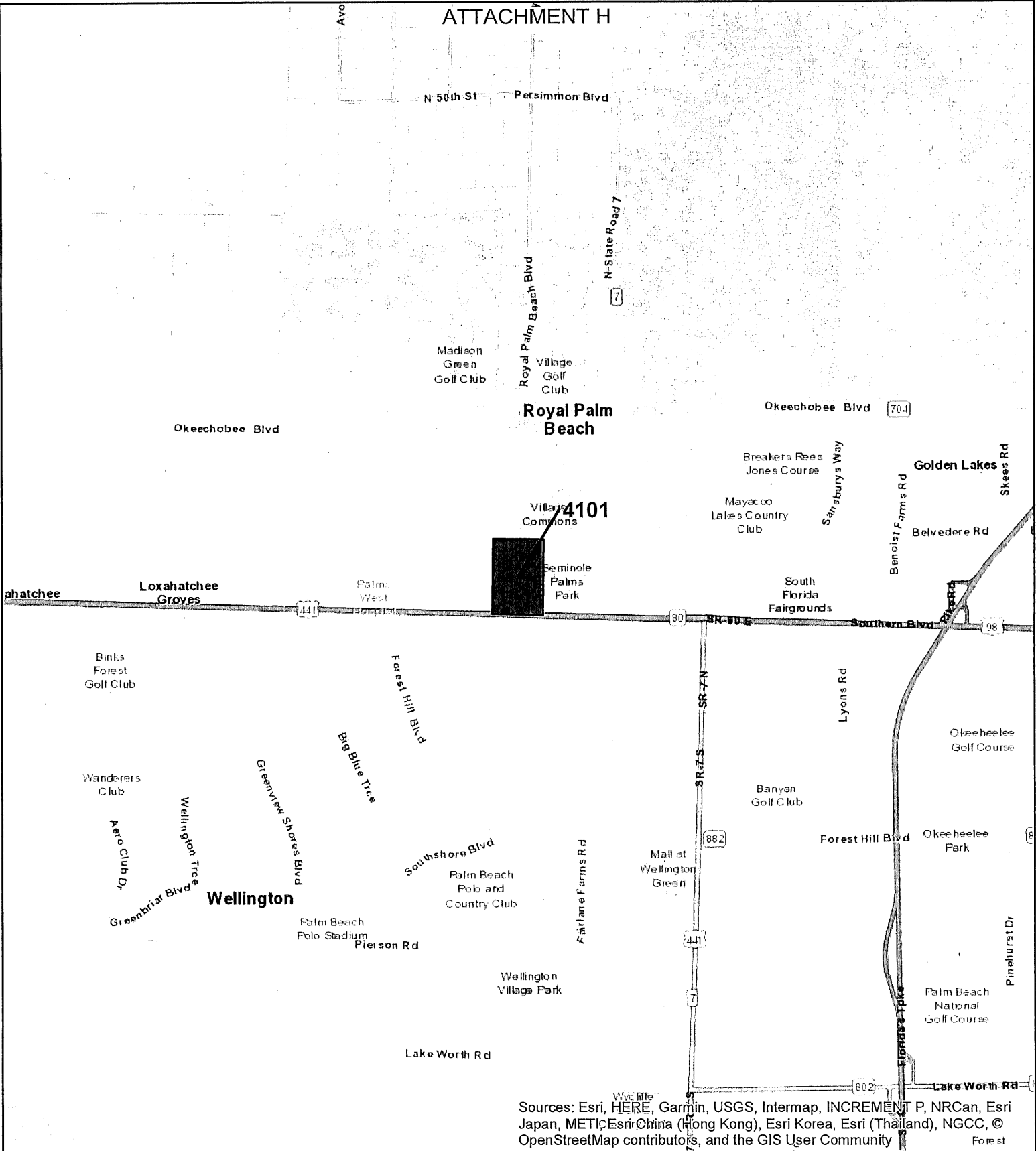

Sources: Esri, HERE, Garmin, USGS, Intermap, INCREMENT P, NRCan, Esri Japan, METI, Esri China (Hong Kong), Esri Korea, Esri (Thailand), NGCC, © OpenStreetMap contributors, and the GIS User Community



Palm Beach County
Water Utilities
Department
 8100 Forest Hill Blvd.
 West Palm Beach, FL 33416
 (561) 740-4600

Project Location Map
Sanitary Sewer Lining Project Lift Station Basin 4101
WUD No. 18-071
Legend
 Lift Station Basin Lining Project

Created by: Bill Kramer P.B.C.W.U.D. GIS Section - Date: 11/01/2018 - File: W:\GIS\PROJECTS\WUD CIP Packages\Conveyance Packages\CD-07 Collection System Rehab\WUD 18-071 Location Map.mxd

WAGNER BONDING
&
INSURANCE, INC.

October 22, 2018

Palm Beach County
8100 Forest Hill Blvd.
West Palm Beach, FL 33413

Re: **Hinterland Group, Inc.**

To whom it may concern,

We are the bonding agent for Hinterland Group, Inc.. They are bonded by Berkley Insurance Company, an "AXV" rated surety in the AM Best Guide. Please be advised that we authorize you to date powers of attorney, form of guarantee and bonds for WUD Project No. 18-071, Work Authorization No. 4, Project Title: Sanitary Sewer Lining Project Lift Station Basin 4101.

Should you have any questions or concerns, please do not hesitate to call.

Sincerely,
Wagner Bonding & Insurance, Inc



Taylor D. Wagner
Resident Florida Licensed Agent
Attorney-In-Fact

P.O. Box 91147 Lakeland, FL. 33804
Phone 863-859-9823
Fax 863-815-1864

ATTACHMENT 3

Summary of Certificates

This report displays detailed Certificate of Insurance information for a selected Insured. Any items shown in red are deficient.

Tuesday, December 18, 2018

Insured: Hinterland Group, Inc. Insured ID: 16-094R-PBC

Status: Compliant

ITS Account Number: PLC2873

Project(s): Palm Beach County - Water Utilities - (Active)

Insurance Policy	Required	Provided	Override
<u>General Liability</u>			
Expiration: 1/31/2019			
General Aggregate:	\$1,000,000	\$2,000,000	
Products - Completed Operations Aggregate:	\$1,000,000	\$2,000,000	
Personal And Advertising Injury:	\$0	\$1,000,000	
Each Occurrence:	\$1,000,000	\$1,000,000	
Fire Damage:	\$0	\$0	
Medical Expense:	\$0	\$0	
<u>Automobile Liability</u>			
Expiration: 1/31/2019			
	All Owned Autos	Any Auto not provided	X
	Hired Autos	not provided	X
	Non-Owned Autos	not provided	X
Combined Single Limit:	\$1,000,000	\$1,000,000	
<u>Workers Compensation/Employers Liability</u>			
Expiration: 1/31/2019			
Each Accident:	\$100,000	\$1,000,000	
Disease - Policy Limit:	\$500,000	\$1,000,000	
Disease - Each Employee:	\$100,000	\$1,000,000	
<u>Inland Marine/Transit Coverage</u>			
Expiration: 1/31/2019			
	Loss Payee	Loss Payee	

Notifications (Show All)

There were no deficiency letters issued.

Do you have an updated Certificate? Click the button below to submit a Certificate.