

PALM BEACH COUNTY BOARD OF COUNTY COMMISSIONERS

AGENDA ITEM SUMMARY

Meeting Date: August 20, 2019 [X] Consent [] Regular [] Workshop [] Public Hearing

Department: County Administration Submitted By: County Administration Submitted For: Office of Community Revitalization

I. EXECUTIVE BRIEF

Motion and Title: Staff recommends a motion to approve:

- A) Expenditure of \$21,300 for the installation of 7 speed humps in the San Castle Countywide Community Revitalization Team (CCRT) area; B) Expenditure of \$63,000 for the installation of 15 speed humps in the Plantation CCRT area; C) Expenditure of \$16,800 for the installation of 4 speed humps in the City of Pahokee; and D) Transfer within the 3900 Capital Outlay Fund for the following projects: 1. San Castle Speed Humps Installation Project for \$21,300 2. Plantation Speed Humps Installation Project for \$63,000 3. Pahokee Speed Humps Installation Project for \$16,800

Summary: The installation of speed humps was requested by neighborhood residents from the Plantation and San Castle CCRT areas and by the City of Pahokee to address the need to slow down traffic and improve safety along County roadways. Approval of the requested funds and the associated budget transfer will fund the construction of a total of 26 speed humps. County policy requires that 60 percent of affected property owners for each street, sign a petition in support of the project. The necessary supporting petitions for the three (3) projects have been received, reviewed and approved by Traffic Engineering, and Staff is recommending approval of the projects. Districts 2, 6 and 7 (HH)

Background and Justification: These Speed Hump Installation Projects were initiated by neighborhood residents from the above referenced CCRT areas and by the City of Pahokee to reduce speeding and improve neighborhood safety. The projects entail the installation of 7 speed humps in the San Castle CCRT area at a cost of \$3,600 per speed hump, along San Castle Boulevard and Washington Avenue; 15 speed humps at a cost of \$4,200 per speed hump in the Plantation CCRT area, along Elmhurst Road, Meridian Road, Buccaneer Trail, Cartier Road, Tiffany Place, and Breezy Lane; and 4 speed humps at a cost of \$4,200 per speed hump in the City of Pahokee, along El Dorado Drive and Seville Street. The total cost of the three projects is \$101,100. The requested transfers are needed to cover the cost of implementation. Funding is available from the CCRT Recoup Funding Account.

The San Castle Speed Hump Installation Project was originally approved by the BCC on July 10, 2018 through the allocation of \$36,400. After the project's approval, OCR and Traffic Engineering Management determined that there were errors made in the counting of signed petitions for San Castle Blvd and Washington Ave., and these two streets were re-petitioned to ensure they met the 60% requirement. The 60% requirement for the two streets has now been met. To date, a total of 9 speed humps have been built along Orange St., Mentone Rd., Thatcher Ave., and Monroe Blvd.. The total amount spent to date is \$32,500 and cover the costs of asphalt, signage and thermoplastic striping, with a remaining balance of \$3,900. As a result of the re-petitioning of San Castle Blvd. and Washington Ave. and in consultation with San Castle neighborhood residents, OCR and Traffic Engineering Management, added one speed hump location on each street, resulting in a total of 7 speed humps being proposed for installation along these streets. The cost to complete the remaining 7 speed humps is \$25,200. Staff is recommending the allocation of \$21,300 to complete the project.

- Attachments: 1. Budget Transfers 2. Speed Hump Layouts

Recommended by: [Signature] Department Director Date 7/24/2019 Approved By: [Signature] Assistant County Administrator Date 7/30/19

II. FISCAL IMPACT ANALYSIS

A. Five Year Summary of Fiscal Impact:

Fiscal Years	2019	2020	2021	2022	2023
Capital Expenditures	\$101,100				
Operating Costs					
External Revenues					
Program Income(County)					
In-Kind Match(County)					
NET FISCAL IMPACT	\$101,100				
#ADDITIONAL FTE POSITIONS (CUMULATIVE)					

Is Item Included in Current Budget? Yes No
 Does this item include the use of federal funds? Yes No

Budget Account No.:

Fund	Agency	Unit	Object	
3900	366	X177	6551	San Castle Speed Hump Project
3900	366	X179	6551	Pahokee Speed Hump Project
3900	366	X180	6551	Plantation Speed Hump Project

B. Recommended Sources of Funds/Summary of Fiscal Impact: Any remaining or unused Project funds will be transferred back to the 3900-366-X006-9909 account.

C. Departmental Fiscal Review: *See D'Agostino*

III. REVIEW COMMENTS

A. OFMB Fiscal and/or Contract Dev. and Control Comments:

Robert Deane 7/24/19 *Dr. S. Jewell* 7/26/19
 AP OFMB Contract Dev. and Control
 7/22

B. Legal Sufficiency:

Debra C. King 7-26-19
 Assistant County Attorney

C. Other Department Review:

ma
 Department Director

19-0856

BOARD OF COUNTY COMMISSIONERS
PALM BEACH COUNTY, FLORIDA
BUDGET TRANSFER

BGEX 366-070919*1573

FUND
3900 Capital Outlay

ACCT.NUMBER	ACCOUNT NAME	ORIGINAL BUDGET	CURRENT BUDGET	INCREASE	DECREASE	ADJUSTED BUDGET	EXPENDED/ ENCUMBERED 7/9/2019	REMAINING BALANCE
<u>REVENUES/EXPENDITURES</u>								
366-X006-9909	Res- Improvement Program	1,495,765	1,513,325	0	101,100	1,412,225		1,412,225
366-X177-6551	Road & Street Improvements	36,400	35,523	21,300	0	56,823	25,789	31,034
366-X179-6551	Road & Street Improvements	0	0	16,800	0	16,800		16,800
366-X180-6551	Road & Street Improvements	0	0	63,000	0	63,000		63,000
Total Receipts and Balances		30,772,375	26,360,350	101,100	101,100	26,360,350		

Signatures & Dates

By Board of County Commissioners
At Meeting of 08/20/2019

Office of Financial Management & Budget
INITIATING DEPARTMENT/DIVISION

Administration/Budget Department Approval

OFMB Department - Posted

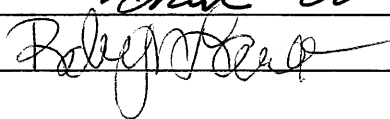
 7/16/19
 7/26/19

Deputy Clerk to the
Board of County Commissioners



SAN CASTLE CCRT AREA SPEED HUMP LAYOUT



MAP PRODUCED BY:
PALM BEACH COUNTY TRAFFICE ENGINEERING  = PROPOSED SPEED HUMP



PLANTATION MHP CCRT AREA SPEED HUMP LAYOUT

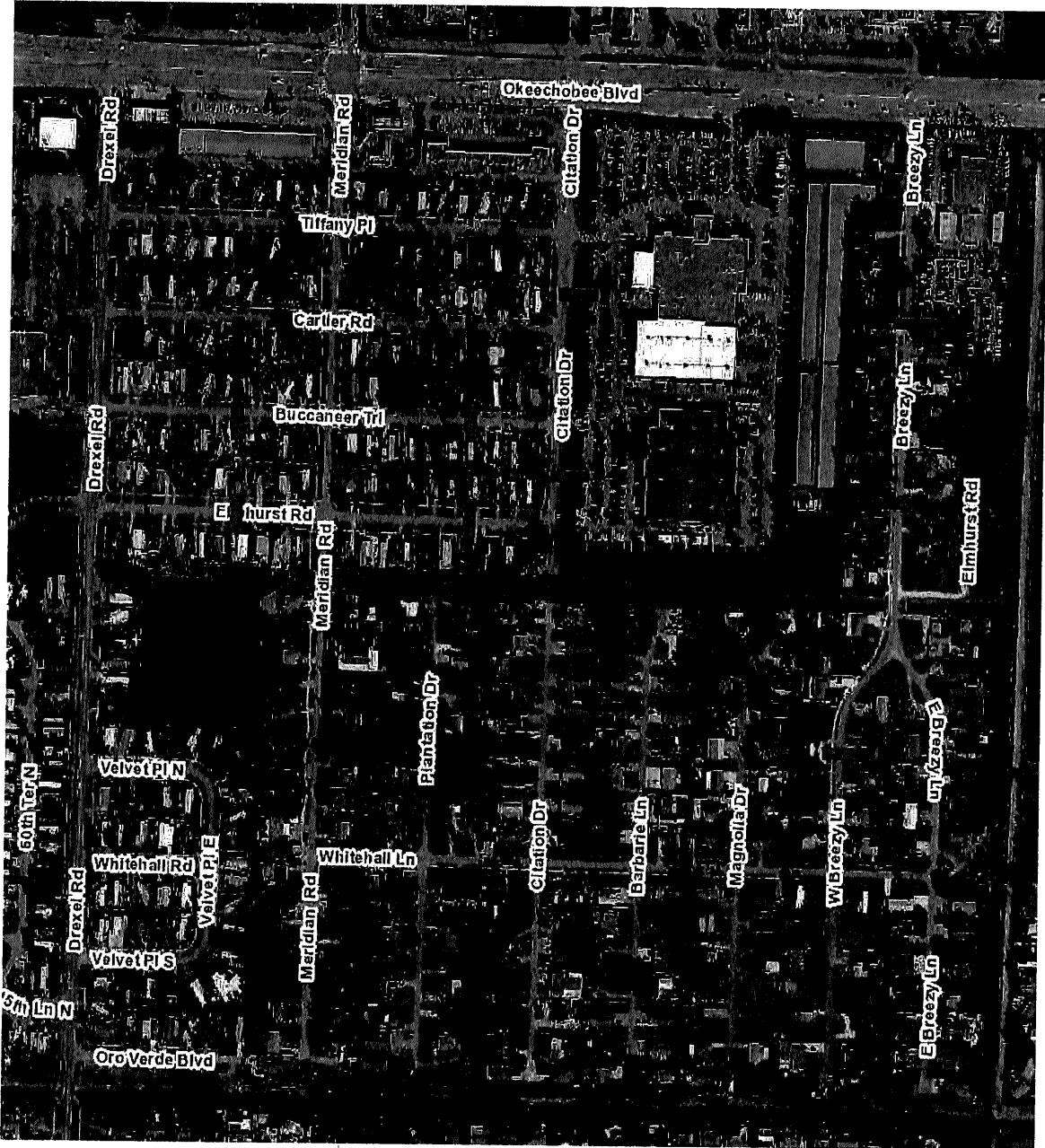

MAP PRODUCED BY:
PALM BEACH COUNTY TRAFFIC ENGINEERING ■■■■ = PROPOSED SPEED HUMP



CITY OF PAHOKEE SPEED HUMP LAYOUT MAP ELDORADO DRIVE

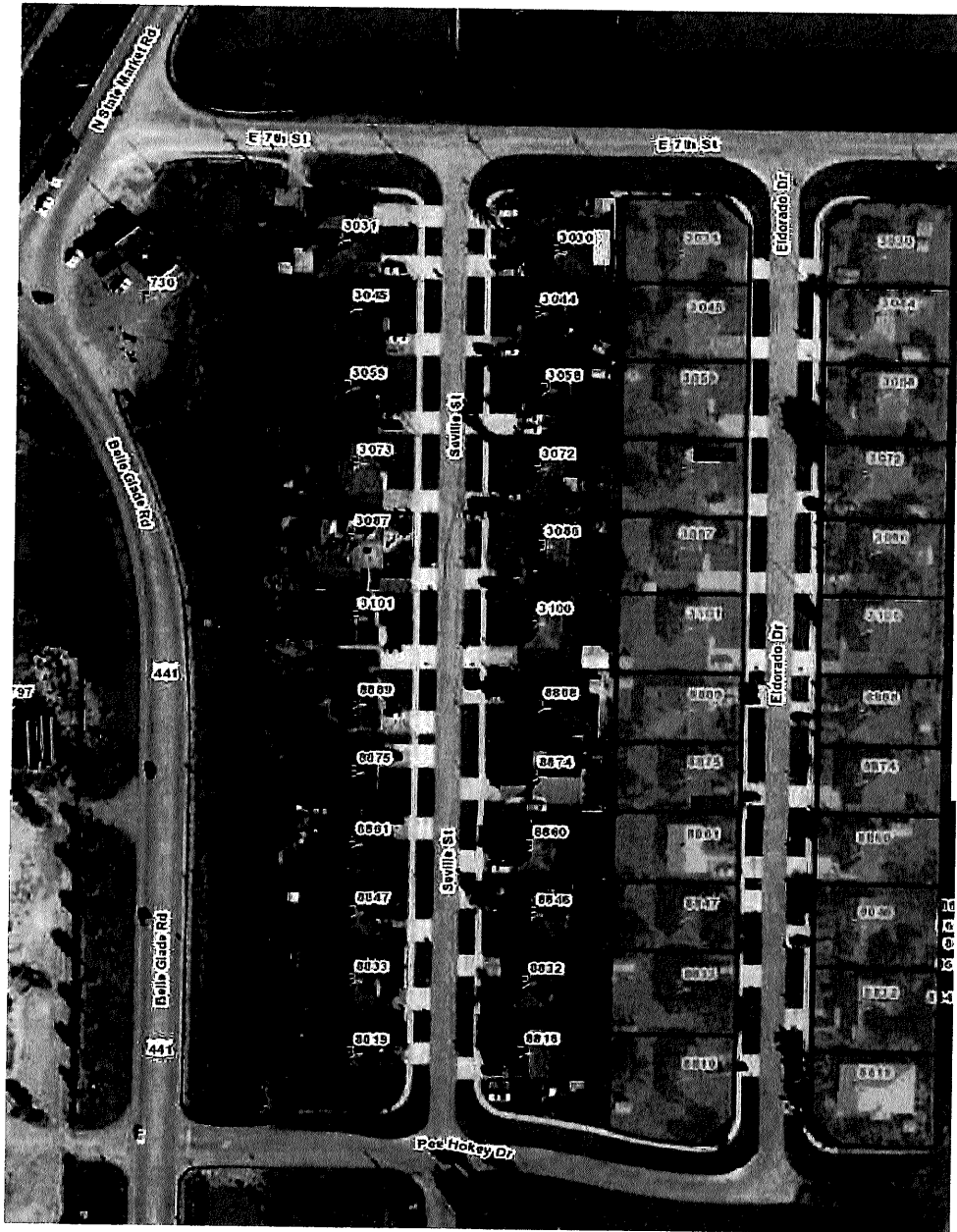

MAP PRODUCED BY:
PALM BEACH COUNTY TRAFFICE ENGINEERING  = PROPOSED SPEED HUMP



CITY OF PAHOKEE SPEED HUMP LAYOUT MAP SEVILLE STREET

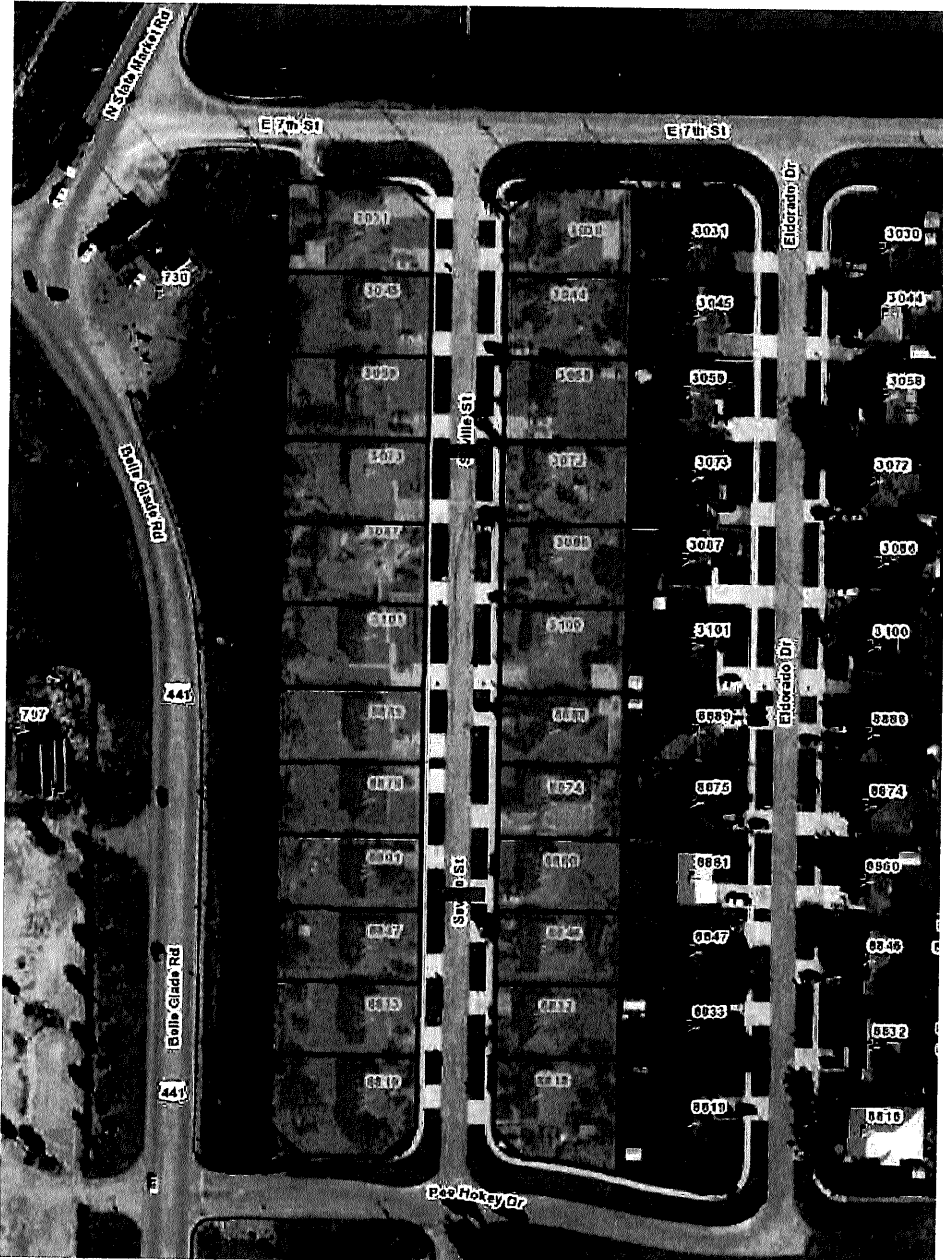

MAP PRODUCED BY:
PALM BEACH COUNTY TRAFFIC ENGINEERING ■■■ = PROPOSED SPEED HUMP